



MASSEY FERGUSON

AGCO



ATTACHMENT OPERATOR'S MANUAL

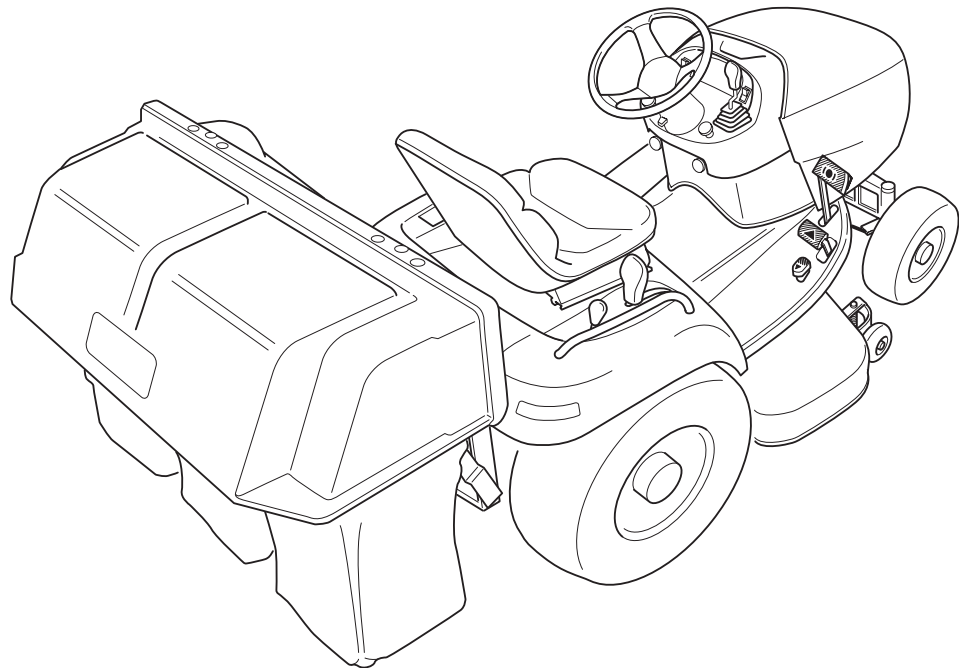

Clean Sweep Triple Catcher

Clean Sweep Triple Catcher

Mfg. No.	Description
1694390	Hitch & Tube Kit (For Use With Legacy XL / 2000 / 2900)
1694389	Clean Sweep Triple Catcher

1725580

Rev. 01

Rev Date 01/2004

TP 100-3898-01-AT-SMAN

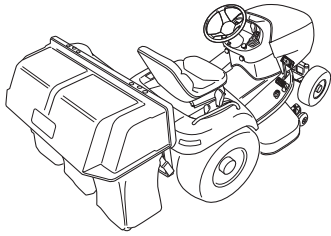

Table of Contents

Safety Rules & Information

General Warnings.....	2
Safety Decals	2

General Operating Information

Mowing with the Triple Catcher.....	3
Recommended Accessories.....	3
After Operation	3

Initial Hitch Installation -

Models without 3-point Hitch

Install Hitch.....	4
--------------------	---

Initial Hitch Installation -

Models with 3-point Hitch

Install Hitch.....	5
--------------------	---

Initial Collector Assembly - All Models

Assemble Front & Back Plates	6
Assemble Tubes & Deflector	7

Assemble Catcher Bags	8
Install Cover.....	8

Removing & Reattaching the Triple Catcher

Removing the Grass Catcher	9
Reattaching the Grass Catcher	10
Storing the Grass Catcher.....	11

Hardware Identification

& Torque Specifications.....	12
------------------------------	----

NOTE: In these instructions, "left" and "right" are referred to as seen from the operating position.

Safety Rules & Information



Read these safety rules and follow them closely. Failure to obey these rules could result in loss of control of unit, severe personal injury or death to you, or bystanders, or damage to property or equipment. The triangle  in text signifies important cautions or warnings which must be followed.

GENERAL WARNINGS

- Know the unit's controls and how to stop quickly. **READ THE OPERATOR'S MANUALS.**
- Read and obey all safety decals.
- Only allow responsible adults, who are familiar with the instructions, to operate the unit.
- Disengage the PTO. Shut off the engine and wait for all moving parts to stop before attaching, adjusting, or disconnecting any part of the collection system.
- Check the collection system to make sure it is bolted tightly to the unit.
- DO NOT operate the unit without either the entire grass catcher or the deflector in place.
- Turn off the PTO to disengage the blades when not mowing.
- DO NOT mow in reverse. Always look down and behind before and while travelling in reverse.
- DO NOT turn sharply when travelling alongside a building or any object. Slow down before turning.
- DO NOT carry passengers.
- When collection system is removed from the mower deck, the deflector must be properly installed.
- Collector bags are subject to deterioration and wear during normal use. Inspect the bag periodically for tears, holes, or weak spots and replace with a new bag that meets manufacturer's durability standards.
- If the mower stalls or the collector chute plugs:
 1. Disengage the PTO;
 2. Stop the engine and remove the key;
 3. Set the parking brake, and wait for all moving parts to stop.
 4. Remove the foreign object or clear the chute with a piece of wood before restarting the engine. **NEVER place hands into COLLECTOR OR MOWER housing to clear jammed objects. Blower OR MOWER may rotate when object is removed.**
- For added stability and to prevent tipping or loss of control:
 - a. Use reduced speed on uneven ground and when turning corners.
 - b. Reduce loads on hillsides. It is recommended that the collection system be kept only half full when negotiating any slopes. Start mowing on slopes when the collection system is empty.
 - c. Mow up and down the face of slopes; never across the face of any slope.
- When operating on slopes, use front counterweights. **Never operate on slopes greater than 17.6% (10°).**

SAFETY DECALS

This unit has been designed and manufactured to provide you with the safety and reliability you would expect from an industry leader in outdoor power equipment manufacturing.

Although reading this manual and the safety instructions it contains will provide you with the necessary basic knowledge to operate this equipment safely and effectively, we have placed several safety labels on the unit to remind you of this important information while you are operating your unit.

All DANGER, WARNING, CAUTION and instructional messages on your rider, attachments and mower should be carefully read and obeyed. Personal bodily injury can result when these instructions are not followed. The information is for your safety and it is important! The safety decals below are on your product.

If any decals are lost or damaged, replace them at once. See your local dealer for replacements.

These labels are easily applied and will act as a constant visual reminder to you, and others who may use the equipment, to follow the safety instructions necessary for safe, effective operation.

ATTACHMENT DECALS

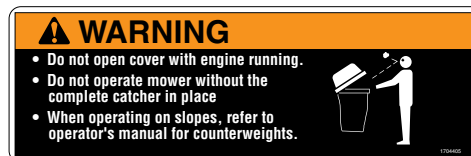

**Decal - WARNING Do Not Open Cover
Part Number 1704405**

Read and obey all operation and warning decals.



Operating Instructions



BEFORE OPERATION

Clear the lawn of all sticks, stones, wire and other debris which may be caught or thrown by the mower blades.

Check grass condition. If wet, wait until later in the day. If grass is wet, the grass catcher is likely to become plugged.

For efficient bagging, air circulation under the mower deck, through the chute and into the bag is very important.

For this reason, BEFORE YOU BEGIN MOWING you should make certain the underside of the mower and the underside of the catcher lid are free from grass and debris.

Make sure that there is a snug fit between mower deck, blower housing, tubes, and grass catcher cover.

MOWING WITH THE CATCHER

Always operate with throttle at full speed when mowing.

Grass should be cut often, and not too short. If grass is too long or lush it may be necessary to keep ground speed to a minimum or to cut only half the width of the mower to prevent clogging. If grass is long, operate with mower in high cutting position for first pass, cutting again in a lower position on a second pass.

Do not open the cover with mower engaged.

If a large amount of cut grass is spilling out from under deck, the tube may be plugged or the bags may be full—discontinue mowing, stop the rider, disengage the PTO, shut off the engine and then empty the catcher or clear the tube.

WARNING

ALWAYS shut off the tractor. Disengage the PTO, and allow all moving parts to stop BEFORE disconnecting or clearing tube, or emptying catcher.

Before leaving the operator's position for any reason, engage the parking brake, disengage the PTO, stop the engine and remove the key.

To reduce fire hazard, keep the engine, rider and mower free of grass, leaves and excess grease. Do not stop or park rider over dry leaves, grass or combustible materials.

REQUIRED ACCESSORIES

A front-mounted weight carrier and 150 lbs. worth of weights are required when using this rear-mounted grass catcher. **Never operate on slopes greater than 17.6% (10°).**

AFTER OPERATION

Remove any debris from the the screen on the underside of the lid. *Note: The lid screen can be partially removed for easier cleaning and should be cleaned regularly.*

The blower housing and tube should be removed for cleaning.

Inspect the grass bags for wear or damage. Make sure that there is a snug fit between mower deck, blower housing, tubes, and grass catcher cover.

STORING THE GRASS CATCHER

Clean the grass catcher thoroughly using a mild detergent (other products may damage the tube). Remove any debris from the the screen on the underside of the lid.

If paint has been scratched on metal parts, touch up with paint, or apply a thin film of oil to prevent corrosion.

Store in a dry area. Dry thoroughly before storing for a long period of time. Always store away from moisture.

Initial Hitch Installation - Models with out 3-Point Hitch

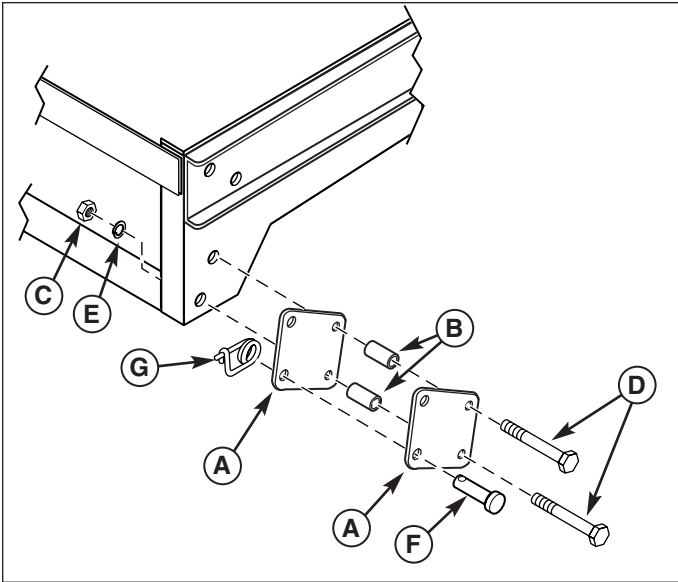
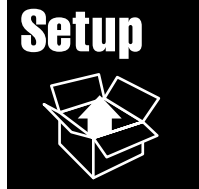

Figure 1. Install Side Brackets
A. Side Brackets **E. Lockwashers, 1/2**
B. Spacers **F. Clevis Pins**
C. Nuts, 1/2-13 **G. Safety Clips**
D. Capscrews, 1/2-13 x 2-1/2

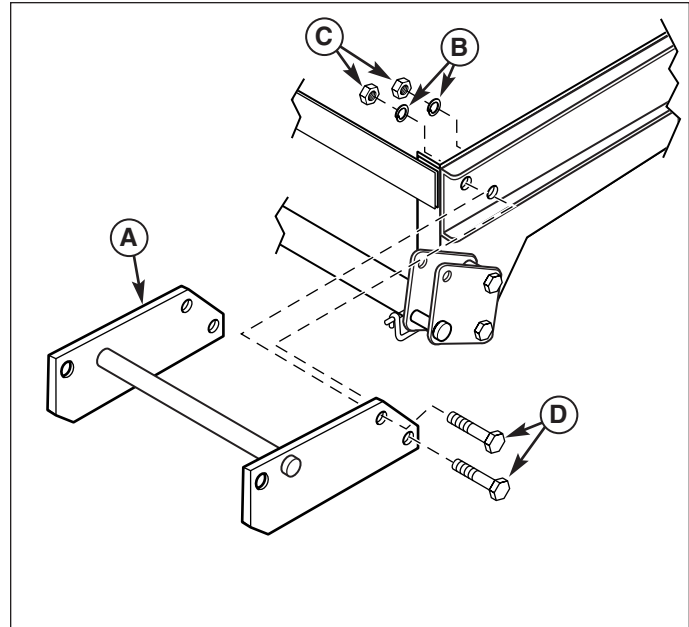

Figure 2. Install Hitch Assembly
A. Hitch Assembly
B. Lockwashers, 1/2
C. Nuts, 1/2-13
D. Capscrews, 1/2-13 x 1-1/4

INITIAL HITCH INSTALLATION - MODELS WITHOUT 3-POINT HITCH

Install Hitch

1. Mount two side brackets (A, Figure 1) to the same side of the frame placing spacers (B) between side brackets (A). Secure with two 1/2-13 x 2-1/2 cap screws (D) 1/2 lock washers (E) and 1/2-13 nuts (C) per side.
2. Install the hitch assembly (A, Figure 2). Secure with 1/2-13 x 1-1/4 cap screws (D), 1/2 washers (B) and 1/2-13 nuts (C)
3. Install the back plate (B, Figure 3) on the lower spacers (D) and secure to the hitch with the long hitch pin (C) and hair pin clip (A).

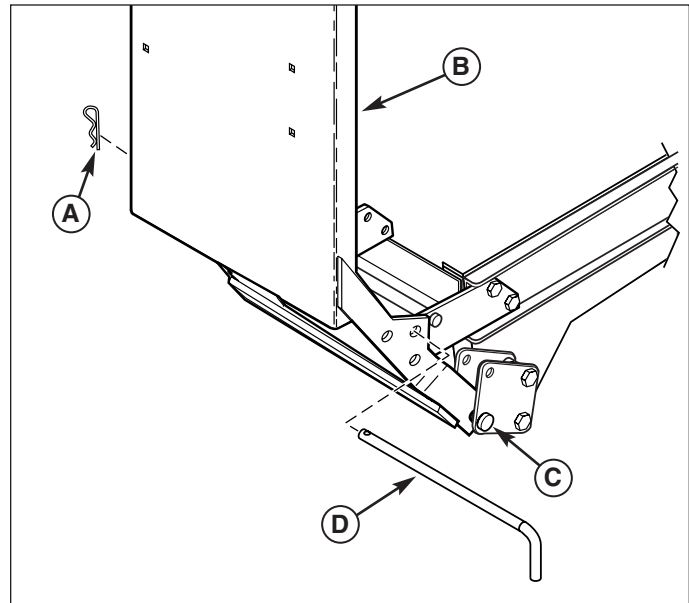

Figure 3. Install Back Plate
A. Hair Pin Clip
B. Back Plate
C. Hitch Pin
D. Lower Spacer



Initial Hitch Installation Models with 3-Point

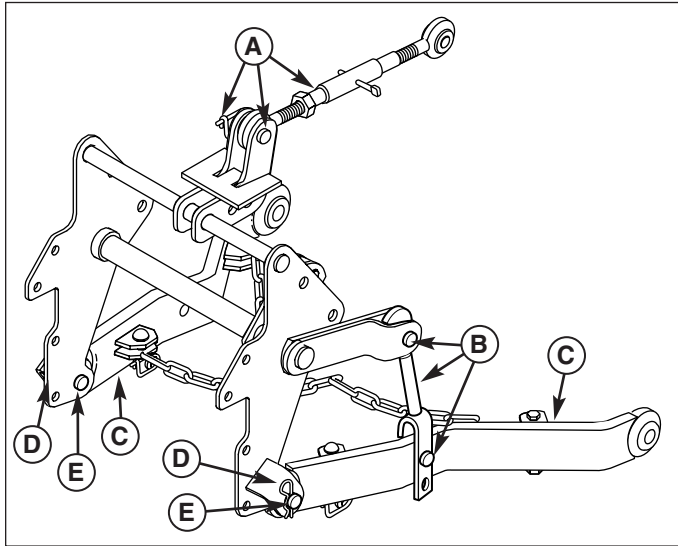

Figure 4. Install Side Brackets
A. Tube Assembly & Mounting Hardware
B. Clevis Assembly & Mounting Hardware
C. Lower Link & Chain Assembly
D. Hair Pin
E. Clevis Pin

INITIAL HITCH INSTALLATION - MODELS WITH 3 POINT HITCH

Install Hitch

1. Remove the tube assembly & mounting hardware (A, Figure 4).
2. Remove the two clevis assemblies & mounting hardware (B, Figure 4).
3. Remove the two lower link & chain assemblies (C, Figure 4) by removing hair pins (D) and clevis pins (E). Reinsert clevis pins (E) and hair pins (D)
4. Raise the lift arm (E, Figure 5) up above the lower hole of the 3-point hitch (F). Install the back plate (B, Figure 5) on the clevis pins (D) and secure to the hitch with the long hitch pin (C) and hair pin clip (A).

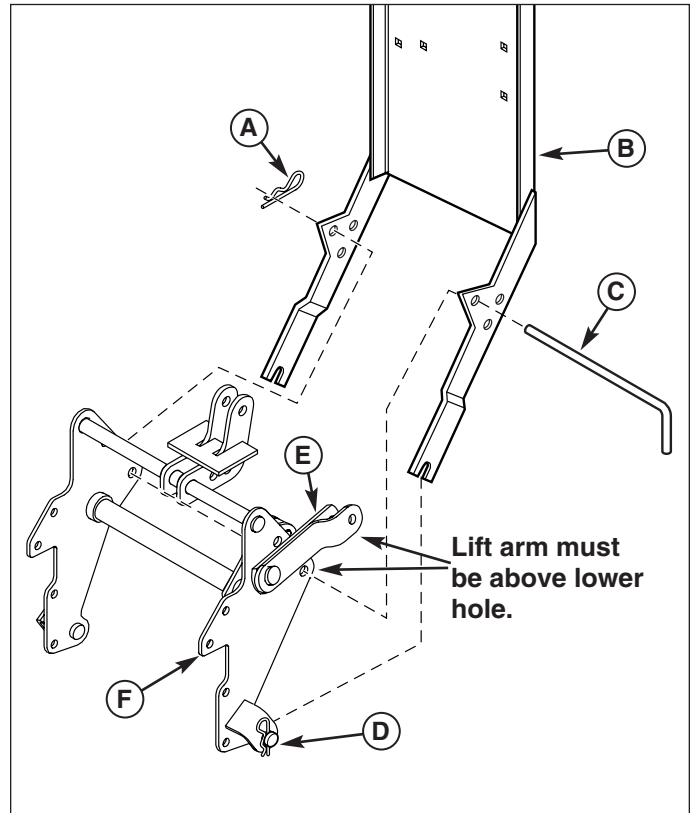

Figure 5. Install Side Brackets
A. Hair Pin Clip
B. Back Plate
C. Hitch Pin
D. Clevis Pin
E. Lift Arm
F. 3-Point Hitch

Lift arm must be above lower hole.

Initial Collector Assembly - All Models

Setup

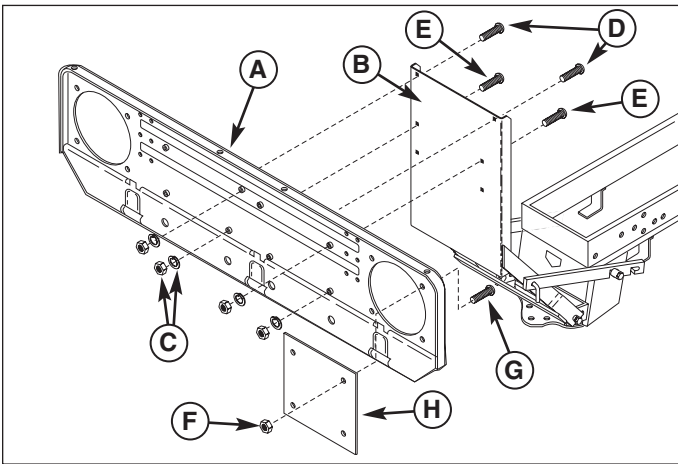

Figure 6. Install LH Discharge Back Plate

- A. Back Plate
- B. Front Plate
- C. 5/16-18 Nuts & Lockwashers
- D. 5/16-18 x 3/4 Carriage Bolts
- E. 5/16-18 x 1-1/4 Carriage Bolts
- F. Locknut, 5/16-18
- G. 5/16-18 x 1 Capscrew
- H. Cover Plate

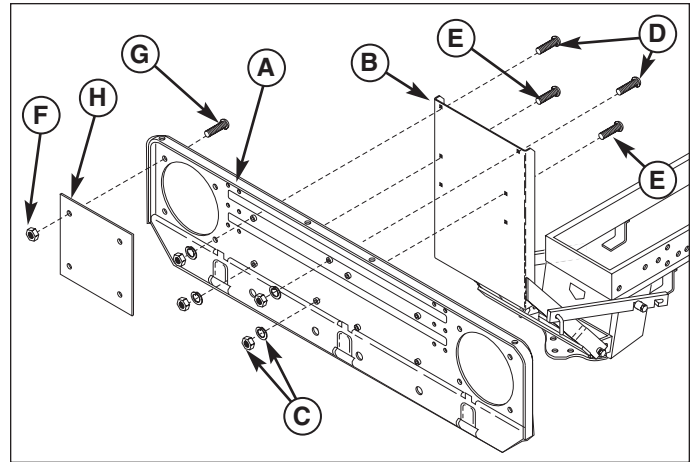

Figure 7. Install RH Discharge Back Plate

- A. Back Plate
- B. Front Plate
- C. 5/16-18 Nuts & Lockwashers
- D. 5/16-18 x 3/4 Carriage Bolts
- E. 5/16-18 x 1-1/4 Carriage Bolts
- F. Locknut, 5/16-18
- G. 5/16-18 x 1 Capscrew
- H. Cover Plate

INITIAL INSTALLATION & ASSEMBLY

Assemble Front and Back Plate

1. For units with left side discharge use the set of holes on the right side of the back plate. For units with right side discharge use the set of holes on the left side of the back plate. Attach the back plate (A, Figure 6 & 7) to the front plate (B) using carriage bolts, lockwashers, and nuts. Use two 5/16-18 x 3/4" carriage bolts (D) in the top two holes, and two 5/16-18 x 1-1/4" carriage bolts (E) in the bottom holes.
2. For units with left side discharge the cover plate mounts to the right side of the back plate. For units with right side discharge the cover plate mounts to the left side of the back plate. Install the cover plate (H, Figure 6 & 7) on the back plate (A). Secure with four 5/16-18 x 1 capscrews (G), and locknuts (F).

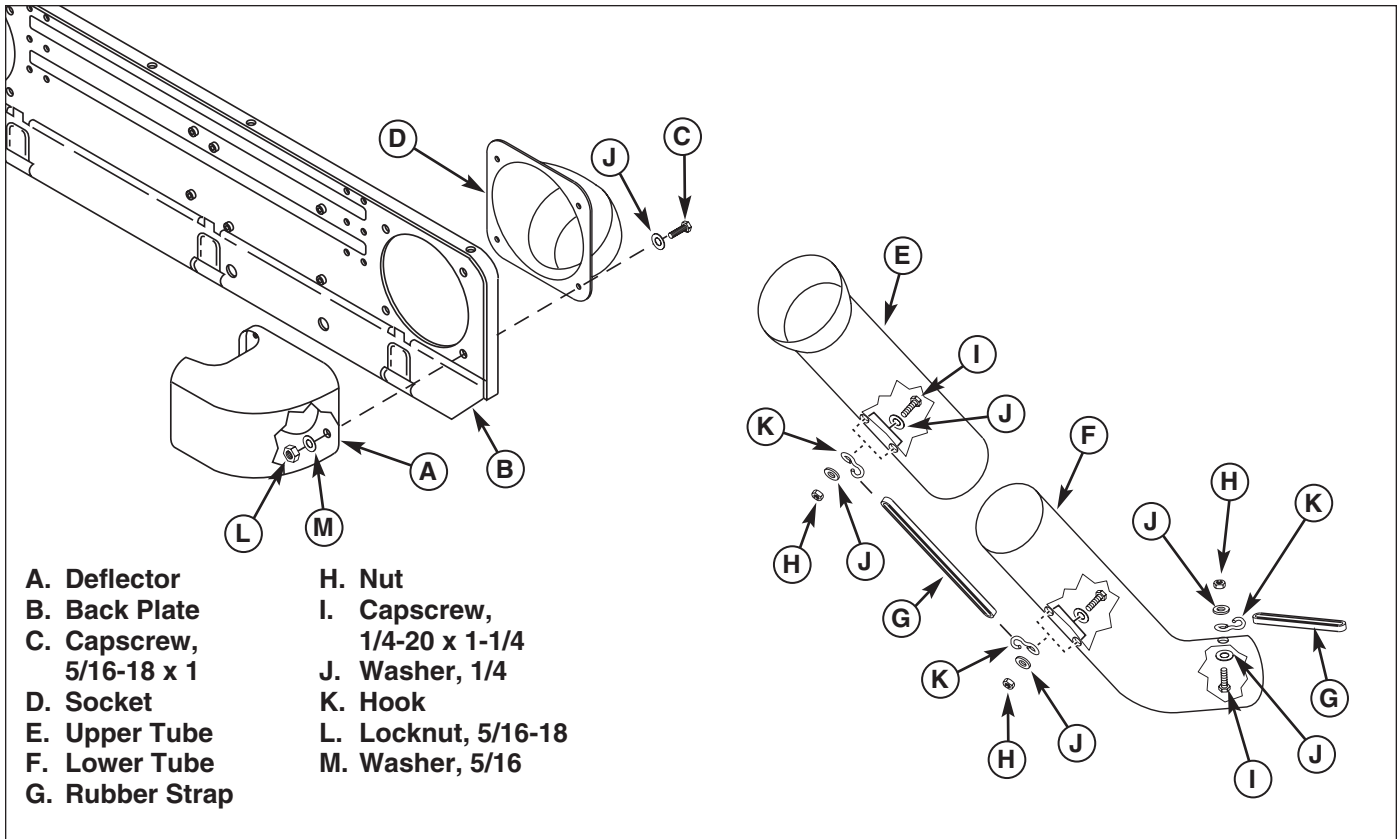

Figure 8. Assemble Tubes & Deflector

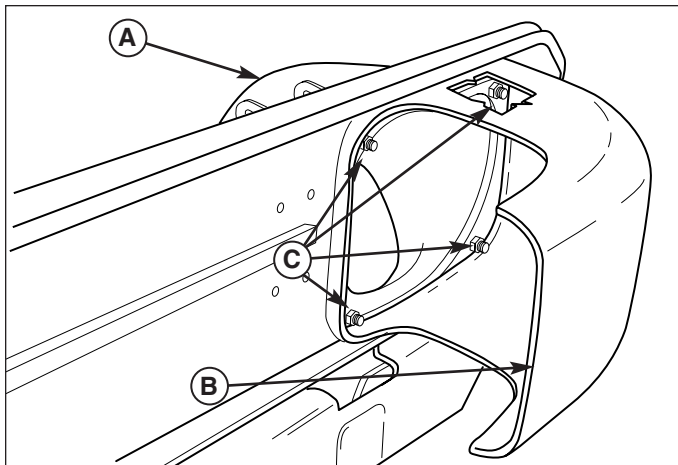

Figure 9. Mount Deflector and Tube Pivot
 A. Tube Pivot C. 5/16" Mounting Hardware
 B. Deflector

Assemble Tubes & Deflector

1. All models covered by this manual require the upper tube (E, Figure 8) to be left at full length.
2. If not already done, insert the upper tube (E, Figure 8) into the socket (D). Insert the tube from the front. This will require some effort.
3. Mount the socket (D, Figure 8) and deflector (A) to

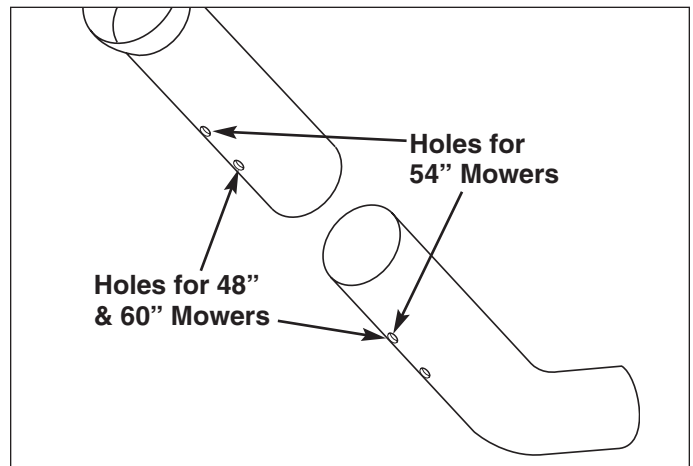

Figure 10. "S" Hook Hole Locations

the back plate (B) using the four 5/16-18 x 1" cap-screws (C), eight flat washers (M), and four nylock nuts (L) as shown in Figures 8 & 9.

4. Insert the lower tube (F) into the upper tube (E). Secure the elbow to the turbo using "S" hooks (K) and a rubber strap (G). Assemble as shown in Figure 8. Use Figure 10 to determine correct hole locations for hooks (K).

Note: Use correct hole locations to maintain proper tube connections and prevent lower tube from disconnecting from the turbo.

Initial Installation & Assembly

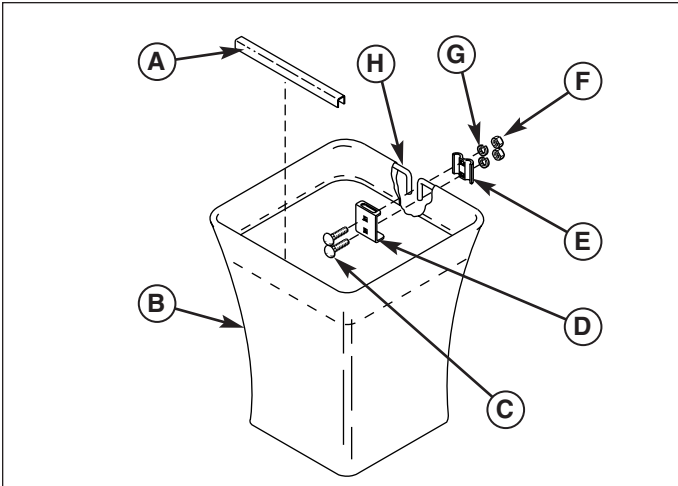

Figure 11. Assemble Catcher Bags

- | | |
|--------------------------------|---------------|
| A. Clip | E. Clamp |
| B. Cloth Bag | F. Nut |
| C. 5/16-18 x 3/4 Carriage Bolt | G. Lockwasher |
| D. Hanger Bracket | H. Wire Hoop |

Assemble Catcher Bags

See Figure 11.

1. Insert the wire hoop (H) through the cloth bag (B).
2. Install the clamp (E) and hanger bracket (D). Secure with two 5/16-18 x 3/4 carriage bolts (C), lockwashers (G), and nuts (F).

Install Cover

1. See Figure 12. Hook the bags (A) on the back plate (B). *Note: If desired, the bags can be lined with 30 gallon trash bags for easy disposal.*
2. See Figure 13. Set the cover (A) on top of the bags (B) and align the hinges (C).
3. See Figure 14. Install the hinge pins (B) through the hinges (C) and secure with a hair pin clip (D).

NOTE: Push the hair pin clips all the way on or they will be bent by the hinge when the cover is opened.

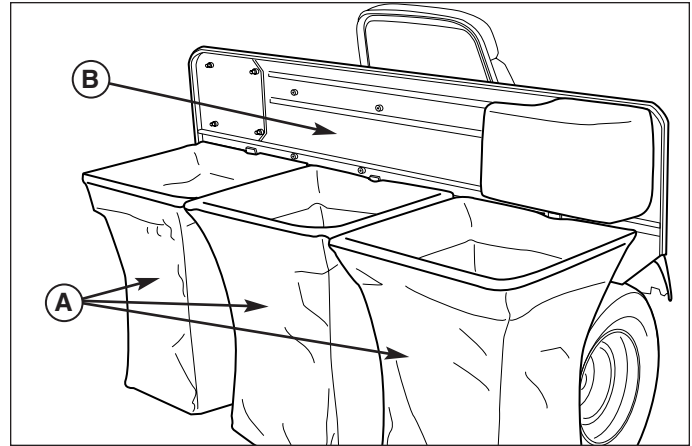

Figure 12. Install the Bags

- | |
|---------------|
| A. Bags |
| B. Back Plate |

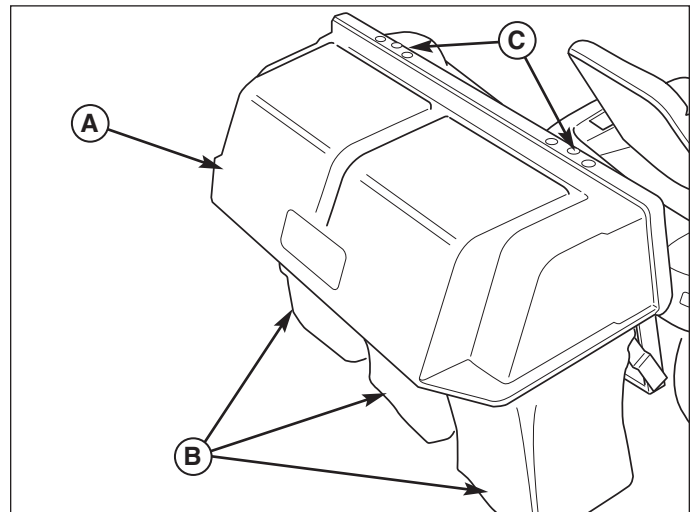

Figure 13. Install Cover

- | | |
|----------|-----------|
| A. Cover | C. Hinges |
| B. Bags | |

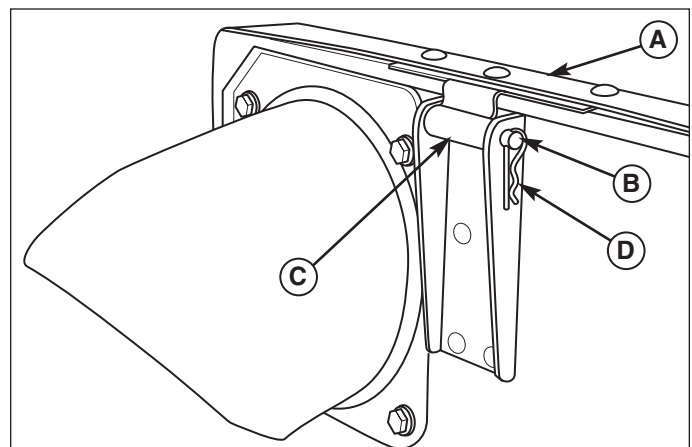

Figure 14. Install Hinge Pins

- | | |
|--------------|------------------|
| A. Cover | C. Hinge |
| B. Hinge Pin | D. Hair Pin Clip |



Removing & Reattaching Grass Catcher

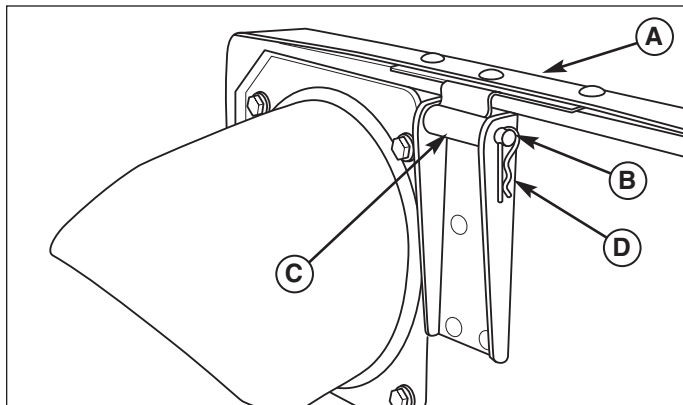

Figure 15. Remove the Cover

- A. Cover
- B. Hinge Pin
- C. Hinge
- D. Hair Pin Clip

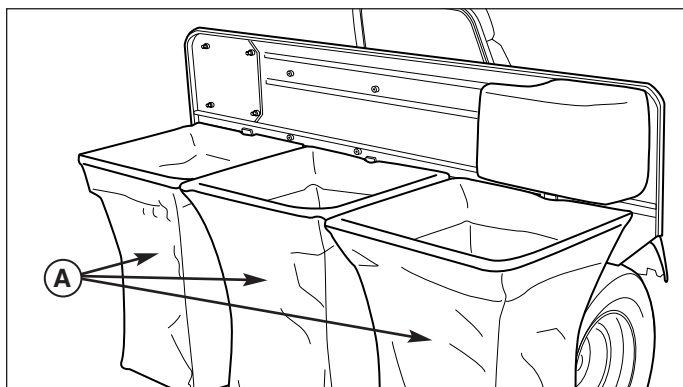

Figure 16. Remove the Bags

- A. Bags

REMOVING THE GRASS CATCHER

1. Remove the hair pin clips (D, Figure 15) and hinge pins (B) and remove the cover (A).
2. Remove the bags (A, Figure 16) by lifting them off their hooks. Empty any grass out the bags.
3. Remove the long hitch pin (C, Figure 17, non 3-Point Hitch Shown).
4. Lift the front and back plate assembly off the spacers or pins (See Figure 18).

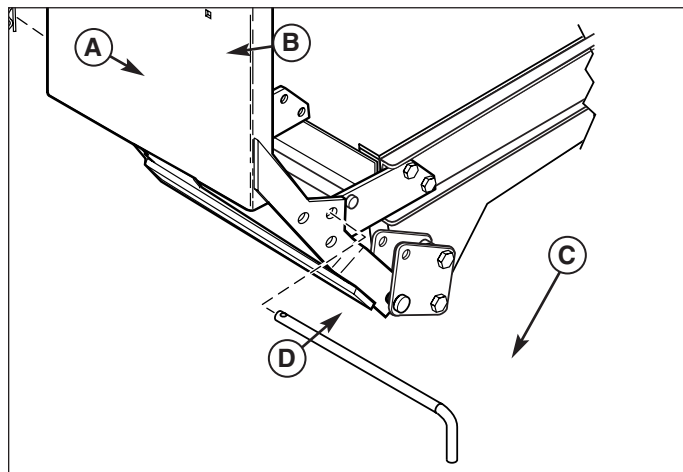

Figure 17. Install Side Brackets

- A. Hair Pin Clip
- B. Back Plate
- C. Hitch Pin
- D. Lower Spacer

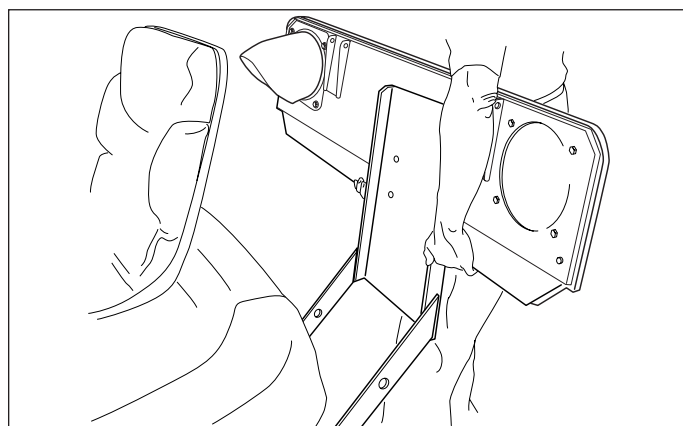

Figure 18. Front & Back Plate Assembly

WARNING

OPERATION WITHOUT TURBO & CATCHER

For operation without turbo, the mower deflector **MUST** be properly installed in the down position and retained by the spring latch (see turbo operator's manual).

Removing & Reattaching

REATTACHING THE GRASS CATCHER

Models with out 3-Point Hitch

1. Set the front and back plate assembly on the pins (Figure 19).
2. Secure with the long hitch pin (C, Figure 19)

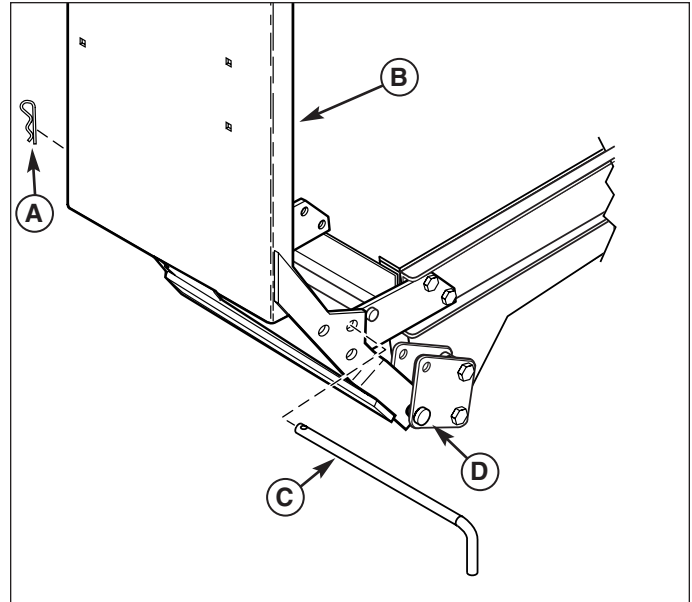

Figure 19. Install Back Plate, without 3-Point Hitch

- A. Hair Pin Clip
- B. Back Plate
- C. Hitch Pin
- D. Lower Spacer

Models with 3-Point Hitch

1. Set the front and back plate assembly on the clevis pins (Figure 20).
2. Secure with the hitch pin (C, Figure 20).

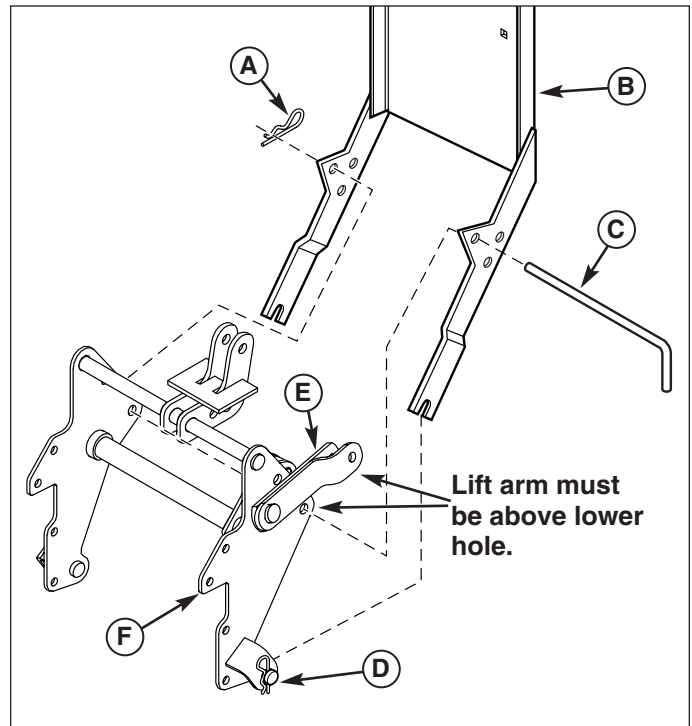

Figure 20. Install Back Plate, with 3-Point Hitch

- A. Hair Pin Clip
- B. Back Plate
- C. Hitch Pin
- D. Clevis Pin
- E. Lift Arm
- F. 3-Point Hitch

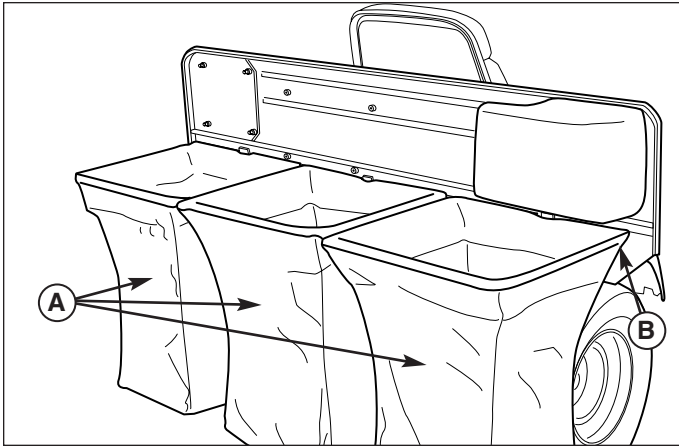

Figure 210. Bags

A. Bags

B. Back Plate

3. Hook the bags (A, Figure 21) on the back plate.
4. Install the catcher cover (A, Figure 22 & 23) and secure with the hinge pins (B) and hair pin clips (D).

NOTE: Push the hair pin clips all the way on or they will be bent by the hinge when the cover is opened.

5. Assemble the upper tube (A, Figure 24) and lower-tube (B) and attach them with a rubber strap (D). Attach to the collector. Attach tubes to the turbo blower with a rubber strap (D).

STORING THE GRASS CATCHER

Clean the grass catcher thoroughly using a mild detergent (other products may damage the tube). Remove any debris from the the screen on the underside of the lid. The screen can be partially removed for easier cleaning.

If paint has been scratched on metal parts, touch up with paint, or apply a thin film of oil to prevent corrosion.

Store in a dry area. Hang the catcher and catcher bags to dry thoroughly before storing for a long period of time. Always store away from moisture.

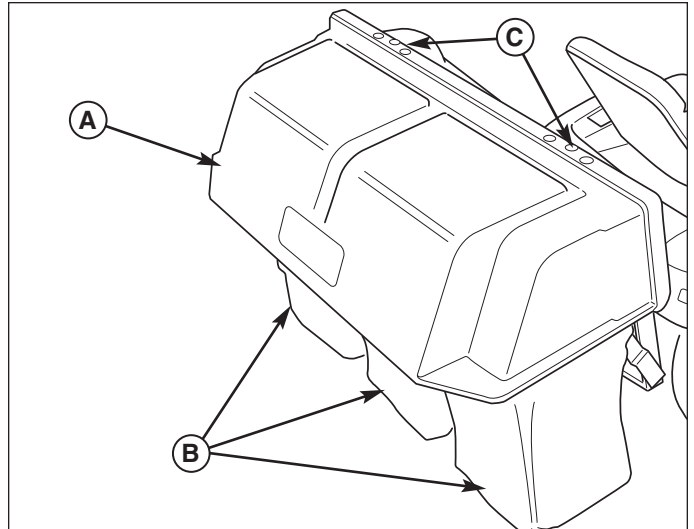

Figure 22. Install Cover

A. Cover

B. Bags

C. Hinges

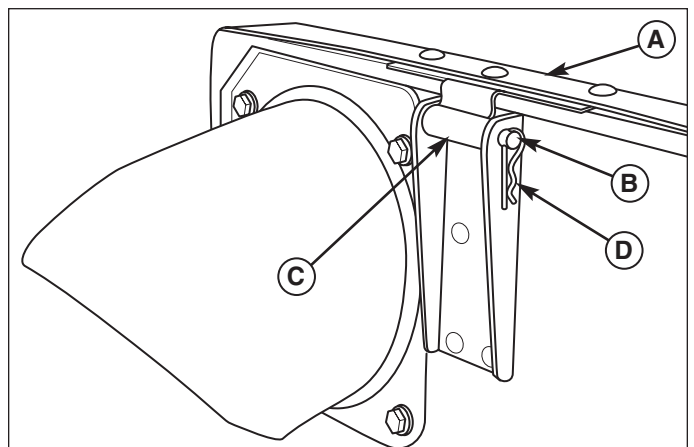

Figure 23. Install Hinge Pins

A. Cover

B. Hinge Pin

C. Hinge

D. Hair Pin Clip

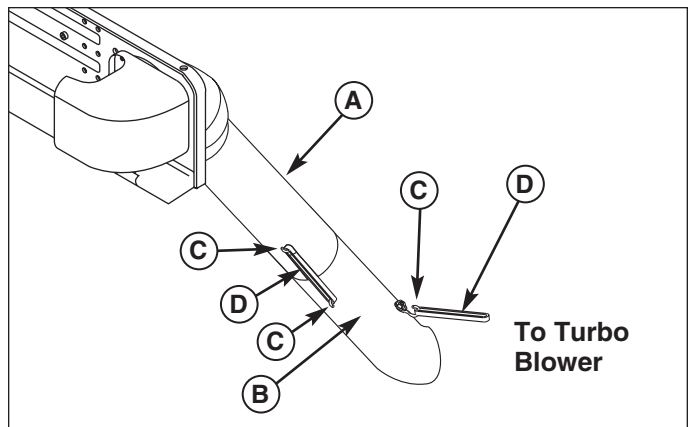

Figure 24. Assemble Tubes

A. Upper Tube

B. Lower Tube

C. "S" Hooks

D. Rubber Strap

Hardware Identification & Torque Specifications

Common Hardware Types

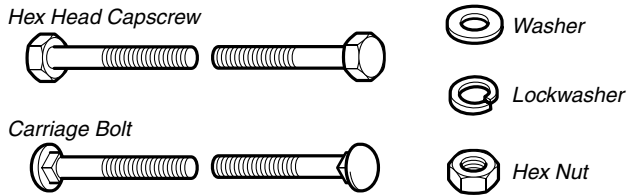

Standard Hardware Sizing

When a washer or nut is identified as **1/2"**, this is the *Nominal size*, meaning the *inside diameter* is 1/2 inch; if a second number is present it represents the *threads per inch*

When bolt or capscrew is identified as **1/2 - 16 x 2"**, this means the *Nominal size*, or *body diameter* is 1/2 inch; the second number represents the *threads per inch* (16 in this example, and the final number is the *body length* of the bolt or screw (in this example 2 inches long).

The guides and ruler furnished below are designed to help you select the appropriate hardware and tools.

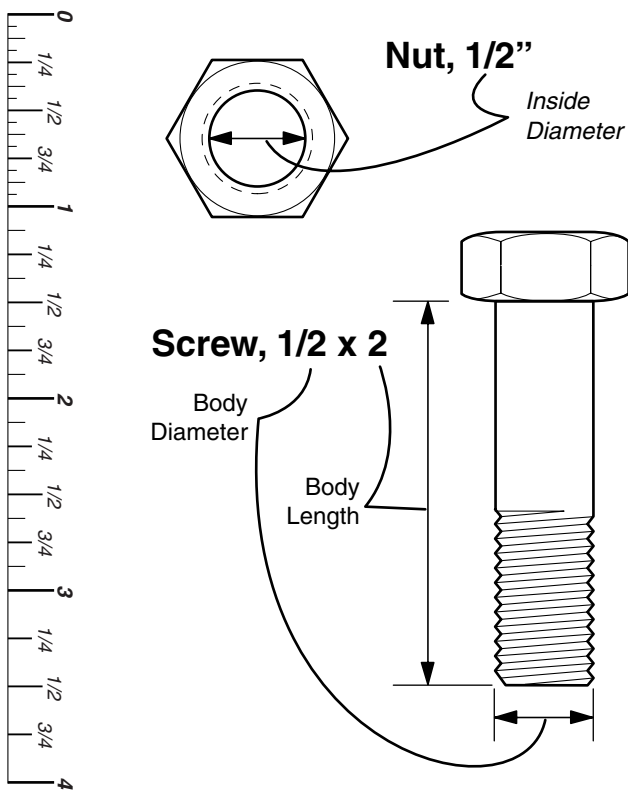

Torque Specification Chart

FOR STANDARD MACHINE HARDWARE (Tolerance $\pm 20\%$)

Hardware Grade	No Marks SAE Grade 2		SAE Grade 5		SAE Grade 8	
	in/lbs ft/lbs	Nm.	in/lbs ft/lbs	Nm.	in/lbs ft/lbs	Nm.
8-32	19	2.1	30	3.4	41	4.6
8-36	20	2.3	31	3.5	43	4.9
10-24	27	3.1	43	4.9	60	6.8
10-32	31	3.5	49	5.5	68	7.7
1/4-20	66	7.6	8	10.9	12	16.3
1/4-28	76	8.6	10	13.6	14	19.0
5/16-18	11	15.0	17	23.1	25	34.0
5/16-24	12	16.3	19	25.8	27	34.0
3/8-16	20	27.2	30	40.8	45	61.2
3/8-24	23	31.3	35	47.6	50	68.0
7/16-14	30	40.8	50	68.0	70	95.2
7/16-20	35	47.6	55	74.8	80	108.8
1/2-13	50	68.0	75	102.0	110	149.6
1/2-20	55	74.8	90	122.4	120	163.2
9/16-12	65	88.4	110	149.6	150	204.0
9/16-18	75	102.0	120	163.2	170	231.2
5/8-11	90	122.4	150	204.0	220	299.2
5/8-18	100	136	180	244.8	240	326.4
3/4-10	160	217.6	260	353.6	386	525.0
3/4-16	180	244.8	300	408.0	420	571.2
7/8-9	140	190.4	400	544.0	600	816.0
7/8-14	155	210.8	440	598.4	660	897.6
1-8	220	299.2	580	788.8	900	1,244.0
1-12	240	326.4	640	870.4	1,000	1,360.0

NOTES

- These torque values are to be used for all hardware excluding: locknuts, self-tapping screws, thread forming screws, sheet metal screws and socket head setscrews.
- Recommended seating torque values for locknuts:
 - for prevailing torque locknuts - use 65% of grade 5 torques.
 - for flange whizlock nuts and screws - use 135% of grade 5 torques.
- Unless otherwise noted on assembly drawings, all torque values must meet this specification.

Wrench & Fastener Size Guide



1/4" Bolt or Nut
Wrench—7/16"

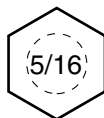

5/16" Bolt or Nut
Wrench—1/2"

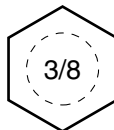

3/8" Bolt or Nut
Wrench—9/16"

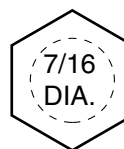

7/16" Bolt or Nut
Wrench (Bolt)—5/8"
Wrench (Nut)—11/16"

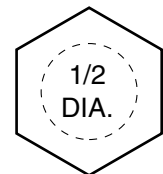

1/2" Bolt or Nut
Wrench—3/4"



Simplicity[®]

MANUFACTURING, INC.
500 N Spring Street / PO Box 997
Port Washington, WI 53074-0997

www.simplicitymfg.com

© Copyright 2004 Simplicity Manufacturing, Inc.
All Rights Reserved. Printed in USA.