

Fig. 1

Attachment

To attach the 42" Rotary Mower to the Tractor, follow the sequence of steps as outlined below:

1. Place the mower beside the tractor, and turn the tractor wheels to full left position. Before sliding the mower under the tractor, remove the hair pin cotters and pins connecting the clevises on front end of bail assembly. Allow the rocker arms to drop down. This will now provide sufficient clearance for the mower to slide under the tractor. With the mower under the tractor, replace the clevises on rocker arms and fasten with hair pin cotters and pins.
2. Connect the rockers arms to front mounting brackets under the tractor, by using pins and hair pin cotters as shown in figure 2.
3. Place the tractor lift lever in its rear position and attach the mower lift lever to the tractor lift arm on right hand side of tractor as shown in figure 3. Use hex capscrew, flatwashers, and hex nut furnished for this purpose.
4. Connect the mower lift chain to the lift lever by fastening the lift links in place with a pin and hair pin cotter as shown in figure 3.
5. Place the cross drive belt in position on the mower drive pulley. Give the belt a 90° twist towards the left hand side of the tractor and mount belt to larger pulley of power take-off as shown in figure 3. When installed in proper manner, the belt should run from the left side of mower pulley to bottom side of power take-off pulley.

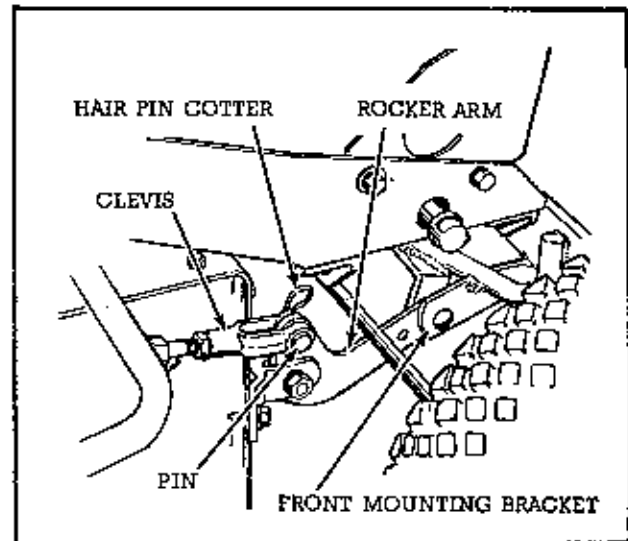

Fig. 2

Adjustments

To check the final adjustment of the mower height, place the tractor with the mower attached, on a smooth flat surface. Rotate the center blade to the front and measure the distance from its front tip to the ground. Then rotate each of the side blades so that their tips can be measured at the front. For best mowing results, the leading tip of the center blade should be about 3/8" higher than the trailing tip of the two side blades. To obtain this adjustment, remove pins from clevises and rocker arms, loosen the hex nut in back of each clevis and turn each clevis in or out sufficiently to achieve this setting. In making this adjustment, be sure that both clevises are adjusted equally.

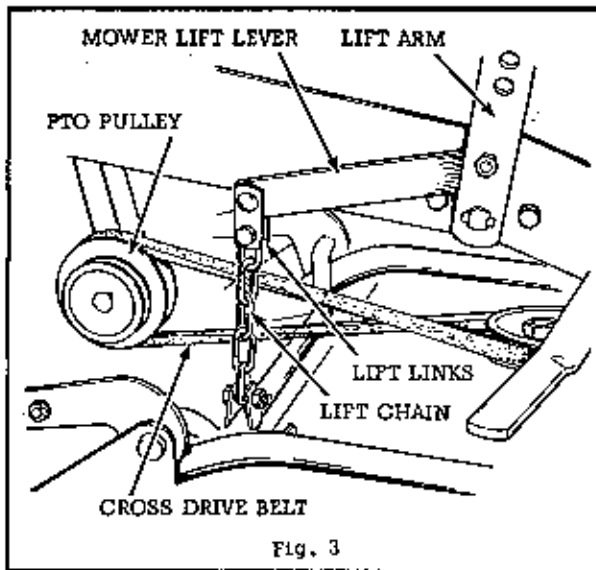

Fig. 3

Operation

1. Set mower to desired height of cut by turning the adjusting screwhandles counter-clockwise to lower the cut, and clockwise to raise the cut. Turn each adjusting handle an equal number of times to insure level operation.
2. Start the tractor engine with the power take-off in the disengaged position, and lower the mower to cutting position by releasing the tractor lift lever.
3. Engage the power take-off to set the mower blades in operation; engage the tractor clutch and proceed with mowing.
4. To transport the mower; disengage the power take-off to stop blades. Raise the mower above the surface by pushing the tractor lift lever to forward locked position.

Belt Tension

After the first 5 to 10 hours of operation, the blade drive belt may stretch slightly. To restore the proper tension to the blade drive belt, remove the right hand cover from the top of mower housing and loosen the nut on idler pulley bolt. Move the idler pulley to a point where tension is sufficient to transmit power from the pulley of drive arbor to pulleys of driven arbors. Hold idler pulley in position while retightening the nut to lock idler in place. **AVOID EXCESSIVE TENSION**, as it will cause premature belt failure.

NOTE: The cross drive belt and the blade drive belt are a super combine type belt and are designed and manufactured to provide long and satisfactory service. Because of the special design of these belts, it is urged that you replace them only with genuine replacement belts ordered from your dealer. Consult the parts list for the correct part numbers for these belts when replacement is necessary.

Lubrication

The mower arbor spindles are supported in pre-lubricated, sealed ball bearing assemblies, which do not require further attention.

Caution

It is the responsibility of the operator to see that the area where the mower will be used is free of all types of foreign material. This includes wire, rope, rags, sticks, bottles, cans, pipe, and rocks, etc. These represent potential dangers to mower, operator, and spectators; as well as having a dulling effect on the mower blades.

Always guard for obstacles when mowing, and, never leave mower running while unattended.

BAIL ASSEMBLY

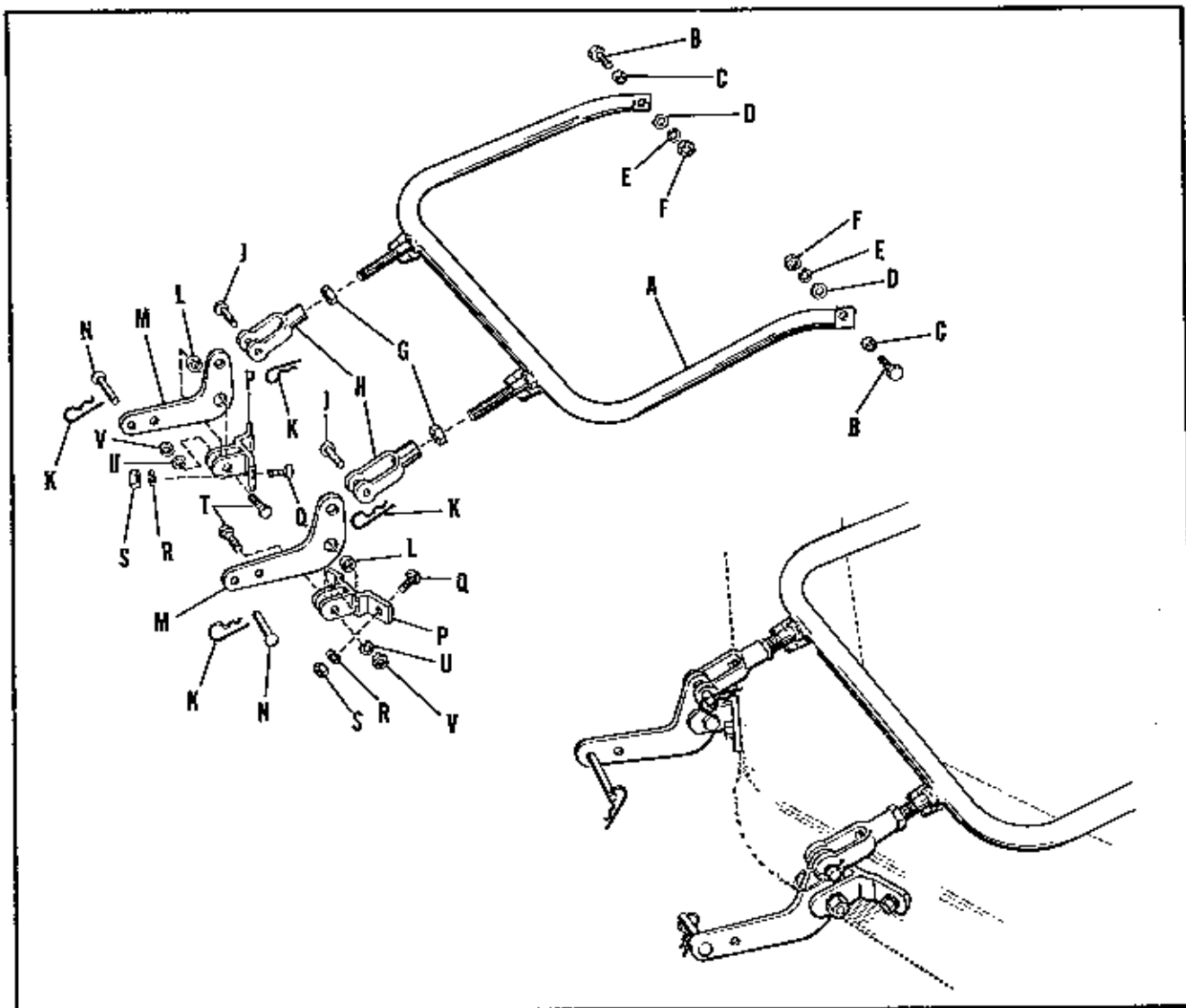

Order by Part Number

| Ref. Let. | Part No. | Description |
|-----------|----------|--|
| A | 108229 | Bail Assembly |
| B | 705049 | Capscrew, Hex Hd., 1/2"-13 NC x 1 1/4" lg. |
| C | 105051 | Spacer |
| D | 719004 | Washer, Plain, 1/2" |
| E | 720004 | Washer, Lock, 1/2" |
| F | 717006 | Nut, Hex, Full, 1/2"-13 NC |
| G | 717016 | Nut, Hex, Jam, 1/2"-20 NF |
| H | 154304 | Yoke End, Adjusting |
| J | 154305 | Yoke Pin |

Order by Part Number

| Ref. Let. | Part No. | Description |
|-----------|----------|------------------------------------|
| K | 8161045 | Clip, Spring |
| L | 105051 | Spacer |
| M | 108228 | Rocker Arm |
| N | 118053 | Pin |
| P | 108219 | Bracket Assembly, Front |
| Q | 702002 | Bolt, Carriage, 3/8"-16 NC x 1" |
| R | 720002 | Washer, Lock, 3/8" |
| S | 717003 | Nut, Hex, Full, 3/8"-16 NC |
| T | 705049 | Capscrew, Hex, 1/2"-13 NC x 1 1/4" |
| U | 720004 | Washer, Lock, 1/2" |
| V | 717006 | Nut, Hex, Full, 1/2"-13 NC |

MOWER UNDERSIDE

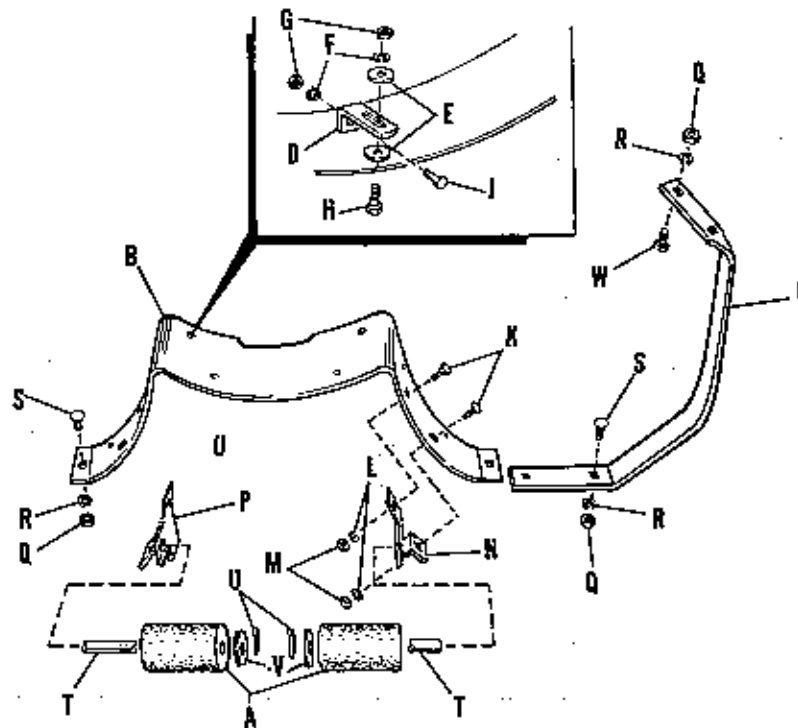
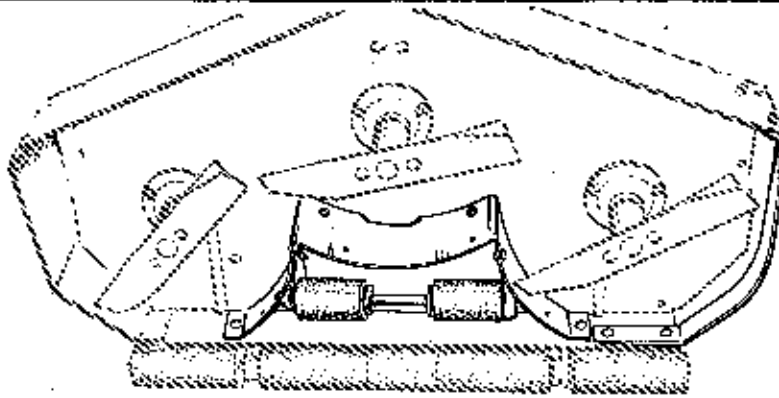

Order by Part Number

| Ref. Letter | Part No. | Description |
|-------------|----------|---|
| A | 108178 | Roller |
| B | 108361 | Baffle |
| C | 108214 | Guard Assembly, Housing |
| D | 108186 | Clip Baffle |
| E | 719006 | Washer, Plain, 1/4" |
| F | 720003 | Washer, Lock, 1/4" |
| G | 717005 | Nut, Hex, Full, 1/4"-20 NC |
| H | 715018 | Capscrew, Hex, 1/4"-20 x 5/8" lg. |
| J | 714012 | Screw, Recessed Hex, Self-Tapping 1/4"-20 NC x 7/8" lg. |
| K | 702015 | Bolt, Carriage, 5/16"-18 NC x 3/4" lg. |

| Ref. Letter | Part No. | Description |
|-------------|----------|---------------------------------------|
| L | 720001 | Washer, Lock, 5/16" |
| M | 717001 | Nut, Hex, Full, 5/16"-18 NC |
| N | 108224 | Bracket, Roller, Lower, L.H. |
| P | 108223 | Bracket, Roller, Lower, R.H. |
| Q | 717003 | Nut, Hex, Full, 3/8"-16 NC |
| R | 720002 | Washer, Lock, 3/8" |
| S | 702003 | Bolt, Carriage, 3/8"-16 NC x 3/4" lg. |
| T | 108225 | Shaft, Roller |
| U | 722011 | Pin, Cotter, 3/16" x 1" lg. |
| V | 115001 | Washer |
| W | 702002 | Bolt, Carriage, 3/8"-16 NC x 1" lg. |

DECK ASSEMBLY

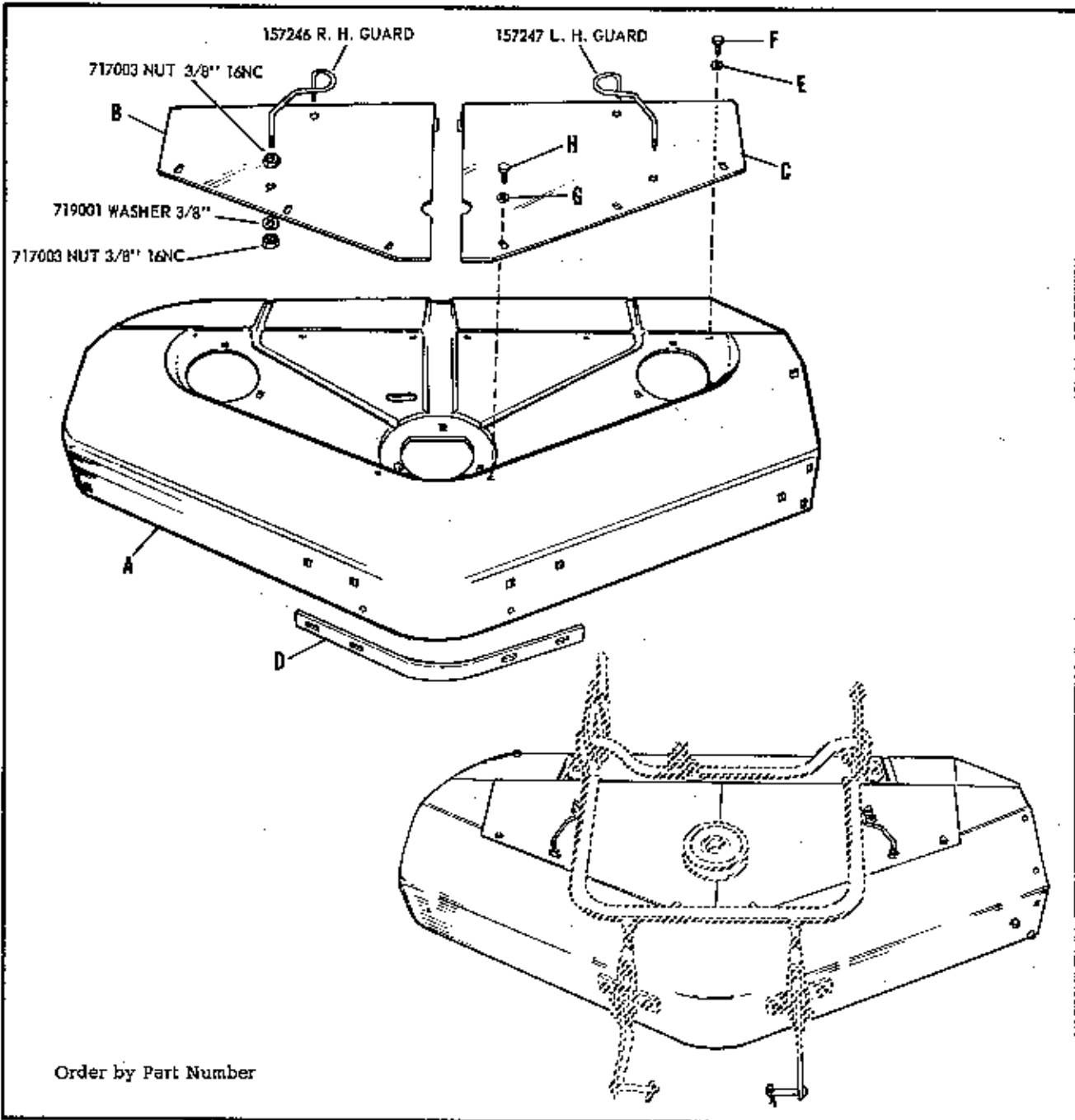

| Ref. No. | Part No. | Description |
|----------|----------|--|
| A | 108354 | Housing, Mower |
| B | 108355 | Cover, R.H. |
| C | 108356 | Cover, L.H. |
| D | 108366 | Bar, Reinforcing |
| E | 719007 | Washer, Plain, 3/16 |
| F | 714007 | Screw, Recessed Hex, Self-Tapping, 1/4-20 x 3/8" |
| G | 719007 | Washer, Plain, 3/16" |
| H | 714007 | Screw, Recessed Hex, Self-Tapping, 1/4-20 x 3/8" |

ROLLER ASSEMBLY

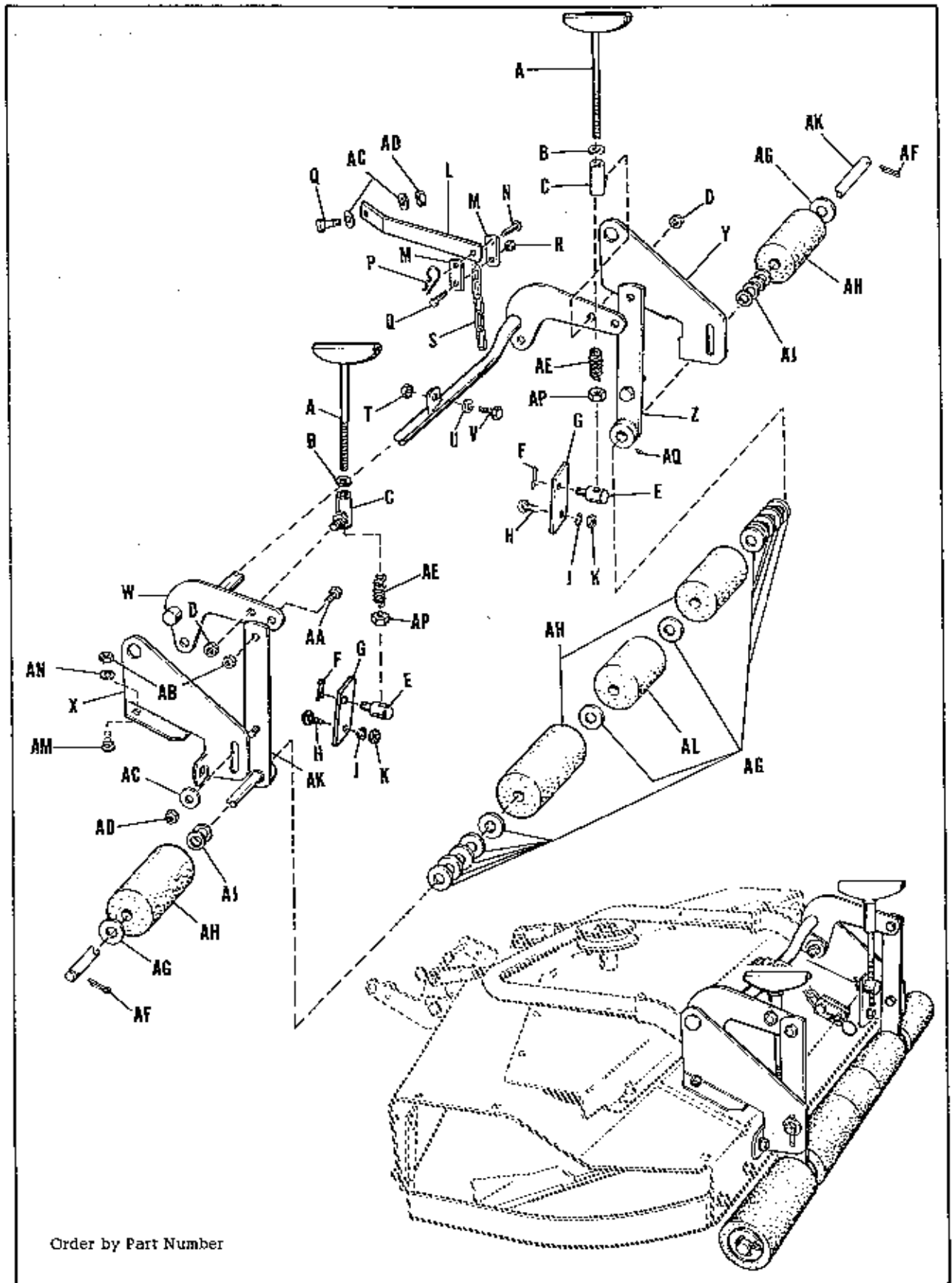

Order by Part Number

ROLLER ASSEMBLY

Order by Part Number

| Reference Letter | Part No. | Description |
|------------------|---------------|--|
| A | 108415 | Screw Assembly, Adjusting |
| B | 719001 | Washer, Plain, 3/8" |
| C | 108241 | Socket Assembly, Crank |
| D | 717510 | Nut, Hex, Full, Lock, 3/8"-16 NC |
| E | 108172 | Pivot |
| F | 722001 | Cotter Pin, 3/32" x 3/4" lg. |
| G | 108242 | Link, Lift |
| H | 703004 | Bolt, Carriage, 3/8"-16 NC x 3/4" lg. |
| J | 720002 | Washer, Lock, 3/8" |
| K | 717003 | Nut, Hex, Full, 3/8"-16 NC |
| L | 108198 | Lever, Mower Lift |
| M | 108199 | Link, Mower Lift |
| N | 153058 | Pin, Lock |
| P | 8161045 | Clip, Spring |
| Q | 705005 | Capscrew, Hex Hd., 3/8"-16 NC x 1" lg. |
| R | 717510 | Nut, Hex, Full, Lock, 3/8"-16 NC |
| S | 1010-4 | Chain |
| T | 717510 | Nut, Hex, Full, Lock, 3/8"-16 NC |
| U | 719001 | 3/8" Washer |
| V | 705005 | Capscrew, Hex Hd., 3/8"-16x1" lg. |
| W | 108235 | Arm Assembly, Rocker |
| X | 108234 | Bracket, Roller, |
| Y | 108233 | Bracket, Roller, |
| Z | 108359 | Bar Assembly, Roller |
| AA | 705005 | Capscrew, Hex Hd., 3/8"-16 NC x 1" lg. |
| AB | 717003 | Nut, Hex, Full, 3/8"-16 NC |
| AC | 719001 | Washer, Plain, 3/8" |
| AD | 717510 | Nut, Hex, Full, Lock, 3/8"-16 NC |
| AE | 108360 | Spring, Adj. Screw |
| AF | 722011 | Pin, Cotter, 3/16" x 1" lg. |
| AG | 116001 | Washer |
| AI | 108240 | Roller |
| AJ | 8261055 | Washer |
| AK | 108358 | Shaft & Support Arm. |
| AL | 108178 | Roller |
| AM | 702003 | Bolt, Carriage, 3/8"-16 NC x 3/4" lg. |
| AN | 720002 | Washer, Lock, 3/8" |
| AP | 717524 | Nut, Hex, Full |
| AQ | 713504 | Set Screw |

ARBOR ASSEMBLIES

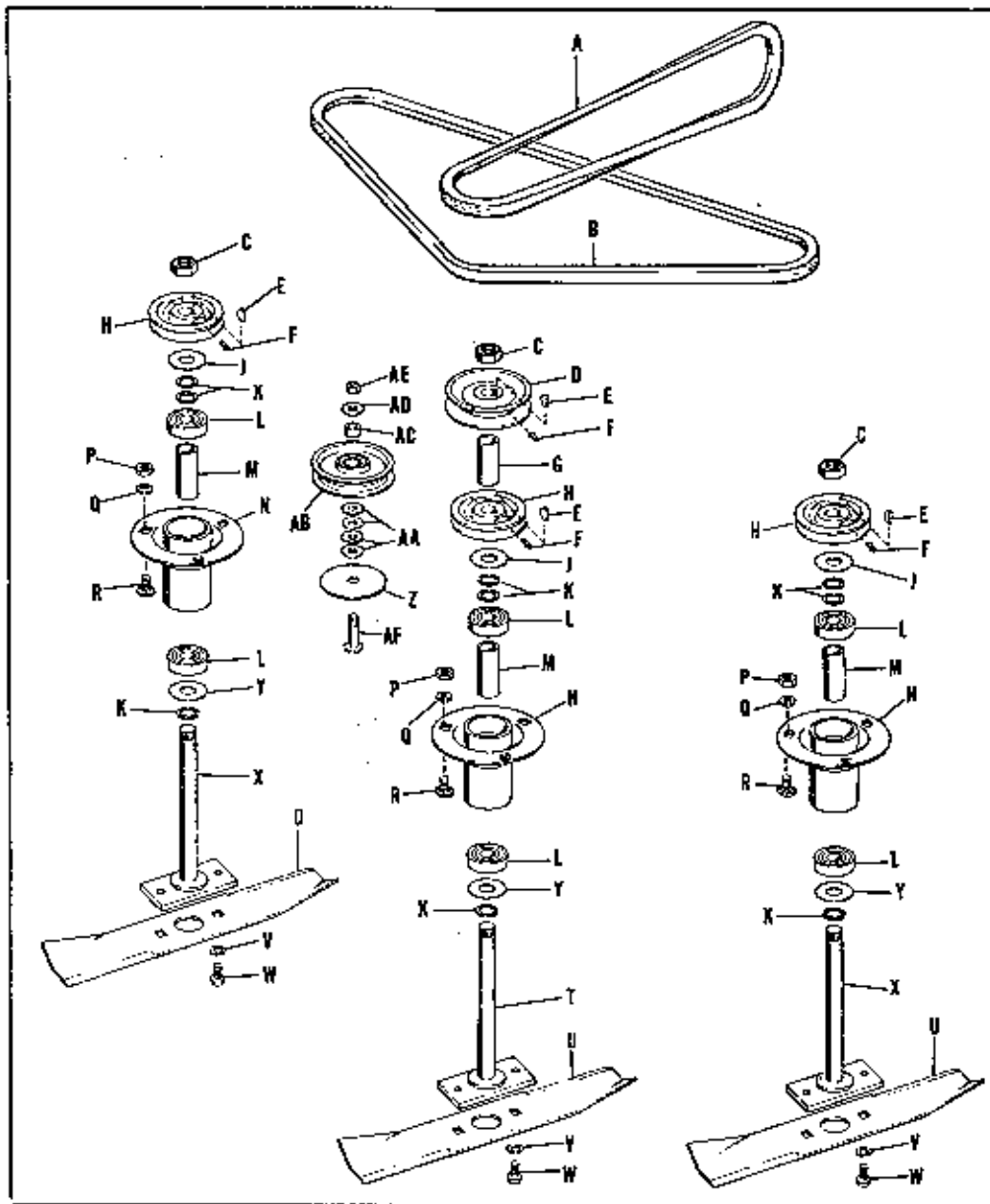

| Ref. Letter | Part No. | Description |
|-------------|----------|---|
| A | 108099 | Belt, "V" (Cross Drive) |
| B | 108209 | Belt, "V" (Mower Spindle Drive) |
| C | 717517 | Nut, Jam, Hex, Lock, 3/4"-16NF |
| D | 108207 | Pulley, Cross Drive |
| E | 725006 | Key, Woodruff, #61 |
| F | 713504 | Screw, Set, Cup Point, Socket Hd., 5/16"-18 NC x 3/8" lg. |
| G | 108245 | Spacer |
| H | 108142 | Pulley |
| J | 108139 | Flinger |
| K | 108181 | Washer |
| L | 108202 | Bearing |
| M | 108201 | Spacer |
| N | 108203 | Tube Assembly, Arbor |
| P | 717003 | Nut, Hex, Full, 3/8"-16 NC |
| Q | 720002 | Washer, Lock, 3/8" |
| R | 703004 | Bolt, Carriage, 3/8"-16 NC x 3/4" |

| Ref. Letter | Part No. | Description |
|-------------|----------|--|
| T | 108252 | Arbor Assembly, Drive |
| U | 108298 | Blade, Knife |
| V | 720002 | Washer, Lock, 3/8" |
| W | 715024 | Capscrew, Hex Hd., 3/8"-16 NC x 5/8" lg. |
| X | 108250 | Arbor Assembly |
| Y | 108257 | Washer |
| Z | 108150 | Washer |
| AA | 719002 | Washer, Plain, 5/16" |
| AE | 108386 | Pulley, Idler |
| AC | 154177 | Spacer |
| AD | 719002 | Washer, Plain, 5/16" |
| AE | 717510 | Nut, Hex, Full, Lock, 3/8"-16 NC |
| AF | 703006 | Bolt, Carriage, 3/8"-16 NC x 1 1/2" lg. |