

Simplicity®

2/11/65

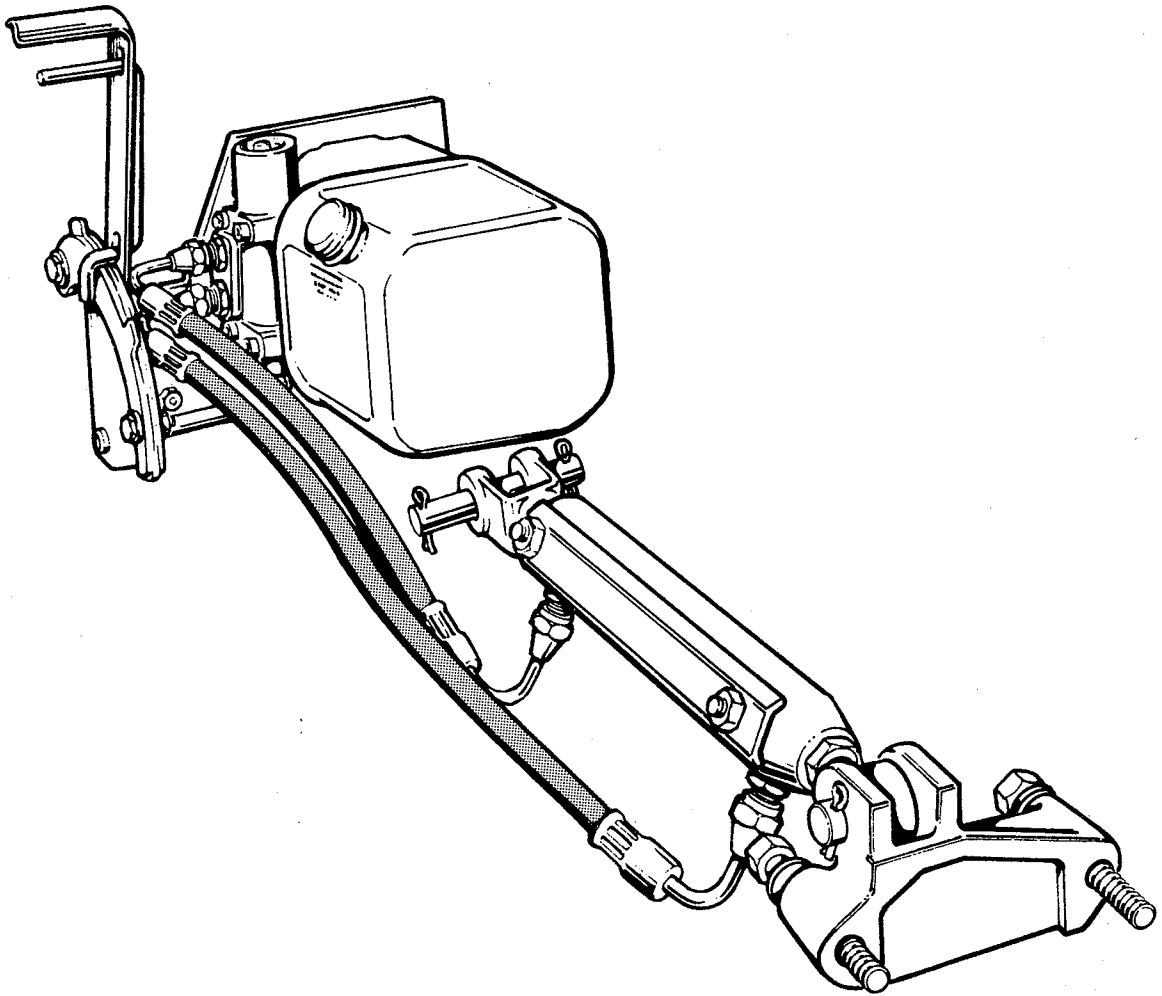

HYDRAULIC KIT No. 339

CAUTION

IT IS VITALLY IMPORTANT THAT THE HYDRAULIC FLUID AND ALL INTERNAL PARTS OF THIS UNIT BE KEPT COMPLETELY CLEAN AND FREE OF FOREIGN MATTER OF ANY TYPE.

USE UTMOST CARE IN ADDING OR CHECKING FLUID, AND IN PERFORMING ANY SERVICE ON INTEGRAL PARTS.

(For instance if a fitting or other part is dropped on a contaminated surface, the part must be carefully washed and dried before re-using.)

REMEMBER-HYDRAULICS DEMAND CLEANLINESS

SIMPLICITY MANUFACTURING COMPANY / PORT WASHINGTON, WIS.

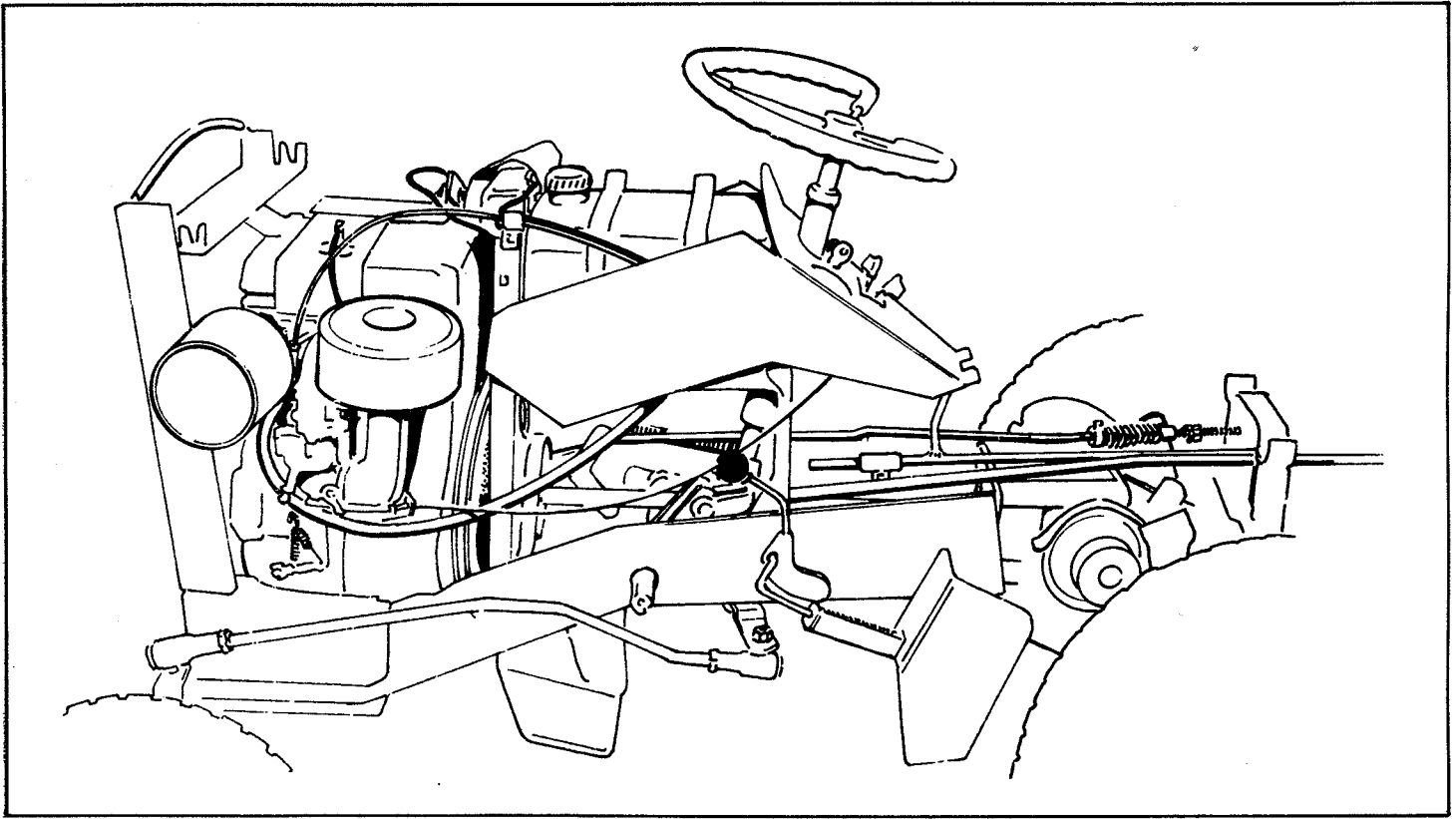

FIGURE 1

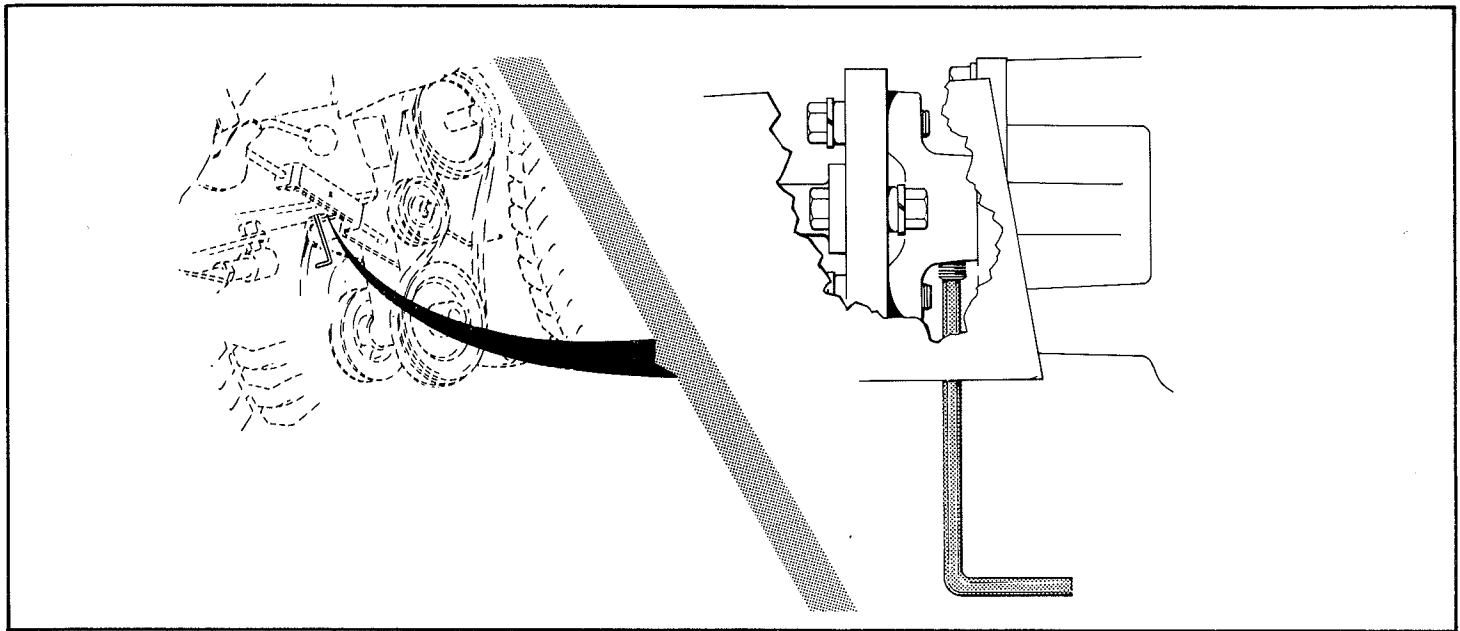

FIGURE 1A

ASSEMBLY

Drive shaft

- A. Remove hood, side panels, battery, and shut gasoline valve below tank and disconnect gasoline hose, (Fig. 1), remove dash support assembly screws, frame from tractor, left handle, and quadrant.
- B. Loosen set screw on rear coupling flange through hole in bottom of frame. (Fig. 1A)
- C. Remove two capscrews holding front coupling to the engine pulley (1, Fig. 2) and replace spacers with the hydraulic pump drive pulley (1, Fig. 3), being sure to have the pump belt in position on the pulley before replacing the attaching screws.
- D. After the front coupling is secured, re-tighten the set screw on the flange at the rear coupling.

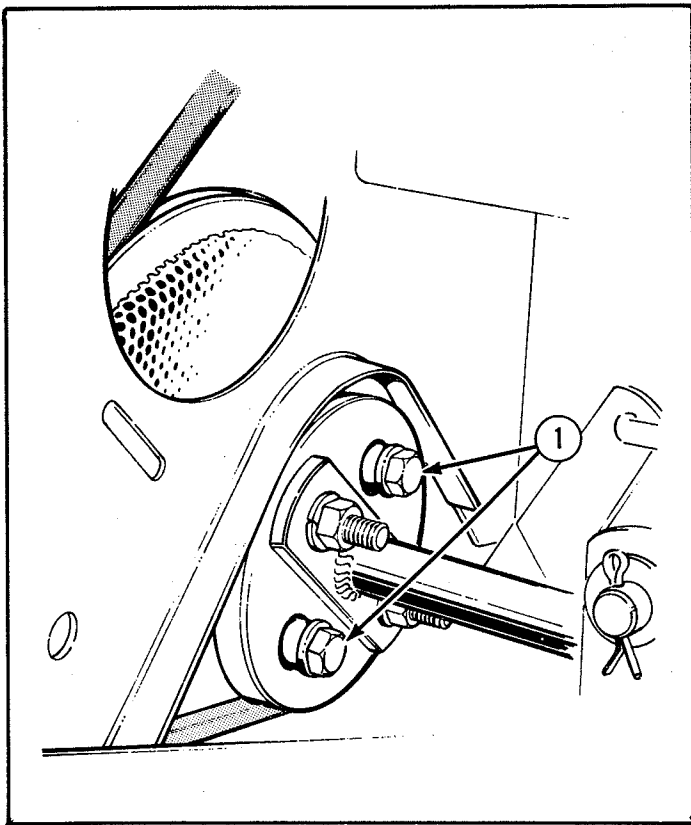

FIGURE 2

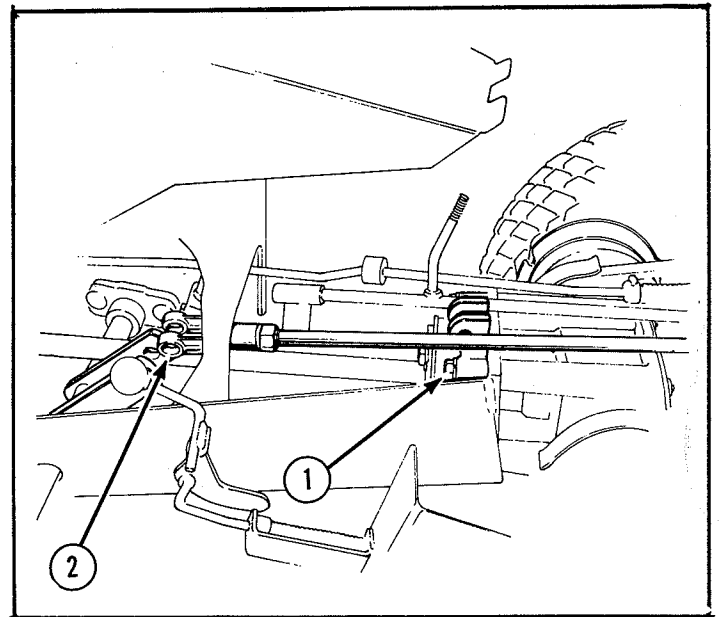

FIGURE 4

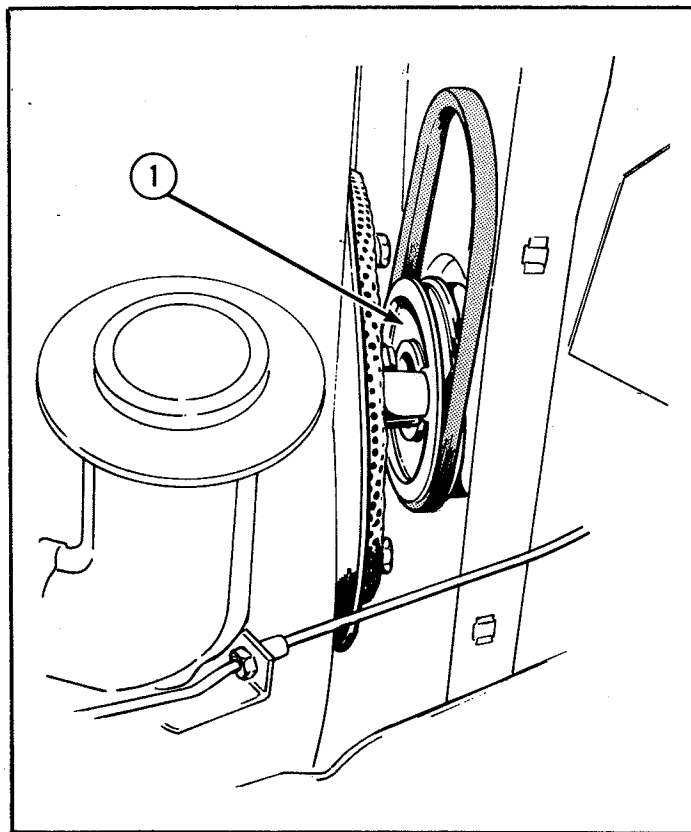

FIGURE 3

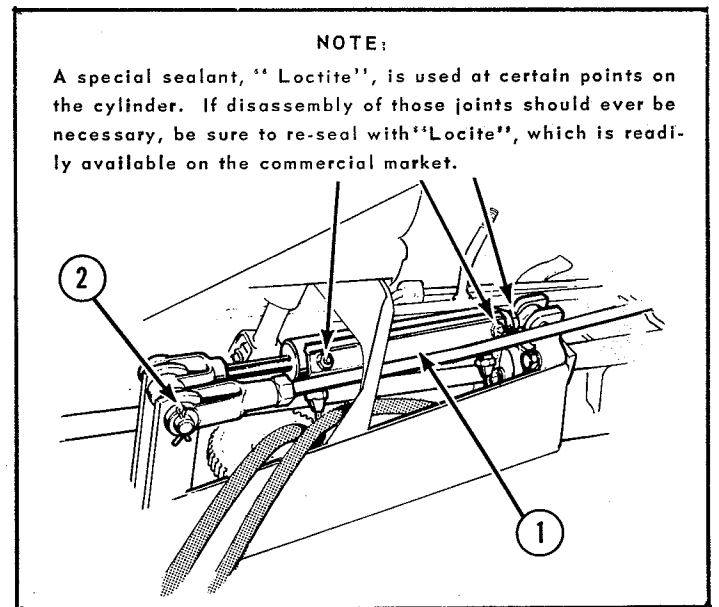

FIGURE 5

NOTE:

A special sealant, "Loctite", is used at certain points on the cylinder. If disassembly of those joints should ever be necessary, be sure to re-seal with "Loctite", which is readily available on the commercial market.

- E. Remove top two screws holding bevel gear housing to rear frame plate, install rear cylinder bracket, and secure with 3/8-16 cap screws provided. (1, Fig. 4)
- F. Remove pivot pin from front clevis on the left rod assembly (2, Fig. 4)
- G. Install cylinder assembly as shown (1, Fig. 5), attaching to the rear bracket with the short pin providing, and attaching the front clevis to the lift lever with the long pin and cotter keys (2, Fig. 5)
- H. Attach the pump and tank assembly to the front panel of the tank support assembly by means of the three Whiz-Lock nuts provided (1, Fig. 6);

HYDRAULIC UNIT

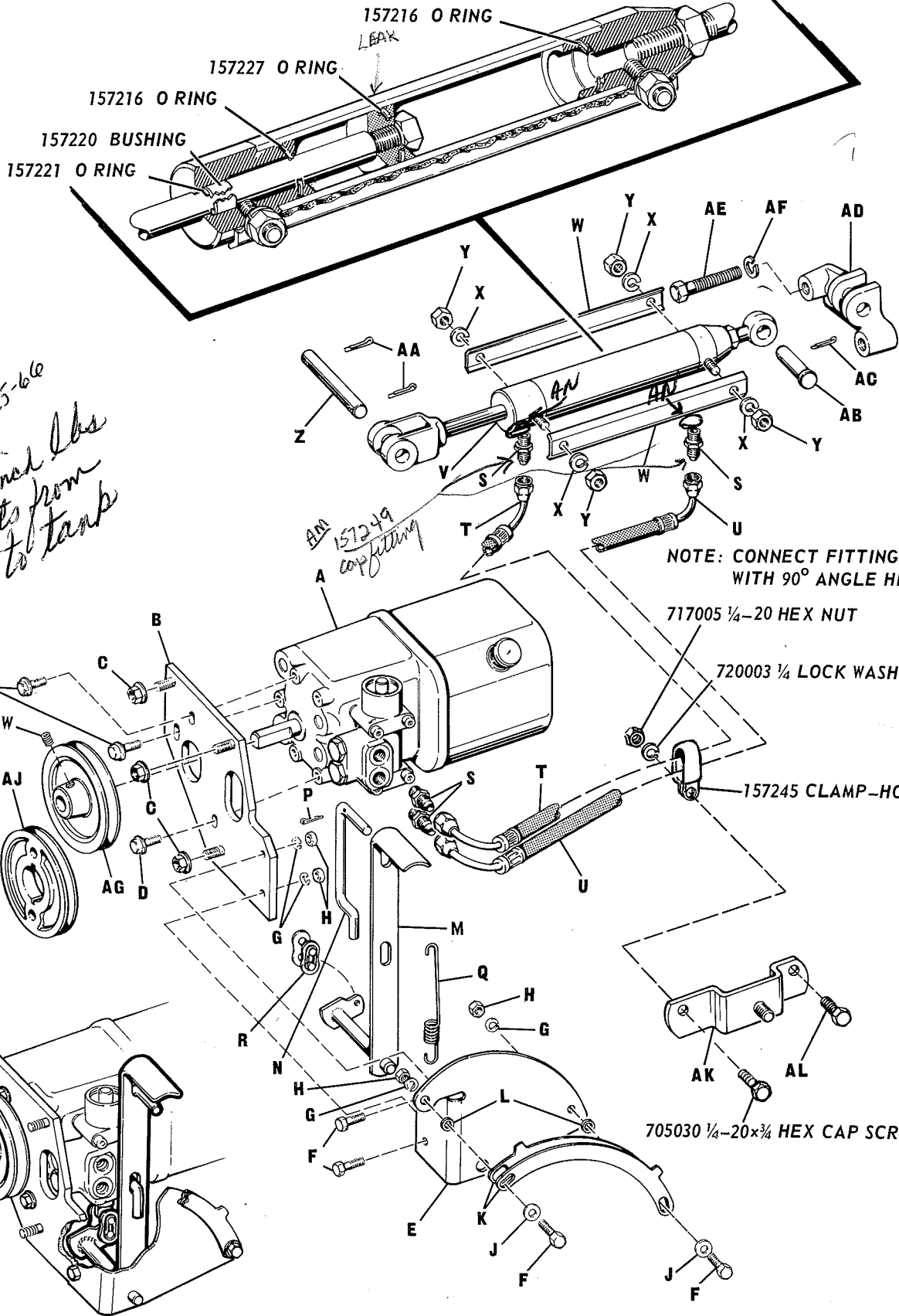

HYDRAULIC UNIT PARTS LIST

Ref. Letter	Part No.	Description
A	157196 157195	Pump & Tank 1 qt Capacity
B	157196	Support 157420 12-1-65
C	718033	Nut-hex.-Whiz-Lock Flange, 5/16-18
D	715060	Hex. Capscrew, 1/4-20 x 3/4 Lg. S.W.H. 12 - FLANGE LOCK
E	157199	Quadrant
F	715057	Hex. Capscrew, 1/4-20 x 3/4 Lg.
G	720003	Washer Lock, 1/4
H	717005	Nut Hex. Full, 1/4-20
J	719006	Washer Flat, 1/4
K	157204	Stop Plate
L	157205	Spacer
M	157200	Lever Assembly
N	157206	Rod-Latch
P	722016	Pin-Cotter, 3/32 x 5/8
Q	157207	Spring
R	157208	Connecting Link
S	157209	Fitting
T	157210	Hose Assembly Short
U	157211	Hose Assembly Long
V	157236	Cylinder Assembly
W	157228	Bar-Side
X	720001	Washer-Lock, 5/16
Y	717001	Nut Hex. Full, 5/16-18
Z	157225	Pin,
AA	722009	Pin-Cotter, 1/8 x 3/4
AB	157194	Pin-Ram Bracket
AC	722009	Pin-Cotter, 1/8 x 3/4
AD	157001	Bracket-Ram
AE	705052	Hex. Capscrew, 7/16-14 x 2-1/4 Lg.
AF	720006	Washer-Lock, 7/16
AG	157229	Pulley Pump
AH	157230	"V"-Belt
AJ	157231	Pulley Drive
AK	157233	Bar Assembly
AL	705007	Hex. Capscrew, 5/16-18 x 1 Lg.

See Page 7 Figure 7 for 157248-Cap, Plastic
 AM 157249 CAP FITTING - FOR SHIPPING ONLY - TO PROTECT THREADS
 AN 157221 "O" Ring
 AP 157428 Angle Bolt 12-1-65

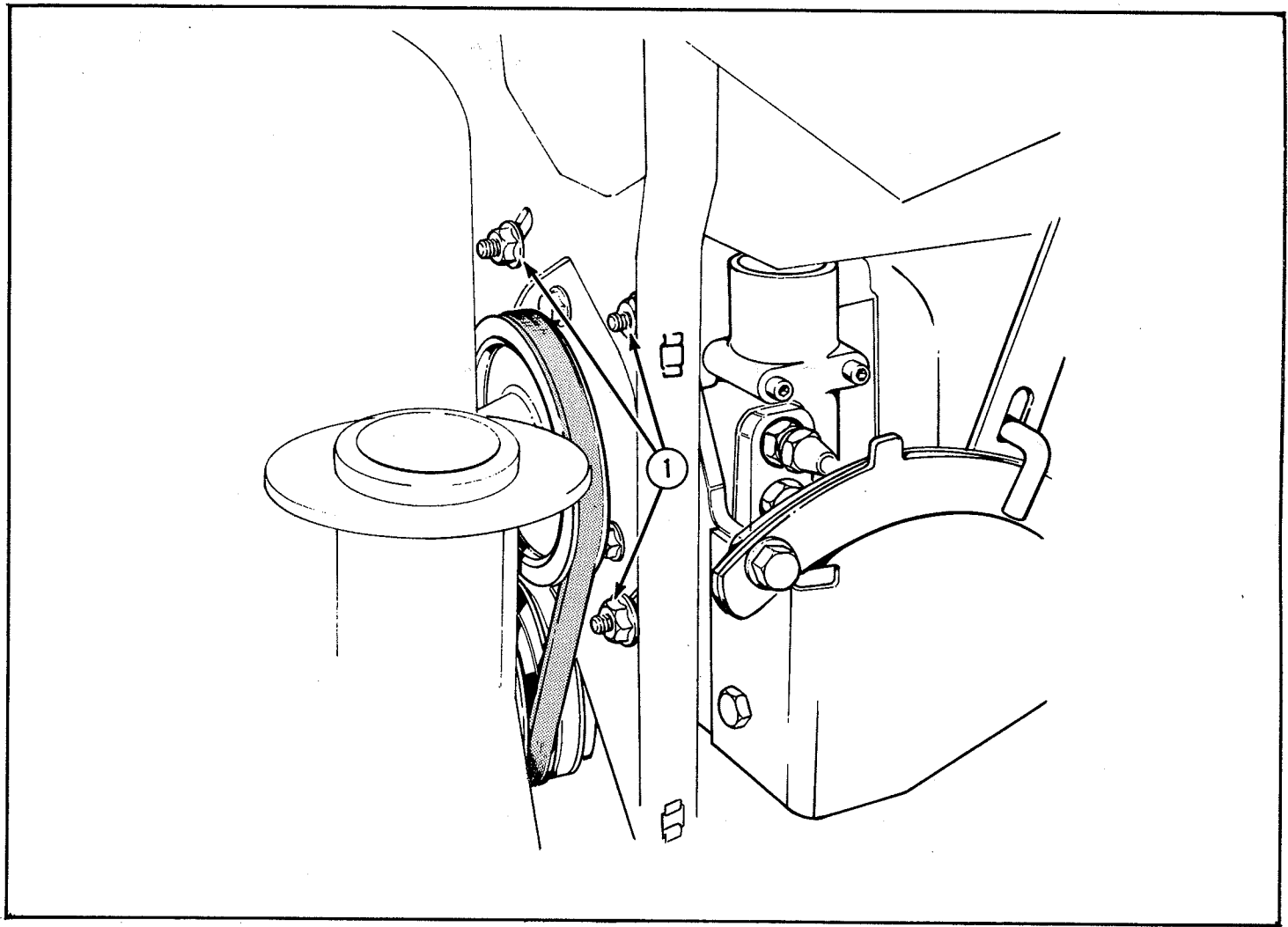

FIGURE 6

with the drive belt positioned on its pulleys. (Provide proper belt tightness by exerting light pressure under the pump assembly while tightening the Whiz-Lock nuts.

- I. Remove the protective slugs from the hose fittings, and attach the longer hose from the rear cylinder fittings to the bottom fitting on the valve assembly (1, Fig. 7 & 7 A) (NOTE: The hose end with 90° bend goes to the cylinder, and the end with 114° bend goes to the valve assembly).
- J. Attach the shorter hose from the front cylinder fitting to the top fitting on the valve assembly (2, Fig. 7). (Check to be sure there is no inter-

ference with the steering gear when the lift lever is operated, and that there are no kinks or sharp bends in the hose).

Install the clamp (4 Fig. 7) to hold the hoses securely in position.

- K. Attach PTO clutch lever bracket (5 Fig. 7) to side of frame, and re-assemble PTO lever as shown.
- L. Replace fuel line, battery, panels, etc. that were previously removed.
- M. Fill pump tank to the line indicated at the lower side of the filler spout. Use only 10W-30 oil as recommended, and recheck this level periodically.

non-foaming

CAUTION: KEEP FILLER SPOUT CLEAN SO THAT NO FOREIGN MATTER CAN GET INTO TANK WHEN CAP IS REMOVED.

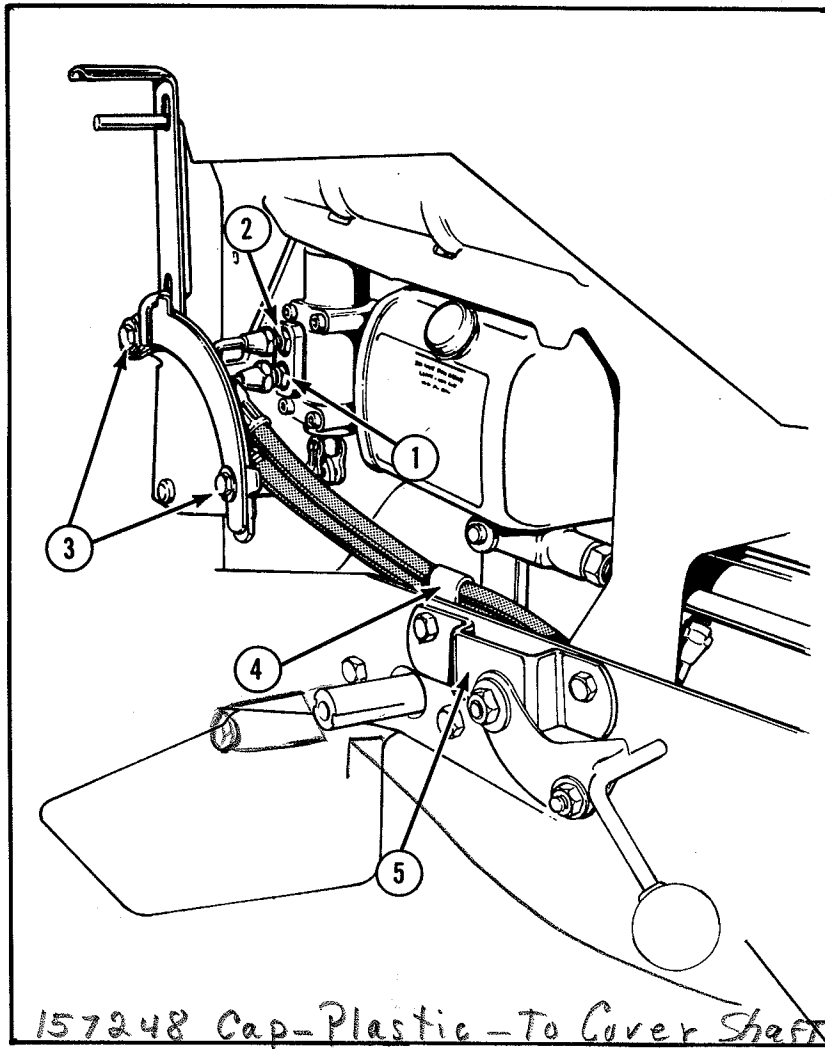

FIGURE 7

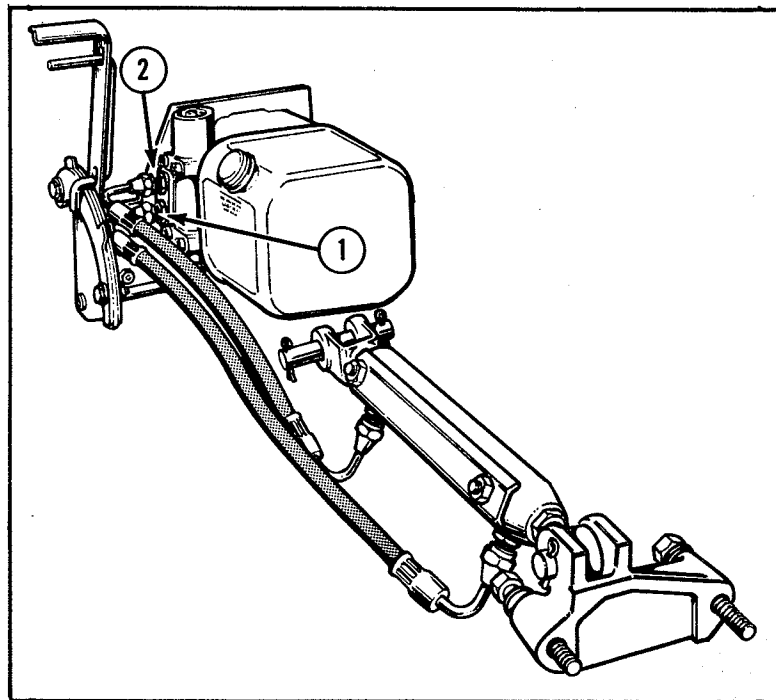

FIGURE 7A

OPERATION

To raise a front mounted attachment, pull the hydraulic lever backward. When the desired height is reached, release the lever and it will return to the "hold" position.

To lower a front mounted attachment, push the lever to the front, then release when desired depth is reached.

A rear mounted attachment is raised by pushing forward on the lever; and is lowered by pulling the lever backward.

The index tabs at each end of the quadrant serve as lock points for the "float" position which allows an attachment such as a dozer blade to follow ground countours freely.

NOTE---

The rear mounted tiller attachment should be operated only in the rear "float" position. Do not operate the tiller in the "hold" position, as difficulty would result if an obstacle were encountered. This would raise the rear wheels off the ground and propel the tractor forward at a dangerous rate. To get in or out of either "float" position, squeeze the release bar handle upward to clear the index tab. (3, Fig. 7)