

Owner's Operating Service Instruction Manual

10¢

Model No.
125-570A

- ASSEMBLY
- OPERATION
- REPAIR PARTS

26" HI WHEEL ROTARY MOWER

WARRANTY

For one year from date of purchase, MTD Products Inc will replace for the original purchaser, free of charge, F.O.B. factory or authorized service firm, any part or parts found to be defective in material or workmanship. All transportation charges on parts submitted for replacement under this warranty must be paid by the purchaser. This warranty does not include replacement of parts which become inoperative through misuse, excessive use, accident, neglect, improper maintenance or alterations by unauthorized persons. This warranty does not include the engine, motor, battery, battery charger or any component parts thereof. For service on these units, refer to the applicable manufacturer's warranty.

The above warranty will apply only to the original owner and will be effective only if the warranty card has been properly processed. It will not apply where the unit has been used commercially.

Warranty service is available through your local authorized service dealer or distributor. **UNDER NO CIRCUMSTANCES WILL THE RETURN OF A COMPLETE UNIT BE ACCEPTED BY THE FACTORY UNLESS PRIOR WRITTEN PERMISSION HAS BEEN EXTENDED.**

MTD PRODUCTS INC • 5389 WEST 130th STREET • P. O. BOX 2741 CLEVELAND OHIO 44111

PRINTED IN U.S.A.

FORM NO. 770-5628

I M P O R T A N T

SAFE OPERATION PRACTICES FOR WALK-BEHIND MOWERS

TRAINING

1. Read the Operating and Service Instruction Manual carefully. Be thoroughly familiar with the controls and the proper use of the equipment.
2. Never allow children to operate a power mower.
3. Keep the area of operation clear of all persons, particularly small children and pets.

PREPARATION

1. Thoroughly inspect the area where the equipment is to be used and remove all stones, sticks, wire, bones and other foreign objects.
2. Do not operate equipment when barefoot or wearing open sandals. Always wear substantial footwear.
3. Check the fuel before starting the engine. Do not fill the gasoline tank indoors, when the engine is running, or while the engine is still hot. Wipe off any spilled gasoline before starting the engine.
4. Disengage the self-propelled mechanism or drive clutch on units so equipped before starting the engine.
5. Never attempt to make a wheel adjustment while the engine is running.
6. Mow only in daylight or in good artificial light.
7. Never operate the equipment in wet grass. Always be sure of your footing; keep a firm hold on the handle and walk, never run.

OPERATION

1. Do not change the engine governor settings or overspeed the engine.
2. Do not put hands or feet near or under rotating parts. Keep clear of the discharge opening at all times.
3. Stop the blade(s) when crossing gravel drive, walks or roads.
4. After striking a foreign object, stop the engine, remove the wire from the spark plug, thoroughly inspect the mower for any damage, and repair the damage before restarting and operating the mower.

5. If the equipment should start to vibrate abnormally, stop the engine and check immediately for the cause. Vibration is generally a warning of trouble.
6. Stop the engine whenever you leave the equipment, before cleaning the mower housing, and when making any repairs or inspections.
7. When cleaning, repairing or inspecting, make certain the blade and all moving parts have stopped. Disconnect the spark plug wire, and keep the wire away from the plug to prevent accidental starting.
8. Do not run the engine indoors.
9. Shut the engine off and wait until the blade comes to a complete stop before removing the grass catcher or unclogging chute.
10. Mow across the face of slopes, never up-and-down. Exercise extreme caution when changing direction on slopes. Do not mow excessively steep slopes.
11. Always disconnect electric mowers (line operated) before cleaning, repairing or adjusting.
12. Never operate mower without proper guards, plates or other safety protective devices in place.
13. Keep washout ports and other mower-housing service openings closed when mowing.

MAINTENANCE AND STORAGE

1. Check the blade and engine mounting bolts at frequent intervals for proper tightness.
2. Keep all nuts, bolts, and screws tight to be sure the equipment is in safe working condition.
3. Never store the equipment with gasoline in the tank inside of a building where fumes may reach an open flame or spark. Allow the engine to cool before storing in any enclosure.
4. To reduce fire hazard, keep the engine free of grass, leaves, or excessive grease.
5. Check the grass catcher bag frequently for wear or deterioration. Replace with new bag for safety protection.

ASSEMBLY INSTRUCTIONS

PARTS IDENTIFICATION

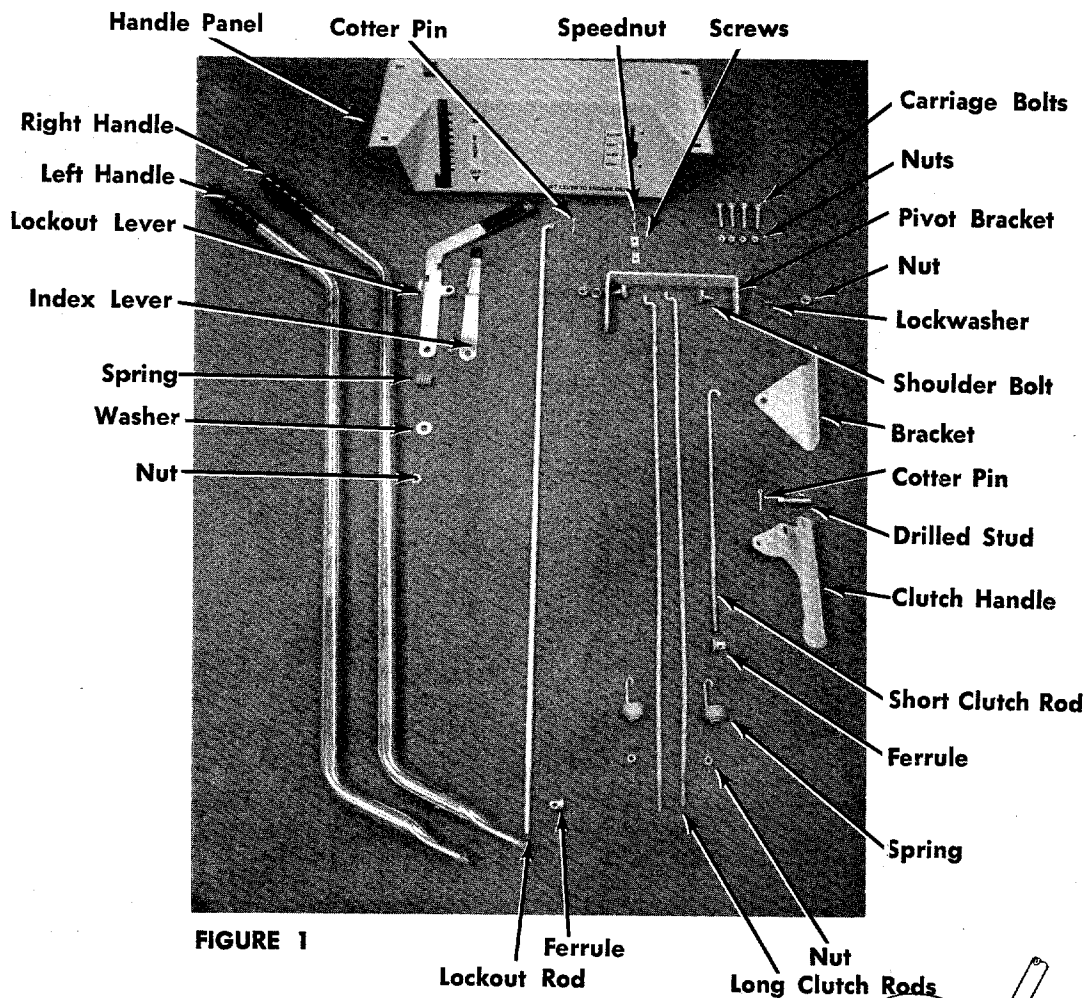

FIGURE 1

1. Remove the nuts, lockwashers and spacers on the four studs on the rear frame of the mower. See figure 2.
2. Place the left handle over the two studs on the left side of the mower.

NOTE

The right handle has a hole near the grip for the clutch handle.

3. Place a lockwasher and nut on each stud. Tighten only finger tight at this time.
4. Assemble the right handle in the same manner.

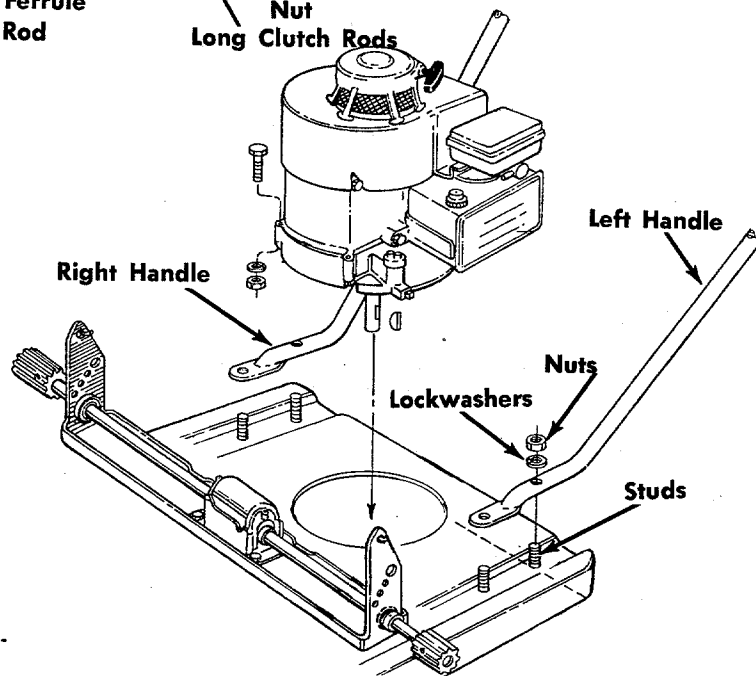

FIGURE 2

5. Assemble the handle panel and bracket to the right handle using two of the carriage bolts and nuts. See figure 3.

NOTE

The bracket must be assembled with the wide side up as shown in figure 3.

6. Assemble the handle panel to the left handle with the other two carriage bolts and nuts.

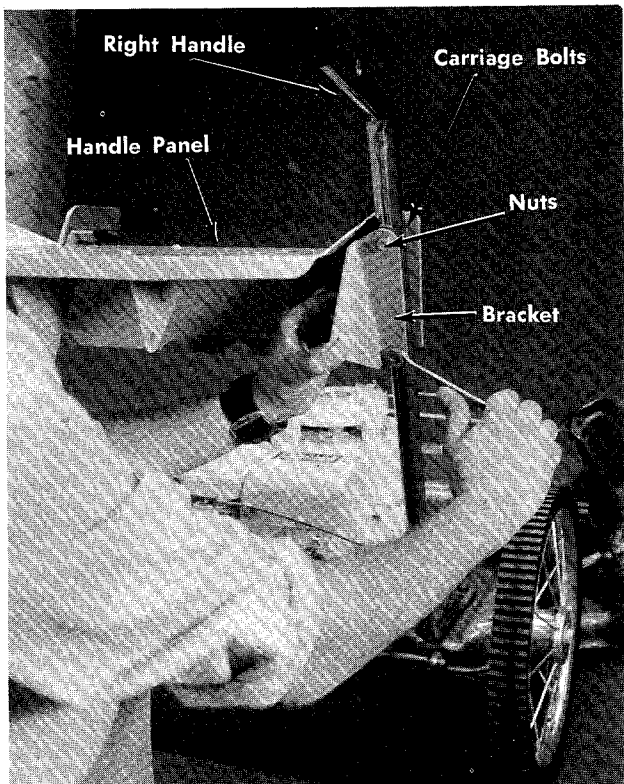

FIGURE 3

7. Tighten the four nuts holding the left and right handle to the frame. See figure 2.
8. Assemble the throttle control to the handle panel with the two speednuts and screws. See figure 4.
9. If the lockout lever and index lever are not pre-assembled, they must be assembled to the bracket welded to the left side of the handle panel. Place the index bracket over the stud with the black plastic grip facing the right. See figure 4.

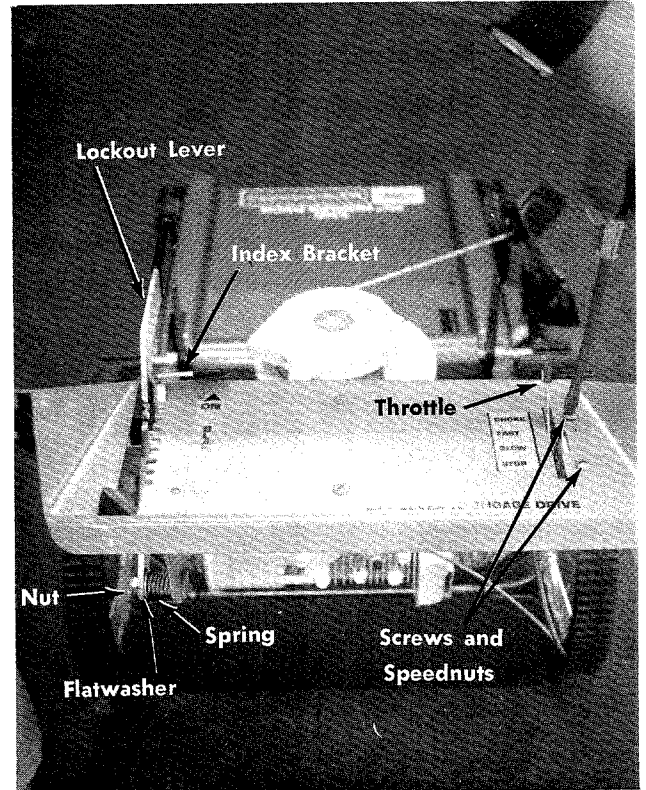

FIGURE 4

10. Put the spring, flatwasher and lockout lever, in that order, over the stud and tighten the nut until the end of the stud is flush with the top of the nut. See figure 4.

NOTE

The black grip on the lockout lever faces the front of the mower.

11. Remove the cotter pin from the ferrule on the deck. Put the hooked end of the lockout rod through the hole on the front of the handle panel and screw the lockout rod into the ferrule until approximately 1 1/4 inches of thread extend through the ferrule. See figure 5.
12. Place the hooked end of the lockout rod into the hole in the lockout lever and secure it with a cotter pin. See figure 6.

CAUTION

The final adjustment of the lockout lever must be made before the engine is started. Final adjustment will be covered in step 19.

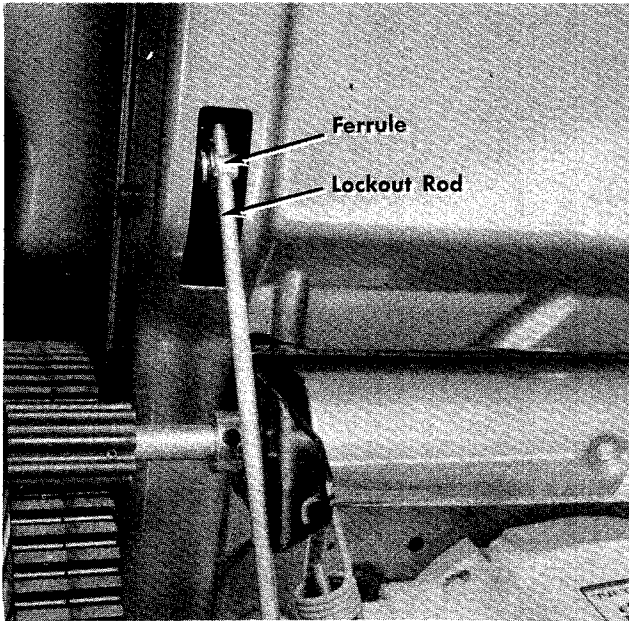

FIGURE 5

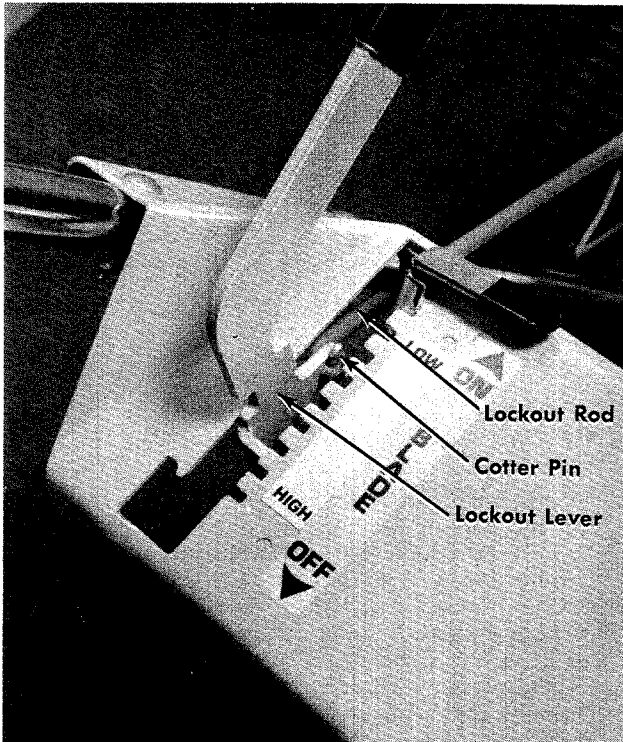

FIGURE 6

13. Assemble the pivot bracket, with the long side to the left, with two shoulder bolts, lockwashers and nuts. See figure 7.

NOTE

Assemble both shoulder bolts from the inside as shown in figure 7.

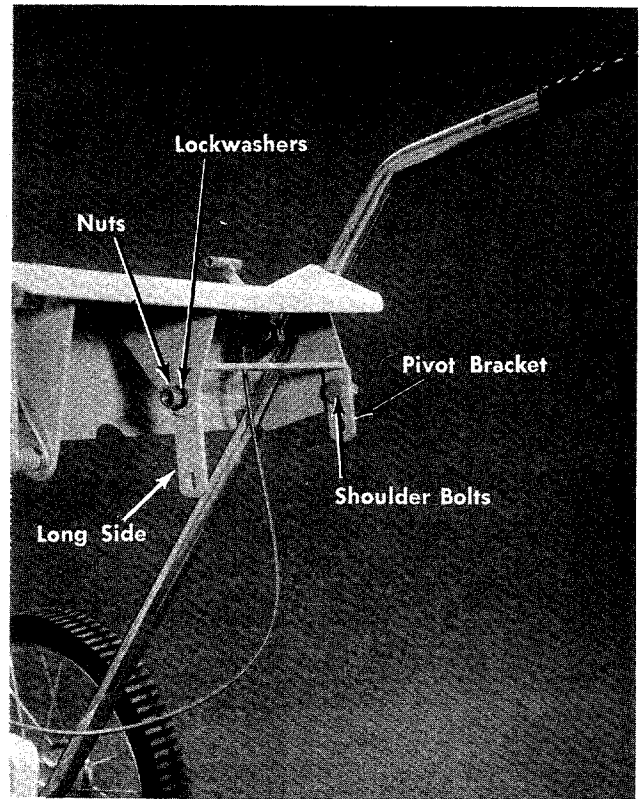

FIGURE 7

14. Slide the springs over the threaded end of the long clutch rods and screw the nuts on until $\frac{3}{4}$ " of threads are extended through the nuts. See figure 8.
15. Assemble the two long clutch rods to the oblong hole on the long side of the pivot bracket. Hook the rods, with the right rod on the bottom, as shown in figure 9.

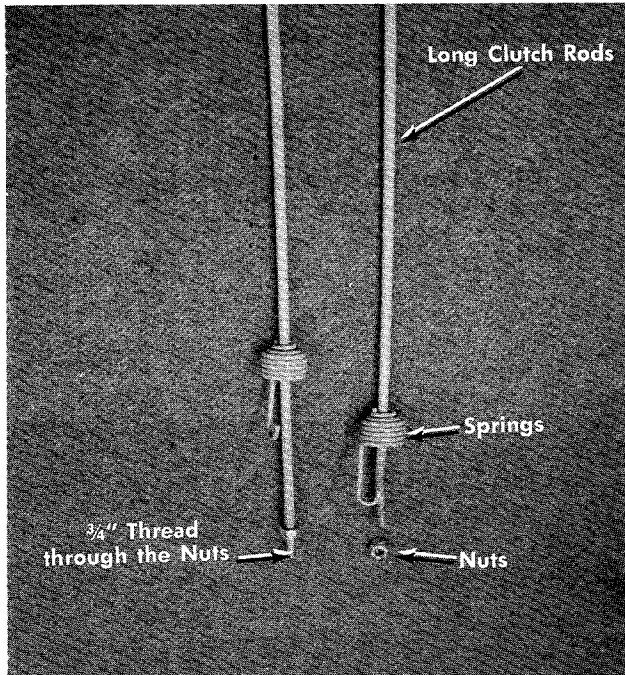

FIGURE 8

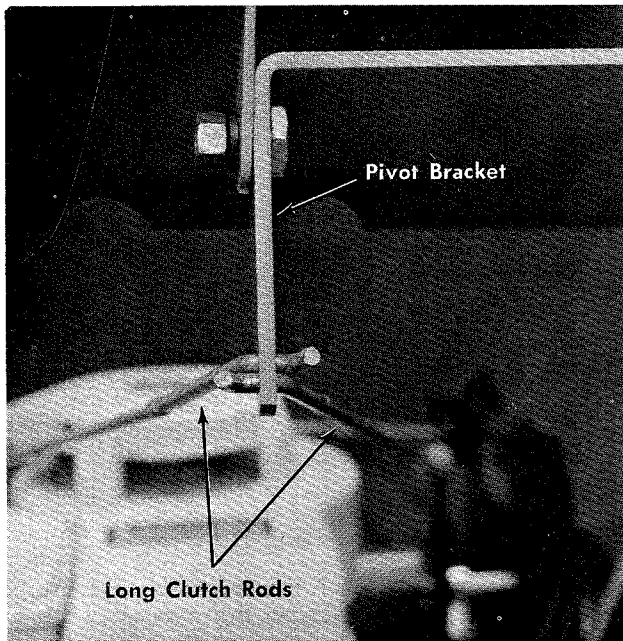

FIGURE 9

16. Place the ferrule through the round hole in the pivot bracket and screw the short clutch rod into the ferrule until 1" of thread extends through the ferrule. See figure 10.
17. Hook the clutch handle to the hooked end of the short clutch rod and assemble the clutch handle to the right handle with the drilled stud and cotter pin. See figure 11.

CAUTION

The final adjustment of the clutch rod must be made before the engine is started. Final adjustment is covered in step 18.

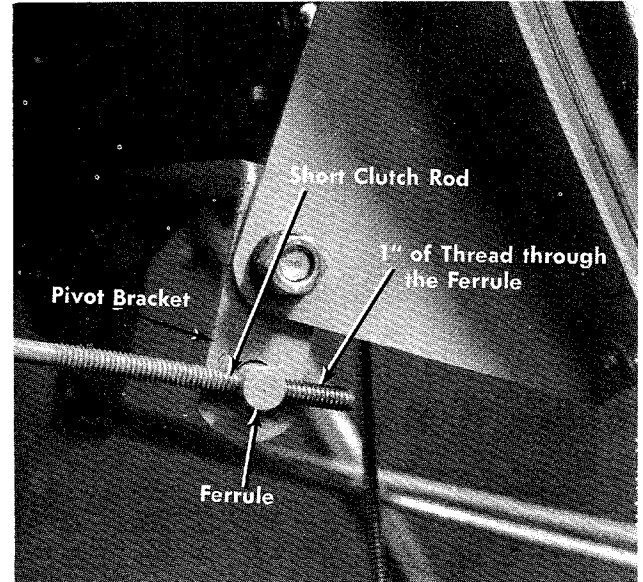

FIGURE 10

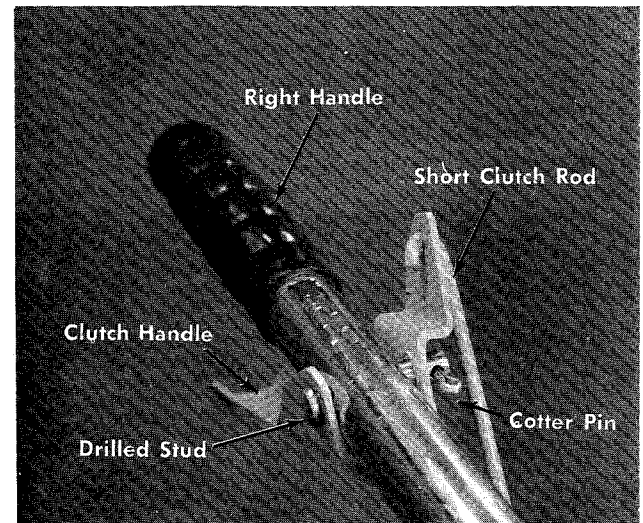

FIGURE 11

18. Final Adjustment—Clutch (Engine Off)

With the clutch handle released as shown in figure 11, the drive pinion should not touch the wheels. When you squeeze the clutch handle the pinions should engage solidly into the tread of the wheels. If the pinions touch the wheels with the clutch handle released, take out the drilled stud and unscrew the short clutch rod from the ferrule. If the pinions do not engage solidly into the wheels, screw the short control rod further into the ferrule.

19. Final Adjustment—Lockout Lever

Put the lockout lever in the OFF position. If the lockout lever cannot be pulled back into the OFF position, remove the cotter pin and unscrew the lockout rod. Reassemble and test. See figures 6 and 12.

Start the engine as explained in the engine manual and check the blade to see if it is turning. If the blade rotates, shut the engine off immediately, remove the cotter pin in the lockout rod and screw the lockout rod out a few turns. Reassemble and test.

OPERATION

1. Check the lubricant level in the gear box. This must be maintained half full at all times and should be checked after each 25 hours of operation. See the Lubrication section of this manual.
2. Check steps 18 and 19 of the Assembly Instructions to be sure the clutch and blade disengagement controls are working properly.
3. Service the engine with gasoline and oil as outlined in the engine manual. See the engine manual for complete care and maintenance of engine. Use regular grade of gasoline (either leaded or unleaded) and fill the engine crankcase with the proper grade of oil.

CAUTION

DO NOT mix the oil and gasoline.

4. Move the lockout lever to the OFF position. See figure 12.
5. Move the throttle control to the CHOKE position. See figure 12.
6. With one foot on the deck, grasp the recoil starter handle and pull out rapidly. Allow the rope to rewind slowly. If the engine does not start after two or three tries, move the throttle control to the FAST position and try again.
7. After the engine starts, move the throttle control into the FAST position.
8. The lockout lever is on the left side of the handle panel. It is used to engage the blade. The indicator lever is located on the lower part of the deck lever. It is used to set the mower deck at the desired cutting height. Forward position is for the lowest cutting height. Rear position is for the highest cutting height.
9. The clutch handle is located on the right handle of the mower. Squeezing the clutch handle engages the drive pinions of the wheels. Release the clutch handle and the forward motion of the mower stops. You must release the clutch handle to make a turn.

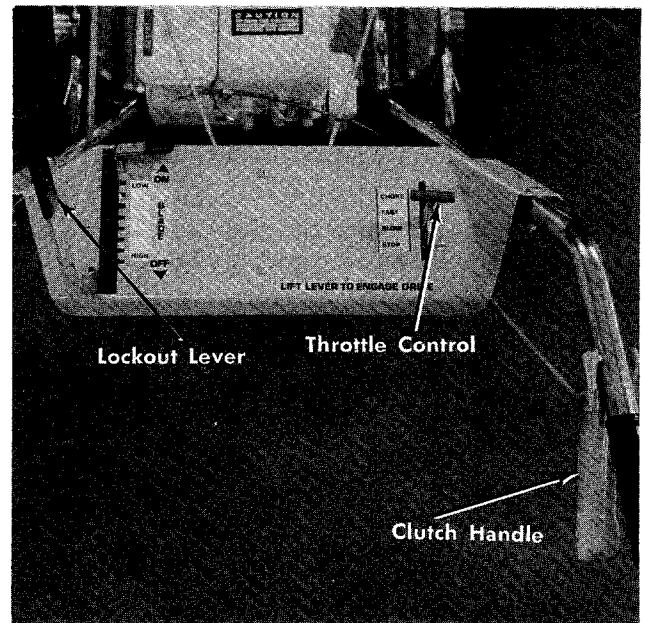

FIGURE 12

10. The throttle control is located on the right hand side of handle panel. This controls engine speed.
11. Fast engine speeds produce better cutting conditions. However, unit should be run at slower speeds until operator is thoroughly familiar with controls.
12. Never attempt to clean or make any adjustments with the engine running.
13. A brief break-in period is essential to insure maximum engine at half speed for a period of time required to use one tank of gasoline. It is also recommended to change crankcase oil after the first five hours of operation. After the initial change, oil should be changed every twenty-five hours of operation or as operating conditions dictate. Always check oil before operating the mower. **BE SURE CRANKCASE IS FULL!**
14. Proper lubrication must be maintained at all times.
15. Appropriate clothing should be worn when cutting brush or heavy weeds. Safety shoes and safety glasses are highly recommended.
16. The engine is stopped by moving the throttle control lever to "STOP" position.
17. The blade is stopped by moving the lockout lever to the OFF position.

LUBRICATION AND MAINTENANCE

IMPORTANT: Always stop engine and disconnect spark plug wire before cleaning, lubricating, or doing any kind of work on the lawn mower.

LUBRICATION

1. **Wheels**—Wheel bearings are ball bearing. Lubricate periodically with a few drops of oil (SAE No. 10 or 20).
2. **Throttle**—Periodically lubricate throttle control lever and throttle wire assembly with a few drops of light oil (SAE No. 10 or 20) for ease of operation.
3. **Engine**—Follow engine manual for lubrication instructions.
4. **Gear Box**—Check lubricant in the gear box. This must be maintained half full at all times and should be checked prior to each mowing. The gear box is packed at the factory with Alduralube Heavy or Temprite No. 2. It is suggested that this or an equivalent type and quality fibrous high heat wheel bearing grease be used in maintaining this mechanism.
5. **Chute Deflector**—The torsion spring and pivot point should be lubricated periodically with light oil to prevent any rust or binding. Deflector must work freely.
6. Lubricate all other linkage after every 25 hours of operation with SAE 10 or 20 oil.
7. The blade spindle bearings are sealed and require no further lubrication.

MAINTENANCE

1. **Cutting Blade**—The blade may easily be removed for grinding or replacement as follows:
 - a) Remove bolts and lockwashers holding blade and blade adapter to blade spindle shaft.
 - b) Remove blade and blade adapter from blade spindle shaft.
 - c) Remove two bolts, lockwashers and nuts holding blade to blade adapter (if necessary).

When sharpening blade, follow the original angle of grind as a guide. It is extremely important that each cutting edge receives an equal amount of grinding to prevent an unbalanced blade. An unbalanced blade will cause excessive vibration when rotating at high speeds and may cause damage to the mower.

NOTE

To insure safe operation of your unit, ALL nuts and bolts must be checked periodically for correct tightness.

2. **Deck**—The underside of the mower deck should be cleaned after each period of use as grass clippings, leaves, dirt, and other matter accumulates. This accumulation of grass clippings, etc., is undesirable as it will invite rust and corrosion and may cause an uneven discharge of grass clippings at next cutting. The deck may be cleaned by tilting the mower backward or on its side and scraping clean with a suitable tool or by washing with a stream of water from a garden hose.

CAUTION

Do not direct the stream of water at a hot engine as damage to the engine may result.

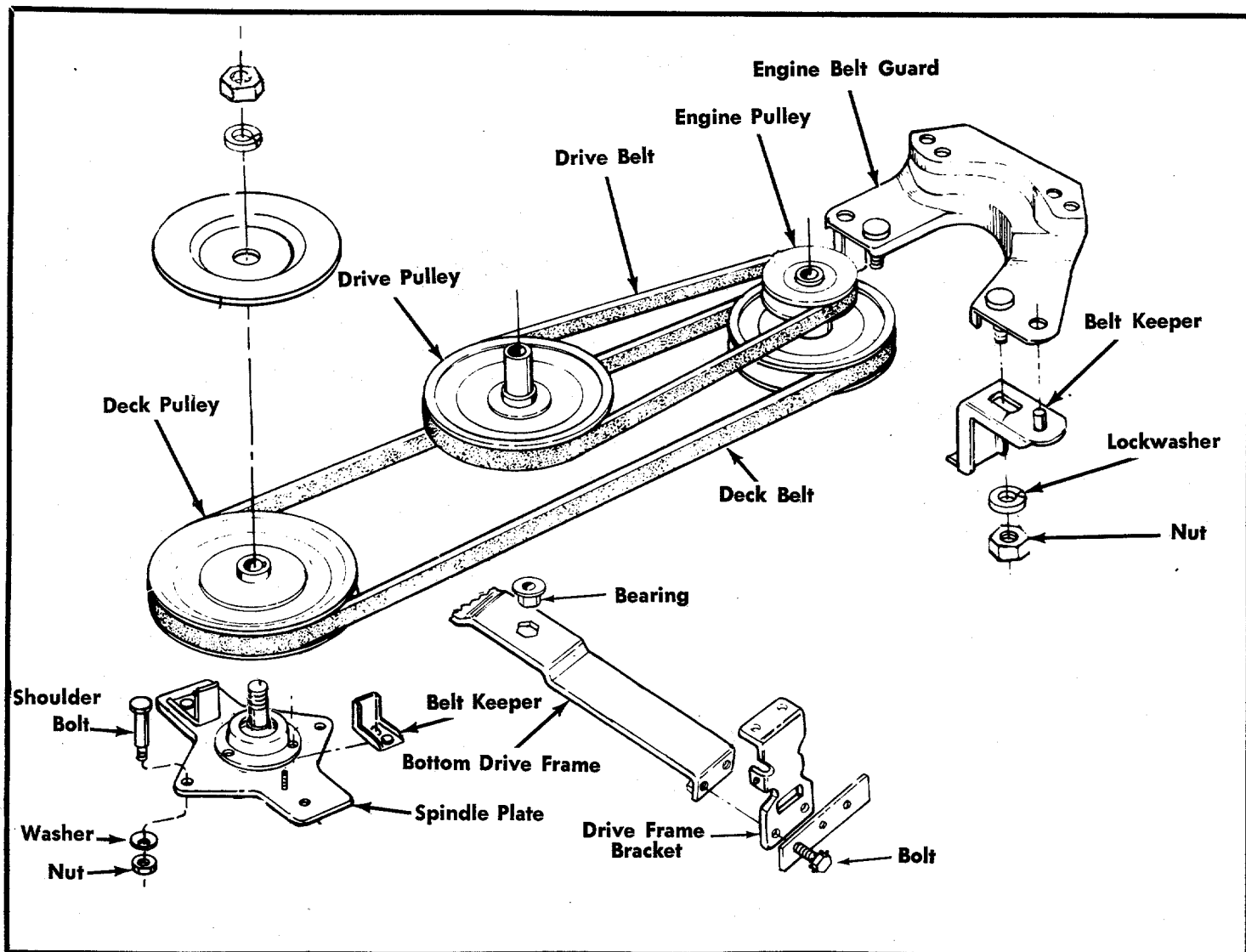

FIGURE 13

REMOVING THE DECK BELT (See figure 13.)

1. Place the lockout lever in the ON position.
2. Remove the two belt keepers and shoulder bolt on the deck pulley.
3. Remove the two belt keepers on the engine pulley.
4. Place the lockout lever in the OFF position.
5. Remove the belt.
6. Reassemble in reverse order with the new belt.

REMOVING THE DRIVE BELT (See figure 13.)

1. Remove the belt keepers on the engine pulley.

2. Place the lockout lever in the OFF position.
3. Unhook the deck belt from the engine pulley.
4. Remove the engine belt guard.
5. Remove the bottom drive frame by removing the two bolts on each end.
6. Roll the belt over the drive pulley.

CAUTION

This pulley is under tension. Release the tension slowly as you remove the belt.

7. Reassemble in reverse order with the new belt.

SERVICE NOTES

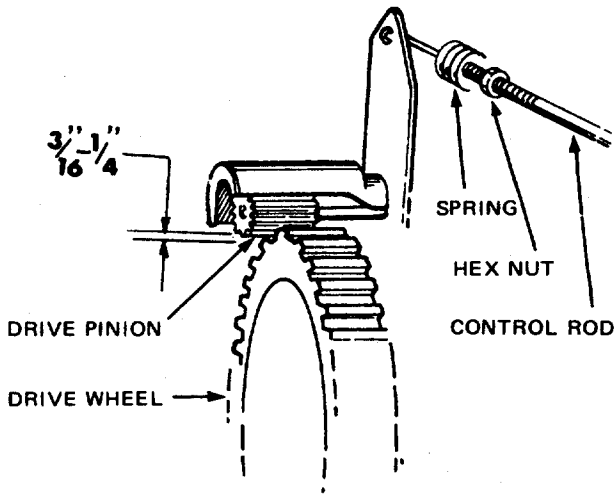

Clearance between Drive Pinion and Drive Wheel should be $3/16''$ to $1/4''$ when control is in "DIS-ENGAGED" position. Adjust Hex Nut on Control Rod as required. Excess clearance will cause premature belt wear.

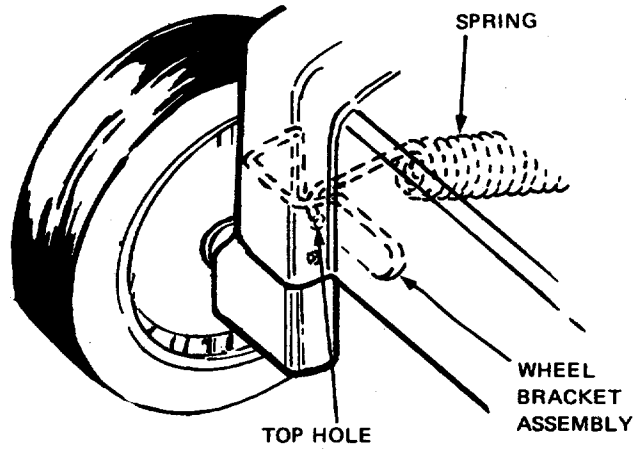

The right hand Deck Extension Spring must be assembled over the top of the Wheel Bracket Assembly and attached through the top mounting hole. Assembly otherwise will prevent correct disengagement when raising the deck.

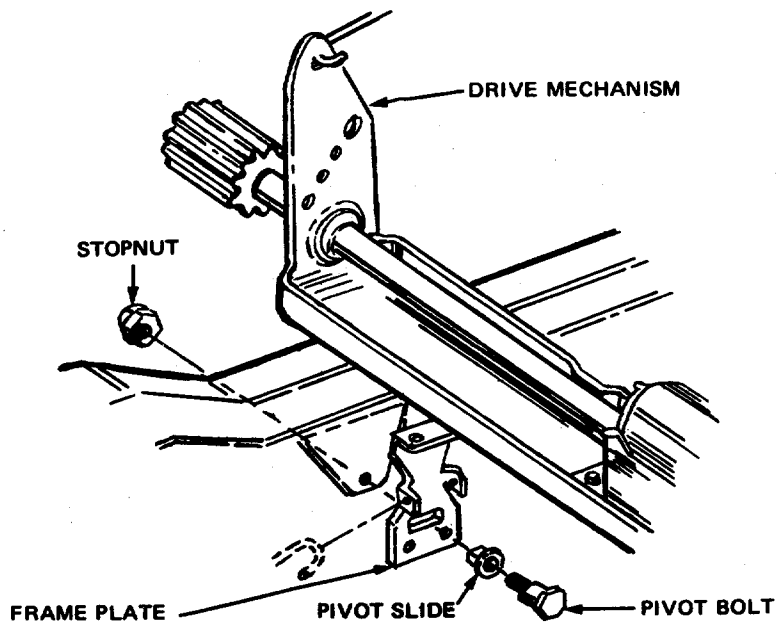

If Drive Mechanism does not pivot freely on frame plates, loosen stop nuts on each side. Belts will damage and wear prematurely if mechanism does not move freely.

6

NOTE

The manufacturer DOES NOT recommend the use of any accessory on this rotary mower other than those manufactured by MID Products Inc.

IMPORTANT

After striking a foreign object, stop the engine, remove wire from spark plug, thoroughly inspect the mower for any damage, and repair the damage before re-starting and operating the mower.

GRASS CATCHER Model No.195-015A is available as optional equipment for the mower shown in this manual.

WARNING

1. The mower should not be operated without the entire grass catcher or chute deflector in place.
2. The mower should not be operated without the protective shield on the rear of the deck in place.

NOTE:

Under normal usage bag material is subject to wear, and should be checked periodically. Be sure any replacement bag complies with the mower manufacturer's recommendations. For replacement bags, use only factory authorized replacement bag NO. 764-0121.

125-570A

IF YOU WRITE TO US ABOUT THIS ARTICLE
OR IF YOU ORDER REPLACEMENT PARTS AL-
WAYS MENTION THIS MODEL & SERIAL NO
MODEL

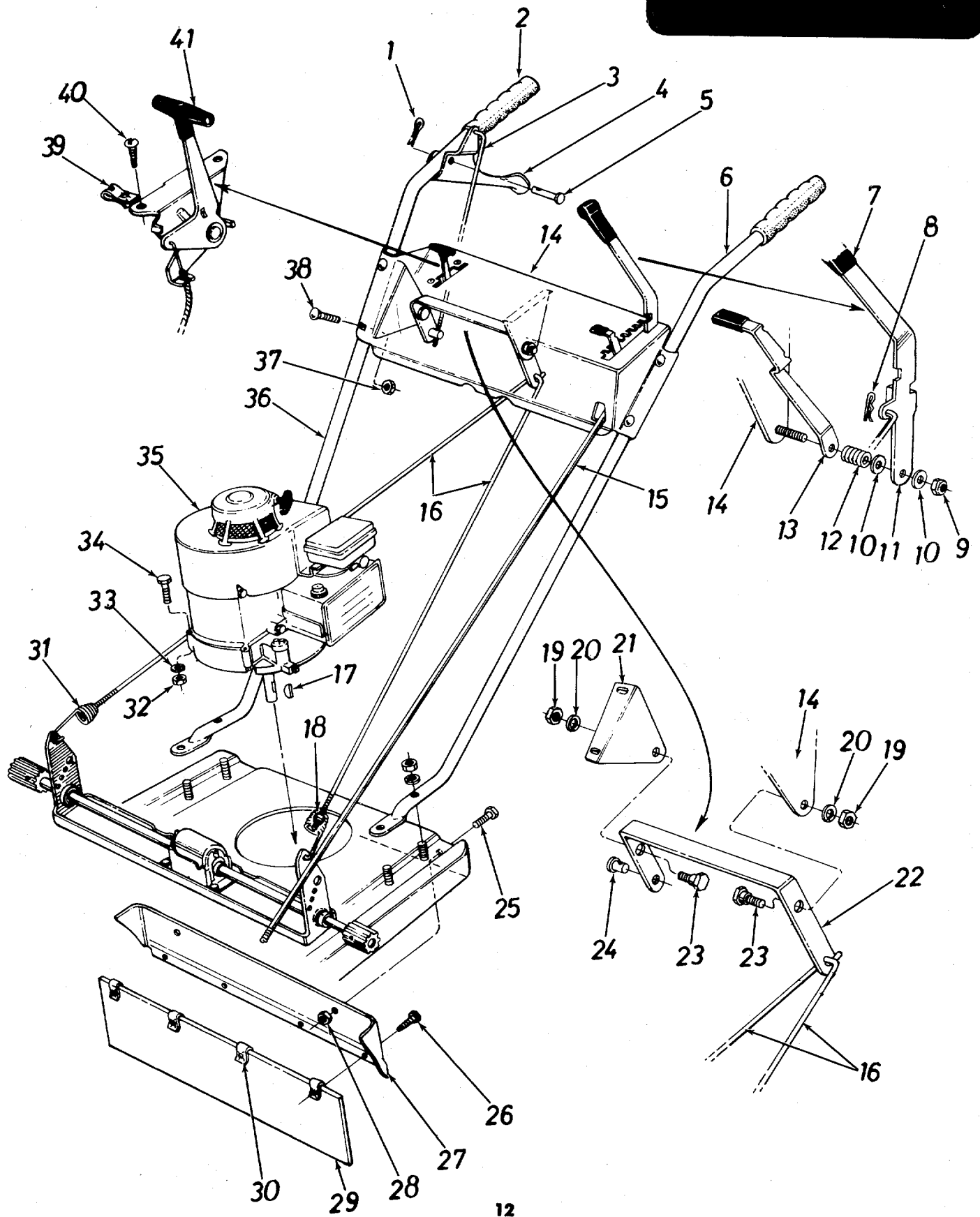

PARTS LIST FOR MODEL 125-570A

REF. NO.	PART NO.	COLOR CODE	DESCRIPTION	NEW PART
1	714-0104		Hair Pin Cotter 5/16" Dia.	
2	01166		Grip	
3	747-0163		Clutch Rod	N
4	12572		Clutch Grip	N
5	711-0415		Clevis Pin	
6	749-0185		Handle—L.H.	N
7	720-0142		Flat Grip (For Lift Lever)	
8	714-0507		Cotter Pin*	
9	712-0116		Hex Elastic Stop Nut 3/8-24 Thd.	
10	736-0300		Flat Wash. .39 I.D.	
11	10324		Lift Lever	
12	732-0193		Compression Spring	
13	10325		Indicator	
14	12568—458		Control Panel Ass'y.	N
15	711-0424		Deck Rod	
16	747-0162		Lockout Rod	N
17	714-0365		#6 Hi-Pro-Key 5/32 x 5/8" Dia.	
18	712-0324		Hex Elastic Stopnut 1/4-20 Thd.	
19	712-0798		Hex Nut 3/8-16 Thd.*	
20	736-0169		L.-Wash. 3/8" Scr.*	
21	12571—458		Bracket	N
22	12570—458		Link Bracket	N
23	738-0183		Shld. Scr. .500 Dia. x .215	
24	711-0619		Adjustment Ferrule 1/4-20 Thd.	
25	710-0567		Hex Scr. 1/4-28 x .62" Lg.	
26	710-0436		Hex Hd. Tapp. Scr. 10Z x .62" Lg.	
27	12548—458		Drag Shield Adapter	N
28	712-0138		Hex Nut 1/4-28 Thd.	
29	735-0182		Drag Shield	N
30	726-0150		Speed Nut 10Z "U" Type	
31	732-0305		Extension Spring	N
32	712-0123		Hex Nut 5/16-24 Thd.*	
33	736-0119		L.-Wash. 5/16" Scr.*	
34	710-0158		Hex Scr. 5/16-24 x 1.25" Lg.*	
35	—		Engine	
36	749-0184		Handle—R.H.	N
37	712-0107	429	Hex Cent. L.-Nut 1/4-20 Thd.	
38	710-0256	262	Carriage Bolt 1/4-20 x 1.50" Lg.*	
39	712-0526		Speed Nut #10	
40	710-0224		Hex Self Tap Scr. Type (A) #10 x .50" Lg.	
41	746-0161		Throttle Control Ass'y.—Compl.	

*For faster service obtain standard nuts, bolts and washers locally. If these items cannot be obtained locally, order by part number and size as shown on the parts list.

458—Arctic Blue

When ordering parts, if color or finish is important, use the appropriate color code shown above (e.g. Arctic Blue finish — 10292 (458)).

The engine is not under warranty by the mower manufacturer... If repairs or service is needed on the engine, please contact your nearest authorized engine service outlet. Check the "Yellow Pages" of your telephone book under "Engines—Gasoline."

**Find It Fast
In The
"Yellow Pages"**



125-570A

IF YOU WRITE TO US ABOUT THIS ARTICLE
OR IF YOU ORDER REPLACEMENT PARTS AL-
WAYS MENTION THIS MODEL & SERIAL NO
MODEL

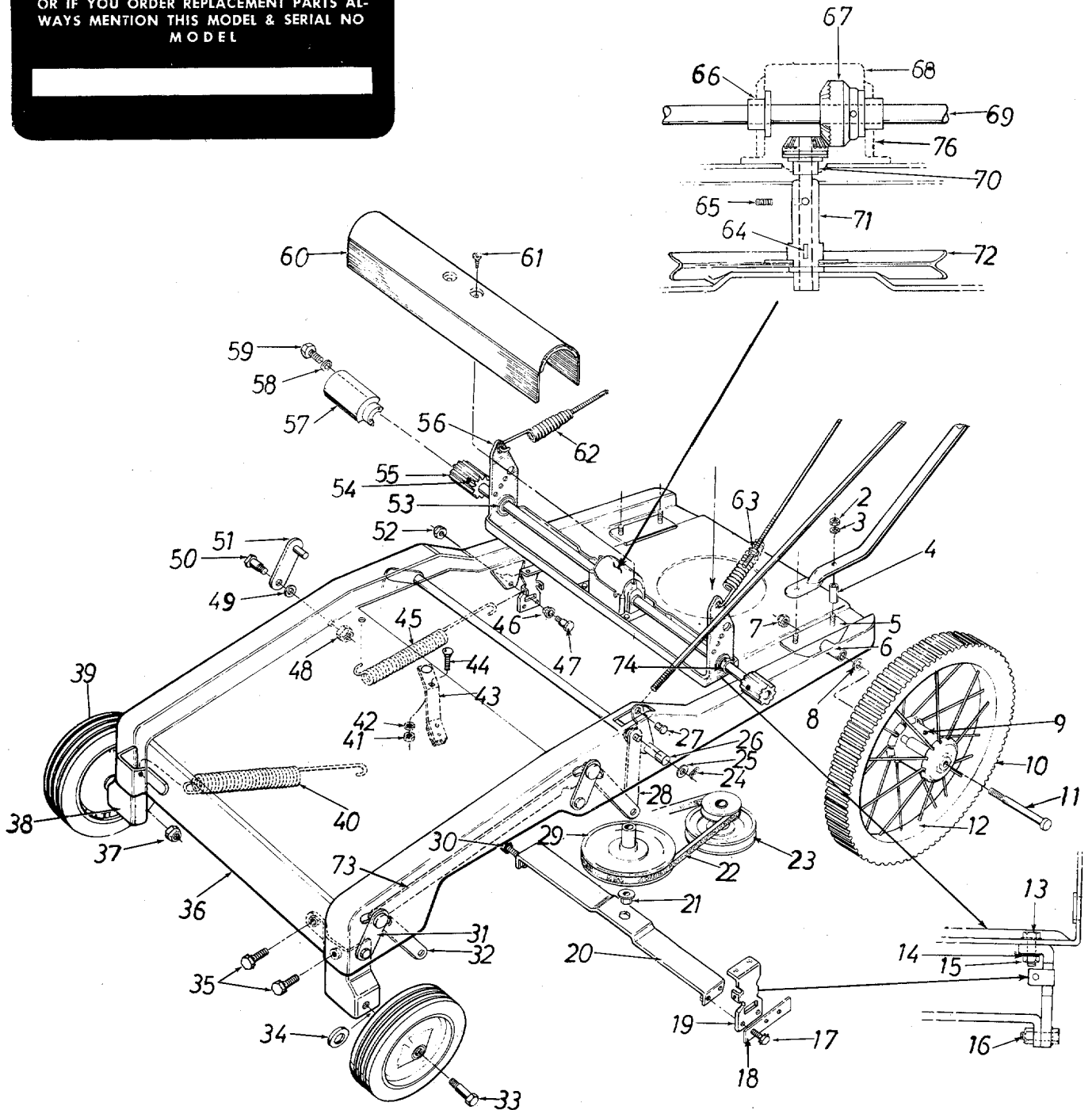

— NOTE —

Gear box is lubricated with two ounces of Alduralube Heavy. Order by part number 727-0111.

NOTE: Set screws in pulleys are treated with a nut and bolt sealant. Remove with allen wrench while applying heat with a small torch. Sealant disintegrates at 400°.

To engage the blade with the engine running...

1. Move the throttle control lever to "FAST" position.
2. Engage the blade engagement lever SLOWLY.
3. Adjust engine speed.

PARTS LIST FOR MODEL 125-570A

REF. NO.	PART NO.	COLOR CODE	DESCRIPTION	NEW PART	REF. NO.	PART NO.	COLOR CODE	DESCRIPTION	NEW PART
2	712-0798		Hex Nut 3/8-16 Thd.*		36	10292		Frame Ass'y.	
3	736-0169		Spring L-Wash. 3/8" Scr.*		37	712-0181		Top L-Nut 3/8-16 Thd.*	
4	—		Spacer Used in Shipment Only		38	10294		Front Wheel Brkt. Ass'y.—R.H.	
5	10297		Rear Wheel Brkt. Ass'y.—L.H.			10293		Front Wheel Brkt. Ass'y.—L.H.	
	10298		Rear Wheel Brkt. Ass'y.—R.H.		39	734-0642		Front Wheel Ass'y.—Comp.	
6	711-0425		Spacer—Rear Axle		40	732-0153		Extension Spring	
7	712-0181		Top Locknut 3/8-16 Thd.*		41	712-0287		Hex Nut 1/4-20 Thd.*	
8	736-0192		Flat Washer .53 I.D.*		42	736-0329		Spring L-Wash. 1/4" Scr.*	
9	718-0132		Oil Cap (One Each Rear Wheel)		43	761-0148		Blade Brake Ass'y.	
10	734-0391		Tire Only 16 x 1.75 (Rear Wheel)		44	710-0134		Carriage Bolt 1/4-20 x .62" Lg.	
	734-0180		Rear Wheel Ass'y.—Less Tire		45	732-0206		Extension Spring	
11	738-0114		Axle Bolt—Rear Wheel		46	748-0180		Pivot Slide	
12	734-0242	454	Rear Wheel Ass'y.—Comp.		47	711-0105		Shoulder Bolt 5/16-18 Thd.	
13	710-0198		Sems Hex Hd. Cap Scr. 5/16-18 x 3/4" Lg.*		48	712-0429		Hex Elastic Stop Nut 5/16-18*	
14	736-0119		Spring L-Wash. 5/16" Scr.*		49	736-0264		Flat Washer .33 I.D. x 3/4 O.D.	
15	712-0267		Hex Nut 5/16-18 Thd.*		50	738-0141		Shoulder Bolt 5/16-18*	
16	710-0322		Sems Hex Hd. Cap Scr. 5/16-18 x 1" Lg.*		51	09721		Pivot Link Ass'y.	
17	710-0322		Sems Hex Hd. Cap Scr. 5/16-18 x 1" Lg.*		52	712-0429		Hex Elast. S-Nut 5/16-18 Thd.*	
18	10883		Drive Frame Stop		53	741-0138		Ball Bearing .627 I.D.	
19	10320		Bottom Drive Frame Plate		54	715-0120		Roll Pin 3/16" Dia. x 1" Lg.*	
20	10328		Bottom Drive Frame Ass'y.		55	748-0182		Drive Pinion	
21	748-0226		Flange Bearing 1/2" Dia.		56	10321		Top Drive Frame	
22	754-0143		Belt 3V x 28" Lg. (Drive Belt)		57	10289		Pinion Cover	
23	756-0154		Two-Step Pulley (Engine)		58	736-0722		Spring L-Wash. #10 Scr.*	
24	714-0101		Hair Pin		59	710-0224		Hex Hd. Self Tap Scr. Type (A) #10 x 1/2" Lg.*	
25	736-0192		Flat Washer .53 I.D.*		60	08100		Cover—Top Drive Frame	
26	10300		Lift Handle Ass'y.		61	710-0148		Hex Hd. Slotted Thd. Cut Scr. #8-32 x 3/8" Lg.*	
27	711-0179		Adjustment Ferrule		62	732-0184		Spring	
28	10318		Deck Link 3 3/4" Lg.		63	712-0324		Hex Elastic Stop Nut 1/4-20 Thd.	
29	756-0155		Pulley 6 1/2" Dia. (Drive Pulley)		64	714-0229		Woodruff Key #2	
30	710-0198		Sems Hex Hd. Cap Scr. 5/16-18 x 3/4" Lg.*		65	710-0421		Allen Set Scr. 5/16-18 x 1/4" Lg.*	
31	09721		Pivot Link Ass'y.		66	748-0110		Flange Bearing 5/8" Dia.	
32	10317		Deck Link 4 3/4" Lg.		67	748-0135		Bevel Gear	
33	710-0427		Hex Scr. 3/8-16 x 2.00" Lg.*		68	07716		Gear Box Cover	
34	736-0105		Belleville Washer		69	10322		Drive Shaft	
35	710-0259		Sems Hex Hd. Cap Scr. 5/16-18 x 5/8" Lg.*		70	748-0108		Flange Bearing 1/2" Dia.	
					71	10254		Pinon Ass'y.	
					72	756-0155		Pulley 6 1/2" Dia. (Drive Pulley)	
					73	10319		Connecting Rod	
					74	711-0169		Collar 5/8" Dia.	
					76	717-0108		Gear Box	
					77	741-0178		Front Wheel Bearing .38 I.D.	

(not shown)

*For faster service obtain standard nuts, bolts and washers locally. If these items cannot be obtained locally, order by part number and size as shown on the parts list.

458—Arctic Blue

When ordering parts, if color or finish is important use the appropriate color code shown above (e.g. Arctic Blue finish — 10292 (458)).

The engine is not under warranty by the mower manufacturer... If repairs or service is needed on the engine, please



contact your nearest authorized engine service outlet. Check the "Yellow Pages" of your telephone book under "Engines—Gasoline."

125-570A

ILLUSTRATION FOR DECK AND PULLEY SYSTEM

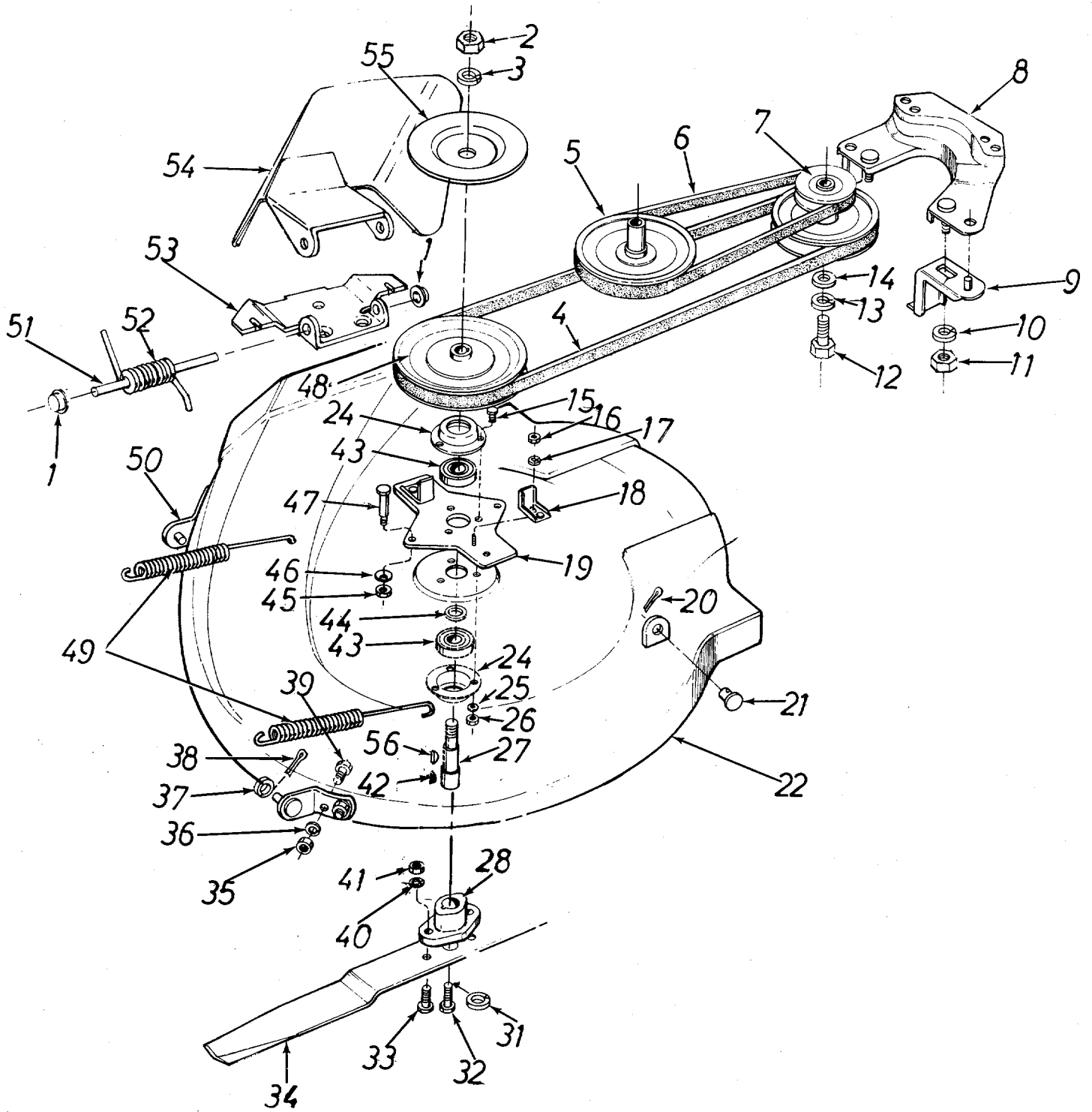

PARTS LIST FOR DECK AND PULLEY SYSTEM MODEL NO. 125-570A

REF. NO.	PART NO.	COLOR CODE	DESCRIPTION	NEW PART
1	726-0106		Push-on Flange Pinnut	
2	712-0242		Hex Jam Nut 5/8-11 Thd.	
3	736-0158		Spring Lockwasher 5/8" Scr.*	
4	754-0144		V-Belt 21/32 x 55" Lg. (Blade Drive Belt)	
5	756-0155		Pulley 6 1/2" Dia. (Drive Pulley)	
6	754-0143		Belt 3V x 28" Lg. (Drive Belt)	
7	756-0154		Two-Step Engine Pulley	
8	10423		Belt Guard Cup Assembly	
9	10426		Belt Keeper Assembly	
10	736-0119		Spring Lockwasher 5/16 Scr.*	
11	712-0267		Hex Nut 5/16-18 Thd.*	
12	710-0152		Hex Hd. Cap Scr. 3/8-24 x 1" Lg.*	
13	736-0169		Spring Lockwasher 3/8" Scr.*	
14	07386		Flat Washer .39 I.D. x 1 3/4" O.D.	
15	710-0322		Sems Hex Hd. Cap Scr. 5/16-18 x 1" Lg.*	
16	712-0267		Hex Nut 5/16-18 Thd.*	
17	736-0119		Spring Lockwasher 5/16" Scr.*	
18	10426		Belt Keeper Assembly	
19	11543		Deck Belt Guard Plate Ass'y.	
20	714-0115		Cotter Pin 1/8" Dia.*	
21	711-0332		Lift Bracket Pin	
22	11087-458		Deck Assembly	
23	741-0163		Bearing Housing Assembly (Includes Ref. No.'s 24 & 43)	
24	08253		Housing	
25	736-0119		Spring Lockwasher 5/16" Scr.*	
26	712-0267		Hex Nut 5/16-18 Thd.*	
27	711-0405		Blade Spindle	
28	10769		Blade Adapter Kit	

REF. NO.	PART NO.	COLOR CODE	DESCRIPTION	NEW PART
31	736-0217		Spring Lockwasher 3/8" Scr. Heavy Duty	
32	710-0459		Hex Hd. Cap Scr. 3/8-24 x 1 1/2" Lg. Heat Treated	
33	710-0117		Hex Hd. Cap Scr. 5/16-24 x 1" Lg. Heat Treated	
34	742-0147		Blade 26 inch	
35	712-0287		Hex Nut 1/4-20 Thd.*	
36	736-0329		Spring Lockwasher 1/4" Scr.*	
37	736-0192		Flat Washer .53 I.D.*	
38	714-0115		Cotter Pin 1/8" Dia.*	
39	710-0258		Hex. Hd. Cap Scr. 1/4-20 x .62" Lg.*	
40	736-0119		Spring Lockwasher 5/16" Scr.*	
41	712-0123		Hex Nut 5/16-24 Thd.*	
42	714-0365		#6 Key Hi Pro 5/32 x 3/8" Dia.	
43	741-0919		Ball Bearing	
44	750-0142		Spacer—Blade Spindle	
45	712-0267		Hex Nut 5/16-18 Thd.*	
46	736-0105		Belleville Washer	
47	738-0129		Shoulder Bolt .498 Dia. x 2.005" Lg.	
48	756-0143		Deck Pulley	
49	732-0153		Extension Spring	
50	10306		Deck Bracket Ass'y.—R.H.	
	10305		Deck Bracket Ass'y.—L.H.	
51	711-0571		Pivot Pin	
52	732-0261		Torsion Spring	
53	11399-458		Adapter Plate	
54	11634-458		Chute Deflector Ass'y. Comp.	
55	11073		Blade Brake Disc	
56	714-0388		#6 Key Hi Pro 3/16 x 3/8" Dia.	

*For faster service obtain standard nuts, bolts and washers locally. If these items cannot be obtained locally, order by part number and size as shown on the parts list.

458—Arctic Blue

When ordering parts, if color or finish is important, use the appropriate color code shown above (e.g. Arctic Blue finish — 10292 (458).

The engine is not under warranty by the mower manufacturer... If repairs or service is needed on the engine, please contact your nearest authorized engine service outlet. Check the "Yellow Pages" of your telephone book under "Engines—Gasoline."

**Find It Fast
In The
'Yellow Pages'**



PARTS INFORMATION

DEFECTIVE OR MISSING PARTS must be reported to the factory immediately. Such claims must include your model number and date of purchase.

POWER EQUIPMENT PARTS AND SERVICE

Parts and service for all MTD manufactured power equipment are available through the authorized service firms listed below. All orders should specify the model number of your unit, parts numbers, description of parts and the quantity of each part required.

A 1 Engine & Mower Co.
327 East 9th Street
Salt Lake City, Utah 84102

Auto Electric & Carburetor Co.
2525 4th Avenue, S.
P. O. Box 1948
Birmingham, Alabama 35233

Automotive Equipment Service Co.
3117 Holmes Street
Kansas City, Missouri 64109

Bailey's Rebuild Inc.
1325 E. Madison Street
Seattle Washington 98102

Bleckie, Inc.
7900 Lorain Avenue
Cleveland, Ohio 44102

Brown Equipment Distributor Inc.
110 Beech Street
Corydon, Indiana 47112

Bullard Supply
2409 Commerce Street
Houston, Texas 77003

Catto & Putty, Inc.
P. O. Box 2408
510 Soledad Street
San Antonio, Texas 78205

Center Supply Company
6867 New Hampshire Avenue
Takoma Park, Maryland 20012

Dixie Sales Company
P. O. Box 1408
327 Battleground Avenue
Greensboro, North Carolina 27402

East Point Cycle & Key Shop
1617 Whiteway
East Point, Georgia 30044

Gamble Distributors
West End Avenue
Carthage, New York 13619

Garden Equipment Co., Inc.
6600 Cherry Avenue
Long Beach, California 90805

Gardenville Supply, Inc.
Pipersville, Pennsylvania 18947

Henry W. O'Neil & Assoc., Inc.
410 North Goodman Street
Rochester, New York 14609

Henzler, Inc.
2015 Lemay Ferry Road
St. Louis, Missouri 63125

Kenton Supply
8216 North Denver Avenue
Portland, Oregon 97217

Kimber's Inc.
115 W. Geddes St.
Syracuse, New York 13204

Marr Brothers
423 E. Jefferson
Dallas, Texas 75203

McClure Lawn & Garden Supply
1114 Lexington Avenue
Mansfield, Ohio 44907

Memphis Cycle & Supply Co.
421 Monroe Avenue
Memphis Tennessee 38103

Morton B. Collins Co.
300 Birnie Avenue
Springfield, Massachusetts 01107

Mox-All of Florida, Inc.
365 Greco Avenue
Coral Gables, Florida 33146

National Central
687 Seville Rd.
Wadsworth, Ohio 44281

Parts & Sales Inc.
2101 Industrial Pkwy.
Elkhart, Indiana 46514

Power Equipment Distributor
36463 So. Gratiot Avenue
Mt. Clemens, Michigan 48043

Power Lawn & Garden Equip. Co.
2551-2571 J. F. Kennedy Road
Dubuque, Iowa 52001

Radco Distributors
2403 Market Street
P. O. Box 3216
Jacksonville, Florida 32206

Raub Supply Company
James & Mulberry Sts.
Lancaster, Pennsylvania 17604

Richmond Battery & Ignition
P. O. Box 25369 - 957 Myers St.
Richmond, Virginia 23260

R. P. W., Inc.
623 S. 16th Street
Omaha, Nebraska 68102

Smith Hardware Company
515 N. George Street
Goldsboro, North Carolina 27530

South Denver Lawn Equip. Co.
527 West Evans
Denver, Colorado 80223

Suhren Engine
8330 Earhart Blvd.
New Orleans, Louisiana 70118

Sutton's Lawn Mower Shop
Route 4, Box 343
North Little Rock, Arkansas 72117

Woodson Sales & Service
1702 North Sylvania
Ft. Worth, Texas 76111

WARRANTY PARTS AND SERVICE POLICY

The purpose of warranty is to protect the customer from defects in workmanship and materials, defects which are NOT detected at the time of manufacture. It does not provide for the unlimited and unrestricted replacement of parts. Use and maintenance are the responsibility of the customer. The manufacturer cannot assume responsibility for conditions over which it has no control. Simply put, if it's the manufacturer's fault, it's the manufacturer's responsibility; if it's the customer's fault, it's the customer's responsibility.

CLAIMS AGAINST THE MANUFACTURER'S WARRANTY INCLUDES

1. Replacement of Missing Parts on new equipment.
2. Replacement of Defective Parts within the warranty period.
3. Repair of Defects within the warranty period.

All claims MUST be substantiated with the following information:

1. Model Number of unit involved.
2. Date unit was purchased or first put into service.
3. Date of failure.
4. Nature of failure.