

M **YARD-MAN**[™]

owner's manual

- **ASSEMBLY**
- **OPERATION**
- **MAINTENANCE**
- **PARTS LIST**

Model Nos.

14912-0

14918-0

YARD-MAN

**11 & 16 H.P.
GARDEN
TRACTOR
WITH
VARIABLE
SPEED**

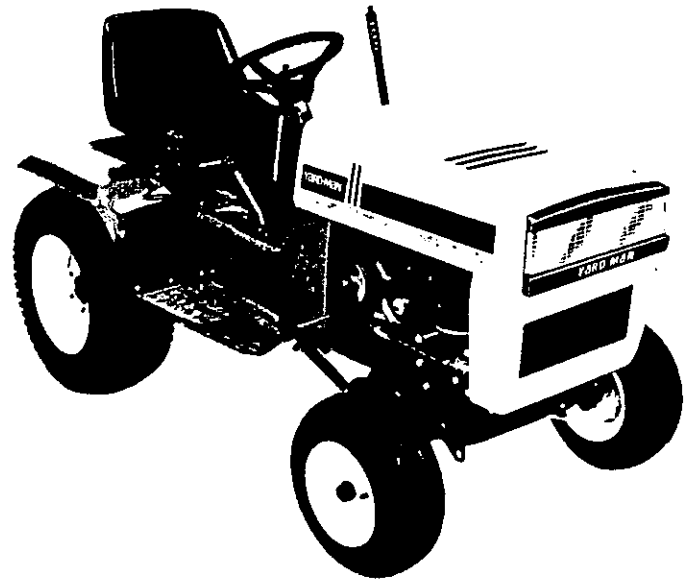

Important:

**Read Safety Rules and
Instructions Carefully**

INDEX

Safety Rules	3	Three Point Hitch	18
Know Your Tractor	4	Trouble Shooting Chart	20
Accessories	4	Illustrated Parts for Tractor	22
Assembly Instructions	5	Parts List for Tractor	23
Controls	6	Illustrated Parts for Transaxle	32
Operation	9	Parts List for Transaxle	33
Lubrication	10	Electrical Diagram and Parts List	34
Adjustments	11	Parts Information	Back Cover
Power Take Off (PTO)	14		

LIMITED WARRANTY

For one year from the date of original retail purchase, YARD-MAN COMPANY will either repair or replace, at its option, free of charge, F.O.B. factory or authorized service firm, any part or parts found to be defective in material or workmanship. Transportation charges under this warranty must be paid by the purchaser unless return is requested by YARD-MAN COMPANY.

This warranty will not apply to any part which has become inoperative due to misuse, excessive use, accident, neglect, improper maintenance, alterations, or unless the unit has been operated and maintained in accordance with the instructions furnished. This warranty does not apply to the engine, motor, battery, battery charger or component parts thereof. Please refer to the applicable manufacturer's warranty on these items.

This warranty will not apply where the unit has been used commercially.

Warranty service is available through your local authorized service dealer or distributor. If you do not know the dealer or distributor in your area, please write to the Customer Service Department of YARD-MAN.

The return of a complete unit will not be accepted by the factory unless prior written permission has been extended by YARD-MAN.

This warranty gives you specific legal rights. You may also have other rights which vary from state to state.



WARNING

TO PURCHASERS OF INTERNAL COMBUSTION ENGINE EQUIPPED MACHINERY OR DEVICES IN THE STATE OF CALIFORNIA

The equipment which you have just purchased does not have a spark arrester. If this equipment is used on any forest covered land, brush covered land, or grass covered unimproved land in the State of California, before using on such land, the California law requires that a spark arrester be provided. In addition, spark arrester is required by law to be in effective working order. The spark arrester must be attached to the exhaust system and comply with Section 4442 of the California Public Resources Code.

IMPORTANT

It is suggested that this manual be read in its entirety before attempting to assemble or operate. Keep this manual in a safe place for future reference and for ordering replacement parts.

This unit is shipped WITHOUT GASOLINE or OIL. After assembly, see operating section of this manual for proper fuel and amount.

This unit is a precision piece of power equipment, not a plaything. Therefore exercise extreme caution at all times.

SAFE OPERATION PRACTICES FOR RIDING VEHICLES

1. Know the controls and how to stop quickly—
READ THE OWNER'S MANUAL.
2. Do not allow children to operate vehicle. Do not allow adults to operate it without proper instruction. Only persons well acquainted with these rules of safe operation should be allowed to use your mower.
3. Do not carry passengers
4. Keep the area of operation clear of all persons, particularly small children and pets. Stop engine when they are in the vicinity of your mower. Although the area of operation should be completely cleared of foreign objects, a small object may have been overlooked and could be accidentally thrown by the mower in any direction.
5. Clear work area of objects which might be picked up and thrown by the mower in any direction.
6. Disengage all attachment clutches and shift into neutral before attempting to start engine.
7. Disengage power to attachment(s) and stop engine before leaving operating position.
8. Disengage power to attachment(s) and stop engine before making any repairs or adjustments. Disconnect the spark plug wire and keep the wire away from the plug to prevent accidental starting.
9. Before attempting to unclog the mower or discharge chute, stop the engine and be sure the blade(s) have stopped completely. Disconnect the spark plug wire and keep the wire away from the plug to prevent accidental starting.
10. Disengage power to attachment(s) when transporting or not in use.
11. Take all possible precautions when leaving vehicle unattended such as disengaging power-take-off, lowering attachments, shifting into neutral, setting parking brake, stopping engine and removing key.
12. Do not stop or start suddenly when going uphill or downhill. Mow up and down face of steep slopes; never across the face.
13. Reduce speed on slopes and in sharp turns to prevent tipping or loss of control. Exercise extreme caution when changing direction on slopes.
14. Stay alert for holes in terrain and other hidden hazards.
15. Use care when pulling loads or using heavy equipment.
 - A. Use only approved drawbar hitch points.
 - B. Limit loads to those you can safely control.
 - C. Do not turn sharply. Use care when backing.
- D. Use counterweight(s) or wheel weights when suggested in owner's manual.
16. Watch out for traffic when crossing or near roadways.
17. When using any attachments, never direct discharge of material toward bystanders nor allow anyone near vehicle while in operation.
18. Handle gasoline with care. It is highly flammable.
 - A. Use approved gasoline container.
 - B. Never remove cap or add gasoline to a running or hot engine or fill fuel tank indoors. Wipe up spilled gasoline.
 - C. Open doors if engine is run in garage. Exhaust fumes are dangerous. Do not run engine indoors.
19. Keep the vehicle and attachments in good operating condition, and keep safety devices in place. Use guards as instructed in owner's manual.
20. Keep all nuts, bolts, and screws tight to be sure the equipment is in safe working condition.
21. Never store the equipment with gasoline in the tank inside a building where fumes may reach an open flame or spark. Allow engine to cool before storing in any enclosure.
22. To reduce fire hazard, keep engine free of grass, leaves or excessive grease.
23. The vehicle and attachments should be stopped and inspected for damage after striking a foreign object. The damage should be repaired before restarting and operating the equipment.
24. Do not change the engine governor settings or overspeed the engine.
25. When using the vehicle with mower, proceed as follows:
 - (1) Mow only in daylight or in good artificial light.
 - (2) Never make a cutting height adjustment while engine is running if operator must dismount to do so.
 - (3) Shut the engine off and wait until the blade comes to a complete stop before removing the grass catcher.
 - (4) Check blade mounting bolts for proper tightness at frequent intervals.
26. Check grass catcher bags frequently for wear or deterioration. For safety protection, replace only with new bag meeting original equipment specifications.
27. Look behind to make sure the area is clear before placing the transmission in reverse and backing up.

KNOW YOUR TRACTOR

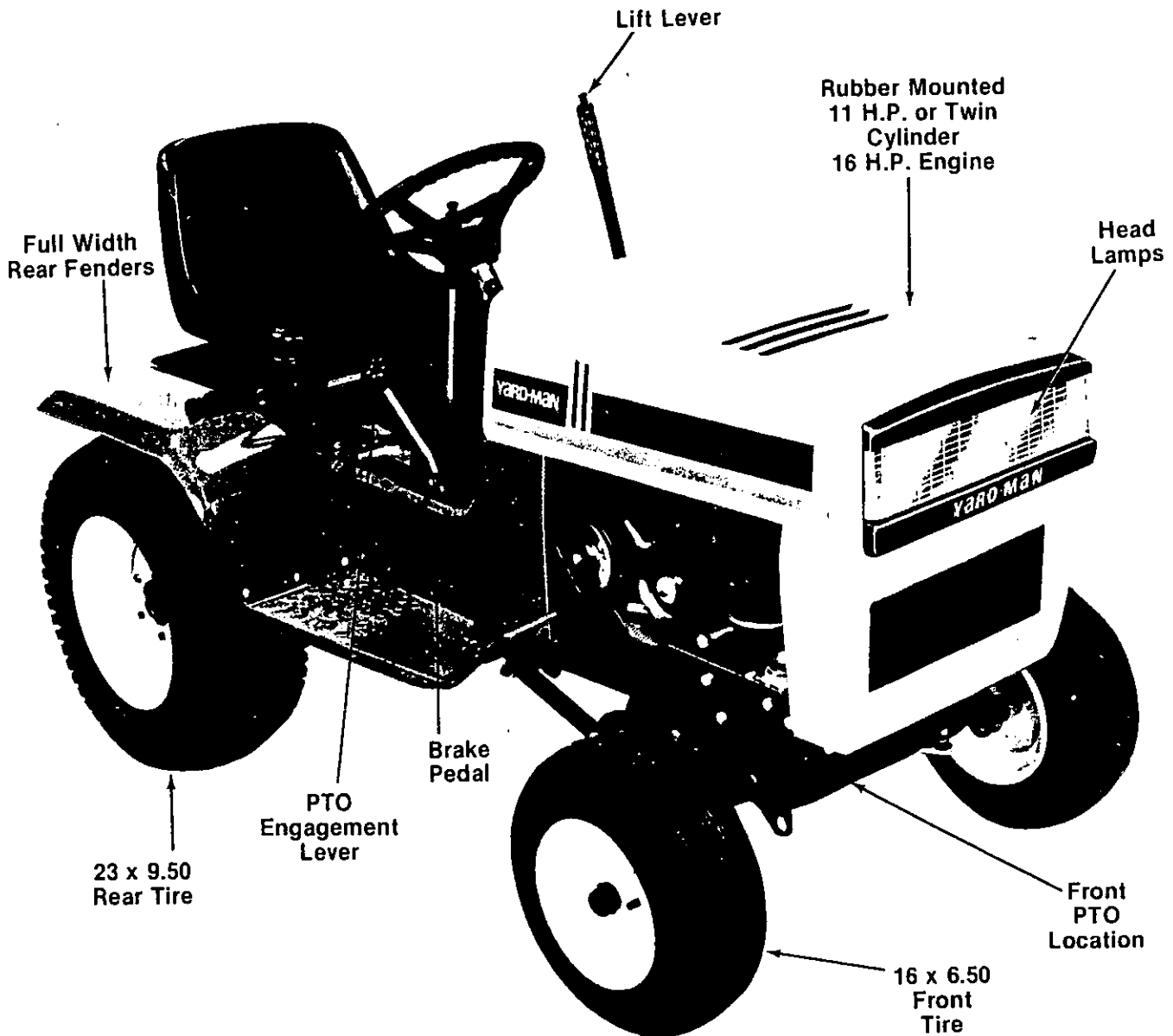

ACCESSORIES

42 inch mowing deck—19957-0.

50 inch mowing deck—19958-0.

Three point hitch kit—19951-0. Necessary when using any of the rear mounted attachments such as the 12" mold board plow, spring tooth cultivator, tandem disc harrow or rotary tiller.

Power take off kit—19952-0. Necessary when using the 48" snow thrower or the rotary tiller.

12 inch mold board plow—19920-0. Requires three point hitch kit 19951-0.

Tandem disc harrow—19921-0. Requires three point hitch kit 19951-0.

Spring tooth cultivator—19922-0. Requires three point hitch kit 19951-0.

54 inch snow blade—19954-0*.

48 inch snow thrower—19955-0*. Requires power take off kit 19952-0.

Rotary tiller—19956-0. Requires three point hitch kit 19951-0 and power take off kit 19952-0.*

*No special mounting kit required if you have a 42" or 50" mowing deck. If you do not have either deck you must have a 19953-0 linkage kit to attach your 48" snow thrower, 54" snow blade and rotary tiller.

ASSEMBLY

TIRE PRESSURE

FOR SHIPPING PURPOSES, THE TIRES ON YOUR UNIT MAY BE OVER-INFLATED. TIRE PRESSURE SHOULD BE REDUCED BEFORE UNIT IS PUT INTO OPERATION. PRESSURE SHOULD BE APPROXIMATELY 15 P.S.I. EQUAL TIRE PRESSURE SHOULD BE MAINTAINED ON ALL TIRES. MAXIMUM TIRE PRESSURE IS 30 P.S.I.

BATTERY

The following information must be read before activating and installing the battery in the tractor.



- A. Battery acid must be handled with great care as it will blister the skin and damage clothing. It is advisable to wear goggles, rubber gloves, and a protective apron when working with it.
- B. Neutralize acid spilled on clothing with dilute ammonia water or a water solution of baking soda. If acid gets on clothes, dilute it with clean water first, then neutralize.
- C. If for any reason acid should be splattered in the eyes, wash it out immediately with clean cold water. Seek medical aid if discomfort continues.
- D. Since battery acid is corrosive to metals, do not pour into any sink or drain. Rinse empty electrolyte containers and mutilate before discarding.



BATTERIES CONTAIN SULFURIC ACID AND MAY CONTAIN EXPLOSIVE GASES (when electrolyte has been added)

- A. Keep sparks, flame, cigarettes away.
- B. Hydrogen gas is generated during charging and discharging.
- C. Ventilate when charging or using in enclosed space.
- D. When using a charger—to avoid sparks, NEVER connect or disconnect charger clips to battery while charger is turned on.
- E. Always shield eyes, protect skin and clothing when working near batteries.

A. ACTIVATING THE BATTERY

1. Place battery to be filled on bench or workbench. NEVER activate battery in unit. Remove vent caps from all cells.
2. Fill each cell carefully using battery grade 1.250-1.265 specific gravity, sulfuric acid to be 3/8" above the top of the separators or to the split ring.
3. Allow battery to set for 20 minutes to 1/2 hour. Add additional acid if necessary to bring it up to the proper level.
4. Replace the vent caps.
5. The battery can now be charged after the 20 minutes setting period. Battery must be SLOW CHARGED (DO NOT FAST CHARGE) at a maximum bench rate of 4-5 amperes until the specific gravity reading is 1.265-1.275. A charging rate in excess of this will buckle and warp the positive plates and perforate the separators. If electrolyte bubbles violently while charging, reduce charging rate until excessive bubbling action subsides, then continue charging until specific gravity is reached.



CAUTION

After battery has been in service, add only approved water. DO NOT ADD ACID.

B. INSTALL BATTERY

1. Place the battery in the battery case with the terminals to the rear. (See figure 1.)
2. Attach the positive cable (from the starter solenoid) and the small wire (from the circuit breaker) to the positive battery terminal (+) with the 1/4" bolt, lockwasher and nut.
3. Attach the negative cable (grounded) to the negative battery terminal (-) with the 1/4" bolt, lockwasher and nut.
4. Hook the hold down rods through the holes in the battery case and place the hold down over the manifold of the battery and the two hold down rods. (See figure 2.)
5. Secure the hold down with the two wing nuts. Hand tighten only.

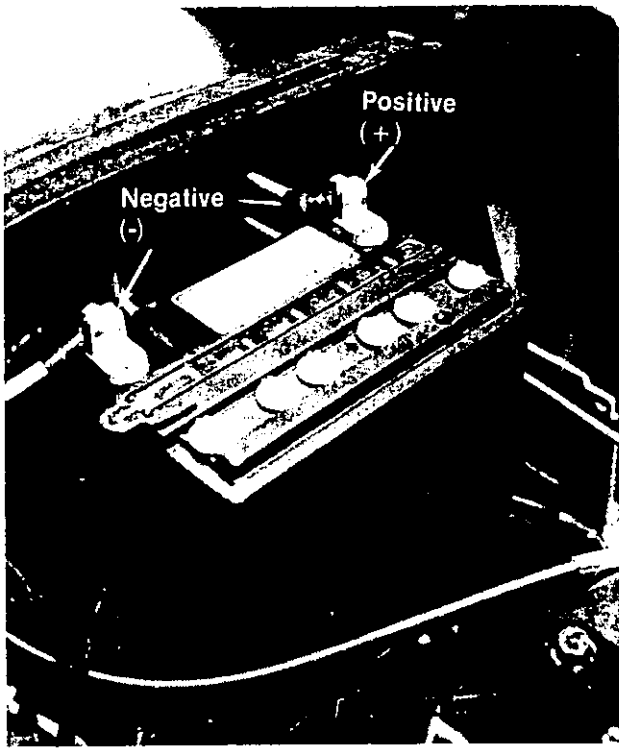

FIGURE 1.

6. Cut the rubber tubing from the battery manifold about 8 inches long.

7. Place the cut end into the plastic drain tube.



The vented battery allows any gases or liquid from the battery to be carried to the rear of the mower through the drain tube.

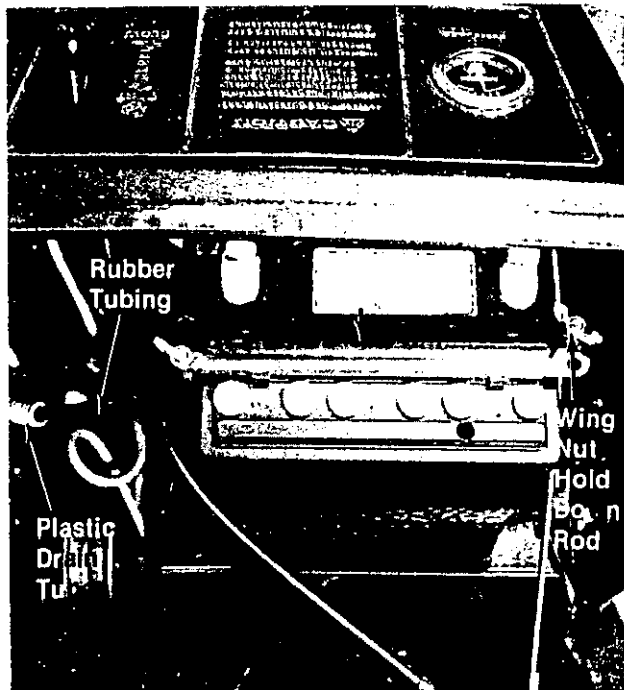

FIGURE 2.

C. OIL

Check oil level. Use approximately 2¾ pints of a high quality detergent oil classified as SC, SD or SE. Do NOT use any additives.

16 H.P. Engine Approximately 3½ pints

11 H.P. Engine Approximately 3 pints

ABOVE FREEZING USE	BELOW FREEZING USE
SAE 30	SAE 5W-20
SAE 10W-30	SAE 5W-30
SAE 10W-40	SAE 10W

CONTROLS

Throttle Control—The throttle control is located on the right side of the dashboard and is used to regulate the engine speed. The engine should be operated from ¾ to full throttle (fast) when operating any equipment that uses the tractor engine as a source of power such as the mowing deck, snow thrower or rotary tiller. See figure 3.

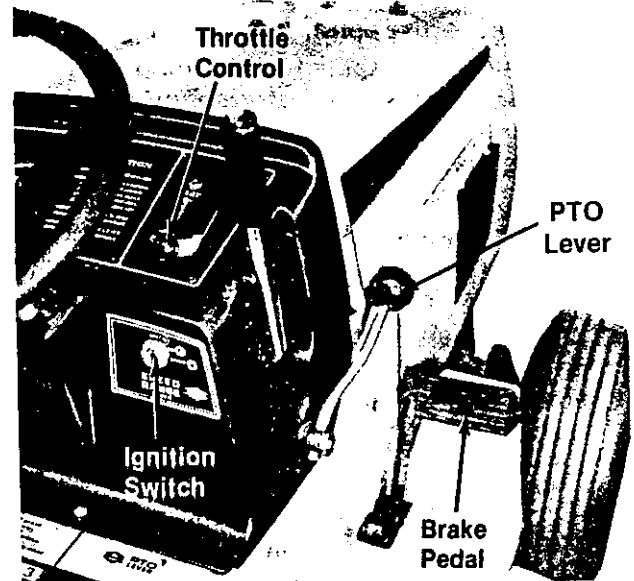

FIGURE 3.

Ignition Switch—The ignition switch is located on the right side of the dashboard. Turn the key to the START position to start the engine. When the engine is running leave the key in the ON position. To stop the engine, turn the key to the OFF position. See figure 3.



WARNING

Remove the key from the tractor when the tractor is not in use to prevent accidental starting.

Brake Pedal—The brake pedal is located on the right side of the frame. Depressing the brake pedal will engage the disc brake located on the transaxle. The clutch pedal **MUST** be depressed as well as the brake pedal to stop the tractor. See figure 3.

Ammeter—The ammeter registers the rate of battery charge. The head lamps operate directly from the engine alternator and the use of the head lamps does not register on the ammeter. The maximum charging rate for the battery is 3 amperes with the engine operating at its maximum speed. (See figure 4.)

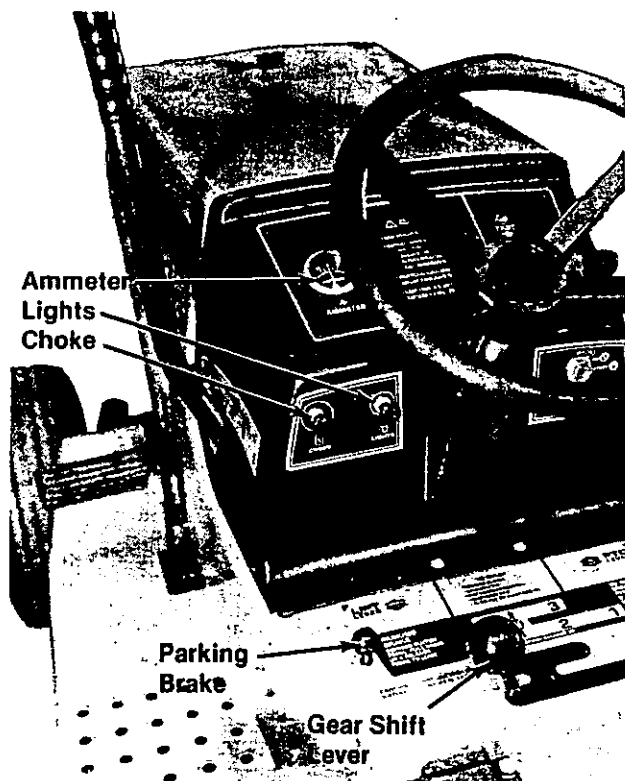

FIGURE 4.

Choke—The choke control is located on the left side of the dashboard. When starting the engine, pull the choke knob out. After the engine warms up, push the choke knob in gradually until the engine runs smoothly with the choke knob all the way in. A warm engine requires less choking. See figure 4.

Lights—The headlamps are operated by pulling out the light switch knob located on the left side of the dashboard. The headlamps will only operate when the engine is running. See figure 4.

Parking Brake—To set the parking brake, depress the clutch pedal and pull up the parking brake knob. It will stay in the raised position. To release the parking brake, depress and release the clutch pedal. See figure 4.

Gear Shift Lever—The transaxle has four forward gears, neutral and reverse. You do not shift through the gears on the transaxle as you would in an automobile. Pre-select the gear appropriate for the job you are doing. See figure 4.

You must depress the clutch pedal and come to a complete stop before shifting gears. See figure 5.

Clutch—The clutch pedal is located on the left side of the tractor. Depressing the clutch pedal disengages the clutch. The clutch pedal must be depressed when you shift the transaxle, come to a complete stop with the engine running and start the engine. See figure 5.

The clutch pedal must be depressed to engage the parking brake.

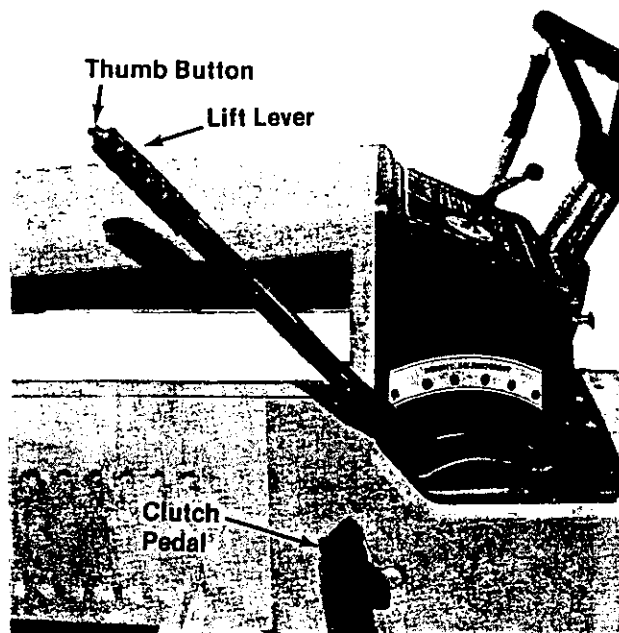

FIGURE 5.

Speed Control Selector—The speed control selector is used with the gear shift lever to obtain your 16 forward speeds.

Within each gear on the transaxle there are four positions for the speed control selector. The farther forward you move the selector, the faster you travel across the ground. To move the speed control selector depress the thumb button and move the selector in either direction. You do not have to declutch or stop the tractor, however, the tractor engine should be running. See figures 6 and 7.



Always move the speed control selector back to the low position (all the way back) when you shut off the engine.

The clutch pedal will not activate the safety switch when the speed control selector is left in the 4th or far forward position and the engine is shut off. If the engine is accidentally shut off with the speed control selector in the 4th position you must follow this procedure to restart your engine.

1. Place the gear shift lever in 4th gear.
2. Depress the clutch pedal and hold it down with steady pressure.
3. Rock the tractor back and forth until the clutch pedal moves down far enough to engage the clutch safety switch.
4. You can now restart the tractor engine.

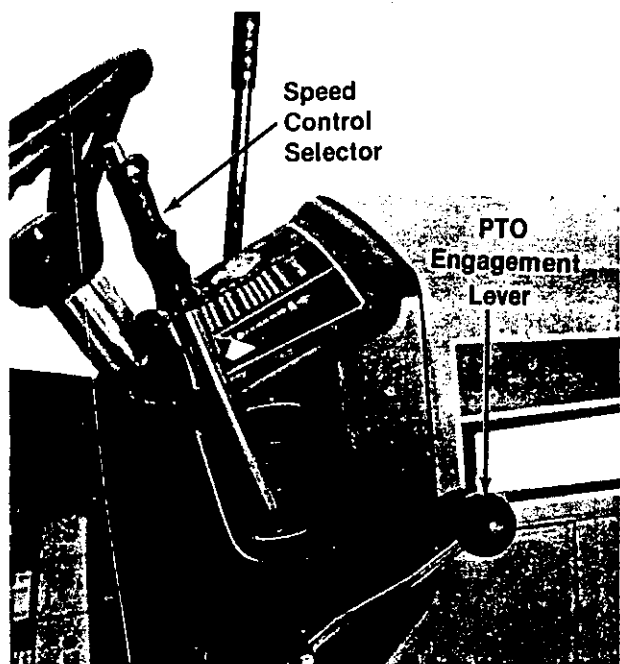

FIGURE 6.

Gasoline Tank—The gasoline tank is located under the tractor seat. Fill the gasoline tank with approximately 3 gallons of clean, fresh, lead-free or leaded "regular" grade automotive gasoline. Tip the seat forward to fill the tank. See figure 8.

Seat Adjustment—The tractor seat is adjustable to four positions. To change positions, tip the seat all the way forward and lift it out of the slots on each side. See figure 8.

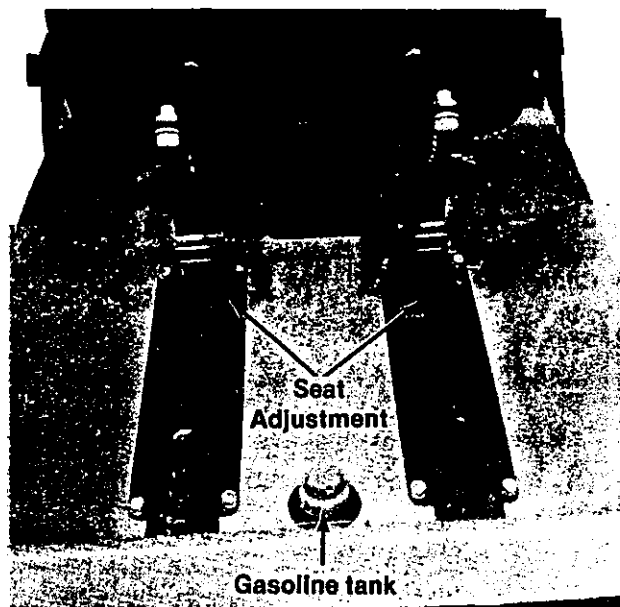

FIGURE 8.

Gear	SPEED RANGE IN M.P.H.									
	1	2	3	4	5	6	7	8	9	10
1st										
2nd										
3rd										
4th										
	All ground engaging tools Snow removing equip.			Light Snow Removal Heavy Grass Cutting		Light Grass Cutting Traveling		Level terrain traveling only.		

Lift Lever—The seven position lift lever is used to change the operating position of all the front, center and rear mounted attachments. To operate, depress the thumb button, move the lift lever to the desired position and release the button. See figure 5.

Power Take Off (PTO)—The PTO lever is located on the right side of the tractor. Moving the lever forward engages the PTO and moving it backward disengages it. Figure 3 shows the PTO lever in the engaged position.



The PTO lever engages the blades on the cutting deck and the optional PTO kit. The PTO kit is needed to operate the snow thrower attachment and rotary tiller.

The PTO lever must be in the disengaged position in order to start the engine.

Side Panels—The right and left side panels can be removed for maintenance or attaching accessories. To remove, turn the four screws in the corners a ¼ turn to the left and remove. Used on 16 H.P. only. See figure 9.



FIGURE 9.

OPERATION

CAUTION

1. KEEP ALL SHIELDS & GUARDS IN PLACE
2. BEFORE LEAVING OPERATOR'S POSITION:
 - SHIFT CONTROLS INTO NEUTRAL
 - SET PARKING BRAKE
 - DISENGAGE ATTACHMENT DRIVE
 - SHUT ENGINE OFF
 - REMOVE IGNITION KEY
3. WAIT FOR ALL MOVEMENT TO STOP BEFORE SERVICING MACHINE
4. KEEP PEOPLE & PETS A SAFE DISTANCE AWAY FROM MACHINE

CAUTION

DO NOT OPERATE MOWER UNLESS GUARD OR ENTIRE GRASS CATCHER IS IN ITS PROPER PLACE.

Starting Procedure

- A. Disengage the PTO lever. See figure 3.
- B. Depress and hold down the clutch pedal. See figure 5.
- C. Set the throttle control in the fast position. See figure 3.
- D. Pull the choke knob out. See figure 4.



A warm engine requires less chocking.

- E. Turn the ignition key clockwise to the start position. See figure 3.
- F. Release the key when the engine is running.
- G. Push the choke knob in gradually until the engine runs smoothly.
- H. With the clutch pedal still depressed (disengaged), put the gear shift lever in one of the four forward or reverse positions. See figure 4.
- I. Release the clutch pedal slowly.

LUBRICATION CHART

Steering Gears—Wipe off old grease and dirt. After every 25 hours of operation place an automotive multi-purpose grease in the teeth of the segment and pinion gears.

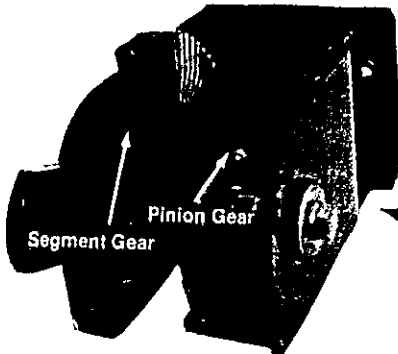

Transaxle—Check oil level four times a year. Lubricant should be at the point of overflowing. Use SAE E.P. 90 oil. Drain and refill every two years. Capacity 4 pints.

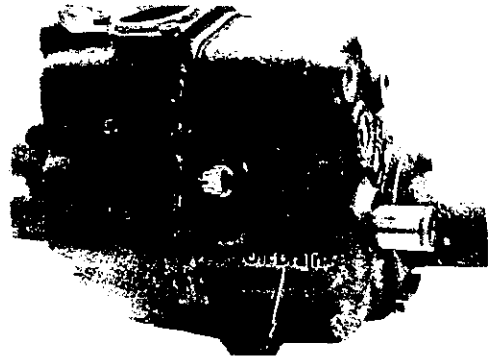

King Pins—(One on each side of the tractor.) Lubricate with a grease gun after every 25 hours of operation. Use automotive multi-purpose grease.

PTO Engagement Lever—Lubricate with a grease gun after every 25 hours of operation. Use an automotive multi-purpose grease.

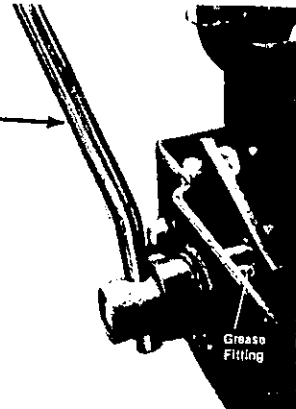
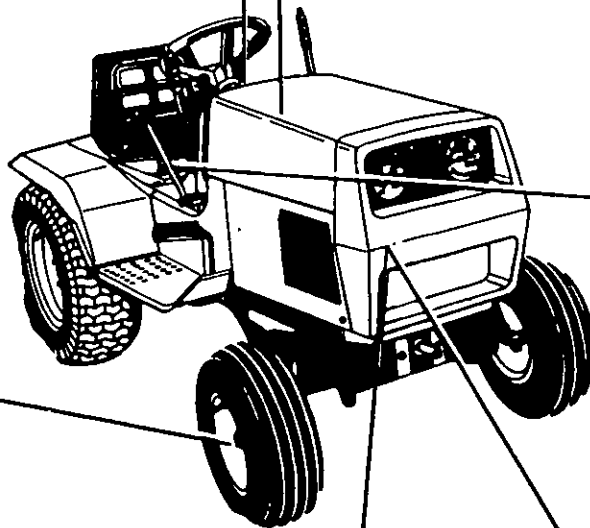

Oil Level—Maintain oil between ADD and FULL marks on dipstick. Check after each 5 hours of operation.

Oil Drain—Change oil after the first 5 hours of operation and every 25 hours thereafter. Remove plug and drain oil while engine is warm.

Fill engine with detergent oil classified as SC, SD or SE. 16 H.P. capacity 3½ pints, 11 H.P. capacity 3 pints.

ABOVE FREEZING USE

- SAE 30
- SAE 10W 30
- SAE 10W 40

BELOW FREEZING USE

- SAE 5W 20
- SAE 5W 30
- SAE 10W

Note: Engine shown is 16 H.P. On the 11 H.P. engine the oil drains through the frame with an elbow.

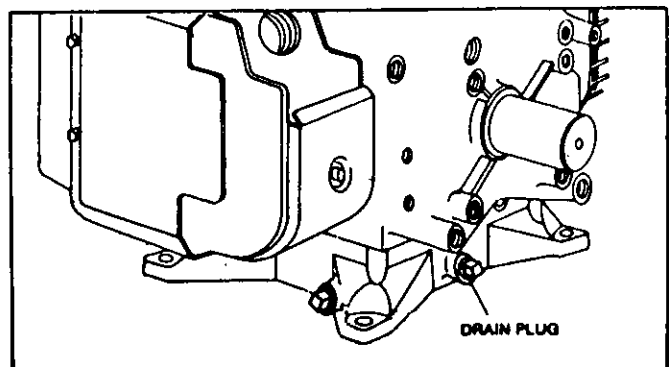
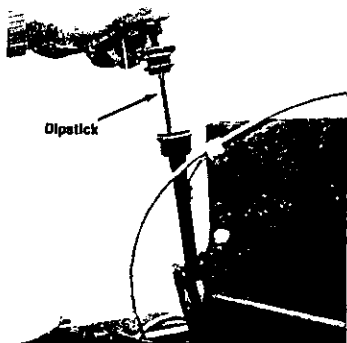

FIGURE 10.

LUBRICATION

The following friction points require NO LUBRICATION.

1. Front wheel bearings
2. Tie rod ends
3. Drag link ends
4. Steering column bearings

Throttle and Choke Cables

If the throttle or choke cable works stiff, lubricate the entire length of the cable with a penetrating silicone type spray or wipe the cable with an oiled rag.

Lubricate all pivot points on the clutch and brake linkage and lift mechanism with SAE 30 oil once a season. A small hydraulic oiler will make this easier.

ADJUSTMENTS

ADJUSTING THE BRAKE CLUTCH ROD

If one of the V-belts on the variable speed drive slips while the speed control selector is in its lowest position or you do not reach the maximum speed with the speed control selector in the highest position, the brake clutch rod may need adjustment. Once correctly set it will require no further adjustment.

1. With the engine running, move the speed control selector into the lowest position (all the way back).
2. Depress the clutch pedal and release it.
3. Check to see if the V-belt from the engine to the variable speed pull is within 1/16" of being flush to the edge of the variable speed pulley. If the V-belt is too low in the variable speed pulley, work it by hand until it is as shown in figure 11.



NOTE

The photograph in figure 11 was taken from the top for clarity. The variable speed pulley can be reached from under the tractor.

4. Tighten the nut on the brake clutch rod located next to the steering column until it just touches the ferrule. See figure 12.

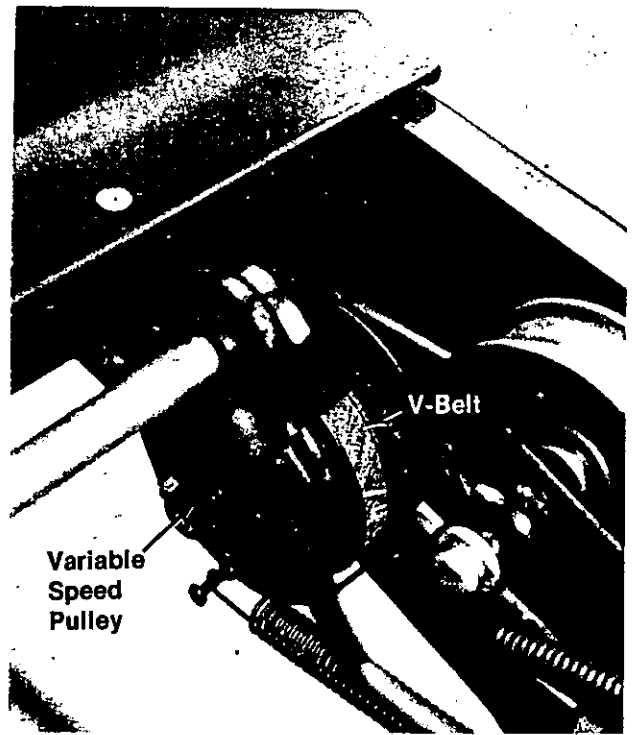

FIGURE 11.

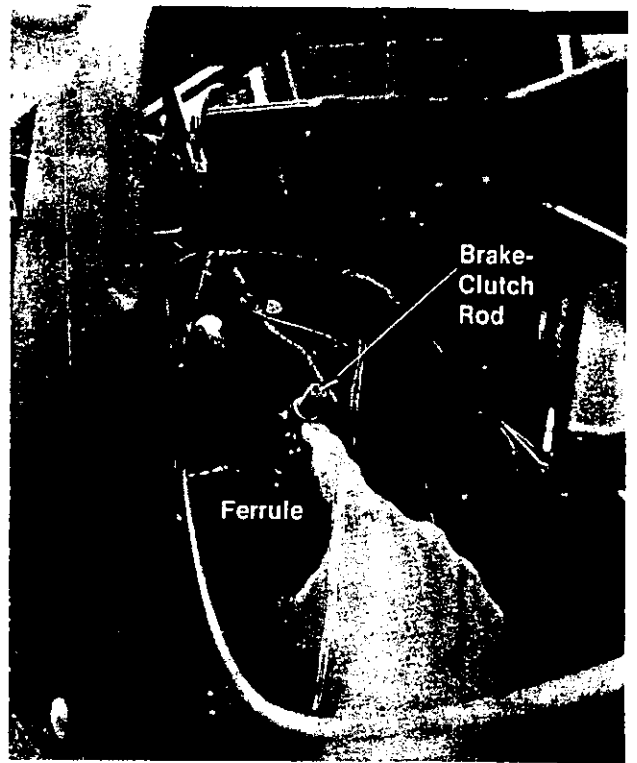

FIGURE 12.

CHANGING V-BELTS FROM THE ENGINE TO THE TRANSAXLE

1. Remove and ground the spark plug wire.
2. Depress the clutch brake pedal and set the parking brake.

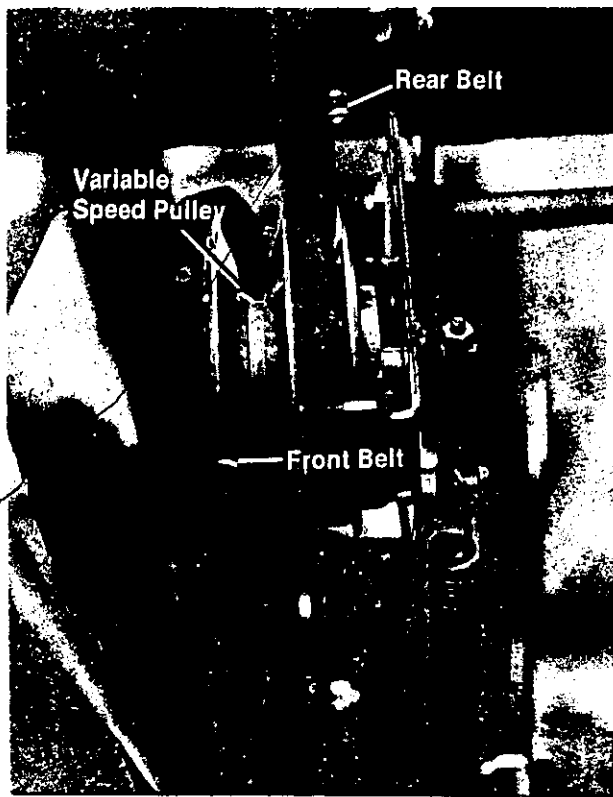

FIGURE 13.

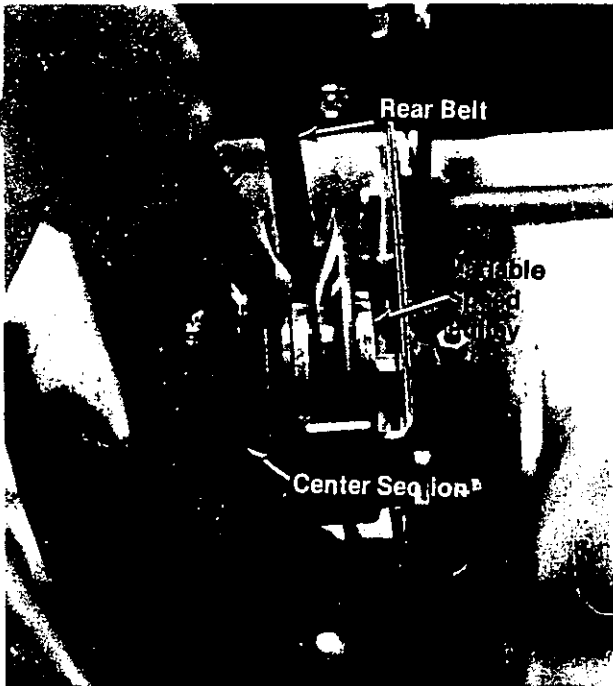

FIGURE 14.

3. Remove the PTO belt from the engine pulley.
4. Remove the bolt, lockwasher and flat washer holding the pulley to the engine crankshaft.
5. Slide off the engine pulley and remove the front belt from the pulley.

6. Put the speed control selector in the far forward position.
7. Unhook the rear belt from the variable speed pulley. See figure 13.
8. Move the speed control selector all the way back into the low position. This will give you more room to work.
9. Slide the center section of the variable speed pulley towards the right side of the tractor and remove the front belt. See figure 14.
10. Remove rear belt from the idlers and transaxle pulley. See figure 15.

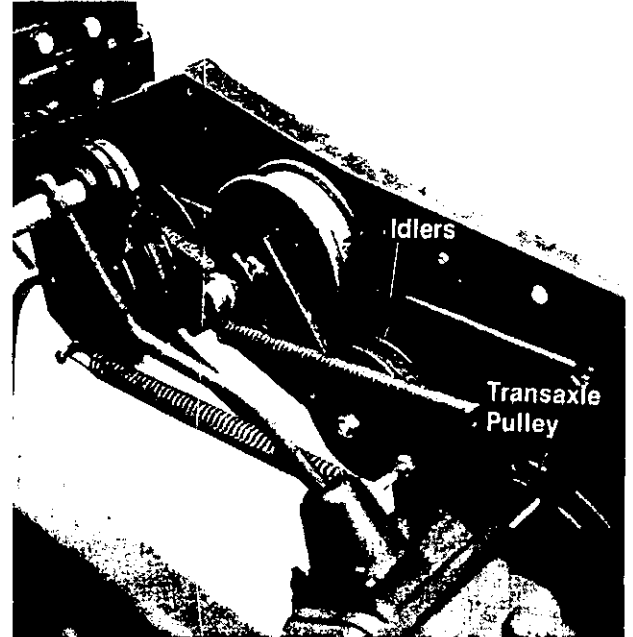

FIGURE 15.

BRAKE ADJUSTMENT

The clutch brake pedal must be in the released position when you adjust the brake.



Be sure to block the wheels of the tractor before making the brake adjustment.

1. Remove the cotter pin in the castle nut on the disc brake.



The disc brake is located on the left side of the tractor on the transaxle.

2. Tighten (turn clockwise) the castle nut until it stops. See figure 16.
3. Loosen (turn counterclockwise) the castle nut one complete turn.
4. Install a new cotter pin.
5. Remove the blocks from the wheels.

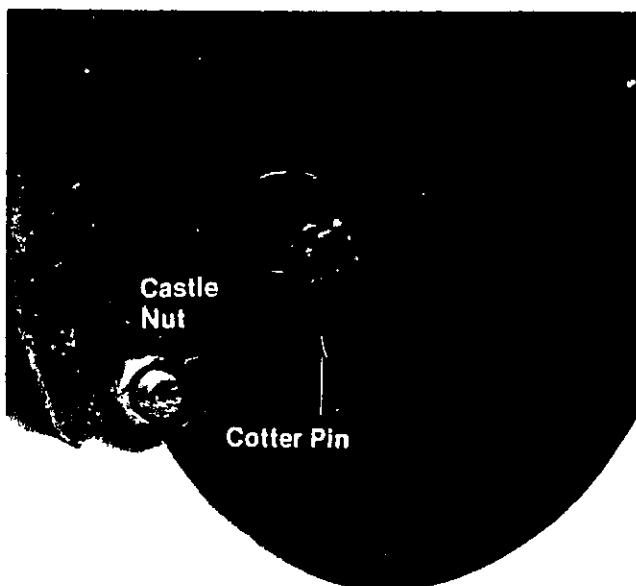

FIGURE 16.

WHEEL ALIGNMENT

Measure the distances A and B on the front wheels (See figure 17.)

Dimension B should be approximately 1/8 inch less than dimension A.

To adjust the toe-in, loosen the hex jam nut, remove the elastic locknut, lift the tie rod end out of the hole in the steering arm and screw the tie rod end in or out as necessary. (See figure 18.)

Reassemble the tie rod end after the correct alignment is made.

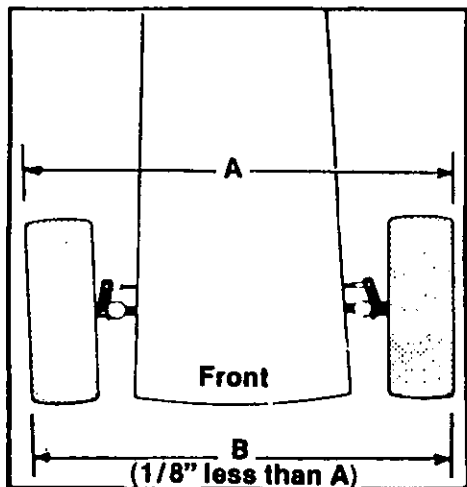

FIGURE 17.

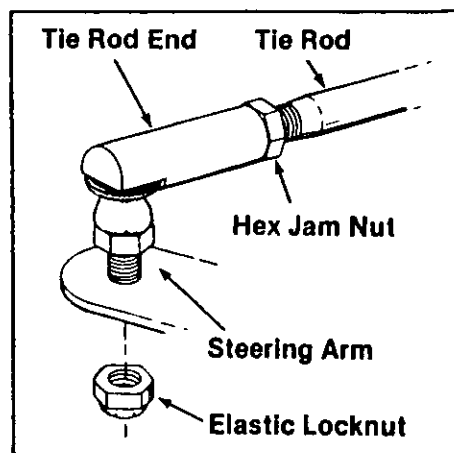

FIGURE 18.

Drag Link

The adjusted length of the drag link from the steering gear to the left front axle bracket should not be changed if either the drag link or ball joints are replaced.

To take off the drag link, remove the nuts and lockwashers holding the ball joints to the steering gear and left front axle bracket. Measure the overall length and adjust the replacement parts to the same length and install to the tractor.

BATTERY REMOVAL

Whenever a battery is installed in a tractor, attach the positive cable first and then the negative (ground) cable.

When removing the battery, always disconnect the negative (ground) cable first.

BATTERY CARE AND HANDLING.

The use of distilled water is recommended, however, you may use drinking water unless it has a high mineral content.

During freezing weather do not add water to the battery unless the tractor is going to be operated for a sufficient time to properly charge the battery.

Maintain the fluid level in the battery to the level indicated on the top of the battery. Keep the terminal clean and coated with grease.

BATTERY STORAGE

If your tractor is not to be used during an off season, the battery can be left in the tractor, however, it MUST be stored in a fully charged condition. The specific gravity must read 1.265 or higher. Use a 12 volt, DC charger with a MAXIMUM CHARGING RATE OF 4 TO 5 AMPS.



CAUTION

A discharged or partially discharged battery can freeze and crack causing extensive damage to the tractor.

During extreme cold weather, charge the battery every two months or whenever the specific gravity is less than 1.200.

Charge the battery just prior to being put back into service.

TIRE PRESSURE

The tires on your tractor have been over inflated for shipping purposes. The front and rear tires should be maintained at 15 p.s.i.



Maximum tire pressure is 30 p.s.i.

INSTALLATION OF TIRE TO RIM



The following procedure must be followed when removing or installing a tire to the rim.

1. Lubricate the tire beads and rim flanges.
2. Do not exceed 30 p.s.i. when seating beads.
3. Adjust to recommended pressure after beads are sealed.

FUEL SHUT-OFF VALVE AND FILTER

The valve and filter is located on the bottom of the gasoline tank. Turn the valve knob in to shut off the fuel flow. Turn the valve knob out to operate the tractor.

The entire valve can be pulled out to clean the filter. When reassembling, place the grommet into the gasoline tank first, then push the valve all the way in.



Only use factory approved parts if repairs are needed on the gasoline tank, grommet valve or gasoline line.

REAR WHEEL TRACK ADJUSTMENT

The rear wheels may be adjusted wider for more stability by reversing the wheels and rims on the hubs.

With the rear wheels in the narrow position, their outside is even with the outside of the front wheels. With the rear wheels in the wide position, their inside is even with the inside of the front wheels.

Use this chart to determine the rear wheel setting.

ATTACHMENT	MODEL NO.	WHEEL SET
42" Mowing Deck	19957-0	N
50" Mowing Deck	19958-0	W/N
12" Mold Board Plow	19920-0	W
Tandem Disc Harrow	19921-0	W
Spring Tooth Cult.	19922-0	W
54" Snow Blade	19954-0	N
48" Snow Thrower	19955-0	N
Rotary Tiller	19956-0	N

N—Narrow
W—Wide

Place a knot in the pulley notch and wind the rope around the pulley in a clockwise direction. Pull the rope with the choke closed to prime the engine. Open choke slightly and repeat operation.

After the engine warms up, open the choke gradually until engine runs smoothly with choke wide open.

PTO 19952-0

INSTALLING THE POWER TAKE OFF

1. Place the PTO assembly in back of the front axle and hook the top slotted hole on the PTO support bracket over the weld pins on the tractor. Tighten nuts finger tight. See figure 19.



NOTE

Photograph was taken with tractor engine removed for clarity.

2. Line up the holes on the bottom of the PTO support bracket with the holes in the tractor frame and attach with two 3/8 x 1" screws and belleville washers. See figure 20.
3. Tighten the upper nuts and lower screws on the PTO support bracket.

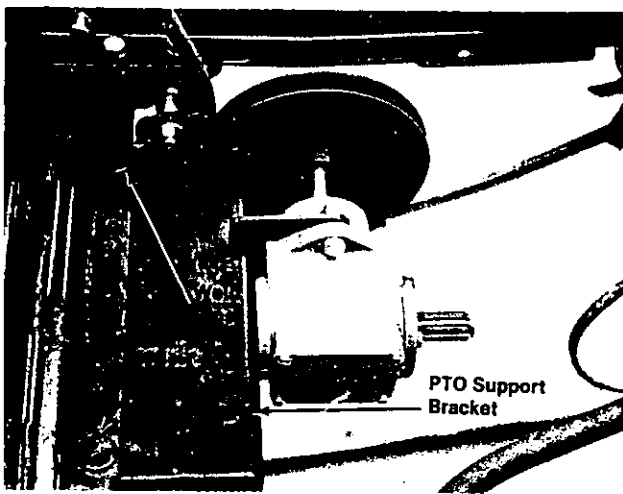

FIGURE 19.

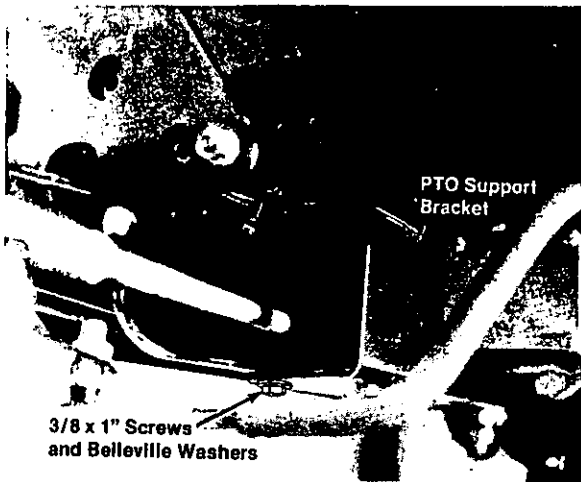

FIGURE 20.

ATTACHING THE PTO BELT

1. Unscrew the "L" handle on the PTO belt guard and pivot the PTO belt guard away from the PTO pulley. See figure 21.
2. Place the V-belt over the PTO pulley, move the belt guard back in place and tighten the "L" handle.
3. Push the belt keepers on the V-idler the direction of the arrows shown in figure 21 and rotate either direction.
4. Unscrew the "L" handle on the engine belt guard and pivot the engine belt guard away from the engine pulley.
5. Attach the V-belt over the V-idler (and under the flat idler) and over the engine pulley.
6. Turn the belt keepers into the locked position.
7. Move the engine belt guard back in place and tighten the "L" handle.

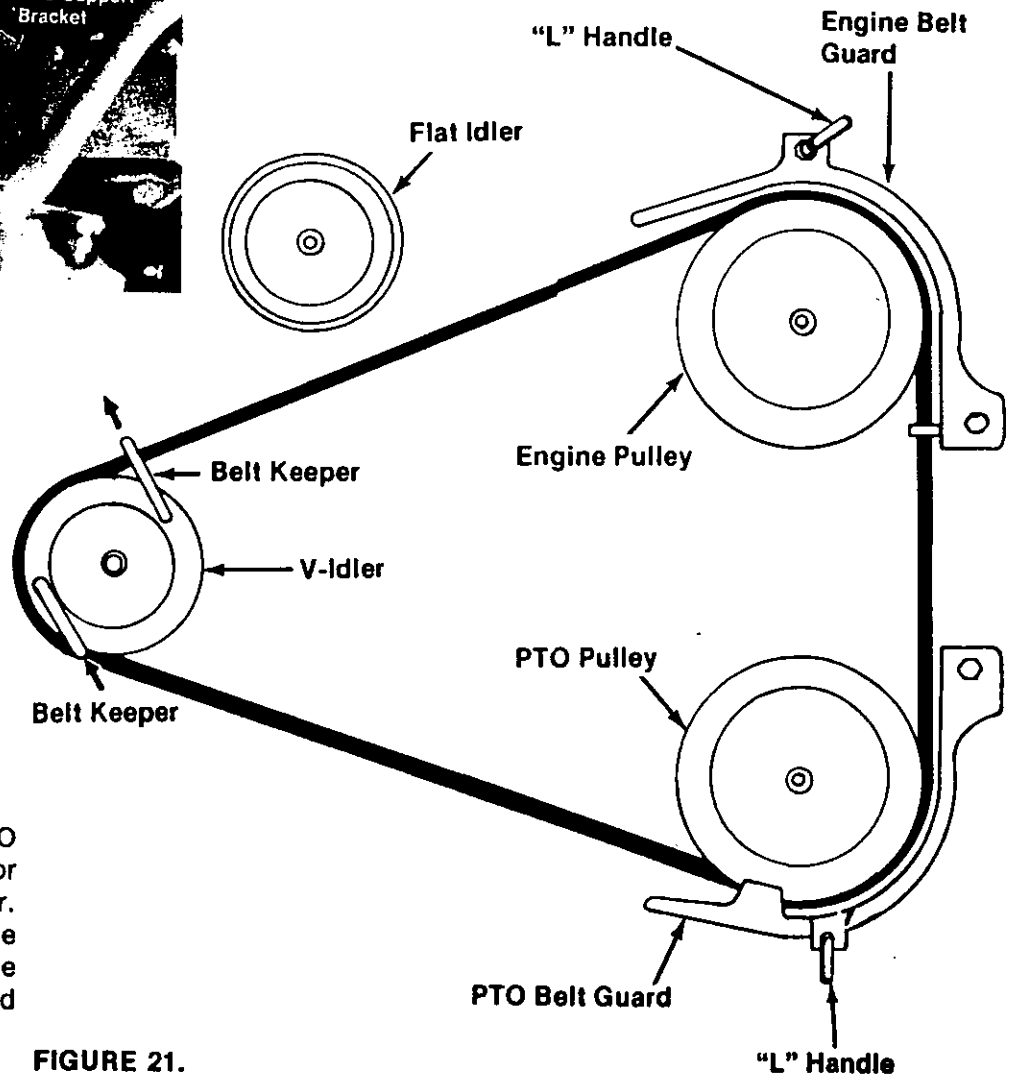

FIGURE 21.

Note: Before removing the PTO Drive Right Angle Gear Box for service, mark the front and rear. If it is assembled backwards the direction of rotation will be wrong for the rotary tiller and snow thrower.

PTO 19952-0

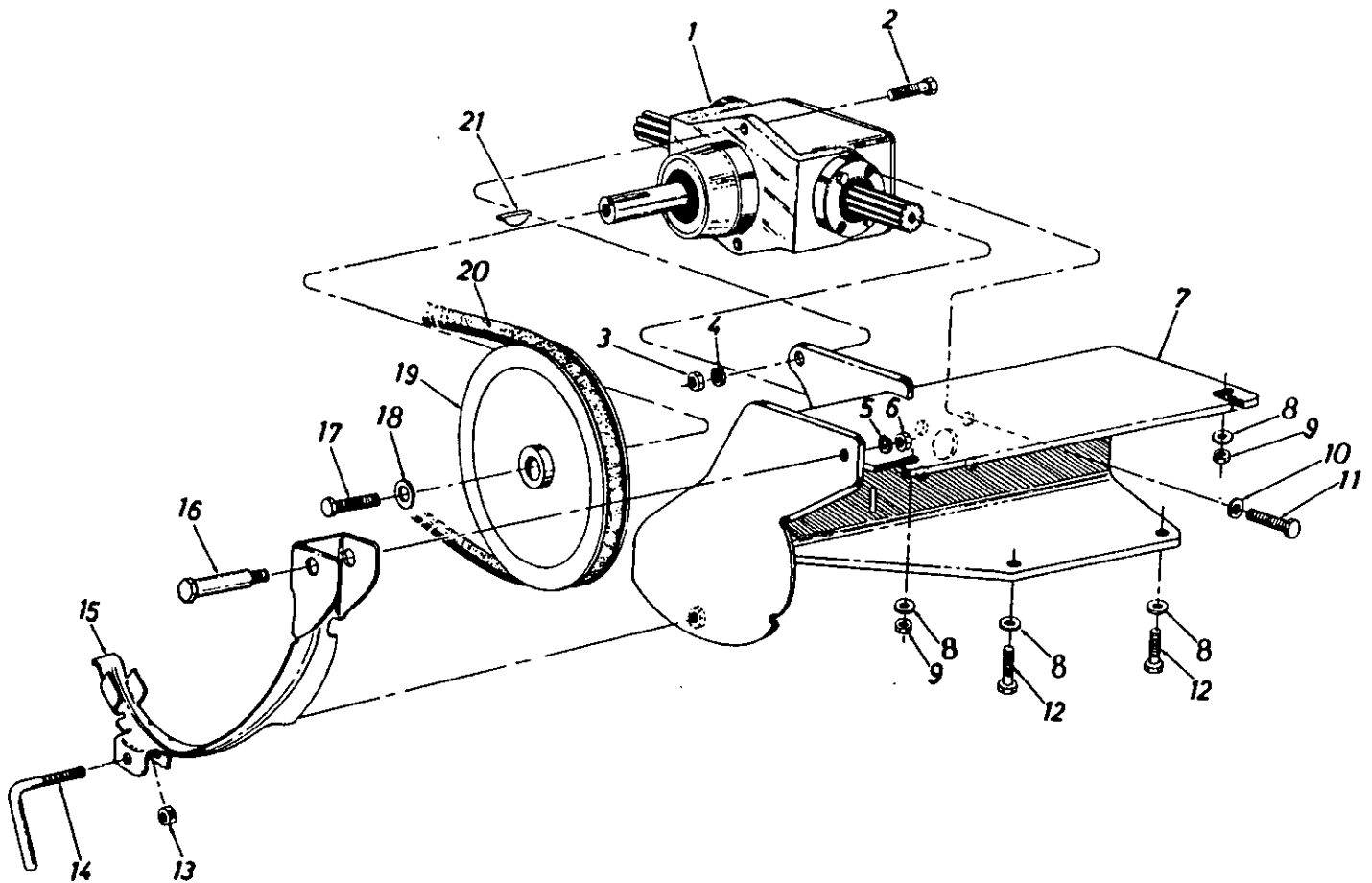
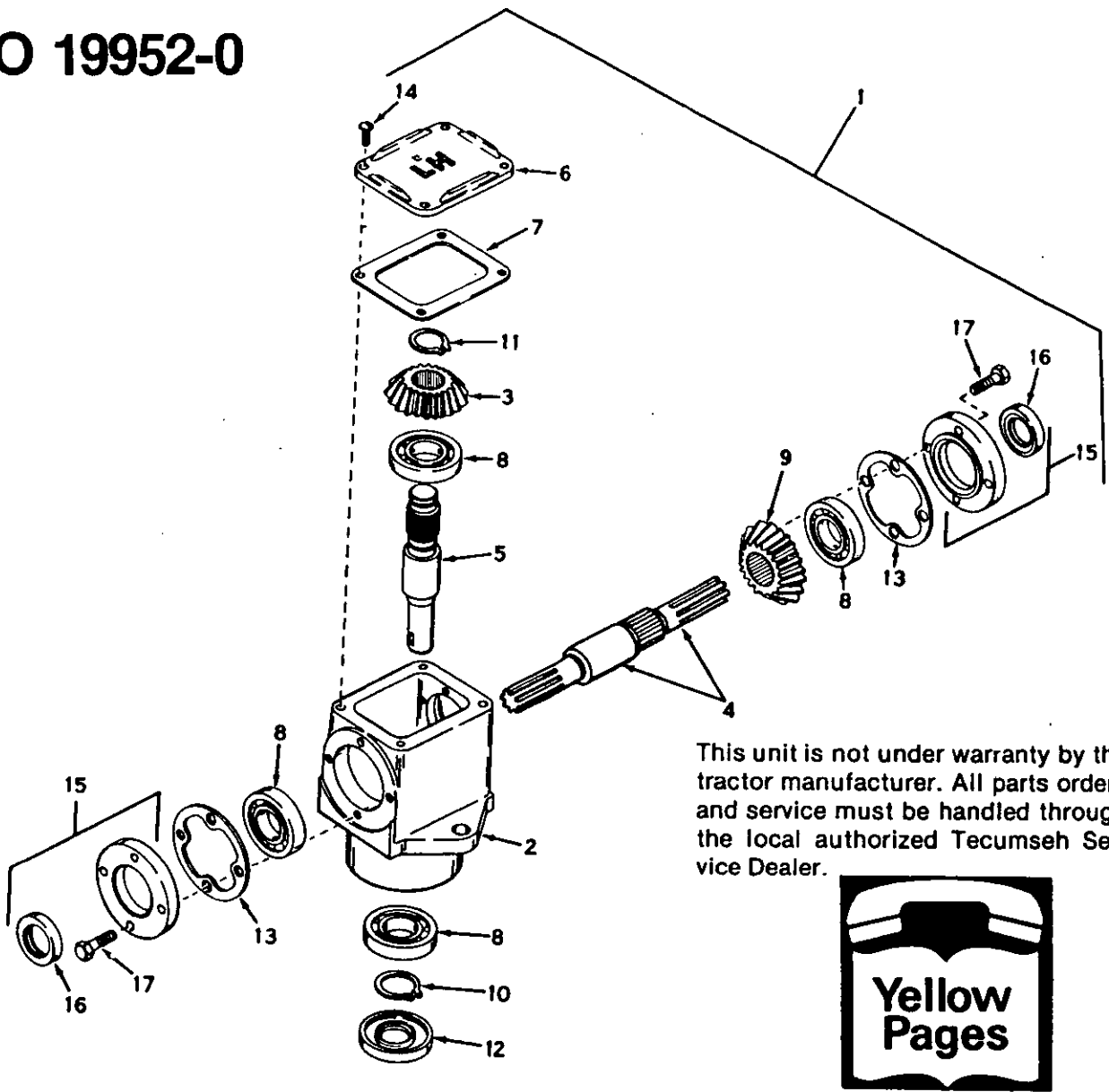

FIGURE 22.

PARTS LIST FOR FRONT P.T.O. KIT MODEL 19952-0

REF. NO.	PART NO.	DESCRIPTION	NEW PART	REF. NO.	PART NO.	DESCRIPTION	NEW PART
1	—	"T" Drive Right Angle Ass'y.		12	710-0514	Hex Scr. 3/8-16 x 1.00" Lg. Grade 5	
2	710-0514	Hex Scr. 3/8-16 x 1.00" Lg. Grade 5		13	712-0237	Hex Cent. L-Nut 5/16-24 Thd.	
3	712-0798	Hex Nut 3/8-16 Thd. *		14	747-0221	P.T.O. Locking Pin	
4	736-0169	L-Wash. 3/8" Scr. *		15	13388	P.T.O. Belt Guard	N
5	736-0169	L-Wash. 3/8" Scr. *		16	738-0146	Shld. Bolt. .50" Dia. x 1.34" Lg.	
6	712-0241	Hex Nut 3/8-24 Thd. *		17	710-0118	Hex Scr. 5/16-18 x .75" Lg. Grade 5	
7	13390	P.T.O. Support Brkt. Ass'y.	N	18	736-0242	Bell. Wash. 5/16" I.D.	
8	736-0105	Bell. Wash.		19	756-0282	P.T.O. Pulley 7.00" O.D.	
9	712-0798	Hex Nut 3/8-16 Thd. *		20	754-0229	"V"-Belt .50" x 52" Lg.	N
10	736-0498	Internal L-Wash. 1/4" I.D.		21	714-0126	#9 Hi-Pro Key 3/16 x 3/4"	
11	710-0722	Hex Scr. 1/4-20 x 1.125" Lg.					



This unit is not under warranty by the tractor manufacturer. All parts orders and service must be handled through the local authorized Tecumseh Service Dealer.



PEERLESS MODEL 3282-P91

Check the Yellow Pages of your telephone directory under "Engines—Gasoline."

"T" DRIVE HEAD MODEL NO. 3282-P91, SERVICE NO. 794210

REF. NO.	PART NO.	DESCRIPTION	REF. NO.	PART NO.	DESCRIPTION
1	PE-794210	Head Ass'y., T Drive (Includes 2 to 15)	10	PE-788019	Ring, Snap
2	PE-770047	Housing T Drive	11	PE-788018	Ring, Snap
3	PE-778046	Gear, Miter	12	PE-788029	Seal, Oil
4	PE-776179	Shaft, Input	13	PE-788030	Gasket, Cap
5	PE-776178	Shaft, Output	14	PE-792025	Scr., Rd. Hd. Self Tap. 10-24 x 1/2
6	PE-772035	Cover	15	PE-786029	Cap and Seal Ass'y. (Incl. 16 and 17)
7	PE-788028	Gasket, Cover	16	PE-788031	Seal, Oil
8	PE-780034	Bearing, Ball	17	PE-792026	Scr., Hex Hd. 1/4-20 x 7/8
9	PE-778069	Gear, Miter			

THREE POINT HITCH 19951-0 (Optional)

INSTALLING THE THREE POINT HITCH

The optional three point hitch is needed for the rotary tiller, disc, cultivator and mold board plow. If you are using the mowing deck, disc, snow thrower or snow blade, it is not necessary to install a three point hitch.

1. Attach the ferrule to the upper arms using the cotter hairpins. See figure 19.
2. Screw the lift rod into the ferrule.
3. Attach the right draft bar to the side of the frame with a cotter hairpin. See figures 19 and 20 to determine which draft bar goes on the right side.
4. Line up the hole in the draft bar with the clevis end of the lift rod and push the clevis pin through both parts. Secure with a cotter hairpin.
5. Repeat the above steps with the left draft bar.
6. Screw the two halves of the center arm together and attach one end to any hole in the center mounting bracket with a clevis pin and a cotter hairpin. See figure 20.

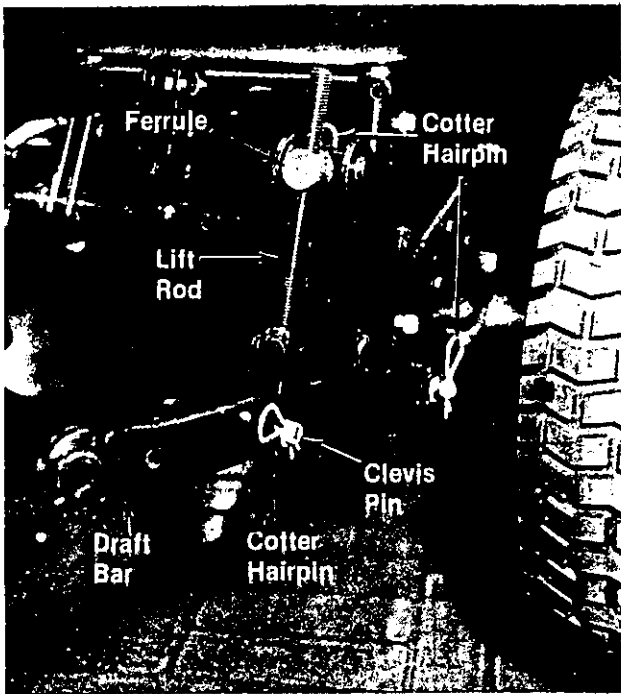

FIGURE 24.

7. Screw one hex nut all the way on to each of the hook bolts.

8. Place a lockwasher next to the hex nut and insert the hook bolt through the inside of the draft bar. Secure using a second nut. Do not tighten. See figure 21.
9. Fasten the chains to the hooks welded on the draft bars. Cross the chains over and attach to the opposite hook bolts.



NOTE

Pull the chains to make them as tight as possible.

10. Tighten the outside nuts on the hook bolts until there is approximately one inch of play in the center of the chains.

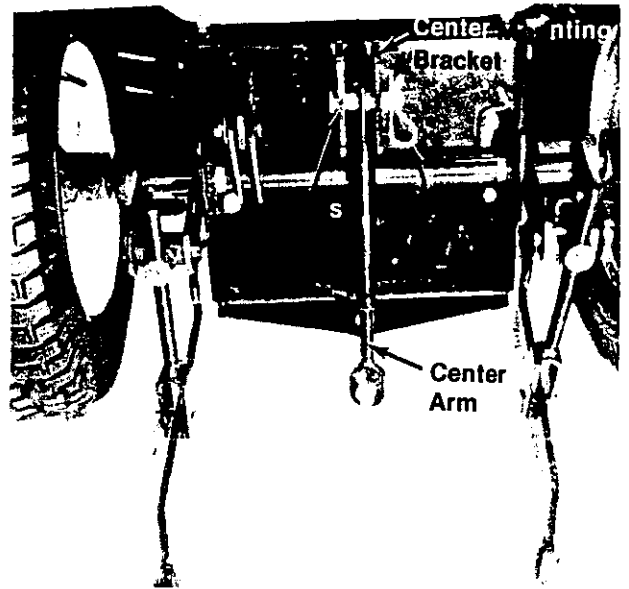

FIGURE 25.

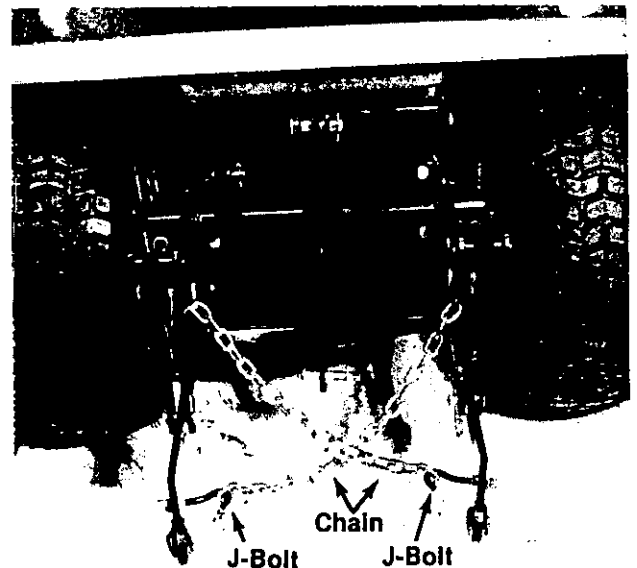

FIGURE 26.

THREE POINT HITCH 19951-0

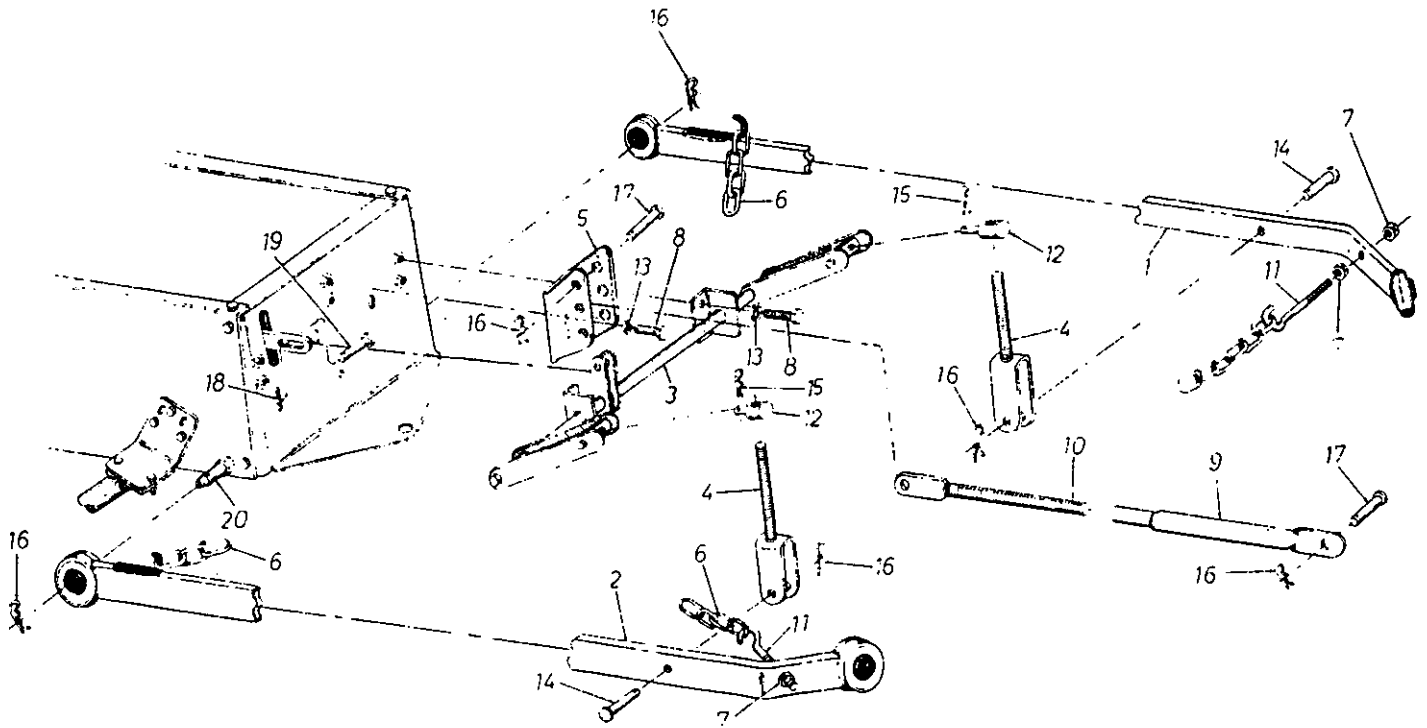

FIGURE 27.

PARTS LIST FOR THREE POINT HITCH MODEL 19951-0

REF. NO.	PART NO.	DESCRIPTION	NEW PART
1	13129	Draft Bar Ass'y. R.H.	
2	13130	Draft Bar Ass'y. L.H.	
3	13135	Rear Lift Shaft Ass'y.	
4	13138	Clevis Scr. Ass'y.	
5	13026	Hitch Brkt.	
6	713-0148	Chain 20 links	
7	712-0290	Hex Cent. L-Nut 7/16-14*	
8	710-0514	Hex Hd. Scr. Grade 5 3/8-16 x 1 Lg.*	
9	749-0238	Clevis Tubing	
10	711-0636	Clevis Screw	
11	711-0639	Hitch Chain Hook	
12	711-0649	Clevis Pin	
13	736-0217	Spring L-Wash. 3/8**	
14	711-0225	Clevis Pin 5/8 Dia. x 1.66 Lg.	
15	714-0147	Hairpin	
16	714-0117	Hairpin	
17	711-0299	Clevis Pin 5/8 Dia. x 2.4 Lg.	
18	714-0470	Cotter Pin 1/8 Dia. x 1 1/4 Lg.*	
19	711-0654	Clevis Pin	
20	711-0497	Link Clevis Pin†	

†Not part of three point hitch kit.

TROUBLE SHOOTING CHART FOR ELECTRIC START MODELS

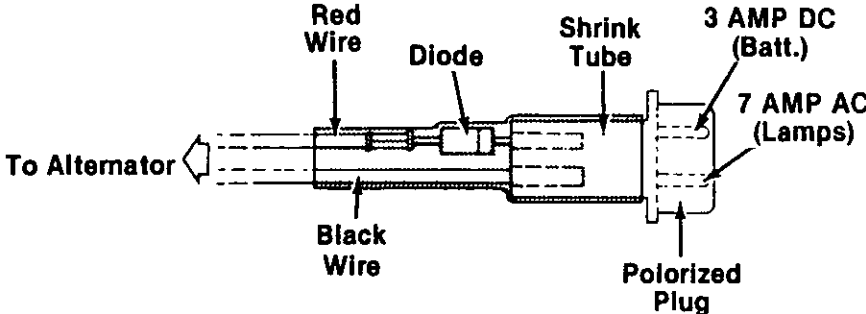
TROUBLE	LOOK FOR	REMEDY
Engine will not crank	Battery installed incorrectly	The battery must be installed with the negative, identified at the terminal post by (Neg, N or -), grounded. The positive (Pos, P or +) attaches to the large cable from the solenoid. The small red wire from the fuse holder or circuit breaker is also attached to the positive terminal.
	Blow fuse or circuit breaker	Replace fuse with 7½ amp. fuse ¼ x 1¼" lg. Circuit breaker will reset itself when it cools off. Fuses or circuit breakers seldom open or fail without a reason. The problem must be corrected. Check for loose connections in the fuse holder. Replace fuse holder if necessary. A dead short may be in the cranking or charging circuit where the insulation may have rubbed through and exposed the bare wire. Replace the wire or repair with electrician's tape if the wire strands have not been damaged. Note: Look for a wire pinched between body panels, burned by the exhaust pipe or muffler or rubbed against a moving part.
	Battery is dead or weak	<p>Use a hydrometer to check the condition of the battery. The Specific Gravity (s.g.) should be 1.265 at 80°F. (1.215 s.g. minimum needed for cranking engine). The reason for the battery failing must be determined. (1) Defective battery. Battery will not accept or hold a full charge. (2) Short circuit. Check for grounded wire. (3) Charging system not working. nator or trickle charger.</p> <p>Alternator. The charging system is an alternator located under the flywheel. It is unregulated and rated 3 amp. at 3600 r.p.m. A diode (rectifier) is located in the output lead just before the wire harness plug on the engine side.</p> <div style="text-align: center;">  </div> <p>The diode changes A.C. to D.C. to charge the battery. A bad diode can either fail to charge the battery or discharge the battery if the alternator is shorted as well as the diode. To test: (1) Disconnect charger lead from the battery (small red wire). (2) Connect 12 V small test lamp between the 3 amp. D.C. charge lead and the positive terminal of the battery. (3) With the engine off, the lamp should not light. If it does, the diode and possibly the alternator should be replaced. (4) Start the engine. The lamp should light. If it does not, the alternator (stator) or lead wire is bad and should be replaced.</p>
	Mechanical failure. (Wires and switches)	The interlock system includes two mechanical activated switches which are wired in series in the circuit used to energize the starter solenoid. While testing the interlock system, you will make the mower temporarily unsafe by permitting the engine to be started with the blade and clutch engaged. WARNING: While testing, disengage the clutch, shut off the blade control, set the parking brake and place the gear shift lever in neutral. Attach a wire (minimum 18 gauge) to the positive terminal of the battery and touch the other end to the small terminal on the solenoid. If the engine does not crank: (1) There is a loose connection or poor ground. (2) The solenoid may be bad. The solenoid can be checked by using a heavy wire (#8 gauge minimum) and jumping between the two large terminals. If the engine cranks, the solenoid is bad. (3) If the engine does not crank when you jump the solenoid, have the starter motor tested by an authorized engine dealer. If the engine does crank, the problem is with one of the safety switches, ignition switch or the wire between the fuse holder (or circuit breaker) and the small terminal on the solenoid. Note: Look for a poor connection at the switches or a defective switch. Replace if necessary.
Engine cranks but will not start	Throttle or choke not in starting position	Check owner's guide for correct position for throttle control and choke for starting.

TROUBLE SHOOTING CHART FOR ELECTRIC START MODELS

TROUBLE	LOOK FOR	REMEDY
	No spark to spark plug	Spark plug lead disconnected. Connect lead. Hold spark plug lead away from engine block about 1/8". Crank engine. There should be a spark. If not, have engine repaired at authorized engine service dealer. Faulty spark plug. To test, remove spark plug. Attach spark plug lead to spark plug. Ground the spark plug body against the engine block. Crank the engine. The spark plug should fire at the electrode. Replace if it does not.
	No fuel to the carburetor	Gasoline tank empty. Fill. Fuel valve shut off. Open valve. Valve is located either at the bottom of the fuel tank or on the carburetor. Fuel line plugged. Remove and clean.
	Air filter dirty	If the air cleaner is dirty, the engine may not start. Clean or replace as recommended by the engine manufacturer.
Engine smokes	Engine loses crankcase vacuum	Dipstick not seated or broken. Replace defective part. Engine breather defective. Replace.
Excessive vibration	Bent or damaged blade spindle	Stop engine immediately. Check all pulleys, blade spindles, blade adapters, keys and bolts for tightness and damage. Tighten or replace any damaged parts.
	Bent blade	Stop engine immediately. Replace damaged blade. Only use original equipment blades.
Mower will not discharge grass or leaves uncut strips	Engine speed low	Throttle must be set between 3/4 and full throttle.
	Transmission selection	Use lower transmission speed. The slower your ground speed, the better the quality of cut.
	Blades short or dull	Sharpen or replace blades (uncut strip problem only).

14912-0

14918-0

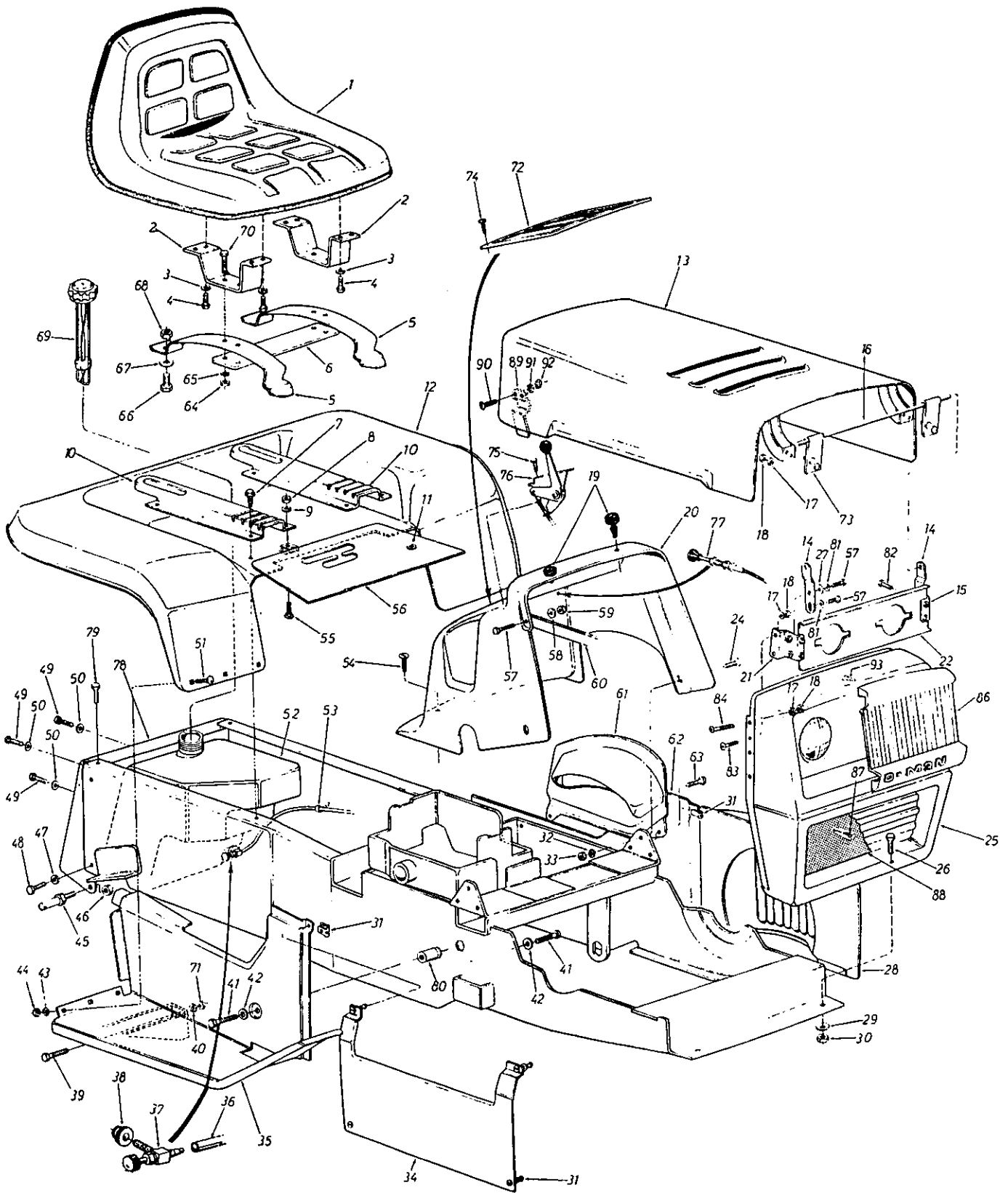

PARTS LIST FOR MODELS 14912-0 AND 14918-0

REF. NO.	PART NO.	COLOR CODE	DESCRIPTION	NEW PART	REF. NO.	PART NO.	COLOR CODE	DESCRIPTION	NEW PART
1	757-0203		Seat Ass'y. Comp.		49	710-0258		Hex Scr. 1/4-20 x .62" Lg.*	
2	13157		Seat Brkt.		50	736-0270		Bell. Wash.	
3	736-0169		L-Wash. 3/8" Scr.*		51	710-0167		Carr. Bolt 1/4-20 x .50" Lg.*	
4	710-0216		Hex Scr. 3/8-16 x .75" Lg.*		52	751-0207		Fuel Tank	
5	13123		Seat Spring		53	725-0157		Tie Strap	
6	13214		Seat Support Plate		54	710-0618		Flat Hd. Self Tap Scr. 1/4"	
7	710-0601		Hex Wash. Hd. Self Tap Scr. 5/16-24 x .75" Lg.		55	710-0260		Carr. Bolt 5/16-18 x .62" Lg.*	
8	712-0267		Hex Nut 5/16-18 Thd.*		56	13107		Transmission Cover	
9	736-0119		L-Wash. 5/16" Scr.		57	710-0252		Hex Scr. 1/4-20 x .75" Lg.*	
10	13124 —497		Seat Adjuster Brkt.		58	736-0329		L-Wash. 1/4" Scr.*	
11	731-0405		Snap Bushing		59	712-0287		Hex Nut 1/4-20 Thd.*	
12	13106 —497		Rear Fender Ass'y.		60	13152		Grille Strap	
13	13471 —312		Hood Ass'y.		61	731-0383		Instrument Panel Insert	
14	13585 —497		Hinge Rod Support		62	13103 —497		Foot Step Panel—L.H.	
15	13690 —497		Hood Support Brkt. Ass'y.—L.H.		63	710-0599		Thread Rolling Scr. 1/4"	
16	747-0231		Hinge Rod		64	712-0267		Hex Nut 5/16-18 Thd.*	
17	736-0329		L-Wash. 1/4" Scr.*		65	736-0119		L-Wash. 5/16" Scr.*	
18	712-0287		Hex Nut 1/4-20 Thd.*		66	710-0689		Nylon Scr. 1/2-13 x .75" Lg.	
19	735-0199		Rubber Bumper		67	736-0160		FI-Wash. 1/2" I.D.	
20	731-0462		Instrument Panel		68	712-0384		Hex Cent. L-Nut 1/2-13 Thd.	
21	13689 —312		Hood Support Brkt. Ass'y.— R.H.		69	751-0226		Fuel Gauge	
22	13687 —497		Head Light Retainer		70	710-0118		Hex Scr. 5/16-18 x .75" Lg.*	
23	725-0222		Head Light		71	712-0798		Hex Nut 3/8-16 Thd.*	
24	710-0255		Truss Mach. Scr. 1/4-20 x .75" Lg.*		72	731-0384		Instrument Panel Cover	
25	14042 —312		Front Grille		73	13581 —497		Hood Hinge Ass'y.	
26	710-0376		Hex Scr. 5/16-18 x 1.00" Lg.*		74	710-0697		Self Tap Black Oval Hd. Scr. 1/2" Lg.	
27	736-0211		FI-Wash. .25 I.D. x 1.25 O.D.		75	710-0721		FI-Hd. Truss Scr. #10 x .62" Lg.	
28	13394 —497		Panel Ass'y.—L.H. (14918-9)		76	746-0337		Throttle Control Ass'y. (14912-9)	
29	736-0242		Bell. Wash.			746-0335		Throttle Control Ass'y. (14918-9)	
30	712-0267		Hex Nut 5/16-18 Thd.*		77	746-0338		Choke Control Ass'y. (14912-9)	
31	726-0166		1/4 Turn Fastener Ass'y.			746-0336		Choke Control Ass'y. (14918-9)	
32	736-0329		L-Wash. 1/4" Scr.*		78	13196		Hitch Plate Ass'y.	
33	712-0287		Hex Nut 1/4-20 Thd.*		79	710-0216		Hex Scr. 3/8-16 x .75" Lg.*	
34	13393 —497		Panel—R.H. (14918-9)		80	748-0252		Lift Shaft Pivot Pin	
35	13102 —497		Foot Step Panel—R.H.		81	736-0270		Bell. Wash.	
36	731-0150		Gas Hose 3/16" I.D. x 5/16" O.D. x 72" Lg.		82	710-0294		Hex Scr. 1/4-20 x .38" Lg.*	
37	751-0171		Fuel Shut-Off Valve		83	710-0286		Truss Hd. Scr. 1/4-20 x .50" Lg.*	
38	735-0149		Rubber Bushing		84	710-0255		Truss Hd. Scr. 1/4-20 x .75" Lg.*	
39	710-0253		Hex Scr. 3/8-16 x 1.00" Lg. Grade 5		85	13196 —497		Hitch Plate Ass'y.	
40	736-0169		L-Wash. 3/8" Scr.*		86	731-0501		Head Lamp Bezel	N
41	710-0201		Hex Scr. 3/8-16 x .62" Lg.*		87	710-0432		Hex Self-Tap Scr. 10-32 x .38" Lg.	
42	736-0117		FI-Wash. .385 I.D. x .62 O.D.		88	13730		Grille Screen	
43	736-0329		L-Wash. 1/4" Scr.*		89	732-0391		Head Spring	N
44	712-0287		Hex Nut 1/4-20 Thd.*		90	710-0192		Truss Mach. Scr. 10-24 x 3/8"	
45	711-0497		Link Clevis Pin		91	736-0722		L-Wash. #10	
46	712-0923		Hex Cent. L-Nut 5/8-18 Thd.*		92	712-0121		Hex Nut 10-24 Thd.	
47	736-0169		L-Wash. 3/8" Scr.*		93	710-0200		Hex Wash. Self-Tap Scr. #8 x .50" Lg.	
48	710-0514		Hex Scr. 3/8-24 x 1.00" Lg. Grade 5						

*For faster service obtain standard nuts, bolts and washers locally. If these items cannot be obtained locally, order by part number and size as shown on parts list.

(497—Yard-Man Red)

When ordering parts, if color or finish is important use the appropriate color code shown above. (e.g. Yard-Man Red Finish—13106 (497).)

NOTE: The engine is not under warranty by the mower manufacturer . . . If repairs or service is needed on the engine, please contact your nearest authorized engine service outlet. Check the "Yellow Pages" of your telephone book under "Engines—Gasoline."



14912-0

14918-0

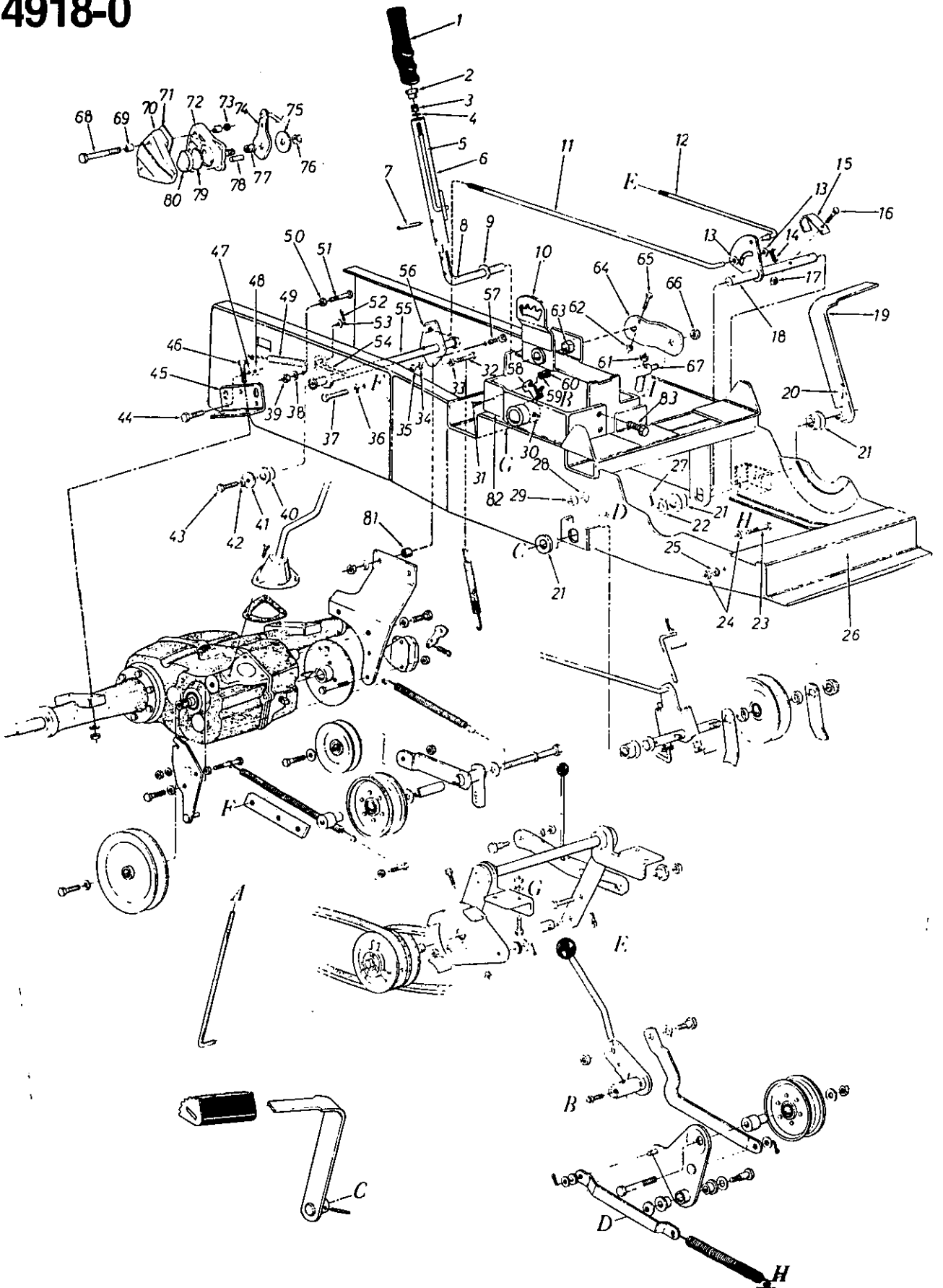

PARTS LIST FOR MODELS 14912-0 AND 14918-0

REF. NO.	PART NO.	COLOR CODE	DESCRIPTION	NEW PART	REF. NO.	PART NO.	COLOR CODE	DESCRIPTION	NEW PART
1	720-0178		Grip		41	736-0123		FI-Wash. 5/16" I.D. x 1.125" O.D.	
2	711-0642		Handle Button		42	736-0119		L-Wash. 5/16" Scr.*	
3	732-0335		Compression Spring		43	710-0538		Plastic Ms. Hex Scr. 5/16-16 x 1.50" Lg.	
4	736-0463		FI-Wash. 1/4" I.D. x 5/8" O.D.		44	710-0514		Hex Scr. 3/8-24 x 1.00" Lg. Grade 5	
5	747-0210		Control Rod		45	13066		Transaxle Support Brkt.	
6	13024		Variable Speed Handle Ass'y.		46	710-0347		Hex Scr. 3/8-16 x 1.75" Lg.*	
7	715-0247		Spring Pin Spiral 3/16" Dia. x 1" Lg.*		47	736-0217		L-Wash. 3/8" Scr. H.D.*	
8	738-0345		Pivot Shaft		48	712-0241		Hex Nut 3/8-24 Thd.*	
9	736-0156		FI-Wash. 5/8" x 1-1/8" O.D.		49	732-0121		Extension Spring	
10	13385		Variable Speed and Steering Brkt.		50	712-0138		Hex Nut 1/4-28 Thd.	
11	747-0229		Brake Rod		51	710-0698		Hex Scr. 1/4-28 x 1.50" Lg.*	
12	747-0218		Clutch Control Rod		52	714-0474		Cotter Pin 1/8" Dia. x .75" Lg.*	
13	736-0117		FI-Wash. .38 I.D. x .62" O.D.		53	736-0117		FI-Wash. .38" I.D.	
14	714-0474		Cotter Pin 1/8" Dia. x .75" Lg.*		54	13062		Brake Rod Ass'y.	
15	13160		Clutch Control Switch Plate		55	13059		Brake and Clutch Jackshaft Ferrule	
16	710-0428		Hex Scr. 1/4-28 x 1.25" Lg.*		56	711-0179		Hex Scr. 5/16-18 x 1 1/4" Lg.*	
17	712-0117		Hex Cent. L-Nut 1/4-28 Thd.		57	710-0528		Safety Switch	
18	13084		Clutch Control Brkt.		58	725-0577		L-Wash. 1/4" Scr.*	
19	13081		Foot Pedal Brkt.		59	736-0329		Hex Nut 1/4-20 Thd.*	
20	715-0114		Roll Pin 1/4" Dia. x 1.50" Lg.*		60	712-0287		Hex Jam Nut 3/8-24 Thd.	
21	741-0199		Hex Flange Brg. Plastic		61	712-0116		Hex Cent. L-Nut 1/4-28 Thd.	
22	736-0188		FI-Wash. .75" I.D. x 1.50" O.D.		62	712-0117		Flange Brg.	
23	710-0442		Hex Scr. 5/16-18 x 1.50" Lg.*		63	748-0227		Actuator Arm Ass'y.	
24	712-0267		Hex Nut 5/16-18 Thd.*		64	13036		Hex Scr. 1/4-28 x 1.25" Lg.*	
25	736-0119		L-Wash. 5/16" Scr.*		65	710-0428		Hex Cent. L-Nut 5/16-18 Thd.	
26	13392		Frame Ass'y.		66	712-0158		Ferrule Ass'y.	
27	714-0470		Cotter Pin 1/8" Dia. x 1.25" Lg.*		67	13115		Hex Scr. 3/8-16 x 3.50" Lg.	
28	736-0217		L-Wash. 3/8" Scr.*		68	710-0316		Spacer	
29	712-0214		Hex Top L-Nut 3/8-16 Thd.		69	761-0138		Casting—Carrier Side	
30	737-0146		Grease Fitting		70	HH-12-03045		Spacer	
31	710-0289		Hex Scr. 1/4-20 x .50" Lg.*		71	HH-11-03436		Casting—Cam Side	
32	710-0528		Hex Scr. 5/16-18 x 1.25" Lg.*		72	HH-12-03041		Hex Cent. L-Nut 3/8-16 Thd.	
33	712-0267		Hex Nut 5/16-18 Thd.*		73	712-0375		Cam Lever	
34	736-0119		L-Wash. 5/16" Scr.*		74	HH-18-02770		Thrust Wash. 5/16" I.D.	
35	712-0267		Hex Nut 5/16-18 Thd.*		75	HH-03-03032		Hex Nut 5/16-24 Thd.*	
36	736-0119		L-Wash. 5/16" Scr.*		76	712-0237		Compression Spring	
37	710-0216		Hex Scr. 3/8-16 x .75" Lg.*		77	HH-06-03031		Push Pin	
38	736-0329		L-Wash. 1/4" Scr.*		78	HH-05-03034		Disc—Back Up	
39	712-0138		Hex Nut 1/4-28 Thd.*		79	HH-03-03097		Pad—Friction	
40	748-0227		Bronze Bearing		80	HH-15-02533		Spacer .380 I.D. x 1" O.D. x .315	
					81	711-0242		PTO Mtg. Brkt. Ass'y.	
					82	13056		Hex Screw 5/16-18 x .75" Lg.	
					83	710-0198			

(497—Yard-Man Red)

*For faster service obtain standard nuts, bolts and washers locally. If these items cannot be obtained locally, order by part number and size as shown on parts list.

When ordering parts, if color or finish is important use the appropriate color code shown above. (e.g. Yard-Man Red Finish—13106 (497).)

14912-0
14918-0



IMPORTANT

Belts listed by Part Number are of special construction and should be used when replacement is necessary. The dimensions and description given are for general reference only and belts purchased by description and dimension generally will only provide temporary service.

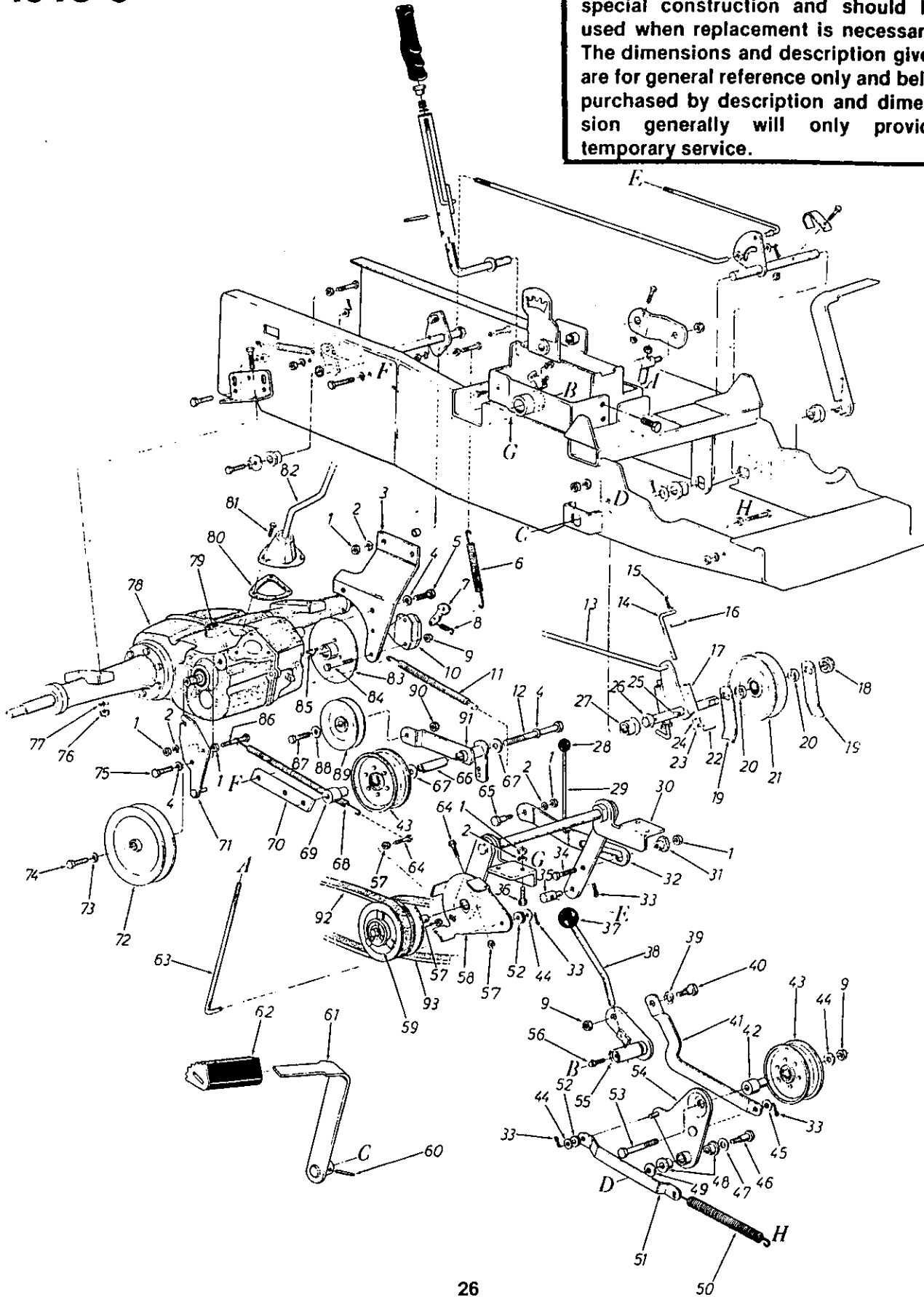

PARTS LIST FOR MODELS 14912-0 AND 14918-0

REF. NO.	PART NO.	COLOR CODE	DESCRIPTION	NEW PART	REF. NO.	PART NO.	COLOR CODE	DESCRIPTION	NEW PART
1	712-0267		Hex Nut 5/16-18 Thd.*		47	736-0100		FI-Wash. 1/2" I.D.*	
2	736-0119		L-Wash. 5/16" Scr.*		48	748-0108		Bronze Bearing	
3	13012		Transaxle Support Brkt.		49	736-0219		Bell.-Wash.	
4	736-0169		L-Wash. 3/8" Scr.*		50	732-0262		Extension Spring	
5	710-0253		Hex Scr. 3/8-16 x 1.00" Lg. Grade 5		51	13077		Spring Strap	
6	732-0260		Brake Spring		52	735-0127		Rubber Wash.	
7	HH-18-02770		Cam Lever		53	710-0427		Hex Scr. 3/8-16 x 2.00" Lg.*	
8	732-0339		Brake Return Spring		54	13074		Clutch Idler Plate	
9	712-0181		Hex Top L-Nut 3/8-16 Thd.		55	13053		Actuator Lever Ass'y.	
10	761-0137		Disc Brake Ass'y. Comp.		56	710-0599		Hex Hd. Self Tap Scr. 1/4-20 x .50" Lg.*	
11	732-0233		Brake Spring		57	712-0117		Hex Cent. L-Nut 1/4-28 Thd.	
12	710-0693		Hex Scr. 3/8-16 x 4.50" Lg.*		58	13041		Var. Speed Belt Guard Ass'y.	
13	13062		Brake Rod Ass'y.		59	717-0342		Var. Speed Pulley	
14	747-0226		Belt Guard		60	715-0114		Spring Pin Spiral 1/4" Dia. x 1.50" Lg.	
15	714-0104		Hair Pin Cotter 5/16" Dia.		61	13080		Foot Pedal Brkt. Ass'y.— R.H.	
16	715-0138		Roll Pin 1/8" Dia. x .63" Lg.*		62	735-0189		Foot Pad (Right and Left)	
17	13082		Brake Control Brkt. Ass'y.		63	747-0213		Control Rod	
18	712-0221		Hex Nut 5/8-18 Thd.*		64	710-0428		Hex Scr. 1/4-28 x 1.25" Lg. Grade 5	
19	13183		Belt Guide		65	738-0296		Shoulder Scr.	
20	750-0171		Spacer 5/8 I.D. x 7/8 O.D. x .25" Lg.		66	750-0261		Spacer Tube	
21	756-0283		V-Idler Pulley 4 1/2" O.D.		67	736-0258		FI-Wash. 3/8" I.D. x 1.00" O.D.*	
22	715-0138		Roll Pin 1/8" Dia. x .63" Lg.*		68	732-0276		Extension Spring	
23	736-0117		FI-Wash.		69	711-0656		Idler Adapter	
24	732-0334		Spring		70	13116		Idler Brkt.	
25	715-0134		Roll Pin 3/16" Dia. x 1.50" Lg.*		71	13039		Spring Brkt. Ass'y.	
26	736-0188		FI-Wash. .76 I.D. x .06		72	756-0281		Transaxle Pulley 7.00" Dia.	
27	741-0199		Flange Brg.—Plastic		73	736-0105		Bell. Wash.	
28	720-0166		Parking Brake Knob		74	710-0180		Hex Scr. 3/8-24 x .75" Lg.*	
29	747-0217		Parking Brake Rod		75	710-0253		Hex Scr. 3/8-16 x 1.00" Lg.*	
30	13045		Variable Speed Mount Ass'y.		76	712-0298		Hex Nut 3/8-16 Thd.*	
31	711-0404		Shoulder Nut		77	736-0217		L-Wash. 3/8" Scr. H.D.	
32	13108		Parking Brake Brkt.		78	—		Transaxle (See Breakdown Page 30)	
33	714-0474		Cotter Pin 1/8" Dia. x .75" Lg.*		79	722-0141		Bumper	
34	710-0322		Hex Scr. 5/16-18 x 1.00" Lg.*		80	—		Part of Transaxle	
35	711-0198		Ferrule		81	—		Part of Transaxle	
36	710-0198		Hex Sems Scr. 5/16-18 x .75" Lg.*		82	—		Part of Transaxle	
37	720-0175		Ball Knob		83	761-0142		Brake Disc Ass'y.	
38	747-0211		P.T.O. Handle		84	710-0937		Hex Scr. 3/8-16 x 2.50" Lg.*	
39	736-0232		Wave Wash. 1/2" Dia.		85	714-0137		Hi-Pro Key 3/8" x 1.06" Lg.	
40	738-0143		Shoulder Bolt		86	710-0395		Hex Scr. 5/16-18 x 2.25" Lg.*	
41	13076		Clutch Idler Link		87	710-0344		Hex Scr. 3/8-16 x 1.50" Lg.*	
42	711-0598		Idler Adapter		88	736-0267		FI-Wash. 3/8" I.D.*	
43	711-0306		FI-Idler Pulley 4-5/8" Dia.		89	756-0293		4" Dia. V-Idler	
44	736-0300		FI-Wash. 3/8" I.D.*		90	712-0375		Hex Cent. L-Nut 3/8-16 Thd.*	
45	736-0108		FI-Wash. 1/2" I.D. x 3/4" O.D.*		91	13060		Idler Arm Ass'y.	
46	738-0146		Shoulder Scr.		92	754-0212		"V"-Belt 5/8" x 45" Lg.	
					93	754-0227		"V"-Belt 5/8" x 63" Lg.	

(497—Yard-Man Red)

*For faster service obtain standard nuts, bolts and washers locally. If these items cannot be obtained locally, order by part number and size as shown on parts list.

When ordering parts, if color or finish is important use the appropriate color code shown above (e.g. Yard-Man Red Finish—13471 (497).)

14912-0
14918-0

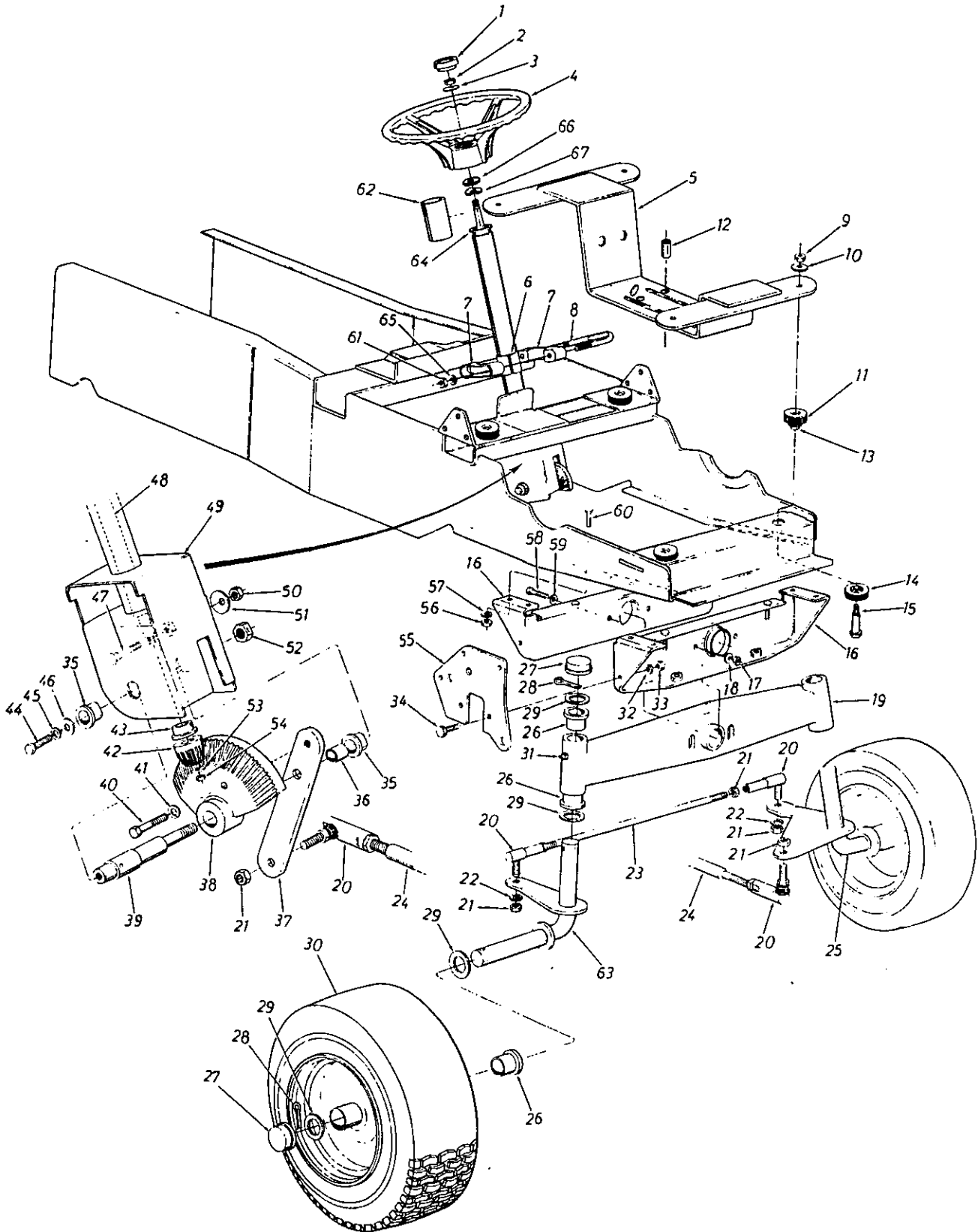

PARTS LIST FOR MODELS 14912-0 AND 14918-0

REF. NO.	PART NO.	COLOR CODE	DESCRIPTION	NEW PART	REF. NO.	PART NO.	COLOR CODE	DESCRIPTION	NEW PART
1	731-0220		Steering Wheel Cap		33	712-0798		Hex Nut 3/8-16 Thd. *	
2	712-0158		Hex Cent. L-Nut 5/16-18 Thd.		34	710-0253		Hex Scr. 3/8-16 x 1.00" Lg. *	
3	736-0270		Bell. Wash.		35	741-0199		Flange Brg.	
4	731-0356		Steering Wheel		36	750-0333		Steering Gear Shaft Spacer	
5	13490		Engine Support Ass'y. (14912-0)		37	13132		Steering Arm	
	13476		Engine Support Ass'y. (14918-0)		38	748-0238		Bevel Gear	
6	750-0344		Tube Spacer		39	738-0342		Steering Gear Shaft	
7	06627		Bearing Block		40	710-0344		Hex Scr. 3/8-16 x 1.50" Lg. *	
8	747-0101		"U"-Clamp		41	736-0169		L-Wash. 3/8" Scr. *	
9	712-0158		Hex Cent. L-Nut 5/16-18 Thd. *		42	748-0237		Pinion Gear	
10	736-0242		Bell. Wash.		43	748-0227		Flange Brg.	
11	722-0151		Engine Mount		44	710-0216		Hex Scr. 3/8-16 x .75" Lg. *	
12	711-0516		Engine Mount Spacer		45	736-0169		L-Wash. 3/8" Scr. *	
13	722-0149		Engine Mount		46	736-0133		FI-Wash. 3/8" I.D. x 1.25 O.D.	
14	722-0150		Engine Mount		47	710-0670		Nylon Hex Screw	
15	738-0413		Shld. Scr.		48	738-0343		Steering Shaft	
16	13032		Front Pivot Brkt. Ass'y.		49	13126		Steering Brk Support Ass'y.	
17	712-0375		Hex Cent. L-Nut 3/8-16 Thd.		50	712-0342		Hex Jam Nut 3/8-18 Thd.	
18	736-0219		Bell. Wash.		51	736-0219		Bell. Wash.	
19	13008		Pivot Bar Ass'y.		52	712-0200		Hex Ins. L-Nut 1/2-20 Thd.	
20	723-0179		Tie Rod End		53	736-0264		FI-Wash. .344 I.D. x .62 O.D.	
21	712-0922		Hex Nut 1/2-20 Thd. *		54	712-0237		Hex Cent. L-Nut 5/16-24 Thd.	
22	736-0921		L-Wash. 1/2" Scr. *		55	13153		Front Pivot Brkt. Reinforcement	
23	747-0214		Tie Rod		56	712-0798		Hex Nut 3/8-16 Thd. *	
24	13190		Drag Link		57	736-0169		L-Wash. 3/8" Scr. *	
25	13001		Front Axle Ass'y.—L.H.		58	710-0937		Hex Scr. 3/8-16 x 2.50" Lg. *	
26	731-0374		Plastic Flange Brg. 1.0" I.D.		59	736-0219		Bell. Wash.	
27	731-0349		Dust Cover		60	710-0253		Hex Scr. 3/8-16 x 1.00" Lg. *	
28	714-0142		Cotter Pin 3/16" Dia. x 1.50" Lg. *		61	712-0267		Hex Nut 5/16-18 Thd. *	
29	736-0259		FI-Wash. 1.0" I.D.		62	750-0362		Steering Tube Outer	
30	734-0771		Front Wheel Ass'y. Comp. 16 x 6.50		63	13002		Front Axle Ass'y.—R.H.	
	734-0787		Rim Only		64	741-0138		Ball Bearing	
	734-0526		Tire Only 16 x 6.50		65	736-0119		L-Wash. 5/16" Scr. *	
31	737-0146		Grease Fitting		66	736-0296		Double "D" FI-Wash.	
32	736-0169		L-Wash. 3/8" Scr. *		67	736-0174		Wave Wash. .660 I.D. x .88 O.D.	

(497—Yard-Man Red)

*For faster service obtain standard nuts, bolts and washers locally. If these items cannot be obtained locally, order by part number and size as shown on parts list.

When ordering parts, if color or finish is important use the appropriate color code shown above. (e.g. Yard-Man Red Finish—13106 (497).)

14912-0
14918-0

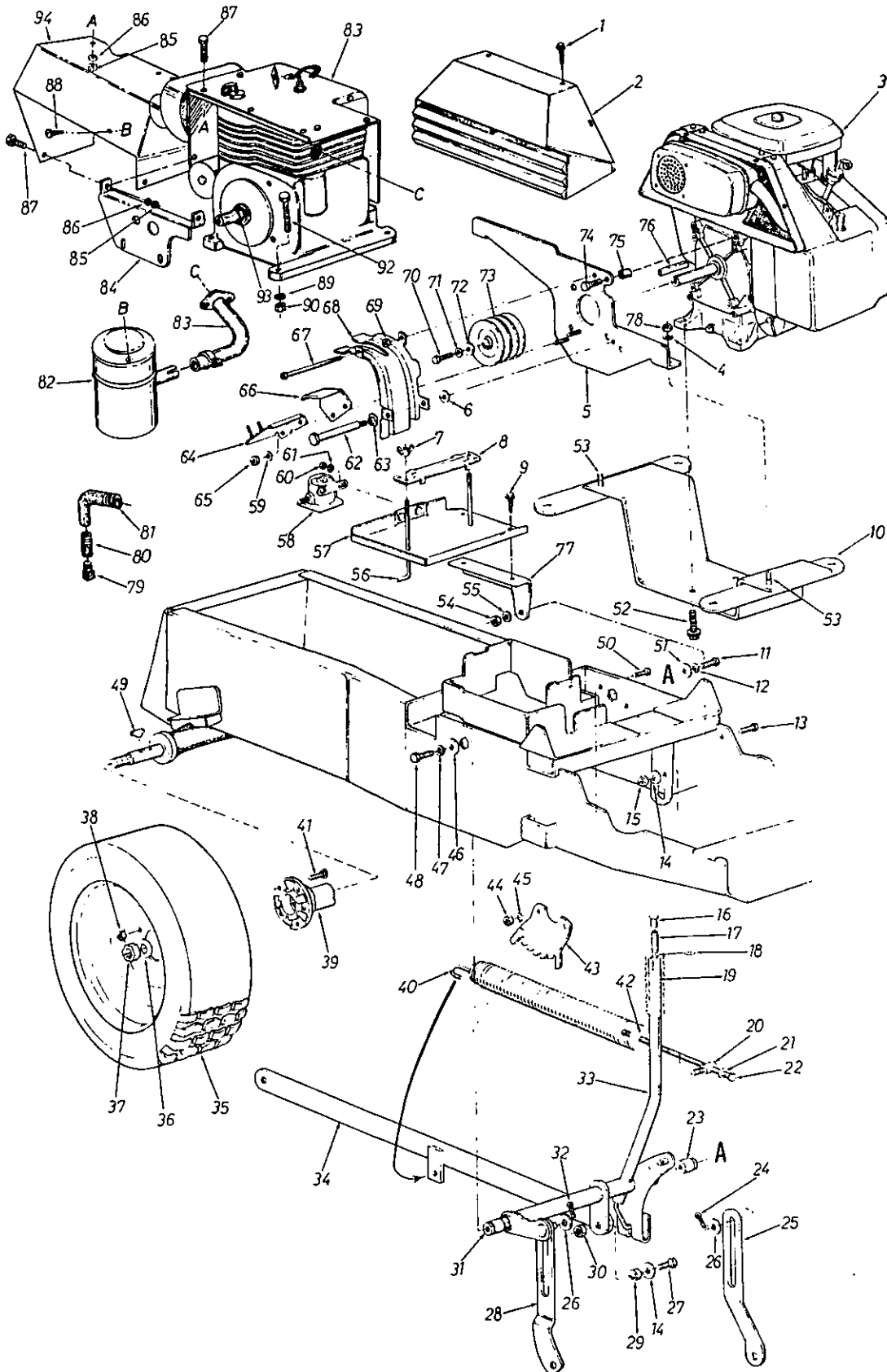

PARTS LIST FOR MODELS 14912-0 AND 14918-0

REF. NO.	PART NO.	COLOR CODE	DESCRIPTION	NEW PART	REF. NO.	PART NO.	COLOR CODE	DESCRIPTION	NEW PART	
1	710-0642		Hex Self Tap Scr. 1/4-20 x .75" Lg.		45	736-0169		L-Wash. 3/8" Scr.*		
2	13429		Exhaust Shield Ass'y. (14918-0) 16 H.P. Twin Cylinder Engine (14918-0)		46	736-0235		FI-Wash. 3/8" I.D. x 1 1/4" O.D.		
3	—					47	736-0169		L-Wash. 3/8" Scr.*	
4	736-0169			L-Wash. 3/8" Scr.*		48	710-0514		Hex Scr. 3/8-16 x 1.00" Lg.*	
5	13473		Engine Belt Guard Mount Plate Ass'y.		49	714-0146		#27 Woodruff Key		
6	736-0105		Bell. Wash.		50	710-0152		Hex Scr. 3/8-24 x 1.00" Lg.*		
7	712-0113		Wing Nut 1/4-20 Thd.		51	736-0235		FI-Wash. 3/8" I.D. x 1 1/4" O.D.		
8	12614		Battery Hold Down		52	710-0502		Hex Wash. Hd. Self Tap Scr. 3/8-16 x 1.25" Lg.		
9	710-0599		Hex Self Tap Scr. 1/4-20 x .50" Lg.		53	710-0342		Hex Scr. 3/8-16 x 1.25" Lg.*		
10	13476	—497	Engine Support Ass'y.		54	712-0267		Hex Nut 5/16-18 Thd.*		
11	710-0514		Hex Scr. 3/8-16 x 1.00" Lg.*		55	736-0119		L-Wash. 5/16" Scr.*		
12	736-0169		L-Wash. 3/8" Scr.*		56	711-0222		Battery Hold Down Rod		
13	710-0322		Hex Sems Scr. 5/16-18 x 1.00" Lg.*		57	13381		Battery Carrier Ass'y.		
14	736-0242		Bell. Wash.		58	725-0530		Solenoid		
15	712-0158		Hex Cent. L-Nut 5/16-18 Thd		59	736-0119		L-Wash. 5/16" Scr.*		
16	711-0634		Lift Handle Button		60	712-0287		Hex Nut 1/4-20 Thd.*		
17	732-0152		Compression Spring		61	736-0329		L-Wash. 1/4" Scr.		
18	736-0173		FI-Wash. 1/4" I.D. x .75" O.D.		62	738-0215		Shoulder Screw		
19	747-0212		Locking Rod		63	736-0232		Wave Wash.		
20	711-0471		Ferrule		64	13146		Engine Belt Guard Ass'y.		
21	736-0140		FI-Wash. 3/8" I.D. x 5/8" O.D.		65	712-0267		Hex Nut 5/16-18 Thd.*		
22	710-0677		Hex Scr. (Special)		66	13148		Engine Belt Guard Ass'y. (Trans.)		
23	748-0252		Lift Shaft Pivot Pin		67	747-0273		Belt Guard Scr.		
24	714-0115		Cotter Pin		68	13149		Engine Belt Guard Ass'y.		
25	13169		Deck Link—L.H.		69	712-0239		Hex Cent. L-Nut 5/16-24 Thd.		
26	736-0179		FI-Wash. 1/2" I.D. x 1 1/4" O.D.		70	710-0459		Hex Scr. 3/8-24 x 1.50" Lg. Grade 5		
27	710-0504		Hex Scr. 1/2-20 x 1.25" Lg.*		71	736-0217		L-Wash. 3/8" Scr. H.D.		
28	13168		Deck Link—R.H.		72	736-0235		FI-Wash. 3/8" Dia.		
29	750-0336		Push Bar Sleeve		73	756-0310		Engine Pulley		
30	712-0158		Hex Cent. L-Nut 5/16-18 Thd.		74	710-0694		Hex Scr. 7/16-14 x 1.50" Lg.		
31	748-0252		Lift Shaft Pivot Pin		75	711-0242		Spacer (14912-0)		
32	714-0115		Cotter Pin		76	714-0118		Sq. Key 1/4" x 1/4" x 1.50" Lg		
33	13086		Lift Shaft Weldment Ass'y.		77	13380		Battery Carrier Support Brkt.		
34	13092		Push Bar Ass'y.		78	712-0798		Hex Nut 3/8-16 Thd.*		
35	734-0786		Rear Wheel Ass'y. Comp. (14818-0)		79	737-0104		Pipe Plug (14912-0)		
	734-0785		Rim Only (14918-0)		80	737-0159		Pipe Nipple (14912-0)		
	734-0322		Tire Only 23.0 x 9.50 (14918-0)		81	737-0158		Elbow (14912-0)		
	734-0795		Rear Wheel Ass'y. Comp. (14912-0)		82	751-0190		Muffler (14912-0)		
	734-0785		Rim Only (14912-0)		83	—		11 H.P. Engine (14912-0)		
	734-0278		Tire Only 23.0 x 8.50 (14912-0)		84	13493		Heat Shield Brkt. (14912-0)		
43	736-0169		FI-Wash. 3/4" I.D.		85	712-0287		Hex Nut 1/4-20 Thd.* (14912-0)		
44	712-0241		Spring Insert Index Brkt. Hex Nut 3/8-24 Thd.*		86	736-0329		L-Wash. 1/4" Scr.* (14912-0)		
					87	710-0258		Hex Scr. 1/4-20 x .62" Lg.* (14912-0)		
					88	710-0456		Hex Drilling Scr. #10 x .50" Lg. (14912-0)		
					93	736-0301		Hex Scr. 3/8-24 x 2.75" Lg. (14912-0)		
					94	13492		Spacer (14912-0)		
								Heat Shield Cover (14912-0)		

*For faster service obtain standard nuts, bolts and washers locally. If these items cannot be obtained locally, order by part number and size as shown on parts list.

When ordering parts, if color or finish is important use the appropriate color code shown above. (e.g. Yard-Man Red Finish—13106 (497).)

(497—Yard-Man Red)

14912-0
14918-0

TRANSAXLE PEERLESS MODEL NO. 2337

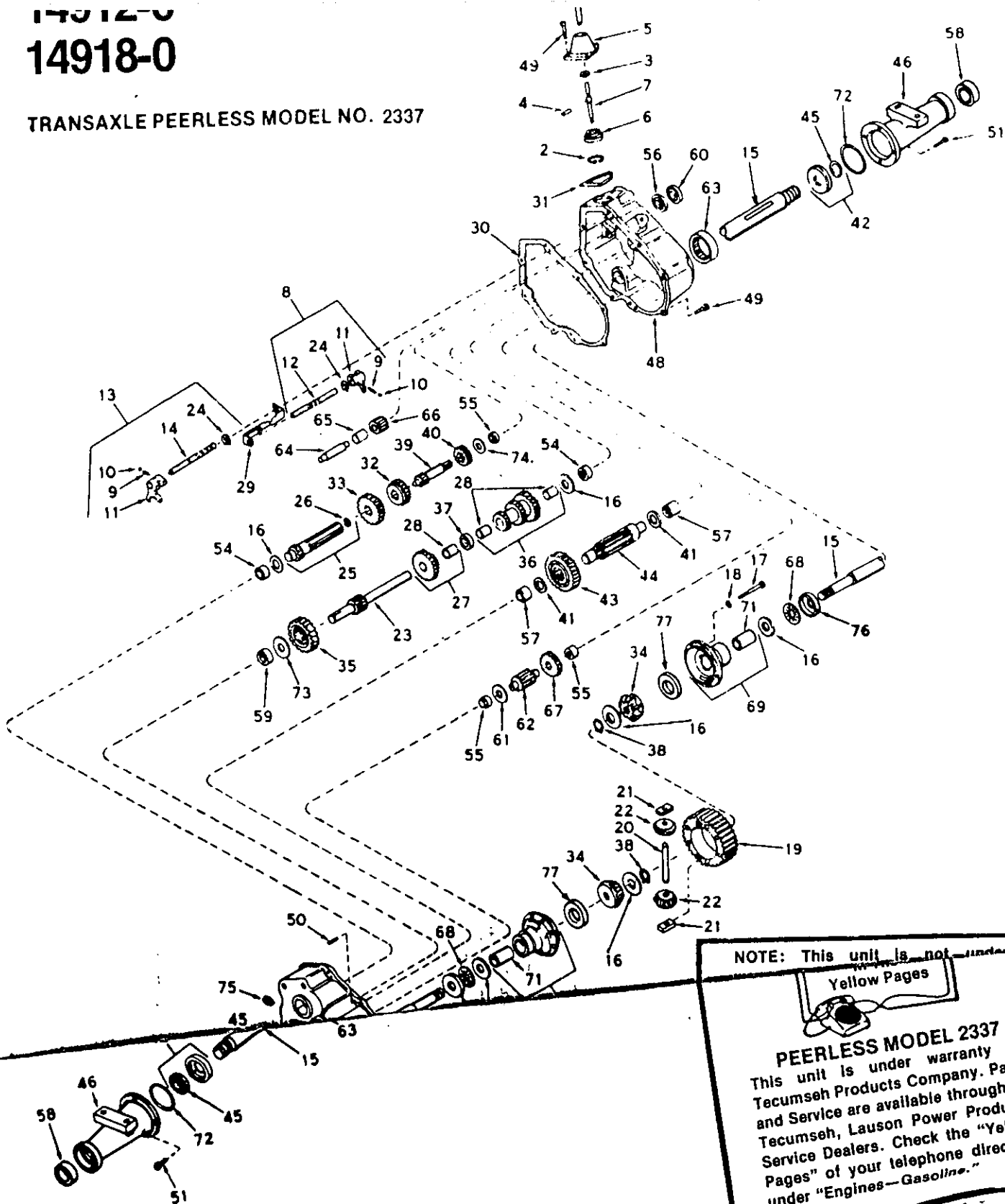

NOTE: This unit is not under warranty.
Yellow Pages

PEERLESS MODEL 2337
This unit is under warranty by Tecumseh Products Company. Parts and Service are available through all Tecumseh, Lauson Power Products Service Dealers. Check the "Yellow Pages" of your telephone directory under "Engines—Gasoline."

14912-0
14918-0

PARTS LIST FOR TRANSAXLE PEERLESS MODEL 2337

REF. NO.	PART NO.	DESCRIPTION	REF. NO.	PART NO.	DESCRIPTION
2	PE-792016	Ring, Snap	40	PE-778024	Spur Gear, Input Shaft
3	PE-792001	Ring, Quad	41	PE-780052	Washer, Thrust
4	PE-792049	Pin, Roll	42	PE-788021	Seal and Retainer Ass'y., Oil (Incl. No. 45)
5	PE-784093	Housing, Shift Lever	43	PE-778036	Gear, Output
6	PE-784094	Keeper, Shift Lever	44	PE-776028	Pinion, Output
7	PE-784289	Lever, Shift*	45	PE-788008	Seal, Oil
8	PE-784054	Rod Ass'y., Shift (Incl. Nos. 9 thru 12 and 24)	46	PE-782025	Housing, Axle
9	PE-792003	Spring	47	PE-772016A	Cover Ass'y., Transaxle (Incl. Nos. 54, 55, 57, 59 and 63)
10	PE-792004	Ball, Steel	48	PE-770012	Case Ass'y., Transaxle (Incl. Nos. 54, 55, 57 and 63)
11	PE-784004	Fork, Shifter	49	PE-792007	Scr., Socket Hd. Cap 1/4-20 x 3/4
12	PE-784055	Rod, Shifter (3rd and 4th)	50	PE-786026	Pin, Dowel
13	PE-784056	Rod Ass'y., Shift (Incl. Nos. 9, 10, 11, 14 and 24)	51	PE-792037	Scr., Hex Hd. Sems, 5/16-18 x 1
14	PE-784057	Rod, Shifter (Low)	52	PE-792019	Plug, Magnetic Drain
15	PE-774361	Axle	54	PE-780049	Bearing, Needle
16	PE-780042	Washer, Thrust	55	PE-530105	Bearing, Needle
17	PE-792005	Scr. Hex Hd. Cap 1/4-20 x 2 1/2	56	PE-780024	Bearing, Ball
18	PE-792006	L-Wash. 1/4"	57	PE-780047	Bearing, Needle
19	PE-778033A	Gear, Ring	58	PE-780050	Bearing, Ball
20	PE-786019	Pin, Drive	59	PE-780046	Bearing, Needle
21	PE-786027	Block, Drive	60	PE-788025	Seal, Oil
22	PE-778094	Pinion, Bevel	61	PE-780001	Washer
23	PE-776029A	Shaft and Gear, Brake	62	PE-776031	Shaft and Pinion
24	PE-792017	Ring, Snap	64	PE-780048	Bearing, Needle
25	PE-776026	Shaft and Brg. Ass'y., Pinion (Incl. No. 26)	64	PE-776030	Shaft, Reverse Idler
26	PE-780018	Bearing, Needle	65	PE-786025	Spacer, Reverse Idler
27	PE-778034	Gear Cluster Ass'y. (Incl. No. 28)	66	PE-778016	Idler, Reverse
28	PE-780053	Bushing	67	PE-778038	Spur Gear (22 teeth)
29	PE-784074	Stop, Shifter	68	PE-780039	Bearing, Thrust
30	PE-788023	Gasket, Case and Cover	69	PE-774072A	Carrier Ass'y., Differential (Incl. No. 71)
31	PE-788022	Gasket, Shifter Lever Housing	70	PE-774071A	Carrier Ass'y., Differential (Incl. No. 71)
32	PE-778019	Gear, Shifting (3rd and 4th)	71	PE-780041	Bushing
33	PE-778020	Gear, Shifting (1st, 2nd and Rev.)	72	PE-788024	"O" Ring
34	PE-778095	Gear, Bevel	73	PE-780007	Washer, Thrust
35	PE-778037	Gear, Idler	74	PE-780051	Washer, Thrust
36	PE-778035	Gear Cluster Ass'y. (Incl. No. 28)	75	PE-792010	Plug, Pipe
37	PE-786024	Spacer	76	PE-780075	Race, Thrust
38	PE-792018	Ring, Snap	77	PE-780107	Washer
39	PE-776175	Shaft, Input			

*Shift lever is not shipped with transaxle. Order separate.

14912-0
14918-0

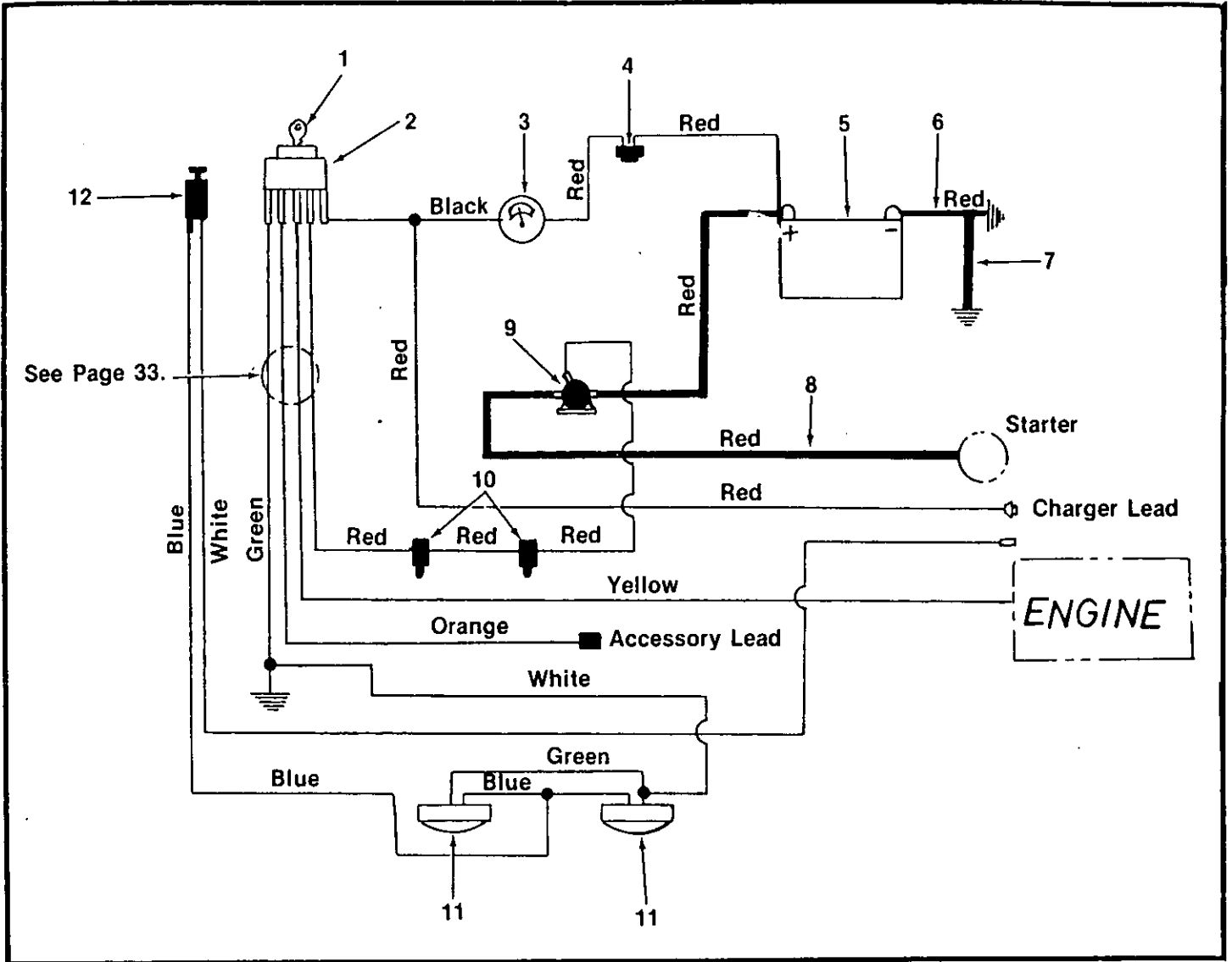

PARTS LIST FOR ELECTRICAL SYSTEM

REF. NO.	PART NO.	DESCRIPTION	NEW PART
1	725-0201	Ignition Key	
2	725-0267	Ignition Switch	
3	725-0119	Ammeter	
4	725-0459	Circuit Breaker (8 Amp)	
5	725-0453	Battery 12 Volt	
6	725-0559	Electric Wire	
7	725-0559	Electric Wire	
8	725-0561	Electric Wire	
9	725-0530	Solenoid	
10	725-0577	Safety Switch—Black	
11	725-0222	Head Lamp	
12	725-0646	Light Switch	

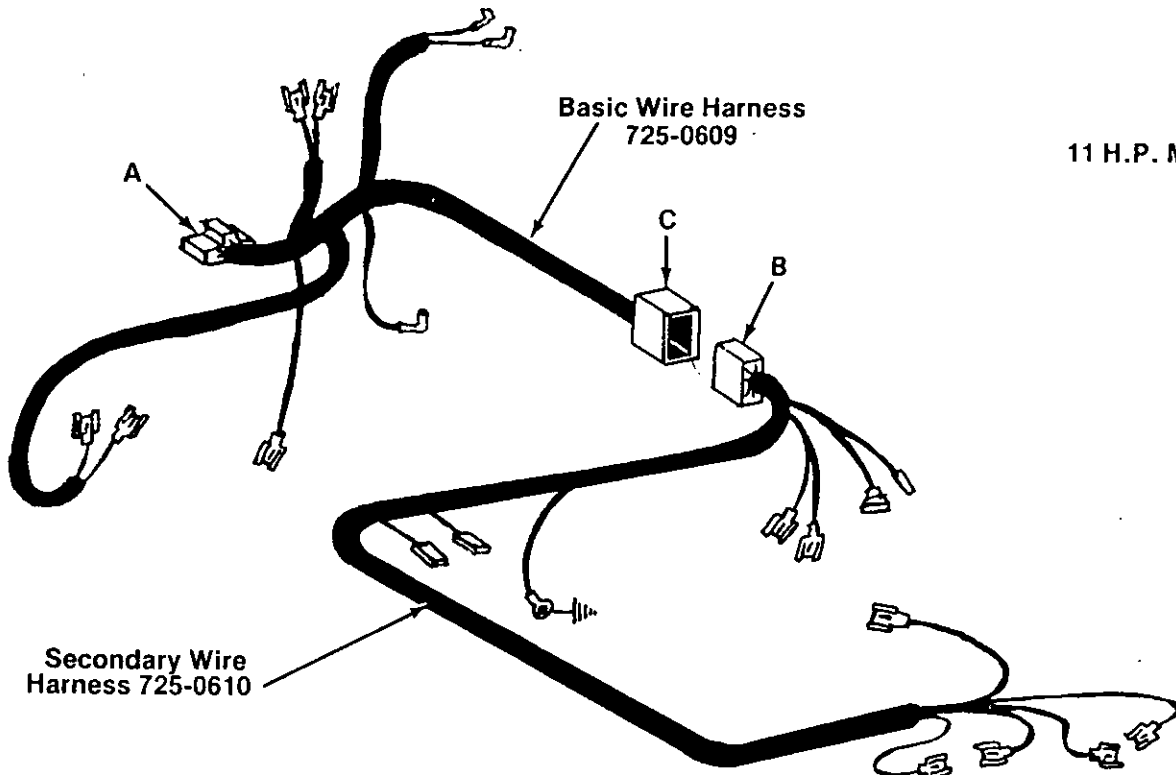

11 H.P. MODELS

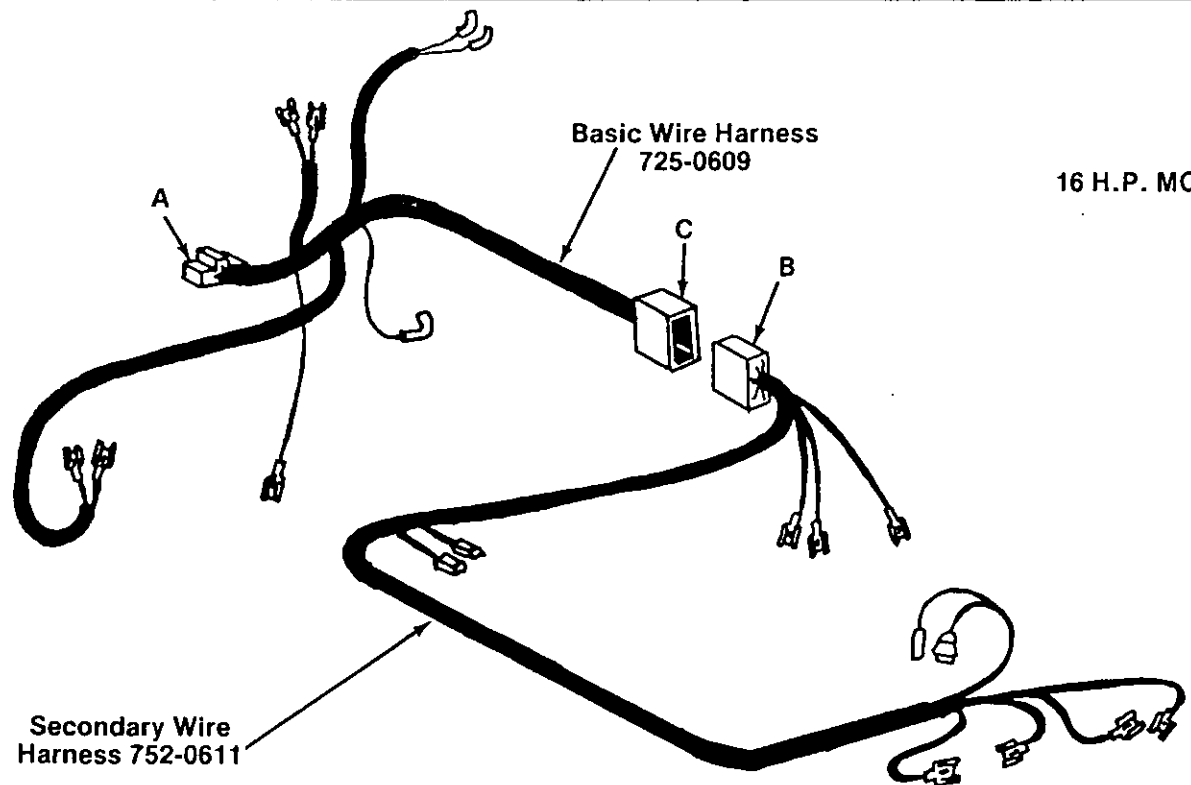

16 H.P. MODELS

<p>Terminal Block for Ignition Switch "A"</p>	<p>Terminal Block for Secondary Wire Harness "B"</p> <p>1 = Red 5 = Blue 2 = Red 6 = Red 3 = Orange 7 = White 4 = Green 8 = Yellow</p>	<p>Terminal Block for Basic Wire Harness "C"</p> <p>1 = Red 5 = Blue 2 = Red 6 = Red 3 = Orange 7 = White 4 = Green 8 = Yellow</p>
--	---	---

YARD-MAN

PARTS INFORMATION

POWER EQUIPMENT PARTS AND SERVICE

Parts and service for all YARD-MAN manufactured power equipment are available through the authorized service distributors listed below. All orders should specify the model number of your unit, parts numbers, description of parts and the quantity of each part required. **DO NOT SEND PARTS ORDER TO FACTORY.** Contact distributor for name of local dealer.

BRIGGS & STRATTON, TECUMSEH AND PEERLESS PARTS AND SERVICE.

Briggs & Stratton, Tecumseh and Peerless parts and service should be handled by your nearest authorized engine service firm. Check the yellow pages of your telephone directory under the listing **Engines—Gasoline, Briggs & Stratton or Tecumseh** Lauson.

ALABAMA	DOTHAN	
Auto Elect. Co. of Ala. Inc.	1301 Montgomery Hwy.	36301
	FLORENCE	
B.M. Ingram Inc.	705 S. Seminary	35630
ARKANSAS	MALVERN	
Power Edge Corp.	227 W. Page Ave.	72104
CALIFORNIA	GARDENA	
Quality Mower Dist.	15100 Crenshaw Blvd.	90249
	NORTHRIDGE	
Mower Sales and Service	8541 Reseda Blvd.	91324
	ORANGE	
Pearson's Lawn Mower	169 S. Hewes St.	92669
	SAN BERNARDINO	
Lawnmower Supply Co.	25608 E. Baseline	92410
	WEST SACRAMENTO	
Impossible Equipment Co. Inc.	1800 Enterprise Blv.	95691
COLORADO	STERLING	
Stickney's	101 Main St.	80751
	WHEAT RIDGE	
Turf Equip. and Parts	8035 West 44th St.	80033
FLORIDA	CORAL GABLES	
Moz-All of Florida, Inc.	365 Greco	33146
	JACKSONVILLE	
Radco Dist., Inc.	4909 Victor St.	32206
	OCALA	
Lovell Brothers	320 N. W. 10th St.	32670
GEORGIA	DUBLIN	
Henderson Equipment Co.	Rt. 19 S. Glenwood Rd. P.O. Box 2054	31021
	CERRO GORDO	
ILLINOIS	R.R. #1	61818
Van Horn Sales	LYONS	
Keen Edge	8615 Ogden Ave.	60534
INDIANA	FORT WAYNE	
Lynn Koehlinger Co.	3675 North Wells- Box 96	46801
	HEBRON	
KENTUCKY	P.O. Box 38	41048
J.A. Stevens Mower Co.	HOPKINSVILLE	
Cayce Mill Supply Co.	505 East First St.	42240
LOUISIANA	BATON ROUGE	
S & S Distributing Co.	1307 Main St.	70821
MAINE	BANGOR	
M.L. Coffin Co.	725 Broadway	04401
MASSACHUSETTS	SOUTHBORO	
Crandall-Hicks Co.	Rt. #9	01772
MICHIGAN	FERNDALE	
Ideal Mower Sales, Inc.	811 Woodward Heights	48220
	GRAND RAPIDS	
Jac Van Dist., Inc.	4350 Airwest S.E.	49508
	JACKSON	
Factory Branch	440 East Prospect	49203
MINNESOTA	ST. PAUL	
Power Tools Inc.	3771 Sibley Memorial Hwy.	55122

MISSOURI	ROLLA
Ozark Equip. Co., Inc.	Hwy. 63 & Black St.-Box 784
	65401
MONTANA	BILLINGS
Parker Montana Co.	2100 Sixth Ave.
	59101
NEBRASKA	OMAHA
K & K Co. Inc.	711 S. 15th St.
	68102
NEW JERSEY	PARSIPPANY
Elmco Dist., Inc.	2 Eastmans Rd.
	07054
NEW MEXICO	ALBUQUERQUE
Southwest Toro, Inc.	3700 Edith Blvd., N.E. P.O. Box 6307
	87107
NEW YORK	SYRACUSE
Morris Dist., Inc.	1153 W. Fayette St.
	13201
NORTH CAROLINA	WINSTON-SALEM
Carswell Dist., Co.	3750 N. Liberty St.-Box 4193 North Station
	27105
OHIO	CARROLL
Stebe's Inc.	P.O. Box 366
	43112
	CLEVELAND
Tecca Dist., Co.	4747 Manufacturing Ave.
	44135
OKLAHOMA	OKLAHOMA CITY
Moore Cycle & Supply	1537 W. Main St.
	73106
OREGON	BEAVERTON
R.M. Wade & Co.	10025 S.W. Allen Blvd.
	97005
PENNSYLVANIA	HATFIELD
Ronconi Equip. Inc.	2867 Sandstone Dr.
	19440
	MT. PLEASANT
Valley Equip. Dist.	203 N. Depot St.
	15666
TENNESSEE	BRISTOL
Mitchell-Powers Hdwe. Co.	5th St. Extension
	37620
	KNOXVILLE
House Hasson Hdwe.	757 Western Ave.
	37917
Master Repair Service	2000 Western Ave.
	37921
	UNION CITY
Graves Dist. Co., Inc.	1318 Stad Ave.
	38261
TEXAS	COMANCHE
Higginbotham Bros.	203 W. Central & Mary
	76442
	EL PASO
Southwest Toro Inc.	1628 Myrtle P.O. Box 51
	79940
	FORT WORTH
Woodson Sales Corp.	1702 N. Sylvania
	76111
UTAH	BOUNTIFUL
Powered Products	485 N. 500W
	84010
VIRGINIA	BLUEFIELD
Bluefield Supply Co.	St. Rte. 102, Box 112
	24605
	LORTON
Ronconi Equip. Inc.	8815 Telegraph Rd.
	22079
	LYNCHBURG
Bailey-Spencer Hardware Co.	1016-26 Commerce St.
	24505
	RICHMOND
Universal Tractor Equip. Corp.	Box 5489 928 N. Meadow St.
	23220
WASHINGTON	SEATTLE
R.M. Wade & Co.	3931 Leary Way N.W.
	98107
CANADA	KITCHENER, ONTARIO
MTD Products	97 Kent Ave.
	N2G4J1

WARRANTY PARTS AND SERVICE POLICY

The purpose of warranty is to protect the customer from defects in workmanship and materials, defects which are NOT detected at the time of manufacture. It does not provide for the unlimited and unrestricted replacement of parts. Use and maintenance are the responsibility of the customer. The manufacturer cannot assume responsibility for conditions over which it has no control. Simply put, if it's the manufacturer's fault, it's the manufacturer's responsibility; if it's the customer's fault, it's the customer's responsibility.

CLAIMS AGAINST THE MANUFACTURER'S WARRANTY INCLUDES

1. Replacement of Missing Parts on new equipment.
2. Replacement of Defective Parts within the warranty period.
3. Repair of Defects within the warranty period.

All claims MUST be substantiated with the following information:

1. Model Number of unit involved.
2. Date unit was purchased or first put into service.
3. Date of failure—Date Repaired.
4. Nature of failure—Correction.