

# OWNERS OPERATING MANUAL

## and PARTS LIST

Stock # 8-D -349

Code # 8-930

**18 INCH**  
**POWER MOWER**  
**MODEL NUMBER**  
**1040-5**



0611-432-A

PRINTED IN U.S.A.

# YARD-MAN

Incorporated

1410 W. Ganson St., Jackson, Michigan

BUILDERS OF THE ORIGINAL SILENT YARD-MAN LAWN MOWER

# **IMPORTANT**

## **RULES FOR SAFE OPERATION**

1. Never place hands or feet under the machine
2. Do not attempt to clean, adjust or repair machine while engine is running.
3. Disconnect spark plug wire before cleaning, adjusting or repairing the machine.
4. Never leave machine running unattended.
5. Never run engine inside a building without opening all doors and windows.
6. Never fill the gasoline tank while the engine is hot, and wipe off any gasoline that might be spilled.
7. Only persons acquainted with the Rules of Safe Operation should be permitted to use mower.

No minor should operate mower unless properly supervised.

*Please read these operating instructions carefully before operating your mower and keep handy for future reference*

## BEFORE STARTING ENGINE

1. (Fig. 2) Remove oil fill plug. Place mower level and fill engine crankcase to top of oil fill plug with S.A.E. No. 30W oil. Tilt mower to make sure oil flows completely into crankcase. Replace fill plug and tighten.
2. The air cleaner protects the engine against grit and dirt. CAUTION, an extremely dirty air cleaner element may cause engine to stall.

SEE ENGINE INSTRUCTION MANUAL FOR PROPER AIR CLEANER MAINTENANCE.

3. Fill tank with good grade regular, clean fresh gasoline. DO NOT MIX OIL with gasoline.

FOR COMPLETE ENGINE INFORMATION READ ENGINE INSTRUCTION BOOKLET FURNISHED WITH YOUR MOWER BEFORE STARTING OR OPERATING.

## TO START ENGINE

1. Move control lever to MAGIC CONTROL position with handle down.
2. Set throttle lever in choke position.
3. Pull starter rope with quick full stroke once. Move throttle lever to "FAST" position. Pull starter rope again.
4. When engine starts move throttle lever to "IDLE" position until engine warms up. Regulate engine speed with hand lever from "IDLE" to "FAST."

## BREAK-IN PERIOD

1. During first 10 hours of operation check frequently the following:
  - \* Oil level in engine crankcase.
  - \* Belt adjustment on engine to jackshaft drive. (Page 6)
  - \* Check all bolts, nuts and screws for tightness.

## OPERATING CONTROLS

1. (Fig. 1) Set operating control lever in MAGIC CONTROL position. Raise handle to start-----lower to stop. For easy maneuverability.
2. Set operating control lever to "MANUAL" position for direct drive operation. Use when mowing large areas or trimming.
3. Throttle lever regulates choke, run, idle and stop.

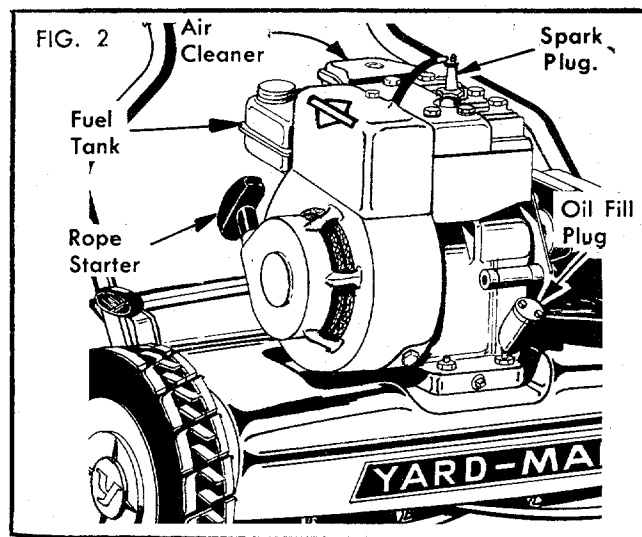
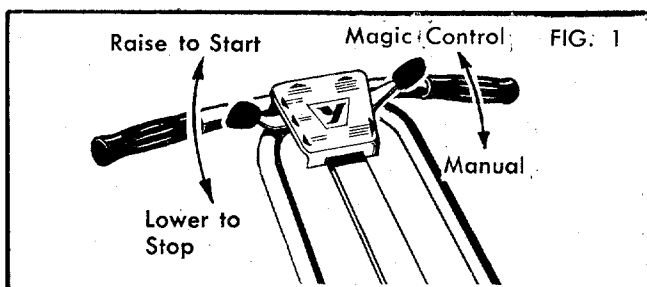

## TO ADJUST HEIGHT OF CUT

1. Consult the chart located on underside of handle cover, the roller adjusting knobs (A) and wheel adjusting levers (B) must be in positions shown for desired cutting height. EXAMPLE: for 1½" cutting height roller knob must be in No. 2 position, and wheel lever must be in No. 4 position. (Fig. 3 and Fig. 3A)
2. Place mower on hard, flat surface and tilt machine back on roller until wheels are off the ground. Move right hand wheel lever outward to disengage locating pin, then move lever forward or back until it is aligned with proper number on deck label. Release outward pressure on lever and be sure that locating pin seats properly in hole in end plate. Repeat this procedure on left hand side, position lever so that mower is level.
3. Tilt mower forward until roller is off the ground. Turn right hand roller knob counter clockwise 2 full turns and move knob up or down until alignment hole in roller bracket is in line with proper number on label at rear of end plate. (see illustration) Turn knob clockwise until tightened securely. Repeat this procedure for other side.

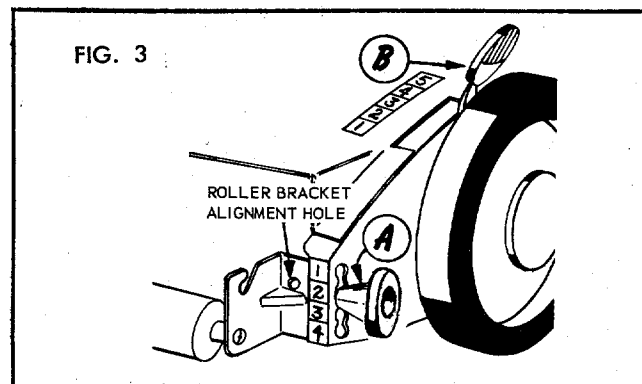

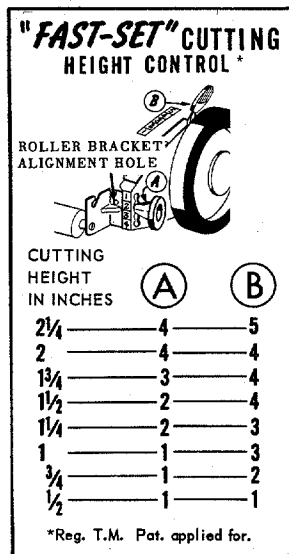

FIG. 3.A

## QUALITY OF CUT

Since a reel type mower does not create a lifting action like a rotary mower, it CANNOT lift up and cut tall blades of grass that are bent over. If cutting height is set too high, grass of this nature will not be in position to be drawn between the reel blades and cutter bar and in many cases will be pushed away by the revolving reel. Therefore, to obtain the utmost in performance and lawn appearance, cutting height ABOVE 1 5/8" IS NOT RECOMMENDED except where grass is up-right and dense.

## SERVICE INSTRUCTIONS

ALWAYS REMOVE SPARK PLUG WIRE BEFORE MAKING ADJUSTMENTS—NEVER MAKE ANY ADJUSTMENTS WITH ENGINE RUNNING.

Check your mower frequently to make sure all parts are operating smoothly. Your mower left the factory properly adjusted and properly lubricated to assure you of a smooth clean cutting job. Keep it clean. The mower should be thoroughly cleaned and lubricated at the start of each mowing season for better operation and longer service life.

DO NOT use water to clean the mower—use a broom or brush to remove grass and dirt. When storing mower for any length of time, follow storage instructions in engine instruction booklet.

### CHECKING AND ADJUSTING CUTTER BAR CLEARANCE

When properly set, the cutter bar should almost contact the reel blades. Only on very fine grass should the reel blades touch the cutter bar, and then very lightly so that only a slight scraping noise is heard.

It's easy to check proper cutter bar clearance—just place a piece of newspaper about 2" wide and 6" long, between reel blades and cutter bar—See Step 2 below. Correct cutter bar clearance should pinch but not cut, the paper at both ends and the middle of the cutter bar. If it doesn't, adjust as follows:

### REEL AND CUTTER BAR PAPER TEST

1. Insert strip of newspaper between cutter bar and reel blades.
2. Turn reel slowly backwards. If the paper is held snugly by each blade then adjustment is correct.
3. Adjust cutter bar so that reel blades pinch paper without cutting it.

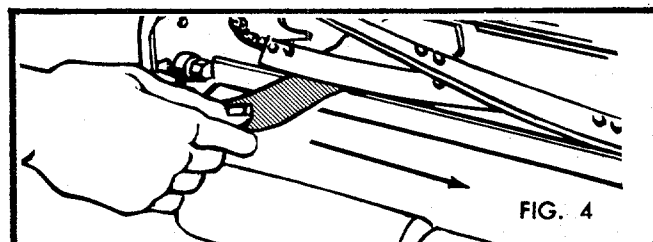

FIG. 4

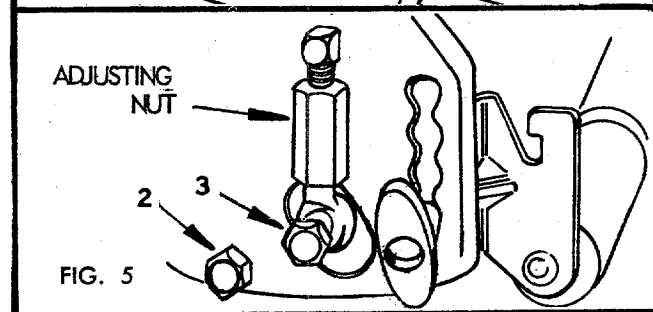

FIG. 5

### CUTTER BAR ADJUSTMENT

(Fig. 4) Cutter Bar bolts (2 & 3) are tapered and extend beyond the side plate slightly. When these tapered bolts are tight any end play or looseness is eliminated. Be sure these bolts are tight before making adjustments.

#### TO TIGHTEN CUTTER BAR

Turn hex adjusting nut counterclockwise.

#### TO LOOSEN CUTTER BAR

Turn hex adjusting nut clockwise.

### SERVICE

1. Sharpening is required when the mower will not cut satisfactorily without the reel blades wiping on the cutter bar.
2. Most lawn mower service shops are equipped with factory built service equipment to give your mower the same precision it had when it came from the factory.

#### NOTE:

When cutter bar is removed for sharpening, left hand pivot bolt (Item 2 fig. 5) must be turned counter clockwise to be removed. Right hand pivot bolt on right hand side of mower must be turned clockwise.

## TO ADJUST CHAIN DRIVE

1. (Fig. 6) (Fig. 7) Set hand control lever in **MAGIC CONTROL** and handle in stand-up position.
2. Loosen 4 engine mount bolts and pull engine back.
3. Loosen 4 control assembly bolts and move spacer plate under control assembly.
4. Pull the control assembly back to tighten chain. Allow  $\frac{1}{8}$  inch slack in chain. Tighten 3 control assembly bolts. Leave spacer plate nut loose.

## TO ADJUST BELT DRIVE

1. Check procedure **TO ADJUST CHAIN DRIVE**.
2. Be sure engine mount bolts are loose and spacer plate is positioned beneath control assembly.
3. Handle must be in stand-up position and hand control lever in **MAGIC-CONTROL** position.
4. With strip of paper between jackshaft and actuator roller, hold control assembly down against spacer plate—then move engine forward until paper is just free. Retighten engine mount bolts.
5. Move spacer plate from under control assembly. Tighten spacer plate nut.

## TO ADJUST MAGIC-CONTROL ACTION

1. Place hand lever in **MANUAL** position (Fig. 7)
2. Lower handle to operating position.
3. Loosen adjusting screw locknuts. (Fig. 7A)
4. With handle down adjust screw so that Actuator Roller has  $\frac{1}{16}$  inch clearance between roller and jackshaft.
5. Retighten adjusting screw lock nut.

## LUBRICATION

1. Change engine oil (crankcase) after first 5 hours of operating. See engine operating instructions.
2. Check air cleaner frequently.
3. Reel bearings require no attention until mower is serviced.
4. Check jackshaft oiler cup frequently, oil at beginning of mowing season and as needed. Oil roller shaft once or twice a year or as needed.
5. Lightly lubricate with engine oil, points indicated on roller and between end plates and wheel dust covers. Periodic lubrication at these points will insure smooth mechanical operation. (Fig. 8)

To insure continued easy operation of controls, oil outside of exposed cables for full length with engine oil as required.

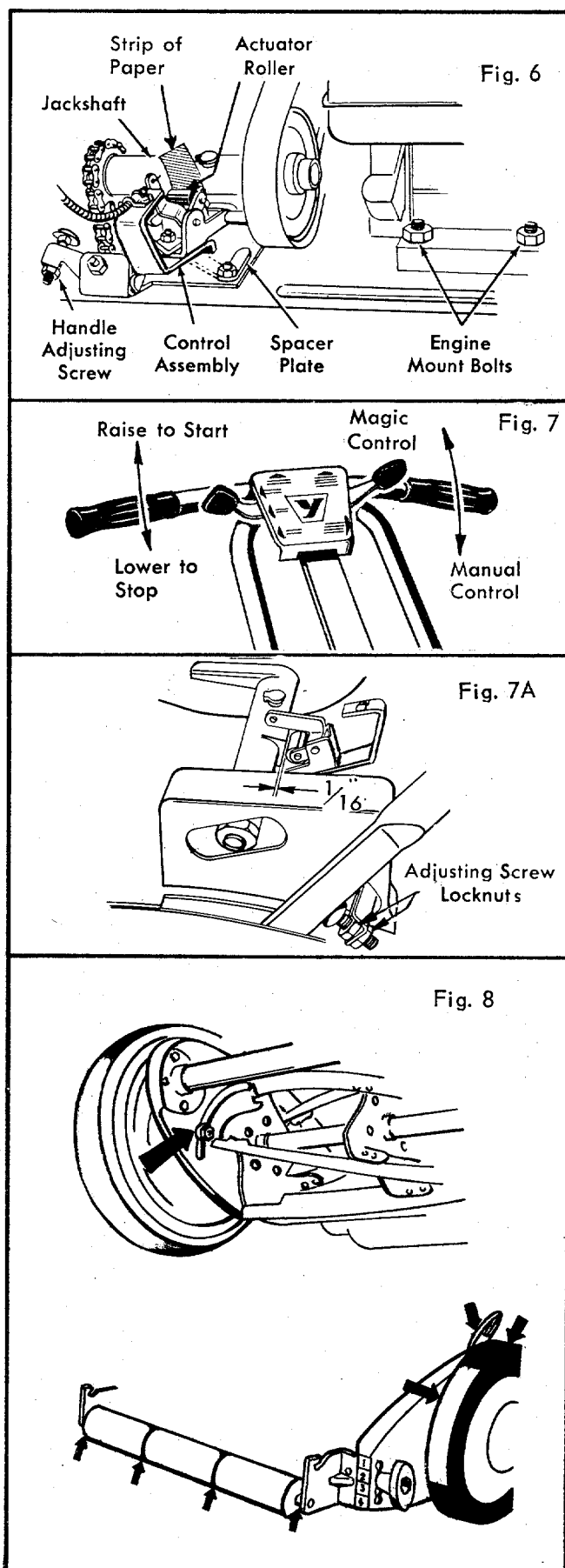

## STAND-UP HANDLE

1. There's no storage problem with the Stand-up Handle.
2. Move handle latch on the end-plate in and move handle to upright position.

To transport mower in car, remove controls and cables from handle. DO NOT KINK CABLES.

## STORAGE

Store your mower in a clean, dry place and keep clean to serve you well. If stored for a length of time, the engine should be drained of fuel. This will prevent the forming of gum deposits on essential parts in the carburetor fuel line and tank, which might affect the efficient operation of your engine when again used.

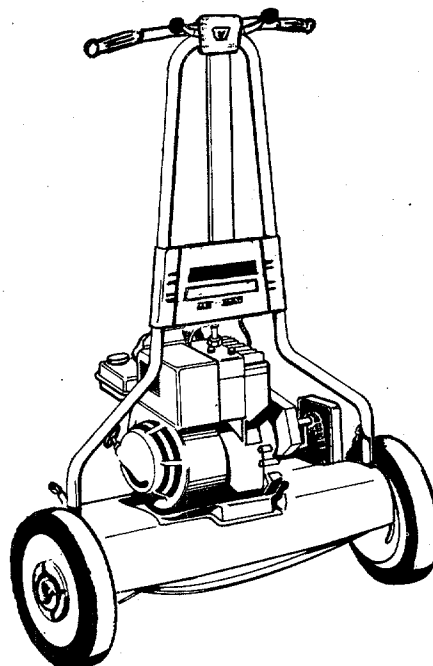

FIG. 10A

## OPERATING AND LAWN MOWING HINTS



1. Simplicity of control in this Power Reel mower makes mowing a pleasure. Raise the "Magic Handle" to start, lower to stop. Set the throttle level for your convenient walking speed.
2. For close trimming around flower beds, along walks and walls, set the handle control lever to "Manual" position. In manual control the reel turns as long as the engine runs. Trim by tilting mower back on roller to stop.

3. See instructions for cutting height adjustment, Pages 4 and 5.

4. Your Power Reel mower is easy to transport. Push down on handle, tilt mower on rollers and push your mower. The blades will be raised for passing over rocks, curbs, etc.

USE A SYSTEM  
WHEN YOU MOW

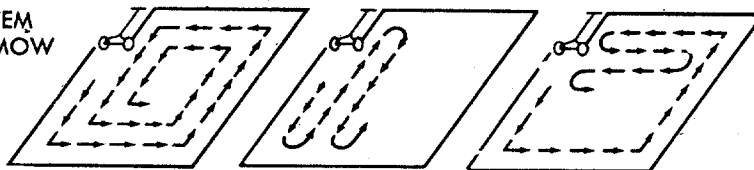

This way gets the edges—it's real fast and it's real work!

A pause at each end is more restful but it misses the edges.

COMBINE FOR  
BEST RESULTS

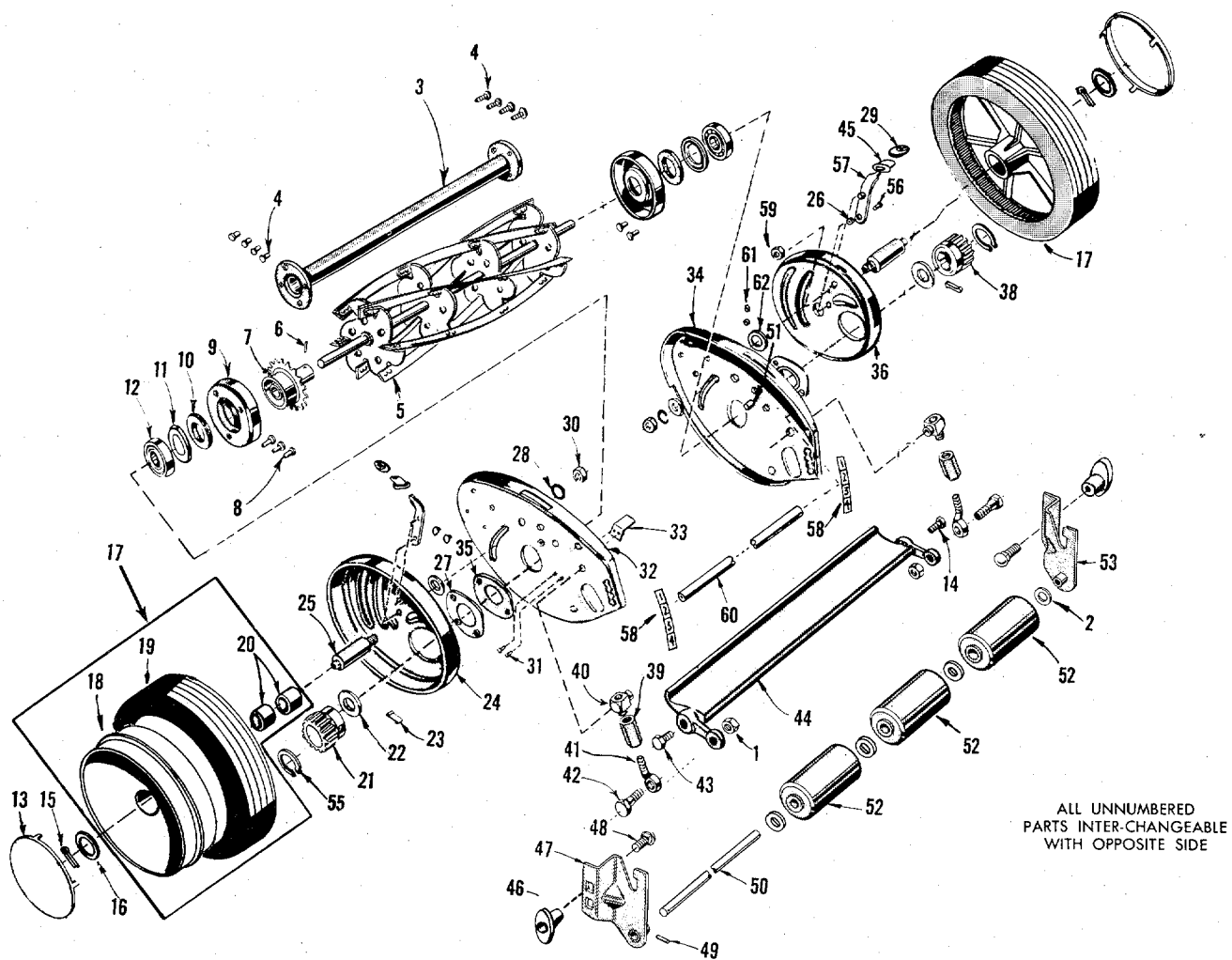

# HOW TO ORDER REPAIR PARTS FOR YOUR



## MODEL 1040-5 POWER MOWER

All parts listed herein may be ordered through YARD-MAN INCORPORATED  
WHEN ORDERING REPAIR PARTS, ALWAYS GIVE THE FOLLOWING INFORMATION AS  
SHOWN IN THIS LIST:

1. THE PART NUMBER.
2. THE PART NAME.
3. The MODEL NUMBER.
4. The NAME of item.

Your Mower is right hand (R.H.) or left hand (L.H.) as you push.

Do not use Key Numbers when ordering Repair Parts, always use Part Numbers.

### PARTS LIST

REF. NO.	PART NO.	NAME OF PART	REF. NO.	PART NO.	NAME OF PART
1	149	*Nut (3/8-24 Hex) .....	32	1129-139-17	End Plate with Trunnions—L.H. ..
2	1540-59	Washer—Roller .....	33	1723-1	Scraper .....
3	1112-18-17	Spacer Tube Assembly 18" .....	34	1129-138-17	End Plate with Trunnions—R.H. ..
4	1530-6	*Rivet (3/16 x 3/8) .....	35	1624-138	Spacer .....
5	2135-20-17	Reel Assembly 18" .....	36	1118-8-17	Gear Housing—R.H. ....
6	1548-5	Rollpin .....	37		
7	2121-2-17	Sprocket, Anti-wind Cup & Hub Ass'y .....	37		
8	1530-20	*Rivet (3/16 x 13/32) .....	38	1629-4	Pinion Gear—R.H. ....
9	1629-28	Retainer .....	39	1539-31	Nut .....
10	104	Felt Washer .....	40	1156-6	Trunnion .....
11	106	Felt Retainer .....	41	1513-40	Bolt .....
12	3	Bearing .....	42	453	Screw .....
13	2674-33	Hub Cap .....	43	455	Screw Cutter Bar—R.H. Thd. ....
14	1509-86	Screw Cutter Bar L.H. Thd. ....	44	2134-11-17	Cutter Bar Assembly—18" .....
15	142	*Cotter Pin (1/8 x 5/8) .....	45	1622-50	Dust Cover .....
16	141	Washer .....	46	1643-23	Roller Adjust Knob .....
17	1108-80-41	Wheel and Tire Assembly .....	47	2132-12-17	Roller Bracket Assembly—L.H. ....
18	1110-27-41	Drive Wheel & Bearings Less Tire .....	48	1529-25	*Bolt (5/16-18 x 5/8) .....
19	2619-25	Tire .....	49	1548-7	Rollpin .....
20	137	Bearing .....	50	1632-57	Roller Shaft—18" .....
21	1692-3	Pinion Gear—L.H. ....	51	10	Trunnion .....
22	109	Felt Washer .....	52	1126-7	Roller Assembly—18" .....
23	323	Pawl .....	53	2132-11-17	Roller Bracket Assembly—R.H. ....
24	1118-9-17	Gear Housing—L.H. ....	54	72	Wrench .....
25	1631-26	Axle .....	55	1650-21	Retaining Ring .....
26	1540-55	Washer .....	56	1509-38	*Screw (#10-32 x 3/8 Hex. Hd.) ....
27	1629-41	Retainer .....	57	1155-14-41	Spring & Trunnion Assembly ....
28	1657-19	Bushing .....	58	1616-119	Roller Adjust Label .....
29	2643-18	Knob Wheel Adjust .....	59	1534-8	*Nut (10-32 Gripco) .....
30	1538-23	Nut .....	60	2642-112-17	Spacer—End Plate (21" only) ....
31	1117	*Screw (10-32 x 3/8 Sems) .....	61	1657-23	Nylon Bushing .....
			62	1540-43	Washer—Special .....

For illustration—See Page 8

\*Standard Hardware Item—May be Purchased Locally



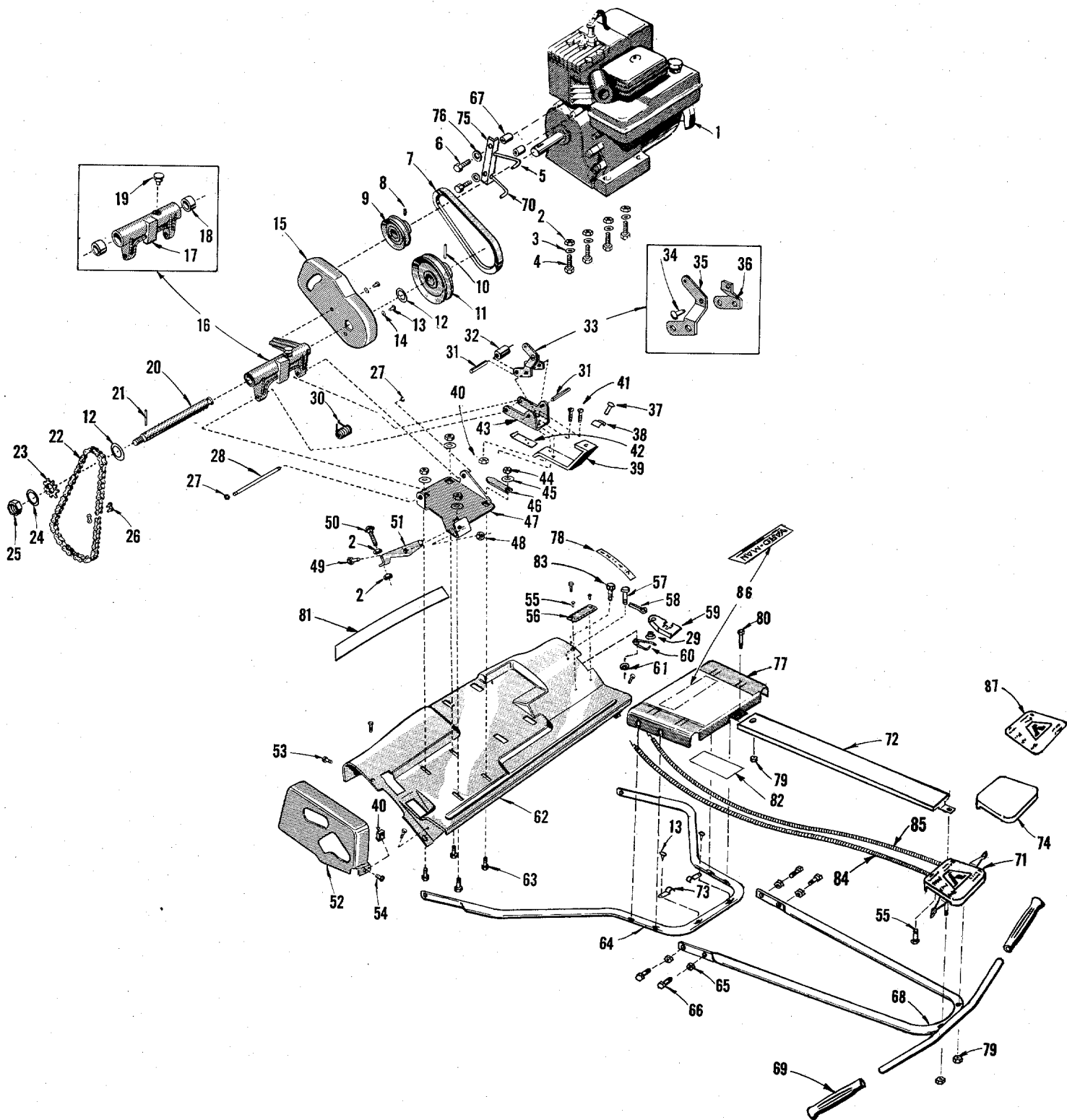

## PARTS LIST

REF. NO.	PART NO.	NAME OF PART	REF. NO.	PART NO.	NAME OF PART
		Briggs & Stratton Engine Model	43	1609-83-17	Bracket
1		60102 Type 0136-01	44	67	*Nut (1/4-20 Hex.)
2	70	*Nut (5/16-18 Hex.)	45	1018	*Lockwasher (1/4)
3	1025	*Lock Washer (5/16)	46	1624-50	Spacer
4	1529-11	*Bolt (5/16-18 x 1 3/8 Carriage)	47	3609-82-17	Bracket
5	1724-7	Keeper—Belt upper—18"	48	41-028	*Nut (5/16-24 Hex. Lock Gripco)
6	1509-69	*Screw (1/4-20 x 1 3/4 Fillister Hd.)			Bolt (5/16-24 Hex. Shoulder
7	1651-20	"V" Belt	49	1513-18	Bolt)
8	1508-13	*Set Screw (5/16-24 x 7/32 Self	50	1513-23	Bolt (5/16-18 x 1 5/8 Step)
		Lock)	51	2705-6	Lever
9	1626-40-17	Pulley	52	3639-32-17	Guard
10	1548-11	Rollpin	53	1513-8	*Bolt (5/16-24 x 1/2 Sems. Hex.
11	2120-34-17	Pulley Assembly			Hd.)
12	1540-17	*Washer (5/8 x 15/16)	54	117	*Screw (10-32 x 3/8 Philps Hd.
13	1511-25	Screw (10-32 x 1/2 Stms Thd.			"Sems")
		Cutting)	55	1511-26	*Screw (6 x 1/4 Rd. Hd. Self
14	1540-55	Washer			Tapping)
15	2639-30-17	Belt Guard	56	1605-334	Name Plate—18"
16	2102-20-17	Jackshaft Housing, Bearings	57	1545-23	Clevis Pin
		& Oiler Assembly	58	1547-4	Cotter Pin
17	3601-64-17	Jackshaft Housing	59	2627-21-17	Latch
18	1652-1	Bearing	60	2642-51	Spring
19	1691-2	Oiler	61	1097	*Washer 3/16
20	1632-26	Jackshaft	62	5690-9-17	Deck—18"
21	1546-2	Pin	63	1529-15	Bolt (1/4-20 x 5/8)
22	1654-2	Chain	64	3712-17-01	Lower Handle Section—18"
23	1638-16	Sprocket	65	1538-8	*Nut (1/4-20 Hex.)
24	1036	Washer	66	1509-22	*Bolt (1/4-20 x 1 3/8 Hex.)
25	1538-16	*Nut (7/16-24 Hex. Jam Lock	67	1624-69	Spacer
		Gripco)	68	4117-34-01	Upper Handle Section
26	1113-13	Connector Link	69	1710-8	Handle Grip
27	1650-10	Retaining Ring	70	1724-9	Lower Belt Keeper—18"
28	1547-3	Pin	71	1129-206	Dual Throttle Control Ass'y
29	1624-122	Spacer			Complete
30	1642-30-17	Spring	72	2622-53-17	Throttle Control Cable Cover
31	1548-13	Rollpin	73	1694-19	Clamp Control Cable
32	1658-8	Roller	74	3622-51-17	Control Cover
33	1155-15-17	Roller Lever Assembly	75	1606-48	Belt Keeper Bracket
34	9	*Rivet (3/16 x 13/32)	76	1540-23	Washer
35	1705-17	Roller Lever—L.H.	77	3622-52-17	Handle Cover
36	1705-10	Roller Lever—R.H.	78	1616-114	Label—Wheel Adjust
37	1117	*Screw (10-32 x 3/8 Ph. Rd. Hd.	79	1534-22	*Nut (#10-24 Hex.)
		Thd. Cut Sems)	80	1501-21	*Screw (#10-24 x 3/8)
38	1694-10	Clamp	81	2616-249	Yard-Man Label
39	2609-180-17	Control Bracket	82	1616-118	Label Adjustment Chart
40	1543-8	*Nut (10-32 Gripco)	83	1513-41	Bolt (5/16-24 x 3/4 Hex. Hd.)
41	41-054	*Screw (10-32 x 9/16 Rd. Hd.	84	0171-24	Clutch Cable Assembly
		Sems)	85	0171-25	Throttle Cable Assembly
42	2642-52-17	Spring	86	1616-236	Label—Handle Cover
			87	1616-237	Label—Throttle Cover

For Illustration—See Page 10

\*Standard Hardware Item—May Be Purchased Locally

**When you own this - -**

**YARD-MAN**

## **POWER REEL MOWER**

**you enjoy these outstanding features**

### **FAST-SET WHEEL HEIGHT CONTROL**

touch of the finger  
sets cutting height  
from  $\frac{1}{2}$ " to  $2\frac{1}{4}$ ".

### **SIMPLE SELF- LOCKING BED-KNIFE ADJUSTMENT**

reel blades do not  
touch bed-knife. Gives  
silent operation and  
extra mower life.

### **FAST-SET ROLLER HEIGHT CONTROL**

eliminates tools to  
set roller for level  
cutting.

### **AUSTEMPERED REEL BLADES**

hard as tool steel,  
resists nicks and  
dulling.

### **MAGIC-CONTROL HANDLE**

raise to go — lower  
to stop.

## **WARRANTY**

This YARD-MAN Lawn Mower is guaranteed for one year from date of purchase against defects in workmanship or material under normal use and service. We agree to repair or replace, without charge to the purchaser, any part proved to be defective within the Warranty period. Parts for this Yard-Man mower will be available for at least ten years from date of purchase. This Warranty will not apply to a lawn mower which has been subjected to misuse, negligence, or accident, nor to a lawn mower which has been altered in any way.

**YARD-MAN<sup>®</sup>** INCORPORATED  
JACKSON, MICHIGAN