

OPERATING INSTRUCTIONS AND PARTS LIST

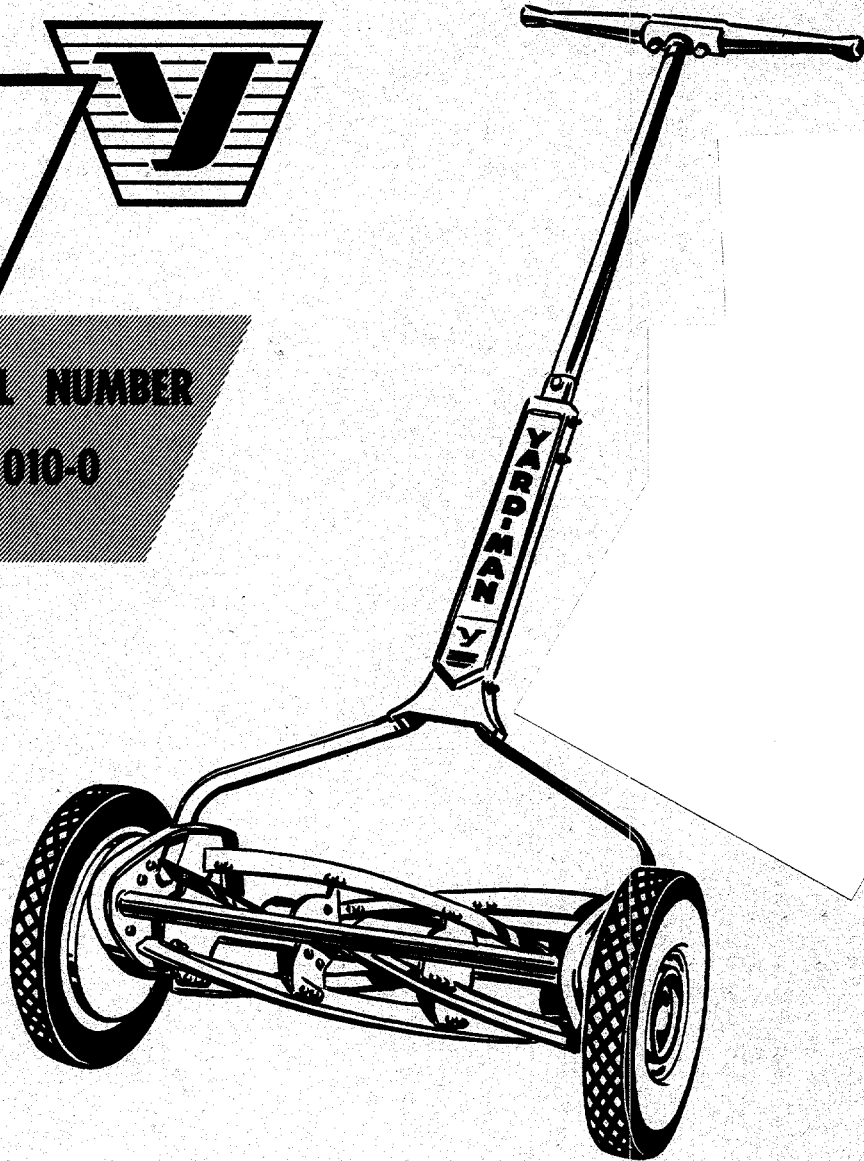
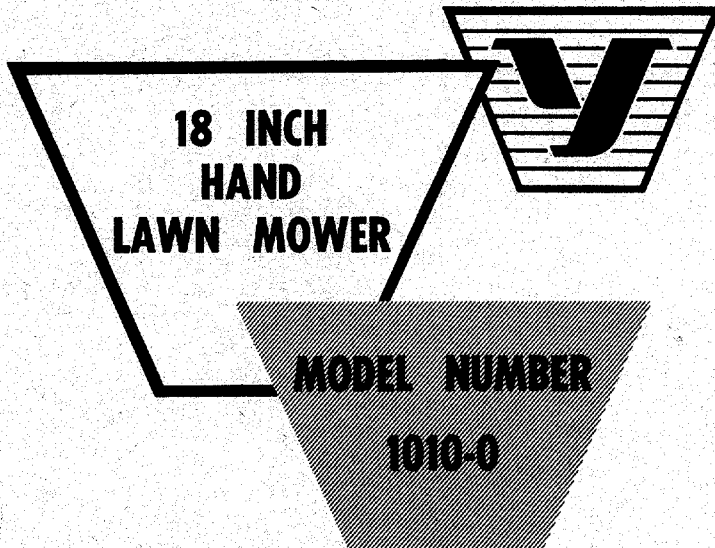

0611-164

OCTOBER, 1958

YARD-MAN Incorporated 1410 W. Ganson St., Jackson, Michigan

BUILDERS OF THE ORIGINAL SILENT YARD-MAN LAWN MOWER

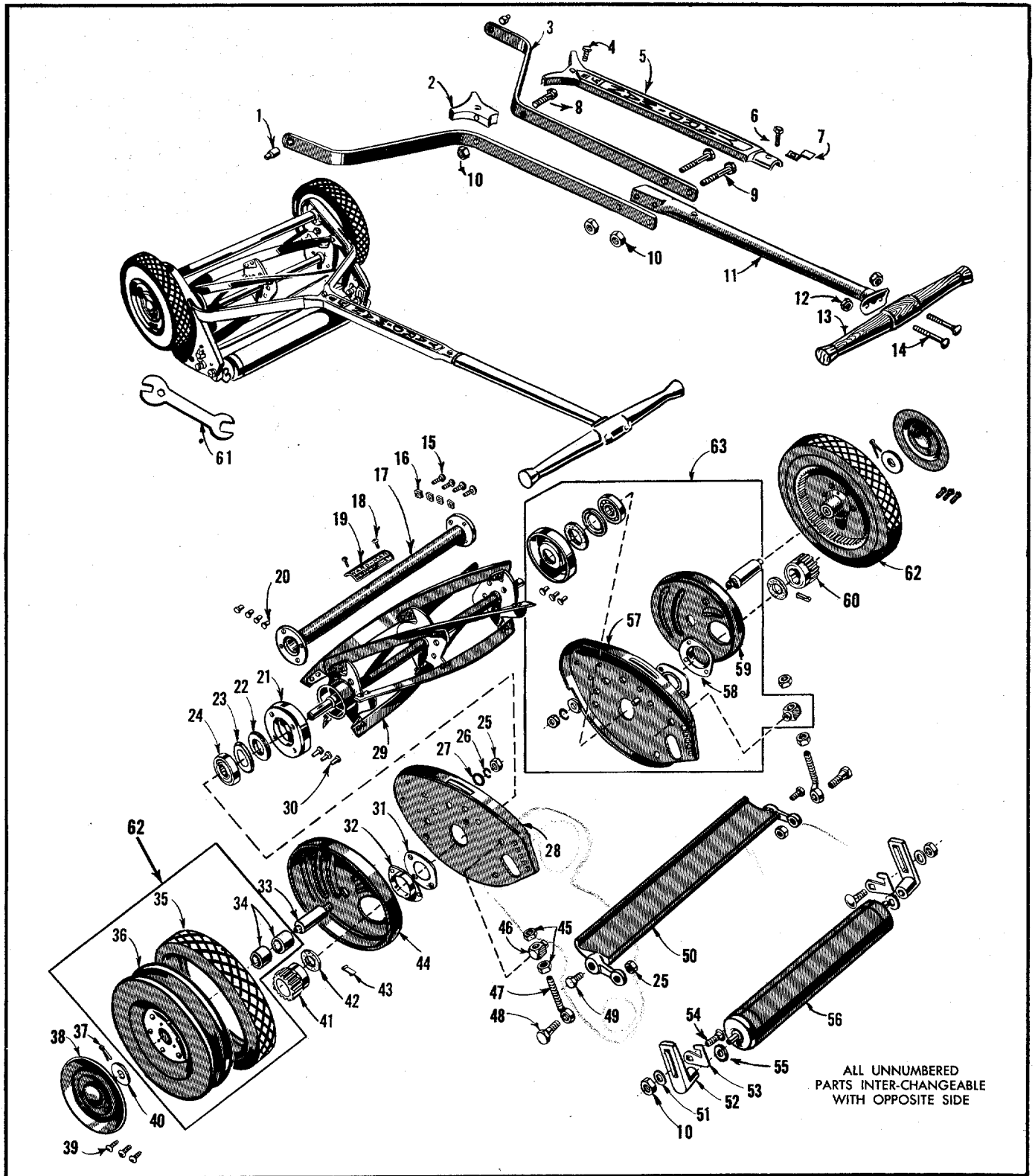

SERVICE

1. Sharpening is required when the mower will not cut satisfactorily without the reel blades wiping on the cutter bar.

2. Most lawn mower service shops are equipped with Yard-Man factory-built service equipment to give your YARD-MAN the same precision it had when it came from the Yard-Man factory.

HOW TO ORDER REPAIR PARTS FOR YOUR



MODEL 1010-0 HAND LAWNMOWER

All parts listed herein may be ordered through YARD-MAN, INCORPORATED

WHEN ORDERING REPAIR PARTS, ALWAYS GIVE THE FOLLOWING INFORMATION AS SHOWN IN THIS LIST:

- | | |
|---------------------|----------------------|
| 1. The PART NUMBER. | 3. The MODEL NUMBER. |
| 2. The PART NAME. | 4. The NAME of item. |

Your mower is right hand (R.H.) or left hand (L.H.) as you push.

PARTS LIST

Drawing Ref. No.	Part No.	Description	Drawing Ref. No.	Part No.	Description
1	10	Trunnion.....	36	2110-11-18	Drive Wheel Less Tire.....
2	2624-18	Spacer.....	37	142	*Cotter Pin (1/8 x 5/8).....
3	3603-43-18	Handle Brace—18".....	38	1622-30-17	Hub Cap.....
4	1511-7	*Screw (10-32 x 3/8 Rd Hd Self Tap).....	39	136	*Screw (10-32 x 3/8 Rd Hd Sems).....
5	3622-28-17	Cover Plate.....	40	141	*Washer (3/8 x 1 1/4).....
6	1523-3	*Screw (#10 x 3/8 Ph Hd Sheet Metal).....	41	428	Pinion Gear—L.H.....
7	1689-3	Grass Catcher Clip.....	42	109	Felt Washer.....
8	169	*Bolt (5/16-18 x 2 1/2 Sq Hd).....	43	323	Pawl.....
9	1509-13	*Bolt (5/16-18 x 2 1/4 Hex Hd).....	44	3601-70L-17	Gear Housing.....
10	70	*Nut (5/16-18 Hex).....	45	52	*Nut (3/8-24 semi fin Hex).....
11	2117-15-18	Handle Shaft.....	46	11	Trunnion.....
12	67	Nut (1/4-20 Hex).....	47	451	Screw—Cutter Bar Adjusting.....
13	1664-2	Cross Handle.....	48	453	Screw (Rear).....
14	165	*Bolt (1/4-20 x 1 3/4 Carriage).....	49	455	Screw (Front).....
15	117	*Screw (10-32 x 7/16 Rd Hd Sems).....	50	2134-6-17	Cutter Bar—18".....
16	116	*Nut (#10-32 Sq Hd).....	51	159	*Washer (5/16 x 3/8).....
17	1112-14-17	Spacer Tube Assembly—18".....	52	1609-80-17	Roller Bracket.....
18	88	*Screw (#6 x 1/4 Self Tap Ph Hd).....	53	171	Basket Hook.....
19	1605-92	Name Plate.....	54	160	*Bolt (5/16-18 x 1 1/16 Carriage).....
20	17	*Rivet (3/16 x 3/8 Rd Hd).....	55	757	*Washer (5/16 x 3/4).....
21	1629-28-17	Retainer.....	56	556-18	Roller—18".....
22	104	Felt Washer.....	57	1129-46R-17	End Plate with Trunnions—R.H.....
23	106	Felt Retainer.....	58	1601-19R-17	Pinion Housing—R.H.....
24	3	Bearing.....	59	3601-70R-17	Gear Housing.....
25	149	*Nut (3/8-24 Jam).....	60	425	Pinion Gear—R.H.....
26	1076	*Lockwasher (3/8).....	61	72	Wrench.....
27	154	*Washer (3/8 x 3/8).....	62	1108-28-18	Drive Wheel Assembly with Tire.....
28	1129-46L-17	End Plate with Trunnions—L.H.....	63	1129-47R-17	End Plate Assembly—R.H.....
29	2135-9-17	Reel Assembly—18".....		1129-47L-17	End Plate Assembly—L.H.....
30	9	*Rivet (3/16 x 13/32 Rd Hd).....			
31	1629-9-17	Retainer.....			
32	1601-19L-17	Pinion Housing L.H.....			
33	340	Axle.....			
34	137	Bearing.....			
35	2619-13	Tire.....			

Assembly Not Illustrated

3111-18R-17	End Plate Assembly—R.H. Less Gear Housing and Axle
3111-18L-17	End Plate Assembly—L.H. Less Gear Housing and Axle

* Standard Hardware Item—May be Purchased Locally.

SETTING UP

1. Attach Handle Braces (1).
2. Attach handle brace spacer and handle with bolts and tighten nuts (2).
3. Attach Cover plate and grass catcher clip with metal screws (3).
4. Turn down grass catcher hooks if grass catcher is used (4).

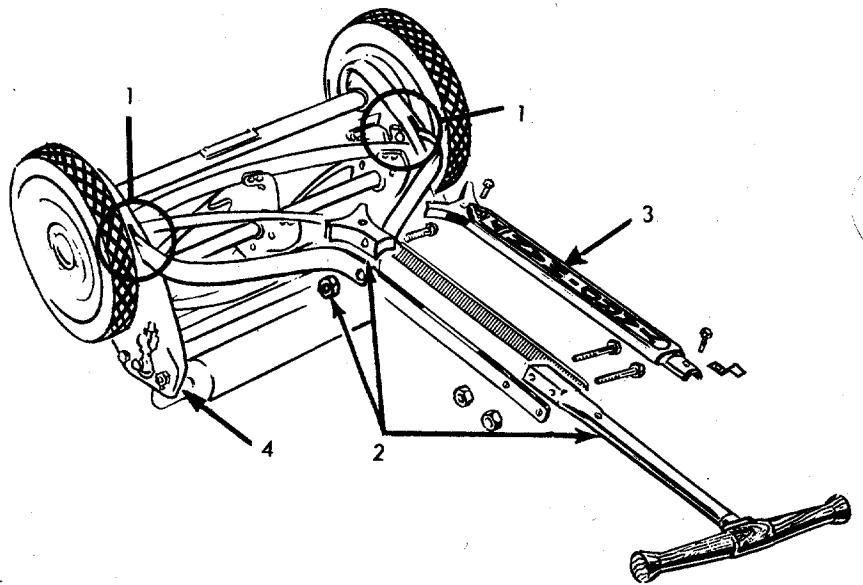

ADJUSTMENTS

TO TIGHTEN CUTTER BAR ADJUSTMENT

1. Loosen top nut (5) one quarter turn
2. Tighten lower nut (6)
3. Bolts (7 & 8) must be tight after adjustment

TO LOOSEN CUTTER BAR ADJUSTMENT

1. Loosen lower nut (6) one quarter turn
2. Tighten top nut (5)
3. Bolts (7 & 8) must be tight after adjustment

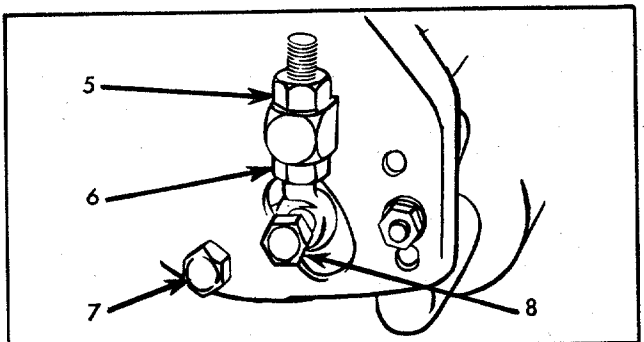

SILENT YARDMAN PAPER TEST

1. Insert strip of newspaper
2. Turn reel slowly
3. Adjust cutter bar so that reel blades pinch paper without cutting it

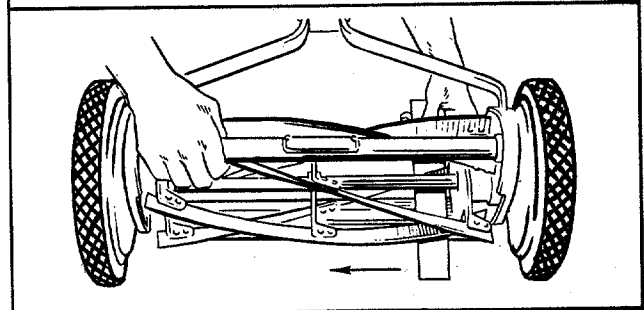

TO CHANGE LAWN MOWER FROM HIGH TO LOW CUT

1. Remove hub caps and wheels
2. Remove wheel axle
3. HIGH CUT— $1\frac{3}{8}$ to $2\frac{1}{4}$ in.
Axle located in hole 1 and dowel pin in hole 4
- MEDIUM CUT— $\frac{3}{4}$ to 1 in.
Axle located in hole 2 and dowel pin in hole 5
- LOW CUT— $\frac{3}{8}$ to 1 in.
Axle located in hole 3 and dowel pin in hole 6
4. Be sure dowel pin seats in side plate hole
5. Attach axle, nut and tighten
6. Replace wheel, washer, cotter pin and hub cap

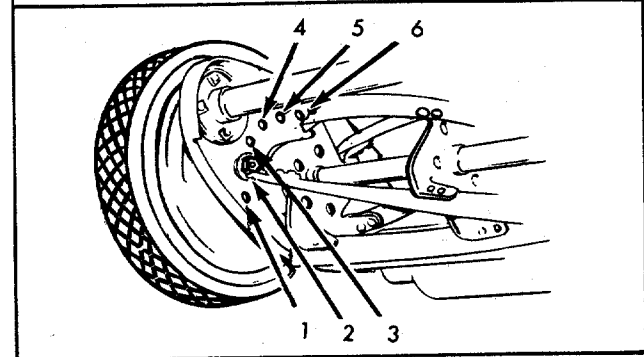

TO ADJUST HEIGHT OF CUT

1. Remove both roller hanger bolts
2. Raise or lower roller to desired cut
3. Set both sides of roller at same height, replace bolts and tighten

LUBRICATION

1. Seals on all bearings, hold dirt out and grease in. No further lubrication is required until mower is sharpened.
2. Oil Roller Bearing once or twice a year.