



STIGA PARK

PRO 20

PRO 16

ROYAL

PRESIDENT

COMFORT

EXCELLENT



8211-0278-08

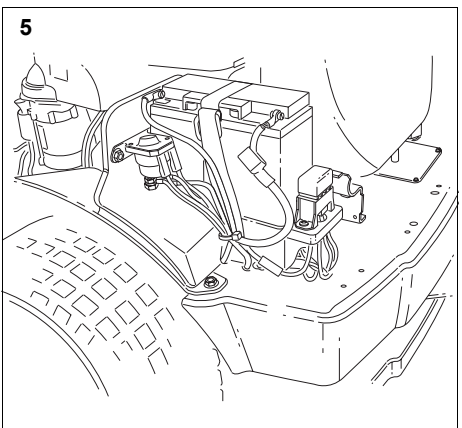
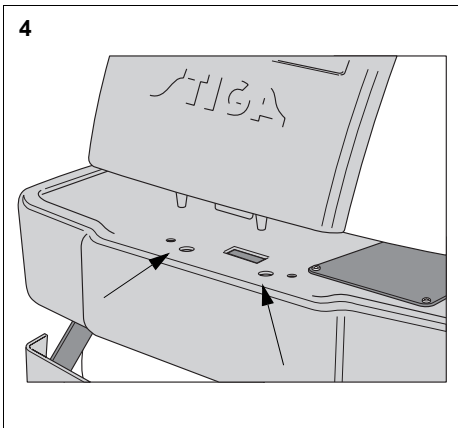
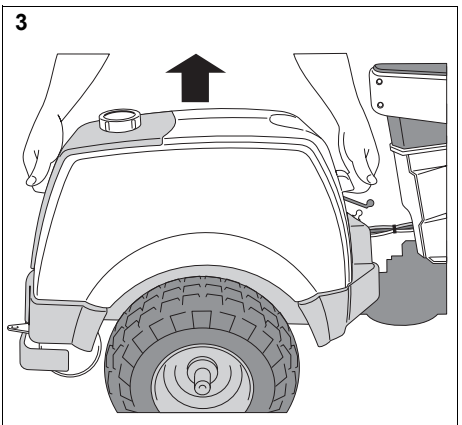
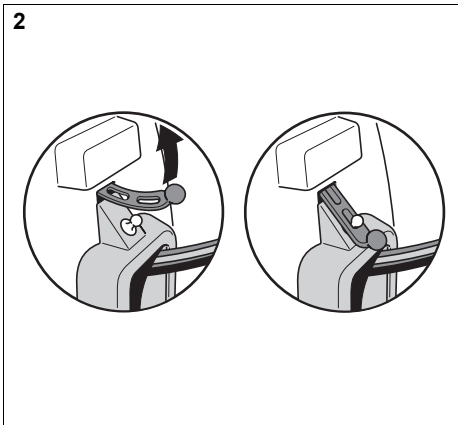
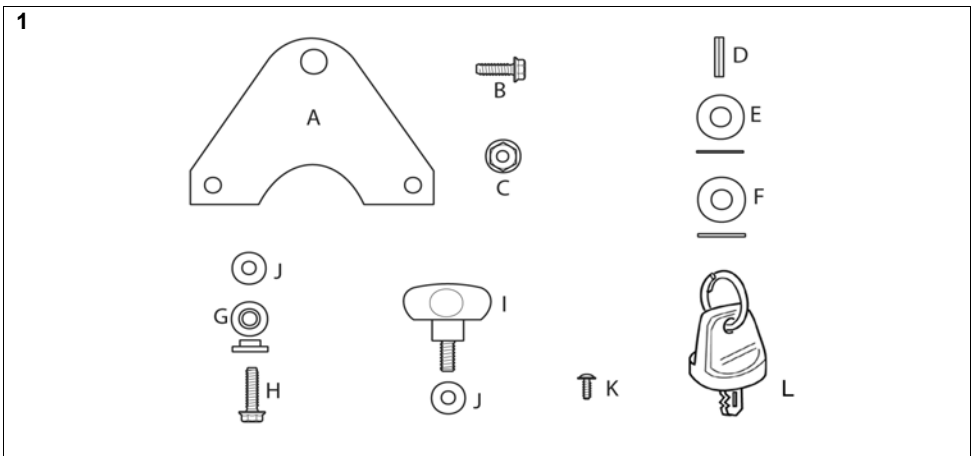

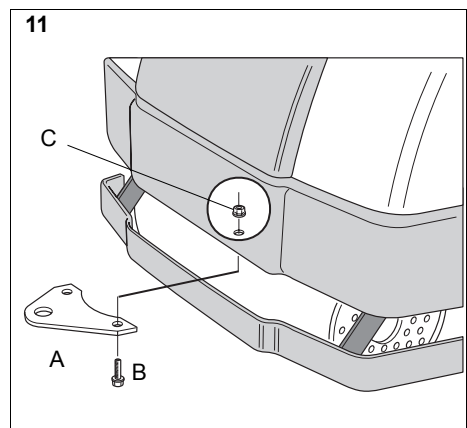
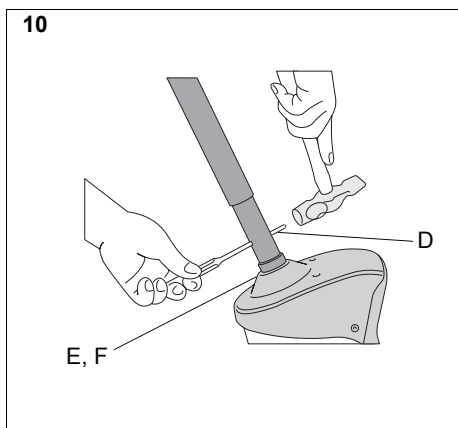
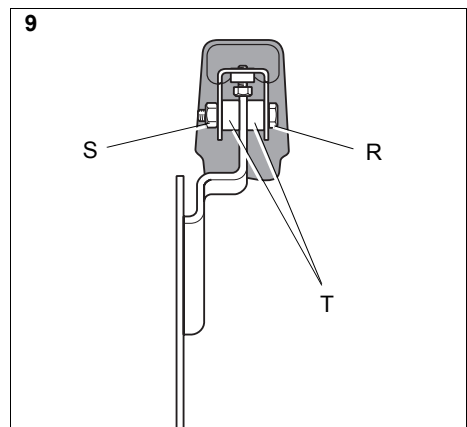
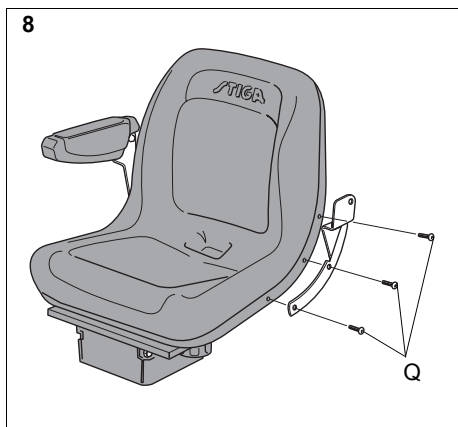
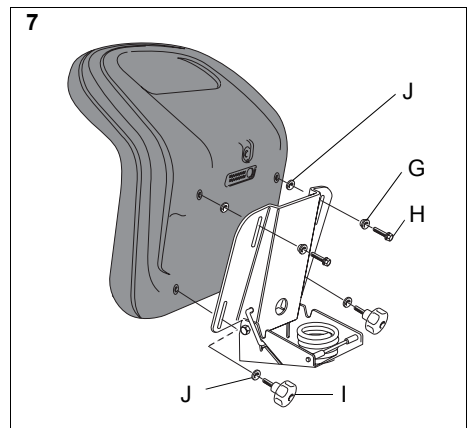
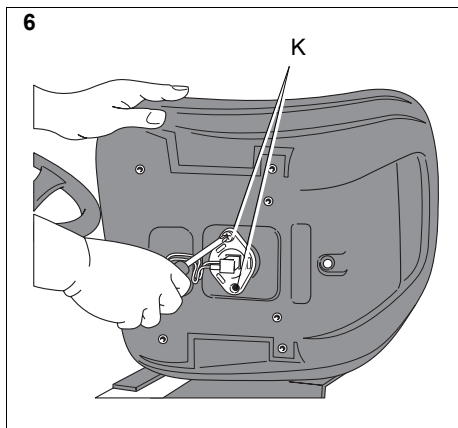

1 GENERAL



This symbol indicates **WARNING**. Personal injury and/or damage to property may result if the instructions are not followed carefully.



You must read these instructions and the accompanying pamphlet "SAFETY INSTRUCTIONS" carefully, before the assembly begin.

2 ASSEMBLY



To avoid injury and damage to people and property, do not use the machine until all the measures in this instruction have been carried out..

2.1 Accessories bag

The machine is supplied with a plastic bag containing components which shall be used during the assembly. The bag contains (fig. 1):

Pos.	No.	Designation	Dimension
A	1	Drawing plate	
B	2	Screw	8 x 20
C	2	Nut	M8
D	1	Tension pin	6 x 36
E	1	Shim washer	16 x 38 x 0.5
F	1	Shim washer	16 x 38 x 1.0
G	2	Shoulder washer	
H	2	Screw	8 x 20
I	2	Knob	
J	4	Washer	8,4 x 22 x 1.5
K	2	Screw, Comfort, President, Excellently	
L	2	Ignition key	

2.2 Engine casing

To inspect and maintain the engine and battery, remove the engine casing. Dismantling:

1. Unscrew the fuel cap/fuel gauge.
2. Pull up the rubber strap at the front edge of the casing (fig. 2).
3. Carefully lift off the engine casing (fig. 3).

Assembly:

1. Place the casing over the lip on each side.
2. Make sure that the pins on the rear edge of the casing go down into the respective holes (fig. 4).
3. Secure the front edge of the casing with the rubber strap (fig. 2).
4. Finally, screw in the fuel cap/fuel gauge.



The machine may not be operated unless the engine casing is closed and locked. Risk of burns and crushing injuries.

2.3 Battery



Do not short circuit the battery's terminals. Sparks occur which can result in fire. Do not wear metal jewellery which can come into contact with the battery terminals.

In the event of damage to the battery casing, cover, terminals or damage to the strip covering the valves, the battery should be replaced.

The battery is a valve-regulated battery with 12 V nominal voltage. The battery fluid does not need to and cannot be checked or topped up. The only maintenance that is required is charging, for example after extended storage.

After charging the battery must be stored in a cool place.



The battery must be fully charged before being used for the first time. The battery must always be stored fully charged. If the battery is stored while discharged, serious damage will occur.

2.3.1 Charging with the engine

The battery can be charged using the engine's generator as follows:

1. Install the battery in the machine as shown below.
2. Place the machine outdoors or install an extraction device for the exhaust fumes.
3. Start the engine according to the instructions in the user guide.
4. Allow the engine to run continuously for 45 minutes.
5. Stop the engine. The battery will now be fully charged.

2.3.2 Charging using battery charger

When charging using a battery charger, a battery charger with constant voltage must be used.

Contact your dealer to purchase a battery charger with constant voltage.

The battery can be damaged if a standard type battery charger is used.

2.3.3 Installing the battery

1. Open the engine casing and position the battery in the appropriate place. See fig. 5.
2. Secure the battery in position.
3. First connect the red cable to the battery's positive terminal (+).
4. Connect the black cable to the battery's negative terminal (-).



If the cables are interchanged, the generator and the battery will be damaged.



The engine must never be driven with the battery disconnected. There is a risk of serious damage to the generator and the electrical system.

2.4 Seat switch (Comfort, President, Excellent)

See fig. 6. At the underside of the seat is a switch, which plays an important role in the machine's safety system located.

Assemble the switch as follows:

1. Loosen the switch from the cables.
2. Assemble the switch at the underside of the seat with the screws (K).
3. Reconnect the cables to optional pins at the switch.

2.5 Seat

See fig. 7. Install the mounting in the rear (upper) holes as follows:

1. Install the shoulder washers (G) on the screws (H).
2. Insert the screws through the slots in the bracket. Place a washer (J) between the seat and the bracket.
3. Tighten the screws in the seat. Tightening torque: 9 ± 1.7 Nm.



If the screws are tightened more than 9 ± 1.7 Nm, the seat will be damaged.

4. Check that the seat moves easily in the slots in the bracket.

Install the mounting in the front (lower) holes as follows:

1. Install a washer (J) on each knob (I).
2. Insert the knobs through the slots in the bracket and tighten by hand in the seat.
3. Fold the seat down and place it in the desired position.
4. Tighten the screw knobs (I) by hand.



The screw knobs (I) and the seat will be damaged if tools are used.

The seat can be folded. If the machine is parked outside when it is raining, fold the seat forward to protect the seat cushion from getting wet.

2.6 Arm rests (Pro20)

See fig. 8, 9. The arm rests and the installation components are supplied in a separate box. Assemble as follows:

1. Assemble the left and right mounts onto the seat. Use 3 screws (Q) supplied at each side.
2. Assemble the arm rests with screws (R), nuts (S) and spacers (T).
3. Tighten the screws so that the arm rests simply can be folded up/down.

2.7 Steering wheel

See fig. 10. In order to minimise the axial play in the steering column, the shim washers (E) and/or (F) must be installed on the steering column between the steering column jacket and the bracket as follows.

1. Install the steering column jacket on the steering column and secure by knocking in the tension pin (D) approximately 1/3 of its length.
2. Pull the steering column jacket and the steering column up.
3. From the outside, check whether no washers, the 0.5 mm washer, the 1.0 mm washer or both washers can be inserted into the gap. The washer/washers must not be forced in, as there must be a little axial play.
4. Pull out the cotter pin and dismantle the steering wheel jacket.
5. Install the washer/washers in accordance with point 3 above.
6. Install the steering column jacket on the steering column and secure by knocking in the tension pin fully. Use a counterhold.

2.8 Towing hitch

See fig. 11. Screw the towing hitch (A) into the two holes on the underside of the rear axle using screws (B+C). Tighten the screws properly.

Tightening torque: 22 Nm.

2.9 Tyre pressure

Check the air pressure in the tyres. Correct air pressure:

Front: 0.6 bar (9 psi)

Rear: 0.4 bar (6 psi)

2.10 Accessories

For the installation of accessories, see separate installation guide supplied with each accessory.

Note: The cutting deck is regarded as an accessory here.



www.stiga.com

GGP Sweden AB • Box 1006 • SE-573 28 TRANÅS