

OPERATOR'S MANUAL

SNAPPER MOWER

MODELS SV181 - V181 - V181S
SV211 - V211 - V211S - V2114

IMPORTANT SAFETY INSTRUCTIONS

WARNING: Failure to comply with the following instructions may result in serious injury to the operator or other persons. The owner of the mower must understand these instructions and, furthermore, must allow only persons who understand these instructions to operate the mower. Any person operating the mower must be of sound mind and body and must not be under the influence of any substance which might impair vision, dexterity, or judgement.

TRAINING

1. Read this Manual carefully. Be thoroughly familiar with the controls and proper use of the mower.
2. Never allow children to operate a power mower.
3. Keep the area of operation clear of all persons, particularly small children, and pets.

PREPARATION

1. Never operate mower without proper guards, plates, safety switches, or other safety protective devices in place and properly connected. Inspect to determine that these safety devices are installed properly, are in good repair, and operate properly. If the condition or operation of these devices are questionable, they must be repaired or replaced before using the mower.
2. Thoroughly inspect the area where the mower is to be used and remove all stones, sticks, wire, bones and other foreign objects. Also note the location of holes, stumps, and other possible hazards.
3. Do not operate mower when barefoot or wearing open sandals. Always wear substantial footwear and long pants.
4. Fill gasoline tank before starting engine. Use approved gasoline container. Do not smoke near open gasoline container. Do not fill gasoline tank indoors or when engine is running. Allow engine to cool for at least ten minutes before refilling. Wipe off any spilled gasoline before starting engine. Do not run engine indoors.
5. Never attempt to make a wheel height adjustment while the engine is running.
6. When mowing over rough ground or in tall grass, mower must be set in highest cutting position.
7. Mow only in daylight or in good artificial light.
8. Never operate mower in wet grass. Always be sure of your footing; keep a firm hold on the handle and walk; never run.

OPERATION

1. Do not change engine governor settings or overspeed engine.
2. Do not put hands or feet near or under rotating parts. Keep clear of discharge area while engine is running.
3. Stop engine when crossing gravel drives, walks, or roads, and under any conditions where thrown objects might be a hazard.
4. After striking a foreign object or if mower vibrates abnormally, stop the engine, disconnect and secure spark plug wire. Inspect the mower for any damage and repair the damage.
5. Stop engine whenever you leave the operating position behind the handle for any reason, including emptying grass bag and making any adjustments, repairs, or inspections.
6. Before cleaning, repairing or inspecting, make certain blade and all moving parts have stopped. Disconnect and secure spark plug wire away from plug to prevent accidental starting.
7. Stop engine and wait until the blade comes to complete stop before removing grass bag and/or unclogging chute.
8. Mow across steep slopes, never up-and-down. Exercise caution when changing directions on slopes. Do not mow excessively steep slopes.

MAINTENANCE AND STORAGE

1. Keep all nuts, bolts, and screws tight to be sure mower is in safe operating condition.
2. Never store mower with gasoline in the tank inside of a building where fumes may reach an open flame or spark. Allow engine to cool before storing in any enclosure.
3. To reduce fire hazard keep mower free of grass, leaves or excessive grease.
4. Check grass bag assembly frequently for wear or deterioration. Replace with new bag if loose seams or tears are evident. Replace slider or bag chute if broken or cracked.
5. Have your mower inspected and serviced each year by an authorized Snapper dealer. Determine if any additional devices are available which might upgrade the safety of your mower.
6. Factory specified Snapper replacement parts must be used to assure adequate protection against injury.

ASSEMBLY

HANDLES

1. Pull up and back on lower handle pivoting, Item No. 52. Tighten the two 5/16" wing nuts, Item No. 61.
2. Fasten upper handle, Item No. 56, to lower handle pivoting, Item No. 52, using two 1/4"-28 x 1-1/2" hex head cap screw, Item No. 54, two 1/4" internal tooth lock washers, Item No. 58, and two 1/4"-28 hex nuts, Item No. 51.

THROTTLE CONTROL

1. Fasten throttle control to outside of upper handle, Item No. 52, using one 1/4"-28 x 1-3/4" hex head cap screw, Item No. 21, one 1/4" internal tooth lock washer, Item No. 58, and one 1/4"-28 hex nut, Item No. 51.
2. Fasten throttle control conduit to handles using clips, Item No. 53.

GRASS BAG

1. Disconnect spark plug wire.
2. Place roll bar, Item No. 45, with off-set side on right hand side into slots in rear wheel brackets, Item No. 43, top part will lay down close to engine, raise up allowing ends to drop through the slots into holes below.
3. Place grass chute, Item No. 4, onto deck with stud nearest to caution passing through hole in chute. Make sure captive carriage bolt drops into slot in the bracket, Item No. 6, next to the right front wheel. Also make sure that chute is pushed straight downward so that ground contact of the interlock switch, Item No. 28, deflects and permits engine to be started. Place clamp, Item No. 26, with slotted end to rear, over the front stud. Secure with 5/16" flat washer, 5/16" lock washer, and one 5/16 x 18 hex nut. See page 7.
4. Place 5/16"-18 x 1" carriage bolt, Item No. 60, through hole in deck which is located at rear of discharge opening, and through hole in plastic chute. Secure clip, Item No. 68, with one 5/16" flat washer, one 5/16" lock washer, and one 5/16" x 18 hex nut. (NOTE: Head of carriage bolt should be to inside of deck).
5. Slip the ends of front wire, Item No. 3, through the front flap of the bag and hook over the roll bar. Slip the ends of the rear wire, Item No. 1, into the rear flap of the bag and hook over top section of lower handle. Top of bag should be slack for best performance. Tension along top of bag may be relieved by bending roll bar backwards slightly. Tie slider cord to rear bag wire.
6. Slip the inlet end of the bag over chute as far as possible. Do not allow side of bag to block discharge opening of chute.

SIDE CHUTE

1. Remove spark plug wire.
2. Attach side chute extension, Item No. 64, to side chute, Item No. 8, using four 10/32" hex nuts, Item No. 65, four 10/32" x 5/16" round head machine screws, Item No. 67, and four 10/32" internal

tooth lock washers. (NOTE: Heads of bolts must be to inside of chute). See page 7.

3. Grip metal side chute with both hands, slightly squeezing together, slip large slot over mounting key in deck, and captive carriage bolt into slot in bracket, Item No. 6. Also be sure that chute is pushed straight downward so that ground contact of interlock switch, Item No. 28, deflects and permits engine to be started.
4. Use one of the clamps, Item No. 26, to hold the top down at the front stud. Use the other clamp to go over the rear stud and into the small slot in side chute. Fasten with three 5/16" flat washers, three 5/16" lock washers and three 5/16"-18 hex nuts.

ADJUSTMENT

CUTTING HEIGHT

1. This mower has solid through axles front and rear to give superior strength and wheel alignment. Thus, with the through axle design, it is necessary to walk the height latches one notch at a time, side to side, when it is desired to change the cutting height.
2. Setting the rear height latches one notch lower than the front will improve performance by raising the rear of the deck.

NOMINAL CUTTING HEIGHT — INCHES NOTCHES FROM THE TOP

	1	2	3	4	5	6
18" — 1"	1 1/2"	2"	2 3/8"	2 3/4"	3 1/8"	
21" — 7/8"	1 1/4"	1 3/4"	2 1/4"	2 3/4"	3 1/8"	

OPERATION

STARTING ENGINE

1. Fill engine with SAE detergent 30 Wt. engine oil.
2. Fill gas tank with leaded or unleaded regular gas.
3. Move throttle control to "START", place foot on deck that is marked "PLACE FOOT HERE WHEN CRANKING". Pull starter rope rapidly.
4. On electric start models, move throttle to start, turn key to start, release when engine starts.
5. **IF ENGINE DOES NOT START, CHECK INTERLOCK SYSTEM.**

GRASS BAG

1. Grass bag should be emptied before chute is allowed to clog. When the chute begins to clog, air pressure ceases to push the top of the bag upward and the sound of the engine changes.
2. The first and most important step in emptying the grass bag is to STOP THE ENGINE AND PAUSE UNTIL THE BLADE STOPS ROTATING.
3. Stop engine. Grasp the front wire, Item No. 3, with

one hand, then the rear wire, Item No. 1, with the other hand, unhook and lift up, pulling the grass bag opening off of the grass chute.

4. To empty the grass bag, grasp the bag with one hand and pull off the slider, Item No. 22, with the other hand.
5. Replace the grass bag, re-fold the rear of the bag and replace slider before starting engine. See the illustration on page 6.

GENERAL

1. SNAPPER V211 will cut either forward or backward. However, due to the set of the blade, slightly less power is required for forward cutting than for reverse cutting.
2. To turn at end of row, push down on handle bars to raise front wheels off of the lawn. This permits turning on the back wheels only and saves scuffing the lawn.
3. For cutting on slopes, it is usually best to move side to side only — not up and down hill.
4. When vacuuming a paved walk or driveway, first lower deck to lowest position. It is then best to run the V211 forward along the extreme left hand side of the area to be cleaned. This will pick up some litter and windrow some litter to the right of the first swath.

MAINTENANCE

GENERAL

1. Refer to engine manual furnished with this packet of instructions, to oil, fuel, and maintain the engine properly.
2. Never place mower on its left hand side with spark plug pointed downward as this will allow the engine oil to run out through the valve tappet vent. If left too long, oil could also leak past the piston into the cylinder.
3. Have your mower inspected and serviced each year an authorized Snapper dealer. Determine if any additional devices are available which might upgrade the safety of your mower.
4. Factory specified Snapper replacement parts must be used to assure maximum protection against injury.
5. To prolong the life and usefulness of your mower, it is a good practice to wash out all of the grass that may be sticking to the underside of the deck.

LUBRICATION

1. Change oil as specified in engine manual.
2. Occasionally put a few drops of oil on all moveable parts.
3. The ball bearing wheels have been factory greased and should not be greased unless removed.

OPTIONAL ACCESSORIES

The optional accessories listed below are available from your Snapper dealer. These kits will add to your convenience and extend the use of the product. Any of these kits may be installed in less than ten minutes using standard household tools.

1. SIDE CHUTE KIT 6-0257 (for V181 series); 6-0258 (for V211 series). This kit consists of a metal chute and fasteners to permit conversion of the mower to side discharge operation.
2. ZIP KIT 6-0254. This kit consists of a plastic coated metal hoop which may be installed on the rear end of the grass bag. Its purpose is to permit fast transfer of the clippings directly into a standard disposable trash bag.
3. SNAPPERIZER KIT 6-0255 (for V211 series only). This kit consists of an expanded metal shredder plate, a bottom plate, and attaching hardware. Its purpose is to convert the mower into an outdoor vacuum and leaf shredder.
4. GRASS BAG KIT 6-0248 (for SV211 series) and 6-0259 (for SV181 series). This kit consists of a grass bag, roll bar, plastic chute, and fasteners to permit conversion of the mower to grass bagging operation.

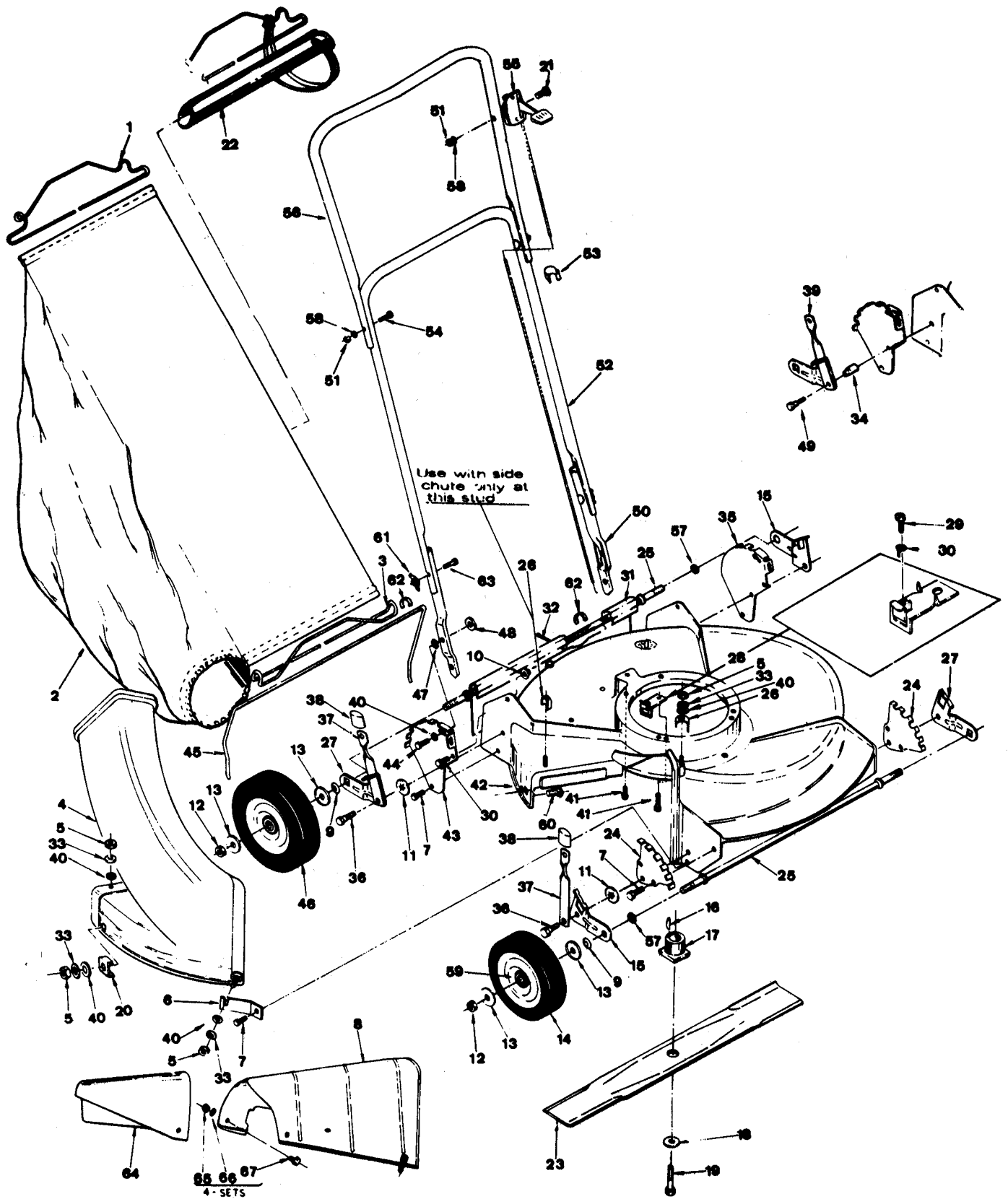

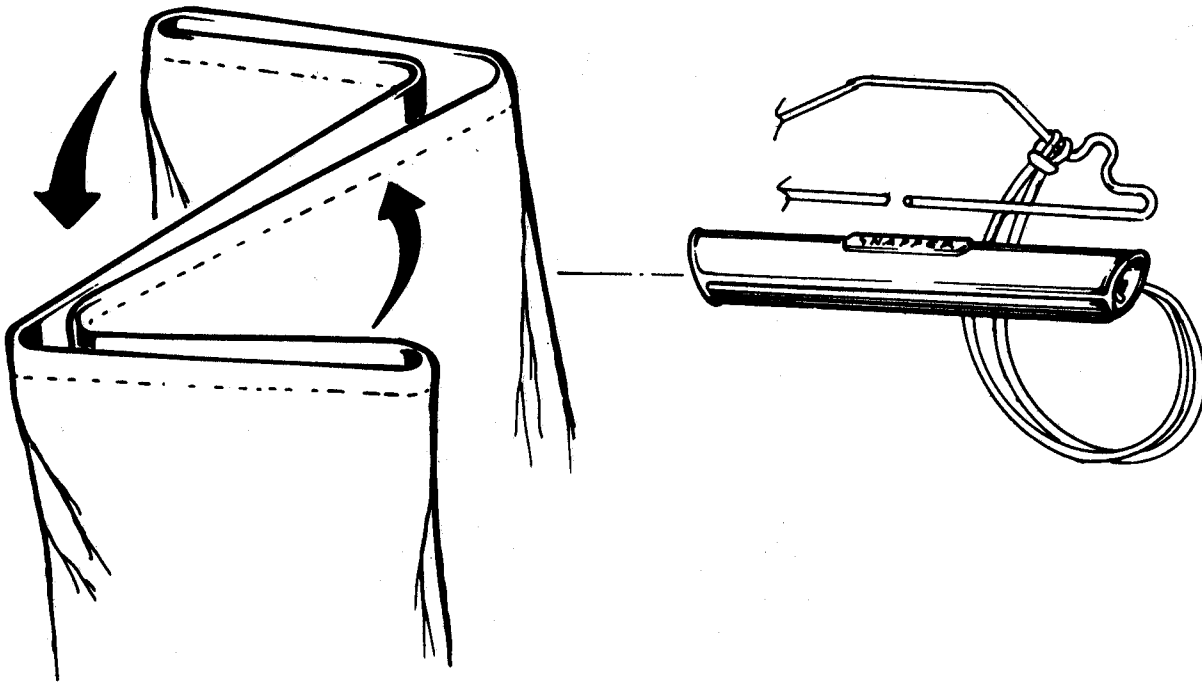

BAG CLOSING INSTRUCTIONS

1. Fold into Z shape as shown, keeping edges aligned.
2. Hold edges together while pushing on slider. Be sure all edges are inside of slider.

V SERIES

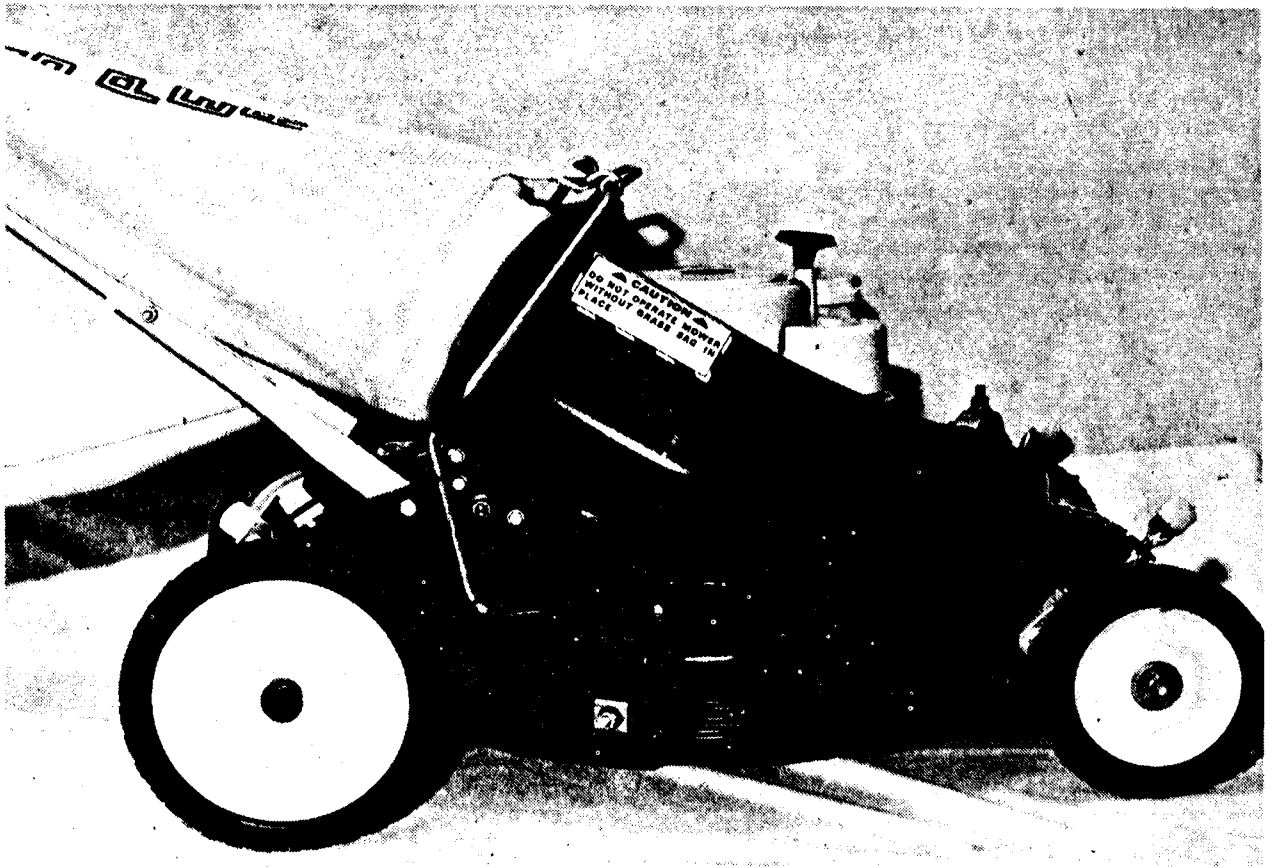

SV SERIES

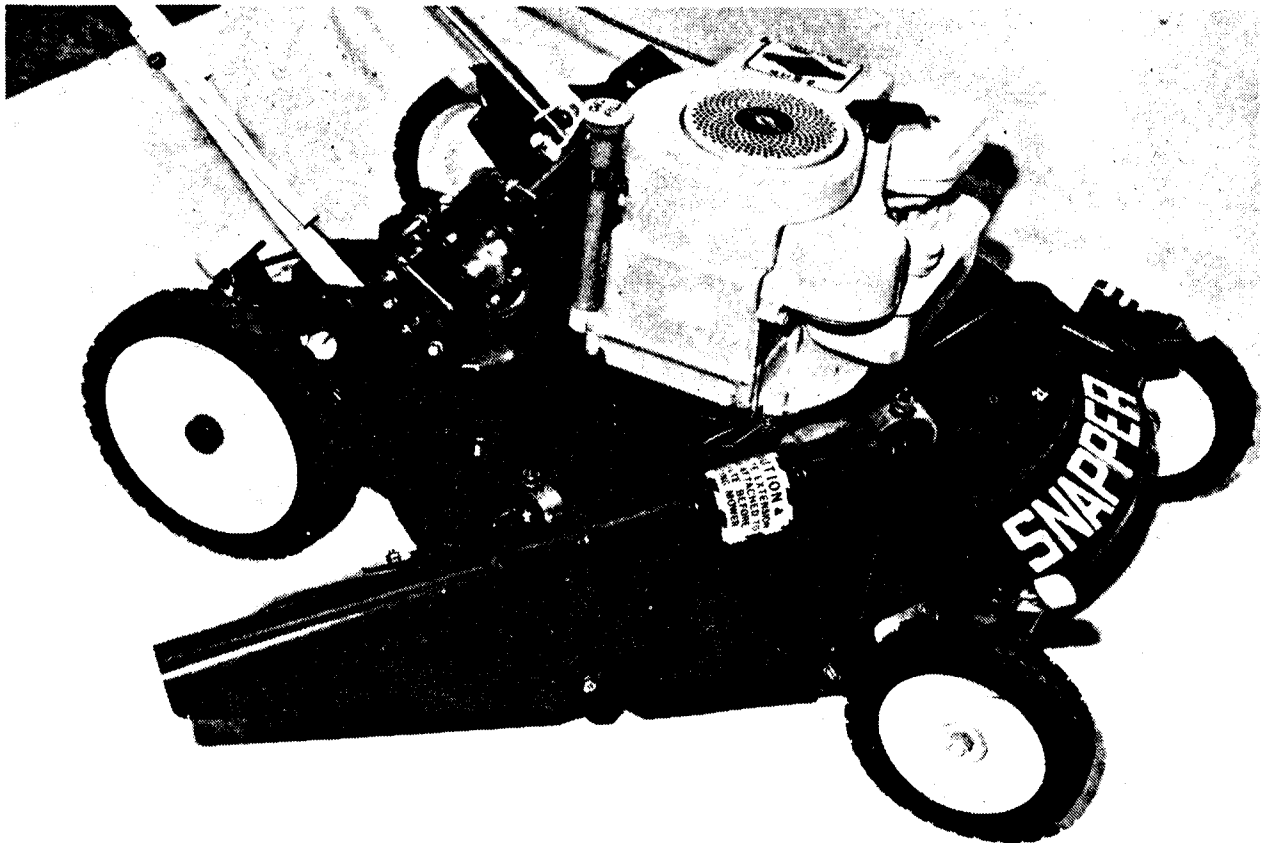

THANK YOU FOR BUYING A SNAPPER PRODUCT!

We have designed and built this machine with utmost care, and it is intended to give you long and satisfactory service.

Any mechanical device can be potentially dangerous if not used properly. No accident prevention program can be successful without the wholehearted co-operation of the person who is directly responsible for the operation of the equipment. Study this operator's manual to learn the operation of the controls and observe all safety precautions. Only use this machine for the purpose it is intended. By following these instructions and safety precautions you should enjoy the long and trouble free operation you expect.

LIMITED WARRANTY

For one year from purchase date for a non-commercial user, or for 30 days from purchase date for a commercial user, McDonough Power Equipment, Inc., through any factory authorized service dealer, will replace for the original purchaser, free of charge, any part or parts, found upon examination by the factory at McDonough, Georgia, to be defective in material or workmanship or both.

All transportation cost incurred by the purchaser in submitting material to an authorized service dealer for replacement under this warranty must be borne by the purchaser.

This warranty does not apply to engines and their components, as these items are warranted separately by their manufacturers. Neither does it apply to parts that have been damaged by accident, alteration, abuse, improper lubrication, normal wear, or other cause beyond our control.

There is no other express warranty.

Implied warranties, including those of merchantability and fitness for a particular purpose, are limited to one year from purchase for non-commercial users, and for 30 days from purchase for commercial users and to the extent permitted by law any and all implied warranties are excluded. This is the exclusive remedy. Liabilities for consequential damages under any and all warranties are excluded.

WARNING: Use of replacement parts other than genuine Snapper parts may impair the safety of your mower and will void our warranty.

IMPORTANT: This warranty is void unless the warranty card attached is filled out completely and mailed to the Factory within 10 days of purchase date.

IT IS THE POLICY OF McDONOUGH POWER EQUIPMENT, INC. TO IMPROVE ITS PRODUCTS WHENEVER IT IS POSSIBLE AND PRACTICAL TO DO SO. WE RESERVE THE RIGHT TO MAKE CHANGES OR ADD IMPROVEMENTS AT ANY TIME WITHOUT INCURRING ANY OBLIGATION TO MAKE SUCH CHANGES ON PRODUCTS MANUFACTURED PREVIOUSLY.

McDONOUGH POWER EQUIPMENT, INC.



McDONOUGH, GA., U. S. A., 30253