

SET-UP INSTRUCTION & PRE-OPERATION CHECKLIST

SNAPPER 21" STEEL DECK COMMERCIAL RECYCLING WALK MOWERS

INTRODUCTION: The SNAPPER Walk Behind Mowers are shipped almost fully assembled and require minimal set-up. Complete each of the following steps carefully. Review and complete each item as instructed on the Pre-Operation checklist. The Snapper Product Registration card must be filled out and sent to Customer Service department at Snapper when completed.

WARNING – DO NOT ATTEMPT TO START OR OPERATE THIS UNIT UNTIL ALL ASSEMBLY STEPS HAVE BEEN COMPLETED. SERIOUS INJURY OR EQUIPMENT DAMAGE MAY RESULT.

HANDLE ASSEMBLY

STEP 1: Remove mower from shipping carton. These mowers are manufactured with (4) 5/16-18 x 2" hex cap screws, and (4) 5/16 bolt retainers that secure the upper, middle handles and lower handle brackets together for packaging purposes. This hardware will have to be removed and discarded. See Figure 1.

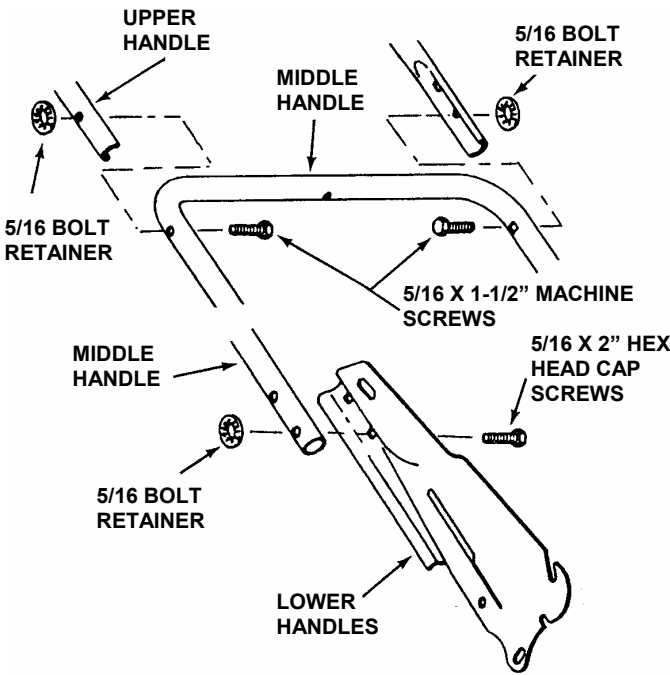

REMOVE EXISTING HARDWARE

FIGURE 1

STEP 2: New hardware can be found in hardware bag. Attach middle handle to lower handle brackets using 5/16-18 x 2" curved head bolts, installed from the inside of handles as shown, and secure with 5/16 internal tooth lock washers and hex nuts. Do Not tighten at this time. See Figure 2.

STEP 3: Attach the upper handle assembly to the middle handle using 5/16-18 x 1-1/2" curved head bolts, installed from the inside of handles as shown, and secure with 5/16 internal tooth lock washers and hex nuts. Do Not tighten at this time. See Figure 3.

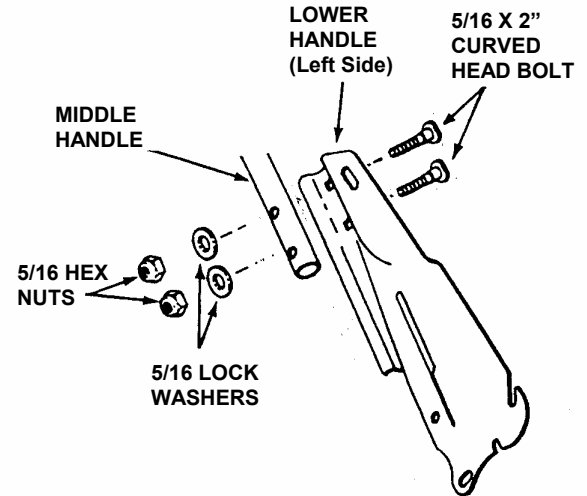

FIGURE 2

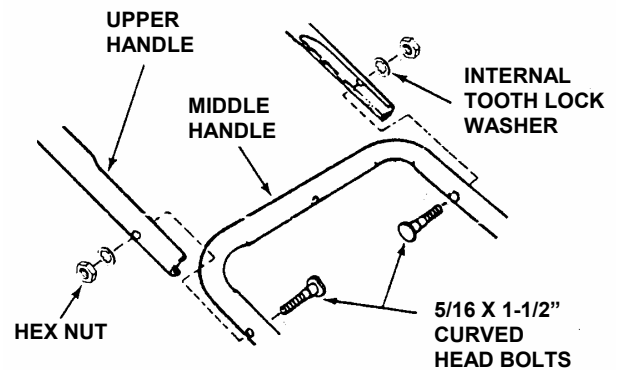

FIGURE 3

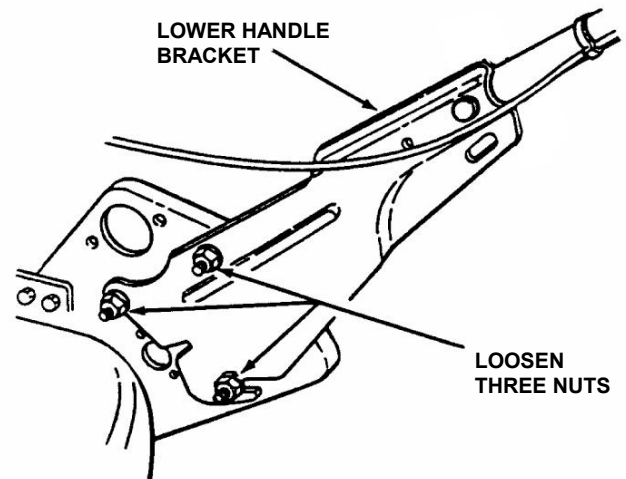

FIGURE 4

STEP 4: To adjust handle height loosen bolts on both lower handle brackets. See Figure 4. Move handles up or down for desired height. See Figure 5. Tighten all bolts and nuts on all handles and brackets.

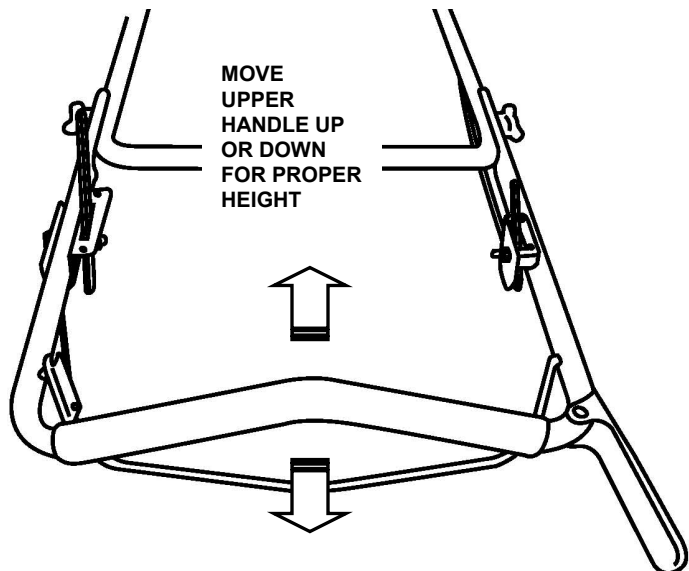

FIGURE 5

STEP 5: Install handle braces between lower handles and drive disc bracket on back of mower deck. See Figure 6. Align top hole of each brace with slotted hole in top portion of each lower handle, and secure with 5/16-18 x 3/4" hex washer head bolt and flange nut. Align hole in bottom of both braces with hole in rear of drive disc bracket, securing with same hardware as above. Tighten securely. NOTE: Attach bottom of both braces to outside of drive disc bracket.

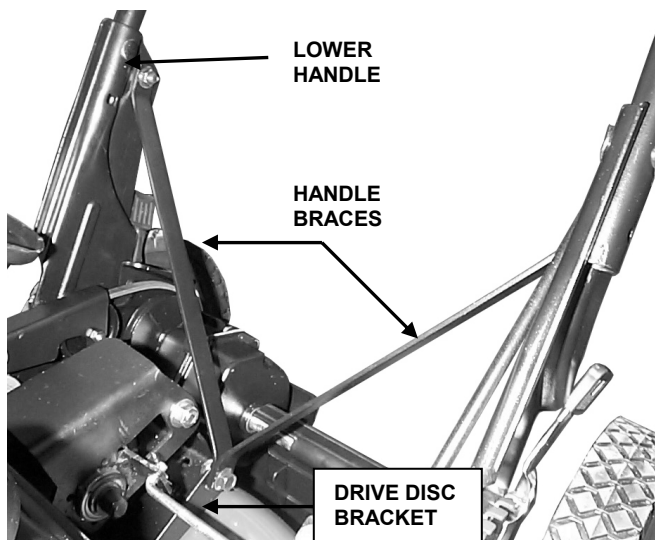

FIGURE 6

STEP 6: Squeezing brake control against upper handle, grasp engine recoil and pull firmly past recoil rope guide on right side of upper handle. Hook recoil rope into eye of rope guide. See Figure 7.

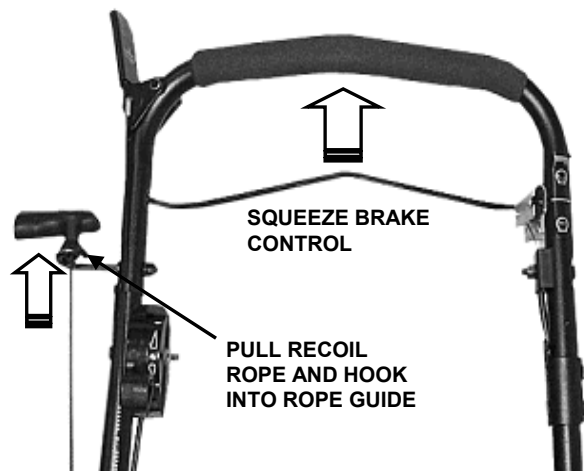

FIGURE 7

STEP 7:

1. Install Operator console onto upper handle section with four 1/4-20 x 1/2" torx screws. See Figure 8.
2. Firmly press Engine speed handle onto right lever as shown.
3. Slip ground speed handle onto left lever as shown, securing with one 8-32 x 1/2" round head machine screw and hex nut. (Be sure nut sets into hexagonal depression in side of handle.)

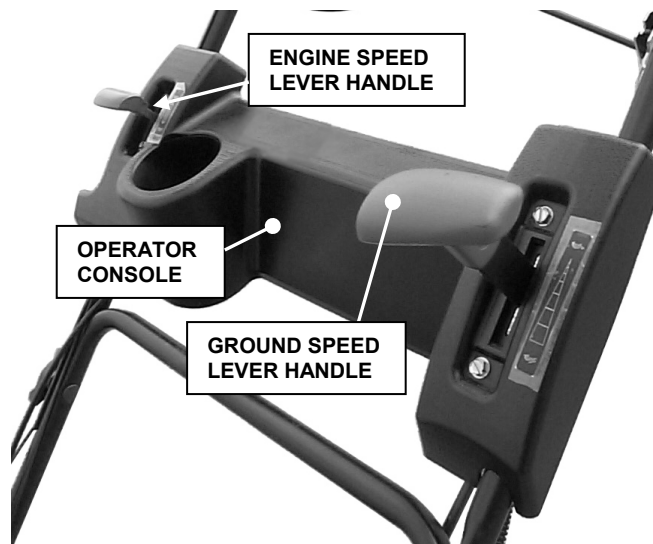

FIGURE 8

DRIVE ASSEMBLY

STEP 1:

1. Remove driven disc spring from driven disc assembly as shown. See Figure 9.

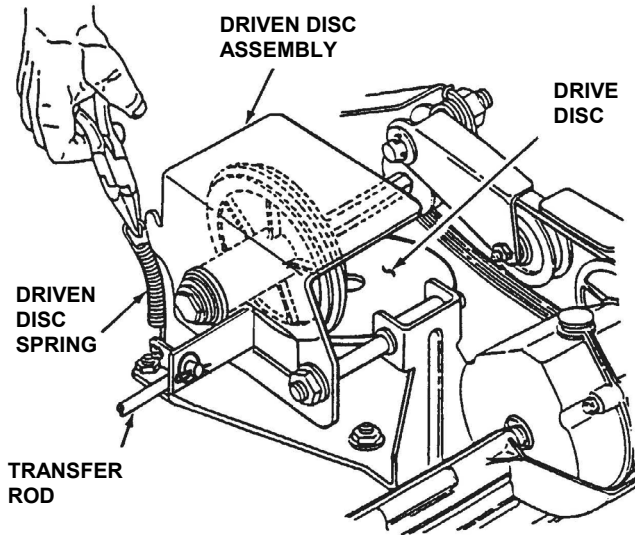

FIGURE 9

2. Manually adjust driven disc to position shown in Figure 10.

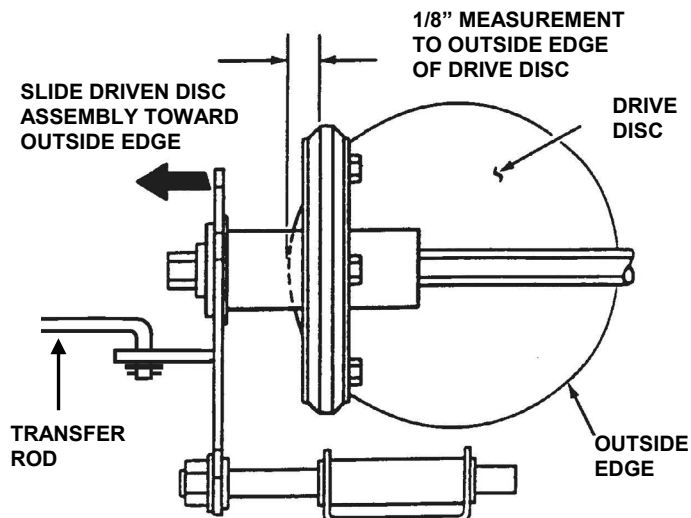

FIGURE 10

3. Slide Ground speed control lever fully forward. See Figure 11.
4. Install threaded end of Ground speed control rod, fitted with one 1/4-28 jam nut, into ball joint on end of speed control pivot arm. See Figure 12. **IMPORTANT: Do not move pivot arm.**

5. Thread rod in until upper end of rod aligns with hole in bottom of ground speed control lever. See Figure 11. Insert upper end of rod into hole, and secure with 5/16" flat washer and hair pin.
6. Slide Ground speed lever back, then fully forward again. Check driven disc position. If needed, repeat #5 above until 1/8" in Figure 10 is maintained, then tighten jam nut securely against ball joint.
7. Replace driven disc spring to driven disc assembly. See Figure 9.

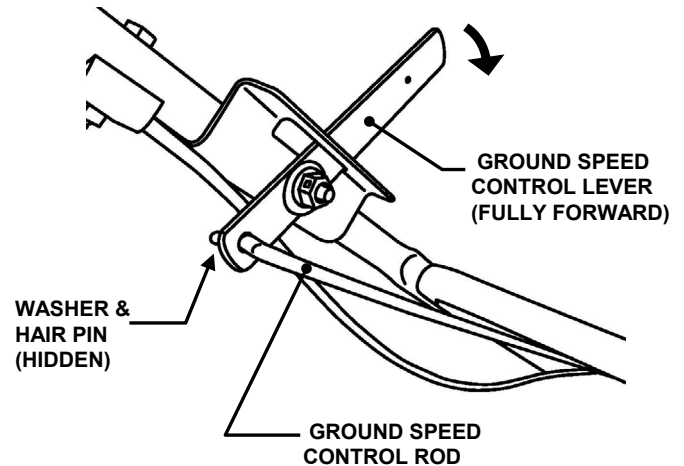

FIGURE 11

(Operator Console and Ground speed handle removed for clarity)

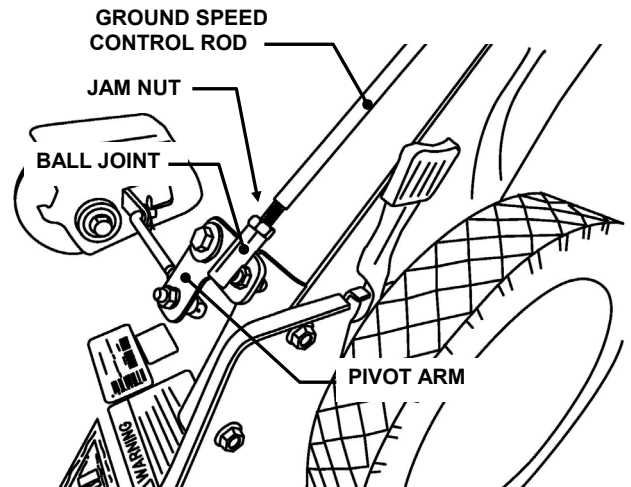

FIGURE 12

STEP 2:

IMPORTANT: Clutch cable adjustments are made to the machine at the factory. The following adjustments are provided for reference only. Complete all items on the Pre-Operation Checklist as instructed.

Check the clearance between the clutch cable and clutch spring. **NOTE:** Clearance between spring and cable is very important. Excessive clearance will cause drive system NOT to operate when wheel drive control handle is depressed. No clearance at all will cause mower to continue to propel itself when wheel drive control handle is released to stop mower movement. Slide vinyl spring cover (located at the end of clutch cable) up clutch cable to gain access to the end of spring and cable loop. With wheel drive control handle released, clearance between spring hook and cable loop should be $1/16''$ to $1/8''$. If clearance is more or less than specified, unhook spring from clutch cable eye, then adjust by turning inner spring in an opposite direction than the outer spring. Rehook spring to clutch cable eye. Slide vinyl cover over the spring when correct clearance is reached. See Figure 13.

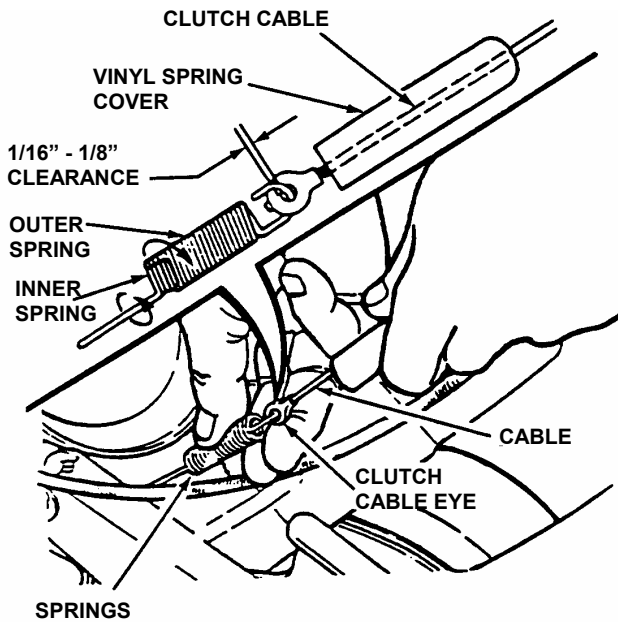

FIGURE 13

DISCHARGE ASSEMBLY

NOTE: Discharge assemblies vary by model. Some assembly steps shown may not apply to your model.

Your mower comes with a recycling cover already installed, and is ready for use as a recycling mower. The recycling cover is designed to remain on the machine at all times, unless alternate discharge operations are desired, such as side discharging or bagging. Recycling cover can be removed to accommodate alternate discharge components.

TO CHANGE DISCHARGE COMPONENTS:

STEP 1: Remove knob nuts and internal/external tooth lock washers securing rear of recycling cover to mower deck. Remove cover. See Figure 14.



FIGURE 14

STEP 2: Install desired discharge component / assembly.

A. SIDE DISCHARGE DEFLECTOR

Install deflector to deck in place of recycling cover, making sure that: 1) hole on outside front of deflector fits onto stud in front of discharge opening where front of recycling cover was originally installed, 2) slot on inside front of deflector slips under restraining nut on top of deck (under right front corner of engine), and 3) slot on inside rear of deflector slips onto stud behind rear of discharge opening, where rear of recycling cover was originally secured. See Figure 15. Install internal/external tooth lock washers and knob nuts on studs and tighten securely.

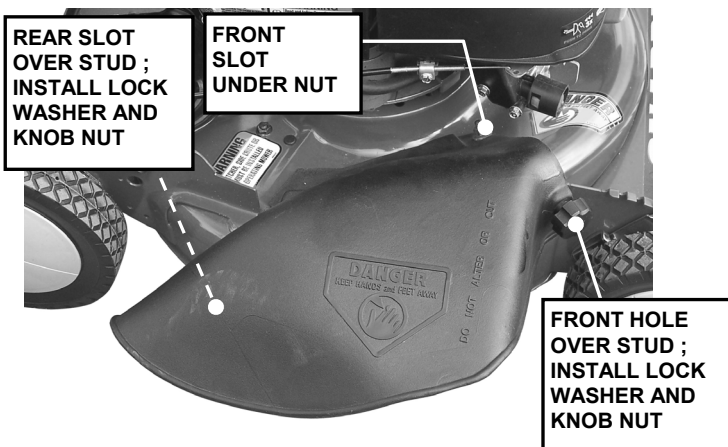

FIGURE 15

B. GRASS BAG

(Optional Accessory on Some Models)

1: Install grass bag adapter to the deck in place of recycling cover. See Figure 16. Refer to side discharge deflector installation instructions.

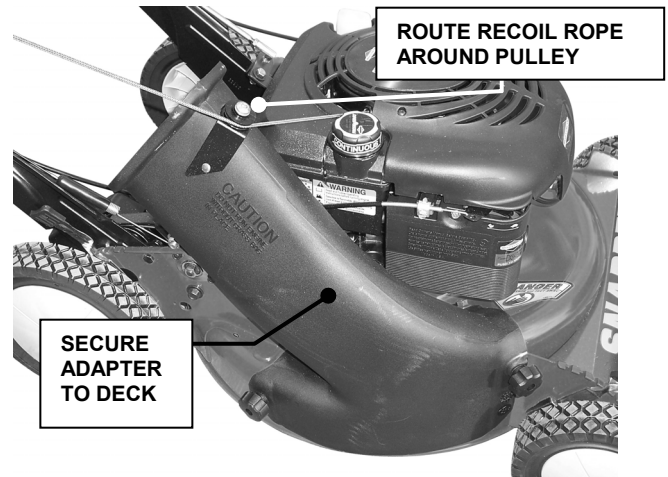

FIGURE 16

1a: Attach Bag Adapter Standoff between rope guide pulley assembly and engine recoil. See Figure 16a.

- A. Remove right rear bolt from engine recoil cover.
- B. Remove torx screw and nut securing rope guide pulley to bracket on bag adapter.
- C. Lay standoff between bolt holes in engine recoil cover and bag adapter pulley bracket. **NOTE:** position standoff so that bent end is toward engine recoil cover.
- D. Flip pulley over so that flange of steel bushing is under pulley. (The bushing will act as a washer between the pulley and standoff.)
- E. Reassemble pulley to bag adapter, and install supplied replacement bolt, fitted with thread sleeve, into recoil cover. Tighten all hardware securely.

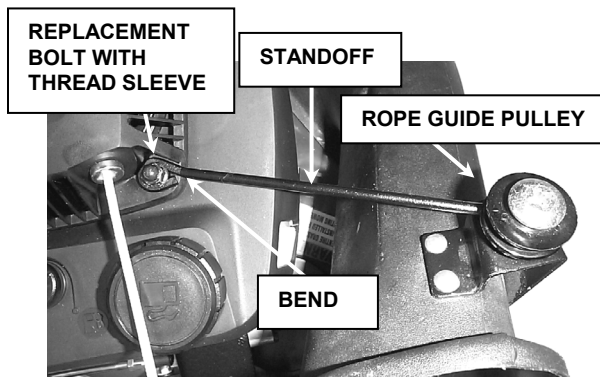

FIGURE 16a

2: Route recoil rope around outside of rope guide pulley. (NOTE: Recoil rope may need to be slackened. Refer to "Handle Assembly".)

3: Install the top wire to the grass bag. Tie the slider to the top wire. Fold bag opening into a "Z" and install slider. See Figure 17.

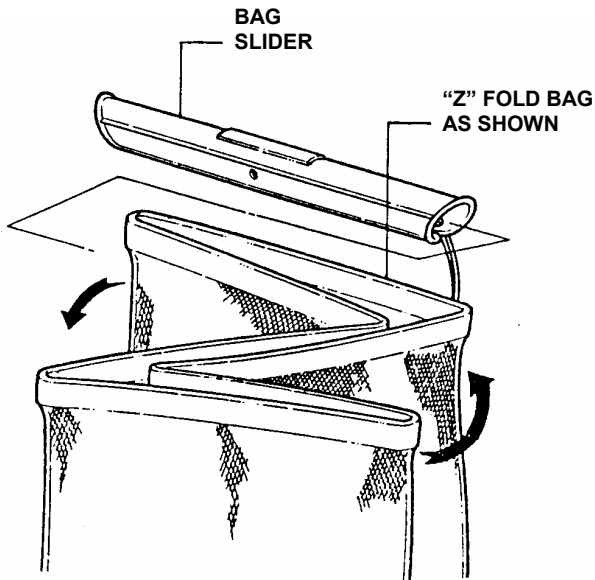

FIGURE 17

4: Install grass bag on the mower as shown in Figure 18.

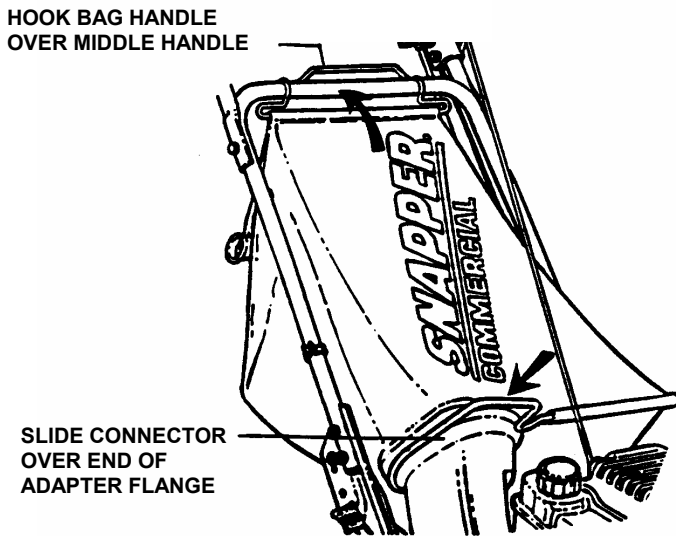

FIGURE 18

FOAM BLADE BLOCK REMOVAL

Tip mower back against the upper handle to gain access to the underside of the cutting blade. Remove foam shipping block from cutting blade. This must be removed before starting the engine.

IMPORTANT: DO NOT tip machine with carburetor or spark plug down. Oil from crankcase will saturate the air filter and cause the engine to be hard to start or not start at all. If contamination does occur, the air filter will have to be replaced.

Assembly is complete. Complete all items on the Pre-Operation Checklist as instructed.

WARNING

DO NOT operate without entire Grass Catcher or guard in place. Grass Catcher components are subject to deterioration during normal use. Inspect frequently and replace worn or damaged components immediately.

PRE-OPERATION CHECKLIST for SNAPPER 21" STEEL DECK COMMERCIAL RECYCLING WALK MOWERS

Snapper has completed initial adjustments and performed operational tests prior to shipping the machine. Due to the possible effects of shipping, handling and storage, Snapper intends for all of the following items to be verified and necessary final adjustments made at time of setup. It remains good practice and is strongly recommended that all the items also be checked prior to placing the machine into service. It is very important that setup is verified and all operational tests completed and results are acceptable. After completing this form, sign and retain for future reference.

SET-UP (Details on Pages 1 through 4 of this Instruction)

- _____ FOAM SHIPPING BLOCK removed from cutting blade.
- _____ UPPER HANDLE & LOWER HANDLE secured in place and hardware tightened securely.
- _____ RECOIL ROPE hooked into rope guide on handle.
- _____ OPERATOR CONSOLE installed, engine speed and ground speed handles installed.
- _____ DRIVE ASSEMBLY COMPONENTS installed and adjusted correctly.
- _____ RECYCLING COVER, SIDE CHUTE or GRASS BAG installed correctly on mower.
- _____ BLADE retaining bolt(s) checked and tighten securely. (40 ft. lbs. recommended.)

LUBRICATION

- _____ ENGINE OIL added to bring level up to full mark on 4-cycle engines (Refer to Engine Manual).
- _____ OIL mixed with FUEL in specified ratio (2 Cycle Engines Only).
- _____ DIFFERENTIAL grease checked and added if needed.

OPERATIONAL TEST

- _____ ENGINE started, engine control settings checked and adjusted as needed.
- _____ WHEEL DRIVE checked for proper operation and adjusted as needed.
- _____ DRIVE DISC adjustment checked and made.
- _____ GROUND SPEED control checked.

CPSC (Consumer Product Safety Commission) COMPLIANCE TEST

- _____ BLADE CONTROL stops engine when released.

CONSUMER INFORMATION

Purchase Date _____ Model _____ Serial No. _____

Retailers Name _____ Signature _____

Address _____ City _____ State _____ Zip _____

MOWER WILL BE USED COMMERCIALY? _____ YES _____ NO

Purchaser's Name _____ Signature _____

Address _____ City _____ State _____ Zip _____

IMPORTANT: This form is to be retained for future reference regarding Warranty, proof of purchase, traceability for product recall or service, etc. Complete the Product Registration Card and Mail to Customer Service Department at SNAPPER, P.O. BOX 1379, McDonough, Georgia, 30253.

INSTRUCTION No. 7100374 (I.R. 1/11/2006)
TP 300-5113-IR-CW-N