

*Parts Manual for*  
**SNAPPER®**

**HIGH-WHEEL WALK BEHIND  
MULCHING KIT**

<b>MODEL</b>
<b>63092</b> <b>7063092</b>

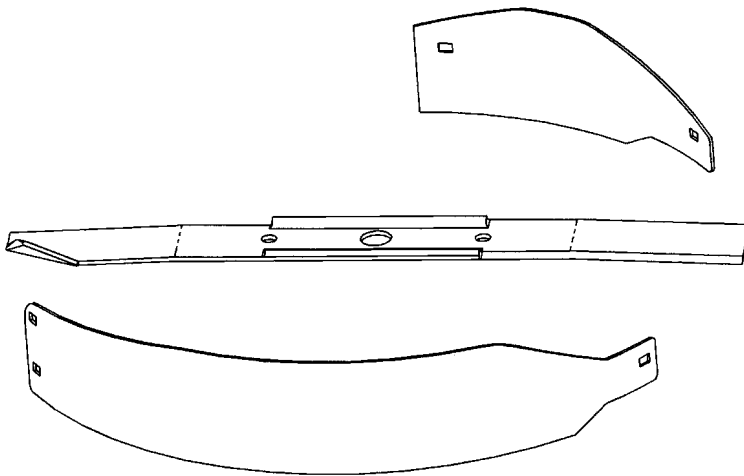

**SNAPPER®** McDonough, GA, 30253 U.S.A.



<b>PAGE</b>	<b>GROUP</b>
4	High-Wheel Walk-Behind Mulching Kit

MULCHER KIT (63092) for 26" Hi-Wheel Mower

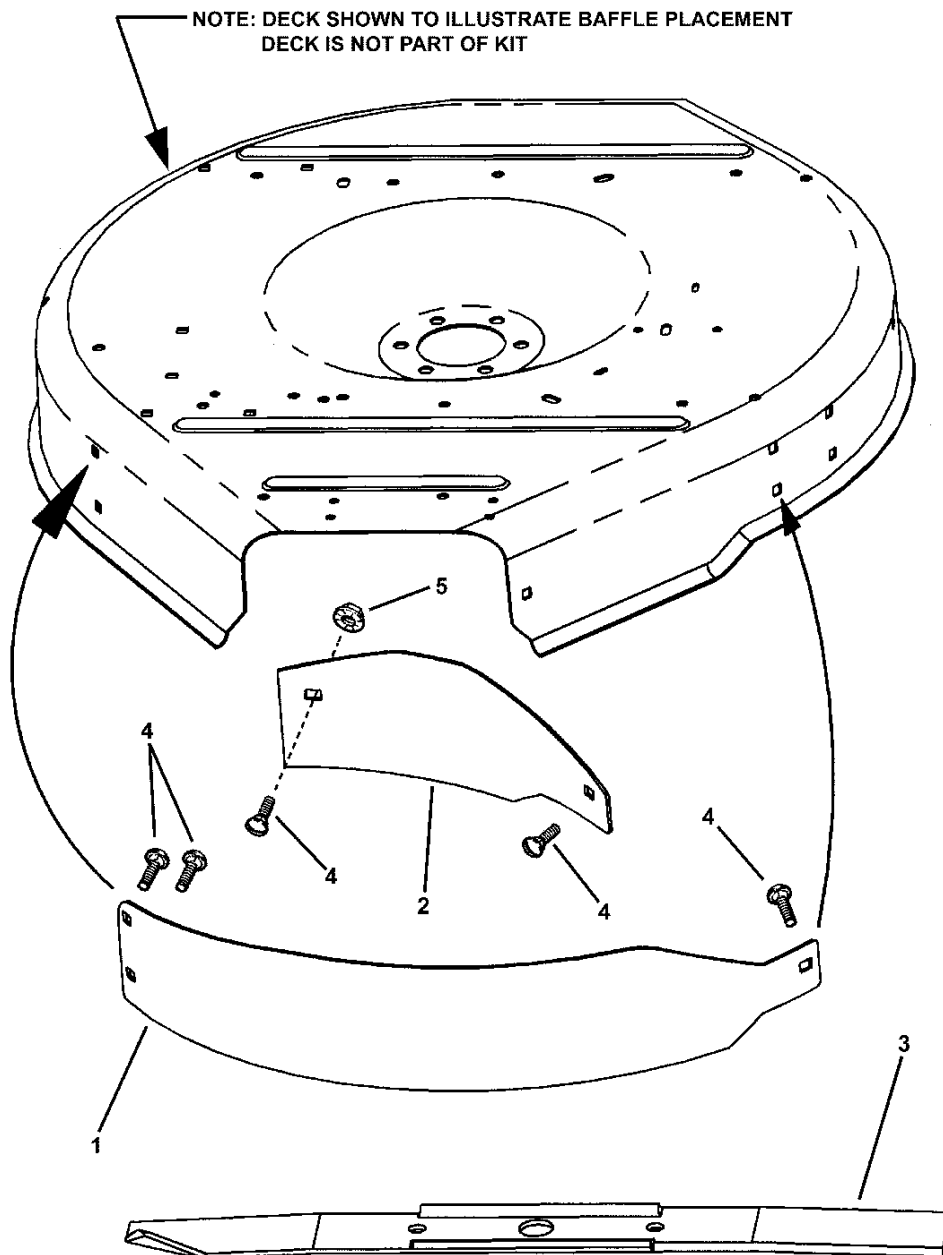

## High-Wheel Walk-Behind Mulching Kit

---

Item	Part No	Qty	Description	Note
1	7072297	1	BAFFLE, Right	
2	7072296	1	BAFFLE, Left	
3	7017360	1	BLADE, 26" Mulcher	
--	7058393	1	HARDWARE BAG, 26" Mulch Kit	<i>includes items 4 &amp; 5 below</i>
4	7091508	5	BOLT, 5/16-18 x 3/4" Short Neck Carriage, GR5	<i>Was 90001</i>
5	7091601	1	NUT, 5/16-18 Hex Flange Lock	<i>Was 90585</i>
--	7072458	1	INSTRUCTION SHEET, 26" Mulch Kit	

### Footnotes:





*Parts Manual for*

# **SNAPPER®**

## **HIGH-WHEEL WALK BEHIND MULCHING KIT**

IT IS THE POLICY OF SNAPPER TO IMPROVE ITS PRODUCTS  
WHENEVER IT IS POSSIBLE AND PRACTICAL TO DO SO. WE  
RESERVE THE RIGHT TO MAKE CHANGES OR ADD IMPROVEMENTS  
AT ANY TIME WITHOUT INCURRING ANY OBLIGATION TO MAKE  
SUCH CHANGES ON PRODUCTS MANUFACTURED PREVIOUSLY.

**SNAPPER®** McDonough, GA, 30253 U.S.A.