

#6-3317 SINGLE BAG GRASS CATCHER for SNAPPER REAR ENGINE RIDERS with 28/33" DECKS & LAWN TRACTORS with 33" DECKS

This grass catcher kit fits Lawn Tractors with 33" Decks and Rear Engine Riders with 28" & 33" Decks. On Series "A" & Later Lawn Tractors, Adapter Kit #6-1334 must be installed before this grass catcher can be installed. On Series "0-2" Lawn Tractors, Adapter Kit #6-1068 must be installed before this grass catcher can be installed. Install adapter kit as described by instructions provided with kit.

WARNING

DO NOT attempt any maintenance, adjustments, service, or repairs with engine running. **STOP** engine. **STOP** blade. Set park brake. Remove key. Remove spark plug wire and secure away from spark plug. Engine and components are **HOT**. Avoid burns, allow sufficient time to cool.

STEP 1: AIR LIFT INSTALLATION.

An optional Air Lift Kit 6-1777 has been included with this grass catcher and may be installed to enhance bagging performance in certain conditions. The air lifts can be installed by reaching through the discharge opening or by removing the blade. Attach one air lift to each end of the blade using the hardware and instructions provided in the kit. Be certain to install lifts on both ends of blade. Torque nuts and bolts on air lifts to 20 to 30 ft. lbs. Torque blade retaining hardware to 45 to 55 ft. lbs. See Figure 1.

NOTE: Not all original equipment or accessory blades will accept the Air Lift Kit. Contact an authorized dealer if you have questions.

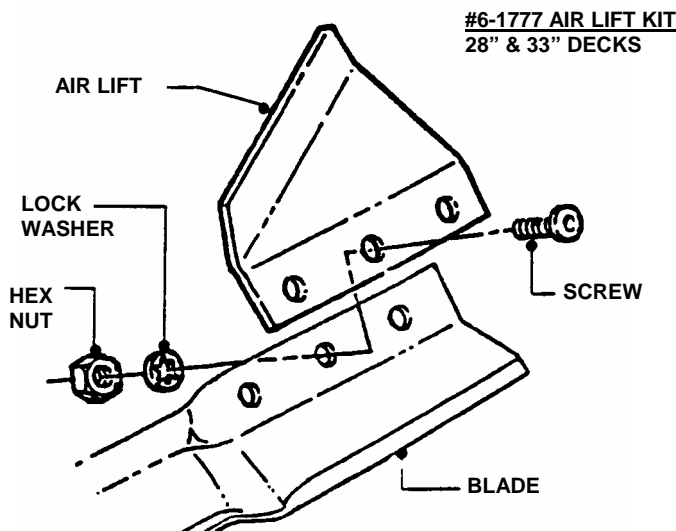

FIGURE 1

(USED ON REAR ENGINE RIDERS ONLY)
Remove both screws from right side of bumper. Remove bolt from right side of main case. Position the muffler shield so that the holes line up with the holes on the bumper. Position the bumper reinforcement with top hole of bumper. Reinstall screws and tighten securely. Install bolt into bumper reinforcement and tighten securely into side of main case. See Figure 2.

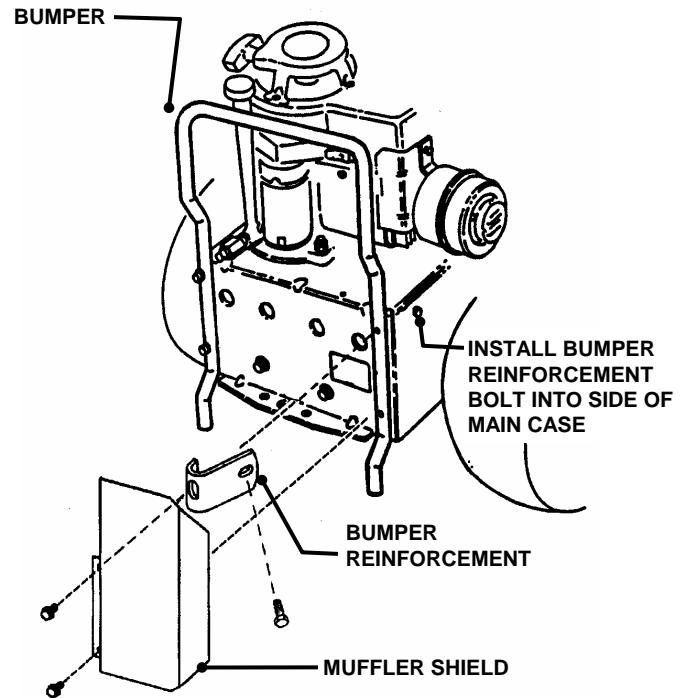

FIGURE 2

STEP 3: HANDLE TO TUBE MOUNTING

Position the tube handle base inside the grass tube. Place the tube handle on the outside, align the holes then secure base and handle with two 1/4-20 X 3/4" carriage bolts (heads on inside of tube) 1/4" lock washers and 1/4-20 hex nuts on the outside and tighten securely. See Figure 3.

WARNING

To prevent fires, keep muffler area clear of debris.

WARNING

The cutting blades and the edges of the cutting deck are extremely sharp and can cause severe injury. Always wear heavy leather gloves when working around cutting blades and the cutting deck.

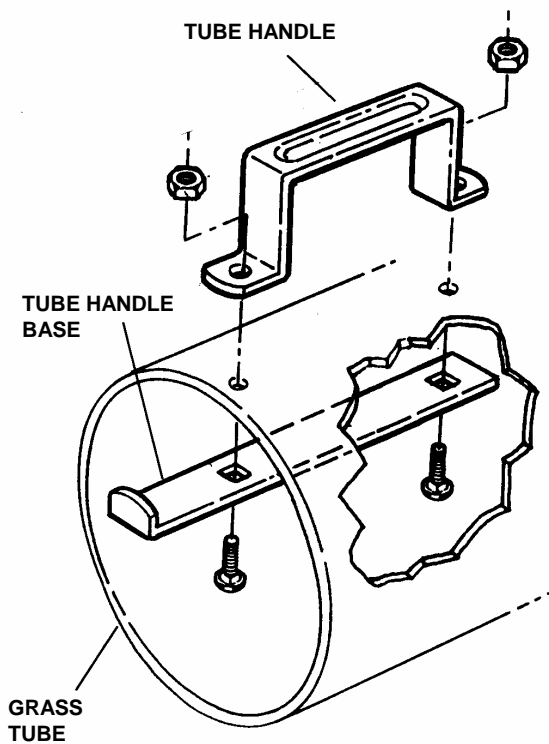

FIGURE 3

STEP 4: TUBE LATCH TO ADAPTER MOUNTING

Position tube latch onto chute adapter. Insert one of the 1/4-20 X 3/4" carriage bolts (heads on inside of tube) into the hole on the end of the adapter. Secure with 1/4" lock washer and 1/4-20 hex nut. See Figure 4.

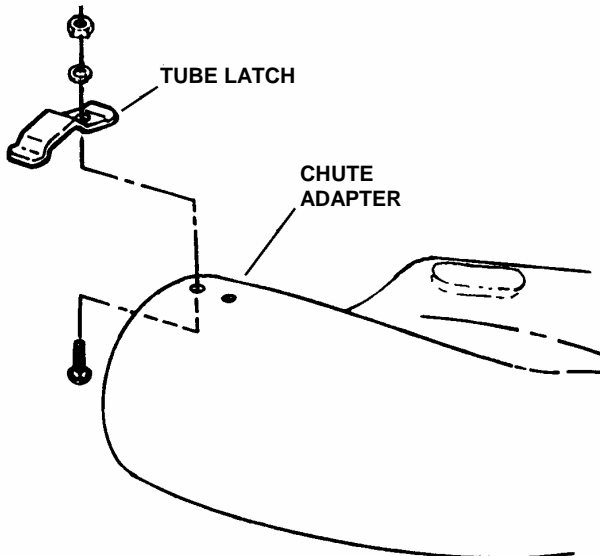

FIGURE 4

NOTE: If mulching cover is installed on deck it must be removed before going to step 5. (Also change from mulching blade to regular blade.)

STEP 5: ADAPTER TO DECK MOUNTING

Loosen the three hex head deflector hinge screws. Remove the side deflector bolts & wing nut and store for future use. See Figure 5A. For riders, lift the deflector. For tractors, remove palnut, hinge pin, hinge spring & deflector; save for future use. See Figure 5A. Position the adapter over deck opening, forward of engagement lugs. See Figure 5B. Slide adapter toward the rear until the retaining ridges slide under the two engagement lugs on the deflector latch hinges. See Figure 5C. Bump the adapter rearward with the palm of your hand if necessary to force the ridges under both the front and rear lug locks. Align the hole in the side of the adapter with the hole in the deck. Insert the 5/16-18 x 1" long carriage bolt from inside the deck and secure with a washer & 5/16-18 wing lock nut on the outside. Retighten the three deflector hinge screws.

DEFLECTOR REMOVED ON TRACTOR, FLIPPED UP ON RIDER

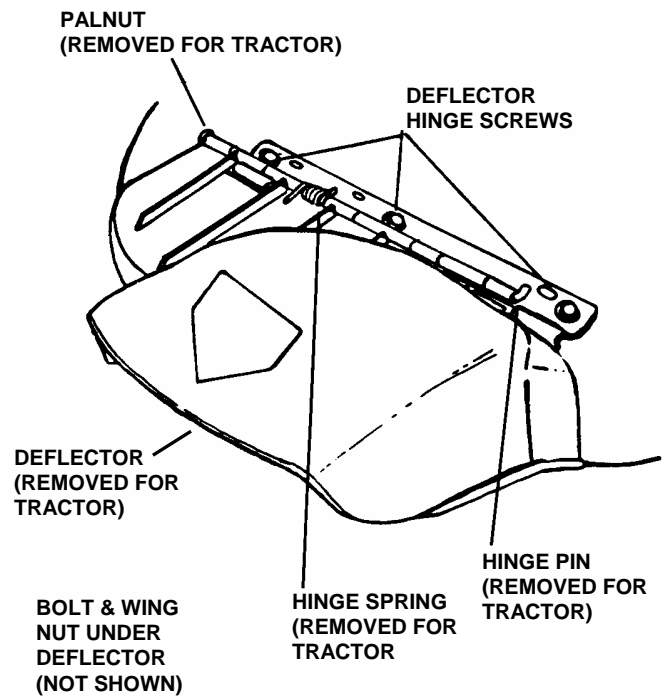

FIGURE 5A

WARNING
DO NOT operate machine without entire grass catcher or guards in place.

TRACTOR MODEL SHOWN (DEFLECTOR REMOVED)

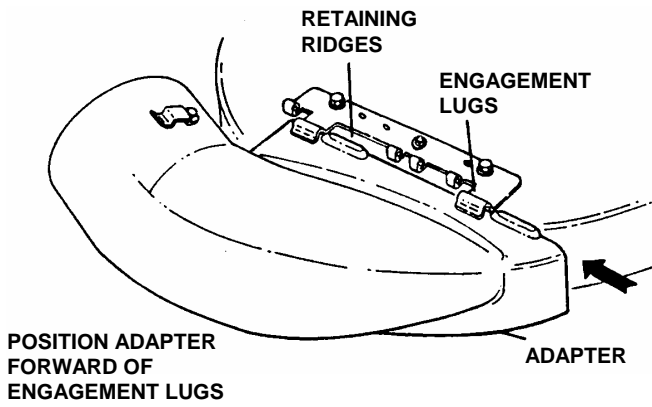

FIGURE 5B

TRACTOR MODEL SHOWN (DEFLECTOR REMOVED)

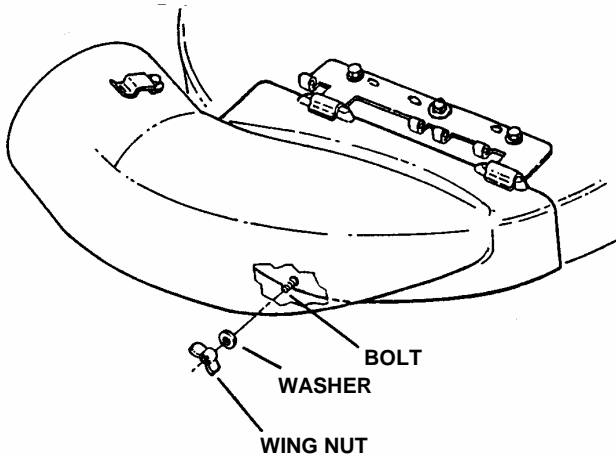

FIGURE 5C

STEP 6: Adapter Kit Installation (Tractors only). Install Adapter Kit #6-1334 per instructions supplied with kit. See Figure 6.

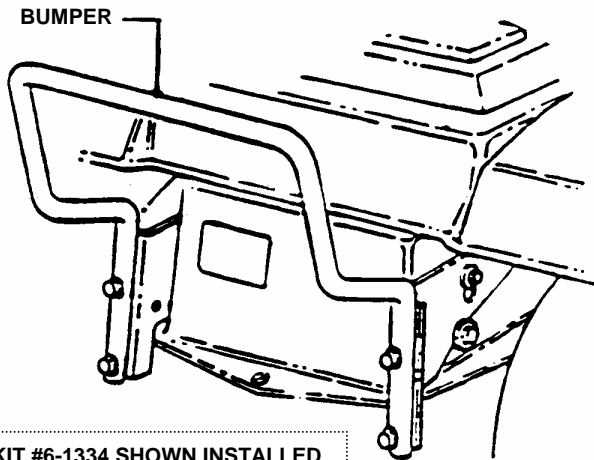

FIGURE 6

STEP 7: DUST SKIRT TO FRAME INSTALLATION

Punch out or tear out the center portion of the reinforcement patches (There are two large ovals and five small round patches) on dust skirt. Insert the legs of the frame through the two larger holes in the skirt. Position the five patches over the studs on the frame (make sure square shield patch on skirt is installed on muffler side). See Figure 7. Then push the frame down over the bumpers. NOTE: Skirt should be on outside of frame and should pass between frame and bumpers. Insert pins in upper holes in bracket to lock frame in place. Install clevis pins through holes and secure with hair pins. Refer to exploded illustration on page 6.

LEGS OF FRAME ARE THROUGH LARGE OVAL SLOTS

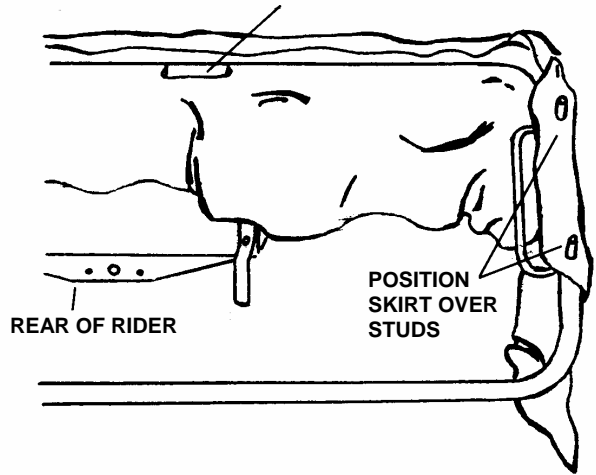

FIGURE 7

STEP 8: Install the grass catcher latch (item 13) on the outside of frame using the #10-3/8" long cap screw (Item 14) on outside of frame and with the #10-32 lock nut (item 15) on the inside. Tighten nuts and screws securely but still allow the latch to rotate. Refer to exploded illustration on page 6. Position the container top over the studs of the frame and secure with the five 5/16" faceted washers. See Figure 8.

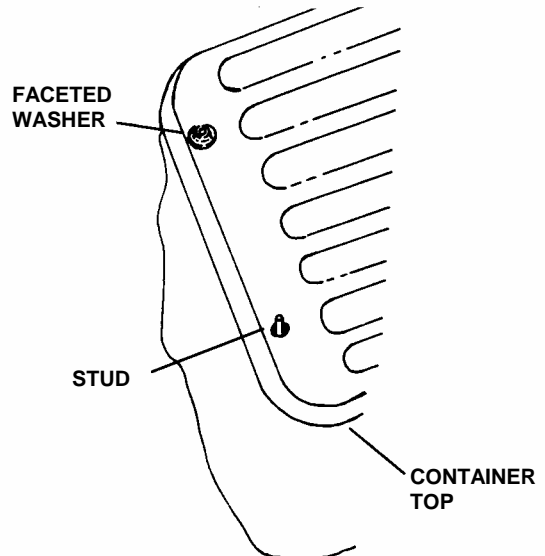

FIGURE 8

STEP 9: Insert the bag rod (item 4, see page 6) into the upper loop of the grass catcher bag (Item 5, see page 6) and work the grass bag until completely around the bag rod. The opening should be positioned at the bag rod opening. Push the bag rod connector (item 12, see page 6) over one end of the bag rod. Push the bag rod connector onto the rod until half of the connector is over the end of the rod. Position bag/rod assembly vertically and place foot on the inside of the bottom section. Lift the upper corner of the bag/rod assembly and guide the other end of the rod into the connector. See Figure 9. Work the rod ends together until they meet. Slide grass bag/rod into frame with open mesh to the rear of mower. Secure in place with latch.

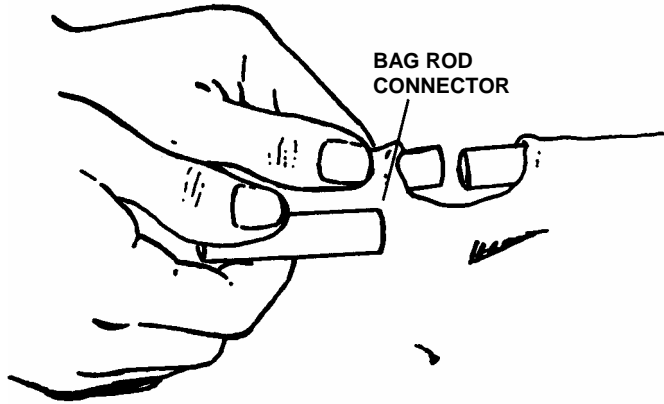

FIGURE 9

STEP 10: Slip top end of grass tube into the container top. Push backward until handle end clears the end of the chute adapter. Then slide the grass tube over the adapter opening and turn grass tube until handle base end catches under the tube latch on adapter. See Figure 10.

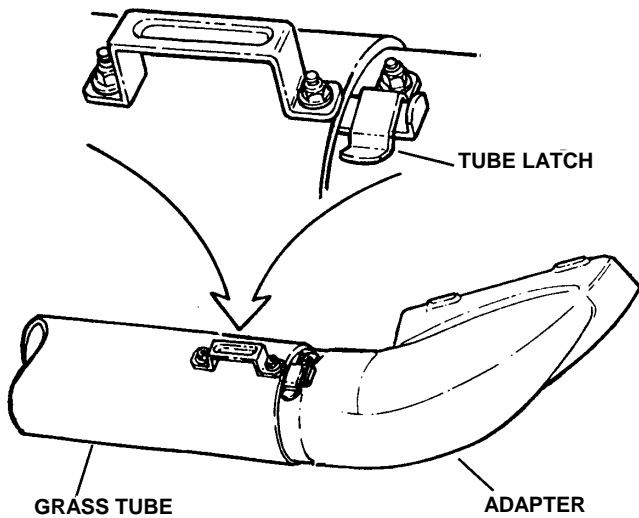

FIGURE 10

STEP 11: WEIGHT PLATE INSTALLATION (REAR ENGINE RIDER ONLY)

IMPORTANT: Some model Riders may require the two mounting holes to be drilled in the front frame. See Step 12 for drilling instructions. The mounting holes in other models may be covered by the SNAPPER label.

Attach the six weights to the front frame using 3/8-16 x 2-1/4" hex cap screws, flat washers, 3/8" split lock washers and 3/8-16 hex nuts. Tighten nuts and bolts securely. See Figure 11.

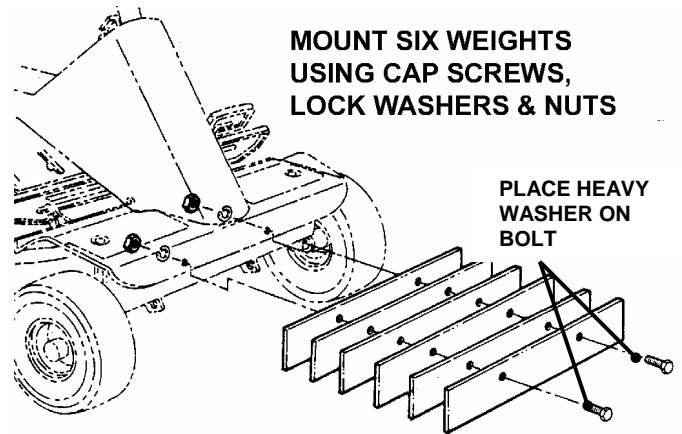

FIGURE 11

⚠ WARNING ⚠

Weight Plates must be installed before operating the machine with a grass catcher kit. Grass catchers and other attachments affect the handling and stability of the machine. Use extra care. Refer to the Operator's Manual for IMPORTANT SAFETY INSTRUCTIONS

STEP 12 DRILL MOUNTING HOLES (SERIES M RIDERS ONLY)

Measure and mark the location of the two holes using dimensions shown. See Figure 12. Drill two 13/32" holes. Attach weight plates. Refer to Step 11.

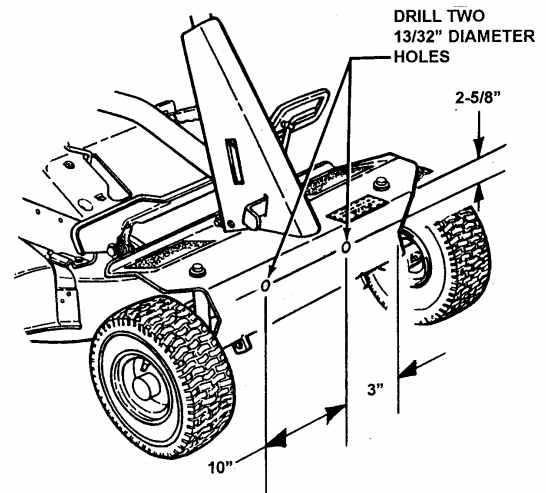

FIGURE 12

SINGLE BAG GRASS CATCHER KIT ILLUSTRATION

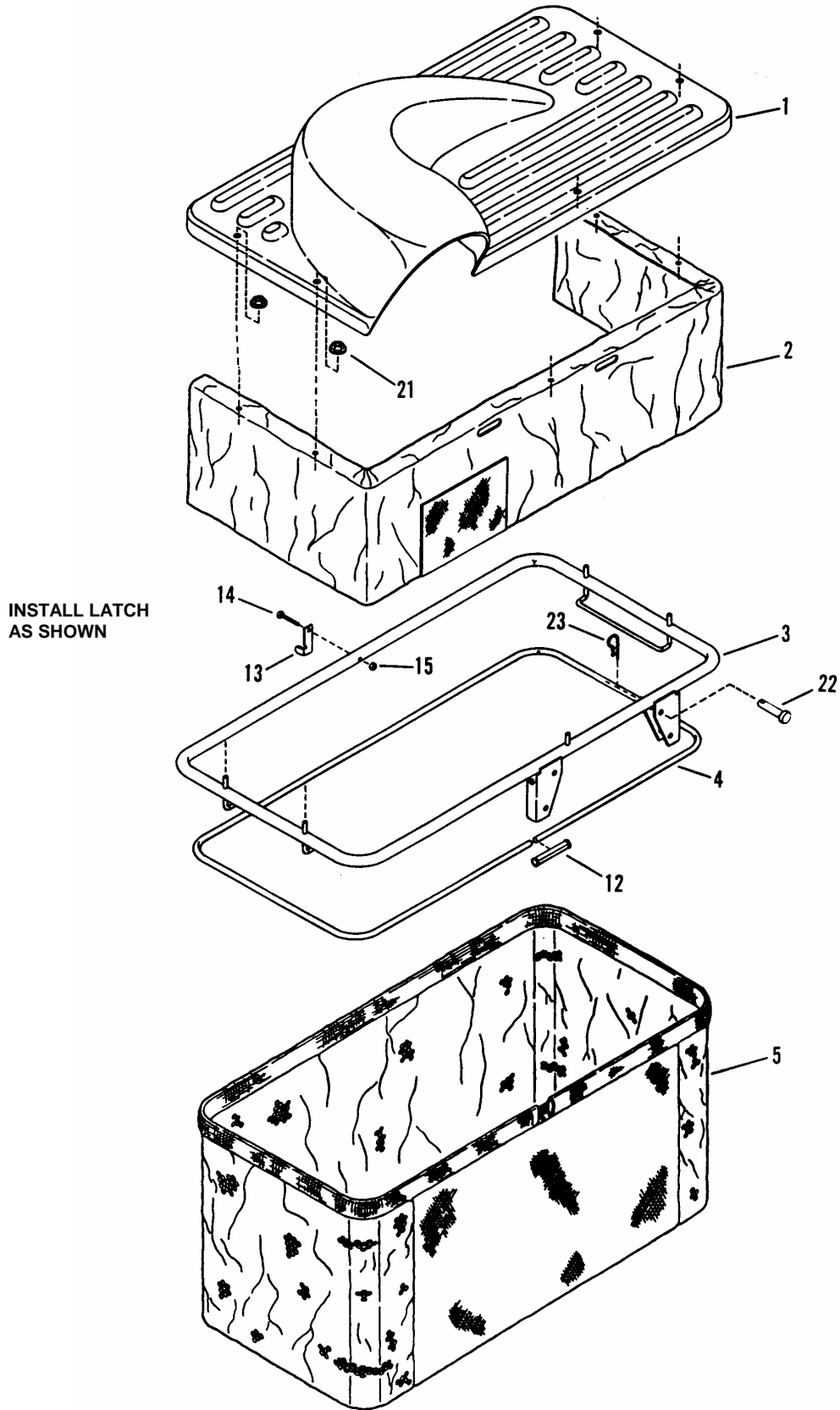

FIGURE 13

SINGLE BAG GRASS CATCHER KIT ILLUSTRATION

#6-1777 AIR LIFT KIT 28" & 33" DECK

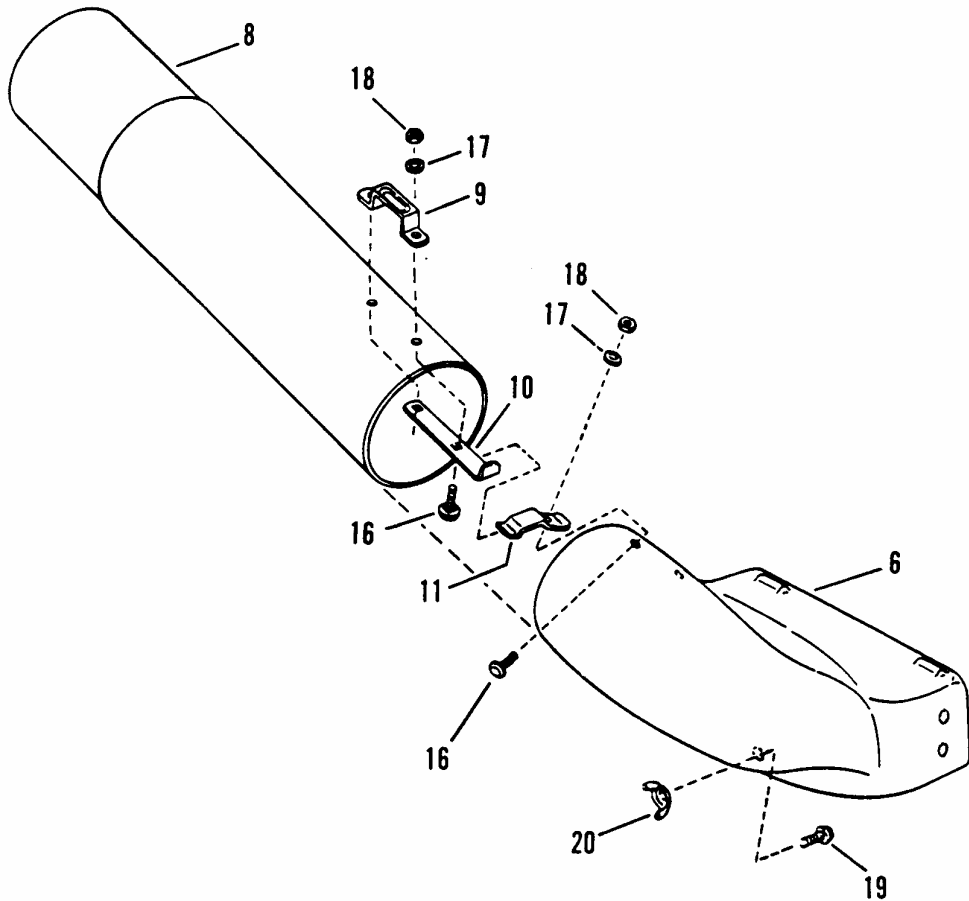
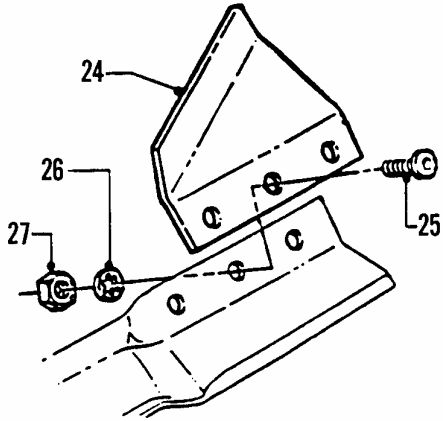

FIGURE 14

SINGLE BAG GRASS CATCHER KIT PARTS LIST

ITEM	PART NO.	DESCRIPTION
-	6-1413	KIT, Single Bag Grass Catcher (Includes Items 1 thru 28)
1	5-3667	TOP, Container (Includes 2-9784 & 1-9910 Decals)
2	1-6108	SKIRT, Dust
3	4-7973	FRAME
4	3-7758	ROD, Bag
5	1-9251	BAG, Grass Catcher
6	5-3669	ADAPTER, Catcher (Includes 2-9784 Decal)
7	7-1677	SHIELD, Muffler
8	1-4517	TUBE, Grass
-	6-0313	BAG, Hardware (Includes Items 9 thru 23)
9	3-7745	HANDLE, Tube
10	3-1952	BASE, Tube Handle
11	3-1951	LATCH, Tube
12	1-2556	CONNECTOR, Bag Rod
13	3-1725	LATCH, Grass Catcher
14	9-0532	SCREW, 10-32x1-3/8" Hex Cap
15	9-0376	NUT, #10-32 Hex Lock
16	9-1530	BOLT, 1/4-20 x 3/4" Short Carriage.(3)
17	9-1314	WASHER, 1/4 Internal Tooth Lock (3)
18	9-1576	NUT, 1/4-20 Hex (3)
19	9-1303	BOLT, 5/16-18x1" Short Neck Carriage.
20	9-1537	WING LOCK NUT, 5/16-18
21	2-9840	WASHER, 5/16 faceted (5)
22	2-9841	PIN, Clevis, 5/16 x 1.69 (2)
23	9-1503	PIN, Hair, 3/32 x 1.5 (2)
--	6-1777	KIT, Air Lift (Includes Items 24 thru 27)
24	3-4468	Lift, Air (2)
25	9-0228	SCREW, 5/16-24 x 5/8" Machine (6)
26	9-0391	WASHER, 5/16 Internal Tooth Lock (6)
27	9-0223	NUT, 5/16-24 Hex (6)
--	3-1954	REINFORCEMENT, Bumper (Shown in Figure 2)
--	7-2416	WEIGHT PLATE (SHOWN IN FIGURE 11) (6)
--	9-1560	BOLT, 3/8-16 x 2 1/4" (SHOWN IN FIGURE 11) (2)
--	9-1320	WASHER, 3/8 Split Lock (SHOWN IN FIGURE 11) (2)
--	9-1302	NUT, 3/8 Hex (SHOWN IN FIGURE 11) (2)
--	2-1746	WASHER, Thick (SHOWN IN FIGURE 11) (2)

GRASS CATCHER OPERATION

Your Grass Catcher equipped SNAPPER machine will keep your lawn cleaner than it would be by raking or using any other vacuum method. The Hi-Vac models, which feature a patented rolled-lip deck design, will do an excellent job of vacuuming and bagging grass clipping, leaves, litter, and even hard to pick-up pine straw. Following are some hints for using the grass catcher.

- Grass clippings and litter are picked up by the vacuum created by the cutter blade and blown into the bag by the air blast coming from the blade. The vacuum and air blast must be sufficient to handle the material you want to collect.
- Light, dry clippings may be put into the bag by using the standard cutter blade and mowing at normal speeds.
- Heavier, more lush material will require more suction and air blast. Run engine faster and slow down the forward speed of the mower.
- Very heavy, lush grass, matted leaves or pine straw will require the entire vacuum and blast you can give it. Run the engine at top speed and the mower at its slowest forward speed. Take less than a full swath under most severe conditions.
- For maximum lift, the cutter unit should be set about 2 1/2" to 3" high. The heavier the litter to be picked up, the higher the unit should be set. Make more than one pass over the area to be cleaned, if needed.
- Normally, it is best to mow or clean by operating in a clockwise direction. However, if litter is matted and heavy, make the first pass in a counterclockwise direction. As material is picked up on the left side of the cutter unit, it will more easily enter the chute and go into the bag.
- The vacuum action of the blade will pick up dust unless the grass is very thick or the ground is wet. Be prepared for this dust storm. You can minimize it if you learn to operate the cutter blade at the lowest speed that will put the clippings and litter in the bag. Because of the dust, your engine air cleaner should be serviced more frequently than usual.
- Never fertilize with dry-type fertilizer just before mowing. The vacuum action will pick up most of the fertilizer and put it in the bag, where it will do very little good for your lawn.
- DO NOT be afraid to experiment with different blade speeds, cutter unit heights, and forward speeds until you have learned how to make your SNAPPER machine operate best under YOUR conditions.

Some mower operator's prefer to place a rigid piece of cardboard or plywood in the bottom of the bag for additional ground clearance and easier handling. If you desire this feature, the dimensions should be 1/8" to 3/8" thick, 15" wide by 35" long with a 4" radius on the corners.

SNAPPER®McDonough, GA., 30253 U.S.A.

COPYRIGHT © 2003
SNAPPER PRODUCTS INC.
ALL RIGHTS RESERVED