

#6-0941 GRASS CATCHER KIT for

SNAPPER[®]

25" SERIES REAR ENGINE RIDERS



CONTENTS

SAFETY INSTRUCTIONS	1
PRE-ASSEMBLY PROCEDURE	2
ILLUSTRATED PARTS LIST	3
OPERATIONAL PROCEDURES	4
LOAD CARRIER OPTION	4



IMPORTANT SAFETY INSTRUCTIONS



ALL THE SAFETY INSTRUCTIONS LISTED IN THE SNAPPER RIDING MOWER OPERATOR'S MANUAL APPLY TO USE OF THE MOWER WITH THE GRASS CATCHER. THOSE OF PARTICULAR IMPORTANCE FOR USE WITH THE GRASS CATCHER ARE LISTED BELOW:

1. DO NOT OPERATE MOWER UP SLOPES IN EXCESS OF 10 DEGREES (17 PERCENT GRADE) WITH GRASS CATCHER INSTALLED UNLESS AUXILIARY WEIGHT OF 50 POUNDS IS PLACED IN FRONT OF MOWER. THE LOAD CARRIER KIT (6-0197) IS AVAILABLE FOR THIS PURPOSE.

2. DISENGAGE CUTTER, STOP ENGINE, AND MAKE CERTAIN BLADE HAS STOPPED BEFORE ATTEMPTING TO UNCLOG GRASS TUBE.

3. CHECK GRASS CATCHER ASSEMBLY FREQUENTLY FOR WEAR OR DETERIORATION. REPLACE WITH NEW BAG, TUBE OR DECK ADAPTER AS REQUIRED.

WARNING! NEVER TRY TO CLEAN OUT THE DECK ADAPTER UNLESS THE ENGINE AND BLADE ARE STOPPED. YOU COULD LOSE A HAND OR SOME FINGERS IF THIS ADVICE IS NOT FOLLOWED.

CAUTION: NEVER OPERATE WITHOUT DUST SKIRT! THE SKIRT PREVENTS DRY MATERIALS FROM BLOWING BACK ON HOT ENGINE COMPONENTS.

SNAPPER POWER EQUIPMENT

McDonough, GA., 30253 U.S.A.



ASSEMBLY

The following is the suggested procedure for installing the grass catcher components for the first time. No special tools are required. Components described in this instruction are called out on the illustrations on this page and listed in the parts identification illustration on the next page. If the Rider is an electric start model with wet cell type battery, remove the battery before standing the unit on its rear bumpers as required in step 1.

1. AIR LIFT INSTALLATION: Check the blade to see if air lifts are installed. If not, install the lifts furnished with this kit. Install per instructions furnished in the air lifter package.

2. HEAT SHIELD: Remove the upper screw on the right side rear bumper and top rear screw in right hand fender. Install bumper support and secure with fender screw just removed. On units with the two piece bumper, slip the muffler shield down over the bumper and secure with the bumper screw. On units with the one piece bumper, loosen screws on left side, remove screws on right side then slip the shield upward into position and secure all screws.

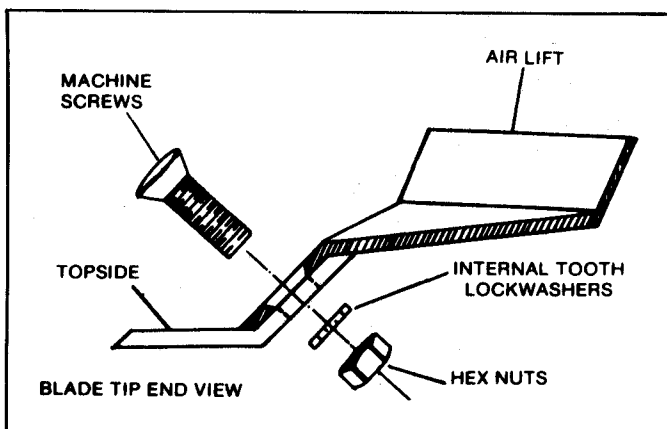

FIGURE 1 - AIR LIFT ASSEMBLY DETAIL

3. ADAPTER TO DECK: To keep the deflector out of the way, lower the deck, lift the deflector fully, then raise the deck until the edge of the deflector catches under and is held by the shift detent bracket. Tilt the top of the adapter upward, then slide it toward the rear until the retaining ridges slide under the two engagement lugs on the deflector latch hinges. Bump the adapter rearward with the palm of your hand if necessary to force the ridges under both the front and rear lug locks. Align the holes in the side of the adapter with the hole in the deck. Insert a 1" long carriage bolt from inside the deck and secure with a 5/16-18 wing nut on the outside.

4. FRAME ASSEMBLY TO BUMPERS: Remove the plastic caps from the tops of the bumpers. Insert the legs of the frame through the two larger holes in the side of the skirt, snap the five eyelets on top seam of the skirt down over the studs on the frame (make sure shield patch on skirt is installed on muffler side), then push the frame down over the bumpers. On units with two piece bumpers, insert quick release pins in lower holes of frame bracket. On units with single piece bumper, insert pins in upper holes in bracket to lock frame in place.

5. BAG TO ROD: With the stitched edge on top of bag toward the outside, insert the bag rod into the upper loop of the bag and work the loop of the bag until completely around the rod with the loop opening positioned over the rod opening. Slide the connector over one end of the rod, pull the other rod end out to clear the open end of the connector, then guide this rod end into the connector. Lift the frame lock and slide the bag rod assembly into the side rails inside the frame.

6. CONTAINER TOP: Position the catcher top over the studs of the frame and secure with the five faceted washers. Assemble the frame latch on the outside of frame and secure with the 1-3/8" long capscrew on outside of frame and with a 10-32 locknut on the inside.

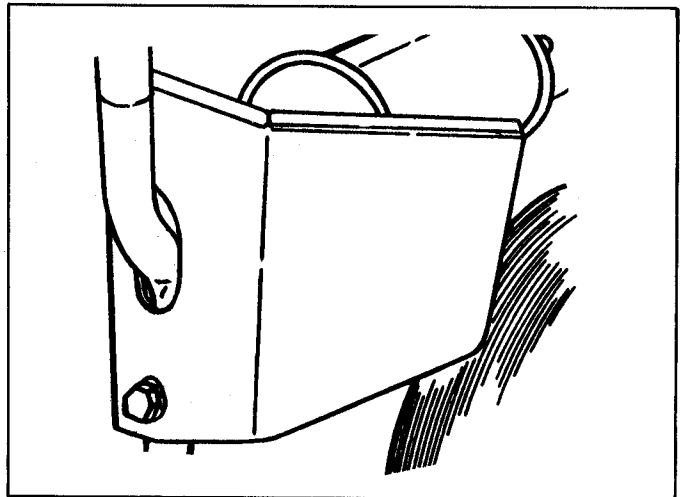

FIGURE 2 - MUFFLER SHIELD INSTALLED

GRASS CATCHER OPERATION

Your Grass Catcher equipped Snapper Hi-Vac Riding Mower will keep your lawn cleaner than it would be by raking or using any other vacuum method. The Hi-Vac models, which feature a patented rolled-lip deck design, will do an excellent job of vacuuming and bagging grass clippings, leaves, litter, and even hard to pick-up pine straw.

■ Grass clippings and litter are picked up by the vacuum created by the cutter blade, and blown into the bag by the air blast coming from the blade. The vacuum and air blast must be sufficient to handle the material you want to collect.

■ Light, dry clippings may be put into the bag by using the standard cutter blade and mowing at normal speeds.

KIT #6-0941 PARTS LIST

ITEM	PART NO.	DESCRIPTION
1	7051303	TOP, Container(Incl. 1-1910 Decal)
2	7016108	SKIRT, Catcher (Part of It. 5)
3	7047973	FRAME
4	7057248	ROD, Catcher Support (incl. #8)
5	7024819	BAG, Grass Catcher(Incl. It. 2)
6	7014750	TUBE, Grass 31.5" L x 7.68" ID
7	7019809	ADAPTER, Deck(Chute)
8	7012556 ★	CONNECTOR, Rod
9	7031725 ★	LATCH, Catcher

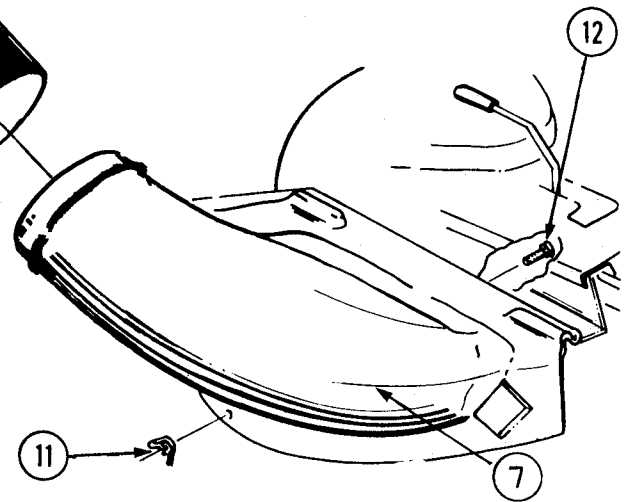
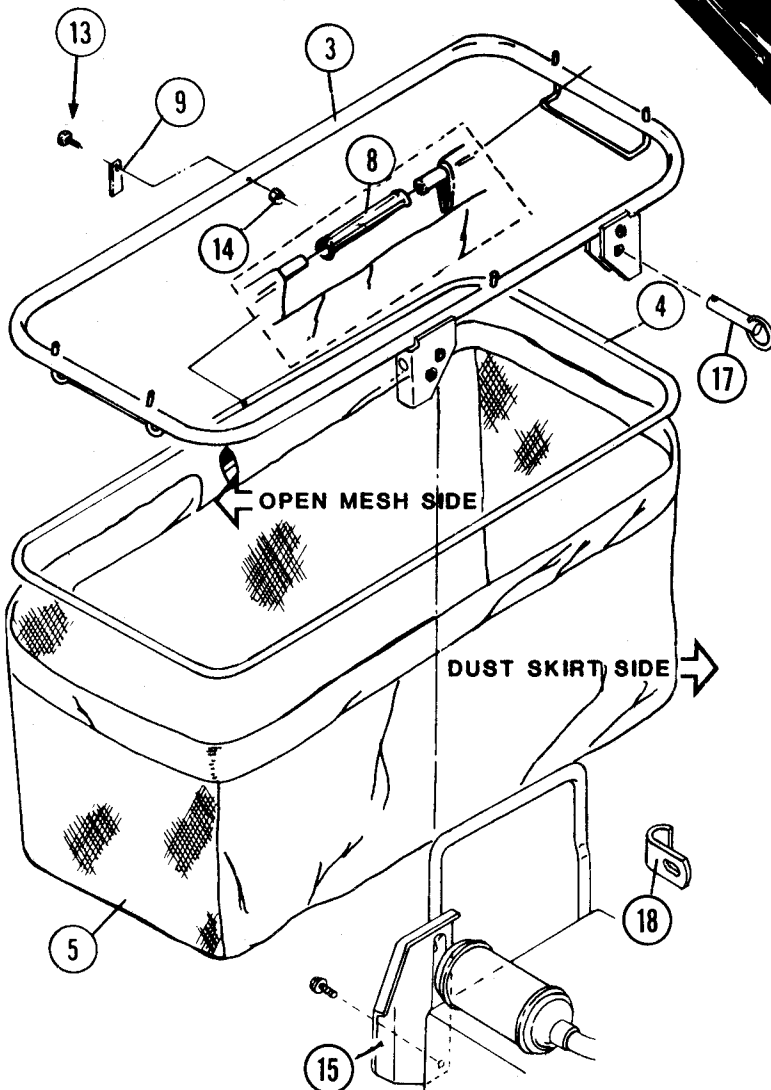
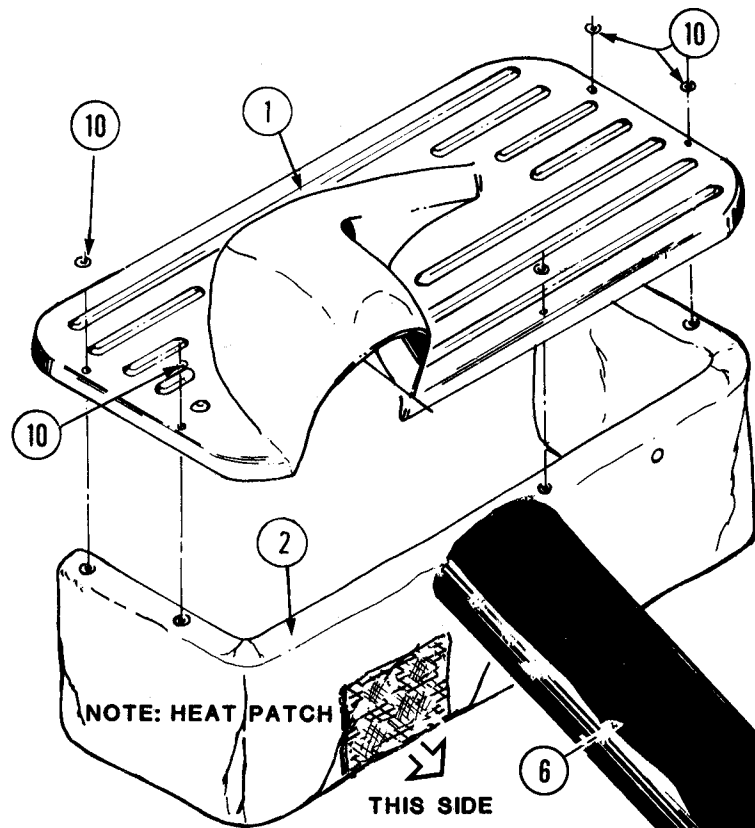

10	7029840 ★	WASHER, Faceted(5)
11	7091537 ★	WING-NUT
12	7090731 ★	BOLT, 5/16x1/2 Carriage
13	7090532 ★	SCREW, 10-32x1-3/8 Hex Cap
14	7090376 ★	LOCKNUT, 10/32 Hex
15	7071677	SHIELD, Muffler Heat
16	7060480	KIT, Air Lift
17	7015610	PIN, Quick Release (2)
18	7031954	SUPPORT, Bumper

★ PART OF # 7060355 HARDWARE BAG

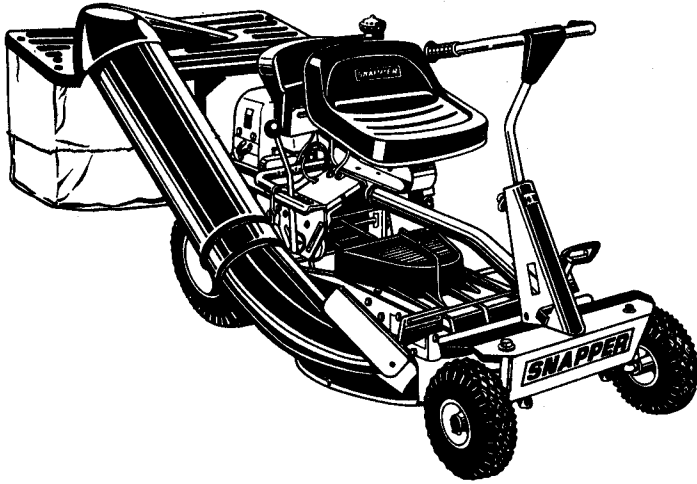

GRASS CATCHER OPERATION

■ Heavier, more lush material will require more suction and air blast. Run the engine faster and slow down the forward speed of the mower.

■ Very heavy, lush grass, matted leaves or pine straw will require all the vacuum and blast you can give it. Run the engine at top speed and the mower at its slowest forward speed. Take less than a full swath under most severe conditions.

■ For maximum lift the cutter unit should be set about 2½" to 3" high- the heavier the litter to be picked up, the higher the unit should be set. Make more than one pass over the area to be cleaned, if needed.

■ Normally it is best to mow or clean by operating in a clockwise direction. However, if litter is matted and heavy, make the first pass in a counterclockwise direction, as material is picked up on the left side of the cutter unit, it will more easily enter the chute and go into the bag.

■ The vacuum action of the blade will pick up dust unless the grass is very thick or the ground is wet. Be prepared for this dust storm. You can minimize it if you learn to operate the cutter blade at the lowest speed that will put the clippings and litter in the bag. Because of the dust, your engine air cleaner should be serviced more frequently than usual.

■ Never fertilize with dry-type fertilizer just before mowing. The vacuum action will pick up most of the fertilizer and put it in the bag, where it will do very little good for your lawn.

■ Do not be afraid to experiment with different blade speeds, cutter unit heights, and forward speeds until you have learned how to make your Snapper Riding Mower operate best under YOUR conditions.

WEIGHTED LOAD CARRIER KIT

In addition to providing a handy tote box on the front end of your Rider for general chores, the carrier is a must if the Rider is to be operated on slopes in excess of 10 degrees (17 percent grade). Under these conditions, the carrier should be weighted down with 50 pounds of material to counter-balance the weight of the grass as the catcher is filled and keep the front wheels firmly on the ground to prevent loss of steering control and stability. Order and install Kit #6-0197.

THATCHERIZER OPTION

The Snapper Thatcherizer will effectively dislodge excessive thatch from your lawn where it can be vacuumed up into the grass catcher. Thatch is a layer of stems, clippings, runners, roots and leaves that have not decayed. It builds up between the ground surface and the green part of the grass. Excessive thatch prevents the proper amount of air, water, and fertilizer from reaching the root structure. In areas where thatch is thick, it can kill the grass and provide a host for insects and turf disease.

In addition to de-thatching, the Thatcherizer can help you perform other lawn care duties. For example, you can use it for "scratching" the surface of the soil for over-seeding, to give the seed a better chance of germinating. Also use it to comb matted grass upright before mowing for a smoother, more even cut. Your Thatcherizer will do a good job of dislodging and raking up that thin layer of pine straw which often remains partially embedded in the soil or is entwined in the grass. When using as a rake, bounce the unit to dump the straw in the selected dumping area. Vacuum up heavy accumulations of pine straw or leaves before using your Thatcherizer. Order Thatcherizer Kit #6-0479 from your Snapper Dealer.

SNAPPER POWER EQUIPMENT
McDonough, GA., 30253 U.S.A.

