

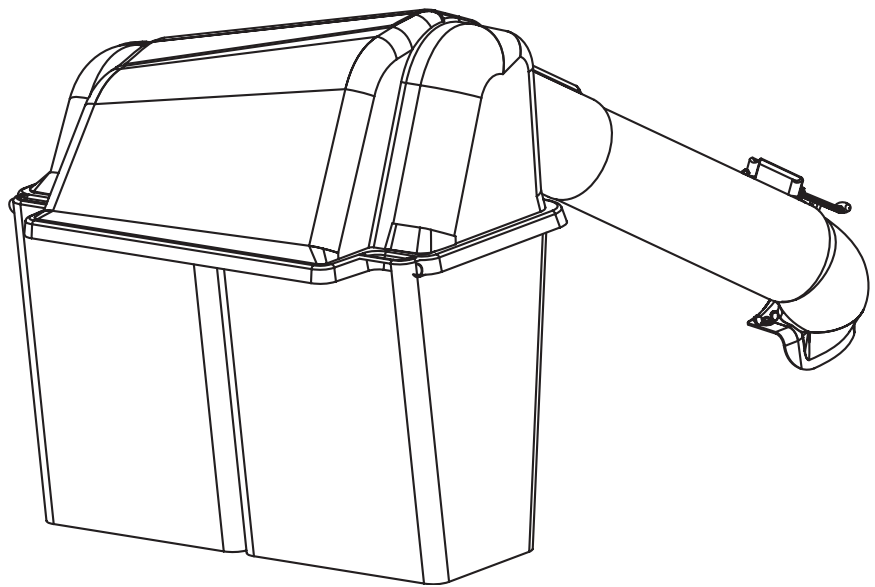

# ATTACHMENT OPERATOR'S MANUAL



## Clean Sweep Twin Catcher

### Clean Sweep Twin Catcher

Mfg. No.	Description
1695164	Clean Sweep Twin Catcher

1733420  
Rev. 00  
Rev. Date 05/2006  
TP 100-4297-00-AT-N



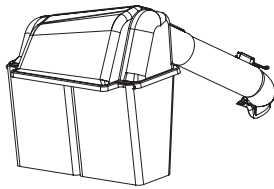

# Table of Contents

---

## **Safety Rules & Information**

General Warnings.....	2
Safety Decals .....	2

## **General Operating Instructions**

Before Operation .....	3
Mowing with the Catcher .....	3
After Operation .....	3
Storing the Grass Catcher .....	3

## **Initial Installation**

Hitch Installation .....	4
Component Installation.....	5
Bag, Chute and Tube Installation .....	8

## **Normal Removal & Installation**

Collector Installation .....	11
Collector Removal .....	12

*NOTE: In these instructions, “left” and “right” are referred to as seen from the operating position.*

# Safety Rules & Information



Read these safety rules and follow them closely. Failure to obey these rules could result in loss of control of unit, severe personal injury or death to you, or bystanders, or damage to property or equipment. The triangle  in text signifies important cautions or warnings which must be followed.

## GENERAL WARNINGS

- Know the unit's controls and how to stop quickly. **READ THE OPERATOR'S MANUALS.**
- Read and obey all safety decals.
- Only allow responsible adults, who are familiar with the instructions, to operate the unit.
- Disengage the PTO. Shut off the engine and wait for all moving parts to stop before attaching, adjusting, or disconnecting any part of the collection system.
- Check the collection system to make sure it is bolted tightly to the unit.
- DO NOT operate the unit without either the entire grass catcher or the deflector in place.
- Turn off the PTO to disengage the blades when not mowing.
- DO NOT mow in reverse unless absolutely necessary. Always look down and behind before and while travelling in reverse.
- DO NOT turn sharply when travelling alongside a building or any object. Slow down before turning.
- DO NOT carry passengers.
- When collection system is removed from the mower deck, the deflector must be properly installed.
- Collector bags are subject to deterioration and wear during normal use. Inspect the bag periodically for tears, holes, or weak spots and replace with a new bag that meets manufacturer's durability standards.
- If the mower stalls or the collector chute plugs:
  1. Disengage the PTO;
  2. Stop the engine and remove the key;
  3. Set the parking brake, and wait for all moving parts to stop.
  4. Remove the foreign object or clear the chute with a piece of wood before restarting the engine. **NEVER place hands into COLLECTOR OR MOWER housing to clear jammed objects. Blower OR MOWER may rotate when object is removed.**
- For added stability and to prevent tipping or loss of control:
  - a. Use reduced speed on uneven ground and when turning corners.
  - b. Reduce loads on hillsides. It is recommended that the collection system be kept only half full when negotiating any slopes. Start mowing on slopes when the collection system is empty.
  - c. Mow up and down the face of slopes; never across the face of any slope.
- **Never operate on slopes greater than 17.6% (10°).**

## SAFETY DECALS

This unit has been designed and manufactured to provide you with the safety and reliability you would expect from an industry leader in outdoor power equipment manufacturing.

Although reading this manual and the safety instructions it contains will provide you with the necessary basic knowledge to operate this equipment safely and effectively, we have placed several safety labels on the unit to remind you of this important information while you are operating your unit.

All DANGER, WARNING, CAUTION and instructional messages on your rider, attachments and mower should be carefully read and obeyed. Personal bodily injury can result when these instructions are not followed. The information is for your safety and it is important! The safety decals below are on your product.

If any decals are lost or damaged, replace them at once. See your local dealer for replacements.

These labels are easily applied and will act as a constant visual reminder to you, and others who may use the equipment, to follow the safety instructions necessary for safe, effective operation.

### Attachment Decal



**Decal - WARNING**  
**Thrown Objects Hazard**  
**Part Number 1732819**

*Read and obey all operation and warning decals.*



# Operating Instructions

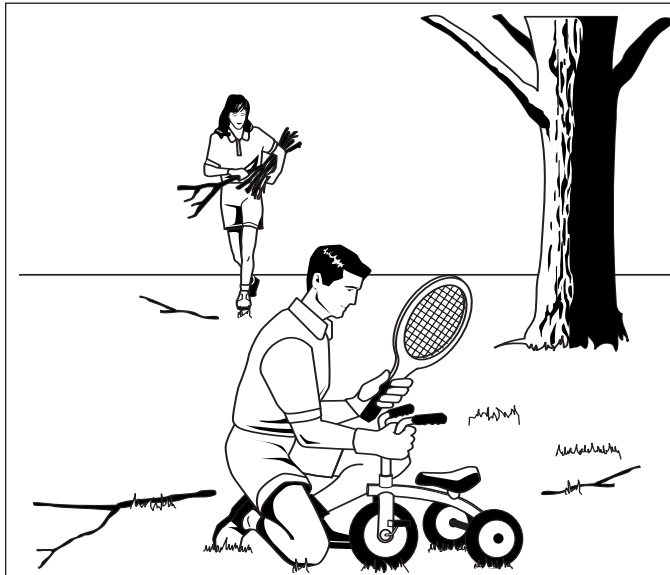

## Before Operation

Clear the lawn of all sticks, stones, wire and other debris which may be caught or thrown by the mower blades.

Check grass condition. If wet, wait until later in the day. If grass is wet, the grass catcher is likely to become plugged.

***For efficient bagging, air circulation under the mower deck, through the chute and into the bag is very important.***

For this reason, **BEFORE YOU BEGIN MOWING** you should make certain the underside of the mower and the underside of the catcher lid are free from grass and debris.

Make sure that there is a snug fit between mower deck, blower housing, tubes, and grass catcher cover.

## Mowing with the Catcher

Always operate with throttle at full speed when mowing.

Grass should be cut often, and not too short. If grass is too long or lush it may be necessary to keep ground speed to a minimum or to cut only half the width of the mower to prevent clogging. If grass is long, operate with mower in high cutting position for first pass, cutting again in a lower position on a second pass.

**Do not open the cover with mower engaged.**

If a large amount of cut grass is spilling out from under deck, the tube may be plugged or the bags may be full—discontinue mowing, stop the unit, disengage the PTO, shut off the engine and then empty the catcher or clear the tube.

## **!** WARNING

**ALWAYS** shut off the tractor. Disengage the PTO, and allow all moving parts to stop **BEFORE** disconnecting or clearing tube, or emptying catcher.

Before leaving the operator's position for any reason, engage the parking brake, disengage the PTO, stop the engine and remove the key.

To reduce fire hazard, keep the engine, rider and mower free of grass, leaves and excess grease. **Do not stop or park rider over dry leaves, grass or combustible materials.**

## **!** CAUTION

**Before you begin operating the unit be certain you have read all of the safety and operational information of this instruction sheet, as well as the Operator's Manual for the tractor and any other attachments.**

**Never operate on slopes greater than 17.6% (10°).**

## After Operation

Remove any debris from the the screen on the underside of the lid.

The blower housing and tube should be removed for cleaning.

Inspect the grass bags for wear or damage. Make sure that there is a snug fit between mower deck, blower housing, tubes, and grass catcher cover.

## **!** CAUTION

**Do not leave grass in bagger containers. Empty containers after each use and before storing. Failure to do so may result in spontaneous combustion which could develop into a fire.**

## Storing The Grass Catcher

Clean the grass catcher thoroughly using a mild detergent (other products may damage the tube). Remove any debris from the screen on the underside of the lid.

If paint has been scratched on metal parts, touch up with paint, or apply a thin film of oil to prevent corrosion.

Store in a dry area. Dry thoroughly before storing for a long period of time. Always store away from moisture.

# Initial Installation



## WARNING

Before beginning any service work turn off the PTO, set the parking brake, turn off the ignition, and disconnect the spark plug wire(s).

## Initial Installation

### Hitch Installation

1. Slide the 5/16-18 speed nut (A, Figure 1) onto rear frame support (E) through square hole (C) so that the threaded side (B) is on the inside of tractor.
2. Secure the 5/16-18 shoulder bolt (D) as shown.
3. Repeat on the other side.

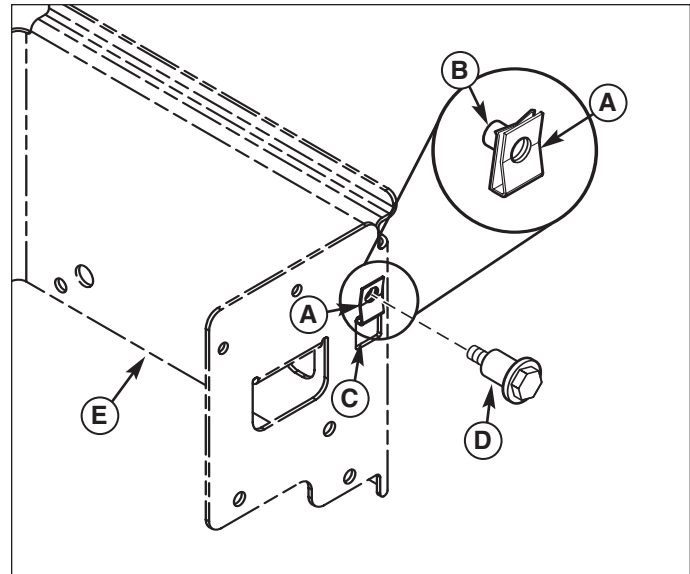

Figure 1. Install Spacer (left side shown)

- A. Speed Nut, 5/16-18
- B. Threaded Side
- C. Square Hole
- D. Shoulder Bolt, 5/16-18
- E. Rear Frame Support

4. Slide the hitch (A, Figure 2) on right side and left side shoulder bolts (B) while sliding post (C) into hole (D) as shown. Secure with hair pin (E).

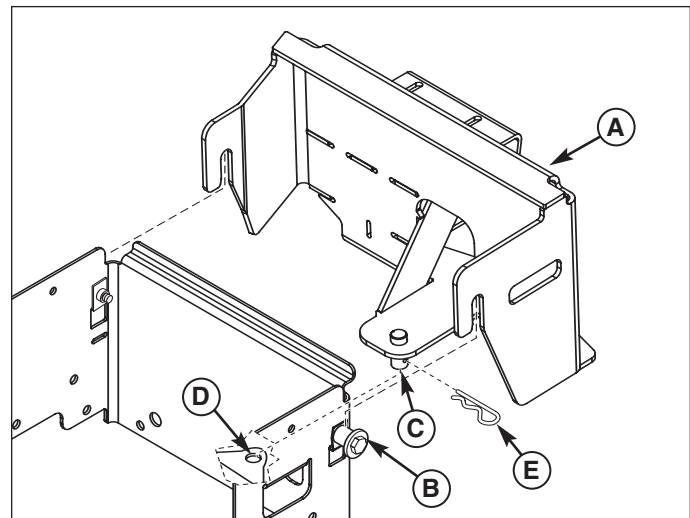
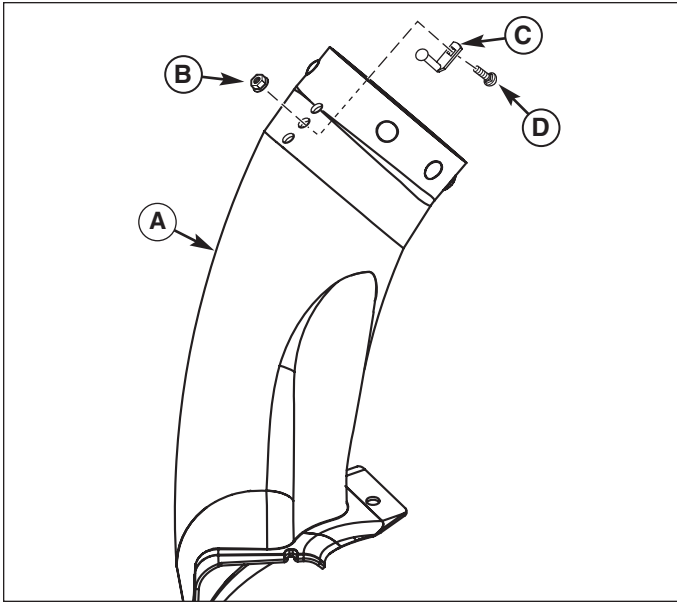
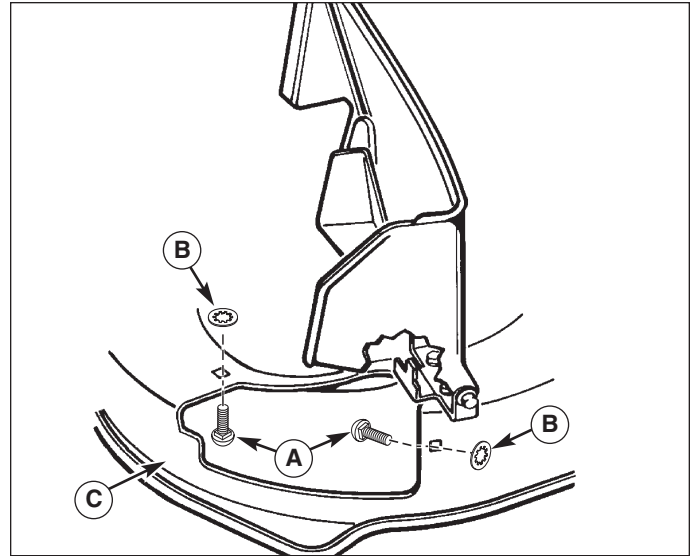

Figure 2. Hitch Installation

- A. Hitch
- B. Shoulder Bolt
- C. Post
- D. Hole in Draw Bar
- E. Hair Pin



**Figure 3. Install Pin**  
**A. Lower Chute**  
**B. Locknut, 1/4-20**  
**C. Pin**  
**D. Carriage Bolt, 1/4-20 x 5/8**



**Figure 4. Install Mounting Plate**  
**A. Carriage Bolts, 5/16-18 x 3/4**  
**B. Push Nuts, 5/16**  
**C. Mower Deck Housing**

## Component Installation

### PIN INSTALLATION ON LOWER CHUTE

1. Insert the head of pin (C, Figure 3) through front hole of lower chute (A). Secure with 1/4-20 x 5/8 carriage bolt (D) and 1/4-20 lock nut (B) as shown.

### CARRIAGE BOLT AND PUSH NUT INSTALLATION MOWER DECK HOUSING

1. Secure the 5/16-18 x 3/4 carriage bolts (A, Figure 4) onto mower deck housing (C) using 5/16 push nuts (B).

*Note: Retaining carriage bolts with push nuts is optional.*

### HANDLE INSTALLATION

1. Install the handle (A, Figure 5) using 1/4-20 x 1/2 screw (C) and 1/4-20 locknut (B) for rear hole. Use 1/4-20 x 1 screw (D) and 1/4-20 locknut (B) as shown. Tighten hardware.
2. Install the strap (E) to screw (D) securing with 1/4-20 locknut (F).

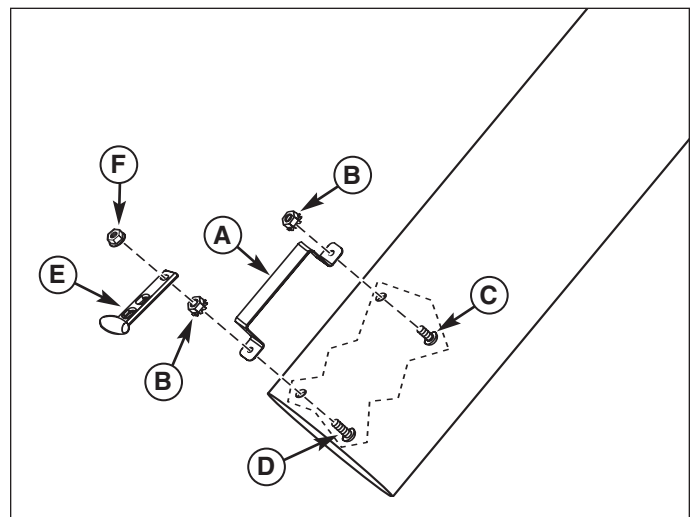

**Figure 5. Handle to Tube Installation**  
**A. Handle**  
**B. Locknuts, KEPS, 1/4-20**  
**C. Screw, Slotted, 1/4-20 x 1/2**  
**D. Screw, Slotted, 1/4-20 x 1**  
**E. Strap, Rubber**  
**F. Locknut, Center Lock, 1/4-20**

# Latch Installation

## INSTALL LATCH AND HINGE TO COVER ASSEMBLY

1. Install the latch (B, Figure 6) to the cover assembly (A) securing with #10-24 x 5/8 screws (D) and #10-24 locknuts (C) as shown.
2. Install the hinge (E) to cover assembly securing with 1/4-20 x 1/2 screws (G) and 1/4-20 locknuts (F).

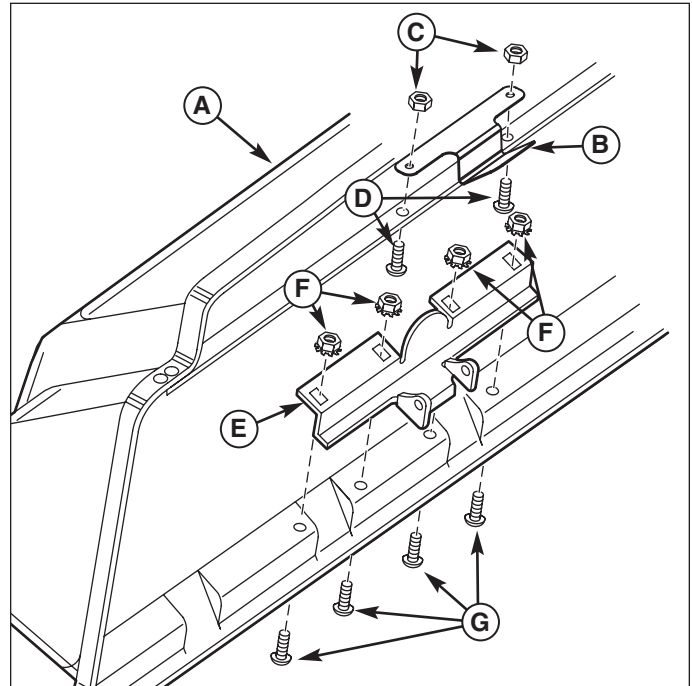

Figure 6. Install Latch & Hinge to Cover Assembly

- A. Cover Assembly
- B. Latch
- C. Locknuts, ESNA, #10-24
- D. Screws, #10-24 x 5/8
- E. Hinge
- F. Locknuts, 1/4-20
- G. Screw, Slotted, 1/4-20 x 1/2

## INSTALL CHANNEL ASSEMBLY AND “U”-TUBE

1. Slide the channel assembly (A, Figure 7) into hitch (B) as shown.
2. Install the pin (C) into the right side of hitch (B) and turn pin (C) counterclockwise to lock in place.
3. Install the “L” channel (E, Figure 8) and “U” tube (A) to channel assembly (B) as shown. Secure with 5/16-18 x 1-3/4 carriage bolts (C), saddle clamps (F), and 5/16-18 nuts (D).
4. Install 5/16-18 x 3/4 capscrew (G) and 5/16-18 locknut (D) as shown.

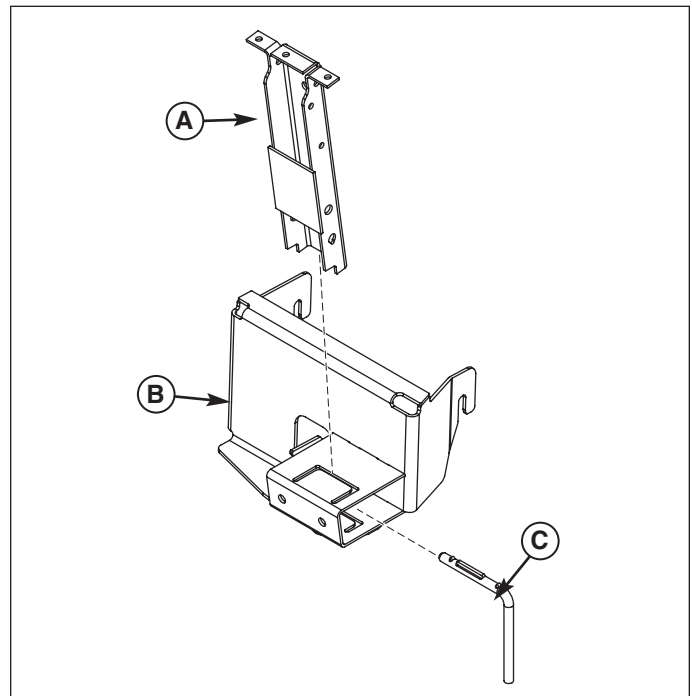
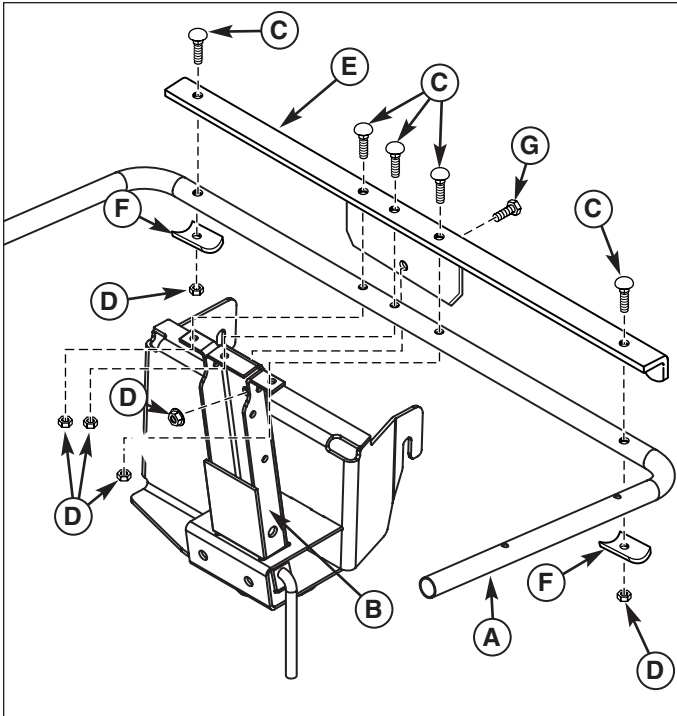

Figure 7. Install Channel Assembly

- A. Channel Assembly
- B. Hitch
- C. Pin





**Figure 8. Install "U" Tube**

- A. "U" Tube
- B. Channel Assembly
- C. Carriage Bolts, 5/16-18 x 1-3/4
- D. Nuts, Nylock, 5/16-18
- E. "L" Channel
- F. Saddle Brackets
- G. Capscrew, 5/16-18 x 3/4

### INSTALL TUBES AND END PLUGS

1. Install the center tube (A, Figure 9) to RH side of channel assembly (B) as shown. Secure with 5/16-24 screws, 5/16 lockwashers (C) and 5/16-24 nuts (D).
2. Install the end caps (G) to tube ends (F) as shown.

### INSTALL COVER TO CHANNEL ASSEMBLY

1. Set the cover (A, Figure 10) on channel assembly. Slide pin (B) through hinge on cover and channel assembly (D) securing with hair pin (C).

### INSTALL CLIP TO BAG ASSEMBLY

1. Slide the white bar (A, Figure 11) onto smooth edge of bag frame and assembly (B) as shown.

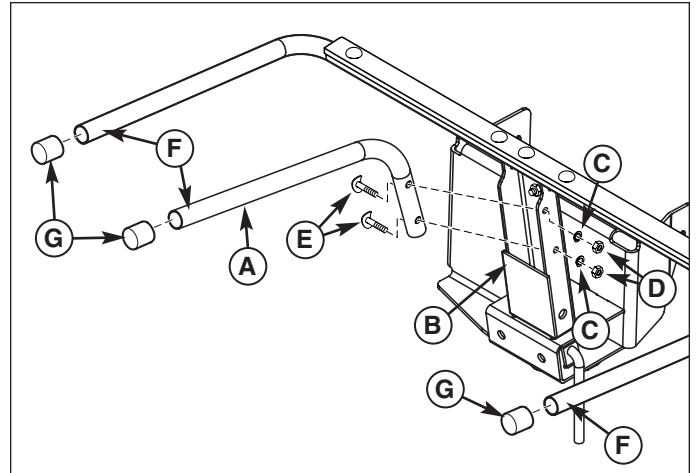

**Figure 9. Install Center Tube and End Caps**

- A. Center Tube
- B. Channel Assembly
- C. Lockwashers, 5/16
- D. Nuts, 5/16-24
- E. Screw, Special, 5/16-24
- F. Tube Ends
- G. End Caps

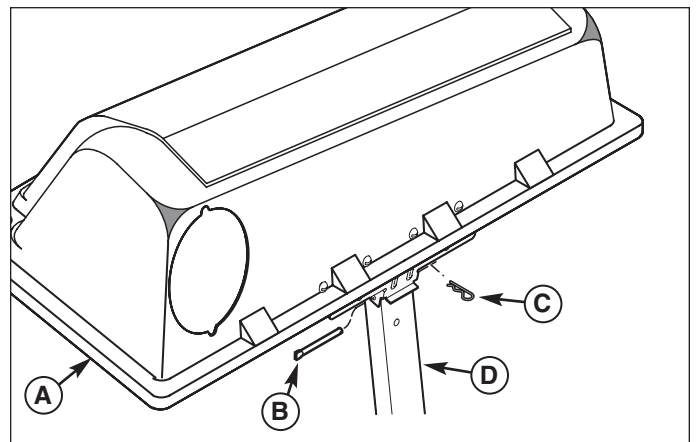

**Figure 10. Install Cover to Channel Assembly**

- A. Cover
- B. Pin
- C. Hair Pin
- D. Channel Assembly

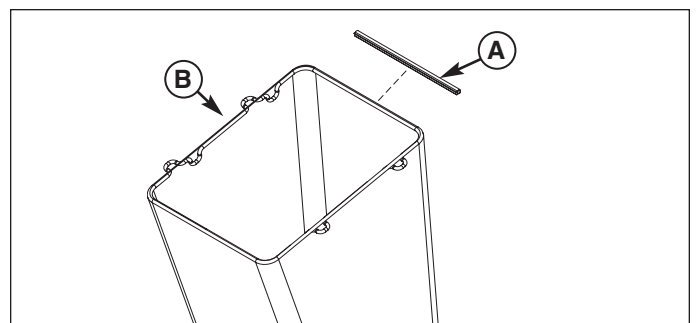

**Figure 11. Install White Bar to Bag**

- A. White Bar
- B. Bag Assembly

# Bag, Chute and Tube Installation

## Bag, Chute and Tube Installation

### INSTALL COLLECTOR BAGS

1. Raise the cover (A, Figure 12).
2. Slide collector bags (B) onto tubes (C) with the white bar towards the rear.

*Note: It may be necessary to fold seat forward to allow cover to stay in the raised position.*

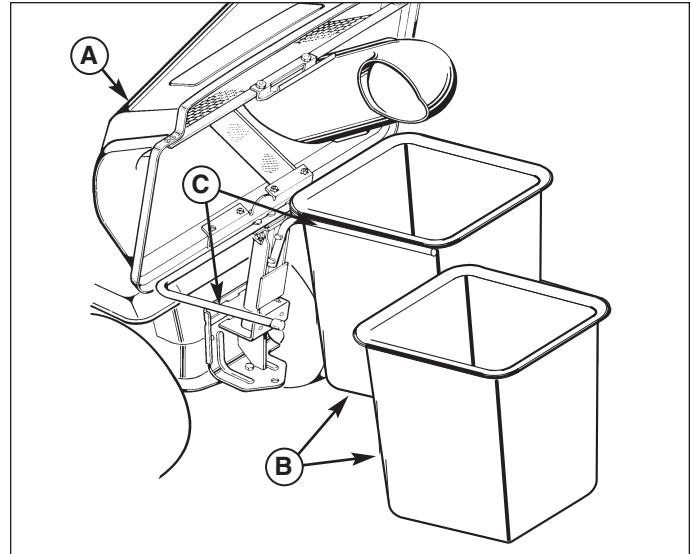
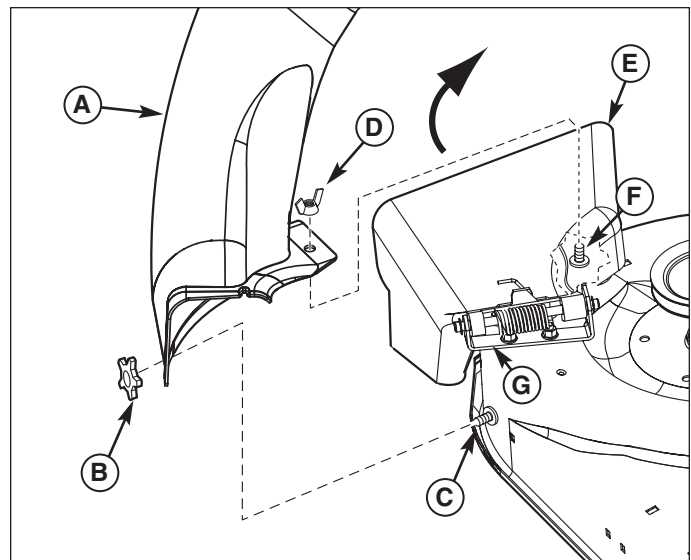

**Figure 12. Install Collector Bags**

- A. Cover**
- B. Collector Bags**
- C. Tubes**

### LOWER DISCHARGE CHUTE INSTALLATION

1. Lift discharge deflector up (E, Figure 13).
2. Place the front hole of the lower chute (A) onto carriage bolt (C) as shown. Slide front edge of lower chute (A) under hinge bracket (G).
3. Place the rear hole of the lower chute (A) onto carriage bolt (F) as shown.
4. Secure knob (B) onto carriage bolt (C) as shown.
5. Secure wing nut (D) onto carriage bolt (F) as shown.



**Figure 13. Install Lower Discharge Chute**

- A. Lower Chute**
- B. Knob, 5/16-18**
- C. Front Carriage Bolt, 5/16-18 x 3/4**
- D. Wing Nut, 5/16**
- E. Discharge Deflector**
- F. Rear Carriage Bolt, 5/16-18 x 3/4**
- G. Hinge Bracket**

## Tube and Chute Installation

### CONNECTING UPPER & MIDDLE TUBE

1. Slide the upper tube (A, Figure 14) into cover (B) aligning ridge (C) with cutout (D) as shown.
2. Slide middle tube (D, Figure 15) into upper tube (E).
3. Slide middle tube (D) over boot (A). Pull strap (B) and place hole completely over pin (C).
4. Secure upper tube (E) over middle tube (D) and secure tubes together using 1/4 x 3/4 screw (F) and correct hole.

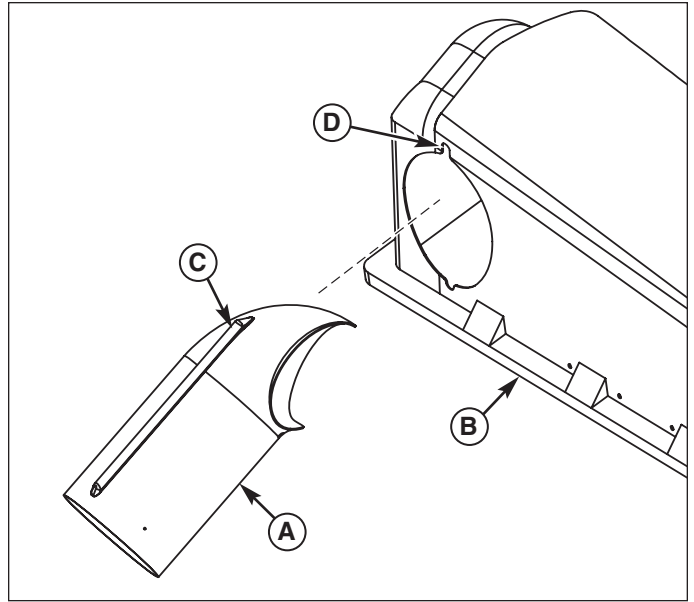

Figure 14. Install Upper Tube to Cover

- A. Upper Tube
- B. Cover
- C. Ridge, Upper Tube
- D. Ridge Cutout

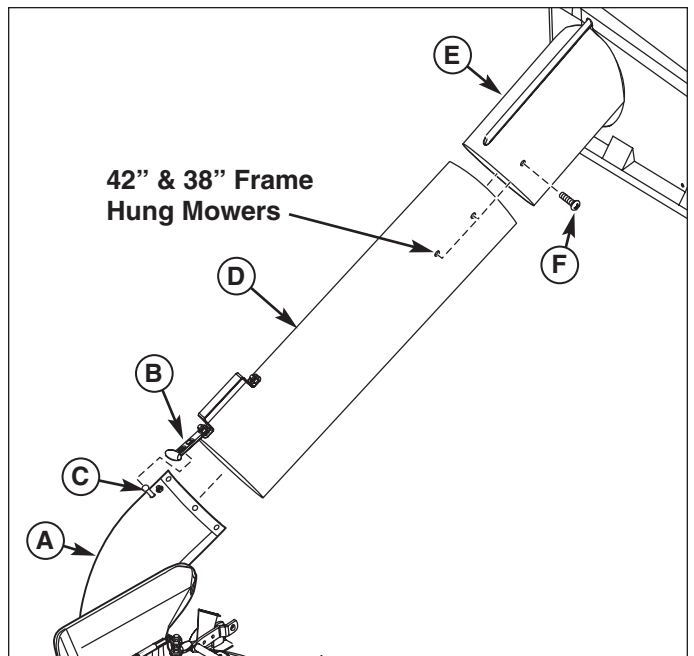
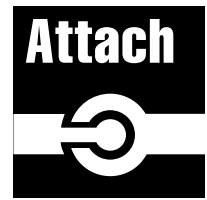

Figure 15. Install Middle Tube

- A. Lower Chute
- B. Strap, Rubber
- C. Pin
- D. Middle Tube
- E. Upper Tube
- F. Screw, Phillips Head, 1/4 x 3/4

# Normal Removal & Installation



## Normal Removal & Installation

### Collector Installation

*Note: See previous pages for more detailed installation and operation instructions if necessary.*

1. Lift discharge deflector up (E, Figure 16).
2. Place the front hole of the lower chute (A) onto carriage bolt (C) as shown. Slide front edge of lower chute (A) under hinge bracket (G).
3. Place the rear hole of the lower chute (A) onto carriage bolt (F) as shown.
4. Secure knob (B) onto carriage bolt (C) as shown.
5. Secure wing nut (D) onto carriage bolt (F) as shown.
6. Mount the the channel assembly (A, Figure 17) into hitch (D). Secure by inserting pin (C) into the right side of hitch (D) and turning pin (C) counterclockwise to lock in place.
7. Pivot cover (B) up. Install bags (E) with white bar (F) towards the rear.
8. Slide the upper and middle tube (J) aligning ridge (L) with cutout (M) as shown.
9. Slide middle and upper tube (J) over lower chute (H). Pull strap (K) and place hole completely over pin (I).

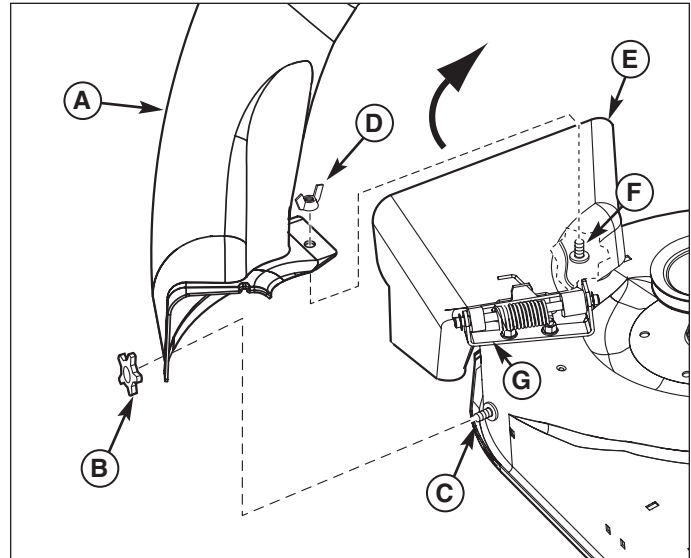

**Figure 16. Install Lower Discharge Chute**

- A. Lower Chute**
- B. Knob, 5/16-18**
- C. Front Carriage Bolt, 5/16-18 x 3/4**
- D. Wing Nut, 5/16**
- E. Discharge Deflector**
- F. Rear Carriage Bolt, 5/16-18 x 3/4**
- G. Hinge Bracket**

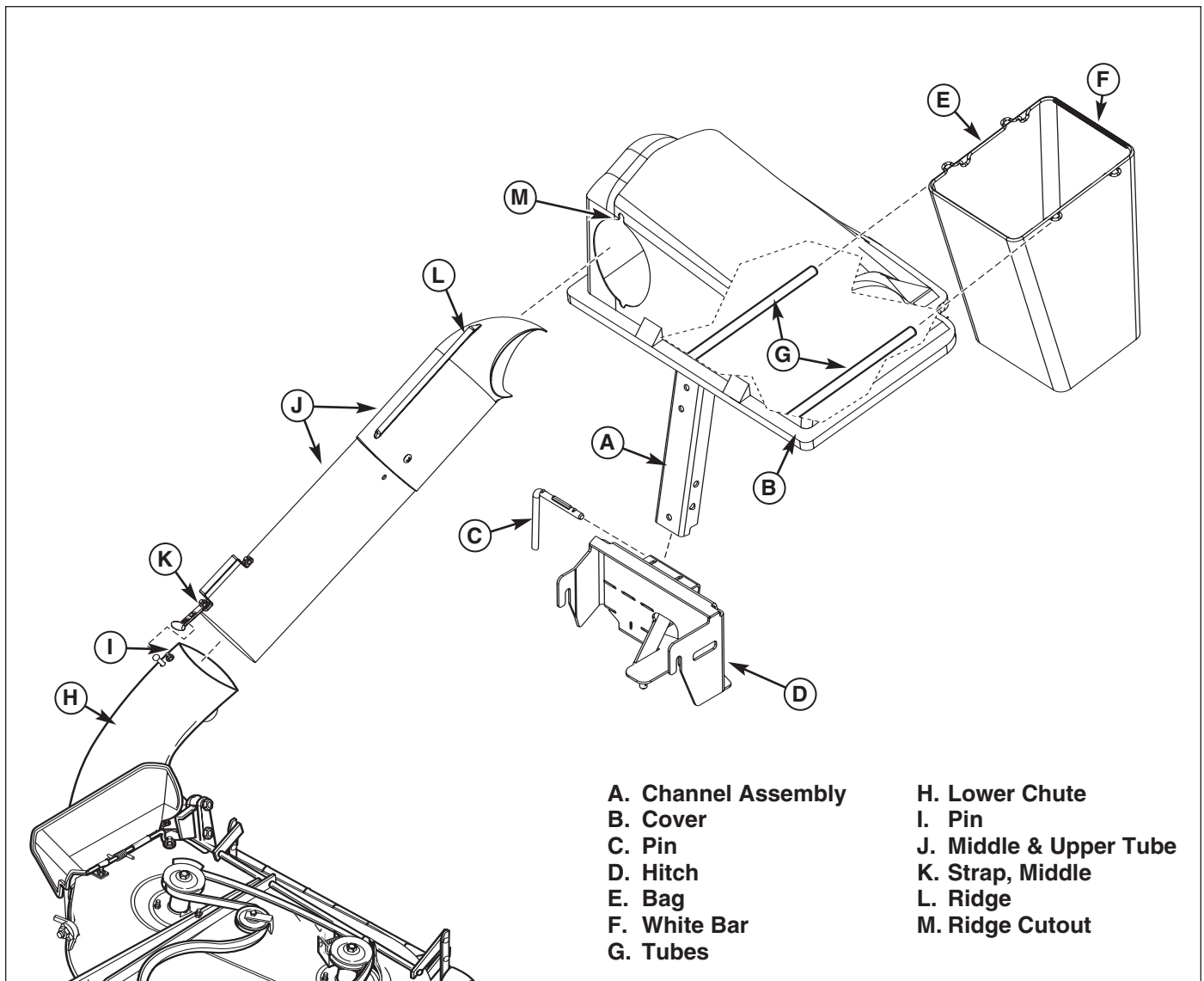

Figure 17. Normal Installation & Removal

## Collector Removal

### **⚠ WARNING**

#### OPERATION WITHOUT BAGGER

For operation without bagger, the mower deflector **MUST** be properly installed in the down position and retained by the spring latch.

1. Unhook strap (K, Figure 17) from pin (I). Remove middle and upper tube (J) from cover (B).
2. Lift up cover (B) remove and empty bags (E).
3. Remove pin (C). Lift and remove channel assembly (A) and cover (B) from hitch (D).
4. Lift discharge deflector up (E, Figure 16).
5. Remove wing nut (D) from carriage bolt (F).
6. Remove the knob (B) from carriage bolt (C).
7. Remove the lower chute (A) from carriage bolt (F).
8. Remove lower chute (A) from carriage bolt (C).



Simplicity Mfg. Inc. - Snapper Products  
535 Macon Street  
McDonough, GA 30253

[www.Snapper.com](http://www.Snapper.com)

© Copyright 2006 Simplicity Manufacturing, Inc.  
All Rights Reserved. Printed in USA.