

# INSTALLATION INSTRUCTIONS

DUAL TAIL WHEELS KIT  
Mfg. Nos. 1691852

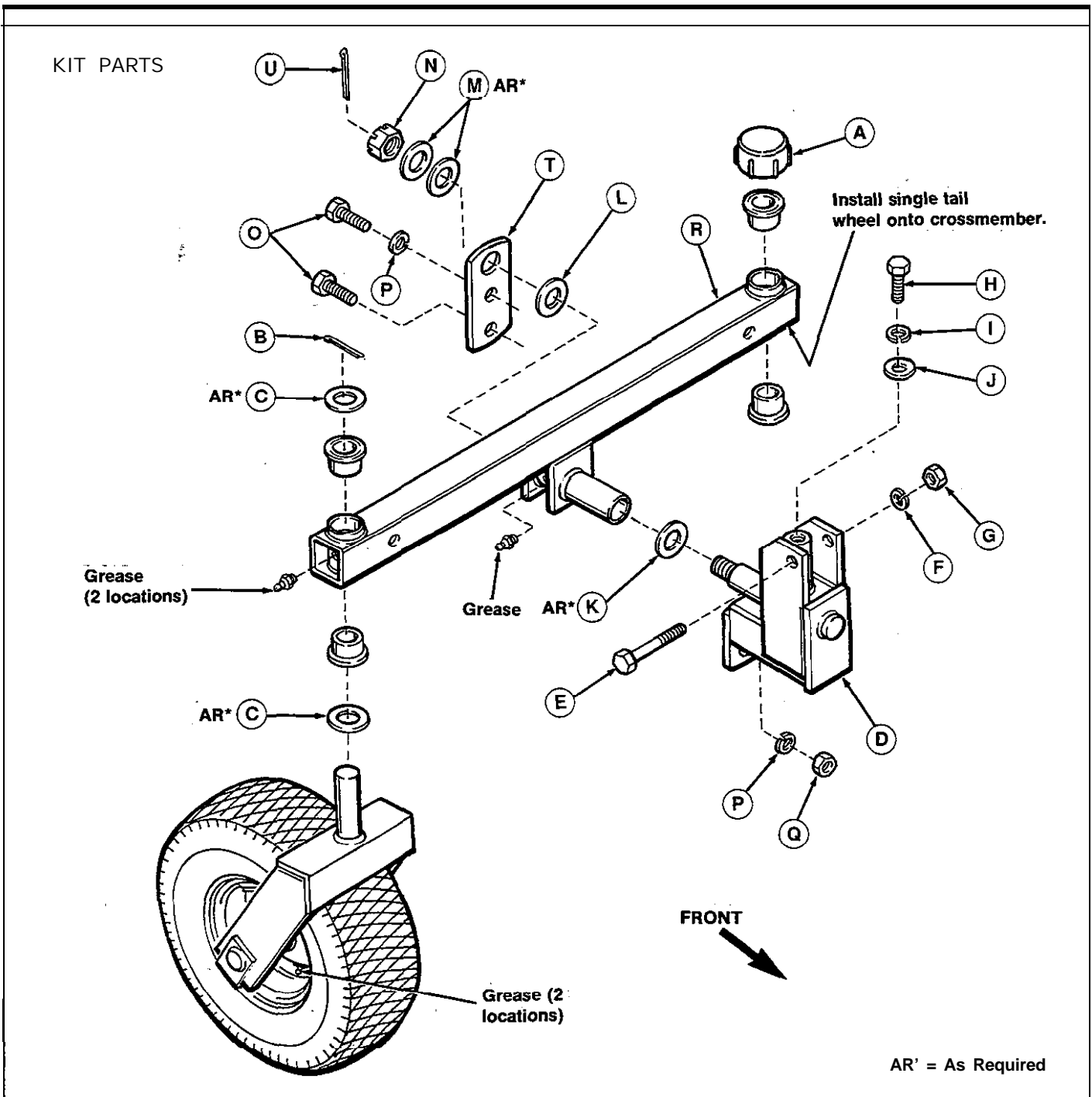

Figure 1.

- A. Plastic Cap
- B. Cotter Pin
- C. Washer
- D. Support Bracket
- E. Capscrew, 3/8-16 x 3-1/2"
- F. Lockwasher
- G. Nut

- H. Capscrew, 1/2-13 x 1-1/4"
- I. Lockwasher
- J. Flat Washer, 1-1/4" O.D.
- K. Flat Washer, 1-1/2" O.D.
- L. Flat Washer, 1-1/2" O.D.
- M. Flat Washer, 1-5/16 O.D.

- O. Capscrew, 1/2-13 x 1-1/4"
- P. Lockwasher
- Q. Nut
- R. Crossmember
- S. Wheel (Assembled)
- T. Plate
- U. Cotter Pin

## INSTALLATION

1. Jack up rear frame and support rider with wooden blocks or jackstands.
2. If 60 gallon grass catcher is to be installed, remove weights and mounting hardware from rear frame. Retain hardware and reinstall whenever grass catcher is removed.
3. Remove plastic cap (A, figure I), cotter pin (B), and washers (C) securing rear wheel. Retain hardware to reinstall wheel onto new crossmember.
4. Install (vertical) spindle of support bracket (D) through rear frame and secure with 3/8-16x 3-1/2" **capscrew** (E), lockwasher (F), and nut (G) on top of frame. Spread uprights of support bracket as required to install to rear frame,
5. Install 1/2-13 x 1-1/4" **capscrew** (H), lockwasher (I), and large flat washer (J, 1-1/4" O.D., 1/2" I.D.) through threaded spindle.
6. Install two washers (K, 1-1/2" O.D., 1" I.D.) on support bracket spindle (more may be necessary) and install crossmember (R) on spindle. While holding crossmember firmly onto spindle, rotate crossmember from side to side. If there is not at least 1/16" clearance with frame, add additional washers (K, as required) between crossmember and support bracket.
7. Place flat washer (L, 1-1/2" O.D., 1" I.D.) and plate (T) onto spindle and secure with washers, (M, 1-5/16" O.D., 3/4" I.D.) and castle nut (N). Use washers (M) as required to fill up space on spindle. Tighten castle nut securely and then back off until crossmember rotates freely. Check that cotter pin (U) can be installed through slot in castle nut. Loosen nut until step 8 is performed.
8. In top hole of plate (T), install 1/2-13 x 1-1/4" **capscrew** (O) and lockwasher (P) into weld **nut** on support bracket. In bottom hole, install similar **capscrew** (O) and secure on backside of support bracket with lockwasher (P) and **nut** (Q). Tighten capscrews (O), castle nut (N), and install cotter pin.
9. Install washer (C, 1-1/2" O.D., 1" I.D.) onto wheel spindles and install through bushings on each side of crossmember. On top side, install **similar washers** as required so that cotter pins (B) are aligned with spindle holes. Make sure that wheels rotate freely after cotter pins are installed.
10. Install plastic caps (A) over wheel spindles.
11. Lubricate the five grease fittings (2 on wheels, 2 on wheel spindles, 1 on support bracket).
12. Adjust tire pressure to 20 psi (137 kPa).