

# Simplicity

## TWO-SPEED PULLEY

Mfrs. No. 467

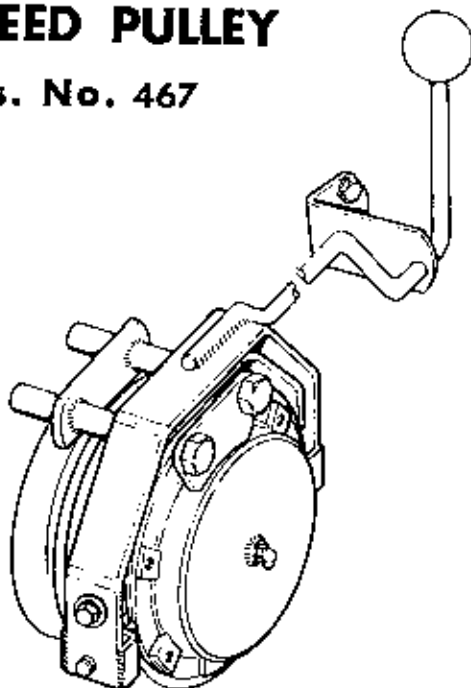

This two speed pulley can increase the effective operation of various attachments. It is designed to provide a direct drive which does not alter the existing tractor speeds. When engaged, speeds will be reduced to one third. **THIS UNIT DOES NOT ALTER THE ATTACHMENT SPEED.** The operator can change the tractor ground speeds without leaving the seat. This is done by the shift lever on the right side of the tractor.

This two speed pulley is particularly useful with the front mounted Snow blower and Snow Plow dozer blade. It is also useful with the rear mounted rotary tiller.

**NOTE:** This two speed pulley can also be installed on the 9 Hp. Landlord, 725 and 700 riding tractors. However it is necessary to cut 1" off of the pulley shaft. This can be conveniently done with a suitable instrument (saw) if the seat and transmission pulley is removed. Remove all burrs and metal shaving prior to installing this two speed pulley.

### SPEED RANGES FOR LANDLORD 101

|         | STANDARD SPEEDS | LOW RANGE SPEEDS |
|---------|-----------------|------------------|
| First   | 1.6 MPH         | .5 MPH           |
| Second  | 3.7             | 1.3              |
| Third   | 6.1             | 2.2              |
| Reverse | 3.1             | 1.1              |

### OPERATION:

Engagement of the reduced speeds is done by the operator pushing the knob to the left. Push to the right for disengaging.

**IMPORTANT:** It is important the tractor transmission is stopped for changing ranges with the low speed pulley. Make sure the idler pulley is completely disengaged before the brake is applied. (This adjustment will be found in the tractor owners and operators manual.) This will eliminate the clashing of gears and prolong their life.

### LUBRICATION:

Lubrication is applied at the factory. Prior to installation, remove set collar and pulley from gear assembly to determine if lubrication has been applied. After 100 hours of operation, remove capscrew from cover, insert the grease fitting which is shipped loose, and apply several shots of multi-purpose lithium-based type grease. Remove fitting and reinstall capscrew. **IMPORTANT! DO NOT LEAVE GREASE FITTING INTO COVER ESPECIALLY WHEN USING TIRE CHAINS. SUBSEQUANT DAMAGE CAN RESULT.** Apply a little grease on shift pivots before slipping them over shift ring.

SIMPLICITY MANUFACTURING COMPANY, INC.

1234567890  
PRINTED IN U.S.A.

# 1296

## PACKING

The two speed pulley is shipped in one carton. The grease (zerk) fitting is shipped loose in this package. All necessary hardware is included.

## ASSEMBLY AND INSTALLATION:

1. Depress the clutch and brake pedal and apply the parking brake.
2. Remove the belt from the transmission pulley.
3. Remove the transmission pulley and key from the transmission shaft.
4. Place the drive belt around the transmission shaft close to the transmission case.
5. Install the two belt stop fingers as indicated in Figure 1.
6. Install the two-speed pulley key in place in the transmission shaft.
7. Attach the two-speed pulley and gear case to the transmission shaft. Place the drive belt around the pulley and loosen the parking brake. Align the two-speed pulley with the idler pulley and the bevel gear housing pulley.
8. Tighten the set screw on the key and then the other set screw  $90^{\circ}$  away.
9. Remove the clutch hand brake spring from the capscrew on the transmission.
10. Remove this capscrew from the transmission case and also the other upper capscrew from the transmission case.
11. Insert the two long studs into the vacant capscrew holes in the upper end of the transmission case. Put the shifter handle assembly in place on these two long studs, making sure that the two pivots are properly positioned over the outer rim of the shift-ring. Refer to Figure 3. Secure with hex nuts and lockwashers.
12. Remove the capscrew from the right side of the tractor frame above the parking brake. Use this screw to attach the shift lever bracket as shown in Figure 3. Align to permit proper movement of the shift lever and then tighten in place.
13. Secure all bolts and nuts tightly. Check the clearance between the belt and the belt-stop fingers. When the belt is engaged, the clearance should be  $1/16''$ .
14. Re-install the clutch and brake spring on bracket. Refer to Figure 1.
15. Make sure that the stop plate (Fig. 3) is positioned next to the two-speed pulley gear case. Approximately  $1/16''$  clearance is required between the stop plate and cover. With this minimum clearance, the stop plate will lodge properly between the nuts.

*NOTE: For purposes of illustration only, the tractor is shown with the wheel removed. It is not necessary to remove wheel to install the two-speed pulley assembly.*

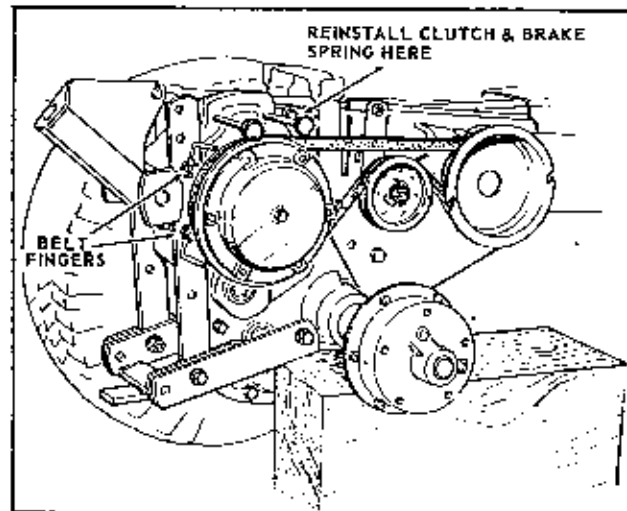

FIGURE 1

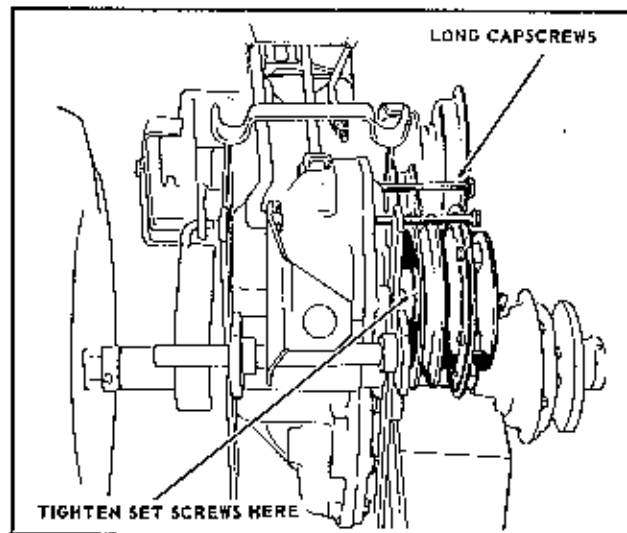

FIGURE 2

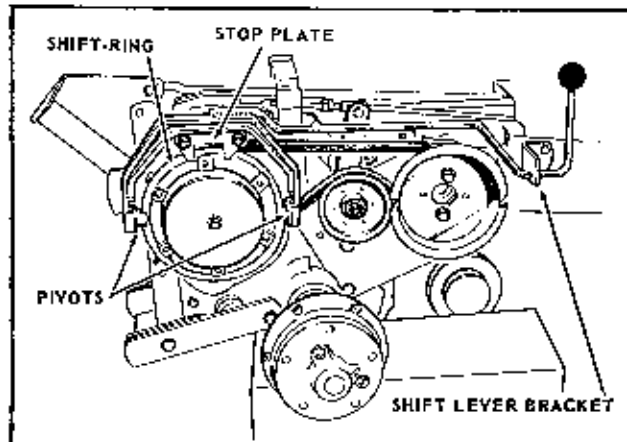
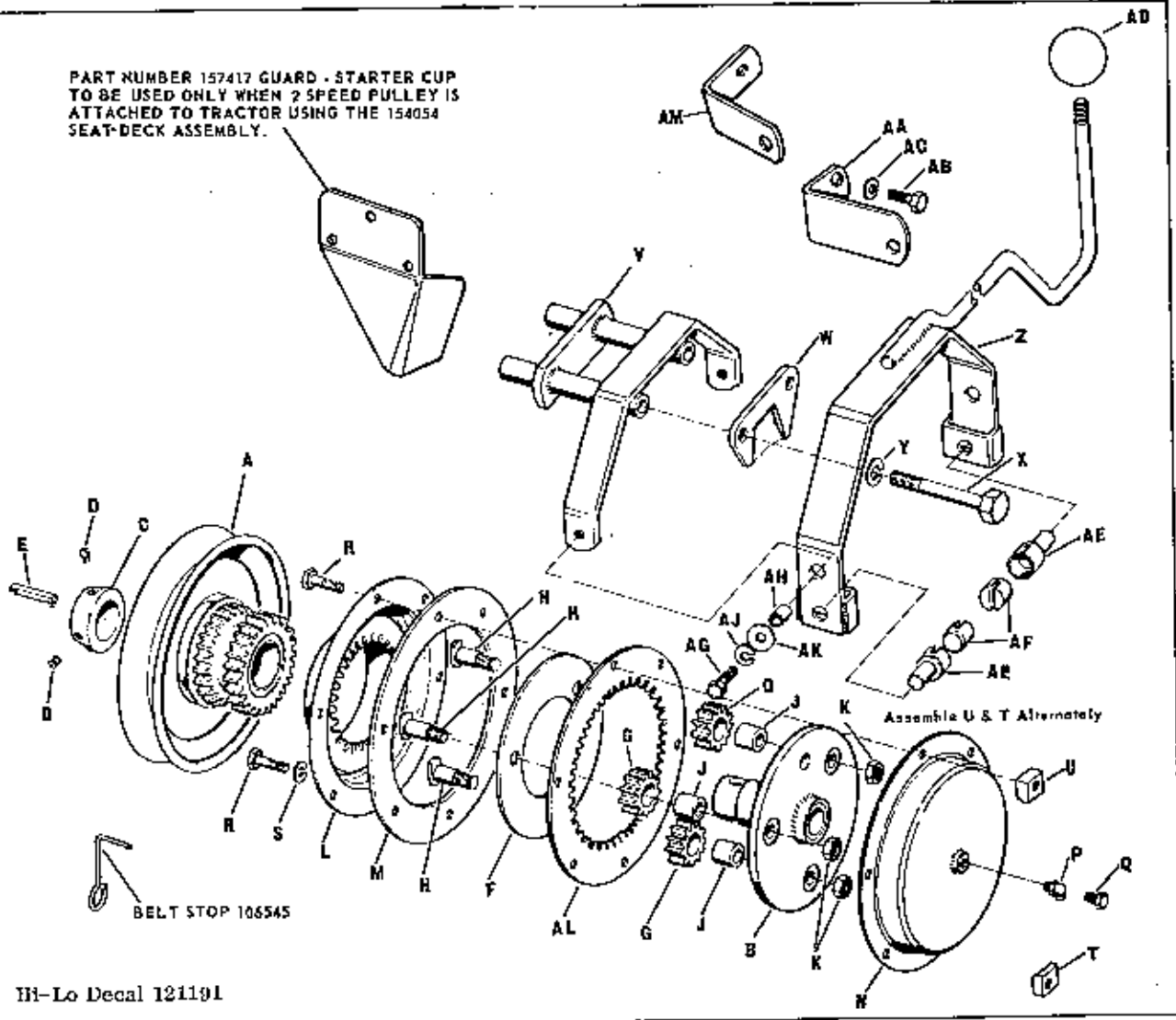

FIGURE 3

PART NUMBER 157417 GUARD - STARTER CUP TO BE USED ONLY WHEN 2 SPEED PULLEY IS ATTACHED TO TRACTOR USING THE 154054 SEAT-DECK ASSEMBLY.



Hi-Lo Decal 121191

| Ref. Let. | Part No. | Description                        | Ref. Let. | Part No. | Description                            |
|-----------|----------|------------------------------------|-----------|----------|--|
| A         | 157322   | Pulley & Gear Ass'y.               | U         | 157366   | Special Nut                            |
| B         | 157327   | Spider & Brg. Ass'y.               | V         | 157343   | Support Ass'y. Shift                   |
| C         | 157331   | Set Collar                         | W         | 157364   | Stop                                   |
| D         | 713504   | Set Screw 5/16"-18 N.C. x 3/8"     | X         | 157347   | Bolt                                   |
| E         | 157332   | Key                                | Y         | 720001   | Lock Washer 5/16"                      |
| F         | 157333   | Ring, Bolt                         | Z         | 157348   | Fork Ass'y. Shift                      |
| G         | 157335   | Pinion                             | AA        | 157352   | Support, Shift Rod F/2010-12 & Earlier |
| H         | 157336   | Pin                                | AB        | 705021   | Hex. Cap Screw 1/4"-20 N.C. x 1"       |
| J         | 157337   | Needle Bearing                     | AC        | 720003   | Lock Washer, 1/4"                      |
| K         | 717511   | Full Lock Nut, Hex., 5/16"-18 N.C. | AD        | 155044   | Knob                                   |
| L         | 157338   | Cover Ass'y. L.H.                  | AE        | 157353   | Pivot                                  |
| M         | 157381   | Shift Ring                         | AF        | 157354   | Bearing, Pivot                         |
| N         | 157340   | Cover Ass'y R.H.                   | AG        | 705030   | Hex. Cap Screw 1/4"-20 N.C. x 3/4"     |
| P         | 727004   | Grease Fitting                     | AH        | 123045   | Spacers                                |
| Q         | 706005   | Hex., Cap Screw 1/4"-28 N.F. x 1/2 | AJ        | 720003   | Lock Washer, 1/4"                      |
| R         | 715071   | Hex Cap Screw 5/16"-18 N.C. x 5/8" | AK        | 719006   | Washer Plain 1/4"                      |
| S         | 720001   | Lock Washer 5/16"                  | AL        | 157342   | Gear Ring-                             |
| T         | 157365   | Special Nut                        | AM        | 157598   | Support Shift Rod F/2110               |

## WARRANTY

The company warrants Simplicity Products to be free from defects in material and workmanship except the company makes no warranty express or implied with respect to tires, engines and engine accessories which generally are warranted by their respective manufacturers. Any part covered by this warranty which is proven defective within one year, under normal use, from date of purchase, will be replaced free of charge, f. o. b. Port Washington, Wisconsin, provided such part is returned to factory transportation charges prepaid and is found to be defective upon examination at the factory. The company is not obligated under this warranty to bear cost of labor or delivery charges in replacement of defective parts. This warranty does not apply to any Simplicity Products altered outside of Simplicity's factory. Such replacement of defective parts shall be the exclusive remedy and in no event shall Simplicity be liable for consequential damages. EXCEPT AS SPECIFICALLY PROVIDED HEREIN, THERE ARE NO WARRANTIES WHICH EXTEND BEYOND THE DESCRIPTION ON ANY SIMPLICITY PRODUCT.

Should warranty service be necessary, the information below should be presented to the authorized SIMPLICITY Dealer.

Customer's Name \_\_\_\_\_

Address \_\_\_\_\_

Mfg. No. \_\_\_\_\_ Serial No. \_\_\_\_\_

Date Purchased \_\_\_\_\_

Purchased From \_\_\_\_\_

Address \_\_\_\_\_

Engine Model No. \_\_\_\_\_ Serial No. \_\_\_\_\_ Type No. \_\_\_\_\_

To obtain replacement parts from dealer, advise quantity, part number and description.



Remember...

### FOR YOUR SAFETY

- 1 ALWAYS STOP ENGINE BEFORE LEAVING MACHINE
- 2 ALWAYS STOP ENGINE BEFORE SERVICING OR ADJUSTING MACHINE OR EQUIPMENT
- 3 ALWAYS KEEP HANDS, FEET AND CLOTHING AWAY FROM POWER-DRIVEN PARTS