

# ***Simplicity***®

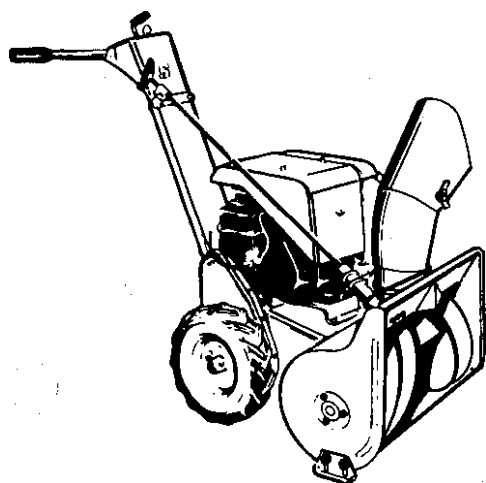

**4hp Mfrs. No. 482  
RUBBER TIRES**

**SNO-AWAY**

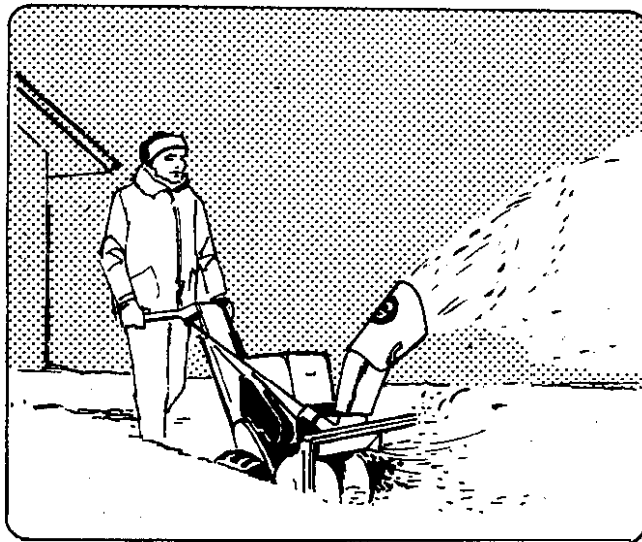
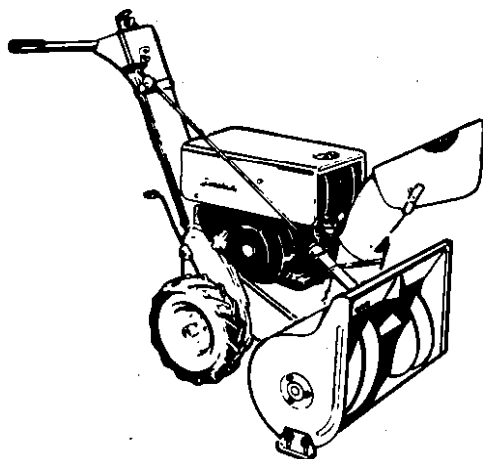

**6hp Mfrs. No. 483  
RUBBER TIRES**



1601 #

## PACKING

The 4 and 6 H.P. Sno-Aways are delivered complete in their separate cartons. The carton contains:

- 1 - Frame, Rotor, Engine and Wheel Assembly
- 1 - Handle Assembly
- 1 - Spout Adjusting Rod
- 2 - Skid Shoes
- 1 - Bag of Hardware

Should shortages of any of the above items occur, advise by stating packers number listed on the green packing slip, serial number of Sno-Away, part number and description of items missing.

## ASSEMBLY

1. Fasten the handle assembly to the mounting brackets as shown at (1), Figure 1, using the (4) 3/8-16 x 2" capscrews, 3/8" plain washers, 3/8" lockwashers and 3/8" hex nuts.

2. The throttle cable assembly is coiled around the engine for shipping purposes. Uncoil the cable and attach to the housing assembly using the (2) 32" x 1/2 self-tapping screws. The cable is held in place by the clamp on the lower portion of the right handle as shown at (2), Figure 1.

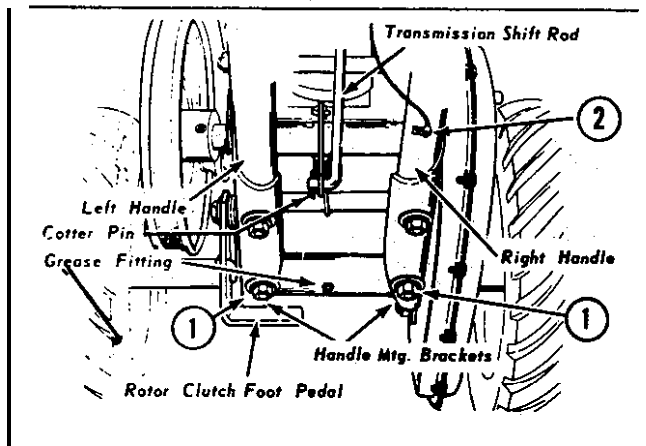

Figure 1.

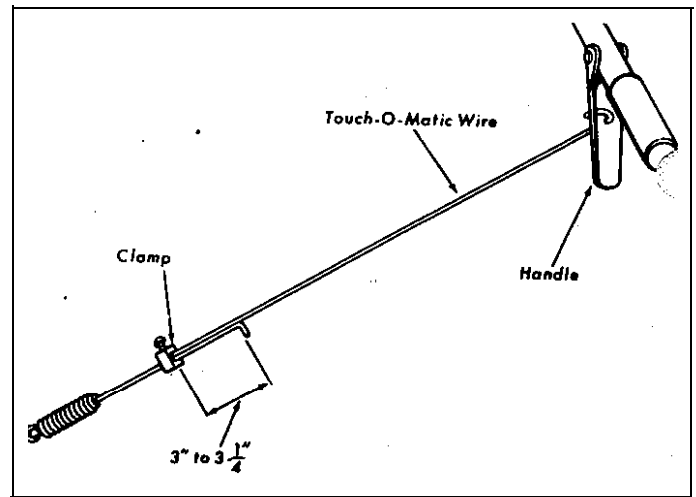

Figure 2.

3. Insert the lower end of transmission shift rod through the hole in the shift lever and fasten in place with a cotter pin as shown in Figure 1.

4. Insert the Touch-O-Matic extension wire through the wire clamp. For proper belt tension, adjust as shown in Figure 2.

5. Attach the spout control cable as shown in Figure 3. Insert the lower end of the spout control rod in the nylon bearing on the blower housing and hold in place with (2) 3/32x 5/8" cotter pins. The spout control rod support bracket is mounted in a reverse position for shipping purposes. Detach and mount as shown in Figure 4. Tighten clamp as necessary to hold spout in desired position.

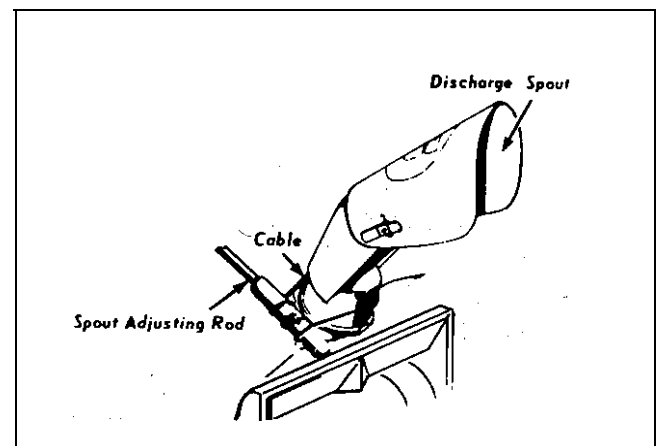

Figure 3.

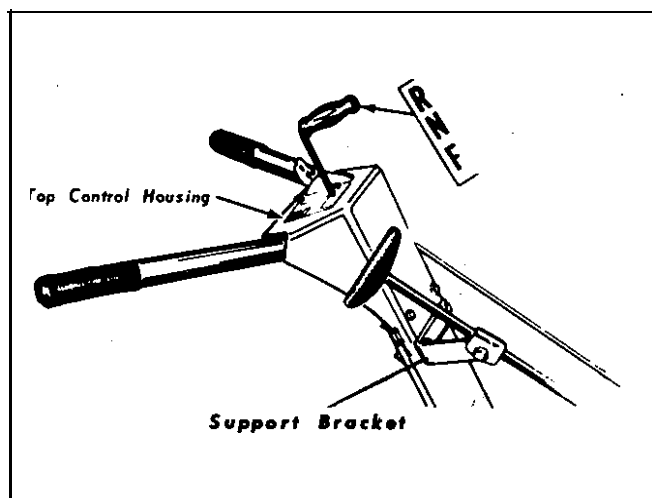

Figure 4.

## LUBRICATION

The 4 H.P. Sno-Away is equipped with 4 grease fittings that require occasional lubrication with a general purpose automotive grease. The location of these fittings is shown in Figures 1.6 & 9. The 6 H.P. Sno-Away has an additional fitting on the 2-speed axle cover.

The bearings on the rotor shaft are a sealed type and do not require further lubrication. An occasional application of light motor oil to the ends of the rotor shaft will aid in prolonging the life of the bearing seals.

## DRAINING OIL • 4 H.P. SNO-AWAY

1. Depress the handles toward the ground to effect a tilting of the engine, and place a block or support under the blower housing to keep it tilted.

2. Remove the pipe cap from the end of the oil drain elbow.

3. Thread the plastic oil filler tube No. 154381 over the threaded end of the elbow until the threads of the elbow cut threads into the plastic tubing.

4. When the plastic tubing is firmly over the threaded end of the elbow, return the Sno-Away to its normal attitude and allow the oil to drain into a suitable container.

5. Refer to engine manufacturer's manual for proper grade and volume of oil for refilling engine crankcase.

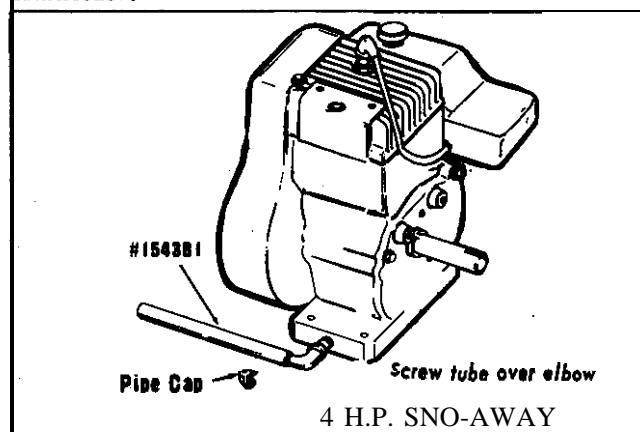

Figure 5.

## DRAINING OIL • 6 H.P. SNO-AWAY

1. Depress the handles toward the ground to effect a tilting of the engine, and place a block or support under the blower housing to keep it tilted.

2. Remove the pipe plug from the oil drain elbow.

3. Thread the plastic oil filler tube No. 154381 into the opening in the elbow until the threads of the elbow cut threads on the plastic tubing.

4. When the plastic tubing is firmly in the elbow, return the Sno-Away to its normal attitude and allow the oil to drain into a suitable container.

5. Refer to engine manufacturer's manual for proper grade and volume of oil for refilling engine crankcase.

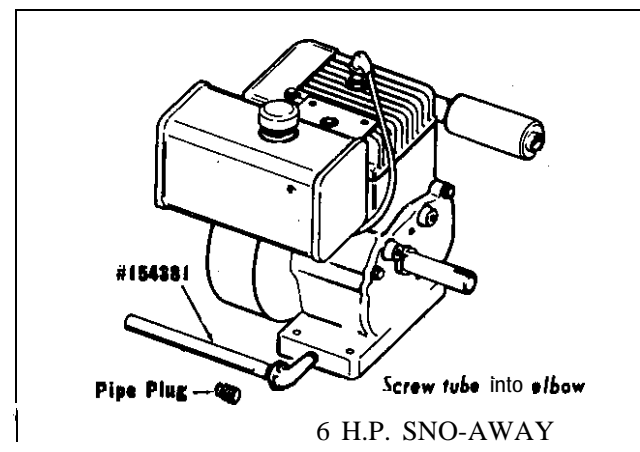

Figure 6.

## BELT TENSION ADJUSTMENT

Belt tension for the rotor drive is regulated by the position of the set collar on the rotor clutch rod. Normally a clearance of  $1/2$ " between the set collar and the clutch rod clip will properly tension this belt. Check this adjustment when the rotor clutch is engaged. Refer to Figure 7.

Belt tension for transmission drive belt is regulated by the position of the wire clamp on the extension spring.

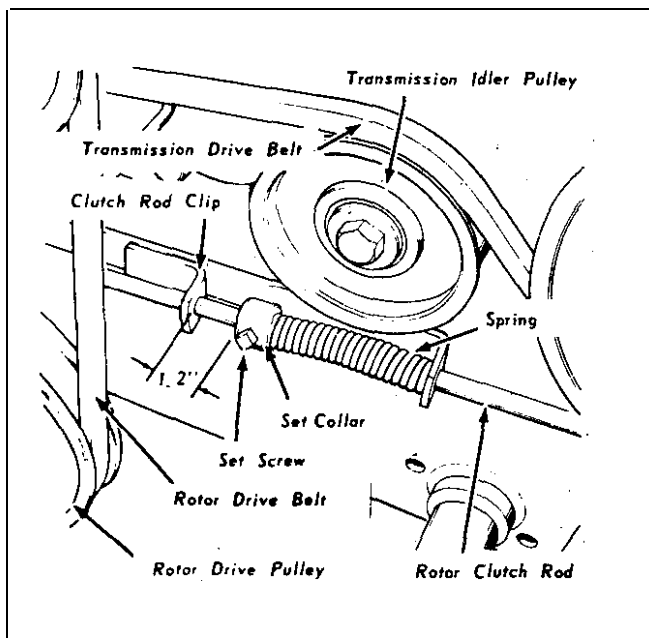

Figure 7.

## BELT STOPS ADJUSTMENT

On the drive pulley side of the engine, belt stops are mounted as shown in Figure 9. Engage the rotor clutch and transmission clutch and check clearance between belts and belt stops. The belt stops will be properly adjusted when  $1/16$ " clearance is visible between the stops and the belts. To adjust, loosen the hex capscrews and reposition the stops to proper clearance. Retighten hex capscrews to hold stops in proper position. Refer to Figure 9.

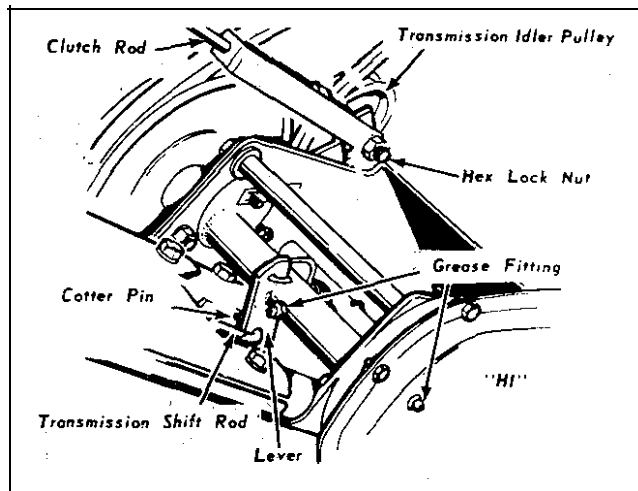

Figure 8.

## OPERATION

Before attempting to start the engine or to operate the Sno-Away, refer to the engine manufacturer's owner's manual for the proper fuel, oil, and procedure for starting the engine.

The operation of the rotor is controlled by the rotor clutch. To engage the rotor clutch, raise the foot pedal shown in Figure 9. To disengage the clutch, depress the foot pedal. Bear in mind that the rotor will operate **independently** of the forward travel of the Sno-Away, as long as the engine is running and the clutch is engaged. Exercise caution at all times, and **never** attempt to remove snow or ice from the rotor housing or discharge spout unless the engine is stopped and rotor clutch is disengaged. To stop the engine, **move** the throttle control lever all the way to the shut-off position.

If the engine fails to shut-off after moving the throttle control lever to the shut-off position, reposition the "shorting-wire" to make contact with the ignition shorting lever located on engine at end of throttle cable.

The direction of travel of the Sno-Away is controlled by the position of the transmission shift lever. Refer to Figure 2. When shifting the transmission, always release Touch-O-Matic control. With the clutch disengaged, push down on the transmission shift lever and the transmission will shift

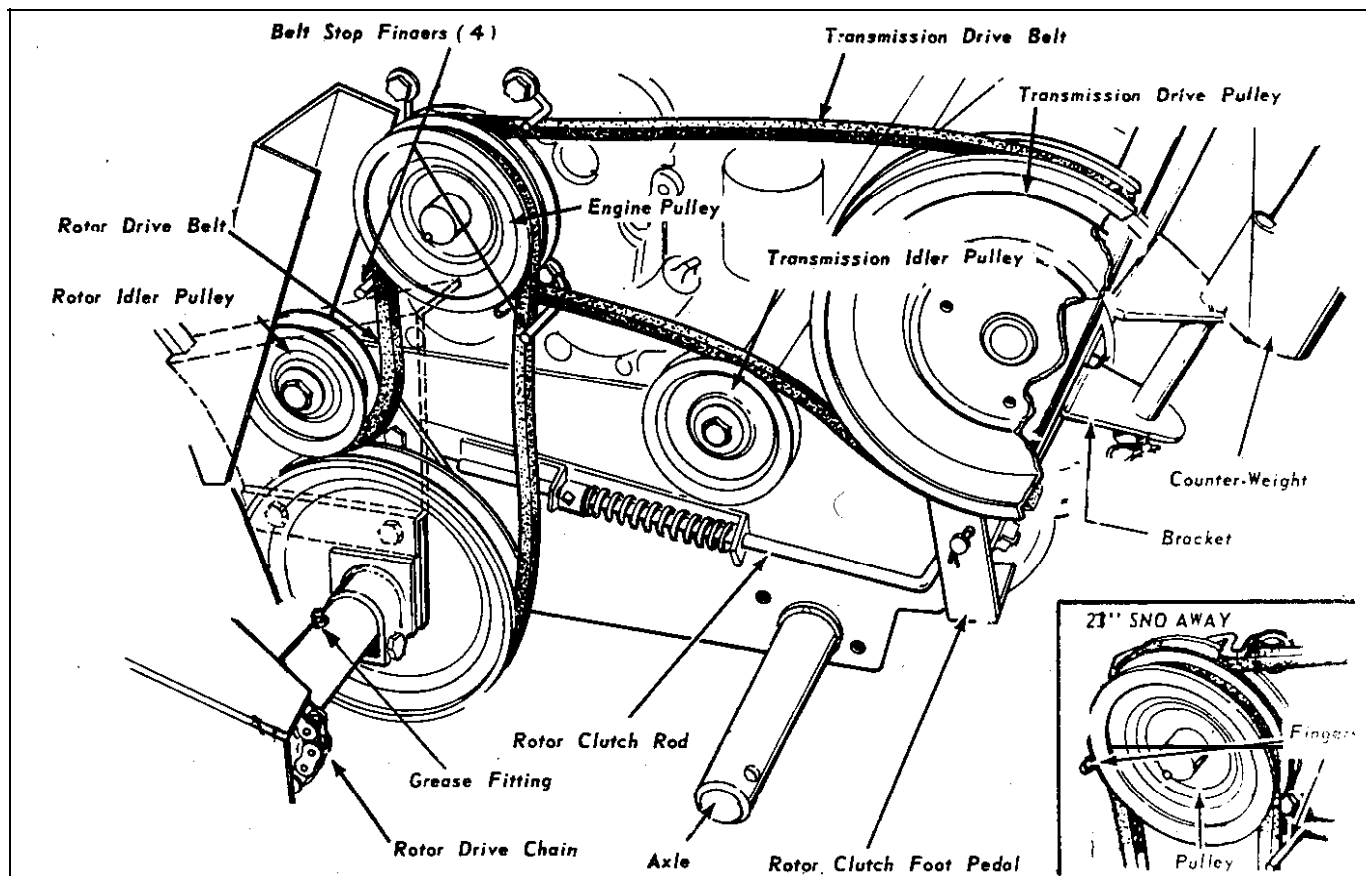

into forward position and Sno-Away will travel forward when the clutch is engaged. To reverse the Sno-Away, disengage the clutch and pull up on shift lever and transmission will shift into the reverse position. Neutral position of the shift lever is half way between forward and reverse and the lever will be held in this position by a detent lever on the left side of the Sno-Away frame.

The skid **shoes on** each side of the rotor housing are adjustable either up **or down** to suit the surface over which the Sno-Away is to be **operated**. For smooth surface, loosen the nuts and **set the shoes** so that the **lower edge** of the rotor housing rides near the surface. For use over an **uneven** or rough surface **adjust** the shoes for maximum lift.

When using the Sno-Away, adjust the discharge spout so that the snow will be thrown with the wind and never into the wind. Throwing snow into the wind will be a source of discomfort to the operator. To alter the direction of discharge, rotate the spout by means of the spout adjusting handle. The distance that the snow may be thrown may be adjusted by loosening the two wing nuts on the discharge spout extension and raising or lowering the extension to give the desired angle. After adjusting, push the extension snugly against the spout assembly to prevent snow from being blown backwards.

against the engine and operator. Slotted holes beneath the wing nuts will allow this to be done before tightening the wing nuts to hold the extension in the desired position.

When operating the Sno-Away through heavy drifts of snow, depress the handles and raise the rotor housing while taking the first pass through the drift. Then back off and lower the rotor housing and go through again. After the first path through the drift has been opened, it may be convenient to use only a portion of the width of the plow on successive passes. Naturally, efficient plowing method will vary from one snowfall to another and from location to location. The operator will soon learn to judge which methods produce the best results. When transporting the plow from one location to another, disengage the rotor clutch for safety.

## IMPORTANT

After completion of plowing operation, allow the engine to operate in a sheltered area for about 5 minutes to dry itself and prevent the formation of ice. When possible, store the Sno-Away in a cold area so that clinging snow will not melt and refreeze into ice.

## WARRANTY

The company warrants Simplicity Products to be free from defects in material and workmanship except the company makes no warranty express or implied with respect to tires, engines and engine accessories which generally are warranted by their respective manufacturers. Any part covered by this warranty which is proven defective within one year, under normal use, from date of purchase, will be replaced free of charge, f. o. b. Port Washington, Wisconsin, provided such part is returned to factory transportation charges prepaid and is found to be defective upon examination at the factory. The company is not obligated under this warranty to bear cost of labor or delivery charges in replacement of defective parts. This warranty does not apply to any Simplicity Products altered outside of Simplicity's factory. Such replacement of defective parts shall be the exclusive remedy and in no event shall Simplicity be liable for consequential damages. EXCEPT AS SPECIFICALLY PROVIDED HEREIN, THERE ARE NO WARRANTIES WHICH EXTEND BEYOND THE DESCRIPTION ON ANY SIMPLICITY PRODUCT.

## SAFE SNOW REMOVAL IS NO ACCIDENT

Improper use of snow removal equipment on the part of the operator can result in injury. To reduce this possibility, give complete and undivided attention to the job at hand.

Protect Yourself and Others By Following These Safety Tips

1. Disengage power and stop motor before cleaning discharge, removing obstacles, making adjustments, or when leaving operating position.
2. Never direct discharge at bystanders nor allow anyone in front of machine -- debris may be hidden in the snow.
3. Keep children and pets a safe distance away.
4. Do not allow children to operate machine nor allow adults to operate it without proper instructions.
5. Adjust height to clear gravel or crushed rock surfaces.
6. Exercise caution to avoid slipping or falling, especially when operating in reverse.
7. Know the controls and how to stop quickly -- read the owner's manual.
8. Handle gasoline with care -- it is highly flammable.
  - a. Use approved gasoline container.
  - b. Never add gasoline to a running motor -- fill tank out of doors and wipe up spilled gasoline.
  - c. Replace gasoline cap securely.
  - d. Open doors if motor is run in garage -- exhaust gases are dangerous
9. Disengage all clutches and shift into neutral before starting motor. Keep hands, feet and clothing away from power driven parts.
10. Use a grounded three wire extension cord for all plug-in electric units.
11. Keep machine in good operating condition and keep safety devices in place.

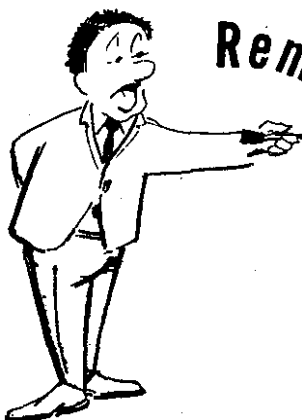

Remember...

### FOR YOUR SAFETY

1. ALWAYS STOP ENGINE BEFORE LEAVING MACHINE
2. ALWAYS STOP ENGINE BEFORE SERVICING OR ADJUSTING MACHINE OR EQUIPMENT
3. ALWAYS KEEP HANDS, FEET AND CLOTHING AWAY FROM POWER-DRIVEN PARTS

# 

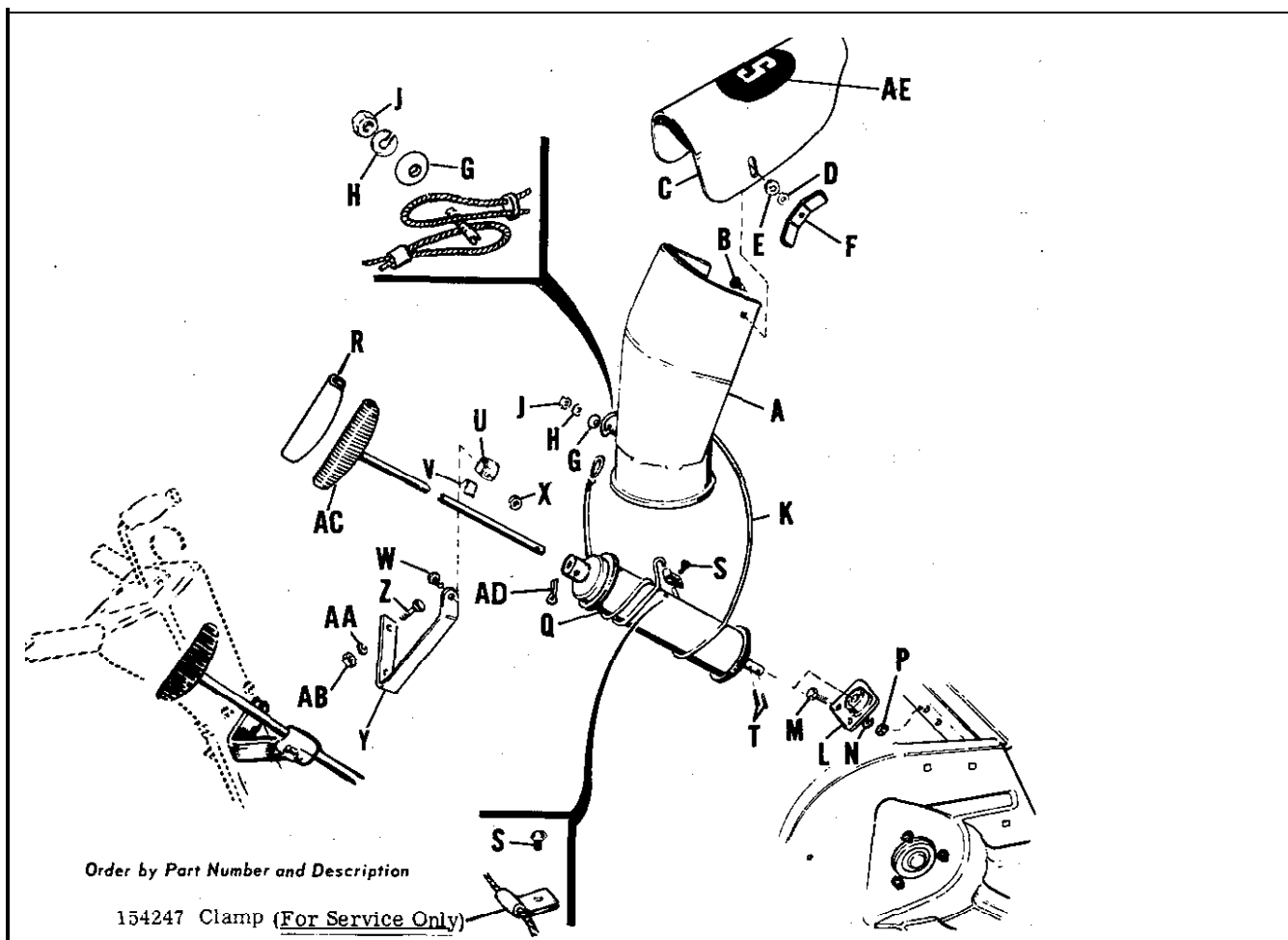

REF. LET.	PART NUMBER		DESCRIPTION
	26" Sno-Away	21" Sno-Away	
A	106762	106762	Spout Assembly
B	703005	703005	Carriage Bolt, 5/16 - 18 x 3/4" lg.
C	106760	106760	Spout Extension
D	719001	719001	Plain Washer, 3/8"
E	721601	721601	Lock Washer, 3/8"
F	106229	106229	Wing Nut
G	106785	106785	Cup Washer
H	720001	720001	Lock Washer, 5/16
J	717001	717001	Hex Nut, Full, 5/16 - 18
K	106881	106881	Cable Assembly
L	106491	106491	Bearing
M	705015	705015	Hex Capscrew, 1/4 - 20 x 5/8" lg.
N	720003	720003	Lock Washer, 1/4"
P	717005	717005	Hex Nut, Full, 1/4" - 20
Q	106870	106870	Spout Control, Tube Assembly
R	106516	106516	Handle Cover
S	715067	715067	Self-Tapping Screw, 1/4 - 20 x 3/8" lg.
T	722016	722016	Cotter Pin, 3/32 x 5/8" lg.
U	152050	152050	Rod Guide
V	121175	121175	Guide Liner
W	705018	705018	Hex Capscrew, 5/16 - 18 x 1-1/2" lg.
X	717511	717511	Hex Nut, Full, Lock, 5/16 18
Y	106521	106521	Spout Adjusting Rod Support
Z	705053	705053	Hex Capscrew, 1/4 - 20 x 1-3/4" lg.
AA	720003	720003	Lock Washer, 1/4"
AB	717005	717005	Hex Nut, Full, 1/4 20
AC	106867	106867	Handle Assembly
AD	722015	722015	Cotter Pin, 5/32 x 1" lg.
AE	106512	106512	Decal

## ROTOR BODY and FRAME

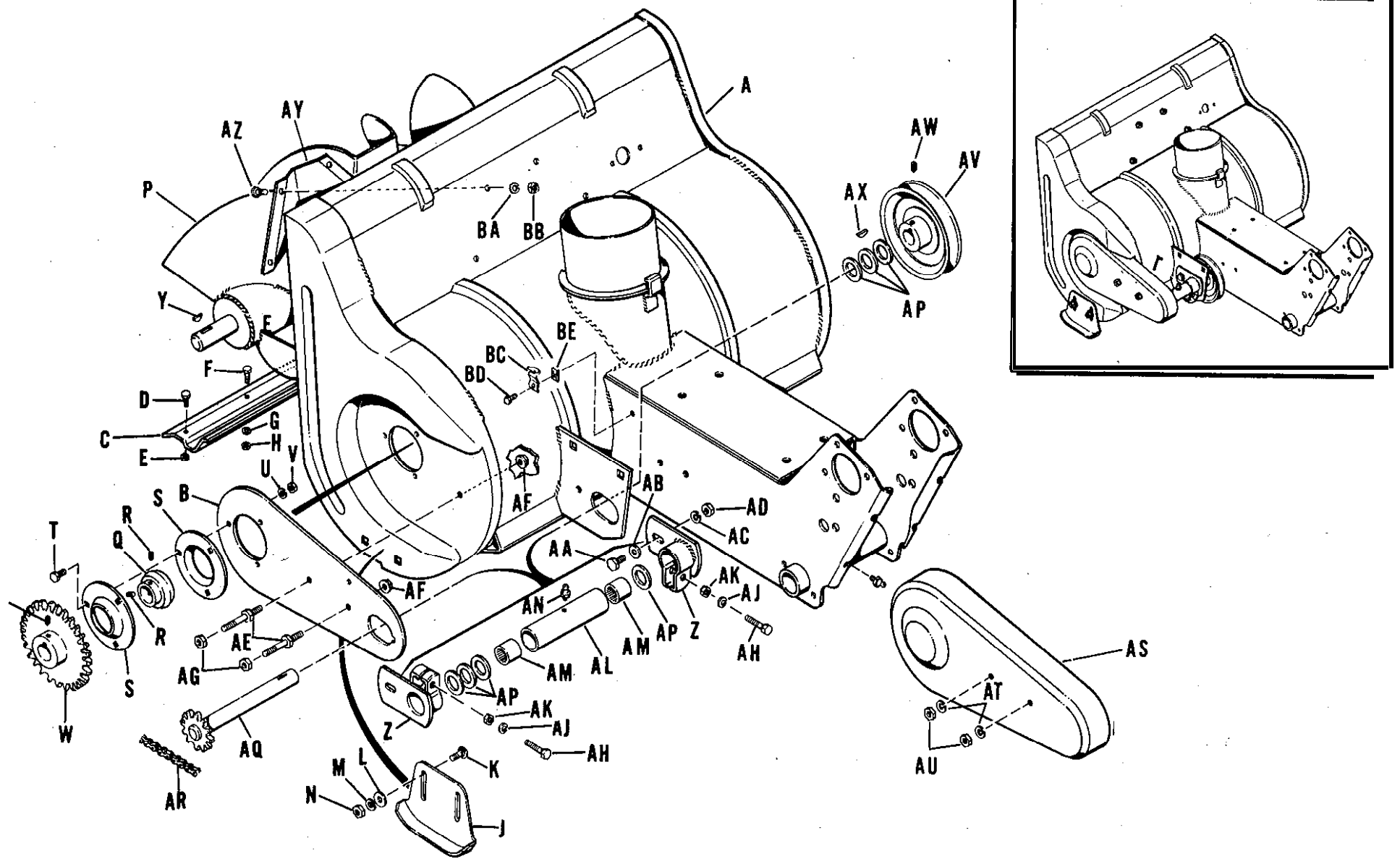



# ROTOR BODY and FRAME

REF. LET.	PART NUMBER		DESCRIPTION
	26" Sno-Away	21" Sno-Away	
A	106832	<b>106814</b>	<b>Body Frame Assembly</b>
B	106745	106745	Side Plate
C	<b>106838</b>	<b>106831</b>	Scraper • Body
D	715071	715071	Hex Capscrew, 5/16 • 18 x 5/8" lg.
E	<b>717511</b>	717511	Hex Nut Full Lock, 5/16 • 18
F	<b>715018</b>	715018	Hex Capscrew, 1/4 20 x 5/8" lg.
G	<b>720003</b>	720003	Lock Washer, 1/4"
H	71700s	717005	Hex Nut Full: 1/4 20
J	<b>106747</b>	106747	Skid
Ii	<b>703004</b>	703004	Carriage Bolt, 3/8 16 x 3/4" lg.
I.	<b>719001</b>	719001	Plain Washer, 3/8"
M	720002	720002	Lock Washer, 3/8"
N	717003	717003	Hex Nut Full, 3/8 16
I'	<b>106839</b>	<b>106823</b>	<b>R o t o r Assembly</b>
Q	106732	106732	<b>Bearing Cartridge</b>
R	<b>713509</b>	<b>713509</b>	Set Screw, 1/4 28 x 1/4" lg.
S	<b>161069</b>	<b>161069</b>	Bearing Flange
1	<b>705017</b>	<b>705017</b>	Hex Capscrew, 5/16 • 18 x 3/4" lg.
I	720001	720001	Lock Washer, 5/16"
\	717001	717001	Hex Nut Full. 5/16 • 18
\	<b>106653</b>	<b>106653</b>	Rotor Sprocket
X	<b>713503</b>	713503	Set Screw, 5/16 • 18 x 5/16" lg.
Y	<b>151040</b>	<b>151040</b>	Key
Z	106376	106176	Clamp Support Assembly
AA	<b>705005</b>	705003	Hex Capscrew, 3/8 16 x 1" lg.
AB	<b>719001</b>	<b>719001</b>	Plain Washer, 3/8"
AC	<b>720002</b>	71000'	Lock Washer, 3/8"
AD	<b>717003</b>	<b>717003</b>	trrx Nut Full. 3/8 16
AE	<b>106771</b>	106771	Stud
AF	<b>718035</b>	<b>718035</b>	Flange Nut. "Whiz Lock". 3/8 16
AG	<b>717510</b>	717310	Hex Nut Full Lock, 3/8 16
Ali	70.501 8	in.50 18	Hex Capscrew, 5/16 • 18 x 1-1/2" lg.
AJ	<b>720001</b>	<b>720001</b>	Lock Washer, 5/16"
Ali	<b>717001</b>	<b>717001</b>	Hex Nut Full_ 5/16 • 18
AL	<b>106843</b>	<b>106826</b>	Bearing Housing
AM	<b>154258</b>	<b>154258</b>	Needle Bearing
AN	<b>727002</b>	727002	Grease Fitting
AP	11061012	<b>8061012</b>	Washer
AQ	<b>106844</b>	<b>106827</b>	Shaft Assembly
AR	<b>106058</b>	<b>106058</b>	Chain
AS	<b>106759</b>	<b>106759</b>	Chain Guard
AT	720002	720002	Lock Washer, 3/8"
AI	<b>717003</b>	<b>717003</b>	Hex Nut Full. 3/8 16
AV	<b>106663</b>	<b>106663</b>	Pulley
AW	<b>713503</b>	<b>713503</b>	Set Screw 5/16 18 x 5/16" lg.
AX	<b>725003</b>	<b>725003</b>	Key
AY	10677-L	106774	Deflector
AZ	<b>705012</b>	<b>705012</b>	Hex Capscrew, 5/16 18 x 5/8" lg.
IIA	<b>720001</b>	<b>720001</b>	Lock Washer, 5/16"
BB	<b>717001</b>	<b>717001</b>	Hex Nut Full. 5/16 • 18
BC	<b>106880</b>	<b>106880</b>	Speed Clip
BD	<b>714006</b>	<b>714006</b>	Self Tapping Screw, No. 10 x 1/2" lg.
BE	<b>718008</b>	<b>718008</b>	Speed Nut

## HANDLES & CONTROLS

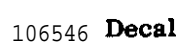

106514 Decal (4h. p.)  
106513 Decal (6h. p.)

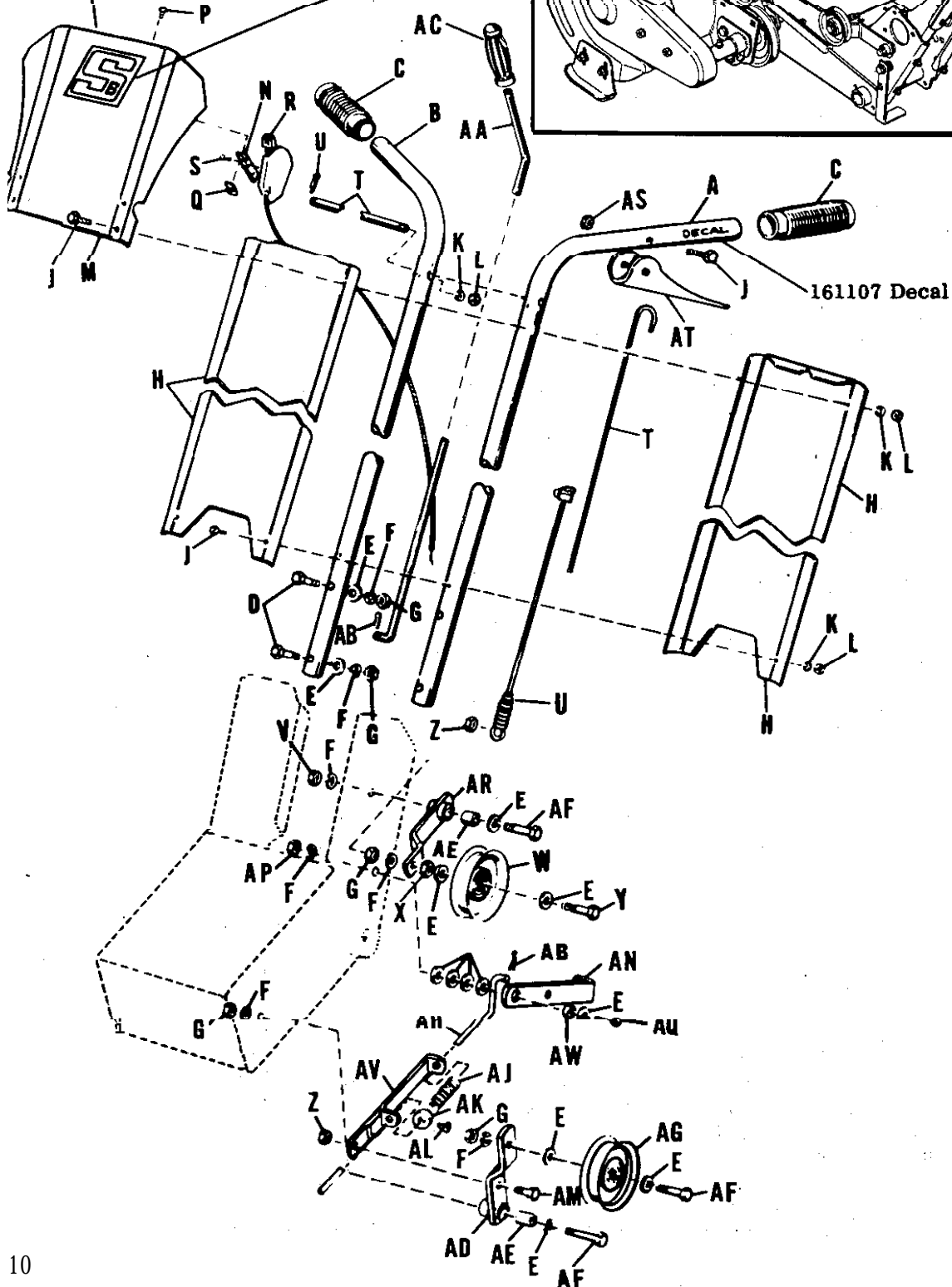
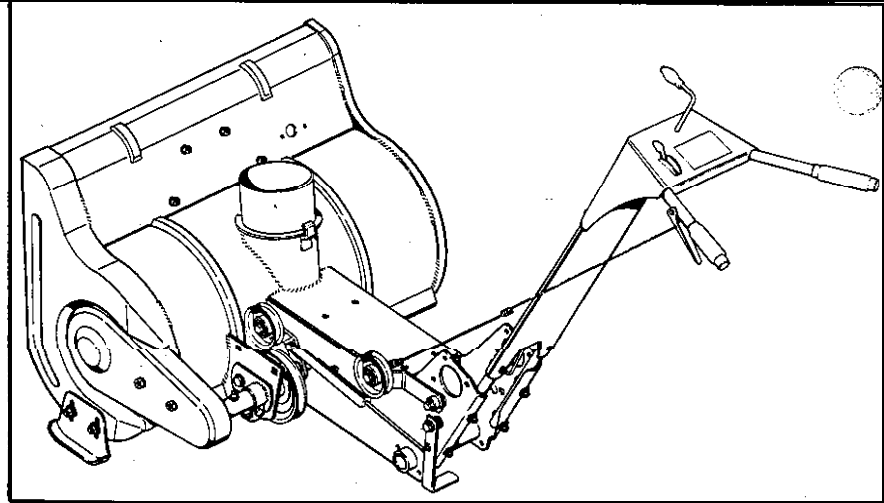

# HANDLES & CONTROLS

REF. LET.	PART	NUMBER	DESCRIPTION
	26" Sno-Away	21" Sno-Away	
A	106781	<b>106781</b>	Handle, LH
B	106782	<b>106782</b>	Handle, RH
C	106558	<b>106558</b>	Grip
D	705006	705006	Hex Capscrew, 3/8" - 16 x 2"
E	<b>719001</b>	719001	Plain Washer, 3/8"
F	720002	720002	Lock Washer, 3/8"
G	717003	717003	Hex Nut, <b>Full</b> , 3/8" - 16
H	<b>106559</b>	<b>106559</b>	Handle Cover
J	705025	705025	Hex Capscrew, 1/4" - 20 x 1-1/2"
K	720003	720003	Lock Washer, 1/4"
L	717005	717005	Hex Nut, <b>Full</b> , 1/4" - 20
M	106780	106780	Housing Assembly
N	106524	106524	Support, Throttle Control
P	714003	714003	Hex Screw, self-tap. No.10 32 x 1/2"
Q	718019	718019	Speed Nut, <b>Tinnerman</b>
R	106563	106563	Throttle Control Assembly
S	714005	714005	Screw, self-tap. No.10 -24 x 1/2"
T	106564	106564	Lever Pin
U	106778	106778	Spring Assembly
V	717003	717003	Hex Nut, <b>Full</b> , 3/8" - 16
W	154534	154534	Idler Pulley (Trans. Drive)
X	717524	717524	Hex Jam Nut
Y	705010	705010	Hex Capscrew, 3/8" - 16 x 3/4"
Z	717510	717510	Hex Nut, <b>Full</b> , Lock, 3/8" - 16
AA	106776	106776	Reverse Rod
AB	722001	722001	Cotter Pin, 3/32" x 3/4"
AC	106572	106572	Grip, Reverse Rod
AD	106201	106201	Idler Lever Assembly
AI?	8171073	8171073	Bearing Race, Inner
AF	705010	705010	Hex Capscrew, 3/8" 16 x 1-3/4
AG	154534	154534	Idler <b>Pulley</b> (Rotor Drive)
AH	106829	106829	Rotor Clutch Rod
AJ	8191045	8191045	Spring
AK	8191022	8191022	set Collar
AL	713001	713001	Set Screw, Sq. Hd. 1/4" - 20 x 3/8
AM	705031	705031	Hex Capscrew, 3/8" - 16 x 7/8" lg.
AN	106223	106223	Foot Clutch <b>Pedal</b>
AP	717003	717003	Hex Nut, <b>Full</b> , 3/8" - 16
AQ	108418	108418	Special <b>Capscrew</b>
AR	106204	106204	Idler Lever Assembly
As	717513	717513	Hex Nut, <b>Full</b> , Lock, 1/4" - 20
AT	118056	118056	Clutch Grip
AU	106786	106786	Clip
AV	8081503	8081503	Clutch Rod Guide Assembly
AW	8161215	<b>8161215,</b>	Bushing



# TRANSMISSION, WHEELS

EF ET	PART 26" Sno Away	NUMBER 21" no Away	DESCRIPTION
A		106777	Guide, Clutch Wire (4hp only)
B	153089	153069	Bearing
C	727002	727002	Grease Fitting
D	-----	106435	Axle & Gear Assembly
E	8061046	061046	Set Collar
F	713006	713006	Set Screw, Sq Hd, 5/16-18x1,
G	153114	153 114	Gasket, Bearing Housing
H	153105	153 105	Gear Case
J	705012	705012	Hex Capscrew, 5/16-18 x 5/
K	720001	720001	Lock Washer, 5/16"
L	717001	717001	Hex Nut, Full, 5/16"-18
M	106193	106193	Shaft, Intermediate
N	12 1044	12 1044	Lock Pin.
P	705005	705005	Hex Capscrew, 3/8"-16 x 1"
Q	719001	719001	Plain Washer, 3/8"
R	720002	720002	Lock Washer, 3/8"
S	7 17003	717003	Hex Nut, Full, 3/8"-16
T	153124	153124	Retaining Ring
u	153079	153079	Washer
v	121306	12 130 6	Gear Assembly, Intermediate
W	153078	153078	Bearing, Intermediate
x	106199	106199	Housing Assembly, Bearing
Y	727002	727002	Grease Fitting
Z	8051038	051038	Bearing
AA	121115	121115	Pulley Shaft Assembly
AB	153079	153079	Washer
AC	153124	1 5 3 1 2 4	Retaining Ring
AD	121118	12 1118	Reverse Pinion
AE	121107	12 1 107	Reverse Pinto" Spacer
AF	121163	121163	Pinion Spacer
AG	121139	121139	Lock Plate
AH	153094	1530 94	Shield
AJ	719002	719002	Plain Washer, 5/16"
AK	7 15033	715033	Hex Head Bolt, L.H.
AL	153090	153090	Nut, Hex, Full, L.H.
AM	153115	153115	Gear Case Gasket
AN	153106	153106	Gear Case Cover Assembly
AP	714006	714006	screw. Self-Tapping, #10 x 1/2"
AQ	716008	718008	Speed Nut
AR	106215	106215	Plate, Friction, Stop
AS	106217	1062 17	Spacer, Frame
AT	106216	106216	Bolt, Frame
AU	720001	720001	Washer, Lock, 5/16"
AV	717001	717001	Hex Nut, Full, 5/16"-18
AW	718021	718021	Detent, Neutral
AX	714014	7 14014	Screw, Self-Tapping, #10 x 3,
AY	719006	719006	Washer, Plain, 1/4"

REF. LET.	PART NUMBER		DESCRIPTION
	26" Sno Away	21" Sno Away	
BZ	715018	715018	Hex capscrew, 1/4"-20 x 5/S
CA	153121	153121	Spring, Reverse Lever
CB	153011	153011	Extension, Spring
c c	121187	-----	Sun Gear Assembly
CD	121167	-----	snap Ring
CE	106394	-----	Key
CF	106410	-----	Shift Rod Assembly
CG	121169	-----	Shift Block
CH	106572	-----	Clevis Rod Grip
CJ	121146	-----	Housing Assembly
CK	720003	-----	Lock Washer, 1/4"
CL	717005	-----	Hex Nut, Full, 1/4"-20
CM	121148	-----	Cover Assembly
CN	121151	-----	Ring Gear
CP			
CQ	121163	-----	Pinion Pinion spacer
CS	121162	-----	Bolt Ring
CT	121184 106416	-----	Hex Head Bolt Spider
c u	72 1004	-----	Lock Washer, 3/8" Shakeproof
c v	718015	-----	Hex Nut, Full, 3/8"-24
CW	121185	-----	Thrust Plate
c x	121186	-----	Seal, Housing Assembly
CY	106407	-----	Carrier Assembly
CZ	705015	-----	Hex capscrew, 1/4"-20 x 5/a
DA	10639:	-----	Washer
DB	106406	-----	Axle Shaft
DC	106405	-----	Axle Plate, R.H.
DD	154291	-----	snap Ring
DE	727002	-----	Grease Fitting
DF	7 19002	-----	Plain Washer, 5/16"
DG	106392	-----	spacer
DH	720002	-----	Lock Washer, 3/8"
DJ	717003	-----	Hex Nut, Full, 3/8"-16
DK	153068	-----	Bearings
DL	106414	-----	Gear & Tube Assembly
DM	121144	-----	Cover, Gear Case Assembly
DN	715017	-----	Hex Capscrew, 5/16-18 x 1-1.,
DP	7 19002	-----	Plain Washer, 5/16
DQ	717511	-----	Hex Nut, Full, 5/16"
DR	153074	-----	Guide, Rod
DS	121175	-----	Liner
DT	106419	106419	Wheel & Tire Assembly
DU	118053	118053	Pin
DV	8161045	8161045	Spring Clip
DW	106420	106420	Steel Wheels
DX	8061055	6061055	Seal, Felt

# SHIELD, DRIVE PULLEYS, ENGINE

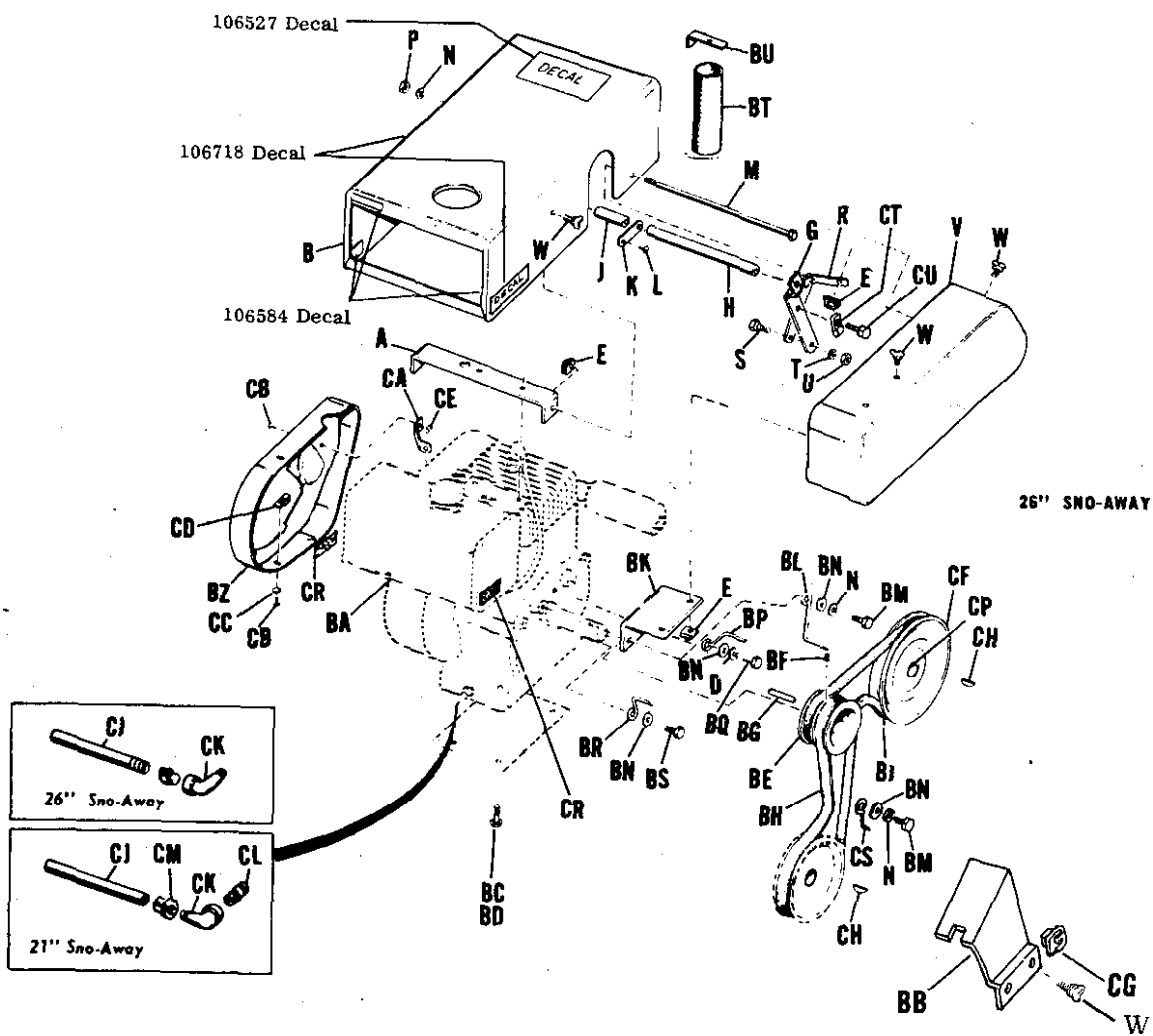
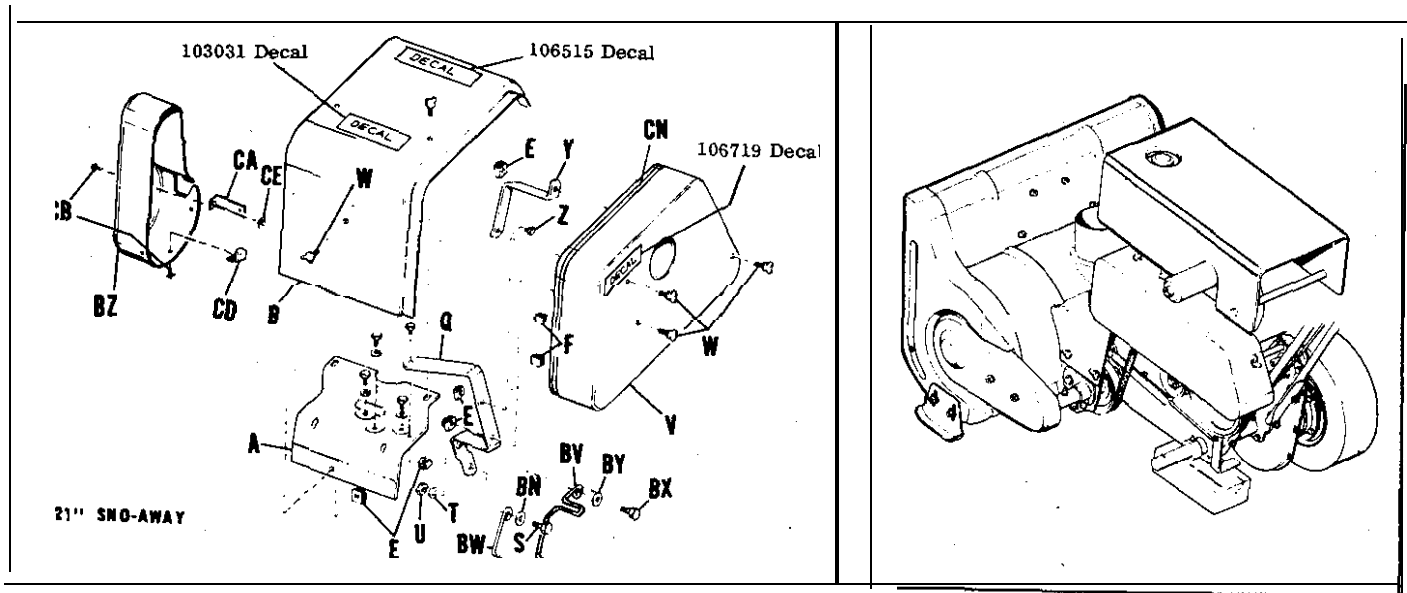

# SHIELD, DRIVE PULLEYS, ENGINE

REF. LET.	PART NUMBER		DESCRIPTION
	26" Sno Away	21" Sno Away	
A	106519	106533	Hood Support
B	106573	106534	Hood Assembly
C	705012	705012	Hex Capscrew, 5/16 - 18 x 5/8" lg.
D	720001	-----	Lock Washer, 5/16"
E	7 18030	718030	Tinnerman Nut, #C31280-5618-1
F	-----	106372	Speed Clip
G	106523	-----	Rear Hood Support
H	106576	-----	Hood spacer, LH
J	106577	-----	Hood Spacer, RH
K	106525	-----	Brace
L	710004	-----	Round Hd. Screw, X10-32 x 3/8"
M	106578	-----	Bolt, Hood Spacer
N	720001	-----	Lock Washer, 5/16"
P	7 17001	-----	Hex Nut, Full: Lock, 5/16"-18
Q	-----	106541	Belt Guard Support
R	106520	-----	Belt Guard Brace
s	705007	705007	Hex Capscrew, 5/16 - 18 x 1" lg.
T	720001	720001	Lock Washer, 5/16"
U	717001	7 1700 1	Hex Nut, Full, 5/16"-18
v	106579	106537	Belt Guard Assembly
W	715037	715037	Thumb Screw
X	-----	-----	-----
Y	-----	106540	Belt Guard Bracket
Z	-----	7 14007	Screw, Rec. Hex. Hd., Self-Tapping, 1/4"-20 x 3/8" lg.
BA	106779	106439	Engine
BB	106865	106866	Belt Cover
ac	715079	-----	Special Capscrew, 3/8 - 16 x 1-1/4" lg.
3D	-----	715081	Special Capscrew, 3/8- 16 x 1" lg.
BE	106882	106227	Engine Pulley
3F	7 13504	713504	Set Screw, Cup Pt., Socket Hd., 5/16"-18 x 3/8" lg.
3G	159129	822 1042	Key
3H	154307	154307	V-Belt ( Rotor Drive )
3J	3021077	8021077	V-Belt ( Transmission Drive )
3K	106522	-----	Guard Support
3L	8061089	-----	Belt Stop
3M	706001	-----	Hex Capscrew, 5/16"- 24 x 3/4" lg.
3N	719002	719002	Plain Washer, 5/16"
3P	106347	-----	Belt Stop
3Q	705017	-----	Hex Capscrew, 5/16"-18 x 3/4" lg.
3R	106346	-----	Belt Stop
3s	706016	-----	Hex Capscrew, 5/16"-24 x 5/8" lg.
BT	1 0 6 5 8 1	-----	Rubber Tube
3U	106385	-----	Tube Clamp
BV	-----	106624	Belt Stop
BW	-----	106545	Belt Stop
Bx	-----	706017	Hex Capscrew, 1/2"-20 x 1" lg.
BY	-----	721506	Lock Washer, Int. Shakeproof, 1/2"
BZ	106.585	106590	cover, Air cooling
CA	106586	106591	Cover Bracket
CB	714003	114003	screw, Self-Tapping #10 x 1/2" lg.
CC	7 19007	-----	Plain Washer, 3/16"
CD	718031	718031	Speed Nut, Special
CE	7 180 19	718019	Speed Nut
CF	106214	106214	Pulley, Transmission Drive
CG	718041	718041	Nut Retainer
CH	725003	725003	Key, woodruff
CJ	154381	154381	Tube, Oil Filler
CK	728501	728502	Street Elbow, 90°
CL	-----	106601	Nipple
CM	-----	726502	Pipe cap
CN	-----	106547	Strip. White
CP	713503	713503	screw. Set
CQ	719002	-----	Plain Washer, 5/16"
CR	106582	-----	Felt Pad
CS	8081035	-----	Belt Stop
CT	154247	-----	Clamp
CU	715067	-----	Hex Capscrew. Self-tapping

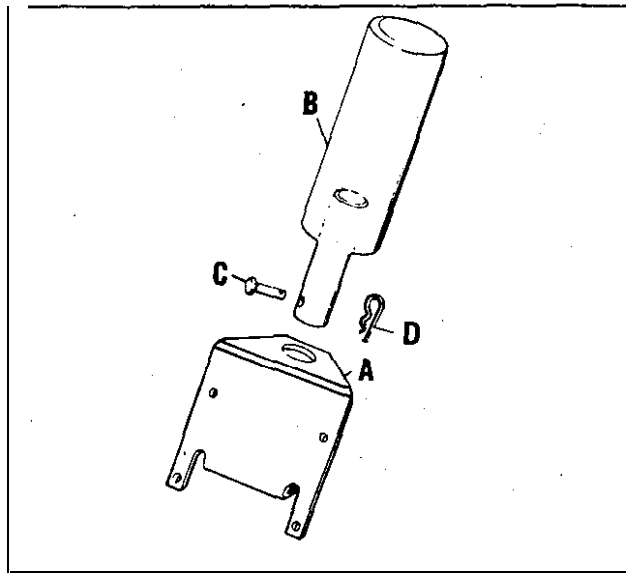

Figure 10.

**COUNTER-WEIGHT KIT**  
**Article No. 260**

REF. LET.	PART NUMBER		DESCRIPTION
	26' Sno-Away	21" Sno-Away	
A	106449	-----	Bracket, Weight
B	154322	-----	Weight Assembly
C	118053	-----	Pin
D	8161045	-----	Clip, Spring

**COUNTER-WEIGHT KIT**  
**Article No. 260**

For added traction in extreme icy conditions, and added handling ease, the above counterweight kit **is** available as optional equipment.

The bracket **and** weight are attached as shown in Figure 7.

Order Steel Lug Wheels by Article Number 257.  
Order Rubber Tire Wheels by Article Number 258.  
Order Tire Chains for Rubber Tire Wheels only, by Article Number 259.