Simplicity®

**OWNER'S
MANUAL**

MFG. NO. 784 42" ROTARY MOWER

MFG. NO. 740 48" ROTARY MOWER

SIMPLICITY MANUFACTURING COMPANY

TP-100-1354-00-AT-S

(was Form 0P-32)



TO THE OWNER

You have made a wise choice in selecting the Simplicity mid-mounted rotary mower for your tractor. It has been specially designed for your Simplicity tractor and constructed to give lasting superior performance.

Before attempting to operate the mower, study this manual and the manual for your tractor thoroughly. Pay special attention to the safety rules in this manual as well as the tractor owner's manual. Your Simplicity equipment is designed with your safety in mind, but it is up to you to be an alert, safety conscious operator. Be sure anyone else who may operate the tractor is also familiar with the operation and safety instructions.

Your Simplicity equipment requires only a minimum of care, but the maintenance instructions should be followed carefully. Thank you for taking time to read this manual. The time spent will pay big dividends in the extra time saving performance you receive from your Simplicity mower. When ordering replacement parts for your rotary mower, be prepared to give your Simplicity dealer the identification number found on the identification plate shown below. It is located on top of the mower deck. We suggest you locate the number now, and record it below for easy reference.

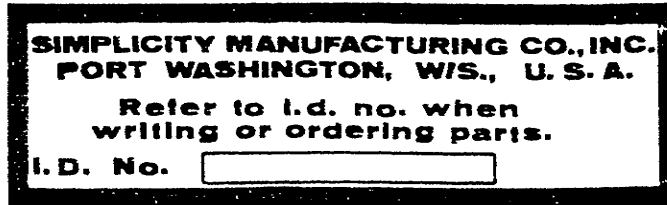

IDENTIFICATION PLATE

SIMPLICITY'S NEW EQUIPMENT WARRANTY

The Company warrants Simplicity products to be free from defects in material and workmanship, except the Company makes no warranty, express or implied, with respect to tires, engines, generators and voltage regulators, which are warranted by their respective manufacturers. Any part covered by this warranty which is proven defective within one year (45 days for equipment used for rental, municipal or commercial purposes) under normal use, from date of purchase, will be replaced without charge, provided such part is returned to the factory, (if requested), and is found to be defective upon examination at the factory. This warranty does not apply to any Simplicity products altered outside of the Simplicity factory. THE FOREGOING WARRANTY IS IN LIEU OF ALL OTHER WARRANTIES, EXPRESS OR IMPLIED, OF MERCHANTABILITY, FITNESS FOR A PARTICULAR PURPOSE, PERFORMANCE, OR OTHERWISE. The Company's obligation under its warranty is strictly and exclusively limited to the replacement of such parts, and in no event shall the Company be liable for any other damages, whether direct, immediate, incidental, special, or consequential. Simplicity Manufacturing Company, Inc., reserves the right to modify or change specifications without prior notification. There are no warranties which extend beyond the description of any Simplicity product.

TABLE OF CONTENTS

SAFETY PRECAUTIONS	1
RECOMMENDED ACCESSORIES AND OPTIONS	2
INSTALLATION	2
REMOVING THE MOWER	3
OPERATION	3
BEFORE OPERATING THE MOWER	3
ENGINE SPEED SETTING	3
POSITIONING THE MOWER	3
ENGAGING THE POWER TAKE OFF	4
CONTROLLING GROUND SPEED	4
MOWING PATTERN	4
MOWING HINTS	4
ADJUSTMENTS	4
CUTTING HEIGHT	4
FRONT TO REAR HEIGHT ADJUSTMENT	4
TROUBLE SHOOTING GUIDE	5
MAINTENANCE	5
ORDERING REPLACEMENT PARTS	5
AFTER EACH USE	5
EVERY 50 HOURS	6
BLADE REPLACEMENT	6
BELT REPLACEMENT	6
SPECIFICATIONS	7
PARTS LIST	8

SAFETY PRECAUTIONS TO PROTECT YOURSELF AND OTHERS

Read and become familiar with the owner's manual for your tractor and the mower before operating the mower.

Do not allow anyone to use the mower unless they have been instructed in how to operate it safely.

Never attempt to adjust, repair, or service the mower while the tractor engine is running.

Do not allow others near the mower while it is operating.

Stay clear of the drive belt, pulleys, and mower blades when the tractor engine is running.

Be sure the mower blades and drive belt have stopped turning before attempting to adjust, repair, or service the mower.

CAUTION: THE BLADES MAY CONTINUE TO ROTATE SEVERAL SECONDS AFTER THE CLUTCH HAS BEEN

DISENGAGED OR THE ENGINE SHUT OFF.

Clear the work area of objects which may be picked up and thrown.

If the mower blade should strike a solid object, disengage the mower drive and shut the tractor engine off immediately. Check the mower blades for damage or loose blade mounting bolts.

Disengage power to the mower and stop the engine before leaving the operator's position.

Mow only in daylight or good artificial light.

Check the blade mounting bolts for proper tightness whenever the mower has been removed from the tractor.

Use caution when mowing on a sloping surface.

MFG. NO. 784-42" and MFG. NO. 740-48" ROTARY MOWER

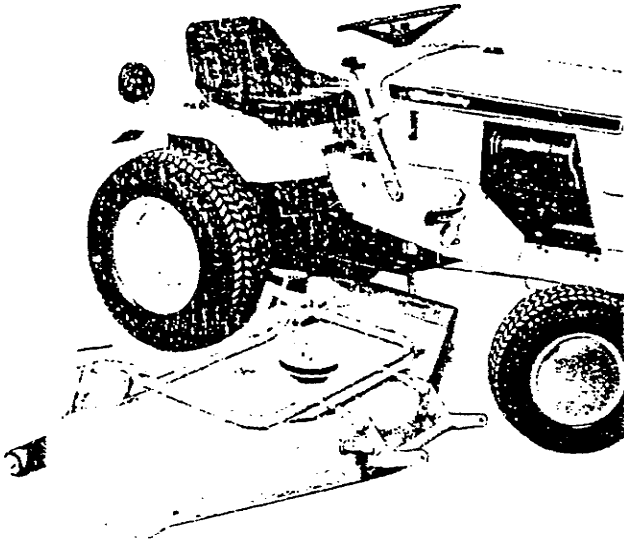

Figure 1. Mower positioned to be slid under tractor.

RECOMMENDED ACCESSORIES AND OPTIONS

Rear wheel weights will give better traction and stability when mowing on hills.

INSTALLATION

1. See figure 1. Position the mower as shown in figure 1, on either side of the tractor. If the mower is to be slid in from the right side as shown on figure 1, turn the front wheels to the left. If the mower is to slide under the tractor from the left side, turn the front wheels to the right.
2. See figure 2. Slide the mower under the tractor as shown and center the mower lift eyebolt under lift cable (A).
3. Attach lift cable (A) to the mower lift eyebolt using pin (B) and spring clip (C).
4. Use the tractor lift lever or electric lift switch to lift the

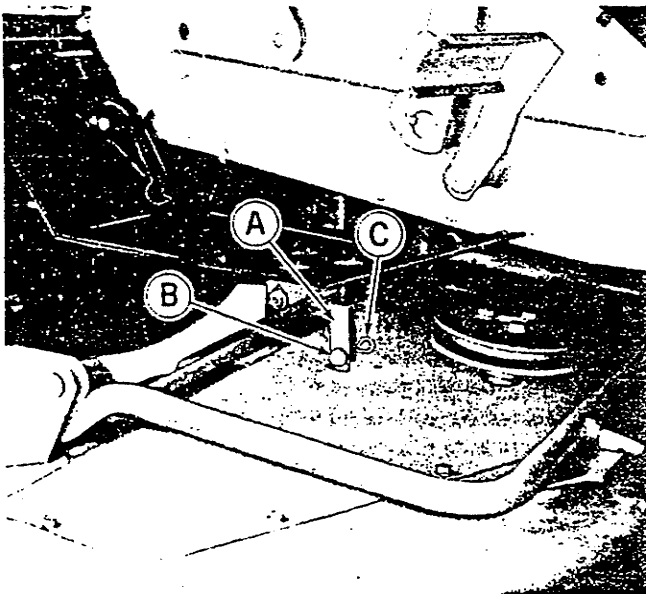

Figure 2. Lift cable attached to mower.

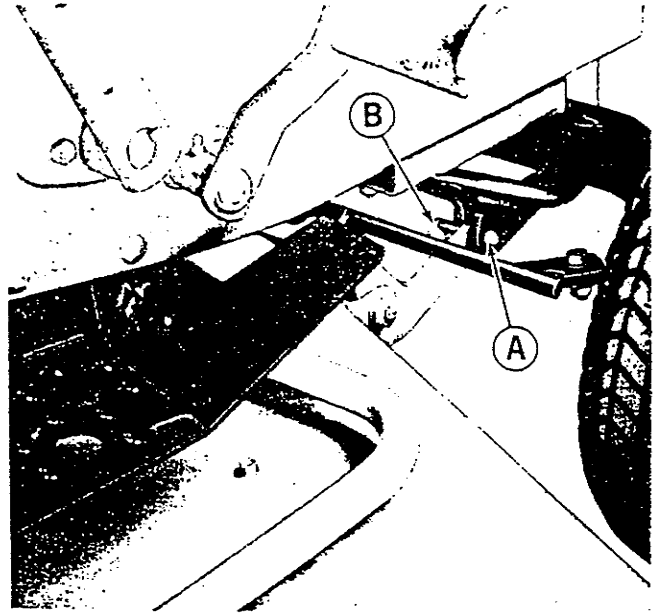

Figure 3. Mower attached to tractor front axle.

mower to the raised position.

5. See figure 3. The mower is well enough balanced in this position so one person can easily install the pins (A) to attach the hitch assembly of the mower to the tractor front axle. This is most easily done by installing the left pin and spring clip (B) shown in figure 3.
6. Use the tractor lift lever or switch to lower the mower to the operating position.
7. See figure 4. Pull down on lever (A) to release the spring tension on the power take off idler pulley bracket.

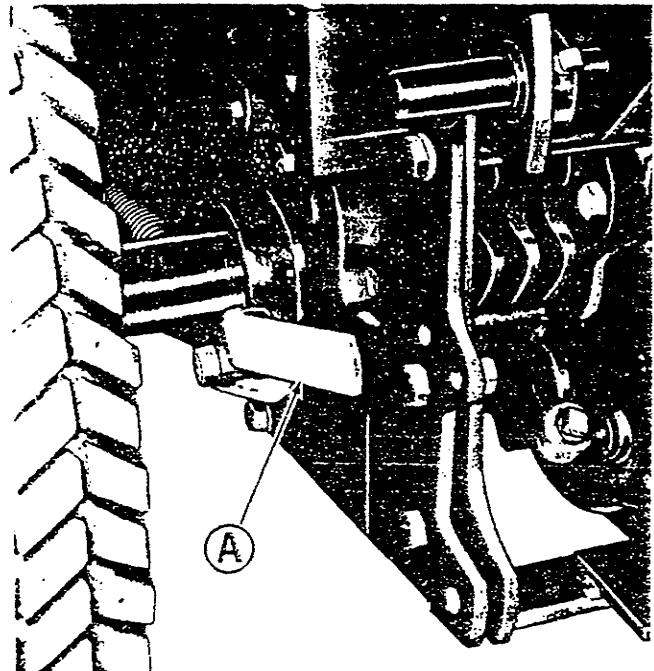

Figure 4. Belt tension lever located at rear of tractor.

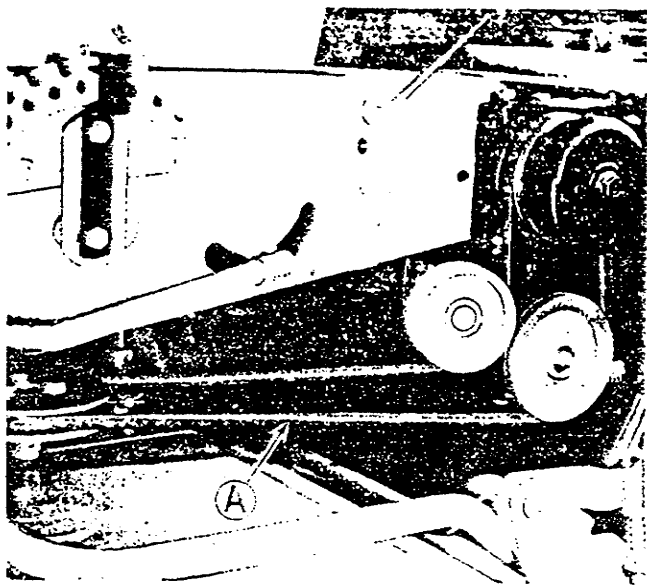

Figure 5. Mower drive belt installed.

8. See figures 5 and 6. Install the mower drive belt (A) over the inside groove of the power take off pulley around the idler pulleys, and the mower drive pulley. As you install the mower drive belt, be sure it is twisted as shown.

9. See figure 4. Pull back on the spring tension lever (A) and lock it in the position as shown in figure 4 to put tension on the mower drive belt.

REMOVING THE MOWER

CAUTION: BEFORE ATTEMPTING TO ADJUST, SERVICE OR REMOVE THE MOWER, BE SURE THE ENGINE IS SHUT OFF, THE PARKING BRAKE SET, AND THE MOWER BLADES HAVE STOPPED TURNING.

1. See figure 4. Push downward on spring tension lever (A) to release the spring tension on the mower drive belt.
2. See figure 5. Remove the mower drive belt (A) from the mower drive pulley, idler pulleys, and power take off pulleys.
3. See figure 4. Position the spring tension lever (A) as shown in figure 4.
4. Use the tractor lift lever or lift switch to lift the mower to the raised position.
5. See figure 3. Remove the spring clips (B) and two pins (A) to unfasten the mower hitch from the tractor front axle.
6. Use the tractor lift lever or lift switch to lower the mower.
7. See figure 2. Remove the spring clip (C) and pin (B) to unfasten lift cable (A) from the mower. Install pin (B) in the mower eyebolt for storage and place spring clip (C) through it.
8. See figure 1. Turn the tractor front wheels left if the mower is to be slid out the right side of the tractor or right if the mower is to be slid out from the left side of the tractor. Slide the mower out.

OPERATION

BEFORE OPERATING THE MOWER

1. Read this manual and the owner's manual for the tractor carefully. Be sure you are familiar with the safety precautions, controls, and operating instructions.

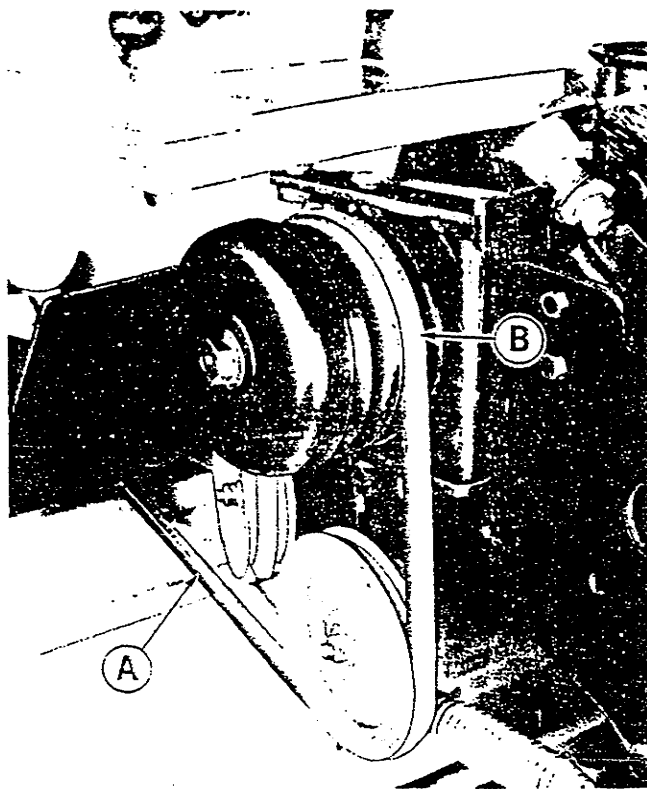

Figure 6. Mower drive belt installed on inner groove of power take off pulley.

2. Check the mower carefully to make sure it is properly installed.
3. Be sure the tractor tires are properly inflated as explained in the tractor owner's manual.
4. Be sure the mower is properly adjusted front to rear, as explained on page 4 of the Adjustment section.
5. Check the condition of the mower blades. Keep them tight, sharp, and in balance.
6. Lubricate the grease fittings as instructed on page 6 of this manual.
7. Clear the lawn of sticks, stones, wire and all other debris which might be caught or thrown by the mower blades.
8. Determine the best method of mowing according to the dimensions, terrain, and obstructions of the lawn.
9. Adjust the cutting height of the mower as explained on page 4 of the Adjustment section.

ENGINE SPEED SETTING

The tractor engine should be operated at 3/4 to full speed when using the mower. When the grass is wet or higher than 3" the engine should be run at full speed. Three-fourths to full speed may be used when mowing lighter grass.

POSITIONING THE MOWER

The mower is lowered into position by using the tractor lift system. This may be either the manual lift lever or the optional electric lift switch. Lower the mower until the lift cable (Figure 2, Item A) is loose.

Mower cutting height is regulated by turning the height control handle located on either side of the mower. See Cutting Height Adjustment in the Adjustment section of this manual.

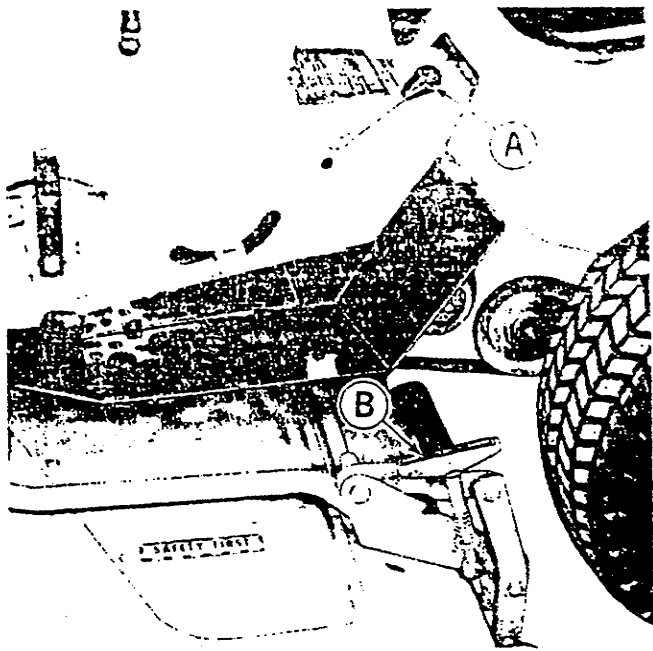

Figure 7. Left side of mower and tractor.

ENGAGING THE POWER TAKE OFF

See figure 7. After the tractor engine has been started and is running at about 3/4 full speed, the mower may be engaged by pushing forward on the tractor power take off control lever (Figure 7, Item A)

CONTROLLING GROUND SPEED

The best ground speed will vary greatly with the type of terrain and the amount and condition of grass being cut. Ground speed should be controlled by the tractor transmission. For normal conditions where the terrain is smooth and the grass dry and not extremely tall a ground speed of 3 - 4 MPH may be best. However, if the terrain is rough and the grass tall or wet, a slower ground speed of about 2 - 3 MPH is sufficient. The Operation Chart in your tractor owner's manual shows the approximate control settings to achieve these speeds.

MOWING PATTERN

Size and type of area to be mowed determines the best mowing pattern to use. Obstructions such as trees, fences, and buildings must also be considered. In most cases, making one or two passes in a counter-clockwise direction around the area to be mowed is advisable to keep cut grass off fences, walks, etc. The remainder of the mowing should normally be done in a clockwise direction so the clippings are dispersed on the cut area.

On moderate size, frequently mowed lawns where the grass is light, it is practical to mow in a counter-clockwise direction so the grass clippings are thrown toward the center of the lawn and concentrated for easy pick up and removal.

MOWING HINTS

Most lawns should be mowed to keep the grass approximately 2" - 3" high. Best results are obtained by cutting often and not too short. To keep a green lawn, never mow more than 1/3 off the height of the grass or a maximum of 1" in one mowing. For extremely tall grass, set the cutting height at maximum for the first mowing, then reset to the

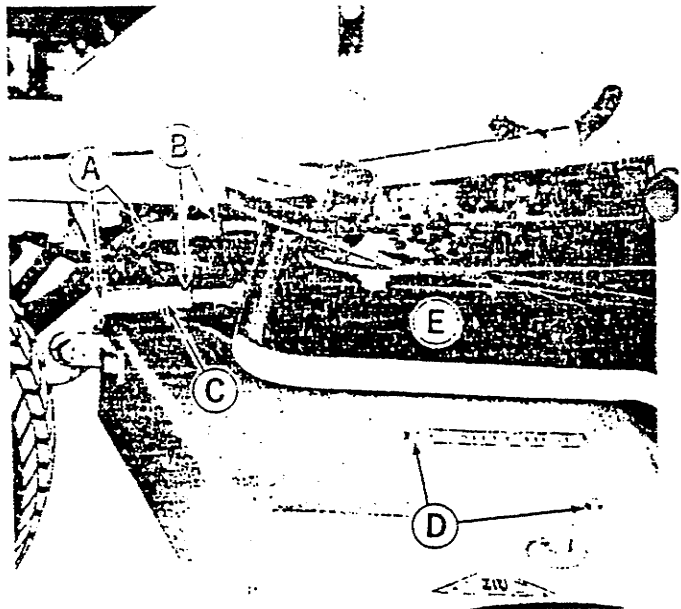

Figure 8. Left side of mower.

desired height and mow again. Allow the grass to grow to three inches then cut off only the top inch.

On thick, springy grass or, soft ground, the mower rollers may sink into the ground giving too low a cut. Adjust the cutting height to get the desired height of cut. For best appearance grass should be cut in the afternoon or evening when it is free of moisture.

ADJUSTMENTS

CUTTING HEIGHT

See figure 7. The cutting height of the mower is adjustable 1-5/8" to 3-1/8". To adjust the height of cut, turn the adjusting handle (B) on each side of the mower clockwise to raise the blades, and counter-clockwise to lower them. The two handles should be rotated the same direction and number of turns so they carry equal weight of the mower and keep the mower level. When the two handles require equal effort to turn, it is a good indication the mower is level. However, it is advisable to occasionally drive the tractor on a smooth level surface and check the height of the two outside blades to insure they are cutting at equal height.

FRONT TO REAR HEIGHT ADJUSTMENT

See figure 9. To give the best mowing job, the mower should be adjusted so the front of the center blade (B) is 1/8" to 1/4" higher than the rear of the two outside blades (A) when the mower is setting on a smooth hard surface. If adjustment is required, proceed as follows:

1. Check the air pressure in the tractor tires to insure that they are inflated according to the tractor owner's manual.
2. With the mower properly installed, drive the tractor on a smooth flat surface, such as a level concrete floor.
3. Use the tractor manual lift lever or electric lift switch to lower the mower completely to the operating position.
4. Shut off the tractor engine. Do not attempt to make any adjustments on the mower while the engine is running.
5. See figure 9. Rotate the left mower blade so it is parallel

TROUBLE SHOOTING GUIDE

PROBLEM OR SYMPTON	POSSIBLE CAUSES	CHECKS AND CORRECTIONS
Mower cuts uneven.	Mower not leveled. Tractor tires not correctly inflated. Mower front to rear height adjustment incorrect.	Level mower. See page 4. Inflate according to tractor owners manual. Adjust as instructed on page 4.
Rough looking cut.	Engine speed too slow. Blades not sharp. Power take off belt slipping.	Run engine at full speed. Sharpen or replace blades. Check belt tension lever. See figure 4.
Mower will not raise.	Lift cable not attached or broken.	Attach or replace lift cable.
Engine stalls easily.	Ground speed too fast. Engine RPM too slow. Engine lacks power.	Reduce ground speed. Run engine at full throttle. See tractor trouble shooting guide in tractor manual.
Mower vibration is noticeable.	Blade mounting bolts loose. Mower blades bent. Blades damaged or out of balance.	Tighten bolts to 45 ft. pounds. Replace blade. Replace or balance blades.
Excessive belt breakage occurs.	Pulleys rough or loose. Using incorrect belt.	Repair or replace pulleys. Use only genuine Simplicity replacement parts.
Tractor handles poorly.	Tires not properly inflated. Moving too fast on rough or sloping surface.	Inflate tires according to tractor owners manual. Reduce travel speed.

with the tractor, and the tips point straight toward the front and rear.

6. Turn the mower height adjusting handles, Figure 7, Item B, so the rear tip of the left blade, Figure 9, Item A, is two inches from the ground surface.

7. Repeat steps five and six on the right side of the mower so the rear of the right blade is two inches from the ground surface.

8. If any height adjustment is needed to correct the height of the right blade, recheck the left blade height.

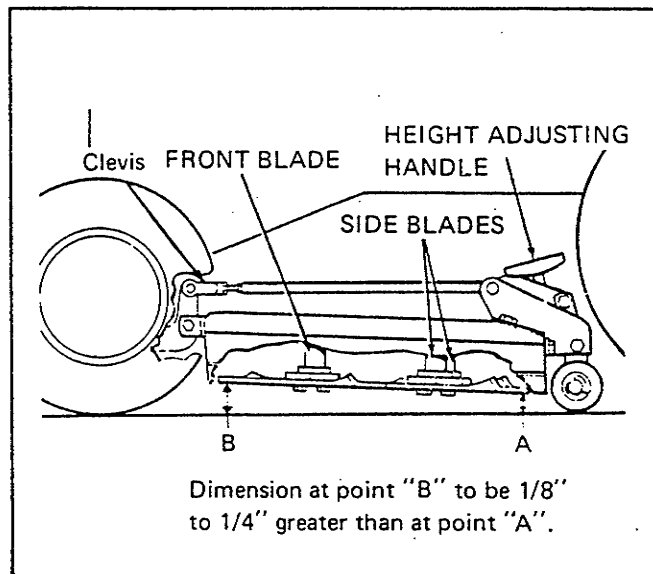

Figure 9. Mower viewed from left side.

9. Turn the center blade so that the tips are pointing straight toward the front and rear. Measure the distance from its front tip to the ground surface (Figure 9, Item B). The distance should be 2-1/8" to 2-1/4", that is 1/8" to 1/4" more than the distance from the rear tip of the outer blades to the ground surface.

10. See figure 8. If adjustment is needed, remove the two spring clips and pins (A). Loosen the locking nuts (B) and turn the eyebolts (C) counter-clockwise to raise the front of the mower, or clockwise to lower the front of the mower as needed. Always turn each of the eyebolts the same number of turns in the same direction.

11. See figure 8. After making the adjustment, tighten the locking nuts (B) and reinstall the pins (A) and spring clips.

12. Recheck both the side and center blade heights. If the adjustment is not correct, repeat steps 10 and 11.

MAINTENANCE

ORDERING REPLACEMENT PARTS

Replacement parts required for performing maintenance services or repair work should be purchased from your Simplicity dealer. When ordering parts be prepared to give him the mower identification number. If you have not already recorded this number on the inside front cover of this manual we suggest you do so now for convenient future reference. **USE ONLY GENUINE SIMPLICITY REPLACEMENT PARTS.**

AFTER EACH USE

Inspect the mower, checking for loose bolts, missing spring clips and pins, etc. Also check the mower blades for sharp-

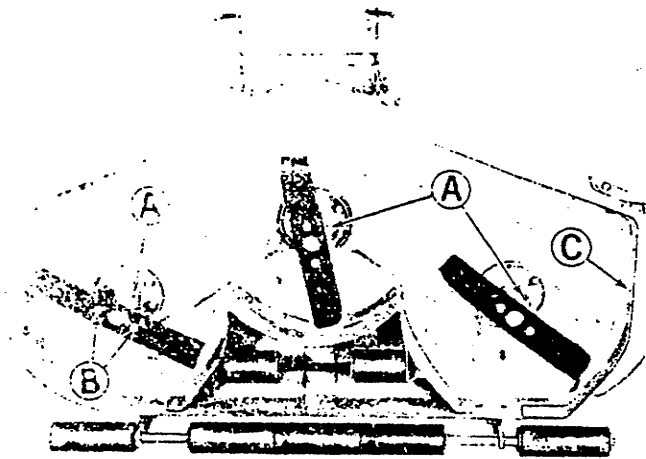

Figure 10. Underside of mower.

ness and to insure they have not been bent or chipped from hitting a hard object. Check the blade mounting bolts to be sure they are tight. The underside of the mower should be checked and any build up of grass clippings or dirt which may reduce the cutting capacity of the mower should be removed.

EVERY 50 HOURS

See figure 10. Each of the three grease fittings (A) should be given about five shots of general purpose automotive grease. Before greasing the grease fittings, wipe them clean to prevent dirt from being forced into the bearings. **DO NOT OVER LUBRICATE THE MOWER. EXCESS GREASE AND OIL MAY GET ON THE BELTS AND CAUSE SLIPPAGE.**

A light coating of grease or SAE 30 weight oil should also be placed on the mower mounting pins, (Figure 3, item A) and all mower pivot points to reduce wear.

OUT OF SERVICE PROTECTION (STORAGE)

1. Remove the mower from the tractor. See page 3.
2. Use water under pressure to thoroughly clean the mower to remove any build up of grass clippings and dirt under the mower deck.
3. Cover any area where the paint has been worn or chipped away with paint or a light coat of oil.
4. Lubricate the mower according to the Every 50 Hour Maintenance service.
5. Store the mower in a dry place.

BLADE REPLACEMENT

Do not attempt to remove the blades until you have the correct size box, socket, or open end wrenches for the blade mounting bolts. Place a wooden block between the mower blade and deck to prevent the blade from rotating until the capscrews are loosened. See figure 10. Remove the capscrews (B) to remove the blades for sharpening or replacement. **CAUTION: NEVER OPERATE THE MOWER WITHOUT THE STONE GUARD (C) IN PLACE. ALWAYS INSURE IT IS SECURELY IN PLACE WHEN SERVICING THE MOWER. DO NOT REMOVE THE ARBORS. REMOVE THE BLADES FROM THE ARBORS TO SHARPEN A**

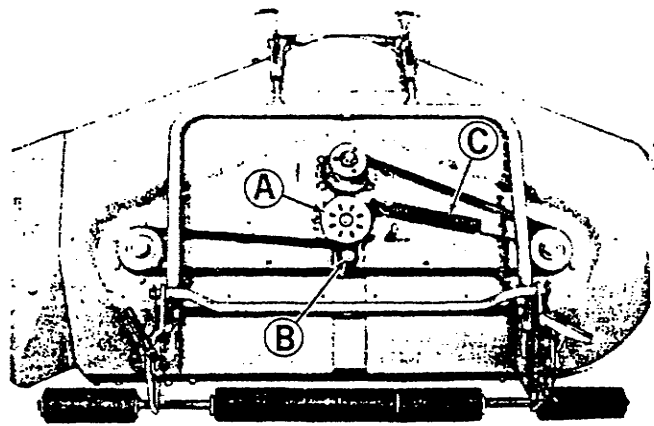

Figure 11. Mower spindle drive belt shown with belt covers removed.

BLADE. TO DO THIS YOURSELF, CLAMP IT IN A VICE AND USE A 10" FILE ALONG THE ORIGINAL BEVEL. FILE TO A RAZOR EDGE AT AN ANGLE OF 30°. To balance the blade insert a knife blade or small rod through the center hole to see if the blade rests with both ends balancing evenly. File the heavy side until even.

Carefully clean the blade and arbor. Install the new or sharpened blade with the lift tabs toward the top. Install the two blade mounting capscrews and tighten them alternately two turns at a time to 45 foot pounds torque. Use a block or wedge to keep the blade from turning while tightening the bolts. Rotate the blades by hand slowly to see that the ends clear the housing all around and the tips are running true. If the mower is properly adjusted and in apparent good condition, but seems to require access engine power it may be that an arbor shaft or bearing has been damaged by hitting an obstruction. Check the blade drive system. Tight bearings, a bent arbor shaft or spindle housing should be repaired or replaced by your Simplicity dealer.

BELT REPLACEMENT

The power take off to mower drive belt can be easily replaced if necessary by following the Installation instructions on page 2 of this manual.

The blade drive belt located under the mower deck, is under spring tension, and does not require any adjustment. Should this belt need replacement, remove the mower from the tractor and proceed as follows:

1. See figure 8. Remove the capscrews (D) and the two belt covers (E) from the mower deck.
2. See figure 11. Remove the broken or damaged belt.
3. Insure the idler pulley (A) is free to pivot so the spring tension will be applied to the belt. Lubricate the idler pulley pivot at (B) with a few drops of SAE 30 engine oil.
4. Check pulleys for rough edges or worn bearings.
5. Install a new Simplicity belt as shown in figure 11, and fasten the belt tension spring (C).
6. See figure 8. Replace the belt covers (E) and capscrews (D)

SPECIFICATIONS

	48" (MFG. NO. 740)	42" (MFG. NO. 784)
Effective Cutting Width	48" (for Sovereign only)	42" (Sovereign or Landlord)
Mowing Capacity	Up to 2-1/4 acres an hour	Up to 2 acres an hour
Dimensions	36" long x 54" wide x 6" deep	35-1/2" long x 47-1/2" wide x 6" deep
Mower overall width (including deflector)	54"	47-1/2"
Deck height above blade	6"	6"
Cutting Height	Continuously variable between 1-5/8" and 3-1/8"	
Blade Arrangement	Three staggered overlapping blades.	
Mower Input Drive	Tractor center PTO clutch controls power to cushioning V-belt to mower center spindle.	
Deck Spindle Drive	Cushioning V-belt with spring-loaded idler. Couples all spindles.	
Spindle Bearings	Sealed rolling contact.	

BAIL ASSEMBLY

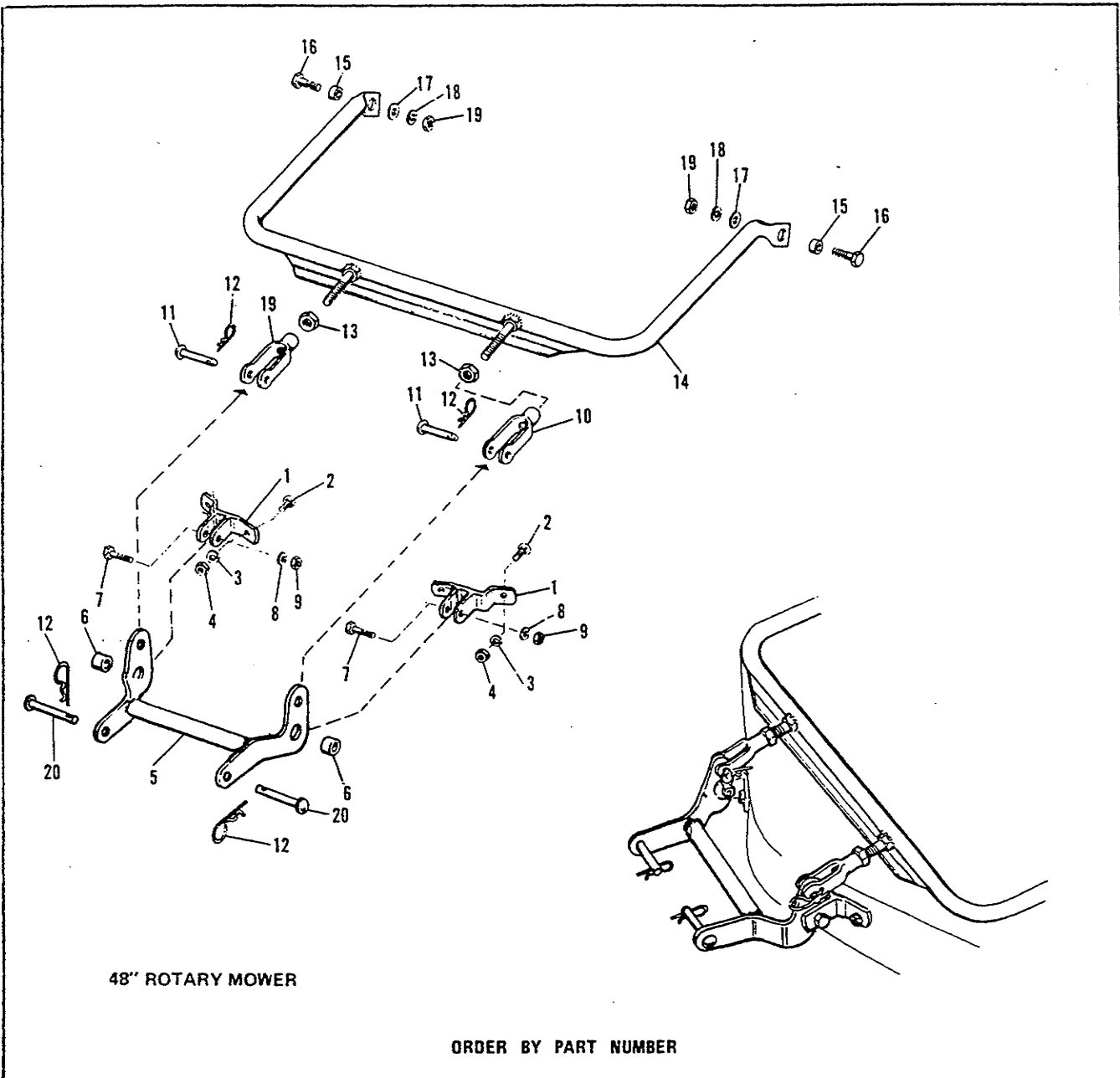

Ref. No.	Part No.	Description	Quan. Req'd.
1	108219	Front Bracket Assembly	2
2	702002	Carriage Bolt, 3/8" - 16 x 1"	4
3	720002	Lock Washer, 3/8"	4
4	717003	Full Hex. Nut, 3/8" - 16	4
5	172468	Rocker Arm	1
6	105051	Spacer	2
7	705049	Hex. Cap Screw, 1/2" - 13 x 1-1/4"	2
8	720004	Lock Washer, 1/2"	2
9	717006	Full Hex. Nut, 1/2" - 13	2
10	154304	End Adj. Yoke	2
11	154305	Yoke Pin	2

Ref. No.	Part No.	Description	Quan. Req'd.
12	8161045	Spring Clip	4
13	717016	Hex. Jam Nut, 1/2" - 20	2
14	172473	Bail Assembly	1
15	105051	Spacer	2
16	705049	Hex. Cap Screw, 1/2" - 13 x 1-1/4"	2
17	719003	Plain Washer, 7/16"	2
18	720004	Lock Washer, 1/2"	2
19	717006	Full Hex. Nut, 1/2" - 13	2
20	118053	Pin	2

DECK ASSEMBLY

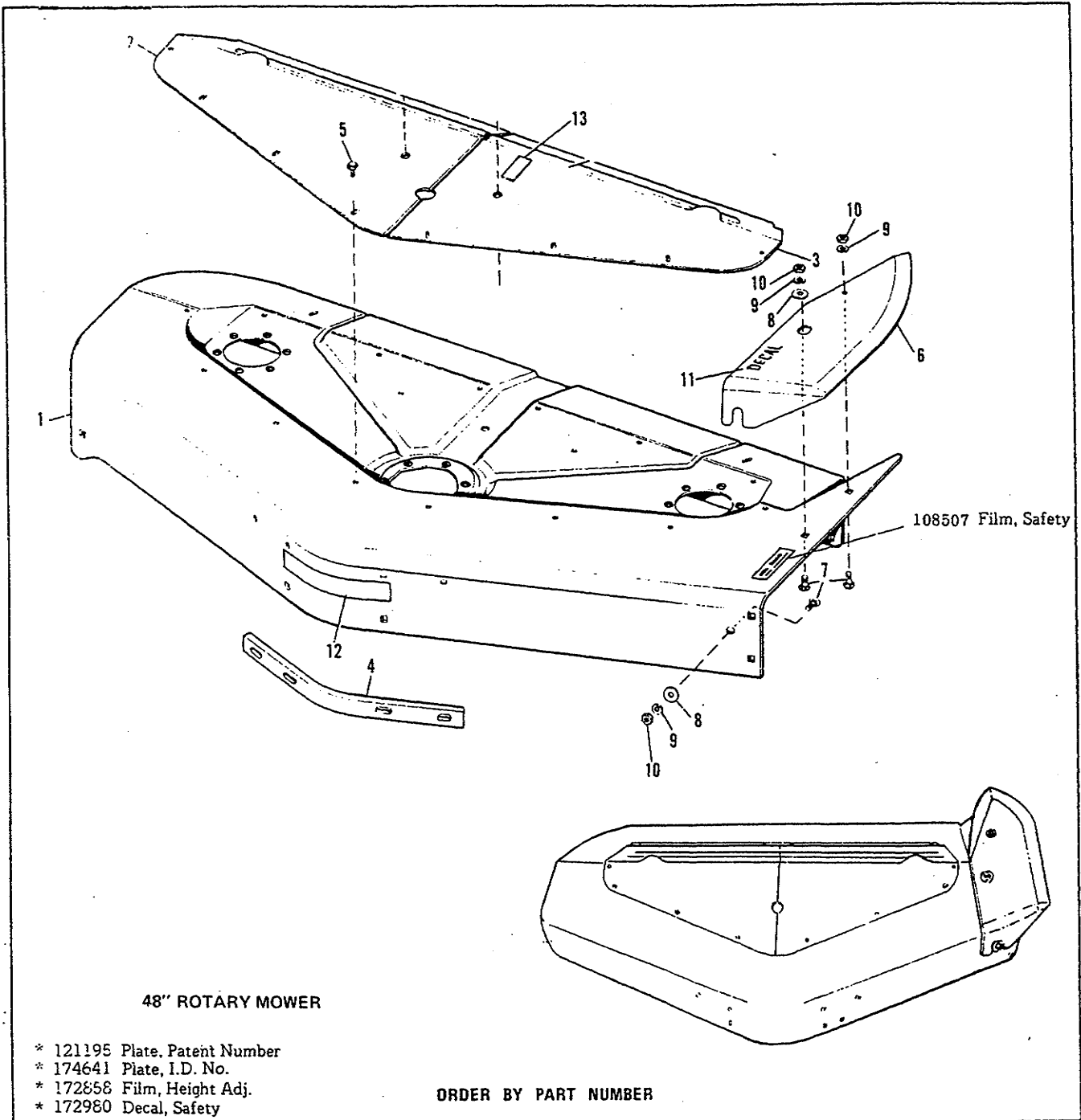

Ref. No.	Part No.	Description	Quan. Req'd.
1	173798	Mower Housing	1
2	172076	R. H. Cover	1
3	172354	L. H. Cover	1
4	108366	Reinforcing Bar	1
5	715067	Self Tapping Screw, 1/4"- 20 x 3/8"	14
6	108506	Deflector	1
7	703004	Carriage Bolt, 3/8"- 16 x 3/4"	2

Ref. No.	Part No.	Description	Quan. Req'd.
8	8161199	Special Washer	2
9	720002	Lock Washer, 3/8"	2
10	717003	Hex. Nut, 3/8" - 16	2
11	103031	Decal, Safety	1
12	106719	Film Simplicity	
13	174845	Film-Belt Installation	1

ROLLER ASSEMBLY

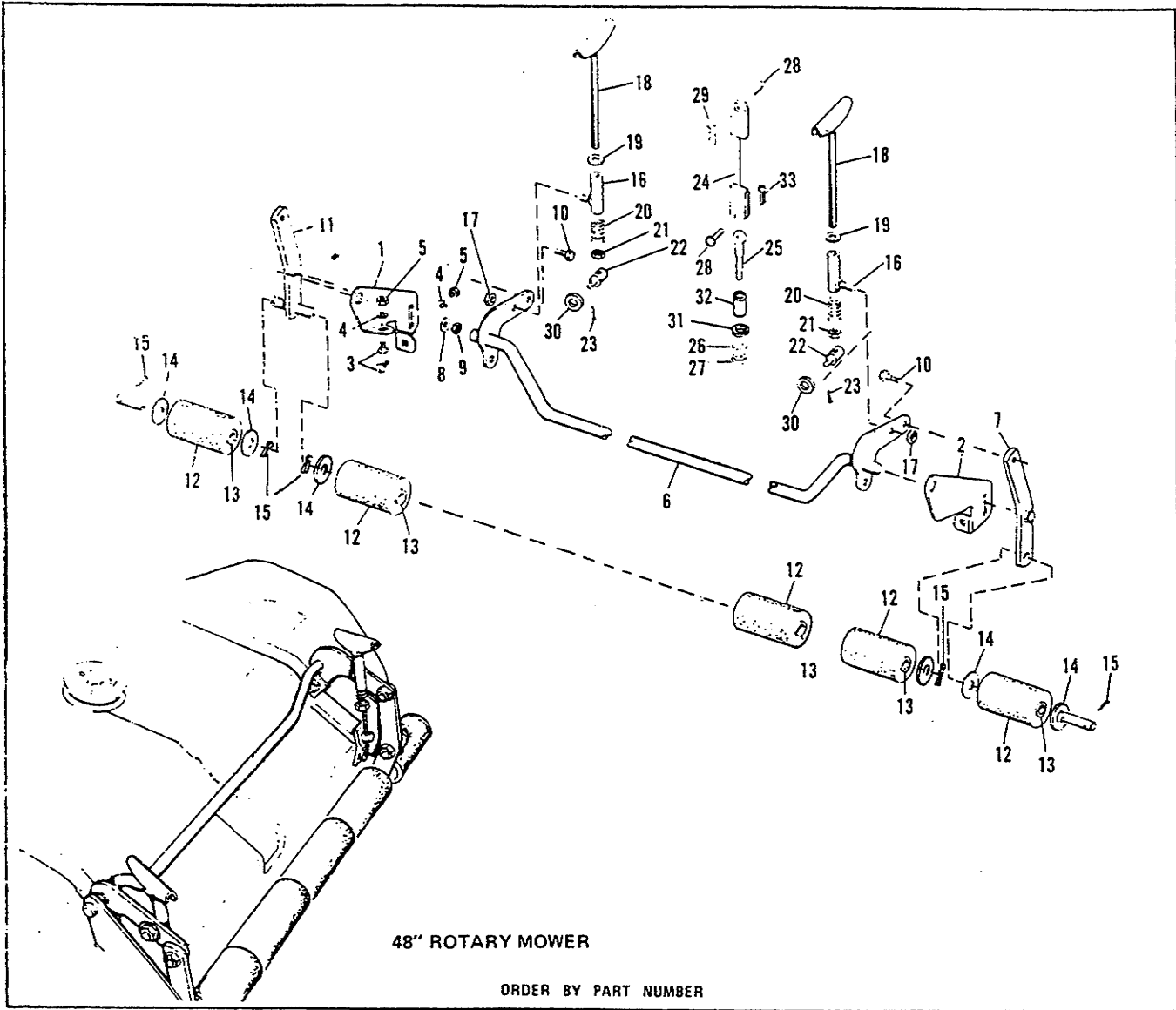

Ref. No.	Part No.	Description	Quan. Req'd.
1	172047	R.H. Roller Bracket	1
2	172046	L.H. Roller Bracket	1
3	702003	Carriage Bolt, 3/8"- 16 x 3/4"	4
4	720002	Lock Washer 3/8"	4
5	717003	Full Hex. Nut, 3/8" - 16	4
6	172015	Rocker Assembly Arm	1
7	108465	Roller Bar Assembly L.H.	1
8	719001	Plain Washer, 3/8"	2
9	717510	Full Hex. Nut, 3/8"- 16	2
10	705005	Hex. Cap Screw, 3/8"- 16 x 1"	2
11	172075	Roller Shaft Assembly	1
12	108432	Roller W/Bushing	5
13	108419	Bushing	5
14	116001	Washer	6
15	722011	Cotter Pin, 3/16"- 1"	5
16	108241	Socket Crank Assembly	2
17	717510	Full Hex. Nut, 3/16"- 16	2

Ref. No.	Part No.	Description	Quan. Req'd.
18	108415	Adjusting Screw Assembly	2
19	719001	Plain Washer 3/8"	4
20	108360	Adjusting Screw Spring	2
21	717013	Hex. Jam Nut, 3/8"- 16	2
22	108512	Pivot	2
23	722016	Cotter Pin, 3/32" x 3/4"	2
24	172860	Cable Assembly, Lift	1
25	171815	Eye Bolt	1
26	720002	Washer, Lock, 3/8" Std.	1
27	717003	Nut, Hex., Full, 3/8"- 16 NC	1
28	153058	Pin	2
29	8161045	Clip, Spring	1
30	719002	Plain Washer, 5/16"	2
31	719001	Plain Flat Washer 3/8"	1
32	172082	Spacer	1
33	722001	Cotter Pin, 3/32" x 3/4"	1

MOWER UNDERSIDE

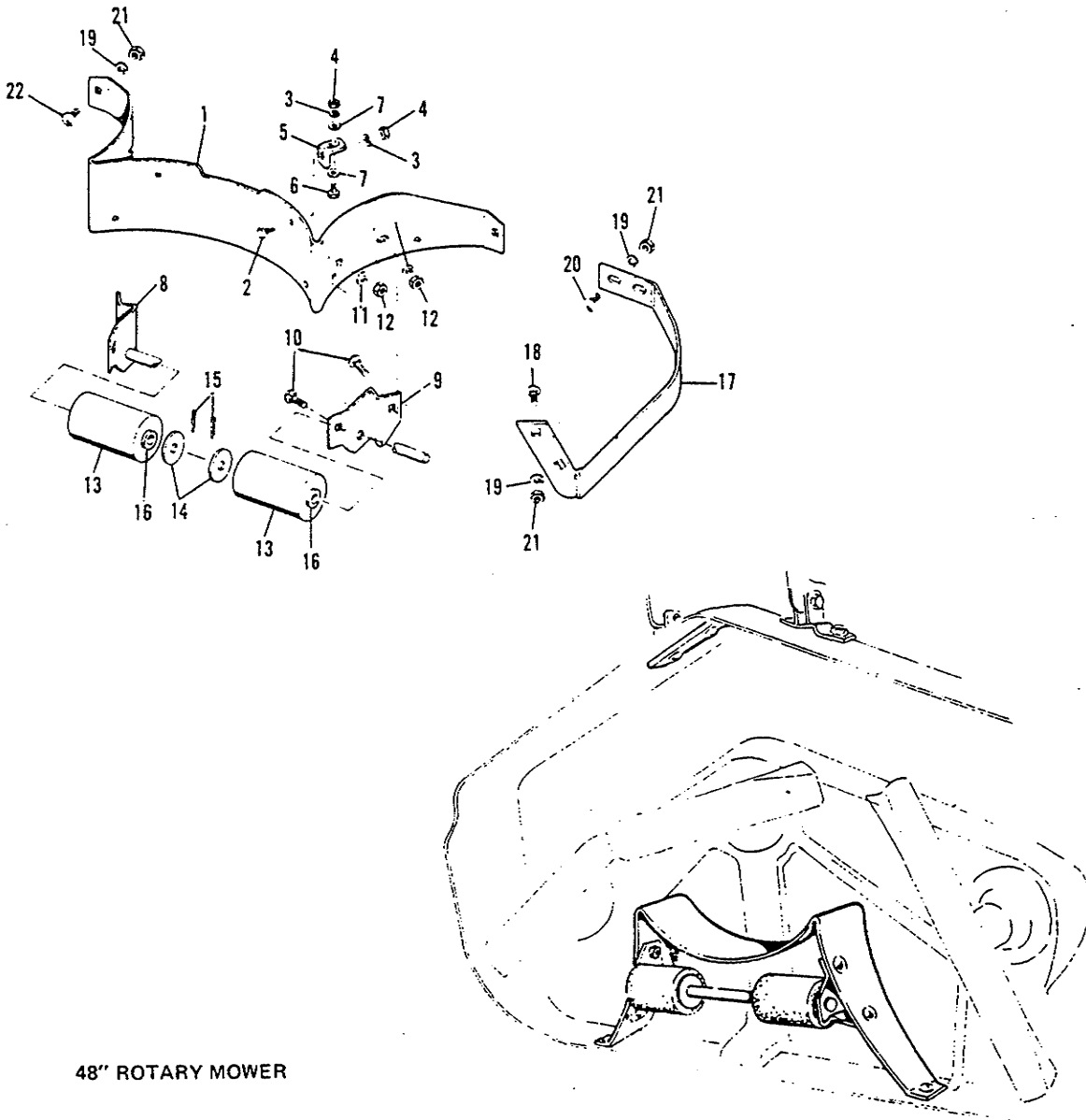

48" ROTARY MOWER

ORDER BY PART NUMBER

Ref. No.	Part No.	Description	Quan. Req'd.	Ref. No.	Part No.	Description	Quan. Req'd.
1	108453	Baffle	1	12	717001	Full Hex. Nut, 5/16" - 18	4
2	714012	Self Tap Hex. Screw, 1/4" - 20 x 7/8"	2	15	108431	Roller Assembly W/Bushing	1
3	720003	Lock Washer, 1/4"	4	14	116001	Washer	2
4	717005	Full Hex. Nut, 1/4" - 20	4	15	722011	Cotter Pin, 3/16" x 1"	2
5	108186	Baffle Clip	2	16	108419	Bushing	4
6	715018	Hex. Cap Screw, 1/4" - 20 x 5/8"	4	17	108452	Housing Assembly Guard	1
7	719006	Plain Washer, 1/4"	4	18	702003	Carriage Bolt, 3/8" - 16 x 3/4"	4
8	108454	Bracket & Shaft Assembly	1	19	720002	Lock Washer 3/8"	6
9	108224	L.H. Roller Bracket	1	20	702002	Carriage Bolt, 3/8" - 16 x 1"	2
10	702015	Carriage Bolt, 5/16" - 18 x 3/4"	4	21	717003	Full Hex. Nut, 3/8" - 16	6
11	720001	Lock Washer, 5/16"	4	22	703004	Carriage Bolt, 3/8" - 16 x 3/4" lg.	2

ARBOR ASSEMBLIES

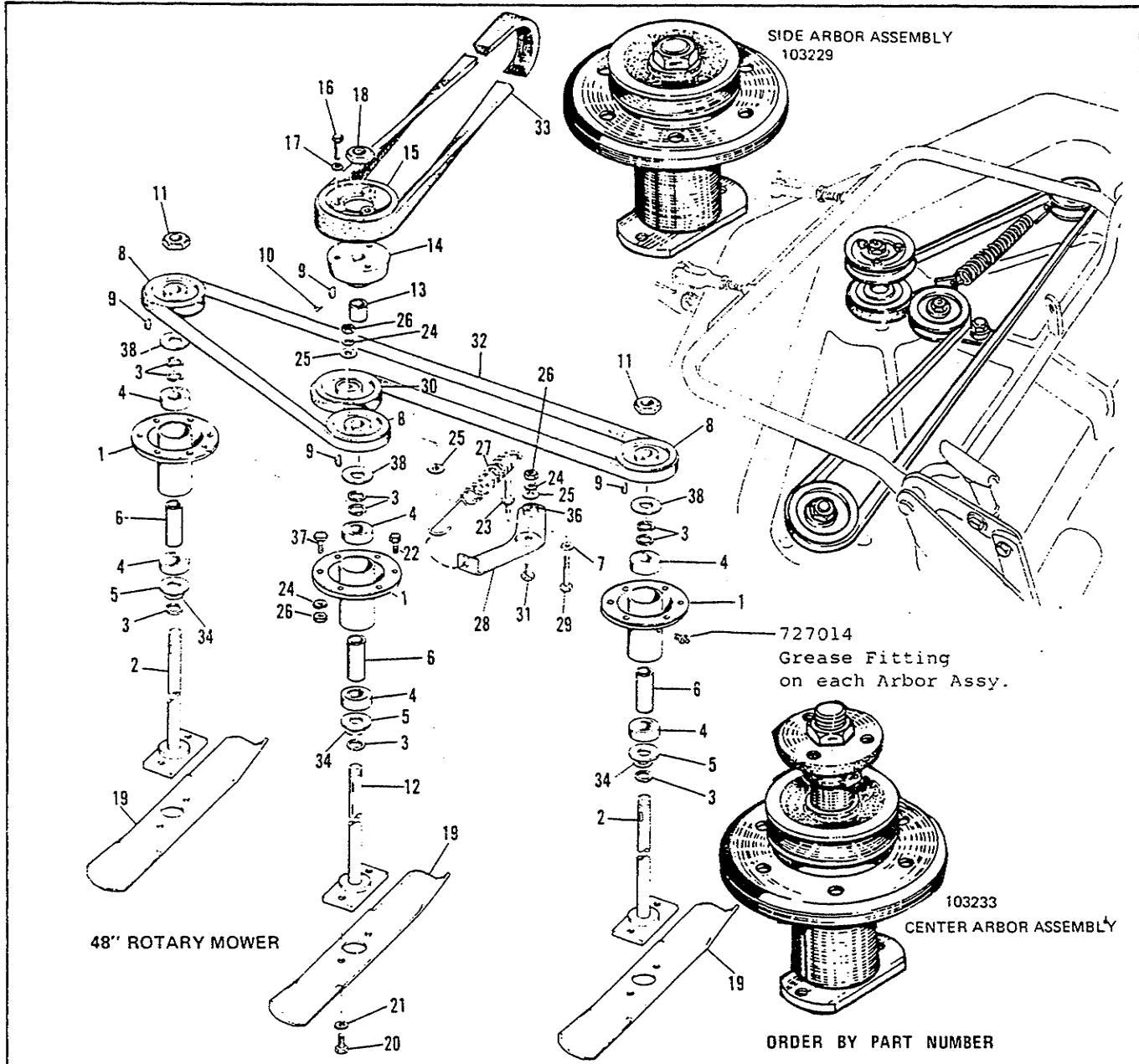

Ref. No.	Part No.	Description	Quan. Req'd.	Ref. No.	Part No.	Description	Quan. Req'd.
1	108679	Tube Assembly, Arbor	2	20	715024	Hex. Cap Screw, 3/8"- 16 x 5/8"	6
2	108250	Arbor Assembly	2	21	720002	Lock Washer, 3/8"	6
3	108181	Washer	13	22	705004	Screw Hex. Cap, 3/8"- 16 NC 3/4" lg.	16
4	108202	Bearing	6	23	156131	Stop Stud	1
5	108257	Washer	3	24	720002	Lock Washer, 3/8"	20
6	108201	Spacer	3	25	719002	Plain Washer, 5/16"	3
7	719001	Washer, Plain, 3/8"	1	26	717003	Full Hex. Nut, 3/8"- 16	20
8	108142	Pulley	3	27	108449	Tension Spring	1
9	725006	Woodruff Key, No. 61 - 3/16" x 5/8" Dia.	4	28	108473	Idler Lever Assembly	1
10	713504	Screw, Set. Cup Pt. 5/16"- 18 x 3/8" Socket Hd.	1	29	705010	Hex. Cap Screw, 3/8"- 16 x 1-3/4"	1
11	717517	Hex. Lock Nut, 3/4"- 16	2	30	108386	Idler Pulley	1
12	108434	Arbor Drive Assembly	1	31	108418	Screw	1
13	108436	Spacer	1	32	108450	"V" Belt, Mower	1
14	172854	Pulley Hub	1	33	163011	"V" Belt	1
15	174190	Pulley	1	34	108472	Washer	1
16	715045	Hex. Cap Screw, 3/8"-24 x 1 - 3/4	3	35	108822	Arbor Assembly with Bearings and Hardware	2
17	720002	Lock Washer, 3/8"	3	36	8171073	Inner Race	1
18	717517	Hex. Lock Nut, 3/4"- 16	1	37	161130	Spec. Hex. Cap Screw	1
19	108448	Knife Blade	3	38	108139	Flinger	3

BAIL ASSEMBLY

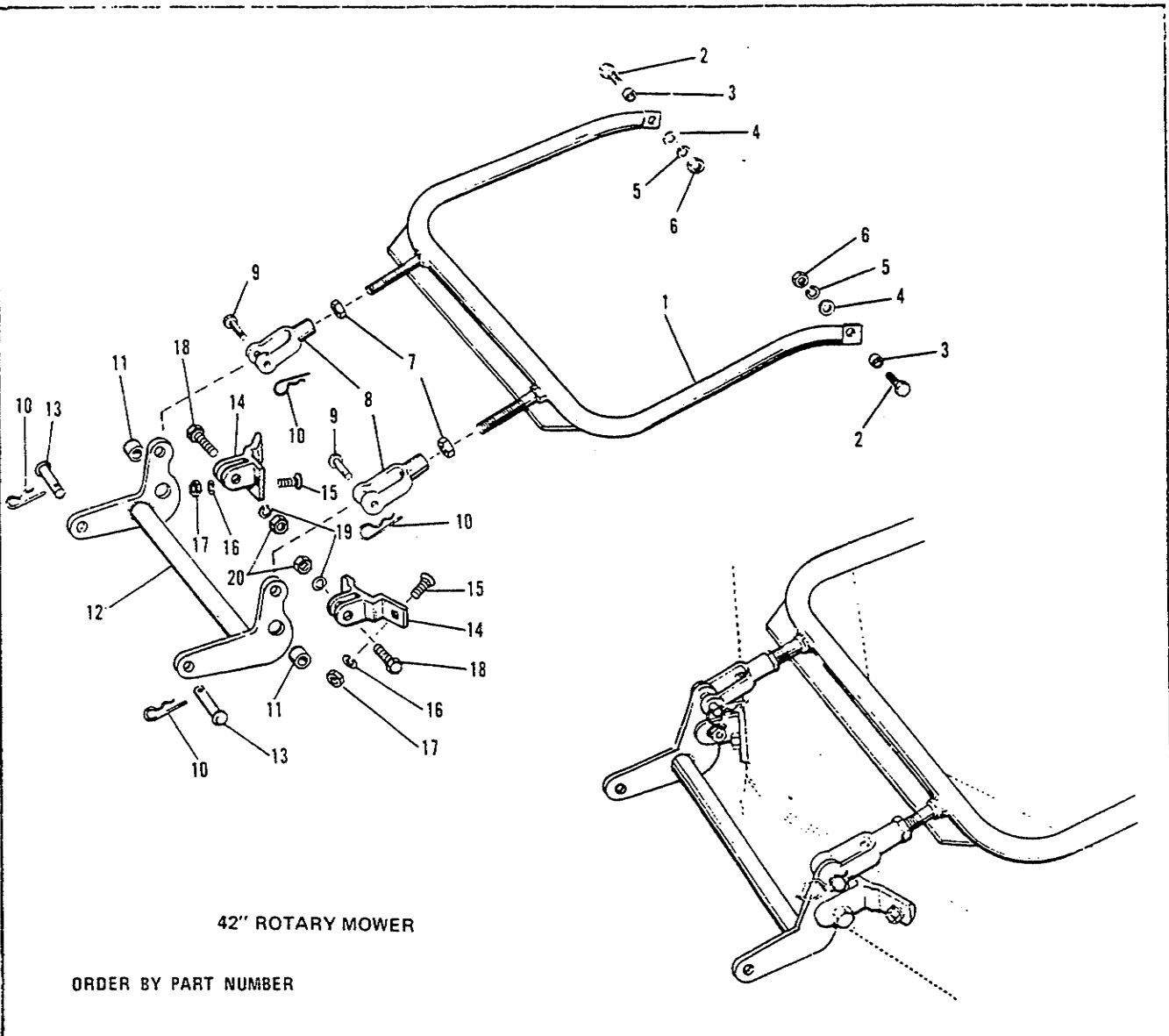

42" ROTARY MOWER

ORDER BY PART NUMBER

Ref. No.	Part No.	Description	Quant. Req'd.
1	171933	Bail Assembly	1
2	705049	Capscrew, Hex. Hd., 1/2" - 13 NC x 1 1/4" lg.	2
3	105051	Spacer	2
4	719003	Washer, Plain, 7/16	2
5	720004	Washer, Lock, 1/2"	2
6	717006	Nut, Hex., Full, 1/2" - 13 NC	2
7	717016	Nut, Hex., Jam, 1/2" - 20 NF	2
8	154304	Yoke End, Adjusting	2
9	154305	Yoke Pin	2
10	8161045	Clip, Spring	4

Ref. No.	Part No.	Description	Quant. Req'd.
11	105051	Spacer	2
12	172468	Rocker Arm	1
13	118053	Pin	2
14	108219	Bracket Assembly, Front	2
15	702002	Bolt, Carriage, 3/8" - 16 NC x 1"	4
16	720002	Washer, Lock, 3/8"	4
17	717003	Nut, Hex. Full, 3/8" - 16 NC	4
18	705049	Capscrew, Hex., 1/2" - 13 NC x 1 1/4"	2
19	720004	Washer, Lock, 1/2" V	2
20	717006	Nut, Hex., Full, 1/2" - 13 NC	2

DECK ASSEMBLY

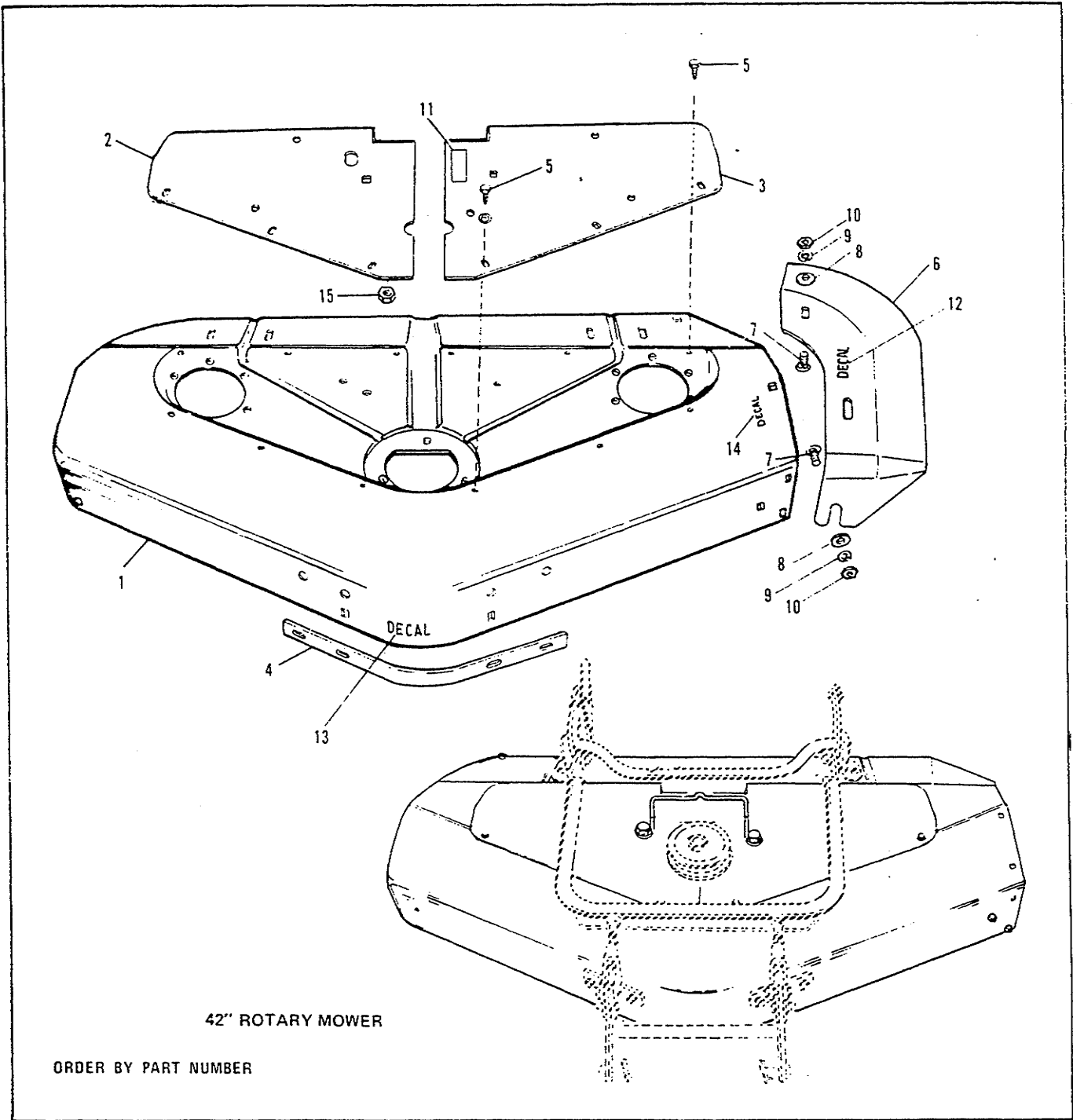

Ref. No.	Part No.	Description	Quant. Req'd.	Ref. No.	Part No.	Description	Quant. Req'd.
1	172043	Mower Housing	1	11	174845	Film-Belt Instructions	1
2	172049	Cover, R.H.	1	12	103031	Decal	1
3	172414	Cover, L.H.	1	13	106719	Decal	1
4	108366	Bar, Reinforcing	1	14	108507	Film, Safety	1
5	715067	Screw, Taptite, 1/4" - 20 x 3/8" lg.	12	15	718041	Nut Retainer	2
6	108525	Deflector	1	*	172858	Film, Height Adj.	
7	703004	Carriage Bolt, 3/8" - 16 x 3/4" lg.	2	*	103100	Plate, Serial Number	
8	8161199	Washer-Special	2	*	121195	Plate, Patent Number	
9	720002	Washer, Lock, 3/8"	2	*	172980	Decal-Safety	
10	717003	Hex. Nut, Full, 3/8" - 16	2				

* Not Illustrated

ROLLER ASSEMBLY

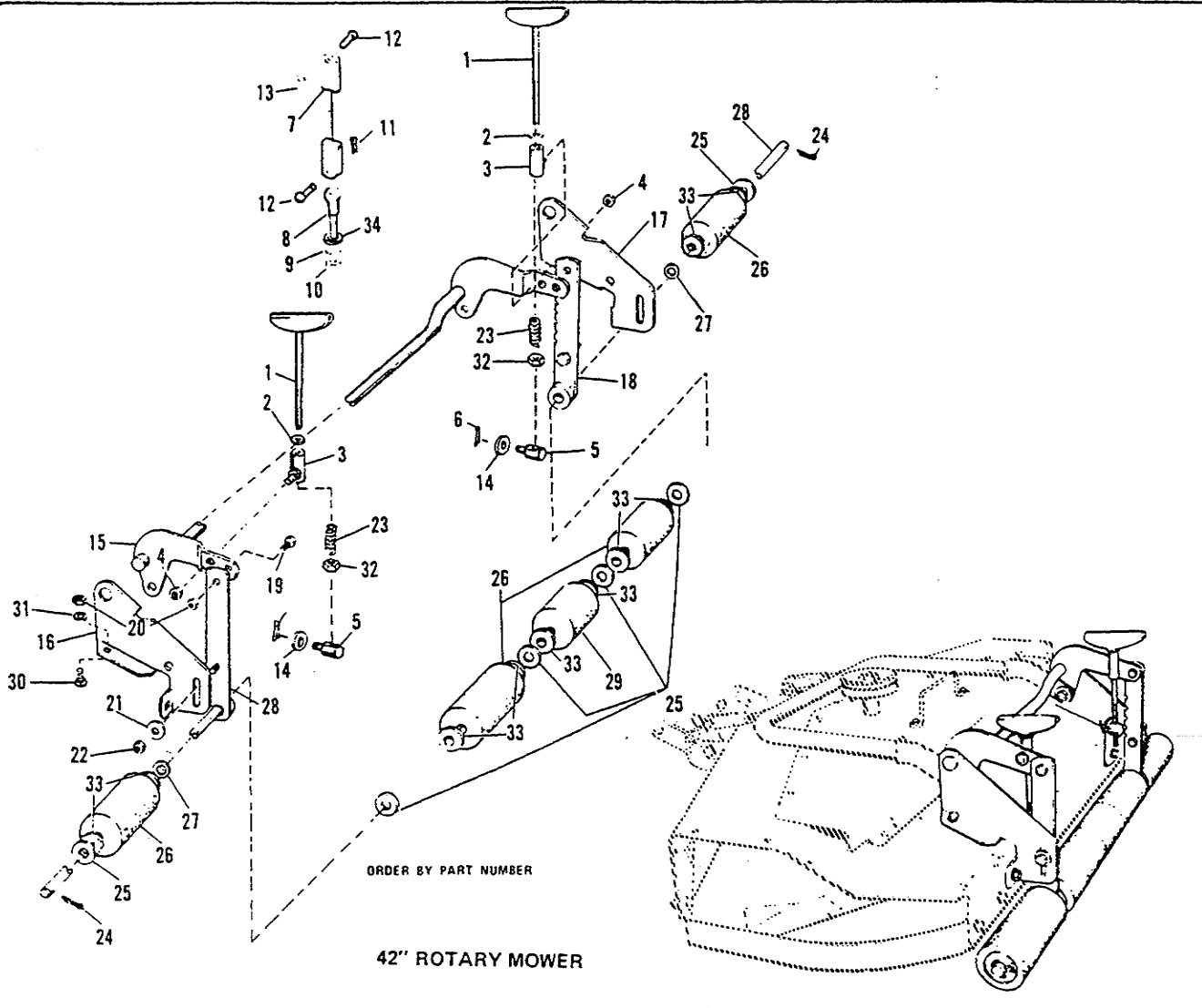

Ref. No.	Part No.	Description	Quant. Req'd.
1	108415	Screw Assembly, Adjusting	2
2	719001	Washer, Plain, 3/8"	4
3	108241	Socket Assembly, Crank	2
4	717510	Nut, Hex., Full, Lock, 3/8" - 16 NC	2
5	108512	Pivot	2
6	722001	Cotter Pin, 3/32" x 3/4" Lg.	2
7	172860	Cable Assembly, Lift	1
8	171815	Eye Bolt	1
9	720002	Lock Washer, 3/8" Std.	1
10	717003	Nut, Hex., Full, 3/8" - 16 NC	1
11	722001	Pin, Cotter 3/32" x 3/4"	1
12	153058	Pin	2
13	8161045	Clip, Spring	1
14	719002	Washer, Plain, 3/8" Std.	2
15	172015	Arm Assembly, Rocker	1
16	172045	Bracket, Roller, R.H.	1
17	172044	Bracket, Roller, L.H.	1
18	172412	Bar Assembly, Roller	1

Ref. No.	Part No.	Description	Quant. Req'd.
19	705005	Capscrew, Hex. Hd., 3/8" - 16 NC x 1" lg.	2
20	717003	Nut, Hex., Full, 3/8" - 16 NC	4
21	719001	Washer, Plain, 3/8"	2
22	717510	Nut, Hex., Full, Lock, 3/8" - 16 NC	2
23	108360	Spring, Adj. Screw	2
24	722011	Pin, Cotter, 3/16" x 1" lg.	4
25	116001	Washer	4
26	108432	Roller W/Bushing	3
27	8261055	Washer	2
28	171958	Shaft & Support Arm.	1
29	108431	Roller W/Bushing	2
30	702003	Bolt, Carriage, 3/8" - 16 NC x 3/4" lg.	4
31	720002	Washer, Lock, 3/8"	4
32	717013	Nut, Hex., Full 3/8" - 16 NC	2
33	108419	Bushings	6
34	719002	Plain Washer	

MOWER UNDERSIDE

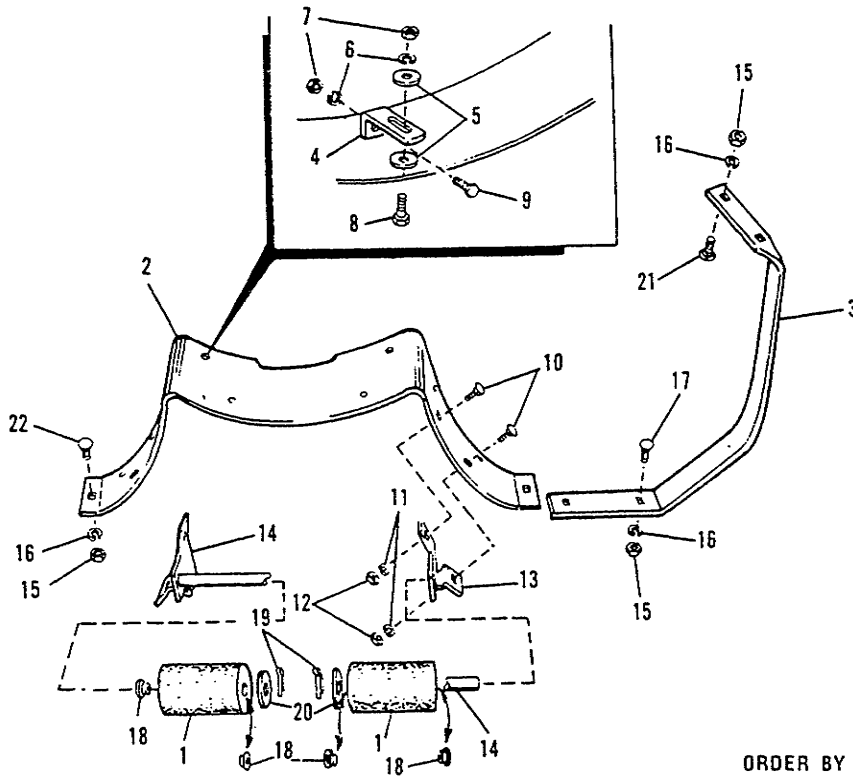
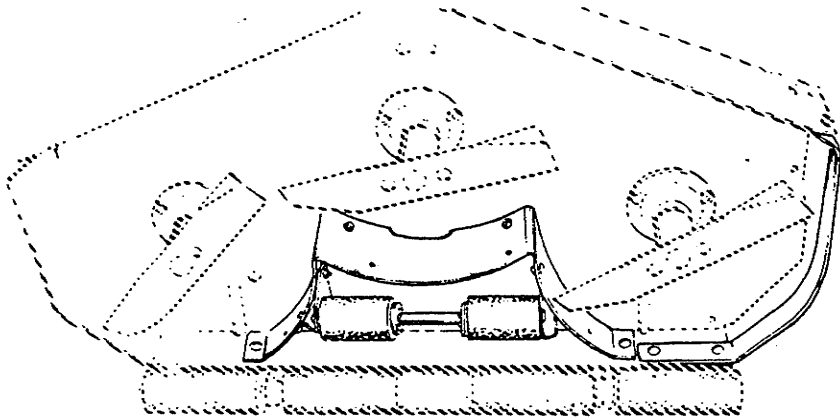

42" ROTARY MOWER

ORDER BY PART NUMBER

Ref. No.	Part No.	Description	Quant. Req'd.	Ref. No.	Part No.	Description	Quant. Req'd.
1	108431	Roller W/Bushing	2	12	717001	Nut, Hex. Full, 5/16" - 18 NC	4
2	108361	Baffle	1	13	108224	Bracket, Roller, Lower, L.H.	1
3	108214	Guard Assembly, Housing	1	14	108426	Bracket & Shaft Assembly	1
4	108186	Clip Baffle	1	15	717003	Nut, Hex., Full, 3/8" - 16 NC	6
5	719006	Washer Plain, 1/4"	2	16	720002	Washer, Lock, 3/8"	6
6	720003	Washer, Lock, 1/4"	2	17	702003	Bolt, Carriage, 3/8" - 16 NC x 3/4" lg.	2
7	717005	Nut, Hex., Full, 1/4" - 20 NC	2	18	108419	Bushings	4
8	715018	Capscrew, Hex., 1/4" - 20 x 5/8" lg.	2	19	722011	Pin, Cotter, 3/16" x 1" lg.	2
9	714012	Screw, Recessed Hex. Self-Tapping 1/4" - 20 NC x 7/8" lg.	2	20	116001	Washer	2
10	702015	Bolt, Carriage, 5/16" - 18 NC x 3/4" lg.	4	21	702002	Bolt, Carriage, 3/8" - 16 NC x 1" lg.	2
11	720001	Washer, Lock, 5/16"	4	22	703004	Bolt, Carriage, 3/8" - 16 x 3/4" lg.	2

ARBOR ASSEMBLIES

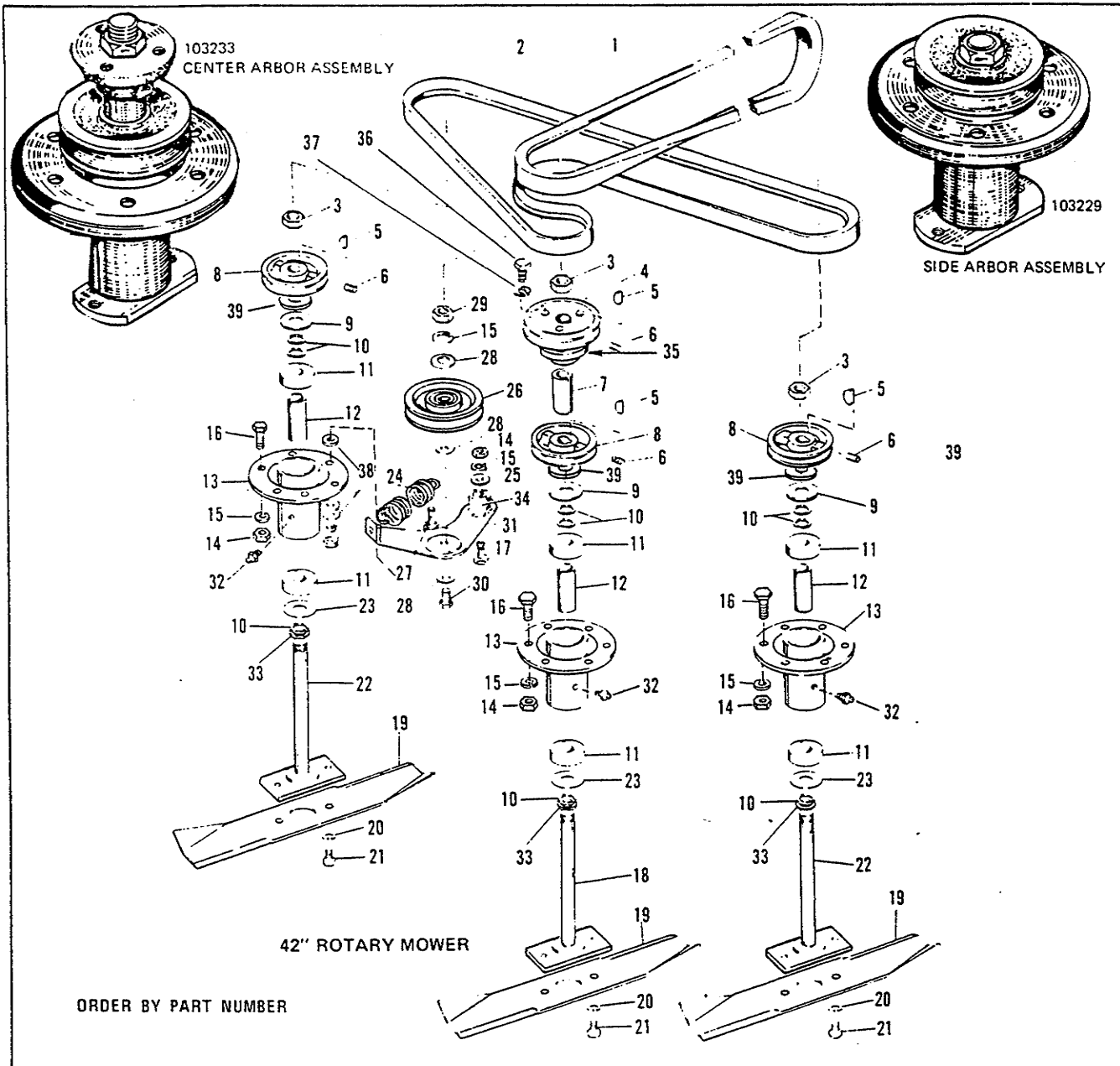

Ref. No.	Part No.	Description	Quant. Req'd.	Ref. No.	Part No.	Description	Quant. Req'd.
1	174687	Belt P.T.O.	1	21	715024	Hex. Hd. Capscrew, 3/8" - 16 x 5/8"	6
2	108209	Belt, "V" (Mower Spindle Drive)	1	22	108250	Arbor Assembly	2
3	717517	Hex., Jam Lock Nut, 3/4" - 16	3	23	108257	Washer	3
4	174189	Pulley	1	24	154369	Spring	1
5	725006	Key, Woodruff, 61	4	25	719002	Plain Washer, 5/16"	1
6	713504	Set Screw, 5/16" - 18 x 3/8"	4	26	108386	Idler Pulley	1
7	108436	Spacer	1	27	156131	Stud	1
8	108142	Pulley	3	28	719002	Plain Washer, 5/16"	3
9	108134	Backing Ring	3	29	717003	Full Lock Hex, Nut, 3/8" - 16	1
10	108181	Washer	9	30	108418	Screw	1
11	108202	Bearing	6	31	108416	Idler Lever Assembly	1
12	108201	Spacer	3	32	727014	Grease Fitting	3
13	108679	Arbor Tube Assembly	3	33	108472	Washer	3
14	717003	Full Hex., Nut, 3/8" - 16	18	34	8171073	Race Inner Bearing	1
15	720002	Lock Washer, 3/8"	18	35	172854	Hub	1
16	705004	Hex. Cap Screw, 3/8" - 16 x 3/4" lg.	17	36	715045	Screw, Cap - 3/8" - 24 x 1 1/4"	3
17	705010	Hex. Cap Screw, 3/8" - 16 x 1 1/4" lg.	1	37	720002	Washer, Lock - 3/8"	3
18	108434	Arbor Crive Assembly	1	38	719002	Washer, 5/16"	3
19	108298	Knife Blade	3	39	108139	Flinger	3
20	720002	Lock Washer, 3/8"	6				

