

FIGURE 1

Attachment

To attach the 48" Rotary Mower to the tractor, follow the sequence of steps as outlined below:

1. Place the mower beside the tractor, and turn the tractor wheels to the full left position. Before sliding the mower under the tractor, remove the hair pin cotters and pins connecting the clevises on front end of bail assembly. Allow the rocker arms to drop down. This will now provide sufficient clearance for the mower to slide under the tractor. With the mower under the tractor, replace the clevises on rocker arms and fasten with hair pin cotters and pins.
2. Connect the rockers arms to front mounting brackets under the tractor, by using pins and hair pin cotters as shown in Figure 2.
3. Place the tractor lift lever in its rear position and attach the mower lift lever to the tractor lift arm on right hand side of tractor as shown in Figure 3. Use hex capscrow, flatwashers, and hex nut furnished for this purpose.
4. Connect the mower lift chain to the lift lever by fastening the lift links in place with a pin and hair pin cotter as shown in Figure 3.
5. Place the cross drive belt in position on the mower drive pulley. Give the belt a 90° twist towards the left hand side of the tractor and mount belt to larger pulley of power take-offs as shown in figure 3. When installed in proper manner, the belt should run from the left side of mower pulley to bottom side of power take-off pulley.

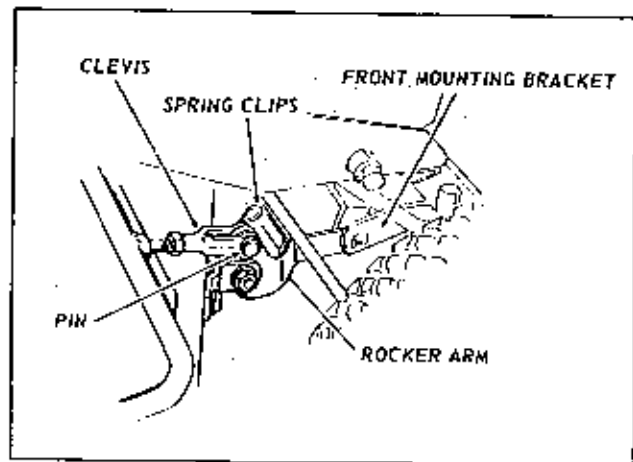

FIGURE 2

Adjustments

To check the final adjustments of the mower height, place the tractor with the mower attached, on a smooth flat surface. Rotate the center blade to the front and measure the distance from its front tip to the ground. Then rotate each of the side blades so that their tips can be measured at the front. For best mowing results, the leading tip of the center blade should be about 1/4" higher than the trailing tip of the two side blades. To obtain this adjustment, remove pins from clevises and rocker arms, loosen the hex nut in back of each clevis and turn each clevis in or out sufficiently to achieve this setting. In making this adjustment, be sure that both clevises are adjusted equally.

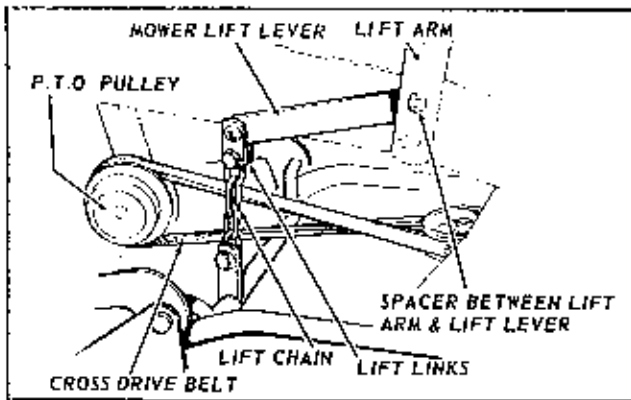

FIGURE 3

Operation

1. Set mower to desired height of cut by turning the adjusting screw handles counter-clockwise to lower the cut, and clockwise to raise the cut. Turn each adjusting handle an equal number of times to insure level operation.
2. Start the tractor engine with the power take-off in the disengaged position, and lower the mower to cutting position by releasing the tractor lift lever.
3. Engage the power take-off to set the mower blades in operation; engage the tractor clutch and proceed with mowing.
4. To transport the mower; disengage the power take-off to stop blades. Raise the mower above the surface by pushing the tractor lift lever to forward locked position.

IMPORTANT

USE ONLY SIMPLICITY REPLACEMENT BELTS & BLADES

Belt Tension

The mower spindle drive belt is spring loaded and requires no further adjustment.

NOTE: The cross drive belt and the blade drive belt are a low stretch, high strength, polyester, "W" design belt and are designed and manufactured to provide long and satisfactory service. Because of the special design of these belts, it is urged that you replace them only with genuine replacement belts ordered from your dealer. Consult the parts list for the correct part numbers for these belts when replacement is necessary.

Lubrication

The mower arbor spindles are supported in prelubricated sealed ball bearing assemblies, which do not require further attention.

CAUTION

MOWER SHALL NOT BE USED WITHOUT EITHER VACUUM COLLECTOR ADAPTER OR THE DEFLECTOR ADAPTER IN PLACE.

Caution

It is the responsibility of the operator to see that the area where the mower will be used is free of all types of foreign material. This includes wire, rope, rags, sticks, bottles, cans, pipe, and rocks, etc. These represent potential dangers to mower, operator, and spectators, as well as having a dulling effect on the mower blades.

Always guard for obstacles when mowing, and, never leave mower running while unattended.

Disengage mower and inspect for damage immediately after striking a foreign object. Insure that damage has been repaired before using mower.

LEAF MULCHER

To install the leaf mulcher, remove the mower from the tractor, and follow the sequence of steps as shown below.



FIGURE 4

1. Remove the guard assembly from the discharge opening of mower housing. Install the Left Hand Baffle Plate as shown in Figure 4. This baffle is held in place by 5 carriage bolts, lockwashers, and hex nuts. Note that the lockwashers and nuts are on the exterior of mower housing.

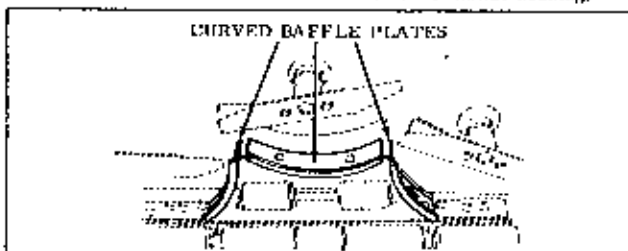

FIGURE 6

3. Install the curved mulcher baffles (Left Hand, Right Hand and center) as shown in Figure 6. These baffles are each held in place by 2 carriage bolts, lockwashers, and hex nuts. Note that lockwashers, and hex nuts are on the inside of the baffle support.

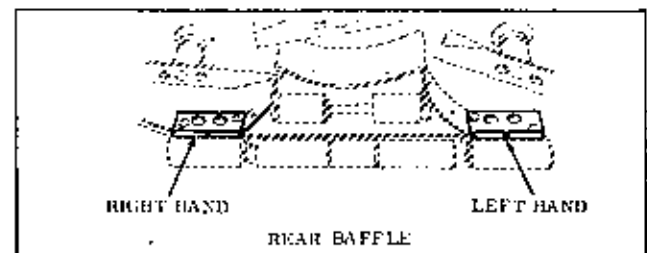

FIGURE 5

2. Install the Left Hand and Right Hand Rear Baffle Plates as shown in Figure 5. These baffles are each held in place by 2 carriage bolts, lockwashers, and hex nuts. Note that the lockwashers and nuts are on the exterior of mower housing.

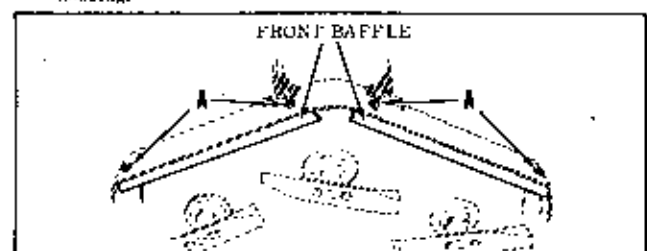
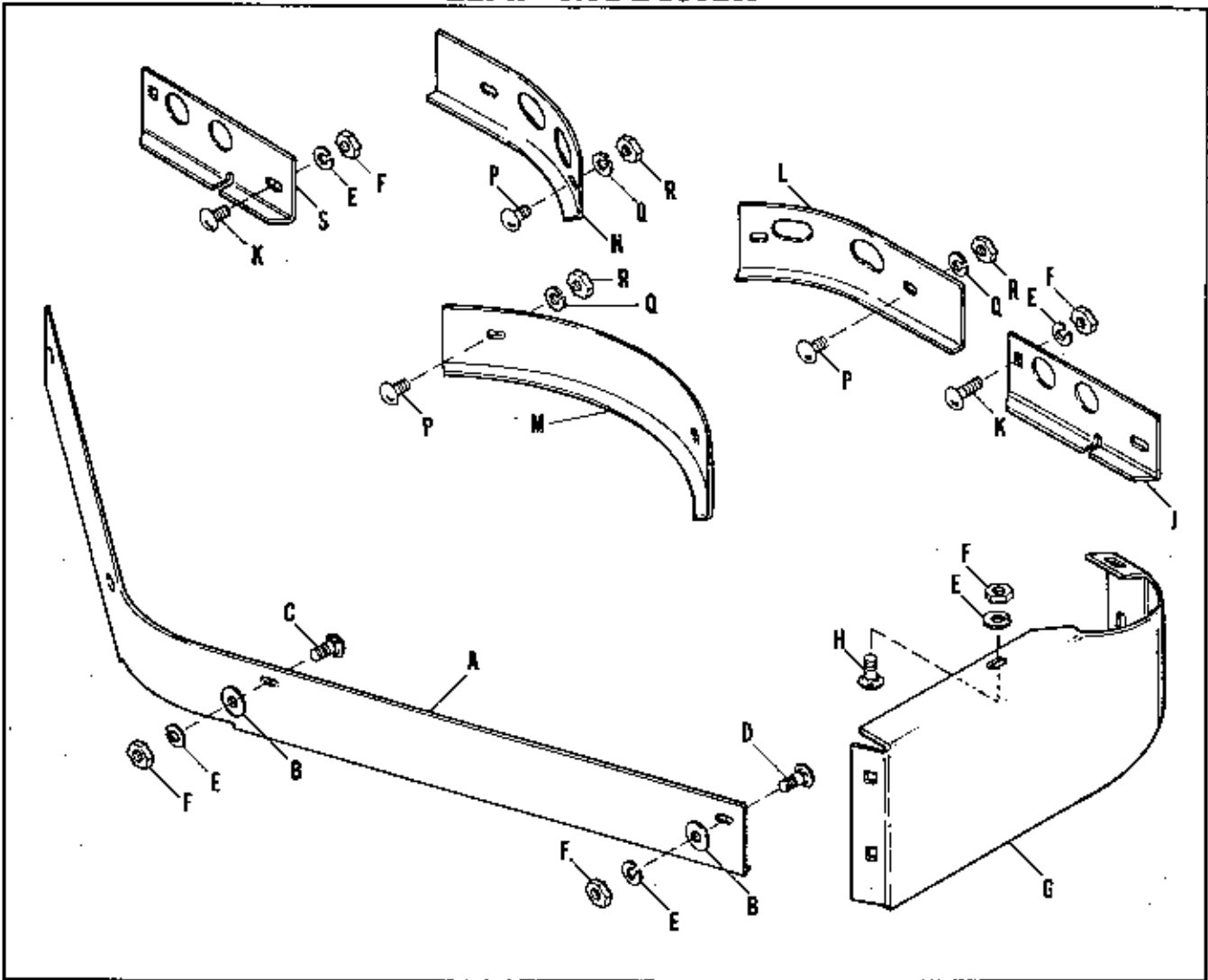

FIGURE 7

4. Install the Front Baffle as shown in Figure 7. This baffle is held in place by 4 carriage bolts, lockwashers, and hex nuts. Four plain, flat washers are furnished for use under the lockwashers at points "A". Note that the hex nuts and lockwashers are on the exterior of the mower housing.

LEAF MULCHER



| Ref. Let. | Part No. | Description |
|-----------|----------|--|
| A | 108532 | Front Mulcher Baffle |
| B | 719001 | Washer, Plain, 3/8" Std. |
| C | 703004 | Carriage Bolt, 3/8"-16 x 3/4" lg. ,w/sq. neck |
| D | 702003 | Carriage Bolt, 3/8"-16 x 3/4" lg. |
| E | 720002 | Washer, Lock, 3/8" |
| F | 717003 | Nut, Hex, Full, 3/8"-16 |
| G | 108533 | Housing End Plate |
| H | 702003 | Carriage Bolt, 3/8"-16 x 3/4" lg. |
| J | 108538 | L. H. Rear Baffle |
| K | 702002 | Carriage Bolt, 3/8"-16 x 1" lg. |
| L | 108536 | L. H. Rear Mulcher Baffle |
| M | 108534 | Center Rear Mulcher Baffle |
| N | 108535 | R. H. Rear Mulcher Baffle |
| P | 703005 | Carriage Bolt, 5/16"-18 x 3/4" lg. ,w/sq. neck |
| Q | 720001 | Washer, Lock, 5/16" |
| R | 717001 | Nut, Hcx, Full, 5/16"-18 |
| S | 108537 | R. H. Rear Baffle |

BAIL ASSEMBLY

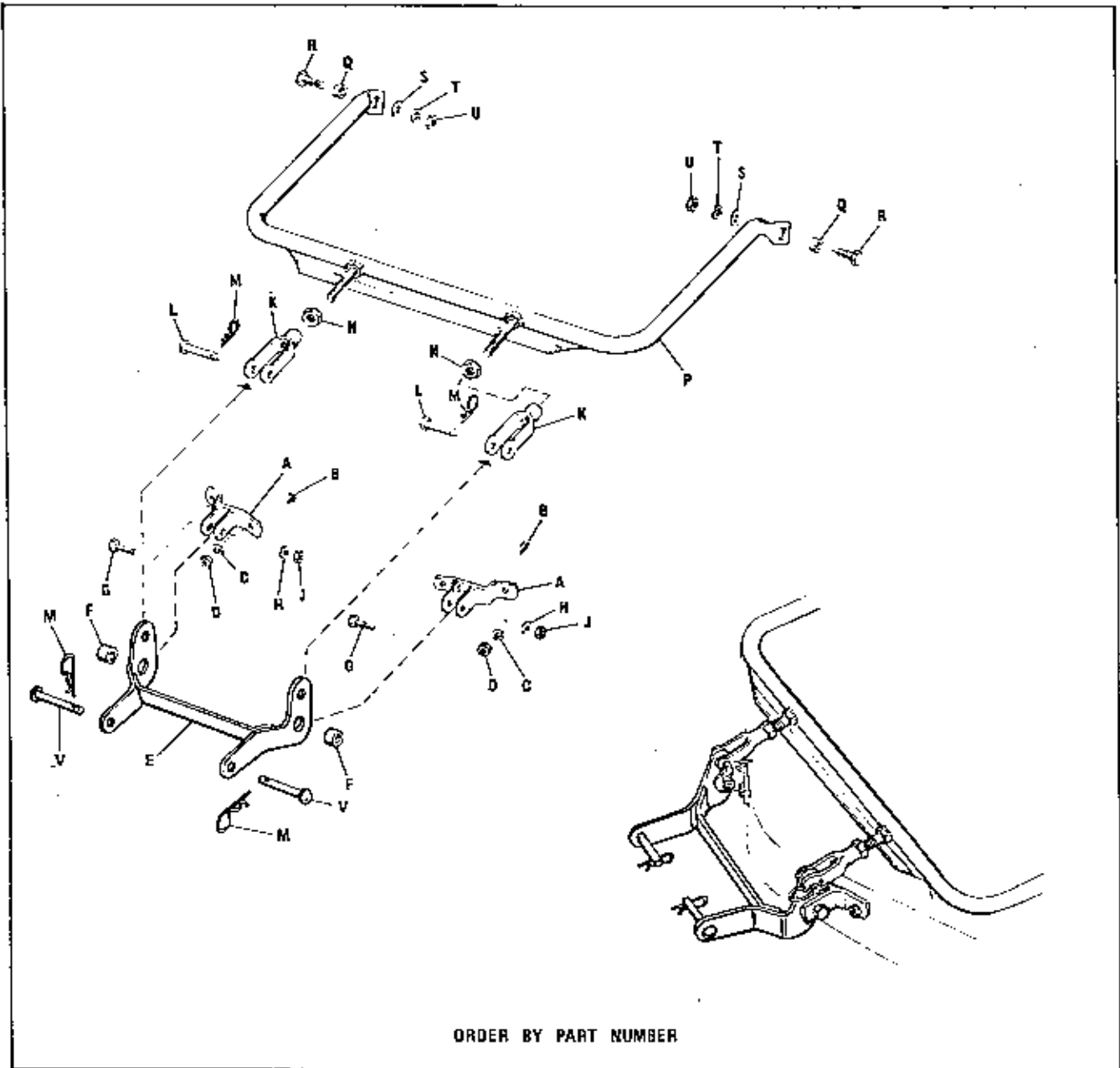

| Ref. Let. | Part No. | Description |
|-----------|----------|----------------------------------|
| A | 108219 | Front Bracket Assembly |
| B | 702002 | Carriage Bolt, 3/8"-16 x 1" |
| C | 720002 | Lock Washer, 3/8" |
| D | 717003 | Full Hex. Nut, 3/8"-16 |
| E | 108794 | Rocker Arm |
| F | 105051 | Spacer |
| G | 705049 | Hex. Cap Screw, 1/2"-13 x 1-1/4" |
| H | 720004 | Lock Washer, 1/2" |
| J | 717006 | Full Hex Nut, 1/2"-13 |
| K | 154304 | End Adj. Yoke |
| L | 154305 | Yoke Pin |

| Ref. Let. | Part No. | Description |
|-----------|----------|----------------------------------|
| M | 8161045 | Spring Clip |
| N | 717016 | Hex. Jam Nut, 1/2"-20 |
| P | 108459 | Bail Assembly |
| Q | 105051 | Spacer |
| R | 705049 | Hex. Cap Screw, 1/2"-13 x 1-1/4" |
| S | 719004 | Plain Washer, 1/2" |
| T | 720004 | Lock Washer, 1/2" |
| U | 717006 | Full Hex Nut, 1/2"-13 |
| V | 118053 | Pin |

MOWER UNDERSIDE

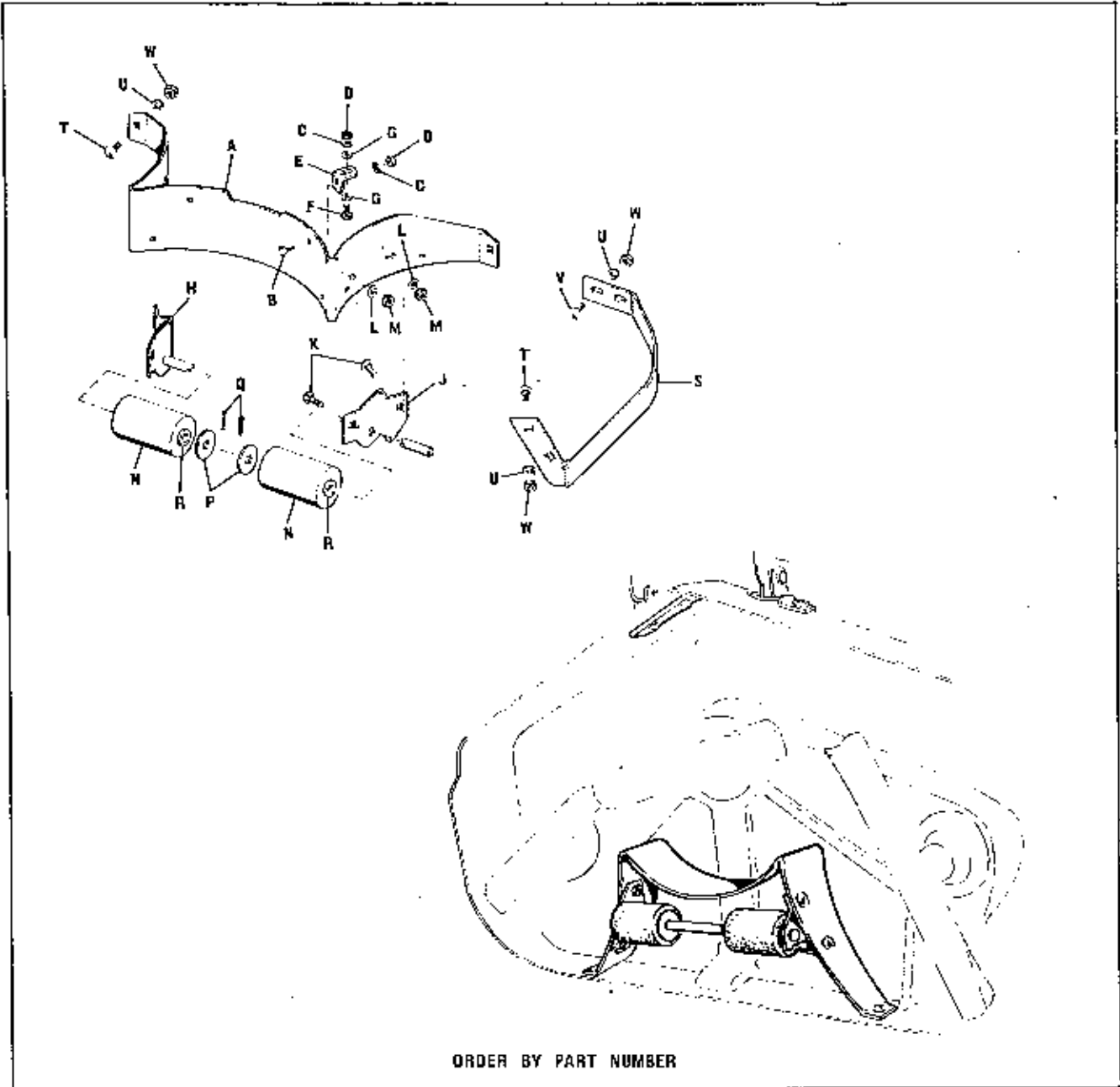

ORDER BY PART NUMBER

| Ref. Let. | Part No. | Description |
|-----------|----------|-------------------------------------|
| A | 108453 | Baffle |
| B | 714012 | Self Tap Hex. Screw, 1/4"-20 x 7/8" |
| C | 720003 | Lock Washer, 1/4" |
| D | 717005 | Full Hex. Nut, 1/4"-20 |
| E | 108186 | Baffle Clip |
| F | 715018 | Hex. Cap Screw, 1/4"-20 x 5/8" |
| G | 719006 | Plain Washer, 1/4" |
| H | 108454 | Bracket & Shaft Assembly |
| J | 108224 | L.H. Roller Bracket |
| K | 702015 | Carriage Bolt, 5/16"-18 x 3/4" |
| L | 720001 | Lock Washer, 5/16" |

| Ref. Let. | Part No. | Description |
|-----------|----------|-------------------------------|
| M | 717001 | Full Hex. Nut, 5/16"-18 |
| N | 108431 | Roller Assembly W/Bushing |
| P | 116001 | Washer |
| Q | 722011 | Cotter Pin, 5/16"-1" |
| R | 108419 | Bushing |
| S | 108452 | Housing Assembly Guard |
| T | 702003 | Carriage Bolt, 3/8"-16 x 3/4" |
| U | 720002 | Lock Washer |
| V | 702002 | Carriage Bolt, 3/8"-16 x 1" |
| W | 717003 | Full Hex. Nut, 3/8"-16 |

DECK ASSEMBLY

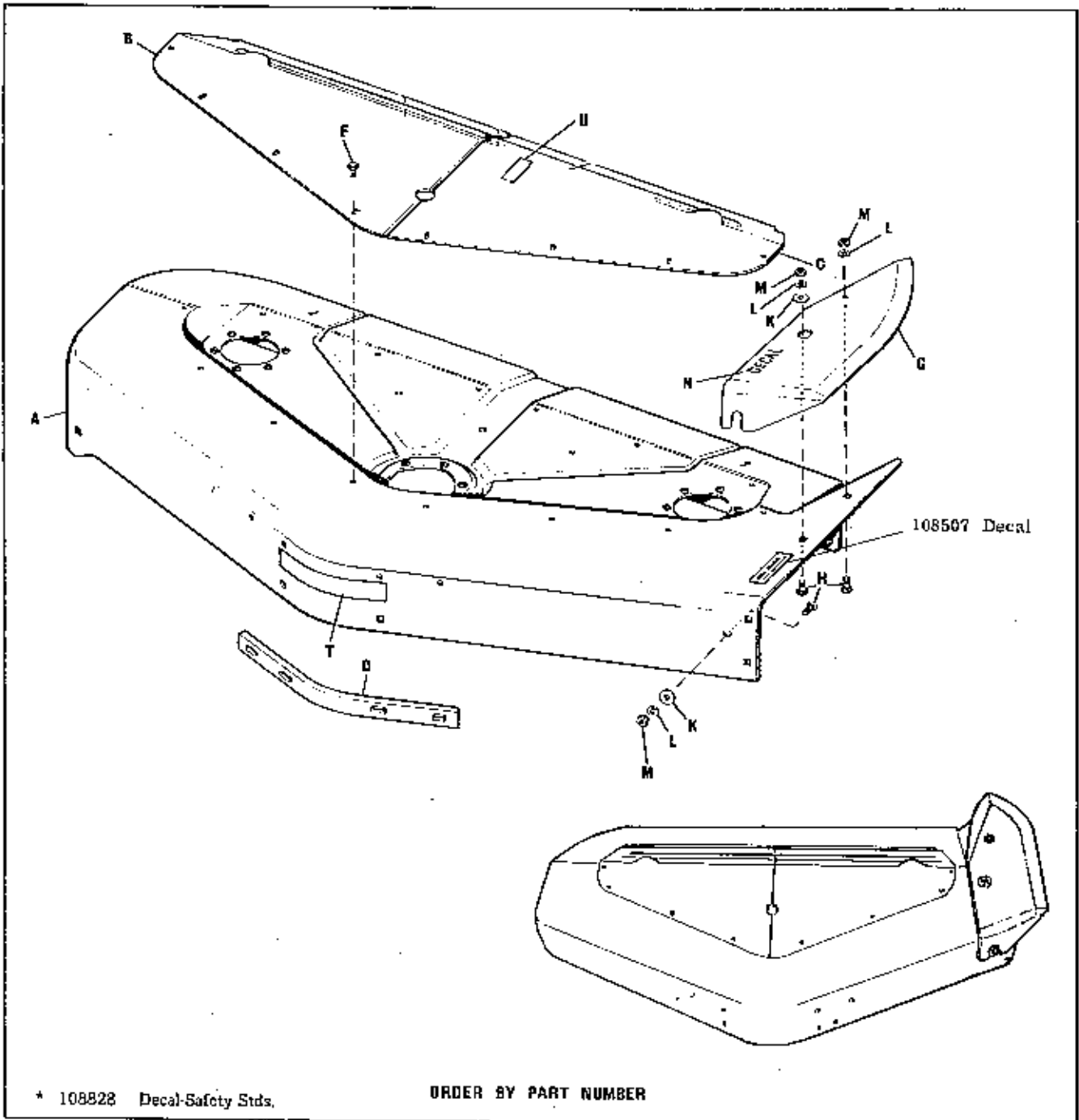

| Ref. Let. | Part No. | Description |
|-----------|----------|---|
| A | 108451 | Mower Housing |
| B | 108456 | R.H. Cover |
| C | 108457 | L.H. Cover |
| D | 108366 | Reinforcing Bar |
| F | 715067 | Self Tapping Screw, 1/4"-20 x 3/8" lg. |
| G | 108506 | Deflector |
| H | 703004 | Carriage Bolt, 3/8"-16 x 1/2" lg. |

| Ref. Let. | Part No. | Description |
|-----------|----------|---------------------|
| K | 8161199 | Special Washer |
| L | 720002 | Lock Washer, 3/8" |
| M | 717003 | Hex Nut, 3/8"-16 |
| N | 103031 | Decal |
| P | 108770 | Guide Belt Assembly |
| T | 106719 | Film Simplicity |
| U | 108102 | Decal |

ROLLER ASSEMBLY

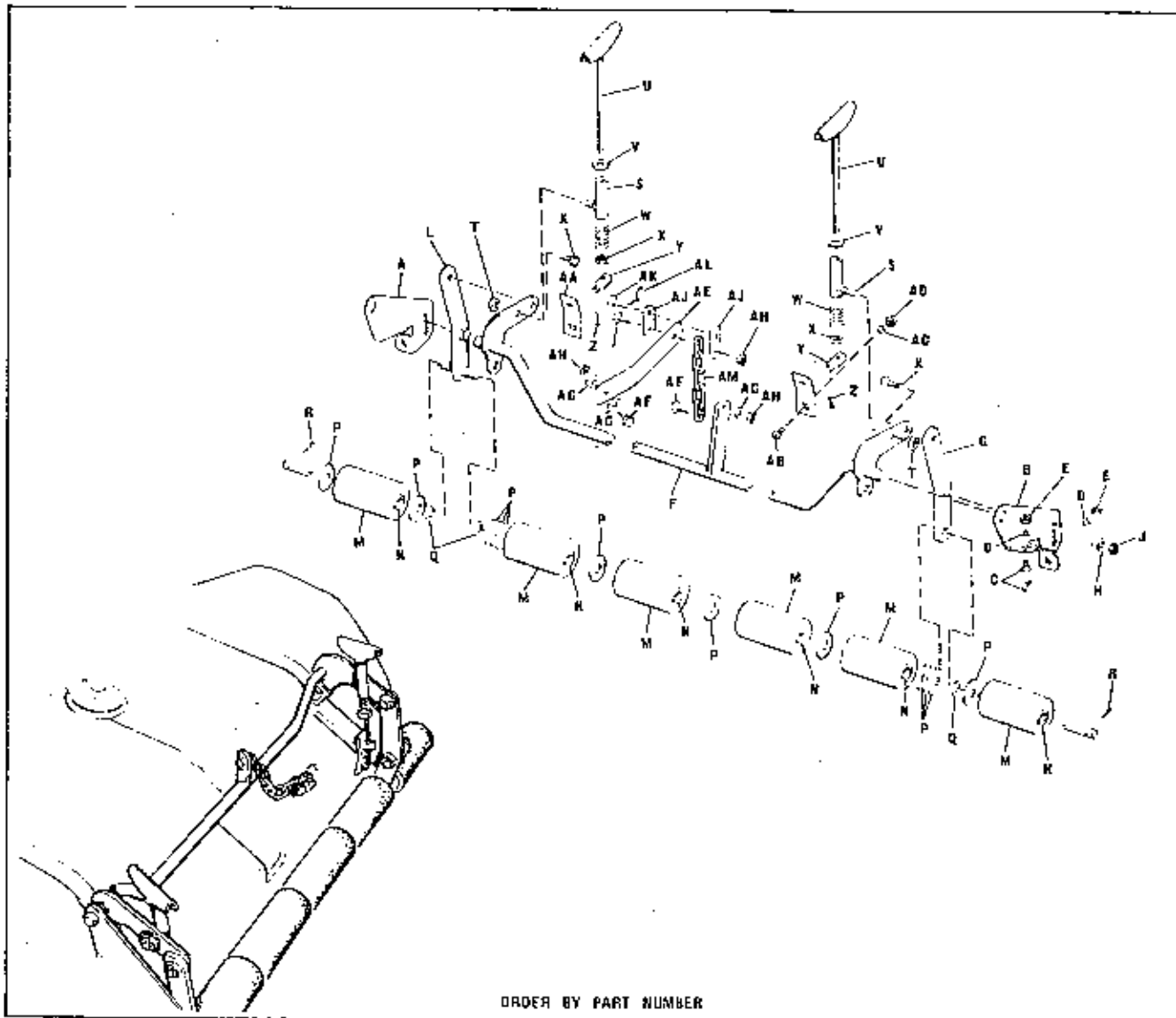

| Ref. Let. | Part No. | Description |
|-----------|----------|-------------------------------|
| A | 108461 | R.H. Roller Bracket |
| B | 108462 | L.H. Roller Bracket |
| C | 702003 | Carriage Bolt, 3/8"-16 x 3/4" |
| D | 720002 | Lock Washer |
| E | 717003 | Full Hex. Nut, 3/8"-16 |
| F | 108463 | Rocker Assembly Arm |
| G | 108465 | Roller Bar Assembly R.H. |
| H | 719001 | Plain Washer, 3/8" |
| J | 717510 | Full Hex. Nut, 3/8"-16 |
| K | 705005 | Hex. Cap Screw, 3/8"-16 x 1" |
| L | 108464 | Roller Shaft Assembly |
| M | 108432 | Roller W/Bushing |
| N | 108419 | Bushing |
| P | 116001 | Washer |
| Q | 8261055 | Washer |
| R | 722011 | Cotter Pin, 3/16"-1" |
| S | 108467 | Socket Crank Assembly |
| T | 717510 | Full Hex. Nut, 3/16"-16 |

| Ref. Let. | Part No. | Description |
|-----------|----------|-------------------------------|
| U | 108469 | Adjusting Screw Assembly |
| V | 719001 | Plain Washer |
| W | 108360 | Adjusting Screw Spring |
| X | 717013 | Hex. Jam Nut, 3/8"-16 |
| Y | 108172 | Pivot |
| Z | 722001 | Cotter Pin, 3/32" x 3/4" |
| AA | 108444 | Lift Link |
| AB | 703004 | Carriage Bolt, 3/8"-16 x 3/4" |
| AC | 720002 | Lock Washer, 3/8" |
| AD | 717003 | Full Hex. Nut, 3/8"-16 |
| AE | 108198 | Mower Lift Lever |
| AF | 705005 | Hex. Cap Screw, 3/8"-16 x 1" |
| AG | 719001 | Plain Washer, 3/8" |
| AH | 717510 | Full Hex. Nut, 3/8"-16 |
| AJ | 108199 | Mower Lift Link |
| AK | 153058 | Lock Pin |
| AL | 8161045 | Spring Clip |
| AM | 101084 | Chain |

ORDER BY PART NUMBER

ARBOR ASSEMBLIES

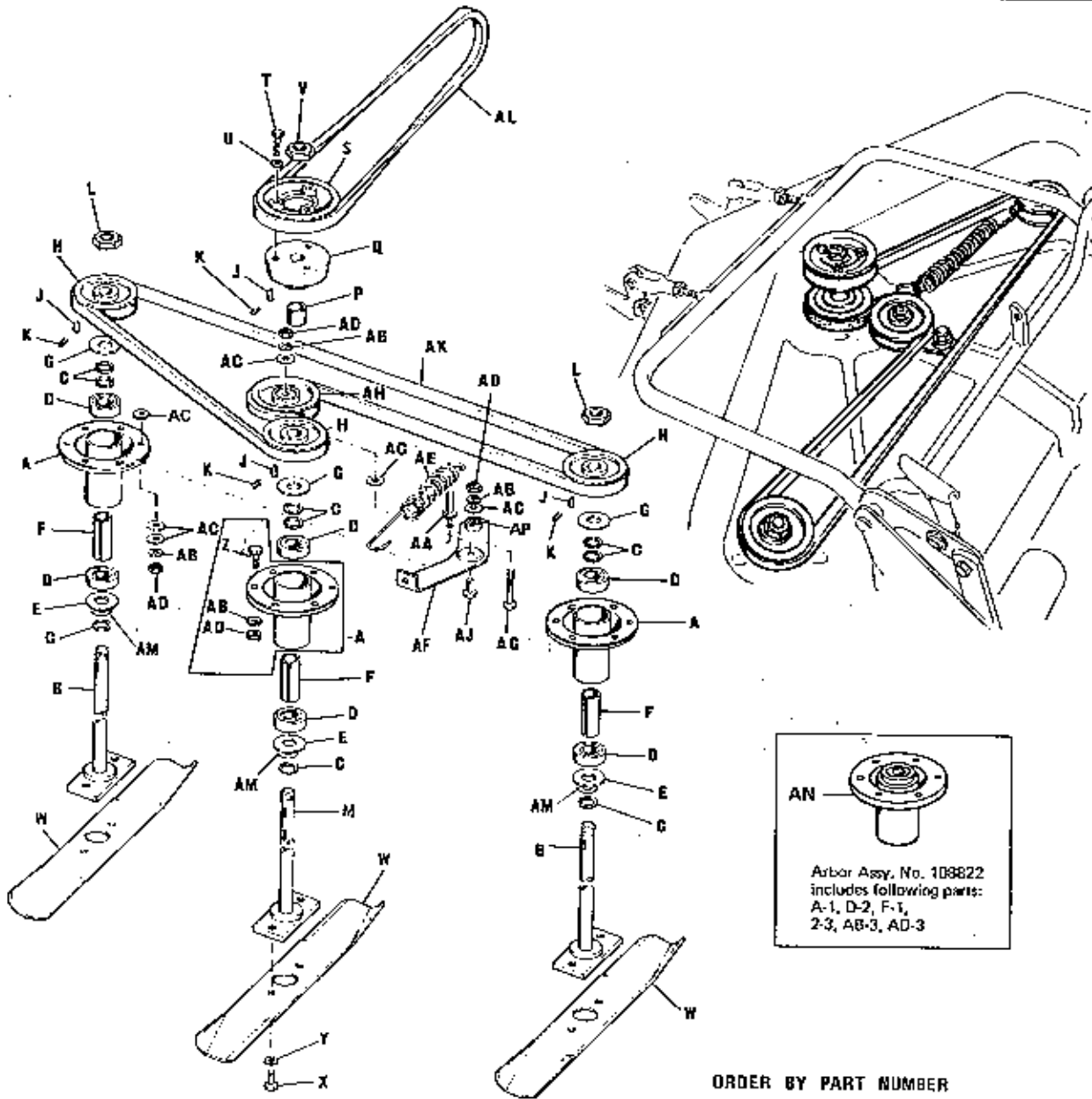

Arbor Assy. No. 108822
includes following parts:
A-1, D-2, F-1,
2-3, AB-3, AD-3

ORDER BY PART NUMBER

| Ref. Let. | Part No. | Description |
|-----------|----------|----------------------------------|
| A | 103097 | Tube Assembly, Arbor |
| B | 108250 | Arbor Assembly |
| C | 108181 | Washer |
| D | 108202 | Bearing |
| E | 108257 | Washer |
| F | 108201 | Spacer |
| G | 108139 | Flinger |
| H | 108142 | Pulley |
| J | 725006 | Woodruff Key, // 61-3/16 x 5/8" |
| K | 713504 | Set Screw, 5/16"-18 x 3/8" |
| L | 717517 | Hex. Lock Nut, 3/4"-16 |
| M | 108434 | Arbor Drive Assembly |
| P | 124044 | Spacer |
| Q | 108436 | Pulley Hub |
| S | 108438 | Pulley |
| T | 705018 | Hex. Cap Screw, 5/16-18 x 1-1/2" |

| Ref. Let. | Part No. | Description |
|-----------|----------|---|
| U | 720001 | Lock Washer, 5/16" |
| V | 717517 | Hex. Lock Nut, 3/4"-16 |
| W | 108448 | Knife Blade |
| X | 715024 | Hex. Cap Screw, 3/8"-16 x 5/8" |
| Y | 720002 | Lock Washer, 3/8" |
| Z | 705004 | Screw Hex. Cap, 3/8"-16 NC x 3/4" lg. Zinc or Cad. Pl. P. |
| AA | 156131 | Stop Stud |
| AB | 720002 | Lock Washer, 3/8" |
| AC | 719002 | Plain Washer, 5/16" |
| AD | 717003 | Full Hex Nut, 3/8"-16 |
| AE | 108449 | Tension Spring |
| AF | 108473 | Idler Lever Assembly |
| AG | 705010 | Hex. Cap Screw, 3/8"-16 x 1-3/4" |
| AH | 108386 | Idler Pulley |
| AJ | 108418 | Screw |
| AK | 108450 | "V" Belt |
| AL | 108458 | "V" Belt, Cross Drive |
| AM | 108472 | Washer |
| AN | 108822 | Arbor Assembly with Bearings and Hardware |
| AP | 8171073 | Inner Race |