

Simplicity[®]

SYSTEM 5008 Broadmoor

1690008	BROADMOOR 8 H.P.
1690023	36" Rotary Mower
1690034	32" Snow Thrower
1600343	30" Rotary Tiller
1690025	Vacuum Collector (Eng. Driven)
1690029	Adapter, Vac. Coll. 36"
1690031	Roving Nozzle
1600236	Dump Cart
1600395	Dump Cart Cover

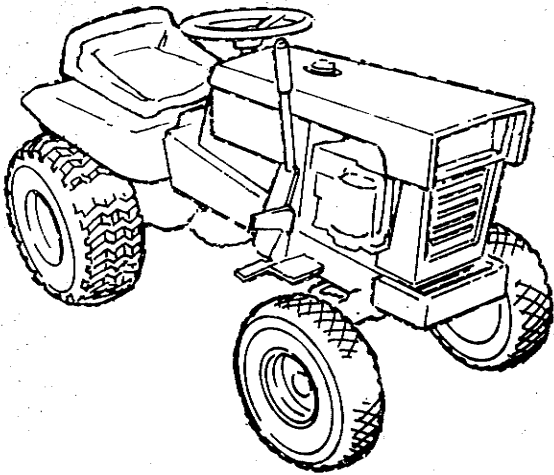

OPERATOR'S MANUAL

TO THE OWNER

Congratulations on your purchase of the Simplicity tractor. It has been designed with emphasis on the ability to do your most important jobs quickly and efficiently with the least operator effort.

So that you can get the very most from your purchase, you and anyone else who may operate the tractor should study this manual and the owners manual for your attachments before using your Simplicity tractor. Throughout the manual, we will refer to directions as left, right, front, and rear. These directions are as the operator sits on the tractor seat in the driving position.

For your own safety and that of your family and others, periodically review the safety tips found in this manual. You will find the table of contents very useful in referring to this manual when questions arise in the future. We have provided you with information to perform most service jobs quickly and easily, but your Simplicity dealer will be happy to help you with any service or repair work.

When ordering replacement parts for your Simplicity tractor, be prepared to give your dealer the identification numbers found on the tractor and engine identification plates shown below. The identification plate for the tractor is located on the frame in front of the tractor seat. The one for the engine is located on the left side of the engine blower housing. We suggest that you locate the numbers and record them below for easy reference.

SIMPLICITY MANUFACTURING CO., INC.
PORT WASHINGTON, WIS., U. S. A.

Refer to I.D. no. when
writing or ordering parts.

I.D. No.

MODEL

TYPE

CODE

MODEL TYPE CODE
BY SPECIAL ORDER ONLY
SEE DEALER FOR DETAILS
SEE DEALER FOR DETAILS

TRACTOR IDENTIFICATION PLATE

ENGINE IDENTIFICATION PLATE

WARRANTY

The Company warrants Simplicity products to be free from defects in material and workmanship, except the Company makes no warranty, express or implied, with respect to tires, engines, generators and voltage regulators, which are warranted by their respective manufacturers. Any part covered by this warranty which is proven defective within one year (45 days for equipment used for rental, municipal or commercial purposes) under normal use, from date of purchase, will be replaced without charge, provided such part is returned to the factory, (if requested), and is found to be defective upon examination at the factory. This warranty does not apply to any Simplicity products altered outside of the Simplicity factory. **THE FOREGOING WARRANTY IS IN LIEU OF ALL OTHER WARRANTIES, EXPRESS OR IMPLIED, OF MERCHANTABILITY, FITNESS FOR A PARTICULAR PURPOSE, PERFORMANCE, OR OTHERWISE.** The Company's obligation under its warranty is strictly and exclusively limited to the replacement of such parts, and in no event shall the Company be liable for any other damages, whether direct, immediate, incidental, special, or consequential. Simplicity Manufacturing Company, Inc., reserves the right to modify or change specifications without prior notification. There are no warranties which extend beyond the description of any Simplicity product.

TINE WARRANTY

Simplicity Manufacturing Company, Inc. warrants rotary tiller tines against breakage for the period not to exceed the normal life of the rotary tiller; and will replace broken tines directly to the customer at no charge; provided broken tines are returned prepaid to the Company's Service Department, Port Washington, Wisconsin.

PROTECT YOURSELF AND OTHERS

In addition to the basic safety rules appearing on the inside front cover, follow these safety tips when using your tractor and its attachments.

- Do not stop or start suddenly when going uphill or downhill. Reduce speed on slopes and in sharp turns to prevent tipping or loss of control.
- If your equipment should start to vibrate abnormally, stop the engine and check immediately for the cause. Vibration is usually a warning of trouble.
- Stay alert for holes in terrain and other hidden hazards.
- Look to be sure children are not behind you before backing up.
- Use care when pulling loads or using heavy equipment: Use only approved drawbar hitch points. Limit loads to those you can safely control. Don't turn too sharp and use care when backing. Use counterweights or wheel weights when suggested in the owners' manual.
- When using any attachments, never direct discharge of material toward bystanders or allow anyone near the tractor while in operation.
- Always stop the engine when removing or installing attachments or unclogging snow or grass chutes. Perform maintenance on unit only when engine is stopped.
- Never allow children or young teenagers to operate the tractor or adults to operate it without proper instruction.

Do not carry passengers. Always keep children and pets a safe distance away.

- Mow only in daylight or in good artificial light.

- Do not operate equipment when barefoot or wearing open sandals. Always wear substantial footwear.
- Disengage all clutches and shift into neutral before starting the engine.
- Take precautions such as disengaging the power take-off, lowering attachments, shifting into neutral, setting parking brake, stopping engine and removing key when leaving vehicle unattended.
- Check all nuts, bolts and screws, especially the blade and engine mounting bolts, for proper tightness at frequent intervals to be sure the equipment is in safe working condition.
- Never store equipment with gasoline in the tank inside of a building where fumes may reach an open flame or spark. Allow engine to cool before storing in any enclosure.
- To reduce fire hazard keep engine free of grass, leaves or excessive grease.
- Watch out for traffic when crossing or near roadways.
- Disengage power to attachments when transporting or not in use.
- Keep hands and feet away from rotating parts. Stay clear of discharge opening at all times.
- Always remove the ignition key when inspecting, cleaning, repairing or adjusting the tractor or attachments.
- Be especially careful when operating on wet or slippery surfaces.

TABLE OF CONTENTS

WARRANTY	INSIDE COVER
SAFETY INFORMATION	1
FEATURES	2
OPERATION	3
CONTROLS AND HOW TO USE THEM	3
BEFORE STARTING	4
STARTING & STOPPING THE ENGINE	5
TRAVEL SPEED SELECTION	5
SHIFTING	5
STOPPING	6
TROUBLE SHOOTING	6
ADJUSTMENTS	7
RAISING THE TRACTOR TO VERTICAL	7
CLUTCH AND BRAKE ROD	7
BELT STOPS	8
STARTER GENERATOR BELT	8

SEAT	9
POWER TAKE OFF	9
PARKING BRAKE	9
MAINTENANCE	10
EVERY 5 HOURS	10
EVERY 25 HOURS	10
EVERY 100 HOURS	11
SERVICE	11
GENERAL REPAIR	11
OFF SEASON STORAGE	11
STARTING AFTER STORAGE	12
REPLACEMENT PARTS	12
SPECIFICATIONS	13-14
ACCESSORIES	15
WARRANTY	15
PARTS LISTING	16-30
PARTS LISTING FOR MAJOR ATTACHMENTS	31

Congratulations on your purchase of this fine riding tractor. We, the Manufacturer, know you bought this machine to your lawn and garden work easier. You bought the right machine to do it. So that you can get the very most from your purchase, we would consider it a personal favor if you would take time to study this manual before using your tractor and its attachments. It will increase the chance of adding you to our long list of satisfied customers. Also, before allowing others to operate your tractor, be sure they read and understand the safety precautions and operation section of this manual.

For your own safety and that of your family and friends, periodically review the safety tips found on the inside front cover and page one of this manual. Before we learn how to operate the tractor, let's take a look at some of its exciting features.

EASY STEERING — 3.3 to 1 ratio gear and sector steering of true geometric design. The front wheels follow different arcs when turning, giving improved steering and minimizing wheel marks on soft lawns. The short turning radius (22 inches inside rear wheel) gives excellent maneuverability-turning time.

EASY TO REACH HAND OPERATED CONTROLS. Gear-shift, choke-o-matic, ignition switch, and ammeter are conveniently located at the instrument panel. The power take-off clutch lever and implement lift lever are located for natural, easy operation. Easy to reach parking brake is simple to use and dependable.

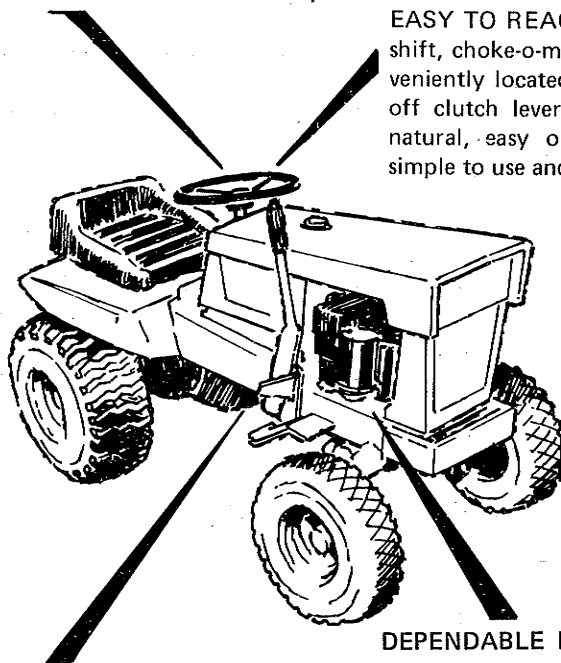

SMOOTH OPERATING COMBINED CLUTCH AND BRAKE PEDAL. Start and stop with easy rocker action and no wheel skid. Improved clutch converts any transmission speed from zero to maximum without shifting for inching or turning.

DEPENDABLE BRIGGS & STRATTON EIGHT HORSE-POWER ENGINE with twelve volt electric starter system, including a 32 amp. hr. automotive type battery. Vertical driveshaft provides maximum power to attachments, simple protected drive system, and low center of gravity.

RUGGED CHANNEL FRAME CONSTRUCTION FOR DURABILITY AND LONG LIFE; electrically welded, heavy gauge steel. Short wheelbase, large low pressure tires. New bead lock rims keep tires sealed at low pressures for a very soft ride.

QUICK SWITCHING ATTACHMENTS. Custom engineering implements are designed to be simple to attach and remove as well as operate. The broadest variety of front, center and rear mounted implements offered.

DEPENDABLE, ALL GEAR TRANSMISSION. Fully enclosed, sealed and lubricated. Limited slip differential reduces wheel slippage on slippery or sloping surfaces, yet allows each wheel to rotate at required speed while turning.

OPERATION

CONTROLS AND HOW TO USE THEM

Picture yourself seated on your tractor. Before starting the engine, let's learn how to use each of these safe, easy to reach controls. (The numbers on the Figures 1 & 2 correspond to the paragraph numbers below.)

1. Ignition Switch: When turned clockwise to the first position the ignition is turned on. Turn past this position to actuate the starter. (If the starter does not actuate, be sure the shift lever is in neutral and the power take-off disengaged.) Release the key as soon as the engine starts. Return the key to the vertical position to stop the engine.

2. Engine Speed and Choke Control Lever: The engine speed and choke control should be moved all the way up for the choke position. Placing the control lever up to the fast position increases the engine speed and down to the slow position decreases the engine speed.

3. Ammeter: The dial pointer will move right to the "Charging" position when energy is being drawn from the battery. The pointer will normally fluctuate to either side of the dial center.

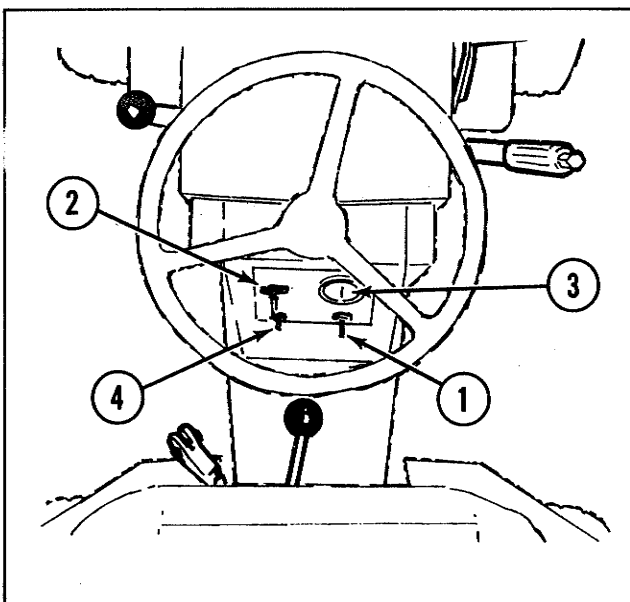

Figure 1

4. Light Switch: (Optional) Place the toggle switch in the "Up" position to turn on lights. Power for lights is taken from the engine dual alternator system and not the battery therefore the light intensity will depend on the engine RPM. The ignition switch must be in the on position for the lights

5. Fuel Gauge and Filler Cap: The gauge measures the level of fuel in the tank. Turn the cap counter-clockwise to remove for refueling.

6. Clutch and Brake Pedal: Depressing the pedal will first disengage the tractor drive clutch. As you continue to depress the pedal the brake will be applied to stop the tractor.

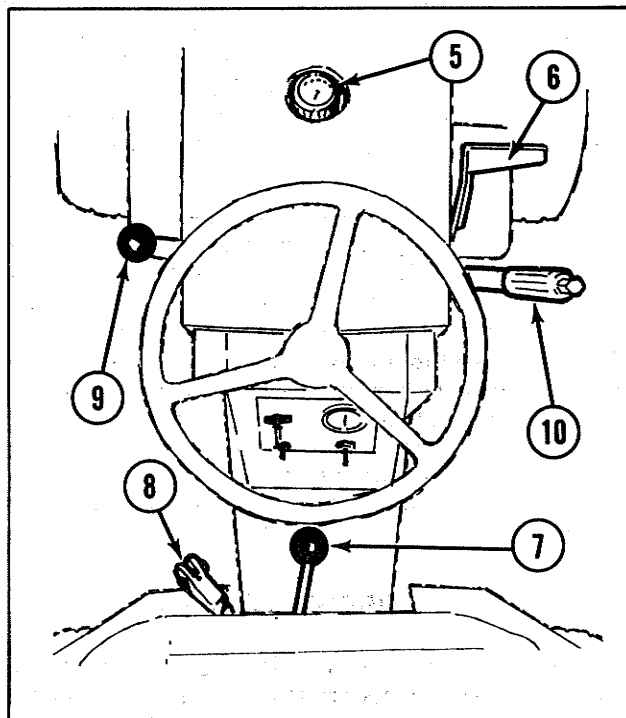

Figure 2

7. Gear Shift Lever: The gear shift lever is used to select the desired transmission gear speed and direction. There are three forward and one reverse positions.

First	1.07 MPH
Second	2.45 MPH
Third	3.81 MPH
Reverse	3.81 MPH

The diagram printed on the panel shows the location of each position. To shift the transmission into first or reverse from the neutral position, it is necessary to pull UP on the shift lever to overcome the force of the shift fork spring. After you feel the lever pass the spring, push the shift lever to the left or right and place the transmission into reverse or first gear as you desire. To shift into second or third, push DOWN on the shift lever from neutral until you feel it overcome the spring, then push it to the left or right until it is in second or third gear. Do not attempt to move the shift lever unless the foot pedal (item 7) is depressed and the tractor is stopped.

8. Parking Brake Lock: To lock the parking brake, grasp the handle and pull it upward and back until it rests against the seat deck. To release, pull the top portion away from the seat deck and push it down. NOTE: Depress foot pedal before engaging or releasing.

9. Power Take-Off Clutch: The power take-off clutch controls power to attachments such as a mower or snow thrower which are driven by the engine pulley. The clutch operates by engaging or disengaging the front pulleys with the implement drive belt to increase or decrease tension. To en-

gage the drive, slowly push the lever forward and down all the way to the engaged position. To disengage the power take-off drive, pull the lever completely to the rear. The engine should be running at three fourths to full throttle when the power take-off is engaged to absorb the initial effect of the added load. Tractor ground speed can be regulated with the transmission throttle. (The power take-off must be disengaged for the starter to operate.)

10. Lift Lever: The lift lever is used for lifting the rotary mower or other implements out of the operating position so they can be transported. The implement is connected to the lift lever either with a lift chain or a lift link to the front or rear of the tractor. The thumb button on top of the handle is pressed to disengage the latch from the quadrant so the lever can be moved forward or rearward as required and locked in position. *See the attachment book for specifics on how the lever is to be used on your particular implements.* All attachments pull back on lift lever to raise and release forward to lower. Attachment when lowered operate in a float position. Lift lever will lock only in the raised position.

BEFORE STARTING

Though your dealer may have performed the before starting check listed below, we suggest you personally check each one so that you will become familiar with them and also to insure that your tractor is ready to go the first time you use it.

1. Tire Inflation: The tractor is shipped with all tires inflated to 25 P.S.I. Before operating, reduce pressure in all tires. The front tires 12 to 15 P.S.I. and rear 6 to 8 P.S.I.

2. Engine Oil: Be sure the oil in the engine crankcase is at the proper level. See your Briggs and Stratton manual and page 10 (Figure 3) of this manual.

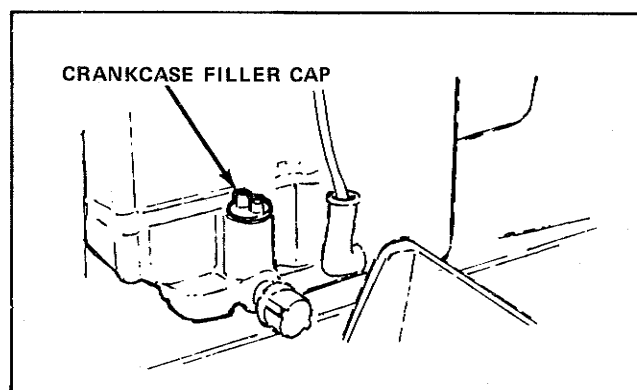

Figure 3

3. Transmission Oil: Check the transmission to insure it is filled with oil to the proper level. See page 11 of this manual for type and weight of oil to use. (Figure 4)

4. Fuel Supply: Check the fuel supply. Fill tank completely with clean, fresh, leaded or non-leaded "Regular" grade automotive gasoline. (*Do not mix oil with gasoline*). Store gasoline in small quantities as prolonged storage produces gum. See page 12, item 6 of this manual. (Figure 5)

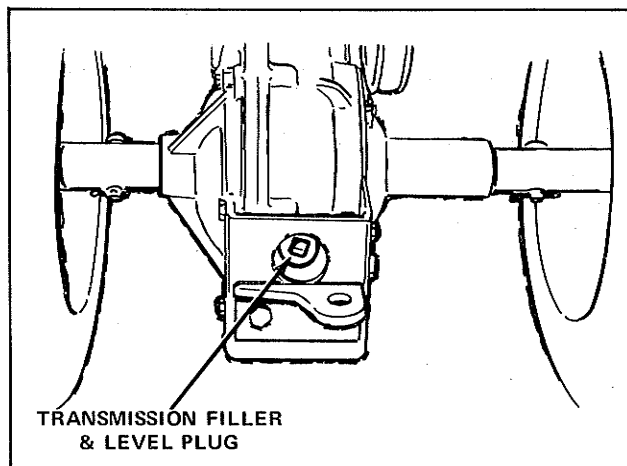

Figure 4

CAUTION

Gasoline is highly inflammable. Avoid overfilling and wipe up any spilled fuel. Allow no open flame, smoking or matches near the area when refueling.

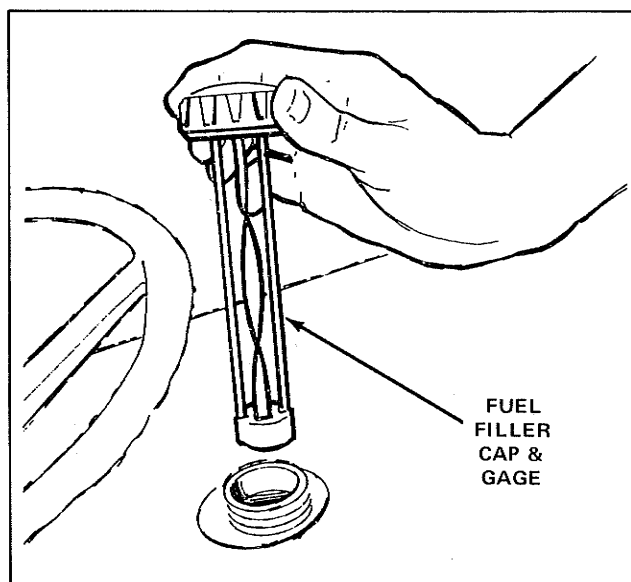

Figure 5

5. Battery: Be sure the battery is filled to the proper level with electrolyte and the vent holes on each cap are open. See page 11.

6. Lubrication: Lubricate all grease fittings and oil lubrication points as shown in the "Maintenance" section of this manual on page 10.

7. Attachments: Read and become familiar with the ATTACHMENT MANUAL which refers to attachments you will be using with your tractor. **IMPORTANT:** If you are using a rotary mower with your tractor, the front to rear height adjustment must be checked. See the Rotary Mower Attachment Manual.

STARTING THE ENGINE

1. Insure that the power take-off is disengaged by moving the lever to the rear and down. The engine will not start unless the power take-off is disengaged. (Figure 6)
2. Place the transmission shift lever in the neutral position. *The engine will not start unless the shift lever is in neutral.* (See Figure 6)
3. Depress the clutch-brake pedal all the way and hold it down. (See Figure 7)

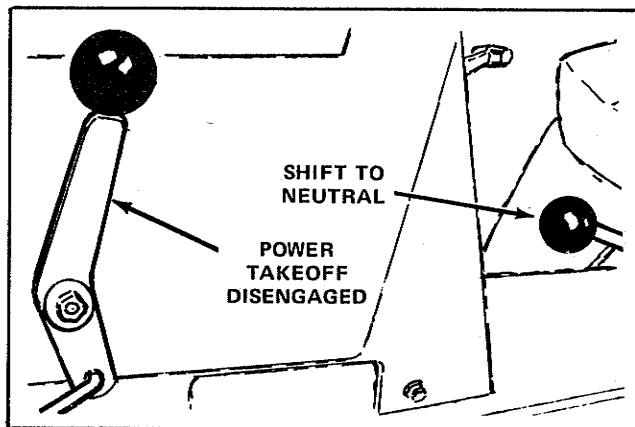

Figure 6

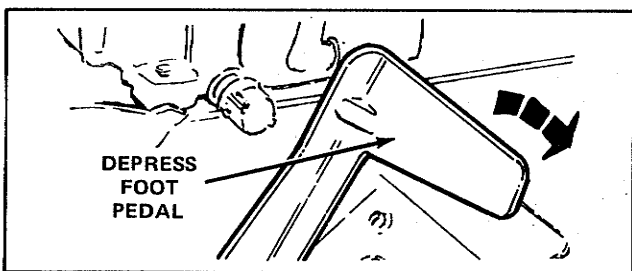

Figure 7

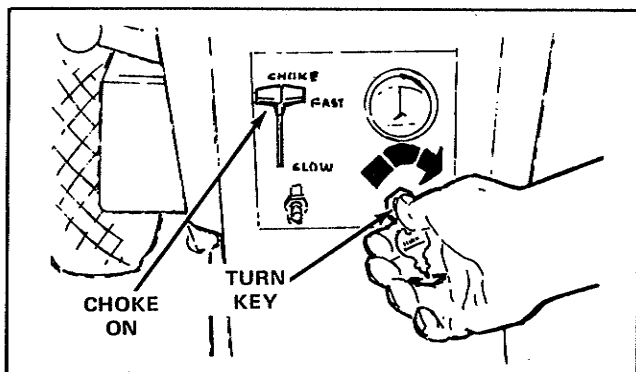

Figure 8

4. Move engine speed and choke control lever up to the choke position.
5. Turn the ignition key clockwise (see Figure 8) and hold until the engine starts, then release. Move the engine speed and choke control lever down to about 1/3 open.
6. Before applying a load, allow the engine to warm up for about a minute, then move the engine speed and choke control lever to fast or slow as needed for the operation.

STOPPING THE ENGINE

1. Move the engine speed and choke control lever to the slow position and allow the engine to idle for about a minute if the tractor has been operating under full load, to gradually reduce engine temperature. Stopping a hot engine too suddenly can cause damage to engine parts.
2. Turn the ignition key counter clockwise to the vertical position and remove the key to prevent unauthorized use of the tractor.

TRAVEL SPEED SELECTION

Tractor ground speed can be determined by placing the transmission in any one of three forward speeds or reverse, by adjusting the engine speed or by inching (slipping) the clutch. When moving the tractor from place to place, be sure any attachments are in the raised (travel) position and the power take-off disengaged. You may find it appropriate to use many combinations of transmission gear and engine speed selections when transporting the tractor. The following guidelines are given:

Use First Gear: When traveling over rough or uneven ground or on hilly terrain.

Use Second Gear: On slight slopes where the ground is fairly level and even.

Use Third Gear: When traveling a distance on level ground or pavement which is smooth and even.

Place the engine speed and choke control lever one third to one half open when beginning travel. After starting the tractor in motion, adjust the engine speed for the desired rate of travel. *See the attachments book for recommended travel speed when using attachments.*

SHIFTING

Always depress the clutch-brake pedal and bring the tractor to a complete stop before attempting to shift gears. To shift the transmission into first or reverse from the neutral position it is necessary to pull UP on the shift lever to overcome the force of the shift fork spring. After you feel the lever pass the spring, push the shift lever to the left or right and place the transmission into reverse or first gear as you desire. To shift into second or third, push DOWN on the shift lever until you feel it overcome the spring, then push it to the left or right until it is placed into second or third gear. If the gears do not engage easily, it may be helpful to let the clutch out for an instant and then depress it again to rotate the gears slightly.

STOPPING

1. Slowly depress the clutch-brake pedal until the tractor stops.
2. Place the tractor in neutral and set the parking brake.
3. Disengage the power take-off clutch and lower any attachments to the ground.
4. If the engine has been running under full load, allow the engine to idle about a minute before turning the ignition key counterclockwise to the OFF position.
5. Remove the key to prevent unauthorized use of the tractor.

TROUBLESHOOTING

For instruction to overcome the following problems see "Adjustments", "Maintenance" and "Service" sections of this book.

IF THE ENGINE FAILS TO TURN OVER — check the following:

1. The shift lever must be in Neutral. Move the lever around to be sure the safety switch is contacted.
2. The power take-off must be disengaged.
3. The battery cable clamps must be clean and tight.
4. The fuse must be in working condition and fuse connection clean and tight.
5. The battery may not be charged.

IF THE ENGINE TURNS, BUT WILL NOT START, check the following:

1. Wiring connections at the ignition switch and starter motor must be clean and tight.
2. The combined throttle and choke control lever must be at choke.
3. The spark plug cable must be tightly connected.
4. The fuel tank must have a good regular gasoline in it.

IF BELT SLIPPAGE OCCURS, check the following:

1. Belts may be stretched or excessively worn.
2. Pulleys may be greasy or oily.
3. Insufficient belt tension due to a broken or worn tension spring or improper adjustment.

IF A BELT BREAKS, check the following:

1. Look for sharp edges or rough spots on the pulleys.
2. Pulleys may be misaligned.
3. Belt tension may be too tight.
4. Pulley may be binding.

IF HANDLING IS DIFFICULT, check the following:

1. Controls or drive systems may be out of adjustment.
2. Tires may be under-inflated, or not of equal pressure. Inflate tires to REAR 6-8 P.S.I., FRONT 12-15 P.S.I.
3. Wheels spinning on slopes. Wet grass is very slippery — try to work in the late afternoon after it has dried. Wheel weights may be added to provide additional traction. See Accessories section of this manual.

ADJUSTMENTS

Clutch and Brake Rod:

The correct adjustment of the clutch and brake pedal linkage is vital to smooth machine motion and braking. These adjustments also determine the effectiveness of the anti-rollback feature. You may wish to raise the tractor to the vertical position. *Be sure to drain fuel if necessary, and remove battery before tilting the tractor.* Make the adjustments as follows:

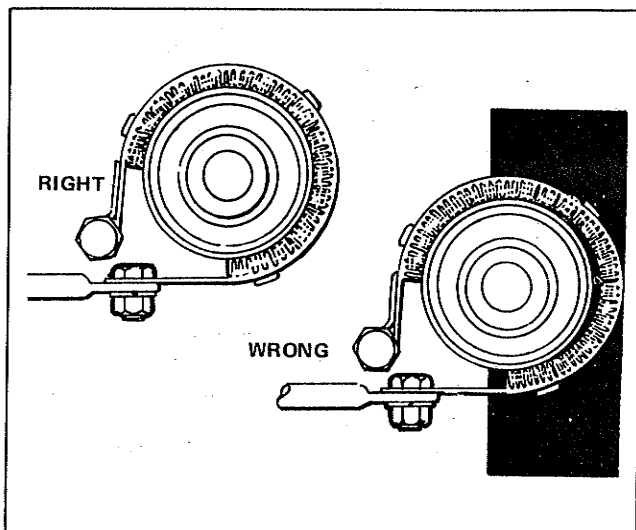

Figure 9

Depress the foot pedal and check the contact of the brake band with the brake drum. The band must conform fully to the curvature of the drum. If it does not, loosen the bolt as shown and align the band with the drum. Tighten the bolt. (See Figure 9)

2. With the foot pedal released (up), secure the brake rod set collar against the tapered coil spring. Be sure to position the collar as shown in Figure 10 so that the spring is NOT compressed. Depress the foot pedal all the way down. It should stop two and one-half inches from the foot rest edge as shown in Figure 11. Re-adjust the set collar if necessary to obtain the two and one-half inch distance.

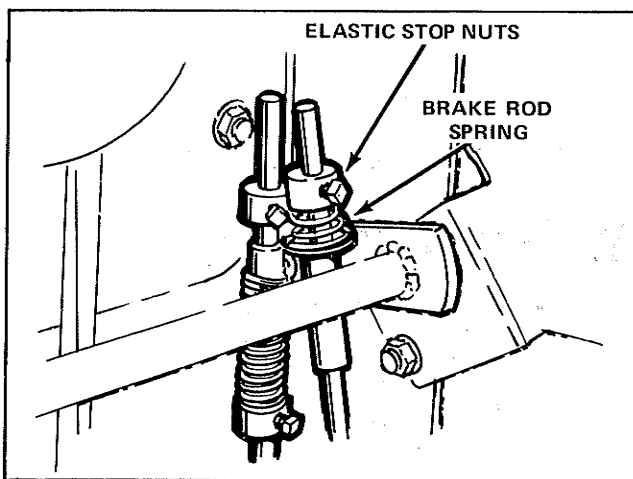

Figure 10

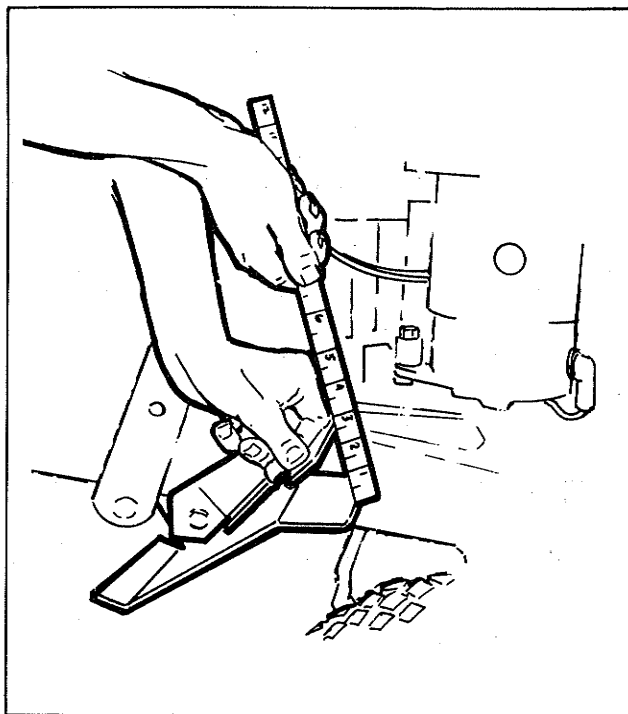

Figure 11

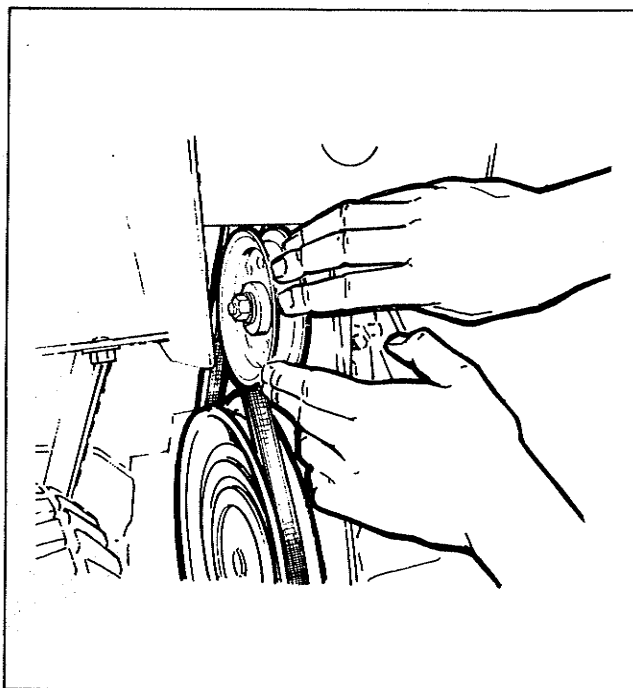

Figure 12

3. With the foot pedal released (up so the clutch idler pulley is pressed firmly against the belt (Figure 12), the distance between the clutch rod, elastic stop nut and the end of the rod guide should be five-eighths ($5/8$) inch as shown in Figure 13.

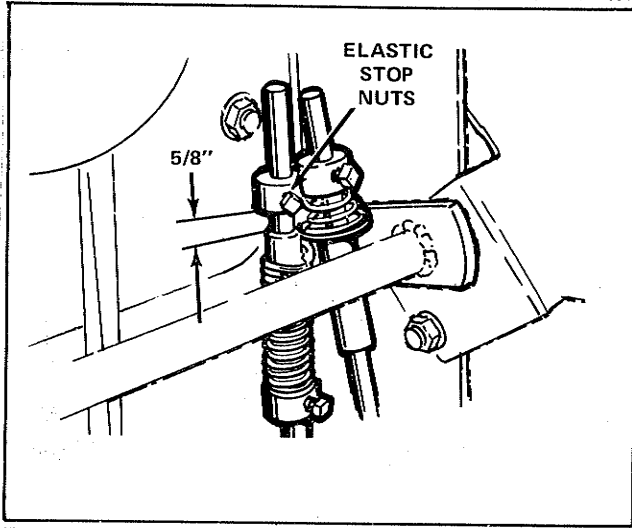

Figure 13

4. With the elastic stop nut adjusted correctly on the clutch rod depress the foot pedal all the way and adjust the set collar at the rear of the spring so that the clutch rod spring is just free to rotate on the rod. (See Figure 14)

Belt Stops:

If the main drive belt will not stop when the clutch is depressed, the belt stops may need adjusting.

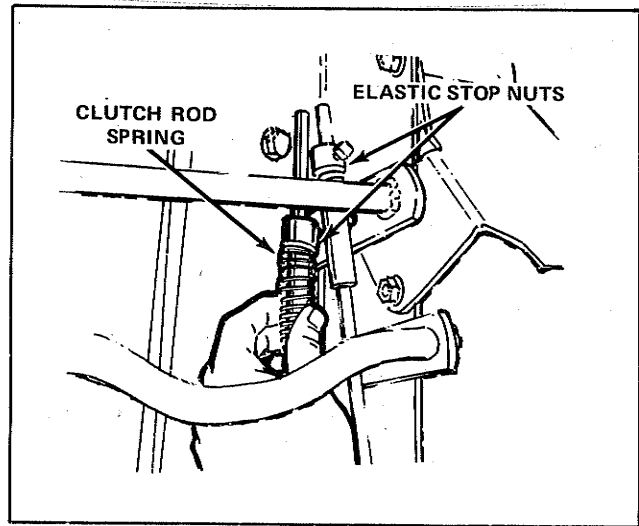
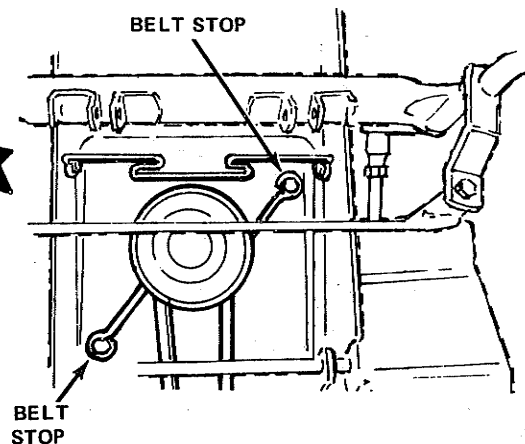
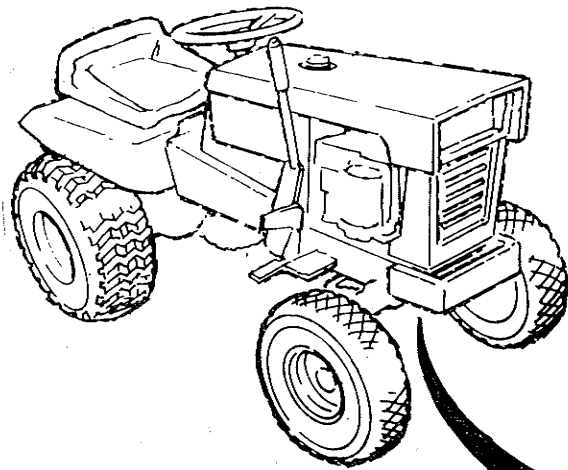

Figure 14

The belt stops on the tractor should be adjusted so there is one-sixteenth to one-eighth inch between the belt stop and the belt when the belt is tight (clutch engaged). To adjust a belt stop, loosen the bolt holding it, move the belt stop to the proper position and re-tighten the bolt. Check the adjustment after the bolt has been tightened. (See Illustration Below)



Seat:

The seat may be adjusted from front to rear as desired by repositioning the seat in any of the three sets of holes in the seat support. Simply remove the nuts and lock washers from the lower seat pan mounting bolts and reposition the seat. Retighten the nuts securely.

Parking Brake:

See illustration below. To adjust the parking brake, loosen the nut located behind the seat deck. Rotate the parking brake handle clockwise to tighten and counterclockwise to loosen the brake. The brake should be tight enough so it will hold in reverse, yet be easily placed in the "locked" position. Before retightening the locking nut, be sure the brake handle is positioned in the 11 o'clock position when engaged.

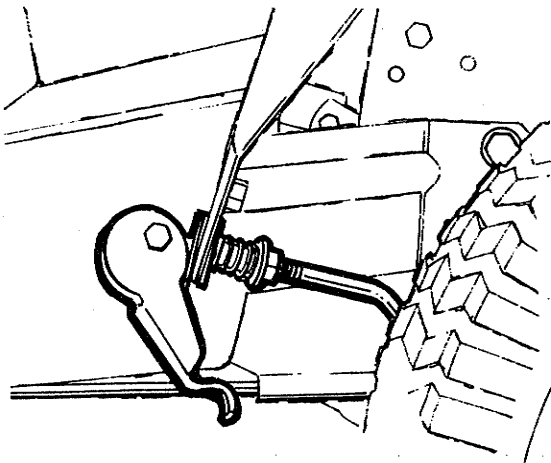

Power Take-Off Rod Guide Adjustment:

Should an attachment fail to drive properly, the power take-off clutch may need adjusting. The power take-off clutch is normally in proper adjustment when there is 7/8 inch distance between the set collar and the end of the bracket when engaged for use with snow thrower and 5/8 inch for use with the rotary mower. If more tension is needed or readjustment is necessary, disengage the power take-off lever, loosen the collar set screw and slide the collar back on the rod slightly. Engage the lever and check the belt tension. Only enough tension to drive the implement being used is necessary. Excess tension may cause premature failure of belts and pulley bearings.

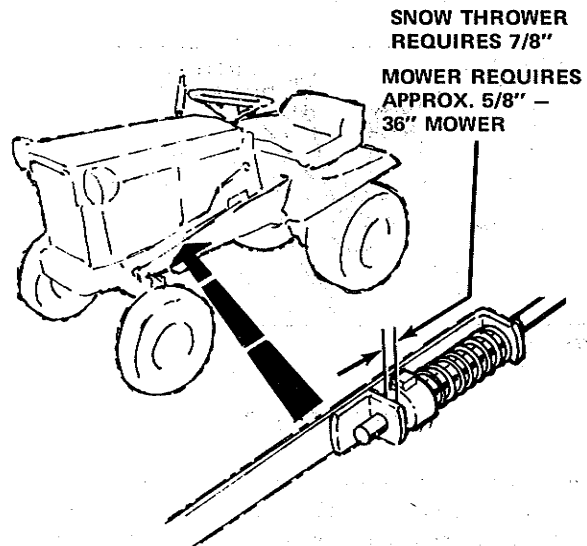

MAINTENANCE

Regular maintenance of your riding tractor will greatly increase its useful life and reduce repair costs. See your Briggs and Stratton manual for engine maintenance in addition to the steps listed here.

EVERY FIVE HOURS

Before starting the engine and at least once every five hours check the oil level in the engine crankcase. Turn the inspection — fill plug counterclockwise to remove. Maintain the oil at the full level. (See Figure 15)

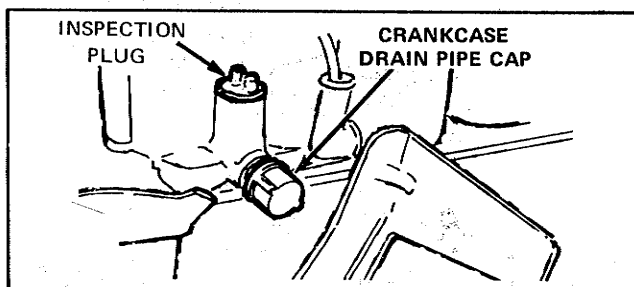

Figure 15

EVERY 25 HOURS

Every 25 hours or oftener under extremely dusty conditions: All attachments should be removed from the tractor and the following maintenance procedures performed:

1. Clean the Cooling System: In order to clean the engine cooling system, it will be necessary to remove the two thumb screws and turn steering wheel tight right, then pivot hood forward. Clean all grass, chaff and dirt from the engine fins and shrouds.

2. Change Engine Oil: Drain the crankcase when the engine is warm. Remove the drain pipe can until all oil is drained, then replace cap and tighten securely. Refill the crankcase with a high quality detergent oil classified MS. Summer (above 40°F.) use SAE 30. Winter (below 40°F.) use SAE 5W-20 or SAE 10W. *It is very important that the engine is serviced according to the season and temperature it will be used in.*

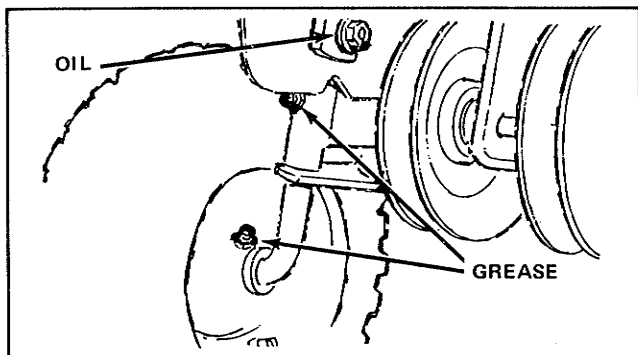

Figure 16

3. Clean the Air Cleaner: Turn the two screws on the air cleaner cover counterclockwise to loosen. Remove cover and foam element. Wash the foam air cleaner element in kerosene or liquid detergent, squeezing several times and dry it thoroughly. Saturate it with engine oil, squeeze several times to distribute the oil and remove excess and reinstall. Make certain the lips of the filter are in position when installing.

4. General Lubrication: The five grease fittings on your tractor should be greased with a lithium base automotive type grease. Remove all dirt, grit and paint from the fitting before greasing. A few drops of engine oil should be applied to the points indicated. Do not allow oil to get on belts or pulleys. (See Figures 16, 17, 18 & 19)

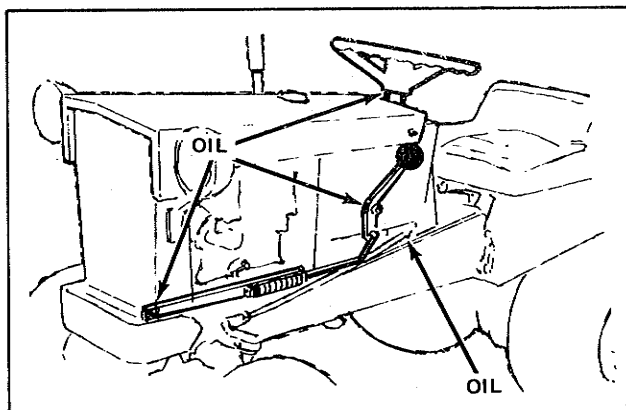

Figure 17

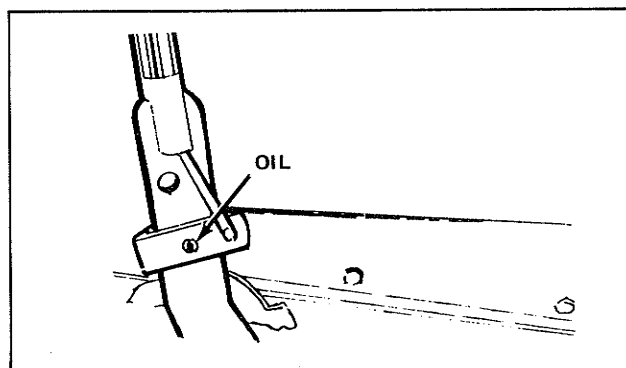

Figure 18

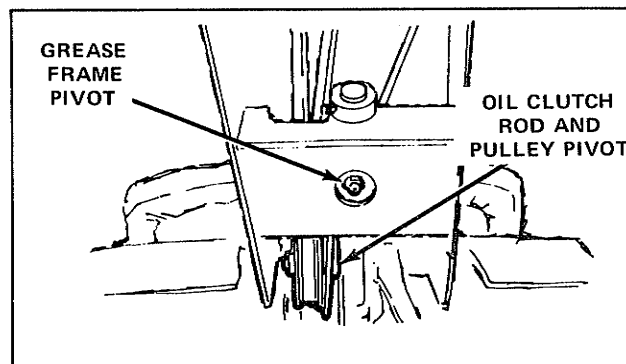

Figure 19

5. Check the Transmission Oil Level by removing the filler and level plug at the rear of the transmission. Allow the tractor to set for about 10 minutes after operation before checking. Oil should be level with the bottom of the filler and level hole. If necessary, add SAE 90 weight transmission oil. Reinstall the plug securely. It is normally not necessary, but if you wish to drain oil from the transmission, the drain plug is located on the lower right side of the transmission housing. (See Figure 20)

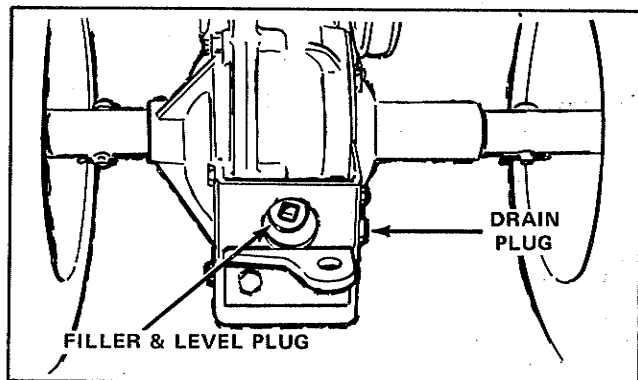

Figure 20

6. Check the Battery Water Level to insure it is maintained at the battery ring or mark approximately one-fourth inch above the plates. If water is needed, add distilled water just before charging to mix the solution. *Do not over fill the battery.* (See Figure 21)

NOTE

Initial filling of the battery will be with electrolyte, thereafter top off when need with distilled water.

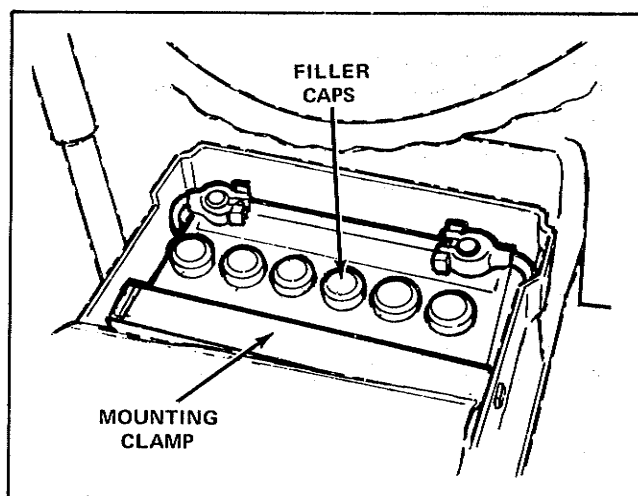

Figure 21

EVERY 100 HOURS OR ONCE A YEAR

1. Remove the spark plug, clean or replace and set the gap at .030". *Do not sand blast plugs, as the abrasive particles left on the plug may damage the engine.* Plugs may be cleaned by scraping or wire brushing compressed air

2. Remove the battery cables. *Always remove the negative "ground" cable first and replace it last.* Clean the battery with soap and water to remove all dirt, oil and corrosion from battery surface. *Do not allow foreign material or cleaning solution to get inside the battery.* Clean the terminals and cable clamps with a wire brush. Replace and tighten snugly. After tightening, coat the terminals and clamps liberally with grease or vaseline to inhibit corrosion.

SERVICE

Battery Replacement:

A dead battery or one too weak to start the engine may not necessarily mean the battery needs to be replaced. The fly-wheel alternator may not be charging properly. If there is any doubt what is causing the problem, see your dealer. If you need to replace the battery, proceed as follows:

1. Disconnect the battery cables, (*remember to remove the negative "ground" cable first*), and remove the old battery from the tractor.
2. Wash the battery mounting area and clamps with soap and water. Remove corrosion from cable ends with a wire brush. Check the new battery to be sure it is filled with the special electrolyte to the rings or marks and the vent holes in the filler caps are open.
3. Carefully place the new battery in the tractor. Fasten the battery hold down clamp and connect the cables. *Connect the (+) positive cable first.*
4. After tightening the cable clamps, put a liberal coat of grease or vaseline on them to inhibit corrosion.

Belt Replacement:

1. Depress the foot pedal to remove tension from the belt and remove the old belt.
2. Install the new belt insuring it is twisted in the same manner. The part of the belt leaving the left side of the engine drive pulley goes to the bottom side of the transmission pulley.
3. Check the belt finger adjustments and the adjustments of the clutch rod. See Adjustments Section on pages 7 and 8.

GENERAL REPAIR

To prevent rusting, sand off and paint any parts which become chipped or damaged. Apply a good rust preventative to all bare metal parts. Keep all fasteners and guards tightened securely.

OFF SEASON STORAGE

When the tractor is to be stored without use for a period of two months or longer, the following precautions should be

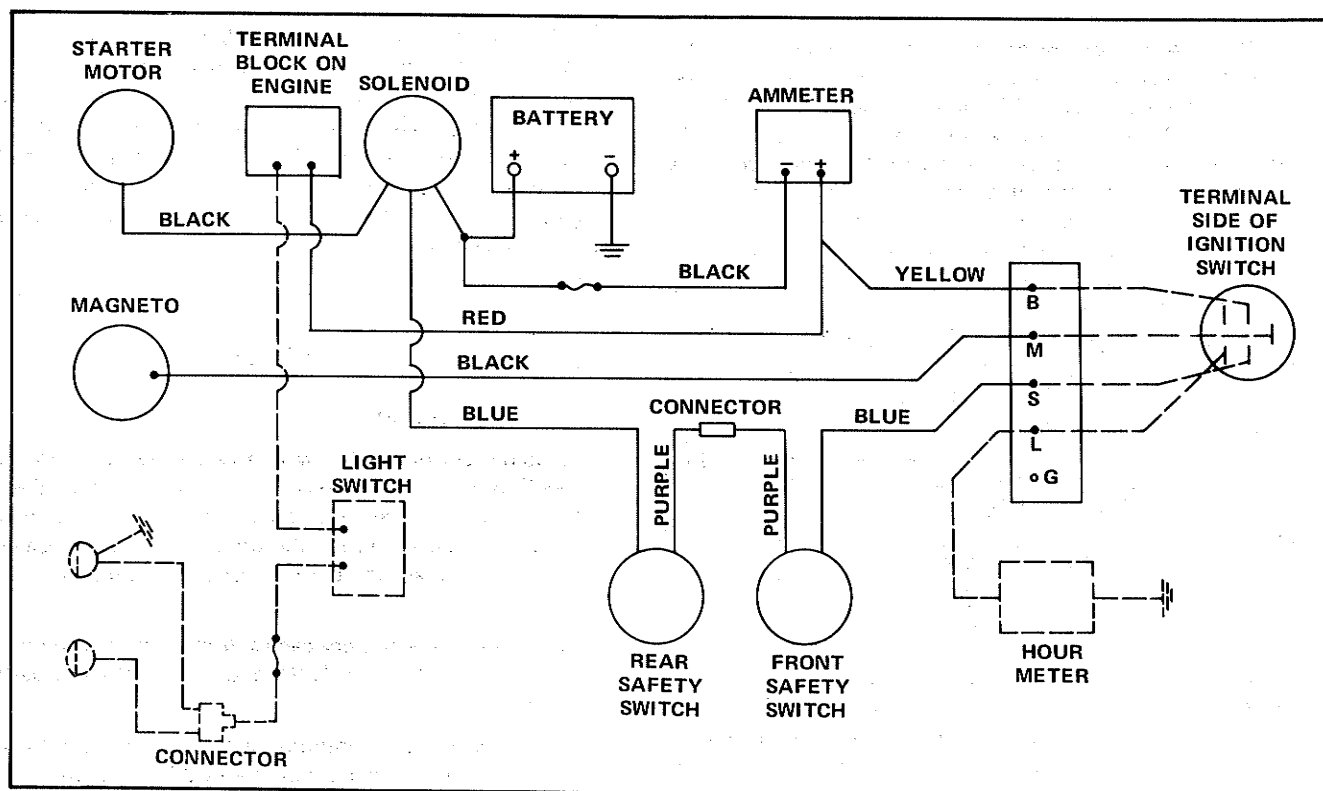

taken to insure the tractor will be ready to go when you need it.

1. Drain the fuel tank completely by running the tractor until it stops. This may be easily done by removing the gas line at the carburetor and draining the tank thru this hose. If you desire, fuel may be stored in the tank or a small container if a good brand of gasoline stabilizer is used. This additive, available from your dealer, prevents formation of gum and varnish for up to one year, providing easier starting and a clean fuel system.

2. Drain and refill the crankcase when the engine is warm. See "Maintenance".

3. Remove spark plug, pour one ounce of 10W-30 oil into cylinder through plug hole. Crank engine a few times to distribute oil and reinstall the plug.

4. Clean dirt and chaff from cylinder head fins and engine housing.

5. Grease all zerks and apply oil to all points shown in "Maintenance".

6. Block the machine up off the wheels to relieve weight and keep tires off a damp floor. Protect the tires from prolonged exposure to direct sunlight.

7. Store the machine in a dry place indoors.

STARTING AFTER STORAGE

1. Remove the spark plug and wipe dry. Crank the engine a few times to blow the excess oil out of the plug hole. Reinstall the plug.

2. Fill the fuel tank with fresh "regular" gasoline (unless a fuel stabilizer has been used).

3. Service the air cleaner. See "Maintenance".

4. Check the crankcase oil level and replenish if necessary. See "Maintenance".

5. Start the engine outdoors or in a well ventilated area. *Do not* run the engine at high speed immediately after starting.

6. Inflate the front tires to 12-15 P.S.I., and rear to 6-8 P.S.I.

SPECIFICATIONS

ENGINE	MAKE: BRIGGS AND STRATTON	MODEL NO: 190707 HORSEPOWER: 8 CYCLES: 4 CYLINDERS: 1	BORE: 3 Inches STROKE: 2-3/4 Inches DISPLACEMENT: 19.44 Cu. In. CRANKSHAFT: Vertical
	ELECTRICAL SYSTEM	Dual Circuit Alternator with Gear Driven Starter Motor	
		12 Volt - 32 Amp. Hr. Automotive Battery	
		Key Ignition Switch	
		Ammeter on Instrument Panel	
	IGNITION	TYPE: Flywheel Magneto w/Key switch Dust Proof Breaker Enclosure	
	GOVERNOR	TYPE: Adjustable, Mechanical, Running in Oil RANGE: 1450 to 3600 R.P.M.	
	AIR CLEANER	Sealed Joint Housing, Oiled Foam Element ELEMENT: Reusable Polyurethane Foam	
	CRANKCASE	BREATHER: Ventilated through Carburetor	
		LUBRICATION: Gear Impeller System	
		OIL CAPACITY: 2-1/4 Pints	
	EXHAUST VALVE AND SEAT	Austenitic Steel with Sintered Alloy Inserts	
	FUEL TANK	MATERIAL: Epoxy Resin Sealed, Terne Coated Steel	
		Fuel Level Gage Built into Filler Cap	
		CAPACITY: 3-1/2 quarts	
TRANSMISSION	MUFFLER	Quiet, Compact, Low Back Pressure	
	TYPE	All Spur Gear, Running in Oil Bath	
	MATERIAL	GEARS: Carburized and Hardened	
		SHAFTS: Hardened and Ground	
		BEARINGS: Needle Type Roller	
	LUBRICATION	SAE 90 OIL CAPACITY: 1 Quart	
	SPEEDS	Three Forward, One Reverse	
	SPEED RANGE	LOW: 1.06 M.P.H.	
		SECOND: 2.79 M.P.H.	
		HIGH: 4.18 M.P.H.	
		REVERSE: 4.18 M.P.H.	
	DIFFERENTIAL	All Gear, Controlled Traction Type	
CHASSIS	FRAME	Inverted Channel, Electrically Welded, Heavy Gage Steel	
		POWER TAKE-OFF POINTS: Front and Rear	
		ENGINE MOUNTING: Above Front Axle	
		PIVOT POINT LOCATION: At Center of Frame	
	REAR WHEELS	PNEUMATIC INFLATION PRESSURE: 6 to 8 P.S.I.	
		TIRE SIZE: 18 x 9.50 - 8LP Terra-Tread (Tubeless)	
	FRONT WHEELS	PNEUMATIC INFLATION PRESSURE: 12 to 15 P.S.I.	
		TIRE SIZE: 5.30/4.50 - 6	
		BEARINGS: Sintered Iron with Grease Fittings	

CHASSIS (Cont'd.)	SEAT	TYPE: Bucket, Rubber Mounted		
		COVER: Black Naugahyde		
		POSITIONS: 3		
	TURNING RADIUS	INSIDE REAR TIRE: 22 Inches		
	STABILITY	UPHILL AND SIDEHILL SLOPE: 40% (With Weights)		
ACCESSIBILITY	Hood Tips Forward for Accessibility			
CONTROLS	STEERING	Three Quarter Circle Steering Wheel		
		SYSTEM: 3.3-to-1 Ratio, Gear and Sector		
	CLUTCH AND BRAKE PEDAL	LOCATION: Right Front		
		CLUTCH: Soft Action, Touch-O-Matic V-Belt		
		BRAKE: External Band Type		
		Parking Brake Lock Standard Equipment		
	LOCATION	IMPLEMENT LIFT LEVER: Right Side		
		POWER TAKE-OFF CLUTCH LEVER: Left Side		
		GEAR SELECTOR: Front Center of Seat		
		Ignition Key Switch	On Instrument Panel	
		Light Switch (Optional)		
		Throttle Lever Choke Lever		Combined
		Ammeter		
		PARKING BRAKE LOCK: Lower Left of Seat		
DIMENSIONS	OVERALL LENGTH	59 Inches		
	OVERALL WIDTH	31.5 Inches		
	HEIGHT	TO TOP OF STEERING WHEEL: 33-9/16 Inches		
		TO TOP OF ENGINE COVER: 30-1/2 Inches		
	WHEEL BASE	42.65 Inches		
SHIPPING WEIGHT	336 Pounds Less Mower — 423 Pounds with Mower			

SPECIFICATIONS SUBJECT TO CHANGE WITHOUT NOTICE

ACCESSORIES

ENGINE WINTERIZING KIT
SNOW TIRE AND WHEEL SET
SNOW CAB
FRONT LIGHT KIT
HUBCAP, ALL WHEELS
WHEEL WEIGHTS
FRONT WEIGHT
REAR WEIGHT
AUXILIARY WEIGHT
TIRE CHAINS FOR 18 x 9.50 - 8
TIRE CHAINS FOR 18 x 5.70/5.00 - 8

FRAME, HOOD AND DASH

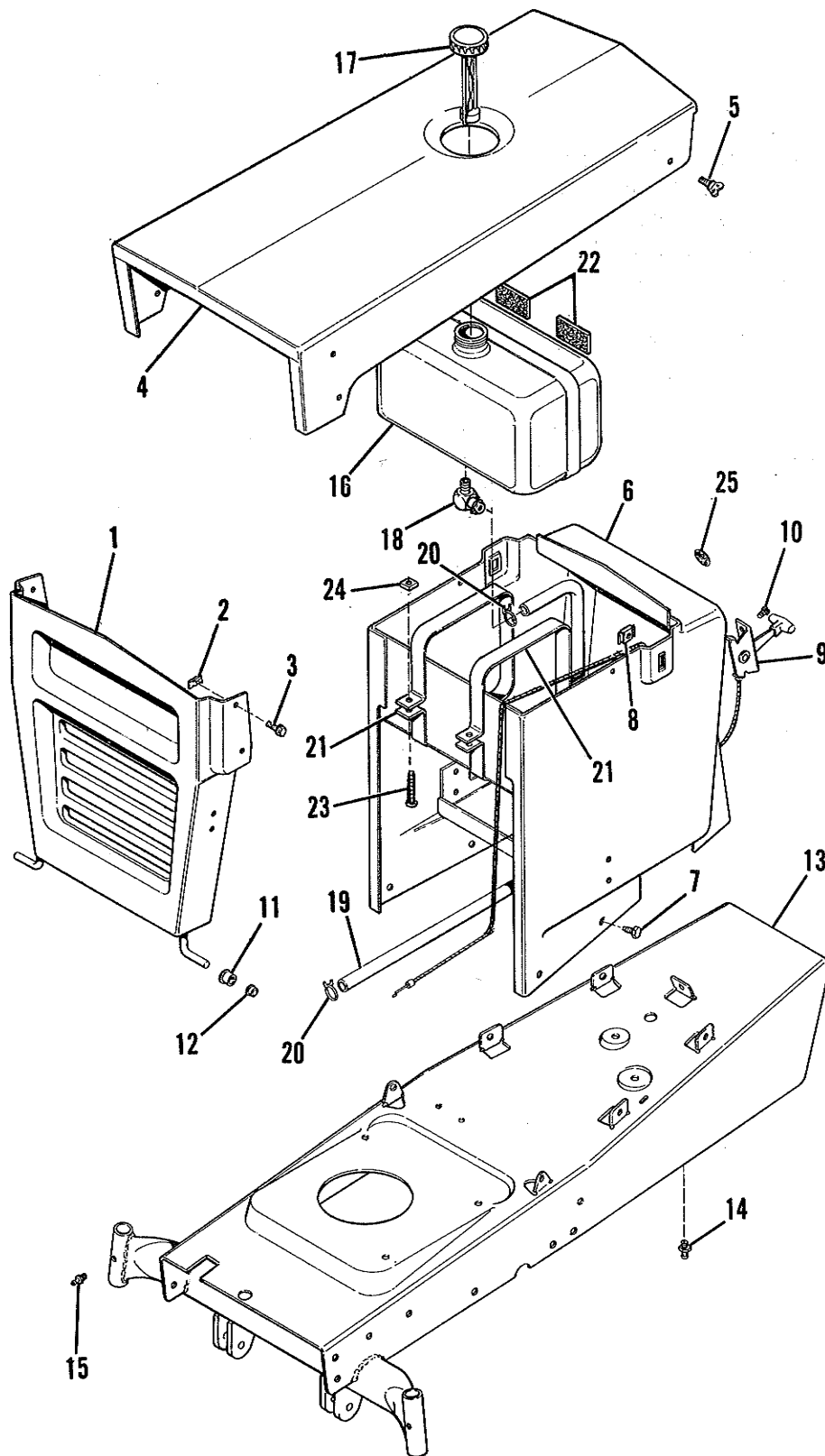

FRAME, HOOD AND DASH

Ref. No.	Part No.	Qty.	Description
1	1650800	1	GRILL ASSEMBLY
2	928705	4	J-NUT
3	930594	4	SCREW, Flange, 1/4"-20 x 3/4" lg.
4	1650756	1	HOOD
5	928693	2	SCREW, Thumb
6	1650819	1	DASH ASSEMBLY
7	927428	7	SCREW, Taptite, 1/4"-20 x 3/8" lg.
8	930659	2	NUT, Retainer
9	1650999	1	CONTROL
10	927428	2	SCREW, Taptite, 1/4"-20 3/8" lg.
11	118273	2	BUSHING
12	1650758	2	FASTENER, Pushnut
13	1650581	1	FRAME ASSEMBLY
14	921133	1	FITTING, Grease
15	914687	2	FITTING, Grease
16	156174	1	TANK, Fuel
17	156175	1	CAP, Fuel Tank
18	174640	1	ELBOW, 90°
19	156177	1	HOSE, Fuel
20	154372	2	CLAMP, Hose
21	156178	2	STRAP, Tank
22	106582	3	GASKET, Felt
23	930534	2	SCREW, Machine, 1/4"-20 x 1-1/2" lg.
24	930633	2	NUT, Square, 1/4-20
25	156319	1	BUTTON, Plug.

POWER TAKE OFF

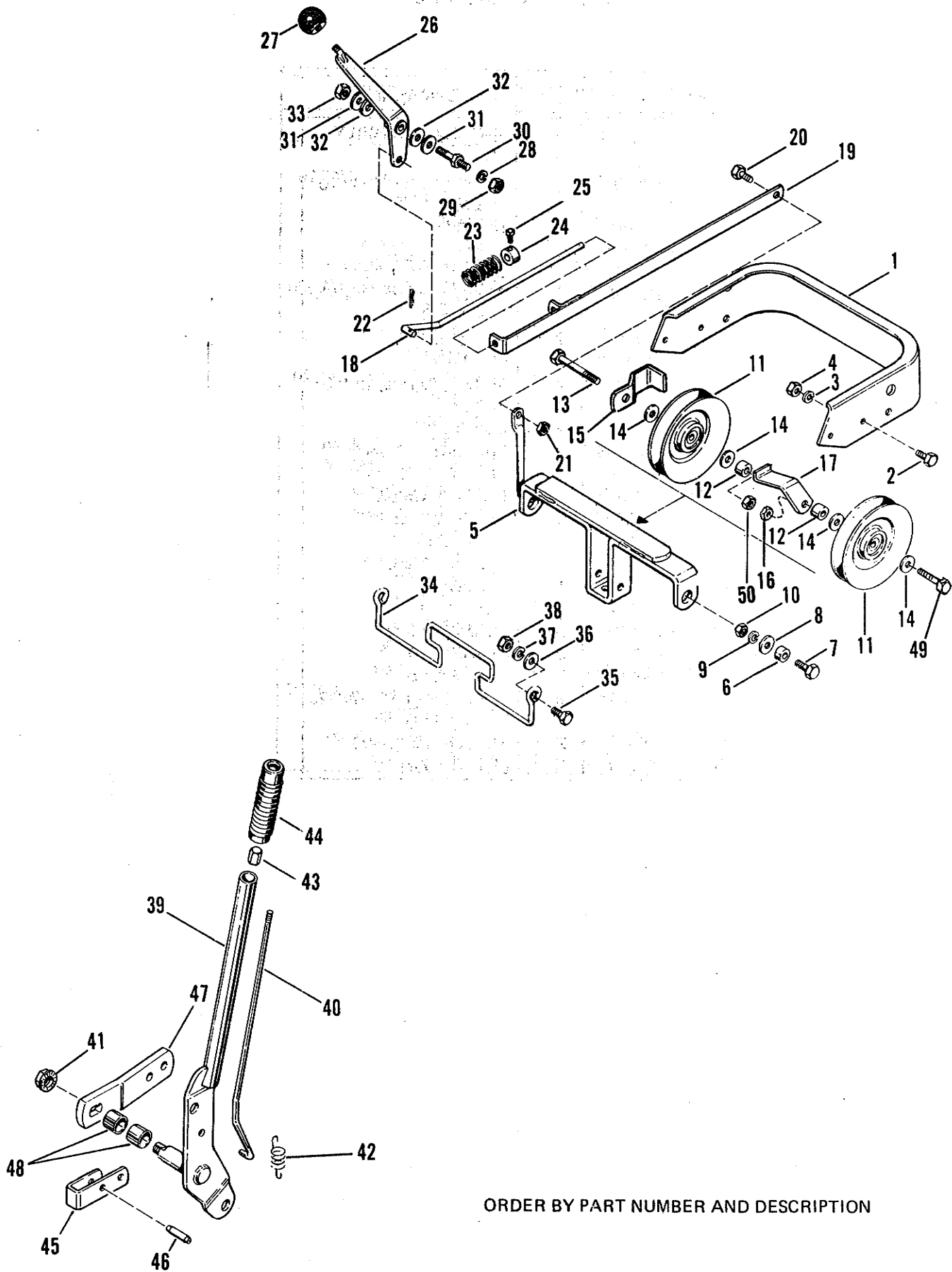

ORDER BY PART NUMBER AND DESCRIPTION

POWER TAKE OFF LIFT LEVER

Ref. No.	Part No.	Qty.	Description
1	1650755	1	BUMPER, Front
2	917397	4	CAPSCREW, Hex, 5/16"-18 x 3/4" lg.
3	917356	4	LOCKWASHER, 5/16"
4	917372	4	NUT, Hex, Full, 5/16"-18
5	177569	1	CLEVIS ASSEMBLY, Pulley
6	154177	2	SPACER
7	907731	2	CAPSCREW, Hex, 3/8"-16 x 1" lg.
8	917378	2	WASHER, Plain, 3/8"
9	916965	2	LOCKWASHER, 3/8"
10	916950	2	NUT, Hex, Full, 3/8"-16
11	101096	2	PULLEY
12	154177	2	SPACER
13	922606	2	CAPSCREW, 3/8-24 x 1-3/4" lg.
14	917642	4	WASHER, Plain, 3/8"
15	162115	2	STOP, Belt
16	923428	2	NUT, Hex, Full, Lock, 3/8"-16
17	1651329	1	STOP
18	176354	1	ROD, Clutch, P.T.O.
19	106399	1	GUIDE ASSEMBLY, Idler
20	908127	1	CAPSCREW, Hex, 3/8"- 16 x 3/4" lg.
21	923428	1	NUT, Hex, Full, Lock, 3/8"-16
22	722016	1	PIN, Cotter, 3/32" x 5/8" lg.
23	163103	1	SPRING
24	8191022	1	COLLAR, Set

Ref. No.	Part No.	Qty.	Description
25	928804	3	SCREW, Set, 1/4"-20 x 3/8" lg.
26	170103	1	LEVER ASSEMBLY
27	8021050	1	BALL, Knob
28	917356	1	LOCKWASHER, 5/16"
29	917372	1	NUT, Hex, Full, 5/16-18
30	170108	1	STUD
31	917642	2	WASHER, Plain, 5/16"
32	159134	2	WASHER, Special
33	923362	1	NUT, Hex, Full, Lock, 5/16"-18
34	165043	1	STOP, Belt, P.T.O.
35	917397	2	CAPSCREW, Hex, 5/16"- 18 x 3/4" lg.
36	917642	2	WASHER, Plain, 5/16"
37	917356	2	LOCKWASHER, 5/16"
38	917372	2	NUT, Hex, Full, 5/16"-18
39	1650151	1	LEVER ASSEMBLY, Lift
40	1650147	1	ROD, Latch
41	930644	1	NUT, Flange, Lock 1/2"-13
42	1650155	1	SPRING
43	1650157	1	BUTTON, Thumb
44	1651702	1	GRIP, Lift Lever
45	154224	1	LATCH, Lift Lever
46	918113	1	PIN, Roll, 3/8" x 1" lg.
47	176464	1	LINK, Lift Lever
48	154289	2	BUSHING
49	927322	1	CAPSCREW, Hex, 3/8-24 x 2" Lg.
50	930628	1	NUT, Hex, Full, Lock, 3/8- 24

FRONT WHEELS AND STEERING

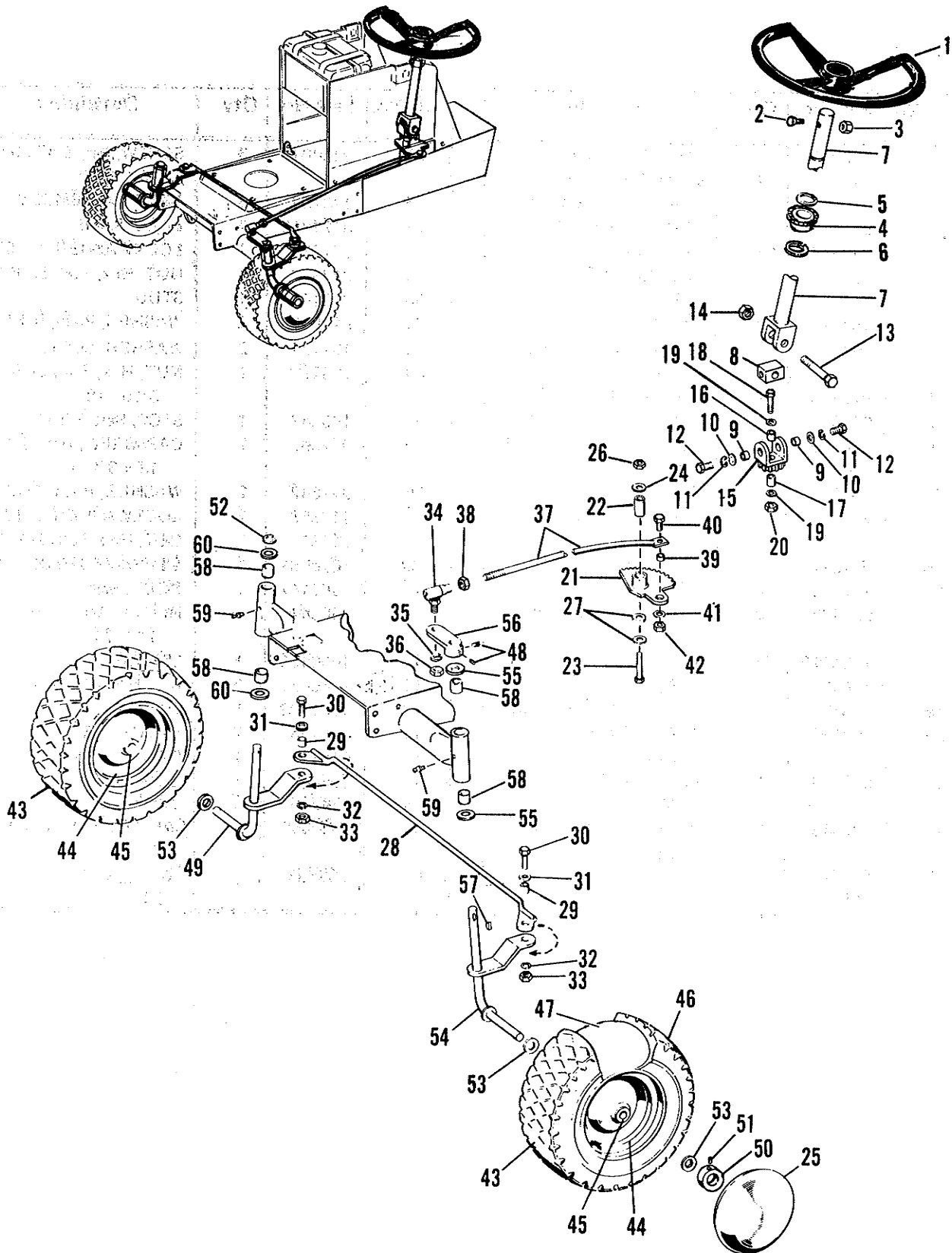

ORDER BY PART NUMBER AND DESCRIPTION

FRONT WHEELS AND STEERING

Ref. No.	Part No.	Qty.	Description	Ref. No.	Part No.	Qty.	Description
1	163113	1	WHEEL ASSEMBLY, Steering	27	8161199	2	WASHER, Special
2	907729	1	CAPSCREW, Hex, 5/16"-18 x 1-1/4" lg.	28	1651326	1	LINK ASSEMBLY, Drag
3	923362	1	NUT, Hex, Full, Lock 5/16"-18	29	154177	2	SPACER
4	157077	1	BUSHING, Steering	30	162053	2	SCREW, Special
5	158223	2	WASHER, (As Required)	31	917378	2	WASHER, Plain, 3/8"
6	157241	1	RING, Snap	32	916965	2	LOCKWASHER, 3/8"
7	1650823	1	SHAFT ASSEMBLY, Steering	33	916950	2	NUT, Hex, Full, 3/8"-16
8	154153	1	PIN, Universal Joint	34	154301	1	JOINT, Ball
9	153081	2	SPACER	35	916966	1	LOCKWASHER, 1/2"
10	917378	2	WASHER, Plain, 3/8"	36	919423	1	NUT, Hex, Full, 1/2"-20
11	916965	2	LOCKWASHER, 3/8"	37	1650589	1	ROD, Tie
12	922126	2	CAPSCREW, Hex, 3/8"-16 x 3/4" lg.	38	919262	1	NUT, Hex, Jam, 1/2-20
13	930570	1	CAPSCREW, Hex, 5/16-18 x 1-1/2" lg.	39	121349	1	SPACER
14	923362	1	NUT, Hex, Full, Lock 5/16"-18	40	907731	1	CAPSCREW, Hex, 3/8"-16 x 1" lg.
15	156027	1	FORK & PINION ASSEMBLY	41	917378	1	WASHER, Plain, 3/8"
16	156064	1	BUSHING	42	923428	1	NUT, Hex, Full, Lock, 3/8"-16
17	8161218	1	SPACER	43	156212	2	WHEEL & TIRE ASSEMBLY
18	923470	1	CAPSCREW, Hex, 3/8"-16 x 1-1/2" lg.	44	156180	2	WHEEL
19	156065	2	WASHER	45	156316	2	BEARING
20	928731	1	NUT, Hex, Lock, Jam, 3/8"-16	46	156213	2	TIRE
21	156066	1	GEAR ASSEMBLY, Steering	47	156214	2	TUBE
22	8061058	1	SPACER	48	928721	2	SCREW, Set, 5/16"-18 x 1/2" lg.
23	921972	1	CAPSCREW, Hex, 3/8"-16 x 2-1/2" lg.	49	165051	1	SPINDLE ASSEMBLY, R.H.
24	917378	1	WASHER, Plain, 3/8"	50	8021010	2	COLLAR, Set
25	156210	2	CAP, Hub, Front (For Service Only)	51	928691	2	SCREW, Set, 5/16"-18 - 5/16" lg.
26	923428	1	NUT, Hex, Full, Lock, 3/8"-16	52	157286	1	RING, Retaining
				53	108181	4	WASHER
				54	165053	1	SPINDLE ASSEMBLY, L.H.
				55	108181	2	WASHER
				56	156007	1	LEVER ASSEMBLY, Steering
				57	930670	2	KEY
				58	154289	4	BUSHING
				59	727001	2	FITTING, Grease
				60	108181	2	WASHER

ENGINE, PULLEY, BRAKE AND CLUTCH

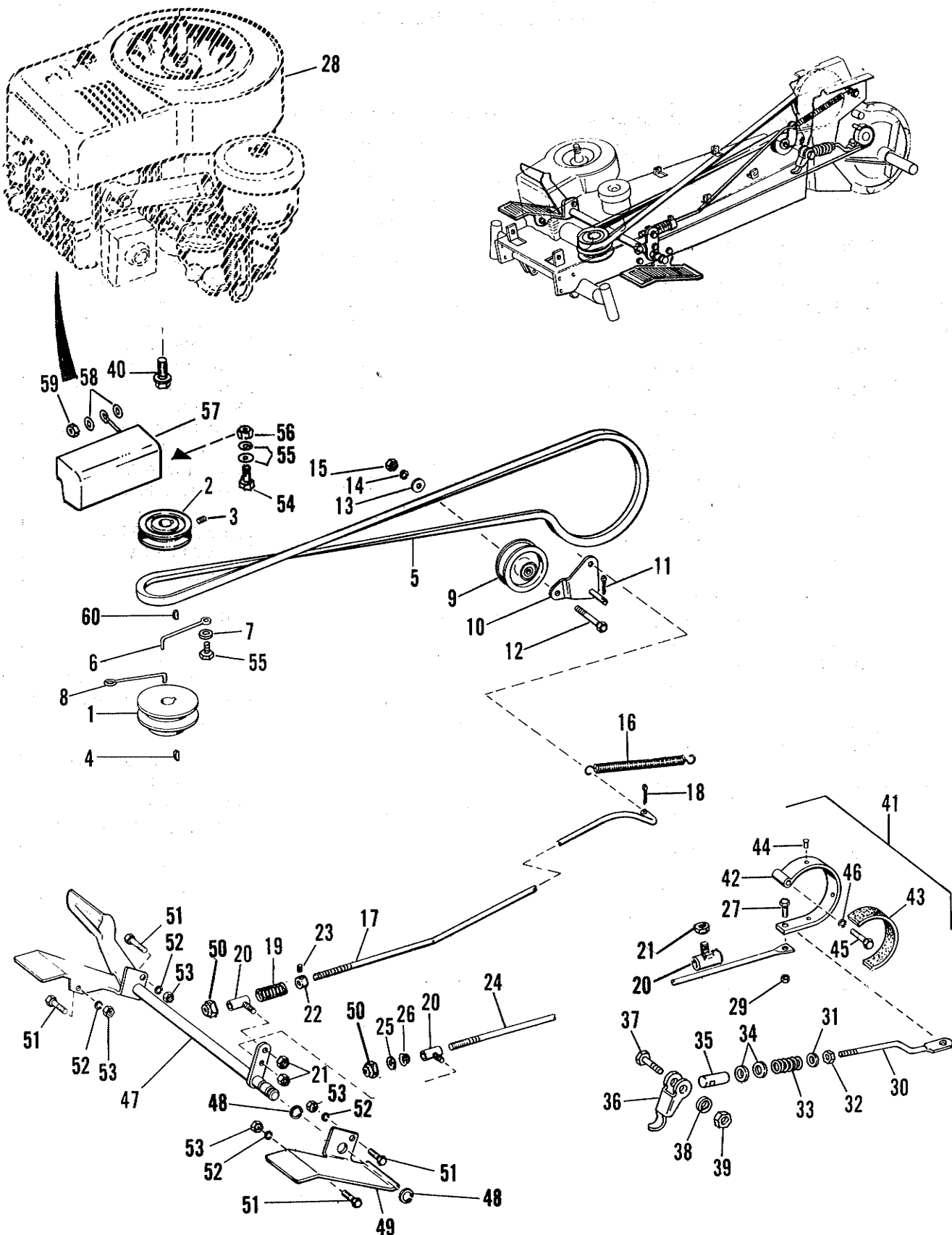

ORDER BY PART NUMBER AND DESCRIPTION

ENGINE, PULLEY, BRAKE AND CLUTCH

Ref. No.	Part No.	Qty.	Description
1	156111	1	PULLEY, Engine, Large
2	1651566	1	PULLEY
3	928691	1	SCREW, Set, 5/16"-18 x 5/16" lg.
4	154096	1	KEY
5	165048	1	BELT, "V" Drive
6	165044	1	STOP, Belt
7	917378	1	WASHER, Plain
8	170786	1	STOP, Belt
9	106716	1	PULLEY, Idler
10	162021	1	BRACKET ASSEMBLY, Pulley
11	918451	1	PIN, Cotter, 1/8" x 3/4" lg.
12	917400	1	CAPSCREW, Hex, 3/8"-16 x 1-1/4" lg.
13	917642	2	WASHER, Plain, 5/16"
14	916965	1	LOCKWASHER, 3/8"
15	916950	1	NUT, Hex, Full, 3/8"-16
16	165068	1	SPRING, Return
17	1650865	1	ROD, Clutch
18	918451	1	PIN, Cotter, 1/8" x 3/4" lg.
19	157041	1	SPRING, Compression
20	156303	3	GUIDE ASSEMBLY, Guide
21	923362	3	NUT, Hex, Full, Lock, 5/16"-18
22	8191022	3	COLLAR, Set
23	928804	3	SCREW, Set, 1/4"-20 x 3/8" lg.
24	1650864	1	ROD, Brake
25	917378	1	WASHER, Plain 3/8" lg.
26	157127	1	SPRING, Conical
27	927340	1	CAPSCREW, Hex, 1/4"-20 x 3/4" lg.
28		1	ENGINE, 8 H. P.
29	923329	1	NUT, Hex, Full, Lock, 1/4"-20
30	174636	1	ROD, Parking Brake

Ref. No.	Part No.	Qty.	Description
31	917377	1	WASHER, Plain, 1/4"
32	917372	1	NUT, Hex, Full, 5/16"-18
33	174482	1	SPRING
34	918431	2	WASHER, Plain, 1/2"
35	171994	1	ROD, End
36	172108	1	LEVER, Parking Brake
37	928745	1	CAPSCREW, Hex, 1/4"-20 x 1-1/4" lg.
38	721702	1	LOCKWASHER, Double, 1/4"
39	923329	1	NUT, Hex, Full, Lock, 1/4"-20
40	928635	3	CAPSCREW, Hex, Special, 3/8"-16 x 1-1/4" lg.
41	156134	1	BAND ASSEMBLY, Brake
42	156135	1	BAND, Brake
43	156136	1	LINING, Brake
44	928810	3	RIVET, # 7 x 1/4" lg.
45	919360	1	CAPSCREW, Hex, 3/8"-16 x 1-1/2" lg.
46	720002	1	LOCKWASHER, 3/8"
47	1650452	1	SHAFT ASSEMBLY, Clutch
48	1602155	2	RING "E"
49	1650447	1	FOOT REST, L. H.
50	924433	2	NUT, Elastic, Stop, 5/16-18
51	908127	4	CAPSCREW, Hex, 3/8"-16 x 3/4" lg.
52	720002	4	LOCKWASHER, 3/8"
53	717003	4	NUT, Hex, Full, 3/8"-16
54	705023	1	CAPSCREW, Hex, 5/16-18 x 3/4" lg.
55	719006	2	WASHER, Plain, 1/4"
56	717508	1	NUT, Hex, Full, Lock, 5/16"-18
57	176896	1	GUARD ASSEMBLY
58	719006	2	WASHER, Plain, 1/4"
59	717508	1	NUT, Hex, Full, Lock, 5/16"-18
60	157120	1	KEY, Drive

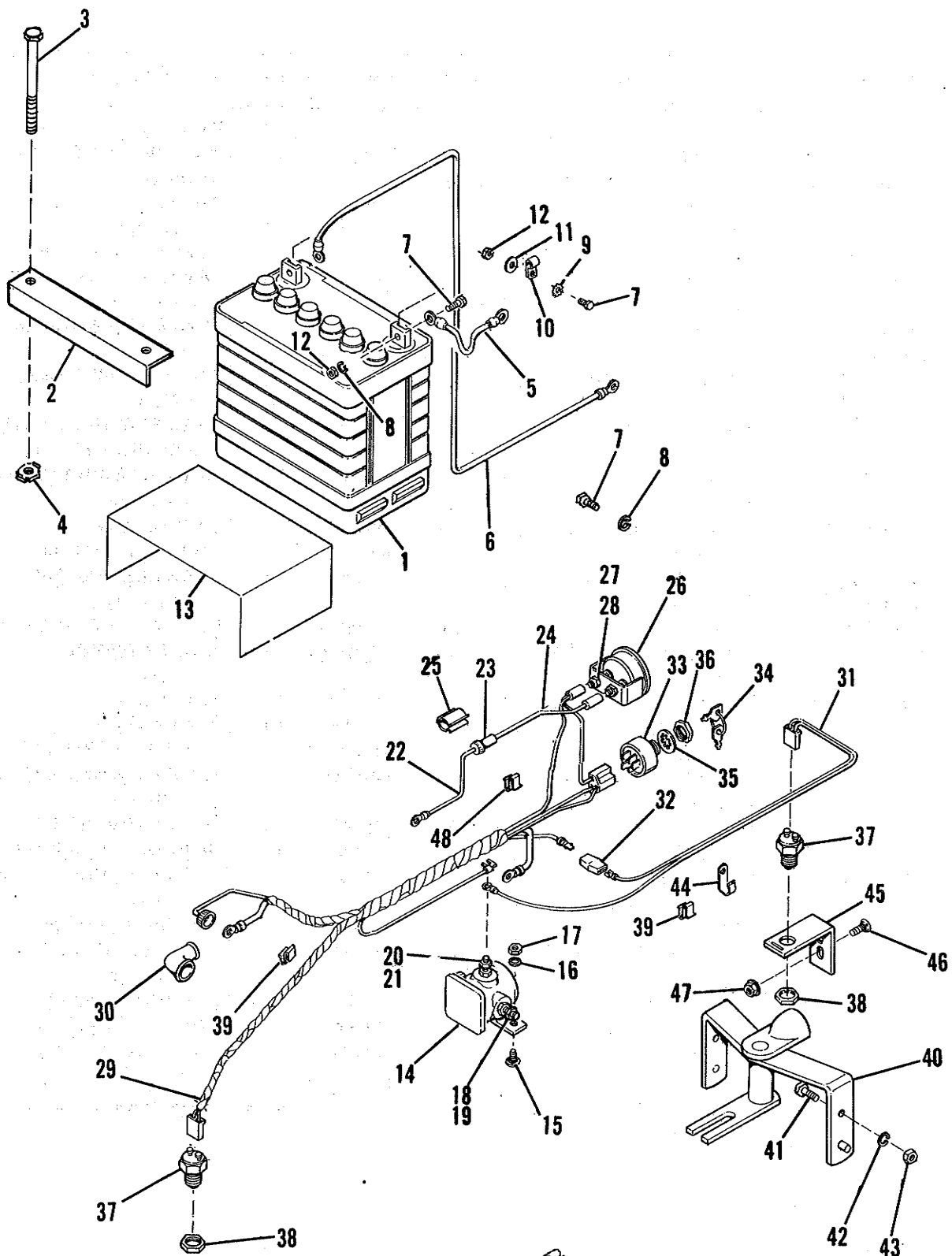

172434 CLIP, Cable

ELECTRICAL SYSTEM

Ref. No.	Part No.	Qty.	Description
1	170059	1	BATTERY
2	170123	1	HOLD DOWN, Battery
3	928634	2	CAPSCREW, Hex, 1/4" 1/4"-20 x 7" lg.
4	926022	2	NUT, Retainer, 1/4"-20
5	122213	1	CABLE
6	1603195	1	CABLE
7	916019	3	CAPSCREW, Hex, 1/4" -20 x 3/4" lg.
8	916964	3	LOCKWASHER, 1/4"
9	909367	1	LOCKWASHER, 1/4"
10	158476	1	CLAMP
11	917377	1	WASHER, Plain, 1/4"
12	916622	3	NUT, Hex, Full, 1/4"-20
13	122143	1	INSULATION, Battery
14	122216	1	SOLENOID
15	923333	2	BOLT, Carriage
16	916964	2	LOCKWASHER, 1/4"
17	916622	2	NUT, Hex, Full, 1/4"-20
18	917356	2	LOCKWASHER, 5/16"
19	917372	2	NUT, Hex, Full, 5/16"-18
20	922711	1	LOCKWASHER, Shakeproof, # 10
21	917415	1	NUT, Hex, Full, # 10-32
22	122207	1	WIRE, Solenoid To Neg.
23	172410	1	FUSE, 7-1/2 AMP.
24	1651826	1	WIRE, Neg. AMP. To Solenoid
25	122183	1	CLIP, Fuse
26	1603189	1	AMMETER
27	922711	2	LOCKWASHER, Shakeproof # 10
28	917415	2	NUT, Hex, Full, # 10-32
29	1651085	1	HARNESS ASSEMBLY
30	122023	2	COVER, Terminal
31	122217	1	WIRE, Safety Switch
32	172100	1	CONNECTOR, Insulator
33	178280	1	SWITCH, Ignition
34	122203	1	KEY & RING ASSEMBLY
35	918906	1	LOCKWASHER, 5/8" INT.
36	122234	1	NUT, Special
37	177522	2	SWITCH, Safety
38	930647	2	NUT, Pal, 9/16-18
39	165073	2	CLIP, Speed
40	170172	1	PIVOT ASSEMBLY
41	917397	2	CAPSCREW, 5/16"-18 x x 3/4" lg.
42	917356	2	LOCKWASHER, 5/16"
43	917372	2	NUT, Hex, Full, 5/16"-18
44	1606820	1	"J" CUP, Open
45	178428	1	BRACKET
46	930517	2	BOLT, Carriage, 1/4-20 x 3/4" lg.
47	930641	2	NUT, Flange, 1/4"-20
48	172434	1	CLIP, Cable

TRANSMISSION

CAUTION! Do not loosen under any circumstance unless dis-assembling transmission completely!

NOTE: Tighten this Bolt and Nut just enough to allow proper pivoting of the two parts.

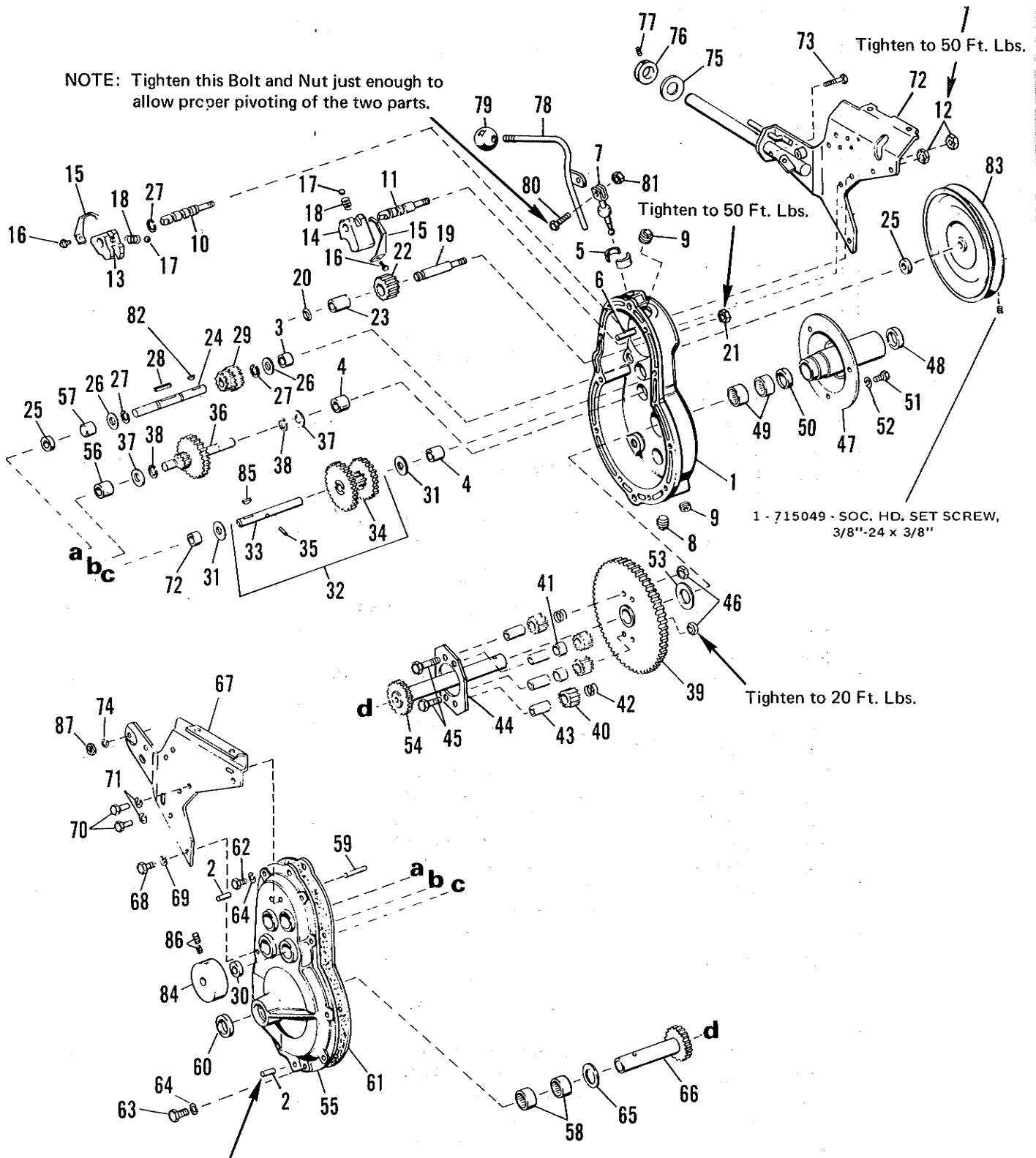

Ref. No.	Part No.	Qty.	Description
1	165003	1	GEAR CASE w/Bearing - Pins - Bushings (Includes 2,3,4,5,6 & 7)
2	918113	2	PIN, Roll
3	156072	1	BEARING, Roller
4	156073	2	BEARING, Roller
5	101042	2	BUSHING, Ball Half
6	156308	1	ROLL PIN ASSEMBLY
7	156031	1	ROD ASSEMBLY, Shift
8	901653	1	PLUG, Pipe
9	930676	2	PLUG, Pipe
10	171365	1	SHAFT, Shift, Rev.-Lo
11	171372	1	SHAFT, Shift, Hi-Lo
12	918213	2	NUT, Hex, Full, 7/16"-14
13	171363	1	FORK, Shift, Rev.
14	171364	1	FORK, Shift, Hi-Lo
15	171342	2	SPRING
16	930614	2	CAPSCREW, Hex, 5/16"-18 x 5/16" lg.
17	154262	2	BALL, Shift, Lock
18	171456	2	SPRING
19	165005	1	SHAFT, Rev., Pinion
20	165006	1	"O" RING
21	918213	1	NUT, Hex Full, 7/16"-14
22	165007	1	PINION, Rev.
23	156082	1	BEARING, Roller
24	170455	1	SHAFT, Pulley, P.T.O.
25	156084	2	SEAL, Oil
26	156085	2	WASHER
27	8061048	2	RING, Retaining
28	170453	1	KEY
29	156087	1	PINION ASSEMBLY, Hi-Lo
30	156084	1	SEAL, Oil
31	156089	2	WASHER
32	165009	1	SHAFT & GEAR ASSEMBLY
33	165010	1	SHAFT, Brake
34	165011	1	GEAR ASSEMBLY, Cluster
35	156292	1	PIN, Dowel
36	165013	1	GEAR & SHAFT ASSEMBLY
37	156085	2	WASHER
38	8061048	2	RING, Retaining
39	156094	1	GEAR ASSEMBLY, Drive
40	158579	4	PINION, Diff.
41	121084	2	SPACER, Diff.
42	162085	2	SPRING, Diff.
43	121083	4	SPINDLE, Pinion, Diff.
44	156002	1	PLATE, Diff.
45	921972	4	CAPSCREW, Hex, 3/8"-16 x 2-1/2" lg.
46	923428	4	NUT, Hex, Full, Lock, 3/8"-16

Ref. No.	Part No.	Qty.	Description
47	156096	1	HOUSING ASSEMBLY, Axle
48	118118	1	SEAL, Oil
49	105195	2	BEARING, Roller
50	156099	1	SEAL, Oil
51	919357	3	CAPSCREW, Hex,
52	916965	3	LOCKWASHER, 3/8"
53	105083	1	WASHER
54	165016	1	AXLE SHAFT ASSEMBLY R.H.
55	165018	1	GEAR CASE COVER ASSEMBLY w/Bearings & Roll Pin Assembly (Includes 56, 57, 58 & 59)
56	156073	1	BEARING, Roller
57	156072	2	BEARING, Roller
58	105195	2	BEARING, Roller
59	156308	1	ROLL PIN ASSEMBLY
60	118118	1	SEAL, Oil
61	156103	1	GASKET, Case
62	907729	8	CAPSCREW, Hex, 5/16"-18 x 1-1/4" lg.
63	921221	2	CAPSCREW, Hex 5/16"-18 x 1-1/2" lg.
64	917356	10	LOCKWASHER, 5/16"
65	105083	1	WASHER
66	165019	1	AXLE SHAFT ASSEMBLY, L.H.
67	174642	1	PLATE, Side, Trans., L.H.
68	908127	1	CAPSCREW, Hex, 3/8"-16 x 3/4" lg.
69	916965	1	LOCKWASHER, 3/8"
70	918212	2	CAPSCREW, Hex, 7/16"-14 x 1" lg.
71	918199	2	LOCKWASHER, 7/16"
72	174045	1	PLATE ASSEMBLY, Side, Trans., R.H.
73	919361	1	CAPSCREW, Hex, 3/8"-16 x 3/4" lg.
74	916965	1	LOCKWASHER, 3/8"
75	105050	1	WASHER
76	154065	1	COLLAR, Set
77	928721	2	SCREW, Set, Sq. Hd. 5/16"-18 x 1/2" lg.
78	165063	1	ROD ASSEMBLY, Shift
79	8021050	1	BALL, Knob
80	916019	1	CAPSCREW, Hex, 1/4"-20 x 3/4" lg.
81	923358	1	NUT, Hex, Full, Lock, 1/4"-20
82	930670	1	KEY
83	156119	1	PULLEY, Transmission
84	165067	1	DRUM, Brake
85	930669	1	KEY
86	928691	2	SCREW, Set, 5/16"-18 x 5/16" lg.
87	916950	1	NUT, Hex, Full, 3/8"-16

SEAT AND SEAT SUPPORT

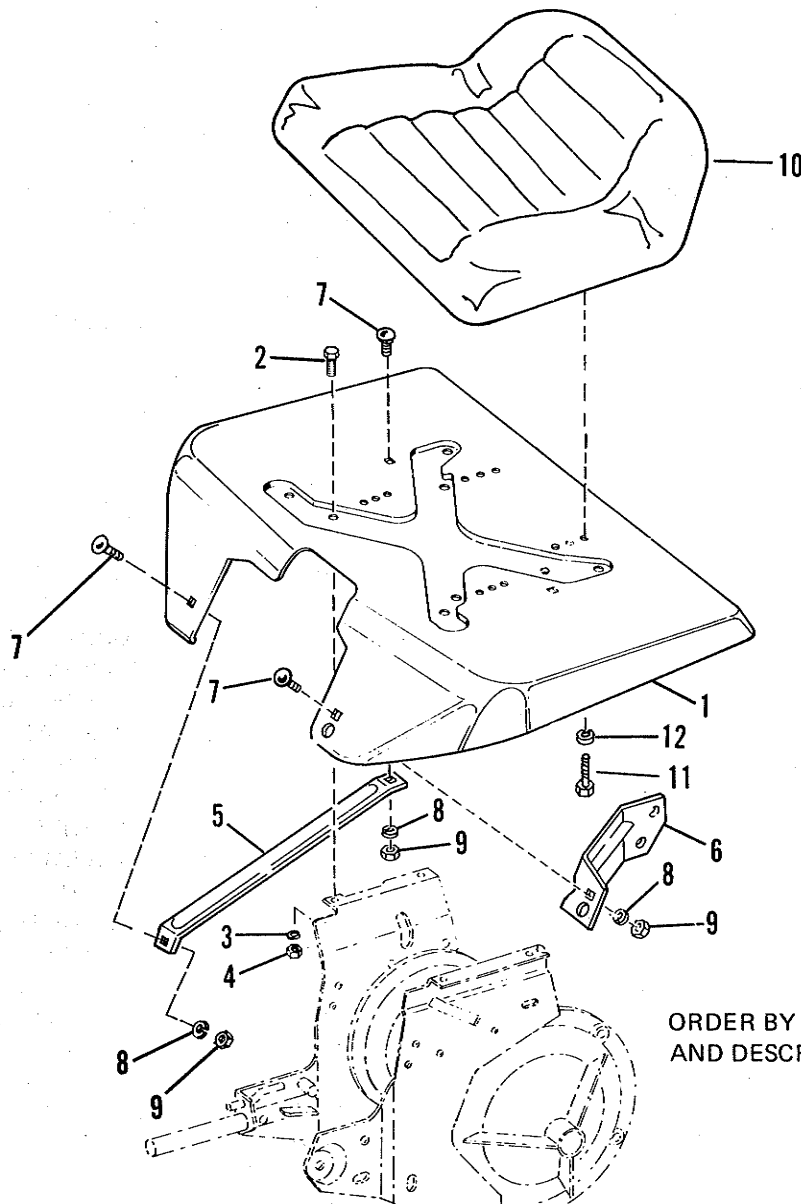

ORDER BY PART NUMBER
AND DESCRIPTION

Ref. No.	Part No.	Qty.	Description
1	174691	1	SUPPORT, Seat
2	907729	4	CAPSCREW, Hex, 5/16" -18 x 1-1/4" lg.
3	917356	4	LOCKWASHER, 5/16"
4	917372	4	NUT, Hex, Full, 5/16-18
5	165070	1	BRACE, Seat Support
6	1651308	1	BRACKET
7	923700	3	BOLT, Carriage, 5/16"-18 x 1/2" lg.
8	917356	3	LOCKWASHER, 5/16"
9	917372	3	NUT, Hex, Full, 5/16"-18
10	176495	1	SEAT ASSEMBLY
11	917397	4	CAPSCREW, Hex, 5/16" -18 x 3/4" lg.
12	917356	4	LOCKWASHER, 5/16"

REAR WHEELS AND HITCH

Also Ref. Nos. 63864
of Transmission Pg. 26-27

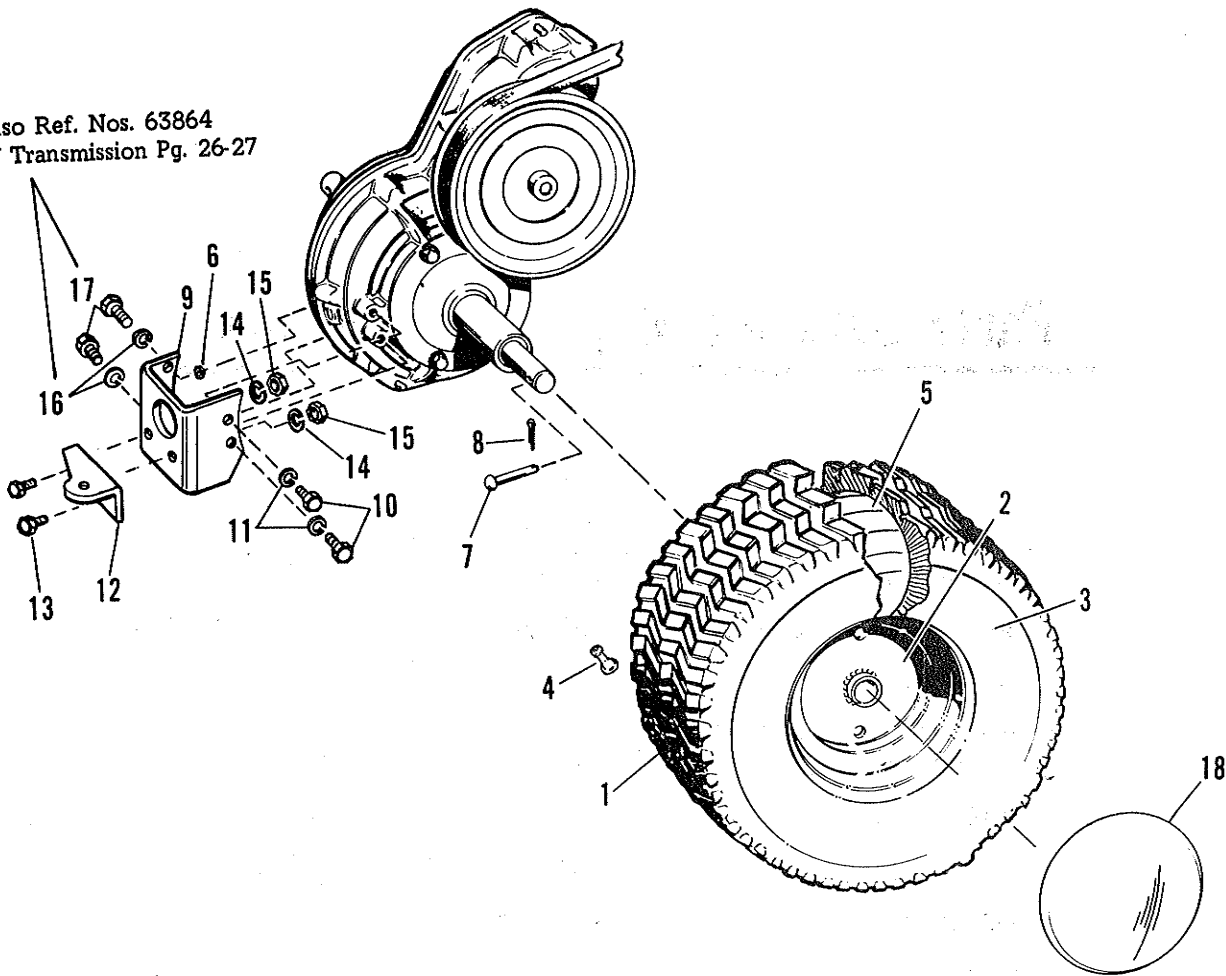

Ref. No.	Part No.	Qty.	Description
1	170026	2	WHEEL & TIRE ASSEMBLY
2	170033	2	WHEEL ASSEMBLY
3	156312	2	TIRE
4	156305	2	VALUE STEM & Cap
5	156380	2	TUBE
6	917642	2	WASHER, Plain, 5/16"
7	118053	2	PIN
8	918451	2	PIN, Cotter, 1/8" x 3/4" lg.
9	156191	1	BRACKET, Draw Bar
10	921965	2	CAPSCREW, Hex, 3/8" -16 x 3/4" lg.
11	916965	2	LOCKWASHER, 3/8"
12	156192	1	CLIP, Draw Bar Hitch
13	925204	2	CAPSCREW, 3/8"-16 x 1" lg.
14	916965	2	LOCKWASHER, 3/8"
15	916950	2	NUT, Hex, Full, 3/8"-16
16	917356	2	LOCKWASHER, 5/16"
17	921221	2	CAPSCREW, 5/16"-18 x 1-1/4" lg.
18	156211	2	CAP, Hub, Rear (Optional)

Parts Lists for Major Attachments

Description	Mfg. No.	Page
36" ROTARY MOWER	1690023	31-33
30" ROTARY TILLER	1600343	34-39
32" SNOW THROWER	1690024	40-42
VACUUM COLLECTOR (Engine Driven)	1690025	43
VAC. COLL. ADAPTORS	1690028	44
	1690029	44
ROVING NOZZLE	1690031	45
DUMP CART	1600236	46
DUMP CART COVER	1690395	47

THE FOLLOWING PAGES CONTAIN ILLUSTRATED PARTS LISTS OF THE MAJOR ATTACHMENTS FOR THIS PRODUCT

Ref. No.	Part No.	Qty.	Description
1	108679	3	ARBOR TUBE ASSY.
2	108134	3	RING, Backing
3	108250	2	ARBOR ASSY.
4	108181	10	WASHER
5	108202	6	BEARING, Ball
6	108257	3	WASHER
7	108472	3	WASHER
8	108201	3	SPACER
9	108139	3	FLINGER
10	177005	3	PULLEY
11	918312	4	KEY, Woodruff, 3/16 x 5/8
12	922133	3	LOCKNUT, hex, 3/4-16
13	108369	1	DRIVE ARBOR ASSY.
14	108371	1	SPACER
15	108246	1	PULLEY, Cross drive
16	1651310	1	HOUSING
17	908127	8	CAPSCREW, hex, 3/8-16 x 3/4
18	916965	8	LOCKWASHER, 3/8
19	916950	8	NUT, Hex, 3/8-16
20	108493	1	LEVER ASSY.
21	108372	1	STUD
22	917642	2	WASHER, Plain, 5/16
23	916965	1	LOCKWASHER, 3/8
24	916950	1	NUT, Hex, 3/8-16
25	923428	1	LOCKNUT, hex, 3/8-16
26	108386	1	PULLEY, Idler
27	108497	1	SCREW, Special
28	917642	4	WASHER, Plain, 5/16
29	916965	2	LOCKWASHER, 3/8
30	916950	2	NUT, Hex, 3/8-16
31	154369	1	SPRING, Tension
32	156131	1	STUD
33	108505	1	BELT, "V"
34	1651376	1	COVER, Half housing, R.H.
35	1651375	1	COVER, half housing, L.H.
36	922123	4	SCREW, Thread cutting
37	917397	2	CAPSCREW, Hex, 5/16-18 x 3/4
38	918431	2	WASHER, Plain, 1/2
39	161080	2	STOP, Belt
40	917642	2	WASHER, Plain, 5/16
41	917356	2	LOCKWASHER, 5/16
42	108500	1	BAFFLE, Mower
43	922125	2	SCREW, Thread cutting, 1/4-20 x 7/8
44	916964	4	LOCKWASHER, 1/4
45	916622	4	NUT, hex, 1/4-20
46	108186	2	CLIP, Baffle
47	921959	2	CAPSCREW, hex, 1/4-20 x 5/8
48	917377	2	WASHER, Plain, 1/4
49	108508	1	BELT, "V"
50	108501	3	BLADE
51	922586	6	CAPSCREW, Hex, 3/8-16 x 5/8
52	916965	6	LOCKWASHER, 3/8
53	912958	3	FITTING, Grease

MFG. NO. 1690023
36" ROTARY MOWER
ARBOR & HOUSING

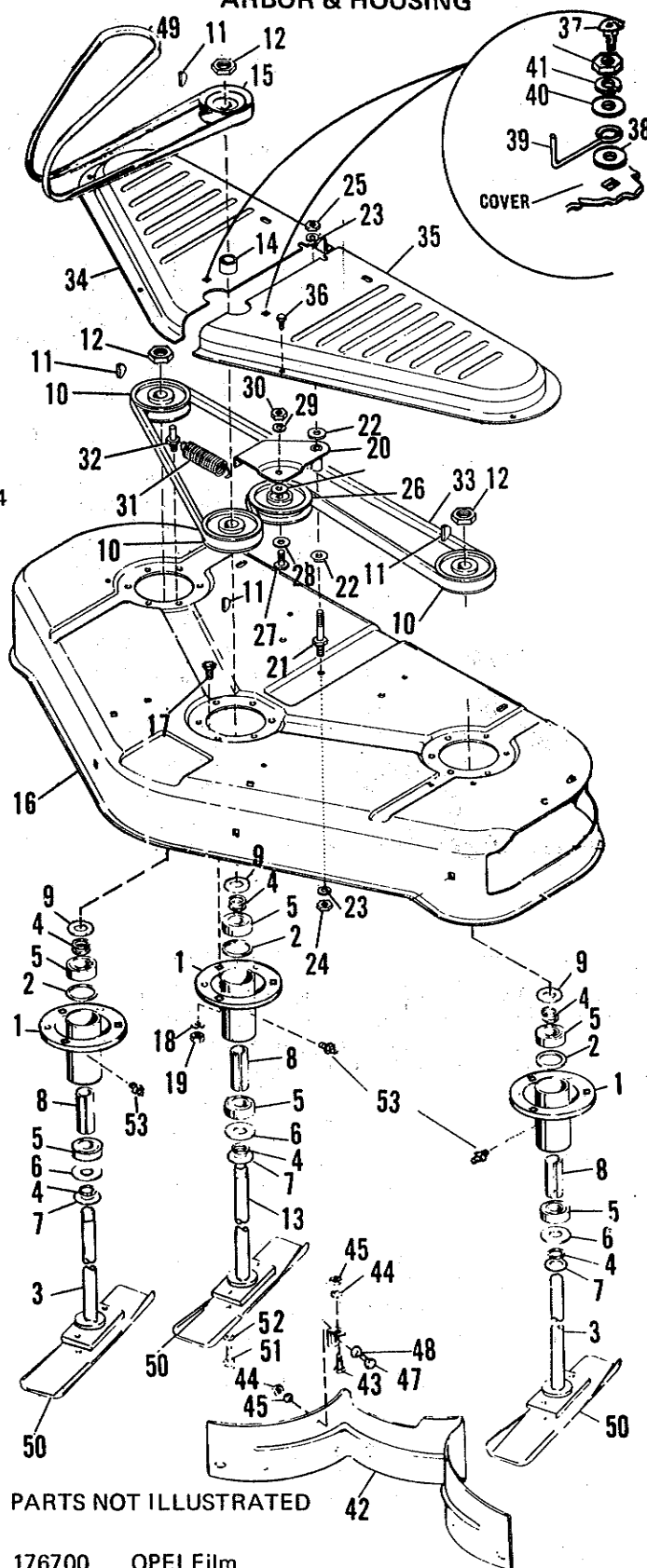

PARTS NOT ILLUSTRATED

- 176700 OPEI Film
- 176719 Decal, Danger
- 176720 Decal, Caution
- 176151 Film, Safety

**MFG. NO. 1690023
36" ROTARY MOWER
HITCH & ROLLERS**

ORDER BY PART NUMBER

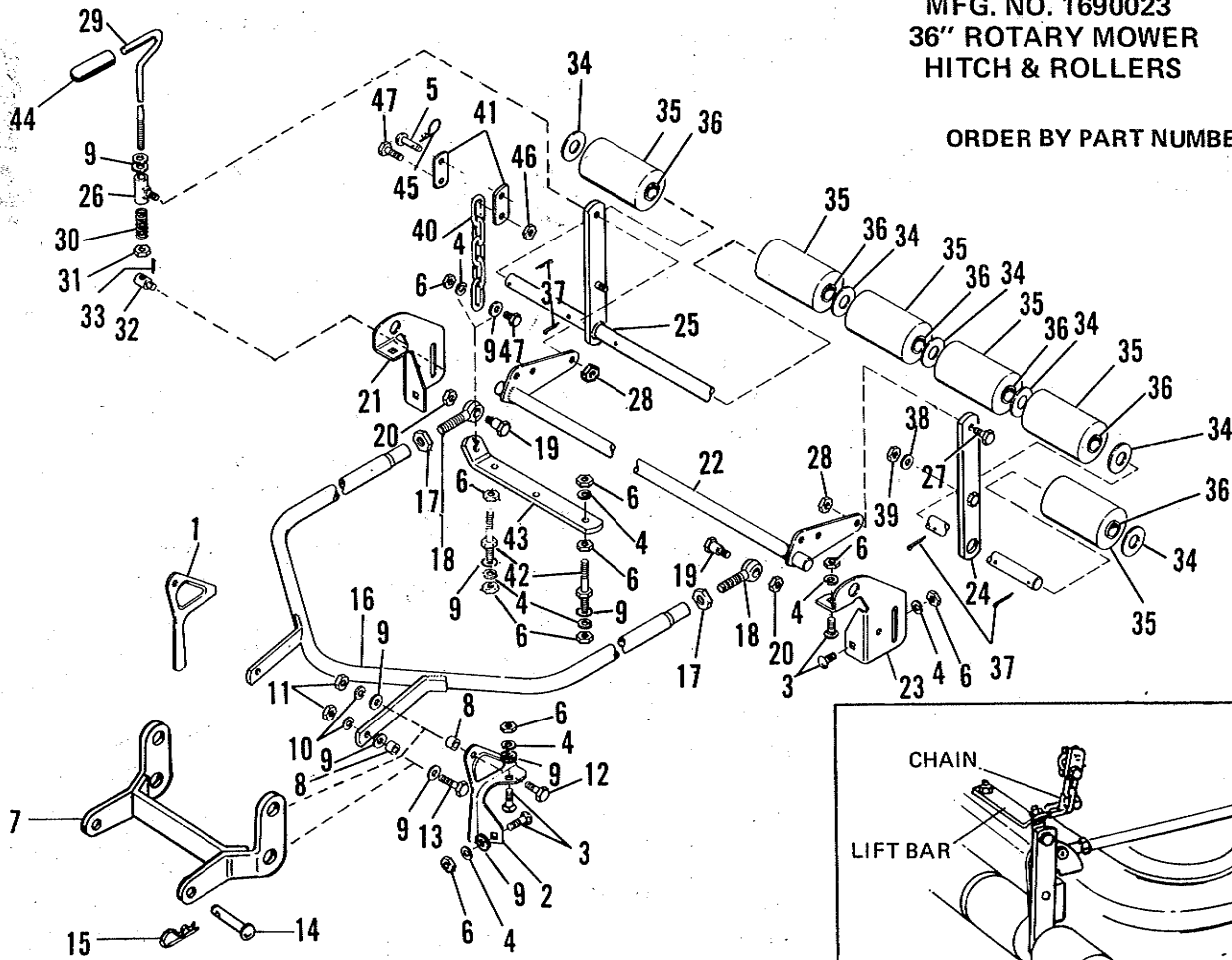

Ref. No.	Part No.	Qty.	Description
1	108484	1	BRACKET, Front, R.H.
2	108483	1	BRACKET, Front, L.H.
3	922110	8	BOLT, Carriage, 3/8-16 x 3/4
4	916965	13	LOCKWASHER, 3/8
5	153058	1	PIN, 3/8 x 1"
6	916950	14	NUT, Hex, 3/8-16
7	108796	1	ROCKER ARM ASSY
8	153073	4	SPACER
9	917378	13	WASHER, Plain, 3/8
10	916965	4	LOCKWASHER, 3/8
11	916950	4	NUT, hex, 3/8-16
12	907731	2	CAPSCREW, hex, 3/8-16 x 1
13	917400	2	CAPSCREW, Hex, 3/8-16 x 1-1/4
14	156306	2	PIN
15	176012	2	CLIP, Safety pin
16	1651977	1	BAIL ASSEMBLY
17	919262	2	NUT, hex jam, 1/2-20
18	157215	2	EYEBOLT
19	108412	2	BOLT, Shoulder
20	923428	2	LOCKNUT, hex, 3/8-16
21	108489	1	BRACKET, rear, R.H.
22	1651314	1	LEVER ASSY., Rear
23	108488	1	BRACKET, Rear, L.H.
24	108256	1	ROLLER BAR ASSY
25	170282	1	ROLLER BAR & SHAFT ASSY.

Ref. No.	Part No.	Qty.	Description
26	108166	1	SOCKET ASSY, Crank
27	925204	1	CAPSCREW, Hex, 3/8-16 x 1
28	928731	1	LOCKNUT, hex, 3/8-16
29	1650394	1	SCREW ASSY., Adjusting
30	108360	1	SPRING
31	917421	1	NUT, hex jam, 3/8-16
32	108172	1	PIVOT
33	918447	1	PIN, Cotter, 3/32 x 3/4
34	116001	6	WASHER
35	108431	6	ROLLER ASSY. w/ Bushings
36	108419	12	BUSHING
37	918458	2	PIN, Cotter, 3/16 x 1
38	917642	2	WASHER, Plain, 5/16
39	923428	2	NUT, hex, 3/8-16
40	107031	1	CHAIN
41	108199	2	LINK, Mower lift
42	108372	2	STUD
43	108375	1	BAR, Lift
44	1651820	1	GRIP, Handle
45	8161045	1	CLIP, Hairpin
46	923362	1	LOCKNUT, hex, 5/16-18
47	916431	1	CAPSCREW, hex, 5/16-18 x 1
48	907731	1	CAPSCREW, Hex, 3/8-16 x 1

**MFG. NO. 1690023
36" ROTARY MOWER
DEFLECTOR & STONE GUARD ASSEMBLIES**

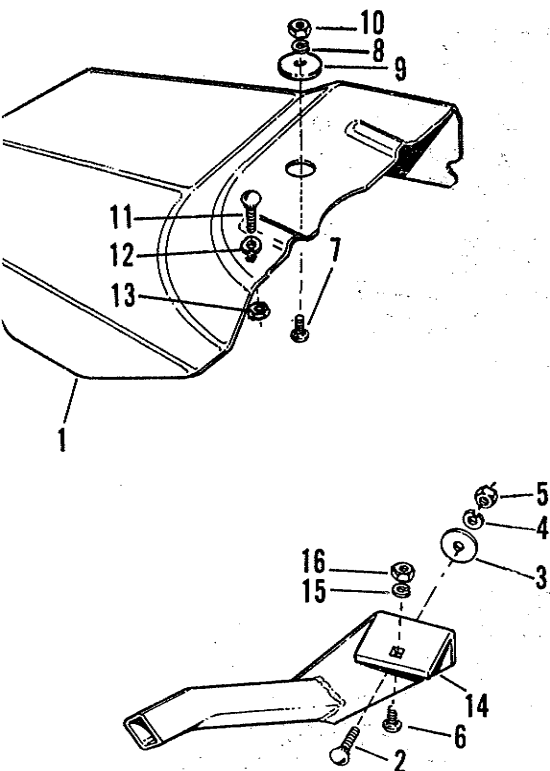

Ref. No.	Part No.	Qty.	Description
1	1651311	1	DEFLECTOR
2	921933	1	BOLT, Carriage, 3/8-16 x 1-1/4
3	8161199	1	WASHER
4	916965	1	LOCKWASHER, 3/8
5	916950	1	NUT, Hex, 3/8-16
6	923232	1	BOLT, Carriage, 3/8-16 x 1
7	920563	1	BOLT, Carriage, 5/16-18 x 1-1/4
8	916965	1	LOCKWASHER, 3/8
9	8161199	1	WASHER
10	916950	1	NUT, Hex, 3/8-16
11	921977	1	CAPSCREW, Hex
12	917356	1	LOCKWASHER, 5/16
13	916159	1	NUT, Retainer
14	174108	1	STONE GUARD ASSY.
15	916965	1	LOCKWASHER, 3/8
16	916950	1	NUT, Hex, 3/8-16

ARBOR KITS

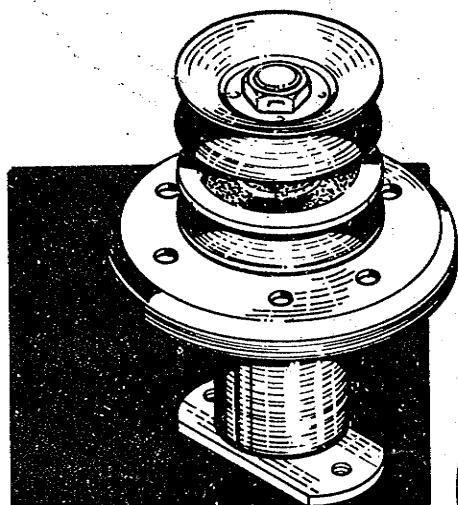

CENTER ARBOR ASSEMBLY

PART NO. 103230

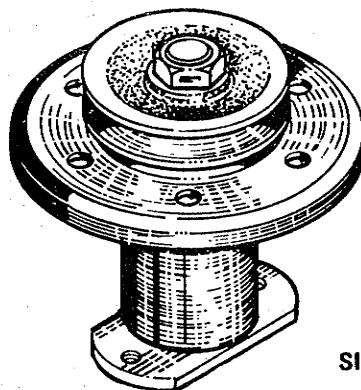

PART NO. 103229

SIDE ARBOR ASSEMBLY

MFG. NO. 1600343
30" ROTARY TILLER
DEFLECTOR & TINE GROUP

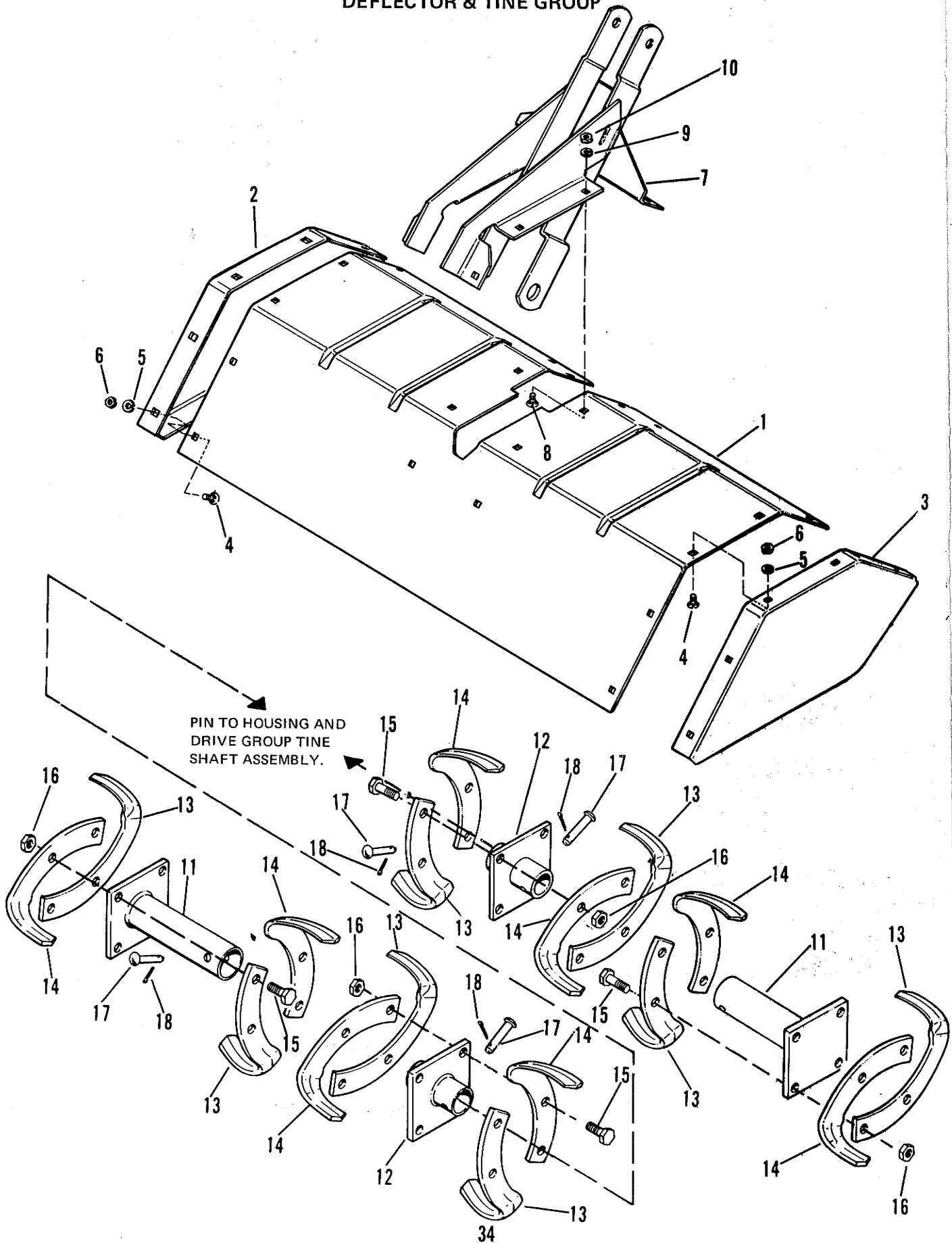

MFG. NO. 1600343
30" ROTARY TILLER
DEFLECTOR & TINE GROUP

Ref. No.	Part No.	Qty.	Description
1	170034	1	DEFLECTOR
2	105273	1	DEFLECTOR, End plate, L.H.
3	105274	1	DEFLECTOR, End plate, R.H.
4	923700	10	BOLT, Carriage, 5/16-18 x 1/2
5	917356	10	LOCKWASHER, 5/16
6	917372	10	NUT, hex, 5/16-18
7	170324	1	SUPPORT ASSEMBLY
8	923346	10	BOLT, Carriage, 5/16-18 x 3/4
9	917356	10	LOCKWASHER, 5/16
10	917372	10	NUT, hex, 5/16-18
11	170127	2	TINE HUB ASSEMBLY
12	118084	2	INNER TINE PLATE ASSY.
13	8152001	8	TINE BLADE L.H.
14	8152002	8	TINE BLADE R.H.
15	920488	16	CAPSCREW, Hex, 7/16-20 x 1-1/4
16	928867	16	LOCKNUT, hex, 7/16-20
17	118053	4	PIN
18	918451	4	PIN, Cotter, 1/8 x 3/4

MFG. NO. 1600343
30" ROTARY TILLER
HOUSING & DRIVE GROUP

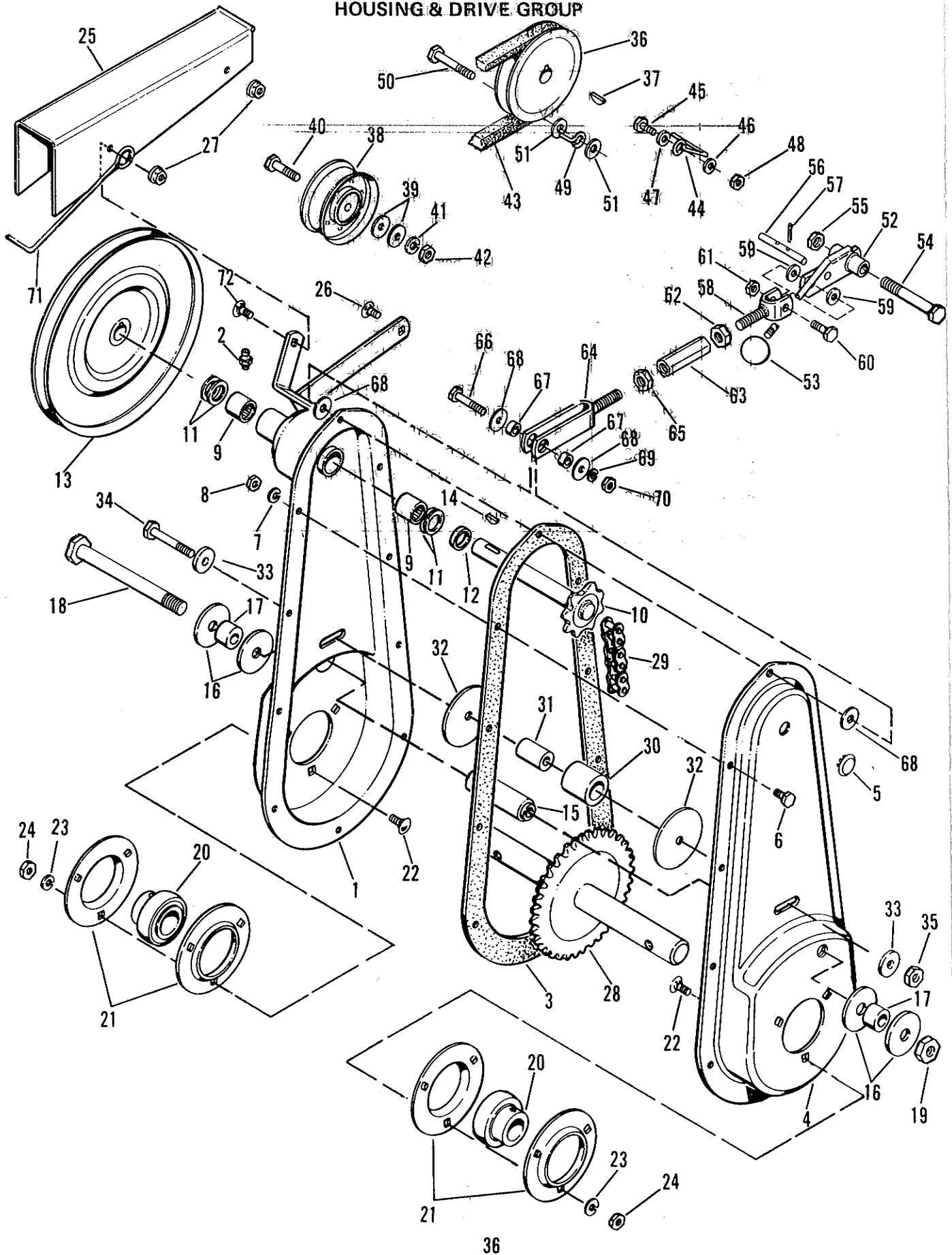

MFG. NO. 1600343
30" ROTARY TILLER
HOUSING & DRIVE GROUP

Ref. No.	Part No.	Qty.	Description
1	170323	1	CASE ASSY., L.H.
2	912808	1	FITTING, Grease, 1/4-28
3	170022	1	GASKET, Case
4	170367	1	CASE ASSY., R.H.
5	164191	1	BUTTON, Plug
6	919318	9	CAPSCREW, Hex, 5/16-18 x 5/8"
7	917356	9	LOCKWASHER, 5/16
8	917372	9	NUT, Hex, 5/16-18
9	108054	2	BEARING, Needle
10	170023	1	DRIVE SHAFT ASSY.
11	153079	4	WASHER
12	170329	1	SPACER
13	170121	1	PULLEY (Driven)
14	905123	1	KEY, Woodruff 3/16x 3/4
15	170029	1	SPACER, Case
16	105010	4	WASHER
17	170179	2	SPACER
18	928865	1	CAPSCREW, Hex, 1/2-13 x 5-1/2"
19	922134	1	LOCKNUT, 1/2-13
20	170419	2	BEARING
21	161069	4	FLANGE, Bearing
22	923346	6	BOLT, Carriage, 5/16-18 x 3/4"
23	917356	6	LOCKWASHER, 5/16
24	917372	6	NUT, hex, 5/16-18
25	105326	1	SPACER, Belt
26	923700	1	BOLT, Carriage, 5/16-18 x 1/2
27	927557	2	NUT, Special, 5/16-18
28	170030	1	TINE SHAFT ASSY.
29	170053	1	CHAIN
30	170177	1	ROLLER
31	170369	1	SPACER
32	170368	2	WASHER
33	157424	2	WASHER, Special
34	922130	1	CAPSCREW, Hex, 3/8-16 x 2-1/4"
35	923428	1	LOCKNUT, hex, 3/8-16
36	170395	1	PULLEY (Driver)
37	905123	1	KEY, Woodruff, 3/16-3/4

Ref. No.	Part No.	Qty.	Description
38	156124	1	PULLEY, Idler
39	917642	2	WASHER, Plain, 5/16
40	917400	1	CAPSCREW, Hex, 3/8-16 x 1-1/4 " lg.
41	916965	1	LOCKWASHER, 3/8
42	916950	1	NUT, hex, 3/8-16
43	108505	1	BELT, "V"
44	170396	1	STOP, Belt
45	917397	1	CAPSCREW, Hex, 5/16-18 x 3/4"
46	917356	1	LOCKWASHER, 5/16
47	917377	1	WASHER, Plain, 1/4
48	917372	1	NUT, hex, 5/16-18
49	170397	1	STOP, Belt
50	919361	1	CAPSCREW, Hex, 3/8-16 x 1-3/4"
51	917642	2	WASHER, Plain, 5/16
52	170310	1	CLUTCH LEVER ASSY.
53	122005	1	KNOB
54	923298	1	CAPSCREW, Hex, 7/16-14 x 2-3/4
55	924058	1	LOCKNUT, hex, 7/16-14
56	170248	1	PIN, Stop
57	918447	1	PIN, Cotter, 3/32 x 3/4
58	170241	1	CLEVIS ASSY., L.H.
59	166161	2	WASHER, Nylon
60	916431	1	CAPSCREW, Hex, 5/16-18 x 1"
61	923362	1	LOCKNUT, hex, 5/16-18
62	925476	1	NUT, Hex, 7/16-14 L.H. Thread
63	166088	1	TURNBUCKLE
64	170244	1	YOKE ASSY., R.H.
65	918213	1	NUT, Hex, 7/16"-14
66	921221	1	CAPSCREW, Hex, 5/16-18 x 1-1/2"
67	156150	2	SPACER
68	917642	4	WASHER, Plain, 5/16
69	917356	1	LOCKWASHER, 5/16
70	917372	1	NUT, Hex, 5/16-18
71	8161158	1	STOP, Belt
72	920562	1	BOLT, Carriage, 5/16-18 x 3/4"

MFG. NO. 1600343
30" ROTARY TILLER
HITCH & LIFT GROUP

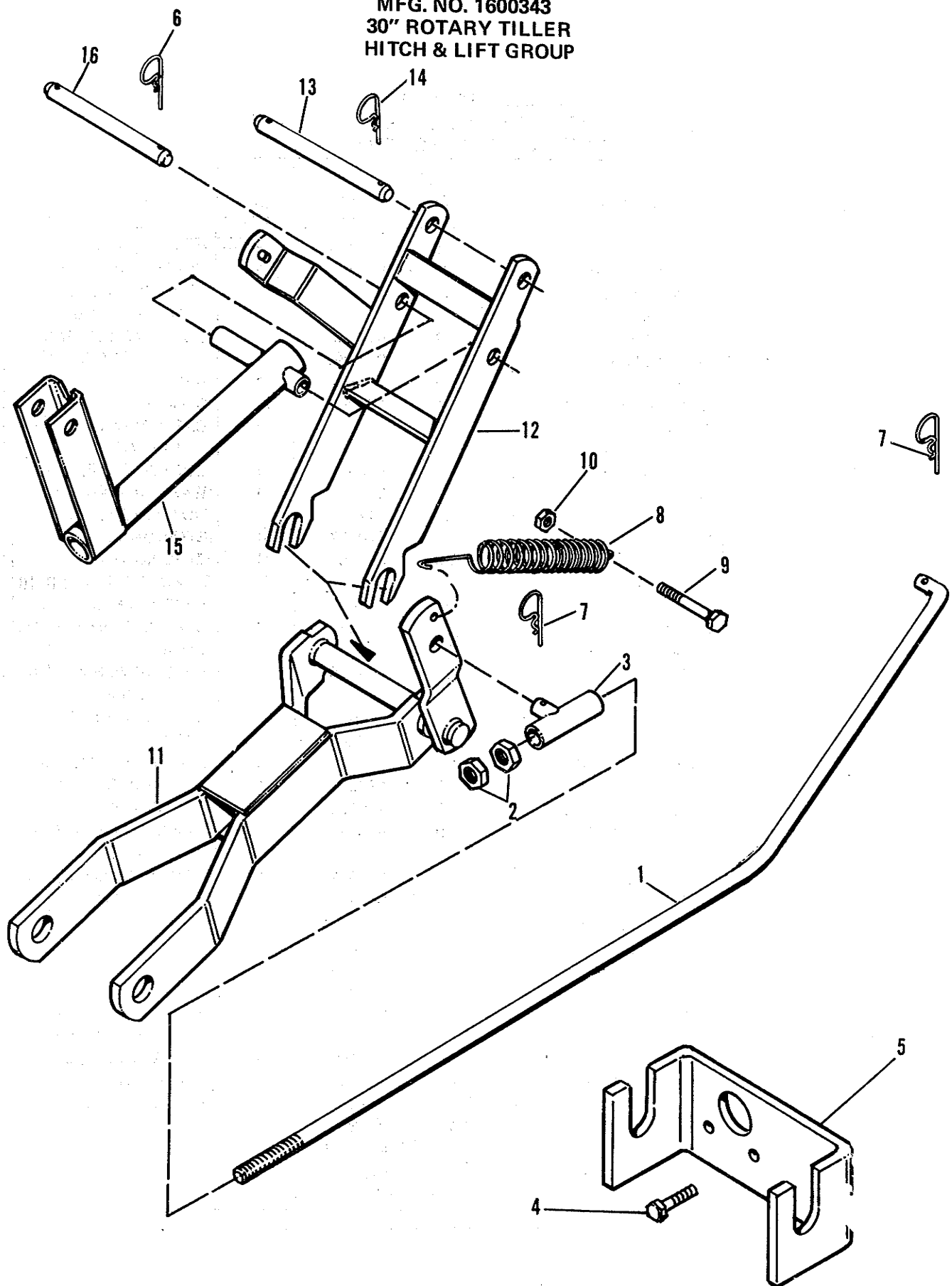

**MFG. NO. 1600343
30" ROTARY TILLER
HITCH & LIFT GROUP**

Ref. No.	Part No.	Qty.	Description
1	176202	1	LIFT ROD (Front)
2	919262	2	NUT, Hex jam, 1/2-20
3	170436	1	GUIDE TUBE ASSEMBLY
4	928726	2	CAPSCREW, Hex, 3/8-16 x 1-1/4
5	123096	1	HITCH
6	8161045	2	CLIPS, Hairpin
7	8161045	2	CLIPS, Hairpin
8	170383	1	SPRING
9	921972	1	CAPSCREW, hex, 3/8-16 x 2-1/2
10	916950	1	NUT, hex, 3/8-16
11	170554	1	HITCH & LIFT ASSEMBLY
12	1650482	1	STRUT ASSEMBLY
13	170117	1	PIN
14	8161045	2	CLIPS, Hairpin
15	170114	1	BEAM
16	170115	1	PIN

MFG. NO. 1690034
32" ROTARY SNOW THROWER
ROTOR, BODY & DRIVE GROUP

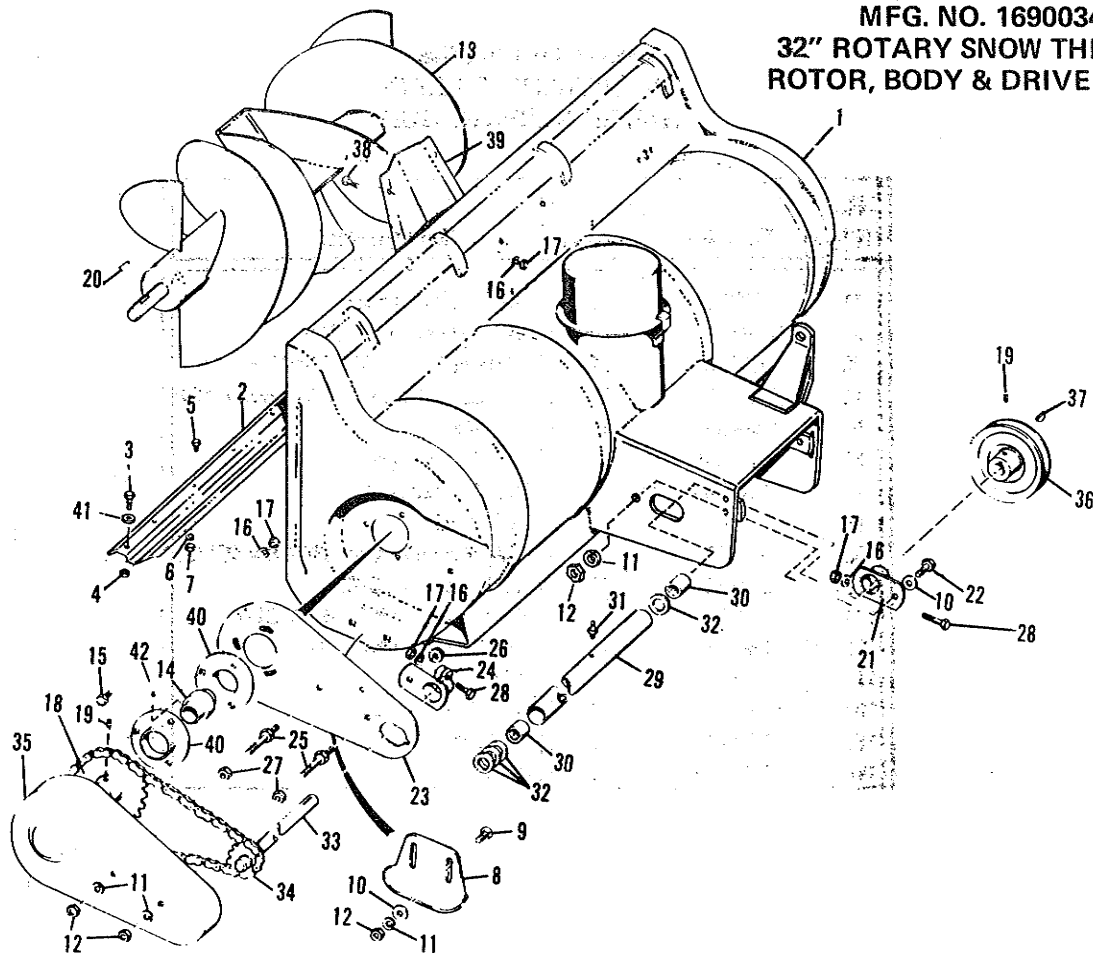

Ref. No.	Part No.	Qty.	Description
1	161198	1	BODY ASSEMBLY
2	106853	1	SCRAPER BODY
3	925295	2	CAPSCREW, Hex, 5/16-18 x 5/8
4	923362	2	LOCKNUT, Full hex, 5/16-18
5	921959	6	CAPSCREW, Hex, 1/4-20 x 5/8
6	916964	6	LOCKWASHER, 1/4
7	916622	6	NUT, Full hex, 1/4-20
8	177434	2	SKID
9	922110	4	BOLT, Carriage, 3/8-16 x 3/4
10	917378	5	WASHER, Plain, 3/8
11	916965	7	LOCKWASHER, 3/8
12	916950	7	NUT, full hex, 3/8-16
13	106847	1	ROTOR ASSEMBLY
14	106732	2	BEARING, Cartridge
15	917397	6	CAPSCREW, Hex, 5/16-18 x 5/8
16	917356	12	LOCKWASHER, 5/16
17	917372	12	NUT, Full hex, 5/16
18	106653	1	ROTOR, Sprocket
19	928691	2	SETSCREW, 5/16-18 x 5/16

40

Ref. No.	Part No.	Qty.	Description
20	151040	1	KEY, Hi-Pro
21	176161	1	CLAMP SUPPORT ASSY.
22	967731	1	CAPSCREW, Hex, 3/8-16 x 1
23	170754	1	PLATE, Side
24	176161	1	CLAMP SUPPORT ASSY.
25	106771	2	STUD
26	928352	2	NUT, Flange, 3/8-16
27	923428	2	LOCKNUT, Full hex, 3/8-16
28	922127	1	CAPSCREW, Hex, 5/16-18 x 1-1/2
29	106656	1	BEARING, Housing
30	154258	2	BEARING, Needle
31	912808	1	FITTING, Grease
32	8061012	7	WASHER
33	106657	1	SHAFT ASSEMBLY
34	106058	1	CHAIN
35	170865	1	GUARD, Chain
36	106485	1	PULLEY
37	905123	1	KEY, 3/16 dia., x 3/4
38	919318	4	CAPSCREW, Hex, 5/16-18 x 5/8
39	106774	1	DEFLECTOR
40	161069	4	FLANGE, Bearing
41	917377	2	WASHER

MFG. NO. 1690034
36" ROTARY SNOW THROWER
SPOUT GROUP

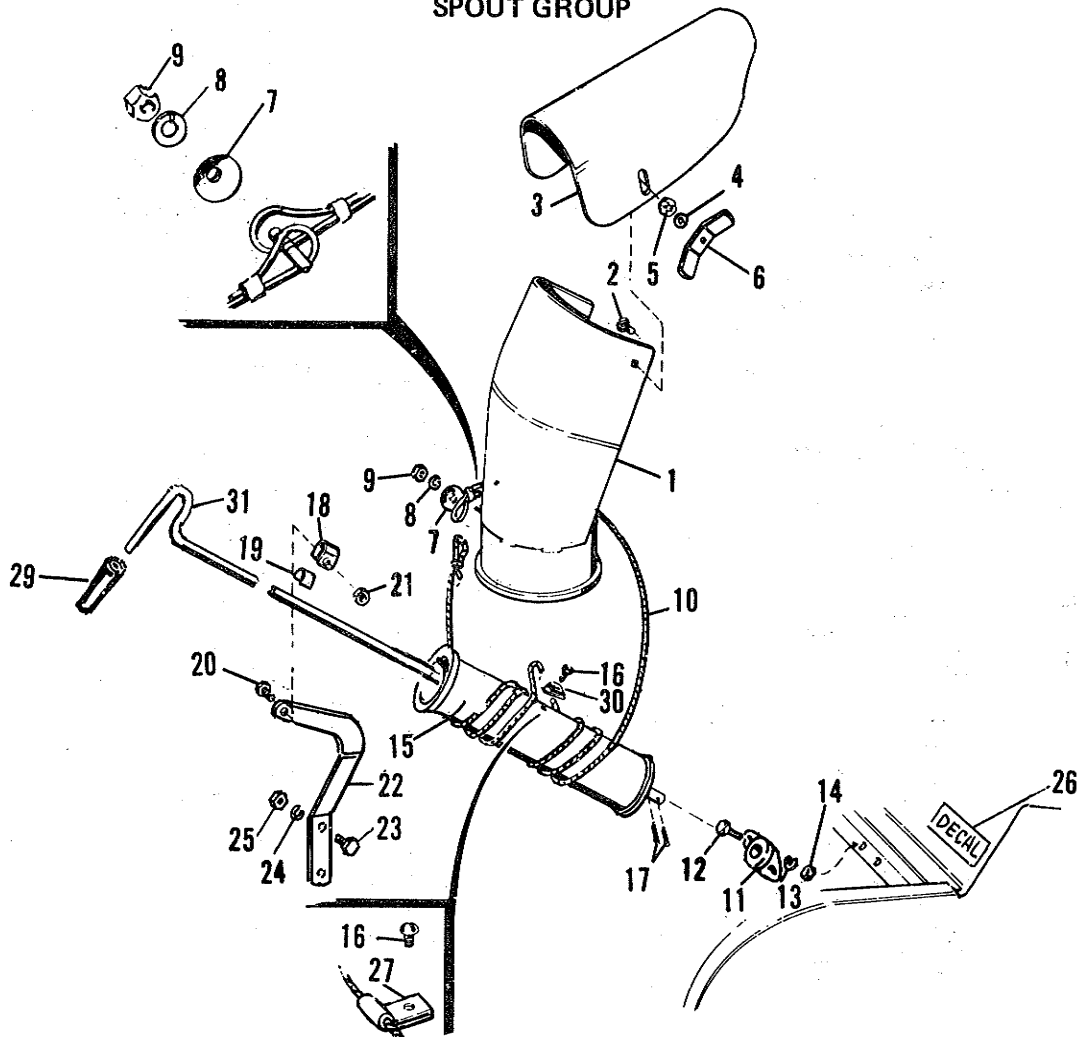

Ref. No.	Part No.	Qty.	Description
1	106762	1	SPOUT ASSEMBLY
2	920562	2	BOLT, Carriage, 5/16-18 x 3/4
3	106760	1	SPOUT, Extension
4	917378	2	WASHER, Plain, 3/8
5	928710	2	LOCKWASHER, 3/8
6	106229	2	WINGNUT
7	171379	1	WASHER, Cup
8	917356	1	LOCKWASHER, 5/16
9	917372	1	NUT, Full hex, 5/16-18
10	171362	1	CABLE ASSEMBLY
11	106491	1	BEARING
12	907727	2	CAPSCREW, Hex, 1/4-20 x 5/8
13	916964	2	LOCKWASHER, 1/4
14	916622	2	NUT, Full hex, 1/4-20
15	176331	1	ROD ASSY., Spout Control
16	927428	1	SCREW, Self-tapping 1/4-20 x 3/8

Ref. No.	Part No.	Qty.	Description
17	922000	2	PIN, Cotter, 3/32 x 5/8
18	152050	1	GUIDE, Rod
19	121175	1	GUIDE, Liner
20	919933	1	CAPSCREW, Hex, 5/16-18 x 1-1/2
21	923362	1	NUT, Lock, Full hex, 5/16-18
22	108499	1	ROD GUIDE SUPPORT
23	907731	2	CAPSCREW, Hex, 3/8-16 x 1 " lg.
24	916965	2	LOCKWASHER, 3/8
25	916950	2	NUT, full hex, 3/8-16
26	161247	1	DECAL
27	154247	1	CLAMP (For Service Only)
28	176934	1	GRIP, Handle
29	918455	1	PIN, Cotter
30	171382	1	CLAMP
31	176417	1	HANDLE, Rod

**MFG. NO. 1690034
32" ROTARY SNOW THROWER
HINGE & MISC. GROUP**

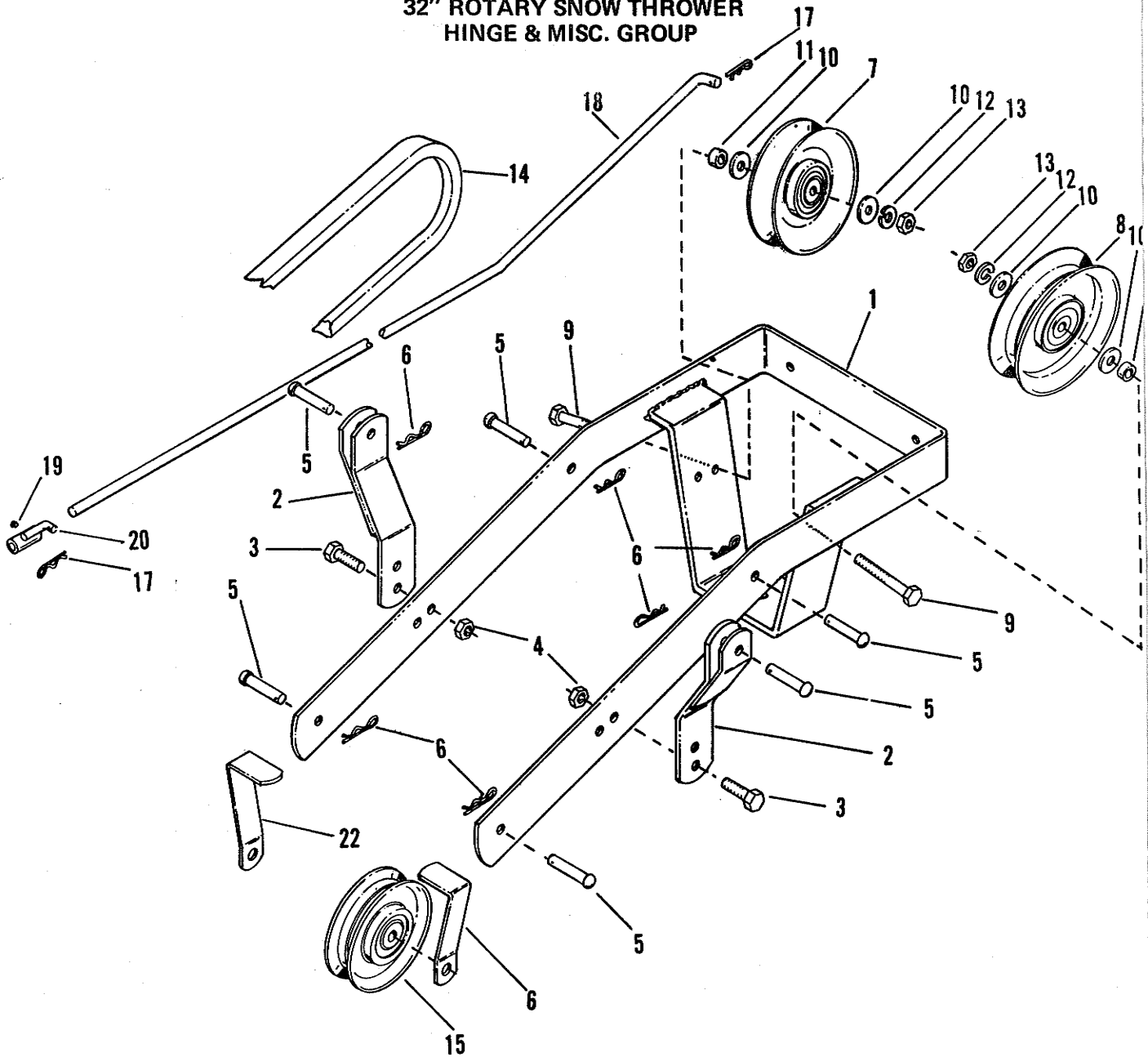

Ref. No.	Part No.	Qty.	Description
1	1651778	1	PUSH ARM ASSEMBLY
2	1651413	2	SUPPORT ARM ASSY.
3	907731	2	CAPSCREW, Hex, Hd., 3/8-16 x 1
4	923428	2	NUT, Hex, Full Lock, 3/8-16
5	156306	6	PIN
6	106788	6	CLIP, Hairpin
7	101096	1	PULLEY
8	171247	1	PULLEY, Idler
9	919361	2	CAPSCREW, Hex, Hd., 3/8-16 x 1-3/4
10	917642	4	WASHER, Plain, 5/16

Ref. No.	Part No.	Qty.	Description
11	154177	2	SPACER
12	916965	2	LOCKWASHER, 3/8
13	916950	2	NUT, hex, 3/8-16 x 2
14	108514	1	BELT, "V", Drive
15	106716	1	PULLEY, Idler
16	1651817	1	STOP, Belt
17	106788	2	CLIP, Hairpin
18	1651425	1	ROD, Lift
19	928709	1	SCREW, Set, Sq. Hd., 5/16-18 x 3/8
20	1651496	1	ROD GUIDE ASSY.
21	161247	1	DECAL, Safety
22	162115	1	STOP, Belt

MFG. NO. 1690025
VACUUM COLLECTOR, ENGINE DRIVEN
COLLECTOR & BLOWER HOUSING

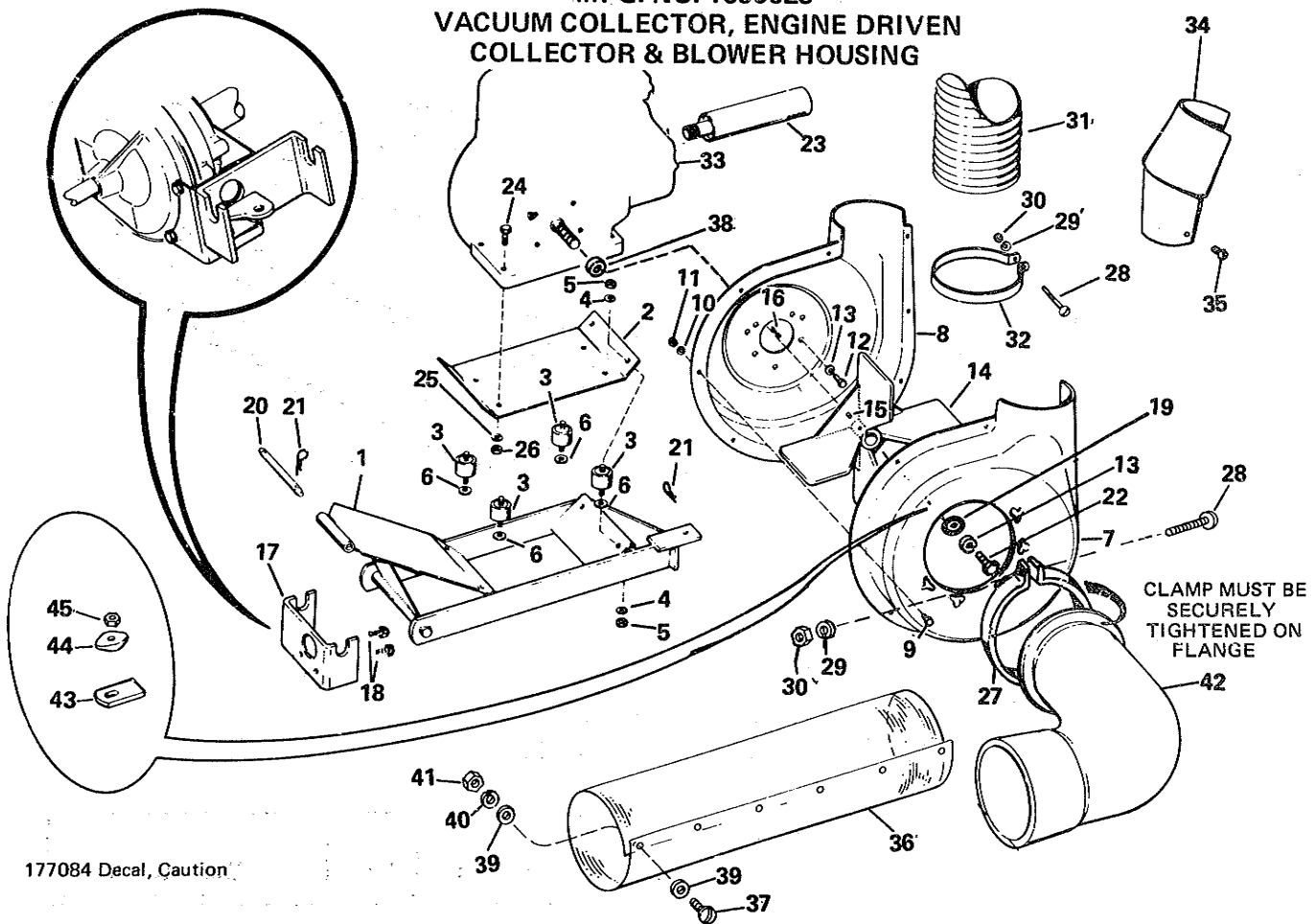

177084 Decal, Caution

Ref. No.	Part No.	Qty.	Description
1	123088	1	FRAME ASSEMBLY
2	123095	1	PLATE, Engine
3	157094	4	CUSHION, Connector
4	917356	8	LOCKWASHER, 5/16
5	917372	8	NUT, full hex, 5/16
6	917642	4	WASHER, Plain, 5/16
7	177269	1	HOUSING ASSEMBLY
8	123013	1	HOUSING, Half blower, R.H.
9	908295	9	CAPSCREW, Hex, 1/4-20 x 1/2
10	916964	9	LOCKWASHER, 1/4
11	916622	9	NUT, full hex, 1/4-20
12	922120	4	CAPSCREW, Hex, 5/16-24 x 5/8
13	917356	4	LOCKWASHER, 5/16
14	123015	1	FAN ASSEMBLY
15	928721	1	SETSCREW, 5/16-18x1/2
16	8221042	1	KEY
17	1230396	1	HITCH
18	919360	2	CAPSCREW, Hex, 3/8-16 x 1-1/2
19	123144	1	WASHER
20	156268	1	PIN, Counterweight
21	8161045	2	CLIP, Spring
22	921515	1	CAPSCREW, Hex, 5/16-24 x 3/4
23	123104	1	MUFFLER

Ref. No.	Part No.	Qty.	Description
24	919933	4	CAPSCREW, Hex, 5/16-18 x 1-1/2
25	917356	4	LOCKWASHER, 5/16
26	917372	4	NUT, full hex, 5/16-18
27	123065	1	CLAMP, Hose
28	928866	2	SCREW, Rd., Hd., Mach., 1/4-20 x 3
29	916964	2	LOCKWASHER, 1/4
30	916622	2	NUT, full hex, 1/4-20
31	174264	1	HOSE, Exhaust
32	123067	1	CLAMP, Hose
33	123141	1	ENGINE
34	123107	1	DEFLECTOR
35	919804	2	SCREW, Self-tap., No. 10
36	1650437	1	TUBE, Intake
37	930531	6	SCREW, Truss Head., Phillips No. 10
38	123140	1	SPACER
39	916955	12	WASHER, 3/16
40	909055	6	LOCKWASHER, No. 10
41	917415	6	NUT, full Hex, No. 10-32
42	177333	1	ELBOW ASSEMBLY, 42" Adapter
43	177271	2	CLAMP, Bar
44	108848	2	NUT, Wing
45	928698	2	LOCKNUT, Full Hex, 5/16-18

**MFG. NO. 1690029
36" ROTARY MOWER
VACUUM COLLECTOR ADAPTER**

Ref. No.	Part No.	Qty.	Description
1	177017	1	36" ADAPTER ASSEMBLY
2	123103	1	NUT ASSEMBLY
3	153073	1	SPACER
4	920563	1	BOLT, Rd. Hd., Sq. Nk., 5/16-18 x 1
5	917356	1	LOCKWASHER, 5/16
6	917372	1	NUT, Full hex, 5/16-18

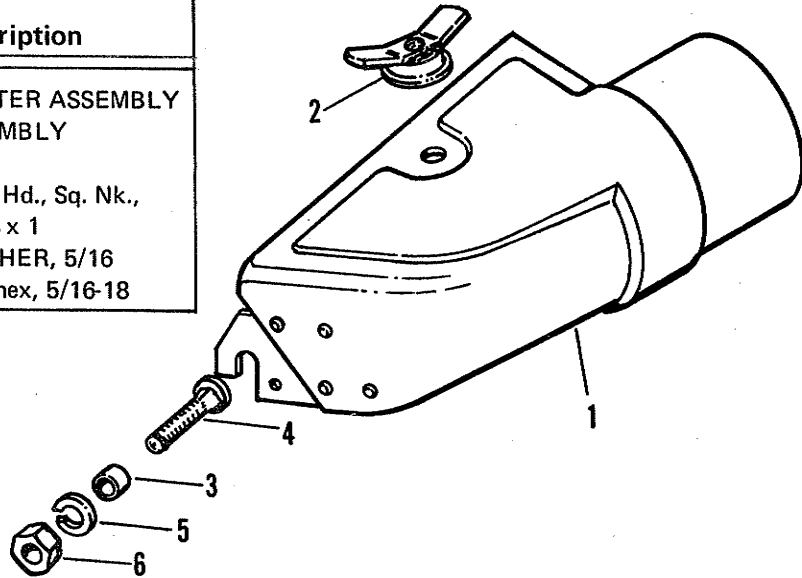

**MFG. NO. 1690028
42" ROTARY MOWER
VACUUM COLLECTOR ADAPTER**

Ref. No.	Part No.	Qty.	Description
1	1651087	1	ADAPTER ASSEMBLY
2	123060	1	NUT ASSEMBLY
3	153081	1	SPACER

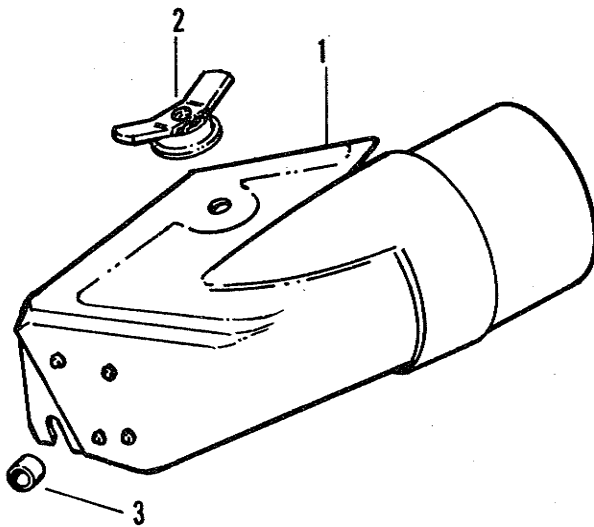

MFG. NO. 1690031
ROVING NOZZLE

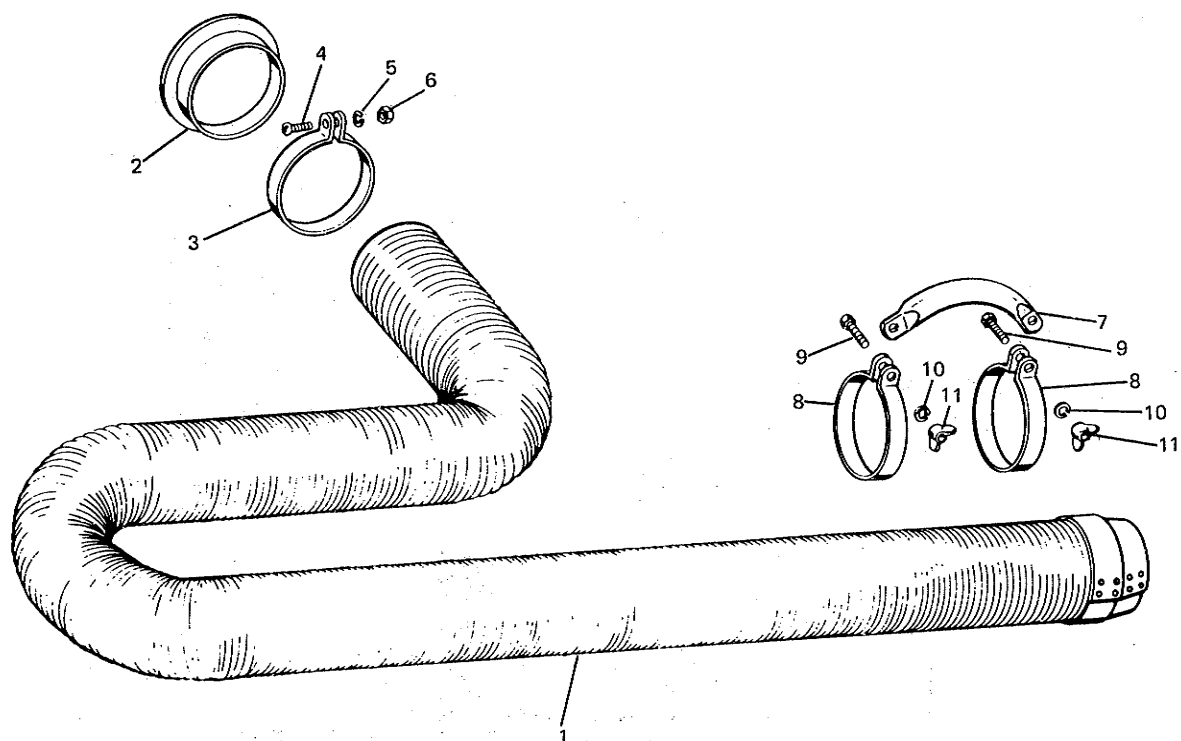

Ref. No.	Part No.	Qty.	Description
1	123127	1	HOSE ASSEMBLY
2	123111	1	FLANGE, Hose
3	123065	1	CLAMP, Hose
4	928866	1	SCREW, R.H., 1/4-20 x 3
5	926964	1	LOCKWASHER, 1/4"
6	916622	1	NUT, Hex, Full, 1/4-20
7	123129	1	HANDLE, Hose
8	123128	2	HANDLE, Hose Clamp
9	917397	2	CAPSCREW, Hex, 5/16-18 x 3/4
10	917356	2	LOCKWASHER, 5/16
11	916952	2	NUT, Wing, 5/16-18

MFG. NO. 1600236
DUMP CART

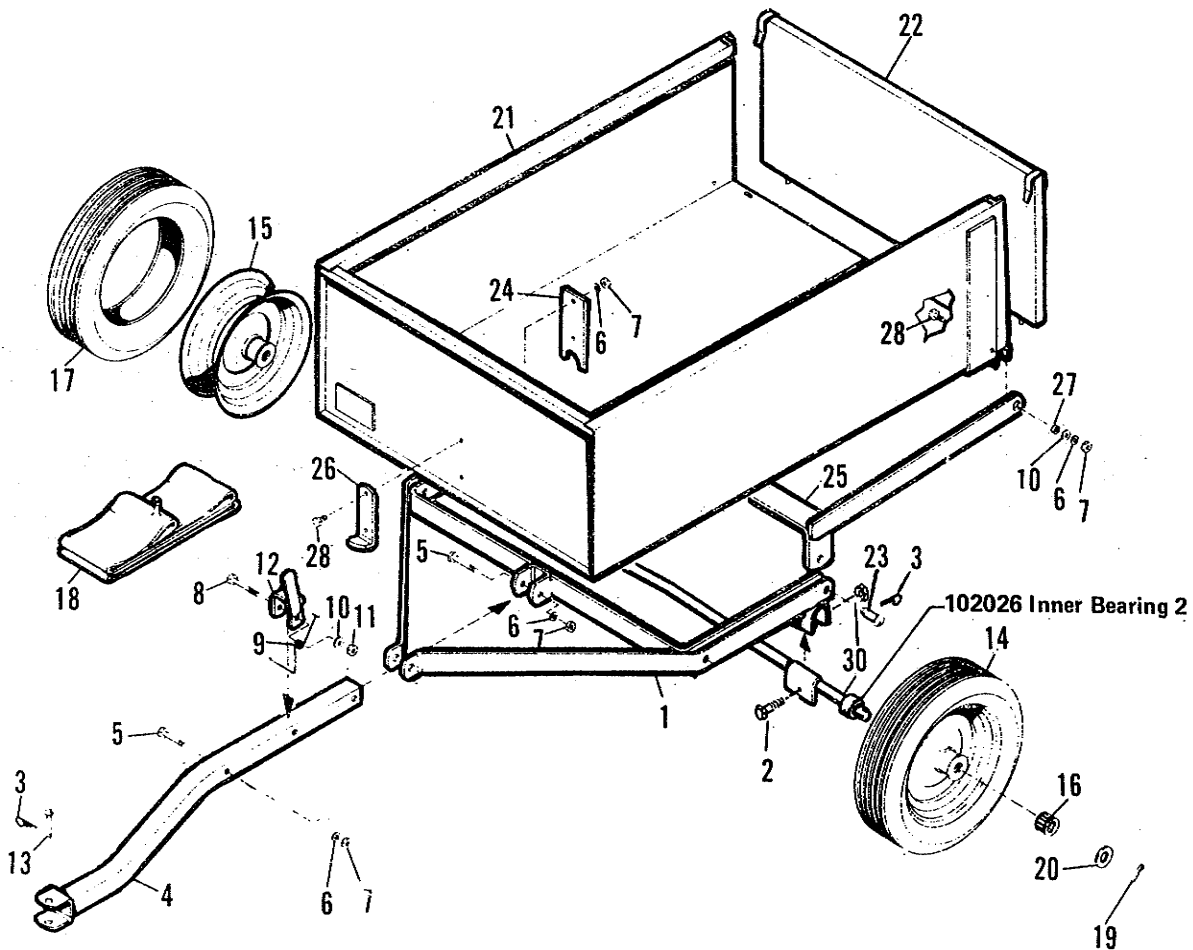

Ref. No.	Part No.	Qty.	Description
1	102035	1	FRAME ASSEMBLY
2	917398	2	CAPSCREW, Hex, 5/16-18 x 1-3/4
3	8161045	3	CLIP, Hairpin
4	102037	1	TONGUE ASSY.
5	919362	2	CAPSCREW, Hex, 3/8-16 x 2-1/4
6	916935	6	LOCKWASHER, 3/8
7	916950	6	NUT, Full hex, 3/8-16
8	930596	1	CAPSCREW, Hex 3/8-16 x 2-3/4
9	102075	1	SPRING, Torsion
10	917378	3	WASHER, Flat, 3/8
11	923428	1	NUT, Full hex, 3/8-16
12	102051	1	BOX CATCH CLEVIS ASSEMBLY
13	105249	1	PIN
14	170320	2	WHEEL & TIRE ASSY.
15	170319	2	WHEEL

Ref. No.	Part No.	Qty.	Description
16	156316	2	BEARING
17	102052	2	TIRE
18	153038	2	TUBE
19	918459	2	PIN, Cotter, 3/16-1-1/2
20	918433	2	WASHER, Flat, 3/4
21	102002	1	BODY, Trailer
22	102003	1	GATE, End
23	102004	2	PIN, Pivot
24	102005	1	PLATE, Box Guide
25	102024	1	BOX PIVOT ASSY.
26	102040	1	PLATE, Box Catch
27	8151076	2	BUSHING
28	907731	2	CAPSCREW, Hex, 3/8-16 x 1
29	102027	1	AXLE ASSEMBLY
30	923362	2	LOCKNUT, 5/16-18
31	917400	2	CAPSCREW, Hex, 3/8-16 x 1-1/4

MFG. NO. 1690395
DUMP CART COVER

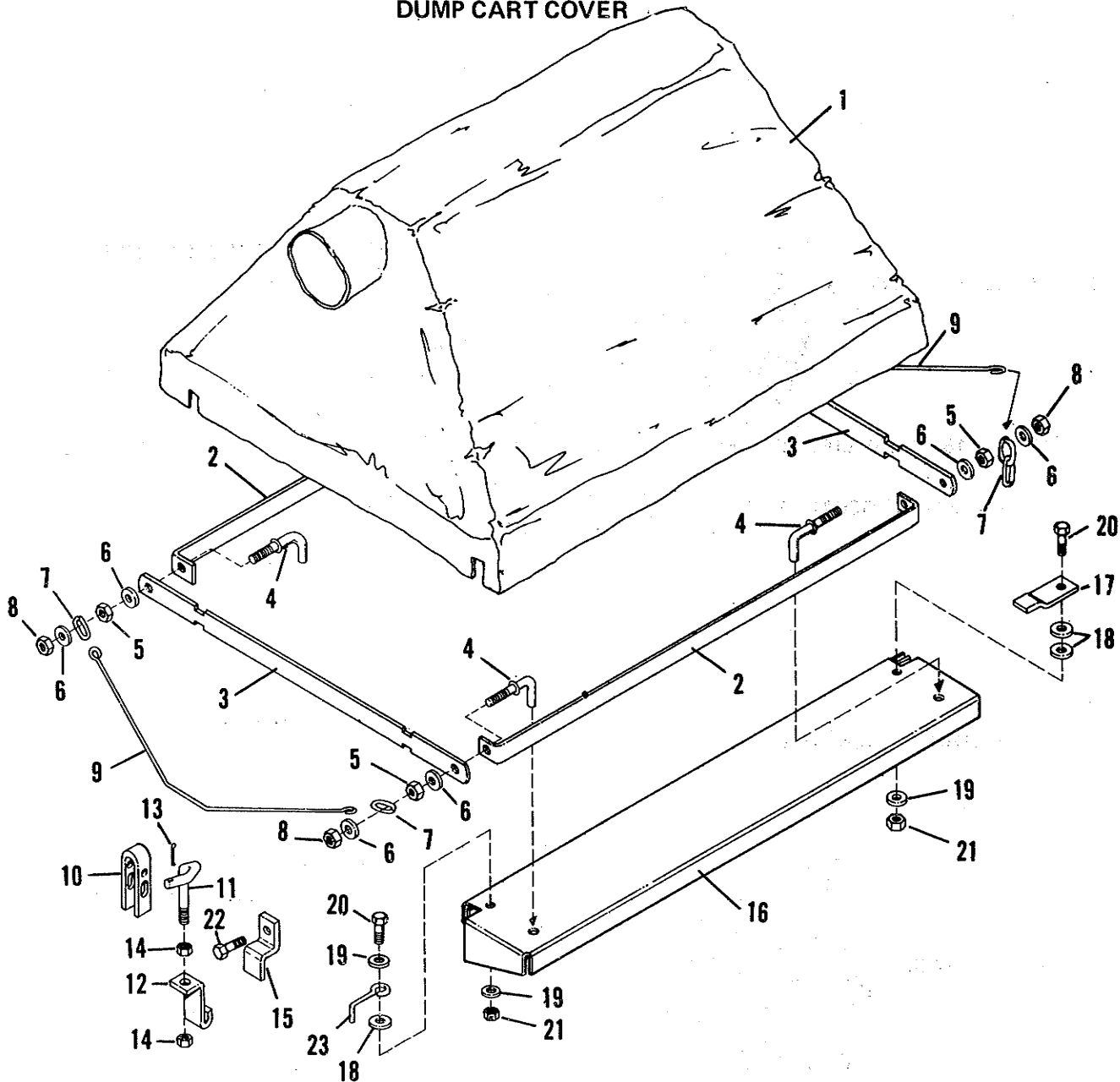

Ref. No.	Part No.	Qty.	Description
1	177917	1	COVER, Cart
2	178191	2	BAR, Side Reinf.
3	178192	2	BAR, End Reinf.
4	178189	4	PIN
5	916950	4	NUT, Hex, 3/8-16
6	917378	8	WASHER, Flat, 3/8
7	170134	6	LINK
8	923428	4	NUT, Centerlock, Hex
9	178188	2	BAIL
10	170002	2	LEVER
11	170001	2	LATCH, Rod
12	170000	2	LATCH
13	918452	2	PIN, Cotter

Ref. No.	Part No.	Qty.	Description
14	923428	4	NUT, Centerlock, Hex
15*	178190	1	BRACKET
16	178187	2	PANEL, Side
17	178198	2	BRACKET
18	159134	6	WASHER, Special
19	917642	6	WASHER, Plain, 5/16
20	917397	4	CAPSCREW, Hex, 5/16-18
21	923362	4	LOCKNUT, Hex, 5/16-18
22	917400	1	CAPSCREW, Hex, 3/8-16 x 1-1/4
23	163065	2	BELT, Stop

* Attached To Front of Dump Cart

