

12-19-68

Edm - yoman - [signature]

Simplicity®

**32" Rotary Mower
Mfr's. No. 417
and
Leaf Mulcher
Mfr's. No.173**

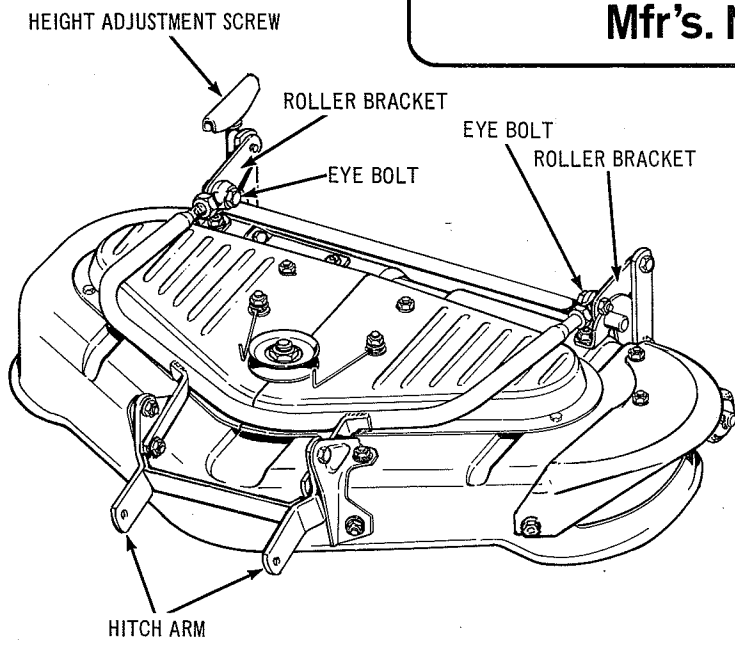

Assembly

Attach the Hitch Assembly as shown in Fig. 1, to the front of the mower housing by means of the Carriage Bolts and Lock Washers, and Hex. Nuts furnished. Note that the heads of the Carriage Bolts are on the inside of the Mower Housing.

Assemble the Eye Bolt to the Roller Brackets at the rear of the Mower Housing, using Hex. Capscrews, Lock Washers, and Hex. Nuts. NOTE: The Bolts are installed so that the Nuts are to the outside.

Mower Attachment

The Mower is attached to the Tractor as follows:

1. Turn the Steering Wheel to cock the Tractor Wheels all the way to the left.
2. Slide the Mower under the Tractor from the right hand side. Straighten the wheels.
3. Attach the Mower Hitch Arms to the front of the Tractor Front Hitch, using Pins and Spring Clips.
4. Place the Mower Drive Belt around the Engine Drive Pulley and then over the Idler Pulleys at the Front End of the Tractor. Place the free end of the Drive Belt over the Drive Pulley of the Mower. To obtain sufficient slack in Belt to attach to Mower Drive Pulley, release the Idler Pulley tension by pushing forward on Tractor Power Take-off Lever.

Operation

To operate the Rotary Mower, place the Mower on the ground and engage Mower Drive with the Power Take-off.

NOTE: After the first 5 to 10 hours of operation the Cross Drive Belt and the Blade Drive Belt #31, Fig. RT-7, may stretch slightly. The tension on the Blade Drive Belt may be increased as illustrated in Fig. RT-7. First remove the Fasteners holding the Housing Covers in place and then remove the Covers from the Housing. Loosen the Nut #32, Fig. RT-7, then apply pressure to move the Idler Pulley #33, in the direction indicated, until enough Belt Tension is obtained. Then hold Pulley in desired position and re-tighten the Nut #32. Replace the Housing and tighten securely.

CAUTION

MOWER SHALL NOT BE USED WITHOUT EITHER VACUUM COLLECTOR ADAPTER OR THE THE DEFLECTOR ADAPTER IN PLACE.

Belts

The Drive Belt and the Spindle Drive Belt are a super combine type which are specially constructed to insure proper Mower operation and long life. When replacements are needed, do not substitute standard fractional horsepower Belts.

ARBOR & HOUSING

Ref. Let.	Part No.	Description
A	103097	Arbor Tube Assembly
B	108134	Backing Ring
C	108250	Arbor Assembly
D	108181	Washer
E	108202	Ball Bearing
F	108257	Washer
G	108472	Washer
H	108201	Spacer
J	108139	Flinger
K	108142	Pulley
L	725006	Woodruff Key, // 61-3/16" x 5/8"
M	713504	Set Screw, 5/16"-18 x 3/8"
N	717517	Jam Lock Hex. Nut, 3/4"-16
P	108369	Drive Arbor Assembly
Q	108371	Spacer
R	108246	Cross Drive Pulley
S	108147	Housing
T	705004	Carriage Bolt, 3/8"-16 x 3/4"
U	720002	Lock Washer, 3/8"
V	717003	Full Hex. Nut, 3/8"-16
W	108386	Idler Pulley
X	719004	Washer
Y	719002	Plain Washer, 5/16"
Z	157081	Spacer
AA	703009	Carriage Bolt, 3/8"-16 x 1-3/4"
AB	717510	Full Lock Hex. Nut, 3/8"-16
AC	108151	"V" Belt (Mower Spindle Drive)
AD	108301	R.H. Half Housing Cover
AE	108302	L.H. Half Housing Cover
AF	714007	Recessed Hex. Screw, 1/4"-20 x 3/8"
AG	703003	Carriage Bolt, 3/8"-16 x 1"
AH	719003	Plain Washer, 7/16"
AJ	8161158	Belt Stop
AK	719001	Plain Washer, 3/8"
AL	720002	Lock Washer, 3/8"
AM	717003	Full Hex. Nut, 3/8"-16
AN	108187	Mower Baffle
AP	714012	Recessed Hex. Screw, 1/4"-20 x 7/8"
AQ	720003	Lock Washer, 1/4"
AR	717005	Full Hex. Nut, 1/4"-20
AS	108186	Baffle Clip, // 10 Ga.
AT	715018	Hex. Cap Screw, 1/4"-20 x 5/8"
AU	719006	Plain Washer
AV	108297	Blade
AW	715024	Hex. Cap Screw, 3/8"-16 x 5/8"
AX	720002	Lock Washer, 3/8"
AY	108495	"V" Belt
AZ	108499	Deflector // 13 Ga.
BA	703005	Carriage Bolt, 5/16"-18 x 3/4"
BB	720001	Lock Washer, 5/16"
BC	717001	Full Hex. Nut, 5/16"-18
BD	8161199	Washer, Special
BE	703004	Carriage Bolt 3/8-16 x 3/4" lg.
*	103031	Decal, Safety
*	103005	Plate, Model Number
*	121195	Plate, Patent Number
*	108507	Film, Safety
*	155061	Decal, Simplicity
BF	108822	Arbor Assembly with Bearings and Hardware
*	108828	Decal-Safety Stds.

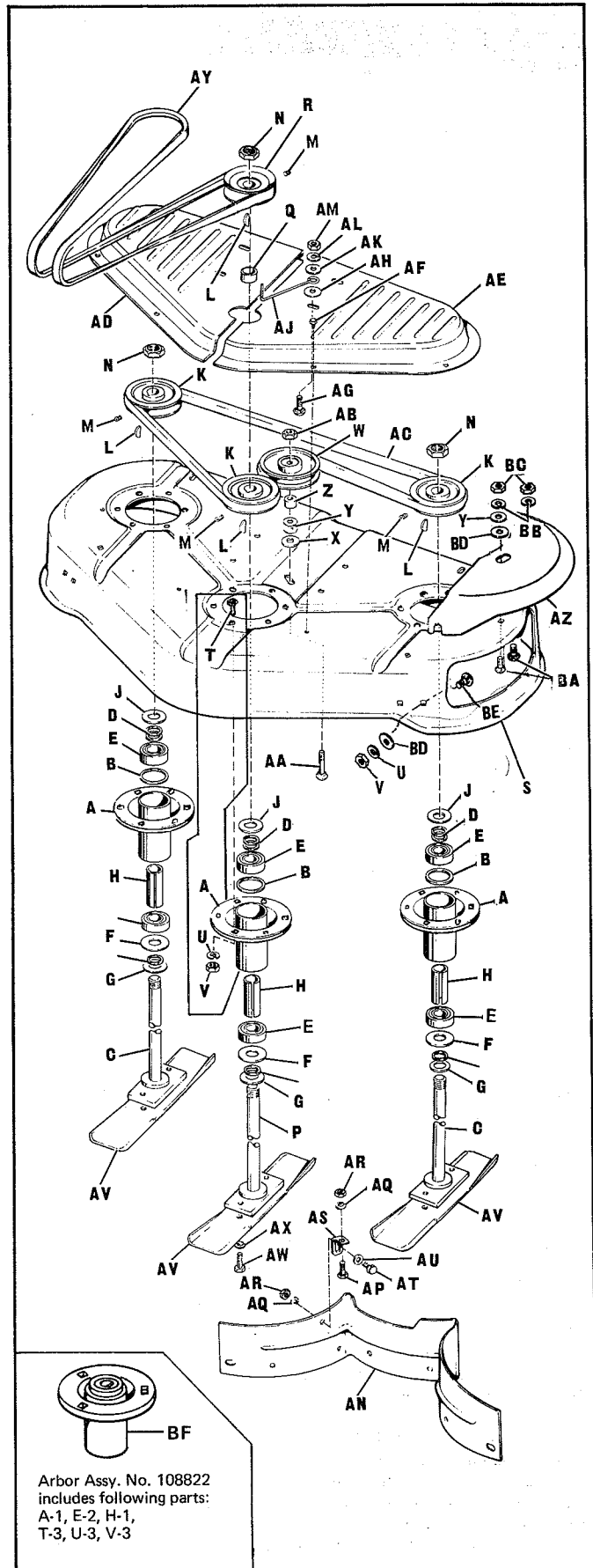

IMPORTANT

USE ONLY SIMPLICITY REPLACEMENT
BELTS & BLADES

HITCH & ROLLERS

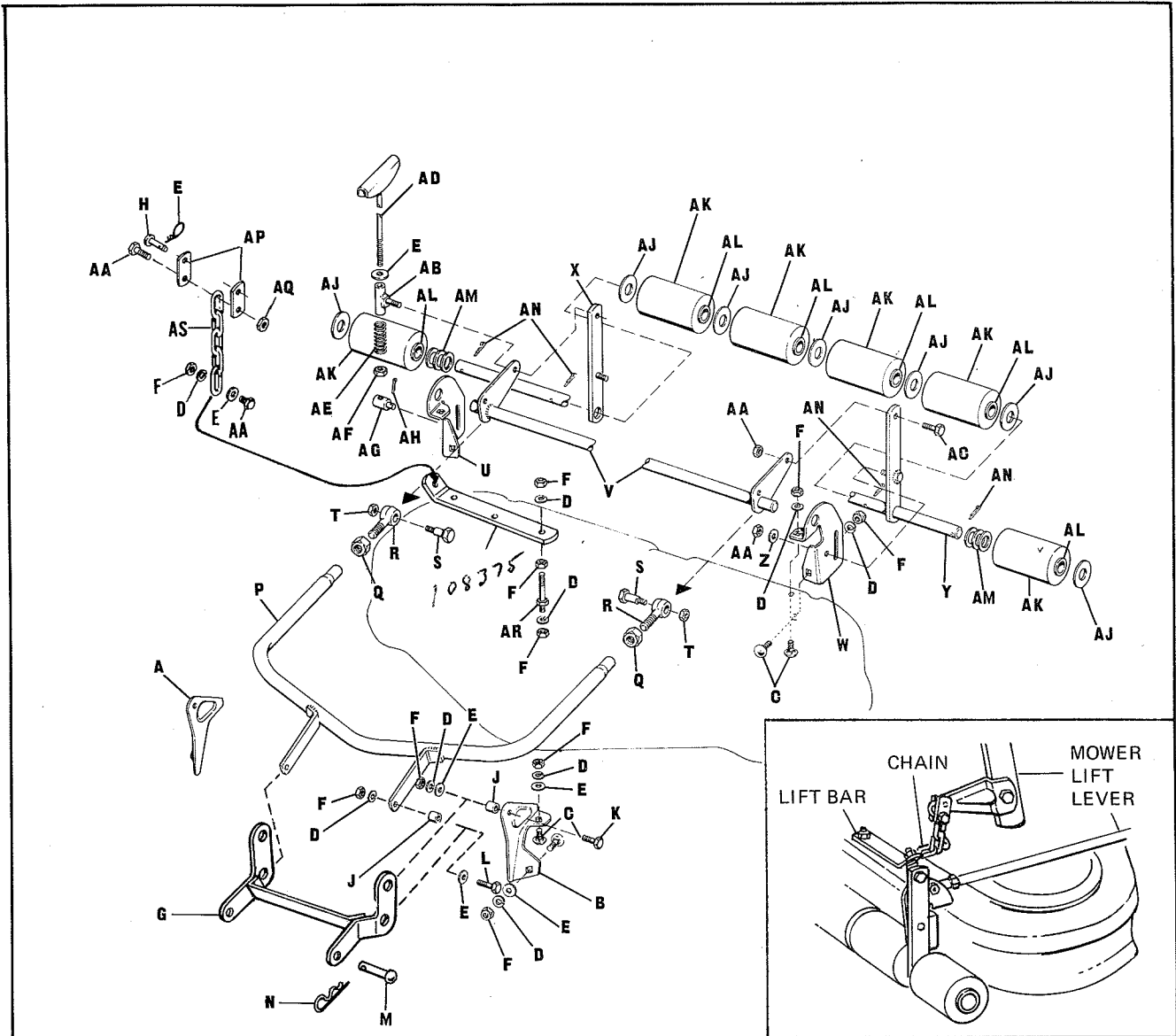

Ref. Let.	Part No.	Description
A	108477	R.H. Front Bracket
B	108476	L.H. Front Bracket
C	703004	Carriage Bolt, 3/8"-16 x 3/4"
D	720002	Lock Washer, 3/8"
E	8161045	Spring Clip
F	717003	Full Hex. Nut, 3/8"-16
G	108796	Rocker Arm Assembly
H	153058	Pin, 3/8" x 1" lg.
J	108717	Spacer
K	705005	Hex. Capscrew, 3/8"-16 x 1"
L	705016	Hex. Capscrew, 3/8"-16 x 1-1/4"
M	156306	Pin
N	8161045	Spring Clip
P	108478	Bail Assembly
Q	717016	Hex. Jam Nut, 1/2"-20
R	157215	Eye Bolt
S	108412	Bolt Shoulder
T	717510	Full Lock Hex. Nut, 3/8"-16
U	108159	R.H. Roller Bracket
V	108160	Rear Lever Assembly
W	108163	L.H. Roller Bracket

Ref. Let.	Part No.	Description
X	108256	Roller Bar Assembly
Y	108254	Roller Bar & Shaft Assembly
Z	719002	Plain Washer, 5/16"
AA	705005	Hex Capscrew
AB	108166	Crank Socket Assembly
AC	705031	Hex. Capscrew, 3/8"-16 x 7/8"
AD	108415	Adj. Screw Assembly
AE	108360	Spring
AF	717013	Jam Hex. Nut, 3/8"-16
AG	108172	Pivot
AH	722001	Cotter Pin, 3/32" x 3/4"
AJ	116001	Washer
AK	108431	Roller Assembly
AL	108419	Bushing (Two per roller)
AM	8261055	Washer
AN	722011	Cotter Pin, 3/16" x 1"
AP	108199	Mower Lift Link
AQ	717510	Hex. Full Lock Nut
AR	108372	Stud
AS	107031	Chain

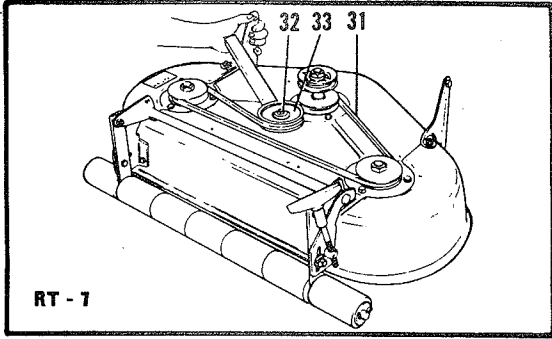

Lubrication

The Mower Arbor Spindles are supported in prelubricated, sealed Ball Bearing Assemblies, which do not require further attention.

MOWER ADJUSTMENT

The Hitch and Adjusting Rod Assembly is hipped loose with the Mower, and the Eye Bolt on each Rod is located in the approximate position for use.

The Front Tip should be approximately 1/4" higher than the Rear Tips. Each Eye Bolt may be moved as necessary to obtain this relationship.

After making this initial setting, place the Tractor, with Mower attached, on a flat surface and measure the height of the Front Tip of the Center Blade and the Rear Tips of the Side Blades.

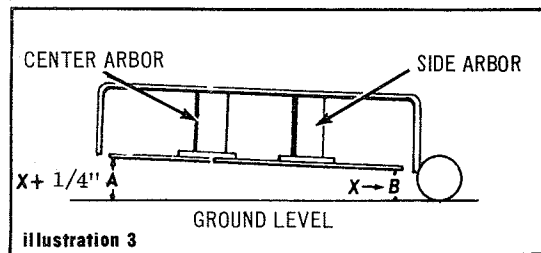

LEAF MULCHER

INSTRUCTIONS FOR ASSEMBLING

The leaf mulcher for the 32" Rotary Mower consists of baffles which must be attached to the housing as illustrated in Figure 1.

1. The front baffle (A) is positioned on the inside front of the housing and is secured by two carriage bolts (F) and the clamp (B).
2. The side baffle (C) which closes off the grass exhaust port, and the other three baffle sections (D) and (E) are fastened into place as shown with the bolts provided.
3. Rotate the blades to check for proper clearance between the blades and the baffle flanges.

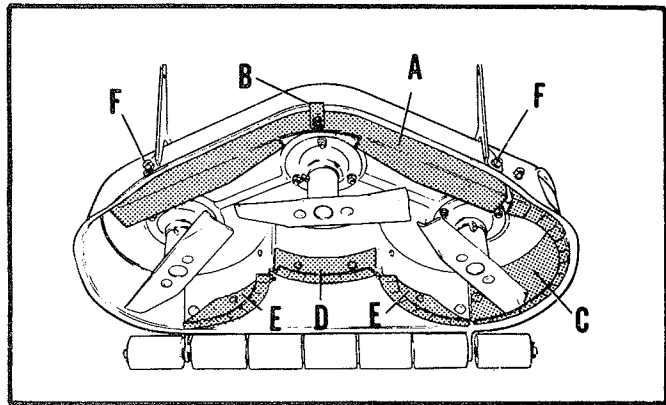

Figure 1.

PARTS LIST FOR LEAF MULCHER

Reference Letter	Part No.	Description
A	108190	Baffle, Mulcher, Front
B	108188	Clamp
C	108184	Baffle, Side
D	108191	Baffle, Rear, Center
E	108189	Baffle, Mulcher, Rear, Side

