

*Simplicity*®

**INSTRUCTIONS  
AND PARTS LIST**

**LANDLORD  
RIDING TRACTOR**

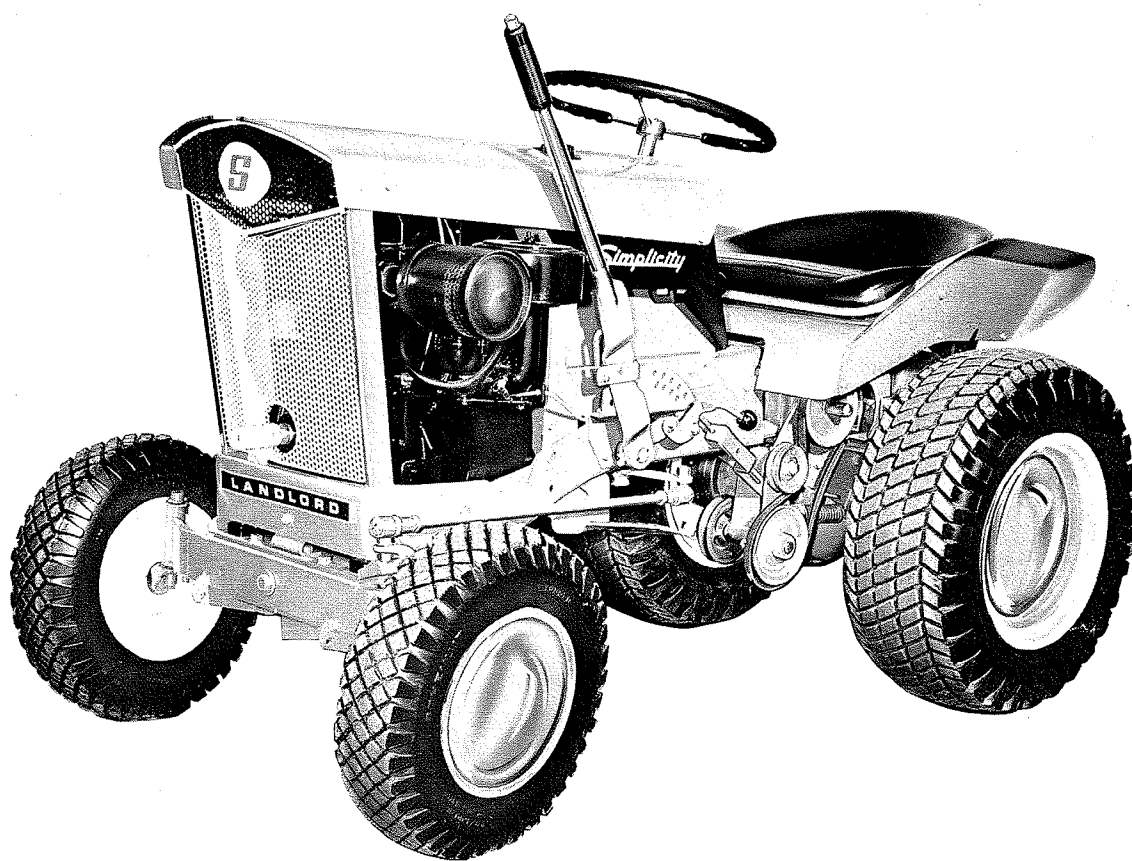

**Mfrs. No. 314  
Mfrs. No. 308**

1 2 3 4 5 6 7 8 9 10

**SIMPLICITY MANUFACTURING COMPANY / PORT WASHINGTON, WIS.**

## REAR LIFT GROUP INSTALLATION

The Rear Lift Group is to be installed in the following manner:

1. Remove 3 hex cap screws from left side of tractor as shown in figure 1.

2. Swing hitch member outward and install lift assembly as shown. Return hitch member to original position and replace hex cap screws. See figure 2.

3. Insert right end of lift assembly into hole in right hitch member and position lift assembly so that collar is flush against right hitch member. Position collar on left side of lift assembly so it is flush against left hitch member; tighten socket hd set screw with allen-wrench. See figure 3.

4. Connect lift assembly to clevis by means of pin, spacer, and cotter pin. Keep spacer on left side of lift assembly. See figure 3.

5. Adjust rear lift rod so that there is clearance between the gear case and the lift assembly when the lift lever is in the forward, latched, position. Also adjust rod so that the lift assembly will strike the gear case before the lift lever strikes the air cleaner on engine when lift lever overtravels forward.

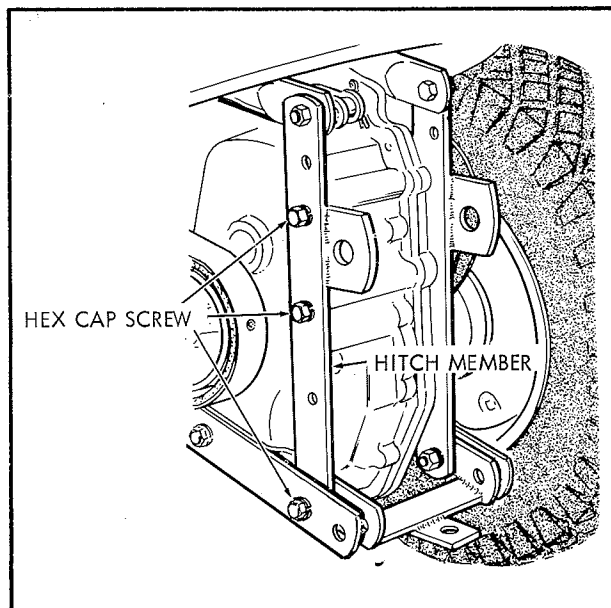

Fig. 1

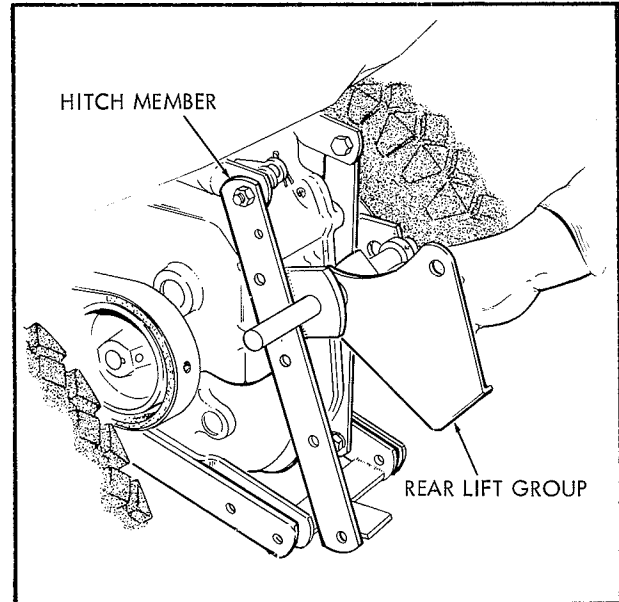

Fig. 2

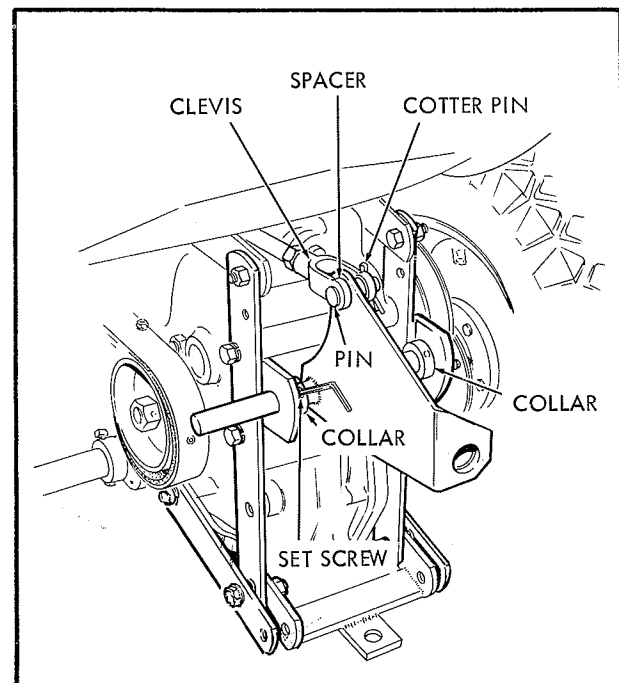

Fig. 3

## LUBRICATION

The tractor has a total of 5 grease fittings which require lubrication with general purpose automotive grease. Use a standard grease gun for the following fittings:

Before lubricating, wipe each grease fitting with a rag to prevent grit and dirt from being carried into bearings with new grease.

- (2) Front Spindles - figure 4
- (2) Steering Mechanism - figure 6
- (1) Rear Axle Tube - figure 7

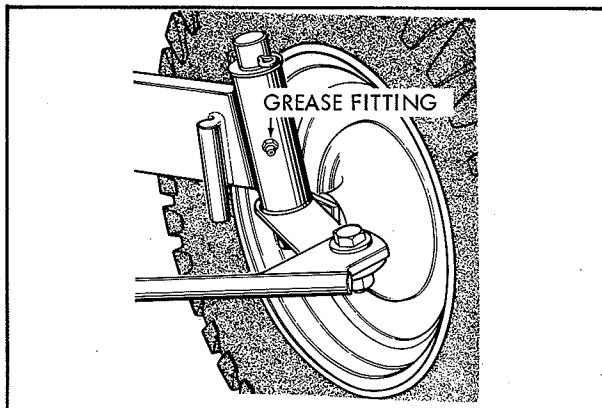

Fig. 4

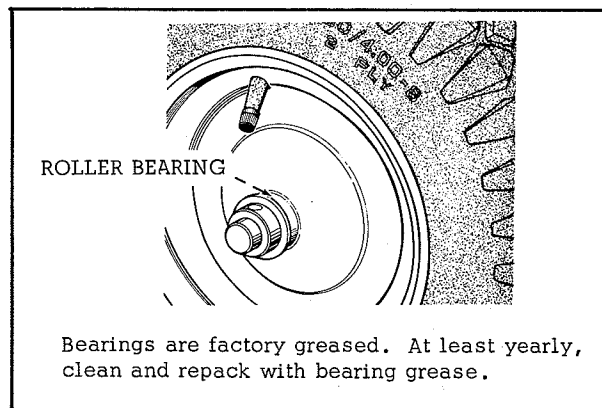

Fig. 5

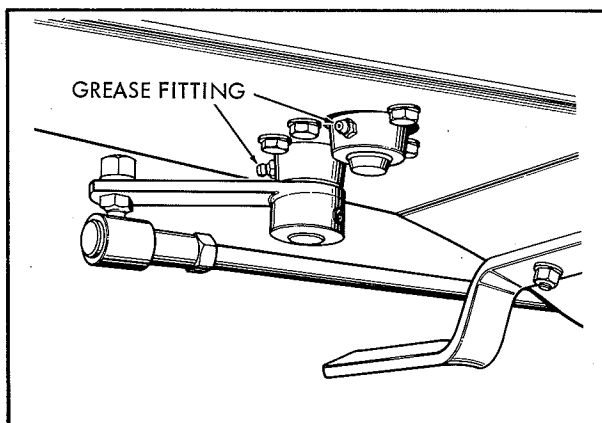

Fig. 6

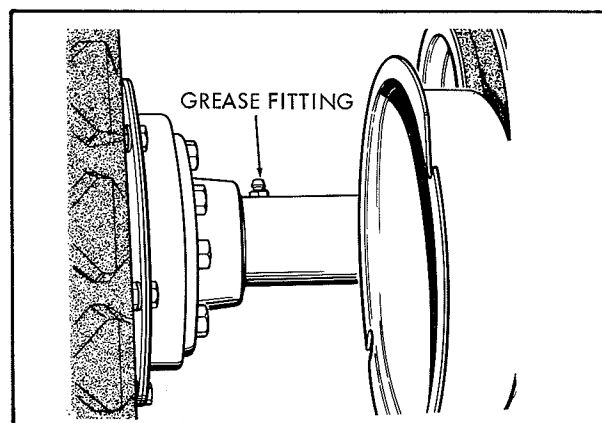

Fig. 7

The transmission has a capacity of 1 1/2 Qts. of SAE 90 oil, and is filled at the factory. It will not normally require replenishment, but occasionally check drain plug for tightness and axle tube oil seals for leakage. Maintain oil level at lower edge of filler plug hole. Remove vent plug from top of transmission and allow oil to settle to normal level before checking. See Figure 9.

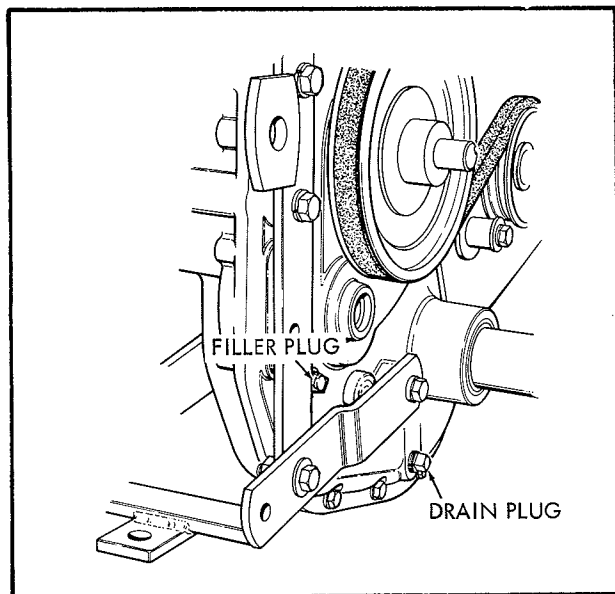

Fig. 9

## ENGINE

Engine - Service air cleaner and crankcase as recommended in engine service manual. Be sure air cleaner is maintained in clean condition. Never use oil in crankcase for more than 25 hours of operation. See figure 15. **CLEAN AIR AND CLEAN ENGINE OIL WILL GIVE LONG TROUBLE FREE OPERATION. DIRT WILL RUIN YOUR ENGINE IN A SHORT TIME.** A funnel and extension are included with the tractor for use in changing oil.

The bevel gear housing has a capacity of 1 pint of SAE 90 oil and is filled at the factory. It will not normally require replenishment, but occasionally check drain plug for tightness and oil seals for leakage. Keep oil up to level of filler plug. See figure 10.

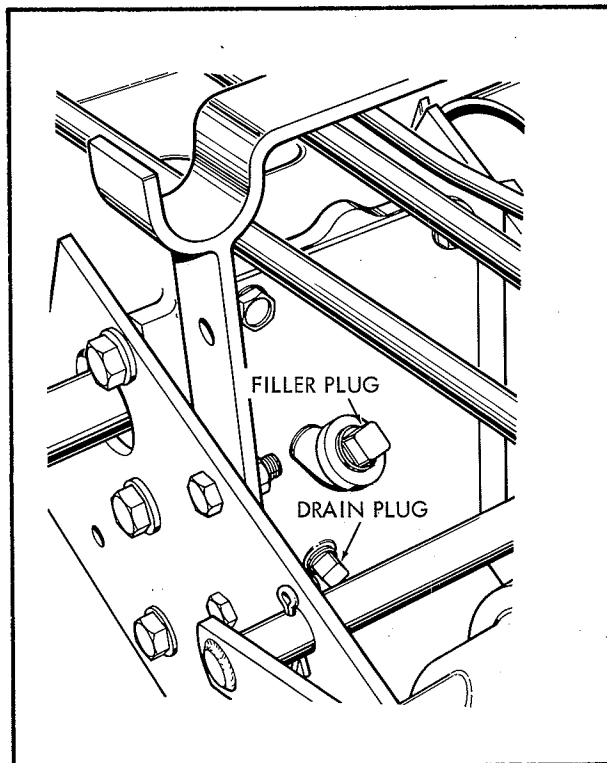

Fig. 10

## TIRES

The tires of the tractor are inflated with air pressure in excess of the normal amount for shipment. For comfort of operation, release some of the pressure until a pressure of 12 lbs per square inch is attained for front tires and 7 lbs per square inch is attained for rear tires. Maintain tires at these pressures.

## BATTERY

Battery - The battery should be kept clean and dry at all times. Keep battery snugly fastened in place and check battery cables for tight connections. Vent caps should be kept tight, and vent holes in vent caps must be kept open at all times to permit gases formed in battery to escape. Full maintenance instructions are provided on separate instruction card for battery.

If tractor is not used for an extended period during winter, remove battery and store in a fully charged condition, in a cool place.

## STARTING ENGINE-ELECTRIC STARTER

1. Place gear shift lever in neutral position. See figure 12. (Be sure tractor is on level ground and will not roll away in neutral. Apply parking brake.)
2. Place choke lever in "CHOKE" position. See figure 12 & 13.
3. Set throttle lever in mid position and turn ignition key to "ON". See figure 12. Press starter button to start engine and release. As engine warms up, return choke lever to "RUN" position.

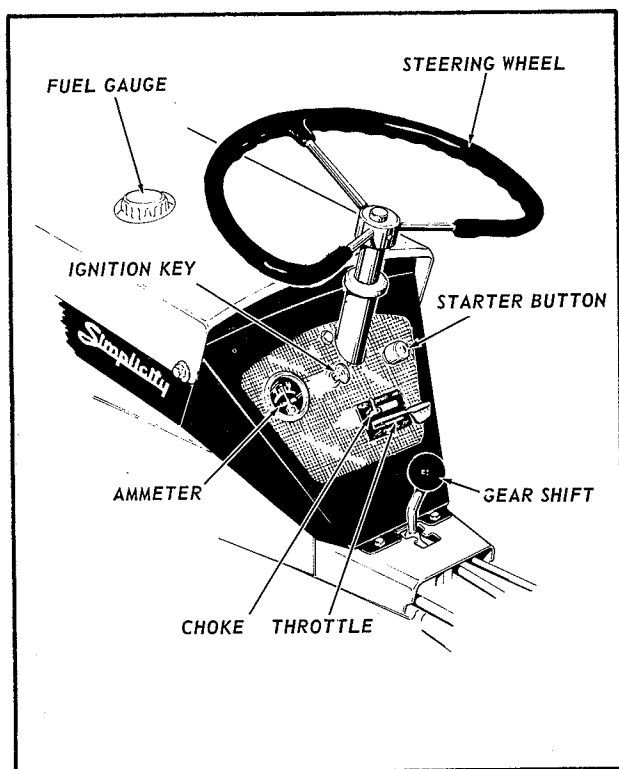

Fig. 12

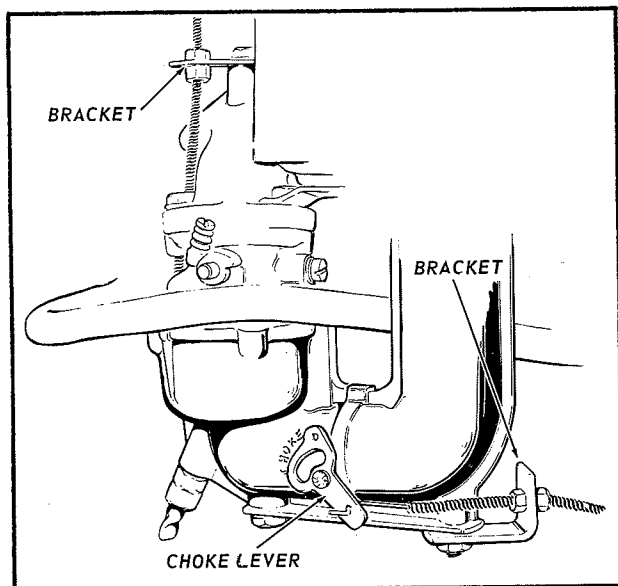

Fig. 13

## STARTING ENGINE- MANUAL

1. Place gear shift lever in neutral position. See figure 12. (Be sure tractor is on level ground and will not roll away.)
2. Pull lift lever handle all the way back and raise seat all the way up.
3. Place choke lever in "CHOKE" position. See figure 12 & 13.
4. Place throttle lever in mid position and turn ignition key to "ON" position. See figure 12.
5. Engage starter rope knot in groove on starter pulley and wind rope around pulley in a clockwise direction. See figure 14. Pull starter rope upwards, rapidly and firmly to start engine. As engine warms up, return choke lever to "RUN" position.

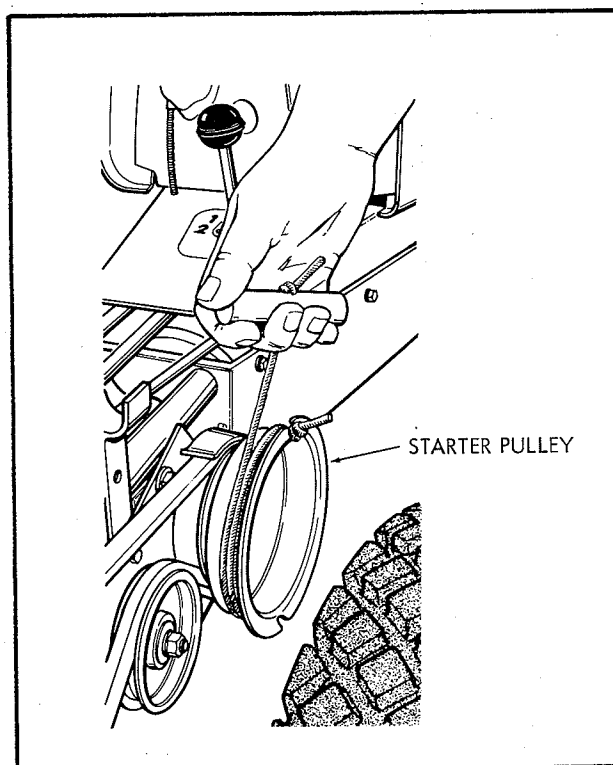

Fig. 14

## TO STOP ENGINE

With clutch disengaged, place gear shift in any gear and turn ignition key to "OFF" position. Engage clutch to hold tractor in parked position and remove ignition key for safekeeping. Apply parking brake!

## OPERATION OF TRACTOR

To place gear shift in desired gear range, depress the combination brake and clutch pedal located on right hand side of tractor. See figure 15. When pedal is depressed move shift lever to desired position (see figure 12) and gradually release pedal until clutch is engaged. When shifting from one range to another, pause briefly in neutral before completing shift. Set throttle lever to obtain desired speed. See figure 12.

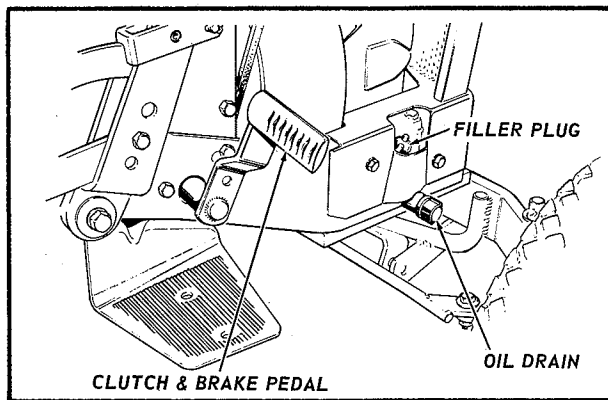

Fig. 15

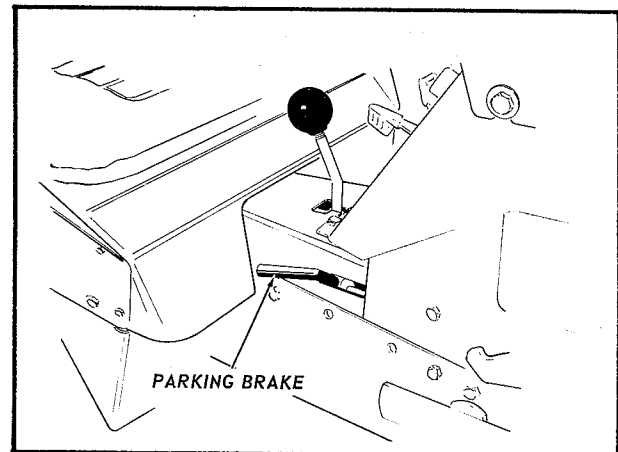

Fig. 16

## PARKING BRAKE

To operate the parking brake, hold the brake pedal depressed and slide the parking brake lever all the way to the rear of its slot and turn the lever in a clockwise direction until it is tight. Refer to Figure 16.

To release the parking brake, turn the parking brake lever in a counter-clockwise direction until the brake pedal is released.

## CLUTCH ADJUSTMENT

Position the set collar on the clutch rod to compress the spring about  $5/8$ ". Then position the locknuts to leave a space of about  $3/4$ " between them and the end of the rod guide. Check to see that when the pedal is operated, the spring is completely decompressed at the moment the locknuts engage the end of the rod guide. Refer to Figure 17.

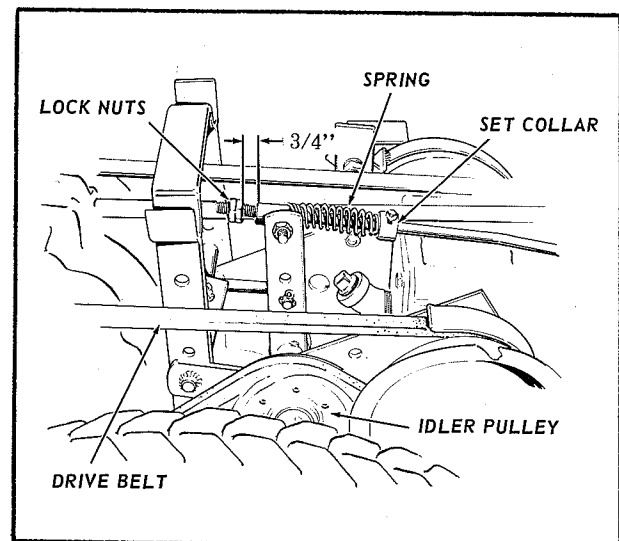

Fig. 17

## BRAKE ADJUSTMENT

Pull the brake band up by hand so that it is tight around the brake drum. Adjust the hex screw to give a clearance of about  $3/4$ " between the brake band and the screw head. Then check to see that the idler pulley releases the belt properly before the brake is applied. If the brake does not hold properly when the pedal is pushed all the way forward, reduce slightly the spacing between the head of the hex bolt and the brake band. Now recheck the clutch rod adjustment for proper idler release. Refer to Figure 18.

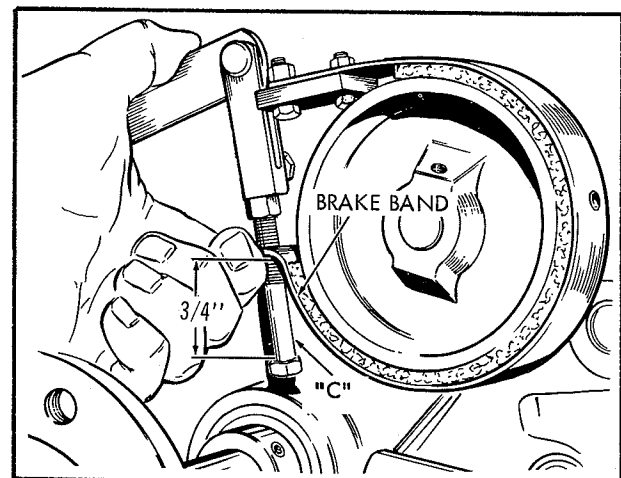

Fig. 18

## POWER TAKE-OFF

For operation of Rotary Mower and Sickle Bar attachments, a power take-off attachment is required. This consists of the power take-off assembly, "V" pulley for bevel gear shaft, drive belt, belt guard, and belt stop packaged in one carton.

For ease of attachment follow the steps outlined below.

1. Mount "V" pulley to shaft of bevel gear assembly (see figure 1) and secure in place with key and set screw. Hub of "V" pulley is to face inward. Place drive belt on "V" pulley and mount belt guard support to inside surface of side plate nearest drive pulley. See figure 5 for mounting bolt location. Attach the belt guard to the guard support as shown in figure 1. Allow approximately 3/16" clearance between belt and guard.

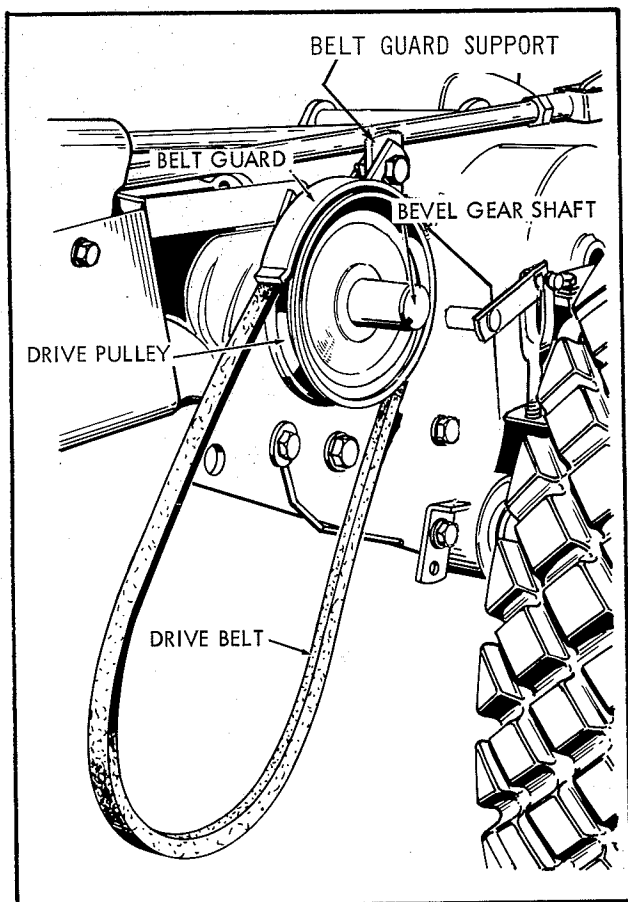

Fig. 1

2. Holding the power take-off assembly in left hand as shown in figure 2, position the tube of the drive bracket assembly between the bevel gear housing side plates. Align the holes in side plates with the hole in drive bracket assembly tube and insert pivot pin through holes in side plates and drive bracket assembly tube.

3. Push pivot pin through the holes in bracket and tube until the position of cotter pin hole in pivot pin is as shown in figure 3. Secure in position with cotter pin furnished.

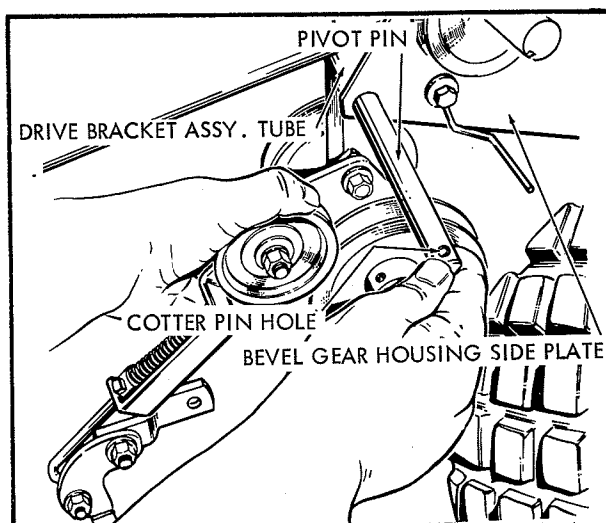

Fig. 2

4. Remove hex cap screw "D" from frame of tractor and mount bracket in place under lift lever quadrant. See figure 4. Position the pivot bar assembly flush against bottom of lift quadrant and re-install hex cap screw and tighten securely. Check alignment of drive pulley on bevel gear shaft, driven pulley of power take-off, and idler pulley, and adjust driving pulley if necessary.

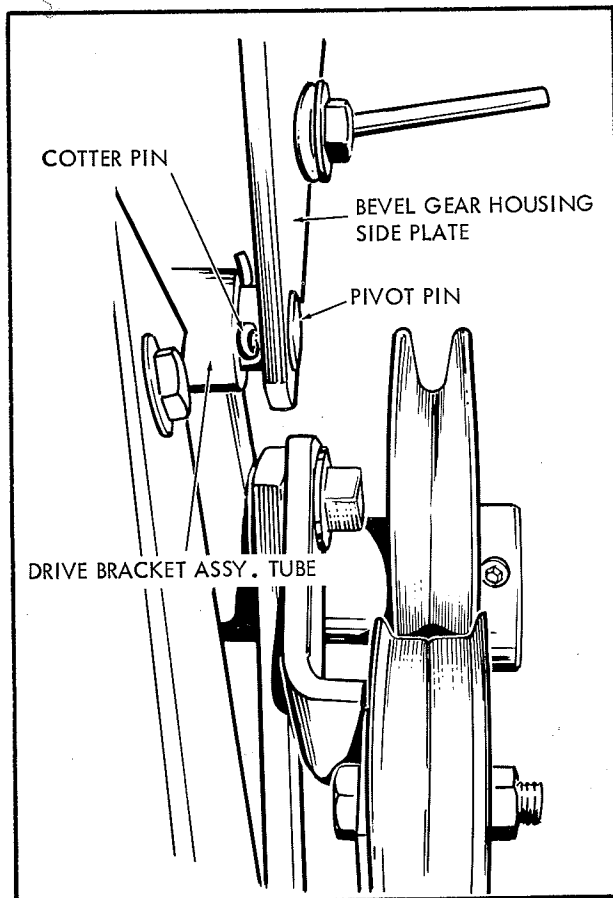

Fig. 3

5. Mount "V" belt in place on driven pulley as shown in figure 5 and attach spring to bottom hole in the spring holder and hook other end of the spring to the idler lever spring holder. Mount belt stop as shown with 3/8" bolt, flat washer, lockwasher and hex nut. When idler pulley is engaged, 1/8" clearance between belt stop and back of "V" belt is required. Note: "V" belt runs under idler pulley. See figure 5.

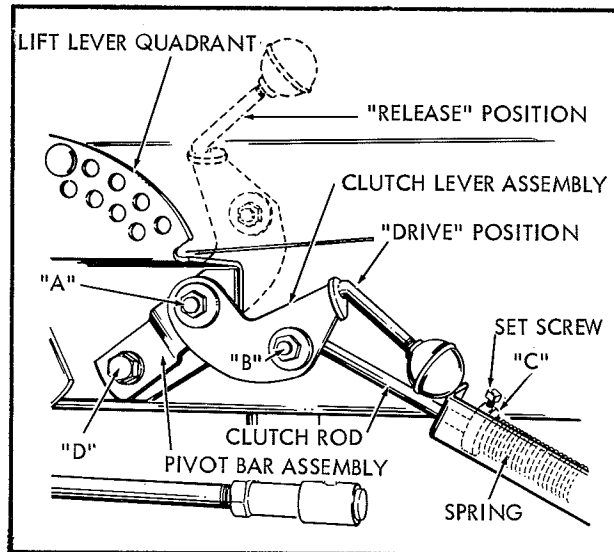

Fig. 4

#### LUBRICATION

The power take-off is lubricated by means of one grease fitting located on the bottom front of the drive bracket assembly. Occasionally apply grease by means of a standard grease gun loaded with automotive type grease. Be sure to wipe dirt and grit from grease fitting before applying grease gun. Lubricate all pivot points and idler pulley bearings with SAE 20 oil every few hours of operation.

#### OPERATION

Operation of the power take-off is controlled by movement of the clutch lever assembly. See figure 4. When the clutch lever is in the forward raised position, the clutch rod releases the tension holding the idler pulley against the drive belt, and power will not be transmitted to the driven pulley of the power take-off assembly. When the clutch lever is in the back, depressed position, the clutch rod applies tension to the idler pulley and as the idler pulley takes-up the slack in the drive belt, power is transmitted from the drive pulley on bevel gear box shaft to the driven pulley of the power take-off. Figure 4 shows clutch lever in drive position.

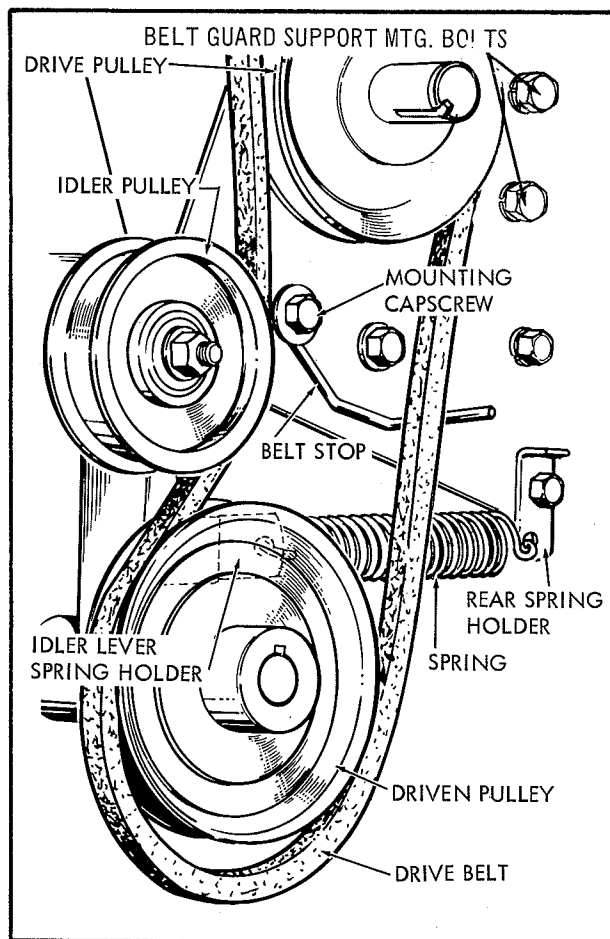

Fig. 5

#### ADJUSTMENT

At points "A" and "B" of figure 4, check tightness of hex nut to be sure that clutch lever assembly and clutch rod are free to pivot without binding.

Place clutch lever in "drive" position and observe clearance between collar "C" (figure 4) and end of bracket. This clearance should normally be approximately 3/4 inch; at this setting the idler pulley should be snugly against the drive belt. If additional tension is required, release clutch lever and loosen set screw on collar and slide collar farther back on clutch rod. Retighten set screw in collar and put clutch lever in drive position. Recheck clearance. The tension of the idler pulley against the drive belt must be sufficient to operate whichever tractor attachment is being used. Any additional tension is unnecessary and will only cause premature failure of belts and idler pulley bearings.



## GUARANTEE

The Company guarantees Simplicity Products to be free from defects in material and workmanship. Any part proven defective within one year, under normal use, from date of purchase, (except tires, engines, and engine accessories which, usually are warranted by their respective manufacturers), will be replaced free of charge, f.o.b. Port Washington, Wisconsin, provided such part is returned to factory transportation charges prepaid, and if upon examination at the factory found to be defective. The Company is not obligated under this guarantee to bear cost of labor or delivery charges in replacement of defective parts. This guarantee does not apply to any Simplicity Products altered outside of Simplicity's factory. We reserve the right to change construction, specifications, prices and terms, without notice and without obligation as to equipment heretofore shipped.

This form is to be used in lieu of the Registration (Warranty) Card.

Should warranty service be necessary, the information below should be presented to the authorized SIMPLICITY Dealer.

Customer's Name \_\_\_\_\_

Address \_\_\_\_\_

Mfg. No. \_\_\_\_\_ Serial No. \_\_\_\_\_

Date Purchased \_\_\_\_\_

Purchased From \_\_\_\_\_

Address \_\_\_\_\_

Engine Model No. \_\_\_\_\_ Serial No. \_\_\_\_\_ Type No. \_\_\_\_\_

To obtain replacement parts from dealer, advise quantity, part number and description.

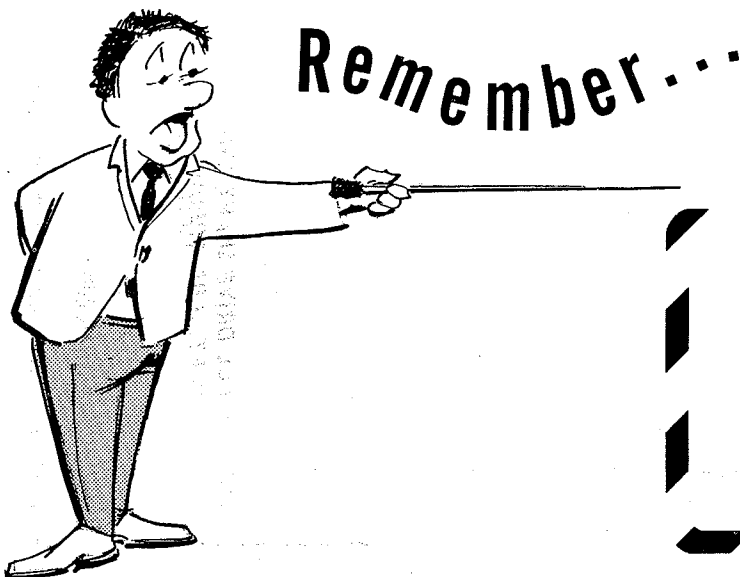

Remember...

### FOR YOUR SAFETY

1. ALWAYS STOP ENGINE BEFORE LEAVING MACHINE
2. ALWAYS STOP ENGINE BEFORE SERVICING OR ADJUSTING MACHINE OR EQUIPMENT
3. ALWAYS KEEP HANDS, FEET AND CLOTHING AWAY FROM POWER-DRIVEN PARTS

# ENGINE AND DRIVE SHAFT

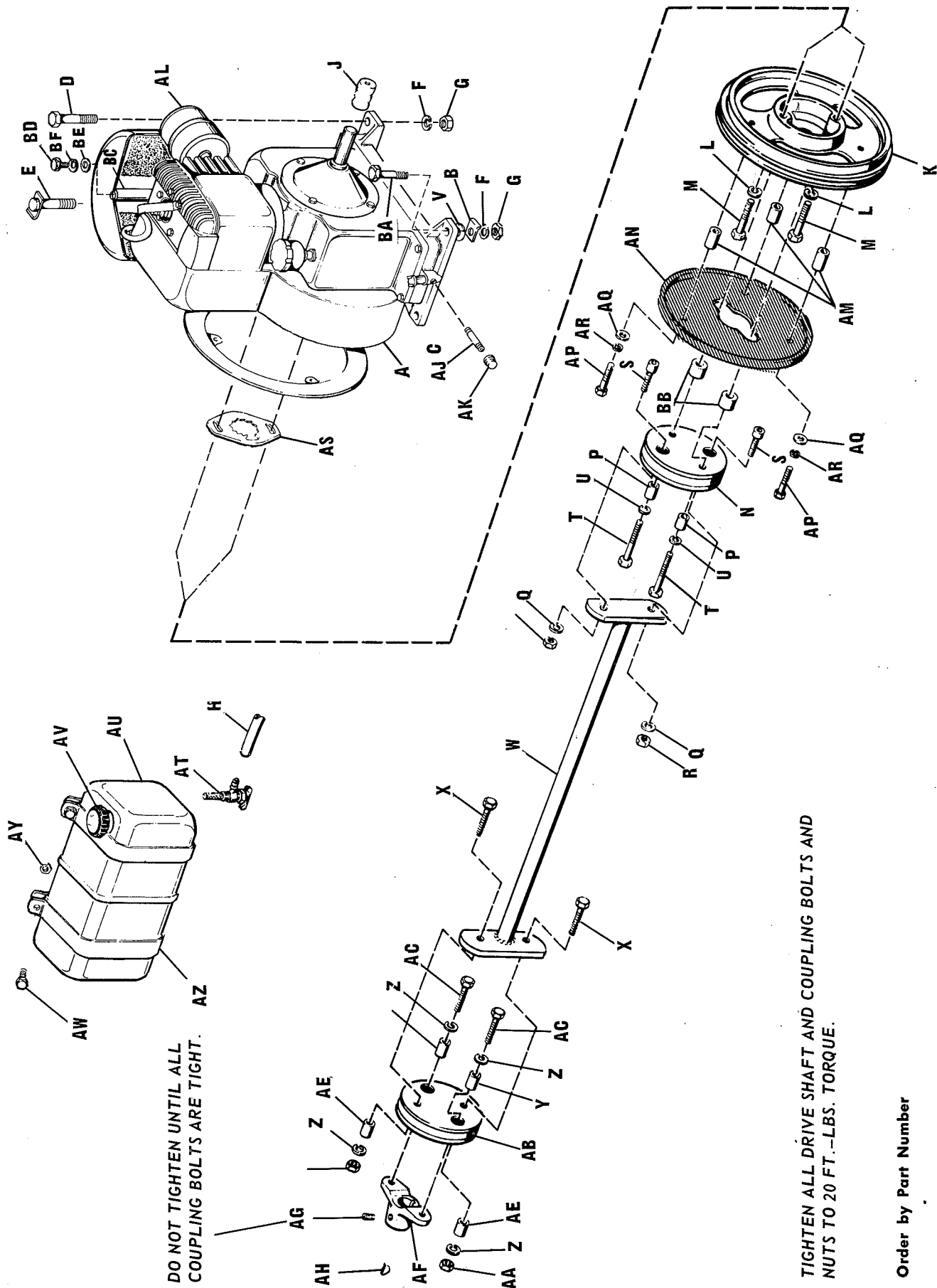

# ENGINE AND DRIVE SHAFT

Order by Part Number

Reference Letter	Part No.	Description
A	157095	Engine Briggs & Stratton 9HP Model-23D <sup>1</sup> , Type-0129-01
B	157144	Locknut, Control
C	157099	Spacer, Engine
D	705006	Screw, Cap, Hex., 3/8" - 16 N. C. x 2" lg.
E	154315	Screw Assembly, Engine, L. H. Rear
F	720002	Washer, Lock, 3/8"
G	717003	Nut, Hex., Full, 3/8" - 16 N. C.
H	157097	Hose, Fuel (flexible)
J	154327	Guard, Crankshaft Extension
K	157023	Pully, Engine
L	720001	Washer, Lock, 5/16"
M	715025	Screw, Cap, Hex., 5/16" - 18 N. C. x 1-3/4" lg.
N	154194	Coupling Assembly
P	154192	Spacer
Q	720002	Washer, Lock, 3/8"
R	717003	Nut, Hex., Full, 3/8" - 16 N. C.
S	715047	Screw, Socket Hd., 3/8"-16 x 1" lg.
T	705006	Capscrew, Hex Hd., 3/8"-16 x 2" lg.
U	720002	Washer, Lock, 3/8"
V	719001	Washer Plain 3/8"
W	157016	Shaft Assembly, Drive
X	705009	Screw, Cap, Hex., 3/8" - 16 N. C. x 1-1/2" lg.
Y	154192	Spacer
Z	720002	Washer, Lock, 3/8"
AA	717003	Nut, Hex., Full, 3/8" - 16 N. C.
AB	154194	Coupling Assembly
AC	705009	Screw, Cap, Hex., 3/8" - 16 N. C. x 1-1/2" lg.
AD	720002	Washer, Lock, 3/8"
AE	154192	Spacer
AF	154198	Flange, Drive Shaft
AG	715049	Screw, Set, Cup Point, Socket Head, 3/8 - 24 x 5/8" lg.
AH	725504	Key, Hi-Pro
AJ	154350	Nipple, Pipe, 3/8" Std. x 2" lg.
AK	726501	Cap, Pipe, 3/8" Std.
AL	154379	Muffler, Exhaust
AM	154485	Spacer
AN	154477	Screen, Engine
AP	705008	Screw, Cap, Hex. 1/4" - 20 NC. x 1-1/4" lg.
AQ	719007	Washer, Plain
AR	720003	Washer, Lock
AS	154292	Nut, Lock
AT	156176	Shut-Off Valve
AU	157006	Fuel Tank
AV	156175	Fuel Tank Cap
AW	705053	Capscrew, Hex Hd., 1/4"-20 x 1-3/4" lg.
AY	717005	Hex Nut, Full, 1/4"-20
AZ	157002	Strap, Tank.
BA	705006	Capscrew, Hex hd., 3/8" - 16 x 2" lg.
BB	157081	Spacer
BC	157126	Spacer, Air Cleaner
BD	715018	Capscrew, Hex Hd., 1/4"-20 x 5/8" lg.
BE	719006	Plain Washer, 1/4"
BF	720003	Lock Washer, 1/4"

## REAR LIFT DRAW BAR GROUP

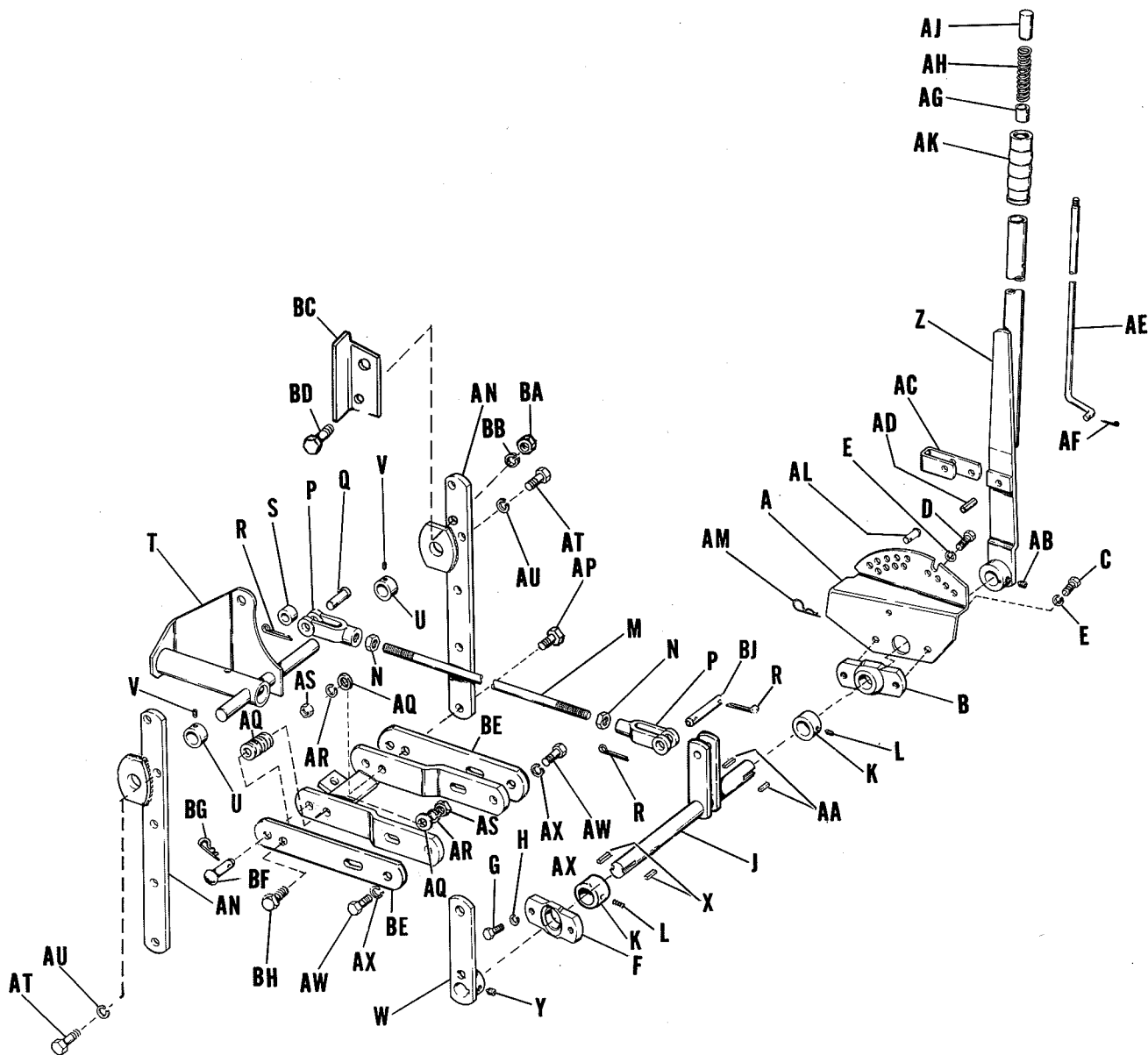

### Order by Part Number

## REAR LIFT AND DRAW BAR GROUP

Order by Part Number

Reference Letter	Part No.	Description
A	154209	Quadrant, Lift Lever
B	154210	Bearing, Lift Lever
C	705031	Screw, Cap, Hex., 3/8" - 16 N. C. x 7/8" lg.
D	705016	Screw, Cap, Hex., 3/8" - 16 N. C. x 1-1/4" lg.
E	720002	Washer, Lock, 3/8"
F	154210	Bearing, Lift Lever
G	705031	Screw, Cap, Hex., 3/8" - 16 N. C. x 7/8" lg.
H	720002	Washer, Lock, 3/8"
J	157105	Shaft Assembly, Lift
K	8211005	Collar, Set
L	713503	Screw, Set, Cup Point, Socket Head, 5/16" - 18 N. C. x 5/16" lg.
M	154213	Rod, Rear Lift
N	717008	Nut, Hex., Full, 1/2" - 20 N. C.
P	154304	Yoke End, Adj.
Q	154305	Pin, Yoke
R	722006	Pin, Cotter, 1/8" x 1" lg.
S	105051	Spacer
T	154214	Lift Assembly, Tiller
U	8021010	Collar, Set
V	713503	Screw, Set, Cup Point, Socket Head, 5/16" - 18 N. C. x 5/16" lg.
W	157078	Lever Assembly, Front Lift
X	157120	Key
Y	713502	Screw, Set, Cup Point, Socket Head, 5/16" - 18 N. C. x 1/4" lg.
Z	157012	Lever Assembly, Lift
AA	157120	Key
AB	713502	Screw, Set, Cup Point, Hollow Head, 5/16" - 18 N. C. x 1/4" lg.
AC	154224	Latch, Lift Lever
AD	723007	Pin, Roll
AE	154225	Rod, Latch
AF	722001	Pin, Cotter, 3/32" x 3/4" lg.
AG	154226	Spacer
AH	152006	Spring
AJ	154227	Button, Thumb
AK	156209	Grip, Handle
AL	153058	Pin
AM	8161045	Clip, Spring
AN	154200	Arm Assembly
AP	705039	Hex Capscrew, 7/16"-14 x 1-1/2" lg.
AQ	719001	Washer, Plain, 3/8"
AR	720006	Washer, Lock, 3/8"
AS	717002	Nut, Hex., Full, 7/16"
AT	705041	Screw, Cap, Hex., 7/16" - 14 N. C. x 1" lg.
AU	720006	Washer, Lock, 7/16"
AV	154202	Bar Assembly, Draw
AW	705042	Hex Capscrew, 7/16"-14 x 1-1/4" lg.
AX	720006	Washer, Lock, 7/16"
BA	717001	Nut, Full, Hex. 5/16"
BB	720001	Washer, Lock 5/16"
BC	154422	Stop, Seat
BD	705001	Screw, Cap, Hex. 5/16" - 18 N. C. x 7/8" lg.
BE	157091	Pull Bar
BF	155037	Pin, Round Head
BG	8161045	Spring Clip
BH	705047	Hex Capscrew, 7/16"-14 x 1-3/4" lg.
BJ	157110	Pin

# FRAME, HOOD, GRILL, INST. PANEL & STEERING POST

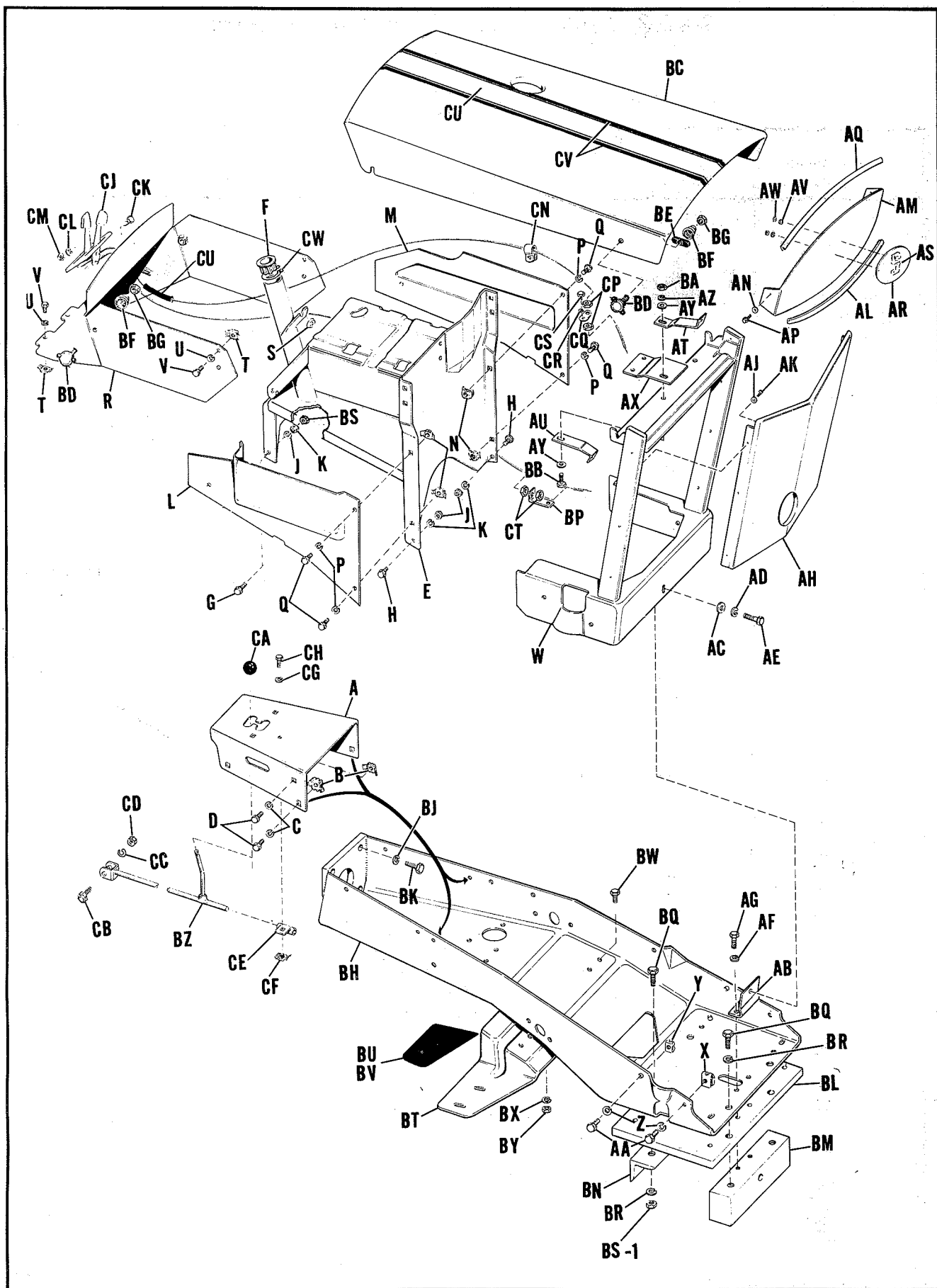

# FRAME, HOOD, GRILL, INST. PANEL & STEERING POST

Order by Part Number

Ref. Letter	Part No.	Description
A	157092	Frame Cover
B	718032	Retainer Nut
C	720003	Lock Washer, 1/4"
D	715018	Hex Capscrew, 1/4"-20 x 5/8" lg.
E	157068	Support Assembly, Fuel Tank & Steering Post
F	157077	Bushing, Steering
G	705019	Hex Capscrew, 5/16"-18 x 1-1/4" lg.
H	705012	Hex Capscrew, 5/16"-18 x 5/8" lg.
J	720001	Lock Washer, 5/16"
K	717001	Hex Nut, Full, 5/16"-18
L	157082	Panel, R.H. Side
M	157058	Panel, L.H. Side
P	720003	Lock Washer, 1/4"
Q	715018	Hex Capscrew, 1/4"-20 x 5/8"
R	157063	Dash Assembly
S	718033	Nut, Flange, "Whiz-Lock", 5/16"-18
T	718032	Nut Retainer
U	720003	Lock Washer, 1/4"
V	715018	Hex Capscrew, 1/4"-20 x 5/8" lg. Grade 5
W	157010	Cover & Tube Assembly
X	718022	Nut Retainer ( Front )
Y	718030	Nut Retainer ( Rear )
Z	720001	Lock Washer, 5/16"
AA	715048	Hex Capscrew, 5/16"-18 x 3/4" lg. Grade 5
AB	157103	Bracket Assembly
AC	719002	Plain Washer, 5/16"
AD	720001	Lock Washer, 5/16"
AE	705019	Hex Capscrew, 5/16"-18 x 1-1/4" lg.
AF	720001	Lock Washer, 5/16"
AG	705018	Hex Capscrew, 5/16"-18 x 1-1/2" lg.
AH	157076	Front Grille
AJ	719007	Plain Washer, 3/16"
AK	714003	Screw, Self-Tap, Recessed Hex Hd., #10 Dia. x 1/2" lg.
AL	157115	Trim, Lower Grille
AM	157061	Grille, Top
AN	719007	Plain Washer, 3/16"
AP	714003	Screw, Self-Tap, Recessed Hex Hd., #10 Dia. x 1/2" lg.
AQ	157114	Trim, Upper Grille
AR	157071	Support Assembly, Emblem
AS	157074	Film, Front Emblem
AT	157111	Brace, Upper Grille ( Top )
AU	157112	Brace, Upper Grille ( Bottom )
AV	720007	Lock Washer, #12
AW	717023	Nut, Full, Hex, #10-24
AX	157104	Bracket, Grille
AY	719006	Plain Washer, 1/4"
AZ	720003	Lock Washer, 1/4"
BA	717005	Nut, Full, Hex, 1/4"-20
BB	715051	Hex Capscrew, 1/4"-20 x 1" lg.
BC	157064	Hood
BD	156309	Tee Handle Assy.
BE	157101	Nut
BF	157127	Spring, Conical
BG	717511	Lock Nut, Full, Hex, 5/16"-18
BH	157085	Frame Assembly
BJ	720006	Lock Washer, 7/16"
BK	706003	Hex Capscrew, 7/16"-20 x 1-1/2"
BL	157057	Weight, Base
BM	157060	Support
BN	157054	Angle, Frame, Rear
BP	157108	Clamp
BQ	706003	Hex Capscrew, 7/16" 20 x 1-1/2" lg.
BR	720006	Lock Washer, 7/16"
BS	717511	Hex Locknut, 5/16"-18

# FRAME, HOOD, GRILL, INS. PANEL & STEERING POST (cont.)

Order by Part Number

Ref. Letter	Part No.	Description
BS-1	717022	Hex Nut, Full, 7/16"-14
BT	157065	Foot Rest
BU	157090	Pad, Foot Rest, L.H.
BV	157089	Pad, Foot Rest, R.H.
BW	705004	Hex Capscrew, 3/8"-16 x 3/4" lg.
BX	720002	Lock Washer, 3/8"
BY	717003	Hex Nut, Full, 3/8"-16
BZ	157055	Rod Assembly, Shifter
CA	8021050	Ball
CB	705018	Hex Capscrew, 5/16"-18 x 1/2" lg.
CC	720001	Lock Washer, 5/16"
CD	717001	Hex Nut, Full, 5/16"-18
CE	157020	Guide Assembly, Shift Rod
CF	718032	Nut Retainer
CG	720003	Lock Washer, 1/4"
CH	715018	Hex Capscrew, 1/4"-20 x 5/8" lg. Grade 5
CJ	157098	Control, Dual, Throttle & Choke
CK	705025	Hex Capscrew, 1/4"-20 x 1-1/2" lg.
CL	720003	Lock Washer, 1/4"
CM	717005	Hex Nut, Full, 1/4"-20
CN	157108	Clip, Choke Cable
CP	718003	Locknut, Control
CQ	157106	Clip, Throttle Cable
CR	720003	Lock Washer, 1/4"
CS	714016	Screw, Self-tap 1/4-20NC x 1/2 lg.
CT	718003	Locknut, Control
CU	157124	Strip, Center (1)
CV	157125	Strip, Side (2)
CU -I	157192	Insulator
CW	157241	Snap Ring



## SEAT AND FENDERS

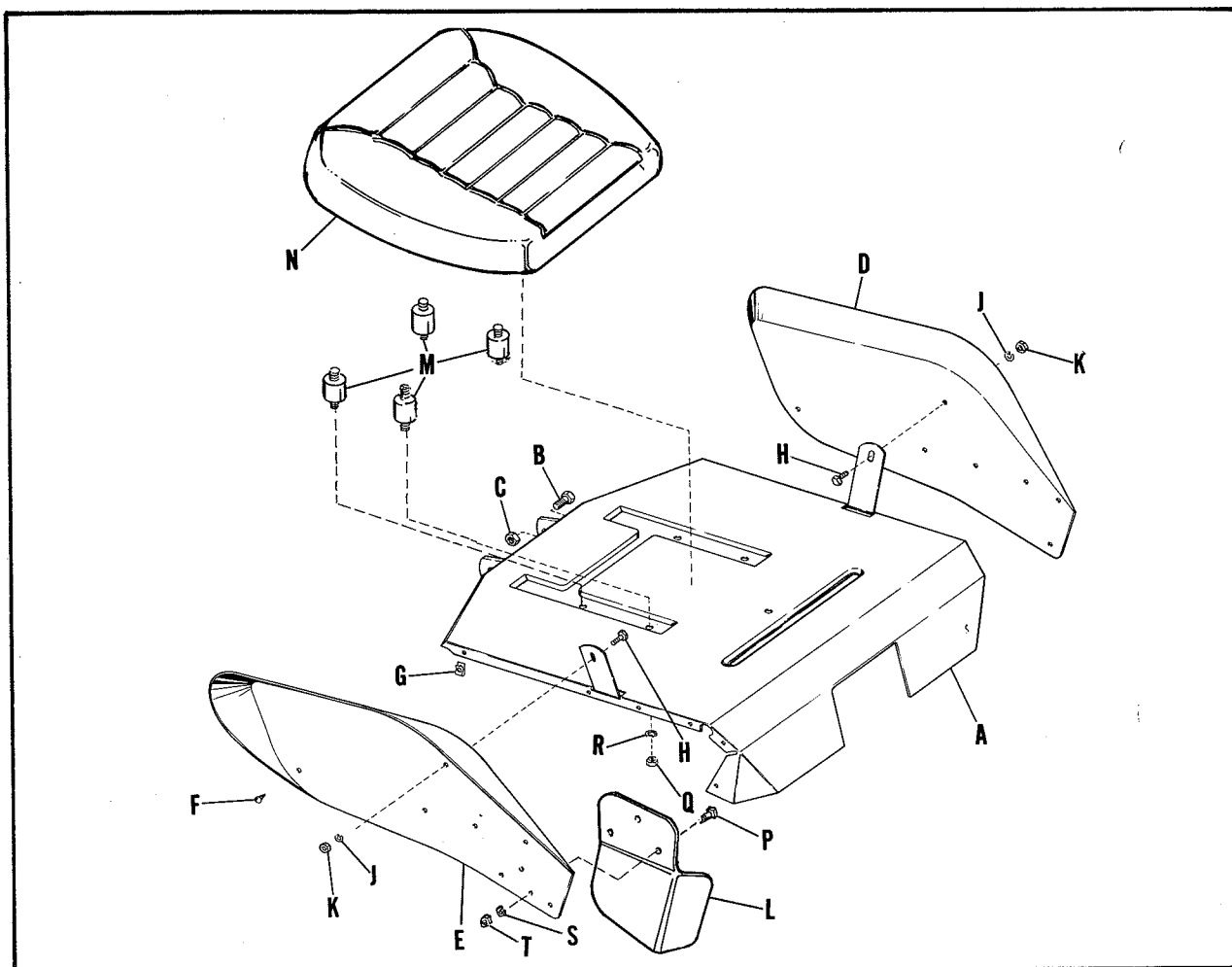

### Order by Part Number

Reference Letters	Part No.	Description
A	154471	Cover and Seat Pivot Assembly
B	705031	Screw, Cap, Hex. , 3/8" - 16 N. C. x 7/8" lg.
C	717510	Nut, Lock, Full, Hex. , 3/8" - 16 N. C.
D	157083	Fender, L. H.
E	157049	Fender, R. H.
F	714003	Screw, Self Tapping, #10 x 1/2" lg.
G	718019	Nut, Speed, Tinnerman
H	705002	Screw, Cap, Hex. , 1/4" - 20 N. C. x 1/2" lg.
J	720003	Washer, Lock, 1/4"
K	717005	Nut, Hex. , Full, 1/4" - 20 N. C.
L	154475	Guard, Starter, Cup
M	157094	Connector Cushion
N	156203	Seat Assembly
P	705030	Capscrew, Hex Hd., 1/4"-20 x 3/4" lg.
Q	717001	Hex Nut, Full, 5/16"-18
R	720001	Lock Washer, 5/16"
S	720003	Lock Washer, 1/4"
T	717005	Hex Nut, Full, 1/4"-20

# REAR WHEELS AND AXLE

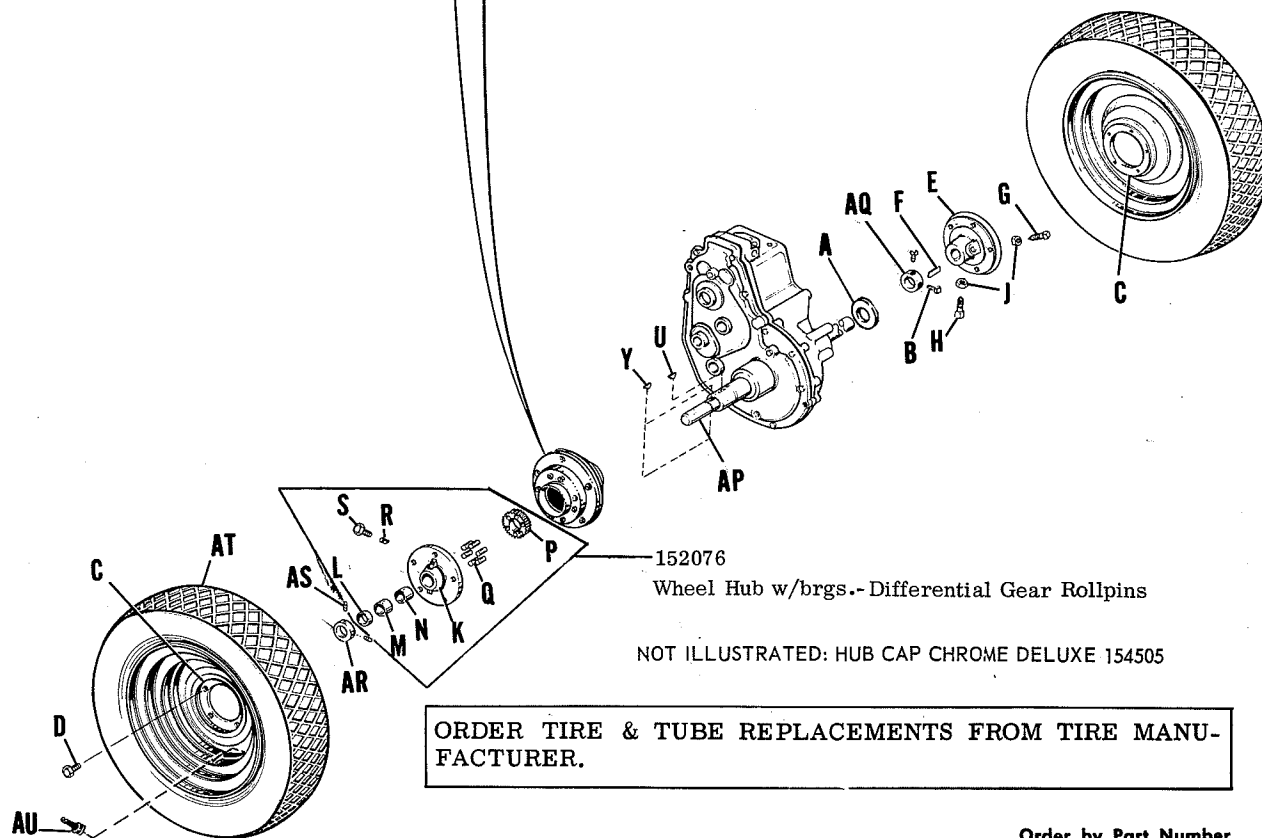
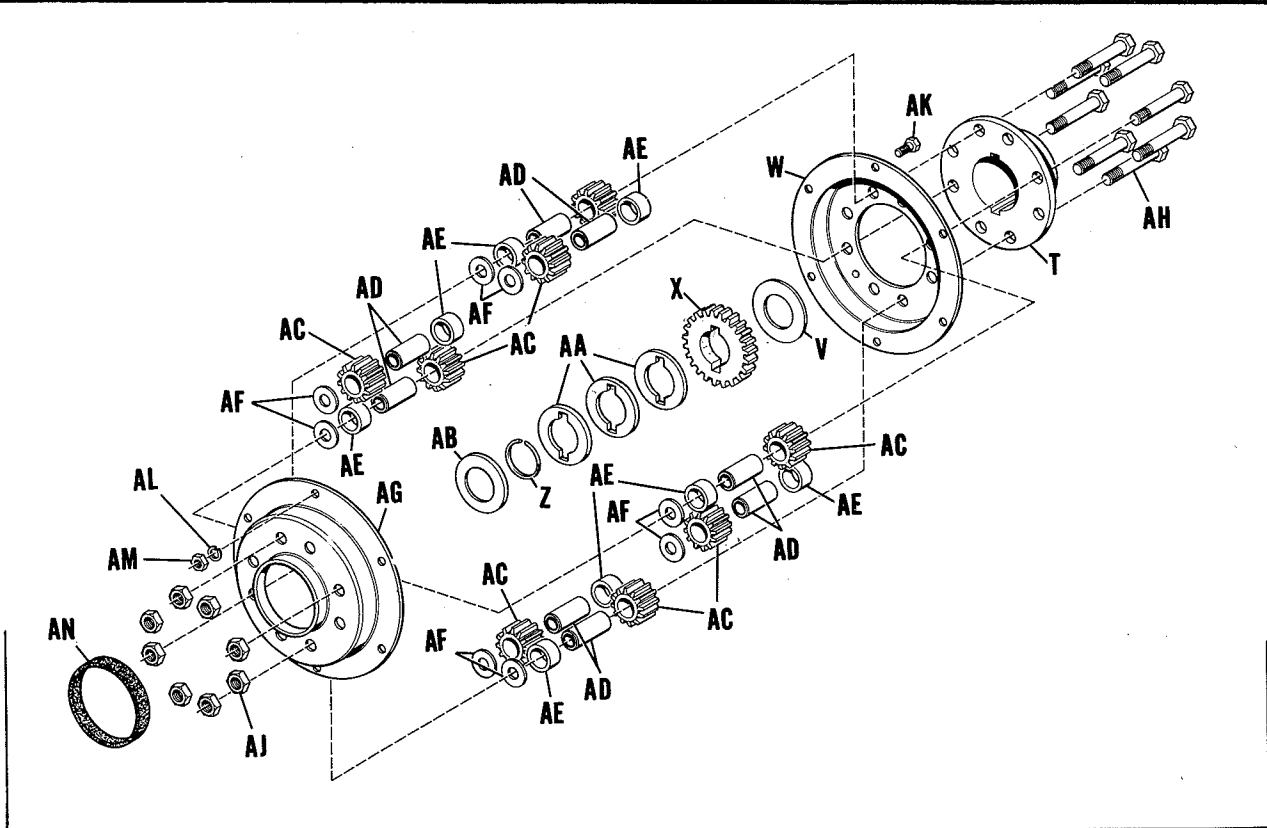

## REAR WHEELS AND AXLE

Order by Part Number

Reference Letter	Part No.	Description
A	105050	Washer
B	713006	Screw, Set, Cup Pt. Sq. Hd., 5/16"-18 NC x 1/2" lg.
C	157025	Drive Wheel
D	8261100	Bolt, Hub
E	154208	Hub, Wheel, L. H.
F	8061100	Key
G	715022	Screw, Set, Sq. Hd., Cone, 3/8" - 16 N. C. x 1-1/2" lg.
H	713004	Screw, Set, Sq. Hd., Cup, 3/8" - 16 N. C. x 1" lg.
J	717021	Nut, Hex., Jam, 3/8" - 16 N. C.
K	152040	Hub, Wheel, R. H.
L	105058	Bearing
M	152041	Bearing, Nylon
N	153068	Bearing
P	154400	Gear, Differential
Q	723003	Pin, Roll
R	152042	Plug, Nylon
S	8261100	Bolt, Control traction
T	157119	Differential Carrier
U	157120	Key, Drive
V	154035	Washer, Axle
W	121149	Cover, Differential
X	121312	Gear, Differential
Y	725501	Key, Hi-Pro
Z	154291	Ring, Retaining
AA	153077	Washer, Axle
AB	154277	Washer, Axle
AC	121311	Pinion, Differential
AD	121083	Spindle, Pinion Differential
AE	121084	Spacer, Differential
AF	719002	Washer, Plain
AG	151022	Cover, Differential
AH	705003	Screw, Cap, Hex., 3/8" - 16 N. C. x 2-1/4" lg.
AJ	717510	Nut, Lock, Full Hex., 3/8" - 16 N. C.
AK	705002	Screw, Cap, Hex., 1/4" - 20 N. C. x 1/2" lg.
AL	720003	Washer, Lock, 1/4"
AM	717005	Nut, Full, Hex., 1/4" - 20 N. C.
AN	121190	Seal, Differential Cover
AP	157026	Rear Axle r
AQ	154065	Collar, Axle
AR	154065	Collar, Axle
AS	713503	Screw, Set, Cup Point, Hollow Head, 5/16" - 18 N. C. x 5/16" lg.
	157024	Tire
	157029	Valve Stem

### CAUTION

Do not exceed 25 ft. lbs. torque on "S" 8261100 Control Traction Bolts.

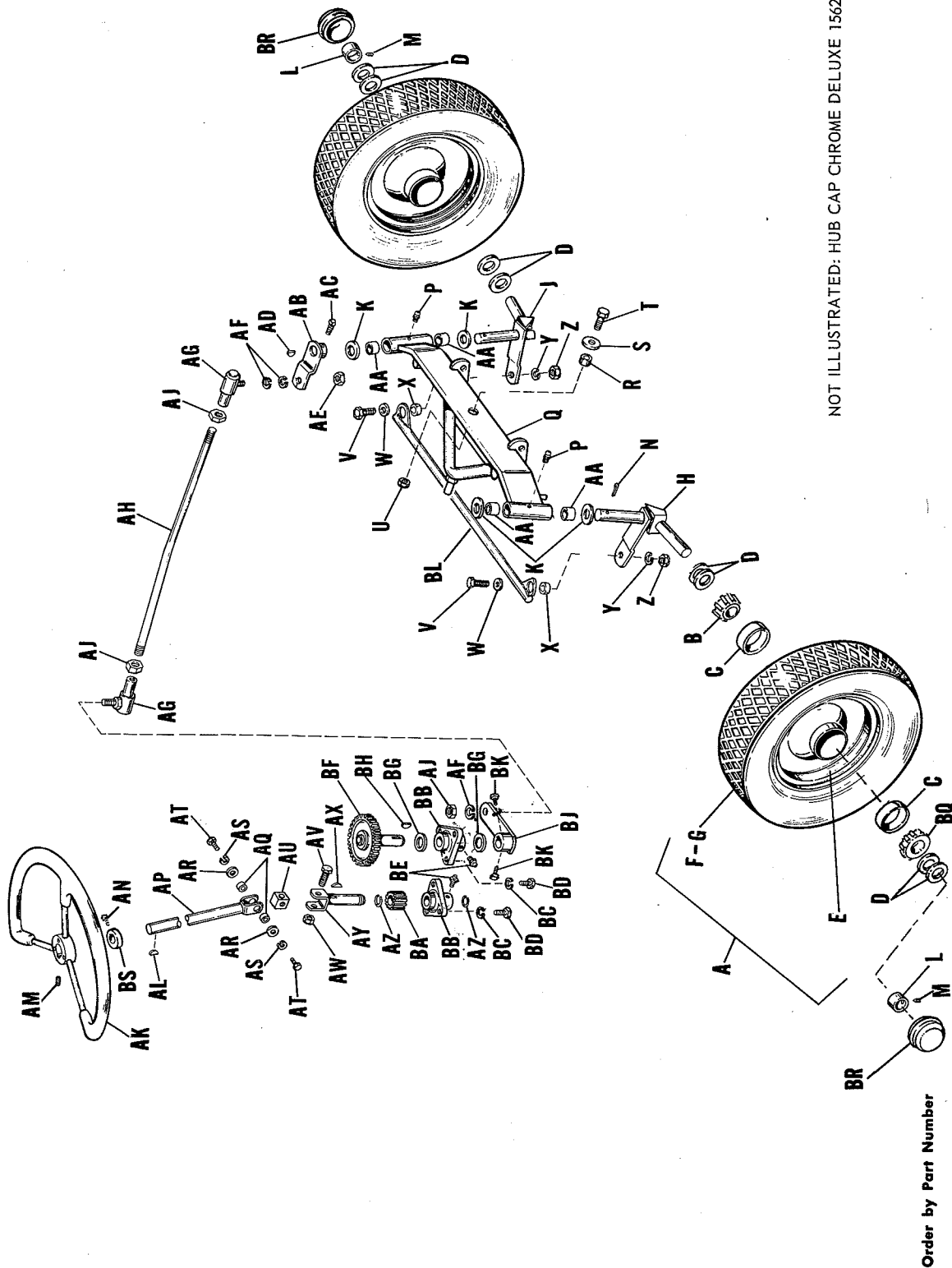

## FRONT WHEELS, AXLE, TIE ROD & STEERING

# FRONT WHEELS, AXLE, TIE ROD & STEERING

Order by Part Number

Reference Letter	Part No.	Description
A	154395	Wheel and Tire Assembly
B	154397	Cone, Bearing, w/seal
C	154393	Bearing Cup,
D	108181	Washer
E	154427	Wheel w/bearing cup
F	153037	Tire, 4.80/4.00
G	153038	Tube, 4.00 - 8
H	154168	Spindle Assembly, R. H.
J	154163	Spindle Assembly, L. H.
K	108181	Washer
L	8021010	Collar, Set
M	713502	Screw, Set, Cup Point, Socket Head, 5/16" - 18 N. C. x 1/4" lg.
N	722007	Pin, Cotter, 3/16" x 1-1/2" lg.
P	727002	Fitting, Grease
Q	154255	Axle Assembly, Front
R	154182	Spacer
S	719004	Washer, Plain, 1/2"
T	705037	Screw, Cap, Hex., 1/2"-13 x 1" lg.
U	717518	Nut, Hex., Full, Lock, 1/2" - 13 N. C.
V	705016	Screw, Cap, Hex., 3/8" - 16 N. C. x 1-1/4" lg.
W	719001	Washer, Plain, 3/8"
X	154177	Spacer
Y	720002	Washer, Lock, 3/8"
Z	717003	Nut, Hex., Full, 3/8" - 16 N. C.
AA	154289	Bearing
AB	154172	Arm Assembly, Steering, L. H.
AC	713006	Screw, Set, Cup Point, Square Head, 5/16" - 18 N. C. x 1/2" lg.
AD	725504	Key, Hi-Pro
AE	717008	Nut, Hex., Full 1/2" - 20 N. C.
AF	720004	Washer, Lock, 1/2"
AG	154301	Joint, Ball
AH	157140	Rod, Tie
AJ	717014	Nut, Jam, 1/2" - 20 N. F.
AK	157113	Wheel, Steering
AL	725003	Key, Woodruff #9
AM	713503	Screw, Set, Cup Point, Socket Head, 5/16" - 18 N. C. x 5/16" lg.
AN	713502	Set Screw, Socket Hd., 5/16"-18 x 1/4" lg.
AP	154432	Shaft Assembly, Steering
AQ	153081	Spacer
AR	719001	Washer, Plain, 3/8"
AS	720002	Washer, Lock, 3/8"
AT	715030	Screw, Cap, Hex., 3/8" - 16 N. C. x 3/4" lg.
AU	154153	Pin, Universal Joint
AV	715026	Screw, Cap, Hex., Head, Special
AW	717511	Nut, Lock, Full, Hex., 5/16" - 18 N. C.
AX	725003	Key, Woodruff #9
AY	154154	Shaft Assembly, Steer, Pin
AZ	154264	Ring, Retaining
BA	154156	Pinion
BB	154157	Bearing, Steering Gear
BC	720001	Washer, Lock, 5/16"
BD	705012	Screw, Cap, Hex., 5/16" - 18 N. C.
BE	727002	Fitting, Grease, #1641
BF	154158	Gear Assembly, Steering
BG	8061012	Washer
BH	725003	Key, Woodruff #9
BJ	154161	Arm Assembly, Steering
BK	713006	Screw, Set, Cup Point, Square Head, 5/16" - 18 N. C. x 1/2" lg.
BL	154175	Drag Link
BQ	154486	Bearing, Outside.
BR	154487	Cap, Hub.
BS	8021010	Set Collar

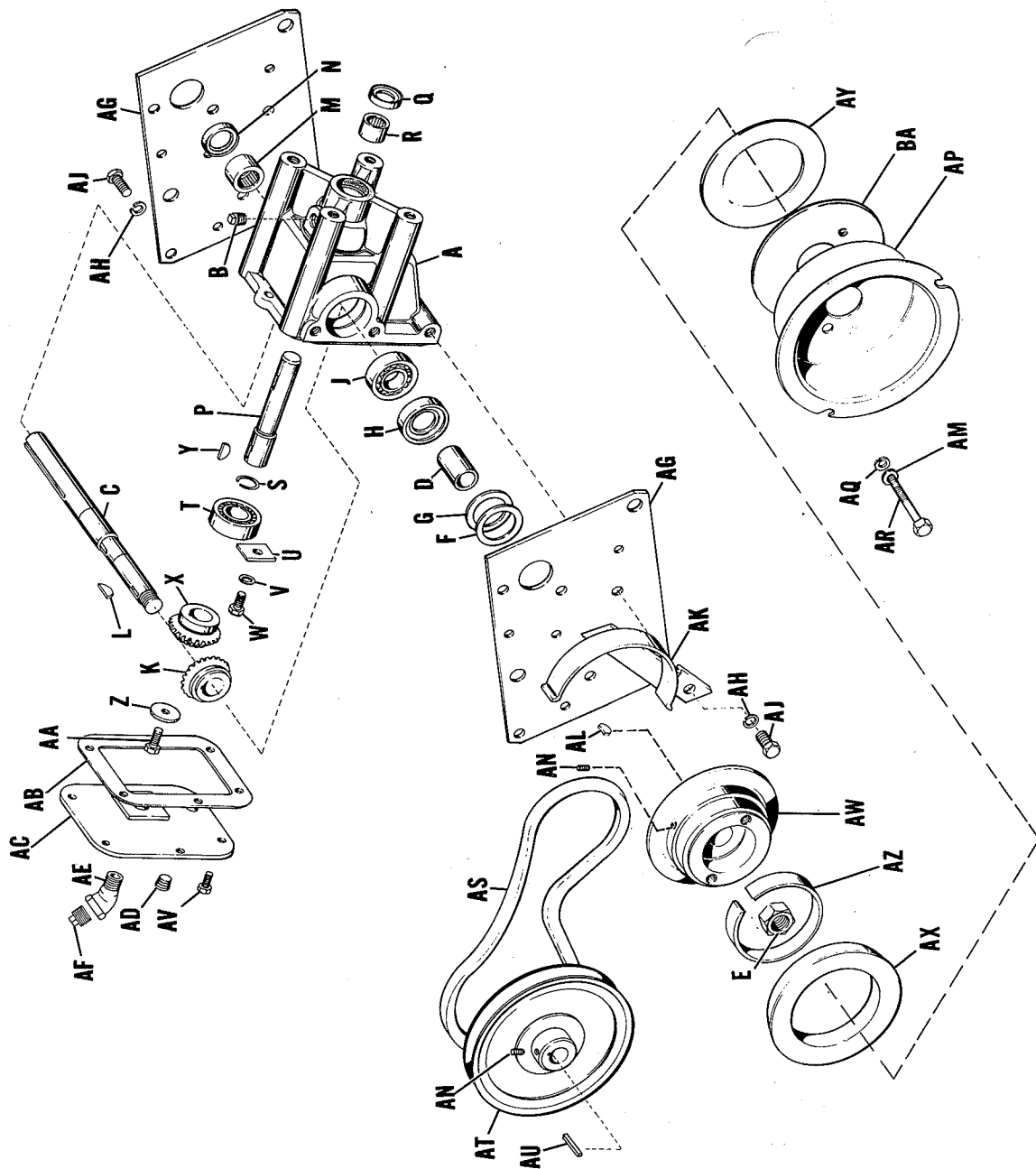

# BEVEL GEAR HOUSING

Order by Part Number

## BEVEL GEAR HOUSING

Order by Part Number

Reference Letter	Part No.	Description
A	154062	Housing, Bevel Gear, Complete w/2 needle brgs.
B	154326	Plug, Pipe
C	154135	Shaft, Driven
D	154136	Spacer, Pulley
E	717517	Nut, Hex., Jam
F	154137	Shim (as required)
G	154138	Shim
H	154278	Seal, Oil
J	118011	Bearing, Ball
K	154139	Gear, Bevel, Driven
L	725003	Key, Woodruff
M	154279	Bearing, Needle
N	118117	Seal, Oil
P	154140	Shaft, Driver
Q	154263	Seal, Oil
R	154258	Bearing, Needle
S	118134	Ring, Retaining
T	118011	Bearing, Ball
U	154040	Plate, Bearing Clamp
V	720001	Washer, Lock, 5/16"
W	705012	Screw, Cap, Hex., 5/16" - 18 N. C. x 5/8" lg.
X	154121	Gear, Bevel, Driver
Y	725003	Key, Woodruff
Z	154026	Washer
AA	154281	Screw, Cap, Hex., 5/16" - 18 N. C. x 3/4" lg.
AB	154282	Gasket
AC	154141	Cover Assembly, Housing
AD	726002	Plug, Pipe
AE	728001	Elbow, Street
AF	726003	Plug, Pipe
AG	154144	Plate, Side
AH	720006	Washer, Lock, 7/16"
AJ	705041	Screw, Cap, Hex., 7/16" - 14 N. C. x 1" lg.
AK	154101	Guard Assembly, Belt
AL	725003	Key, Woodruff
AM	719002	Plain Washer, 5/16"
AN	713503	Screw, Set, Cup Point, Socket Head, 5/16" - 18 N. C. x 5/16" lg.
AP	154384	Pulley, Rope Starter
AQ	720001	Washer, Lock, 5/16"
AR	705001	Screw, Cap, Hex., 5/16" - 18 N. C. x 7/8" lg.
AS	154273	Belt, V-Drive
AT	154272	Pulley, Drive
AU	8061081	Key
AV	707003	Screw, Cap, Hex., 1/4" - 20 x 5/8" lg.
AW	157030	Pulley Half
AX	157031	Pulley Half
AY	157032	Thrust Washer
AZ	157033	Bearings
BA	157150	Thrust Washer





## CLUTCH AND BRAKE GROUP

Order by Part Number

Reference Letter	Part No.	Description
A	108386	Pulley, Idler
C	705016	Capscrew, Hex Hd., 3/8"-16 x 1-1/4" lg.
D	719001	Washer, Plain, 3/8"
E	717003	Nut, Hex., Full, 3/8" - 16 N. C.
F	720002	Washer, Lock, 3/8"
G	157034	Seat Support Assembly
H	157039	Link, Clutch Lever
J	722001	Cotter Pin
K	157041	Compression Spring
L	8191022	Set Collar
M	713001	Set Screw, Sq. Hd., 1/4"-20 x 3/8" lg.
N	157087	Collar, Parking Brake
P	157088	Lock, Parking Brake
Q	717511	Nut, Lock, Hex., Full, 5/16" - 18 N. C.
R	154114	Lever Assembly, Clutch and Brake
S	713502	Screw, Set, Cup Point Socket Head, 5/16" - 18 N. C. x 1/4" lg.
T	154117	Guide Assembly, Rod
U	717001	Nut, Hex., Full, 5/16" - 18 N. C.
V	157040	Rod, Brake and Clutch
W	157042	Lever Assembly, Foot Pedal
X	713502	Screw, Set, Cup Point Socket Head, 5/16" - 18 N. C. x 1/4" lg.
Y	8271027	Bushing
Z	154123	Bearing Assembly, Foot Pedal
AA	705007	Screw, Cap, Hex., 5/16" - 18 N. C. x 1" lg.
AB	720001	Washer, Lock, 5/16"
AC	717001	Nut, Hex., Full, 5/16" - 18 N. C.
AD	157043	Pedal Assembly, Foot (Brake and Clutch)
AE	725002	Key, Woodruff #6
AF	154369	Tension Spring
AG	722001	Cotter Pin, 3/32" x 3/4" lg.
AH	715032	Screw, Cap, Hex., 3/8" - 16 N. C. x 3" lg.
AJ	108172	Pivot
AK	717003	Nut, Hex., Full, 3/8" - 16 N. C.
AL	722001	Pin, Cotter, 3/32" dia. x 3/4" lg.
AM	154132	Brake Band and Lining Assembly
AN	154060	Band, Brake
AP	724501	Rivet #7 x 5/16" lg.
AQ	154133	Lining, Brake
AR	154134	Bracket, Brake Band
AS	705030	Screw, Cap, Hex., 1/4" - 20 N. C. x 3/4" lg.
AT	720003	Washer, Lock, 1/4"
AU	717005	Nut, Hex., Full, 1/4" - 20 N. C.
AV	108157	Clevis, Adj.
AW	717003	Nut, Hex., Full, 3/8" - 16 N. C.
AX	715023	Screw, Cap, Hex., 3/8" - 16 N. C. x 3-1/4" lg.
AY	720002	Washer, Lock, 3/8"
AZ	705031	Screw, Cap, Hex., 3/8" - 16 N. C. x 7/8" lg.
BA	725003	Key, Woodruff #9
BB	154131	Drum, Brake
BC	713010	Screw, Set, Cup Point Square Head, 5/16" - 18 N. C. x 5/8" lg.
BD	154111	Shaft Assembly, Clutch and Brake
BE	725002	Key, Woodruff #6
BF	154248	Retainer, Spring
BG	108158	Clevis Pin
BH	722010	Pin, Cotter 1/8" x 1-1/4" lg.

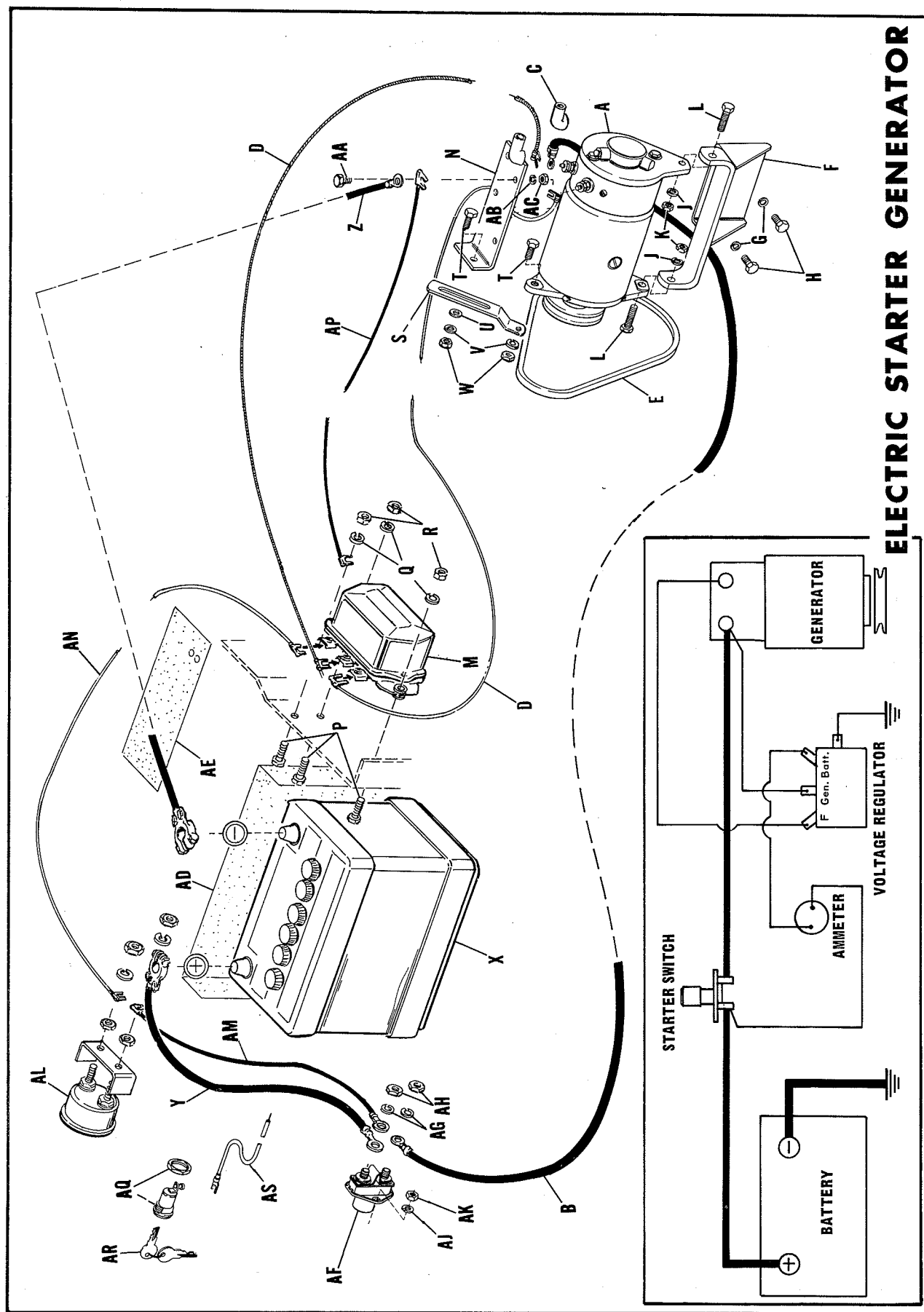

## ELECTRIC STARTER-GENERATOR SYSTEM

Order by Part Number

Ref. Letter	Part No.	Description
A	122041	Motor-Generator
B	122149	Cable, Generator, Start
C	122023	Terminal Cover
D	122140	Wire, Reg. Gen.
E	122146	"V"-Belt
F	157004	Support Assembly
G	720001	Lock Washer, 5/16"
H	705017	Hex Capscrew, 5/16"-18 x 3/4" lg.
J	720001	Lock Washer, 5/16"
K	717001	Hex Nut, Full, 5/16"-18
L	705019	Hex Capscrew, 5/16"-18 x 1-1/4"
M	122148	Voltage Regulator
N	154002	Bracket
P	705030	Hex Capscrew, 1/4"-20 x 3/4" lg.
Q	720003	Lock Washer, 1/4"
R	717005	Hex Nut, Full, 1/4"-20
S	157102	Belt Tightener
T	705017	Hex Capscrew, 5/16"-18 x 3/4" lg.
U	719002	Plain Washer, 5/16"
V	720001	Lock Washer, 5/16"
W	717001	Hex Nut, Full, 5/16"-18
X	122135	Battery
Y	122139	Cable ( Battery to Starter )
Z	122138	Cable ( Battery to Ground )
AA	705015	Hex Capscrew, 1/4"-20 x 5/8" lg.
AB	720003	Lock Washer, 1/4"
AC	717005	Hex Nut, Full, 1/4"-20
AD	122142	Battery Insulation
AE	122143	Fuel Tank Insulation
AF	122046	Starter Switch
AG	720002	Lock Washer, 3/8"
AH	717003	Hex Nut, Full
AJ	720003	Lock Washer, 1/4"
AK	717005	Hex Nut, Full, 1/4"-20
AL	122131	Ammeter
AM	122145	Wire ( Ammeter to Starter )
AN	122144	Wire ( Ammeter to Regulator )
AP	122147	Wire ( Ground to Ground )
AQ	122048	Ignition Switch
AR	122111	Keys
AS	122141	Wire( Switch to Engine )

## POWER TAKE-OFF

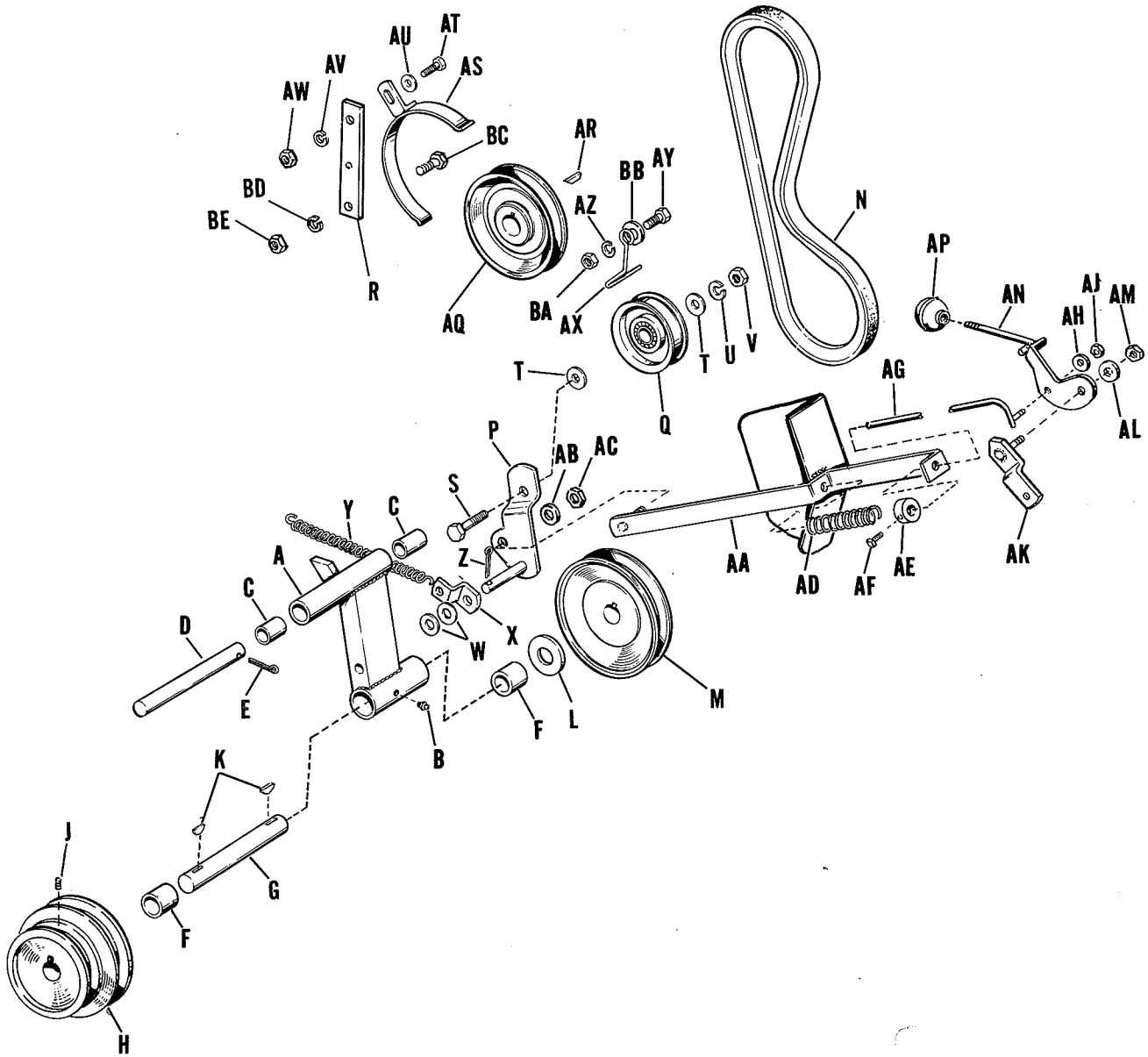

### Order by Part Number

# POWER TAKE-OFF

Order by Part Number

Reference Letter	Part No.	Description
-A	154228	Bracket Assembly, Drive
B	727006	Fitting, Grease
-C	8051038	Bushing
D	154233	Rod, Pivot
E	722007	Pin, Cotter
F	154258	Bearing, Needle
G	157118	Shaft, Power Take-Off
H	157116	Pulley, Power Take-Off
J	713503	Screw, Set, Cup Point, Socket Hd., 5/16" - 18 N.C. x 5/16" lg.
K	725003	Key, Woodruff
L	108182	Washer
M	154308	Pulley
N	106390	Belt, "V", Power Take-Off
P	154360	Lever Assembly, Idler
Q	154534	Pulley, Idler
R	157050	Guard Support
S	705016	Capscrew, Hex Hd., 3/8" - 16 N.C. x 1-1/4" lg.
T	719002	Washer, Plain, 5/16"
U	720002	Washer, Lock, 3/8"
V	717003	Nut, Hex, Full, 3/8" - 16 N.C.
W	719001	Washer, Plain, 3/8"
-X	154368	Clip, Spring
Y	154369	Spring, Tension
Z	722009	Pin, Cotter, 1/8" x 3/4" lg.
AA	154540	Guide Assembly, Rod
AB	719001	Washer, Plain, 3/8"
AC	717510	Nut, Lock, Hex Hd., Full, 3/8" - 16 N.C.
AD	8191045	Spring
AE	8191022	Collar, Set
AF	713001	Screw, Set. Sq. Hd. Cup Pt., 1/4" - 20 N.C. x 3/8" lg.
AG	154364	Rod Assembly, Clutch
AH	719002	Washer, Plain, 5/16"
AJ	717511	Nut, Lock, Hex Hd., Full, 5/16" - 18 N.C.
AK	154362	Pivot Bar Assembly
AL	719001	Washer, Plain, 3/8"
AM	717510	Nut, Lock, Hex Hd. Full, 3/8" - 16 N.C.
AN	154356	Lever Assembly, Clutch
AP	122005	Knob
AQ	157121	Pulley
AR	8061081	Key
AS	157132	Guard Assembly, Belt
AT	705005	Capscrew, 3/8" - 16 N.C. x 1" lg.
AU	719001	Washer, Plain, 3/8"
AV	720002	Washer, Lock, 3/8"
AW	717003	Nut, Hex, Full, 3/8" - 16 N.C.
AX	8021014	Stop, Belt
AY	705031	Capscrew, 3/8" - 16 N.C. x 7/8" lg.
AZ	720002	Washer, Lock, 3/8"
BA	717003	Nut, Full, Hex, 3/8" - 16 N.C.
BB	719001	Washer, Plain, 3/8"
BC	705007	Hex Capscrew, 5/16"-18 x 1" lg.
BD	720001	Lockwasher, 5/16"
BE	717001	Hex Nut, 5/16"-18

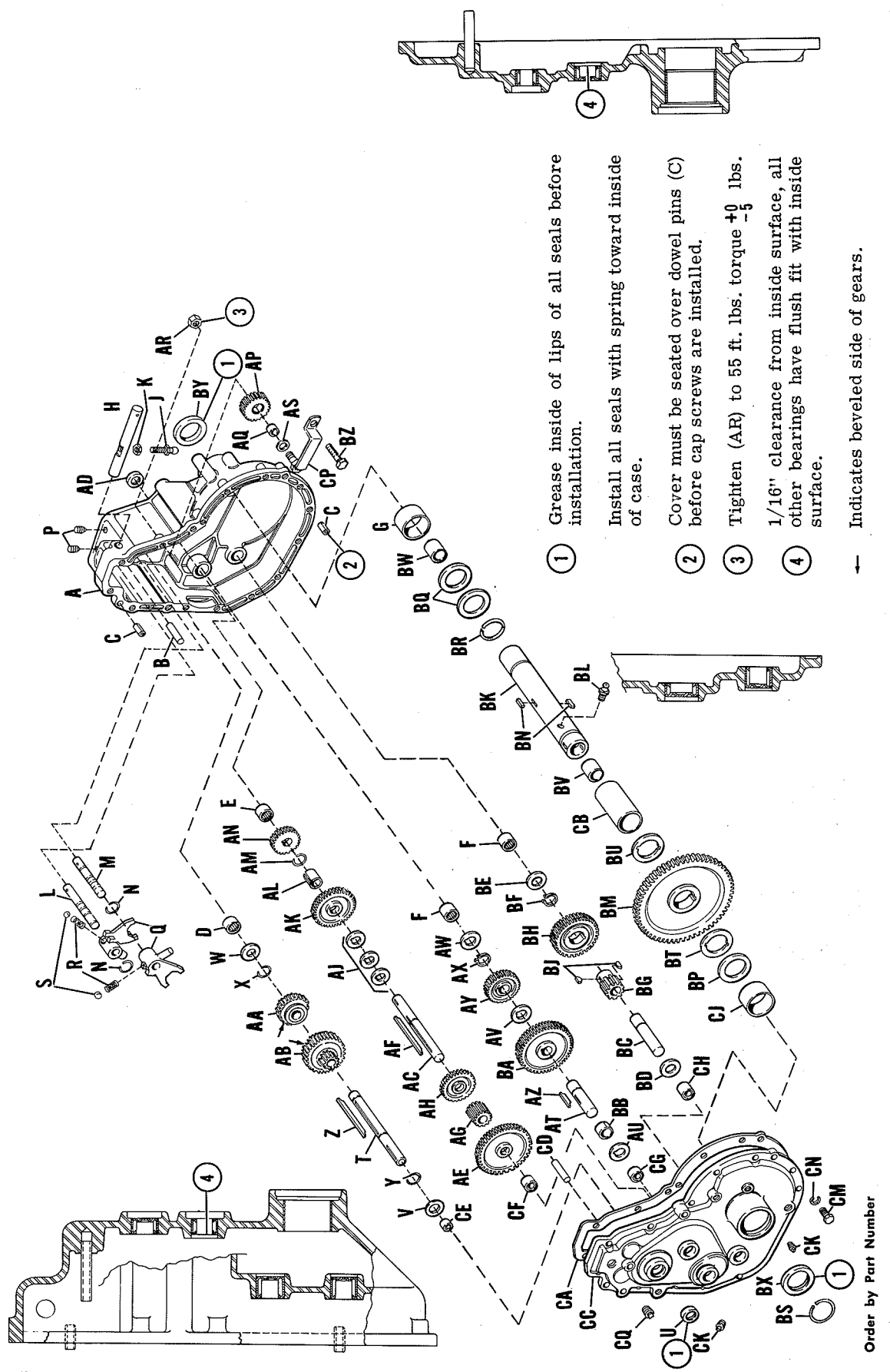

## TRANSMISSION GROUP

# TRANSMISSION GROUP

Order by Part Number

Reference Letter	Part No.	Description
A	154190	Case, Gear , Complete w/ bearings and dowel pins
B	154538	Pin, Roll
C	723007	Pin, Roll
D	154257	Bearing, Needle
E	154258	Bearing, Needle
F	154259	Bearing, Needle
G	154260	Bearing, Axle Tube
H	154066	Rod, Shift
J	154261	Stem, Shift
K	717010	Nut, Hex. , Full, 3/8" - 24 N. F.
L	154067	Shaft, Shifter, Rev. , Med.
M	154068	Shaft, Shifter, High, Low
N	8061048	Ring, Retaining
P	715019	Screw, Set, Hollow Head, Cone Point, 5/16" - 18 N. C. x 1/2" lg.
Q	154069	Fork, Shift
R	154323	Spring
S	154262	Ball, Shift Lock
T	154070	Shaft, Pulley
U	154263	Seal, Oil
V	154462	Washer
W	154462	Washer
X	154264	Ring, Retaining
Y	154264	Ring, Retaining
Z	154265	Key
AA	154072	Pinion Assembly, Rev. , II
AB	154075	Pinion Assembly, I and III
AC	154077	Shaft, 1st Intm.
AD	154263	Seal, Oil
AE	154078	Gear, Driven, I
AF	154354	Key
AG	154079	Pinion, 1st Intm.
AH	154080	Pinion, Driven, III
AJ	8061012	Spacer, Trans. Gear
AK	154081	Gear, Driven, II
AL	154082	Spacer
AM	154264	Ring, Retaining
AN	154083	Pinion, Reverse
AP	154087	Gear, Reverse
AQ	154084	Spacer, Rev. Gear
AR	717516	Nut, Lock, 1/2" - 20 N. F.
AS	154325	Washer
AT	154086	Shaft, 2nd. Intm.
AU	154038	Washer
AV	154038	Washer
AW	154038	Washer
AX	154266	Ring, Retaining
AY	154088	Pinion, 2nd. Intm.
AZ	154267	Key
BA	154089	Gear, 2nd. Intm.
BB	154090	Spacer
BC	154091	Shaft, 3rd. Intm.
BD	154038	Washer
BE	154038	Washer
BF	154266	Ring, Retaining
BG	154092	Pinion, 3rd. Intm.
BH	154093	Gear, 3rd. Intm.
BJ	725002	Key, Woodruff
BK	157188	Axle Tube W/Bushing

## TRANSMISSION GROUP (cont.)

Order by Part Number

Reference Letter	Part No.	Description
BL	727002	Fitting, Grease
BM	154095	Gear, Drive
BN	154096	Key
BP	154097	Washer
BQ	154097	Washer
BR	154268	Ring, Snap
BS	154268	Ring, Snap
BT	154130	Washer, Axle Tube
BU	154130	Washer, Axle Tube
BV	157028	Bearing
BW	157028	Bearing
BX	154269	Seal
BY	154269	Seal
BZ	705016	Screw, Cap, Hex., 3/8" - 16 N. C. x 1-1/4" lg.
CA	154270	Gasket, Gear Case
CB	154098	Spacer, Axle Tube
CC	154191	Cover, Gear Case, Complete w/ bearings
CD	154537	Pin, Roll
CE	154258	Bearing, Needle
CF	154257	Bearing, Needle
CG	154271	Bearing, Needle
CH	154259	Bearing, Needle
CJ	154260	Bearing, Axle Tube
CK	726003	Plug, Pipe, 3/8"
CM	705007	Screw, Cap, Hex., 5/16" - 18 N. C. x 1" lg.
CN	720001	Washer, Lock, 5/16"
CP	154352	Pin Assembly, Rev. Gear
CQ	726003	Plug, Pipe, 3/8"

SIMPLICITY MANUFACTURING COMPANY / PORT WASHINGTON, WIS.