

Installation

Instructions

Front End Repair Kit

Part No. 5600079

For Simplicity Citation Models

Kit Contents:

Front end No.	Qty.	Description
5402029C	1	Front End Weldment
5402041C	2	Bracket, Bolt on
5022098	4	Cap, Plastic
5025156	10	Washer, 3/8" SAE
5025013X10	4	Bolt, 3/8-16 X 1-1/4"
5025013X20	4	Bolt, 3/8-16 X 2-1/2"
5025013X28	4	Bolt, 3/8-16 X 3-1/2"
5025394	10	Nut, 3/8-16 Hex Nylock Flange
5021072	2	Seal, Grease
5025203X10	2	Pin, Cotter
5047489	1	Spacer
5022852	1	Bearing
5100358	1	Bearing
5025265X52	1	Bolt, 3/4-16 X 6-1/2"
5025284	1	Nut, 3/4-16 Hex Nylon Lock
5025160	2	Washer, 3/4 SAE
5049949C	1	Caster Pivot Frame
5100772	1	Tie Wrap, 15" Long, UV Black

⚠ WARNING

Before beginning any service work turn off the PTO, set the parking brake, turn off the ignition, and disconnect the spark plug wire(s).

1. Park the machine on a flat, level surface and engage the parking brake. Disengage the PTO switch, turn off the engine and remove the key from the ignition.
2. Save all the hardware that is being removed. Remove the floor pan and the front shocks.
3. Refer to Figure 1. Place approximately 8" of wooden blocking under the mower deck and lower the deck onto the blocking. Position jack under the front of the machine. Lift the front caster wheels off the ground and place approximately 4" of wooden blocking between the mower deck and the frame. Lower the jack down until the frame rests on the blocking. Remove the jack.
4. Cut the (3) existing black tie wraps that fasten the headlight wire harness to the front of the frame. Refer to Figure 9. Remove the 3/4" hardware holding the caster pivot frame and remove the caster pivot frame assembly.
5. Loosen the (4) deck puller bar adjustment bolts (A, Figure 2). Remove the (4) mount hardware (B) that connect the deck puller bar to the front end and the deck. Remove the deck puller bar and set aside.
6. Refer to Figure 3. Cut the front cross member (A) within 4-1/4" to 4-1/2" from the inside of the frame rail (B). NOTE: Keep the cut perpendicular to the top of the frame rail.

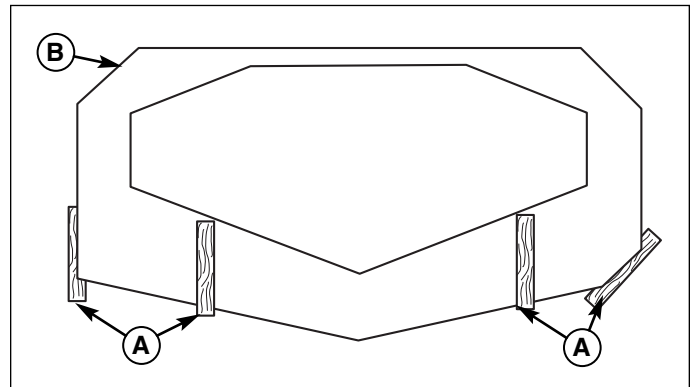

Figure 1. Position of Wooden Blocks
A. Wooden Blocks
B. Mower Deck

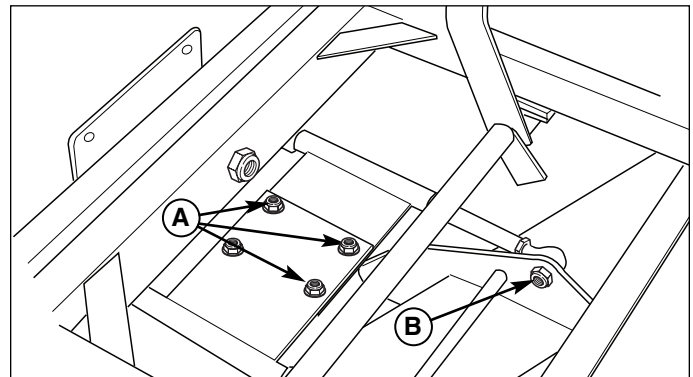

Figure 2. Deck Puller Bar
A. Puller Bar Adjustment Bolts
B. Mount Hardware

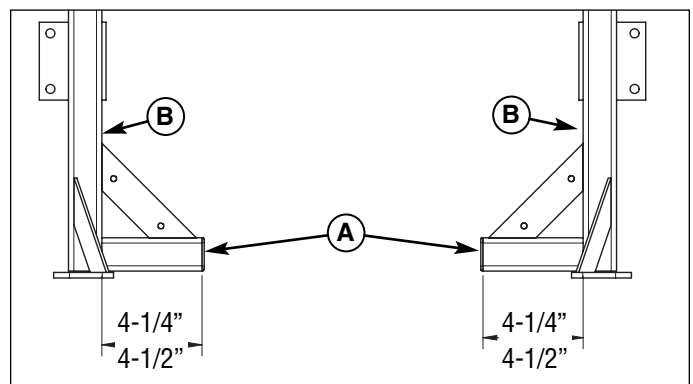

Figure 3. Cut Front Cross Member
A. Front Cross Member
B. Frame Rail

7. Install the plastic end caps (B, Figure 4) in the ends of the cut cross member (A) and the new front end (C).

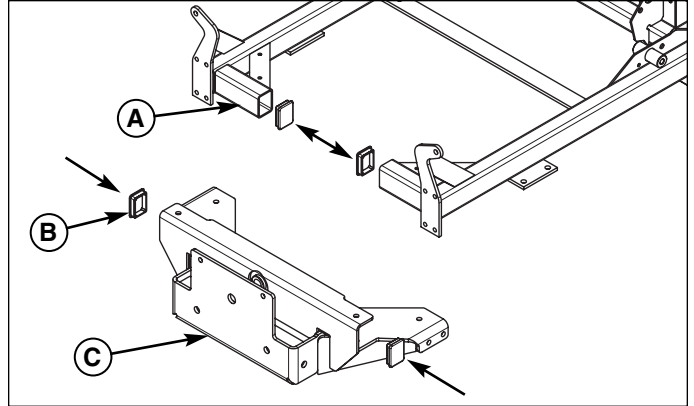

Figure 4. Install Plastic End Caps

A. Cut Cross Member

B. Plastic End Cap

C. New Front end

8. Position from the bottom the new front end against the frame as shown in Figure 5. Then slide toward the rear of the machine until the c-channel of the new front end rests over the front cross member that was cut.

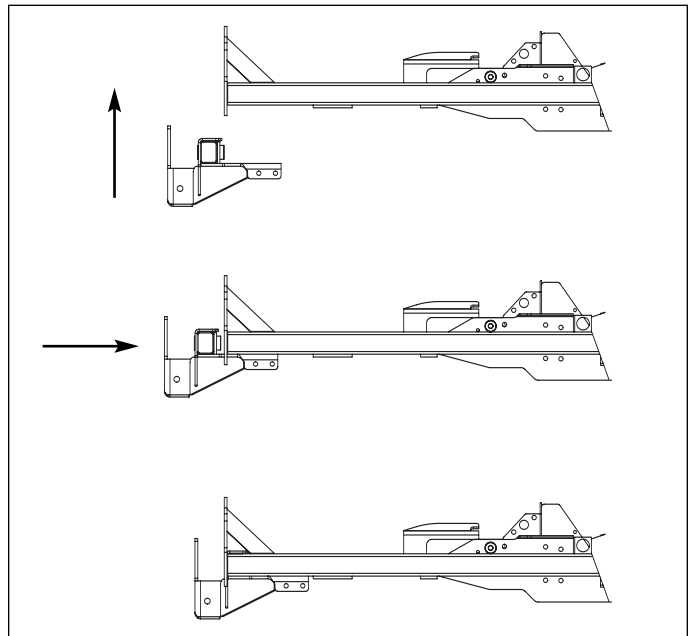

Figure 5. Install New Front end

- Loosely install the rear brackets (F, Figure 6) to the new front end with the 3/8-16 X 1-1/4" bolts (C), 3/8-16 X 3-1/2" bolts (B), 3/8 SAE washers (D), and 3/8-16" nylon flange nuts (E). Snugly clamp the front of the new front end to the cross member using (2) C-clamps (See Figure 7). NOTE: Do not over tighten the clamps.

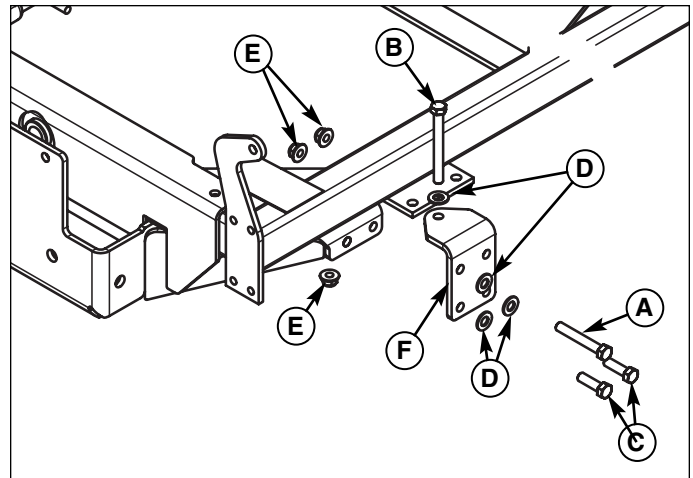

Figure 6. Loosely Install the Rear Brackets

- A. 3/8-16 X 2-1/2 Bolt
- B. 3/8-16 X 3-1/2 Bolt
- C. 3/8-16 X 1-1/4 Bolt
- D. 3/8" SAE Washer
- E. 3/8-16 Nylon Flange Nut
- F. Rear Bracket

- Snugly clamp the top of bracket and the bottom of the new front end to the frame rail using (2) more C-clamps. Tighten the bottom bracket bolts. Refer to Figure 8. Using the front top hole as a guide drill a 3/8" hole through the frame and install 3/8-16 X 2-1/2" bolts and 3/8-16 flange nuts on both sides of the frame. Tighten the bracket hardware (Do Not Exceeds 35 ft lbs of Torque) and remove clamps that were holding it.
- Drill the front mounting holes: Use the holes in the new front end as guide, drill the top holes from the top and the bottom holes from the bottom to insure the correct alignment. Install 3/8-16 X 3-1/2" bolts (A, Figure 6) and 3/8-16 flange nuts (E, Figure 6). Tighten the hardware and remove the clamps.

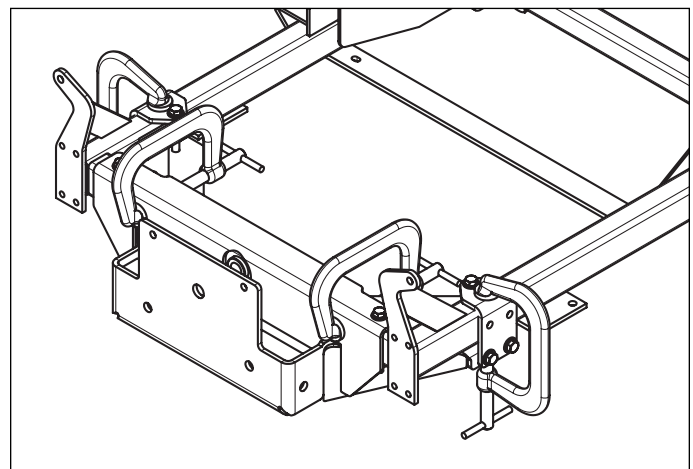

Figure 7. C-Clamp Positions

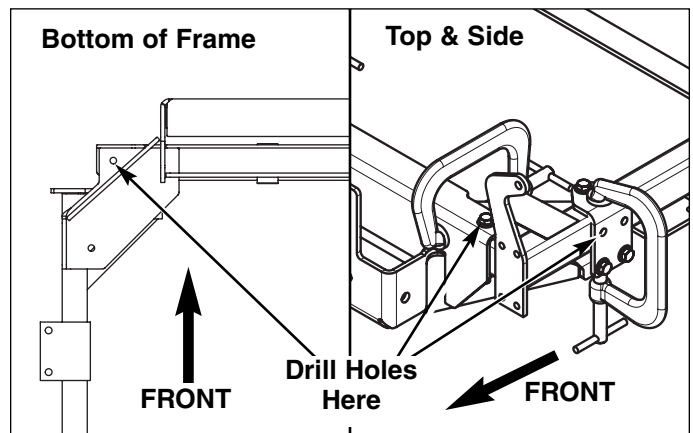

Figure 8. Drill 3/8" Holes

11. Remove the caster wheels yokes from the old front end assembly. Refer to Figure 9, install the removed yokes (G) and spacer (I) in to the new front end assembly. If needed, clean and re-grease tapered bearings before installation. Install the new caster pivot frame (H) to the frame with the new 3/4" hardware (J, K, L) provided.

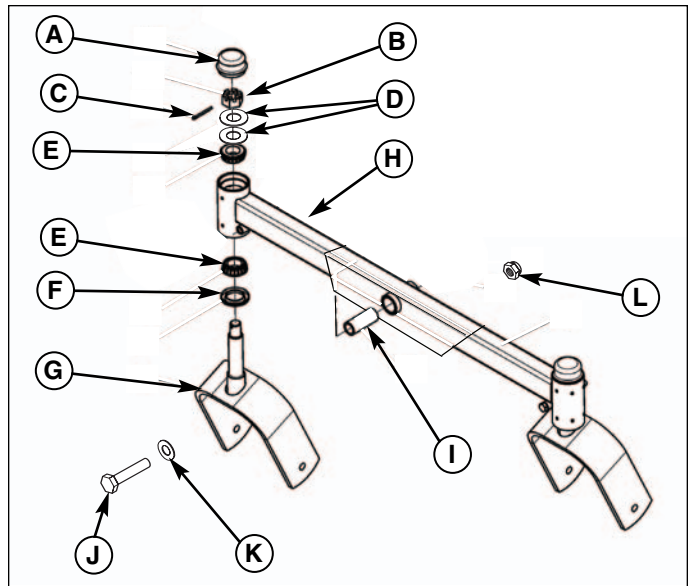

Figure 9. Caster Pivot Frame Assembly

- A. Cap
- B. Slotted Nut
- C. Cotter Pin
- D. 3/4" SAE Washer
- E. Bearing
- F. Grease Seal
- G. Caster Yoke
- H. New Caster Pivot Frame
- I. Spacer, .75 x 1.00 x 2.38
- J. 3/4-16 x 6-1/2" Bolt
- K. 3/4" SAE Washer
- L. 3/4-16" Nylon Nut

12. Refer to Figure 10. Reinstall the mower deck puller bar (front of the puller bar install on the inside of the new front end). Install hardware removed previously. Tighten the puller bar adjustment bolts (A, Figure 2).

13. Reinstall the floor pan and the front shocks.

NOTE: Use the (3) 15" tie wraps to fasten the headlight wire harness back to the frame.

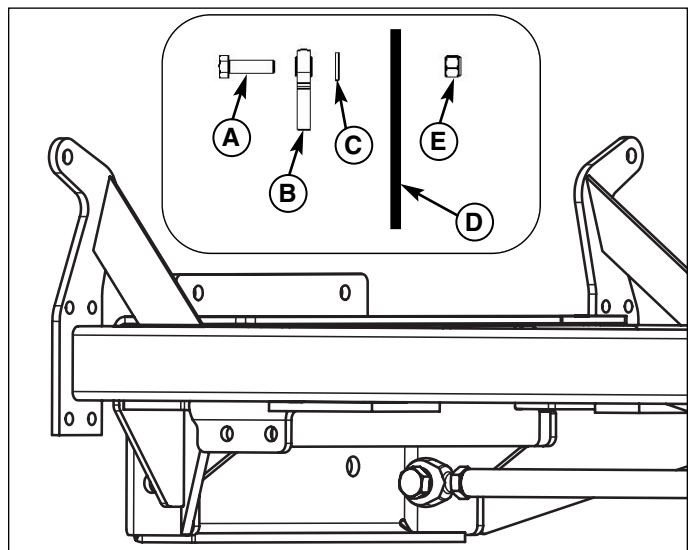

Figure 10. Reinstall the Puller Bar

- A. Bolt
- B. Ball Joint
- C. Washer
- D. Frame
- E. Nut