

Fig. 1

Attachment

To attach the 42" Rotary Mower to the Model 700 Tractor, follow the sequence of steps as outlined below:

1. Place the mower beside the tractor, and turn the tractor wheels to full left position. Before sliding the mower under the tractor, remove the hair pin cutters and pins connecting the clevises on front end of ball assembly. Allow the rocker arms to drop down. This will now provide sufficient clearance for the mower to slide under the tractor. With the mower under the tractor, replace the clevises on rocker arms and fasten with hair pin cutters and pins.
2. Connect the rocker arms to front mounting brackets under the tractor, by using pins and hair pin cutters as shown in figure 2.
3. Place the tractor lift lever in its rear position and attach the mower lift lever to the tractor lift arm on right hand side of tractor as shown in figure 3. Use hex capscrew, flatwashers, and hex nut furnished for this purpose.
4. Connect the mower lift chain to the lift lever by fastening the lift links in place with a pin and hair pin cotter as shown in figure 3.
5. Place the cross drive belt in position on the mower drive pulley. Give the belt a 90° twist towards the left hand side of the tractor and mount belt to larger pulley of power take-off as shown in figure 3. When installed in proper manner, the belt should run from the left side of mower pulley to bottom side of power take-off pulley.

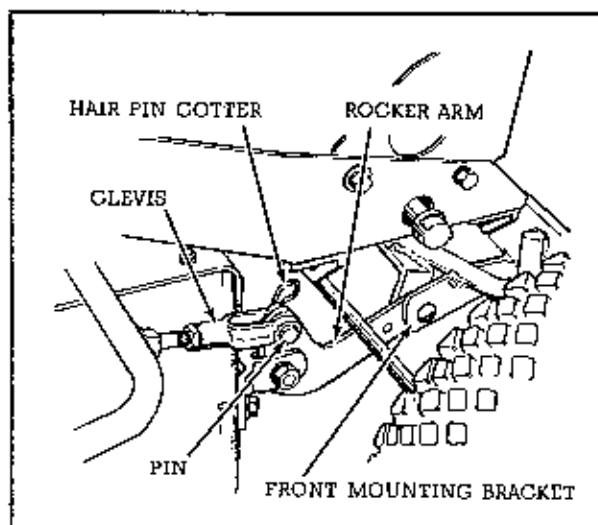
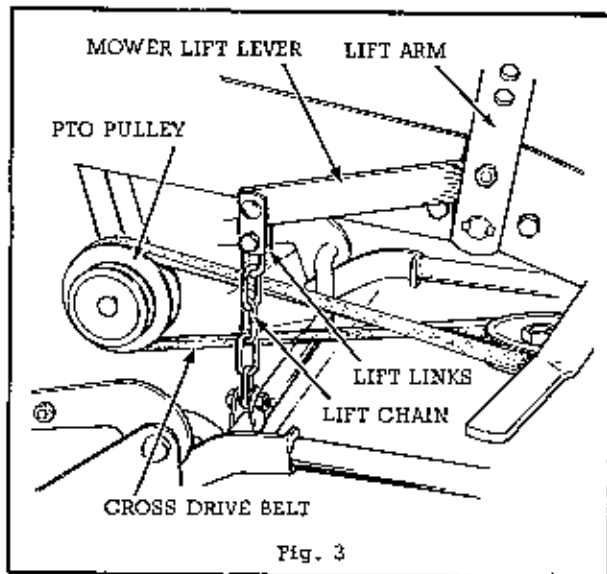

Fig. 2

Adjustments

To check the final adjustment of the mower height, place the tractor with the mower attached, on a smooth flat surface. Rotate the center blade to the front and measure the distance from its front tip to the ground. Then rotate each of the side blades so that their tips can be measured at the front. For best mowing results, the leading tip of the center blade should be about 3/8" higher than the trailing tip of the two side blades. To obtain this adjustment, remove pins from clevises and rocker arms, loosen the hex nut in back of each clevis and turn each clevis in or out sufficiently to achieve this setting. In making this adjustment, be sure that both clevises are adjusted equally.



Operation

1. Set mower to desired height of cut by turning the adjusting screw handles counter-clockwise to lower the cut, and clockwise to raise the cut. Turn each adjusting handle an equal number of times to insure level operation.
2. Start the tractor engine with the power take-off in the disengaged position, and lower the mower to cutting position by releasing the tractor lift lever.
3. Engage the power take-off to set the mower blades in operation; engage the tractor clutch and proceed with mowing.
4. To transport the mower; disengage the power take-off to stop blades. Raise the mower above the surface by pushing the tractor lift lever to forward locked position.

Belt Tension

After the first 5 to 10 hours of operation, the blade drive belt may stretch slightly. To restore the proper tension to the blade drive belt, remove the right hand cover from the top of mower housing and loosen the nut on idler pulley bolt. Move the idler pulley to a point where tension is sufficient to transmit power from the pulley of drive arbor to pulleys of driven arbors. Hold idler pulley in position while retightening the nut to lock idler in place. **AVOID EXCESSIVE TENSION**, as it will cause premature belt failure.

NOTE: The cross drive belt and the blade drive belt are a super combine type belt and are designed and manufactured to provide long and satisfactory service. Because of the special design of these belts, it is urged that you replace them only with genuine replacement belts ordered from your dealer. Consult the parts list for the correct part numbers for these belts when replacement is necessary.

Lubrication

The 42" Rotary Mower will require lubrication only once or twice in a mowing season. The ball bearings on all arbor spindles are a sealed type and are lubricated in the following manner: On each arbor tube assembly you will find 1 pipe plug which must be removed. Insert 1 oz. of S.A.E. #20 oil into each arbor tube and then replace pipe plugs securely. Turn the mower up-side down for a short time to allow the oil to reach the upper bearings.

Occasionally add oil to the ball bearing of the idler pulley located beneath the right hand deck cover.

Caution

It is the responsibility of the operator to see that the area where the mower will be used is free of all types of foreign material. This includes wire, rope, rags, sticks, bottles, cans, pipe, and rocks, etc. These represent potential dangers to mower, operator, and spectators; as well as having a dulling effect on the mower blades.

Always guard for obstacles when mowing, and, never leave mower running while unattended.

BAIL ASSEMBLY

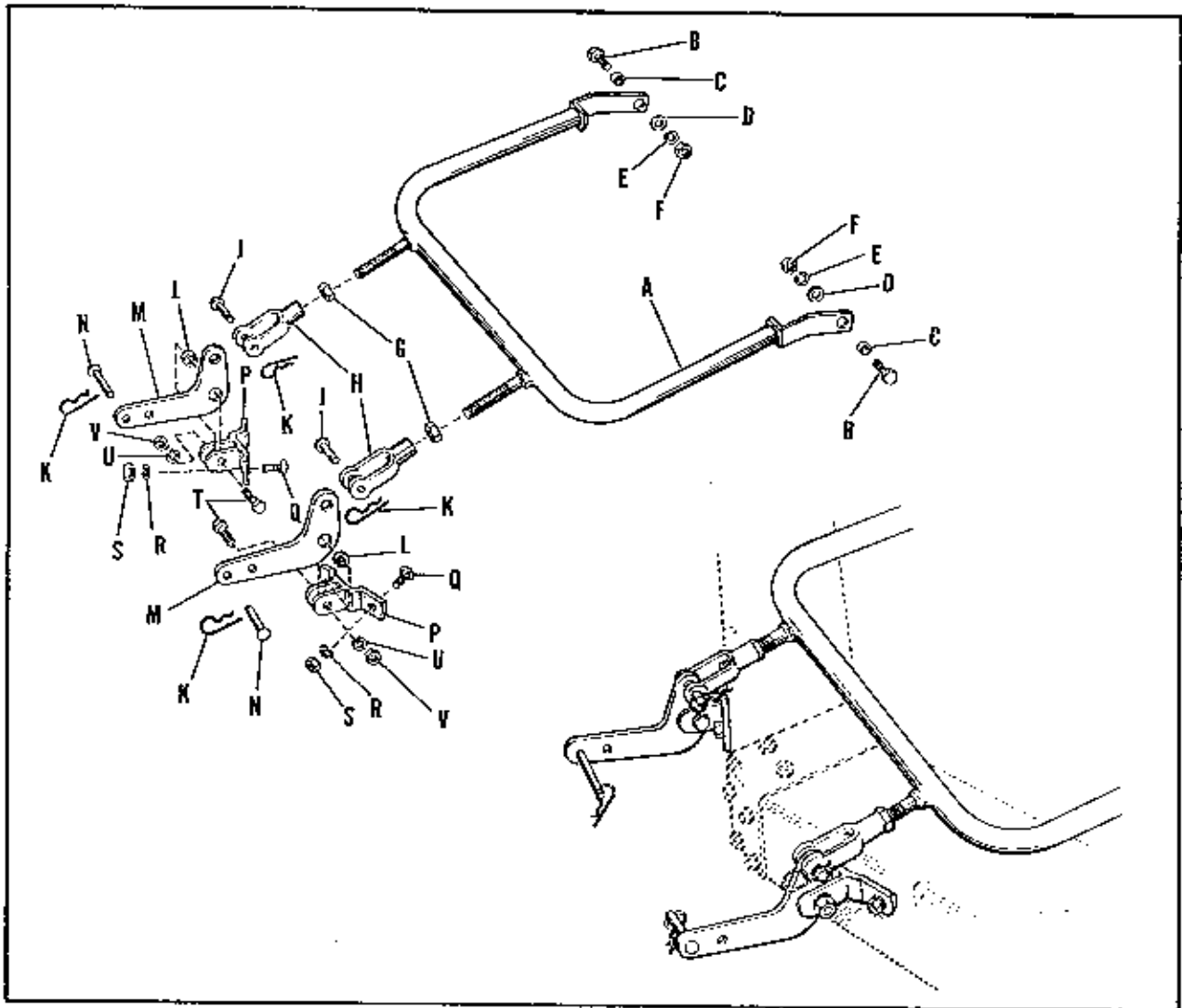

Order by Part Number

Ref. Let.	Part No.	Description
A	108229	Bail Assembly
B	705049	Capscrew, Hex Hd., 1/2"-13 NC x 1 1/4" lg.
C	105051	Spacer
D	719004	Washer, Plain, 1/2"
E	720004	Washer, Lock, 1/2"
F	717006	Nut, Hex, Full, 1/2"-13 NC
G	717016	Nut, Hex, Jam, 1/2"-20 NF
H	154304	Yoke End, Adjusting
J	154305	Yoke Pin

Order by Part Number

Ref. Let.	Part No.	Description
K	8161045	Clip, Spring
L	105051	Spacer
M	108228	Rocker Arm
N	118053	Pin
P	108219	Bracket Assembly, Front
Q	702002	Bolt, Carriage, 3/8"-16 NC x 1"
R	720002	Washer, Lock, 3/8"
S	717003	Nut, Hex, Full, 3/8"-16 NC
T	705049	Capscrew, Hex, 1/2"-13 NC x 1 1/4"
U	720004	Washer, Lock, 1/2"
V	717006	Nut, Hex, Full, 1/2"-13 NC

MOWER UNDERSIDE

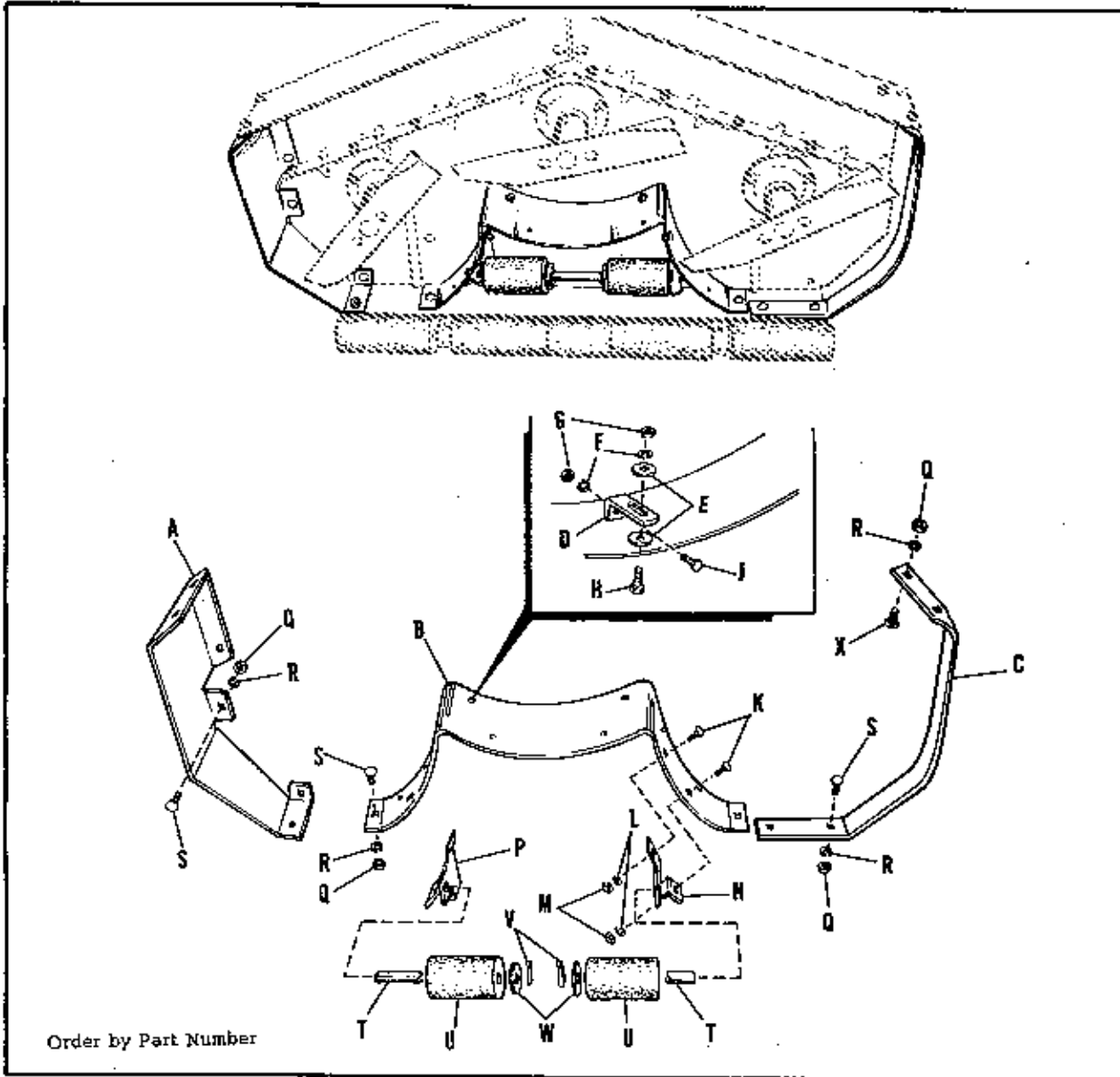

Order by Part Number

Ref. Let.	Part No.	Description
A	108213	Plate, End, Housing
B	108222	Baffle
C	108214	Guard Assembly, Housing
D	108186	Clip, Baffle
E	719006	Washer, Plain, 1/4"
F	720003	Washer, Lock, 1/4"
G	717005	Nut, Hex, Full, 1/4"-20 NC
H	715018	Capscrew, Hex, 1/4"-20 NC x 5/8"
J	714012	Screw, Recessed Hex, Self Tapping 1/4"-20 NC x 7/8" lg.
K	702015	Bolt, Carriage, 5/16"-18 NC x 3/4" lg.
L	720001	Washer, Lock, 5/16"
M	717001	Nut, Hex, Full, 5/16"-18 NC

Ref. Let.	Part No.	Description
N	108224	Bracket, Roller, Lower, L.H.
P	108223	Bracket, Roller, Lower, R.H.
Q	717003	Nut, Hex, Full, 3/8"-16 NC
R	720002	Washer, Lock, 3/8"
S	702003	Bolt, Carriage, 3/8"-16 NC x 3/4" lg.
T	108225	Shaft, Roller
U	108178	Roller
V	722011	Pin, Cotter, 3/16" x 1" lg.
W	116001	Washer
X	702002	Bolt, Carriage, 3/8"-16 NC x 1" lg.

DECK ASSEMBLY

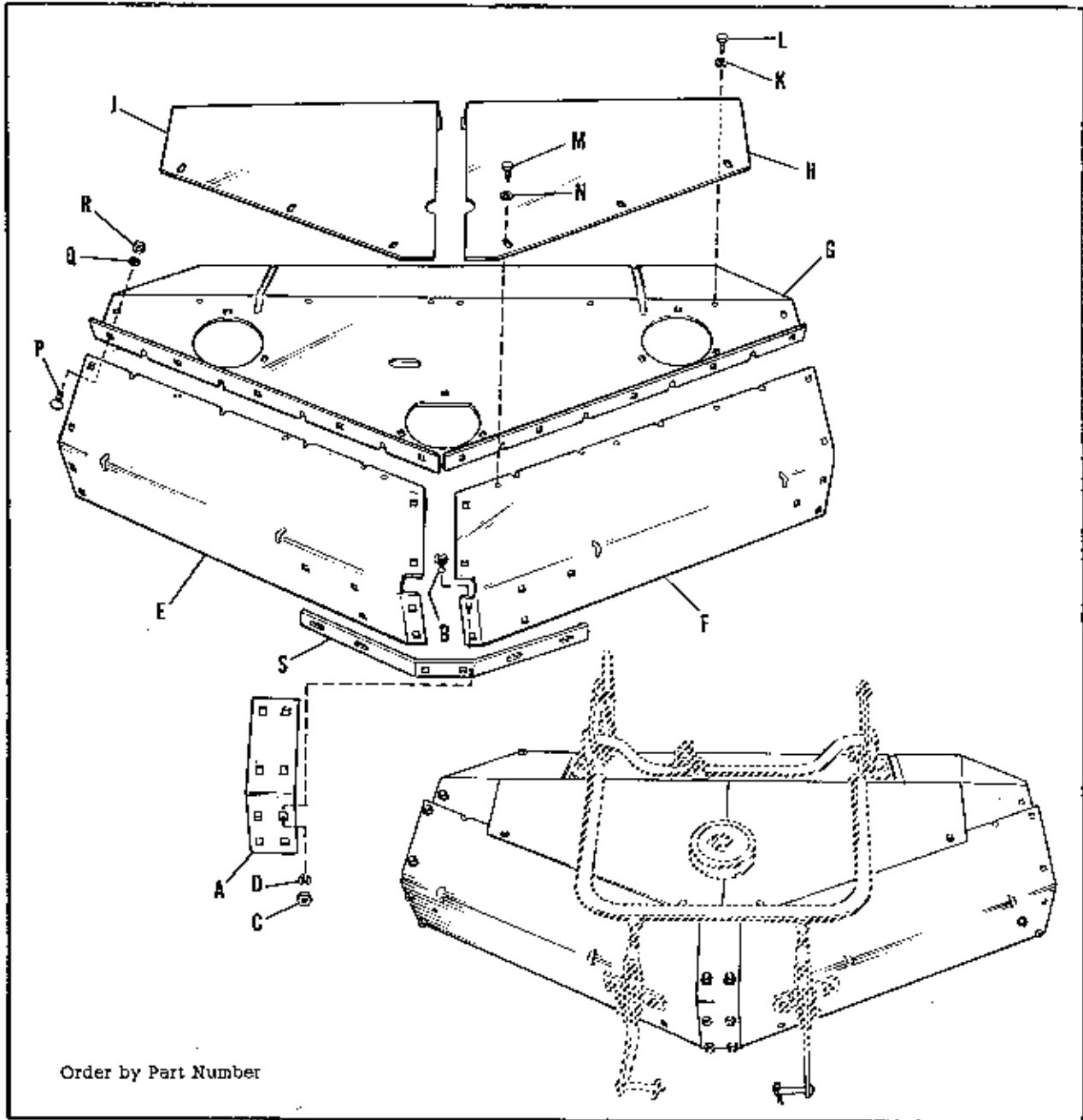

Order by Part Number

Ref. Let.	Part No.	Description
A	108217	Plate, Front
B	702003	Bolt, Carriage, 3/8"-16 NC x 3/4"
C	717003	Nut, Hex, Full, 3/8"-16 NC
D	720002	Washer, Lock, 3/8"
E	108211	Deck, Front, R.H.
F	108212	Deck, Front, L.H.
G	108210	Deck Housing
H	108227	Cover, L.H.
J	108226	Cover, R.H.
K	719007	Washer, Plain, 3/16"

Ref. Let.	Part No.	Description
L	714007	Screw, Recessed Hex, Self Tapping 1/4"-20 NC x 3/8" lg.
M	714007	Screw, Recessed Hex, Self Tapping 1/4"-20 NC x 3/8" lg.
N	719007	Washer, Plain, 3/16"
P	702003	Bolt, Carriage, 3/8"-16 NC x 3/4"
Q	720002	Washer, Lock, 3/8"
R	717003	Nut, Hex, Full, 3/8"-16 NC
S	108218	Bar, Reinforcing

ROLLER ASSEMBLY

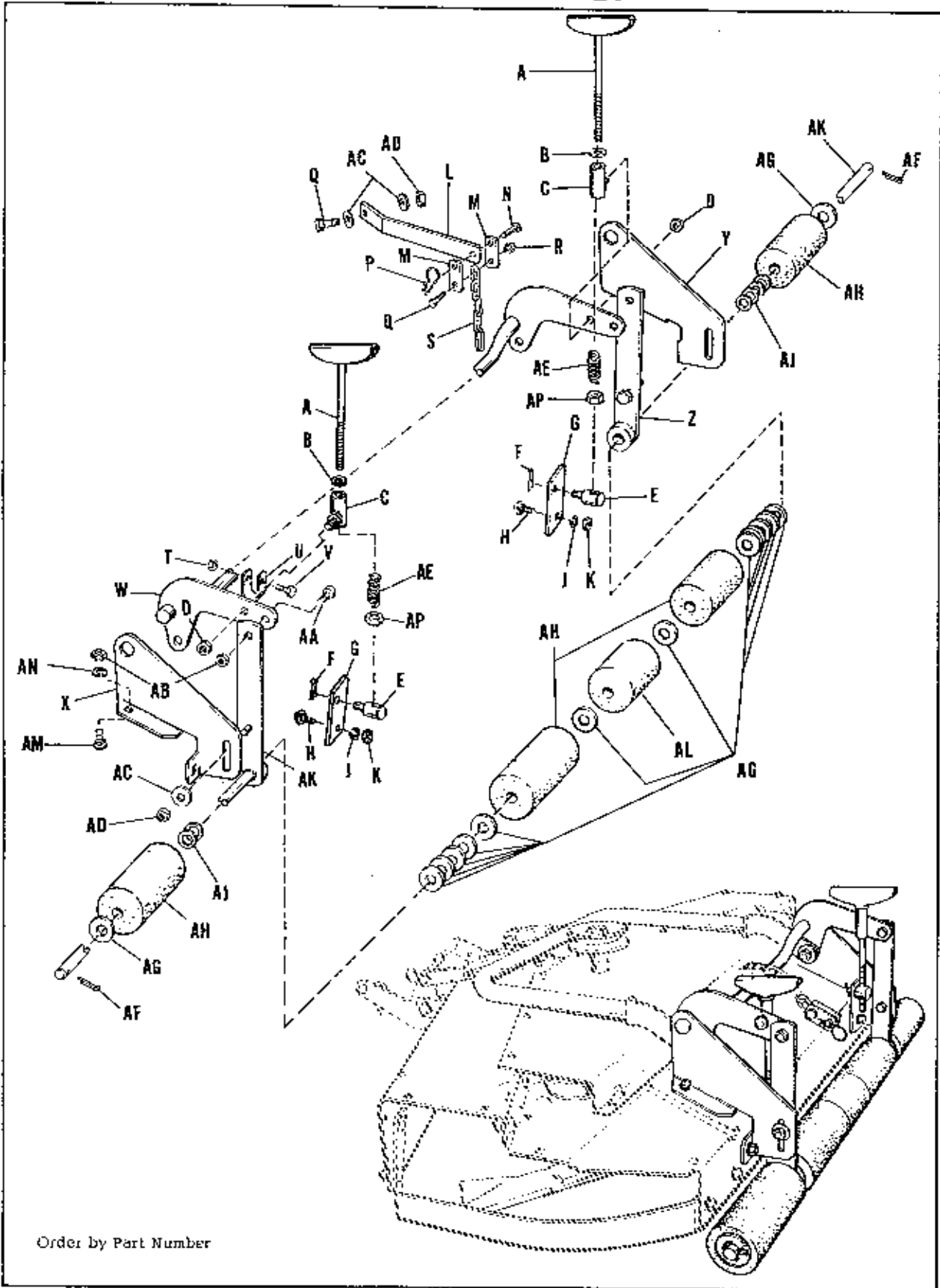

Order by Part Number

ROLLER ASSEMBLY

Order by Part Number

Reference Letter	Part No.	Description
A	108169	Screw Assembly, Adjusting
B	719001	Washer, Plain, 3/8"
C	108241	Socket Assembly, Crank
D	717510	Nut, Hex, Full, Lock, 3/8"-16 NC
E	108172	Pivot
F	722001	Cotter Pin, 3/32" x 3/4" lg.
G	108242	Link, Lift
H	703004	Bolt, Carriage, 3/8"-16 NC x 3/4" lg.
J	720002	Washer, Lock, 3/8"
K	717003	Nut, Hex, Full, 3/8"-16 NC
L	108198	Lever, Mower Lift
M	108199	Link, Mower Lift
N	153058	Pin, Lock
P	8161045	Clip, Spring
Q	705005	Capscrew, Hex Hd., 3/8"-16 NC x 1" lg.
R	717510	Nut, Hex, Full, Lock, 3/8"-16 NC
S	107031	Chain
T	717510	Nut, Hex, Full, Lock, 3/8"-16 NC
U	108200	Clip, Chain
V	705009	Capscrew, Hex Hd., 3/8"-16 NC x 1 1/2" lg.
W	108235	Arm Assembly, Rocker
X	108234	Bracket, Roller, L.H.
Y	108233	Bracket, Roller, R.H.
Z	108359	Bar Assembly, Roller
AA	705005	Capscrew, Hex Hd., 3/8"-16 NC x 1" lg.
AB	717003	Nut, Hex, Full, 3/8"-16 NC
AC	719001	Washer, Plain, 3/8"
AD	717510	Nut, Hex, Full, Lock, 3/8"-16 NC
AE	108360	Spring, Adj. Screw
AF	722011	Pin, Cotter, 3/16" x 1" lg.
AG	115001	Washer
AH	108240	Roller
AJ	8261055	Washer
AK	108358	Shaft & Support Arm.
AL	108178	Roller
AM	702003	Bolt, Carriage, 3/8"-16 NC x 3/4" lg.
AN	720002	Washer, Lock, 3/8"
AP	717003	Nut, Hex, Full

ARBOR ASSEMBLIES

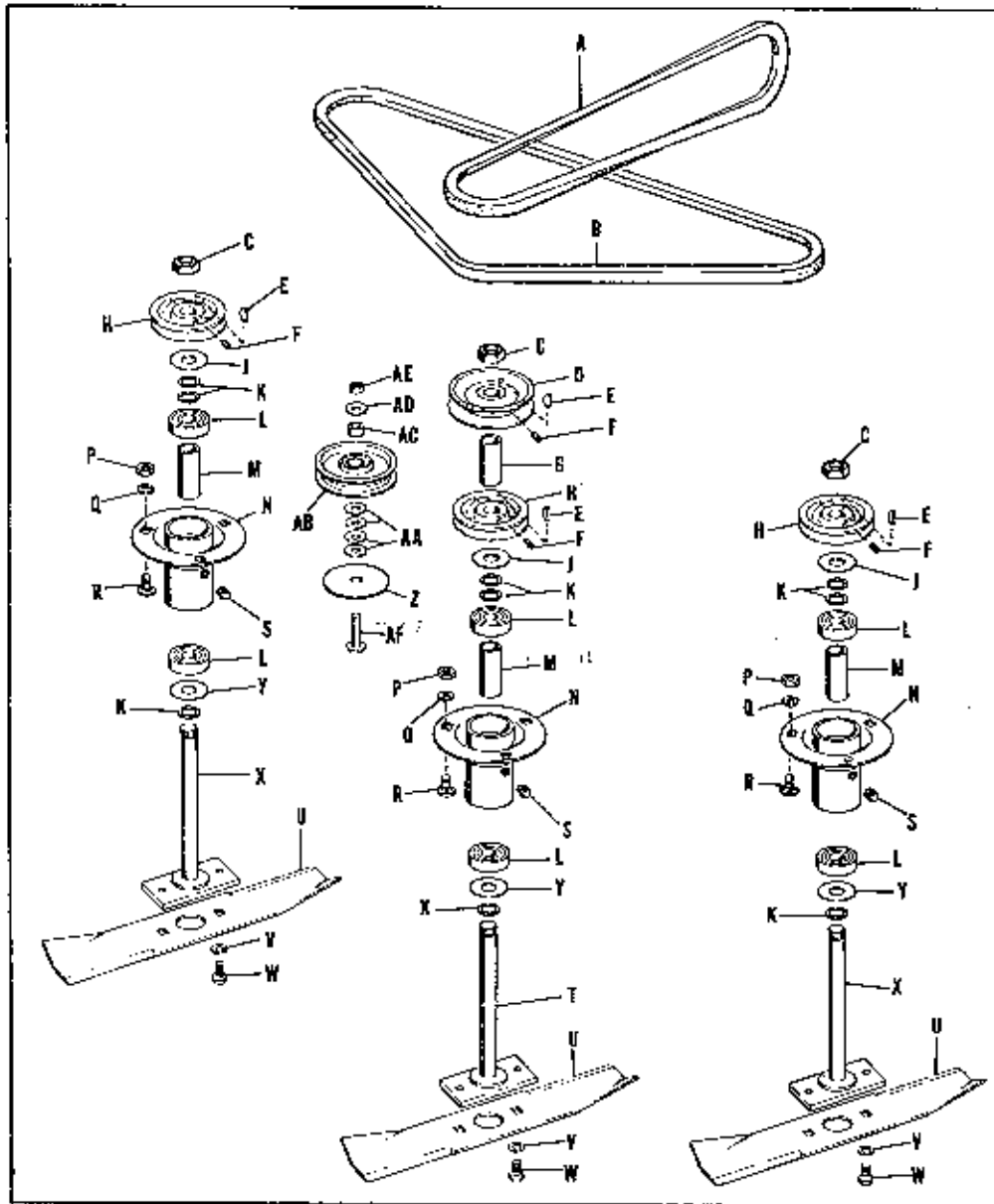

Ref. Letter	Part No.	Description
A	108099	Belt, "V" (Cross Drive)
B	108209	Belt, "V" (Mower Spindle Drive)
C	717517	Nut, Jam, Hex, Lock, 3/4"-16NF
D	108207	Pulley, Cross Drive
E	725006	Key, Woodruff, #61
F	713504	Screw, Set, Cup Point, Socket Hd., 5/16"-18 NC x 3/8" lg.
G	108245	Spacer
H	108142	Pulley
J	108139	Flinger
K	108181	Washer
L	108202	Bearing
M	108201	Spacer
N	108203	Tube Assembly, Arbor
P	717003	Nut, Hex, Full, 3/8"-16 NC
Q	720002	Washer, Lock, 3/8"
R	703004	Bolt, Carriage, 3/8"-16 NC x 3/4"

Ref. Letter	Part No.	Description
S	725001	Plug, Pipe, 1/8" Sq. Hd.
T	108252	Arbor Assembly, Drive
U	108298	Blade, Knife
V	720002	Washer, Lock, 3/8"
W	705011	Capscrew, Hex Hd., 3/8"-16 NC x 5/8" lg.
X	108250	Arbor Assembly
Y	108257	Washer
Z	108150	Washer
AA	719002	Washer, Plain, 5/16"
AB	108149	Pulley, Idler
AC	154177	Spacer
AD	719002	Washer, Plain, 5/16"
AE	717510	Nut, Hex, Full, Lock, 3/8"-16 NC
AF	703006	Bolt, Carriage, 3/8"-16 NC x 1 1/2" lg.