

Attachment Illustrated Parts List



Attachment

Mfg. No.	Description
1694916	Catcher, Clean Sweep Twin, 38/42"

Simplicity

MANUFACTURING, INC.
500 N. Spring Street / PO Box 997
Port Washington, WI 53074-0997 USA

www.simplicitymfg.com

© Copyright 2007 Simplicity Manufacturing, Inc. All Rights Reserved. Printed In USA.

Part No.: 1734810

Rev. 04/2007

TP 400-4531-00-AT-SMA

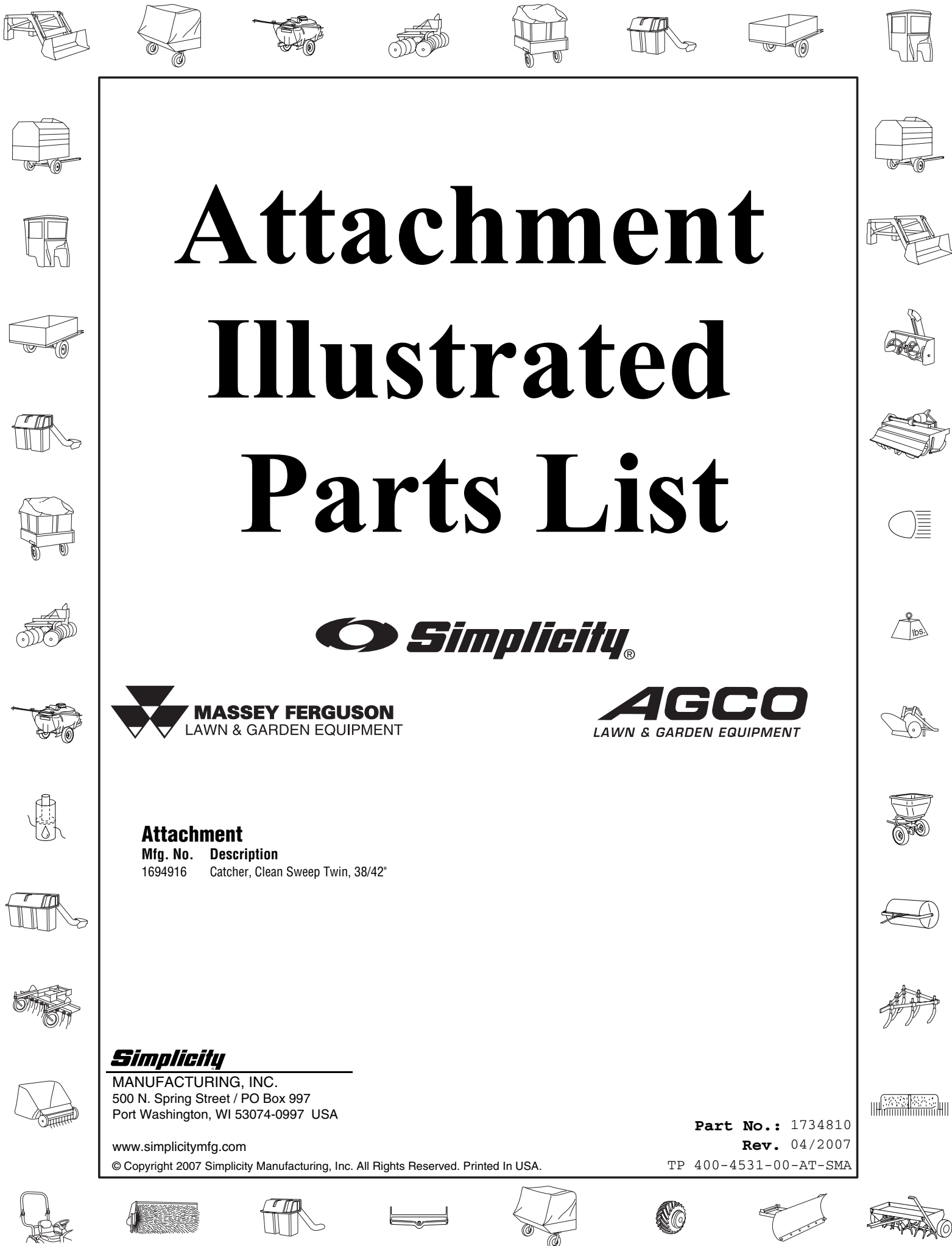

PRODUCT COMPONENTS	PAGES
Twin Catcher Assembly	4
Torque Specification Chart	Inside Back Cover

Twin Catcher Assembly

NOTE: Unless noted otherwise,
use the standard hardware torque
specification chart.

1694916

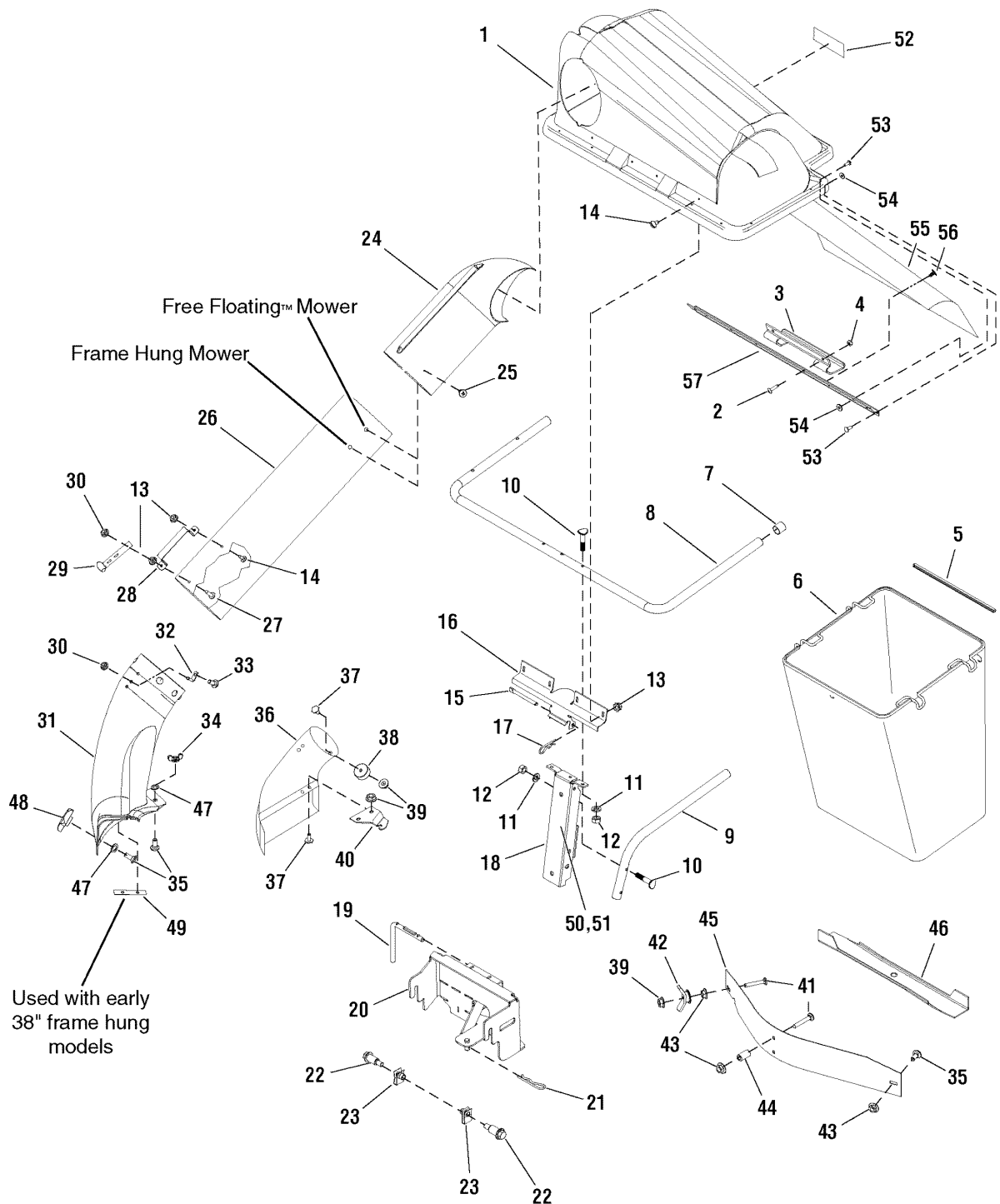

The above parts group applies to the following Mfg. Nos.:

1694916 - Catcher

Twin Catcher Assembly

REF NO	PART NO.	QTY.	DESCRIPTION
1	1732815SM	1	COVER ASSEMBLY, Twin (Includes Ref. Nos. 52, 53, 54, 55, 56, 57)
2	004x21MA	2	SCREW, #10 - 24 x 5/8
3	0504537MA	1	HANDLE, Cover
4	1933896SM	2	NUT, #10 - 24, ESNA Lock
5	1700864SM	2	EDGING, 13-1/8" Long
6	1732350SM	2	BAG ASSEMBLY, Twin
7	024862MA	3	CAP
8	054410E701MA	1	TUBE, "U"
9	054412E701MA	1	TUBE, Center
10	006x93MA	5	SCREW, 5/16 - 24, Curve
11	1917356SM	5	LOCKWASHER, 5/16 Spring
12	1920263SM	5	NUT, 5/16 - 24, Hex
13	1928372SM	6	NUT, 1/4 - 20, Keps Lock
14	004x24MA	5	SCREW, 1/4 - 20 x 1/2
15	054407ZMA	1	PIN, Cover Hinge
16	054398E701MA	1	HINGE, Cover
17	1960074SM	1	PIN, Hair
18	1732867SM	1	CHANNEL ASSEMBLY
19	1732565SM	1	PIN, Channel Mount
20	1732067ASM	1	MOUNT ASSEMBLY, Channel
21	1960033SM	1	PIN, Hair
22	1728976SM	2	BOLT, Shoulder, 5/16 - 18
23	1960717SM	2	NUT, 5/16 - 18, Speed
24	1732446SM	1	ELBOW, Upper Tube
25	26x239MA	1	SCREW, 1/4 x 3/4, Phillips
26	1732552SM	1	TUBE, Clear
27	004x71MA	1	SCREW, 1/4 - 20 x 1
28	054416ZMA	1	HANDLE, Tube
29	2171600SM	1	STRAP, Rubber
30	1930642SM	2	NUT, 1/4 - 20, Centerlock Flange
31	1732060SM	1	BOOT, 38/42" Snapper Models
32	054563MA	1	PIN, Latch
33	1960252SM	1	BOLT, Carriage, 1/4 - 20 x 5/8
34	014x86MA	1	NUT, 5/16 - 18, Wing
35	1931333SM	3	BOLT, Carriage, 5/16 - 18 x 3/4
36	1732561SM	1	BOOT, 38" Simplicity Model
37	1960371SM	3	SCREW, 5/16 - 18 x 3/4
38	1704341SM	1	WASHER, Special, 11/32 x 3/4
39	1935048SM	4	NUT, 5/16 - 18, Centerlock Flange
40	1704355ASM	1	BRACKET, Boot Mount
41	1931339SM	3	BOLT, Carriage, 5/16 x 18 x 2
42	1679163SM	1	NUT ASSEMBLY, 5/16 - 18, Wing
43	1927557SM	4	NUT, 5/16 - 18, Whizlock
44	1674669SM	2	SPACER

Footnotes

The above parts group applies to the following Mfg. Nos.:

1694916 - Catcher

Twin Catcher Assembly

NOTE: Unless noted otherwise,
use the standard hardware torque
specification chart.

1694916

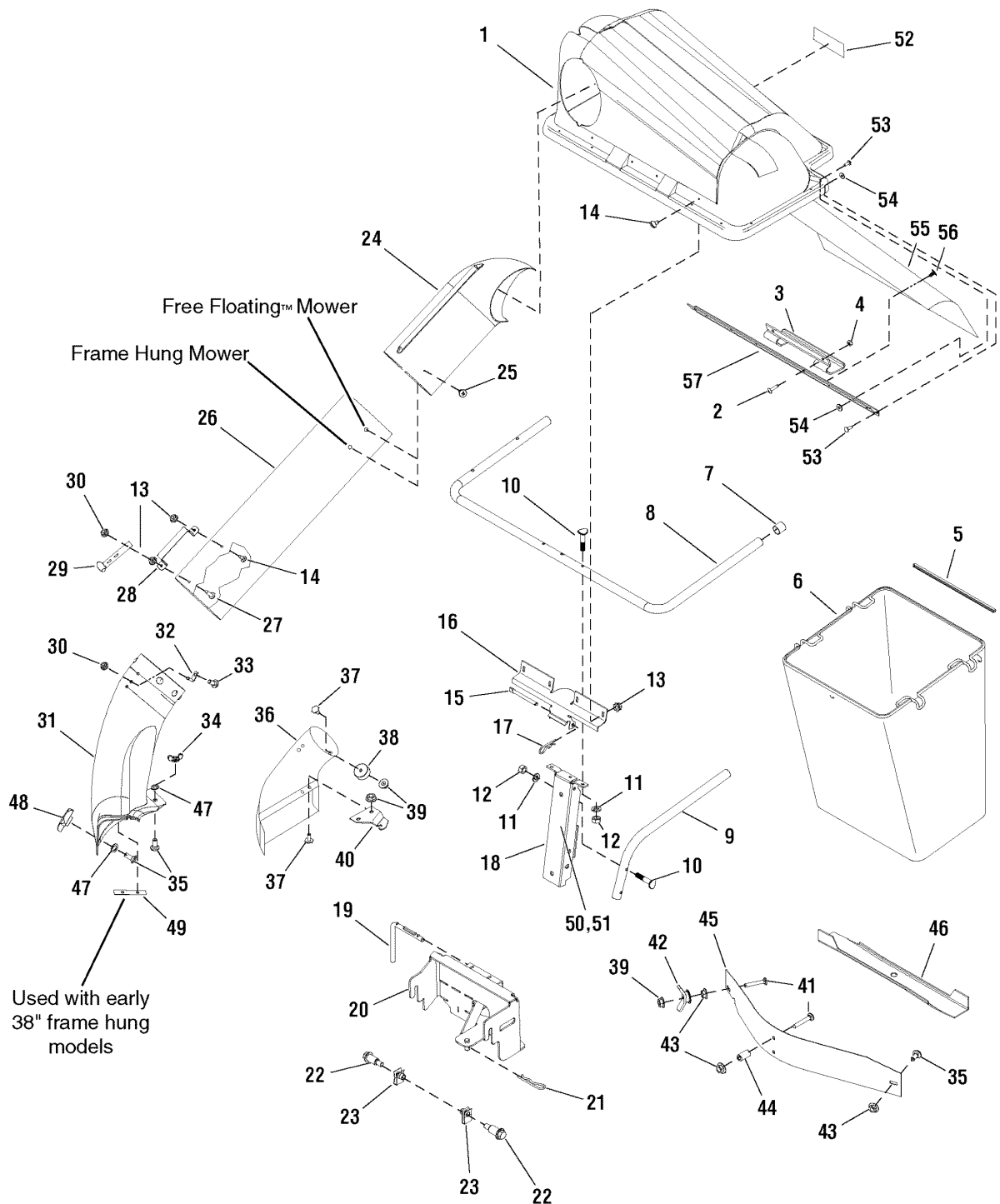

Used with early
38" frame hung
models

The above parts group applies to the following Mfg. Nos.:
1694916 - Catcher

Twin Catcher Assembly

REF NO	PART NO.	QTY.	DESCRIPTION
48	1733098SM	1	KNOB, 5/16 - 18, Internal Thread, 5 Lobe
49	1733180ASM	1	SHIM, Mower Deflector Bracket
50	----	1	ID LABEL/SERIAL PLATE (Not Servicable)
51	----	1	OVERLAY, Mylar (Not Servicable)
52	1732819SM	1	DECAL, Cover Warning
53	1673320SM	18	RIVET, Pop, 3/16
54	1910531SM	12	WASHER, Rivet, 3/16
55	1732488SM	1	SCREEN, Twin Cover
56	1732490SM	6	FASTENERS, Push, 1/4 x 1/2
57	1734384SM	1	SCREEN SUPPORT, Twin
--	1732352	1	INSTRUCTION MANUAL
--	1733181	1	INSTRUCTION SHEET, Shim

Footnotes

The above parts group applies to the following Mfg. Nos.:

1694916 - Catcher

Hardware Identification & Torque Specifications

Common Hardware Types

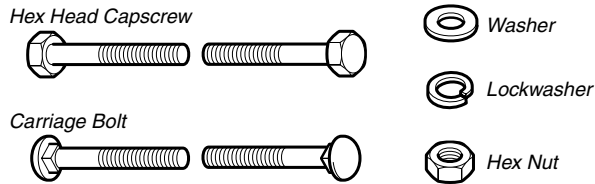

Standard Hardware Sizing

When a washer or nut is identified as **1/2"**, this is the *Nominal size*, meaning the *inside diameter* is 1/2 inch; if a second number is present it represent the *threads per inch*

When bolt or capscrew is identified as **1/2 - 16 x 2"**, this means the *Nominal size*, or *body diameter* is 1/2 inch; the second number represents the *threads per inch* (16 in this example, and the final number is the *body length* of the bolt or screw (in this example 2 inches long).

The guides and ruler furnished below are designed to help you select the appropriate hardware and tools.

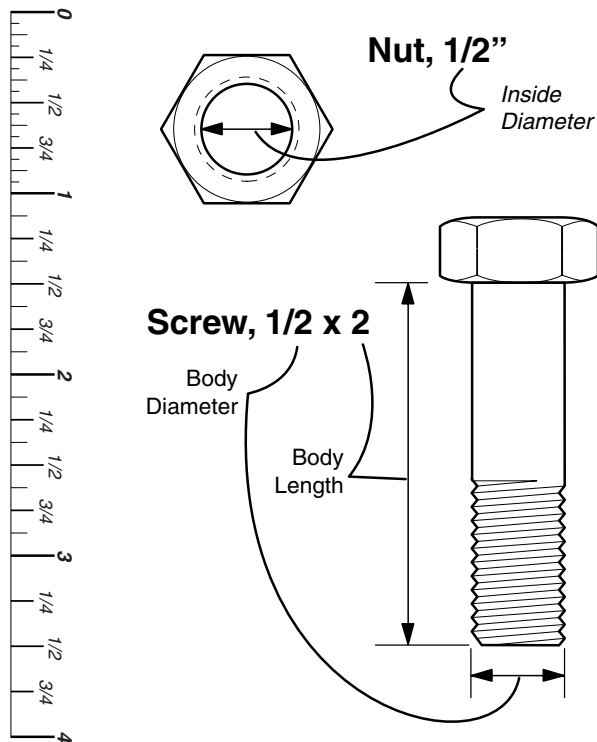

Torque Specification Chart						
FOR STANDARD MACHINE HARDWARE (Tolerance ± 20%)						
Hardware Grade	No Marks SAE Grade 2		SAE Grade 5		SAE Grade 8	
	in/lbs ft/lbs	Nm.	in/lbs ft/lbs	Nm.	in/lbs ft/lbs	Nm.
8-32	19	2.1	30	3.4	41	4.6
8-36	20	2.3	31	3.5	43	4.9
10-24	27	3.1	43	4.9	60	6.8
10-32	31	3.5	49	5.5	68	7.7
1/4-20	66	7.6	8	10.9	12	16.3
1/4-28	76	8.6	10	13.6	14	19.0
5/16-18	11	15.0	17	23.1	25	34.0
5/16-24	12	16.3	19	25.8	27	34.0
3/8-16	20	27.2	30	40.8	45	61.2
3/8-24	23	31.3	35	47.6	50	68.0
7/16-14	30	40.8	50	68.0	70	95.2
7/16-20	35	47.6	55	74.8	80	108.8
1/2-13	50	68.0	75	102.0	110	149.6
1/2-20	55	74.8	90	122.4	120	163.2
9/16-12	65	88.4	110	149.6	150	204.0
9/16-18	75	102.0	120	163.2	170	231.2
5/8-11	90	122.4	150	204.0	220	299.2
5/8-18	100	136	180	244.8	240	326.4
3/4-10	160	217.6	260	353.6	386	525.0
3/4-16	180	244.8	300	408.0	420	571.2
7/8-9	140	190.4	400	544.0	600	816.0
7/8-14	155	210.8	440	598.4	660	897.6
1-8	220	299.2	580	788.8	900	1,244.0
1-12	240	326.4	640	870.4	1,000	1,360.0

NOTES

- These torque values are to be used for all hardware excluding: locknuts, self-tapping screws, thread forming screws, sheet metal screws and socket head setscrews.
- Recommended seating torque values for locknuts:
 - for prevailing torque locknuts - use 65% of grade 5 torques.
 - for flange whizlock nuts and screws - use 135% of grade 5 torques.
- Unless otherwise noted on assembly drawings, all torque values must meet this specification.

Wrench & Fastener Size Guide



1/4" Bolt or Nut
Wrench—7/16"

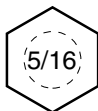

5/16" Bolt or Nut
Wrench—1/2"

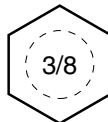

3/8" Bolt or Nut
Wrench—9/16"



7/16" Bolt or Nut
Wrench (Bolt)—5/8"
Wrench (Nut)—11/16"

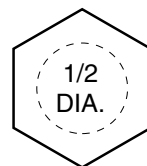

1/2" Bolt or Nut
Wrench—3/4"

