

\$1.00

OWNER'S GUIDE

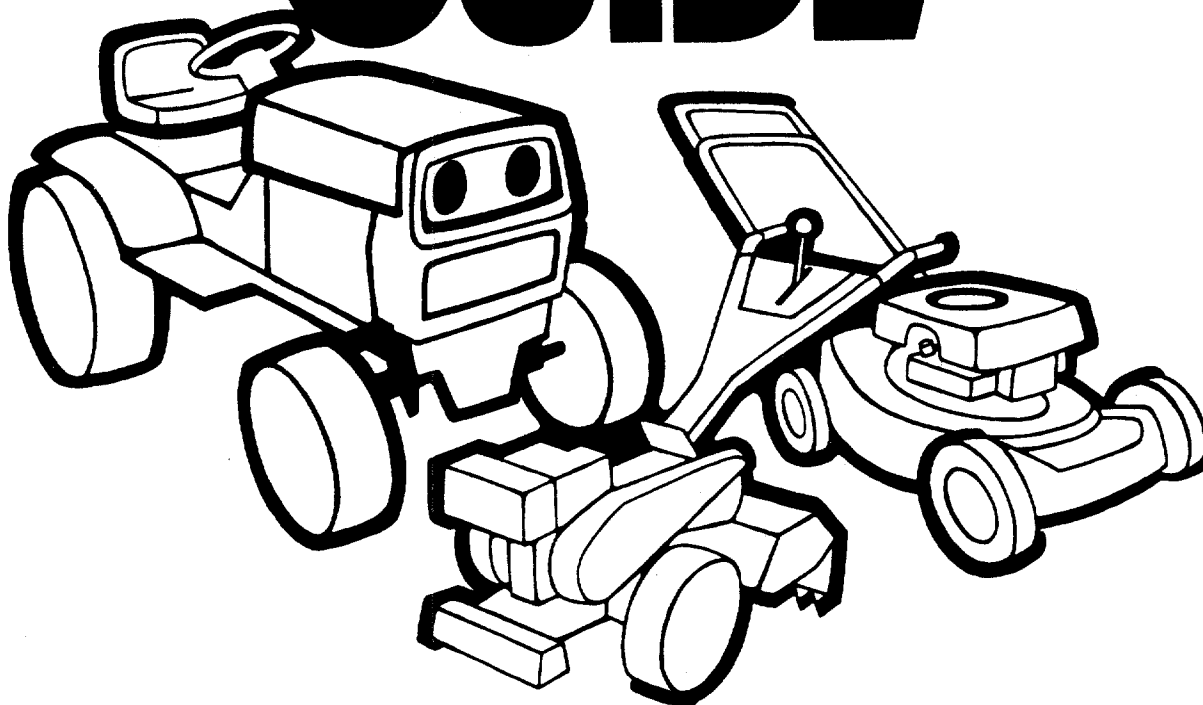

**38" SIDE
DISCHARGE
MOWING
DECK**

DECK "F"
Model Number
190-805-000
for
**Model 600 Series
Front Engine
Lawn Tractors**
190-063-000

**IMPORTANT: Read Safety Rules and Instructions In
Lawn Tractor Owner's Guide Carefully.**

Model 805 Deck ("F")

38" Side Discharge Mowing Deck Model 600 Series Front Engine Lawn Tractors

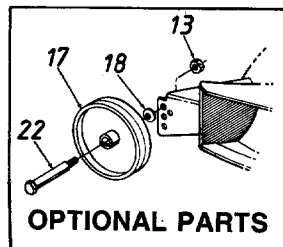
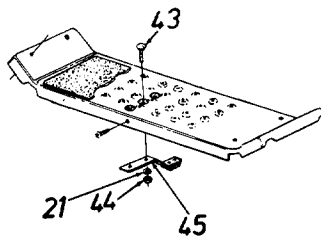
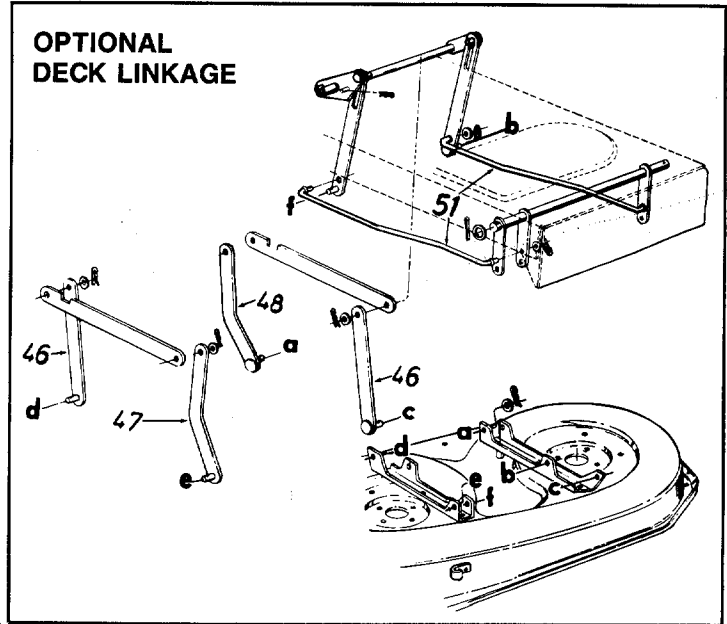
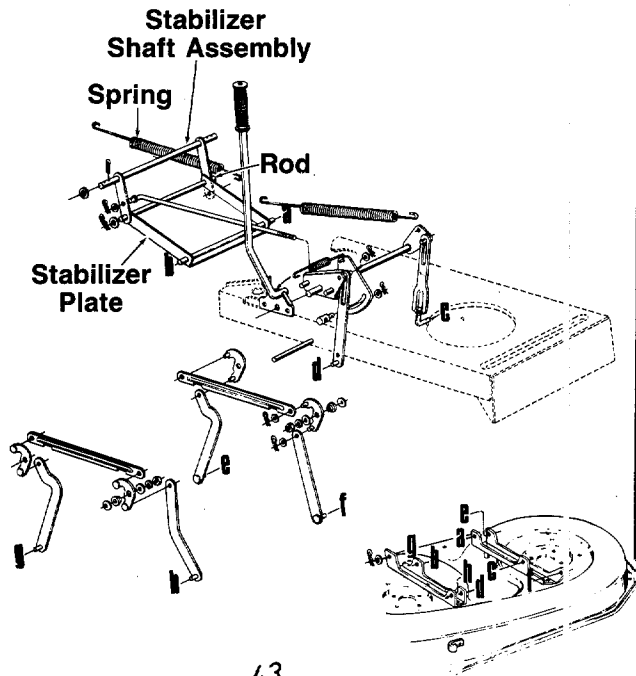

6" PLASTIC WHLS ON DECK
WERE SUBSTITUTED FOR 5"
WHLS ON SOME UNITS.

734-0974

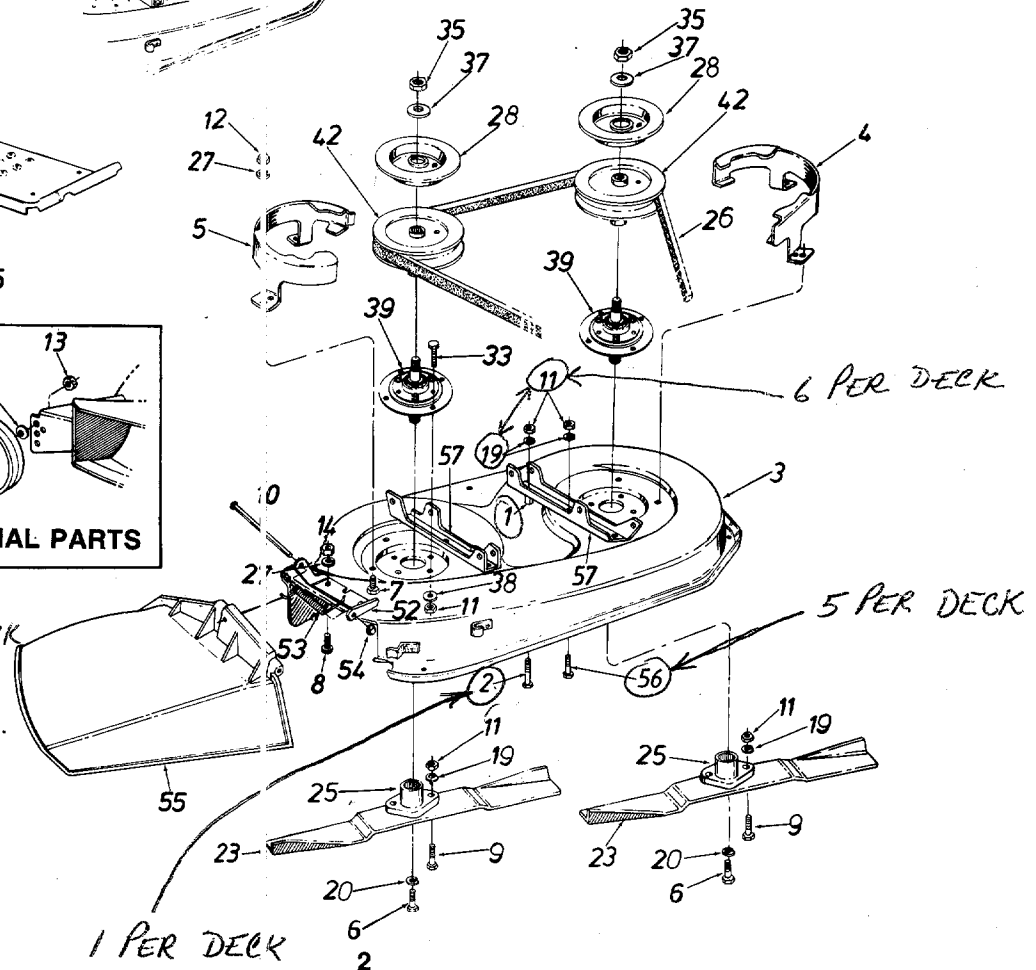

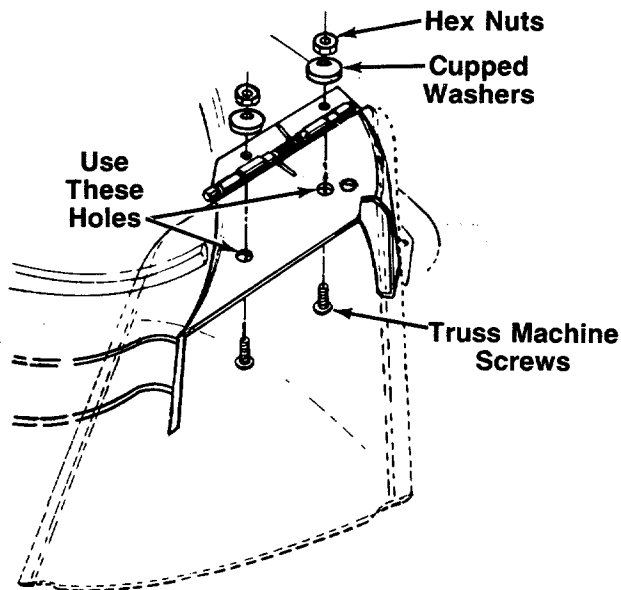

FIGURE 1.

Model 805 Deck

PARTS LIST FOR 38" MOWING DECK

REF. NO.	PART NO.	CODE	DESCRIPTION	REF. NO.	PART NO.	CODE	DESCRIPTION
1	750-0776		Spacer .33" I.D. x .88"	23	742-0473A		High-Lift Blade 19.38
2	710-0672		Hex Bolt 5/16-24 x 1.25" Lg.	25	748-0300		Blade Adapter
3	17503	N	38" Deck Ass'y. w/Deck Wheels	26	754-0329		V-Belt 69"
	801-7503	N	38" Deck Ass'y. Comp. w/Deck Wheels (For Service Only)	27	736-0270		Bell-Wash. 1/4" I.D.
	17717	N	38" Deck Ass'y. w/o Deck Wheels	28	09322		Brake Disc
	813-06102	N	38" Deck Ass'y. w/o Deck Wheels (For Service Only)	33	710-0157		Hex Bolt 5/16-24 x .75" Lg.
4	16607		Belt Guard Deck—L.H.	35	712-0318		Hex Jam Nut 5/8-18 Thd.
5	16608A		Belt Guard Deck—R.H.	37	736-0158		L-Wash. 5/8" I.D.*
6	710-0152		Hex Bolt 3/8-24 x 1.0" Lg.	38	736-0119		L-Wash. 5/16" I.D.*
7	710-0195		Hex Bolt 1/4-28 x .62" Lg.	39	717-0906		Blade Spindle Ass'y. Comp.
8	710-0255		Truss Mach. Scr. 1/4-20 x .75"	42	756-0486		5" Dia. Pulley
9	710-0888		Hex Bolt Special 5/16-24 x 1.0"	43	710-0134		Carr. Bolt 1/4-20 x .62" **
10	711-0792		Hinge Pin	44	712-0287		Hex Nut 1/4-20 Thd.**
11	712-0123		Hex Nut 5/16-24 Thd.*	45	761-0168		Blade Brake Ass'y.**
12	712-0138		Hex Nut 1/4-28 Thd.	46	14804		Link Deck Hanger Ass'y.**†
13	712-0181		Hex Top L-Nut 3/8-16 Thd.†	47	14800		Link Deck Hanger Ass'y. (Dog Leg)**†
14	712-0287		Hex Nut 1/4-20 Thd.*	48	15925		Link Deck Hanger Ass'y.—L.H.**†
17	734-0973		Deck Wheel—5"†	51	711-0790		Stabilizer Rod**†
18	736-0105		Bell-Wash. .40" I.D. x .88" O.D.†	52	703-1693		Hinge Mtg. Brkt.
19	736-0119		L-Wash. 5/16" I.D.*	53	732-0602		Torsion Spring
20	736-0217		L-Wash. 3/8" I.D.—H.D.	54	726-0106		Push Nut
21	736-0329		L-Wash. 1/4" I.D.*†	55	731-1032		Chute Ass'y. Comp.
22	738-0373		Shld. Bolt .498" Dia. x 1.53"†	56	710-0157		Hex Bolt 5/16-24 x .75" Lg.
				57	17493A	N	Deck Hanger Channel

†Optional Parts

**Not part of deck assembly complete.

*For faster service obtain standard nuts, bolts and washers locally. If these items cannot be obtained locally, order by part number and size as shown on parts list.

ASSEMBLY INSTRUCTIONS



WARNING: Do not operate your unit unless the chute deflector has been properly installed.

ATTACHING THE CHUTE DEFLECTOR

Assemble the chute to the deck, using the holes shown in figure 1.

1. Remove the truss machine screws, cupped washers and hex jam nuts which are attached to the deck next to the chute opening.
2. Place the chute deflector in position as shown in figure 1. Secure with hardware just removed.

HARDWARE REQUIRED FOR DK HANGER

736-0119 = 4

712-0123 = 6

710-0672 = 1

710-0157 = 5

750-0776 = 1

736-0242 = 2

17493A = 2



NOTE

Specifications subject to change without notice or obligation.

REFER TO THE LAWN TRACTOR OWNER'S MANUAL FOR SAFE OPERATION PRACTICES, AND CORRECT OPERATION AND MAINTENANCE INSTRUCTIONS. READ INSTRUCTIONS CAREFULLY.

DECK BELT REMOVAL AND REPLACEMENT

1. Place the lift lever in the disengaged position.
2. Remove the hex bolts (belt keepers) from the engine pulley belt guard. See figure 2.

NOTE: Your unit will have either two or three hex bolts. When reassembling, make certain hex bolts are assembled in the same locations from which they were removed. See figure 2.

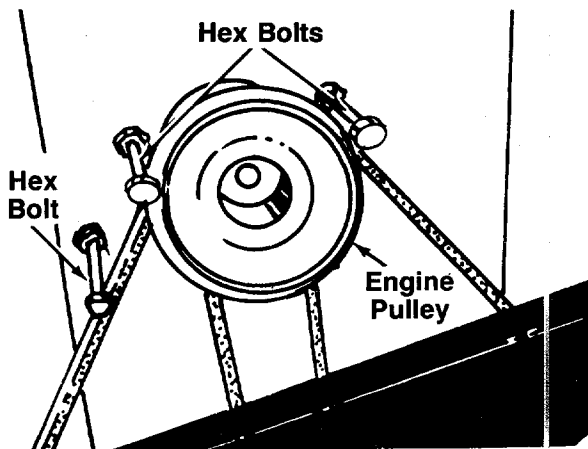

FIGURE 2.—Single Cylinder Engine Lawn Tractor Shown

NOTE: Figure 2 is shown with the unit tipped up for clarity. It is not necessary to tip the unit to remove the belts.

3. Unhook the deck belt from the engine pulley.
4. Place the lift lever in the engaged (all the way forward) position.

5. Lawn tractors equipped with a stabilizer plate attached to the deck (see illustration on page 2): Disconnect the spring which is attached to a bracket on the transaxle, inside the left rear wheel. Use a spring puller or other suitable tool.
6. Disconnect the six deck links by removing the hairpin clips and flat washers.
7. Lawn tractors equipped with a stabilizer plate attached to the deck: Disconnect the stabilizer plate from the stabilizer shaft assembly by removing the hairpin clips and flat washers and sliding out the rod.
8. Place the lift lever in the disengaged position.
9. Slide the deck from beneath the lawn tractor.
10. Remove the belt guards at each deck pulley by removing the hex bolts, lock washers and hex nuts. See figure 3.

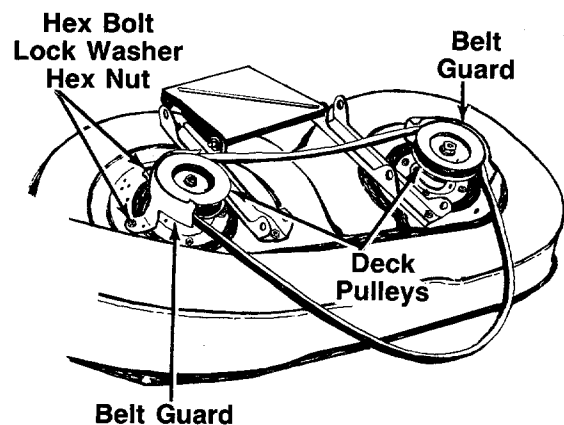

FIGURE 3.

11. Remove and replace the belt, reassemble following the instructions in reverse order.