

# Owner's Operating Service Instruction Manual

10¢

Model No.  
154-518A

- ASSEMBLY
- OPERATION
- REPAIR PARTS

## 18" SELF-PROPELLED REEL MOWER

### WARRANTY

For one year from date of purchase, MTD Products Inc will replace for the original purchaser, free of charge, F.O.B. factory or authorized service firm, any part or parts found to be defective in material or workmanship. All transportation charges on parts submitted for replacement under this warranty must be paid by the purchaser. This warranty does not include replacement of parts which become inoperative through misuse, excessive use, accident, neglect, improper maintenance or alterations by unauthorized persons. This warranty does not include the engine, motor, battery, battery charger or any component parts thereof. For service on these units, refer to the applicable manufacturer's warranty.

The above warranty will apply only to the original owner and will be effective only if the warranty card has been properly processed. It will not apply where the unit has been used commercially.

Warranty service is available through your local authorized service dealer or distributor. **UNDER NO CIRCUMSTANCES WILL THE RETURN OF A COMPLETE UNIT BE ACCEPTED BY THE FACTORY UNLESS PRIOR WRITTEN PERMISSION HAS BEEN EXTENDED.**

# **I M P O R T A N T**

## **SAFE OPERATION PRACTICES FOR WALK-BEHIND MOWERS**

### **TRAINING**

1. Read the Operating and Service Instruction Manual carefully. Be thoroughly familiar with the controls and the proper use of the equipment.
2. Never allow children to operate a power mower.
3. Keep the area of operation clear of all persons, particularly small children and pets.

### **PREPARATION**

1. Thoroughly inspect the area where the equipment is to be used and remove all stones, sticks, wire, bones and other foreign objects.
2. Do not operate equipment when barefoot or wearing open sandals. Always wear substantial footwear.
3. Check the fuel before starting the engine. Do not fill the gasoline tank indoors, when the engine is running, or while the engine is still hot. Wipe off any spilled gasoline before starting the engine.
4. Disengage the self-propelled mechanism or drive clutch on units so equipped before starting the engine (motor).
5. Never attempt to make a wheel adjustment while the engine (motor) is running.
6. Mow only in daylight or in good artificial light.
7. Never operate the equipment in wet grass. Always be sure of your footing; keep a firm hold on the handle and walk, never run.

### **OPERATION**

1. Do not change the engine governor settings or overspeed the engine.
2. Do not put hands or feet near or under rotating parts. Keep clear of the discharge opening at all times.
3. Stop the blade(s) when crossing gravel drive, walks or roads.
4. After striking a foreign object, stop the engine (motor), remove the wire from spark plug, thoroughly inspect the mower for any damage, and repair the damage before restarting and operating the mower.

5. If the equipment should start to vibrate abnormally, stop the engine (motor) and check immediately for the cause. Vibration is generally a warning of trouble.
6. Stop the engine (motor) whenever you leave the equipment, before cleaning the mower housing, and when making any repairs or inspections.
7. When cleaning, repairing or inspecting, make certain the blade and all moving parts have stopped. Disconnect the spark plug wire, and keep the wire away from the plug to prevent accidental starting.
8. Do not run the engine indoors.
9. Shut the engine (motor) off and wait until the blade comes to a complete stop before removing the grass catcher or unclogging chute.
10. Mow across the face of slopes, never up-and-down. Exercise extreme caution when changing direction on slopes. Do not mow excessively steep slopes.
11. Always disconnect electric mowers (line operated) before cleaning, repairing or adjusting.
12. Never operate mower without proper guards, plates or other safety protective devices in place.
13. Keep washout ports and other mower-housing service openings closed when mowing.

### **MAINTENANCE AND STORAGE**

1. Check the blade and engine mounting bolts at frequent intervals for proper tightness.
2. Keep all nuts, bolts, and screws tight to be sure the equipment is in safe working condition.
3. Never store the equipment with gasoline in the tank inside of a building where fumes may reach an open flame or spark. Allow the engine to cool before storing in any enclosure.
4. To reduce fire hazard, keep the engine free of grass, leaves, or excessive grease.
5. Check the grass catcher bag frequently for wear or deterioration. Replace with new bag for safety protection.

# ASSEMBLY INSTRUCTIONS

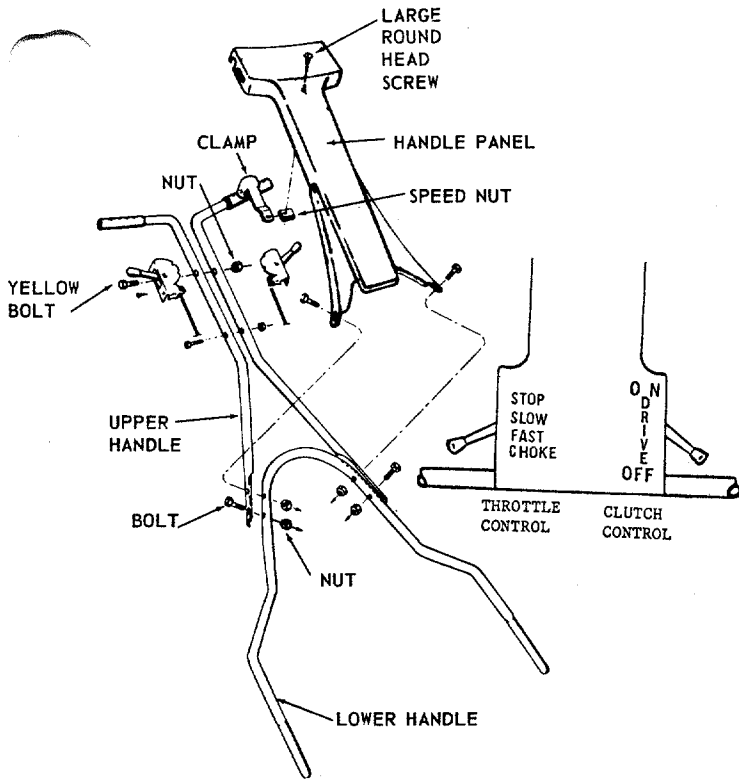

**FIG. 1**

Your lawn mower is right hand (R.H.) or left hand (L.H.) as you operate it.

1. Remove lawn mower and all parts from carton. Make certain that all loose parts and literature are removed from the carton before the carton is discarded.
2. Assemble two upper handle parts with bolt and nut in the second hole from the top and tighten.
3. Place the speed nut on the clamp so that the flat surface of the speed nut is on top.
4. Place the clamp over the upper handles and secure with the yellow bolt and nut. **DO NOT TIGHTEN.**
5. Fasten the handle panel to the handle in the upper holes where the upper and lower handle assemblies. Assemble lower bolts and nuts. **DO NOT TIGHTEN.**
6. Extend both control assemblies which are attached to the reel and place them on the floor.

## CAUTION

DO NOT BEND OR KINK WIRE

7. Snap lower handle into position over lugs on the deck.
8. Assemble handle stop bolt, with nut and lockwasher on the **RIGHT HAND** side frame as shown.

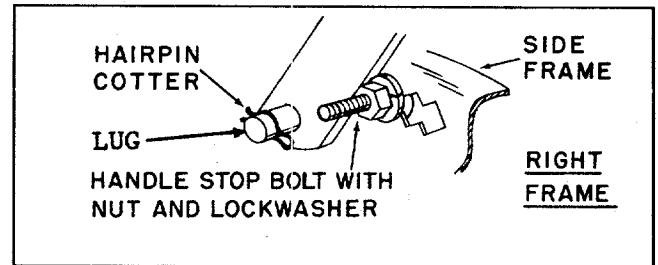

**FIG. 2**

9. Assemble the handle stop bolt, lockwasher, stop bracket on the **LEFT HAND** side frame as shown. See Adjustment Section for handle adjustment.

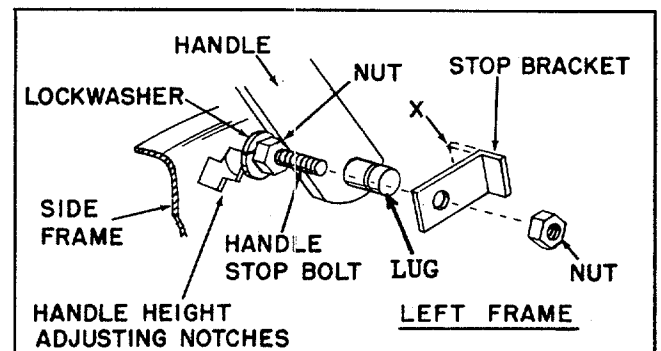

**FIG. 3**

10. Tilt the handle panel up about 3 inches and place the throttle control through the hole in the left side of the handle panel. Attach with two metal screws.
11. Repeat Step 10 with the clutch control on the right hand side of the handle panel.
12. Fasten the handle panel to upper handle with the large round head screw by tightening it into the speed nut on the clamp.
13. Tighten all bolts and nuts.
14. Secure control wires to lower handle with cable clips.

# OPERATING INSTRUCTIONS

1. Be sure the crankcase is filled with oil as recommended in this manual and put regular gasoline in the fuel tank.
2. Disengage drive by moving control to "OFF" position.
3. Move Throttle Control lever to "CHOKE" position.

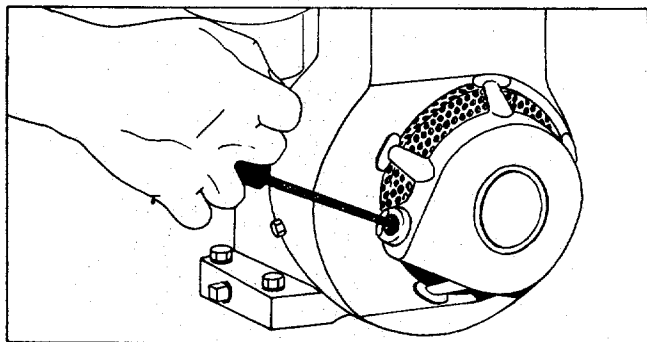

FIG. 4

4. Grasp starter grip as illustrated and pull out cord rapidly.
5. Slowly return the throttle control lever to the running position after the engine has stopped.

A brief break-in period is essential to insure maximum engine and mower life. This consists of running the engine at half speed for a period of time required to use one tank of gasoline. It is also recommended to change crankcase oil after the first five hours of operation.

## OPERATING YOUR MOWER

(See Fig. 1)

Engagement of the drive to place the mower and reel into motion is controlled by the clutch control on the right hand side of the handle panel. Move the clutch control forward to the "ON" position to engage the drive and back to the "OFF" position to disengage the drive.

The forward motion of the mower can temporarily be stopped by tipping the mower back on the rubber rollers so the wheels do not touch the ground.

The throttle control on the left hand side of the handle panel controls the speed of the reel. After you determine the desired speed the control lever can remain in that position when engaging or disengaging the drive.

To prevent tearing the lawn when making sharp turns, push down on the handle to raise the drive wheels and make the turn on the rear rollers. Disengage the drive when making very sharp turns. To pull the mower backwards, disengage the drive and push down on the handle and move the mower on the rear rollers.

## ADJUSTMENTS

### HANDLE HEIGHT ADJUSTMENT

(See Fig. 2 and 3)

For operating comfort, the handle height can be adjusted to one of four positions. To adjust handle height, proceed as follows:

1. Remove the hex nut and handle stop bracket from the handle stop bolt in the left side frame.
2. Remove the hex nut and lockwasher securing the handle stop bolt in both left and right side frames and remove the handle stop bolts.
3. Push the handle forward and insert the handle stop bolts through the desired notch in each side frame, making certain that both bolts are in the same notch in each side frame.
4. Reassemble the handle stop by reversing Steps 1 and 2.

For a controlled "float" of the handle, the stop bracket can be reversed as shown at X.

When the handle is in the high position, the handle stop is not required.

### **CAUTION**

When cutting tall grass, periodically check (remove if necessary) for excessive grass build-up around the reel shaft between the chain guard and reel. A build-up of grass in this area could force the chain guard into the chain and cause damage.

## CUTTING HEIGHT ADJUSTMENT

(See Fig. 5 and 6)

The cutting height of the mower is adjusted by raising and lowering the drive wheels and roller brackets. Refer to the cutting height table below to determine what position the wheels and roller brackets must be in to obtain the desired cutting height.

### CUTTING HEIGHT TABLE

CUTTING HEIGHT	POSITION FRONT	ROLLER POSITION SIDE FRAME	NOTCH IN ROLLER BRKT.
1/2"	A	1	Bottom
3/4"	A	2	Bottom
7/8"	A	3	Bottom
1"	B	1	Top
1-1/8"	A	3	Top
1-1/4"	B	2	Bottom
1-3/8"	B	3	Bottom
1-1/2"	B	3	Top
1-5/8"	C	2	Bottom
1-3/4"	C	2	Top
1-7/8"	C	3	Bottom
* 2"	C	3	Top
2-1/8"	D	1	Top
2-1/4"	C	4	Bottom
2-3/8"	C	4	Top
2-1/2"	D	3	Bottom
2-5/8"	D	3	Top
2-3/4"	D	4	Bottom
3"	D	4	Top

\* Cutting heights over 1-1/2" should be used only when grass conditions permit, i.e., tall, firm, vigorous grass.

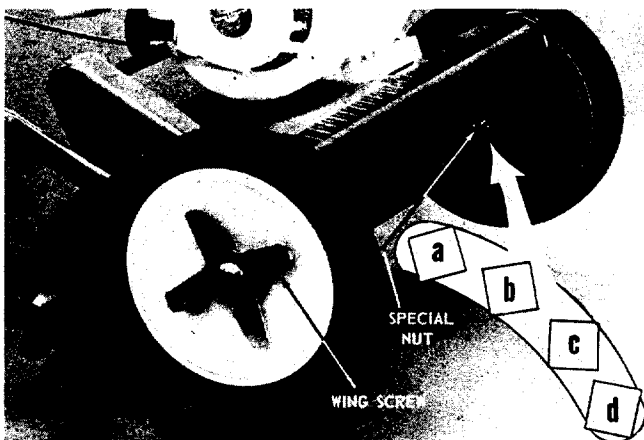

FIG. 5

## DRIVE WHEEL ADJUSTMENT (See Fig. 5)

1. Loosen the drive wheel wing screws and push the screws in, to disengage the special nuts from the height adjustment notch in the side frames.
2. Move the wheels to the desired position and engage two corners of the special nuts in the notch in the side frames.
3. Tighten the wing screws securely to lock the wheels in position.

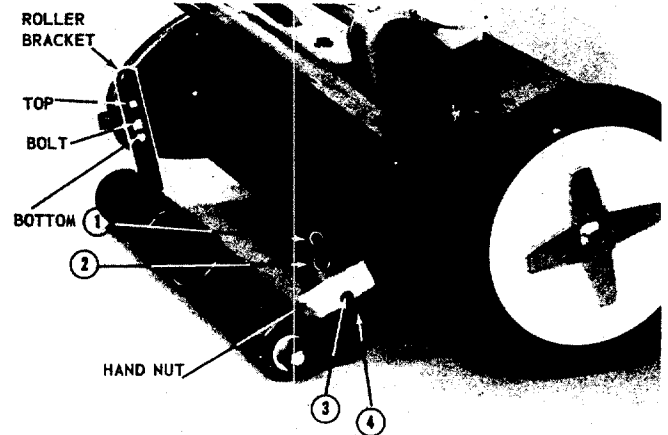

FIG. 6

### NOTE

Make sure the drive wheels are in the same notch in each side frame.

## REAR ROLLER BRACKET ADJUSTMENT

(See Fig. 6)

1. Loosen the roller bracket hand nuts until the end of the nuts clear the side frame.
2. Move the roller brackets to the desired position and push hand nuts in engaging hole in the side frames.
3. Move the roller brackets up or down until the bolts line up with the top or bottom notch in the brackets.
4. Tighten the hand nuts securely making certain the square shoulder of the bolts engage properly with the notch in the roller brackets.

### NOTE

Make certain the bolts are in the same notch in each roller bracket and the hand nuts are engaged in the same hole in each side frame.

## **DRIVE BELT ADJUSTMENT ( See Fig. 7 )**

The spring loaded idler pulley on the clutch automatically compensates for normal belt wear and stretch. If excessive belt slippage occurs and the belt is in good condition, perform the following adjustment:

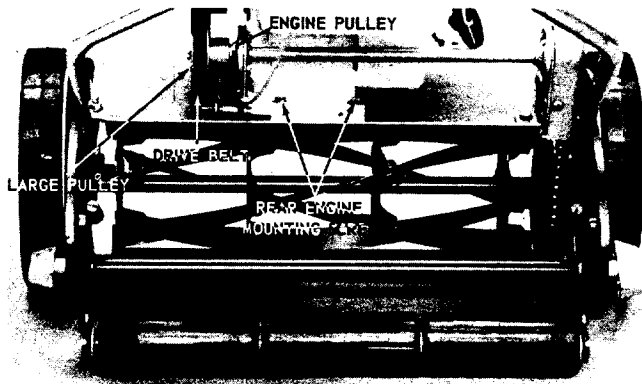

**FIG. 7**

1. Loosen the four engine mounting screws and slide the engine forward to remove only the excess slack from the belt. Do not move the engine too far forward, the belt will not disengage.
2. After adjusting the belt, tighten the engine mounting screws securely. Make certain the engine pulley is in line with the large pulley. Check alignment of pulleys by looking through rear of belt guard.
3. To insure the belt is properly adjusted, perform the following check:
  - a. Place the drive grip in the disengaged position and move the engine control lever to the stop position.
  - b. Pull the starter handle several times. If the mower has a tendency to move, belt is too tight. Move engine back to loosen belt and repeat the above procedure.
  - c. Start the engine and check the operation of the clutch, mower should not move when the clutch is disengaged.

## **CUTTER BAR ADJUSTMENTS ( See Fig. 8 )**

The cutter bar is adjusted by turning the two adjusting screws on the inside of each side frame. With a screw driver, turn the screw equally to the left (counter-clockwise) to bring the cutter bar closer to the reel blades. The cutter bar should very lightly contact the reel blades for best performance.

### **NOTE**

Excessive tightness will cause rapid wear of the cutting edges. A correctly adjusted cutter bar will cut a strip of newspaper along the full length of each reel blade and the reel will revolve freely.

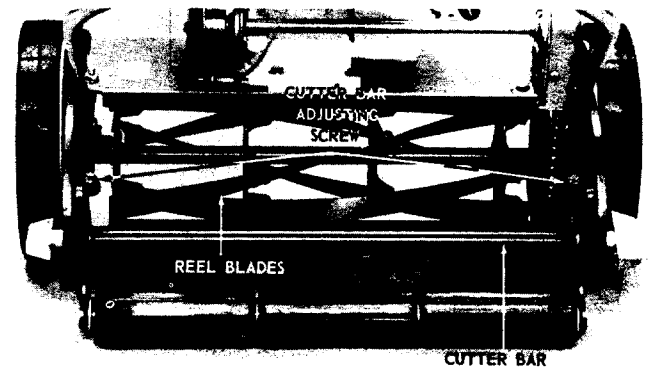

**FIG. 8**

## **CHAIN ADJUSTMENT ( See Fig. 9 )**

After a new mower has been operated for 5 to 10 hours, the chain may require adjustment to take up initial slack. After the initial adjustment, check chain adjustment each time the chain is lubricated. Adjust chain as follows:

1. Place the clutch control in the disengage position.
2. Remove the chain guard.
3. Loosen the upper nut on the deck adjusting screws on each side of the deck. On the chain side of the deck, insert a screw driver or steel bar between the deck and side frame. Pry the deck upward to tighten the chain. A properly adjusted chain has a slight amount of slack between the sprockets.
4. When the proper chain tension is obtained, reach through the handle slot in the deck and turn the lower nut on the adjusting screw up until it contacts the underside of the deck; then tighten the upper nut securely against the deck.
5. Adjust the opposite side of the deck approximately the same amount.
6. Reinstall chain guard.

### **NOTE**

Do not adjust the chain too tightly. This causes rapid wear and chain stretch, and may cause failure of the reel and cross shaft bearing.

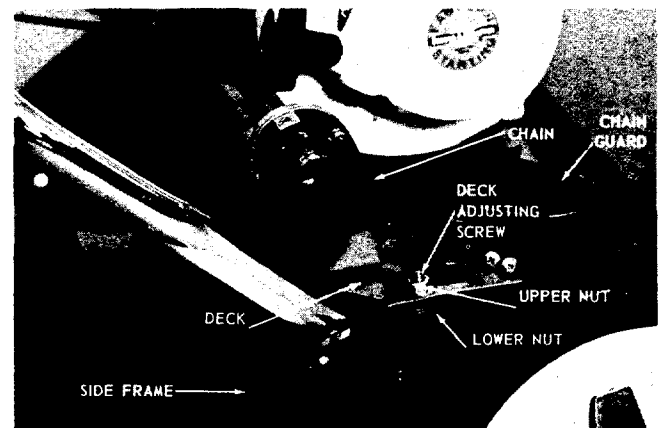

**FIG. 9**

## **DRIVE BELT REPLACEMENT ( See Fig. 10)**

1. Remove belt guard.
2. Loosen the four engine mounting bolts and slide the engine back as far as possible.
3. Place the drive grip in the disengaged position. Remove the old drive belt from around the engine pulley and then from around the large pulley.
4. Position the new drive belt around the large pulley. Slip the belt around the engine pulley making certain the bottom of the belt is between the belt guide and idler pulley.
5. Reinstall the belt guard making certain the pin inside the guard is above the belt.
6. Refer to drive belt adjustment instructions in this manual.

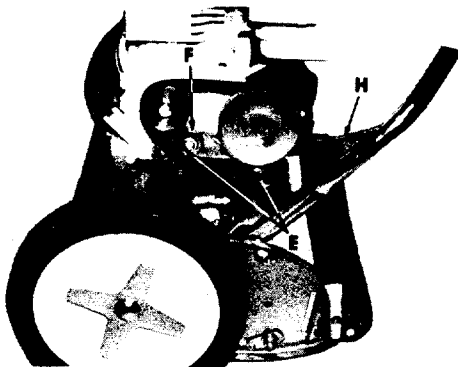

**FIG. 10**

Lubricating the mower as instructed below:

**A - Rear Rollers** - Every 10 to 15 operating hours, lubricate the rollers, Figure 12, with SAE No. 30 oil. Tip mower to allow oil to run into the rollers.

**B - Reel Bearings** - Shield type ball bearings, Figure 12, are lubricated at the factory and the only attention required is checking of the lubricant when the reel blades are sharpened, or when the mower is checked by your dealer.

**C - Gears and Wheels** - At the beginning of each cutting season lubricate the gears and wheels, Figure 13, with a semi-fluid grease, such as, Alemite Lubricant 0-164. To lubricate proceed as follows:

1. Remove the cotter pins from the end of the wing screws. Turn the wing screws out of the special nuts and remove the wheels from the mower. Remove the lock washer and axle from the wheels.
2. Apply a liberal amount of grease to the pinion and wheel gears, wheel hubs and axle.
3. Reassemble wheels by reversing Step 1. Make certain pinion and wheel gears mesh properly.

**D - Cross Shaft Bearings** - At the beginning of each season and after every 30 days of service, lubricate bearings, Figure 12, with SAE No. 30 oil. Insert spout of an oil can through the hole in the bearing covers and force oil into the felt retainer until saturated.

**E - Clutch Pivot Points** - At the beginning of each cutting season and as required to maintain smooth operation, lubricate clutch pivot points, Figure 11, with SAE No. 30 oil

**F - Idler Arm Cam** - At the beginning of each cutting season and as required to maintain smooth operation, lubricate the bottom edge of the idler arm cam, Figure 11, with a light coat of grease.

**G - Roller Chain** - Every 8 operating hours, lubricate the roller chain, Figure 12, with SAE No. 30 oil. Apply oil to the chain so that it reaches the inside of each roller.

**H - Throttle and Clutch Control Cables** - If the control cables, Figure 12, become hard to operate, lubricate the outside of control cable housing with No. 30 oil. Oil will run between the coils and lubricate the inside of the housing. Wipe off the excess oil that remains on the outside of the housing.

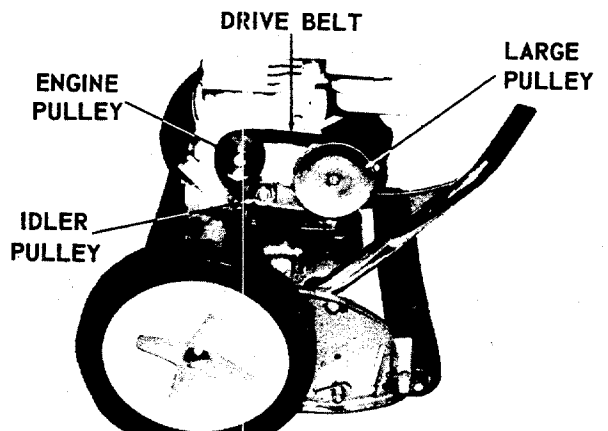

**FIG. 11**

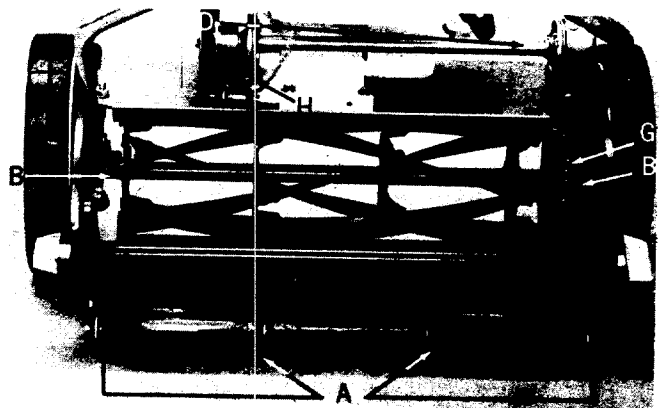

**FIG. 12**

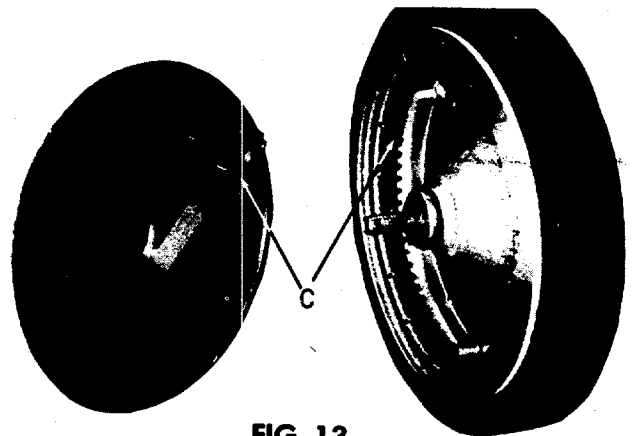

**FIG. 13**

# REEL MOWER MODEL 154-518A

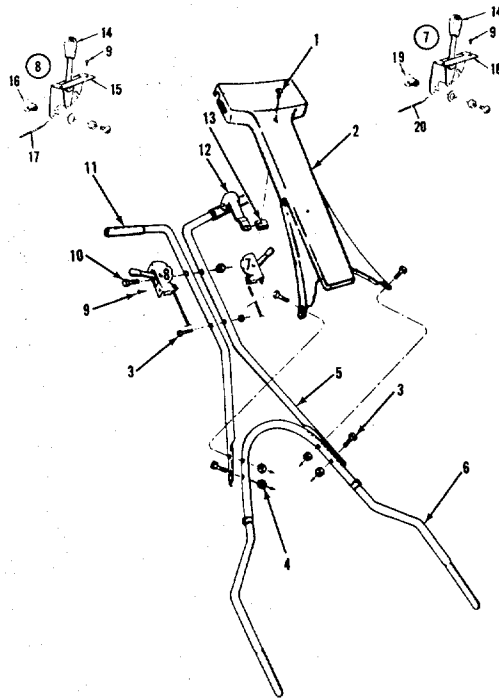

FIG. 14

Illus. No.	Part No. COLOR CODE	DESCRIPTION
1	710-473	Truss Head Machine Screw 10—24 x .50 long *
2	9365—463	Handle Panel
3	710-606	Hex Head Cap Screw ¼—20 x .50 long *
4	712-107	Hex Centerlock Nut ¼—20 thread *
5	9364	Upper Handle (2 required)
6	7522	Lower Handle
7	9641	Clutch Control Complete
8	8357	Throttle Control Complete
9	710-148	Thread Cutting Screw 8—32 x ¾ long *
10	710-136	Hex Head Cap Screw ¼—20 x 2 long *
11	7071	Grip (2 required)
12	7861	Clamp Control
13	712-526	Speed Nut
14	7470	Knob † ‡
15	8372	Throttle Control Bracket ‡
16	7627	Ferrule-Throttle Control ‡
17	732-139	Conduit and Wire ‡
18	9849	Clutch Control Bracket †
19	9642	Ferrule-Clutch Control Bracket †
20	732-177	Clutch Control - Conduit & Wire †
21	714-130	Hairpin Cotter H.P.C. 150 13 Wire for .50" Pin

\* For faster service obtain standard nuts, bolts and washers locally. If these items cannot be found locally order by part number and size as shown on parts list.

‡ Part of Throttle Control Complete 8357.

† Part of Clutch Control Complete 9641.

The engine is not under warranty by the mower manufacturer. If repairs or service is needed on the engine, please contact your nearest authorized engine service outlet. Check the "Yellow Pages" of your telephone book under "Engines - Gasoline."

Find us fast in the





# REEL MOWER MODEL 154-518A

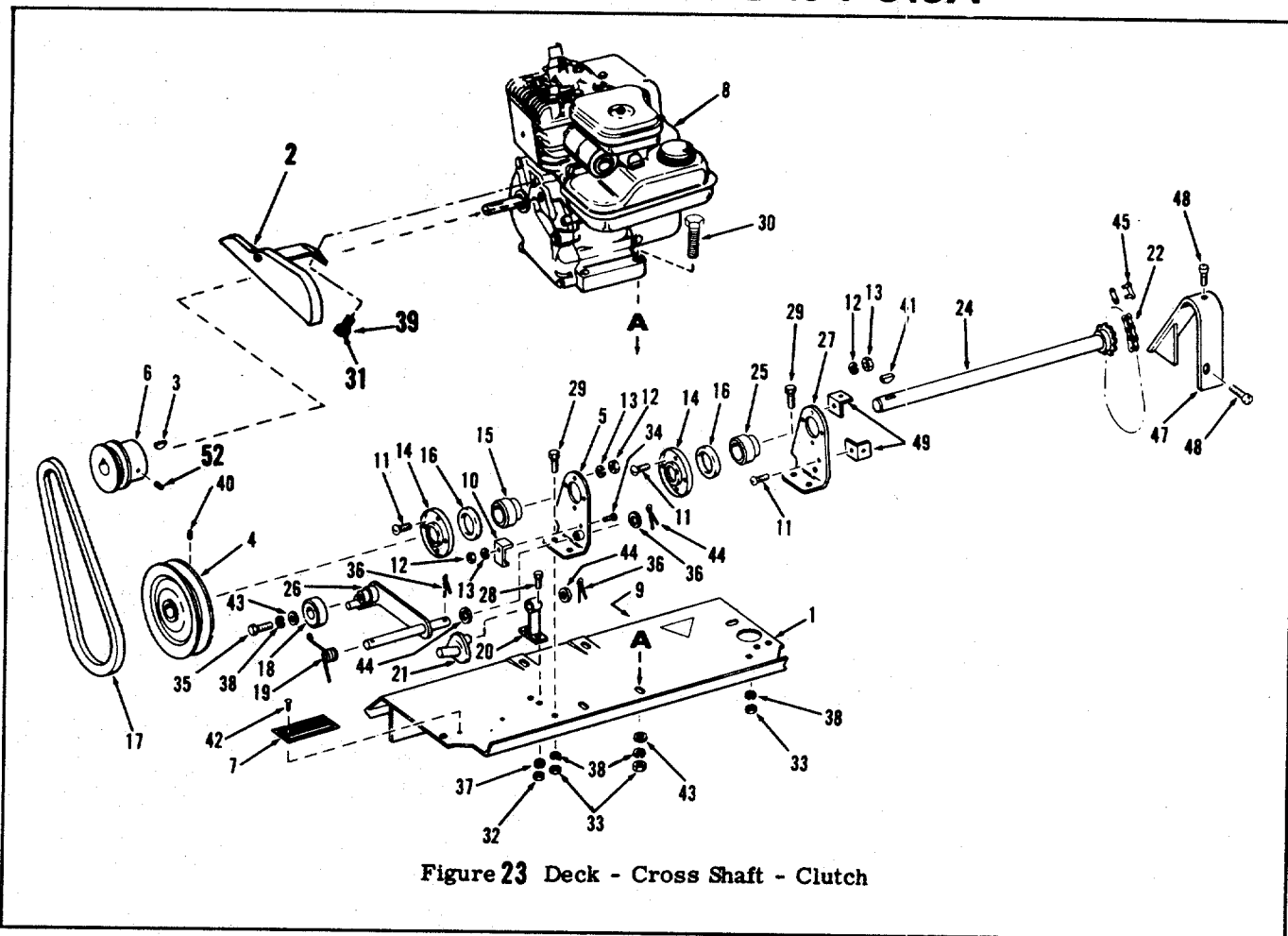

Figure 23 Deck - Cross Shaft - Clutch

Ref. No.	Part No.	Quan.	Description	Ref. No.	Part No.	Quan.	Description
1	JA-126317	1	Deck	27	JA-315028	1	Bracket, Cross Shaft Bearing
2	JA-126101	1	Guard Assembly, Belt	28	JA-400106	2	Hex Hd. Cap Scw. 1/4-20 x .62 lg. *
3	714-106	1	Key, Crankshaft Pulley	29	JA-400182	4	Hex Hd. Cap Scw. 5/16-18 x .62 lg. *
4	JA-112965	1	Pulley, Cross Shaft	30	JA-400192	4	Hex Hd. Cap Scw. 5/16-18 x .50 lg. *
5	JA-154018	1	Cross Shaft Bracket Ass'y	31	710-131	1	Hex Hd. Cap Scw. 1/2-20 x .75 lg. *
6	756-126	1	Pulley, Crankshaft	32	JA-443102	2	Nut, 1/4-20 Hex *
7	-	1	Plate, Serial Number	33	JA-443106	8	Nut, 5/16-18 Hex *
8	-	1	Engine Assem. B & S Mod. No. 60102	34	JA-402122	1	Rd. Hd. Mach. Scw. No. 10-24 x .75*
9	JA-329051	1	Decal, Model	35	JA-402278	1	Rd. Hd. Mach. Scw. 5/16-18 x .50*
10	JA-310305	1	Clamp, Cable	36	JA-460004	3	Cotter Pin 1/16 x .75*
11	JA-402116	9	Rd. Hd. Mach. Scw. No. 10-24 x 3/8 *	37	JA-446128	2	Lockwasher .25*
12	JA-444310	9	Nut, No. 10-24, Hex *	38	JA-446134	9	Lockwasher 5/16 *
13	JA-447208	9	Lockwasher, No. 10 Type 12 *	39	736-114	1	Lockwasher *
14	JA-314798	2	Cover, Bearing	40	JA-427503	1	Set Screws 5/16-18 *
15	JA-314801	1	Bearing, Cross Shaft, L.H.	41	JA-463009	1	Key No. 6
16	JA-314802	2	Felt, Oil Retaining	42	JA-409508	2	Screw, No. 2 x .25 Type "U" Drive *
17	754-126	1	Belt, Drive 1/2 x 20	43	JA-457016	5	Washer 5/16 Flat Burr *
18	JA-311961	1	Bearing, Idler	44	JA-453011	3	Washer 3/8 SAE *
22	JA-314843	1	Chain, Drive	48	JA-409226	3	Pan Hd. Sheet Metal Scw. No. 10 x 3/8 *
19	JA-314823	1	Spring, Belt Tightener	45	JA-470506	1	Link Connecting
20	JA-314827	1	Bracket, Bell Crank	46	JA-447006	1	Lockwasher, No. 10 *
21	JA-154017	1	Crank, Bell	47	JA-107716	1	Guard, Chain
22	JA-314843	1	Chain, Drive	48	JA-409226	3	Pan Hd. Sheet Metal Scw. No. 10 x 3/8 *
24	JA-107655	1	Shaft, Cross w/Sprocket	49	JA-314929	2	Clip, Chain Guard, Upper
25	JA-314930	1	Bearing, Cross Shaft R.H.	51	JA-341853	1	Decal, Safety Specs.
26	JA-154388	1	Shaft and Arm, Clutch	52	710-137	1	Set Screw 5/16-24 thread *

\* For faster service obtain standard nuts, bolts and washers locally. If these items cannot be found locally order by part number and size as shown on parts list.

# REEL MOWER MODEL 154-518A

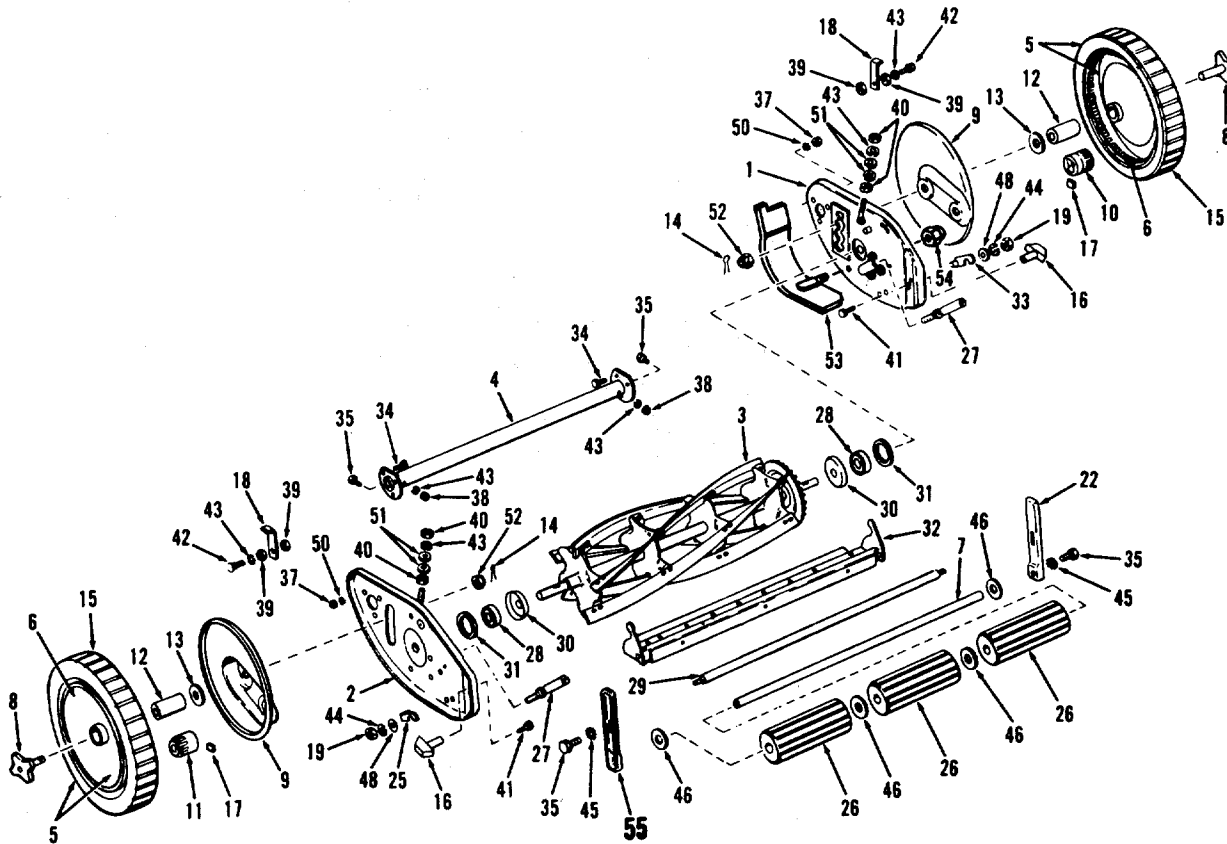

Figure 24 Lower Unit

Ref. No.	Part No.	Quan.	Description	Ref. No.	Part No.	Quan.	Description
1	JA-119160	1	Frame, R.H. Side	28	JA-314854	2	Bearing, Reel Shaft
2	JA-119159	1	Frame, L.H. Side	29	JA-315061	1	Rod, Tie
3	JA-119159	1	Reel Ass'y, 5 Blade w/Sprocket	30	JA-314871	2	Slinger, Dirt
4	JA-106918	1	Tube, Front Cross	31	JA-314920	2	Washer, Reel Bearing Felt
5	JA-106921	2	Wheel Assembly, w/Tire	32	JA-107711	1	Bar, Cutter
6	JA-106922	2	Wheel Assembly, less Tire	33	JA-107663	1	Pin and Plate, Mounting, R.H.
7	JA-309565	1	Shaft, Rear Roller	34	JA-400104	6	Hex Hd. Cap Scw. 1/4-20 x .50*
8	JA-154021	2	Knock Off Spinner Ass'y R.H.	35	JA-400182	4	Hex Hd. Cap Scw. 5/16-18 x .62*
8A	JA-500523	1	Knock Off Spinner Ass'y L.H.	36	JA-343754	2	Decal, Roller Adj.
9	JA-154023	2	Shield, Dust	37	JA-443102	6	Nut, 1/4-20 Hex *
10	JA-313503	1	Pinion, R.H.	38	JA-443106	2	Nut, 5/16-18 Hex *
11	JA-313504	1	Pinion, L.H.	39	JA-443806	4	Nut, Jam 5/16-18 Hex *
12	JA-343694	2	Shaft, Wheel	40	JA-443808	4	Nut, Jam 5/16-24 Hex *
13	JA-447018	2	Washer, Lock, .50" Ext. *	41	JA-44086	2	Bolt, 5/16-18 x .50 Carriage*
14	JA-460028	2	Pin-1/8 x 1 Cotter - Wheel Ret. *	42	JA-440078	2	Bolt, 5/16-18 x .75 Short Neck Carriage*
15	JA-313511	2	Tire, Diamond Tread	43	JA-446134	6	Lock washer, 5/16 *
16	JA-229042	2	Knob, Roller Adj.	44	JA-446140	2	Lock washer, 3/8 *
17	JA-313659	2	Pawl, Pinion Drive	45	JA-447012	2	Lock washer *
18	JA-313707	2	Bracket, Handle Stop	46	JA-452012	4	Washer, 1/2 Flat *
19	JA-443810	2	Nut, 3/8-16 Hex Jam *	48	JA-453011	2	Washer, 3/8 Flat *
20	JA-107001	1	Case, R.H. Adj. Screw w/Rivets *	50	JA-447510	6	Lock washer, 1/4 *
21	JA-107000	1	Case, L.H. Adj. Screw w/Rivets *	51	JA-455010	4	Washer, 5/16 Flat *
22	JA-344148	1	Bracket, Rear Roller R.H.	52	JA-343852	2	Nut, Wheel Adjustment *
23	JA-314767	2	Stud, Handle	53	JA-154118	1	Reel Sprocket Guard Ass'y
24	JA-314792	2	Screw, Deck Adjusting	54	JA-445630	1	Nut, 5/16-18 Hex Conelock Gd. Mtg. *
25	JA-107593	1	Pin and Plate, Mounting, L.H.	55	JA-344147	1	Bracket, Rear Rolled L.H.
26	JA-343701	3	Roller, Rear				
27	JA-314852	2	Screw, Cutter Bar Adjusting				

For faster service obtain standard nuts, bolts and washers locally. If these items cannot be found locally order by part number and size as shown on parts list.

# PARTS INFORMATION

**DEFECTIVE OR MISSING PARTS** must be reported to the factory immediately. Such claims must include your model number and date of purchase.

## POWER EQUIPMENT PARTS AND SERVICE

Parts and service for all MTD manufactured power equipment are available through the authorized service firms listed below. All orders should specify the model number of your unit, parts numbers, description of parts and the quantity of each part required.

### A 1 Engine & Mower Co.

327 East 9th Street  
Salt Lake City, Utah 84102

### American Electric Ignition Co.

124 N. W. 8th Street  
Oklahoma City, Oklahoma 73102

### Auto Electric & Carburetor Co.

2525 4th Avenue, S.  
P. O. Box 1948  
Birmingham, Alabama 35233

### Automotive Equipment Service Co.

3117 Holmes Street  
Kansas City, Missouri 64109

### Bailey's Rebuild Inc.

1325 E. Madison Street  
Seattle Washington 98102

### Bleckrie, Inc.

7900 Lorain Avenue  
Cleveland, Ohio 44102

### Brown Equipment Distributor Inc.

110 Beech Street  
Corydon, Indiana 47112

### Bullard Supply

2409 Commerce Street  
Houston, Texas 77003

### Carl A. Anderson Co.

623 S. 16th Street  
Omaha, Nebraska 68102

### Catto & Putty, Inc.

P. O. Box 2408  
510 Soledad Street  
San Antonio, Texas 78205

### Center Supply Company

6867 New Hampshire Avenue  
Takoma Park, Maryland 20012

### Dixie Sales Company

P. O. Box 1408  
327 Battleground Avenue  
Greensboro, North Carolina 27402

### East Point Cycle & Key Shop

1617 Whiteway  
East Point, Georgia 30044

### Gamble Distributors

West End Avenue  
Carthage, New York 13619

### Garden Equipment Co., Inc.

6600 Cherry Avenue  
Long Beach, California 90805

### Gardenville Supply, Inc.

Pipersville, Pennsylvania 18947

### Henry W. O'Neil & Assoc., Inc.

410 North Goodman Street  
Rochester, New York 14609

### Henzler, Inc.

2015 Lemay Ferry Road  
St. Louis, Missouri 63125

### Kenton Supply

8216 North Denver Avenue  
Portland, Oregon 97217

### Kimber's Inc.

115 W. Geddes St.  
Syracuse, New York 13204

### The Lawnmower Shop

1340 El Camino Real  
San Carlos, California 94070

### Marr Brothers

423 E. Jefferson  
Dallas, Texas 75203

### Mathews Auto Electric Co.

420 East 2nd Street  
Tulsa Oklahoma 74120

### McClure Lawn & Garden Supply

1114 Lexington Avenue  
Mansfield, Ohio 44907

### Memphis Cycle & Supply Co.

421 Monroe Avenue  
Memphis Tennessee 38103

### Morton B. Collins Co.

300 Birnie Avenue  
Springfield, Massachusetts 01107

### Moz-All of Florida, Inc.

365 Greco Avenue  
Coral Gables, Florida 33146

## BRIGGS & STRATTON, TECUMSEH AND PEERLESS PARTS AND SERVICE

Briggs & Stratton, Tecumseh and Peerless parts and service should be handled by your nearest authorized engine service firm. Check the yellow pages of your telephone directory under the listing *Engines — Gasoline*, Briggs & Stratton or Tecumseh Lauson — Power Products.

### National Central, Div. of

Joe Sterling, Inc.  
Drawer "D" 687 Seville Rd.  
Wadsworth, Ohio 44281

### Parts & Sales Inc.

2101 Industrial Pkwy.  
Elkhart, Indiana 46514

### Power Equipment Distributor

36463 So. Gratiot Avenue  
Mt. Clemens, Michigan 48043

### Power Lawn & Garden Equip. Co.

2551-2571 J. F. Kennedy Road  
Dubuque, Iowa 52001

### Radco Distributors

2403 Market Street  
P. O. Box 3216  
Jacksonville, Florida 32206

### Raub Supply Company

James & Mulberry Sts.  
Lancaster, Pennsylvania 17604

### Richmond Battery & Ignition

P. O. Box 25369 — 957 Myers St.  
Richmond, Virginia 23260

### Smith Hardware Company

515 N. George Street  
Goldsboro, North Carolina 27530

### South Denver Lawn Equip. Co.

527 West Evans  
Denver, Colorado 80223

### Suhren Engine

8330 Earhart Blvd.  
New Orleans, Louisiana 70118

### Sutton's Lawn Mower Shop

Route 4, Box 343  
North Little Rock, Arkansas 72117

### Warner Equipment

7520 Lyndale Avenue, So.  
Minneapolis, Minnesota 55423

### Woodson Sales & Service

1702 North Sylvania  
Ft. Worth, Texas 76111

## WARRANTY PARTS AND SERVICE POLICY

The purpose of warranty is to protect the customer from defects in workmanship and materials, defects which are NOT detected at the time of manufacture. It does not provide for the unlimited and unrestricted replacement of parts. Use and maintenance are the responsibility of the customer. The manufacturer cannot assume responsibility for conditions over which it has no control. Simply put, if it's the manufacturer's fault, it's the manufacturer's responsibility; if it's the customer's fault, it's the customer's responsibility.

### CLAIMS AGAINST THE MANUFACTURER'S WARRANTY INCLUDES

1. Replacement of Missing Parts on new equipment.
2. Replacement of Defective Parts within the warranty period.
3. Repair of Defects within the warranty period.

All claims MUST be substantiated with the following information:

1. Model Number of unit involved.
2. Date unit was purchased or first put into service.
3. Date of failure.
4. Nature of failure.

