

OWNER'S MANUAL

- ASSEMBLY
- OPERATION
- MAINTENANCE
- PARTS LIST

Model Nos.
137-410A
137-410-300

Important:

**Read Safety Rules and
Instructions Carefully**

**26"
RIDING
MOWERS**

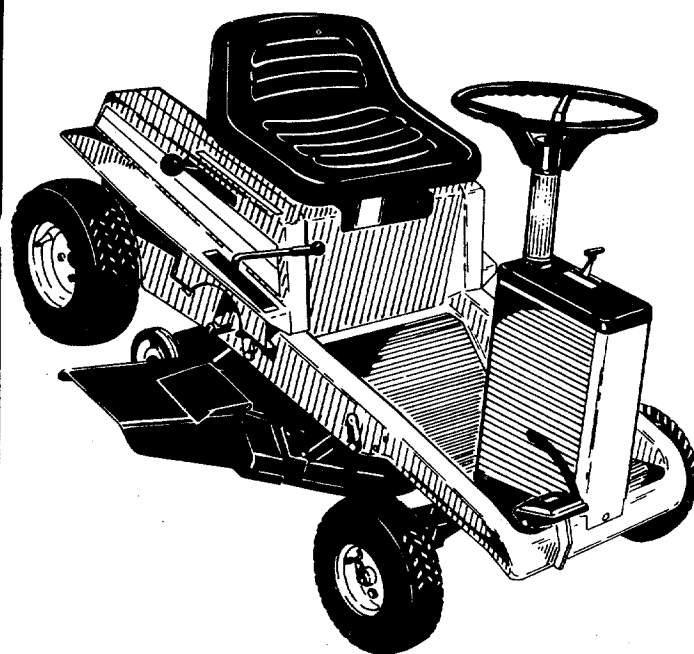

IMPORTANT

It is suggested that this manual be read in its entirety before attempting to assemble or operate. Keep this manual in a safe place for future reference and for ordering replacement parts.

This unit is shipped WITHOUT GASOLINE or OIL. After assembly, see operating section of this manual for proper fuel and amount.

Your rotary mower is a precision piece of power equipment, not a plaything. Therefore exercise extreme caution at all times.

SAFE OPERATION PRACTICES FOR RIDING VEHICLES

1. Know the controls and how to stop quickly—**READ THE OWNER'S MANUAL.**
2. Do not allow children to operate vehicle. Do not allow adults to operate it without proper instruction. Only persons well acquainted with these rules of safe operation should be allowed to use your mower.
3. Do not carry passengers.
4. Keep the area of operation clear of all persons, particularly small children and pets. Stop engine when they are in the vicinity of your mower. Although the area of operation should be completely cleared of foreign objects, a small object may have been overlooked and could be accidentally thrown by the mower in any direction.
5. Clear work area of objects which might be picked up and thrown by the mower in any direction.
6. Disengage all attachment clutches and shift into neutral before attempting to start engine.
7. Disengage power to attachment(s) and stop engine before leaving operator position.
8. Disengage power to attachment(s) and stop engine before making any repairs or adjustments. Disconnect the spark plug wire and keep the wire away from the plug to prevent accidental starting.
9. Before attempting to unclog the mower or discharge chute, stop the engine and be sure the blade(s) have stopped completely. Disconnect the spark plug wire and keep the wire away from the plug to prevent accidental starting.
10. Disengage power to attachment(s) when transporting or not in use.
11. Take all possible precautions when leaving vehicle unattended such as disengaging power-take-off, lowering attachments, shifting into neutral, setting parking brake, stopping engine and removing key.
12. Do not stop or start suddenly when going uphill or downhill. Mow up and down face of steep slopes; never across the face.
13. Reduce speed on slopes and in sharp turns to prevent tipping or loss of control. Exercise extreme caution when changing direction on slopes.
14. Stay alert for holes in terrain and other hidden hazards.
15. Use care when pulling loads or using heavy equipment.
 - A. Use only approved drawbar hitch points.
 - B. Limit loads to those you can safely control.
 - C. Do not turn sharply. Use care when backing.
- D. Use counterweight(s) or wheel weights when suggested in owner's manual.
16. Watch out for traffic when crossing or near roadways.
17. When using any attachments never direct discharge of material toward bystanders nor allow anyone near vehicle while in operation.
18. Handle gasoline with care—it is highly flammable.
 - A. Use approved gasoline container.
 - B. Never remove cap or add gasoline to a running or hot engine or fill fuel tank indoors. Wipe up spilled gasoline.
 - C. Open doors if engine is run in garage—exhaust fumes are dangerous. Do not run engine indoors.
19. Keep the vehicle and attachments in good operating condition, and keep safety devices in place. Use guards as instructed in owner's manual.
20. Keep all nuts, bolts, and screws tight to be sure the equipment is in safe working condition.
21. Never store the equipment with gasoline in the tank inside a building where fumes may reach an open flame or spark. Allow engine to cool before storing in any enclosure.
22. To reduce fire hazard keep engine free of grass, leaves or excessive grease.
23. The vehicle and attachments should be stopped and inspected for damage after striking a foreign object, and the damage should be repaired before restarting and operating the equipment.
24. Do not change the engine governor settings or overspeed the engine.
25. When using the vehicle with mower, proceed as follows:
 - (1) Mow only in daylight or in good artificial light.
 - (2) Never make a cutting height adjustment while engine is running if operator must dismount to do so.
 - (3) Shut the engine off and wait until the blade comes to a complete stop before removing the grass catcher.
 - (4) Check blade mounting bolts for proper tightness at frequent intervals.
26. Check grass catcher bags frequently for wear or deterioration. For safety protection replace only with new bag meeting original equipment specifications.
27. Look behind to make sure the area is clear before placing the transmission in reverse and backing up.

INDEX

Safe Operation Practices.....	2	Transmission Breakdown.....	10
Index and Assembly.....	3	Electrical Breakdown.....	11
Controls.....	4	Schematic for Electrical System.....	12
Operating Instructions.....	5	Trouble Shooting Chart.....	13
Maintenance and Adjustments.....	6	Illustrated Parts for Rider.....	14 & 16
Lubrication.....	9	Parts Lists for Rider.....	15 & 17
Off-Season Storage.....	9	Parts Information.....	Back Cover

GRASS CATCHER Model No. 197-015A is available as optional equipment for the mower shown in this manual.



1. The mower should not be operated without the entire grass catcher or chute deflector in place.



NOTE

Under normal usage bag material is subject to wear, and should be checked periodically. Be sure any replacement bag complies with the mower manufacturer's recommendations.

For replacement bags, use only factory authorized replacement bag No. 764-0121.



IMPORTANT

After striking a foreign object, stop the engine (motor). Remove wire from spark plug, thoroughly inspect the mower for any damage, and repair the damage before restarting and operating the mower.



NOTE

The manufacturer DOES NOT recommend the use of any accessory on this rider mower other than those manufactured by MTD Products Inc.

TIRE PRESSURE

FOR SHIPPING PURPOSES, THE TIRES ON YOUR UNIT MAY BE OVER-INFLATED. TIRE PRESSURE SHOULD BE REDUCED BEFORE UNIT IS PUT INTO OPERATION. PRESSURE SHOULD BE APPROXIMATELY 15 P.S.I. EQUAL TIRE PRESSURE SHOULD BE MAINTAINED. MAXIMUM TIRE PRESSURE 30 P.S.I.



CAUTION

Installation of tire to rim:

1. Lubricate tire beads and rim flanges.
2. Do not exceed 30 P.S.I. when seating beads.
3. Adjust to recommended pressure after beads are sealed.

ASSEMBLY



NOTE

Reference to right-hand or left-hand side of machine is from the driver's seat facing forward.

Your mower is shipped assembled except for the steering wheel and seat.

STEERING WHEEL See figure 1.

- Step 1. Line up the hole in the steering column and the hole in the tubing assembly and drive in the roll pin with a hammer.



NOTE

It may be necessary to use a drift to line up the holes.

- Step 2. Place the end caps on the spacer.
- Step 3. Slide the spacer over the tubing assembly until it lays flush against the steering box.
- Step 4. Place the steering wheel on the tubing shaft.
- Step 5. Secure in place with Belleville washer and hex nut.
- Step 6. Put on steering wheel cap by hand.

SEAT ASSEMBLY See figure 2.

- Step 7. Your molded seat comes with the mounting bolt molded in the seat.
 - a. Select one of three hole locations on seat bracket.
 - b. Place seat on bracket and secure with spring lockwasher and hex nut.

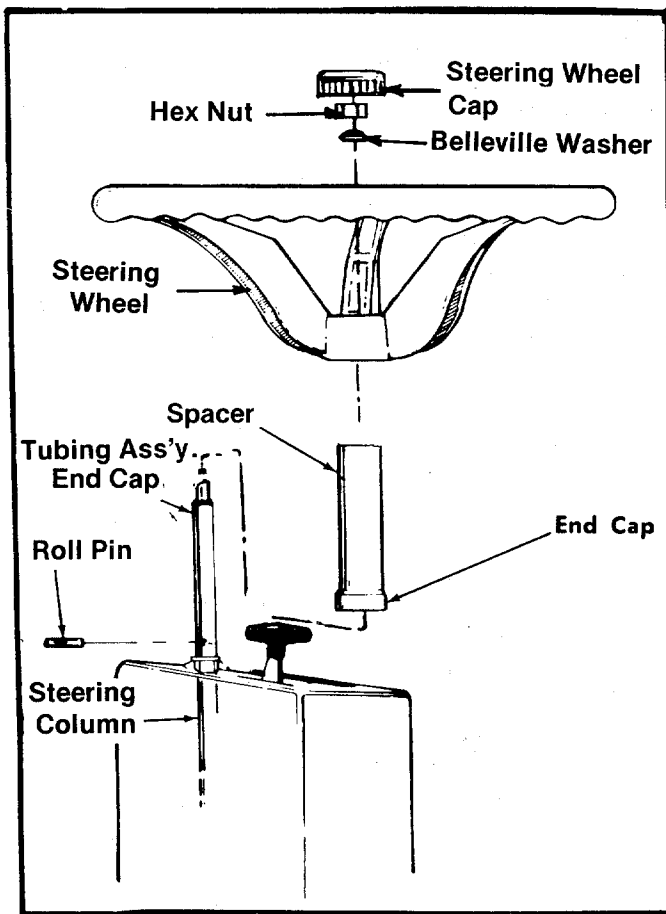

FIGURE 1. STEERING WHEEL ASSEMBLY

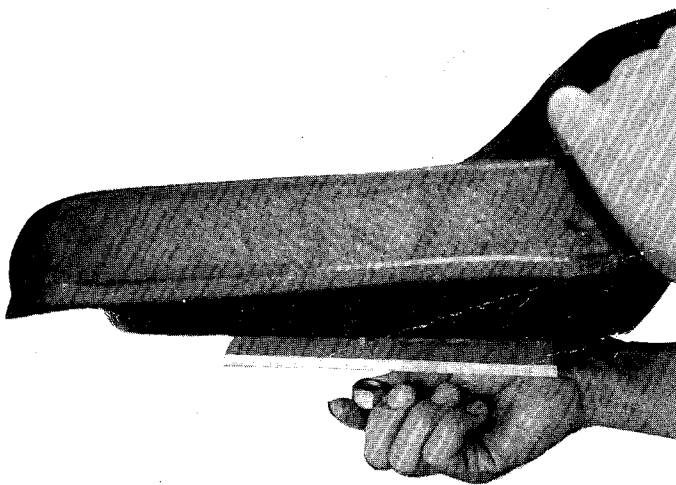

FIGURE 2. SEAT ASSEMBLY

Check ALL nuts and bolts for correct tightness.

CONTROLS See figure 3.

THROTTLE CONTROL

The throttle control is used to regulate the engine speed and to activate the choke on the engine. To get the maximum efficiency on cutting, the throttle should be in the FAST position when operating the mower. Pushing the throttle all the way forward, past FAST will choke the engine.

IGNITION KEY

The key must be turned to the ON position before you pull the recoil handle to start the engine. Remove the key when the mower is not in use. Turn the key to the left to the OFF position to stop the engine.

INTERLOCKS (Not Shown)

An interlock safety switch is located on the clutch pedal and the lift and disengagement lever.

The Clutch Pedal must be depressed all the way down and locked and the Lift and Disengagement Lever must be in the STOP position (forward) before the engine can be started.

GEAR SHIFT LEVER

The gear shift lever has three positions, FORWARD, NEUTRAL and REVERSE. The clutch pedal must be depressed and the rider must not be moving when shifting gears. You may not be able to shift gears when the clutch is locked in the disengaged position. Do not force the shift lever. Release the clutch pedal slightly to line up the shifting collar in the transmission and then try to shift.

BRAKE

To operate the brake depress the right pedal all the way down. To lock the brake in the park position, pivot the pedal forward with your foot as you depress it. It will stay in the depressed position. To release the parking brake, pivot the pedal to the rear.

LIFT AND DISENGAGEMENT LEVER

The lift and disengagement lever is used to raise and lower the cutting deck, set the cutting height, and disengage the cutting blades.

Move the lever to the left and pull the lever all the way back and lock it to disengage the blades. The lever may be set in any one of the five cutting height positions. This lever works in conjunction with the deck wheel adjusters.

DECK WHEELS

Always set both deck wheels in the same relative position. Set these wheels after you set the Lift and Disengagement Lever so they just clear the ground. This will prevent scalping the grass.

CLUTCH PEDAL

The Clutch Pedal is on the left side of the mower. When it is depressed it disengages the transmission from the engine. The clutch must be depressed when you shift gears or come to a stop.

It can be locked in the disengaged position for starting by depressing it all the way and pivoting it forward to the locked position. To release the clutch, pivot it to the rear and it will be unlocked. Release the clutch pedal slowly.

OPERATING INSTRUCTIONS



CAUTION

1. Keep all shields and guards in place.
2. Before leaving the operator's position:
 - Shift controls into neutral
 - Set parking brake
 - Disengage attachment drive
 - Shut off engine
 - Remove ignition key
3. Wait for all movement to stop before servicing machine.
4. Keep people and pets a safe distance away from machine.

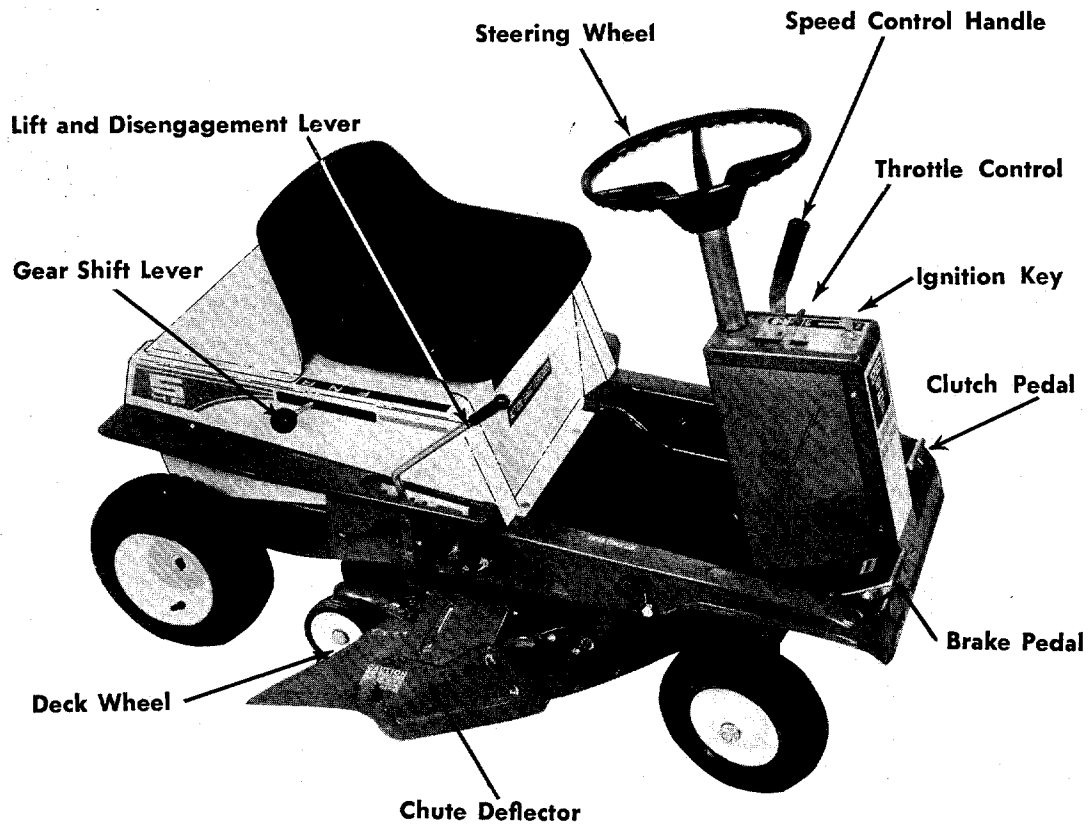

FIGURE 3. CONTROLS



CAUTION

Parking brake **MUST** be disengaged before unit is put into motion.



NOTE

Unit is equipped with separate brake and clutch pedals. To efficiently stop, it is necessary to disengage clutch when applying brakes.

Depressing the clutch pedal at any time will slow you down or, if depressed all the way, will stop the mower.

STOPPING

Engine—Turn the ignition key to the left to the OFF position.

Rider—Depress the clutch and brake pedals.

Blades—Pull the lift and disengagement lever all the way back and lock it.

STARTING THE ENGINE

1. Be sure the crankcase is filled with oil as recommended in the engine manual and put regular gasoline in the gasoline tank.
2. Be sure the fuel shut off valve located on the carburetor is open.
3. Attach the wire to the spark plug.
4. Depress the clutch pedal and lock it down.
5. Pull the lift and disengagement lever back to the disengaged position and lock it.
6. Set the throttle control lever in the CHOKE position.

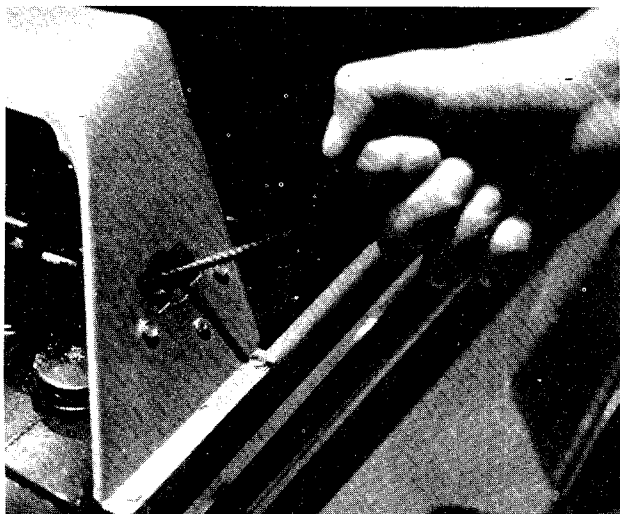

FIGURE 4. RECOIL STARTER

7. Turn the ignition key to the ON position, twist the recoil starter handle until it is free and pull it with a quick steady motion. After the engine starts, return the recoil starter handle and twist it until it locks. See figure 4.



NOTE

Failure to lock the recoil handle will cause engine to stop when the clutch or blade is engaged.

8. To stop the mower turn the ignition key to the OFF position and remove the key when the rider is not in use.

PUTTING THE RIDER IN MOTION

1. Advance the throttle control from $\frac{3}{4}$ to full throttle to prevent strain on the engine and to operate the cutting blades.
2. Hold the clutch pedal down with your right foot.
3. Place the gear shift lever in either the FORWARD or REVERSE position.
4. Slowly release the clutch pedal.
5. To stop the rider, depress the clutch pedal and the brake pedal.
6. The blades can be engaged either while moving or while standing still. Move the lift and disengagement lever forward slowly until the blades are running.

MAINTENANCE AND ADJUSTMENTS

THROTTLE CONTROL See figure 5.

To Check Operation:

Remove Air Cleaner. Move remote control lever to CHOKE position. The carburetor choke should then be closed. Move the remote control lever to STOP. Control lever on carburetor should then make good contact with stop switch to short out ignition.

To Adjust

Place remote control lever on equipment in FAST (high speed) position.

Lever C on carburetor should be just touching choke arm at D. To adjust, loosen casing clamp screw A on blower housing. Move control casing B forward or backward until correct position is obtained. Tighten screw A.

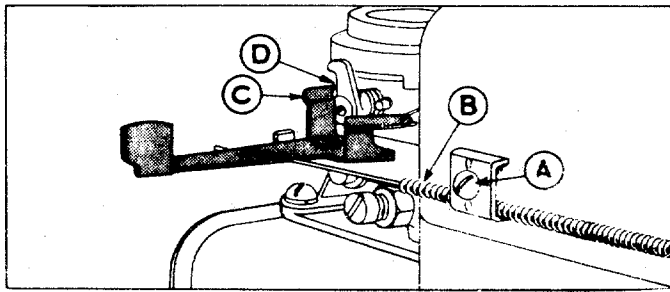

FIGURE 5. THROTTLE ADJUSTMENT

Recheck operation of controls after adjustment. Replace air cleaner.

CARBURETOR ADJUSTMENTS See figure 6.

Minor carburetor adjustments may be required to compensate for differences in fuel, temperature, altitude and load.

Initial Adjustment:

Turn needle valve clockwise to close it. Then open 2 turns. This initial adjustment will permit the engine to be started and warmed up before making final adjustment.

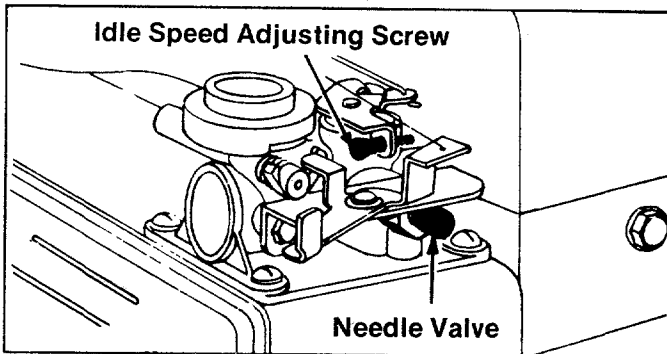

FIGURE 6. CARBURETOR ADJUSTMENT



To insure safe operation of your unit, ALL nuts and bolts must be checked periodically for correct tightness.

Final Adjustment:

With engine running at normal operation speed (approximately 3000 RPM without load) turn needle valve clockwise until engine starts to lose speed (lean mixture). Then slowly turn needle valve counterclockwise past the point of smoothest operation until engine just begins to run unevenly. This mixture will give best performance under load.

To check adjustment move engine control from SLOW to FAST speed. If engine tends to stall or die out, it usually indicates that the mixture is slightly lean and it may be necessary to open the needle valve slightly to provide a richer mixture. This richer mixture may cause a slight unevenness in idling.

CHAIN ADJUSTMENT

After the first five hours of operation the initial slack should be removed from the chain. The chain should be tight enough so that it deflects approximately 1/2" when it is depressed with the thumb.

To Adjust:

The adjusting bolt is located under the frame, above the cutting deck on the right side of the mower.

Turn the adjusting bolt clockwise with an open end wrench until the chain reaches the proper tension.



If the transmission mounting plate will not slide forward to adjust the chain tension, it may be necessary to loosen the four nuts mounting the transmission to the frame.

BRAKE ADJUSTMENT See figure 7.

To adjust the brake, tighten the locknut one half turn and then test the brakes. Repeat if necessary.

The brake is located by the right rear wheel inside the frame.

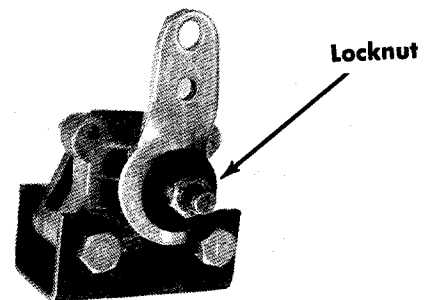

FIGURE 7. BRAKE ADJUSTMENT

BLADES



Disconnect the spark plug wire and remove the ignition key before removing the blades.

Sharp and balanced blades are essential for efficient mowing and long mower and engine life. When sharpening blades, file equal amount of metal from each side. The blades should be balanced before they are reinstalled. An unbalanced blade will cause excessive vibration and undue wear on the mower and the engine. When reassembling, all parts must be installed in the proper order and fastened securely.

Remove the 3/8" bolt and lockwasher. Pull the blade and adapter off the mower deck. To remove the adapter from the blade, remove the two 5/16" bolts, lockwashers and nuts. See figure 8.

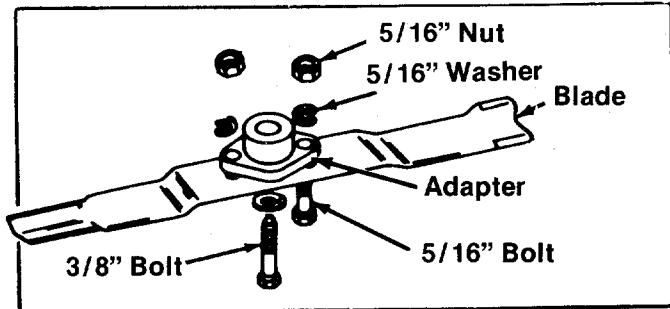

FIGURE 8. BLADE REMOVAL

MOWER DECK

The underside of the mower deck should be cleaned after each period of use as grass clippings, leaves, dirt and other matter will accumulate. This accumulation of grass clippings, etc., is undesirable as it will invite rust

and corrosion and may cause an uneven discharge of grass clippings at the next mowing.

The deck may be cleaned by tilting the mower on its front wheels until the frame and the steering wheel supports the entire unit. Scrape clean with a suitable tool or by washing with a stream of water from a garden hose. Be sure to disconnect the spark plug wire and ground it while performing this maintenance.

BELT REMOVAL See figure 9.

To Remove the Deck Belt:

- Step 1. Put the Lift and Disengagement Lever into the ENGAGED position.
- Step 2. Remove both keepers on the engine belt guard.
- Step 3. Remove the two keepers on the deck pulley.
- Step 4. Remove the shoulder bolt on the deck pulley.
- Step 5. Move the Lift and Disengagement Lever into the disengaged position and remove the belt.
- Step 6. Reassemble in reverse order with the new belt.

When assembling the idler be sure the longer shoulder is up so the idler turns free.

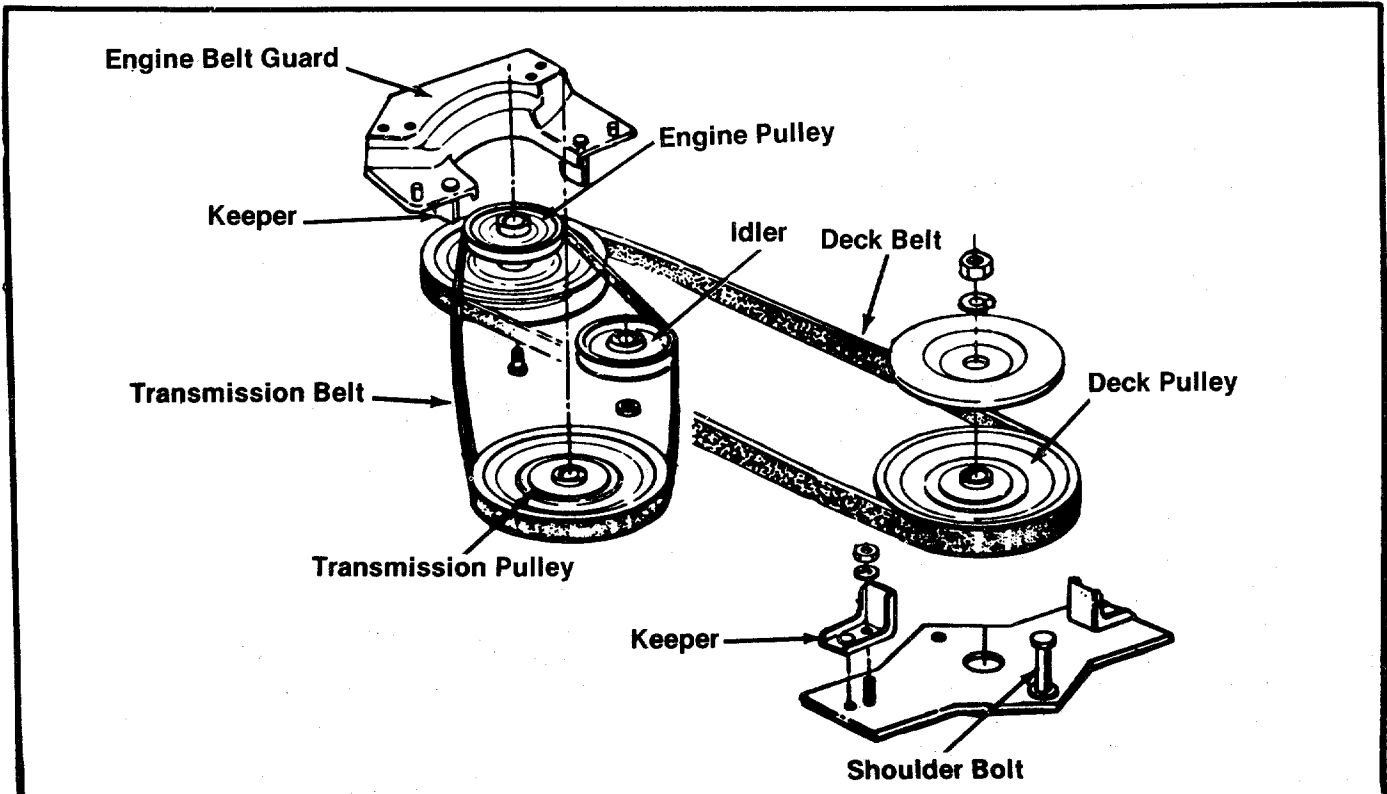

FIGURE 9. BELT REMOVAL

LUBRICATION

1. **Engine.** Maintain the engine oil according to the engine manual.
2. **Bearings.** The following bearings are oil impregnated and do not require lubrication, however, their normal life can be extended by lubricating them once a season with a light, non-detergent oil.
 - A. King Pin Bearings (total 4 bearings)
 - B. Rear Axle Bearings (total 2 bearings)
 - C. Front Wheel Bearings (total 4 bearings)
 - D. Deck Wheel Bearings (total 4 bearings)
3. **Throttle Control and Cable.** Wipe oiled rag along entire length of cable.
4. **Chain.** Wipe oiled rag along entire length of chain.



NOTE

Under extremely dusty conditions do not oil the chain.

5. **Linkage.** Oil all deck linkage and height adjustment linkage.
6. **Transmission.** Lubricated at the factory, does not require checking. Lubricate with 4 oz. of grease high temperature 450°F. if disassembled.

OFF-SEASON STORAGE



NOTE

Engines to be stored over 30 days should be completely drained of fuel to prevent gum deposits forming on essential carburetor parts, fuel filters, fuel lines and tank.

1. Remove all fuel from fuel tank. Run the engine until it stops from lack of fuel. The small amount of fuel that remains in the sump of the tank should then be removed by absorbing it with a clean, dry cloth.
2. While engine is still warm, drain oil from crankcase. Refill with fresh oil.
3. Remove spark plug, pour 1 ounce of SAE 30 oil into cylinder and crank slowly to distribute oil. To prevent accidental starting, DO NOT replace the spark plug.
4. Clean dirt and chaff from cylinder, cylinder head fins and blower housing.
5. Clean all grass from underside of deck.
6. Clean the air filter.
7. Place blocks under frame of mower so that the wheels are off the ground.
8. Cover all bare metal parts, such as the mowing edge of the blades, with grease to prevent rusting.
9. Cover the mower with a tarpaulin or other protective covering.

137-410A

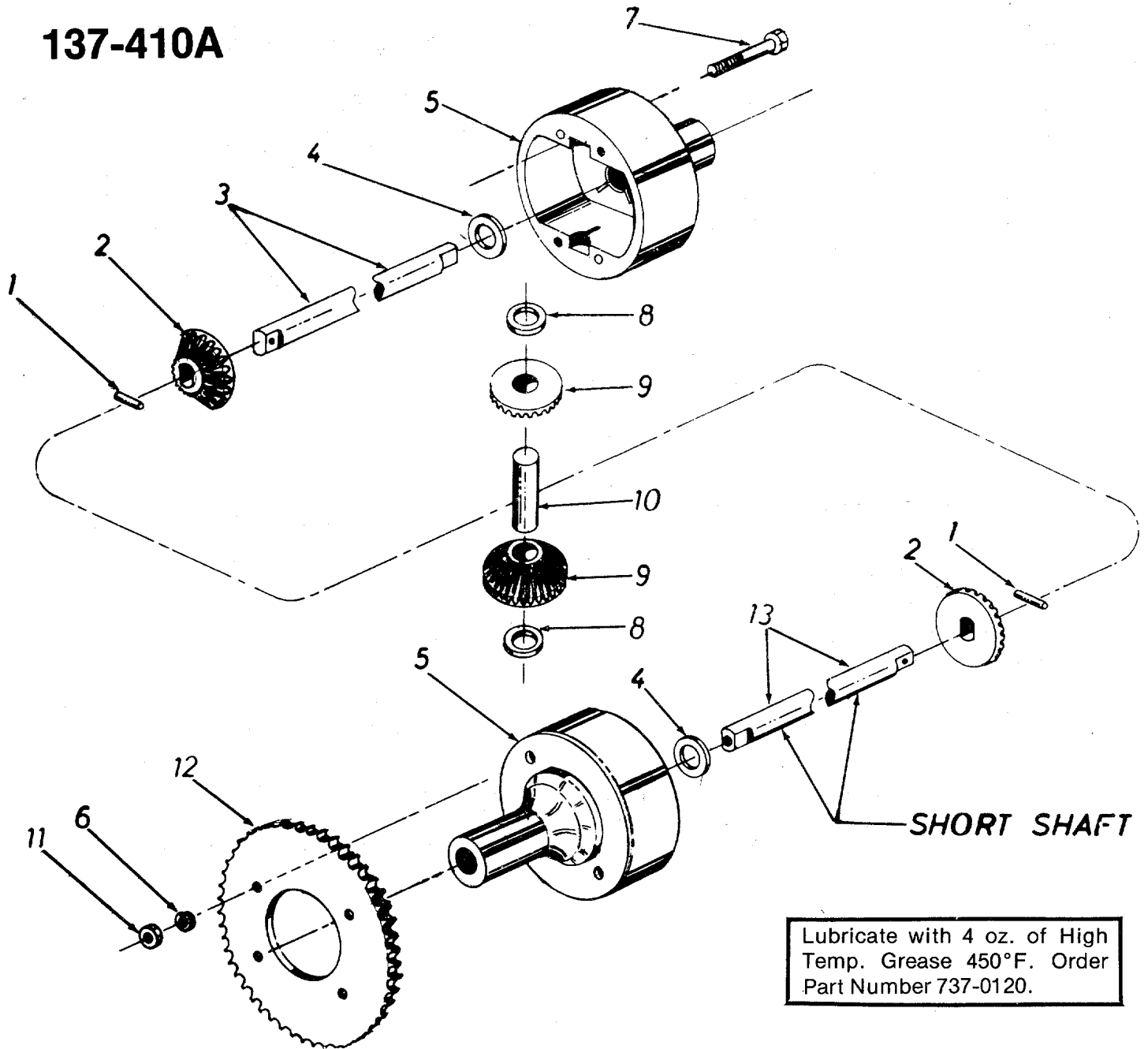

Lubricate with 4 oz. of High Temp. Grease 450°F. Order Part Number 737-0120.

PARTS LIST FOR DIFFERENTIAL ASSEMBLY 717-0328

REF. NO.	PART NO.	QTY REQ'D	DESCRIPTION
1	715-0247	2	Spring Pin Spir. 3/16" Dia. x 1.00" Lg.
2	748-0185	2	Gear—Double "D" Hole
3	738-0300	1	Shaft—Long 19.31" Lg.
4	736-0188	2	FI-Wash. .760 I.D. x 1.49 O.D.
5	717-0341	2	Housing Half
6	736-0119	2	L-Wash. 5/16" Scr.*
7	710-0363	2	Hex Scr. 5/16-24 x 4.00" Lg.*
8	736-0187	2	FI-Wash. .640 I.D. x 1.24 O.D.
9	748-0158	2	Gear—Round Hole
10	711-0276	1	Drive Pin
11	712-0237	2	Hex Cent. L-Nut 5/16-24 Thd.
12	09054	1	Sprocket—40 Tooth
13	738-0301	1	Shaft—Short 7.07" Lg.

137-410A

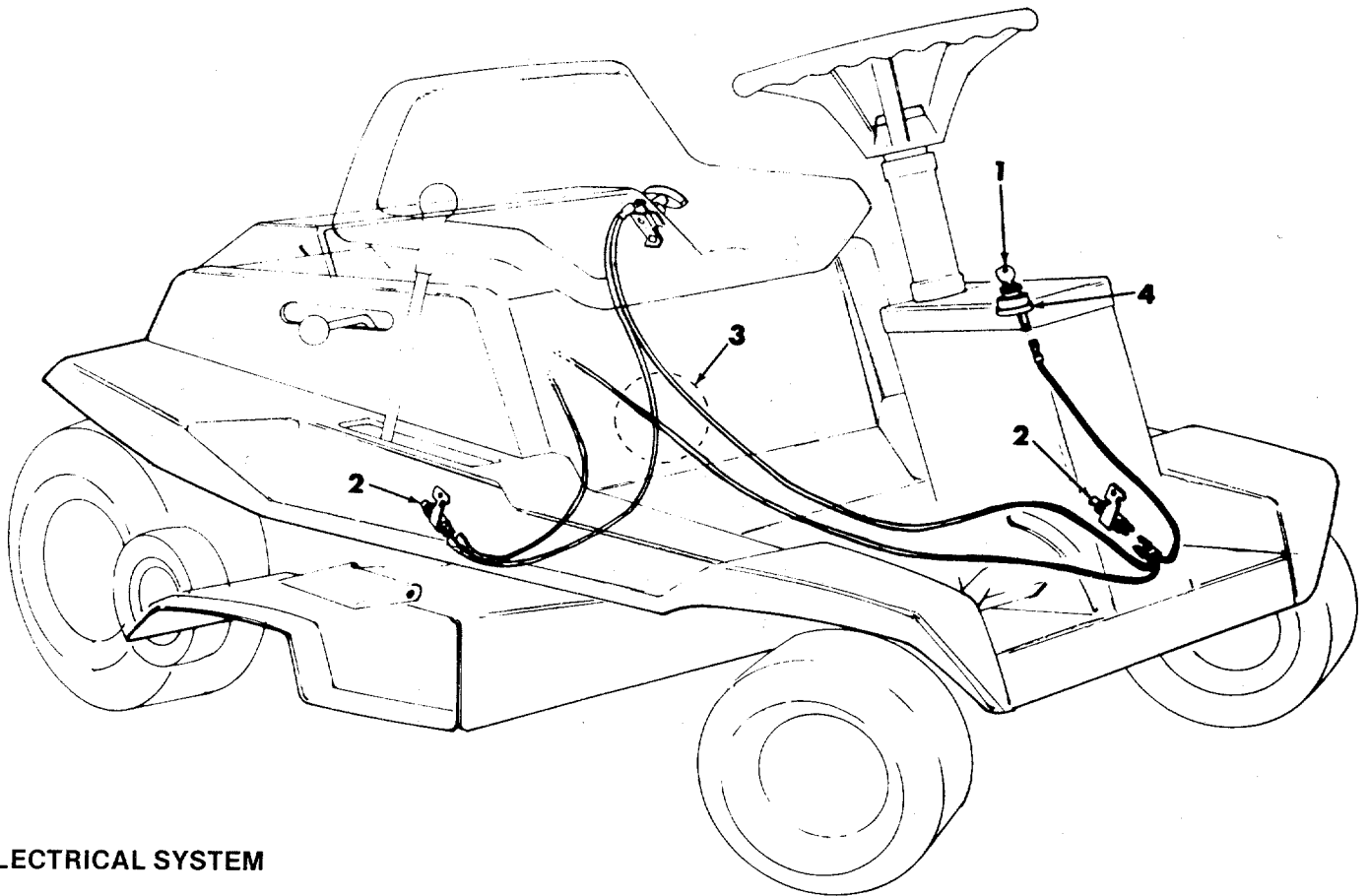

ELECTRICAL SYSTEM

PARTS LIST FOR ELECTRICAL SYSTEM

REF. NO.	PART NO.	DESCRIPTION	NEW PART
1	725-0128	Key Only for Switch	
2	725-0269	Safety Switch (Red)	
3	725-0281	Wire Harness	
4	725-0464	Switch	N

TROUBLE SHOOTING CHART



CAUTION: ALWAYS DISCONNECT SPARK PLUG BEFORE ATTEMPTING ANY REMEDY.

TROUBLE	LOOK FOR	REMEDY
Engine fails to start.	Safety System	<p>If the engine will not start be sure the clutch control is disengaged; blade controls disengaged, the throttle control is set and the key is turned on.</p> <p>A. Disconnect the yellow wire from the engine. This comes from the ignition switch.</p> <p>B. If the engine fails to start the problem is with the engine, not the safety system.</p> <p>C. If the engine starts, the problem is with the safety system. Check the yellow wire for a ground.</p> <p>D. Check the operation of the switch behind the recoil starter handle.</p> <p>E. If the engine stops when the clutch or blade is engaged, the recoil handle is not pushed into the receptacle and twisted a quarter turn.</p>
	Blocked fuel line or empty gas tank.	Clean fuel line; check fuel supply. Also check fuel shut-off valve.
	Defective spark plug.	<p>Spark plug lead wire disconnected.</p> <p>Faulty spark plug—spark should jump gap between control electrode and side electrode. If spark does not jump, replace spark plug.</p> <p>NOTE: Use insulated pliers to hold the spark plug wire.</p>
	Throttle setting.	Throttle control lever not in the starting position.
	Loose connections	Spark plug wire loose.
Hard starting or loss of power.	Dirty air cleaner.	Remove air cleaner and clean as outlined in Engine Manual .
	Carburetor improperly adjusted.	Review paragraph Carburetor Adjustment .
Excessive vibration.	Bent or damaged blade spindle.	Stop engine immediately; tighten all bolts and make all necessary repairs. If vibration continues, have the unit serviced by a competent repairman.
Unit fails to discharge grass.	Discharge chute clogged.	Clean discharge chute and inside of deck.
	Foreign object lodged in deck.	Remove object from deck. See CAUTION following step 1 in paragraph Operation .
Engine overheats.	Obstructions in air passages.	Remove any obstruction from air passages in shroud.
	Grass and dirt in engine shroud.	Clean cooling fins.
	Oil level.	Fill crankcase to proper oil level.

137-410A

IF YOU WRITE TO US ABOUT THIS ARTICLE
OR IF YOU ORDER REPLACEMENT PARTS AL-
WAYS MENTION THIS MODEL & SERIAL NO
MODEL

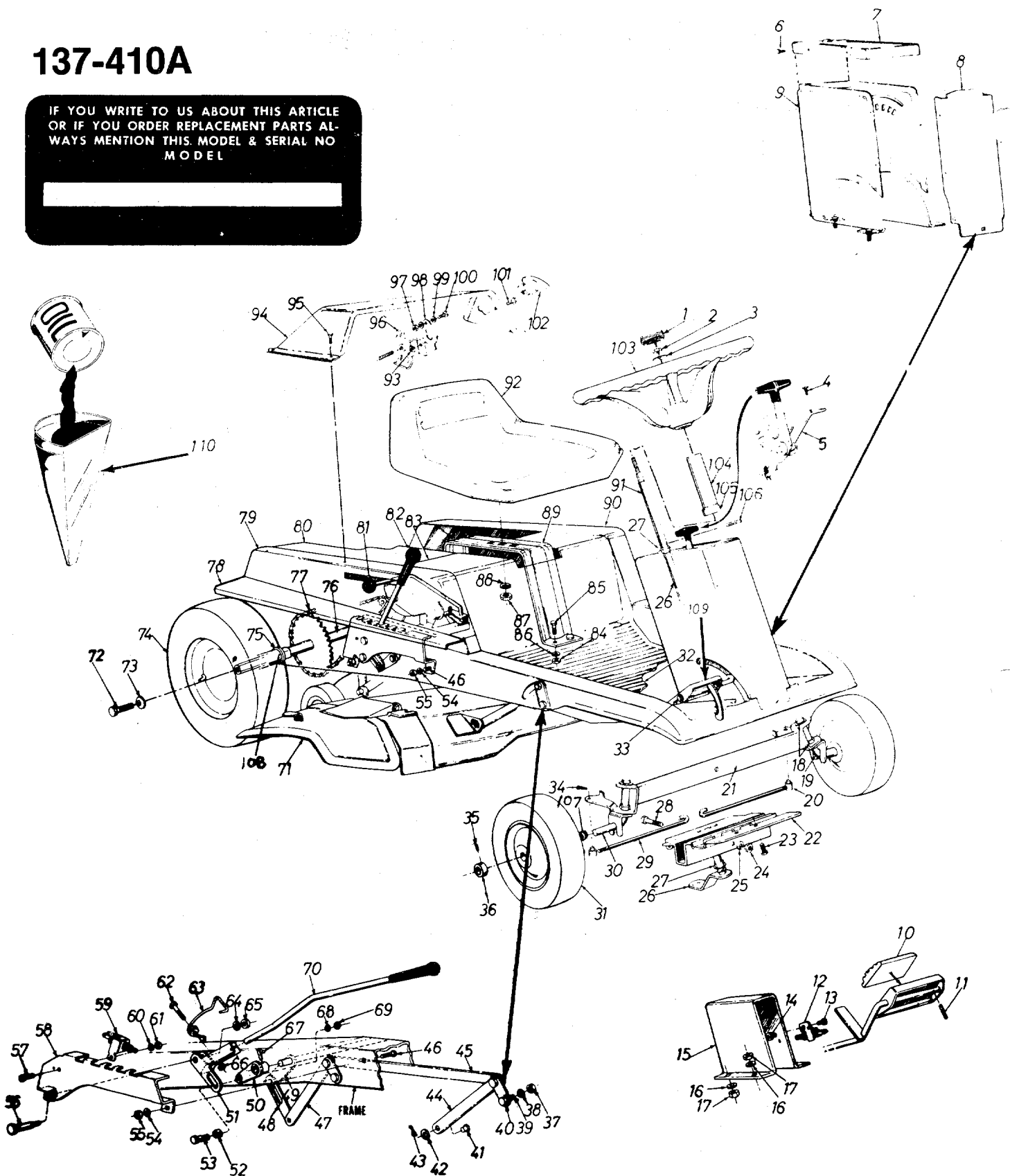

EXPLODED VIEW

PARTS LIST FOR EXPLODED VIEW MODEL 137-410A

REF. NO.	PART NO.	COLOR CODE	DESCRIPTION	NEW PART	REF. NO.	PART NO.	COLOR CODE	DESCRIPTION	NEW PART
1	731-0220		Steering Wheel Cap		59	725-0269		Safety Switch	
2	712-0158		Hex Cent. L-Nut 5/16-18		60	736-0329		L-Wash. 1/4" Scr. *	
3	736-0219		Bell. Wash.		61	712-0287		Hex Nut 1/4-20 Thd. *	
4	710-0224		Hex Scr. #10 x .50" Lg.		62	710-0559		Hex Scr. 1/4-28 x 1.75"	
5	746-0172		Throttle Control 63.5" Lg.		63	732-0231		Torsion Spring	
6	710-0224		Hex AB-Tapp Scr. #10 x .50"		64	736-0105		Bell. Wash.	
7	11372	-463	Steering Box Top Cover		65	712-0798		Hex Nut 3/8-16 Thd. *	
8	10818	-463	Steering Box Front Cover		66	712-0117		Hex L-Nut 1/4-28 Thd.	
9	11374	-463	Steering Box		67	715-0107		Spring Pin Spiral 5/16" x 1.38"	
10	12379		Clutch Pedal Pad						
	12378		Brake Pedal Pad		68	736-0169		L-Wash. 3/8" Scr. *	
11	715-0131		Spring Pin Roll 1/4" Dia. x 2.50"		69	712-0798		Hex Nut 3/8-16 Thd. *	
					70	11826		Lift Handle	
12	725-0269		Safety Switch		71	11571		Chute Cover Ass'y.	
13	710-0252		Hex Scr. 1/4-20 x .75" Lg. *		72	710-0568		Hex Scr. 5/16-18 x .75" Lg.	
14	712-0287		Hex Nut 1/4-20 Thd. *		73	736-0242		Bell. Wash.	
15	10832	-463	Brake Lever Brkt.		74	734-0522		Rear Wheel Ass'y. Comp.	
16	736-0119		Spring L-Wash. 5/16" Scr. *			734-0517		Rear Wheel—Rim Only	
17	712-0267		Hex Nut 5/16-18 Thd. *					(Includes Hub)	
18	748-0227		Hex Flanged Brg. .630 I.D.			734-0301		Rear Wheel—Tire Only 12.2 x 3.7	
19	09709	-463	Front Axle Ass'y. L.H.						
20	711-0198		Pivot Bushing (Tie Rod End)		75	741-0199		Flange Brg. w/Flats .753 I.D.	
21	09711	-463	Pivot Bar Ass'y.						
22	11376	-463	Front Pivot Brkt.		76	717-0328		Rear Axle Ass'y.	
23	710-0322		Hex Sems Scr. 5/16-18 x 1.00"*		77	713-0357		#41 Chain 1/2" x 67 Links	
						713-0723		#41 Master Link	
24	712-0923		Hex Cent. L-Nut 5/8-18 Thd.		78	10813	-463	Fender R.H.	
25	736-0158		L-Wash. 5/8" Scr. *			10814	-463	Fender L.H.	
26	09922		Steering Shaft Ass'y.		79	10824		Engine Box Side Panel—R.H.	
27	748-0227		Hex Flanged Brg. .630 I.D.		80	10827		Engine Box Top Panel	
28	710-0312		Hex Scr. 5/8-18 x 1.31		81	722-0115		Ball Knob	
29	711-0335		Tie Rod		82	720-0143		Grip Black—Lift Handle	
30	09706	-463	Front Axle Ass'y.—R.H.		83	10826		Engine Box Front Panel	
31	734-0510		Front Wheel Ass'y.—Comp.		84	712-0267		Hex Nut 5/16-18 Thd. *	
	748-0146		Front Wheel Brg.		85	710-0198		Hex Sems Scr. 5/16-18 x .75" Lg. *	
32	735-0117		Floor Mat 3/32 Running Bd.						
33	726-0221		Push Cap 1/2" Dia.		86	736-0119		L-Wash. 5/16" Scr. *	
34	714-0111		Cotter pin 3/32" Dia. x 1.00"		87	712-0206		Hex Nut 1/2-13 Thd. *	
35	710-0494		Sq. Hd. Set Scr. 5/16-18 x .38		88	736-0921		L-Wash. 1/2" Scr. *	
36	711-0169		Collar 5/8" I.D.		89	10174		Seat Support Ass'y.	
37	712-0267		Hex Nut 5/16-18 Thd. *		90	10825		Engine Box Side Panel—L.H.	
38	736-0119		L-Wash. 5/16" Scr. *		91	750-0209		Steering Tube Ass'y.	
39	738-0140		Shld. Scr. .437" Dia. x .180		92	757-0264		Seat Ass'y. 10.0" Back	
40	09721	-463	Pivot Link Ass'y.		93	712-0287		Hex Nut 1/4-20 Thd. *	
41	711-0332		Lift Brkt. Pin		94	11528		Engine Box Top Bezel	
42	736-0192		Fl-Wash. .531 I.D. x .93 O.D.		95	710-0224		Hex Scr. #10 x .50" Lg.	
43	714-0101		Int. Cotter Pin 1/2" Dia.		96	11053		Switch Brkt. Ass'y.	
44	12336	-463	Pivot Link Ass'y.		97	712-0121		Hex Nut #10-24 Thd.	
45	09735	-463	Connecting Rod		98	732-0257		Switch Spring	
46	710-0260		Carriage Bolt 5/16-18 x .62"*		99	736-0338		Fiber Washer	
47	12337	-463	Pivot Link Ass'y.		100	710-0425		Mach. Scr. #10-24 x .62" Lg.	
48	09737	-463	Link—Slotted		101	710-0351		Self-Tap Scr. #10 x .50" Lg.	
49	11830	-463	Lift Shaft Ass'y.		102	11263		Handle Plastic	
50	11831	-463	Lift Hub Ass'y.		103	731-0219		Steering Wheel	
51	11827	-463	Handle Lift Brkt. Ass'y.		104	09920		Steering Tube Spacer	
52	750-0195		Roller—Spacer		105	09921		Bearing Cap	
53	738-0234		Shld. Scr. .500" Dia. x .295		106	715-0108		Spring Pin Spiral 1/4" x 1.00"	
54	736-0119		L-Wash. 5/16" Scr. *		107	736-0156		Fl-Wash.	
55	712-0267		Hex Nut 5/16-18 Thd. *		108	736-0134		Fl-Wash.	
56	738-0213		Shld. Scr. .498" Dia. x 1.450		109	10848		Foot Pedal Latch Ass'y.	
57	710-0286		Truss Mach. Scr. 1/4-20 x .50		110	11228		Plastic Funnel	
58	11825	-463	Index Brkt.						

(463—Top Flite Red)

*For faster service obtain standard nuts, bolts and washers locally. If these items cannot be obtained locally, order by part number and size as shown on parts list.

When ordering parts, if color or finish is important use the appropriate color code shown above (e.g. Top Flite Red—11372 (463).)

137-410A

NOTE: If for any reason Disc Brake is disassembled, be sure round end of push pins (Ref. No. 12) is toward the cam lever (Ref. No. 11).

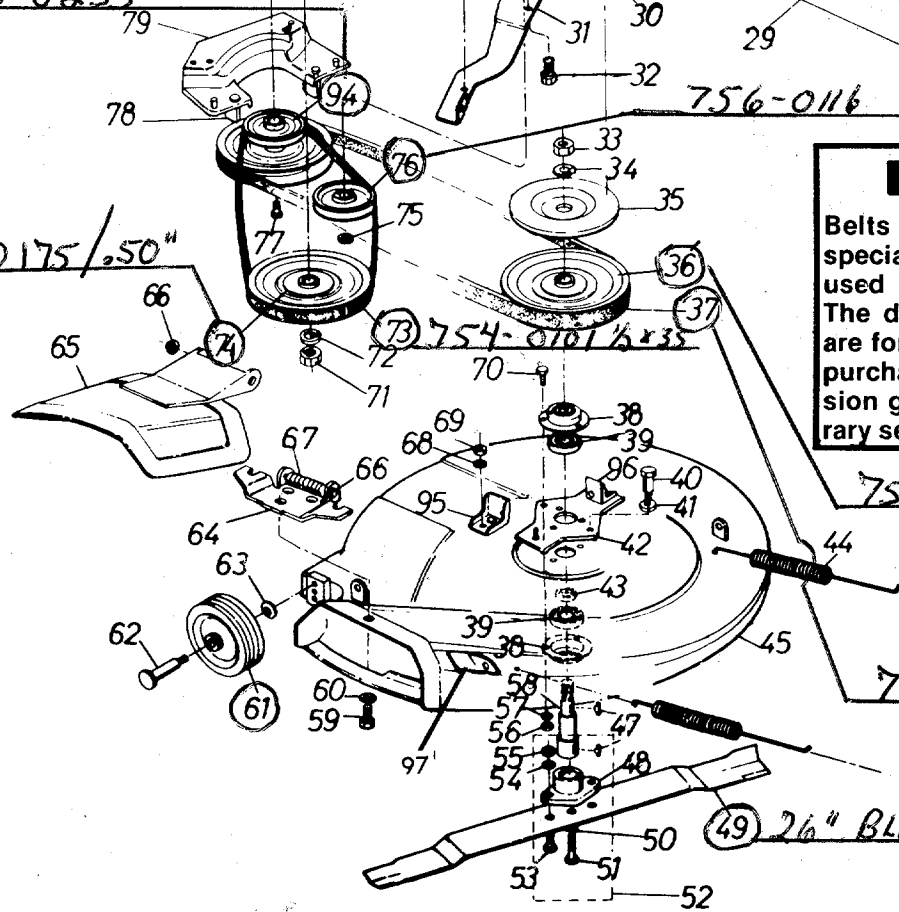
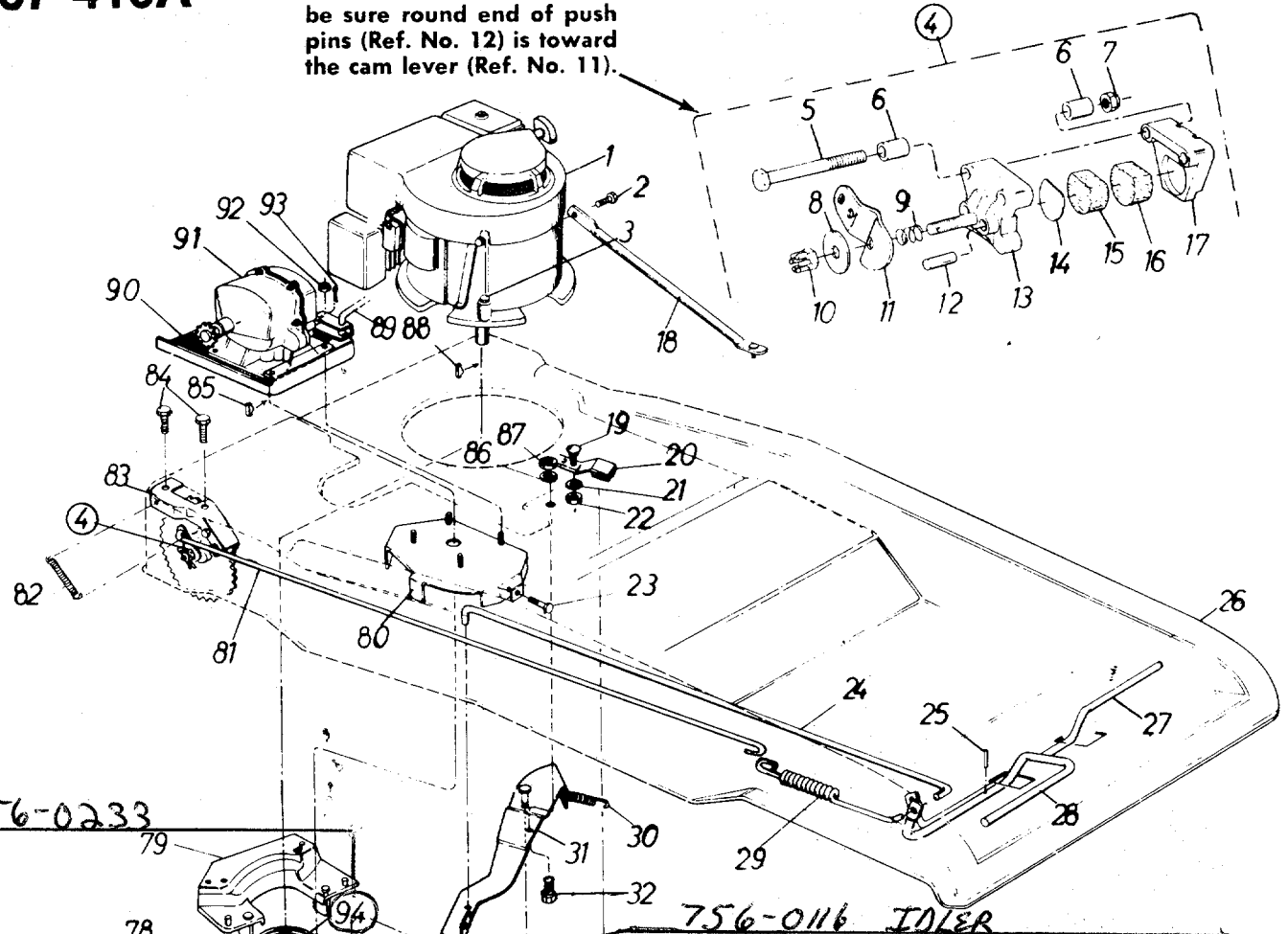

IMPORTANT
Belts listed by Part Number are of special construction and should be used when replacement is necessary. The dimensions and description given are for general reference only and belts purchased by description and dimension generally will only provide temporary service.

756-0143 / .63" ID
754-0138 / 2 1/32 x 50.0 lg
26" BLADE / 742-0147

DECK AND FRAME VIEW

PARTS LIST FOR DECK AND FRAME VIEW MODEL 137-410A

REF. NO.	PART NO.	COLOR CODE	DESCRIPTION	NEW PART	REF. NO.	PART NO.	COLOR CODE	DESCRIPTION	NEW PART
1	—		Engine		51	710-0459		Hex Hd. Cap Scr. 3/8-24 x 1.50" Lg. H.T.	
2	710-0198		Hex Sems Scr. 5/16-18 x .75" Lg.*		52	10769		Blade Adapter Kit	
3	710-0442		Hex Hd. Cap Scr. 5/16-18 x 1.50" Lg.*		53	710-0117		Hex Hd. Cap Scr. 5/16-24 x 1.00" Lg. H.T.	
4	761-0130		Disc Brake Ass'y. Comp.		54	736-0119		Spring L-Wash. 5/16" Scr.*	
5	710-0378		Hex Hd. Cap Scr. 5/16-18 x 2.50" Lg.*		55	712-0123		Hex Nut 5/16-24 Thd.*	
6	HH-11-03527		Spacer for Disc Brake .322 I.D. x .38		56	712-0267		Hex Nut 5/16-18 Thd.*	
7	712-0158		Hex Cent. L-Nut 5/16-18 Thd.		57	736-0119		Spring L-Wash. 5/16" Scr.*	
8	HH-03-03032		Washer		58	711-0405		Spindle	
9	HH-06-03031		Spring		59	710-0195		Hex Hd. Cap Scr. 1/4-28 x .62" Lg.*	
10	712-0237		Hex Cent. L-Nut		60	736-0329		Spring L-Wash. 1/4" Scr.*	
11	HH-18-03493		Cam Lever		61	734-0295		5.0 inch Dia. Wheel Ass'y. (Deck)	
12	HH-05-03034		Push Pin		62	738-0119		Shld. Scr. .625" Dia. x 1.75" Lg. (Axle)	
13	HH-12-03292		Casting—Cam Side		63	736-0105		Bell. Wash. .400 I.D. x .88 O.D.	
14	HH-03-03303		Disc—Back Up		64	11399 —463		Adapter Plate Ass'y.	
15	HH-15-02124		Fric. Pad .450 Thk.		65	11571 —463		Chute Cover Ass'y.	
16	HH-15-03149		Fric. Pad .250 Thk.		66	11634 —463		Chute Cover Ass'y.—Comp.	
17	HH-12-03293		Casting—Carrier Side		67	726-0106		Push Nut 1/4" Rod	
18	10400		Engine Brace Ass'y.		68	732-0261		Torsion Spring	
19	710-0289		Hex Hd. Cap Scr. 1/4-20 x .50" Lg.*		69	736-0119		Spring L-Wash. 5/16" Scr.*	
20	761-0148		Blade Brake Ass'y.		70	712-0267		Hex Nut 5/16-18 Thd.*	
21	736-0329		Spring L-Wash. 1/4" Scr.*		71	710-0322		Hex Sems Scr. 5/16-18 x 1.00" Lg.*	
22	712-0287		Hex Nut 1/4-20 Thd.*		72	712-0922		Hex Jam Nut 1/2-20 Thd.	
23	710-0117		Hex Hd. Cap Scr. 5/16-24 x 1.00" Lg. Heat Treated		73	736-0921		Spring L-Wash. 1/2" Scr.*	
24	10079		Foot Pedal Rod 27.44" Lg.		74	754-0101		"V"-Belt 1/2" x 35" Lg. (Drive Belt)	
25	715-0103		Spring Pin Roll 1/8" Dia. x .75" Lg.		75	756-0175		Transmission Split Pulley .50" I.D.	
26	10057 —463		Frame		76	712-0116		Hex Ins. L-Nut 3/8-24 Thd.	
27	11532		Clutch Foot Pedal Rod Ass'y.		77	756-0116		"V"-Belt Idler	
28	11378		Brake Foot Pedal Rod		78	710-0152		Hex Hd. Cap Scr. 3/8-24 x 1.00" Lg.*	
29	732-0245		Brake Spring (Foot Pedal Location)		79	10426 —463		Belt Keeper Ass'y.	
30	732-0121		Idler Extension Spring		80	10423 —463		Belt Guard Cup Ass'y.	
31	11438 —436		Idler Brkt. Ass'y.		81	10086 —463		Transmission Belt Guard Ass'y.	
32	738-0140		Shld. Scr. .437" Dia. x .180		82	747-0109		Brake Rod .25" Dia. x 31.62" Lg.	
33	712-0261		Hex Cent. L-Nut 5/8-11 Thd.		83	732-0118		Extension Spring (Brake Return)	
34	736-0158		Spring L-Wash. 5/8" Scr.*		84	10245 —463		Disc Brake Brkt. Ass'y.	
35	11073		Brake Disc (Deck)		85	710-0198		Hex Sems Scr. 5/16-18 x .75" Lg.*	
36	756-0143		Deck Pulley .63" I.D.		86	714-0129		#4 Hi-Pro-Key 3/32 x 5/8" Dia. Hardened	
37	754-0138		"V"-Belt 21/32 x 50.0" Lg. (Blade Drive Belt)		87	736-0119		Spring L-Wash. 5/16" Scr.*	
38	741-0163		Brg. Housing Ass'y.		88	712-0267		Hex Nut 5/16-18 Thd.*	
	08253		Bearing Housing		89	714-0365		#6 Hi-Pro-Key 5/32 x 5/8" Dia.	
39	741-0919		Ball Brg.		90	10846		Shift Lever Ass'y.	
40	738-0129		Shld. Scr. .498" Dia. x 2.00" Lg.		91	10247		Transmission Plate	
41	736-0105		Bell. Wash. .400 I.D. x .88 O.D.		92	717-0223		Single Speed Transmission Ass'y.	
42	11537 —463		25.0" Deck Belt Guard Plate Ass'y.		93	712-0429		Hex Ins. L-Nut 5/16-18 Thd.	
43	750-0142		Spacer .836" I.D. x 1.01 O.D. (Deck)		94	714-0507		Cotter Pin 3/32" Dia. x 1.00"	
44	732-0153		Spring .75" O.D. x 8.65" Lg. (Deck)		95	756-0233		Two Step Engine Pulley	
45	12344 —463		26 inch Deck Ass'y.		96	10426		Belt Keeper Ass'y. R.H. (Deck)	
46	12345 —463		26 inch Deck Ass'y.—Comp.		97	11823		Belt Keeper Ass'y. L.H. (Deck)	
47	714-0388		#61 Hi-Pro-Key 3/16" x 5/8" Dia. (Top Key)			12343		Deck Brkt.	
	714-0365		#6 Hi-Pro-Key 5/32" x 5/8" Dia. (Bottom Key)						
48	10769		Blade Adapter Kit						
49	742-0147		26 inch Blade						
50	736-0217		Spring L-Wash. 3/8" Scr. Heavy Duty						

WHEEL CHART

FRONT WHEEL		REAR WHEEL	
PART NO.	DESCRIPTION	PART NO.	DESCRIPTION
734-0510	Wheel Ass'y. Comp. 10.25 x 3.25	734-0522	Wheel Ass'y. Comp. 12.2 x 3.7
748-0146	Flange Brg. w/Flats .630" I.D.	734-0517	Rim Ass'y. w/Hub
		734-0301	Tire Only Tubeless 12.2 x 3.7
		734-0255	Air Valve
		734-0336	Inner Tube (Service Only)

PARTS INFORMATION

POWER EQUIPMENT PARTS AND SERVICE

Parts and service for all MTD manufactured power equipment are available through the authorized service firms listed below. All orders should specify the model number of your unit, parts numbers, description of parts and the quantity of each part required.

ALABAMA	BIRMINGHAM	
	Auto Electric & Carburetor Co.	2625 4th Ave. S. 35233
ARKANSAS	NORTH LITTLE ROCK	
	Sutton's Lawn Mower Shop	Rt. 4, Box 368 72117
	FORT SMITH	
	Mity Mite Motors, Inc.	2515 Towson Ave. 72901
CALIFORNIA	SAN BERNARDINO	
	Lawn Mower Supply Co.	25608 E. Baseline 92410
	SAN FRANCISCO	
	J.W. Jewett Co.	981 Folsom St. 94107
	SACRAMENTO	
	Luttig & Severson	2030 28th St. 95818
COLORADO	DENVER	
	South Denver Lawn Equip.	527 West Evans 80223
CONNECTICUT	SUFFIELD	
	The Jones & Ramsey Co.	850 Thompsonville Rd. 06078
FLORIDA	JACKSONVILLE	
	Radco Distributors	2403 Market St. 32206
	CORAL GABLES	
	Moz-All of Florida, Inc.	365 Greco Ave. 33146
GEORGIA	EAST POINT	
	East Point Cycle & Key	2834 Church St. 30344
ILLINOIS	LYONS	
	Keen Edge Co.	8615 Ogden Ave. 60534
INDIANA	ELKHART	
	Parts & Sales Inc.	2101 Industrial Pkwy. ..46514
IOWA	DUBUQUE	
	Power Lawn & Garden Equip. .	2551 J.F. Kennedy 52001
KANSAS	WICHITA	
	Hixon, Inc.	3030 Mascot 67204
LOUISIANA	NEW ORLEANS	
	Suhren Engine Co.	8330 Earhart Blvd. 70118
MARYLAND	TAKOMA PARK	
	Center Supply Co.	6867 New Hampshire Ave. 20012
MASSACHUSETTS	SPRINGFIELD	
	Morton B. Collins Co.	300 Birnie Ave. 01107
MICHIGAN	MOUNT CLEMENS	
	Power Equipment Dist.	36463 South Gratiot... 48043
	LANSING	
	Lorenz Service Co.	2500 S. Pennsylvania.. 48900
MINNESOTA	MINNETONKA	
	Hance Distributing Inc.	11212 Wayzata Blvd. ..55343
MISSISSIPPI	BILOXI	
	Biloxi Sales & Service, Inc.	506 Caillavet St. 39533
MISSOURI	KANSAS CITY	
	Automotive Equip. Service	3117 Holmes St. 64109
	ST. LOUIS	
	Henzler, Inc.	2015 Lemay Ferry Rd. 63125
NEW YORK	CARTHAGE	
	Gamble Dist., Inc.	West End Ave. 13619
	SYRACUSE	
	Kimber's, Inc.	115 N. Geddes St. 13204

BRIGGS & STRATTON, TECUMSEH AND PEERLESS PARTS AND SERVICE

Briggs & Stratton, Tecumseh and Peerless parts and service should be handled by your nearest authorized engine service firm. Check the yellow pages of your telephone directory under the listing *Engines Gasoline*, Briggs & Stratton or Tecumseh Lauson

NORTH CAROLINA	GREENSBORO	
	Dixie Sales Company	327 Battleground Ave.. 27402
	GOLDSBORO	
	Smith Hardware Co.	515 N. George St. 27530
OHIO	WADSWORTH	
	National Central	687 Seville Rd. 44281
	CLEVELAND	
	Bleckrie, Inc.	7900 Lorain Ave. 44102
	CARROLL	
	Stebe's Mid-State Mower Supply Box 366	43112
	WILLARD	
	Sunshine Wholesale Tire Outlet Route 224	44890
	MANSFIELD	
	McClure Lawn & Garden Supply...1114 Lexington Ave. .	44903
OKLAHOMA	MUSKOGEE	
	Victory Motors, Inc.	605 S. Cherokee 74401
	ADA	
	Ada Auto Supply	301 E. 12th St. 74820
OREGON	PORTLAND	
	Kenton Supply Co.	8216 N. Denver Ave. . 97217
PENNSYLVANIA	LANCASTER	
	Raub Supply Co.	James & Mulberry Sts...17604
	PITTSBURGH	
	Bluemont Co.	11125 Frankstown Rd.. 15235
TENNESSEE	KNOXVILLE	
	Master Repair Service	2423 Broadway, N.E. ...37917
	MEMPHIS	
	Memphis Cycle & Supply Co.	421 Monroe Ave. 38103
	American Sales & Service, Inc. .	1922 Lynnbrook 38116
TEXAS	DALLAS	
	Marr Brothers, Inc.	423 E. Jefferson 75202
	HOUSTON	
	Bullard Supply Co.	2409 Commerce St. 77003
	SAN ANTONIO	
	Catto & Putty, Inc.	P.O. Box 240878206
	FORT WORTH	
	Woodson Sales Corp.	1702 N. Sylvania 76111
UTAH	SALT LAKE CITY	
	A-1 Engine & Mower Co.	437 E. 9th St.84111
VERMONT	BURLINGTON	
	Vermont Appliance Co.	44 Lakeside Ave.05401
VIRGINIA	RICHMOND	
	RBI Corp.	963 Myers St. 23260
WASHINGTON	SEATTLE	
	Bailey's Rebuild, Inc.	1325 E. Madison St. ...98102
WEST VIRGINIA	CHARLESTON	
	Young's, Inc.	233 Virginia St., E. ... 25301
WISCONSIN	APPLETON	
	Automotive Supply Co.	123 S. Linwood Ave. ..54911

WARRANTY PARTS AND SERVICE POLICY

The purpose of warranty is to protect the customer from defects in workmanship and materials, defects which are NOT detected at the time of manufacture. It does not provide for the unlimited and unrestricted replacement of parts. Use and maintenance are the responsibility of the customer. The manufacturer cannot assume responsibility for conditions over which it has no control. Simply put, if it's the manufacturer's fault, it's the manufacturer's responsibility; if it's the customer's fault, it's the customer's responsibility.

CLAIMS AGAINST THE MANUFACTURER'S WARRANTY INCLUDES

1. Replacement of Missing Parts on new equipment.
2. Replacement of Defective Parts within the warranty period.
3. Repair of Defects within the warranty period.

All claims MUST be substantiated with the following information:

1. Model Number of unit involved.
2. Date unit was purchased or first put into service.
3. Date of failure.
4. Nature of failure.