

Operating/Service Instructions

RIDING MOWER

IMPORTANT

SAFE OPERATION PRACTICES - RIDING MOWERS

Model Nos.

132-460, 132-465,
132-470 & 132-475

191-468 Snow Blower Blower

1. Know the controls and how to stop quickly—
READ THE OWNER'S MANUAL.
2. Do not allow children to operate vehicle. Do not allow adults to operate it without proper instruction.
3. Do not carry passengers. **Keep children and pets a safe distance away.**
4. Clear work area of objects which might be picked up and thrown.
5. Disengage all attachment clutches and shift into neutral before attempting to start engine (motor).
6. Disengage power to attachments and stop engine (motor) before leaving operator position.
7. Disengage power to attachment(s) and stop engine (motor) before making any repairs or adjustments.
8. Disengage power to attachments when transporting or not in use.
9. Take all possible precautions when leaving vehicle unattended; such as disengaging power-take-off, lowering attachments, shifting into neutral, setting parking brake, stopping engine and removing key.
10. Do not stop or start suddenly when going uphill or downhill. Mow up and down the face of steep slopes; never across the face.
11. Reduce speed on slopes and in sharp turns to prevent tipping or loss of control. Exercise extreme caution when changing direction on slopes.
12. Stay alert for holes in terrain and other hidden hazards.
13. Use care when pulling loads or using heavy equipment.
 - A. Use only approved drawbar hitch points.
 - B. Limit loads to those you can safely control.
 - C. Do not turn sharply. Use care when backing.
 - D. Use counterweight(s) or wheel weights when suggested in owner's manual.
14. Watch out for traffic when crossing or near roadways.
15. When using any attachments never direct discharge of material toward bystanders nor allow anyone near vehicle while in operation.
16. Handle gasoline with care—it is highly flammable.
 - A. Use approved gasoline container.
 - B. Never remove cap or add gasoline to a running or hot engine or fill fuel tank indoors. Wipe up spilled gasoline.
 - C. Open doors if engine is run in garage — exhaust fumes are dangerous. Do not run engine (motor) indoors.
17. Keep vehicle and attachments in good operating condition and keep safety devices in place. Use guards as instructed in owner's manual.
18. Keep all nuts, bolts, and screws tight to be sure equipment is in safe working condition.
19. Never store equipment with gasoline in the tank inside a building where fumes may reach an open flame or spark.
20. Allow engine to cool before storing in any enclosure.
21. To reduce fire hazard keep engine free of grass, leaves or excessive grease.
22. Vehicle and attachments should be stopped and inspected for damage after striking a foreign object and the damage should be repaired before restarting and operating the equipment.
23. Do not change engine governor settings or over-speed engine.
24. When using vehicle with mower:
 - (1) Mow only in daylight or in good artificial light.
 - (2) Never make a cutting height adjustment while engine (motor) is running if operator must dismount to do so.
 - (3) Shut engine (motor) off when removing grass catcher and/or unclogging chute.
 - (4) Check blade mounting bolts for proper tightness at frequent intervals.
25. Check grass catcher bags frequently for wear or deterioration. Replace with new bags for safety protection.

GRASS CATCHER Model No. 192-010 is available as optional equipment for the mowers shown in this manual.

WARNING

1. The mower should not be operated without the entire grass catcher or chute deflector in place.

NOTE

Under normal usage bag material is subject to wear, and should be checked periodically. Be sure any replacement bag complies with the mower manufacturer's recommendations.

For replacement bags, use only factory authorized replacement bag No. 764-122.

Your new rider mower is completely assembled when you receive it except for the steering wheel, seat, engine oil and battery on electric start models.

Add 2 1/4 pints of high quality detergent oil. (Below 40° F. Use SAE 5W-20 Oil; above 40° F., use SAE 30 oil.)

NOTE

Reference to right-hand or left-hand side of machine is from the driver's seat facing forward.

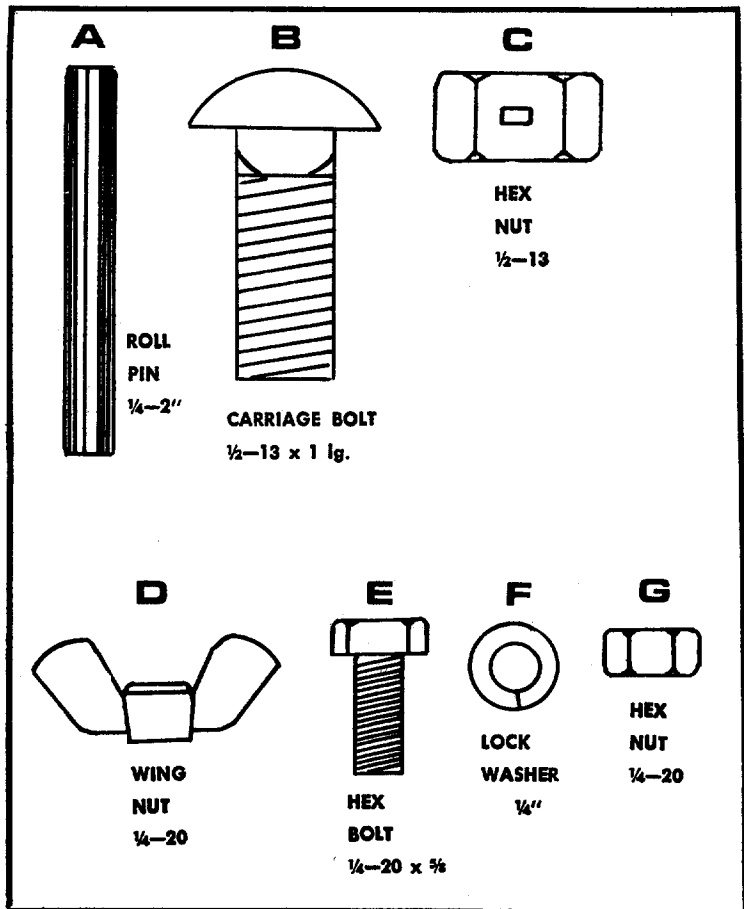

FIGURE 1. HARDWARE SUPPLIED

TOOLS REQUIRED

- Two 7/16" wrenches (electric start model only)
- One 3/4" wrench
- Hammer

ASSEMBLY

STEERING WHEEL ASSEMBLY

- Step 1. Remove the lawn mower and all parts from the carton. Make certain that all loose parts and literature have been removed before the carton is discarded.
- Step 2. Line up the hole in the steering column with the hole in the steering wheel.
- Step 3. Drive in roll pin A with a hammer being careful not to hit the plastic steering wheel. See figure 2.
- Step 4. Press the cap on the steering wheel by hand. See figure 2.

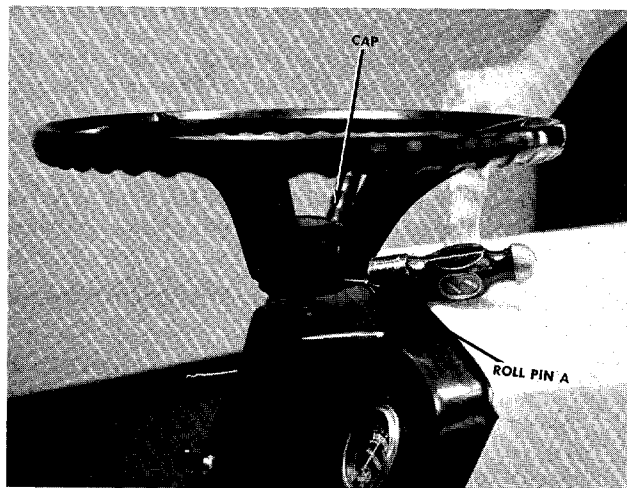

FIGURE 2. STEERING WHEEL ASSEMBLY

SEAT ASSEMBLY

Step 5. Hook the large carriage bolt B into the bottom of the seat as shown in figure 3.

Step 6. Place the seat on the seat spring and secure with hex nut C. See figure 4.

NOTE

The seat is adjustable using any one of the four mounting holes.

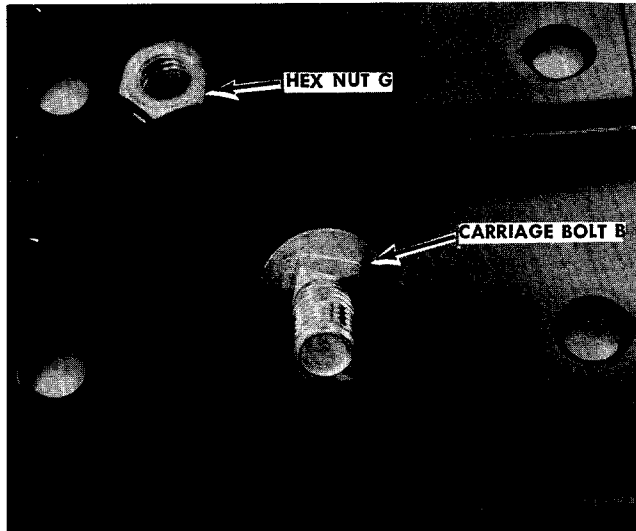

FIGURE 3. ATTACHING SEAT BOLT

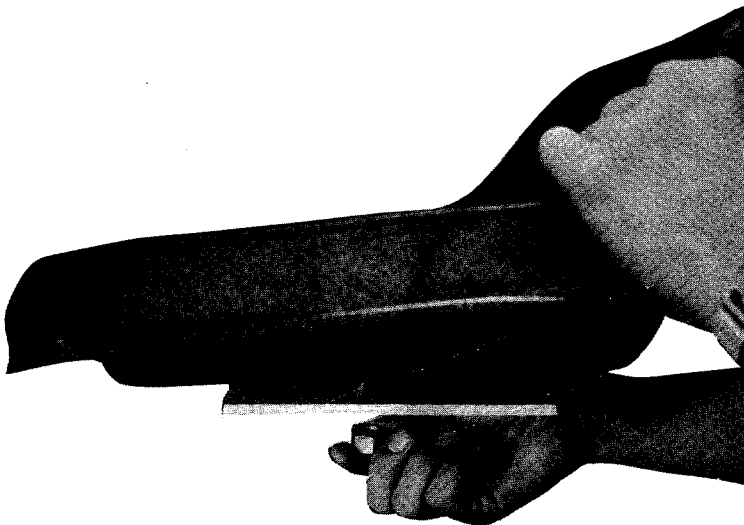

FIGURE 4. SEAT ASSEMBLY

Step 7. Activate the battery. See the instructions packed with the battery for activation.

ELECTROLYTE ANTIDOTES

External: Flood with water, then cover with moistened sodium bicarbonate (baking soda). If eyes are involved, wash first with water then with 1 per cent solution of freshly prepared sodium bicarbonate (baking soda). Call physician immediately.

Internal: Do not use emetics, stomach pumps, carbonates or bicarbonates. Give at least 20 to 30 oz. (2/3 to 1 ounce) of milk of magnesia, or preferably aluminum hydroxide gel diluted with water. If these alkalies are not available, the whites of eggs (2 to 3) well-beaten may be used. Give large quantities of water. Prevent collapse. Call physician immediately.

- Open the hood of the mower.
- Place the battery with the terminals to the FRONT in the battery case. See figure 5.
- Hook both hold-down rods under the battery case and place the hold down over the battery caps and secure with wing nuts D.

CAUTION

Be sure the flared edge of the hold down is facing up to avoid damage to the battery.

- Attach the free end of the positive cable and the small wire from the ammeter, to the positive battery terminal with bolt E, washer F and nut G. The battery terminal is marked +.
- Attach the free end of the negative cable to the negative terminal with bolt E, washer F and nut G. Battery terminal is marked -.

NOTE

To prevent sulfate encrustation of the battery terminals coat terminals with a thin coat of grease.

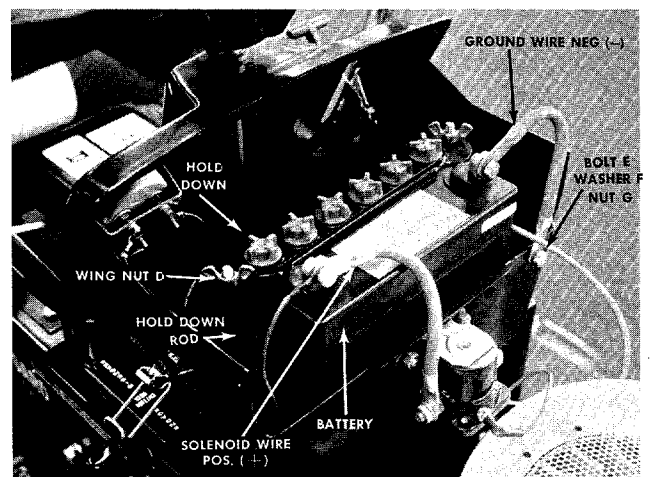

FIGURE 5. INSTALLING THE BATTERY

CONTROLS

a. **Throttle Control.** The throttle control is used to regulate the engine speed and choke the engine. The engine should be operated from $\frac{3}{4}$ to full throttle when operating the cutting deck or snow thrower (optional). See figure 6.

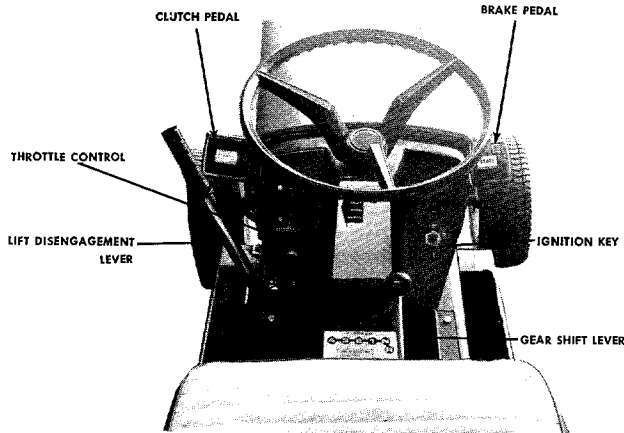

FIGURE 6. CONTROLS

b. **Gear Shift Lever.** The gear shift lever is used to shift into one of four gears, NEUTRAL or REVERSE. See figures 6 and 7.

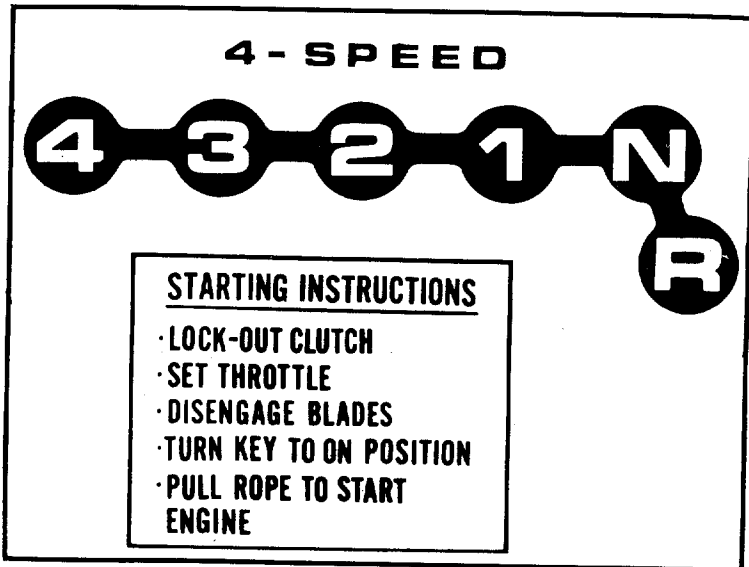

FIGURE 7. SHIFT PATTERN

c. **Brake.** The brake pedal is located on the right hand side of the mower and is operated by depressing it with your right foot. See figure 6.

d. **Brake Lock.** The brake lock is located on the right hand side of the mower. To lock the brake, depress the brake pedal and lift up the lock button. The pedal will stay depressed. To release, depress the pedal.

e. **Clutch Pedal.** The clutch pedal is used to disengage the drive mechanism. Depressing the clutch pedal at any time will slow you down or, if depressed all the way, will stop the mower. See figure 6.

f. **Clutch Lockout.** When the clutch pedal is depressed all the way it can be locked by placing the clutch lockout in the START position as shown in figure 8. The clutch lockout must be in this position before the engine will start.

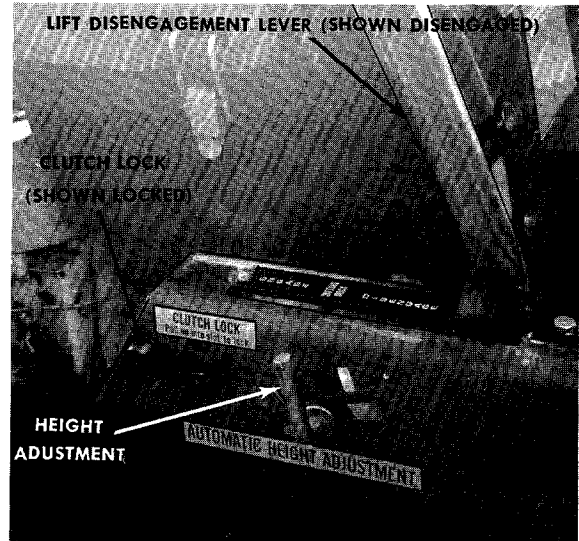

FIGURE 8. LEFT HAND VIEW

g. **Ignition Switch.** The ignition switch is located on the right side of the dashboard. See figure 6. Turn the key to the ON position when starting the engine. To stop the engine turn the key to the left to the OFF position and remove the key to prevent accidental starting.

NOTE

The engine will not start unless the clutch lockout is in the LOCKED position and the lift lever is in the DISENGAGED position.

h. **Recoil Starter** The recoil starter is located on the right side of the dashboard. The recoil starter can either be pulled while seated on the rider or pulled while standing behind the rider. The ignition key must be on before the engine will start. After the engine starts, the recoil starter handle must be returned and locked into the dashboard before the blades or clutch are engaged. The engine will stop if you do not follow these instructions.

i. **Ammeter.** The ammeter registers the rate of battery charge or discharge. The ammeter should register on the plus side (+) when the engine is running in the fast position until the battery is completely charged. With a fully charged battery or with the engine idling the ammeter will not show a charge.

j. **Light Switch. (Electric Start Only)** Pull the light switch out to turn on the lights. The lights will only operate when the engine is running.

k. **Ignition switch.** The ignition switch is located on the right side of the dashboard.

Electric Start Models Only. Turn the key to the START position to start the engine. When the engine is running, let the key return to the ON position. To stop the engine, turn the key to the left to the OFF position and remove it to prevent accidental starting.

NOTE

The engine will not start unless the clutch lockout is in the START position and the lift lever is in the DISENGAGED position.

l. Lift and Disengagement Lever. It is used to raise the cutting deck. Pulling it all the way back and locking it disengages the blades. The engine will not start unless the lift and disengagement lever is in the disengaged position. See figure 8.

m. Cutting Controls. The cutting controls consist of the height adjustment and the wheel height adjusters.

Height Adjustment. See figure 10. With the lift and disengagement lever in DISENGAGE position, unscrew the height adjustment handle until it can be moved to the desired mowing height (see figure 10) and tighten it. Set the individual wheel adjusters so that the wheels clear the ground by 1/4 inch to prevent scalping.

Wheel Height Adjusters. Set your mowing height with the individual wheel adjusters located on the deck. See figure 9. Move the individual height adjustment levers forward to lower the cut of grass. Move the height adjustment handle all the way to LOW CUT position. Place the lift and disengagement lever in FULL ENGAGE position. This will allow the deck to "float" and follow the contour of the ground.

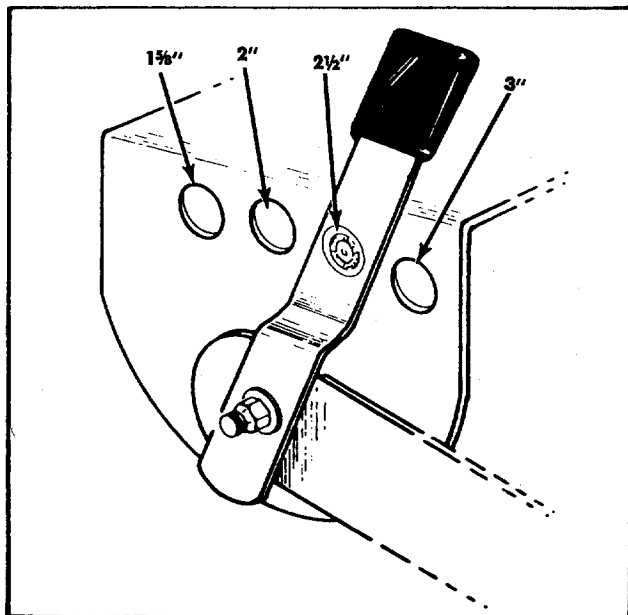

FIGURE 9. MOWING HEIGHT ADJUSTMENT

CHECKING OIL AND GASOLINE

NOTE

When packaged for shipment the machine contains no oil or gasoline. Before starting the engine, oil must be added to the engine crankcase and gasoline to the tank. DO NOT mix oil with gasoline.

OIL

Remove the oil dip stick (See Figure 11.) and pour 2 1/4 pints of good quality type MS engine oil into the crank case.

Summer
Use SAE 30

Winter (Below 40° F)
Use SAE 5W-20 or SAE 10W

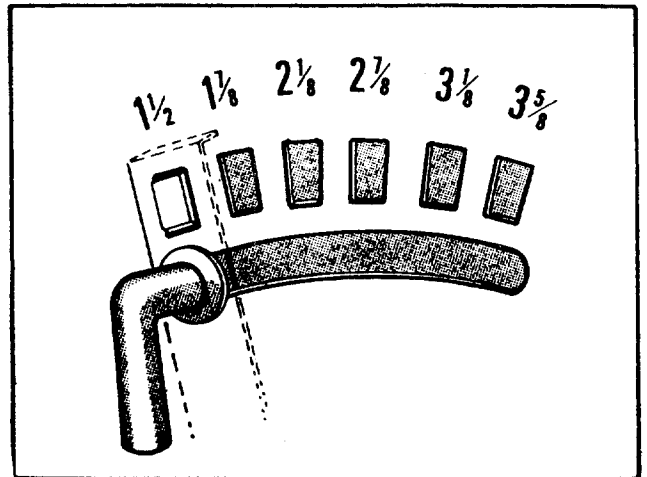

FIGURE 10. HEIGHT ADJUSTMENT SCREW

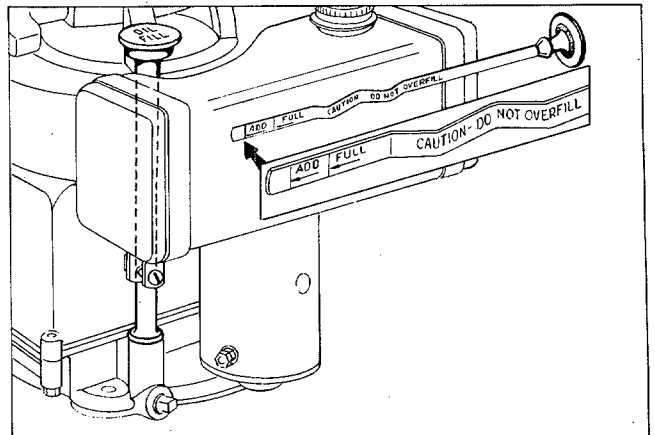

FIGURE 11. OIL DIP STICK

Gasoline

Remove the gas cap and fill the tank with FRESH REGULAR GASOLINE. Do not use gasoline that has been stored for any length of time.

OPERATING INSTRUCTIONS

WARNING

The mower shall not be operated without the entire grass catcher (optional) or chute deflector in place.

IMPORTANT: After striking a foreign object, stop the engine (motor). Remove wire from spark plug, thoroughly inspect the mower for any damage, and repair the damage before restarting and operating the mower.

6. STARTING THE ENGINE

Refer to page 5 for information regarding oil and gasoline requirements; check that the spark plug wire is connected, then proceed as follows:

Step 1. Be sure the fuel shut-off valve is open. See figure 12.

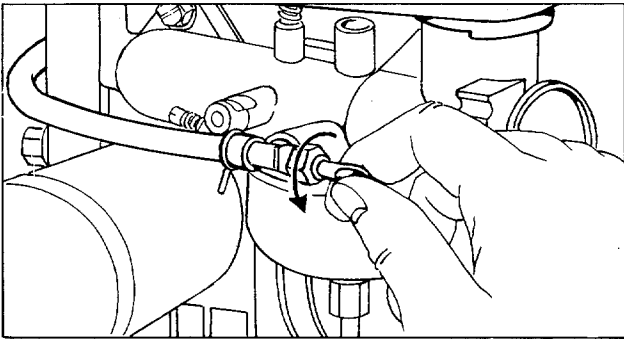

FIGURE 12. FUEL SHUT-OFF VALVE

Step 2. Place the Clutch Lockout in the LOCK position. See figure 8.

Step 3. Place the lift and disengagement lever in the DISENGAGED position. See figure 8.

Step 4. Set the throttle control in the CHOKE position. See figure 6.

Step 5. Recoil Starter.

- Turn the ignition key to the ON position. See figure 13.
- Grasp the recoil starter, unlock it by twisting it $\frac{1}{4}$ turn and pull it out sharply and hold it in the out position.
- Slowly release the recoil starter and lock it into the dashboard as shown in figure 13.

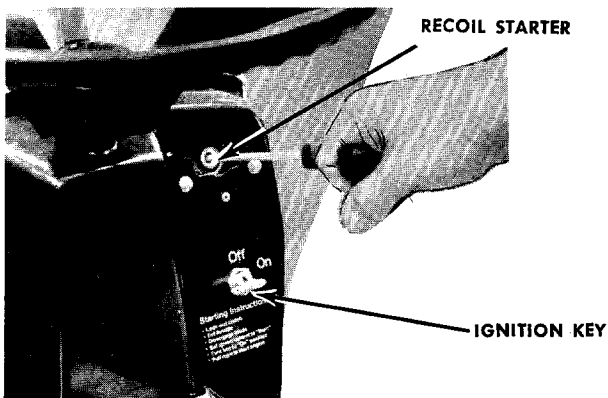

FIGURE 13. RECOIL STARTER

Electric Start Models Only. See figure 14. Turn the ignition key to the START position. When the engine is running, let the key return to the ON position.

To stop either model, turn the key to the left to the OFF position and remove the key to prevent accidental starting.

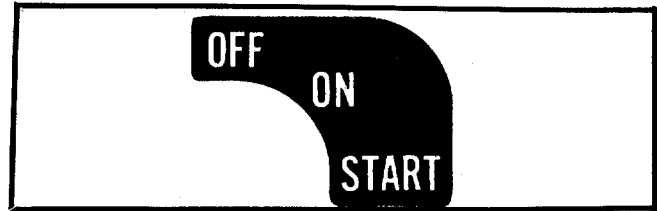

FIGURE 14. ELECTRIC START

NOTE

A brief break-in period is essential to ensure maximum engine and mower life. This consists of running the engine at half speed for a period of time required to use one tank of gasoline. It is also recommended to change crankcase oil after the first 5 hours of operation.

7. OPERATING THE MOWER

Step 1. Set the desired cutting height.

Step 2. Start the engine as outlined in paragraph 6.

Step 3. Put the gear shift lever into either FIRST or REVERSE.

NOTE

DO NOT force the gear shift lever! If the lever cannot be moved from NEUTRAL to one of the drive positions, release the clutch pedal slowly, depress it again, and then move the gear shift lever as required.

Step 4. Once the machine is in motion, remove foot from the pedal. The mower will now move ahead or to the rear, and the use of the steering wheel will provide directional control.

Step 5. The mower is brought to a stop by pressing right foot pedal (brake). The left foot pedal (clutch) will disengage the drive belt.

CAUTION

Gear changing should be done only after the mower has been brought to a full stop. If the mower is not to be used for a long period, place the gear shift lever in NEUTRAL and stop the engine. DO NOT leave the machine on an incline.

8. OPERATING THE CUTTER BLADE

The cutting blades may be engaged while the mower is moving or standing still. **DO NOT** engage the cutting blades abruptly as the sudden belt tension on the pulley may cause the engine to stall.

WARNING

When the blade drive is engaged, keep feet and hands away from the discharge opening and from the blade.

To stop the blades, move the lift and disengagement lever (figure 8.) into the **DISENGAGED** position. This raises the deck and disengages the blades.

NOTE

When the machine is used for other than mowing operations the blade drive should be disengaged.

9. CRANKCASE OIL

To ensure maximum engine performance, perform the following periodic maintenance:

Oil Check

Check the oil level in the crankcase before each use of the machine and after every five hours of operation. Oil should be kept between the add and full marks on the dipstick. See figure 11.

After the first five hours of operating a new engine, drain the oil (see figure 15) from the crankcase while engine is still hot and refill crankcase with new oil; thereafter change the oil every 25 hours of operation. This procedure ensures for minimum wear of engine parts and provides for virtually trouble-free operation. To change the oil, proceed as follows:

Step 1. With the machine on level ground, place a suitable metal container under the oil drain plug, then remove the drain plug. See figure 15.

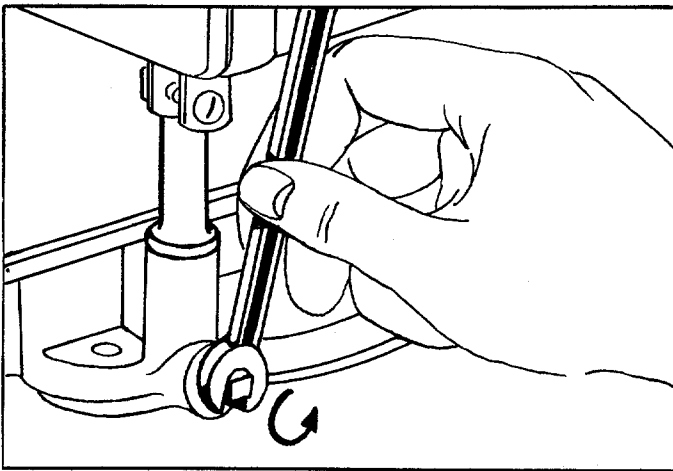

FIGURE 15. OIL DRAIN

Step 2. After the oil has been drained completely from the crankcase, replace the drain plug and tighten.

Step 3. Refill crankcase with 2¼ pints of good quality, type MS, Engine oil into the crankcase. Summer use SAE 30; Winter (Below 40° F) use SAE 5W-20 or SAE 10W.

10. LUBRICATION

Lubricate the wheel bearings (2 per wheel) and the upper and lower spindle bearings with SAE 30 oil once a season. See figure 16.

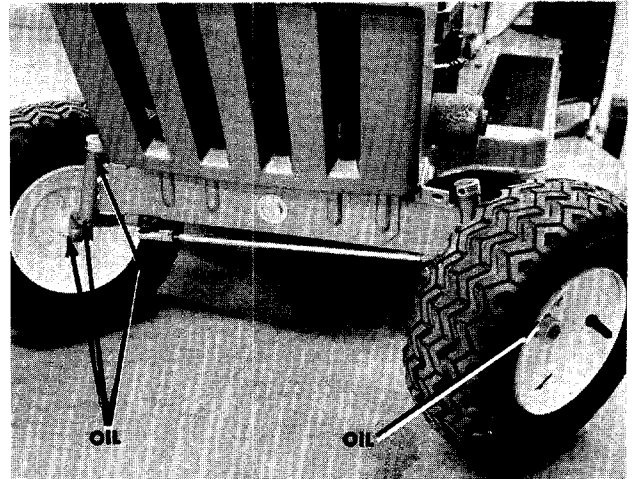

FIGURE 16. WHEEL AND SPINDLE BEARINGS

Lubricate the four rear axle bearings with SAE 30 oil once a season.

The chain can be lubricated by wiping it with an oily rag.

The differential and transmission are sealed at the factory and require no further lubrication.

11. CHAIN

The spring-loaded idlers take up any slack in the chain and require no adjustments.

12. AIR CLEANER

Under normal operating conditions, the air cleaner, located on top of the carburetor, must be serviced after every ten hours of use. Under extremely dusty operating conditions the air cleaner must be serviced after every hour of operation. Refer to figure 17.

When assembling the air cleaner, make certain the lip of the foam element extends over edge of the air cleaner body. The foam element will form a protective seal.

Step 1. Remove two screws and lift off complete air cleaner assembly.

Step 2. Remove screen and spacers from foam element.

Step 3. Remove foam element from air cleaner body.

Step 4. a. Wash foam element in kerosene or liquid detergent and water to remove dirt.

b. Wrap foam in cloth and squeeze dry.

c. Saturate foam in SAE 30 engine oil, then squeeze out excess oil.

d. Assemble parts, fasten to carburetor with screw.

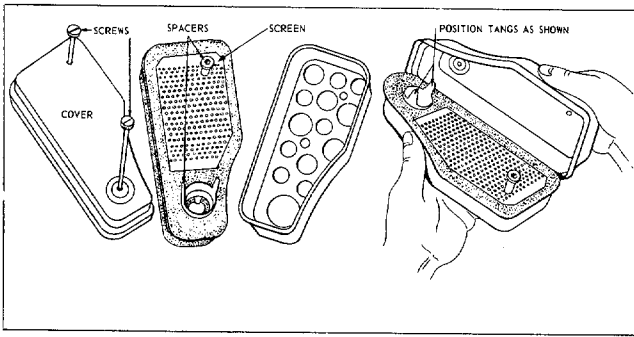

FIGURE 17. AIR CLEANER

13. CLEANING ENGINE AND BLADE HOUSING

Any fuel or oil spilled on the machine should be wiped off promptly. Grass, leaves, and other dirt must not be left to accumulate around the cooling fins of the engine or on any part of the machine.

Clean the underside of the blade housing after each mowing.

14. TIRES

The tires should be inflated to 7 to 10 psi. A punctured tire may be repaired in the same manner as an automobile tire.

15. BELTS

Check that belts are free of oil or dirt. Wipe the belts periodically with a clean rag.

16. SPARK PLUG

The spark plug gap should be cleaned and reset to a 0.030-inch clearance every 25 hours of engine operation (see figure 18). Spark plug replacement is recommended at the start of each mowing season; check engine parts list for correct plug type.

NOTE

Whenever the spark plug is removed for cleaning, it is advisable to replace the spark plug gasket with a new gasket.

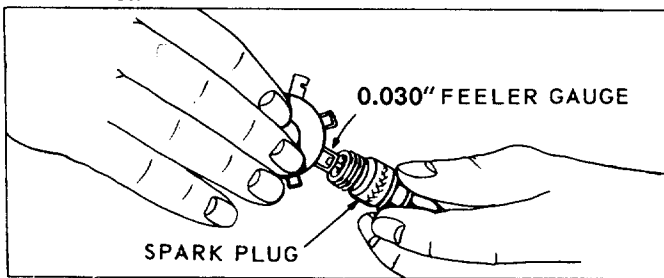

FIGURE 18. SPARK PLUG CLEARANCE

17. REPLACING BLADE

WARNING

Before beginning work on the cutter blade, remove the spark plug from the cylinder.

Removing and Sharpening Blades. Remove the center bolt and lockwasher. See figure 19. Pull the blade and blade adapter from the blade spindle.

The adapter can be removed from the blade by removing the two adapter bolts, lockwashers and nuts.

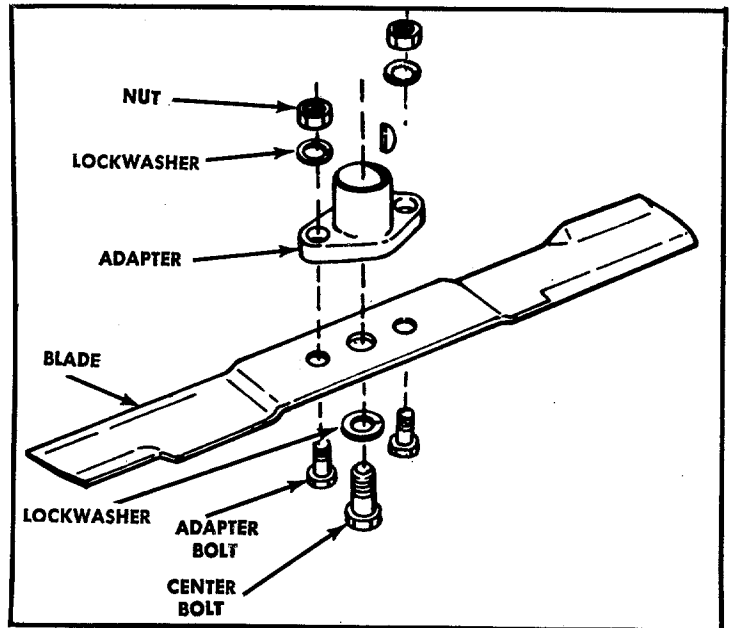

FIGURE 19. BLADE REMOVAL

When grinding or filing the blades to sharpen them, remove equal amounts of metal from both edges to keep the blade in balance. The blade can be tested for balance by balancing it on a screwdriver. Remove metal from the heavy side until it balances directly over the center hole in the blade. See figure 20.

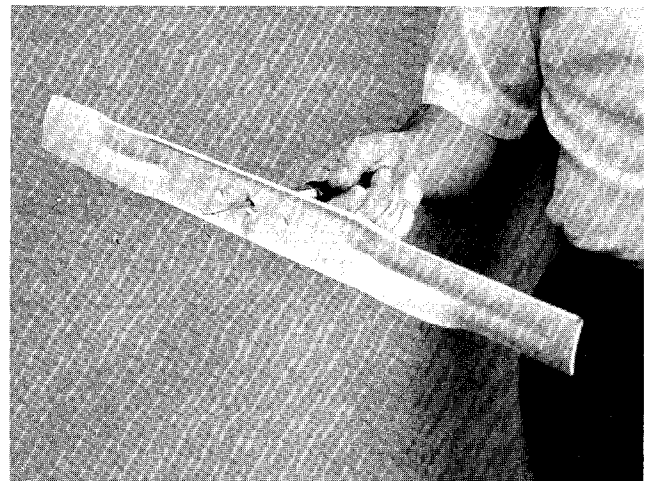

FIGURE 20. BLADE BALANCING

NOTE

When replacing the blade, be sure the side of the blade marked "Bottom Side" is down when the mower is in the operating position.

19. WHEEL ADJUSTMENT

The caster (forward slant of the king pin) and the camber (tilt of the wheels out at the top) requires no adjustment. Automotive steering principals have been used to determine the caster and camber on the tractor. The front wheels should toe-in 1/8 inch.

To adjust the toe-in follow these steps.

Step 1. Loosen the hex jam nut on one side. See figure 21.

- Step 2. Remove the elastic locknut and drop the tie rod end out of the wheel bracket.
- Step 3. Adjust the tie rod end in or out to obtain the proper toe-in adjustment as shown in figure 22.

NOTE

Unscrew the tie rod end to toe the wheels in.

- Step 4. Reassemble in reverse order.

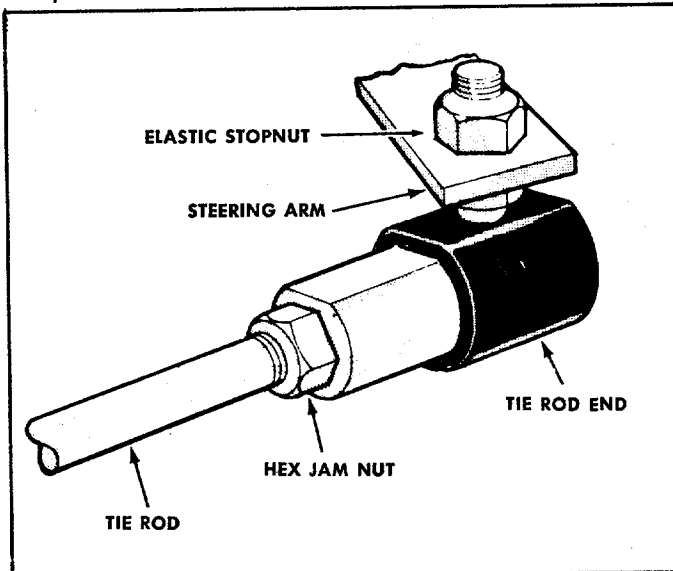

FIGURE 21. TIE ROD ADJUSTMENT

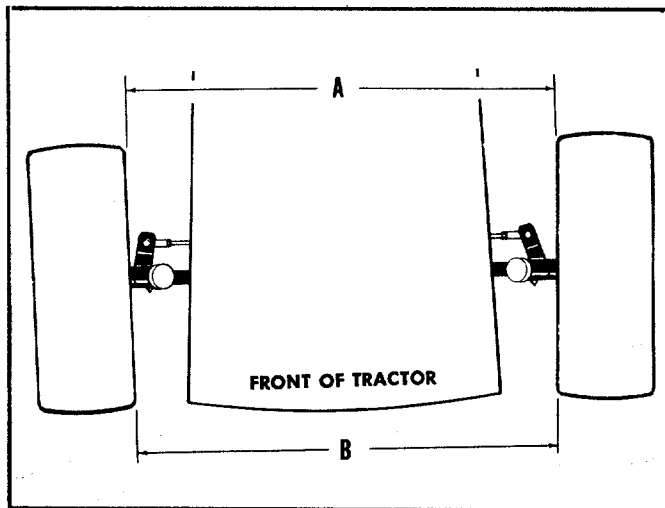

FIGURE 22. TOE-IN DIAGRAM

19. CHANGING BELTS

To change either belt, tip the mower on its rear wheels until it rests on the seat. Disconnect and ground the spark plug wire. NOTE: If your unit has a battery, remove from unit;; also seal gas tank cap with a small piece of plastic film.

Changing Mowing Unit Belt:

1. Place the lift and disengagement lever in ENGAGE position.
2. Remove the belt guard on the double groove engine pulley by removing the two hex nuts. See figure 23.
3. Remove the belt guards on the two blade spindle pulleys on the deck by removing two hex nuts.
4. Remove the cotter hairpins and washers from the four FRONT linkage arms.
5. Place the lift and disengagement lever in DISENGAGE position and remove the belt.
6. Reassemble with the new belt.

Changing Transmission Drive Belt:

1. Place the lift and disengagement lever in ENGAGE position.
2. Remove the belt guard on the double groove engine pulley by removing the two hex nuts. See figure 23.
3. Place the lift and disengagement lever in DISENGAGE position and remove the mowing unit belt from the engine pulley.
4. Remove the cotter hair pins and washers from the four FRONT linkage arms.
5. Remove the steering rod from the wheel bracket by removing the hex nut.
6. Remove the hex nut and lockwashers on the transmission pulley and pull the pulley out enough for the belt to be removed.
7. Remove the belt.
8. Reassemble with the new belt.

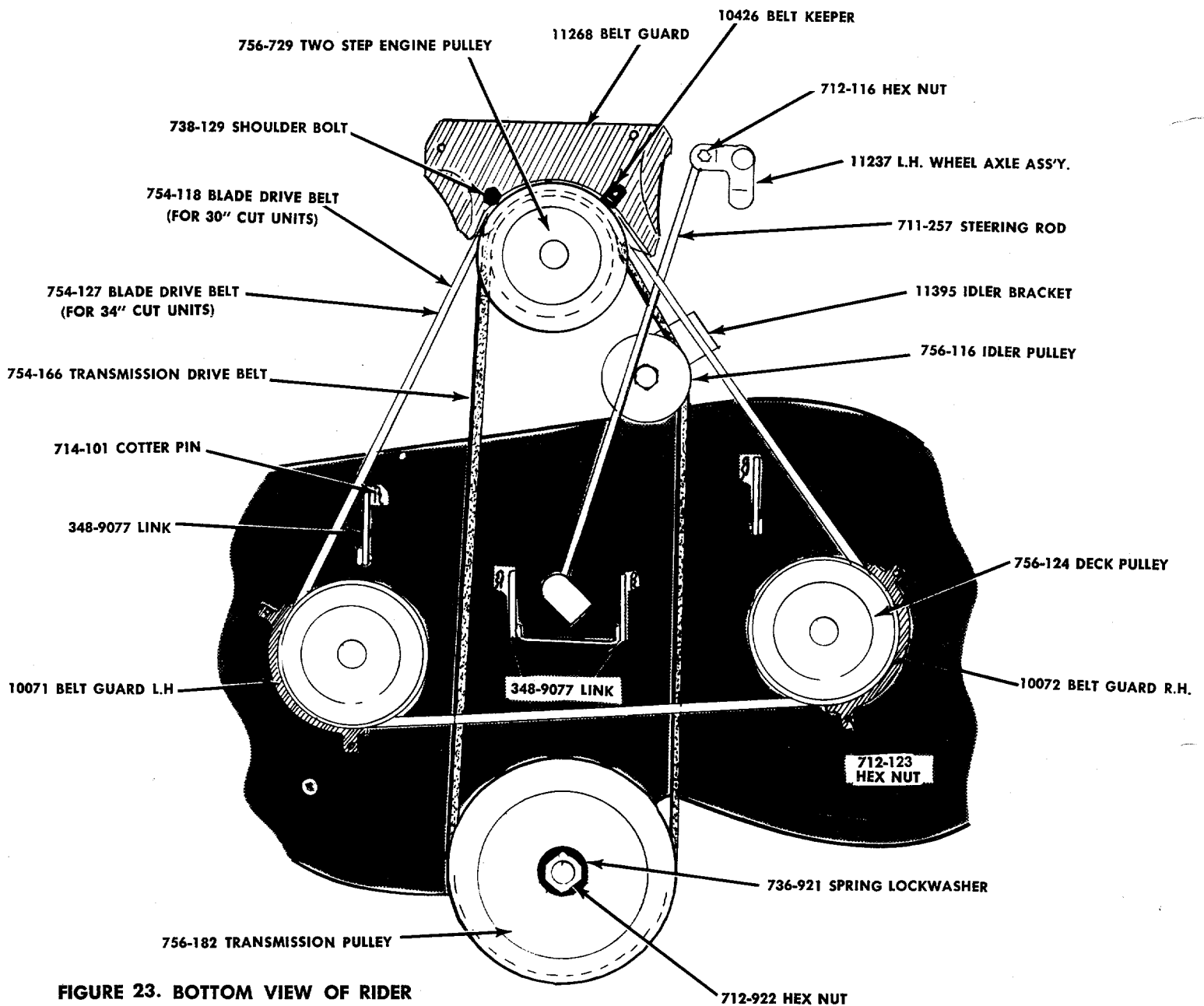

FIGURE 23. BOTTOM VIEW OF RIDER

OFF-SEASON STORAGE

OFF-SEASON STORAGE

NOTE

Engines to be stored over 30 days should be completely drained of fuel to prevent gum deposits forming on essential carburetor parts, fuel filter, fuel lines, and tank.

1. Remove all fuel from tank. Run the engine until it stops from lack of fuel. The small amount of fuel that remains in the sump of the tank should then be removed by absorbing it with a clean, dry cloth.
2. While engine is still warm, drain oil from crankcase. Refill with fresh oil.
3. Remove spark plug, pour 1 ounce of SAE-30 oil into cylinder and crank slowly to distribute oil. To prevent accidental starting, DO NOT replace the spark plug.

4. Clean dirt and chaff from cylinder, cylinder head fins and blower housing.
5. Clean all grass from underside of deck.
6. Clean the air filter.
7. Place blocks under frame of mower so that the wheels are off the ground.
8. Cover all bare metal parts, such as the mowing edge of the blades, with grease to prevent rusting.
9. Cover the mower with a tarpaulin or other protective covering.

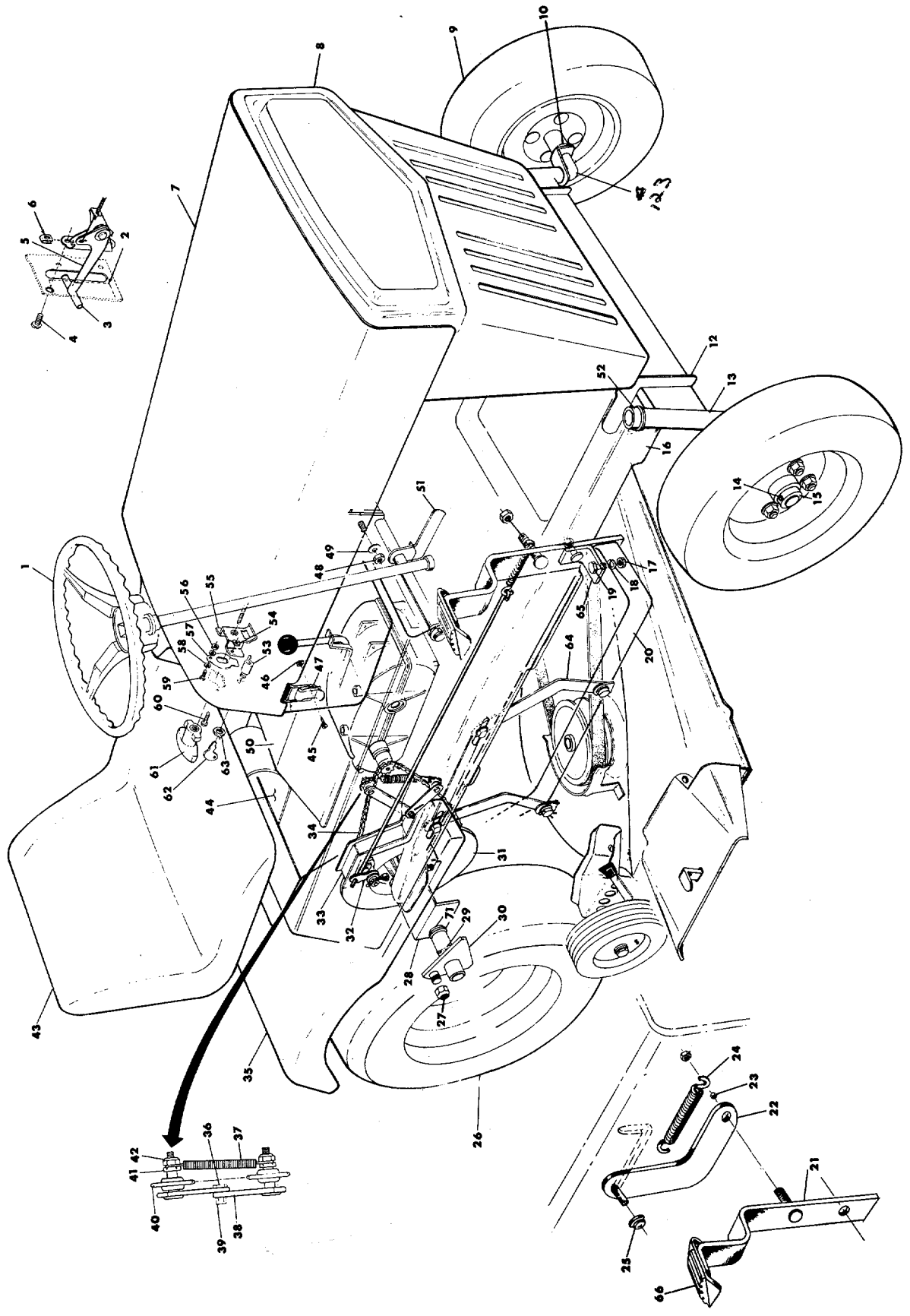

FIGURE 24. RIGHT HAND VIEW

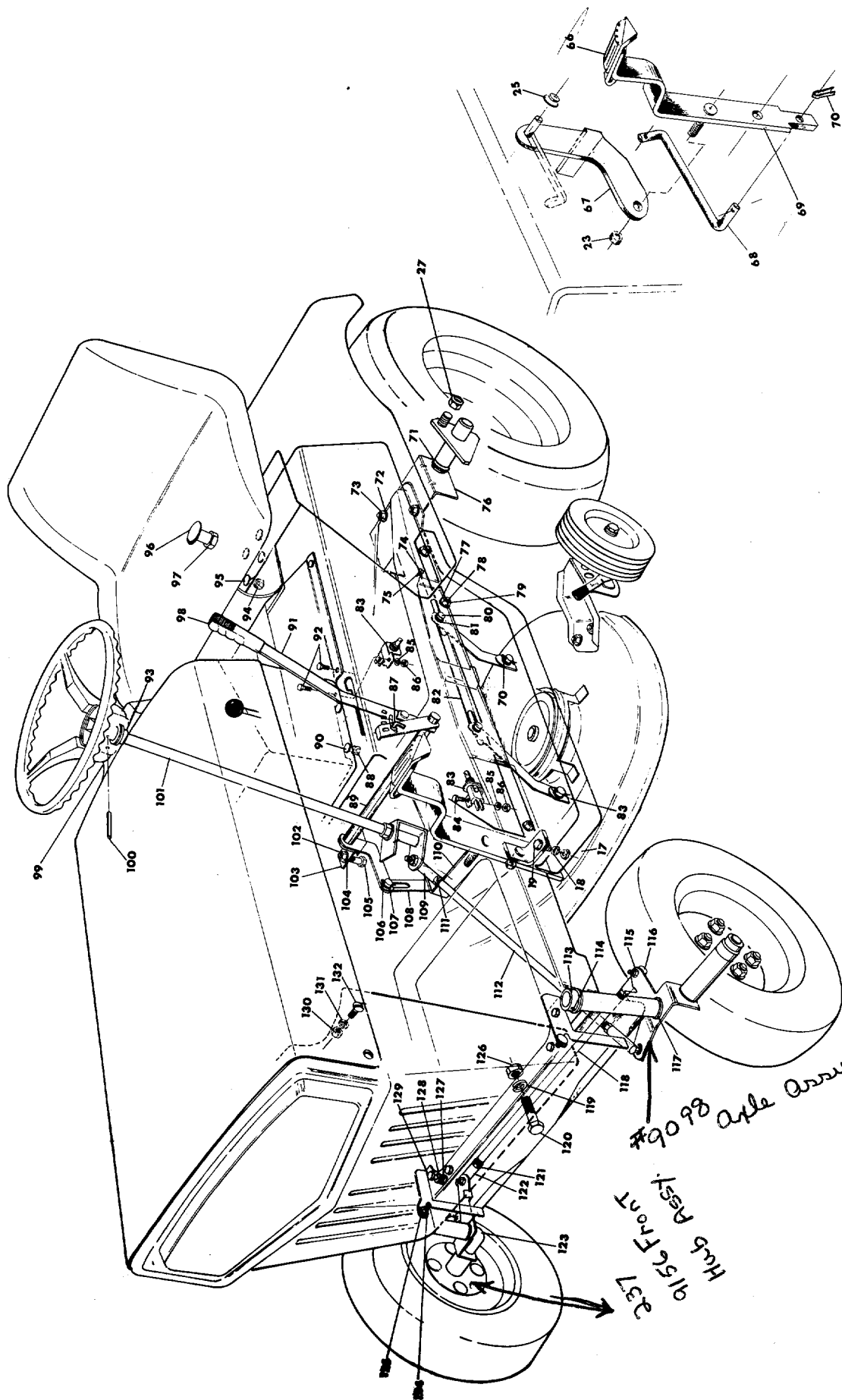

FIGURE 25. LEFT HAND VIEW

NOTE: If for any reason Disc Brake is disassembled, be sure round end of push pins (Ref. No. 193) is toward the cam lever (Ref. No. 195).

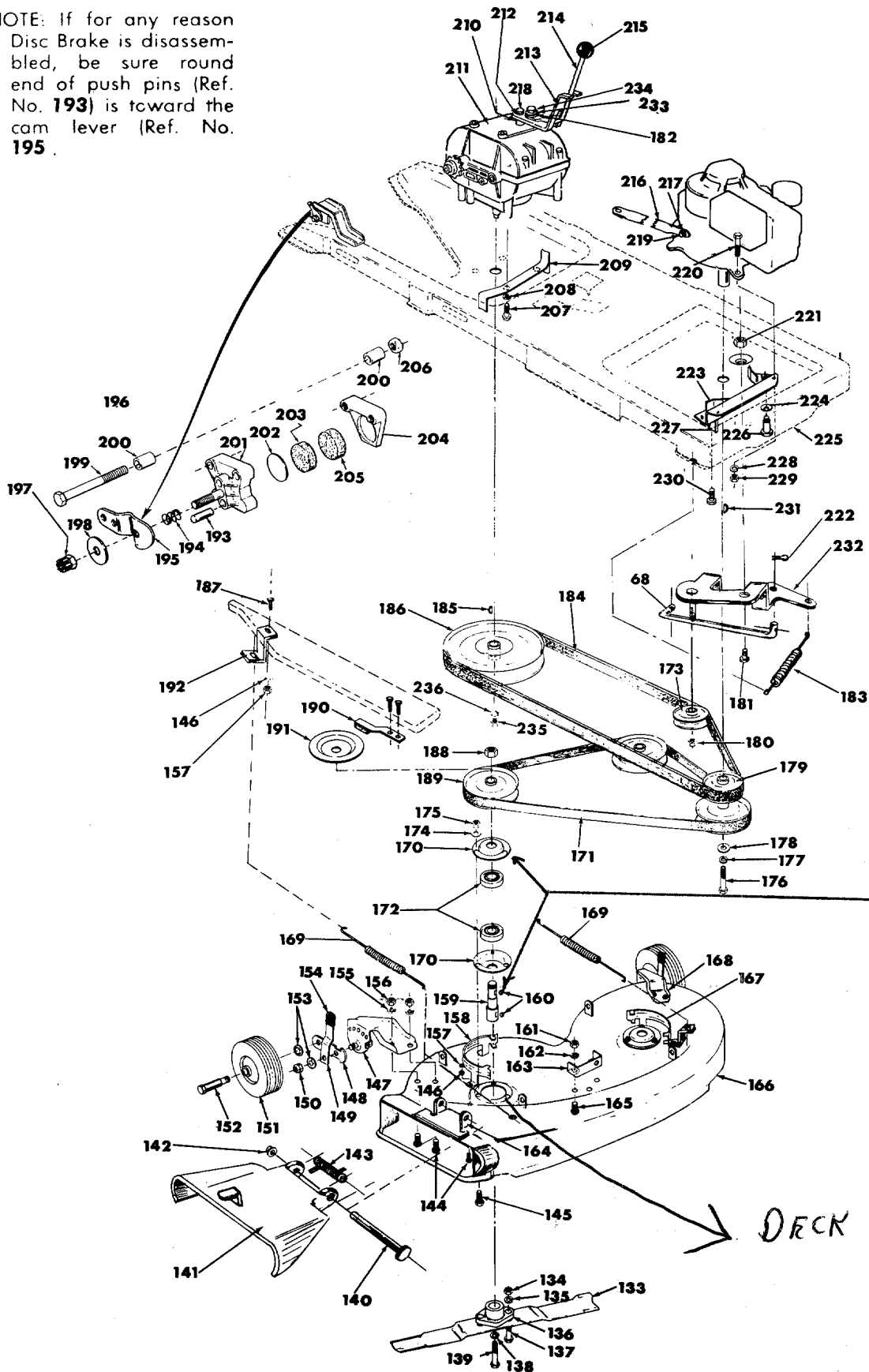

FIGURE 26. DECK AND FRAME VIEW

PARTS PRICE LIST FOR RIDER MOWER NO. 132-460, 132-465, 132-470 AND 132-475

Ref. No.	Part No.	Description	Ref. No.	Part No.	Description
1	723-204	Steering Wheel	60	710-351	Truss Hd. Self Tap Scr. #10 x .50" Lg.
	723-207	Steering Wheel Cap			(132-460 & 465 Only)
2	11260	Dash Panel Assembly (132-460 & 465 Only)	61	11263	Plastic Handle (132-460 & 465 Only)
	11262	Dash Panel Assembly (132-470 & 475 Only)	62	725-128	Key Only—For Switch (132-460 & 465 Only)
3	722-111	Knob Only	63		Part of Ref. No. 53 (132-460 & 465 Only)
4	710-473	Truss Hd. Mach. Scr. #10-24 x .50*	64	348-9077	Deck Link Assembly
5	746-160	Throttle Control—Complete	65	710-322	Sems Hex Hd. Cap Scr. 5/16-18 x 1" Lg.*
6	712-147	Speed Nut #10-24 U Type	66	10614	Pedal Pad Vinyl
7	437-9991	Hood Front (132-460 & 465 Only)	67	11370	Switch Lever Assembly
	10793	Hood—Front (132-470 & 475 Only)	68	11361	Clutch Rod 5/16" Dia.
8	10491	Grille (132-460 & 465 Only)	69	11357	Pedal Bracket Ass'y—L.H.
	10793	Grille (132-470 & 475 Only)	70	714-507	Cotter Pin
9	501-10109	Front Wheel Assembly—Complete	71	748-151	Flange Bearing with Flats .753 I.D.
	734-289	Front Wheel—Tire Only	72	736-169	Spring Lockwasher 3/8" Scr.*
	10108	Front Wheel—Rim Only	73	712-123	Hex Inserted Locknut 3/8-24 Thd.
10	748-184	Flange Bearing .630 I.D.	74	710-179	Hex Hd. Thd. Cut Scr. 1/4-20 x 1/2" Lg.
11	11237	Front Wheel Axle Assy.—L.H.	75	736-329	Spring Lockwasher 1/4" Scr.
12	10496	Front Pivot Bracket	76	348-9126	Bearing Bracket Assembly—L.H.
13	348-9039	Pivot Bar Assembly	77	736-119	Spring Lockwasher 5/16" Scr.*
14	710-356	Sq. Hd. Set Scr. 5/16-18 x .50" Lg. (Cup Point)	78	710-322	Sems Hex Hd. Cap Scr. 5/16-18 x 1" Lg.*
15	711-169	Collar 3/8" I.D.	79	712-267	Hex Nut 5/16-18 Thd.*
16	11258	Frame	80	748-152	Shoulder Pin
17	712-267	Hex Nut 5/16-18 Thd.*	81	736-860	Flat Washer
18	736-119	Spring Lockwasher 5/16" Scr.*	82	348-9131	Connecting Rod
19	710-322	Sems Hex Hd. Cap Scr. 5/16-18 x 1.00" Lg.	83	725-269	Safety Switch
20	348-9324	Foot Rest Assembly—R.H.	84	710-289	Hex Hd. Mach. Scr. 1/4-20 x .50" Lg.*
21	11356	Brake Pedal Bracket Ass'y—R.H.	85	736-329	Spring Lockwasher 1/4" Scr.*
22	11056	Brake Lever Ass'y	86	712-287	Hex Nut 1/4-20 Thd.*
23	712-287	Hex Nut 1/4-20 Thd.*	87	710-309	Adjustment Screw
24	732-245	Brake Spring	88	712-267	Hex Nut 5/16-18 Thd.*
25	726-121	Push Cap 1/4" Dia.—Black	89	348-9102	Lift Handle Shaft Ass'y
26	503-9262	Rear Wheel Assembly—Complete	90	736-119	Spring Lockwasher 5/16" Scr.*
	312-9262	Rear Wheel—Rim Only	91	10875	Lift Handle with Strip Ass'y
	734-275	Rear Wheel—Tire Only	92	710-289	Hex Hd. Mach. Scr. 1/4-20 x .50" Lg.*
27	712-193	Cone Nuts	93	748-227	Flange Bearing
28	348-9124	Bearing Bracket Ass'y. R.H.	94	712-267	Hex Nut 5/16-18 Thd.*
29	715-107	Spirol Pin 5/16" Dia. x 1.38" Lg.	95	736-119	Spring Lockwasher 5/16" Scr.*
30	312-9154	Rear Wheel Hub Ass'y.	96	710-385	Carriage Bolt 1/2-13 x 1" Lg.*
31	10286	Brake Disc	97	712-384	Hex Nut 1/2-13 Thd.*
32	761-131	Disc Brake Assembly—Complete	98	305-8118	Grip
33	10284	Disc Brake Bracket Ass'y.	100	715-121	Spirol Pin
34	713-163	#41 Chain 1/2" Pitch x 79 Link	101	348-9993	Steering Shaft Assembly
	713-723	#41 Master Link 1/2" Pitch Type II	102	712-267	Hex Nut 5/16-18 Thd.*
35	437-9132	Fender Assembly	103	348-9128	Height Adjustment Mounting Bracket
36	738-141	Shoulder Bolt .437" Dia. x .350" Lg.	104	736-119	Spring Lockwasher 5/16" Scr.*
37	732-169	Extension Spring .41 I.D. x 2.50" Lg.	105	710-322	Sems Hex Hd. Cap Scr. 5/16-18 x 1" Lg.*
38	348-9812	Sprocket Idler Bracket Ass'y	106	714-101	Hair Pin—Cotter
39	712-267	Hex Nut 5/16-18 Thd.*	107	736-160	Flat Washer
40	723-168	Sprocket Idler 10 Teeth	108	437-9136	Slotted Link
41	712-195	Locknut 3/8-24 Thd.	109	723-156	Ball Joint
42	712-181	Hex Top Locknut 3/8-16 Thd.	110	437-9073	Deck Bracket Assembly
43	312-8535	Seat Assembly	111	712-711	Hex Jam Nut 3/8-24 Thd.*
	723-232	Seat Cover	112	747-105	Steering Rod
44	348-255	Seat Spring	113	711-169	Collar
45	710-147	Truss Hd. Mach. Scr. #6-32 x .38" Lg.*	114	710-494	Sq. Hd. Set Scr. 5/16-18 x 1/4" Lg.*
46	712-112	Hex Nut #6-32 Thd.*	115	712-181	Hex Top Locknut 3/8-16 Thd.
47	723-209	Hood Latch	116	723-156	Ball Joint
48	712-181	Hex Top Lock Nut 3/8-16 Thd.	117	748-855	Flange Bearing
49	736-105	Belleville Washer	118	711-256	Tie Rod
50	11125	Cover—Upper Frame	119	736-158	Spring Lockwasher 3/8" Scr.*
51	348-9102	Lift Handle Shaft Assembly	120	710-312	Hex Hd. Cap Scr. 5/8-18 x 1.3" Lg.*
52	748-184	Flange Bearing .630 I.D.	121	712-711	Hex Jam Nut 3/8-24 Thd.
53	725-266	Magneto Ignition Switch	122	723-156	Ball Joint
54	712-287	Hex Nut 1/4-20 Thd.* (132-460 & 465 Only)	123	348-9095	Axle Ass'y—Front R.H.
55	11053	Switch Bracket Assembly (132-460 & 465 Only)	124	712-798	Hex Nut 3/8-16" Thd.*
56	712-121	Hex Nut #10-24 Thd.* (132-460 & 465 Only)	125	736-133	Flat Washer
57	732-257	Switch Spring (132-460 & 465 Only)	126	712-923	Hex Lock Nut 5/8-18 Thd.*
58	736-338	Fiber Washer (132-460 & 465 Only)	127	712-267	Hex Nut 5/16-18 Thd.*
59	710-425	Truss Hd. Mach. Scr. #10-24 x .62" Lg.* (132-460 & 465 Only)	128	736-119	Spring Lockwasher 5/16" Scr.
			129	710-322	Sems Hex Hd. Cap Scr. 5/16-18 x 1" Lg.*

*For faster service, obtain standard nuts, bolts and washers locally. If these items cannot be obtained locally, order by part number and size as shown on the parts list.

437 — Flag Red) When ordering parts if color or finish is important, use the appropriate color code shown at left.
 348 — Black) (e.g. Flag Red Finish — 11364 (437))

Prices are approximate and subject to change without notice.
 Parts Prices F.O.B. Shipping Point

PARTS PRICE LIST FOR RIDER MOWER NO. 132-460, 132-465, 132-470 AND 132-475 CONTINUED

Ref. No.	Part No.	Description	Ref. No.	Part No.	Description
130	712-287	Hex Nut 1/4-20 Thd.*	181	738-147	Shoulder Bolt .500" Dia. x .170" Lg.
131	736-329	Spring Lockwasher 1/4" Scr.*	182	735-126	Rubber Washer .33 I.D. x .87 O.D.
132	710-286	Truss Head Mach. Scr. 1/4-20 x 1/2" Lg.*	183	732-262	Spring
133	742-120	Blade 17 Inch (132-465 & 475 Only)	184	754-166	"V"-Belt 21/32 x 62" Lg. (Transmission Drive Belt)
	742-118	Blade 15 inch (132-460 & 470 Only)	185	714-314	Key Hi-Pro #606
134	712-123	Hex Nut 5/16-24 Thd.*	186	756-182	Pulley 9.00" Dia. (Transmission)
135	736-119	Spring Lockwasher 5/16" Scr.*	187	710-289	Hex Hd. Cap Scr. 1/4-20 x .50" Lg.*
136	748-189	Blade Adapter	188	712-923	Locknut 5/8-18 Thd.
137	710-117	Hex Hd. Cap Scr. 5/16-24 x 1" Lg. Heat Treated	189	756-124	Pulley 4.75 O.D. (Deck Pulley)
138	736-217	Spring Lockwasher 3/8" Scr. Heavy Duty	190	310-9326	Brake Spring Assembly
139	710-459	Hex Hd. Cap Scr. 3/8-24 x 1 1/2" Lg. Heat Treated	191	310-9322	Brake Disc. (For Cutting Blades)
140	711-571	Pivot Pin	192	11272	Deck Spring Bracket
141	11574	Chute Cover Assembly	193	05-1033-0000	Push Pin
142	726-106	Push-On Flange Nut	194	06-1029-0000	Compression Spring
143	732-261	Torsion Spring	195	18-1687-0000	Cam Lever
144	710-286	Truss Hd. Mach. Scr. 1/4-20 x 1/2" Lg.*	196	761-131	Disc Brake Ass'y—Complete
145	710-322	Sems Hex Hd. Cap Scr. 5/16-18 x 1" Lg.*	197	712-158	Hex Locknut 5/16-18 Thd.
146	736-329	Spring Lockwasher 1/4" Scr.*	198	03-1030-0000	Thrust Washer 5/16" I.D.
147	11236	Wheel Bracket Ass'y—R.H.	199	710-176	Hex Hd. Cap Scr. 5/16-18 x 2 3/4" Lg.
148	10937	Pivot Bar	200	11-1764-0000	Bushing 5/16" I.D. x 1/2" Lg.
149	10949	Spring Lever Ass'y with Knob	201	12-1984-0004	Casting, Cam Side
150	712-181	Hex Top Locknut 3/8-16 Thd.	202	03-1031-0000	Back Up Disc
151	734-225	Wheel Ass'y—Cutting Deck 6 x 1.75	203	15-1070-1079	Friction Pad
152	738-119	Shoulder Bolt .625" Dia. x 1.750" Lg.	204	12-1536-0001	Casting, Carrier Side
153	736-105	Belleville Washer	205	15-1070-1049	Friction Pad
154	305-7520	Knob	206	712-158	Hex Locknut 5/16-18 Thd.
155	736-329	Spring Lockwasher 1/4" Scr.*	207	710-259	Hex Hd. Cap Scr. 5/16-18 x 5/8" Lg.
156	712-287	Hex Nut 1/4-20 Thd.*	208	736-119	Spring Lockwasher 5/16" Scr.
157	712-287	Hex Nut 1/4-20 Thd.*	209	11270	Belt Guard—Transmission
158	10072	Belt Guard—R.H.	210	717-234	Washer—Special
159	711-255	Blade Spindle	211		Transmission—Complete
160	714-365	#6 Hi-Pro Key	212	736-109	Belleville Washer
161	712-287	Hex Nut 1/4-20 Thd.*	213	11546	Shift Lever Bracket Ass'y
162	736-329	Spring Lockwasher 1/4" Scr.*	214	11545	Shift Lever
163	348-9073	Deck Bracket Ass'y	215	722-115	Shift Knob
164	11399	Adapter Plate Ass'y	216	10903	Engine Brace
165	710-286	Truss Hd. Mach. Scr. 1/4-20 x .50" Lg.*	217	736-119	Spring Lockwasher 5/16" Scr.*
166	11394	Deck Assembly (132-465 & 475 Only)	218	710-237	Hex Hd. Cap Scr. 5/16-24 x .62" Lg.*
	11392	Deck Assembly (132-460 & 470 Only)	219	710-259	Hex Hd. Cap Scr. 5/16-18 x 5/8" Lg.*
167	10071	Belt Guard—L.H.	220	710-442	Hex Hd. Cap Scr. 5/16- x 1 1/2" Lg.*
168	11237	Wheel Bracket Ass'y—L.H.	221	712-116	Crown Locknut 3/8-24 Thd.
169	732-191	Spring .75 O.D. x 11.0" Lg.	222	714-115	Cotter Pin 1/8" Dia. x 1.00" Lg.*
170	310-8253	Housing	223	11268	Belt Guard Ass'y (Engine Pulley)
171	754-151	"V"-Belt 21/32 x 66" Lg. (Blade Drive Belt) (132-465 & 475 Only)	224	736-105	Belleville Washer
	754-118	"V"-Belt 21/32 x 63" Lg. (Blade Drive Belt) (132-460 & 470 Only)	225	11258	Frame
172	741-919	Ball Bearing	226	738-129	Shoulder Bolt (For Engine Belt Guard)
173	756-116	Idler	227	10426	Belt Keeper Ass'y
174	736-119	Spring Lockwasher 5/16" Scr.*	228	736-119	Spring Lockwasher 5/16" Scr.*
175	712-267	Hex Nut 5/16-18 Thd.*	229	712-123	Hex Nut 5/16-24 Thd.*
176	710-191	Hex Hd. Cap Scr. 3/8-24 x 1 1/4" Lg.*	230	710-259	Sems Hex Hd. Cap Scr. 5/16-18 x 5/8" Lg.*
177	736-329	Spring Lockwasher 1/4" Scr.*	231	714-365	#6 Hi-Pro Key
178	736-133	Flat Washer	232	11359	Idler Bracket Assembly
179	756-129	Two-Step Engine Pulley	233	736-159	Flat Washer .344 I.D. x .88 O.D.
180	712-181	Top Locknut 3/8-16 Thd.*	234	712-158	Hex Center Locknut 5/16-18 Thd.
			235	736-921	Spring Lockwasher 1/2" Scr.*
			236	712-923	Hex Jam Nut 1/2-20 Thd.
			237	362-9156	FRONT WHEEL HUB ASS'Y

238 09156 H42

* For faster service, obtain standard nuts, bolts and washers locally. If these items cannot be obtained locally, order by part number and size as shown on the parts list.

437 — Flag Red) When ordering parts if color or finish is important, use the appropriate color code shown
 348 — Black) at left (e.g. Flag Red Finish —11364 (437)).

Prices are approximate and subject to change without notice.
 Parts Prices F.O.B. Shipping Point

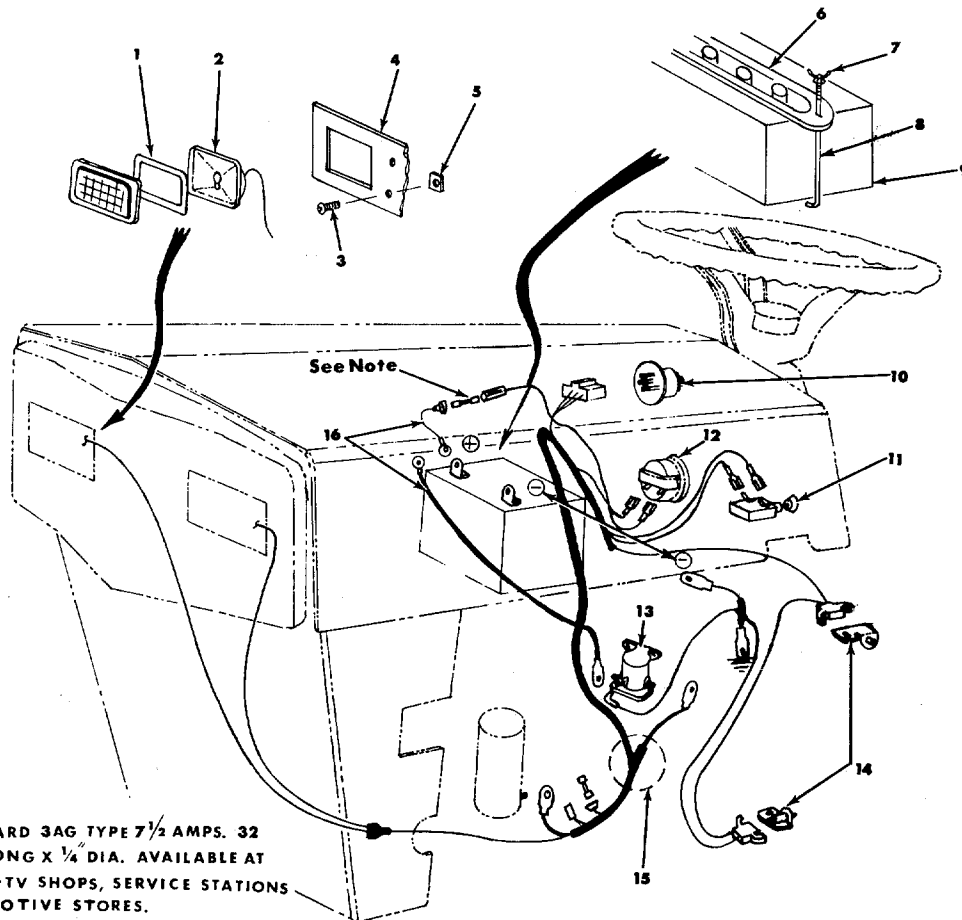

NOTE

FUSE-STANDARD 3AG TYPE 7½ AMPS. 32 VOLTS 1¼" LONG X ¼" DIA. AVAILABLE AT MOST RADIO-TV SHOPS, SERVICE STATIONS AND AUTOMOTIVE STORES.

FIGURE 27. ELECTRICAL DIAGRAM

PARTS LIST FOR ELECTRICAL DIAGRAM

REF. NO.	PART NO.	DESCRIPTION
1	---	Part of Ref. No. 2
2	725-155	Head Lights
3	710-286	Truss Head Mach. Scr. ¼-20 x .50" Lg.*
4	10795	Head Light Retainer
5	712-287	Hex Nut ¼-20 Thd.*
6	312-8821	Battery Hold Down
7	712-113	Wing Nut ¼-20 Thd.
8	711-222	Battery Hold Down Rod
9	725-117	Battery
10	725-267	Ignition Switch
	725-201	Ignition Key (Not Shown)
11	725-202	Head Light Switch
12	725-119	Ammeter
13	725-270	Solenoid
14	725-268	Safety Switch
15	725-278	Wire Harness
16	725-301	Electric Wire with Fuse Holder
17	---	The following will be a list of hardware for battery terminals:
	710-258	Hex Head Scr. ¼-20 x ¾" Lg.*
	712-287	Hex Nut ¼-20 Thd.*
	736-329	Spring Lockwasher ¼" Scr.*

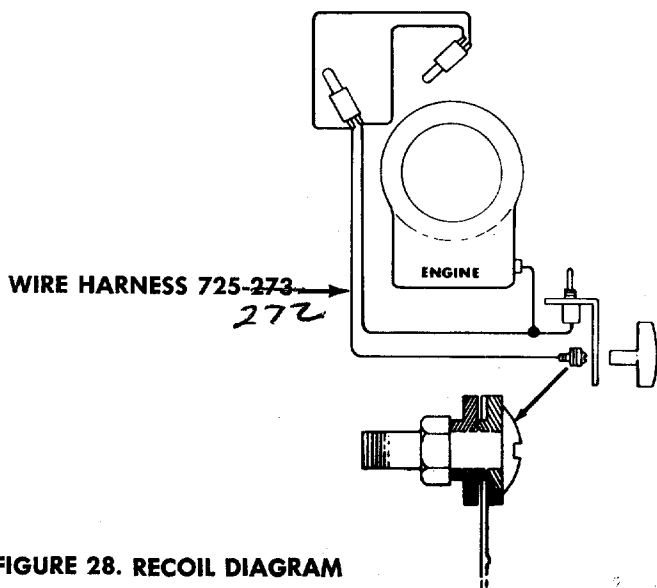
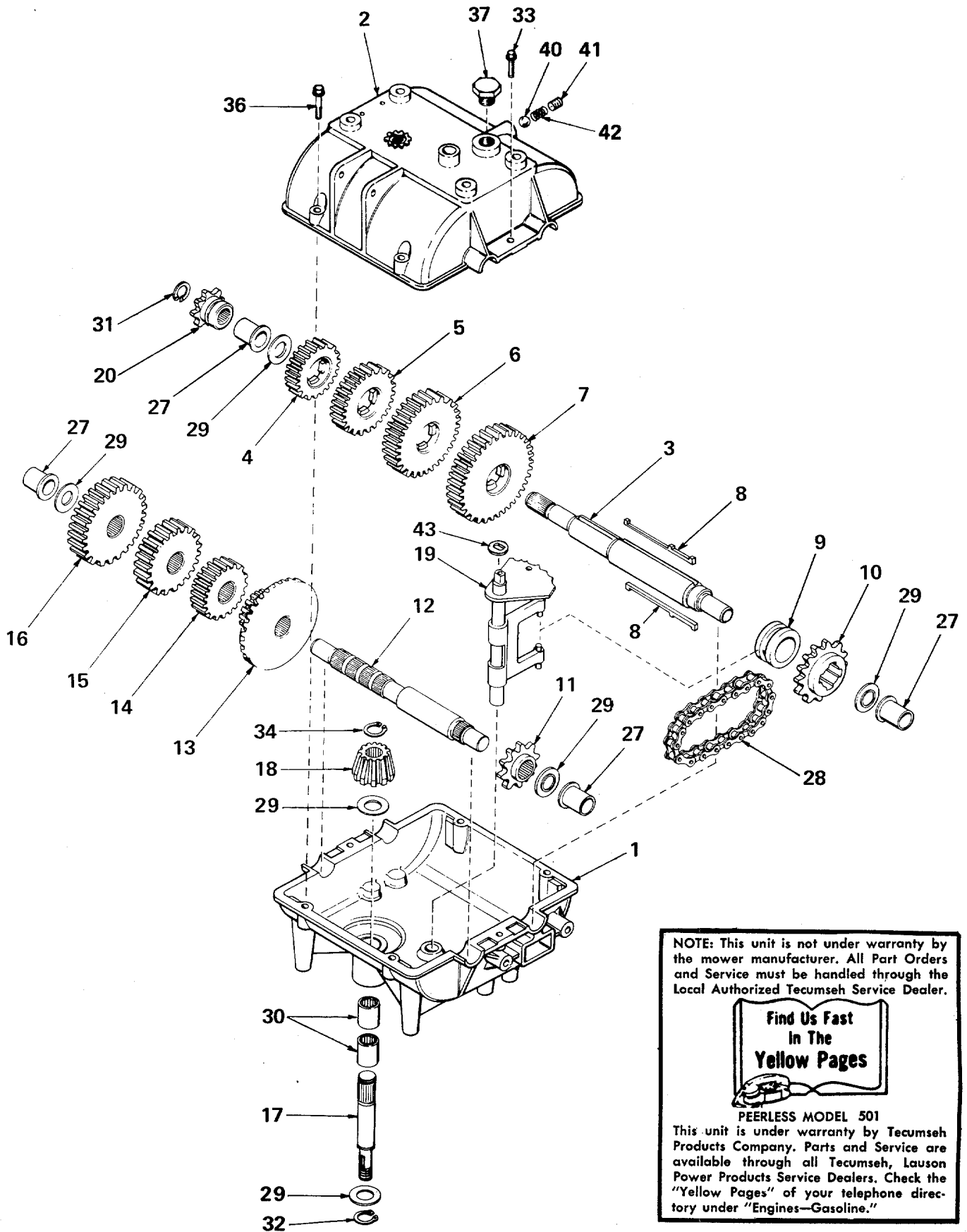

FIGURE 28. RECOIL DIAGRAM

*For faster service, obtain standard nuts, bolts and washers locally. If these items cannot be obtained locally, order by part number and size as shown on the parts list.

REVERSING TRANSMISSION (PEERLESS 501)



NOTE: This unit is not under warranty by the mower manufacturer. All Part Orders and Service must be handled through the Local Authorized Tecumseh Service Dealer.

**Find Us Fast
in The
Yellow Pages**

PEERLESS MODEL 501
This unit is under warranty by Tecumseh Products Company. Parts and Service are available through all Tecumseh, Lauson Power Products Service Dealers. Check the "Yellow Pages" of your telephone directory under "Engines—Gasoline."

FIGURE 29. TRANSMISSION—EXPLODED VIEW

PARTS PRICE LIST FOR REVERSING TRANSMISSION (PEERLESS 501)

REF. NO.	PART NO.	PART NAME
1	770061	Case, Transmission
2	772070	Cover, Transmission
3	776139	Shaft, Output & Brake
4	778105	Gear Spur (20 teeth)
5	778106	Gear, Spur (25 teeth)
6	778107	Gear Spur (30 teeth)
7	778108	Gear, Spur (35 teeth)
8	792071	Key
9	784216	Collar, Shift
10	786060	Sprocket (14 teeth)
11	786061	Sprocket (10 teeth)
12	776134	Shaft, Counter
13	778109	Gear, Bevel (42 tooth & 15 tooth spur gear)
14	778110	Gear, Spur (20 teeth)
15	778111	Gear Spur (25 teeth)
16	778112	Gear, Spur (30 teeth)
17	776140	Shaft, Input
18	778113	Bevel Pinion, Input
19	784217	Rod & Fork Assy., Shifter
20	786050	Sprocket (8 teeth)
27	780105	Bushing, Flanged
28	786062	Chain Roller (#41 chain 22 links)
29	780072	Race Thrust
30	780106	Bearing Needle
31	792072	Ring, Retaining
32	392035	Ring, Retaining
33	792059	Screw, 1/4-20 x 3/4 Hex Hd. Tap-Tite
34	788040	Ring, Retaining
36	792073	Screw, 1/4-20 x 1 1/4 Hex Hd. Tap-Tite
37	792074	Plug
40	792077	Ball, 5/16" Steel
41	792078	Screw, 3/8-16 x 3/8 set
42	792079	Spring
43	792083	Washer

NOTE: This unit is not under warranty by the mower manufacturer. All Part Orders and Service must be handled through the Local Authorized Tecumseh Service Dealer.



PEERLESS MODEL 501

This unit is under warranty by Tecumseh Products Company. Parts and Service are available through all Tecumseh, Lauson Power Products Service Dealers. Check the "Yellow Pages" of your telephone directory under "Engines—Gasoline."

11271 DIFFERENTIAL

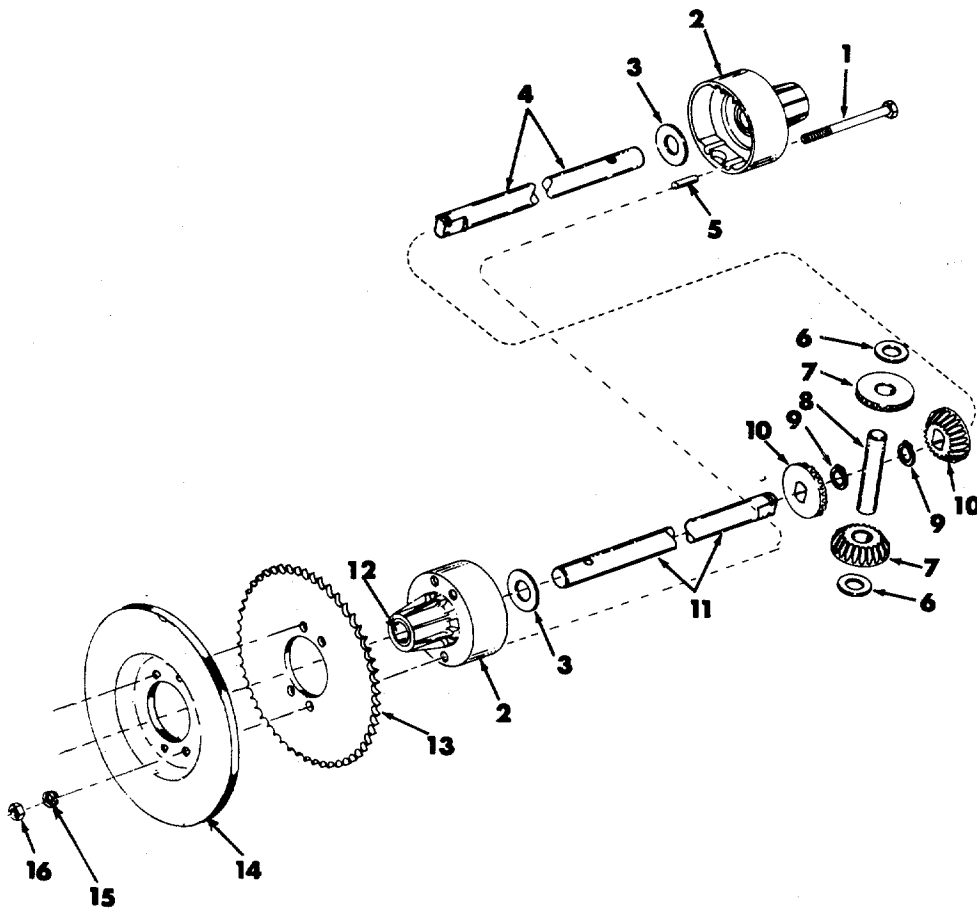

FIGURE 30. DIFFERENTIAL—EXPLODED VIEW

PARTS LIST FOR DIFFERENTIAL 11271

Ref. No.	Part No.	Description
1	710-363	Hex Hd. Cap Scr. 5/16-24 x 4.00" Lg.
2	719-150	Differential Housing Half
3	736-188	Flat Washer .760 I.D. x 1.49 O.D.
4	738-121	Differential Shaft 13.47" Lg.
5	715-123	Dowel Pin 3/16" Dia. x .62" Lg.
6	736-187	Flat Washer .640 I.D. x 1.24 O.D.
7	748-158	Miter Gear—Round Hole
8	711-276	Drive Pin
9	716-101	Snap Ring for .750 Dia. Shaft
10	748-185	Miter Gear—Double "D" Hole
11	738-122	Differential Shaft 10.34" Lg.
12	748-169	Flange Bearing
13	713-162	Sprocket 48 Tooth
14	10286	Brake Disc
15	736-119	Spring Lockwasher 5/16" Scr.
16	712-237	Hex Center Locknut 5/16-24 Thd.

BATTERY WARRANTY CERTIFICATE

The following general warranty policy applies to all batteries sold by IBMA members using this warranty. The nationwide warranty applies only to batteries bearing the IBMA seal of approval.

All new batteries sold by IBMA members carry a warranty against faulty material or workmanship for 90 days from date of purchase. A faulty battery is to be adjusted, repaired or replaced with a new battery by an IBMA member, jobber or dealer only, or the warranty becomes void. An IBMA type battery that is faulty within the 90 day period is to be repaired or replaced with a new battery F.O.B. any IBMA factory supplier or any IBMA authorized dealer, without charge.

Your battery carries a further warranty on a pro-rata adjustment basis covering the number of months determined by the class of service and type of battery. In determining the exchange cost of a new battery, charges will be made for months of service used and the warranty is valid to the original purchaser only.

IBMA approved factory suppliers, as well as all IBMA authorized dealers, are to honor this Warranty. If your IBMA approved battery carries the IBMA seal of approval, this Warranty is to be honored by dealers handling IBMA approved batteries everywhere. (Independent Battery Manufacturers Association, Inc.)

Failures in service that are caused by fire, collision, freezing, abuse, faulty electrical equipment or the use of a battery of a group size smaller or specifications lower than the original battery are not covered by this policy.

BATTERY MANUFACTURER MEMBERSHIP LIST

ALABAMA	Express Bty. Div.	Contract Bty. Mfg.	Shreveport	Maryland Heights	OREGON	Memphis
Birmingham	Leeth Brothers	Yocam Batteries	Central Bty.	Electro Bty. Mfg.	Beaverton	Central Battery
Southern Bty.	FLORIDA	ILLINOIS	MARYLAND	Sikeston	Western Bty., Inc.	Laheer Bty. Prod.
Yocam Batteries	Fort Lauderdale	Belleville	Baltimore	Electro Bty.	Portland	Southern Bty.
Mobile	Florida Bty.	Bell City Bty. Mfg.	East Penn Mfg.	NEW JERSEY	Laheer Bty. Prod.	Nashville
Yocam Batteries	Hialeah	Chicago	MASSACHUSETTS	Atlantic City	PENNSYLVANIA	Electro-Lite Bty.
Montgomery	East Penn Mfg.	Illinois Bty. Mfg.	Watertown	Landis Battery	Altoona	Southern Bty.
Ebco Battery	Jacksonville	Universal Bty.	Atlantic Bty.	NEW MEXICO	East Penn Mfg.	TEXAS
ALASKA	Tropex Batteries	Volta Bty. Corp.	MICHIGAN	Albuquerque	Erie	Dallas
Anchorage	Yocam Batteries	Peoria	Detroit	Sandia Bty. Mfg.	New Castle Bty.	Continental Bty.
Alaska Husky Bty.	Miami	Red Diamond Bty.	Batteries Mfg.	NEW YORK	Lancaster	Reliable Battery
ARKANSAS	Tropex Batteries	INDIANA	Flint	Buffalo	Lancaster Bty.	El Paso
Hot Springs	Yocam Batteries	Muncie	ABC Batteries	East Penn Mfg.	Lyon Station	El Paso Bty.
Red Diamond Bty.	Orlando	Stout Storage Bty.	Holly	Lockport	East Penn Mfg.	Houston
CALIFORNIA	Yocam Batteries	IOWA	Detroit Battery	Great Lakes Battery	New Castle	Texford Bty. Co.
Los Angeles	Pensacola	Corydon	Madison Heights	NORTH CAROLINA	New Castle Bty.	Reliable Battery
Estee Battery	Yocam Batteries	Voltmaster	C & W Lektra	Charlotte	Philadelphia	San Antonio
Laheer Bty. Prod.	St. Petersburg	Council Bluffs	Warren	Yocam Batteries	East Penn Mfg.	Reliable Battery
Oakland	Electro Battery Co.	Reliance Bty. Prod.	G & M Battery	Thomasville	Geidel Bty. Div.	UTAH
Laheer Bty. Prod.	Tampa	Des Moines	MINNESOTA	East Penn Mfg.	Pittsburgh	Salt Lake City
Sacramento	Bilt-Rite Bty. Mfg.	Voltmaster	St. Paul	OHIO	Simon Bty. & Res.	Laheer Bty. Prod.
Laheer Bty. Prod.	Contract Bty. Mfg.	KANSAS	Standard Storage Bty.	Akron	Geidel Bty. Div.	VIRGINIA
San Francisco	DeSoto Bty. & Elec.	Kansas City	MISSISSIPPI	Crown Battery	RHODE ISLAND	Arlington
Amp King Bty.	Tropex Batteries	American Batteries	Florence	Cincinnati	Providence	Express Bty. Div.
Laheer Bty. Prod.	Yocam Batteries	Contract Bty. Mfg.	Contract Bty. Mfg.	Moore Battery	Pilof Mfg., Inc.	Leeth Bros.
Pico Bty. Mfg.	GEORGIA	KENTUCKY	Jackson	Cleveland	SOUTH CAROLINA	Lynchburg
Stockton	Albany	Whitesburg	Central Bty.	Crown Battery	Columbia	Hydrate Battery
Stockton Battery	Ebco Battery	Electro-Lite Bty.	New Albany	New Castle Bty.	Yocam Batteries	WASHINGTON
COLORADO	Southern Bty.	LOUISIANA	Laheer Bty. Prod.	Columbus	Tennessee	Seattle
Denver	Yocam Batteries	New Orleans	MISSOURI	Crown Battery	Chattanooga	Laheer Bty. Prod.
Moore Battery	Columbus	Central Bty.	Joplin	Fremont	Electro-Lite Bty.	Laheer Bty. Prod.
D. C.	Ebco Battery	Reliable Bty.	Lead Products	Crown Battery	Knoxville	Industrial Bty. &
Washington					Southern Bty.	Supply

WARRANTY

For one year from date of purchase, MTD Products Inc will replace for the original purchaser, free of charge, F.O.B. factory or authorized service firm, any part or parts found to be defective in material or workmanship. All transportation charges on parts submitted for replacement under this warranty must be paid by the purchaser. This warranty does not include replacement of parts which become inoperative through misuse, excessive use, accident, neglect, improper maintenance or alterations by unauthorized persons. This warranty does not include the engine, motor, battery, battery charger or any component parts thereof. For service on these units refer to the applicable manufacturer's warranty.

The above warranty will apply only to the original owner and will be effective only if the warranty card has been properly processed. It will not apply where the unit has been used commercially.

Warranty service is available through your local authorized service dealer or distributor. **UNDER NO CIRCUMSTANCES WILL THE RETURN OF A COMPLETE UNIT BE ACCEPTED BY THE FACTORY UNLESS PRIOR WRITTEN PERMISSION HAS BEEN EXTENDED.**

PARTS INFORMATION

MOWER, TILLER, SNOW THROWER AND TRACTOR PARTS

Mower, tiller, snow thrower and tractor parts are available through the authorized service firms listed below. All orders should specify the model number of your unit, parts numbers, description of parts and the quantity of each part required.

A 1 Engine & Mower Co.
327 East 9th Street
Salt Lake City, Utah 84102

American Electric Ignition Co.
124 N. W. 8th Street
Oklahoma City, Oklahoma 73102

Auto Electric & Carburetor Co.
2625 4th Avenue, S.
P. O. Box 1948
Birmingham, Alabama 35233

Automotive Equipment Service Co.
3117 Holmes Street
Kansas City, Missouri 64109

Bailey's Rebuild Inc.
1325 E. Madison Street
Seattle, Washington 98102

Brown Equipment Distributor Inc.
110 Beech Street
Corydon, Indiana 47112

Bullard Supply
2409 Commerce Street
Houston, Texas 77003

Center Supply Company
6867 New Hampshire Avenue
Takoma Park, Maryland 20012

R. T. Clapp Co.
2016 Magnolia Ave., N. E.
Knoxville, Tennessee 37917

W. B. Clements
400 Salem Avenue
Roanoke, Virginia 24016

Morton B. Collins Co.
300 Birnie Avenue
Springfield, Massachusetts 01107

Dixie Sales Company
P. O. Box 1408
327 Battleground Avenue
Greensboro, North Carolina 27402

East Point Cycle & Key Shop
1617 Whiteway
East Point, Georgia 30044

Gamble Distributors
West End Avenue
Carthage, New York 13619

Garden Equipment Co., Inc.
6600 Cherry Avenue
Long Beach, California 90805

Henzler, Inc.
2015 Lemay Ferry Road
St. Louis, Missouri 63125

Frank E. Ives & Son
1101 Lincoln Avenue
Prospect Park, Pennsylvania 19076

J. W. Jewett Co.
981 Folsom Street
San Francisco, California 94107

Kenton Supply
8216 North Denver Avenue
Portland, Oregon 97217

Kimber's Inc.
615 W. Genesee Street
Syracuse, New York 13204

Marr Brothers
423 E. Jefferson
Dallas, Texas 75203

Mathews Auto Electric Co.
420 East 2nd Street
Tulsa, Oklahoma 74120

McClure Lawn & Garden Supply
1114 Lexington Avenue
Mansfield, Ohio 44907

Memphis Cycle & Supply Co.
421 Monroe Avenue
Memphis, Tennessee 38103

ENGINE PARTS AND SERVICE

Engine parts and service should be handled by your nearest authorized engine service firm. Check the yellow pages of your telephone directory under the listing *Engines - Gasoline*, Briggs and Stratton or Tecumseh Lauson - Power Products.

Moz-All of Florida, Inc.
365 Greco Avenue
Coral Gables, Florida 33146

National Central, Div. of Joe Sterling, Inc.
Drawer "D" 687 Seville Rd.
Wadsworth, Ohio 44281

Power Equipment Distributor
36463 So. Gratiot Avenue
Mt. Clemens, Michigan 48043

Parts & Sales Inc.
335 West St. Charles Road
Villa Park, Illinois 60181

Power Lawn & Garden Equip. Co.
2551-2571 J. F. Kennedy Road
Dubuque, Iowa 52001

Raub Supply Company
James & Mulberry Sts.
Lancaster, Pennsylvania 17604

Radco Distributors
2403 Market Street
P. O. Box 3216
Jacksonville, Florida 32206

Richmond Battery & Ignition
P. O. Box 25369 - 957 Myers St.
Richmond, Virginia 23260

Smith Hardware Company
515 N. George Street
Goldsboro, North Carolina 27530

South Denver Lawn Equip. Co.
527 West Evans
Denver, Colorado 80223

Suhren Engine
8330 Earhart Blvd.
New Orleans, Louisiana 70118

Sutton's Lawn Mower Shop
Route 4, Box 343
North Little Rock, Arkansas 72117

Warner Equipment
7520 Lyndale Avenue, So.
Minneapolis, Minnesota 55423