

OWNER'S MANUAL

26" RIDING MOWERS

Model Numbers
132-400A
132-400-300

Important:
Read Safety Rules and
Instructions Carefully

Thank you for purchasing an
American built product.

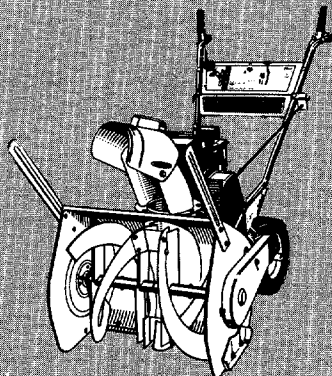
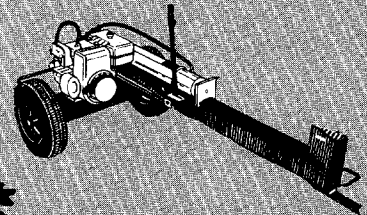
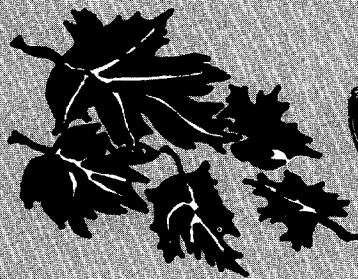
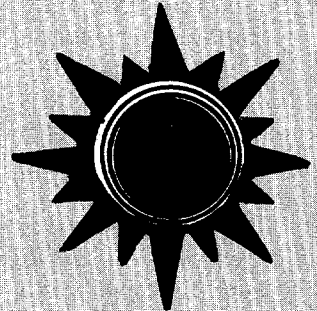
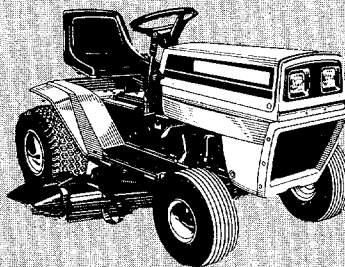
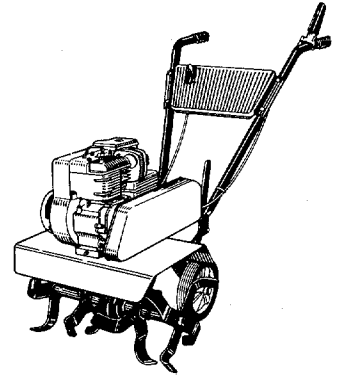

INDEX

Safe Operation Practices	3	Maintenance	12
Assembly Instructions	4	Off-Season Storage	15
Controls	7	Trouble Shooting Chart	16
Operation	8	Illustrated Parts	18-25
Adjustments	10	Electrical Diagram	26
Lubrication	11	Parts Information	Back Cover

LIMITED WARRANTY

For one year from the date of original retail purchase, MTD PRODUCTS INC will either repair or replace, at its option, free of charge, F.O.B. factory or authorized service firm, any part or parts found to be defective in material or workmanship. Transportation charges for the movement of any power equipment unit or attachment are the responsibility of the purchaser. Transportation charges for any parts submitted for replacement under this warranty must be paid by the purchaser unless such return is requested by MTD PRODUCTS INC.

This warranty will not apply to any part which has become inoperative due to misuse, excessive use, accident, neglect, improper maintenance, alterations, or unless the unit has been operated and maintained in accordance with the instructions furnished. This warranty does not apply to the engine, motor, battery, battery charger or component parts thereof. Please refer to the applicable manufacturer's warranty on these items.

This warranty will not apply where the unit has been used commercially.

Warranty service is available through your local authorized service dealer or distributor. If you do not know the dealer or distributor in your area, please write to the Customer Service Department of MTD.

The return of a complete unit will not be accepted by the factory unless prior written permission has been extended by MTD.

This warranty gives you specific legal rights. You may also have other rights which vary from state to state.



WARNING

TO PURCHASERS OF INTERNAL COMBUSTION ENGINE EQUIPPED MACHINERY OR DEVICES IN THE STATE OF CALIFORNIA

The equipment which you have just purchased does not have a spark arrester. If this equipment is used on any forest covered land, brush covered land, or grass covered unimproved land in the State of California, before using on such land, the California law requires that a spark arrester be provided. In addition, spark arrester is required by law to be in effective working order. The spark arrester must be attached to the exhaust system and comply with Section 4442 of the California Public Resources Code.

**WARNING**

To reduce the potential for any injury, comply with the following safety instructions. Failure to comply with the instructions may result in personal injury.

SAFE OPERATION PRACTICES FOR RIDING VEHICLES

1. It is suggested that this manual be read in its entirety before attempting to assemble or operate this unit. Keep this manual in a safe place for future reference and for ordering replacement parts.
2. This unit is a precision piece of power equipment, not a plaything. Therefore exercise extreme caution at all times.
3. Know the controls and how to stop quickly—READ THIS OWNER'S MANUAL.
4. Do not allow children to operate vehicle. Do not allow adults to operate it without proper instruction. Only persons well acquainted with these rules of safe operation should be allowed to use your mower.
5. No one should operate this unit while intoxicated or while taking medication that impairs the senses or reactions.
6. Wear sturdy, rough-soled work shoes and close-fitting slacks and shirts to avoid entanglement in the moving parts. Never operate a unit in bare feet, sandals, or sneakers.
7. To prevent injury, do not carry passengers or give rides. Keep children, pets and bystanders out of the area while mowing. Only the operator should ride on the unit and only ride in the seat.
8. Check overhead clearance carefully before driving under power lines, guy wires, bridges or low hanging tree branches, before entering or leaving buildings, or in any other situation where the operator may be struck or pulled from the unit, which could result in serious injury.
9. To maintain control of the unit and reduce the possibility of upset or collision, operate the tractor smoothly. Avoid erratic operation and excessive speed.
10. Keep the area of operation clear of all persons, particularly small children and pets. Stop engine when they are in the vicinity of your mower. Although the area of operation should be completely cleared of foreign objects, a small object may have been overlooked and could be accidentally thrown by the mower in any direction and cause injury.
11. Clear work area of objects which might be picked up and thrown by the mower in any direction and cause injury.
12. Stop the blade(s) when crossing gravel drives, walks or roads.
13. Disengage all attachment clutches and shift into neutral before attempting to start engine.
14. Disengage power to attachment(s) and stop engine before leaving operating position.
15. Do not put hands or feet near or under rotating parts. Keep clear of the discharge opening at all times as the rotating blade(s) can cause injury.
16. Disengage power to attachment(s) and stop engine before making any repairs or adjustments. Disconnect the spark plug wire and keep the wire away from the plug to prevent accidental starting.
17. Before attempting to unclog the mower or discharge chute, stop the engine. The mower blade(s) may continue to rotate for a few seconds after the engine is shut off. Therefore, be sure the blade(s) have stopped completely. Disconnect the spark plug wire and keep the wire away from the plug to prevent accidental starting.
18. Disengage power to attachment(s) when transporting or not in use.
19. Take all possible precautions when leaving vehicle unattended such as disengaging power-take-off, lowering attachments, shifting into neutral, setting parking brake, stopping engine and removing key.
20. Do not stop or start suddenly when going uphill or downhill. Mow up and down face of steep slopes; never across the face.
21. Reduce speed on slopes and in sharp turns to prevent tipping or loss of control. Always keep the tractor in gear when going down steep hills to take advantage of engine braking action.
22. Stay alert for holes in terrain and other hidden hazards.
23. Use care when pulling loads or using heavy equipment.
 - A. Use only approved drawbar hitch points.
 - B. Limit loads to those you can safely control.
 - C. Do not turn sharply. Use care when backing.
 - D. Use counterweight(s) or wheel weights when suggested in owner's manual.
24. Watch out for traffic when crossing or near roadways.
25. When using any attachments, never direct discharge of material toward bystanders nor allow anyone near vehicle while in operation.
26. Handle gasoline with care. It is highly flammable.
 - A. Use approved gasoline container.
 - B. Never remove cap or add gasoline to a running or hot engine or fill fuel tank indoors. Wipe up spilled gasoline.
 - C. Open doors if engine is run in garage. Exhaust fumes are dangerous. Do not run engine indoors.
27. Keep the vehicle and attachments in good operating condition, and keep safety devices in place. Use guards as instructed in owner's manual.
28. Keep all nuts, bolts, and screws tight to be sure the equipment is in safe working condition.

29. Never store the equipment with gasoline in the tank inside a building where fumes may reach an open flame or spark. Allow engine to cool before storing in any enclosure.
30. To reduce fire hazard, keep engine free of grass, leaves or excessive grease.
31. The vehicle and attachments should be stopped and inspected for damage after striking a foreign object. The damage should be repaired before restarting and operating the equipment.
32. Do not change the engine governor settings or overspeed the engine.
33. When using the vehicle with mower, proceed as follows:
 - (1) Mow only in daylight or in good artificial light.

- (2) Never make a cutting height adjustment while engine is running if operator must dismount to do so.
 - (3) Shut the engine off and wait until the blade comes to a complete stop before removing the grass catcher.
 - (4) Check blade mounting bolts for proper tightness at frequent intervals.
34. Check grass catcher bags frequently for wear or deterioration. For safety protection, replace only with new bag meeting original equipment specifications.
 35. Look behind to make sure the area is clear before placing the transmission in reverse and continue looking behind while backing up.

ASSEMBLY INSTRUCTIONS



This unit is shipped WITHOUT GASOLINE or OIL. After assembly, see separate engine manual for proper fuel and engine oil recommendations.



Reference to right-hand or left-hand side of machine is from the driver's seat facing forward.

Contents of Hardware Pack:

- A (1) Hex Bolt 1/4-20 x 1.25" Long
- B (1) Hex Lock Nut 1/4-20 Thread
- C (2) Speed Nuts #10-24 Thread
- D (2) Hex Self-tapping Screws #10 x .50" Long
- E (1) Belleville Washer
- F (1) Hex Lock Nut 5/16-18 Thread
- G (1) Steering Wheel Cap
- H (4) Hex Bolts 1/4-20 x .50" Long
- I (4) Lock Washers 1/4" I.D.
- J (4) Flat Washers

Loose Parts in Carton:

- K (1) Steering Tube Assembly
- L (1) Steering Cover
- M (1) Steering Wheel
- N (1) Seat

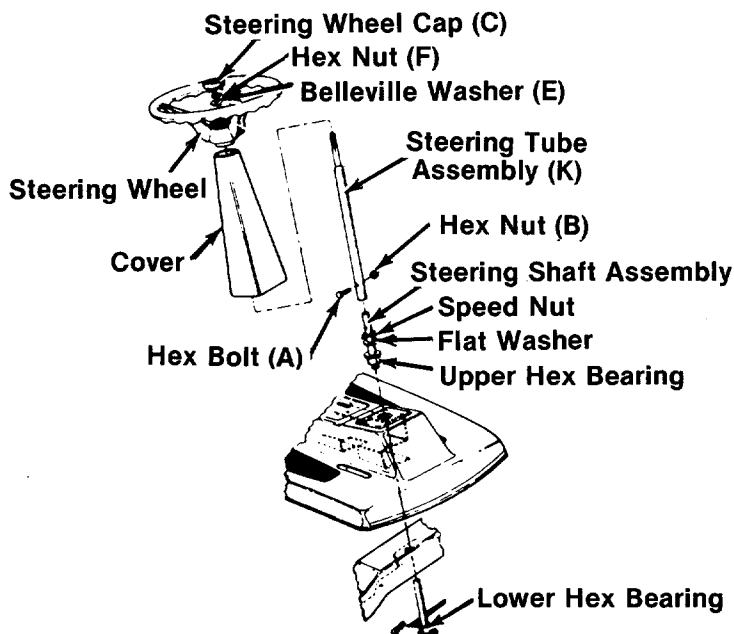

STEERING WHEEL ASSEMBLY



Due to vibration during shipment, it is possible that the steering shaft on your unit may have dropped to a position where alignment of parts is difficult. This must be kept in mind during the assembly operation.

1. Check the upper and lower hex bearings. Be sure they are seated and in position. See figure 1.
2. Place your hand under the front of the unit. Push up on the steering shaft assembly.

FIGURE 1. STEERING ASSEMBLY

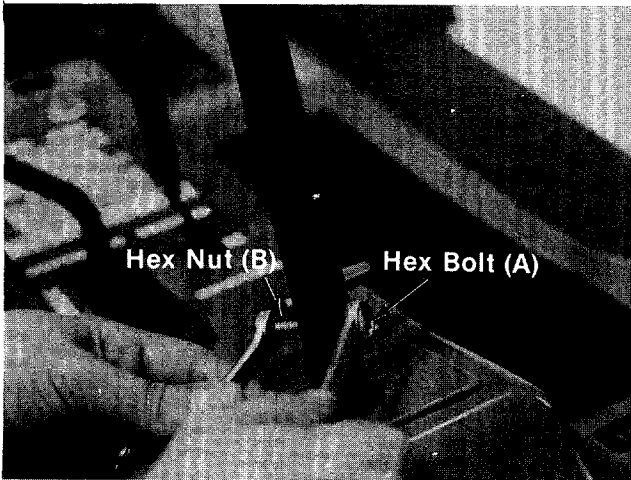

FIGURE 2.

3. Hold up the shaft assembly. Place the steering tube assembly on the shaft and start the hex bolt (A) through the hole. See figure 2. ←
4. Fasten the tubing assembly to the steering shaft assembly with hex bolt and hex nut (B) provided.

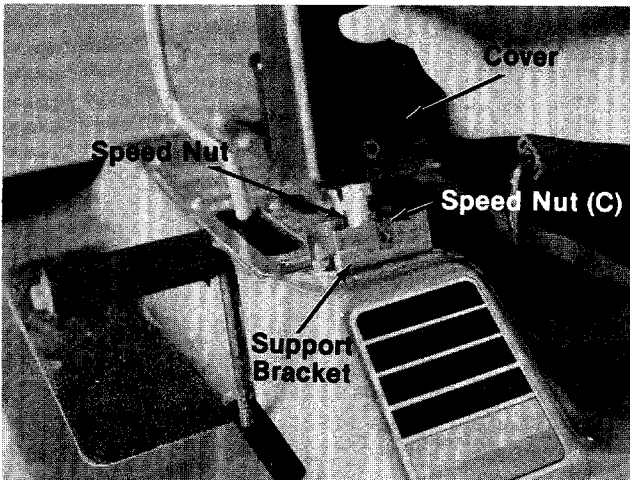

FIGURE 3.

5. Place two speed nuts (C) on support bracket as shown in figure 3. ←
6. Place the cover over the steering tube assembly. Line up holes in cover with speed nuts. See figure 3.

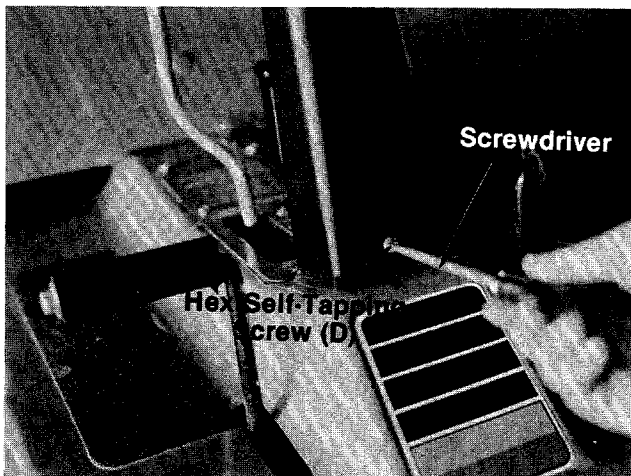

FIGURE 4.

7. Secure cover to support bracket with two self-tapping screws (D) provided. See figure 4. ←

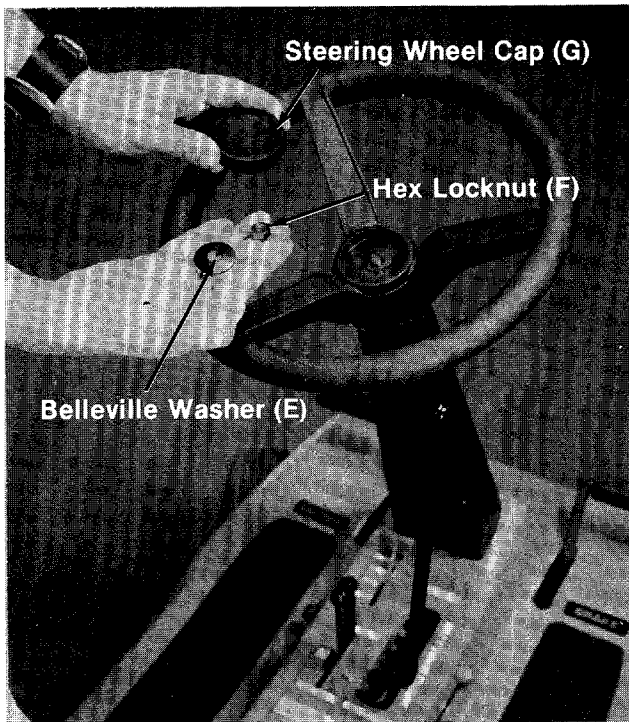

FIGURE 5.

8. Place the steering wheel on the tubing assembly and fasten with belleville washer (E) and hex lock nut (F). See figure 5. ←
9. Again, it may be necessary to raise the steering shaft assembly in order to put the hex lock nut on.
10. Place the steering wheel cap on by hand. See figure 5.

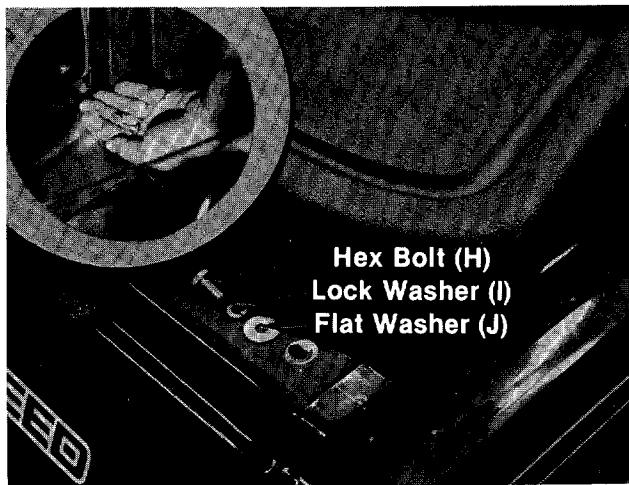

FIGURE 6.

SEAT ASSEMBLY

- To secure seat to cover assembly, place lock washer (I) and flat washers (J) on hex bolts (H). ← Line up the four holes in bottom of seat with four corresponding holes in cover. Then insert the four hex bolts up through holes, tightening with an adjustable wrench. See figure 6.

TIRE PRESSURE

FOR SHIPPING PURPOSES, THE TIRES ON YOUR UNIT MAY BE OVER-INFLATED. TIRE PRESSURE SHOULD BE REDUCED BEFORE UNIT IS PUT INTO OPERATION. PRESSURE SHOULD BE APPROXIMATELY 15 P.S.I. EQUAL TIRE PRESSURE SHOULD BE MAINTAINED ON ALL TIRES. MAXIMUM TIRE PRESSURE IS 30 P.S.I.



CAUTION

Installation of tire to rim:

1. Lubricate tire beads and rim flanges.
2. Do not exceed 30 P.S.I. when seating beads.
3. Adjust to recommended pressure after beads are sealed.

CONTROLS (See figures 7 and 10)

This manual should be read in its entirety before you operate your riding mower. The more you know and understand about the machine and its operation, the better job it will do for you. While reading the manual, compare the illustrations with your mower to familiarize yourself with the locations of various controls, lubrication points, attachments and adjustment features.

Study the operating instructions and safety precautions thoroughly to insure proper functioning of your mower and to prevent injury to yourself and others. Be sure to save this manual for future reference.

THROTTLE CONTROL

The throttle control is used to regulate the engine speed and to activate the choke on the engine. To get the maximum efficiency on cutting, the throttle should be in the "FAST" position when operating the mower. Pushing the throttle all the way forward, past "FAST", will choke the engine.

IGNITION KEY

The key must be turned to the "ON" position before the recoil handle is pulled to start the engine. Turn the key to the left (to the "OFF" position) to stop the engine. Remove the key when the mower is not in use.

LIFT AND DISENGAGEMENT LEVER

The lift and disengagement lever is used to raise and lower the cutting deck, set the cutting height, and disengage the cutting blades.

Move the lever to the right all the way back and lock it to disengage the blades. The lever may be set in any one of the five cutting height positions.



The lift and disengagement lever must be in the disengaged position when starting the engine and when shifting into reverse.

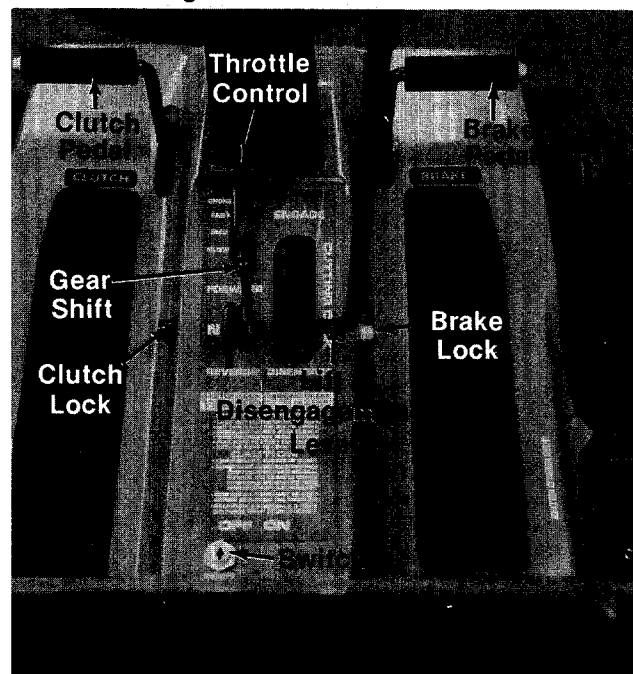

FIGURE 7. CONTROLS

INTERLOCKS (Not Shown)

An interlock safety switch is located on the clutch pedal and the lift and disengagement lever.

The clutch pedal must be depressed and locked and the lift and disengagement lever must be in the "DISENGAGED" position (all the way back) before the engine can be started. Failure to follow these instructions will prevent starting.

Before the unit can be shifted into reverse, the lift and disengagement lever must be in the disengaged position.

GEAR SHIFT LEVER

The gear shift lever has three positions, "FORWARD", "NEUTRAL" and "REVERSE." The clutch pedal must be depressed and the riding mower must not be moving when shifting gears. Do not force the shift lever. Release the clutch pedal slightly to line up the shifting collar in the transmission. Then try to shift gears.

BRAKE

To operate the brake, depress the right pedal all the way. To lock the brake in park position, depress the right pedal all the way and lift the brake lock. Pedal will stay in the depressed position. To release the parking brake, depress the pedal.

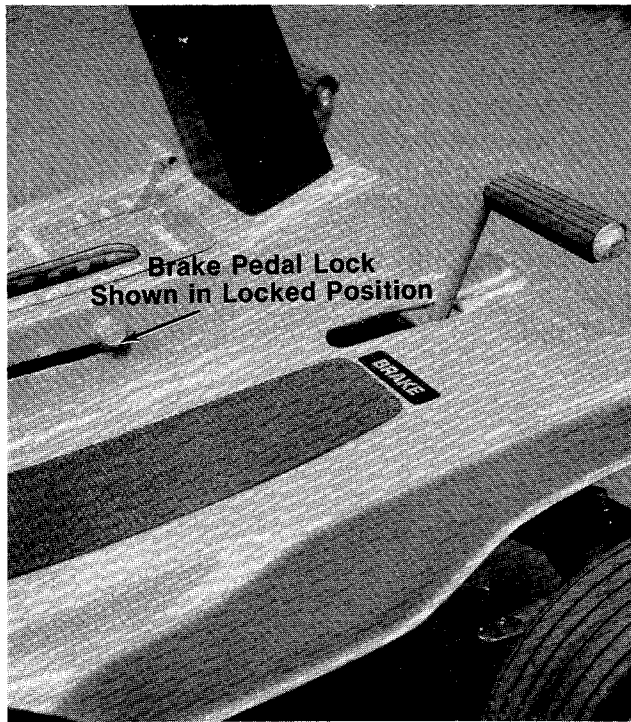

FIGURE 8. BRAKE PEDAL LOCK

CLUTCH PEDAL

The clutch pedal is located on the left side. When depressed, it disengages the engine from the transmission. It can be held in the disengaged position by lifting the clutch lock. To stop the mower, depress the clutch and brake pedals. See figure 9.

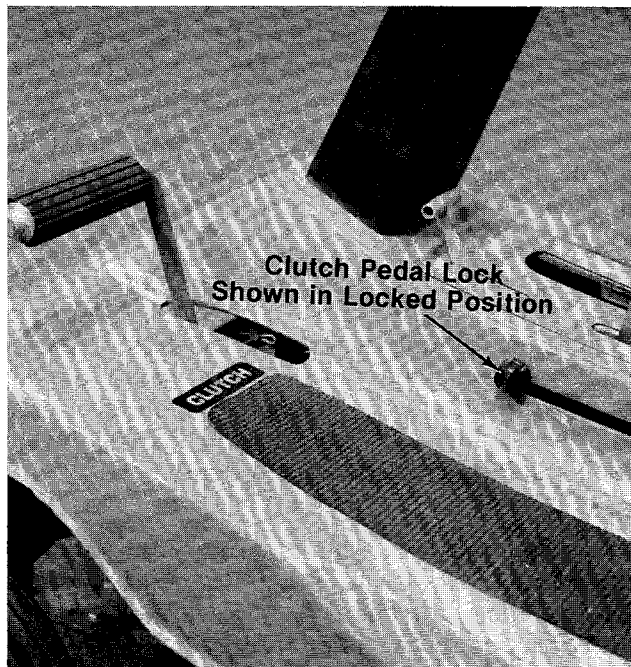

FIGURE 9. CLUTCH PEDAL LOCK



FIGURE 10. CONTROLS

OPERATION



CAUTION

1. Keep all shields in place.
2. Before leaving operator's position:
 - a. Shift transmission to neutral
 - b. Set parking brake
 - c. Disengage attachment clutch
 - d. Shut off engine
 - e. Remove ignition key
3. Wait for all movement to stop before servicing machine.
4. Keep people and pets a safe distance away from machine.
5. Look to the rear before backing up.

CAUTION

**DO NOT OPERATE
MOWER UNLESS
GUARD OR ENTIRE
GRASS CATCHER IS
IN ITS PROPER PLACE.**

STARTING THE ENGINE

1. Be sure the crankcase is filled with oil as recommended in the engine manual. Fill fuel tank with **regular** gasoline.
2. Attach the wire to the spark plug.
3. Depress the clutch pedal and lock it down.
4. Move the lift and disengagement lever back to the disengaged position and lock it.



NOTE

This unit is equipped with a safety interlock system for your protection. The purpose of the safety interlock system is to prevent the engine from cranking or starting unless the transmission is shifted into neutral and the blade disengagement lever is in the disengaged position. In addition, the lift and disengagement lever must be in the disengaged position when the unit is put into reverse or the engine will shut off.



WARNING

Do not operate the rider if the interlock system is malfunctioning because it is a safety device, designed for protection.

5. Set the throttle control lever in the "CHOKE" position.
6. Turn the ignition key to the "ON" position. Twist the recoil starter handle until it is free and pull it with a quick steady motion. After the engine starts, return the recoil starter handle. Twist it until it locks. See figures 11 and 12.



NOTE

If these instructions are not followed, the engine will stop running when the clutch or blades are engaged.

Slowly return the throttle to the running position as soon as the engine starts.

7. To stop, turn the ignition key to the "OFF" position. Remove the key when the rider is not in use.

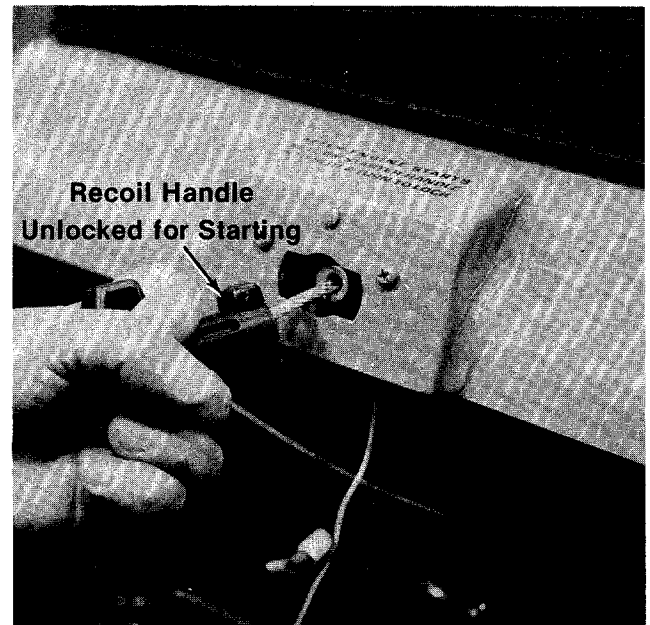

FIGURE 11. RECOIL HANDLE

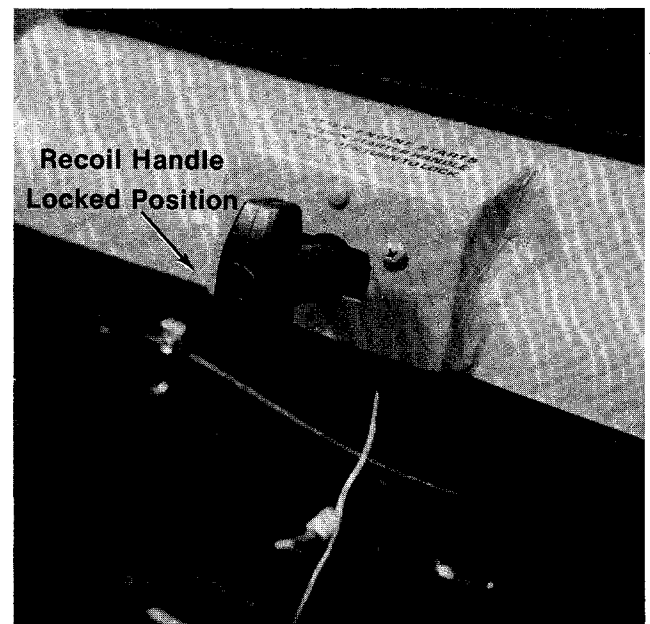

FIGURE 12. RECOIL HANDLE
PUTTING THE RIDING MOWER IN MOTION



CAUTION

Parking brake **must** be disengaged before unit is put into motion.

1. Advance the throttle control from $\frac{3}{4}$ to full throttle to prevent strain on the engine and to operate the cutting blades.
2. Place the gear shift lever in either the "FORWARD" or "REVERSE" position.
3. Slowly release the clutch pedal.

4. To stop, depress the clutch and the brake pedals.
5. The blades can be engaged either while moving or while standing still. Move the lift and disengagement lever forward slowly until the blades are running.

Be sure that lawn is clear of stones, sticks, wire, or other objects which could damage lawn mower or engine. For best results and to insure more even grass distribution, do not mow when lawn is excessively wet.



IMPORTANT

If you strike a foreign object, stop the engine. Remove wire from spark plug, thoroughly inspect the mower for any damage, and repair the damage before restarting and operating the mower.

STOPPING

Engine—Turn the ignition key to the left to the “OFF” position.

Rider—Depress the clutch and brake pedals.



NOTE

Unit is equipped with separate brake and clutch pedals. To stop, disengage the clutch when applying the brakes.

Blades—Pull the lift and disengagement lever all the way back and lock it.

GRASS CATCHER Model 015 is available as optional equipment for the mowers shown in this manual.



WARNING

The mower should not be operated without the entire grass catcher or chute deflector in place.



NOTE

Under normal usage bag material is subject to wear, and should be checked periodically. Be sure any replacement bag complies with the mower manufacturer’s recommendations.

For replacement bags, use only factory authorized replacement bag No. 764-0121.

ADJUSTMENTS



CAUTION

Do not at any time make any adjustment to lawn mower without first stopping engine and disconnecting spark plug wire.

THROTTLE CONTROL

To Check Operation:

1. Remove air cleaner.
2. Move throttle control lever to “CHOKE” position. The carburetor choke should be closed.
3. Move throttle control lever to “STOP” position. Lever should make good contact with stop switch.

To Adjust: (See Figure 13)

Place remote control lever on equipment in “FAST” (high speed) position.

Lever C on carburetor should be just touching choke arm at D. To adjust, loosen casing clamp screw A on blower housing. Move control casing B forward or backward until correct position is obtained. Tighten screw A.

Recheck operation of controls after adjustment. Replace air cleaner.

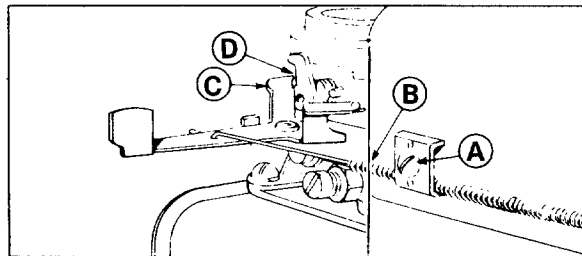

FIGURE 13. THROTTLE CONTROL ADJUSTMENT
CARBURETOR ADJUSTMENTS



WARNING

If any adjustments are made to the engine while the engine is running (e.g. carburetor), disengage all clutches and blades. Keep clear of all moving parts. Be careful of heated surfaces and muffler.

Minor carburetor adjustment may be required to compensate for differences in fuel, temperature, altitude and load.

Refer to the separate engine manual packed with your unit for carburetor adjustment information.

CHAIN ADJUSTMENT (See Figure 14)

After the first five hours of operation the initial slack should be removed from the chain. The chain should be tight enough so that it deflects approximately 1/2" when it is depressed with the thumb.

To Adjust:

The adjusting bolt is located under the frame, above the cutting deck on the right side of the mower.

Turn the adjusting bolt clockwise with an open end wrench until the chain reaches the proper tension.



If the transmission mounting plate will not slide forward to adjust the chain tension, it may be necessary to loosen the four nuts mounting the transmission to the frame.

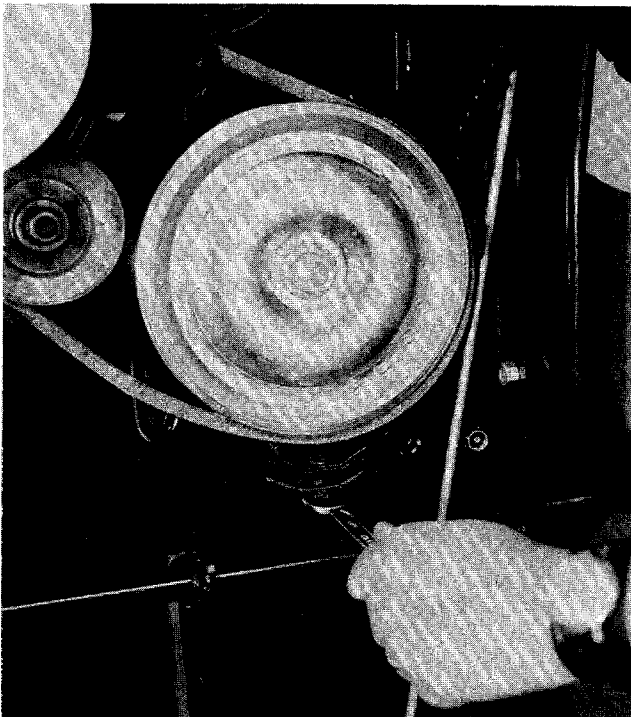

FIGURE 14. CHAIN ADJUSTMENT



Deck was removed for photographing.

BRAKE ADJUSTMENTS (See Figure 15)

During normal operation of this machine, the brakes are subject to wear and will require periodic examination and adjustment.

The brake is located by the right rear wheel inside the frame.

To adjust the brake, tighten the lock nut one-half turn and then test the brake.

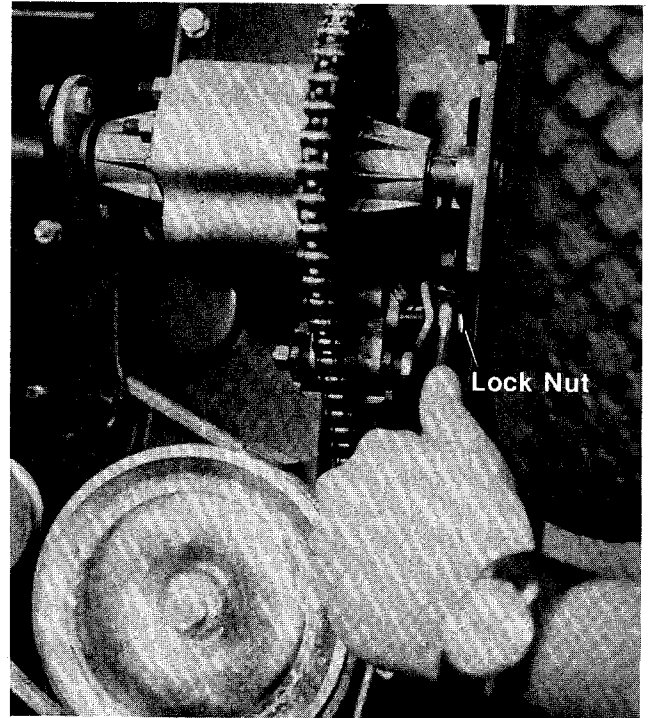

FIGURE 15. BRAKE ADJUSTMENT



Deck was removed for photographing.

LUBRICATION (See Figure 16)



Always stop engine and disconnect spark plug wire before cleaning, lubricating or doing any kind of work on lawn mower.

1. **Engine.** Maintain the engine oil according to the engine manual.
2. **Bearings.** The following bearings are oil impregnated and do not require lubrication. However, their normal life can be extended by lubricating them once a season with a light, non-detergent oil. A 4 oz. plastic bottle of light oil lubricant is available. Order part number 737-0170. Engine oil may also be used.
 - a. King Pin Bearings (total 4 bearings)
 - b. Rear Axle Bearings (total 3 bearings)
 - c. Front Wheel Bearings (total 4 bearings)

3. **Throttle Control and Cable.** Wipe oiled rag along entire length of cable.
4. **Chain.** Wipe oiled rag along entire length of chain.



Under extremely dusty conditions do not oil the chain.

5. **Linkage.** Oil all deck linkage and height adjustment linkage.
6. **Transmission.** Lubricated at the factory, does not require checking. Lubricate with 4 oz. of Lubriplate No. 310 if disassembled.
7. **Differential.** Lubricated at the factory, does not require checking. Lubricate with 3 oz. of High Temp. grease, Plastilube #0, if disassembled. If ordered from the factory, order part number 737-0166.
8. **Steering.** Lubricate at least once a season with oil.

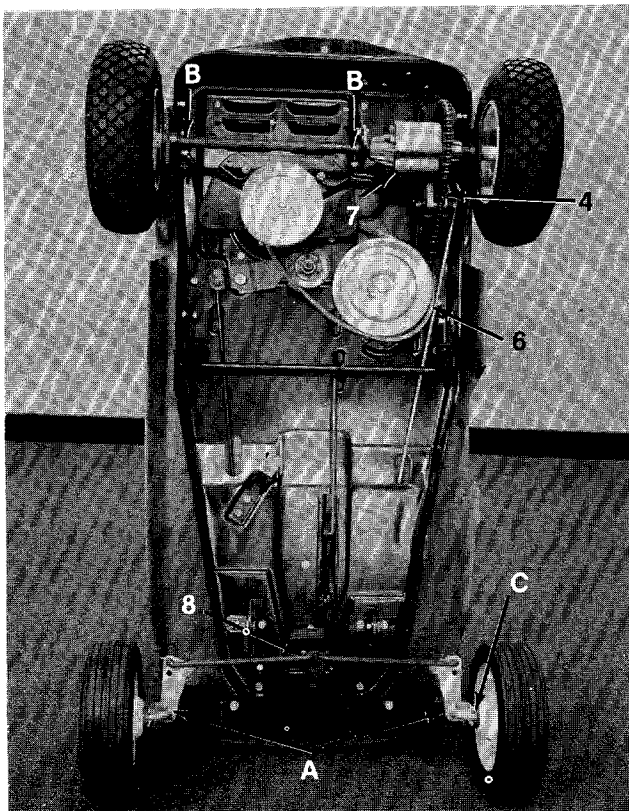

FIGURE 16. LUBRICATION POINTS

MAINTENANCE

CUTTING BLADE

A. Removal for Sharpening or Replacement



Be sure to disconnect and ground the spark plug wire before working on the cutting blade to prevent accidental engine starting.

1. Remove the large bolt and lock washer which holds the blade and adapter to the blade spindle.
2. Remove the blade and adapter from the spindle. Be careful not to lose the key on the spindle.
3. If the blade or blade adapter needs replacing, remove the two small bolts, lock washers and nuts which hold the blade to the adapter.

B. Sharpening

Remove the cutting blade by following the directions of the preceding section.

When sharpening the blade, follow the original angle of grind as a guide. It is **extremely important** that each cutting edge receives an equal amount of grinding to prevent an unbalanced blade. An unbalanced blade will cause excessive vibration when rotating at high speeds, may cause damage to the mower and could break, causing personal injury.

The blade can be tested for balance by balancing it on a round shaft screwdriver. Remove metal from the heavy side until it balances evenly.



It is recommended that the blade always be removed from the adapter for the best test of balance.

C. Reassembly

Before reassembling the blade and the blade adapter to the unit, lubricate the engine spindle and the inner surface of the blade adapter with light oil. Lubricating the bolt holes, bolts and inner surface of the nuts with light oil is also recommended. A 4 oz. plastic bottle of light oil lubricant is available. Order part number 737-0170. Engine oil may also be used.

When replacing the blade, be sure to install the blade with the side of the blade marked "Bottom" (or with part number) facing the ground when the mower is in the operating position. Make certain key is in place on the blade spindle.

Blade Mounting Torque

3/8" Dia. Bolt 375 in. lb. min., 450 in. lb. max.
5/16" Dia. Bolt 150 in. lb. min., 250 in. lb. max.

MOWER DECK

The underside of the mower deck should be cleaned after each period of use as grass clippings, leaves, dirt and other matter will accumulate. This accumulation of grass clippings, etc., is undesirable as it will invite rust and corrosion and may cause an uneven discharge of grass clippings at the next mowing.

The deck may be cleaned by tilting the mower on its front wheels until the frame and the steering wheel supports the entire unit. Scrape clean with a suitable tool or by washing with a stream of water from a garden hose. Be sure to disconnect the spark plug wire and ground it while performing this maintenance.



NOTE

To insure safe operation, ALL nuts and bolts must be checked periodically for correct tightness.

ENGINE OIL

Check oil level before starting engine and after every 5 hours of operation or each period of use. ADD oil as necessary to keep level FULL TO POINT OF OVERFLOWING. Engine should be in a level position when checking oil.

Change oil after first 5 hours of operation. Thereafter change every 25 hours. Change oil while engine is warm. Oil capacity 1¾ pints.

AIR CLEANER

Service air cleaner every 25 hours under normal conditions. Clean every few hours under extremely dusty conditions. Poor engine performance and flooding usually indicates that the air cleaner should be serviced.

To service air cleaner, refer to the separate engine manual packed with your unit.

SPARK PLUG

The spark plug should be cleaned and the gap reset once a season. Spark plug replacement is recommended at the start of each mowing season; check engine manual for correct plug type and gap specifications.

BELT REMOVAL AND REPLACEMENT

Preparation

1. To prevent gasoline from leaking from the engine, remove the fuel tank cap. Place a piece of thin plastic over the neck of the fuel tank and screw on the cap.
2. Disconnect the spark plug wire and ground it against the engine.
3. Tip the rider up on its front wheels and let it rest on the steering wheel.

To Remove the Deck Belt:

1. Put the lift and disengagement lever into the ENGAGED position.
2. Remove two belt keepers at the engine pulley. See figure 17.

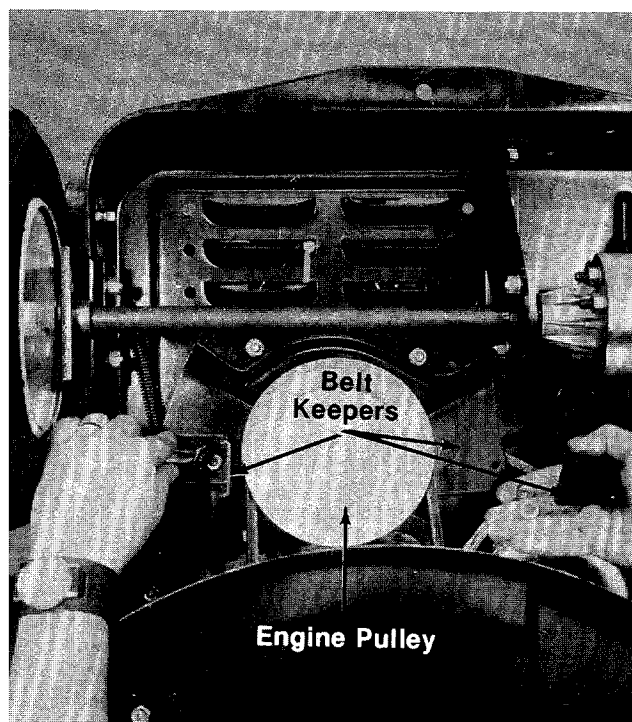

FIGURE 17. REMOVAL OF BELT KEEPERS

3. Remove two belt keepers at the deck pulley and shoulder bolt. See figures 18 and 19.
4. DISENGAGE the deck and move the deck towards the engine pulley by hand. Then unhook the belt from the engine pulley.
5. ENGAGE the deck and remove the belt.

To Remove the Drive Belt:

1. Remove the two belt keepers at the engine pulley. DISENGAGE the deck and remove the belt.
2. ENGAGE the deck and unhook the deck springs.



CAUTION

Deck will drop when last bolt is removed in step 3.

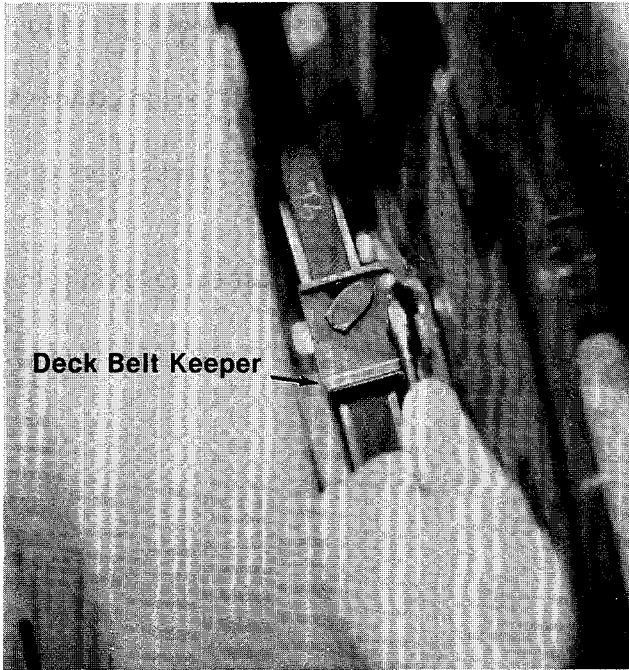

Deck Belt Keeper

FIGURE 18. REMOVAL OF DECK BELT KEEPERS

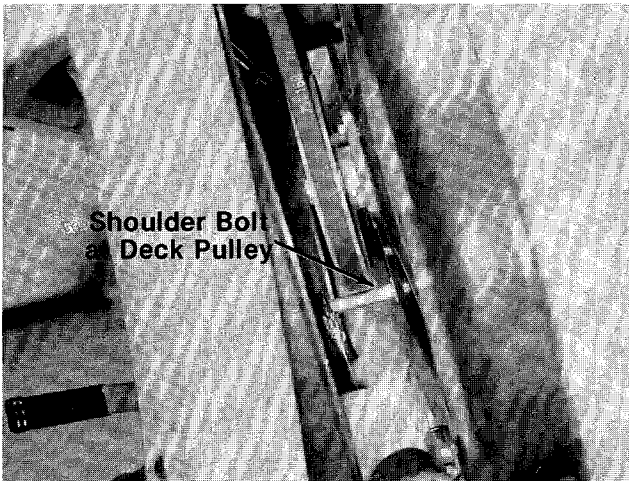

Shoulder Bolt at Deck Pulley

FIGURE 19. SHOULDER BOLT REMOVAL

3. Remove six hex screws, nuts and lock washers holding the deck. See figure 20.
4. Remove the belt guard at the engine pulley. See figure 21.
5. Remove the nut and lock washers at the idler pulley. See figure 21.
6. Remove the hex nut and lock washer at the transmission pulley. See figure 21.
7. Slide the idler pulley off the idler bracket, which relieves the tension on the belt.

8. Remove the transmission pulley along with the belt. Assemble in reverse order.



NOTE

Be sure all belts are properly aligned, and that all nuts and bolts are tight before unit is put back into operation.



NOTE

When reassembling the transmission pulley, place hub side up.

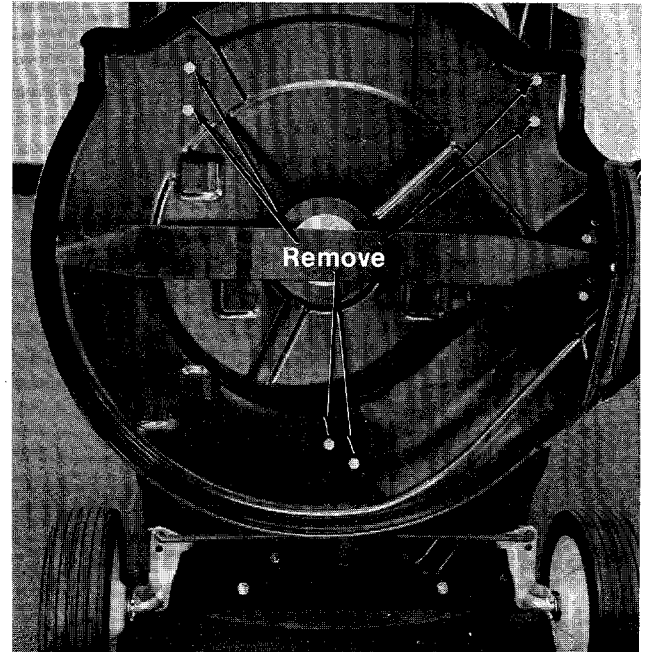

Remove

FIGURE 20. DECK REMOVAL

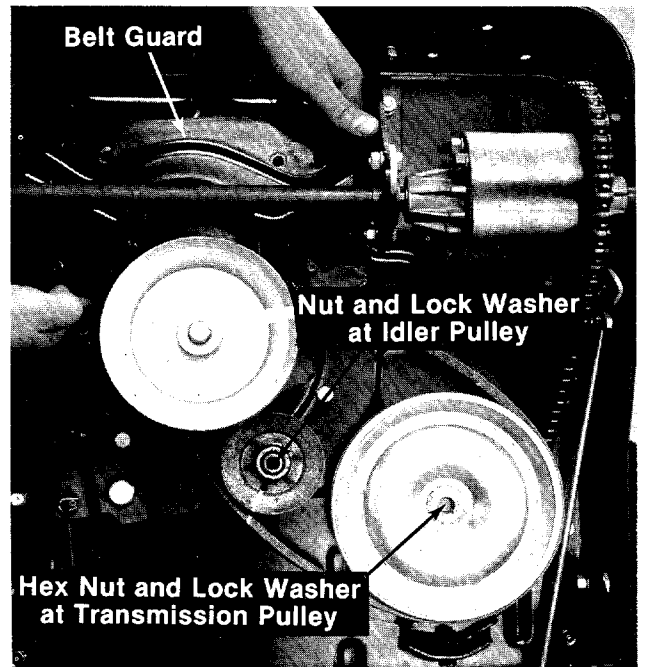

Belt Guard

Nut and Lock Washer at Idler Pulley

Hex Nut and Lock Washer at Transmission Pulley

FIGURE 21. ENGINE BELT GUARD REMOVAL

OFF-SEASON STORAGE



NOTE

Engines to be stored over 30 days should be completely drained of fuel to prevent gum deposits forming on essential carburetor parts, fuel filters, fuel lines and tank.

1. Remove all fuel from fuel tank. Run the engine until it stops from lack of fuel. The small amount of fuel that remains in the sump of the tank should then be removed by absorbing it with a clean, dry cloth.
2. While engine is still warm, drain oil from crankcase. Refill with fresh oil.
3. Remove spark plug, pour 1 ounce of SAE 30 oil into cylinder and crank slowly to distribute oil. To prevent accidental starting, DO NOT replace the spark plug.
4. Clean dirt and chaff from cylinder, cylinder head fins and blower housing.
5. Clean all grass from underside of deck.
6. Clean the air filter.
7. Place blocks under frame of mower so that the wheels are off the ground.
8. Cover all bare metal parts, such as the mowing edge of the blades, with grease to prevent rusting.
9. Cover the mower with a tarpaulin or other protective covering.

TROUBLE SHOOTING CHART FOR RECOIL START MODELS

CAUTION: ALWAYS DISCONNECT SPARK PLUG BEFORE ATTEMPTING ANY REMEDY.

TROUBLE	LOOK FOR	REMEDY
Engine will not start when recoil handle is pulled.	Clutch and blade not disengaged.	Clutch pedal must be depressed and blade must be shut off.
	Ignition key not in the ON position.	Turn on the ignition key.
	Throttle not in the starting position.	Check owner's guide for correct position for throttle control for starting.
	No spark to spark plug.	Spark plug lead disconnected. Connect lead. Hold spark plug lead away from engine block about 1/8". Crank engine. There should be a spark. If not, have the engine repaired at authorized engine service dealer. Faulty spark plug. To test, remove spark plug. Attach spark plug lead to spark plug. Ground spark plug body against the engine block. Crank the engine. The spark plug should fire at the electrode. Replace if it does not.
	No fuel to the carburetor.	Gasoline tank empty. Fill. Fuel valve shut off. Open valve. Valve is located either at the bottom of the fuel tank or on the carburetor. Fuel line is plugged. Remove and clean.
	Air filter dirty.	If the air cleaner is dirty, the engine may not start. Clean or replace as recommended by the engine manufacturer.
	Mechanical failure (wires or switch).	The interlock system includes two mechanical activated switches which are wired in parallel. If the buttons on both switches are not depressed at least 1/8", the magneto will be grounded and the engine will not start. While testing the interlock system, you will make the mower temporarily unsafe by permitting the engine to be started with the blade and clutch engaged. WARNING: While testing, disengage the clutch, shut off the blade control, set the parking brake and place the gear shift lever in neutral. Disconnect the yellow wire where it attaches to the primary wire from the breaker assembly on the engine. Try to start the engine. If the engine does not start , the problem is in the engine (e.g. no fuel or no ignition). If the engine does start the problem is in the safety system. Check the following: 1. The interlock wire may be grounded by being pinched or rubbing through the insulation. Tape or replace the wire. 2. The bolt on the flat spring behind the recoil starter where the yellow wire attaches must be insulated from the spring. Use a continuity tester. If it is not insulated, remove the bolt and nut, and replace the two fiber washers and reassemble.
Engine stops when the mower blade is engaged or the clutch is released.	Recoil handle is not in proper position.	After the engine starts, the recoil starter handle must be pushed into the dashboard and turned a quarter turn either direction to lock it in place.
Engine smokes.	Engine loses crankcase vacuum.	Dipstick not seated or broken. Replace defective part. Engine breather defective. Replace.
Excessive vibration	Bent or damaged blade spindle	Stop engine immediately. Check all pulleys, blade spindles, blade adapters, keys and bolts for tightness or damage. Tighten or replace any damaged parts.
	Bent blade.	Stop engine immediately. Replace damaged blade. Only use original equipment blades.
Mower will not discharge grass or leaves uncut strips.	Engine speed too low.	Throttle must be set between 3/4 and full throttle.
	Transmission selection.	Use lower transmission gear. The slower your ground speed, the better the quality of cut.
	Blades short or dull.	Sharpen or replace blades (uncut strip problem only).

NOTES

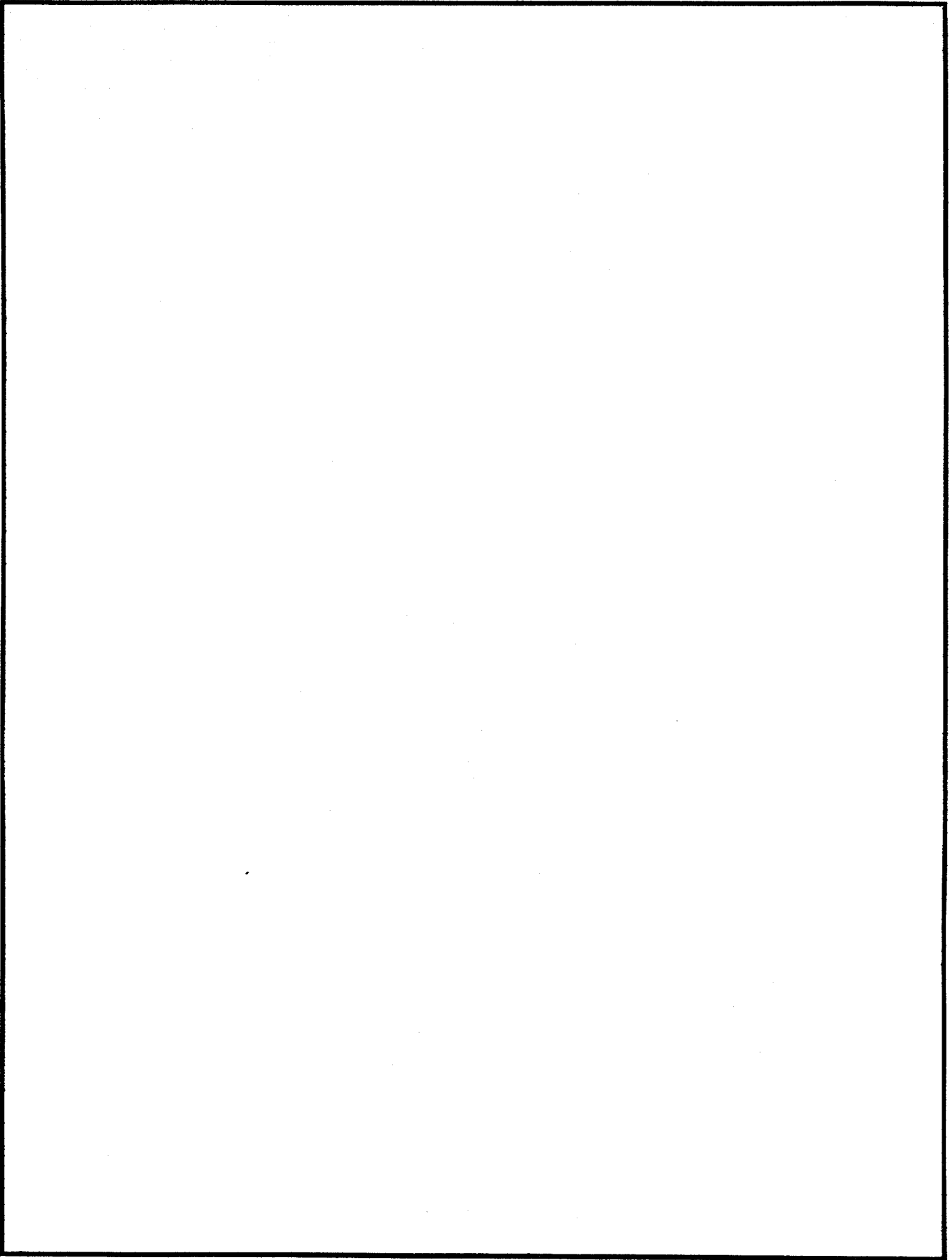

Model 400

IF YOU WRITE TO US ABOUT THIS ARTICLE
OR IF YOU ORDER REPLACEMENT PARTS AL-
WAYS MENTION THIS MODEL & SERIAL NO
MODEL

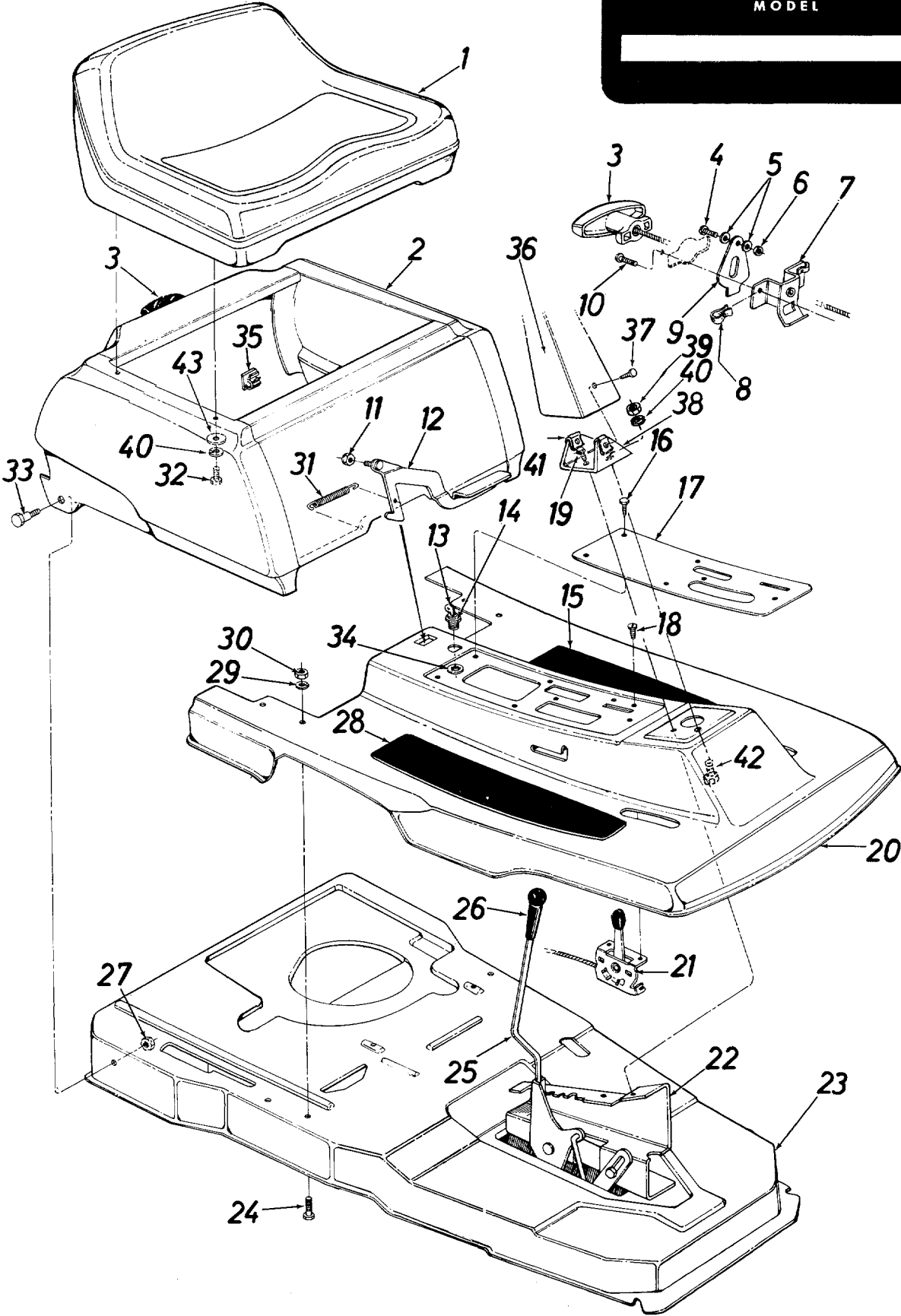

Model 400

PARTS LIST FOR MODEL 400 RIDING MOWER

REF. NO.	PART NO.	COLOR CODE	DESCRIPTION	NEW PART	REF. NO.	PART NO.	COLOR CODE	DESCRIPTION	NEW PART
1	757-0265		Seat Comp.		21	746-0239		Throttle Control Ass'y.	
2	12131	—486	Cover Ass'y.		22	12150		Index and Support Brkt.	
3	11263		Plastic Handle		23	12125		Main Frame	
4	710-0425		Truss Mach. Scr. #10-24 .62" Lg.*		24	710-0198		Hex Sems Scr. 5/16-18 x .75" Lg.*	
5	736-0338		Fiber Washer		25	12142		Deck Lift Handle Ass'y.	
6	712-0121		Hex Nut #10-24 Thd.		26	720-0143		Grip	
7	11053		Switch Brkt. Ass'y.		27	712-0158		Hex Cent. L-Nut 5/16-18 Thd.	
8	712-0344		Speed Nut #10Z		28	723-0241		Foot Pad	
9	732-0257		Switch Spring		29	736-0119		L-Wash. 5/16" Scr.*	
10	710-0351		Truss Mach. B-Tap Scr. #10 x .50" Lg.*		30	712-0267		Hex Nut 5/16-18 Thd.	
11	712-0429		Hex Ins. L-Nut 5/16-18 Thd.		31	732-0118		Extension Spring	
12	12144		Latch—Engine Cover		32	710-0289		Hex Scr. 1/4-20 x .50" Lg.*	
13	725-0201		Ignition Key		33	738-0155		Shld. Scr. .437 Dia. x .162	
14	725-0464		Ignition Switch		34	736-0225		Internal L-Wash. 5/8 I.D.	
15	723-0241		Foot Pad		35	726-0141		Adjustment Clamp	
16	710-0456		Hex Drilling Scr. #10 x .50" Lg.*		36	731-0262		Cover—Steering Column	
17	12175		Cover Plate		37	710-0224		AB Tap Scr. #10 x .50" Lg.	
18	710-0227		Hex Wash. Hd. AB Tap Scr. #8 x .50" Lg.		38	13912		Support Brkt.	
19	710-0456		Hex Drilling Scr. #10 x .50" Lg.*		39	712-0287		Hex Nut 1/4-20 Thd.*	
20	14403	—486	Floor Pan		40	736-0329		L-Wash. 1/4" Scr.*	
					41	712-0147		Speed Nut #10-24 Thd.	
					42	710-0252		Hex Scr. 1/4-20 x .75" Lg.*	
					43	736-0173		Flat Washer	

*For faster service obtain standard nuts, bolts and washers locally. If these items cannot be obtained locally, order by part number and size as shown on parts list.

(486—Star Orange)

When ordering parts, if color or finish is important, use the appropriate color code shown above. (e.g. Star Orange Finish—12131 (486).)



NOTE

This instruction manual covers various models and all specifications shown do not necessarily apply to your model. Specifications subject to change without notice or obligation.

NOTE: The engine is not under warranty by the mower manufacturer... If repairs or service is needed on the engine, please contact your nearest authorized engine service outlet. Check the "Yellow Pages" of your telephone book under "Engines—Gasoline."



Model 400

NOTE: If for any reason Disc Brake is disassembled, be sure round end of push pins (Ref. No. 18) is toward the cam lever (Ref. No. 86).

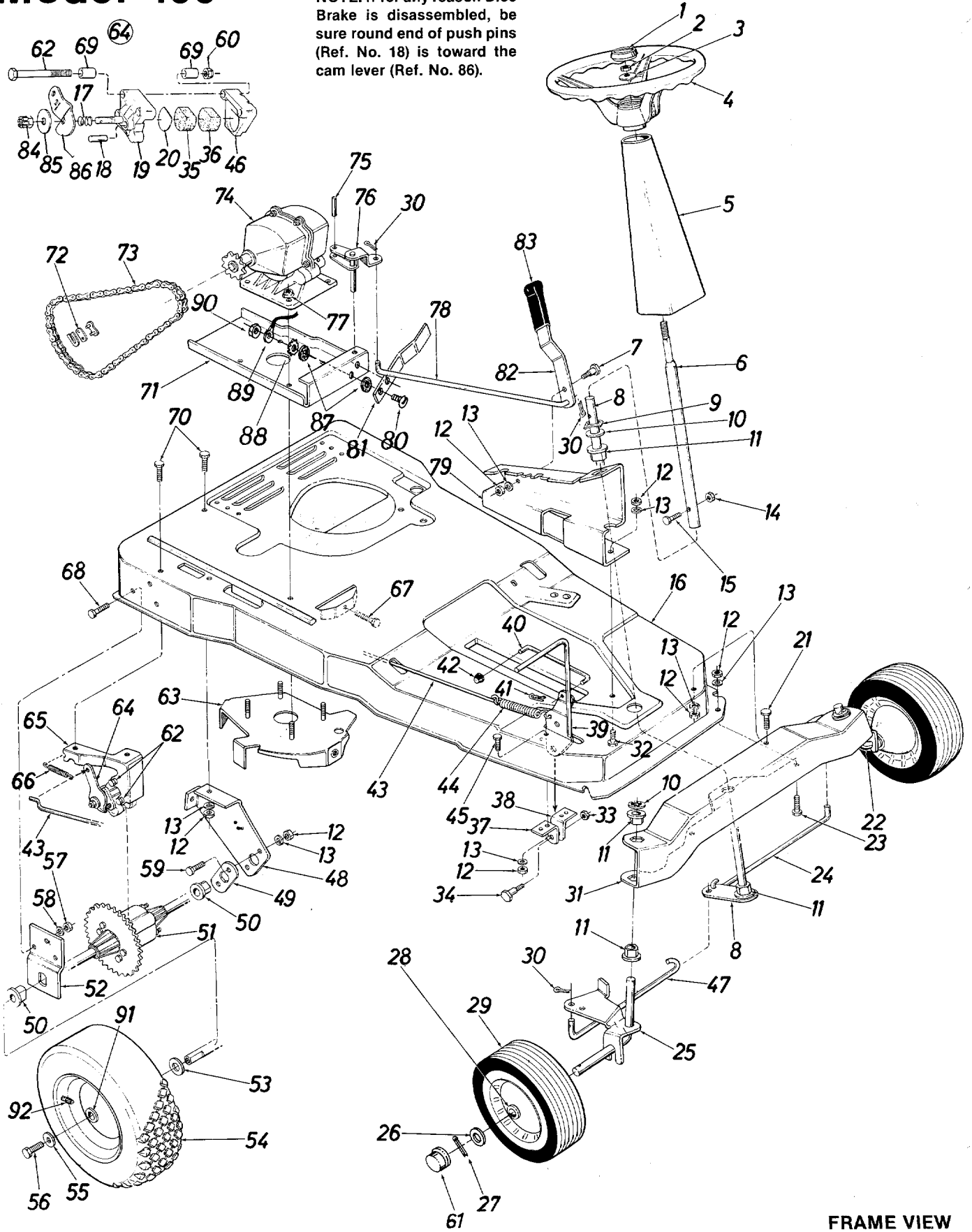

FRAME VIEW

Model 400

PARTS LIST FOR MODEL 400 RIDING MOWER

REF. NO.	PART NO.	COLOR CODE	DESCRIPTION	NEW PART	REF. NO.	PART NO.	COLOR CODE	DESCRIPTION	NEW PART
1	731-0220		Steering Wheel Cap		47	747-0146		Tie Rod 3/8" Dia.—R.H.	
2	712-0158		Hex Cent. L-Nut 5/16-18 Thd.*		48	12147		Rear Axle Support Brkt.	
3	736-0242		Belleville Wash.		49	10470		Bearing—Plate	
4	731-0219		Steering Wheel Ass'y.		50	741-0199		Plastic Flange Brg. w/Flats .753 I.D.	
5	731-0262		Cover—Steering Column		51	717-0320		Differential Ass'y.—Comp.	
6	750-0233		Steering Tube Ass'y.		52	12148		Axle Brkt.	
7	738-0140		Shld. Scr. .437 Dia. x .180" Lg.		53	736-0134		Fl-Wash. .812 I.D. x 1.38 O.D.	
8	12138		Steering Shaft Ass'y.		54	734-0522		Wheel Ass'y.—Comp. Rear 12.2 x 3.7	
9	712-0222		Push Speed Nut .62 Dia.			734-0301		Tire Only	
10	726-0159		Push Nut .625" Shaft			734-0517		Rim Only	
11	741-0225		Hex Flange Brg. .630 I.D.		55	736-0105		Belleville Wash. .400 I.D. x .88 O.D.	
12	712-0267		Hex Nut 5/16-18 Thd.*		56	710-0627		Scr. 5/16-24 x .75" Lg. Gr. 5	
13	736-0119		L-Wash. 5/16" Scr.*		57	736-0119		L-Wash. 5/16" Scr.*	
14	712-0107		Hex Cent. L-Nut 1/4-20 Thd.		58	712-0267		Hex Nut 5/16-18 Thd.*	
15	710-0106		Hex Scr. 1/4-20 x 1.25" Lg.		59	710-0198		Hex Sems Scr. 5/16-18 x .75" Lg.*	
16	12125 —452		Main Frame		60	712-0158		Hex Cent. L-Nut 5/16-18 Thd.	
17	HH-06-03031		Spring—Compres. .350" Dia. x 4 Coils		61	731-0484		Hub Cap	
18	HH-05-03034		Push Pin .309" Dia. x .857"		62	710-0378		Hex Scr. 5/16-18 x 2.50" Lg.*	
19	HH-12-03292		Casting—Cam		63	10086		Belt Guard Ass'y.—Trans.	
20	HH-03-03303		Back Up Wash. 1.115" Dia. x .018 Thk. (D-Shaped)		64	761-0130		Disc Brake Ass'y.—Comp.	
21	710-0198		Hex Sems Scr. 5/16-18 x .75" Lg.*		65	12145		Brake Brkt. Ass'y.	
22	14455		Axle Ass'y.—Front—L.H.		66	732-0118		Ext. Spring	
23	710-0198		Hex Sems Scr. 5/16-18 x .75" Lg.*		67	710-0117		Hex Scr. 5/16-24 x 1.00" Lg. H.T.	
24	747-0147		Tie Rod 3/8" Dia. L.H.		68	710-0198		Hex Sems Scr. 5/16-18 x .75" Lg.*	
25	14454		Axle Ass'y.—Front—R.H.		69	761-0133		Spacer for Disc Brake	
26	736-0285		Fl-Wash. .63" x 1.62" x .062"		70	710-0198		Hex Sems Scr. 5/16-18 x .75" Lg.*	
27	714-0470		Cotter Pin 1/8" x 1 1/4" Lg.		71	10247		Transmission Plate	
28	748-0146		Flange Brg. w/Flats .630 I.D.		72	713-0723		#41 Master Link 1/2" Pitch Type II	
29	734-0510		Wheel Ass'y.—Front 10.25 x 3.25		73	713-0190		#41 Chain 1/2" Pitch x 71 Links	
30	714-0507		Cotter Pin 3/32" Dia. x .75" Lg.*		74	717-0223		Single Spd. Trans.—Comp.	
31	12151		Front Wheel Brkt.		75	715-0103		Spring Pin Roll 1/8 x .75" Lg.	
32	710-0198		Hex Sems Scr. 5/16-18 x .75" Lg.*		76	12170		Shift Brkt. Ass'y.	
33	712-0375		Hex Cent. L-Nut 3/8-16 Thd.		77	712-0429		Hex Ins. L-Nut 5/16-18 Thd.	
34	738-0234		Shld. Scr. .500" Dia. x .295" Lg.		78	747-0136		Shiff Rod	
35	HH-15-02124		Pad—Friction (D-Shaped) 1.110" Dia. x .472 Thk.		79	12150		Index and Support Brkt.	
36	HH-15-03149		Pad—Friction (D-Shaped) 1.110" Dia. x .245 Thk.		80	710-0473		Truss Mach. Scr. #10-24 x .50" Lg.*	
37	12155		Pedal Pivot Brkt. w/1/2" Hole		81	732-0420		Spring Switch	N
38	12156		Pedal Pivot Brkt. w/3/8" Hole		82	12169		Shift Lever	
39	12136		Brake Pedal Ass'y.		83	720-0142		Grip—Flat Bar Type	
40	12419		Pedal Lockout Rod 5/16"		84	712-0134		Hex Top L-Nut 5/16-24 Thd.	
41	714-0104		Int. Cotter Pin 5/16" Dia.*		85	HH-03-03032		Wash. .349 I.D. x 1.004 O.D. x .066 Thk.	
42	726-0109		Push Cap—.312 I.D.		86	HH-18-03493		Cam Lever 22°	
43	747-0128		Brake Rod 1/4" Dia. x 25.25" Lg.		87	736-0338		Fiber Washer	
44	732-0245		Brake Spring		88	736-0147		Ext. L-Wash. #10 I.D.	
45	710-0198		Hex Sems Scr. 5/16-18 x .75" Lg.*		89	725-0829		Wire Harness	N
46	HH-12-03293		Casting—Carrier		90	712-0121		Hex Nut #10-24 Thd.*	
					91	741-0199		Rear Wheel Bearing	
					92	734-0255		Air Valve	

*For faster service obtain standard nuts, bolts and washers locally. If these items cannot be obtained locally, order by part number and size as shown on parts list.

Model 400

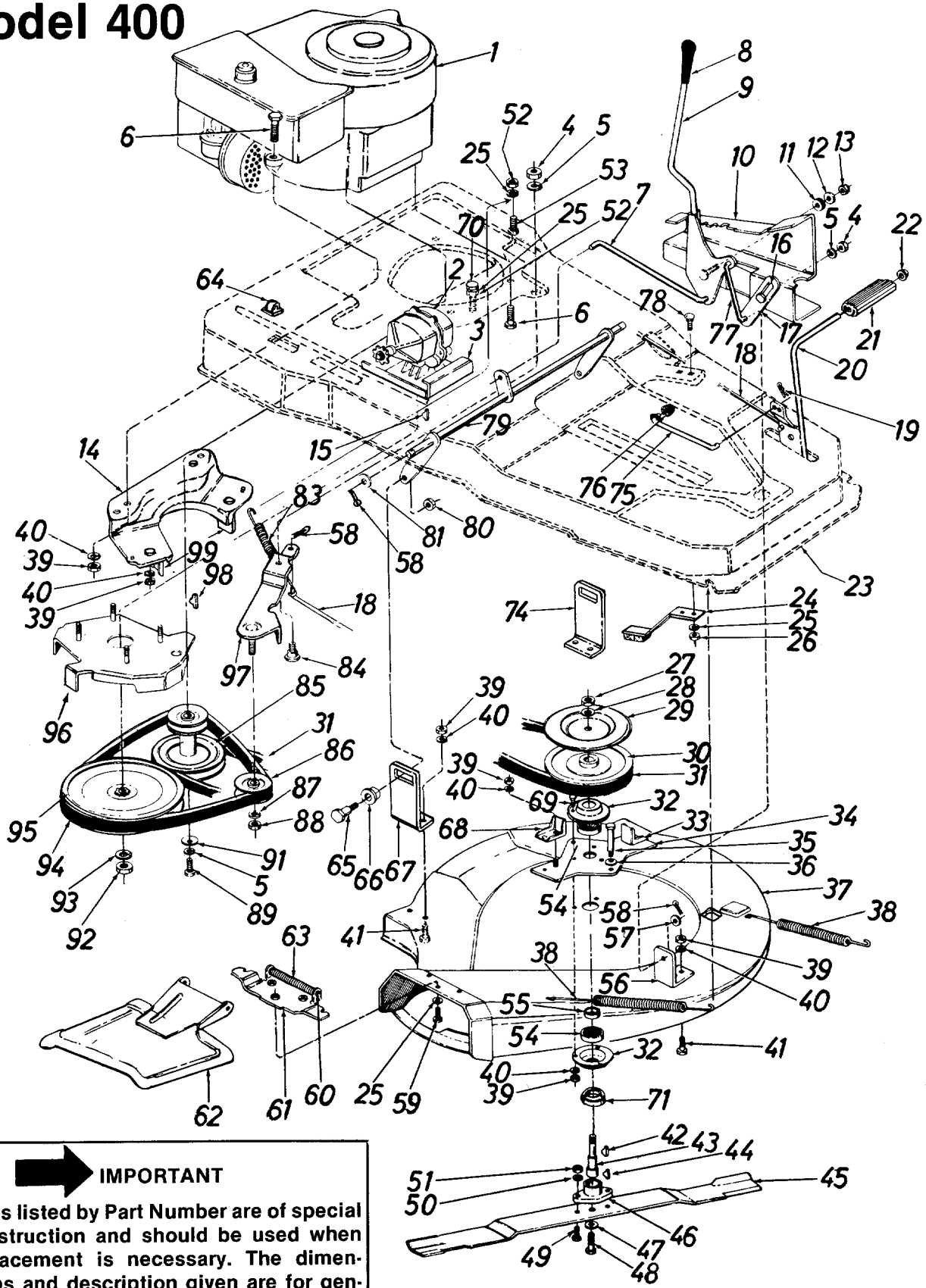

➔ IMPORTANT

Belts listed by Part Number are of special construction and should be used when replacement is necessary. The dimensions and description given are for general reference only and belts purchased by description and dimension generally will only provide temporary service.

Model 400

PARTS LIST FOR MODEL 400 RIDING MOWER

REF. NO.	PART NO.	COLOR CODE	DESCRIPTION	NEW PART	REF. NO.	PART NO.	COLOR CODE	DESCRIPTION	NEW PART
1	—		Engine		49	710-0117		Hex Scr. 5/16-24 x 1.00" Lg. H.T.	
2	717-0223		Trans. Ass'y.—Comp.						
3	10247		Trans. Plate		50	736-0119		L-Wash. 5/16" Scr.*	
4	712-0798		Hex Nut 3/8-16 Thd.*		51	712-0123		Hex Nut 5/16-24 Thd.*	
5	736-0217		L-Wash. 3/8" Scr. H.D.		52	712-0138		Hex Nut 1/4-28 Thd.*	
6	710-0442		Hex Scr. 5/16-18 x 1.50" Lg.*		53	710-0559		Hex Scr. 1/4-28 x 1.75" Lg.*	
7	747-0127		Lift Handle Rod 3/8" Dia.		54	741-0919		Ball Bearing	
8	720-0143		Grip		55	750-0142		Spacer	
9	12142		Deck Lift Handle Ass'y.		56	12153		Front Deck Brkt.	
0	12150		Index and Support Brkt.		57	736-0185		Fl-Wash. .406 I.D. x .734 O.D. x .063*	
1	735-0126		Rubber Washer						
2	736-0101		Fl-Wash. .406 I.D. x 1.00 O.D. x .030		58	714-0507		Cot. Pin 3/32 Dia. x .75" Lg.	
3	712-0112		Hex Nut #6-32 Thd.*		59	710-0195		Hex Scr. 1/4-28 x .62	
4	10423		Belt Guard—Cup Ass'y.		60	726-0166		Push Cap 1/4" Dia.	
5	714-0129		#4 Hi-Pro Key 3/32 x 5/8" Dia.		61	11399		Adapter Ass'y.	
6	738-0183		Shoulder Scr.		62	11634		Chute Cover Ass'y.—Comp.	
7	12152		Deck Hanger Link		63	732-0261		Torsion Spring	
8	747-0132		Clutch Rod		64	726-0141		Adjustment Clamp	
9	714-0104		Hairpin Cotter		65	738-0141		Shld. Scr. .437 Dia. x .350	
10	12133		Clutch Pedal Ass'y.		66	748-0180		Pivot Slide	
11	731-0142		Foot Pedal Bar		67	12154		Rear Deck Brkt.	
12	726-0221		Push Cap 1/2" I.D.		68	10426		Belt Keeper Ass'y.	
13	12125		Main Frame		69	710-0322		Hex Sems Scr. 5/16-18 x 1.00" Lg.*	
14	761-0148		Blade Brake Ass'y. 1.38		70	710-0299		Hex Scr. 1/4-28 x 1.00" Lg.*	
15	736-0329		L-Wash. 1/4" Scr.*		71	13703		Bearing Shield	
16	712-0287		Hex Nut 1/4-20 Thd.*		74	12154		Rear Deck Brkt.	
17	712-0261		Hex Cent. L-Nut 5/8-11 Thd.		75	12419		Pedal Lockout Rod 5/16"	
18	736-0158		Fl-Wash. 5/8" Scr.*		76	726-0109		Push Cap—.312 I.D.	
19	11073		Brake Disc		77	747-0125		Deck Lift Rod 3/8" Dia.	
20	756-0143		Split Pulley .63 I.D.		78	710-0167		Carriage Bolt 1/4-20 x .50" Lg.	
21	754-0188		V-Belt 21/32-51" Lg.		79	12139		Deck Lift Shaft Ass'y.	
22	08253		Housing—Bearing		80	712-0158		Hex Cent. L-Nut 5/16-18 Thd.	
23	12172		Belt Keeper Ass'y.		81	736-0116		Fl-Wash. .635 I.D. x .93 O.D.	
24	11537		Belt Guard Plate Ass'y.		83	732-0233		Tension Spring	
25	738-0129		Shld. Scr. .498 Dia. x 2.005		84	738-0147		Shld. Scr. .500 Dia. x .170	
26	736-0105		Bell-Wash. .400 I.D. x .88 O.D.		85	756-0212		Engine Two Step Pulley and 5.81	
27	12157		26" Deck Ass'y.		86	756-0116		V-Belt Idler	
28	732-0153		Spring .75 O.D. x 8.65 Lg.		87	736-0217		L-Wash. 3/8" Scr. H.D.	
29	712-0267		Hex Nut 5/16-18 Thd.*		88	712-0711		Hex Jam Nut 3/8-24 Thd.*	
30	736-0119		L-Wash. 5/16" Scr.*		89	710-0151		Hex Scr. 3/8-24 x 2.00" Lg.*	
31	710-0198		Hex Sems Scr. 5/16-18 x .75" Lg.*		91	711-0572		Step Washer	
32	714-0388		#61 Hi-Pro Key 3/16 x 5/8" Dia.		92	712-0922		Hex Jam Nut 1/2-20*	
33	711-0405		Blade Spindle		93	736-0921		L-Wash. 1/2" Scr.*	
34	714-0365		#6 Hi-Pro Key 5/32 x 5/8 Dia.		94	754-0101		V-Belt 1/2 x 35" Lg.	
35	742-0147		26" Blade		95	756-0175		Trans. Split Pulley .50 I.D.	
36	10769		Blade Adapter Kit		96	10086		Belt Guard Ass'y.—Trans.	
37	736-0217		L-Wash. 3/8" Scr. H.D.		97	12162		Idler Brkt. Ass'y.	
38	710-0459		Hex Scr. 3/8-24 x 1.50" Lg. H.T.		98	714-0365		#6 Hi-Pro Key 5/32 x 5/8" Dia.	
					99	12160		Belt Keeper Ass'y.	

(486—Star Orange)

*For faster service obtain standard nuts, bolts and washers locally. If these items cannot be obtained locally, order by part number and size as shown on parts list.

When ordering parts, if color or finish is important, use the appropriate color code shown above. (e.g. Star Orange Finish—12131 (486).)

Model 400

717-0223 REVERSING TRANSMISSION

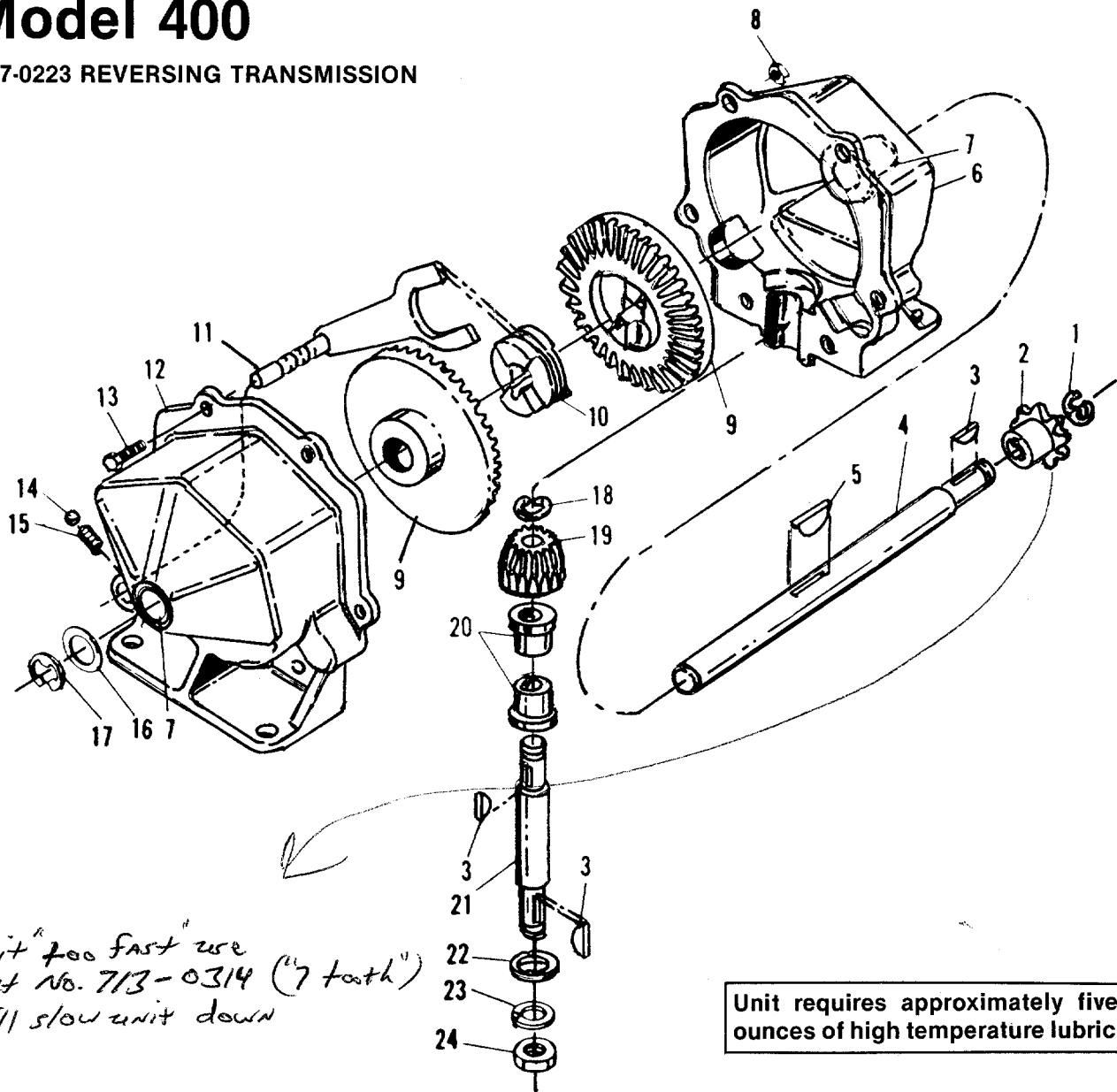

PARTS LIST FOR REVERSING TRANSMISSION 717-0223

REF. NO.	PART NO.	COLOR CODE	DESCRIPTION	NEW PART	REF. NO.	PART NO.	COLOR CODE	DESCRIPTION	NEW PART
1	716-0104		E-Ring for .500" Dia. Shaft		14	741-0862		Detent Ball	
2	748-0852		Sprocket—8 Tooth		15	732-0863		Detent Spring	
3	714-0129		#4 Hi-Pro Key 3/32 x 5/8" Dia.		16	736-0116		Fl-Wash. .635 I.D. x .93 O.D.	
4	711-0854		Output Shaft		17	716-0106		E-Ring for .625" Dia. Shaft	
5	714-0126		#9 Hi-Pro Key 3/16 x 3/4" Dia.		18	716-0865		Snap Ring for .500" Dia. Shaft	
6	717-0123		Trans. Case—L.H. Comp.		19	748-0866		Pinion Gear	
7	748-0855		Flange Bearing		20	748-0867		Bearing .627 I.D.	
8	712-0117		Hex Center Lock 1/4-28*		21	738-0159		Pinion Shaft	
9	748-0856		Bevel Gear		22	736-0192		Fl-Wash. .531 I.D. x .93 O.D.	
10	748-0857		Clutch Collar		23	736-0921		Spring L-Wash. 1/2" Scr.*	
11	08583		Shift Yoke Assembly		24	712-0922		Hex Jam Nut 1/2-20 Thd.*	
12	717-0124		Trans. Case—R.H.—Comp. (With Detent Hole)			737-0120		Grease—High Temp. 450° F. (5 oz.)	
13	710-0195		Hex Bolt 1/4-28 x .62" Lg.			717-0223		Transmission Complete	

Model 400

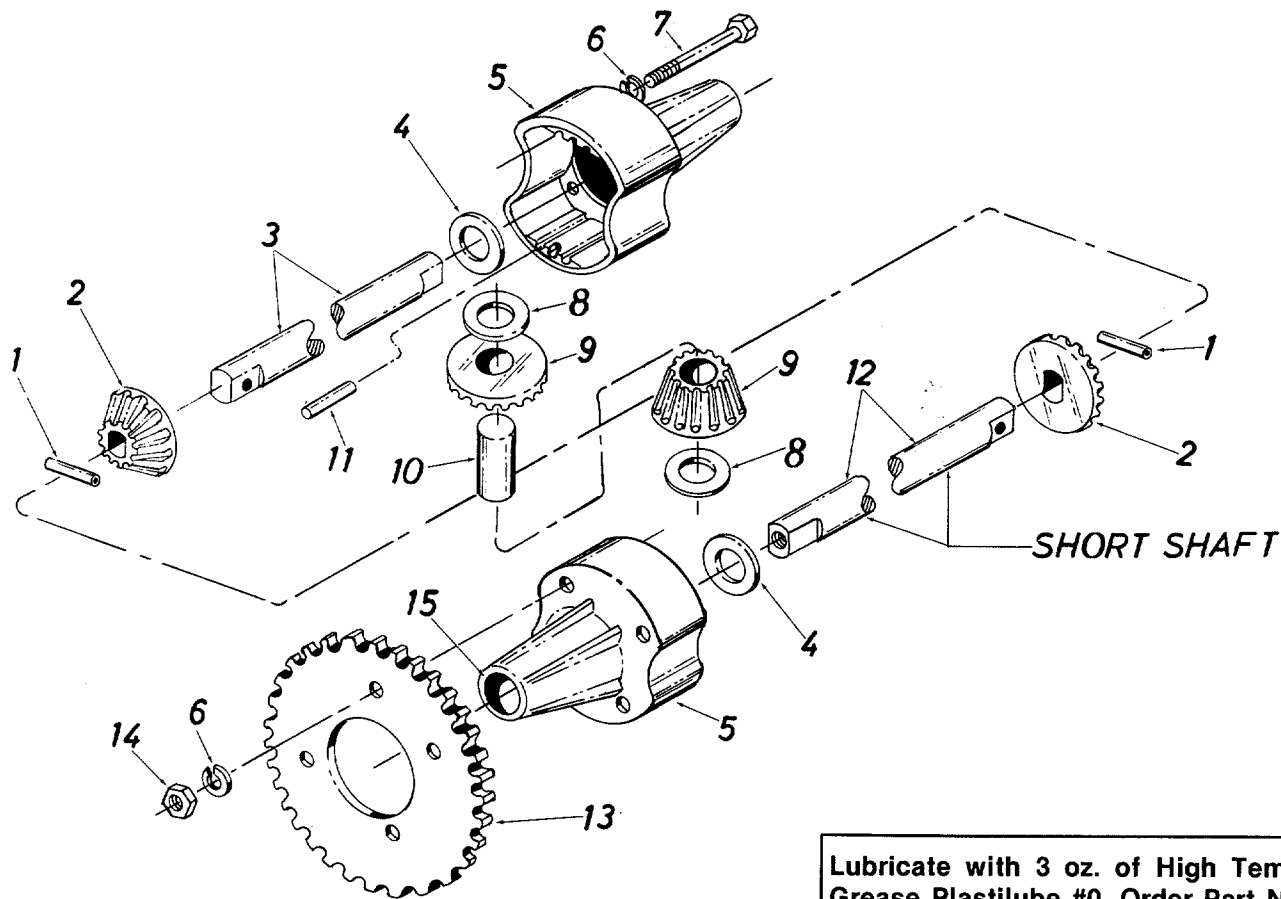

Lubricate with 3 oz. of High Temp. Grease Plastilube #0. Order Part No. 737-0166.

PARTS LIST FOR DIFFERENTIAL ASSEMBLY 717-0320

REF. NO.	PART NO.	Qty. Req'd.	DESCRIPTION
1	715-0247	2	Spring Pin Spir. 3/16" Dia. x 1.00" Lg.
2	748-0185	2	Gear—Double "D" Hole
3	738-0300	1	Shaft (Long)—19.31" Lg.
4	736-0188	2	FI-Wash. .760 I.D. x 1.49 O.D.
5	719-0150	2	Housing Half
6	736-0119	8	L-Wash. 5/16" I.D.*
7	710-0526	4	Hex Bolt 5/16-24 x 4.00" Lg.
8	736-0187	2	FI-Wash. .640 I.D. x .24 O.D.
9	748-0158	2	Gear—Round Hole
10	711-0276	1	Drive Pin
11	715-0123	2	Dowel Pin 3/16" Dia. x .62" Lg.
12	738-0301	1	Shaft (Short)—7.07" Lg.
13	09054	1	Sprocket—40 Teeth
14	712-0237	4	Hex Cent. L-Nut 5/16-24 Thd.
15	748-0169	2	Flange Bearing

*For faster service obtain standard nuts, bolts and washers locally. If these items cannot be obtained locally, order by part number and size as shown on parts list.

Model 400

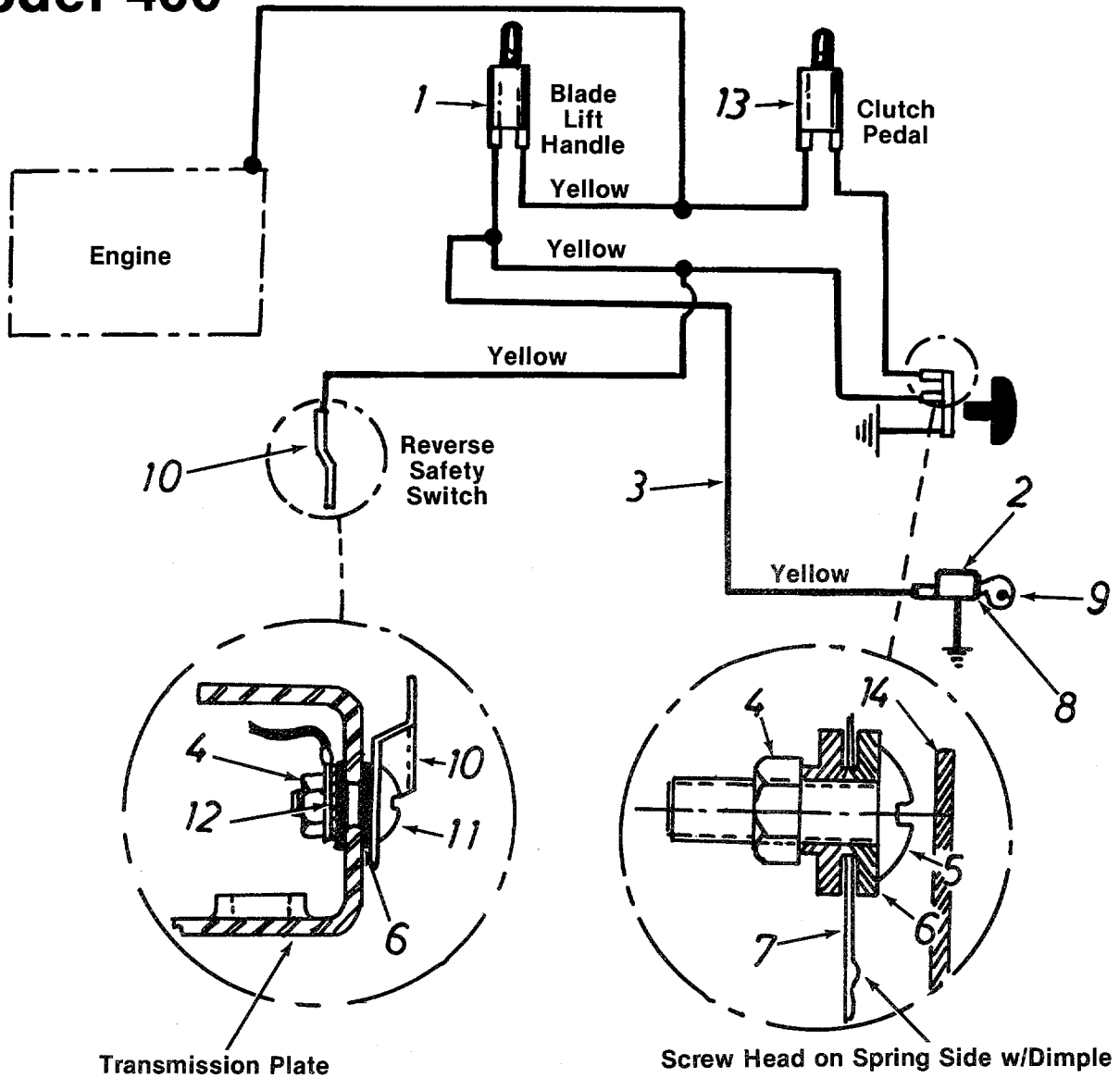

PARTS LIST FOR SCHEMATIC

REF. NO.	PART NO.	COLOR CODE	DESCRIPTION	NEW PART
1	725-0269		Safety Switch Norm Close—Red	
2	725-0464		Magneto Ignition Switch w/Nut	
3	725-0829		Wire Harness	
4	712-0121		Hex Nut #10-24	
5	710-0425		Truss Mach. Scr. #10-24 x .62" Lg.	
6	736-0338		Fiber Washer	
7	732-0257		Switch Spring	
8	736-0225		Internal L-Wash. .62" I.D.	
9	725-0201		Ignition Key	
10	732-0420		Spring Switch	N
11	710-0473		Truss Mach. Scr. #10-24 x .50" Lg.	
12	736-0147		Ext. L-Wash. #10 I.D.	
13	725-0379		Safety Switch	
14	12545		Grounding Plate	

PARTS INFORMATION

POWER EQUIPMENT PARTS AND SERVICE

Parts and service for all MTD manufactured power equipment are available through the authorized service firms listed below. All orders should specify the model number of your unit, part numbers, description of parts and the quantity of each part required.

NOTE: If any parts are found to be missing or defective upon assembly of this unit, write to advise the factory so that immediate replacement can be made.

ALABAMA	BIRMINGHAM	
Auto Electric & Carburetor Co.	2625 4th Ave. S.	35233
ARKANSAS	FORT SMITH	
Mity Mite Motors, Inc.	4515 S. 16th St.	72901
	NORTH LITTLE ROCK	
Sutton's Lawn Mower Shop	Rt. 4, Box 368	72117
CALIFORNIA	PORTERVILLE	
Billious	75 North D Street	93257
COLORADO	DENVER	
Spitzer Industrial Products Co.	6601 N. Washington St., Box 29114	80229
FLORIDA	JACKSONVILLE	
Radco Distributors	4909 Victor St., Box 5459	32207
	OPA LOCKA	
Small Eng. Dist.	2351 N.W. 147th St.	33054
GEORGIA	EAST POINT	
East Point Cycle & Key	2834 Church St.	30344
ILLINOIS	LYONS	
Keen Edge Co.	8615 Ogden Ave.	60534
INDIANA	ELKHART	
Parts & Sales Inc.	2101 Industrial Pkwy.	46514
IOWA	DUBUQUE	
Power Lawn & Garden Equip.	2551 J.F. Kennedy	52001
LOUISIANA	NEW ORLEANS	
Suhren Engine Co.	8330 Earhart Blvd.	70118
MARYLAND	TAKOMA PARK	
Center Supply Co.	6867 New Hampshire Ave.	20012
MASSACHUSETTS	SPRINGFIELD	
Morton B. Collins Co.	300 Birnie Ave.	01107
MICHIGAN	LANSING	
Lorenz Service Co.	2500 S. Pennsylvania	48910
	MOUNT CLEMENS	
Power Equipment Dist.	340 Hubbard	48043
MINNESOTA	HOPKINS	
Hance Distributing Inc.	420 Excelsior Ave. W.	55343
MISSISSIPPI	BILOXI	
Biloxi Sales & Service, Inc.	506 Caillavet St.	39533
MISSOURI	KANSAS CITY	
Automotive Equip. Service	3117 Holmes St.	64109
	ST. JOSEPH	
Ross-Frazier Supply Co.	8th and Monterey	64503
	ST. LOUIS	
Henzler, Inc.	2015 Lemay Ferry Rd.	63125
NEW JERSEY	BELLMAWR	
Lawnmower Parts Inc.	717 Creek Rd.	08030
NEW MEXICO	ALBUQUERQUE	
Spitzer Eng. & Parts	1023 Third St. N.W.	87103
NEW YORK	CARTHAGE	
Gamble Dist., Inc.	West End Ave.	13619

BRIGGS AND STRATTON, TECUMSEH AND PEERLESS PARTS AND SERVICE

Briggs & Stratton, Tecumseh and Peerless parts and service should be handled by your nearest authorized engine service firm. Check the yellow pages of your telephone directory under the listing **Engines—Gasoline**, Briggs & Stratton or Tecumseh Lauson.

NORTH CAROLINA	GOLDSBORO	
Smith Hardware Co.	515 N. George St.	27530
	GREENSBORO	
Dixie Sales Company	335 N. Green	27402
OHIO	CARROLL	
Stebe's Mid-State Mower Supply	71 High St., Box 366	43112
	CLEVELAND	
Bleckrie, Inc.	7900 Lorain Ave.	44102
	WADSWORTH	
National Central	687 Seville Rd.	44281
	YOUNGSTOWN	
Burton Supply Co.	1301 Logan Ave., Box 929	44501
OKLAHOMA	MUSKOGEE	
Victory Motors, Inc.	605 S. Cherokee	74401
OREGON	PORTLAND	
Kenton Supply Co.	8216 N. Denver Ave.	97217
PENNSYLVANIA	HARRISBURG	
EECO Inc.	4021 N. 6th St.	17110
	PHILADELPHIA	
Thompson Rubber Co.	5222-24 N. Fifth St.	19120
	PITTSBURGH	
Bluemont Co.	11125 Frankstown Rd.	15235
	PUNXSUTAWNEY	
Frank Roberts & Sons	R.D. 2	15767
TENNESSEE	KNOXVILLE	
Master Repair Service	2000 Western Ave.	37921
	MEMPHIS	
American Sales & Service, Inc.	3035-43 Bellbrook	38
TEXAS	DALLAS	
Marr Brothers, Inc.	423 E. Jefferson	75203
	FORT WORTH	
Woodson Sales Corp.	1702 N. Sylvania	76111
	HOUSTON	
Bullard Supply Co.	2409 Commerce St.	77003
UTAH	SALT LAKE CITY	
A-1 Engine & Mower Co.	437 E. 9th St.	84111
VERMONT	BURLINGTON	
Vermont Hdwe. Co. Inc.	180 Flynn Ave.	05401
VIRGINIA	ASHLAND	
RBI Corp.	Lake Ridge Park, 101 Cedar Run Dr.	23005
WASHINGTON	SEATTLE	
Bailey's Inc.	1414 14th Ave.	98102
WEST VIRGINIA	CHARLESTON	
Young's, Inc.	233 Virginia St., E.	25301
WISCONSIN	MARSHFIELD	
Power Pac	301 E. 29th St.	54449

WARRANTY PARTS AND SERVICE POLICY

The purpose of warranty is to protect the customer from defects in workmanship and materials, defects which are NOT detected at the time of manufacture. It does not provide for the unlimited and unrestricted replacement of parts. Use and maintenance are the responsibility of the customer. The manufacturer cannot assume responsibility for conditions over which it has no control. Simply put, if it's the manufacturer's fault, it's the manufacturer's responsibility; if it's the customer's fault, it's the customer's responsibility.

CLAIMS AGAINST THE MANUFACTURER'S WARRANTY INCLUDES:

1. Replacement of Missing Parts on new equipment.
2. Replacement of Defective Parts within the warranty period.
3. Repair of Defects within the warranty period.

All claims MUST be substantiated with the following information:

1. Model Number of unit involved.
2. Date unit was purchased or first put into service.
3. Date of failure.
4. Nature of failure.