

OWNER'S MANUAL

- ASSEMBLY
- OPERATION
- MAINTENANCE
- PARTS LIST

Model No.
128-350A

Important:

**Read Safety Rules and
Instructions Carefully**

22"
**REAR DISCHARGE
SELF PROPELLED
ROTARY MOWER**



LIMITED WARRANTY

For one year from the date of original retail purchase, MTD PRODUCTS INC will either repair or replace, at its option, free of charge, F.O.B. factory or authorized service firm, any part or parts found to be defective in material or workmanship. Transportation charges under this warranty must be paid by the purchaser unless return is requested by MTD PRODUCTS INC.

This warranty will not apply to any part which has become inoperative due to misuse, excessive use, accident, neglect, improper maintenance, alterations, or unless the unit has been operated and maintained in accordance with the instructions furnished. This warranty does not apply to the engine, motor, battery, battery charger or component parts thereof. Please refer to the applicable manufacturer's warranty on these items.

This warranty will not apply where the unit has been used commercially.

Warranty service is available through your local authorized service dealer or distributor. If you do not know the dealer or distributor in your area, please write to the Customer Service Department of MTD.

The return of a complete unit will not be accepted by the factory unless prior written permission has been extended by MTD.

This warranty gives you specific legal rights. You may also have other rights which vary from state to state.

WARNING TO PURCHASERS OF INTERNAL COMBUSTION ENGINE EQUIPPED MACHINERY OR DEVICES IN THE STATE OF CALIFORNIA

The equipment which you have just purchased does not have a spark arrester. If this equipment is used on any forest covered land, brush covered land, or grass covered unimproved land in the State of California, before using on such land, the California law requires that a spark arrester be provided. In addition, spark arrester is required by law to be in effective working order. The spark arrester must be attached to the exhaust system and comply with Section 4442 of the California Public Resources Code.

IMPORTANT

It is suggested that this manual be read in its entirety before attempting to assemble or operate. Keep this manual in a safe place for future reference and for ordering replacement parts.

This unit is shipped WITHOUT GASOLINE or OIL. After assembly, see operating section of this manual for proper fuel and amount.

Your rotary mower is a precision piece of power equipment, not a plaything. Therefore exercise extreme caution at all times.

SAFE OPERATION PRACTICES FOR WALK-BEHIND MOWERS

TRAINING

1. Read the Operating and Service Owner's Manual carefully. Be thoroughly familiar with the controls and the proper use of the equipment.
2. Never allow children to operate a power mower. Only persons well acquainted with these rules of safe operation should be allowed to use your mower.
3. Keep the area of operation clear of all persons, particularly small children and pets. Stop engine when they are in the vicinity of your mower. Although the area of operation should be completely cleared of foreign objects, a small object may have been overlooked and could be accidentally thrown by the mower in any direction.

PREPARATION

1. Thoroughly inspect the area where the equipment is to be used and remove all stones, sticks, wire, bones and other foreign objects which could be picked up and thrown by the mower in any direction.
2. Do not operate equipment when barefoot or wearing open sandals. Always wear substantial footwear.
3. Do not wear loose fitting clothing that could get caught on the mower.
4. Check the fuel before starting the engine. Do not fill the gasoline tank indoors, when the engine is running, or while the engine is still hot. Wipe off any spilled gasoline before starting the engine.
5. Disengage the self-propelled mechanism or drive clutch on units so equipped before starting the engine.
6. Never attempt to make a wheel or cutting height adjustment while the engine is running.
7. Mow only in daylight or in good artificial light.
8. Never operate the equipment in wet grass. Always be sure of your footing; keep a firm hold on the handle and walk, never run.

OPERATION

1. Do not change the engine governor settings or overspeed the engine. Excessive engine speeds are dangerous.
2. Do not put hands or feet near or under rotating parts. Keep clear of the discharge opening at all times.
3. Stop the blade(s) when crossing gravel drive, walks or roads.
4. After striking a foreign object, stop the engine, remove the wire from the spark plug, thoroughly inspect the mower for any

damage, and repair the damage before restarting and operating the mower.

5. If the equipment should start to vibrate abnormally, stop the engine and check immediately for the cause. Vibration is generally a warning of trouble.
6. Stop the engine whenever you leave the mower, before cleaning the mower housing, and when making any repairs or inspections.
7. When cleaning, repairing or inspecting, make certain the blade and all moving parts have stopped. Disconnect the spark plug wire, and keep the wire away from the plug to prevent accidental starting.
8. Before attempting to unclog the mower or discharge chute, stop the engine and be sure the blade(s) have stopped completely. Disconnect the spark plug wire and keep the wire away from the plug to prevent accidental starting.
9. Do not run the engine indoors.
10. Shut the engine off and wait until the blade comes to a complete stop before removing the grass catcher.
11. Mow across the face of slopes, never up-and-down. Exercise extreme caution when changing direction on slopes. Do not mow excessively steep slopes.
12. Always disconnect electric mowers (line operated) before cleaning, repairing or adjusting.
13. Never operate mower without proper guards, plates or other safety protective devices in place.
14. Keep washout ports and other mower-housing service openings closed when mowing.
15. **DO NOT OPERATE** this mower with the chute doors open, unless the complete grass catcher is properly mounted on the mower.

MAINTENANCE AND STORAGE

1. Check the blade and engine mounting bolts at frequent intervals for proper tightness.
2. Keep all nuts, bolts, and screws tight to be sure the equipment is in safe working condition.
3. Never store the equipment with gasoline in the tank inside of a building where fumes may reach an open flame or spark. Allow the engine to cool before storing in any enclosure.
4. To reduce fire hazard, keep the engine free of grass, leaves, or excessive grease.
5. Check the grass catcher bag frequently for wear or deterioration. For safety protection replace only with new bag meeting original equipment specifications.

ASSEMBLY



NOTE

Reference to Left or Right side of machine is from operator's position at the handle facing forward.

The Lawn Mower, except the handle and throttle control, is fully assembled, packed and shipped in one container.

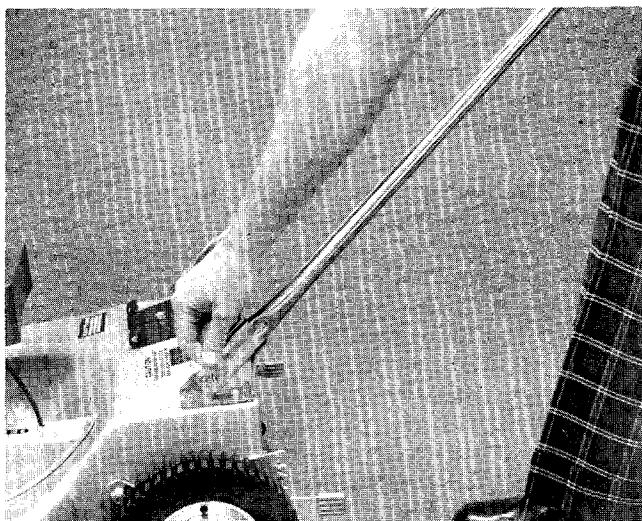

FIGURE 1

ATTACHING THE HANDLE

1. The throttle is attached to the engine. Extend the throttle control and lay it on the floor. Be careful not to bend or kink the wire.
2. Attach the lower handle over the pins on the handle brackets located on the rear of the mower. (See figure 1.)



NOTE

There are two (2) holes in the handle mount brackets. Place the lower handle against the brackets and secure with hair pin in second hole. Second hole is for operation. First hole is for storage.

3. Place the two cotter hairpins in the holes in the pins.
4. Assemble the upper handle with the engagement lever attached, to the lower handle with the two knobs. Make sure the single hole for the throttle is on the right side of the handle. The knobs can be either to the inside or the outside of the handle. (See figure 2.)

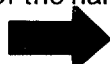

NOTE

There are two height positions for the handle. See the Operation section of this handbook for adjustment.

5. Assemble the throttle control to the upper handle with the nut and bolt. (See figure 3.)

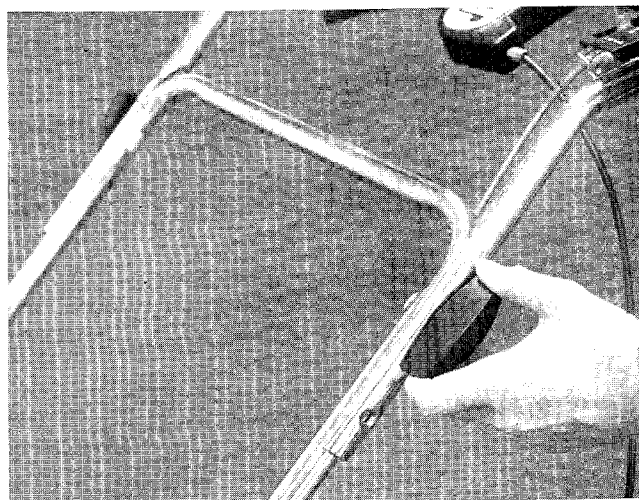

FIGURE 2

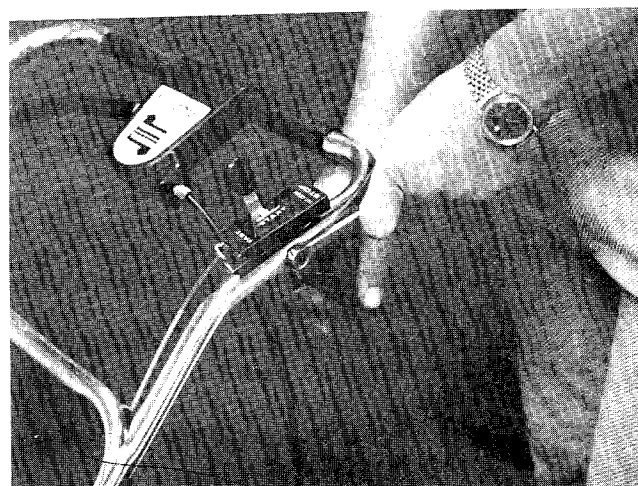

FIGURE 3

6. Secure the throttle control wire and clutch wire to the lower handle with the cable ties. (See figure 4.) Cut off ends.

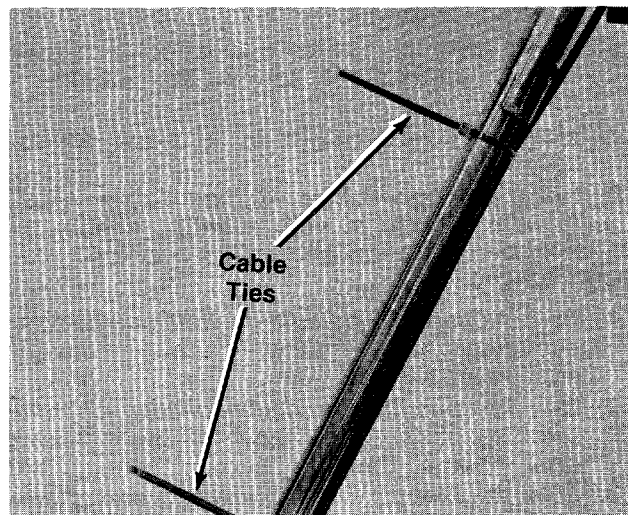

FIGURE 4

ASSEMBLY—GRASS CATCHER

The grass catcher is partially assembled. The hardware needed is in the hardware pack. It consists of:

- 7 bolts 3/8" long
- 4 bolts 1" long
- 11 lockwashers
- 11 nuts
- 2 cotterpins

1. Thread the rear frame through the bag. See figure 5.
2. Place the ends of the upper frame inside the bag.
3. Assemble the rear frame to the front frame with the four 1" bolts, lockwashers and nuts. See figure 6.
4. Fasten the bag to the frame with the 7 bolts 3/8" long, lockwashers and nuts. Start the three holes on the top of the bag, then do both sides.
5. Fit the lower edge of the bag into the slot in the bottom of the front frame and place the two cotter pins through the eyelets in the bag.
6. Open up the legs of the cotter pins to secure them.

7. Close the top of the bag by stretching the elastic over the upper frame.



WARNING

Never operate the mower with the bag open.

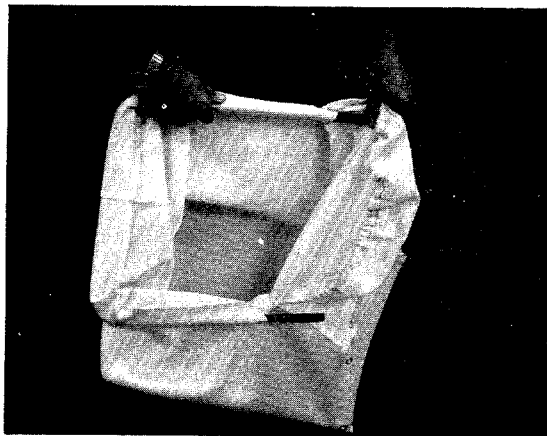

FIGURE 5

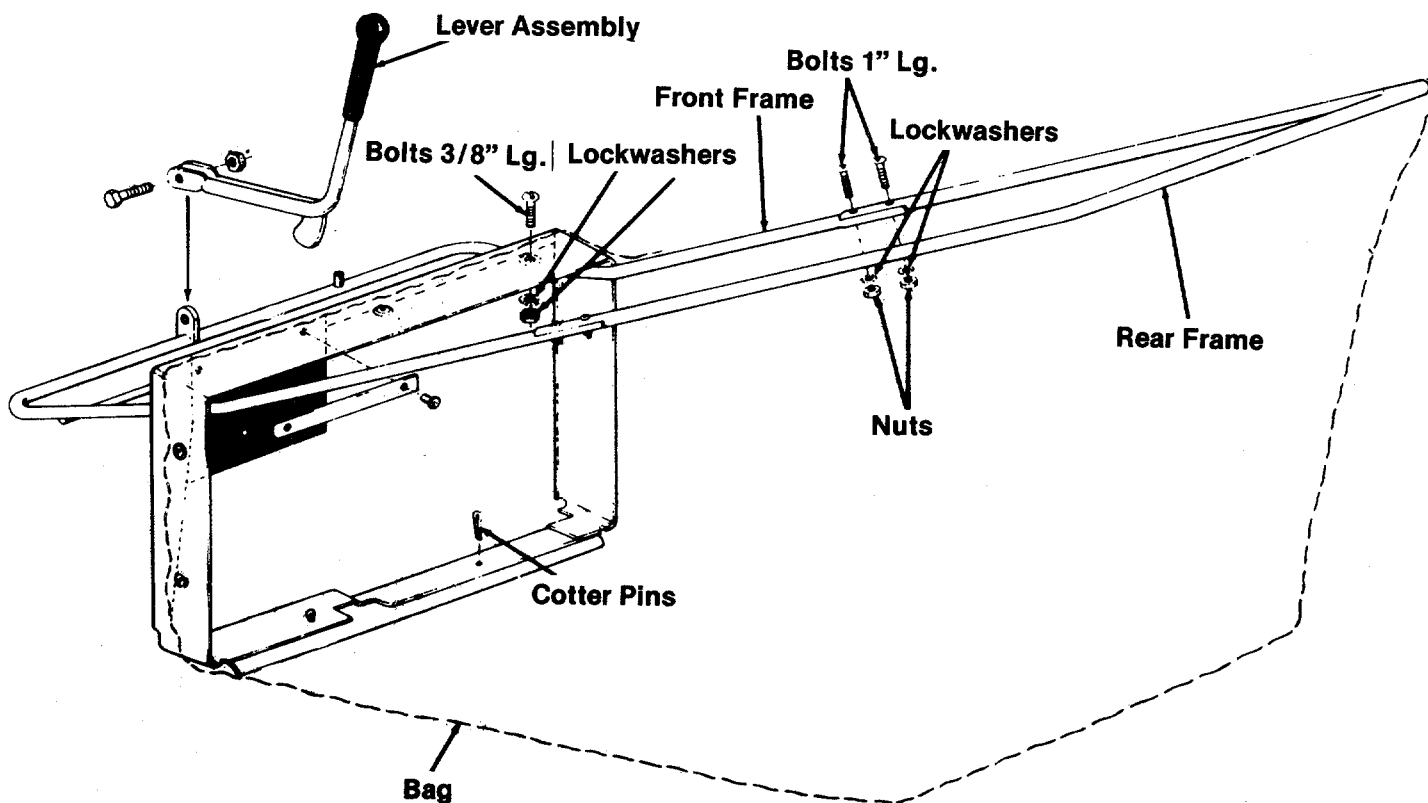

FIGURE 6

OPERATION

Before starting the engine fill the crankcase with oil.



WARNING

The mower shall not be operated without the entire grass catcher or rubber protective shield in place.



NOTE

Under normal usage the grass catcher bag material is subject to wear and should be checked periodically.

This mower is designed to be operated at full throttle to give you the best cut and do the most effective job of bagging the cut grass.

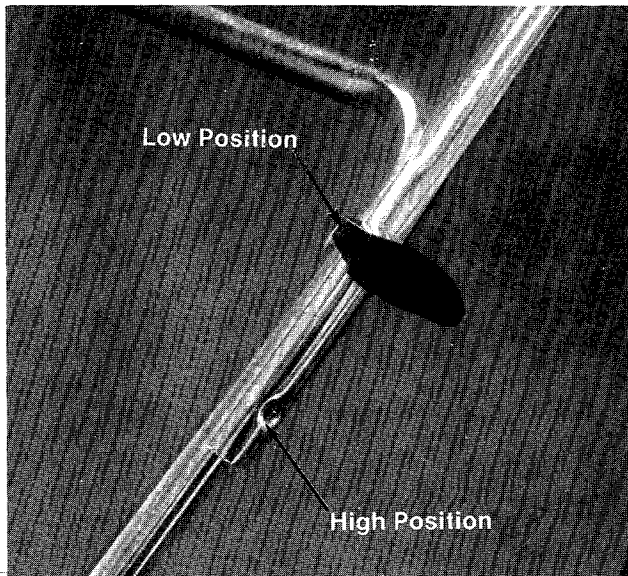

FIGURE 6

HANDLE POSITION

The upper handle can be adjusted to a high or low position. The operator of the lawn mower can easily adjust the handle position by unscrewing the two knobs, removing the two bolts and reassembling in the other position. No tools are necessary to make this adjustment. (See figure 6.)

ATTACHING GRASS CATCHER

The doors shown in figure 7 cannot be opened to discharge the grass unless the grass catcher is in place.



WARNING

Under no circumstances should the doors be opened while the engine is operating.

1. Attach the grass catcher frame to the front of the adapter as shown in figure 8.
2. Push down on the back of the bag until the entire grass catcher seats into the bracket.
3. Move the locking lever towards the rear of the mower. (See figure 9.) This locks the grass catcher in place and opens the doors.
4. To remove the grass catcher, unlock the locking lever and lift off the grass catcher.

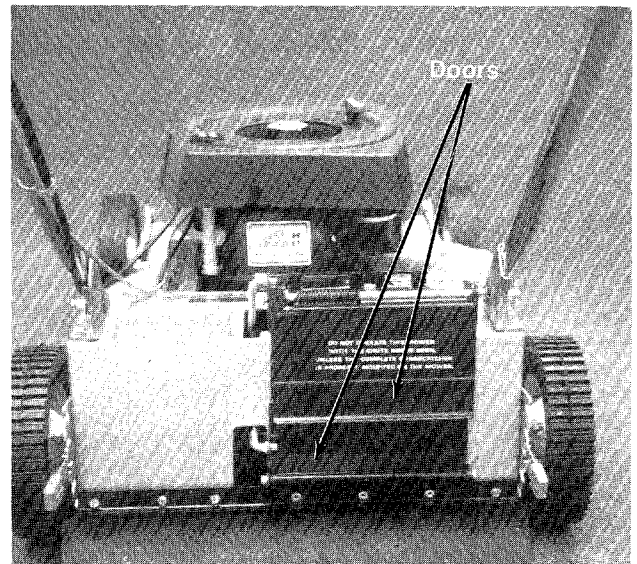

FIGURE 7



FIGURE 8

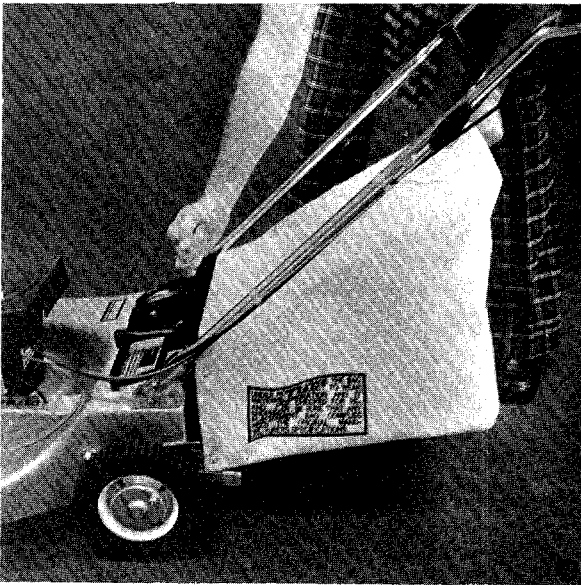

FIGURE 9

THROTTLE CONTROL

Your engine has an automatic choke. The throttle control is used to regulate the engine speed and stop the engine. The engine can be started with the throttle control lever anywhere in the START position. Move the throttle control to the STOP position to stop the engine. (See figure 10.)

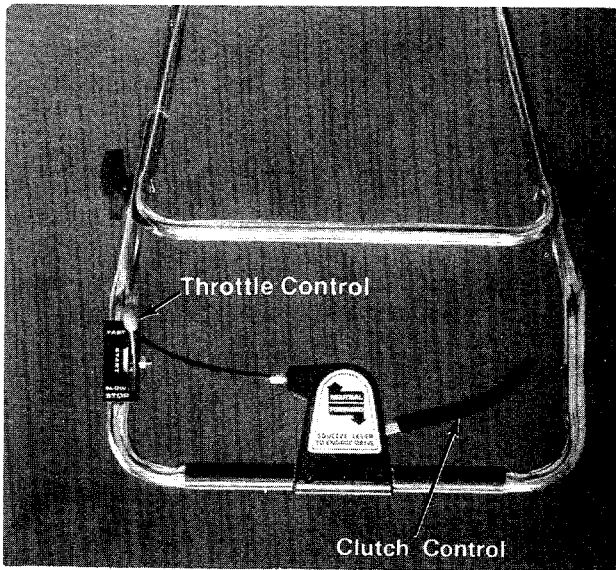

FIGURE 10

CLUTCH CONTROL

Squeezing the clutch control engages the drive mechanism to the rear wheels. Releasing the clutch control stops the rear wheels from driving. Release the clutch control to slow down when negotiating an obstacle, making a turn or stopping. (See figures 11 and 12.)

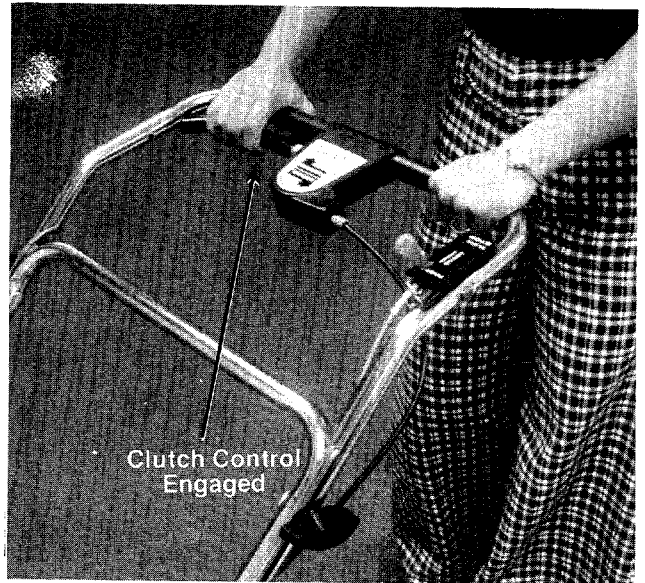

FIGURE 11



WARNING

The blade continues to rotate when the clutch is released.



FIGURE 12

Start the engine from the left side by lifting up on the starter handle and placing your foot on the mower deck. (See figure 13.)



FIGURE 13

HEIGHT ADJUSTMENT



Before changing the cutting height, stop the engine and disconnect the spark plug wire. Adjustments may be made by moving the height adjustment lever on each wheel to the desired position. (See figure 14.) There are five cutting heights. All four height adjusters should be in the same relative position.

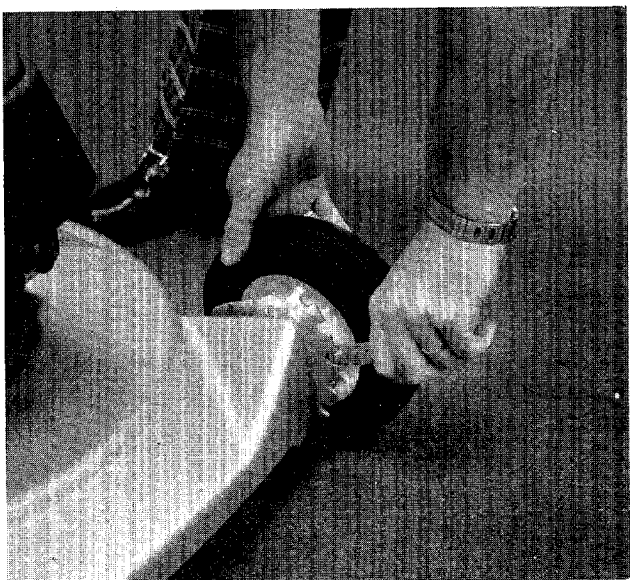

FIGURE 14

HANDLE STORAGE

The handle can be stored in the upright position to take less room. Grasp the lower handle at the bottom, pull apart slightly and tip the handle forward. It will lock in this position. Reverse this procedure to place the handle in the operating position. (See figure 15.)

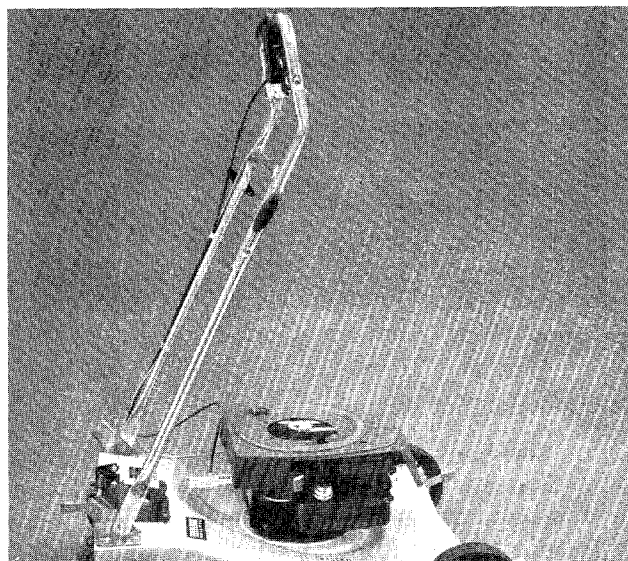

FIGURE 15

FOLDING THE HANDLE

The handle can be folded completely for storage. To fold the handle, loosen the black plastic knobs on each side of the handle, swing the upper handle down as you pivot the lower handle forward. (See figures 16, 17 and 18.)

The following maintenance and adjustment instructions are primarily for the mower. For the engine refer to the Engine Operating and Maintenance manual packed with this mower.

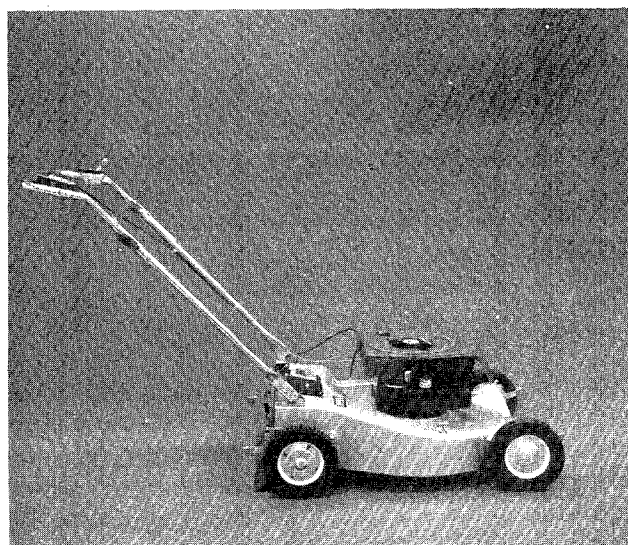

FIGURE 16



FIGURE 17

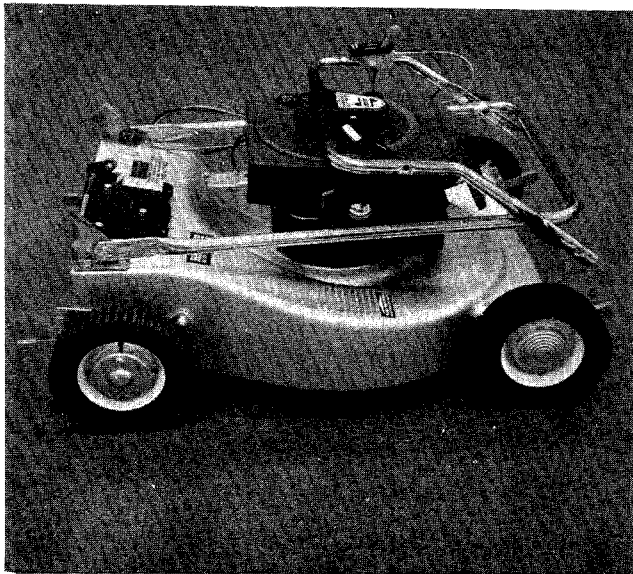

FIGURE 18

WHEEL LUBRICATION

Each front wheel has two ball bearings and each rear wheel has a sintered iron sleeve bearing that requires periodic lubrication. Place a few drops of light oil on each bearing at the start of each mowing season.

CUTTING BLADE

The blade may be removed for sharpening or replacement as follows:

1. Remove the center bolt and center lockwasher holding the blade and adapter to the engine crankshaft.
2. Remove the blade and adapter from the crankshaft.
3. Be careful not to lose the key on the crankshaft. See figure 19.

4. Remove the two smaller bolts, lockwashers and nuts holding the blade to the adapter. (See figure 19.)

When sharpening the blade, follow the original angle of grind as a guide. It is extremely important that each cutting edge receives an equal amount of grinding to prevent an unbalanced blade. An unbalanced blade will cause excessive vibration when rotating at high speeds and may cause damage to the mower.

The blade can be tested for balance by balancing it on a screwdriver. Remove metal from the heavy side until it balances evenly. (See figure 20.)



NOTE

When replacing the blade, be sure the side of the blade marked "Bottom" or having the part number is facing the ground when the mower is in the operating position.

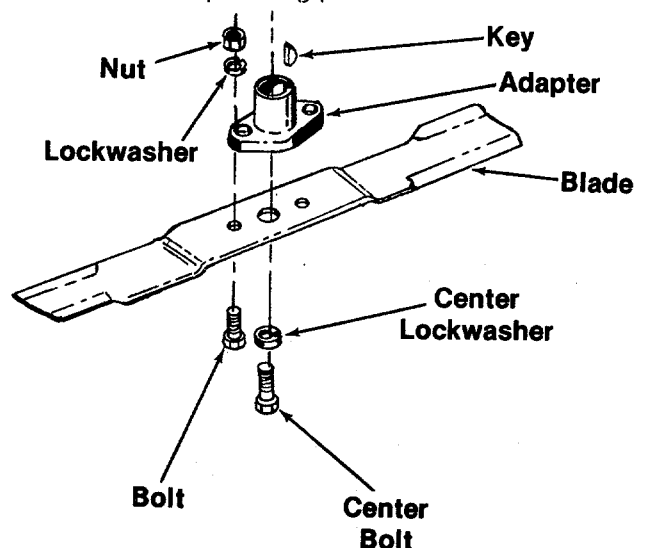

FIGURE 19

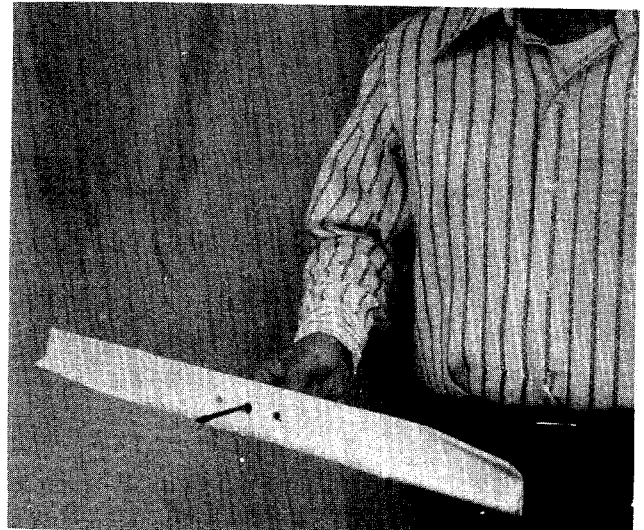

FIGURE 20

MAINTENANCE

CHAIN LUBRICATION

If the rotary mower is operated in a sandy area the chain should not be lubricated. Excessive oil on a chain will collect dirt and cause excessive wear on the chain and sprockets.

To lubricate the chain, remove the master link, soak the chain in kerosene or a solvent, let it air dry and wipe the chain with a rag saturated with SAE 30 oil. Reassemble the chain to the sprockets. Closed end of the master link clip should face in direction of chain travel.

BELT REMOVAL

1. Remove the spark plug wire and ground it.
2. Remove the three screws holding the belt guard (and idler assembly). (See figure 21.)
3. Remove the belt from the idler as you lift off the belt guard.
4. Place the mower in an upright position. (See figure 22.)



WARNING

Make sure that the mower is secure and cannot tip over.

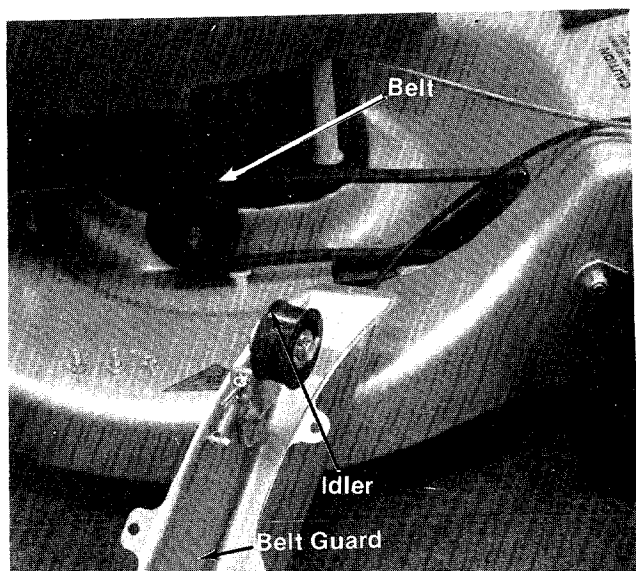

FIGURE 21

5. Remove the three screws holding the cover plate. A phillips screwdriver, standard screwdriver and adjustable wrench are required. See figure 22.

6. Remove the nut and slide the pulley bolt out. As the pulley bolt is removed, it will be necessary to remove two belleville washers, two flat washers, four spacers, the pulley/sprocket and the support link. See figure 23.



NOTE

Be sure the spacers and washers are installed in the same order when re-assembling the pulley. See figure 26.

7. Remove the belt (See figure 24.)
8. Install the new belt as shown in figure 25 with the idler under the belt.
9. Reassemble the pulley bolt making certain the parts are assembled in correct order. See figure 26.
10. Assemble the belt cover plate, lower pan and blade to mower.

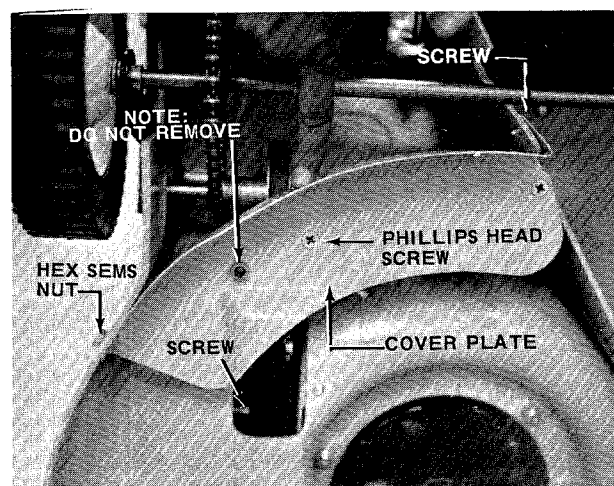

FIGURE 22

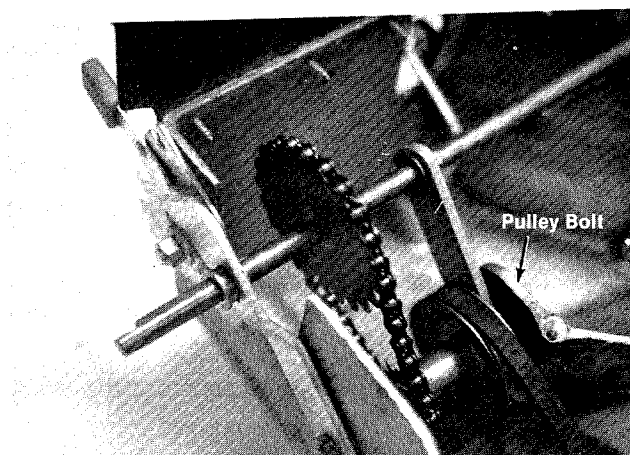

FIGURE 23

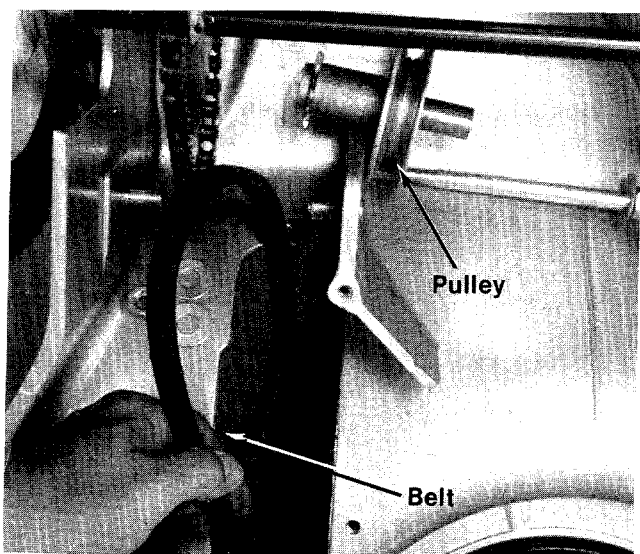

FIGURE 24

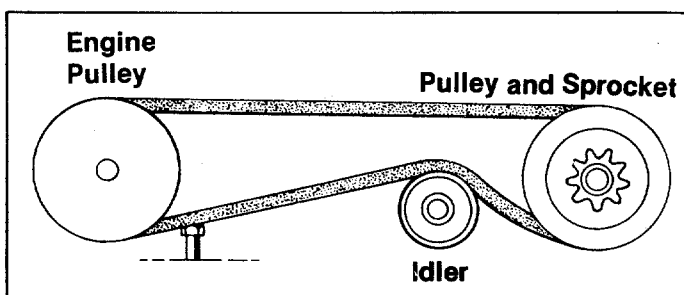

FIGURE 25

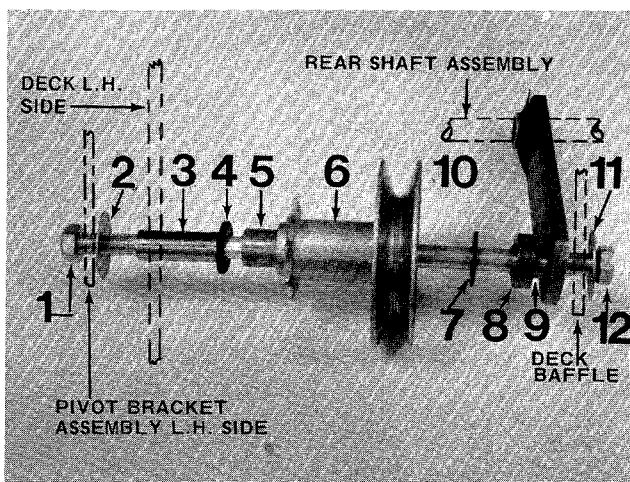

FIGURE 26



Figure 26 shows the order of assembly only. Parts cannot be preassembled.

Descriptions for Figure 26.

1. Hex top lock nut.
2. Belleville washer
3. Spacer 1.42" lg.
4. Flat washer
5. Spacer 2.00" lg.
6. Pulley and sprocket assembly
7. Flat washer
8. Spacer
9. Spacer .90" lg.
10. Support link
11. Belleville washer
12. 5" bolt

CLUTCH CONTROL ADJUSTMENT

1. To increase belt tension, loosen jam nut and backoff two or three threads. (See figure 27.)
2. Thread the barrel nut on end of control cable outward two or three threads, and retighten jam nut. (See figure 27.)
3. To decrease belt tension, loosen jam nut and back off two or three threads. (See figure 27.)
4. Thread the barrel nut on end of control cable inward two or three threads, and retighten jam nut. (See figure 27.)

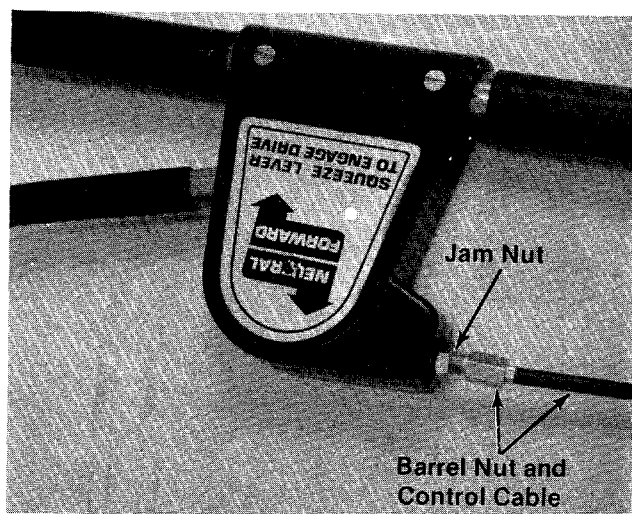

FIGURE 27

OFF-SEASON STORAGE

If the machine is to be inoperative for a period longer than 30 days, the following procedures are recommended:

1. Working outdoors, drain all fuel from the fuel tank. Use a clean dry cloth to absorb the small amount of fuel remaining in the tank, then run the engine until all fuel in the carburetor is exhausted.



Do not drain fuel while smoking, or if near an open fire.

2. Drain all the oil from the crankcase (this should be done after the engine has been operated and is still warm) and refill the crankcase with clean new oil.

3. Disconnect the spark plug wire and remove the spark plug from the cylinder. Pour about 2 or 3 tablespoons of engine oil into the cylinder, and then turn the engine over several times to spread out the oil. Replace the spark plug, but do not connect the wire.

4. Clean the engine and the entire mower thoroughly.

5. Lubricate all lubrication points.



NOTE

The manufacturer DOES NOT recommend the use of any accessory on this Rotary Mower other than those manufactured by MTD Products Inc.



WARNING

DO NOT operate the mower with the chute doors open unless the complete grass catcher is properly mounted on the mower.



NOTE:

Under normal usage bag material is subject to wear and should be checked periodically. Be sure any replacement bag complies with the mower manufacturer's recommendations.

For replacement bags, use only factory authorized replacement bag No. 764-0150.



IMPORTANT

After striking a foreign object, stop the engine, remove wire from spark plug. Thoroughly inspect the mower for any damage, and repair the damage before restarting and operating the mower.

128-350A

IF YOU WRITE TO US ABOUT THIS ARTICLE
OR IF YOU ORDER REPLACEMENT PARTS AL-
WAYS MENTION THIS MODEL & SERIAL NO
MODEL

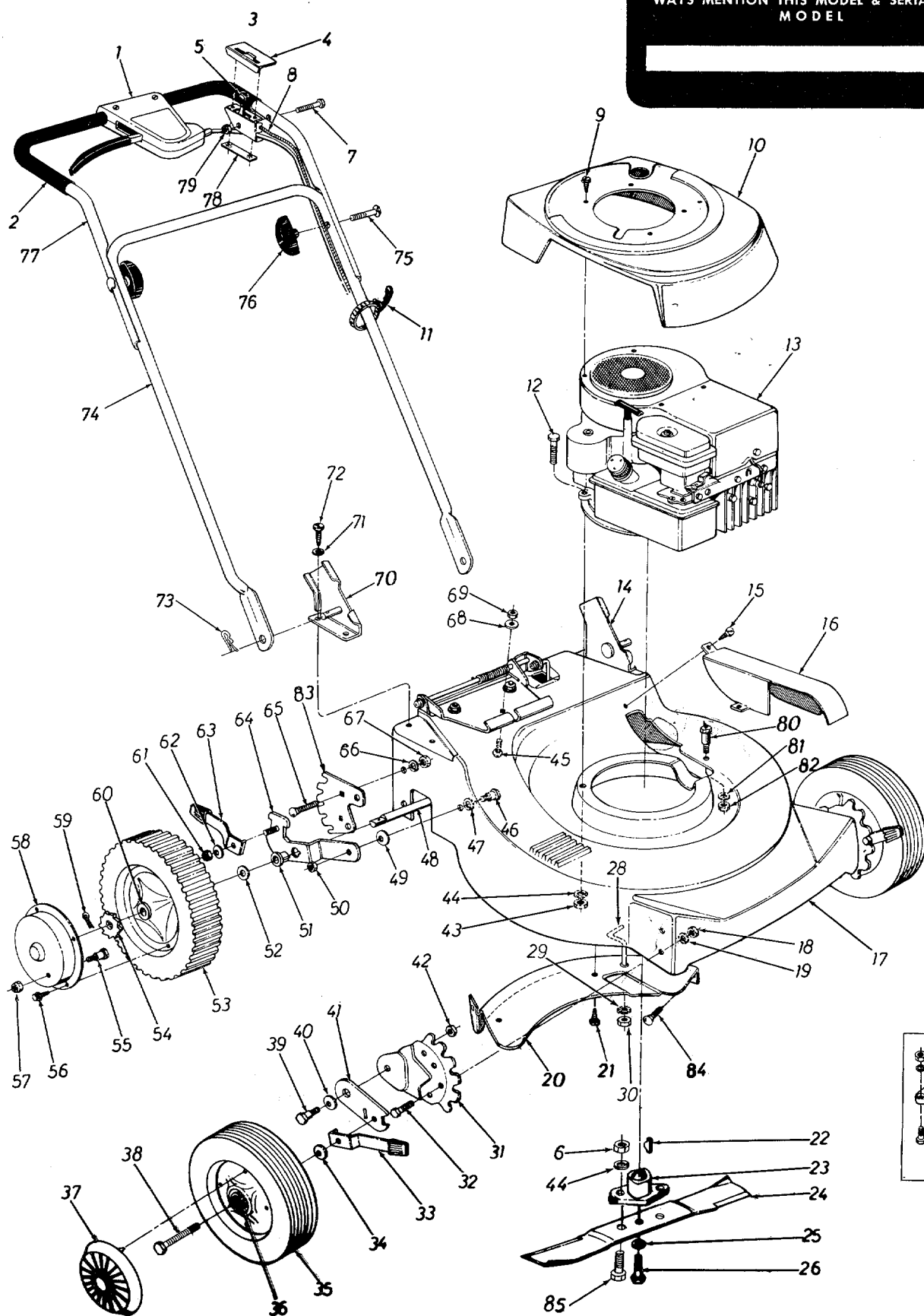

PARTS LIST FOR MODEL 128-350A

REF. NO.	PART NO.	COLOR CODE	DESCRIPTION	NEW PART	REF. NO.	NEW PART	COLOR CODE	DESCRIPTION	PART NO.
1	12608		Clutch Control Ass'y. Comp.		43	712-0267		Hex Nut 5/16-18 Thd. *	
2	718-0143		Grip		44	736-0119		L-Wash. 5/16" Scr. *	
3	746-0256		Throttle Control Ass'y. Comp.		45	710-0134		Carr. Bolt 1/4-20 x .62" Lg.	
4	731-0344		Plastic Label		46	738-0143		Shld. Scr. .498 Dia. x .340	
5	731-0189		Control Knob		47	736-0232		Wave Wash. .530 I.D. x .78 O.D.	
6	712-0123		Hex Nut 5/16-24 Thd. *		48	12313		Rear Shaft Ass'y.	
7	710-0606		Hex Scr. 1/4-20 x 1.50" Lg. *		49	736-0219		Bell. Wash. .400 I.D. x 1.13 O.D.	
8	746-0255		Conduit and Wire		50	712-0181		Hex Top L-Nut 3/8-16 Thd.	
9	710-0227		Slot Hex Hd. Self Extr. Scr. #8- x .50" Lg. *		51	748-0142		Flange Brg.	
10	731-0303		Engine Shroud		52	736-0192		FI-Wash. .531 I.D. x .93 O.D.	
11	726-0178		Cable Ties		53	734-0538		Wheel Ass'y. Comp.—Rear	
12	710-0442		Hex Scr. 5/16-18 x 1.50" Lg. *		54	748-0187		Ratchet	
13	—		Engine		55	738-0137		Shld. Scr. .342 Dia. x .268	
14	12935		Handle Mount Brkt. Ass'y. —L.H.		56	710-0227		Slot Hex Hd. Self Extr. Scr. #8- x .50" Lg.	
15	710-0456		Hex Drilling Scr. #10 x 1/2" Lg.		57	712-0219		Elastic Stop Nut 1/4-20 Thd.	
16	12309 —463		Belt Cover Ass'y.		58	10647 —463		Hub Cap—Rear	
17	12609 —463		22" Deck Ass'y.		59	714-0115		Cotter Pin 1/8" Dia. x 1.00" Lg. *	
18	712-0798		Hex Nut 3/8-16 Thd. *		60	748-0125		Sleeve Brg. .503 I.D.	
19	736-0169		L-Wash. 3/8" Scr. *		61	712-0798		Hex Nut 3/8-16 Thd. *	
20	12607		Cover Plate		62	736-0105		Bell. Wash. .400 I.D. x .88 O.D.	
21	710-0618		FI-Hd. Phil. Scr. 1/4-20 x .62" Lg.		63	10531		Spring Lever Ass'y. w/ Knob	
22	714-0365		#6 Hi-Pro-Key 5/32 x 5/8" Dia.		64	10639		Pivot Brkt. Ass'y.—R.H.	
23	10769		Blade Adapter Kit			10638		Pivot Brkt. Ass'y.—L.H.	
24	742-0125		22" Blade		65	710-0260		Carr. Bolt 5/16-18 x .62" Lg.	
25	736-0217		L-Wash. 3/8" Scr. Heavy Duty		66	736-0119		L-Wash. 5/16" Scr. *	
26	710-0459		Hex Scr. 3/8-24 x 1.50" Lg. H.T.		67	712-0267		Hex Nut 5/16-18 Thd.	
27	10769		Blade Adapter Kit		68	736-0329		L-Wash. 1/4" Scr. *	
28	711-0629		Finger		69	712-0287		Hex Cent. 1/4-20 Thd. *	
29	736-0329		L-Wash. 1/4" Scr. *		70	12936		Handle Mount Brkt. Ass'y.—R.H.	
30	712-0287		Hex Nut 1/4-20 Thd. *		71	736-0329		L-Wash. 1/4" Scr. *	
31	12321		Ht. Adj. Ass'y. Comp.—L.H.		72	710-0252		Hex Scr. 1/4-20 x .75" Lg. *	
	12322		Ht. Adj. Ass'y. Comp.—R.H.		73	714-0104		Intern. Cotter Pin 5/16" Dia.	
	12323		Index Plate		74	749-0179		Lower Handle	
32	710-0216		Hex Scr. 3/8-16 x .75" Lg. *		75	710-0405		Curved Carr. Bolt 5/16-18 x 1.75" Lg.	
33	10531		Spring Lever Ass'y. w/ Knob		76	09966		Hand Knob	
34	736-0105		Bell. Wash. .400 I.D. x .88 O.D.		77	749-0181		Upper Handle	
35	734-0845		Front Wheel Ass'y. Comp.	N	78	726-0134		Speed Nut—Twin Type	
36	741-0178		Ball Bearing (2 req'd.)		79	712-0107		Hex Cent. L-Nut 1/4-20 Thd.	
37	731-0124		Hub Cap		80	738-0138		Shld. Scr. .437 Dia. x .470	
38	710-0427		Hex Scr. 3/8-16 x 2.00" Lg. *		81	736-0119		L-Wash. 5/16-18" Scr. *	
39	738-0269		Shoulder Scr.		82	712-0267		Hex Nut 5/16-18 Thd. *	
40	736-0255		Bell. Wash. .500 I.D. x 1.14 O.D.		83	10643		Index Plate	
41	10619		Pivot Bar		84	710-0258		Hex Scr. 1/4-20 x .62" Lg. *	
42	712-0375		Hex Cent. L-Nut 3/8-16 Thd.		85	710-0117		Hex Scr. 5/16-24 x 1.00" Lg.	

*For faster service obtain standard nuts, bolts and washers locally. If these items cannot be obtained locally, order by part number and size as shown on parts list.

(463—Top Flite Red)

When ordering parts, if color or finish is important use the appropriate color code shown above (e.g. Top Flite Red Finish—12428 (463).)



NOTE

This instruction manual covers various models and all specifications shown do not necessarily apply to your model. Specifications subject to change without notice or obligation.

NOTE: The engine is not under warranty by the mower manufacturer . . . If repairs or service is needed on the engine, please contact your nearest authorized engine service outlet. Check the "Yellow Pages" of your telephone book under "Engines—Gasoline."



128-350A

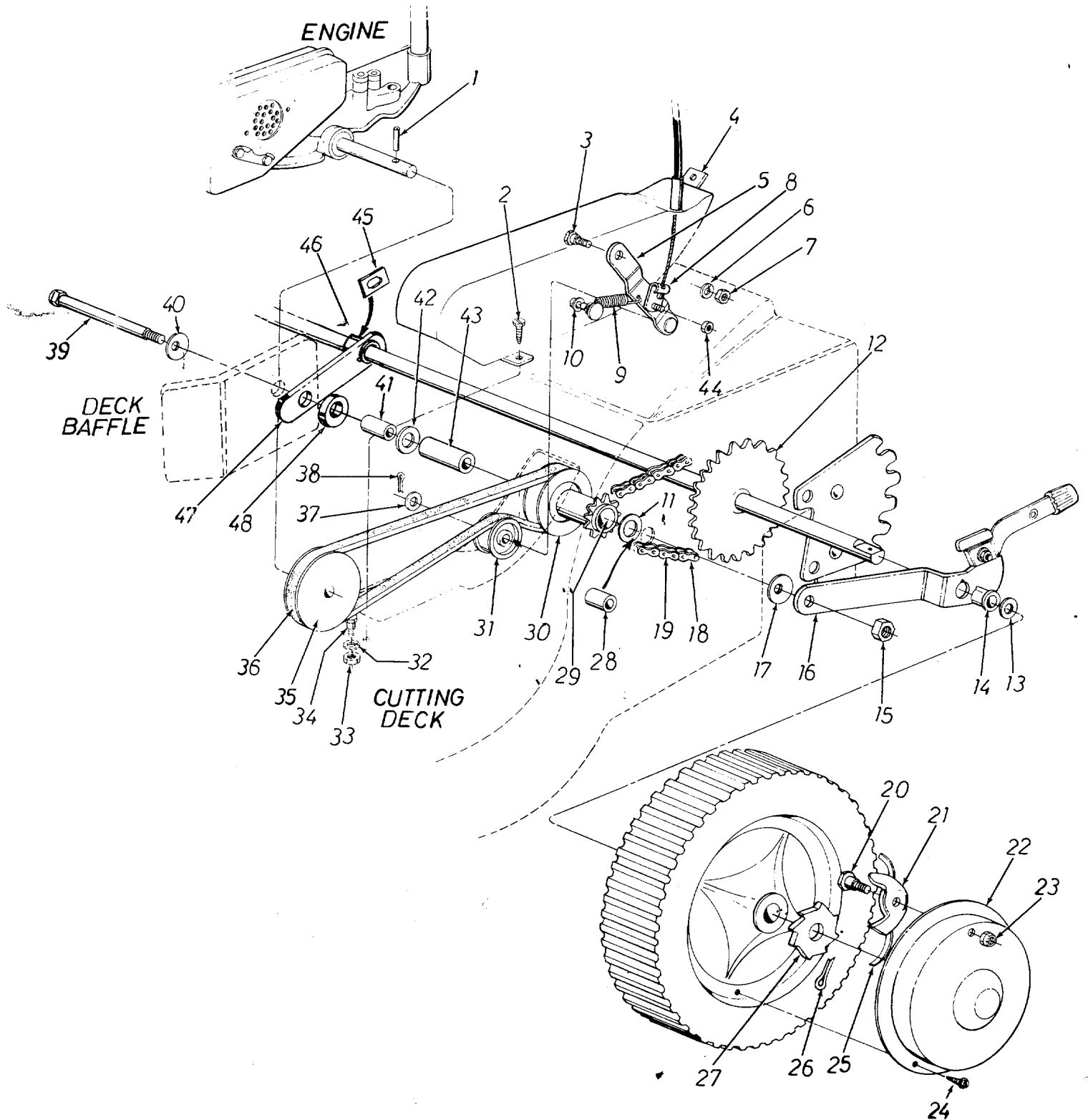

PARTS LIST FOR MODEL 128-350A

REF. NO.	PART NO.	COLOR CODE	DESCRIPTION	NEW PART	REF. NO.	PART NO.	COLOR CODE	DESCRIPTION	NEW PART
1	715-0105		Spring Pin Roll 3/16" Dia. x 1.50" Lg.		27	748-0187		Ratchet	
2	710-0599		Hex Wash. S-Tapp Scr. 1/4-20 x .50" Lg.		28	750-0262		Spacer .50 O.D. x .38 I.D. x 1.42" Lg.	
3	738-0255		Shoulder Scr. .375 Dia. x .172		29	741-0181		Sleeve Bearing .62 I.D. x .75 O.D. x .94 Lg.	
4	12308 —463		Belt Cover Ass'y.		30	756-0191		Pulley with 9 Tooth Sprocket Ass'y.	
5	12605		Engagement Brkt. Ass'y.		31	756-0192		Plastic Flat Idler	
6	736-0329		L-Wash. 1/4" Scr. *		32	736-0119		L-Wash. 5/16" Scr. *	
7	712-0287		Hex Nut 1/4-20 Thd. *		33	712-0267		Hex Nut 5/16-18 Thd. *	
8	746-0260		Clevis Lanyard Fitting		34	738-0138		Shld. Scr. .437 Dia. x .470	
9	732-0250		Extension Spring		35	756-0115		Engine Pulley	
10	726-0111		Push Cap .188"		36	754-0935		V-Belt 1/2 x 31" Lg.	
11	736-0300		Fl.-Wash. .385 I.D. x .87 O.D.		37	736-0160		Fl.-Wash. .531 I.D. x .930 O.D.	
12	12313		Rear Shaft Ass'y.		38	714-0115		Cotter Pin 1/8" Dia. x 1.00" Lg. *	
13	736-0192		Fl.-Wash. .531 I.D. x .93 O.D.		39	710-0615		Hex Scr. 3/8-16 x 5.00" Lg. *	
14	748-0142		Flange Bearing		40	736-0219		Belleville Wash. .400 I.D. x 1.13 O.D.	
15	712-0181		Hex Top L-Nut 3/8-16 Thd.		41	750-0263		Spacer .50 O.D. x .38 I.D. x .90" Lg.	
16	10638		Pivot Brkt. Ass'y.—L.H.		42	736-0300		Fl.-Wash. .385 I.D. x .87 O.D.	
	10639		Pivot Brkt. Ass'y.—R.H.		43	750-0261		Spacer .62 O.D. x .38 I.D. x 2.00" Lg.	
17	736-0219		Belleville Wash. .400 I.D. x 1.13 O.D.		44	712-0287		Hex Nut 1/4-20 Thd. *	
18	713-0144		Roller Chain #48 x 31 Links		45	726-0163		Push Clip	
19	713-0122		Master Link #48		46	748-0142		Flange Bearing	
20	738-0137		Shld. Scr. .342 Dia. x .268		47	12967		Support Link	
21	748-0188		Pawl		48	750-0289		Spacer	
22	10647 —463		Hub Cap—Rear		49	746-0306		Clutch Cable	
23	712-0219		Elastic Stop Nut 1/4-20 Thd.						
24	710-0407		Slot Hex Hd. Self Extr. Scr. #8-32 x .50" Lg.						
25	10622		Nylon Spring						
26	714-0115		Cotter Pin 1/8" Dia. x 1.00" Lg. *						

*For faster service, obtain standard nuts, bolts and washers locally. If these items cannot be obtained locally, order by part number and size as shown on the parts list.

(463—Top Flite Red) When ordering parts if color or finish is important, use the appropriate color code shown at left (e.g. Top Flite Red Finish—12429 (463).)

The engine is not under warranty by the mower manufacturer. If repairs or service is needed on the engine, please contact your nearest authorized engine service outlet. Check the "Yellow Pages" of your telephone book under "Engines — Gasoline."



128-350A

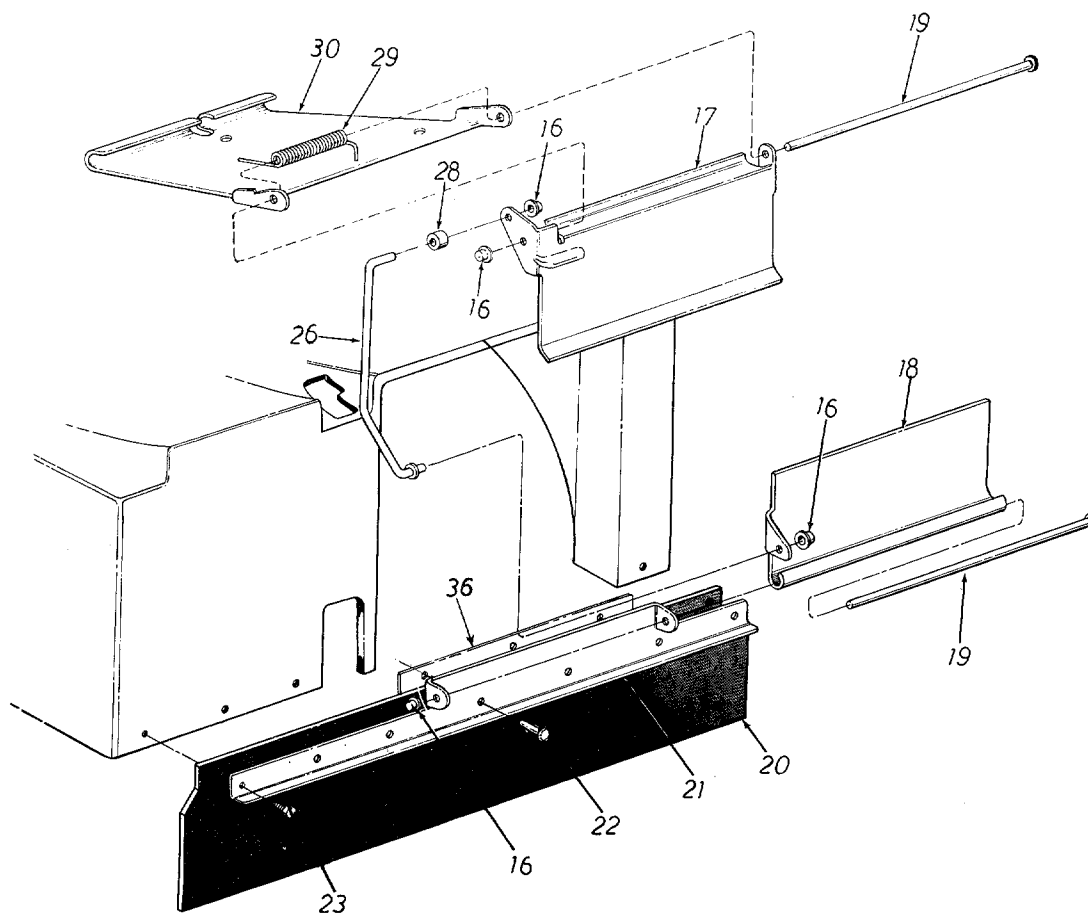
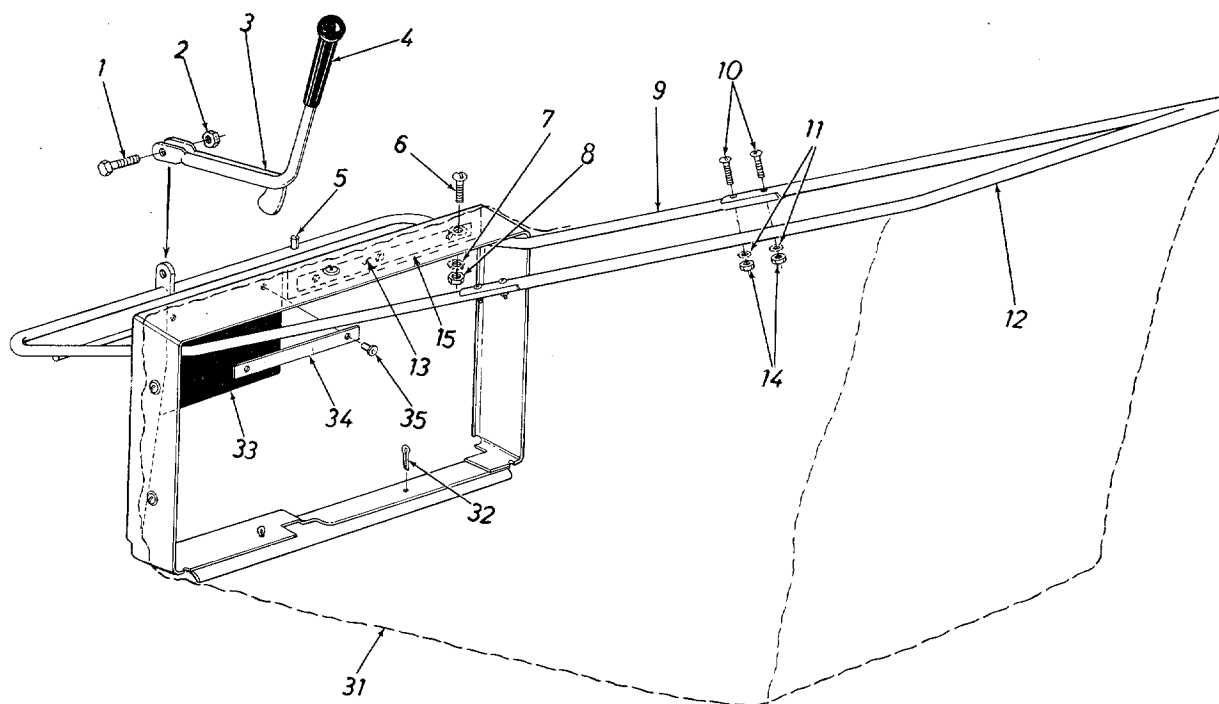

PARTS LIST FOR MODEL 128-350A

REF. NO.	PART NO.	COLOR CODE	DESCRIPTION	NEW PART	REF. NO.	PART NO.	COLOR CODE	DESCRIPTION	NEW PART
1	710-0117		Hex Scr. 5/16-24 x 1.00" Lg. *		17	12395		Chute Door—Upper Half	
2	712-0237		Hex Center L-Nut 5/16-24 Thd.		18	12194		Chute Door—Lower Half	
3	12393		Cam Lever Ass'y.		19	738-0253		Hinge Rod	
4	720-0143		Grip		20	735-0169		Rear Protective Flap	
5	715-0247		Spring Pin Spiral		21	12305		Rear Safety Shield Plate	
6	710-0192		Truss Mach. Scr. #10-24 x .38" Lg.		22	728-0123		Rivet*	
7	736-0147		Ext. L-Wash. #10 Scr. *		23	710-0436		Hex B-Tapp Scr. #10Z x .62" Lg. *	
8	712-0121		Hex Nut #10-24 Thd. *		26	747-0141		Connecting Rod	
9	12579		Catcher Frame Ass'y. Lower Half		28	748-0246		Roller Spacer	
10	710-0467		Rd. Hd. Mach. Scr. #10-24 x 1.00" Lg. *		29	732-0295		Torsion Spring	
11	736-0147		Ext. L-Wash. #10 Scr. *		30	12192		Grass Catcher Adapter	
12	749-0234		Frame—Rear Half		31	764-0150		Bag	
13	12316		Reinforcement Bar		32	714-0115		Cotter Pin 1/8" Dia. x 1.00" Lg. *	
14	712-0121		Hex Nut #10-24 Thd. *		33	735-0184		Grass Catcher Flap	
15	735-0183		Grass Catcher Flap		34	12185		Reinforcement Bar	
16	726-0135		Push Nut 5/16" Rod		35	728-0123		Rivet	
					36	12316		Reinforcement Bar	

*For faster service obtain standard nuts and bolts locally. If these items cannot be obtained locally, order by part number and size as shown on the parts list.

(463—Top Flite Red) When ordering parts, if color or finish is important, use the appropriate color code shown at left. (e.g. Top Flite Red Finish—12609 (463).)

The engine is not under warranty by the mower manufacturer. If repairs or service is needed on the engine, please contact your nearest authorized engine service outlet. Check the "Yellow Pages" of your telephone book under "Engines — Gasoline."



128-350A

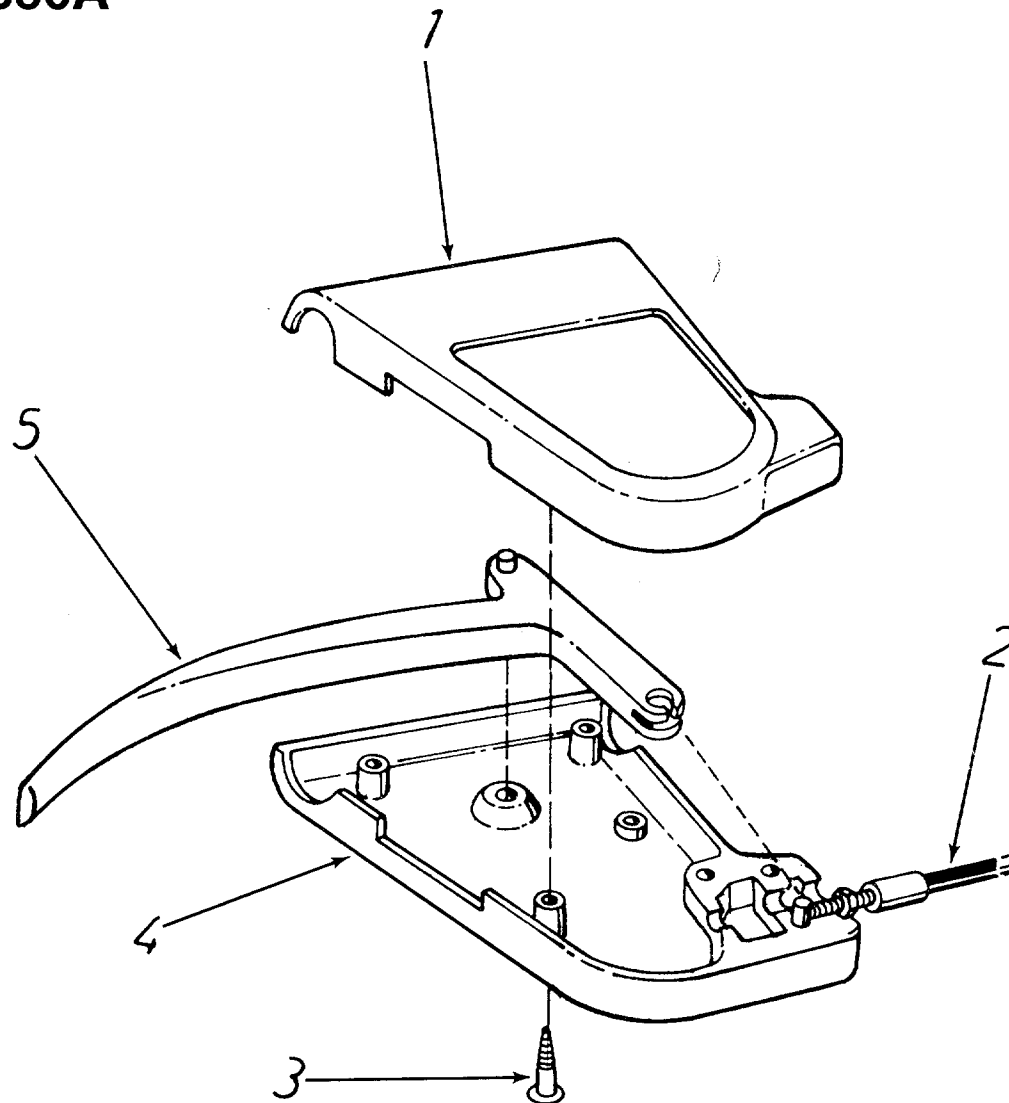

PARTS LIST FOR CONTROL LEVER ASSEMBLY BREAKDOWN 128-350A

REF. NO.	PART NO.	COLOR CODE	DESCRIPTION	NEW PART
1	731-0407		Front Cover Control	
2	746-0306		Control Cable 58" Lg. w/6" Ext.	
3	710-0535		Slotted Oval Self Tap Scr. #10 x .87" Lg.	
4	731-0408		Rear Control Cover	
5	731-0406		Lever Clutch Control	

*For faster service obtain standard nuts and bolts locally. If these items cannot be obtained locally, order by part number and size as shown on the parts list.

(463—Top Flite Red)
When ordering parts, if color or finish is important use the appropriate color code shown above. (e.g. Top Flite Red Finish—12609 (463).)

NOTE: The engine is not under warranty by the mower manufacturer . . . If repairs or service is needed on the engine, please contact your nearest authorized engine service outlet. Check the "Yellow Pages" of your telephone book under "Engines—Gasoline."



PARTS INFORMATION

POWER EQUIPMENT PARTS AND SERVICE

Parts and service for all MTD manufactured power equipment are available through the authorized service firms listed below. All orders should specify the model number of your unit, parts number, description of parts and the quantity of each part required.

ALABAMA	BIRMINGHAM	
Auto Electric & Carburetor Co.	2625 4th Ave. S.	35233
ARKANSAS	NORTH LITTLE ROCK	
Sutton's Lawn Mower Shop	Rt. 4, Box 368	72117
	FORT SMITH	
Mity Mite Motors, Inc.	2515 Towson Ave.	72901
CALIFORNIA	PORTERVILLE	
Billious	75 North D Street	93257
	SAN BERNARDINO	
Lawn Mower Supply Co.	25608 E. Baseline	92410
	SAN FRANCISCO	
J.W. Jewett Co.	981 Folsom St.	94107
	SACRAMENTO	
Luttig & Severson	2030 28th St.	95818
COLORADO	DENVER	
South Denver Lawn Equip.	527 West Evans	80223
CONNECTICUT	SUFFIELD	
The Jones & Ramsey Co.	850 Thompsonville Rd.	06078
FLORIDA	JACKSONVILLE	
Radco Distributors	2403 Market St.	32206
	CORAL GABLES	
Moz-All of Florida, Inc.	365 Greco Ave.	33146
GEORGIA	EAST POINT	
East Point Cycle & Key	2834 Church St.	30344
ILLINOIS	LYONS	
Keen Edge Co.	8615 Ogden Ave.	60534
INDIANA	ELKHART	
Parts & Sales Inc.	2101 Industrial Pkwy.	46514
IOWA	DUBUQUE	
Power Lawn & Garden Equip.	2551 J.F. Kennedy	52001
LOUISIANA	NEW ORLEANS	
Suhren Engine Co.	8330 Earhart Blvd.	70118
MARYLAND	TAKOMA PARK	
Center Supply Co.	6867 New Hampshire Ave.	20012
MASSACHUSETTS	SPRINGFIELD	
Morton B. Collins Co.	300 Birnie Ave.	01107
MICHIGAN	MOUNT CLEMENS	
Power Equipment Dist.	36463 South Gratiot	48043
	LANSING	
Lorenz Service Co.	2500 S. Pennsylvania	48900
MINNESOTA	MINNETONKA	
Hance Distributing Inc.	11212 Wayzata Blvd.	55343
MISSISSIPPI	BILOXI	
Biloxi Sales & Service, Inc.	506 Caillavet St.	39533
MISSOURI	KANSAS CITY	
Automotive Equip. Service	3117 Holmes St.	64109
	ST. LOUIS	
Henzler, Inc.	2015 Lemay Ferry Rd.	63125
NEW JERSEY	BELLMAWR	
Lawnmower Parts Inc.	717 Creek Rd., P.O. Box 7	08030

BRIGGS & STRATTON, TECUMSEH AND PEERLESS PARTS AND SERVICE

Briggs & Stratton, Tecumseh and Peerless parts a service should be handled by your nearest authorized engine service firm. Check the yellow pages of your telephone directory under the listing **Engines—Gasoline**, Briggs & Stratton or Tecumseh Lauson.

NEW YORK	CARTHAGE	
Gamble Dist., Inc.	West End Ave.	13619
NORTH CAROLINA	GREENSBORO	
Dixie Sales Company	327 Battleground Ave.	27402
	GOLDSBORO	
Smith Hardware Co.	515 N. George St.	27530
OHIO	WADSWORTH	
National Central	687 Seville Rd.	44281
	CLEVELAND	
Bleckrie, Inc.	7900 Lorain Ave.	44102
	CARROLL	
Stebe's Mid-State Mower Supply	Box 366	43112
	WILLARD	
Sunshine Wholesale Tire Outlet	Route 224	44890
OKLAHOMA	MUSKOGEE	
Victory Motors, Inc.	605 S. Cherokee	74401
	ADA	
Ada Auto Supply	301 E. 12th St.	74820
OREGON	PORTLAND	
Kenton Supply Co.	8216 N. Denver Ave.	97217
PENNSYLVANIA	LANCASTER	
Raub Supply Co.	James & Mulberry Sts.	17604
	PITTSBURGH	
Bluemont Co.	11125 Frankstown Rd.	15235
TENNESSEE	KNOXVILLE	
Master Repair Service	2423 Broadway, N.E.	37917
	MEMPHIS	
Memphis Cycle & Supply Co.	421 Monroe Ave.	3810
American Sales & Service, Inc.	1922 Lynnbrook	381
TEXAS	DALLAS	
Marr Brothers, Inc.	423 E. Jefferson	75203
	HOUSTON	
Bullard Supply Co.	2409 Commerce St.	77003
	SAN ANTONIO	
Catto & Putty, Inc.	P.O. Box 2408	78206
	FORT WORTH	
Woodson Sales Corp.	1702 N. Sylvania	76111
UTAH	SALT LAKE CITY	
A-1 Engine & Mower Co.	437 E. 9th St.	84111
VERMONT	BURLINGTON	
Vermont Appliance Co.	44 Lakeside Ave.	05401
VIRGINIA	RICHMOND	
RBI Corp.	963 Myers St.	23260
WASHINGTON	SEATTLE	
Bailey's Rebuild, Inc.	1325 E. Madison St.	98102
WEST VIRGINIA	CHARLESTON	
Young's, Inc.	233 Virginia St., E.	25301
WISCONSIN	APPLETON	
Automotive Supply Co.	123 S. Linwood Ave.	54911

WARRANTY PARTS AND SERVICE POLICY

The purpose of warranty is to protect the customer from defects in workmanship and materials, defects which are NOT detected at the time of manufacture. It does not provide for the unlimited and unrestricted replacement of parts. Use and maintenance are the responsibility of the customer. The manufacturer cannot assume responsibility for conditions which it has no control. Simply put, if it's the manufacturer's fault, it's the manufacturer's responsibility; if it's the customer's fault, it's the customer's responsibility.

CLAIMS AGAINST THE MANUFACTURER'S WARRANTY INCLUDES

1. Replacement of Missing Parts on new equipment.
2. Replacement of Defective Parts within the warranty period.
3. Repair of Defects within the warranty period.

All claims MUST be substantiated with the following information:

1. Model Number of unit involved.
2. Date unit was purchased or first put into service.
3. Date of failure.
4. Nature of failure.