

OWNER'S MANUAL

- ASSEMBLY
- OPERATION
- MAINTENANCE
- PARTS LIST

Model Nos.
127-335A
127-335-300

Important:

**Read Safety Rules and
Instructions Carefully**

**20''
REAR DISCHARGE
SELF PROPELLED
ROTARY MOWER**

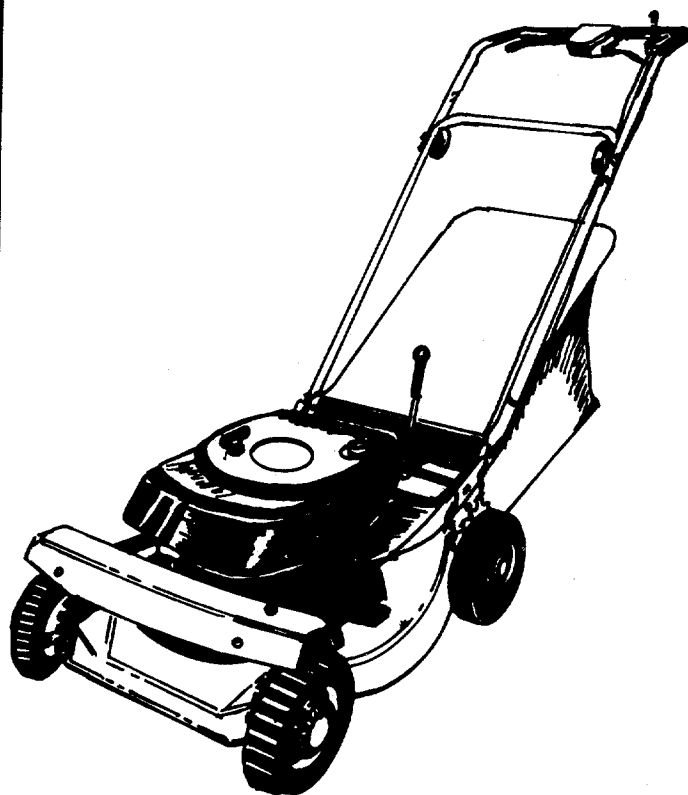

IMPORTANT

It is suggested that this manual be read in its entirety before attempting to assemble or operate. Keep this manual in a safe place for future reference and for ordering replacement parts.

This unit is shipped WITHOUT GASOLINE or OIL. After assembly, see operating section of this manual for proper fuel and amount.

Your rotary mower is a precision piece of power equipment, not a plaything. Therefore exercise extreme caution at all times.

SAFE OPERATION PRACTICES FOR WALK-BEHIND MOWERS

TRAINING

1. Read the Operating and Service Owner's Manual carefully. Be thoroughly familiar with the controls and the proper use of the equipment.
2. Never allow children to operate a power mower. Only persons well acquainted with these rules of safe operation should be allowed to use your mower.
3. Keep the area of operation clear of all persons, particularly small children and pets. Stop engine when they are in the vicinity of your mower. Although the area of operation should be completely cleared of foreign objects, a small object may have been overlooked and could be accidentally thrown by the mower in any direction.

PREPARATION

1. Thoroughly inspect the area where the equipment is to be used and remove all stones, sticks, wire, bones and other foreign objects which could be picked up and thrown by the mower in any direction.
2. Do not operate equipment when barefoot or wearing open sandals. Always wear substantial footwear.
3. Do not wear loose fitting clothing that could get caught on the mower.
4. Check the fuel before starting the engine. Do not fill the gasoline tank indoors, when the engine is running, or while the engine is still hot. Wipe off any spilled gasoline before starting the engine.
5. Disengage the self-propelled mechanism or drive clutch on units so equipped before starting the engine.
6. Never attempt to make a wheel or cutting height adjustment while the engine is running.
7. Mow only in daylight or in good artificial light.
8. Never operate the equipment in wet grass. Always be sure of your footing; keep a firm hold on the handle and walk, never run.

OPERATION

1. Do not change the engine governor settings or overspeed the engine. Excessive engine speeds are dangerous.
2. Do not put hands or feet near or under rotating parts. Keep clear of the discharge opening at all times.
3. Stop the blade(s) when crossing gravel drive, walks or roads.
4. After striking a foreign object, stop the engine, remove the wire from the spark plug, thoroughly inspect the mower for any

damage, and repair the damage before restarting and operating the mower.

5. If the equipment should start to vibrate abnormally, stop the engine and check immediately for the cause. Vibration is generally a warning of trouble.
6. Stop the engine whenever you leave the mower, before cleaning the mower housing, and when making any repairs or inspections.
7. When cleaning, repairing or inspecting, make certain the blade and all moving parts have stopped. Disconnect the spark plug wire, and keep the wire away from the plug to prevent accidental starting.
8. Before attempting to unclog the mower or discharge chute, stop the engine and be sure the blade(s) have stopped completely. Disconnect the spark plug wire and keep the wire away from the plug to prevent accidental starting.
9. Do not run the engine indoors.
10. Shut the engine off and wait until the blade comes to a complete stop before removing the grass catcher.
11. Mow across the face of slopes, never up-and-down. Exercise extreme caution when changing direction on slopes. Do not mow excessively steep slopes.
12. Always disconnect electric mowers (line operated) before cleaning, repairing or adjusting.
13. Never operate mower without proper guards, plates or other safety protective devices in place.
14. Keep washout ports and other mower-housing service openings closed when mowing.
15. **DO NOT OPERATE** this mower with the chute doors open, unless the complete grass catcher is properly mounted on the mower.

MAINTENANCE AND STORAGE

1. Check the blade and engine mounting bolts at frequent intervals for proper tightness.
2. Keep all nuts, bolts, and screws tight to be sure the equipment is in safe working condition.
3. Never store the equipment with gasoline in the tank inside of a building where fumes may reach an open flame or spark. Allow the engine to cool before storing in any enclosure.
4. To reduce fire hazard, keep the engine free of grass, leaves, or excessive grease.
5. Check the grass catcher bag frequently for wear or deterioration. For safety protection replace only with new bag meeting original equipment specifications.

ASSEMBLY

NOTE

Reference to Left or Right side of machine is from operator's position at the handle facing forward.

The Lawn Mower, except the handle, throttle control and grass catcher is fully assembled, packed and shipped in one container.

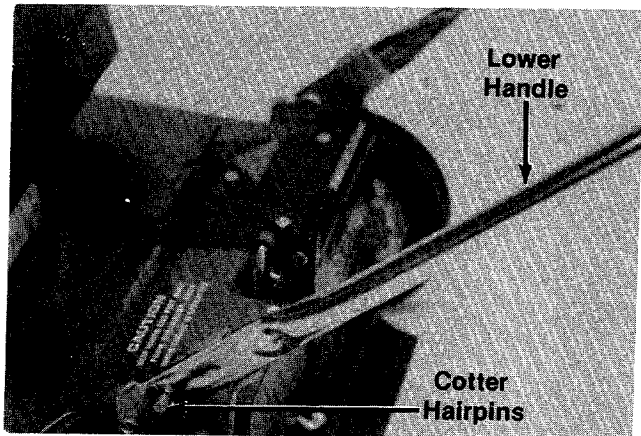

FIGURE 1

ATTACHING THE HANDLE

1. The throttle is attached to the engine. Extend the throttle control and lay it on the floor. Be careful not to bend or kink the wire.
2. Attach the lower handle over the pins on the handle brackets located on the rear of the mower. (See figure 1.)

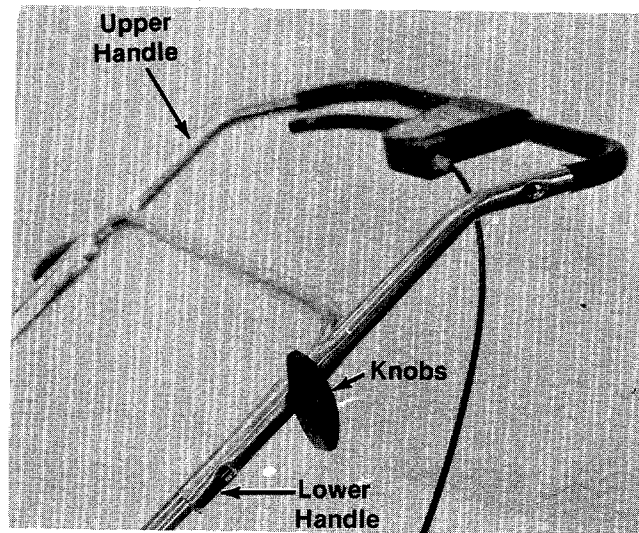

FIGURE 2

NOTE

It may be necessary to squeeze the ends of the lower handle in slightly to assure a snug fit against the handle brackets.

NOTE

There are two (2) holes in the handle mount brackets. Place the lower handle against the brackets and secure with hair pin in second hole. Second hole is for operation. First hole is for storage.

3. Place the two cotter hairpins in the holes in the pins.
4. Assemble the upper handle with the engagement lever attached, to the lower handle with the two knobs. Make sure the single hole for the throttle is on the left side of the handle. The knobs can be either to the inside or the outside of the handle. (See figure 2.)

NOTE

There are two height positions for the handle. See the Operation section of this handbook for adjustment.

5. Assemble the throttle control to the upper handle with the nut and bolt. (See figure 3.)

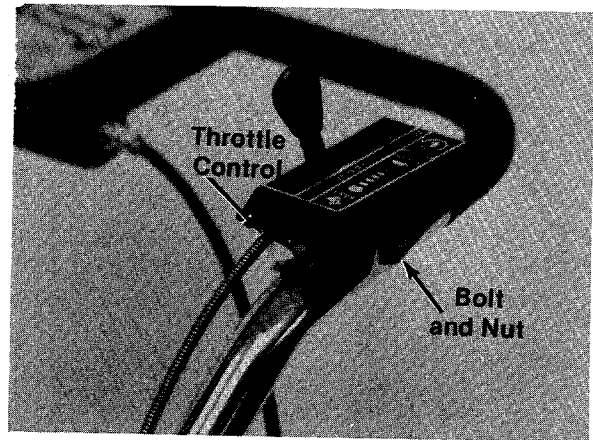
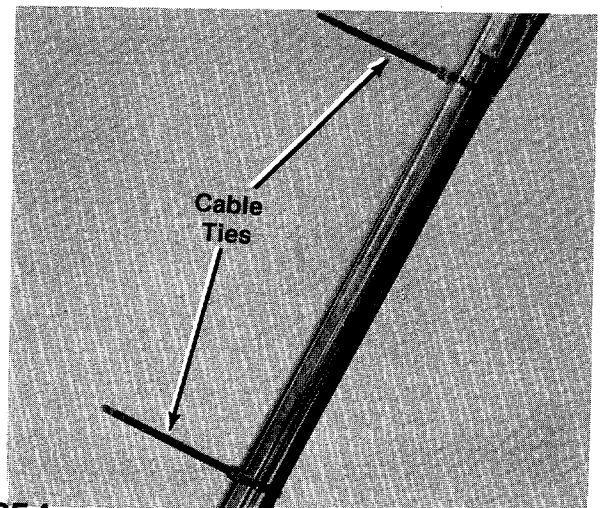

FIGURE 3

6. Secure the throttle control wire and clutch wire to the lower handle with the cable ties. (See figure 4.)



3 FIGURE 4

ASSEMBLY—GRASS CATCHER

The grass catcher is partially assembled. The hardware needed is in the hardware pack. It consists of:

- 7 bolts 3/8" long
- 4 bolts 1" long
- 11 lockwashers
- 11 nuts
- 2 cotterpins

1. Thread the rear frame through the bag. See figure 5.
2. Place the ends of the upper frame inside the bag.
3. Assemble the rear frame to the front frame with the four 1" bolts, lockwashers and nuts. See figure 6.
4. Fasten the bag to the frame with the 7 bolts 3/8" long, lockwashers and nuts. Start the three holes on the top of the bag, then do both sides.
5. Fit the lower edge of the bag into the slot in the bottom of the front frame and place the two cotter pins through the eyelets in the bag.
6. Open up the legs of the cotter pins to secure them.

7. Close the top of the bag by stretching the elastic over the upper frame.



WARNING

Never operate the mower with the bag open.

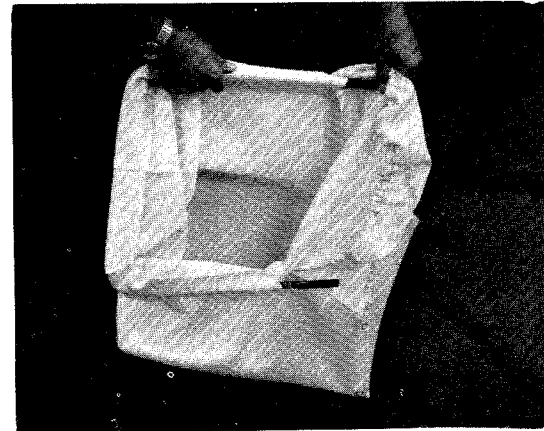

FIGURE 5

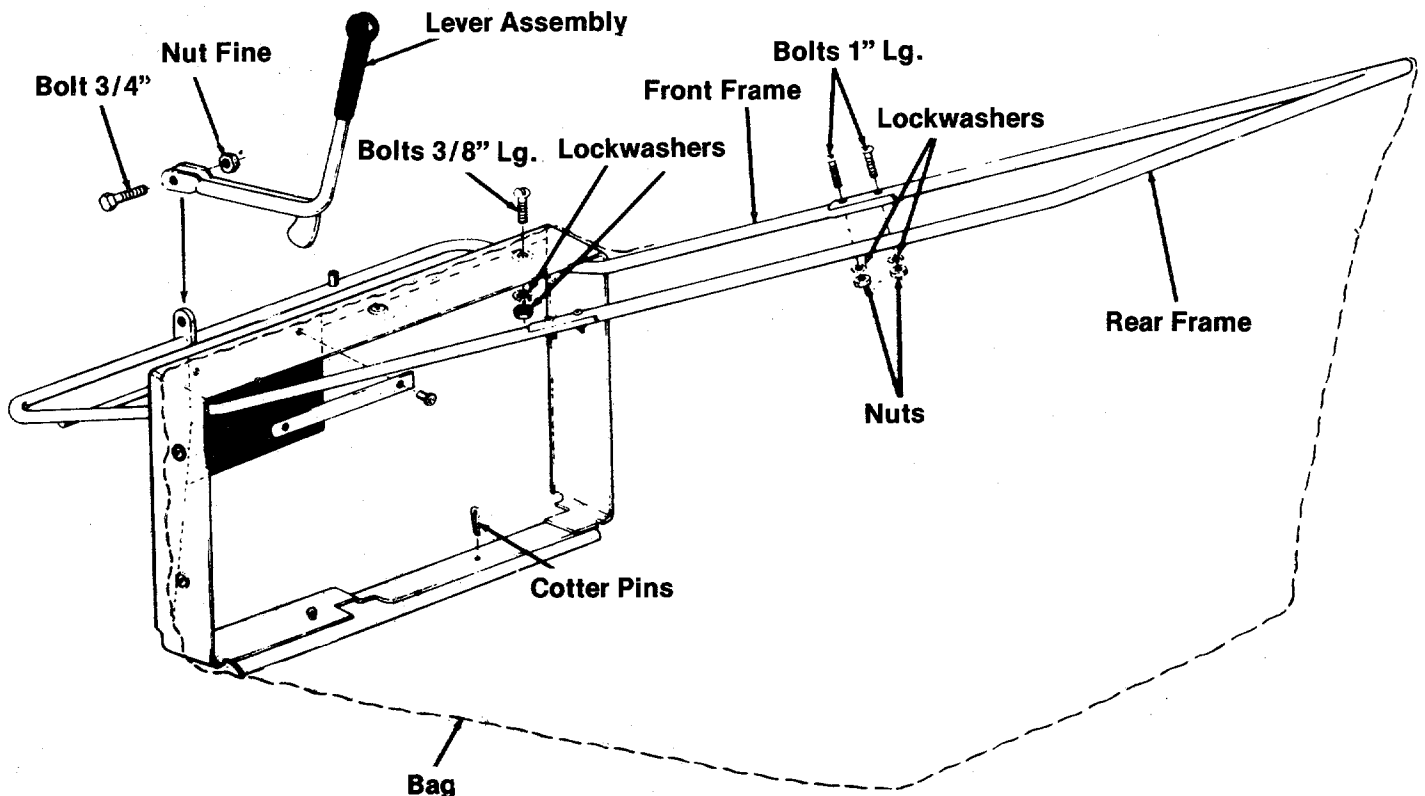

FIGURE 6

OPERATION

Before starting the engine fill the crankcase with oil.



WARNING

The mower shall not be operated without the entire grass catcher or rubber protective shield in place.



NOTE

Under normal usage the grass catcher bag material is subject to wear and should be checked periodically.

This mower is designed to be operated at full throttle to give you the best cut and do the most effective job of bagging the cut grass.

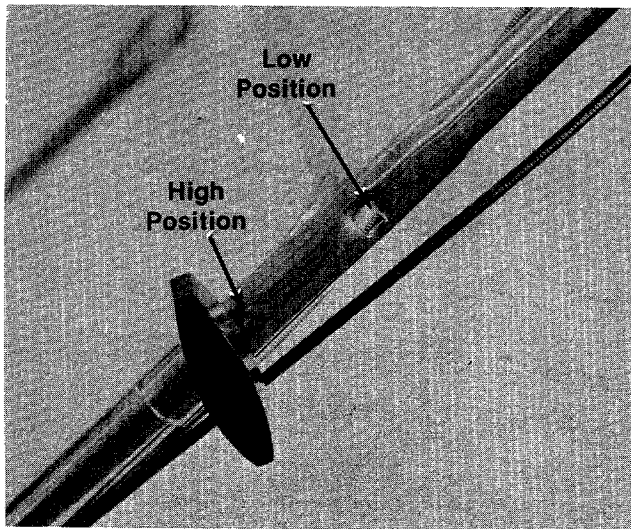

FIGURE 7

HANDLE POSITION

The upper handle can be adjusted to a high or low position. The operator of the lawn mower can easily adjust the handle position by unscrewing the two knobs, removing the two bolts and reassembling in the other position. No tools are necessary to make this adjustment. (See figure 7.)

ATTACHING GRASS CATCHER

The doors shown in figure 8 cannot be opened to discharge the grass unless the grass catcher is in place.



WARNING

Under no circumstances should the doors be opened while the engine is operating.

1. Attach the grass catcher frame to the front of the adapter as shown in figure 9.
2. Push down on the back of the bag until the entire grass catcher seats into the bracket.
3. Move the locking lever towards the rear of the mower. (See figure 10.) This locks the grass catcher in place and opens the doors.
4. To remove the grass catcher, unlock the locking lever and lift off the grass catcher.

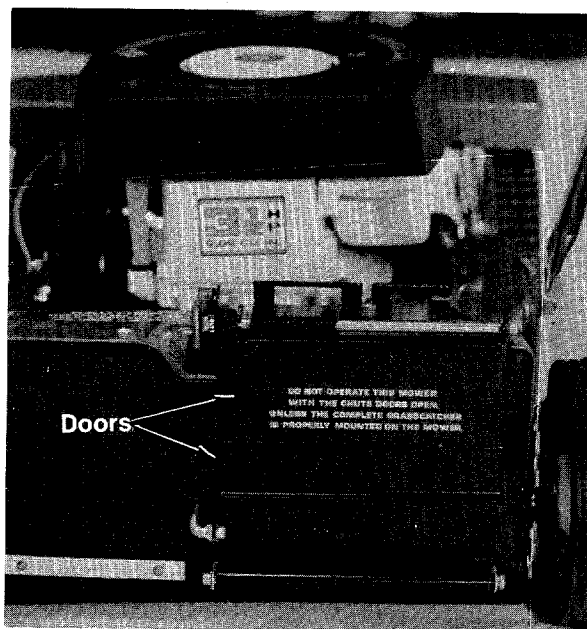

FIGURE 8

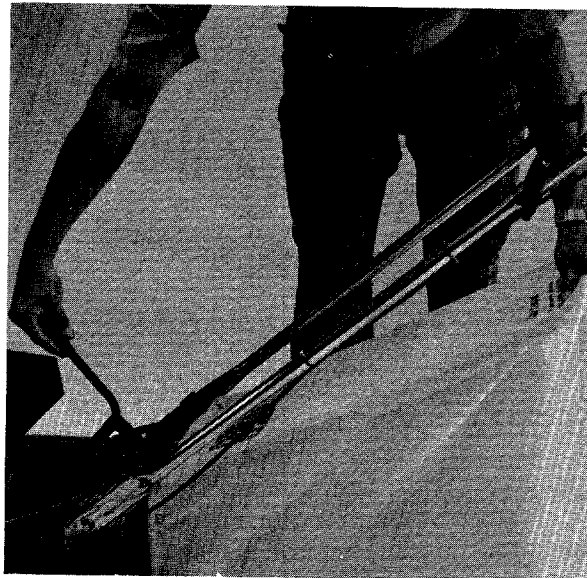

FIGURE 9



FIGURE 10

THROTTLE CONTROL

Your engine has an automatic choke. The throttle control is used to regulate the engine speed and stop the engine. The engine can be started with the throttle control lever anywhere in the START position. Move the throttle control to the rear to the STOP position to stop the engine. (See figure 11.)

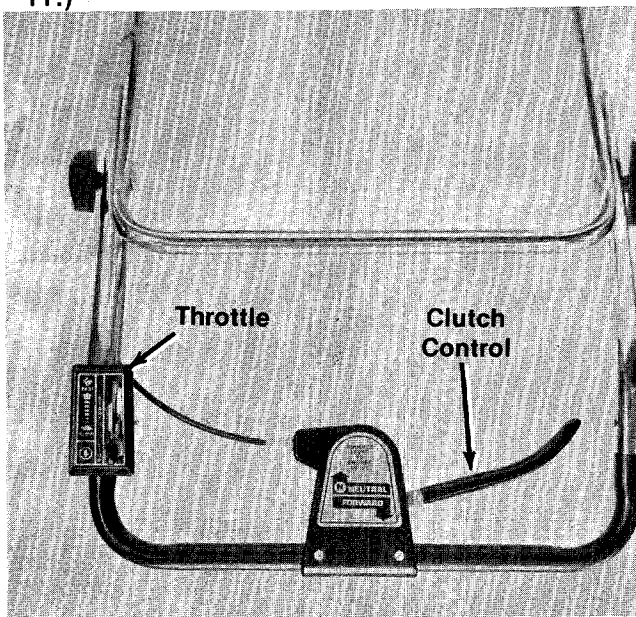

FIGURE 11

Squeezing the clutch control engages the drive mechanism to the front wheels. Releasing the clutch control stops the front wheels from driving. Release the clutch control to slow down when negotiating an obstacle, making a turn or stopping. (See figures 12 and 13.)

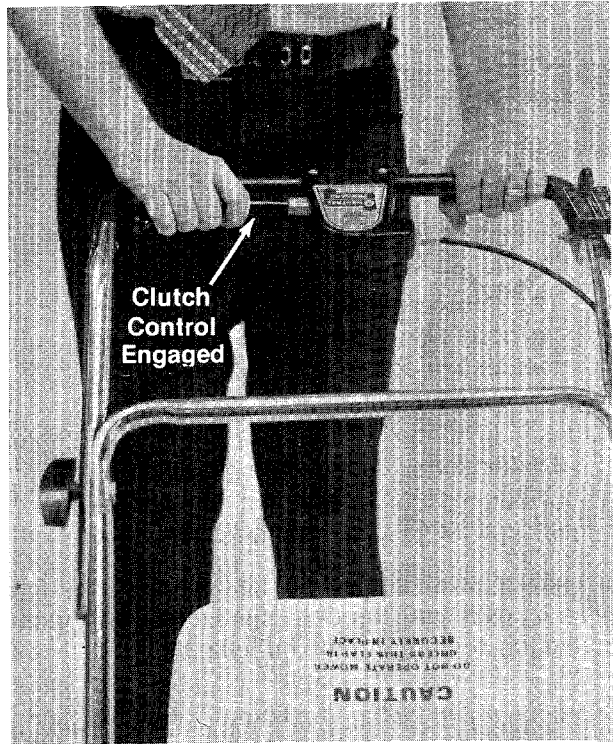

FIGURE 12



The blade continues to rotate when the clutch is released.

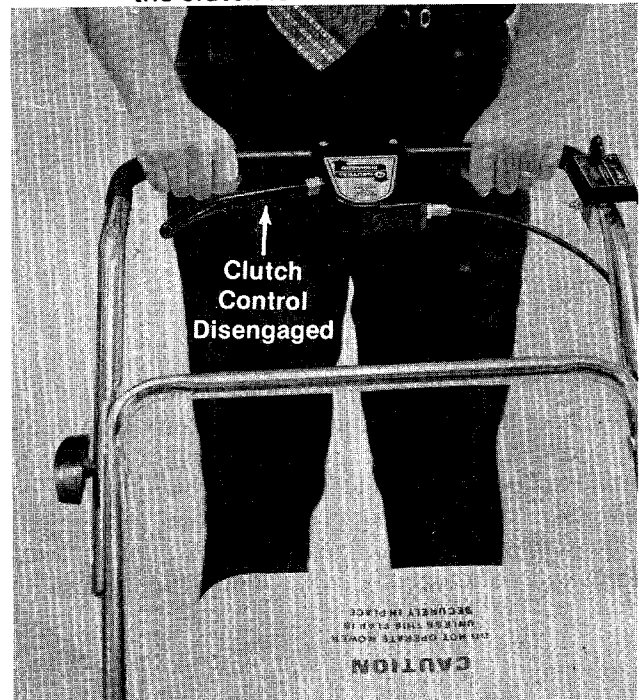

FIGURE 13

Start the engine from the right side by lifting up on the starter handle and placing your foot on the mower deck. (See figure 14.)



FIGURE 14
HEIGHT ADJUSTMENT



Before changing the cutting height, stop the engine and disconnect the spark plug wire. Adjustments may be made by moving the height adjustment lever on each wheel to the desired position. (See figure 15.) There are five cutting heights. All four height adjusters should be in the same relative position.



FIGURE 15

HANDLE STORAGE

The handle can be stored in the upright position to take less room. Grasp the lower handle at the bottom, pull apart slightly and tip the handle forward. It will lock in this position. Reverse this procedure to place the handle in the operating position. (See figure 16.)

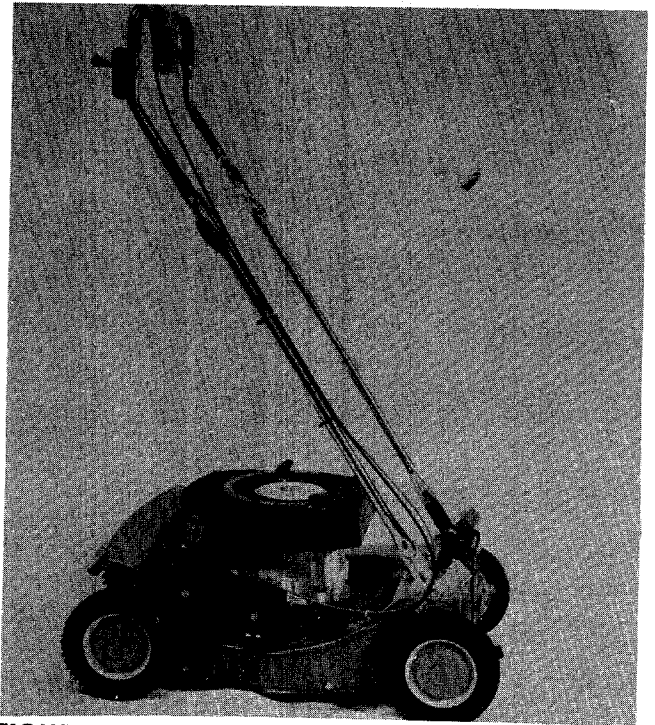

FIGURE 16
FOLDING THE HANDLE

The handle can be folded completely for storage. To fold the handle, loosen the black plastic knobs on each side of the handle, swing the upper handle down as you pivot the lower handle forward. (See figures 17 and 18.)

The following maintenance and adjustment instructions are primarily for the mower. For the engine refer to the Engine Operating and Maintenance manual packed with this mower.



FIGURE 17

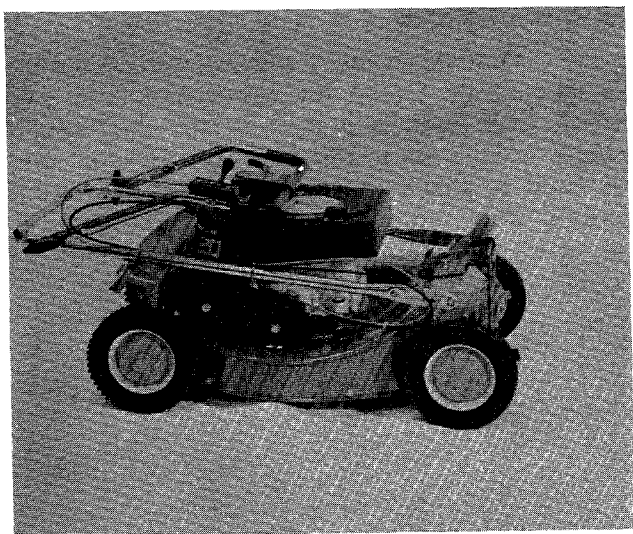

FIGURE 18

MAINTENANCE

WHEEL LUBRICATION

Each rear wheel has two ball bearings and each front wheel has a sintered iron sleeve bearing that requires periodic lubrication. Place a few drops of light oil on each bearing at the start of each mowing season.

CUTTING BLADE

The blade may be removed for sharpening or replacement as follows:

1. Remove the large bolt and lockwasher holding the blade and adapter to the engine crankshaft.
2. Remove the blade and adapter from the crankshaft.
3. Be careful not to lose the key on the crankshaft. (See figure 19.)

When sharpening the blade, follow the original angle of grind as a guide. It is extremely important that each cutting edge receives an equal amount of grinding to prevent an unbalanced blade. An unbalanced blade will cause excessive vibration when rotating at high speeds and may cause damage to the mower.

The blade can be tested for balance by balancing it on a screwdriver. Remove metal from the heavy side until it balances evenly. (See figure 20.)

NOTE

When replacing the blade, be sure the side of the blade marked "Bottom" or having the part number is facing the ground when the mower is in the operating position.

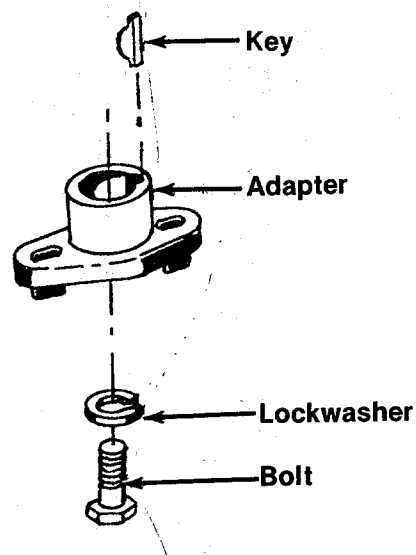

FIGURE 19

CLUTCH CONTROL ADJUSTMENT

1. To increase belt tension, loosen jam nut and backoff two or three threads. (See figure 20.)
2. Thread the barrel nut on end of control cable inward two or three threads, and retighten jam nut.
3. To decrease belt tension, loosen jam nut and back off two or three threads.
4. Thread the barrel nut on end of control cable outward two or three threads, and retighten jam nut.

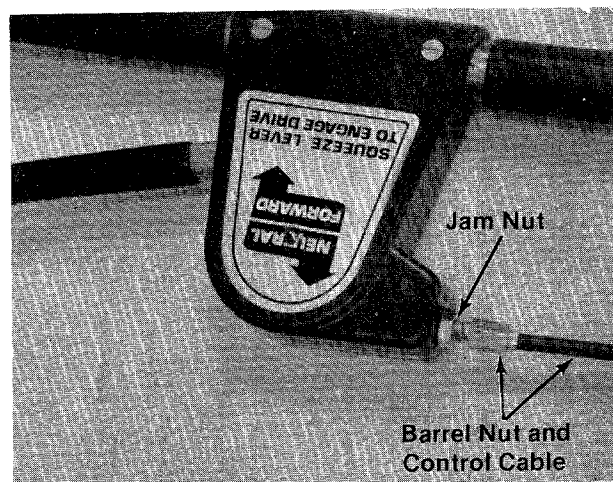

FIGURE 20

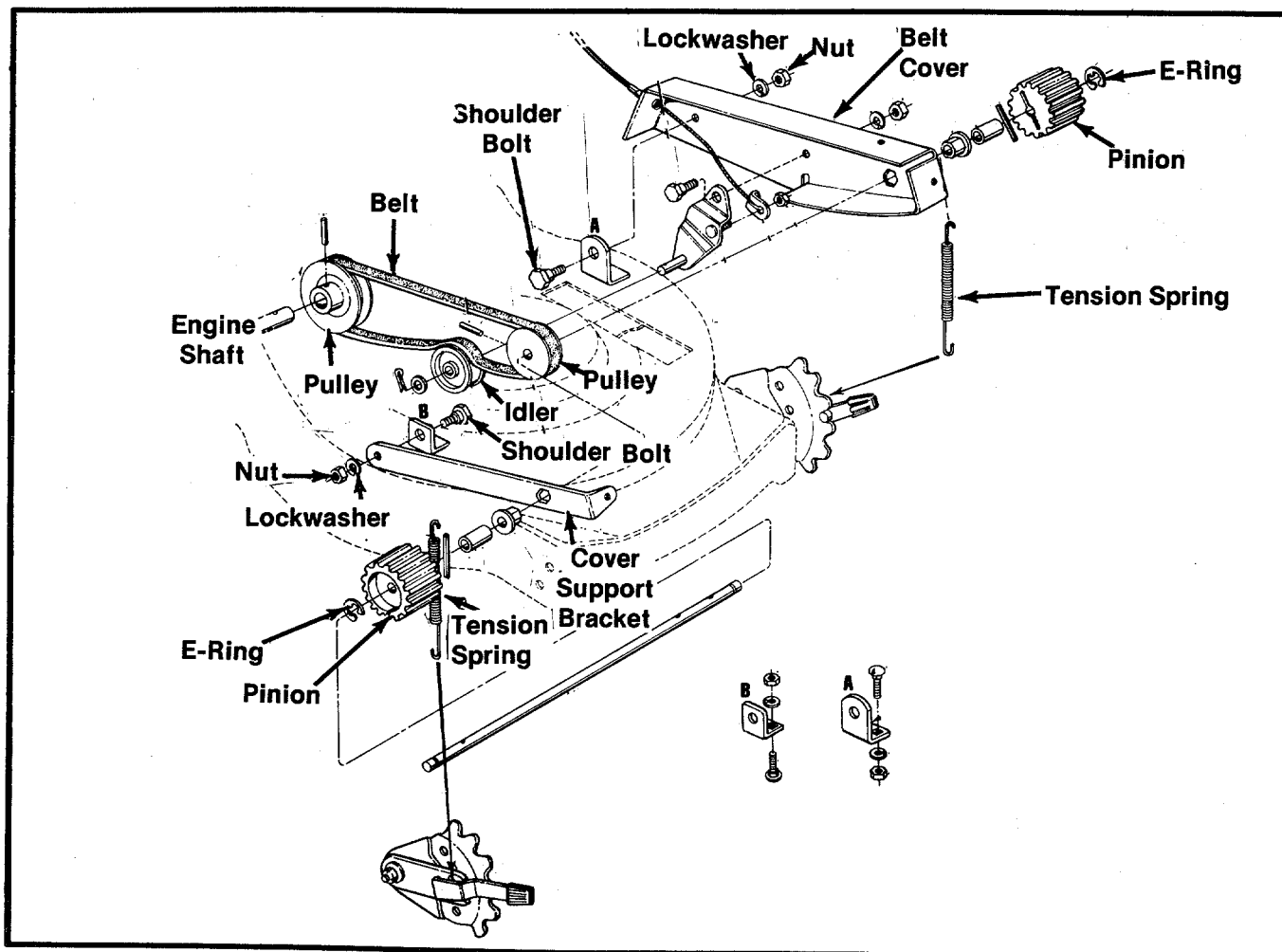

FIGURE 21

BELT REMOVAL

1. Remove both tension springs. (See figure 21.)
2. Remove the pinion cover.
3. Using a screw driver remove the E-rings and pinions on both wheels.
4. Remove the shoulder bolt, lockwashers and nut on the belt cover.
5. Slide the belt cover to the left.
6. Unhook the belt from the idler and the pulleys.
7. Remove the shoulder bolt, lockwasher and nut from the cover support bracket.
8. Remove belt and reassemble in reverse order with a new belt.

OFF-SEASON STORAGE

If the machine is to be inoperative for a period longer than 30 days, the following procedures are recommended:

1. Working outdoors, drain all fuel from the fuel tank. Use a clean dry cloth to absorb the small amount of fuel remaining in the tank, then run the engine until all fuel in the carburetor is exhausted.



WARNING

- Do not drain fuel while smoking, or if near an open fire.
2. Drain all the oil from the crankcase (this should be done after the engine has been operated and is still warm) and refill the crankcase with clean new oil.
 3. Disconnect the spark plug wire and remove the spark plug from the cylinder. Pour about 2 or 3 tablespoons of engine oil into the cylinder, and then turn the engine over several times to spread out the oil. Replace the spark plug, but do not connect the wire.
 4. Clean the engine and the entire mower thoroughly.

127-335A

SEE SUPP SHEET WHEN
ORDERING PARTS FOR
CLUTCH

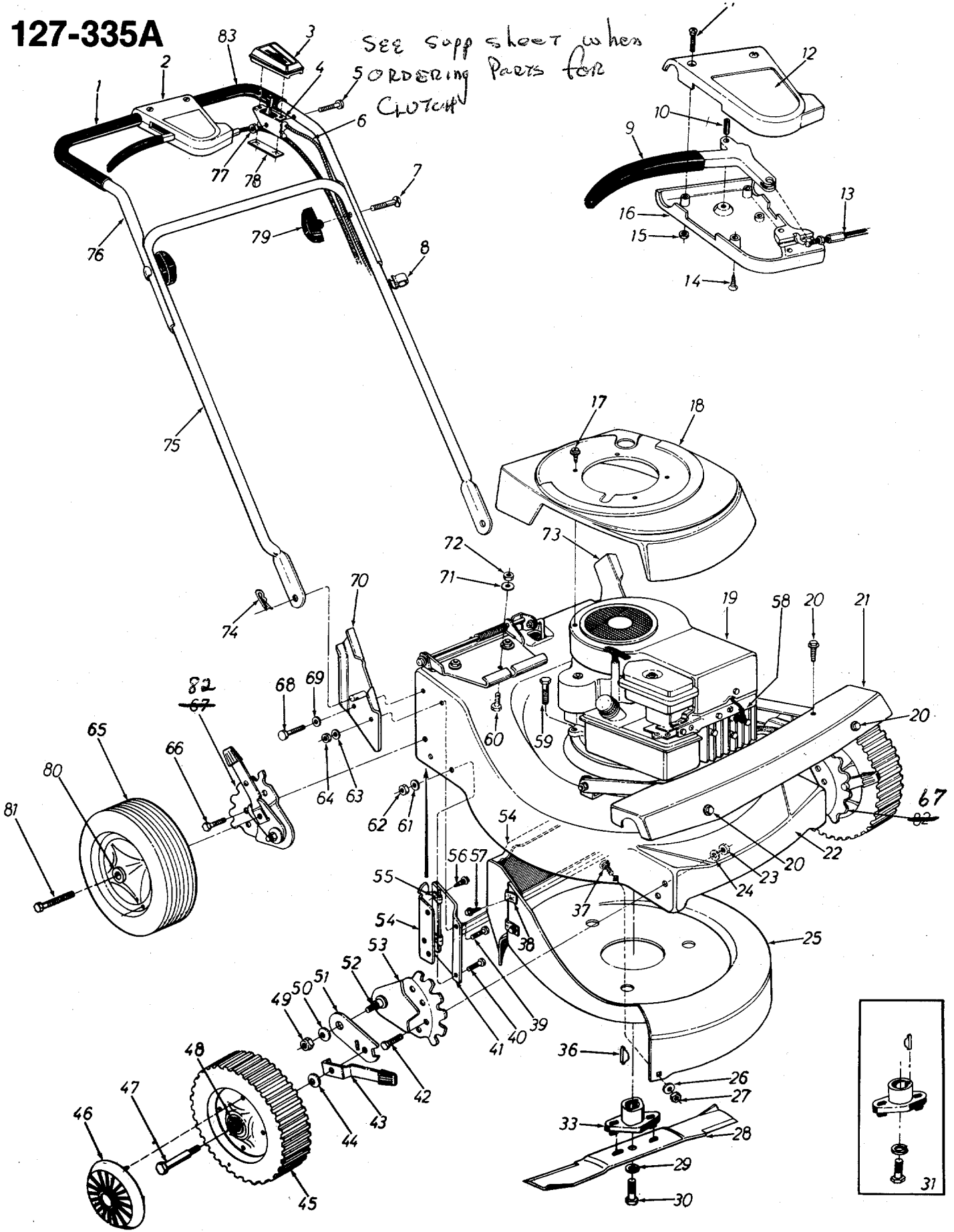

PARTS LIST FOR MODEL 127-335A

REF. NO.	PART NO.	COLOR CODE	DESCRIPTION	NEW PART	REF NO.	PART NO.	COLOR CODE	DESCRIPTION	NEW PART
1	718-0143		Plastic Grip Shrink Type		43	10530		Spring Lever Ass'y.	
2	12973		Complete Clutch Control		44	736-0105		Bell-Wash. .40 I.D. x .88 O.D.	
			Ass'y.	N	45	09392	-503	Front Wheel 8 x 1.75 Comp.	
3	731-0344		Plastic Label		46	731-0124		Hub Cap—Red Plastic	
4	746-0256		Throttle Control Ass'y.		47	738-0102		Shld. Scr. .498 Dia. x 1.44" Lg.	
			Comp.		48	748-0125		Sleeve Brg. .503 I.D. x .63 O.D.	
5	710-0606		Hex Scr. — 1/4-20 x 1.50 Lg.*		49	712-0375		Hex Cent. L-Nut 3/8-16 Thd.*	
6	746-0255		Control Wire Cond. 67.0 Lg. x 2.31		50	736-0255		Bell-Wash. .51 I.D. x 1.12 O.D.	
7	710-0405		Curved Carriage Bolt 5/16-18 x 1.75		51	10619		Pivot Bar	
8	725-0157		Cable Ties Self Clinching		52	738-0269		Shoulder Scr.	
9	719-0193		Clutch Lever—Finished		53	12323		Index Plate	
10	715-0248		Spring Pin Roll 3/16 Dia. x .75" Lg.		54	12176		Rear Deck Section Ass'y.	
11	710-0534		Phillips Drive Oval Hd. Scr.		55	712-0344		Speed Nut #10Z	
12	731-0331		Front Control Cover		56	710-0436		Hex B-Tapp Scr. #10Z x .62" Lg.	
13	746-0297		Clutch Control Cable—64-62 Lg.	N	57	710-0436		Hex B-Tapp Scr. #10Z x .62" Lg.	
14	710-0535		Slotted Oval Self Tapp Scr.		58	735-0639		Spark Plug Boot	
15	712-0223		Hex Nut #8-32 Thd.*		59	710-0158		Hex Scr. 5/16-24 x 1.25" Lg.*	
16	731-0332		Rear Control Cover		60	710-0167		Carriage Bolt 1/4-20 x .50" Lg.*	
17	710-0227		Hex Wash. Hd-AB Tapp Scr. #8 x .50" Lg.*		61	736-0329		L-Wash. 1/4" Scr.*	
18	731-0303		Engine Shroud		62	712-0287		Hex Nut 1/4-20 Thd.*	
19	—		Engine B & S. 3.5 H.P.		63	736-0329		L-Wash. 1/4" Scr.*	
20	710-0599		Hex Wash Self Tapp Scr. 1/4-20 x .50		64	712-0287		Hex Nut 1/4-20 Thd.*	
21	12982	-462	Cover	N	65	734-0643		Rear Wheel 8 x 1.75 Comp.	
22	12981	-462	20" Rear Discharge S.P. Deck		66	710-0209		Hex Sems 3/8-16 x .62" Lg.*	
23	712-0798		Hex Nut 3/8-16 Thd.*		67	12321		Height Adjustment Ass'y.—L.H.	
24	736-0169		L-Wash. for 3/8 Scr.*		68	710-0289		Hex Scr. 1/4-20 x .500" Lg.*	
25	12190	-462	Rear Discharge Baffle		69	736-0329		L-Wash. 1/4" Scr.*	
26	736-0329		L-Wash. for 1/4 Scr.*		70	12296		Handle Brkt. Ass'y.—R.H.	
27	712-0287		Hex Nut 1/4-20 Thd.*		71	736-0329		L-Wash. 1/4" Scr.*	
28	742-0187		20" Blade	N	72	712-0287		Hex Nut 1/4-20 Thd.*	
29	736-0217		L-Wash. for 3/8 Scr.*		73	12297		Handle Brkt. Ass'y.—L.H.	
30	710-0459		Hex Scr. 3/8-24 x 1.50" Lg.*		74	714-0104		Int. Cotter Pin .516 Dia.*	
31	753-0165		Blade Adapter Kit	N	75	749-0179		Lower Handle	
33	748-0256		Blade Adapter	N	76	749-0181		Upper Handle	
36	714-0365		#6 Hi-Pro Key 5/32" x 5/8" Dia.		77	712-0107		Hex Cent. L-Nut 1/4-20 Thd.	
37	710-0167		Carriage Bolt 1/4-20 x .50" Lg.*		78	726-0134		Speed Nut #8-32	
38	726-0139		Speed Nut—U Type		79	09966		Knob Handle Ass'y.	
39	710-0289		Hex Scr. 1/4-20 x .50" Lg.*		80	741-0178		Ball Bearing	
40	710-0294		Hex Scr. 1/4-20 x .375" Lg.*		81	710-0427		Hex Scr. 3/8-16 x 2.00" Lg.*	
41	12302		Side Plate		82	12322		Height Adjustment Ass'y.—R.H.	
42	710-0209		Hex Sems Scr. 3/8-16 x .62" Lg.*		83	731-0323		Plastic Grip Shrink Type 9.0 Lg.	

*For faster service, obtain standard nuts, bolts and washers locally. If these items cannot be obtained locally, order by part number and size as shown on the parts list.

(462—Red Flake) When ordering parts if color or finish is important, use the appropriate color code shown at left. (e.g. Red Flake Finish—12982(462))

The engine is not under warranty by the mower manufacturer. If repairs or service is needed on the engine, please contact your nearest authorized engine service outlet. Check the "Yellow Pages" of your telephone book under "Engines — Gasoline."



127-335A

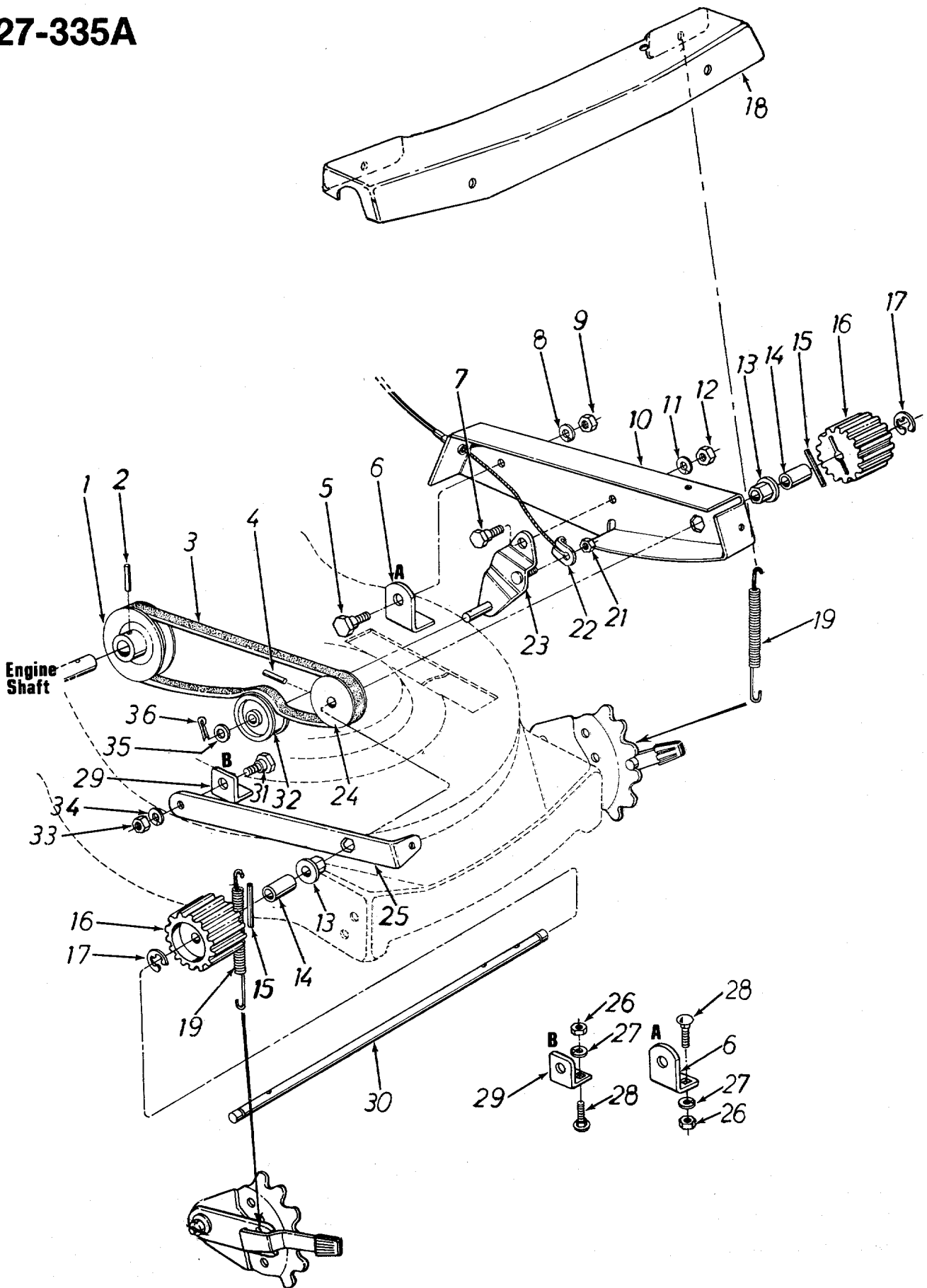

PARTS LIST FOR MODEL 127-335A

REF. NO.	PART NO.	COLOR CODE	DESCRIPTION	NEW PART
1	756-0289		½ "V"-Engine Pulley	N
2	715-0246		Spring Pin Spiral 3/16" Dia. x 1.25" Lg.	
3	754-0163		"V"-Belt ½" x 28.0" Lg.	
4	715-0247		Spring Pin Spiral 3/16" Dia. x 1.00" Lg.	
5	738-0147		Shld. Scr. .500 Dia. x .170	
6	12978		Belt Cover Pivot Brkt.	N
7	738-0147		Shld. Scr. .500 Dia. x .170	
8	736-0169		L-Wash. 3/8" Scr.*	
9	712-0342		Hex Jam Nut 3/8-16 Thd.	
10	12976		Belt Cover Ass'y.	N
11	736-0169		L-Wash. 3/8" Scr.*	
12	712-0342		Hex Jam Nut 3/8-16 Thd.	
13	748-0228		Hex Flange Brg. .503 I.D.	
14	711-0313		Spacer .52 I.D. x .69 O.D. x .88	
15	715-0246		Spring Pin Spiral 3/16 Dia. x 1.25" Lg.	
16	731-0393		13 Teeth Drive Pinion	N
17	716-0104		"E"-Ring for .500 Dia. Shaft	
18	12982		Cover	N
19	732-0264		Extension Spring .38 O.D. x 2.50" Lg.	
21	712-0107		Hex Cent. L-Nut ¼-20 Thd.	
22	746-0260		Clevis Lanyard Fitting	
23	12974		Idler Brkt. Ass'y.	N
24	756-0290		½ "V"-Pulley	N
25	12980		Cover Support Brkt.	N
26	712-0287		Hex Nut ¼-20 Thd.*	
27	736-0329		L-Wash. ¼" Scr.*	
28	710-0167		Carriage Bolt ¼-20 x .500" Lg.	
29	12979		Cover Support Pivot Brkt.	N
30	738-0356		Pinion Shaft	N
31	738-0147		Shld. Scr. .500 Dia. x .170	
32	756-0192		Plastic Flat Idler	
33	712-0342		Hex Jam Nut 3/8-16 Thd.*	
34	736-0169		L-Wash. 3/8" Scr.*	
35	736-0150		FI-Wash. .53 I.D. x .94 O.D.	
36	714-0115		Cotter Pin 1/8" Dia. x 1.00" Lg.*	

*For faster service obtain standard nuts and bolts locally. If these items cannot be obtained locally, order by part number and size as shown on the parts list.

(462—Red Flake) When ordering parts, if color or finish is important, use the appropriate color code shown at left. (e.g. Red Flake Finish—12609 (462))

The engine is not under warranty by the mower manufacturer. If repairs or service is needed on the engine, please contact your nearest authorized engine service outlet. Check the "Yellow Pages" of your telephone book under "Engines — Gasoline."

**Find It Fast
In The
Yellow Pages**



127-335A

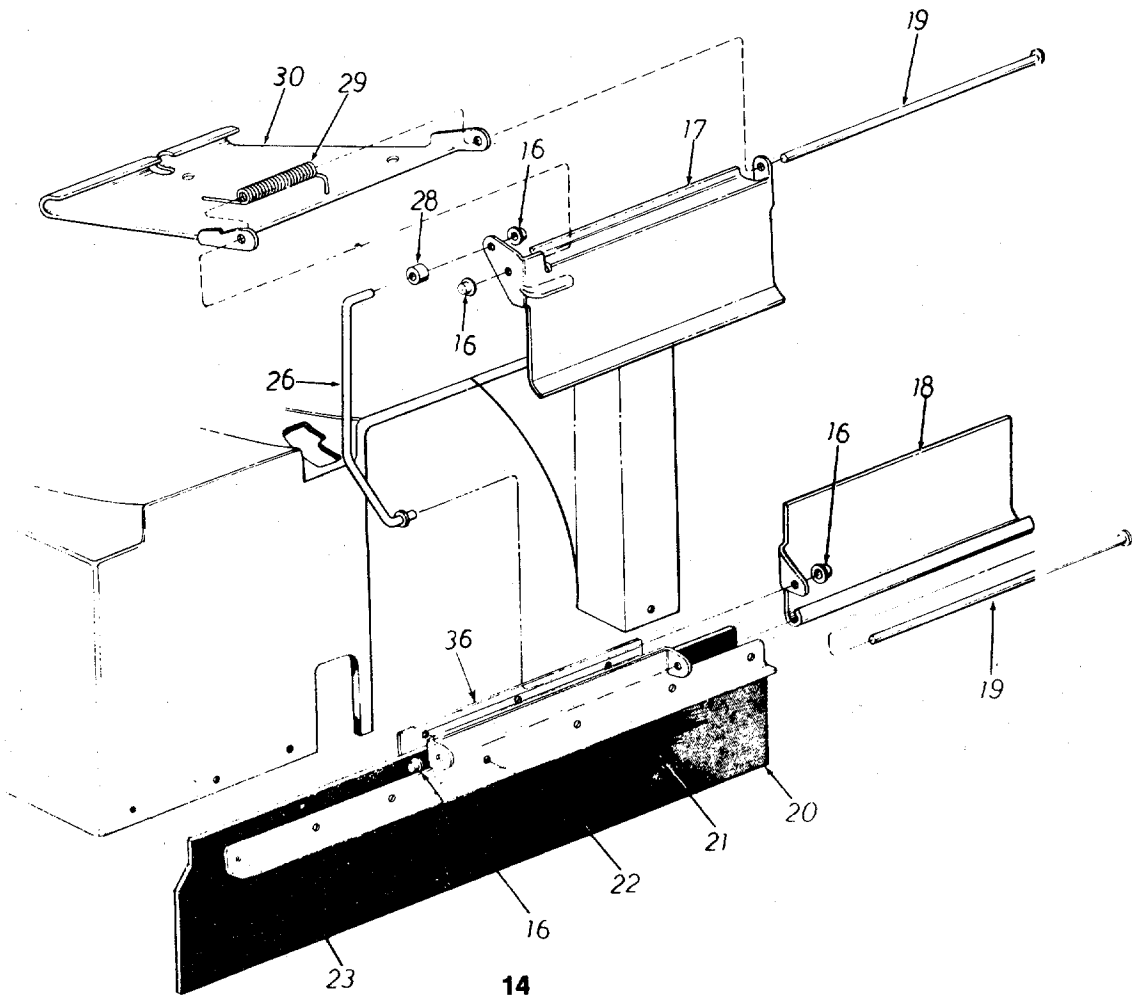
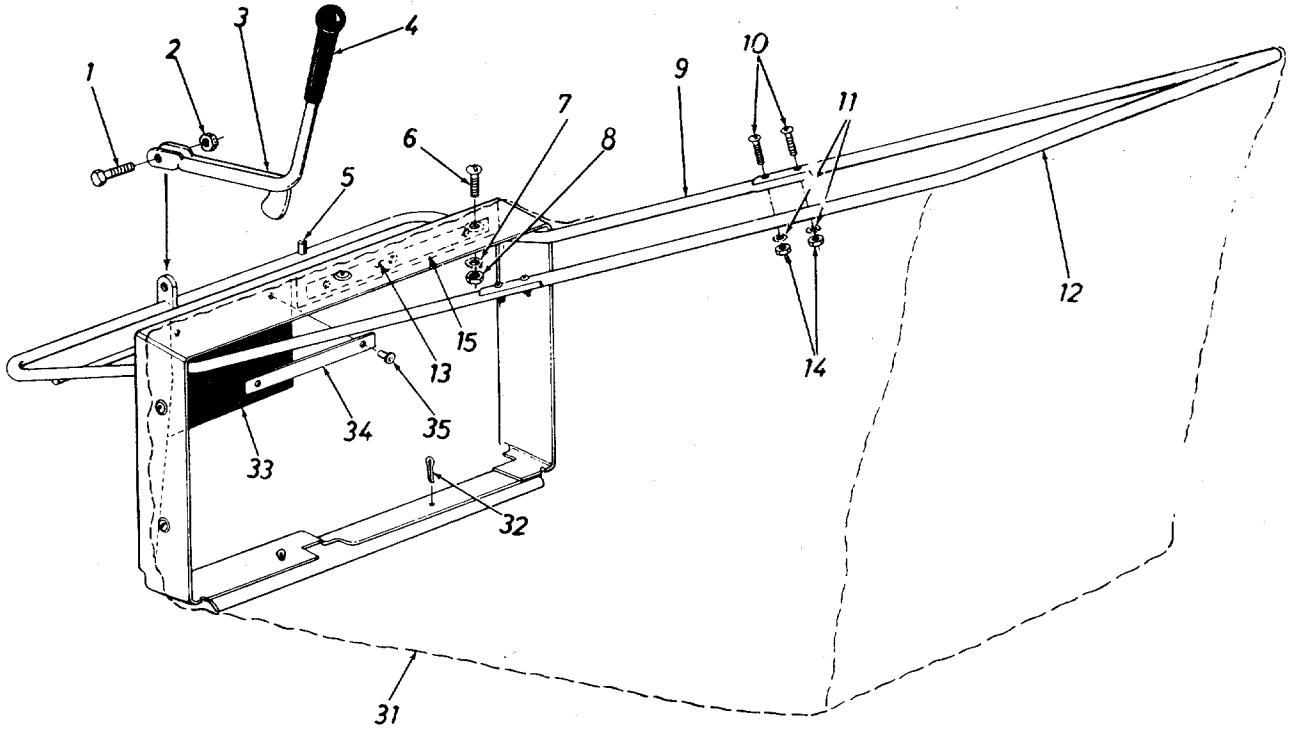

PARTS LIST FOR MODEL 127-335A

REF. NO.	PART NO.	COLOR CODE	DESCRIPTION	NEW PART	REF. NO.	PART NO.	COLOR CODE	DESCRIPTION	NEW PART
1	710-0117		Hex Scr. 5/16-24 x 1.00" Lg.*		17	12395		Chute Door—Upper Half	
2	712-0237		Hex Center L-Nut 5/16-24 Thd.		18	12144		Chute Door—Lower Half	
3	12393		Cam Lever Ass'y.		19	738-0253		Hinge Rod	
4	720-0143		Grip		20	735-0169		Rear Protective Flap	
5	715-0247		Spring Pin Spiral		21	12305		Rear Safety Shield Plate	
6	710-0192		Truss Mach. Scr. #10-24 x .38" Lg.		22	728-0128		Rivet*	
7	736-0147		Ext. L-Wash. #10 Scr.*		23	710-0436		Hex B-Tapp Scr. #10Z x .62" Lg.*	
8	712-0121		Hex Nut #10-24 Thd.*		26	747-0141		Connecting Rod	
9	12579		Catcher Frame Ass'y. Lower Half		28	748-0246		Roller Spacer	
10	710-0467		Rd. Hd. Mach. Scr. #10-24 x 1.00" Lg.*		29	732-0295		Torsion Spring	
11	736-0147		Ext. L-Wash. #10 Scr.*		30	12192		Grass Catcher Adapter	
12	749-0234		Frame—Rear Half		31	764-0150		Bag	
13	12316		Reinforcement Bar		32	714-0115		Cotter Pin 1/8" Dia. x 1.00" Lg.*	
14	712-0121		Hex Nut #10-24 Thd.*		33	735-0184		Grass Catcher Flap	
15	735-0183		Grass Catcher Flap		34	12185		Reinforcement Bar	
16	726-0135		Push Nut 5/16" Rod		35	728-0128		Rivet	
					36	12316		Reinforcement Bar	
						197-010		Grass Catcher Complete	

*For faster service obtain standard nuts and bolts locally. If these items cannot be obtained locally, order by part number and size as shown on the parts list.

 **NOTE**

The manufacturer DOES NOT recommend the use of any accessory on this Rotary Mower other than those manufactured by MTD Products Inc.



WARNING

DO NOT operate the mower with the chute doors open unless the complete grass catcher is properly mounted on the mower.

 **NOTE**

Under normal usage bag material is subject to wear and should be checked periodically. Be sure any replacement bag complies with the mower manufacturer's recommendations.

For replacement bags, use only factory authorized replacement bag No. 764-0150.

 **IMPORTANT**

After striking a foreign object, stop the engine, remove wire from spark plug. Thoroughly inspect the mower for any damage, and repair the damage before restarting and operating the mower.

PARTS INFORMATION

POWER EQUIPMENT PARTS AND SERVICE

Parts and service for all MTD manufactured power equipment are available through the authorized service firms listed below. All orders should specify the model number of your unit, parts numbers, description of parts and the quantity of each part required.

ALABAMA	BIRMINGHAM	
	Auto Electric & Carburetor Co.	2625 4th Ave. S. 35233
ARKANSAS	NORTH LITTLE ROCK	
	Sutton's Lawn Mower Shop	Rt. 4, Box 368 72117
	FORT SMITH	
	Mity Mite Motors, Inc.	2515 Towson Ave. 72901
CALIFORNIA	SAN BERNARDINO	
	Lawn Mower Supply Co.	25608 E. Baseline 92410
	SAN FRANCISCO	
	J.W. Jewett Co.	981 Folsom St. 94107
	SACRAMENTO	
	Luttig & Severson	2030 28th St. 95818
COLORADO	DENVER	
	South Denver Lawn Equip.	527 West Evans 80223
CONNECTICUT	SUFFIELD	
	The Jones & Ramsey Co.	850 Thompsonville Rd. 06078
FLORIDA	JACKSONVILLE	
	Radco Distributors	2403 Market St. 32206
	CORAL GABLES	
	Moz-All of Florida, Inc.	365 Greco Ave. 33146
GEORGIA	EAST POINT	
	East Point Cycle & Key	2834 Church St. 30344
ILLINOIS	LYONS	
	Keen Edge Co.	8615 Ogden Ave. 60534
INDIANA	ELKHART	
	Parts & Sales Inc.	2101 Industrial Pkwy. ..46514
IOWA	DUBUQUE	
	Power Lawn & Garden Equip.	2551 J.F. Kennedy 52001
KANSAS	WICHITA	
	Hixon, Inc.	3030 Mascot 67204
LOUISIANA	NEW ORLEANS	
	Suhren Engine Co.	8330 Earhart Blvd. 70118
MARYLAND	TAKOMA PARK	
	Center Supply Co.	6867 New Hampshire Ave. 20012
MASSACHUSETTS	SPRINGFIELD	
	Morton B. Collins Co.	300 Birnie Ave. 01107
MICHIGAN	MOUNT CLEMENS	
	Power Equipment Dist.	36463 South Gratiot... 48043
	LANSING	
	Lorenz Service Co.	2500 S. Pennsylvania.. 48900
MINNESOTA	MINNETONKA	
	Hance Distributing Inc.	11212 Wayzata Blvd. ..55343
MISSISSIPPI	BILOXI	
	Biloxi Sales & Service, Inc.	506 Caillavet St. 39533
MISSOURI	KANSAS CITY	
	Automotive Equip. Service	3117 Holmes St. 64109
	ST. LOUIS	
	Henzler, Inc.	2015 Lemay Ferry Rd. 63125
NEW YORK	CARTHAGE	
	Gamble Dist., Inc.	West End Ave. 13619
	SYRACUSE	
	Kimber's, Inc.	115 N. Geddes St. 13204

BRIGGS & STRATTON, TECUMSEH AND PEERLESS PARTS AND SERVICE

Briggs & Stratton, Tecumseh and Peerless parts and service should be handled by your nearest authorized engine service firm. Check the yellow pages of your telephone directory under the listing *Engines Gasoline*, Briggs & Stratton or Tecumseh Lauson

NORTH CAROLINA	GREENSBORO	
	Dixie Sales Company	327 Battleground Ave.. 27402
	GOLDSBORO	
	Smith Hardware Co.	515 N. George St. 27530
OHIO	WADSWORTH	
	National Central	687 Seville Rd. 44281
	CLEVELAND	
	Bleckrie, Inc.	7900 Lorain Ave. 44102
	CARROLL	
	Stebe's Mid-State Mower Supply	Box 366 43112
	WILLARD	
	Sunshine Wholesale Tire Outlet	Route 224 44890
	MANSFIELD	
	McClure Lawn & Garden Supply	1114 Lexington Ave. . 44903
OKLAHOMA	MUSKOGEE	
	Victory Motors, Inc.	605 S. Cherokee 74401
	ADA	
	Ada Auto Supply	301 E. 12th St. 74820
OREGON	PORTLAND	
	Kenton Supply Co.	8216 N. Denver Ave. . 97217
PENNSYLVANIA	LANCASTER	
	Raub Supply Co.	James & Mulberry Sts...17604
	PITTSBURGH	
	Bluemont Co.	11125 Frankstown Rd.. 15235
TENNESSEE	KNOXVILLE	
	Master Repair Service	2423 Broadway, N.E. ..37917
	MEMPHIS	
	Memphis Cycle & Supply Co.	421 Monroe Ave. 38103
	American Sales & Service, Inc.	1922 Lynnbrook 38116
TEXAS	DALLAS	
	Marr Brothers, Inc.	423 E. Jefferson 75203
	HOUSTON	
	Bullard Supply Co.	2409 Commerce St. 77003
	SAN ANTONIO	
	Catto & Putty, Inc.	P.O. Box 2408 78206
	FORT WORTH	
	Woodson Sales Corp.	1702 N. Sylvania 76111
UTAH	SALT LAKE CITY	
	A-1 Engine & Mower Co.	437 E. 9th St. 84111
VERMONT	BURLINGTON	
	Vermont Appliance Co.	44 Lakeside Ave. 05401
VIRGINIA	RICHMOND	
	RBI Corp.	963 Myers St. 23260
WASHINGTON	SEATTLE	
	Bailey's Rebuild, Inc.	1325 E. Madison St. ...98102
WEST VIRGINIA	CHARLESTON	
	Young's, Inc.	233 Virginia St., E. ... 25301
WISCONSIN	APPLETON	
	Automotive Supply Co.	123 S. Linwood Ave. ..54911

WARRANTY PARTS AND SERVICE POLICY

The purpose of warranty is to protect the customer from defects in workmanship and materials, defects which are NOT detected at the time of manufacture. It does not provide for the unlimited and unrestricted replacement of parts. Use and maintenance are the responsibility of the customer. The manufacturer cannot assume responsibility for conditions over which it has no control. Simply put, if it's the manufacturer's fault, it's the manufacturer's responsibility; if it's the customer's fault, it's the customer's responsibility.

CLAIMS AGAINST THE MANUFACTURER'S WARRANTY INCLUDES

1. Replacement of Missing Parts on new equipment.
2. Replacement of Defective Parts within the warranty period.
3. Repair of Defects within the warranty period.

All claims MUST be substantiated with the following information:

1. Model Number of unit involved.
2. Date unit was purchased or first put into service.
3. Date of failure.
4. Nature of failure.