

# OWNERS MANUAL

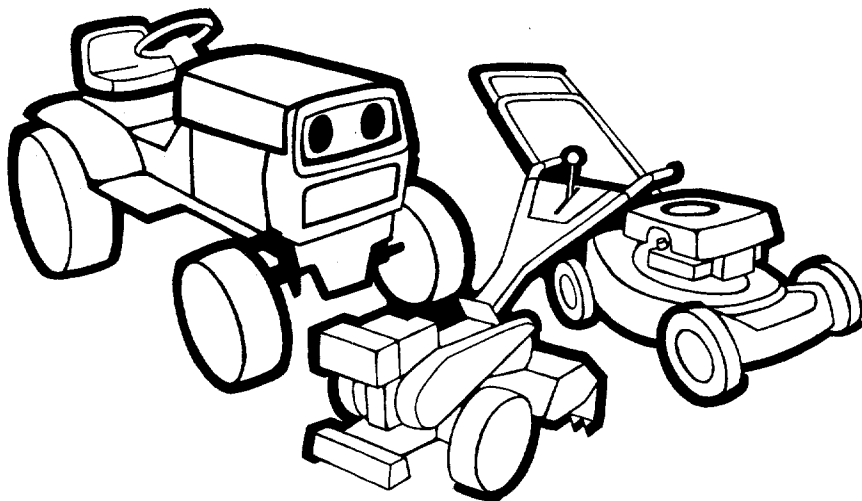

**20"  
REAR  
DISCHARGE  
ROTARY  
MOWER**

**ASSEMBLY  
OPERATION  
MAINTENANCE  
PARTS LIST**

**Model Number  
114-331A000**

**Important:  
Read Safety Rules and  
Instructions Carefully**

Thank you for purchasing an  
American built product.

# INDEX

Safe Operation Practices .....	3	Maintenance .....	12
Assembly .....	4	Off-Season Storage .....	13
Controls .....	10	Trouble Shooting Chart .....	15
Operation .....	10	Illustrated Parts .....	16, 18
Adjustments .....	11	Repair Parts Lists .....	17, 19
Lubrication .....	12	Parts Information .....	Back Cover

## LIMITED WARRANTY

For one year from the date of original retail purchase, MTD PRODUCTS INC will either repair or replace, at its option, free of charge, F.O.B. factory or authorized service firm, any part or parts found to be defective in material or workmanship. Transportation charges for the movement of any power equipment unit or attachment are the responsibility of the purchaser. Transportation charges for any parts submitted for replacement under this warranty must be paid by the purchaser unless such return is requested by MTD PRODUCTS INC.

This warranty will not apply to any part which has become inoperative due to misuse, excessive use, accident, neglect, improper maintenance, alterations, or unless the unit has been operated and maintained in accordance with the instructions furnished. This warranty does not apply to the engine, motor, battery, battery charger or component parts thereof. Please refer to the applicable manufacturer's warranty on these items.

This warranty will not apply where the unit has been used commercially.

Warranty service is available through your local authorized service dealer or distributor. If you do not know the dealer or distributor in your area, please write to the Customer Service Department of MTD.

The return of a complete unit will not be accepted by the factory unless prior written permission has been extended by MTD.

This warranty gives you specific legal rights. You may also have other rights which vary from state to state.



**WARNING**

This unit is equipped with an internal combustion engine and should not be used on or near any unimproved forest-covered, brush-covered or grass-covered land unless the engine's exhaust system is equipped with a spark arrester meeting applicable local or state laws (if any). If a spark arrester is used, it should be maintained in effective working order by the operator.

In the State of California the above is required by law (Section 4442 of the California Public Resources Code). Other states may have similar laws. Federal laws apply on federal lands. A spark arrester muffler is available at your nearest engine authorized service center.



To reduce the potential for any injury, comply with the following safety instructions. Failure to comply with the instructions may result in personal injury.

## SAFE OPERATION PRACTICES FOR WALK-BEHIND MOWERS

### TRAINING

1. Read this owner's manual carefully in its entirety before attempting to assemble or operate this machine. Be completely familiar with the controls and the proper use of this machine before operating it. Keep this manual in a safe place for future and regular reference and for ordering replacement parts.
2. Your rotary mower is a precision piece of power equipment, not a plaything. Therefore, exercise extreme caution at all times.
3. Never allow children to operate a power mower. Only persons well acquainted with these rules of safe operation should be allowed to use your mower.
4. Keep the area of operation clear of all persons, particularly small children and pets. Stop engine when they are in the vicinity of your mower. Although the area of operation should be completely cleared of foreign objects, an object may have been overlooked and could be accidentally thrown by the mower in any direction and cause serious personal injury to the operator or any others allowed in the area.

### PREPARATION

1. Thoroughly inspect the area where the equipment is to be used. Remove all stones, sticks, wire, bones and other foreign objects which could be picked up and thrown by the mower in any direction and cause serious personal injury to the operator or any others allowed in the area.
2. Do not operate equipment when barefoot or wearing open sandals. Always wear substantial footwear.
3. Do not wear loose fitting clothing that could get caught on the mower.
4. Check the fuel before starting the engine. Gasoline is an extremely flammable fuel. Do not fill the gasoline tank indoors, while the engine is running, or while the engine is still hot. Wipe off any spilled gasoline before starting the engine as it may cause a fire or explosion.
5. Disengage the self-propelled mechanism or drive clutch on units so equipped before starting the engine.
6. The blade control handle is a safety device. Never attempt to bypass its operation. Doing so makes the safety device inoperative and may result in personal injury through contact with the rotating blade. The blade control handle must operate easily in both directions.
7. Never attempt to make a wheel or cutting height adjustment while the engine is running.
8. Mow only in daylight or in good artificial light.
9. Never operate the equipment in wet grass. Always be sure of your footing. A slip and fall can cause serious personal injury. Keep a firm hold on the handle and walk, never run.

### OPERATION

1. Do not change the engine governor settings or overspeed the engine. Excessive engine speeds are dangerous.
2. Do not put hands or feet near or under rotating parts. Keep clear of the discharge opening at all times as the rotating blade can cause injury.
3. Stop the blade when crossing gravel drives, walks or roads.
4. After striking a foreign object, stop the engine, remove the wire from the spark plug, and thoroughly inspect the mower for any damage. Repair the damage before restarting and operating the mower.
5. If the equipment should start to vibrate abnormally, stop the engine and check immediately for the cause. Vibration is generally a warning of trouble.
6. Shut the engine off and wait until the blade comes to a complete stop before removing the grass catcher or unclogging the chute. The cutting blade continues to rotate for a few seconds after the engine is shut off. Never place any part of the body in the blade area until you are sure the blade has stopped rotating.
7. Before cleaning, repairing or inspecting, make certain the blade and all moving parts have stopped. Disconnect the spark plug wire, and keep the wire away from the spark plug to prevent accidental starting.
8. Do not run the engine indoors.
9. Mow across the face of slopes, never up-and-down. Exercise extreme caution when changing direction on slopes. Do not mow excessively steep slopes. Always be sure of your footing. A slip and fall can cause serious personal injury.
10. Always disconnect electric mowers (line operated) before cleaning, repairing or adjusting.
11. Never operate mower without proper guards, plates or other safety protective devices in place.
12. **DO NOT OPERATE** this mower unless the complete grass catcher is properly mounted on the mower.

### MAINTENANCE AND STORAGE

1. Check the blade and engine mounting bolts at frequent intervals for proper tightness.
2. Keep all nuts, bolts, and screws tight to be sure the equipment is in safe working condition.
3. Never store the equipment with gasoline in the tank inside of a building where fumes may reach an open flame or spark. Allow the engine to cool before storing in any enclosure.
4. To reduce fire hazard, keep the engine free of grass, leaves, or excessive grease.
5. Check the grass catcher bag frequently for wear or deterioration. For safety protection, replace only with new bag meeting original equipment specifications.



Reference to right or left hand side of the mower is observed from the operating position.

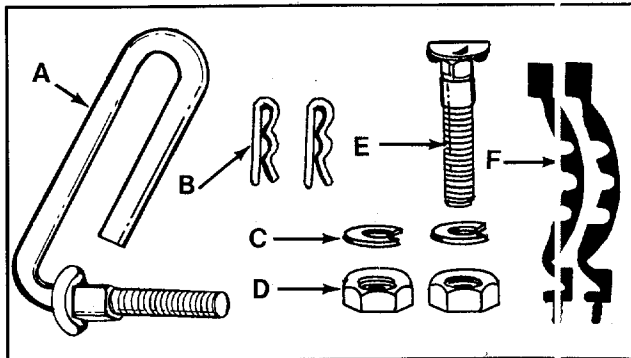

FIGURE 1.

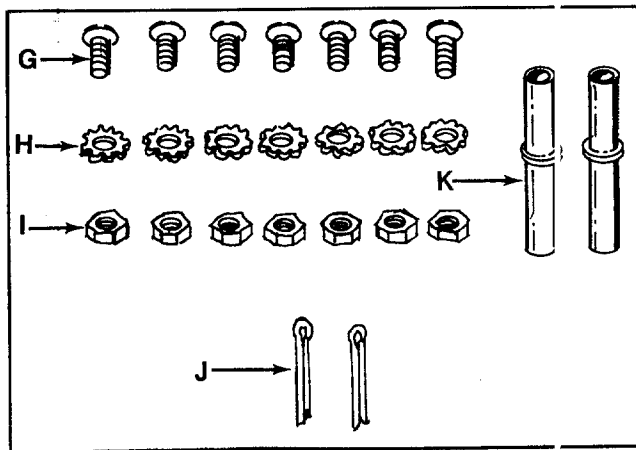

FIGURE 2.

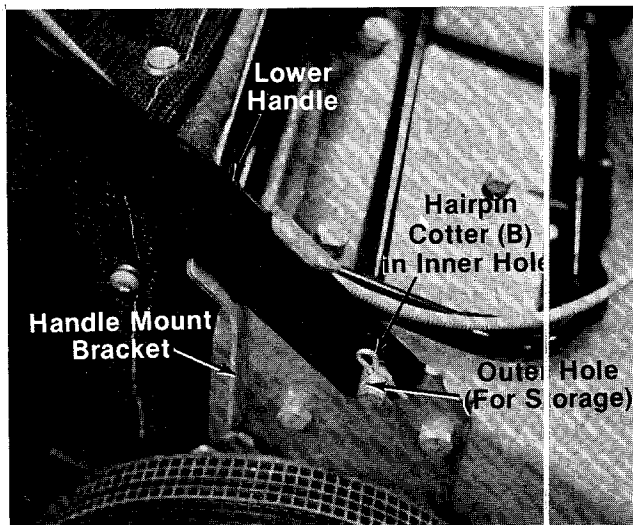

FIGURE 3.

## ASSEMBLY INSTRUCTIONS



This unit is shipped WITHOUT GASOLINE or OIL. After assembly, see separate engine manual for proper fuel and engine oil recommendations.

### Contents of hardware pack: (See figures 1 and 2)

- ← A (1) Rope Guide Bolt
- B (2) Hairpin Cotters
- C (2) Lock Washers 5/16" I.D.
- D (2) Hex Nuts 5/16-18 Thread
- E (1) Curved Head Carriage Bolt
- F (2) Cable Ties

- G (7) Truss Head Bolts 3/8" Long
- ← H (7) External Lock Washers
- I (7) Hex Nuts #10-24 Thread
- J (2) Cotter Pins
- K (2) Tubing Connectors

1. Remove lawn mower and loose parts from carton. Make certain all parts and literature have been removed from the carton before the carton is discarded.
2. Extend the throttle control cable (attached to the upper handle) and the brake cable (attached to the engine) and place on the floor. Be careful not to bend or kink control cables.
3. Attach the lower handle by placing the bottom holes in the lower handle over the weld pins on the handle mount brackets. Make certain the instruction label on the lower handle can be read from the operating position. Secure with hairpin cotters (B) in inner holes on weld pins. See figure 3.



There are two (2) holes in the handle mount brackets. Place the hairpin cotter in the inner hole for operation. Outer hole is for storage.



It may be necessary to bend the ends of the lower handle inward slightly to obtain a tight fit against the handle mount brackets.

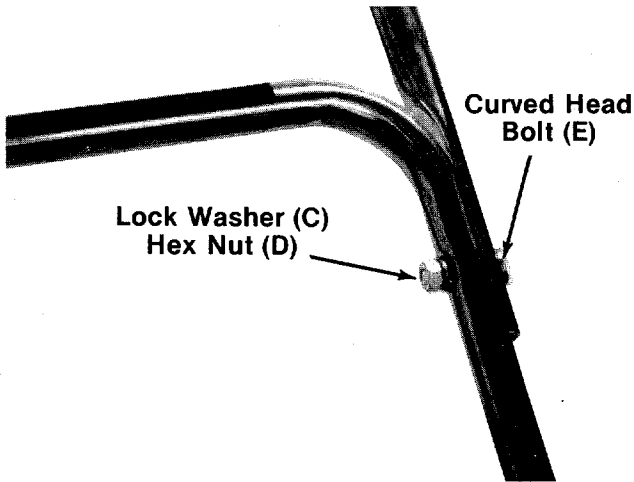

FIGURE 4.

4. Place the upper handle in position over the lower handle. The control housing must be on the left hand side of the handle. Secure the left hand side of upper handle using the curved head bolt (E), lock washer (C) and hex nut (D) as shown in figure 4.

**NOTE**

The right hand side of the handle will be secured with the rope guide bolt. However, left handed operators may assemble the rope guide bolt to the left side of the handle for easier starting.

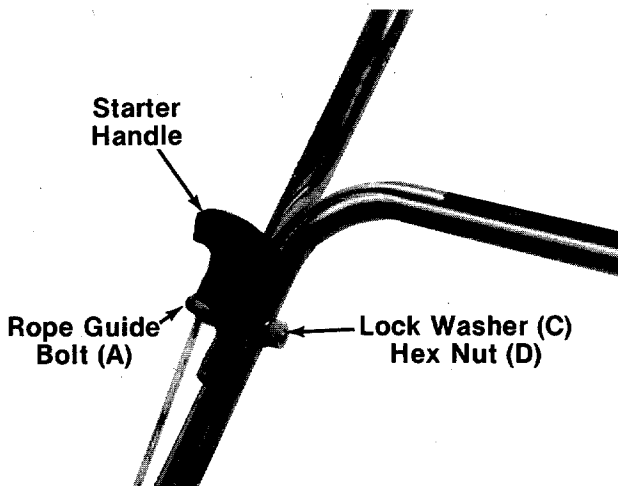

FIGURE 5.

5. Insert the rope guide bolt (A) through the right hand side of upper and lower handle.
6. The starter rope is wound around the starter handle. Maintain the tension on the rope as you unwind it.
7. Slip the starter rope into the rope guide bolt as shown in figure 5. Secure the rope guide bolt with lock washer (C) and hex nut (D). If more slack is needed in the starter rope, disconnect and ground the spark plug wire. Depress the blade control handle and pull additional rope out from the engine.

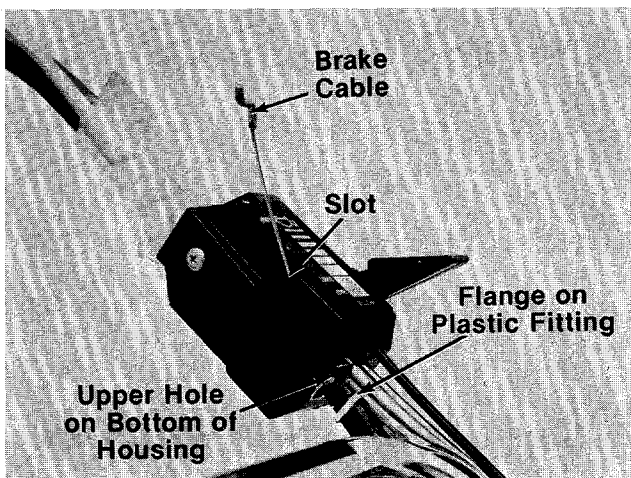

FIGURE 6.

8. Route the brake cable under the lower handle. Place the end of the brake cable into the upper hole on the bottom of the control housing, and through the slot in the side of the housing as shown in figure 6. The angle of the flange on the plastic fitting must be positioned downward as shown. Be careful not to bend or kink the cable.



Brake cable must be assembled as shown for proper blade brake operation.

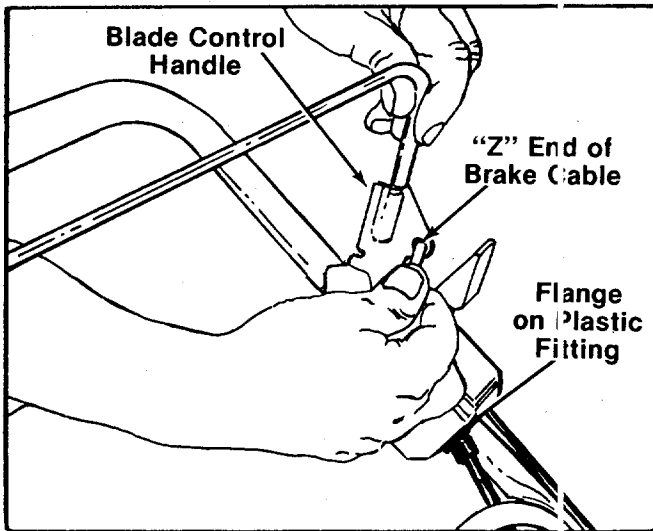

FIGURE 7.

9. Snap the plastic fitting on the end of the cable into the control housing. Hook the "Z" end of the brake cable into the hole in the blade control handle. See figure 7. If additional slack is needed in order to hook the cable into the handle, proceed as follows.

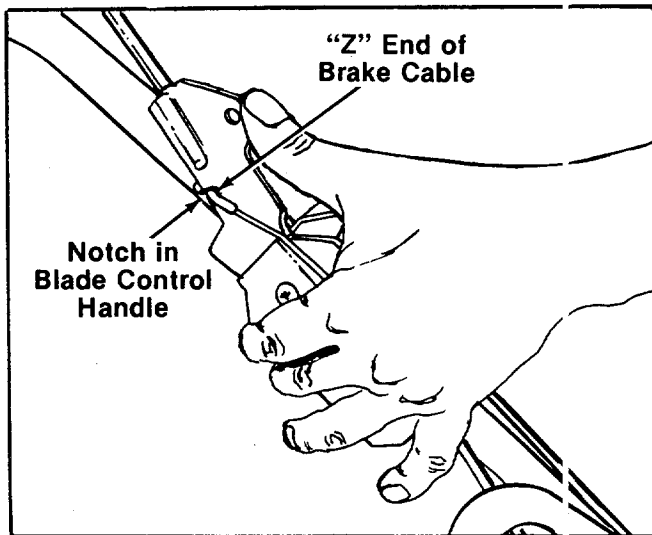

FIGURE 8.

- a. Hook the "Z" end of the cable into notch provided in the blade control handle. See figure 8.
- b. Squeeze blade control handle against upper handle.
- c. Release the blade control handle, unhook the cable from the notch and hook it into the hole in the blade control handle.

10. Remove the engine shroud if unit is so equipped. Replace it after attaching the throttle control cable to the engine.

11. Place the throttle control lever on the handle in "Fast" position.

12. Push the throttle control lever on the engine to the full open position (as far toward the outside of the unit as it will go) as shown in figure 9.

13. Hook the "Z" end of the throttle control cable into the hole in the control lever on the engine.

14. Remove the screw on the cable clamp shown in figure 9. Slip the control casing under the clamp. With the throttle lever on the engine still in the full open position, replace and tighten the screw to secure the throttle control cable.

15. Loosen the screw on the clamp on the side of the engine. Secure the cable **away from the muffler**. Be careful not to bend or kink the cable. Tighten the screw.

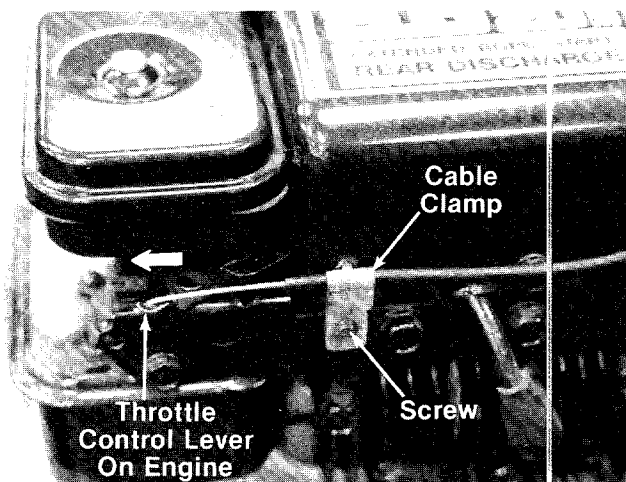

FIGURE 9.

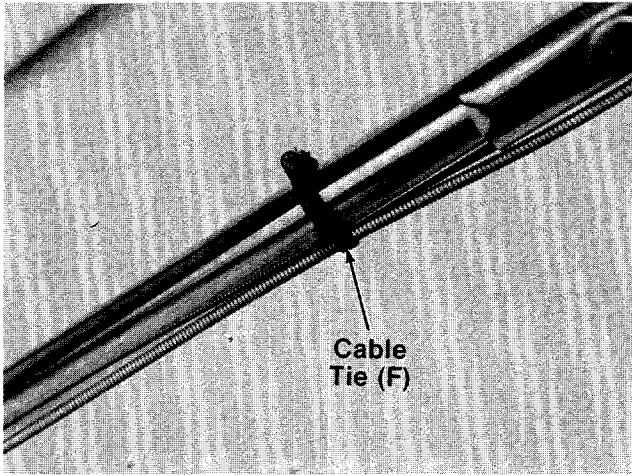

FIGURE 10.

16. Secure throttle control and brake cables to upper and lower handles with cable ties (F). See figure 10.
17. Check **all** nuts and bolts for correct tightness.

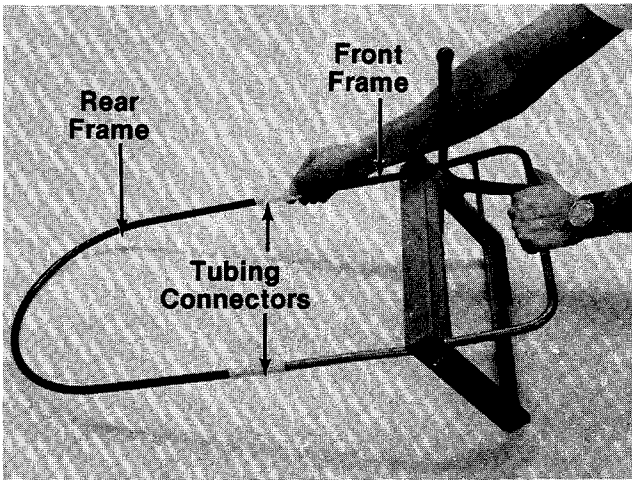

FIGURE 11.

## Grass Catcher Assembly

1. Connect the front and rear frames by pushing the tubing connectors (K) onto the ends of the rear frame. See figure 11.

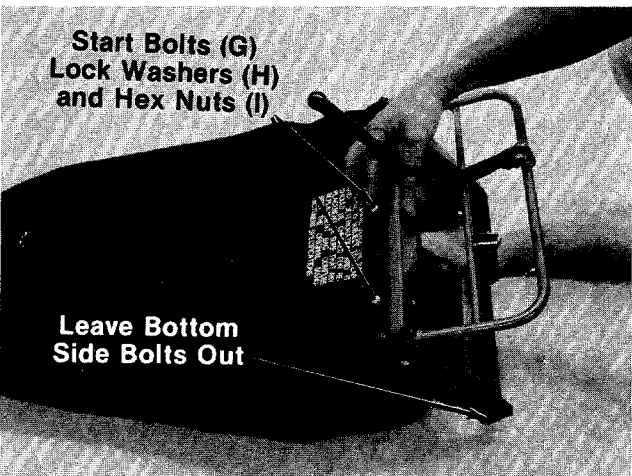
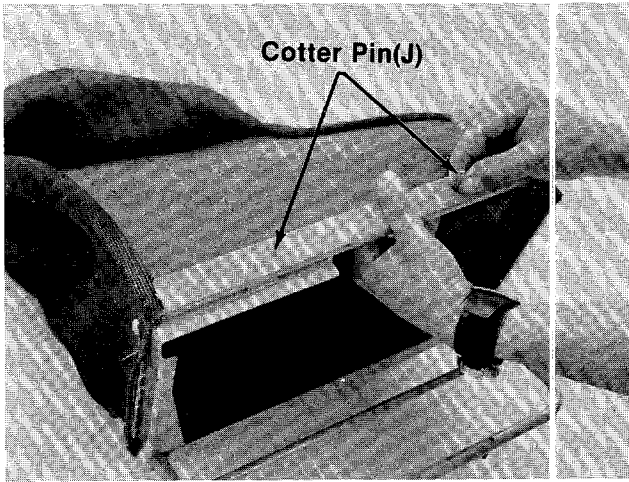

FIGURE 12.

2. Slip the frame into grass bag. The black plastic is the bottom of the grass bag. Fasten edges of bag (with eyelets) to front frame with 3/8" bolts (G), lock washers (H) and hex nuts (I). Finger tighten. See figure 12. Hint: For easier assembly Do Not fasten lower bolts on sides until after step 3.



3. Stand bag on end with open end up. Pull bottom of bag forward into slot. Align holes and slip cotter pins (J) into holes. Spread ends of pins to secure bag to frame. See figure 13. Tighten all nuts and bolts securely with screwdriver.

FIGURE 13.

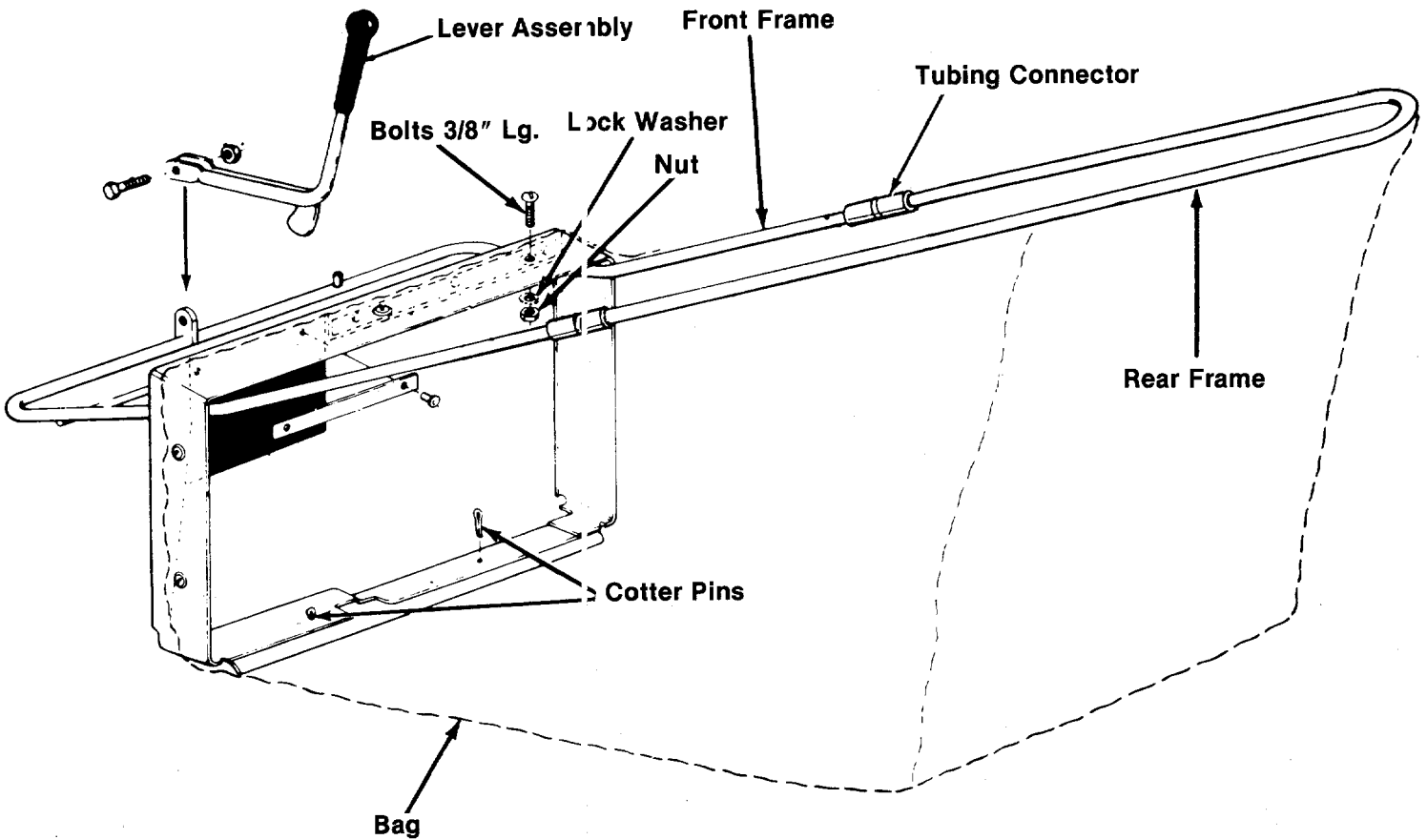



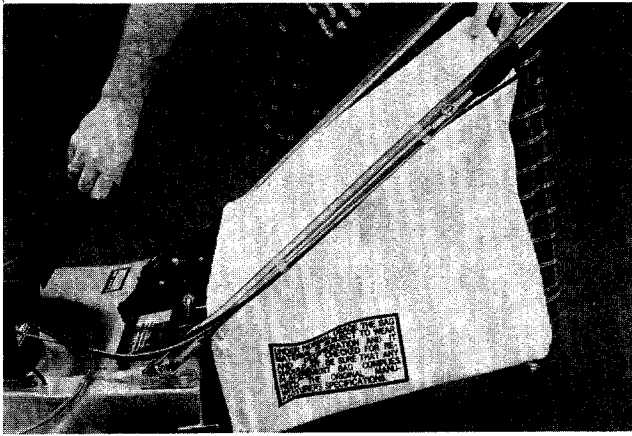

FIGURE 14.

## To Attach Bag To Mower



**WARNING**

Under no circumstances should the doors be opened while the engine is operating unless the grass catcher is securely in place.

1. Attach the grass catcher frame to the front of the adapter as shown in figure 14.

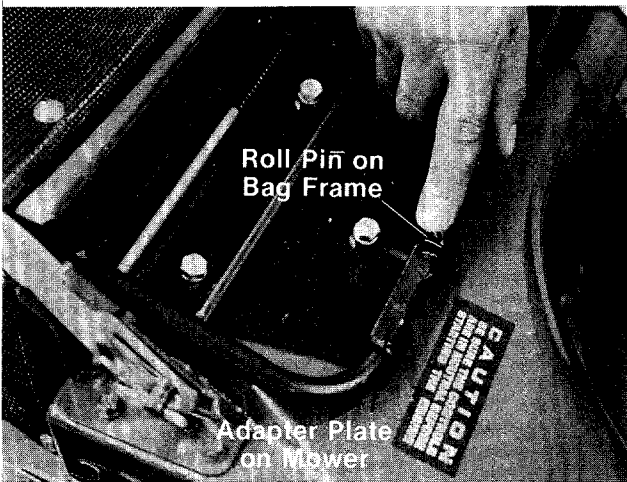

FIGURE 15.

- Tilt bag slightly forward and slide roll pin on bag frame into slot on mower. See figure 15. Push down on bag to position on mower.

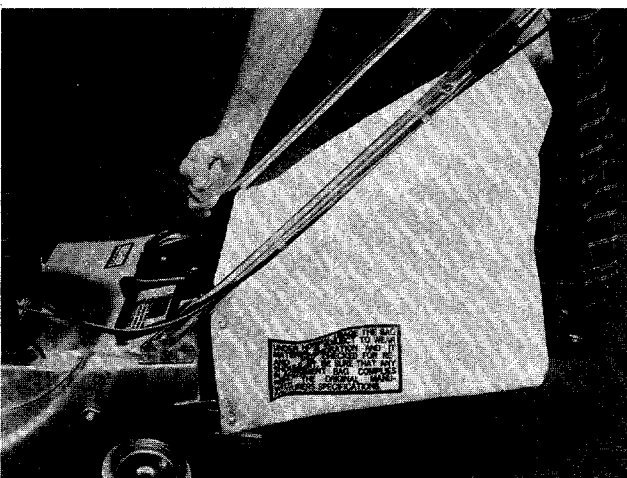

FIGURE 16.

2. Pull cam lever back and down to lock grass catcher on mower. This automatically opens rear discharge doors on mower. See figure 16. To remove the grass catcher, unlock the locking lever and lift off the grass catcher.

## CONTROLS

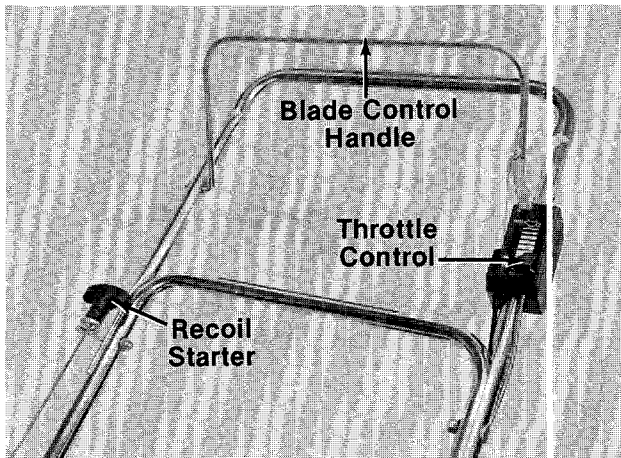

FIGURE 17.

### BLADE CONTROL HANDLE

**WARNING**  
THIS CONTROL MECHANISM IS A SAFETY DEVICE. NEVER ATTEMPT TO BYPASS ITS OPERATIONS.

The blade control handle is located on the upper handle of the mower. See figure 17. The blade control handle must be depressed in order to operate the unit. Release the blade control handle to stop the engine and blade.



The blade will be rotating whenever the engine is running.

### THROTTLE CONTROL

The throttle control is located on the left side of the upper handle. It is used to regulate the engine speed. The engine should be started with the engine in the FAST or START position.



The throttle control cannot be used to stop the engine.

### RECOIL STARTER

The recoil starter handle is attached to the handle. See figure 17. Stand behind the unit in the operating position to start the unit.

## OPERATION

**DO NOT OPERATE THIS MOWER WITH THE CHUTE DOOR OPEN, UNLESS THE COMPLETE GRASS-CATCHER IS PROPERLY MOUNTED ON THE MOWER.**



FIGURE 18.

Keep hands and feet away from the chute area on cutting deck. See figure 18.



For shipping purposes your mower is set with the wheels in a low cutting height position. For best results raise the cutting position until it is determined which height is best for your lawn. See cutting height adjustment section.

### BEFORE STARTING

1. Fill sump with oil as instructed in the separate engine manual packed with your unit.
2. Fill fuel tank, using clean, fresh, unleaded, low-lead or regular grade leaded gasoline. Fill tank completely!  
DO NOT MIX OIL WITH GASOLINE.
3. Attach spark plug wire to spark plug.

### TO START ENGINE AND ENGAGE BLADE

1. Move the throttle control lever to FAST or START position.
2. Standing behind the unit, depress the blade control handle and hold it against the upper handle as shown in figure 19.

3. Grasp the recoil starter handle as shown and pull up rapidly. Return it slowly to the rope guide bolt.
4. After engine starts, move throttle control to desired engine speed.

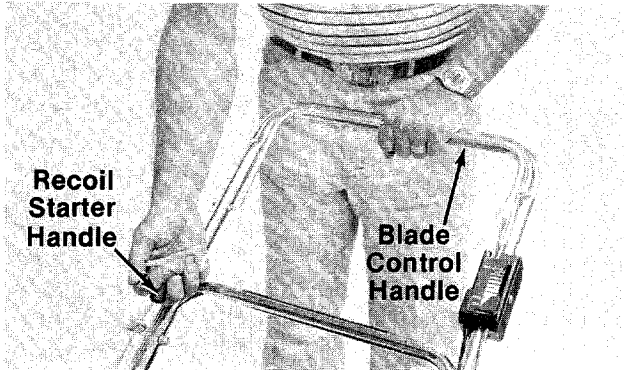

FIGURE 19.

#### TO STOP ENGINE AND BLADE

1. Release the blade control handle to stop the engine and blade.



The blade continues to rotate for a few seconds after the engine is shut off.

2. Disconnect the spark plug wire and ground it against the engine to prevent accidental starting while equipment is unattended.

#### USING YOUR ROTARY MOWER



**DO NOT** operate the mower with the chute door open unless the complete grass catcher is properly mounted on the mower.

Be sure that lawn is clear of stones, sticks, wire, or other objects which could damage lawn mower or engine. Such objects could be accidentally thrown by the mower in any direction and cause serious personal injury to the operator and others.

Operate a new engine at intermediate speeds and light load for the first few hours as you would a new automotive engine.

For the best results, do not cut wet grass because it tends to stick to the underside of the mower, preventing proper discharge of grass clippings, and could cause you to slip and fall. New grass, thick grass or wet grass may require a narrower cut. Blade speed should be adjusted to the condition of the lawn.

For best results, cut off one-third or less of the total length of the grass. Lawn should be cut in the fall as long as there is growth.

This mower is designed to be operated at full throttle to give you the best cut and do the most effective job of bagging the cut grass.

#### ➔ IMPORTANT

If you strike a foreign object, stop the engine. Remove wire from spark plug, thoroughly inspect the mower for any damage, and repair the damage before restarting and operating the mower. Extensive vibration of the mower during operation is an indication of damage. The unit should be promptly inspected and repaired.

## ADJUSTMENTS

#### ⚠ CAUTION

Do not at any time make any adjustment to lawn mower without first stopping engine and disconnecting spark plug wire.

#### CUTTING HEIGHT ADJUSTMENT

An adjusting plate and thumb lever at each wheel position provides cutting height adjustment. Each adjusting plate has five holes. Height of cut will be changed when the thumb lever is moved from one hole to another. Simply depress the lever towards wheel and move wheel and lever assembly to desired position.

Cutting height will be raised as front and rear levers are lowered. Cutting height will be lowered as front and rear levers are raised. All wheels must be placed in the same relative position.

For rough or uneven lawns, move the wheels to a position which will give a higher cutting height.

#### THROTTLE

If adjustment becomes necessary, the throttle control wire assembly can be reset as follows:

1. Loosen, but do not remove, screw securing throttle control wire assembly at engine. See figure 9.
2. Move throttle control lever on handle to "FAST" position.
3. Move control lever on engine to full open position. Retighten screw to secure throttle control wire assembly.

### CARBURETOR ADJUSTMENTS



If any adjustments are made to the engine while the engine is running (e.g. carburetor), keep clear of all moving parts. Be careful of heated surfaces and muffler.

Minor carburetor adjustment may be required to compensate for differences in fuel, temperature, altitude and load.

Refer to the separate engine manual packed with your mower for carburetor adjustment information.

### LUBRICATION



Always stop engine and disconnect spark plug wire before cleaning, lubricating or doing any kind of work on lawn mower.

**Blade Control**—Lubricate the pivot points on the blade control handle and the brake cable at least once a season with light oil. See figure 20. The blade control must operate freely in both directions.

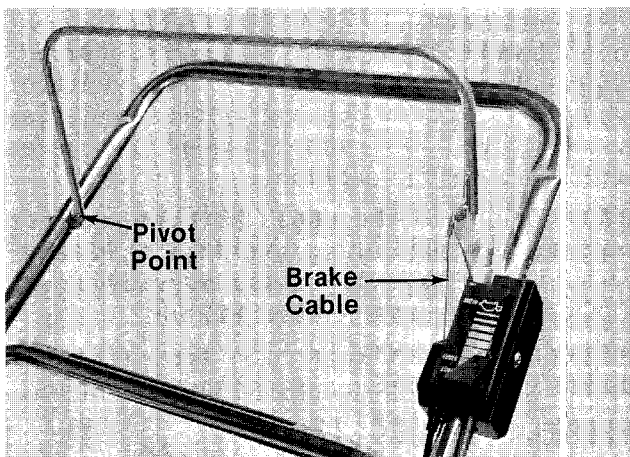

FIGURE 20.

**Discharge Chute Door Mechanism**—The torsion spring and pivot point should be lubricated periodically with light oil to prevent any rust or binding. Door must work freely.

**Wheels**—The wheels require no lubrication. However, if the wheels are removed for any reason, lubricate the surface of the axle bolt and the inner surface of the wheel with light oil. A 4 oz. plastic bottle of light oil lubricant is available. Order part number 737-0170. Engine oil may also be used.

**Engine**—Follow engine manual for lubrication instructions.

**Throttle**—Periodically lubricate throttle control lever and throttle wire assembly with a few drops of light oil for ease of operation.

### MAINTENANCE



When tipping the unit, empty the fuel tank and keep engine spark plug side up.

#### CUTTING BLADE

##### A. Removal for Sharpening or Replacement



Be sure to disconnect and ground the spark plug wire before working on the cutting blade to prevent accidental engine starting.

Remove the large bolt and lock washer which holds the blade and adapter to the engine crankshaft. Remove the blade and adapter from the crankshaft.

If the blade or blade adapter needs replacing, remove the two small bolts, lock washers and nuts which hold the blade to the adapter.



Periodically inspect the blade adapter for cracks, especially if you strike a foreign object. Replace when necessary.

##### B. Sharpening

Remove the cutting blade by following the directions of the preceding section.

When sharpening the blade, follow the original angle of grind as a guide. It is **extremely important** that each cutting edge receives an equal amount of grinding to prevent an unbalanced blade. An unbalanced blade will cause excessive vibration when rotating at high speeds, may cause damage to the mower and could break, causing personal injury.

It is recommended that the blade always be removed from the adapter for the best test of balance. The blade can be tested by balancing it on a round shaft screwdriver. Remove metal from the heavy side until it balances evenly.

### C. Reassembly

Before reassembling the blade and the blade adapter to the unit, lubricate the engine crankshaft and the inner surface of the blade adapter with light oil. Lubricating the bolt holes, bolts and inner surface of the nuts with light oil is also recommended. A 4 oz. plastic bottle of light oil lubricant is available. Order part number 737-0170. Engine oil may also be used.

When replacing the blade, be sure to install the blade with the side of the blade marked "Bottom" (or with part number) facing the ground when the mower is in the operating position.

### Blade Mounting Torque

3/8" Dia. Bolt 375 in. lb. min., 450 in. lb. max.

5/16" Dia. Bolt 150 in. lb. min., 250 in. lb. max.

To insure safe operation of your unit, **all** nuts and bolts must be checked periodically for correct tightness.

### DECK

The underside of mower deck should be cleaned after each period of use as grass clippings, leaves, dirt and other matter will accumulate. This accumulation of grass clippings, etc., is undesirable as it will invite rust and corrosion and may cause an uneven discharge of grass clippings at the next cutting.

The deck may be cleaned by tilting the mower forward or on its side and scraping clean with a suitable tool or by washing with a stream of water from a garden hose.



### CAUTION

Do not direct the stream of water at a hot engine as damage to the engine may result.

### ENGINE OIL

Check oil level before starting engine and after every 5 hours of operation. ADD oil as necessary to keep level to full mark on dipstick. Before removing dipstick, clean area around dipstick to prevent dirt from entering oil fill opening. Engine should be in a level position when checking oil.

Change oil after first 5 hours of operation. Thereafter change every 25 hours. Change oil while engine is warm. Oil may be drained thru oil drain on bottom of the engine. Oil capacity 1-1/4 pints.

### AIR CLEANER

Service air cleaner every 25 hours under normal conditions. Clean every few hours under extremely dusty conditions. Poor engine performance and flooding usually indicates that the air cleaner should be serviced.

To service the air cleaner, refer to the separate engine manual packed with your unit.

### SPARK PLUG

The spark plug should be cleaned and the gap reset once a season. Spark plug replacement is recommended at the start of each mowing season; check engine manual for correct plug type and gap specifications.

## OFF-SEASON STORAGE

The following steps should be taken to prepare lawn mower for storage.

1. Clean and lubricate mower thoroughly as described in the lubrication instructions.
2. Refer to engine manual for correct engine storage instructions.
3. Coat mower's cutting blade with chassis grease to prevent rusting.
4. Store mower in a dry, clean area.



### CAUTION

When storing any type of power equipment in an unventilated or metal storage shed, care should be taken to rust proof the equipment. Using a light oil or silicone, coat the equipment, especially cables and all moving parts.

## HANDLE STORAGE

The handle may be placed in an upright position for storage.

Move hairpin cotters to outer hole on weld pins. See figure 3. Press outward on the bottom of the lower handle and push forward. The handle will lock in this position.

To place the handle in the operating position, remove the starter rope from the rope guide bolt. Grasp the lower handle at the bottom, pull apart slightly and tip the handle backward. Place the cotter hairpins in the inner holes. With the spark plug wire disconnected and grounded, depress the blade control handle and pull the starter rope out from the engine. Slip the starter rope into the rope guide bolt.



The use of any accessory on this Rotary Mower other than those manufactured by the mower manufacturer is **not** recommended.

GRASS CATCHER Model 011 is available as replacement equipment for the mower shown in this manual.



1. DO NOT operate the mower with the chute doors open unless the complete grass catcher is properly mounted on the mower.
2. DO NOT operate the mower without the protective shield on the rear of the deck in place.



Under normal usage bag material is subject to wear and should be checked periodically. Be sure any replacement bag complies with the mower manufacturer's recommendations.

For replacement bags, use only factory authorized replacement bag No. 764-0174.

## Trouble Shooting Chart

Problem	Cause	Remedy
1 Engine fails to start	<p><b>A</b> Blade control handle disengaged</p> <p><b>B</b> Check fuel tank for gas</p> <p><b>C</b> Spark plug lead wire disconnected.</p> <p><b>D</b> Throttle control lever not in the starting position</p> <p><b>E</b> Faulty spark plug</p> <p><b>F</b> Carburetor improperly adjusted, engine flooded</p> <p><b>G</b> Old stale gasoline</p> <p><b>H</b> Engine brake engaged</p>	<p><b>A</b> Engage blade control handle.</p> <p><b>B</b> Fill tank if empty.</p> <p><b>C</b> Connect lead wire.</p> <p><b>D</b> Move throttle lever to start position.</p> <p><b>E</b> Spark should jump gap between control electrode and side electrode. If spark does not jump, replace the spark plug.</p> <p><b>F</b> Remove spark plug, dry the plug, crank engine with plug removed, and throttle in off position. Replace spark plug and lead wire and resume starting procedures.</p> <p><b>G</b> Drain and refill with fresh gasoline.</p> <p><b>H</b> Follow starting procedure.</p>
2 Hard starting or loss of power	<p><b>A</b> Spark plug wire loose</p> <p><b>B</b> Carburetor improperly adjusted</p> <p><b>C</b> Dirty air cleaner</p>	<p><b>A</b> Connect and tighten spark plug wire.</p> <p><b>B</b> Adjust carburetor. See separate engine manual.</p> <p><b>C</b> Clean air cleaner as described in separate engine manual.</p>
3 Operation erratic	<p><b>A</b> Dirt in gas tank</p> <p><b>B</b> Dirty air cleaner</p> <p><b>C</b> Water in fuel supply</p> <p><b>D</b> Vent in gas cap plugged</p> <p><b>E</b> Carburetor improperly adjusted</p>	<p><b>A</b> Remove the dirt and fill tank with fresh gas.</p> <p><b>B</b> Clean air cleaner as described in separate engine manual.</p> <p><b>C</b> Drain contaminated fuel and fill tank with fresh gas.</p> <p><b>D</b> Clear vent or replace gas cap.</p> <p><b>E</b> Adjust carburetor. See separate engine manual.</p>
4 Occasional skip (hesitates) at high speed	<p><b>A</b> Carburetor idle speed too slow</p> <p><b>B</b> Spark plug gap too close</p> <p><b>C</b> Carburetor idle mixture adjustment improperly set</p>	<p><b>A</b> Adjust carburetor. See separate engine manual.</p> <p><b>B</b> Adjust to .030".</p> <p><b>C</b> Adjust carburetor. See separate engine manual.</p>
5 Idles poorly	<p><b>A</b> Spark plug fouled, faulty, or gap too wide</p> <p><b>B</b> Carburetor improperly adjusted</p> <p><b>C</b> Dirty air cleaner</p>	<p><b>A</b> Reset gap to .030" or replace spark plug.</p> <p><b>B</b> Adjust carburetor. See separate engine manual.</p> <p><b>C</b> Clean air cleaner as described in separate engine manual.</p>
6 Engine overheats	<p><b>A</b> Carburetor not adjusted properly</p> <p><b>B</b> Air flow restricted</p> <p><b>C</b> Engine oil level low</p>	<p><b>A</b> Adjust carburetor. See separate engine manual.</p> <p><b>B</b> Remove blower housing and clean as described in separate engine manual.</p> <p><b>C</b> Fill crankcase with the proper oil.</p>
7 Excessive vibration	<p><b>A</b> Cutting blade loose or unbalanced</p> <p><b>B</b> Bent cutting blade</p>	<p><b>A</b> Tighten blade and adapter. Balance blade.</p> <p><b>B</b> Replace blade.</p>

**Note:** For repairs beyond the minor adjustments listed above, contact your local authorized service dealer.

# Model 331A

Meets CPSC Blade Safety Requirements

Lot/Model

Mfg. Date

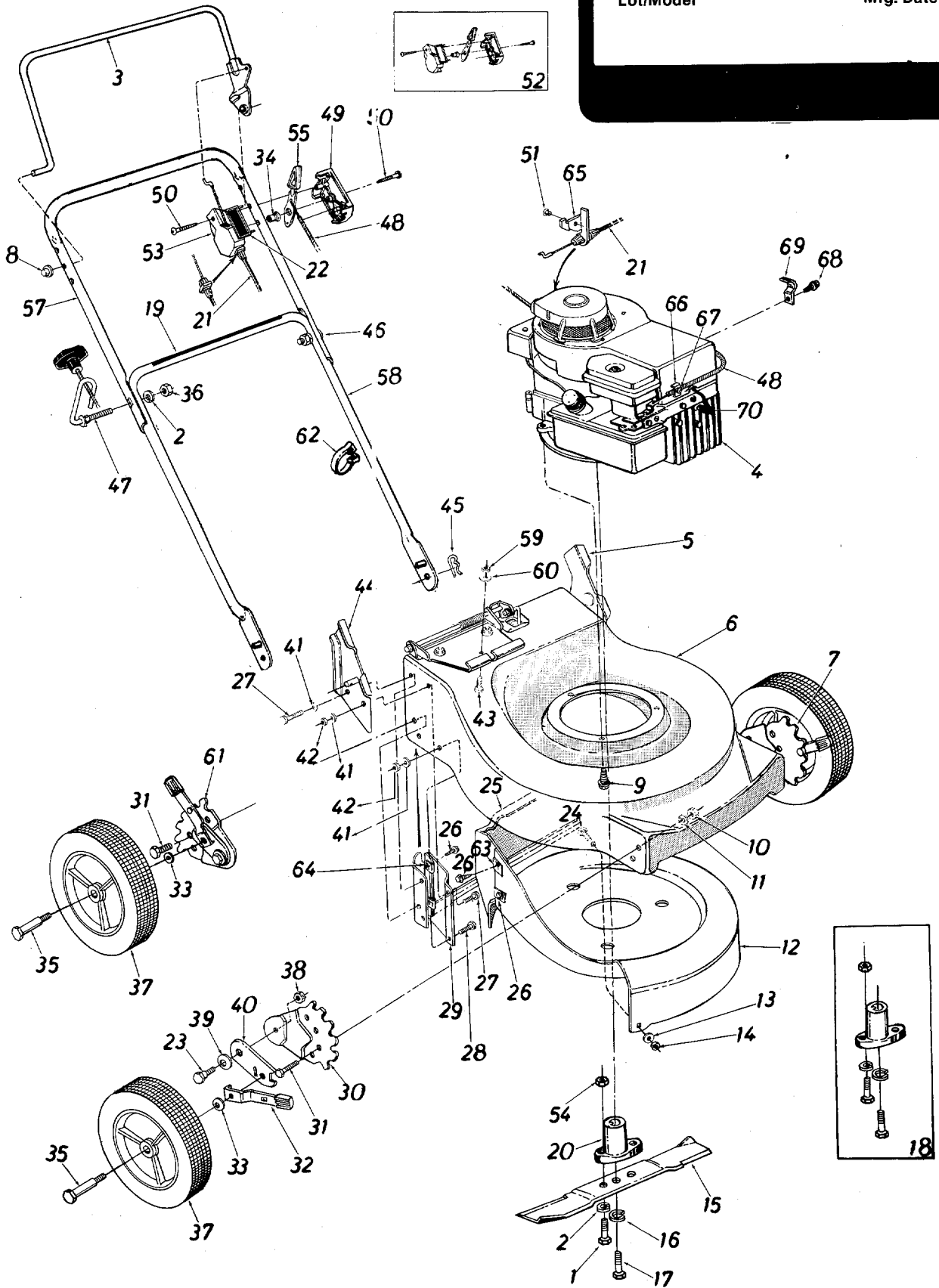



# Model 331A

## PARTS LIST FOR MODEL 331A ROTARY MOWER

REF. NO.	PART NO.	COLOR CODE	DESCRIPTION	NEW PART	REF. NO.	PART NO.	COLOR CODE	DESCRIPTION	NEW PART
1	710-0888		Hex Bolt 5/16-24 x 1.0" Lg. Grade 5		36	712-0267		Hex Nut 5/16-18 Thd.*	
2	736-0119		L-Wash. 5/16" I.D.*		37	734-1162		Wheel Ass'y. Comp.—Plastic	
3	14321		Control Handle Ass'y.—L.H. Engine		38	712-0375		Hex Cent. L-Nut 3/8-16 Thd.	
4	—				39	736-0255		Bell-Wash. .515" I.D. x 1.14" O.D.	
5	12297		Handle Brkt. Ass'y.—L.H.		40	10619		Pivot Bar	
6	12191 —462		Rear Discharge Deck		41	736-0329		L-Wash. 1/4" I.D.*	
7	12321		Height Adjuster Ass'y.—L.H.		42	712-0287		Hex Nut 1/4-20 Thd.*	
8	726-0135		Push Nut 5/16" Rod		43	710-0167		Carriage Bolt 1/4-20 x .50" Lg.*	
9	710-0654		Hex Wash. Hd. TT-Tap Scr. 3/8-16 x 1.0" Lg.		44	12296		Handle Brkt. Ass'y.—R.H.	
10	712-0798		Hex Nut 3/8-16 Thd.*		45	714-0104		Internal Cotter Pin 1/8" Dia.	
11	736-0169		L-Wash. 3/8" I.D.*		46	710-0671		Curved Carr. Bolt 5/16-18 x 1.38" Lg.	
12	12190 —462		Rear Discharge Baffle		47	710-0842		Rope Guide BOLT	
13	736-0329		L-Wash. 1/4" I.D.*		48	746-0472		Throttle Wire—58.0"	
14	712-0287		Hex Nut 1/4-20 Thd.*		49	731-0523		Control Panel Half	
15	742-0123		20" Blade		50	710-0796		Truss Mach. Scr. #12 x 1.5" Lg.	
16	736-0217		L-Wash. 3/8" I.D.—H.D.		51	728-0171		Pop Rivet	
17	710-0331		Hex Bolt 3/8-24 x 2.25" Lg. Grade 5		52	753-0360		Control Housing Comp.	
18	753-0348		Blade Adapter Kit		53	731-0526		Clutch Panel Half	
19	777-3455		Instruction Label—Handle		54	712-0123		Hex Nut 5/16-24 Thd.*	
20	753-0348		Blade Adapter Kit		55	731-0528		Throttle Control Lever	
21	746-0477		Control Cable—43.0"		57	749-0436		Upper Handle	
22	777-3458		Control Label—Throttle		58	749-0505		Lower Handle	
23	710-0216		Hex Bolt 3/8-16 x .75" Lg.*		59	712-0287		Hex Nut 1/4-20 Thd.*	
24	710-0167		Carriage Bolt 1/4-20 x .50" Lg.*		60	736-0329		L-Wash. 1/4" I.D.*	
25	12612 —462		Rear Deck Section Ass'y.		61	12322		Height Adjuster Ass'y.—L.H.	
26	710-0589		Hex Wash. Hd. AB-Tap Scr. #10Z x .75" Lg.		62	726-0192		Cable Tie	
27	710-0599		Hex Wash. Hd. Self-Tap Scr. 1/4-20 x .50" Lg.		63	726-0139		Speed Nut "U" Type—10-Z	
28	710-0294		Hex Bolt 1/4-20 x .375" Lg.*		64	712-0344		Speed Nut "U" Type—10-Z	
29	12302 —462		Side Plate		65	14924		Cable Brkt.	
30	12323		Index Plate		66	751-0369		Casing Clamp	
31	710-0209		Hex Sems Bolt 3/8-16 x .62" Lg.*		67	710-0227		Hex Wash. Hd. AB-Tap Scr. #8 x .38" Lg.	
32	10531		Spring Lever Ass'y. w/Knob		68	710-0429		Hex "B"-Tap Scr. #10 x .38" Lg.	
33	736-0105		Bell-Wash.		69	12894		Casing Clamp	
34	731-0524		Control Disc Pin		70	735-0639		Spark Plug Boot	
35	738-0102		Shld. Bolt .498" Dia. x 1.45" Lg.		—	8331A000-4		Hardware Pack	

(462—Red Flake)

\*For faster service obtain standard nuts, bolts, and washers locally. If these items cannot be obtained locally, order by part number and size as shown on parts list.

When ordering parts if color or finish is important, use the appropriate color code shown at left. (e.g. Red Flake Finish—12191 (462).)

NOTE: The engine is not under warranty by the mower manufacturer... If repairs or service is needed on the engine, please contact your nearest authorized engine service outlet. Check the "Yellow Pages" of your telephone book under "Engines—Gasoline."

Find It Fast  
In The  
Yellow Pages



NOTE

Specifications subject to change without notice or obligation.

# Model 331A

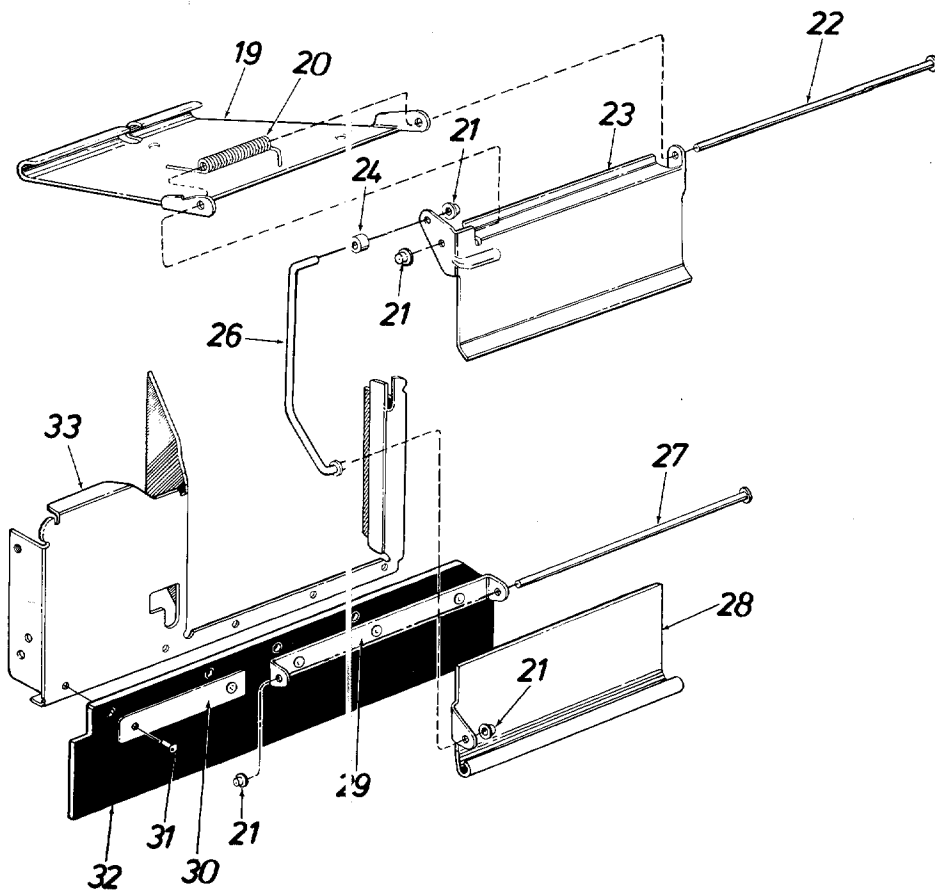
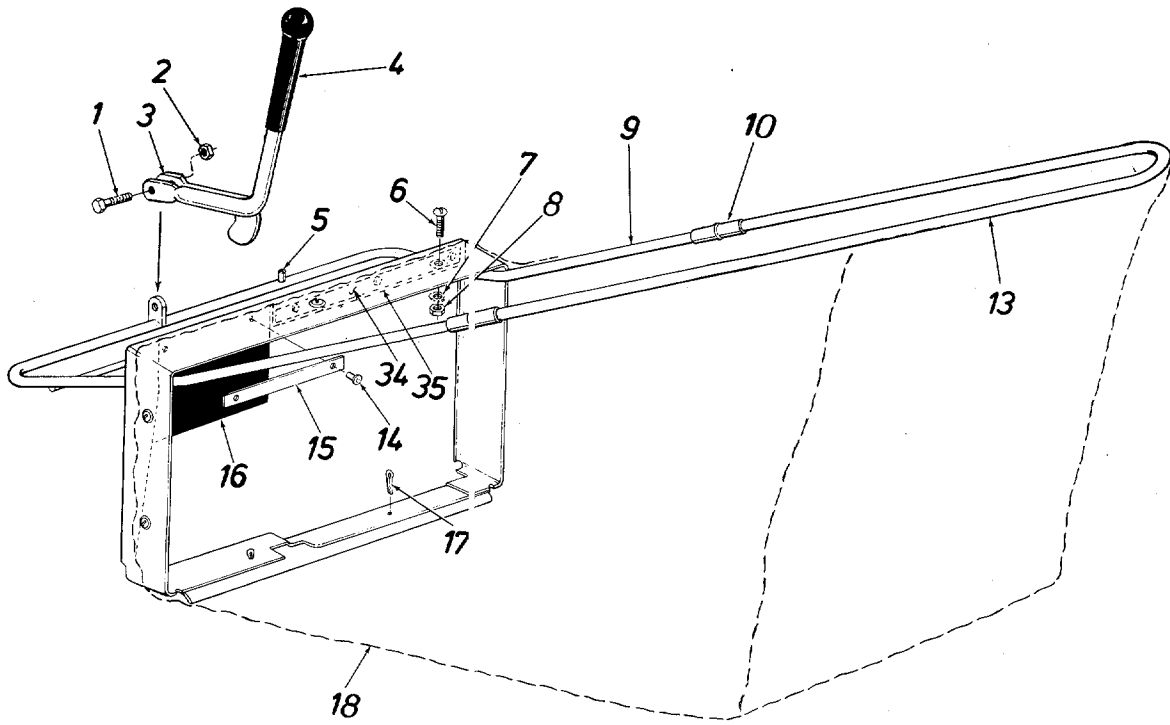

# Model 331A

## PARTS LIST FOR MODEL 331A ROTARY MOWER

REF. NO.	PART NO.	COLOR CODE	DESCRIPTION	NEW PART
1	710-0117		Hex Bolt 5/16-24 x 1.00" Lg.*	
2	712-0305		Hex Cent. L-Nut 5/16-24 Thd.	
3	12393		Cam Lever Ass'y.	
4	720-0143		Grip	
5	715-0247		Spring Pin Spiral	
6	710-0192		Truss Mach. Scr. #10-24 x .38" Lg.*	
7	736-0147		Ext. L-Wash. #10 I.D.	
8	712-0121		Hex Nut #10-24 Thd.*	
9	14131		Catcher Frame Ass'y. Lower Half	
10	750-0473		Tubing Connector	
13	749-0371		Frame—Rear Half	
14	728-0128		Rivet	
15	12185		Reinforcement Bar	
16	735-0168		Grass Catcher Flap	
17	714-0115		Cotter Pin 1/8" Dia. x 1.00" Lg.*	
18	764-0174		Grass Catcher Bag	
19	12192		Grass Catcher Adapter	
20	732-0295		Torsion Spring	
21	726-0135		Push Nut 5/16" Rod	
22	738-0253		Hinge Rod	
23	12395		Chute Door—Upper Half	
24	748-0246		Roller Spacer	
26	747-0141		Connecting Rod	
27	738-0253		Hinge Rod	
28	12194		Chute Door—Lower Half	
29	12195		Hinge Bracket	
30	12185		Reinforcement Bar	
31	728-0131		Rivet .188 x .438	
32	735-0167		Rear Protective Flap	
33	12612		Rear Deck Section Ass'y.	
34	12316		Reinforcement Bar	
35	735-0183		Grass Catcher Flap	

\*For faster service, obtain standard nuts, bolts, and washers locally. If these items cannot be obtained locally, order by part number and size as shown on parts list.

(462—Red Flake) When ordering parts if color or finish is important, use the appropriate color code shown at left. (e.g. Red Flake Finish—12191 (462).)

The engine is not under warranty by the mower manufacturer. If repairs or service is needed on the engine, please contact your nearest authorized engine service outlet. Check the "Yellow Pages" of your telephone book under "Engines—Gasoline."



# PARTS INFORMATION

## POWER EQUIPMENT PARTS AND SERVICE

Parts and service are available through the authorized service firms listed below. All orders should specify the model number of your unit, part numbers, description of parts and the quantity of each part required.

## BRIGGS AND STRATTON, TECUMSEH AND PEERLESS PART AND SERVICE

Briggs & Stratton, Tecumseh and Peerless parts and service should be handled by your nearest authorized engine service firm. Check the yellow pages of your telephone directory under the listing **Engines—Gasoline**, Briggs & Stratton or Tecumseh Lauson.

**NOTE:** If any parts are found to be missing or defective upon assembly of this unit, write to advise the factory so that immediate replacement can be made.

<b>ALABAMA</b>	<b>BIRMINGHAM</b>	<b>GOLDSBORO</b>
Auto Electric & Carburetor Co. ....	2625 4th Ave. S. ....	515 N. George St. ....
<b>ARKANSAS</b>	<b>NORTH LITTLE ROCK</b>	<b>GREENSBORO</b>
Sutton's Lawn Mower Shop .....	5301 Roundtop Drive	335 N. Green .....
	Box 368, Rt. 4 .....	27402
	72117	<b>CARROLL</b>
<b>CALIFORNIA</b>	<b>PORTERVILLE</b>	Stebe's Mid-State Mower Supply . . .
Billious .....	75 North D Street .....	43112
<b>COLORADO</b>	<b>DENVER</b>	<b>CLEVELAND</b>
Spitzer Industrial Products Co. ....	6601 N.	Bleckrie, Inc. ....
	Washington St. ....	44102
	80229	<b>WADSWORTH</b>
<b>FLORIDA</b>	<b>JACKSONVILLE</b>	687 Seville Rd. ....
Radco Distributors .....	4909 Victor St.	44281
	Box 5459 .....	<b>YOUNGSTOWN</b>
	32207	1301 Logan Ave.
	<b>HIALEAH</b>	Box 929 .....
Small Eng. Dist. ....	7995 W. 26th Court .....	44501
<b>GEORGIA</b>	<b>EAST POINT</b>	<b>MUSKOGEE</b>
East Point Cycle & Key .....	2834 Church St. ....	605 S. Cherokee .....
	30344	74401
<b>ILLINOIS</b>	<b>LYONS</b>	<b>PORTLAND</b>
Keen Edge Co. ....	8615 Ogden Ave. ....	8216 N. Denver Ave. ....
	60534	97217
<b>INDIANA</b>	<b>ELKHART</b>	<b>HARRISBURG</b>
Parts & Sales Inc. ....	2101 Industrial Pkwy. ....	4021 N. 6th St. ....
	46516	17110
<b>IOWA</b>	<b>DUBUQUE</b>	<b>PHILADELPHIA</b>
Power Lawn & Garden Equip. ....	2551 J.F. Kennedy ....	5222-24 N. Fifth St. ....
	52001	19120
<b>LOUISIANA</b>	<b>NEW ORLEANS</b>	<b>PITTSBURGH</b>
Suhren Engine Co. ....	8330 Earhart Blvd. ....	11125 Frankstown Rd. ....
	70118	15235
<b>MARYLAND</b>	<b>TAKOMA PARK</b>	<b>PUNXSUTAWNEY</b>
Center Supply Co. ....	6867 New Hampshire	R.D. 2 .....
	Ave. ....	15767
	20912	<b>SCRANTON</b>
<b>MASSACHUSETTS</b>	<b>SPRINGFIELD</b>	Scranton Auto Ignition Co. ....
Morton B. Collins Co. ....	300 Birnie Ave. ....	185
	01107	<b>KNOXVILLE</b>
<b>MICHIGAN</b>	<b>LANSING</b>	2000 Western Ave. ....
Lorenz Service Co. ....	2500 S. Pennsylvania .....	37921
	48910	<b>MEMPHIS</b>
Power Equipment Dist. ....	<b>MOUNT CLEMENS</b>	3035-43 Bellbrook .....
	340 Hubbard .....	38116
	48043	<b>DALLAS</b>
<b>MINNESOTA</b>	<b>HOPKINS</b>	423 E. Jefferson .....
Hance Distributing Inc. ....	420 Excelsior Ave. W. ....	75203
	55343	<b>FORT WORTH</b>
<b>MISSISSIPPI</b>	<b>BILOXI</b>	1702 N. Sylvania .....
Biloxi Sales & Service, Inc. ....	506 Caillavet St. ....	76111
	39533	<b>HOUSTON</b>
<b>MISSOURI</b>	<b>KANSAS CITY</b>	2409 Commerce St. ....
Automotive Equip. Service .....	3117 Holmes St. ....	77003
	64109	<b>SAN ANTONIO</b>
Ross-Frazier Supply Co. ....	<b>ST. JOSEPH</b>	8610 Botts Lane
	8th and Monterey .....	P.O. Box 17867 .....
	64503	78217
Henzler, Inc. ....	<b>ST. LOUIS</b>	<b>BOUNTIFUL</b>
	2015 Lemay Ferry Fld. ....	485 N 500 W. ....
	63125	84010
<b>NEW JERSEY</b>	<b>BELLMAWR</b>	<b>ASHLAND</b>
Lawnmower Parts Inc. ....	717 Creek Rd. ....	101 Cedar Ridge Dr. ....
	08030	23005
<b>NEW MEXICO</b>	<b>ALBUQUERQUE</b>	<b>SEATTLE</b>
Spitzer Eng. & Parts .....	1023 Third Ave. N.W. ....	1414 14th Ave. ....
	87103	98122
<b>NEW YORK</b>	<b>CARTHAGE</b>	<b>APPLETON</b>
Gamble Dist., Inc. ....	West End Ave. ....	123 S. Linwood Ave.
	13619	P.O. Box 798 .....
		54911
		<b>CHILTON</b>
		444 N. Madison St. ....
		53014
		<b>NORTH CAROLINA</b>
		Smith Hardware Co. ....
		27530
		<b>OHIO</b>
		Dixie Sales Company .....
		43112
		<b>OKLAHOMA</b>
		Victory Motors, Inc. ....
		74401
		<b>OREGON</b>
		Kenton Supply Co. ....
		97217
		<b>PENNSYLVANIA</b>
		EECO Inc. ....
		17110
		<b>TENNESSEE</b>
		Master Repair Service .....
		37921
		<b>TEXAS</b>
		Marr Brothers, Inc. ....
		75203
		<b>UTAH</b>
		Powered Products .....
		84010
		<b>VIRGINIA</b>
		RBI Corp. ....
		23005
		<b>WASHINGTON</b>
		Equip. Northwest .....
		98122
		<b>WISCONSIN</b>
		Automotive Supply Co. ....
		54911

## WARRANTY PARTS AND SERVICE POLICY

(1283)

The purpose of warranty is to protect the customer from defects in workmanship and materials, defects which are NOT detected at the time of manufacture. It does not provide for the unlimited and unrestricted replacement of parts. Use and maintenance are the responsibility of the customer. The manufacturer cannot assume responsibility for conditions over which it has no control. Simply put, if it's the manufacturer's fault, it's the manufacturer's responsibility; if it's the customer's fault, it's the customer's responsibility.

### CLAIMS AGAINST THE MANUFACTURER'S WARRANTY INCLUDES:

1. Replacement of Missing Parts on new equipment.
2. Replacement of Defective Parts within the warranty period.
3. Repair of Defects within the warranty period.

All claims MUST be substantiated with the following information:

1. Model Number of unit involved.
2. Date unit was purchased or first put into service.
3. Date of failure.
4. Nature of failure.