



Envoy

CODE
100D

OWNER'S HANDBOOK

(English Version)

CODE FROM SERIAL NO:
100D 260000001
ISSUE: 28.11.05

HANDBOOK: 111-0444(REV .A.)

MAIN FEATURES /SPECIFICATIONS

Main Features

- 1 Handlebar Securing Knob.
- 2 Cable.
- 3 Switch Control Unit.
- 4 Bail Arm.
- 5 Handlebar.
- 6 Cable Cleat.
- 7 Grassbag Assembly.
- 8 Rear Deflector.
- 9 Serial No. Decal.
- 10 Height of Cut Lever
- 11 Motor Housing

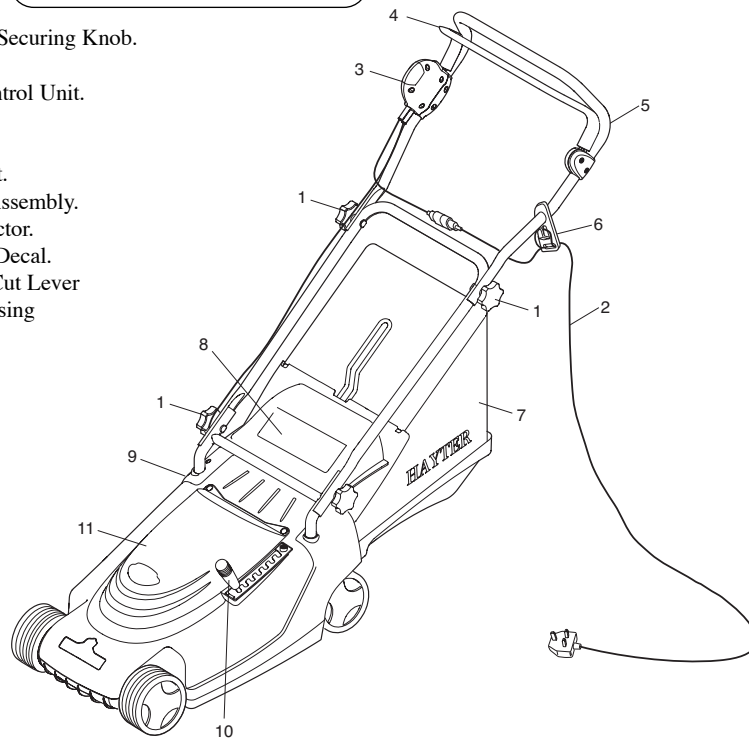

Specifications

Code	100D
Supply	220-240V~50Hz
Rated Input	1.4 kW
Fuse Rating	13A
Weight	23 Kg
Cutterblade Speed	2800 rpm
Cutting width	360mm
Cutting height	13 - 60mm
Overall dimensions	1,360mm x 450mm x 1,040mm

CONTENTS

1.2	Main Features/Specifications	1.19 - 1.22	Mower Maintenance
1.3	Contents	1.19	- Deck Housing
1.4	Introduction	1.19	- Securing Nuts and Bolts
1.5	Warranty	1.19	- Lubrication
1.6 - 1.9	Safety Precautions	1.19	- Motor
1.9	Safety Symbols	1.19	- Switch Control Unit
1.9	Control Symbols	1.20	- Cutterblade Removal
1.10	Assembling the Mower	1.21	- Cutterblade Sharpening
1.10	- Delivery Checklist	1.21	- Supply Cable
1.10	- Handlebar	1.22	- Storage
1.10	- Grassbag Attachment		
1.10	- Supply Cable	1.23 - 1.24	Trouble Shooting
1.11 - 1.15	Operating The Mower	1.25	EC Declaration of Conformity
1.11	- Electrical Connections	1.26 - 1.27	Parts List
1.11	- Starting	1.28	Parts List Diagram
1.11	- Forward Travel	1.29 - 1.31	Notes
1.11	- Turning	1.32	Customer Info
1.12	- Stopping		
1.12	- Height of Cut		
1.12	- Before Mowing		
1.13	- Grassbag		
1.13	- Without Grass Collection		
1.13	- Heavy Growth		
1.13	- Non-Grassed Areas		
1.14	- Safe Mower Practice		
1.15	- Overloading Protection		
1.16 - 1.17	- Lawn Care Calendar - Guide Only		
1.17	- Lawn Stripes		
1.18	Maintenance Schedule		

INTRODUCTION

Thank you for purchasing a **Hayter** mower. The following pages are designed to help you gain safe and efficient service from your mower.

IMPORTANT: This 'Owners Handbook' should be regarded as part of the mower as it gives essential information regarding mower safety, operation, maintenance and specifications. Read and understand this handbook prior to operating your mower for the first time. Make sure you are familiar with all the controls and points of regular maintenance. If you have any doubts, consult your local **Hayter** authorised dealer who will be pleased to give you assistance.

IMPORTANT: This mower is designed solely for use in a domestic grass cutting environment. Use in any other way is considered as contrary to the intended use. Compliance with and strict adherence to the conditions of operation, service and repair as specified in this handbook also constitute essential elements of the intended use.

This mower should be operated, serviced and repaired only by persons who are familiar with its particular characteristics and who are acquainted with the relevant safety procedures.

The safety precautions listed in this handbook and all other generally recognised regulations on safety must be observed at all times.

Any arbitrary modifications carried out to this machine may relieve Hayter Limited of liability for any resulting damage or injury.

Hayter mowers are robustly constructed and designed for efficient economical performance under normal mowing conditions. Correct operation and maintenance will ensure a long and satisfactory service life. Prior to despatch from our factory every effort is made to ensure that your mower is delivered in perfect condition.

Throughout this handbook all references to **left** and **right** are as viewed from behind the handlebar, in the direction of forward travel.

This handbook is based on information available at the time of publication.

HAYTER LIMITED reserve the right to amend product specifications without prior notification.

WARRANTY

LIMITED WARRANTY

Hayter Limited warrants to the original user/purchaser that this unit shall be free from defects in material or workmanship under normal use for a period of two years from the date of purchase. To qualify for the full benefit of the warranty, the warranty registration card must be returned to Hayter Limited within 14 days of purchase. If the selling dealer has not returned the Warranty Registration Card which is attached to the rear of the Owners Handbook please complete and return. Subject to the conditions and exclusions noted in this limited warranty, we shall at our option, repair or replace any warranted part during the applicable period. If you are in any doubt or experience any difficulty, please consult a Hayter Authorised Service Dealer for clarification.

A 90 day warranty period applies to those items which are subject to normal wear and tear e.g. wheels, cutterblades, cables, grassbags and other consumable wearing parts.

This warranty does not apply to any unit that has been tampered with, altered, misused, abused or used for hire, and will become invalid if non genuine Hayter parts are fitted. This warranty does not cover minor mechanical adjustments unless they are due to defective material or workmanship. Consult the Owner's Handbook or a Hayter Authorised Service Dealer for assistance when making these adjustments.

The machines are not warranted for commercial use.

To make a warranty claim, return the unit to a Hayter authorised service dealer along with proof of purchase stating the machine serial number and date of purchase. Subject to the conditions and exclusions in this limited warranty, the authorised dealer will, at our option, repair or replace any warranted part within the duration of the warranty period.

This limited warranty gives specific legal rights and is in addition to any statutory rights to which you may be entitled and your statutory rights are not affected by this warranty. If you need additional information concerning this written warranty, or assistance in obtaining services, please write to: Hayter Limited, Service Department, Spellbrook, Bishop's Stortford, Hertfordshire, CM23 4BU

UK ONLY: Details of your local Hayter authorised dealer are contained in The Yellow Pages or contact:- Freephone 0800 616298: or visit the Hayter website at www.hayter.co.uk

SAFETY PRECAUTIONS

Safety Alert Symbol



This safety alert symbol indicates important safety messages. When you see this symbol be alert to the possibility of injury. Carefully read the following and inform others.

Your mower is perfectly safe if used correctly. Failure to observe the following precautions may result in serious injury.

Training



Read the instructions carefully. Ensure that you are familiar with the controls and the proper use of the equipment. Learn how to stop the mower quickly in an emergency.

Never allow children or people unfamiliar with these instructions to use the mower.

Never mow while people, especially children, or pets are nearby.

Keep in mind that the user is responsible for accidents or hazards occurring to other people or their property.

Preparation



It is recommended that a high sensitivity Residual Current - Operated Circuit - Breaker (RCCB) with a trip current of not more than 30mA is installed at the mains power socket. This will provide the user with additional protection against electric shock. The fuse installed in the plug only provides protection for the electrical equipment and will not safeguard against electrocution. Always check the RCCB before using the mower.

WARNING: Regularly inspect the supply cable for signs of damage or ageing. Replace immediately if defective.

Always wear substantial footwear and long trousers while mowing. Do not operate the equipment when barefoot or wearing sandals.

Thoroughly inspect the area where the mower is to be used and remove all stones, sticks, wires, bones and other foreign objects.

SAFETY PRECAUTIONS

Preparation

Always ensure that the mower is in a safe operating condition. Frequently check all nuts, bolts and screws for tightness. Use only genuine Hayter parts.

A damaged cutterblade and loose fixing bolt are major hazards. Before use, visually inspect the cutting mechanism to ensure that it is in good condition. A damaged cutterblade must be replaced immediately with a genuine **Hayter** replacement part. Cutterblades which are slightly worn can be resharpened. Ensure that both cutting edges are resharpened equally to maintain balance.

An unbalanced cutterblade may cause serious damage to your machine.

Refer to "Maintenance."



Operation

SWITCH OFF AND REMOVE PLUG FROM MAINS.

- Before clearing blockages or unclogging the discharge chute.
- Before cleaning, checking or working on the mower.
- Whenever you leave the mower.
- After striking a foreign object. Inspect the mower for damage and make repairs before re-starting and operating the mower.
- If the mower starts to vibrate abnormally (check immediately).
- If the supply cable is entangled.



THE CUTTERBLADE CAN CONTINUE TO ROTATE AFTER THE MACHINE IS SWITCHED OFF.

Keep the supply cable clear of the cutterblade at all times.

Do not mow across the supply cable. Immediately disconnect the cable from the mains supply if this occurs and check for damage. Do not use a defective supply cable.

Mow only in the daylight or in good artificial light.

Avoid using the mower on wet grass, where feasible.

Always be sure of your footing on slopes.

Walk, never run.

Mow across the face of slopes, never up and down.

Exercise extreme caution when changing direction on slopes.

Do not mow excessively steep slopes.

SAFETY PRECAUTIONS

Operation



Use extreme caution when reversing or pulling the mower towards you.

Switch off if the mower has to be tilted for transportation when crossing surfaces other than grass and when transporting the mower to and from the area to be mowed.

Never operate the mower unless the guards are securely in position and in good condition.

Start the mower carefully, with feet well away from the cutterblade.

Do not tilt the front of the mower more than is absolutely necessary when starting.

Never lift the rear of the mower.

Do not put hands or feet near or under rotating parts.

Never pick up or carry a mower while it is running or connected to the mains supply.

Do not lift the rear deflector plate whilst the mower is in operation, particularly when using without a grassbag.

Maintenance & Storage



Keep all nuts, bolts and screws tight to ensure that the mower is in a safe working condition. (For torque settings refer to mower maintenance).

Carefully examine the supply cable for signs of damage or ageing. Replace immediately if defective.

Check the grassbag frequently for wear or deterioration and replace if necessary.

Wear strong work gloves when removing and reassembling the cutterblade.

Replace worn or damaged parts for safety.

SAFETY PRECAUTIONS

Safety Symbols

Safety Alert - Be aware to the possibility of injury.



Danger of severing toes or fingers in cutting mechanism.



Danger of being hit by thrown objects.



Carefully read the Owners Handbook before using the machine.

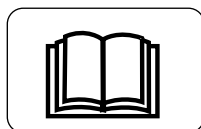

Switch off and remove plug from mains before performing maintenance or repair work.

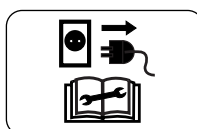

Keep bystanders at a safe distance from the mower.

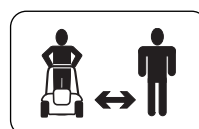

Do not use in rain or in wet conditions.



Wait until all machine components have stopped before touching them.



Danger of Electrical shock, electrocution.



CAUTION - PREVENT ENVIRONMENTAL DAMAGE: This mower has a separate collection mark. This indicates at the end of its life the mower must be taken to an authorised disposal site. It must not be disposed of with general waste. See page 1.22 for more detail.

Control Symbols

Switch ON / OFF
(Symbol)

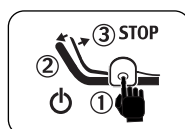

Height of Cut Adjustment
(Symbol)

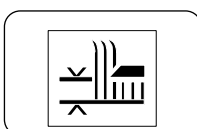

ASSEMBLING THE MOWER

Delivery Checklist

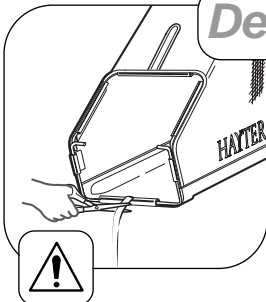

Remove the mower from the packaging and check that the following items have been supplied correctly. If any items are missing contact your local Hayter dealer.

1. Instruction Sheet
2. Grassbag Frame
3. Grassbag Top Cover
4. Grassbag Fabric
5. Supply Cable

To prevent accidents cut off the long ribbon attached to the grassbag and discard.

Handlebar

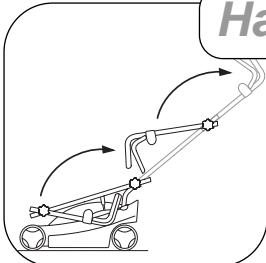

Unscrew the handlebar securing knobs sufficiently to allow the handlebar to pivot. Unfold the handlebar to the operating position. Tighten all handlebar knobs to secure the handlebar in position.

Take care to ensure that the power cable does not become snagged at the pivot points.

Grassbag Attachment

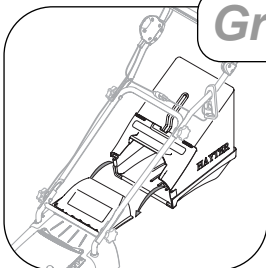

Once the grassbag is assembled. Raise the rear deflector, pass the grassbag under the handlebar and hook in position. Lower the deflector to rest on the grassbag.

Supply Cable

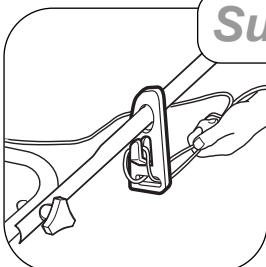

Route the supply cable loosely across to the cable cleat on the left side of the handlebar. Make a loop in the supply cable and secure to the cable cleat.

OPERATING THE MOWER

Electrical Connection

Position the mower on the grass area to be cut. Carefully uncoil the supply cable clear of the mower. Ensure that the mains socket is switched 'OFF' before connecting. Switch 'ON'.

Note: We recommend the use of a RCCB unit- Refer to "Safety Precautions" - Preparation.

Starting

Locate the bail arm lever mounted on the handlebar and ensure that your feet are clear of the mower deck. Depress the safety button with the right hand and pull the bail arm towards the handlebar with the left hand. The motor will now start.

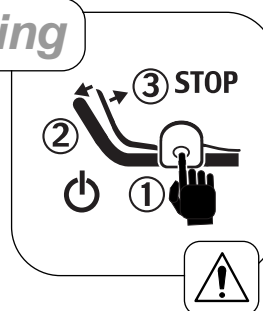

Forward Travel

Hold and push against the handlebar with both hands to move the mower forwards.

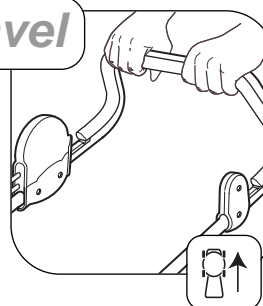

Turning

To make a wide turn steer the mower with the handlebar whilst travelling forward.

To make a tight turn apply downward pressure on the handlebar to raise the front wheels of the mower just above ground level and steer the mower using the handlebar in the required direction.

To prevent accidents do not raise the front of the mower excessively when making a turn. Never raise the rear of the mower when the motor is running.



OPERATING THE MOWER

Stopping

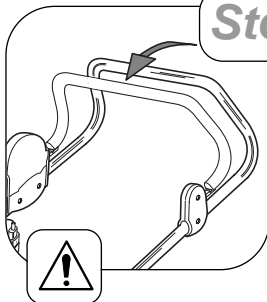

Release the bail arm to stop the motor.

WARNING: AVOID ACCIDENTS - The cutterblade may continue to rotate after the mower is switched off

Height of Cut

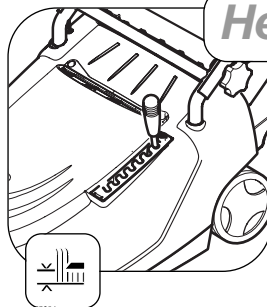

Move the height of cut lever sideways to disengage it from the locking notch, then push forwards to lower or pull backwards to raise the height of cut. Release the lever in the required position and ensure that it locks firmly into one of the seven notch settings.

Always select a height of cut to suit operating conditions. Prevent motor overloading and blockages by avoiding low cuts in long grass conditions. Be prepared to make two cuts when the grass is long.

Before Mowing

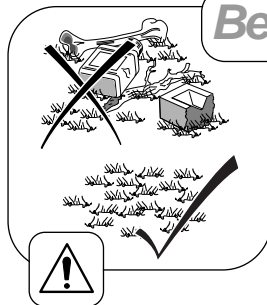

To prevent accidents thoroughly inspect the area and remove all objects which when contacted by the mower cutterblade could become dangerous projectiles. Inspect the area for hidden obstructions which when contacted by the cutterblade could risk health and safety. Remember the location of these obstructions and ensure that you mow around them.

OPERATING THE MOWER

Grassbag

To empty the grassbag raise the rear deflector and pass the grassbag under the handlebar and lower the rear deflector to rest against the rear of the mower.

Pour out the grass clippings and shake the grassbag vigorously to clean the airways. Good grass collection depends on good air flow through the grassbag. When collecting grass clippings it is important that the grassbag is emptied regularly to prevent blockages and motor overloading.

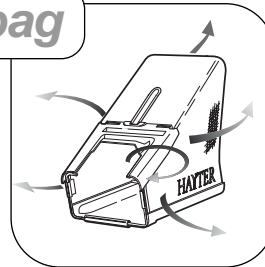

Without Grass Collection

Remove the grassbag and operate the mower with the rear deflector in the closed position.

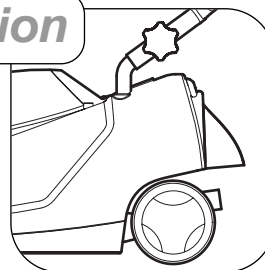

Heavy Growth

Areas of heavy growth should be mown without collecting the clippings. If collection is required, first mow the area without the grassbag at the maximum height of cut setting. Allow the grass clippings to dry out and then mow the area at the maximum height of cut setting with the grassbag fitted. Reduce the height of cut and mow the area again as necessary until the required finish is obtained.

To prevent grass damage do not remove more than one third of grass height in one cut.

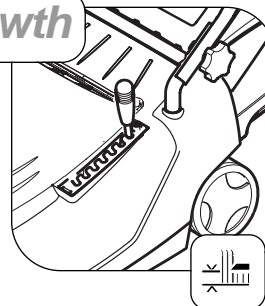

Non-Grassed Areas

When moving the mower across non-grassed areas, stop the motor and set the mower to the maximum height of cut to protect the cutting mechanism.

OPERATING THE MOWER

Safe Mower Practice



WARNING: PREVENT ACCIDENTS -Take extreme care do not mow across the supply cable. If this should occur, switch off immediately and disconnect the plug from the power supply. Carefully examine the cable for cuts and damage. A defective cable must be replaced before the mower is used again. Always be aware of the location of the supply cable in relationship to the mower and the grass area. Do not allow the cable to become hidden in uncut grass. Keep the cable over the cut area at all times. A cable which is out of sight is out of mind and this could lead to a hazardous situation. Plan a 'cutting scheme' which works away from the power supply point and ensures that the cable is trailed out over the cut area. Work up and down the lawn in rows. Turn the machine round at the end of the row and step across the cable so that the cable is trailed along in the cut area on the return run.

When working around flower beds, prevent the cable from trailing across the cultivated area by positioning a stake at the corner of the bed. Do not allow the cable to be pulled around sharp obstructions. Stop mowing immediately if cable resistance is felt and remove the obstruction. Do not allow the cable to become entangled.

WARNING: PREVENT ACCIDENTS - Switch off at the mains, remove the plug before adjusting, cleaning or if the cable is entangled.

OPERATING THE MOWER

Overloading Protection

Do not let the motor labour or slow down through being overloaded in work. When this situation occurs, raise the front of the mower slightly by bearing down on the handlebar, allow the motor to reach maximum speed and proceed to mow at a slower pace. Alternatively readjust to a higher cut position. If the motor continues to labour, switch off and remove the plug from the mains supply. Remove and empty the grassbag. Examine the discharge chute and remove any blockage. Turn the machine on its side and clear any obstruction from the cutterblade and the underside of the mower deck. Place the machine upright and replace the grassbag. Readjust to a higher cut position if necessary. Restart the mower and proceed to mow at a pace which does not overload the mower.



IMPORTANT: PREVENT DAMAGE - DO NOT continue to operate the motor in an overloaded condition. If this does occur, stop mowing and allow the motor to run at maximum speed for one minute. This will allow the motor to cool down to its normal working temperature.

LAWN CARE CALENDAR

To be used as a guide only.

January

There is very little work to do this month apart from brushing away leaves. Keep off the grass if frozen or waterlogged.

February

Rake the grass thoroughly. Spike the lawn to aerate and stimulate soil organisms and root growth and apply lawn sand if necessary.

March

The yearly lawn work programme really starts this month. As soon as the ground conditions are suitable, the first cut can be made. The first cut should merely "top" the grass as close cutting at this stage could result in severe yellowing or browning. Two cuts are generally sufficient this month.

April

Mow often enough to stop grass growing away. Dig out patches of coarse grass or resistant weed. Re-seed bare patches.

May

Keep mowing increasing the frequency as required. Treat with selective weed killers or combined weed/feed preparations if you did not feed the lawn in April.

June

Summer mowing should now be under way. It should be necessary to mow the lawn twice a week. Raking before mowing is important this month as the combined action keeps runners of clover under control. Water the grass if necessary, and remember to soak thoroughly.

July

Treat the grass with the second application of fertiliser or weed killer/fertiliser. Water when necessary and rake occasionally. As a general rule the grass clippings should be removed each time you mow. If weather conditions are dry and hot and the grass is weed free, leave the clippings on the lawn to help maintain ground moisture.

LAWN CARE CALENDAR

August

Keep mowing regularly and watering as necessary. Fill any cracks caused by drought with a mixture of sharp sand and soil. In dry weather conditions leave the grass longer to help retain ground moisture.

September

Raise the height of cut to allow the grass to thicken and protect the roots from the winter frost and snow.

October

Rake out the thatch from the turf and spike the lawn to assist in drainage. Brush in peat and sharp sand.

November

Use a stiff broom to disperse worm casts before mowing. Keep turf free from leaves.

December

Apart from brushing away leaves, December is a slack end of a busy year. Keep off the lawn if it is very wet or frozen.

Lawn Stripes

The way to achieve a neat striped effect is for the lawn being cut in parallel stripes, alternate stripes being mown in opposite directions. A much more important routine is to cut at right angles to the line of the previous mowing. If the work has been carried in a north-south line, then the next cutting should be in an east-west direction. The cross-cutting keeps down the coarse weed grasses.

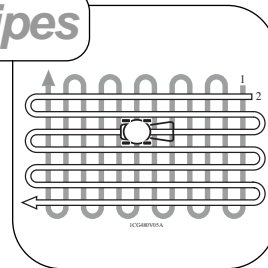

To prevent grass damage do not remove more than one third of the grass height in one cut.

MAINTENANCE SCHEDULE

Follow the hourly or calendar intervals, whichever occurs first. More frequent service will be required if working for prolonged periods under dusty, dry conditions, or when airborne debris is present or after extensive operation cutting tall, dry grass.

Daily

- Remove grass debris from around the height of cut ratchet, air filter in the cowl and the underside of the deck housing.
- Remove grass debris from the grassbag and check for signs of damage.
- Check the condition of guards and safety devices.
- Check condition of cutterblade.

25-50Hrs or Every Season

- Lubricate wheels, pivot points and linkages.
- Sharpen the cutterblade.
- Flash test (Dealer) to ensure complete safety.
- Check cables/switch and connection
- Replace air filter

MOWER MAINTENANCE

Deck Housing

Remove grass debris from the top and underside of the deck housing immediately after use.

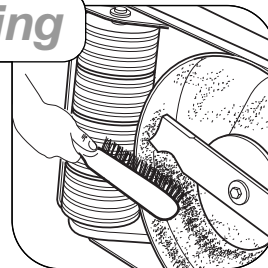

Securing Fasteners

Regularly check that all securing nuts and bolts are tight. Replace missing or damaged items immediately.

Bolt - Cutterblade fixing Torque 20Nm

Plastic Screws - Bottom of Handlebar Torque 3.5Nm

General Screws - Used on plastic parts 1.5Nm (**Note: Use manual handtools only**).

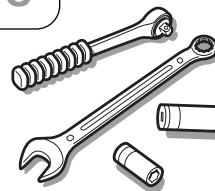

Lubrication

Lubricate the wheels, pivot points and linkages with engine oil every 25 operating hours.

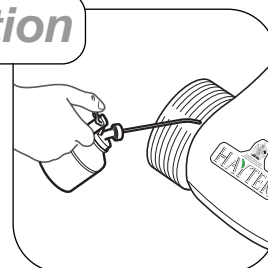

Motor

The motor is maintenance free.

Switch Control Unit

The switch control unit is maintenance free.

MOWER MAINTENANCE

Cutterblade Removal

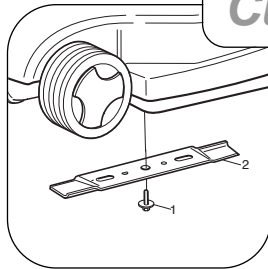

Turn the mower on its side.

Firmly grip the end of the cutterblade (2) with a gloved hand and remove bolt (1). When replacing ensure that the new cutterblade is the correct way up with the turned edges facing towards the motor before locating onto the two carrier pins. Secure the cutterblade fixing nylon bolt and tighten to the specified torque of 20Nm.

The cutterblade has sharp edges. ALWAYS wear strong gloves to protect your hands when working on the cutterblade. DO NOT rotate tools towards the cutting edges to avoid the risk of injury should the tool slip. ALWAYS use genuine Hayter replacement parts.

The condition of the cutterblade and its mounting arrangement should be checked regularly for signs of wear or damage. Ensure that the cutterblade is not bent or cracked.

A damaged cutterblade that is out of balance will vibrate excessively and may break. **DO NOT** use an unbalanced cutterblade.

Regularly check that the bolt securing the cutterblade is tightened to the specified torque of 20Nm.

Replace the cutterblade every 2 years or sooner if excessively worn or damaged.

To prevent injury it is wise to seek assistance when turning the mower on its side.

MOWER MAINTENANCE

Cutterblade Sharpening

A slightly worn cutterblade may be re-sharpened. Both blade edges must be sharpened equally to ensure balance. Sharpen the cutterblade every 25 mowing hours or more frequently if conditions require. Remove the cutterblade from the mower and clean using a brush and water. Inspect the cutterblade for signs of damage. Sharpen both cutting edges with a flat file to restore performance.

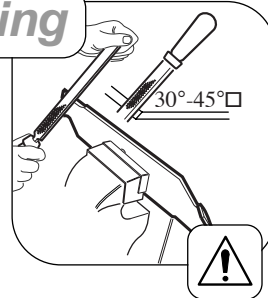

Ensure that the cutterblade is balanced. Use a screw driver with a round shaft to support the cutterblade through its centre hole. Hold the cutterblade horizontal and then release. A balanced cutterblade will remain horizontal.

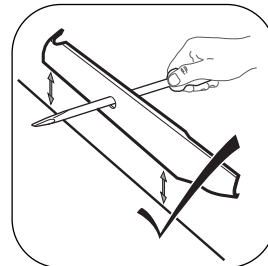

If the cutterblade is not balanced the heavy end will rotate downwards. Sharpen the heavy end until the cutterblade is correctly balanced.

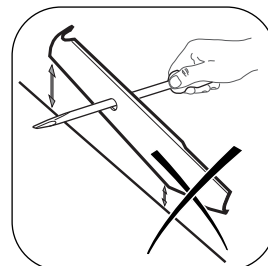

Supply Cable

Check the condition of the supply cable for damage or ageing. Replace immediately if defective.

MOWER MAINTENANCE

Storage

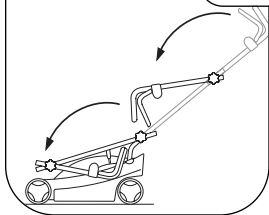

Handlebar storage: To collapse the handlebar first unscrew the two top securing knobs to allow the top section of the handlebar to pivot forward to rest against the middle section then unscrew the bottom two securing knobs sufficiently to allow both top and middle sections to be folded forwards.

Storage for long periods: To ensure your mower is maintained in good working order it is important that the following procedure is adopted when the mower is stored for periods in excess of one month. Refer to the Maintenance section as necessary.

Clean all areas of the mower and ensure that the grassbag is clean.

Lubricate the mower.

Treat metal parts with a water repellent anti-corrosion product.

Lower the handlebar if desired.

Cover the mower with a protective sheet and store it in a dry area.

Rest the mower deck on wooden blocks to remove the weight of the mower from its wheels / roller.



Please refer to Safety Symbols on page 1.9

EU Directive 2002/96/EC classifies this product as an electrical or electronic equipment.

- (a) This equipment should not be disposed of as unsorted municipal waste.
- (b) It should be taken to a designated collection point or recycling centre and handled according to national laws in the area.
- (c) The consumer has a critical role in returning waste electronic/electrical equipment for recycling and disposal.
- (d) Recycling keeps this equipment out of the municipal waste stream.
- (e) The crossed-out bin symbol is a reminder to follow these points.
- (f) Please contact your local authority or local dealer and ask for further details regarding the correct method of disposal.

TROUBLE SHOOTING

PROBLEM	POSSIBLE FAULT	REMEDY
Motor fails to start.	Mains supply socket dead.	Test socket by plugging in another appliance.
	RCCB tripped.	Remove mower plug and check RCCB action. Check the supply cable for any obvious signs of damage and replace immediately if defective. If no obvious faults are found a serious fault is indicated. Contact your Hayter Dealer.
	Plug pulled out of mains socket.	Re-engage plug.
	Fuse failure.	Fit a new 13 amp fuse.
	Supply cable damaged.	Disconnect from the mains and check the supply cable for any obvious signs of damage. Replace immediately if defective.
	Cutterblade obstructed.	Disconnect from the mains and remove any obstructions.
Motor will not stop.	Faulty switch control unit.	Ensure switch lever has returned to the 'OFF' position. Disconnect from the mains and contact your Hayter Dealer.
Cutterblade runs on excessively after switching 'OFF'.	Faulty brake unit.	Contact your Hayter Dealer.

TROUBLE SHOOTING

PROBLEM	POSSIBLE FAULT	REMEDY
Motor vibrates excessively.	Mounting bolts loose.	Tighten bolts.
	Cutterblade bolt loose.	Tighten bolt.
	Cutterblade out of balance.	Balance cutterblade.
Uneven cut	Undulating ground contours.	Change direction of travel.
	Cutterblade worn.	Sharpen the cutterblade.
	Cutterblade out of balance.	Balance cutterblade.
	Wheels / Roller damaged.	Inspect and replace as necessary.
Discharge chute blocks.	Grass is wet.	Mow dry grass.
	Cut height too low.	Increase cut height.
	Grassbag full.	Empty grassbag.
	No airflow through the grassbag.	Clean the grassbag.
Mower is hard to push.	Cut height too low.	Increase cut height.
	Wheels / Roller damaged.	Inspect and lubricate or replace as necessary.
Poor grass collection.	No airflow through the grassbag.	Clean the grassbag.
	Discharge chute blocked.	Remove blockage.
	Wet grass.	Mow dry grass.
	Grassbag full.	Empty grassbag.

EC DECLARATION OF CONFORMITY

Manufactured for: HAYTER LIMITED,
Address: Spellbrook, Bishop's Stortford, Herts. CM23 4BU. ENGLAND



declare that the lawnmower:

Model name:	Envoy
Type:	Pedestrian Rotary Electric Lawnmower
Model No:	CODE 100D
Cutting width:	360 mm
Speed of rotation of the cutting device:	2800 rpm
Motor manufacturer:	ATB, Austria
Speed of rotation of engine:	2800 rpm

Complies with the provisions of Directive: 98/37/EC Essential Health & Safety Requirements Relating to the Design & Construction of Machinery and Safety Components, as amended and the regulations transposed into national law.

Also Directive 89/336/EEC Electromagnetic Compatibility, as amended and the regulations transposed into national law.

Also Directive 73/23/EEC Low Voltage, as amended and the regulations transposed into national law.

Also Directive 2000/14/EC Noise emission in the environment by equipment for use outdoors and the regulations transposed into national law.

Procedure applied for the conformity assessment: ANNEX VI, procedure 1.

Notified Body: TÜV Industrie Service GMBH – TÜV SÜD Group, Westendstraße 199, 80686 MÜNCHEN. Germany

Notified body identification No: 0036

Measured sound power level: 88 dB(A)

Guaranteed sound power level: 96 dB(A)

Complies with harmonized standards: EN 55014-1, EN 55014-2, EN 60335-2-77, EN 61000-3-2 and EN 61000-3-3

Signed

S.A. Maryniak
(Technical Director)

Date: January 2006

Declaration done and technical documentation kept at:
HAYTER LIMITED
Spellbrook, Bishop's Stortford,
Herts. CM23 4BU ENGLAND

VIBRATION INFORMATION

The vibration level at the operator contact positions, measured in accordance with European Standard EN 836

CODE 100D 6.1 ms⁻²

PARTS LIST

ITEM NO.	DESCRIPTION	PART NO.	QTY.	ITEM NOTE
1	Motor	HY100001	1	
2	Capacitor	HY100002	1	
3	Underdeck	HY100003	1	
4	Throw Plate	HY100004	1	
5	Wheel - Wide Assy	HY100506	2	
6	Bearing - Wheel	HY100033	12	
7	Hub - Cap	HY100036	4	
8	Starlock 12mm	HY100047	4	
9	Rod - Rear Axle	HY100068	1	
10	Wheel - Thin Assy	HY100505	4	
11	Lever - HOC	HY100038	1	
12	Spring - HOC	HY100041	1	
13	Rear Axle Assy	HY100504	1	
14	Plate - Axle Pivot	HY100064	4	
15	Screw - M4	HY100078	53	
16	Bolt - Fixing Cutterblade	100013	1	
17	Cutterblade	HY100012	1	
18	Carrier - Cutterblade	100014	1	
19	Rod - Connecting	HY100037	1	
20	Starlock - 8mm	HY100048	3	
21	Axle - Front Assy	HY100503	1	
22	Fins - Front	HY100006	1	
23	Bolt - Motor	HY100076	4	
24	Cover - Main	111-0537	1	
25	Decal - Hayter	410087	1	
26	Hoc - Screw Cover	111-0543	1	
27	Moulding-Vent Mesh Support	111-0041	1	
28	Decal - Envoy	111-0542	1	
29	Cover Electric Trim	111-0538	1	
30	Handlebar - lower	111-0540	1	
31	Handlebar - Middle	100025	1	
32	Handlebar - Upper	100024	1	
33	Switch - Assy/ Trailing Lead	100515	1	
34	Screw - M4 x 19	HY100128	1	
35	Bail Arm	HY100017	1	
36	Mount - Bail Arm Assy	HY100510	1	
37	Hand Wheel - Assy	480088	4	
38	Bolt - Handlebar	HY100028	4	
39	Deflector - Rear	HY100007	1	
40	Rod - Deflector	100126	1	
41	Serial No Label	-----	1	

PARTS LIST

ITEM NO.	DESCRIPTION	PART NO.	QTY.	ITEM NOTE
41	Spring - Deflector	HY100009	1	
42	Knob - HOC	HY100039	1	
43	Ratchet - HOC	111-0539	1	
44	Washer - Spring M8	100119	4	
45	Grassbag - Fabric/base	100513	1	
46	Frame - Grassbag	100016	1	
47	Top - Grass Bag	HY100075	1	
48	Screw - M6 x 20	HY100127	2	
49	Bolt M10 x 30	HY100029	2	
50	Fan - Motor Top	HY100019	1	
51	Spacer - Rear Wheel	HY100030	6	
52	Pin - Spring HOC	HY100042	1	
53	Spring - Counter Balance	100080	1	
54	Cleat - Cable	100105	1	
55	Terminal Block	HY100077	1	
56	Washer - Grip M10	HY100079	2	
57	Vent Mesh Grille	111-0075	1	
58	Cable - Tie	100023	4	
59	Washer - M8	100106	4	
60	Main Lead - 17m UK Assy	HY100135	1	
61	Decal Caution	111-0084	1	

PARTS LIST

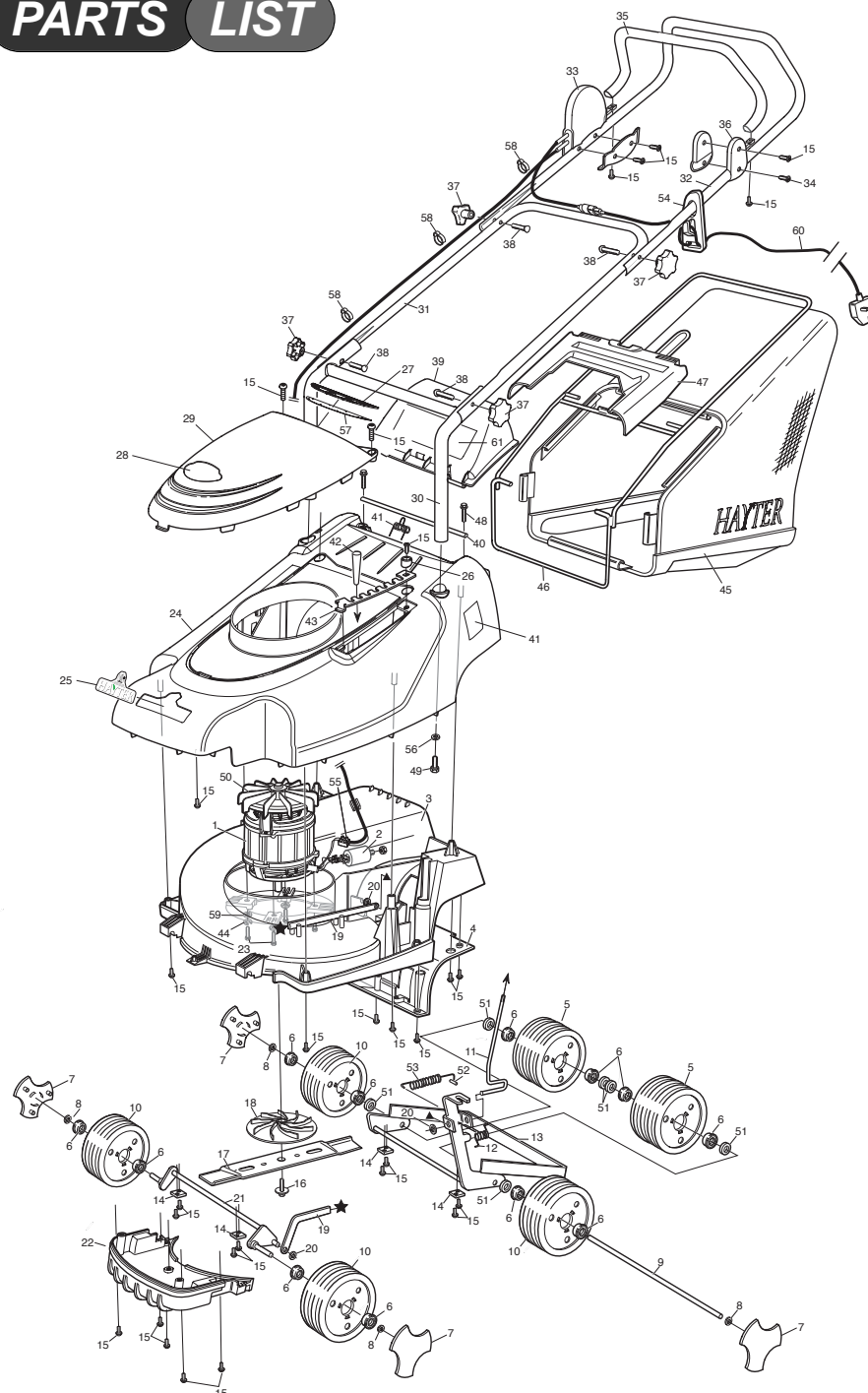

NOTES

Notes:-

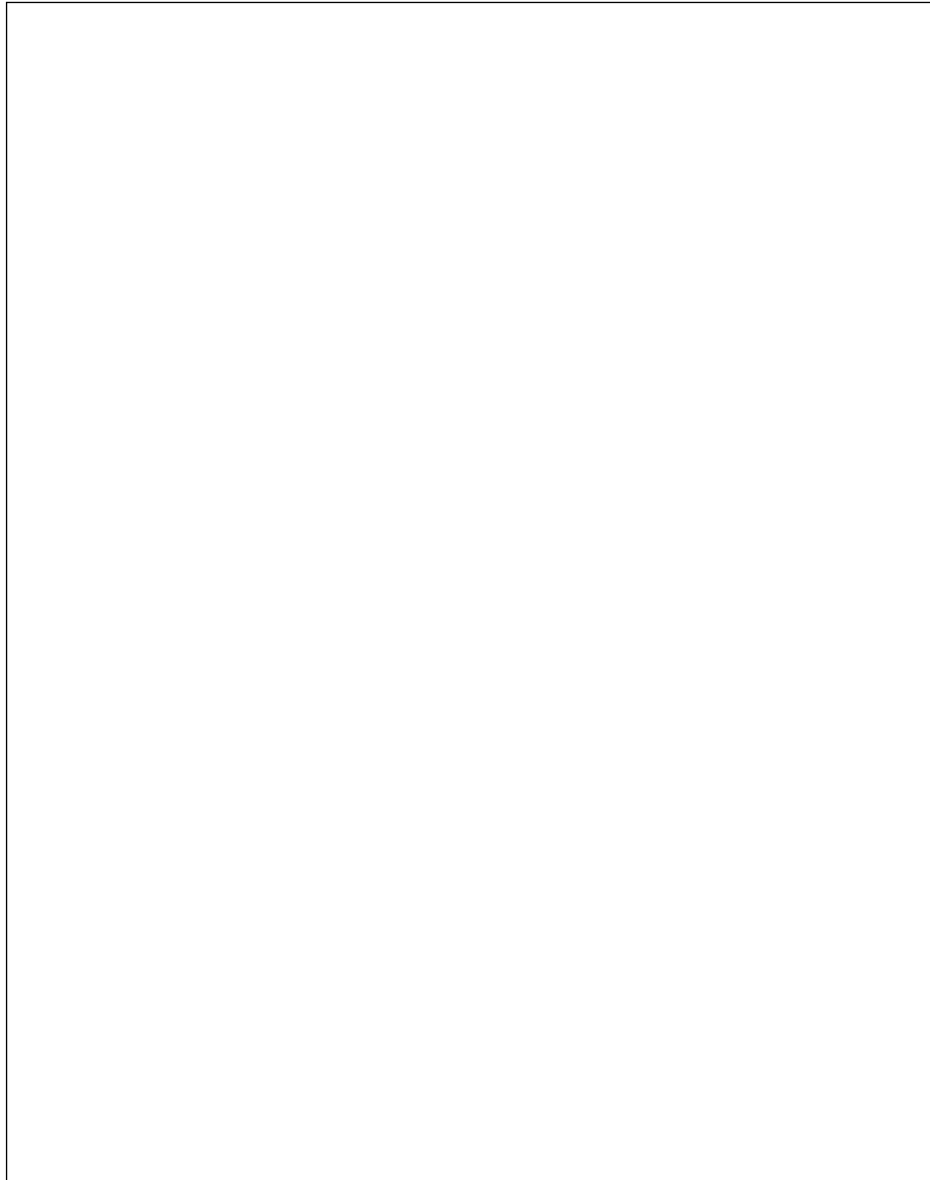

NOTES

Notes:-

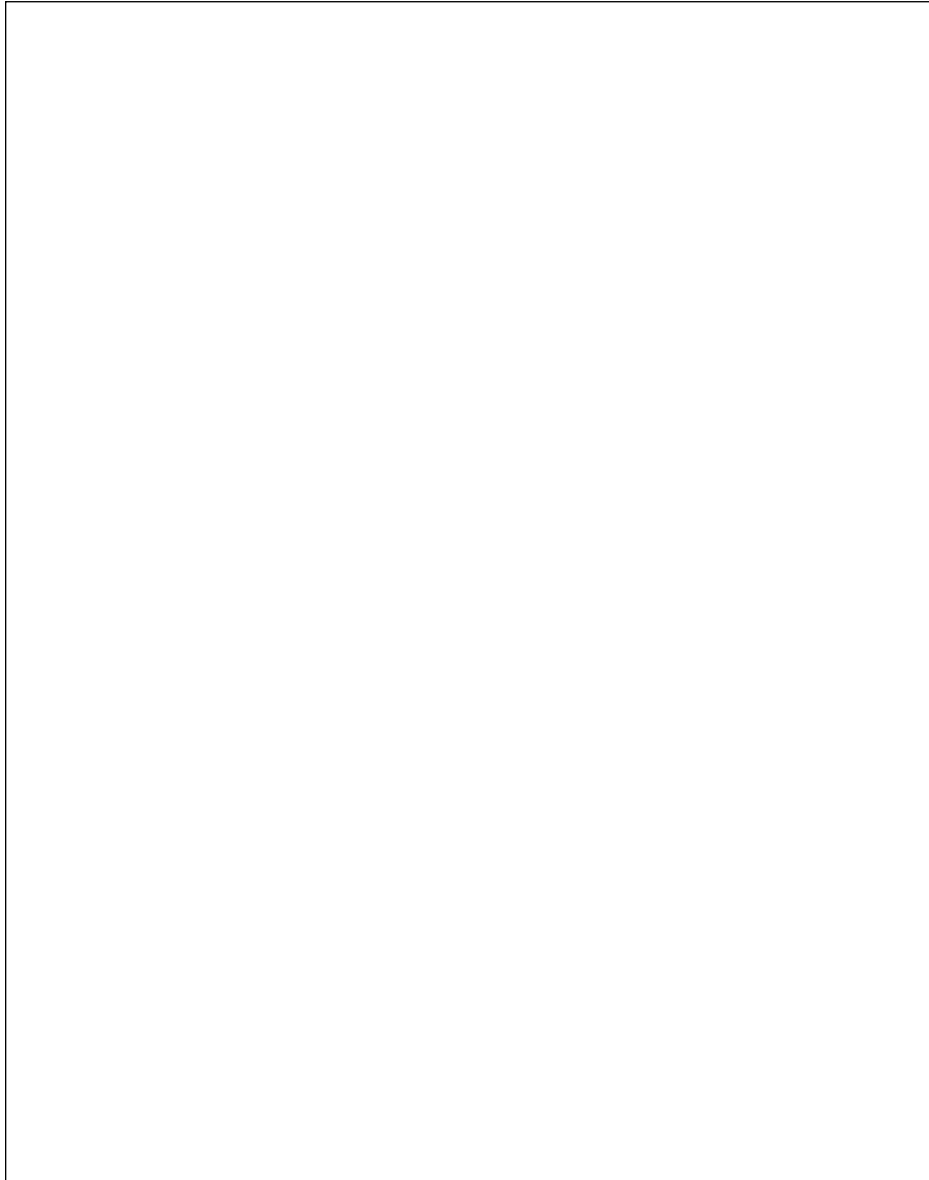

NOTES

Notes:-

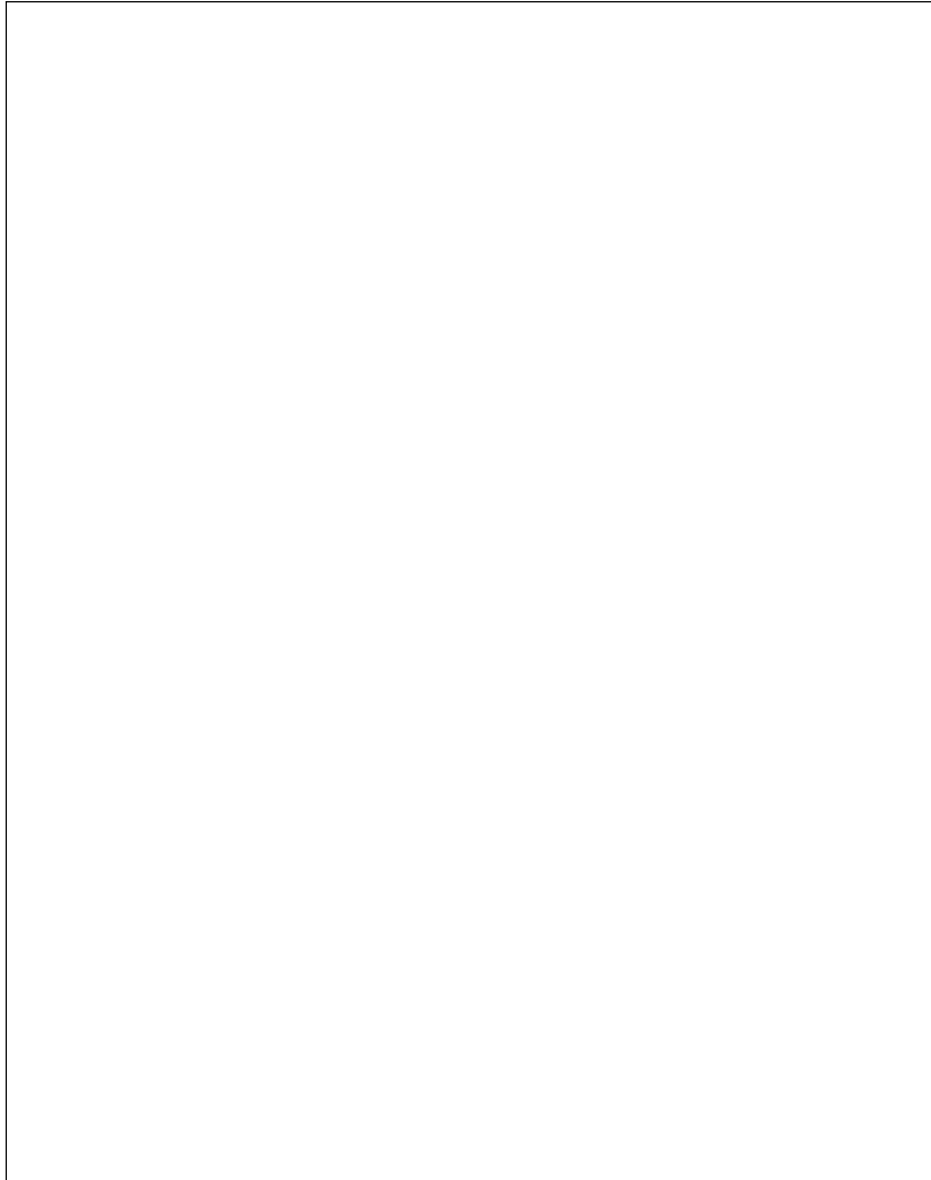

CUSTOMER INFORMATION

Serial No:

Motor Type 220-240V~50Hz (100D)

Date of Sale:- _____

Your Local Dealer:-

DEALER STAMP