

MobileVision™

Operation and Installation Manual

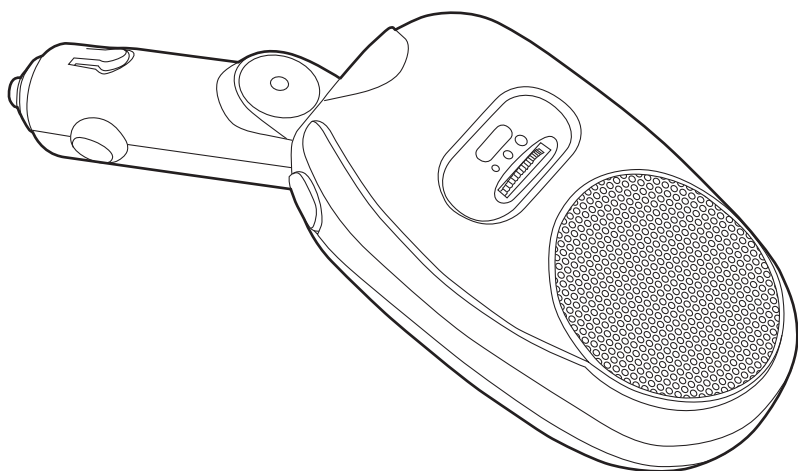

BT-HFKP5
Bluetooth VPA Hands Free
Speakerphone Car Kit

Safety and Caution

- Never install the product in a location where it interferes with your field of vision.
- **This product must be installed and used in accordance with this manual. Any alterations to this product that enables it to be used in any way other than intended or designed could distract the driver and result in an accident causing injury or death. Magnadyne Corporation disclaims any and all liability that may result from failure to install and operate in any other manner in which this was intended.**
- Do not disassemble, modify the unit or attempt to repair the product yourself. If the product needs to be repaired, consult your dealer.
- Do not install the unit in a place exposed to direct sunlight, excessive heat or humidity. Avoid places with excessive dust or the possibility of water splashing.
- **Check local laws regarding use of a mobile handset and speakerphone Car Kits while driving. If you use the speakerphone Car Kit while driving, ensure your attention and focus remains on your responsibility of driving safely.**
- Observe all signs that require an electrical device or RF radio product to be switched off in designated areas. These could include hospitals, blasting areas, and potentially explosive atmospheres.
- Turn off your Speakerphone Car Kit prior to boarding an aircraft. Do not use in aircraft.

FCC Compliance Statement:

This device complies with part 15 of the FCC rules. Operation is subject to the following two conditions:

1. This device may not cause harmful interference.
2. This device must accept any interference received, including interference that may cause undesire operation.

Kit Contents

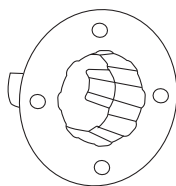

Adapting Collar

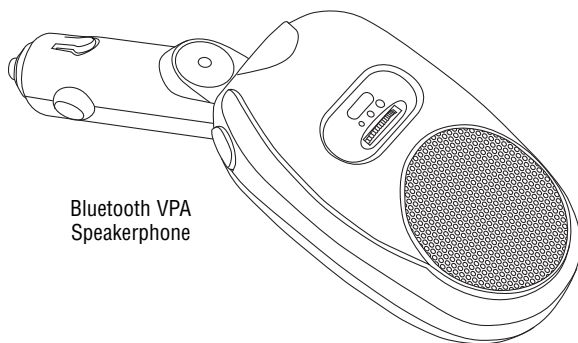

Bluetooth VPA
Speakerphone

Bluetooth Speakerphone Introduction

This Bluetooth VPA (Vehicle Power Accessory) Speakerphone is specially designed for the user to enjoy the convenience of wireless communication. The built-in microphone with D.S.P. technology has echo cancellation along with noise suppression to deliver impeccable sound quality.

Bluetooth Technology?

Bluetooth wireless technology revolutionized personal connectivity by providing freedom from wired connections and enabling connectivity between mobile computers, mobile phones, portable handheld devices and other Bluetooth enables devices within 30 feet. Bluetooth wireless technology utilizes global sound and digital data 2.4G ISM transmission.

Installation

Installing the Bluetooth VPA Speakerphone:

1. Locate the DC power outlet closest to the driver that will not interfere with any operation of the vehicle or driver.
2. Insert the Bluetooth VPA Speakerphone with the speaker and microphone facing the driver.
3. For the best performance, place the kit within 24" of the driver with no obstructions.
4. Use the adapting collar if needed for a better fit into the DC power outlet.

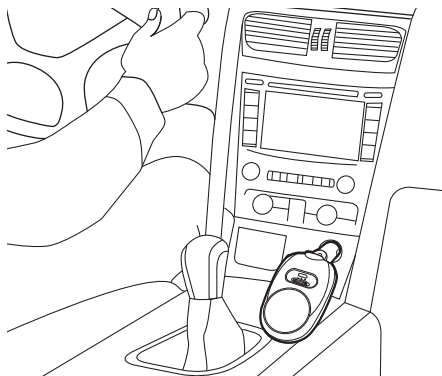

Insert Car Kit into nearest DC power outlet which does not interfere with operation of the vehicle.

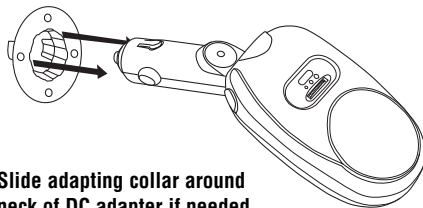

Slide adapting collar around neck of DC adapter if needed.

PLEASE READ PRIOR TO INSTALLATION

CAUTION: Majority of vehicles manufactured today include air bag systems that inflate with great force during an accident. If necessary, contact the vehicle's manufacturer for air bag information specific to the vehicle. **DO NOT** place an object, including all components, in the area over the air bag or in the air bag deployment area. If the components are improperly installed, serious injury could occur during inflation of the air bag.

- Mount components securely to prevent shifting that could cause injury or interfere with the vehicle being operated safely.
- This hands-free kit is intended for 12-24 Volt DC operation only.

Button and Feature Locations

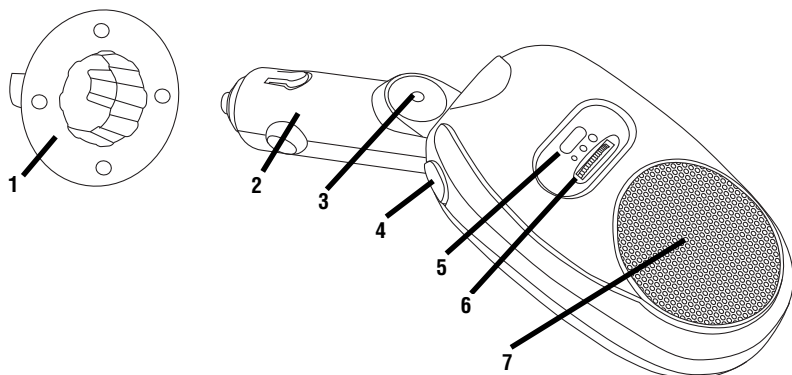

1. Adapting Collar
2. DC Plug
3. Built-In Microphone
4. Multi-Function Button
5. LED

6. Volume Dial
Turn to left or right to decrease or increase volume.
7. Speaker

Operation Instructions

Turning On/Off Car Kit

Turning On: Car kit is in Off mode:

Press and hold the multi-function button for 3 seconds until you hear a short beep. The LED will flash (green) every 3 seconds when the Car Kit is "On" and in standby mode.

Turning Off: When Car Kit is in standby mode:

Press and hold the multi-function button for 3 seconds until you hear a beep. The LED will flash off.

IMPORTANT: Press the multi-function button each time you turn on the car kit to reactivate the pairing so the connection between the car kit and paired mobile handset is resumed. For pairing, please refer to procedures under "Pairing".

Pairing to a Mobile Handset

Prior to using the car kit for the first time, you must pair it with a Bluetooth-enabled mobile handset. The following steps describe the pairing instruction for a typical Bluetooth-enabled mobile handset.

1. Plug the Car Kit into the DC power outlet and have the mobile handset within 24" of the Car Kit.
2. Ensure the car kit is in the "Off" mode.
3. Press and hold the multi-function button for 6 seconds until you hear a long beep. The green LED will turn on when it's ready for pairing.
4. Activate your mobile handset's Bluetooth accessing function by referring to your mobile handset user guide for details. Meanwhile, the handset will search for accessible Bluetooth devices.
5. Select "BT-HFKP5" from the list on your mobile handset.
6. Enter the pre-programmed passkey "0000" and press "OK" to pair the car kit and the handset. When pairing is completed, you may hear a long beep and LED will flash green every three seconds and return to standby mode.
7. Press "Return" to go back to your handset's main menu. (For most mobile handset models, a headset icon or other icon indicating connection will be shown on the screen.) You should now be able to make and receive calls through the car kit.

Operation Instructions (Continued)

IMPORTANT: If the pairing cannot be completed within 2 minutes, the Car Kit's LED will flash off and the Car Kit will go into standby mode. Please repeat steps 2 to 7 to pair the speakerphone and mobile handset again.

Connection/Link to a Mobile Handset

Once pairing is complete, the car kit will be in standby mode. Before you place or answer a call, if the connection icon is not shown on phone screen, follow these steps to activate the Bluetooth connection/link from your handset to the car kit until the connection icon is on the screen.

1. On Handset: Select "BT-HFKP5" from the paired list on your handset screen.
2. On Car Kit: Press multi-function button and select "Accept" on handset screen to accept connection. Some mobile handsets may automatically connect.

IMPORTANT: Whenever the Bluetooth connection/link is removed and you cannot see the connection icon on the phone screen, you must reconnect by following the above directions.

Disconnection from the Mobile Handset

To disconnect your mobile handset from the Car Kit or to Pair/Connect another Bluetooth handset, follow these directions.

1. Power off the Car Kit.
2. Select "disconnect" to remove previous connection from your handset list.
3. Follow pairing directions to pair another Bluetooth-enabled handset.

Using the Car Kit

Once pairing is complete and the battery is fully charged, you may access the following functions. Some of the below-mentioned functions are only accessible for handsets supported with Hands-Free Profile.

Answering a Call:

To answer a call, quickly press the multi-function button, the Car Kit will beep.

Ending a Call:

To end a call, quickly press the multi-function button, the Car Kit will beep.

Reject a Call:

Press and hold the multi-function button for 3 seconds, the Car Kit will beep.

Voice Dialing:

When the Car Kit is in Standby mode, press the multi-function button until it beeps and say the voice tag.

NOTE: The Voice Dialing function only works on voice-dialing enabled phones.

IMPORTANT: Voice tags must be prerecorded into your mobile handset in order to use this function. This function is only applicable to mobile handsets with a Bluetooth Hands-Free Profile. Refer to your mobile handset's user manual for additional information.

Last Number Re-Dialing:

When the Car Kit is in Standby Mode, press the multi-function button twice.

Adjusting the Volume:

Turn the volume dial until the desired volume level is reached.

Operation Instructions (Continued)

LED Indication

Car Kit Mode	Green LED
Power On/ Standby	Flashes every 3 seconds
Power Off	Off
Dialing Out	Flashes every 2 seconds
Answer Calls	Flashes every 2 seconds
Pairing in Progress	Constantly On
Pairing Completed	Flashes every 3 seconds

MFB - Multi-Function Button

Press	Press to MFB	Time
Power On/Off	3 seconds	Once
Pairing	6 seconds	Once
Answering Calls	1 second	Once
Ending Calls	1 second	Once
Call Reject	3 seconds	Once
Voice Dialing	1 second	Once
Last Number Redial	1 second	Twice

Care and Maintenance

- Do not expose the Car Kit to liquid, moisture or humidity. It is not waterproof.
- Do not use abrasive cleaning solvents to clean the Car Kit.
- Do not place the Car Kit in high temperatures.
- Do not attempt to disassemble the Car Kit. It does not contain serviceable components.
- If you won't be using the Car Kit for an extended period of times, store it in a dry place, free from extreme temperatures, humidity or dust.

Trouble Shooting

If you are unable to connect your speakerphone and mobile handset, try the following:	Ensure the Car Kit is paired with your mobile handset.
	Ensure your mobile handset's Bluetooth feature is activated.
	Please refer to your mobile handset user guide for specific instructions.
	Ensure the Car Kit is within a maximum of 30 feet of your mobile handset(s) and there are no obstructions, such as walls or other electrical devices in between as it may cause shorten or interfere with transmission.
	If all the above steps do not resolve your problem, remove the car kit for 5 minutes.

The Bluetooth Car Kit is compliant with and adopts the Bluetooth Specification V1.2. However, interoperability between the device and other Bluetooth-enabled products is not guaranteed because it depends on compatibility. For more information on the compatibility between the device with other Bluetooth-enabled products, please check with the manufacturer/importer.

Specifications

Bluetooth Specifications:	Version 1.2, Class 2, 10 Meters
Bluetooth Profile Supported:	Headset & Hands-Free Profiles
Operating Frequency Band :	2.402 to 2.480GHz unlicensed ISM band
Multi-Pairing:	Up to 7 bluetooth devices
Input Voltage:	DC 12-24V
Dimension(L/M/S):	15.5 x 5.5 x 3.2cm.
Weight:	69 g. with battery

ONE (1) YEAR LIMITED WARRANTY

Magnadyne Corporation or its authorized agents will within one year from the date of sale to you, repair, replace or refund the retail sales price of said product or any part thereof, at the option of the Magnadyne Corporation or its authorized agents, if said product or part is found defective in materials or workmanship, when properly connected and operating on the correct power requirements designated for the specific product. This warranty and Magnadyne Corporation or its authorized agent's obligations hereunder do not apply where the product was; damaged while in the possession of the consumer, subjected to unreasonable or unintended use, not reasonably maintained, utilized in commercial or industrial operations, or serviced by anyone other than Magnadyne Corporation or its authorized agents, or where the warning seal on the product is broken or the power and/or plugs are detached from the unit. Magnadyne Corporation or any of its authorized agents will not assume any labor costs for the removal and reinstallation of any product found to be defective, or the cost of transportation to Magnadyne Corporation or its authorized agents. Such cost are the sole responsibility of the purchaser.

This warranty does not cover the cabinet appearance items or accessories used in connection with this product, or any damage to recording or recording tape, or any damage to the products resulting from improper installation, alteration, accident, misuse, abuse or acts of nature.

MAGNADYNE CORPORATION OR ITS AUTHORIZED AGENTS SHALL NOT BE LIABLE TO ANYONE FOR CONSEQUENTIAL OR INCIDENTAL DAMAGES OR CLAIMS EXCEPT THOSE ACCORDED BY LAW. NO EXPRESSED WARRANTY OR IMPLIED WARRANTY IS GIVEN EXCEPT THOSE SET FORTH HEREIN. NO IMPLIED WARRANTY SHALL EXTEND BEYOND ONE YEAR FROM THE DATE OF SALE.

This warranty extends only to the original purchaser of the product and is not transferable. Some states do not allow limitations on how long an implied warranty lasts, and some states do not allow the exclusion or limitation of incidental or consequential damages, so the above limitations or exclusion may not apply to you. This warranty gives you specific legal rights, and you may have other rights that vary from state to state.

“NOTE: The manufacturer is not responsible for any radio or TV interference caused by unauthorized modifications to this equipment. Such modifications could void the User's authority to operate the equipment.”

Defective merchandise should be returned to the original point of purchase or secondly, to Magnadyne Corporation, 1111 W. Victoria Street, Compton CA 90220.

Return Authorization must be obtained before sending, or merchandise may be refused.