

SONY®

VAIO® C1 PictureBook™ Computer User Guide

PCG-C1XS



Notice to Users

© 2000 Sony Electronics Inc. All rights reserved. This manual and the software described herein, in whole or in part, may not be reproduced, translated, or reduced to any machine-readable form without prior written approval.

SONY ELECTRONICS INC. PROVIDES NO WARRANTY WITH REGARD TO THIS MANUAL, THE SOFTWARE, OR OTHER INFORMATION CONTAINED HEREIN AND HEREBY EXPRESSLY DISCLAIMS ANY IMPLIED WARRANTIES OF MERCHANTABILITY OR FITNESS FOR ANY PARTICULAR PURPOSE WITH REGARD TO THIS MANUAL, THE SOFTWARE, OR SUCH OTHER INFORMATION. IN NO EVENT SHALL SONY ELECTRONICS INC. BE LIABLE FOR ANY INCIDENTAL, CONSEQUENTIAL, OR SPECIAL DAMAGES, WHETHER BASED ON TORT, CONTRACT, OR OTHERWISE, ARISING OUT OF OR IN CONNECTION WITH THIS MANUAL, THE SOFTWARE, OR OTHER INFORMATION CONTAINED HEREIN OR THE USE THEREOF.

Sony Electronics Inc. reserves the right to make any modification to this manual or the information contained herein at any time without notice. The software described herein is governed by the terms of a separate user license agreement.

This product contains software owned by Sony and licensed by third parties. Use of such software is subject to the terms and conditions of license agreements enclosed with this product. Some of the software may not be transported or used outside the United States. Software specifications are subject to change without notice and may not necessarily be identical to current retail versions.

Updates and additions to software may require an additional charge. Subscriptions to online service providers may require a fee and credit card information. Financial services may require prior arrangements with participating financial institutions.

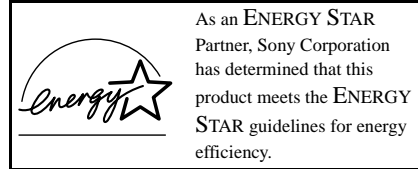

The International ENERGY STAR Office Equipment Program is an international program that promotes energy saving through the use of computers and other office equipment. The program backs the development and dissemination of products with functions that effectively reduce energy consumption. It is an open system in which business proprietors can participate voluntarily. The targeted products are office equipment such as computers, displays, printers, facsimiles and copiers. Their standards and logos are uniform among participating nations. ENERGY STAR is a U.S. registered mark.

Sony, i.LINK, Jog Dial, Motion Eye, VAIO, and the VAIO logo are trademarks of Sony Corporation. Windows and the Windows 98 logo are registered trademarks of Microsoft Corporation.

All other trademarks are trademarks of their respective owners

Owner's Record

The model number and serial number are located on the bottom of your VAIO® PCG-C1XS PictureBook Computer. Record the serial number in the space provided here. Refer to the model and serial numbers when you call your Sony Service Center.

Model Number: PCG-C1XS

Serial Number: _____

Safety Information

WARNING

- To prevent fire or shock hazard, do not expose your notebook computer to rain or moisture.
- To avoid electrical shock, do not open the cabinet. Refer servicing to qualified personnel only.
- Never install modem or telephone wiring during a lightning storm.
- Never install telephone jacks in wet locations unless the jack is specifically designed for wet locations.
- Never touch uninsulated telephone wire or terminals unless the telephone line has been disconnected at the network interface.
- Use caution when installing or modifying telephone lines.
- Avoid using the modem during an electrical storm.
- Do not use the modem or a telephone to report a gas leak in the vicinity of the leak.
- A socket outlet should be as close as possible to the unit and easily accessible.

- ! **For CD-ROM: The use of optical instruments with the CD-ROM drive will increase eye hazard.**
- ! **L'utilisation d'instruments optiques avec cet appareil augmente le risque de blessures aux yeux.**

- ! **For DVD-ROM: As the laser beam used in the DVD-ROM drive is harmful to the eyes, do not attempt to disassemble the drive cabinet. Refer servicing to qualified personnel only.**
- ! **Comme le faisceau laser utilisé par ce lecteur DVD-ROM est dangereux pour les yeux, ne tentez pas de démonter le boîtier. Confiez l'entretien de cet appareil exclusivement au personnel qualifié.**

- ! **CAUTION: To reduce the risk of fire, use only No. 26 AWG or larger telecommunication line cord.**
- ! **ATTENTION: Pour réduire le risque d'incendie, utiliser seulement un cordon de télécommunication n° 26 AWG ou plus gros.**

AVERTISSEMENT

- Pour prévenir tout risque d'incendie ou d'électrocution, garder cet appareil à l'abri de la pluie et de l'humidité.
- Pour prévenir tout risque d'électrocution, ne pas ouvrir le châssis de cet appareil et ne confier son entretien qu'à une personne qualifiée.
- L'appareil doit être le plus près possible d'une prise murale pour en faciliter l'accès.

For questions regarding your product or for the Sony Service Center nearest you, call 1-888-476-6972 in the United States or 1-800-961-7669 in Canada.

The number below is for FCC related matters only.

Regulatory Information

Declaration of Conformity

Trade Name: SONY

Model No: PCG-C1XS

Responsible Party:
Sony Electronics Inc.

Address:
1 Sony Drive
Park Ridge, NJ 07656

Telephone No.: 201-930-6972

This device complies with Part 15 of the FCC rules. Operation is subject to the following two conditions: (1) This device may not cause harmful interference, and (2) this device must accept any interference received, including interference that may cause undesired operation.

This equipment has been tested and found to comply with the limits for a Class B digital device, pursuant to Part 15 of the Rules. These limits are designed to provide reasonable protection against harmful interference in a residential installation. This equipment generates, uses, and can radiate radio frequency energy and, if not installed and used in accordance with the instructions, may cause harmful interference to radio communications. However, there is no guarantee that

interference will not occur in a particular installation. If this equipment does cause harmful interference to radio or television reception, which can be determined by turning the equipment off and on, the user is encouraged to try to correct the interference by one or more of the following measures:

- Reorient or relocate the receiving antenna.
- Increase the separation between the equipment and the receiver.
- Connect the equipment into an outlet on a circuit different from that to which the receiver is connected.
- Consult the dealer or an experienced radio/TV technician for help.

You are cautioned that any changes or modifications not expressly approved in this manual could void your authority to operate this equipment.

Only peripherals (computer input/output devices, terminals, printers, etc.) that comply with FCC Class B limits may be attached to this computer product. Operation with non-compliant peripherals is likely to result in interference to radio and television reception.

All cables used to connect peripherals must be shielded and grounded. Operation with cables, connected to peripherals, that are not shielded and grounded, may result in interference to radio and television reception.

FCC Part 68

This equipment complies with Part 68 of the FCC rules. On the bottom of this equipment is a label that contains, among other information, the FCC equivalence number (REN) for this equipment. If requested, this information must be provided to the telephone company.

This modem uses the USOC RJ-11 telephone jack.

The REN is used to determine the quantity of devices which may be connected to the telephone line. Excessive RENs on the telephone line may result in the devices not ringing in response to an incoming call. In most, but not all areas, the sum of the RENs should not exceed five (5.0). To be certain of the number of devices that may be connected to the line, as determined by the total RENs, contact the telephone company to determine the maximum REN for the calling area.

If the terminal equipment causes harm to the telephone network, the telephone company will notify you in advance that temporary discontinuance of service may be required. But if advance notice is not practical, the telephone company will notify the customer as soon as possible. Also, you will be advised of your right to file a complaint with the FCC if you believe it is necessary.

The telephone company may make changes in its facilities, equipment, operations or procedures that could affect the operations of the equipment. If this happens, the telephone company will provide advance notice in order for you to make the necessary modifications in order to maintain uninterrupted service.

If trouble is experienced with this equipment, please contact 1-888-4SONYPC (1-888-476-6972), or write to the Sony Customer Information Center, One Sony Drive, Park Ridge, NJ 07656 for repair and/or warranty information. If the trouble is causing harm to the telephone network, the telephone company may request that you remove the equipment from the network until the problem is resolved.

Repair of this equipment should be made only by a Sony Service Center or Sony authorized agent. For the Sony Service Center nearest you, call 1-888-4SONYPC (1-888-476-6972).

This equipment cannot be used on public coin service provided by the telephone company. Connection to Party Line Service is subject to state and possible provincial tariffs. (Contact the state or provincial utility service commission, public service commission, or corporation commission for information.)

Telephone Consumer Protection Act of 1991 (United States)

The Telephone Consumer Protection Act of 1991 makes it unlawful for any person to use a computer or other electronic device to send any message via a telephone facsimile machine unless such message clearly contains, in a margin at the top or bottom of each transmitted page or on the first page of the transmission, the date and time it is sent and an identification of the business, other entity, or individual sending the message, and the telephone number of the sending machine or such business, other entity, or individual.

In order to program this information into your facsimile machine, see your fax software documentation.

Telephone Consumer Guidelines (Canada)

Please refer to your telephone directory under 'Privacy Issues' and/or 'Terms of Service.' For more detailed information, please contact:

CRTC
Terrasses de la Chaudière, Tour centrale
1 promenade du Portage, 5 étage Hull PQ
K1A 0N2.

This Class B digital apparatus complies with Canadian ICES-003.

Cet appareil numérique de la classe B est conforme à la norme NMB-003 du Canada.

DISPOSAL OF LITHIUM ION BATTERY

You can return your unwanted lithium ion batteries to your nearest Sony Service Center or Factory Service Center.



In some areas the disposal of lithium ion batteries in household or business trash may be prohibited.

For the Sony Service Center nearest you call 1-888-476-6972 in the United States or 1-800-961-7669 in Canada.

! Do not handle damaged or leaking lithium ion batteries.

! Ne pas manipuler les batteries au lithium-ion qui fuient ou sont endommagées.

! Danger of explosion if battery is incorrectly replaced. Replace only with the same or equivalent type recommended by the manufacturer. Discard used batteries according to the manufacturer's instructions.

! Une batterie non conforme présente un danger d'explosion. La remplacer seulement par une batterie identique ou de type équivalent recommandé par le fabricant. Évacuer les batteries usées selon les directives du fabricant.

! The battery pack used in this device may present a fire or chemical burn hazard if mistreated. Do not disassemble, heat above 212°F (100°C) or incinerate. Dispose of used battery promptly. Keep away from children.

! La manutention incorrecte du module de batterie de cet appareil présente un risque d'incendie ou de brûlures chimiques. Ne pas démonter, incinérer ou exposer à une température de plus de 100°C. Évacuer promptement la batterie usée. Garder hors de portée des enfants.

INDUSTRY CANADA NOTICE

NOTICE: The Industry Canada label identifies certified equipment. This certification means that the equipment meets certain telecommunications network protective, operational and safety requirements as prescribed in the appropriate Terminal Equipment Technical Requirements document(s). The Department does not guarantee the equipment will operate to the user's satisfaction.

Before installing this equipment, users should ensure that it is permissible to be connected to the facilities of the local telecommunications company. The equipment must also be installed using an acceptable method of connection.

The customer should be aware that compliance with the above conditions may not prevent degradation of service in some situations.

Repairs to certified equipment should be coordinated by a representative designated by the supplier. Equipment malfunctions or any repairs or alterations made by the user to this equipment may give the telecommunications company cause to request that the user disconnect the equipment.

Users should ensure for their own protection that the electrical ground connections of the power utility, telephone lines and internal metallic water pipe system, if present, are connected together. This precaution may be particularly important in rural areas.

Caution: Users should not attempt to make such connections themselves, but should contact the appropriate electric inspection authority, or electrician, as appropriate.

NOTICE: The Ringer Equivalence Number (REN) assigned to each terminal device provides an indication of the maximum number of terminals allowed to be connected to a telephone interface. The termination on an interface may consist of any combination of devices subject only to the requirement that the sum of the Ringer Equivalence Numbers of all the devices does not exceed 5. The Ringer Equivalence Number for this equipment is 0.1.

AVIS DE L'INDUSTRIE CANADA

AVIS: L'étiquette d'Industrie Canada identifie le matériel homologué.

Cette étiquette certifie que le matériel est conforme aux normes de protection, d'exploitation et de sécurité des réseaux de télécommunications, comme le prescrivent les documents concernant les exigences techniques relatives au matériel terminal. Le Ministère n'assure toutefois pas que le matériel fonctionnera à la satisfaction de l'utilisateur.

Avant d'installer ce matériel, l'utilisateur doit s'assurer qu'il est permis de le raccorder aux installations de l'entreprise locale de télécommunication. Le matériel doit également être installé en suivant une méthode acceptée de raccordement. L'abonné ne doit pas oublier qu'il est possible que la conformité aux conditions énoncées ci-dessus n'empêche pas la dégradation du service dans certaines situations.

Les réparations de matériel homologué doivent être coordonnées par un représentant désigné par le fournisseur. L'entreprise de télécommunications peut demander à l'utilisateur de débrancher un appareil à la suite de réparations ou de modifications effectuées par l'utilisateur ou à cause de mauvais fonctionnement.

Pour sa propre protection, l'utilisateur doit s'assurer que tous les fils de mise à la terre de la source d'énergie électrique, des lignes téléphoniques et des canalisations d'eau métalliques, s'il y en a, sont raccordés ensemble. Cette précaution est particulièrement importante dans les régions rurales.

Avertissement: L'utilisateur ne doit pas tenter de faire ces raccordements lui-même; il doit avoir recours à un service d'inspection des installations électriques, ou à un électricien, selon le cas.

AVIS: L'indice d'équivalence de la sonnerie (IES) assigné à chaque dispositif terminal indique le nombre maximal de terminaux qui peuvent être raccordés à une interface.

La terminaison d'une interface téléphonique peut consister en une combinaison de quelques dispositifs, à la seule condition que la somme d'indices d'équivalence de la sonnerie de tous les dispositifs n'excède pas 5. L'indice d'équivalence de la sonnerie de ce matériel est 0.1.

Contents

<i>Welcome</i>	1
Features	1
Unpacking Your VAIO C1 PictureBook Computer.....	2
Manuals.....	2
Software CDs.....	3
Recovery CDs.....	3
Other.....	3
<i>Setting Up Your VAIO C1 PictureBook™ Computer</i>	5
Locating the Controls and Connectors.....	5
Front.....	5
Left.....	6
Right.....	7
Bottom.....	7
Connecting a Power Source.....	8
Using the AC Adapter.....	8
Using Battery Power.....	9
Conserving Battery Power.....	13
Opening the PowerPanel.....	13
Displaying the PowerPanel Toolbar.....	13
Starting Your VAIO C1 PictureBook Computer.....	14
Shutting Down Your VAIO C1 PictureBook Computer.....	15
Registering Your Computer.....	16
Using the Keyboard.....	17
Combinations and Functions with the Windows 98 Key.....	19
Indicators.....	20
Combinations and Functions with the Fn Key.....	21

Using the Pointing Device.....	22
VAIO Action Setup	24
Jog Dial™ Control.....	24
Using the Jog Dial™ Control.....	26
Software that does not support the Jog Dial Control	27
Internal Timer.....	28
AutoAlert E-mail Notification System.....	28
i.LINK Interface.....	28
Using the built-in MOTION EYE camera	29
Capturing a still image.....	29
Using the Floppy Disk Drive	33
Using PC Cards	35
Using Smart Connect	38
Using Infrared Communication Devices	39
Using Power Saving Modes.....	41
Normal Mode	41
System Suspend Mode.....	41
System Hibernation Mode.....	42
<i>Connecting Peripheral Devices</i>	<i>43</i>
Connecting a Phone Line	44
Connecting a Printer	46
Connecting an External Display.....	47
Selecting a Display	50
CRT Display.....	52
Television Display (When connected to the Display Adapter)...	54
Connecting an External USB Mouse.....	55
Connecting a CD Drive	56
Connecting an i.LINK device	59
Connecting External Speakers.....	60
Connecting an External Microphone.....	61

<i>Getting Help</i>	62
Troubleshooting	64
Power Management.....	71
Using the System and Application Recovery CDs.....	72
Using the System Recovery CD(s).....	72
Using the Application Recovery CD(s).....	74
Hard Drive Partition.....	75
Specifications	76
 <i>Index</i>	 79

Welcome

Congratulations on your purchase of the VAIO® C1 PictureBook™ Computer with integrated digital camera. Sony has combined leading-edge technology in audio, video, computing, and communications to provide you with state-of-the-art personal computing.

Features



For a complete description of the specifications of your VAIO® C1 PictureBook, see page 76.

- ❑ **Exceptional performance** - Your computer includes a fast Intel® processor.
- ❑ **Portability** - The rechargeable battery pack provides hours of use without AC power.
- ❑ **Sony audio and video quality** - A high-resolution LCD screen enables you to take advantage of today's advanced multimedia applications, games, and entertainment software.
- ❑ **Windows® 98 Second Edition** - Your system includes one of the latest operating systems from Microsoft.
- ❑ **Communications:** Access popular online services, send and receive e-mail, browse the Internet, and use the dialing and fax features.

Unpacking Your VAIO C1 PictureBook Computer

Remove the following hardware items from the box:

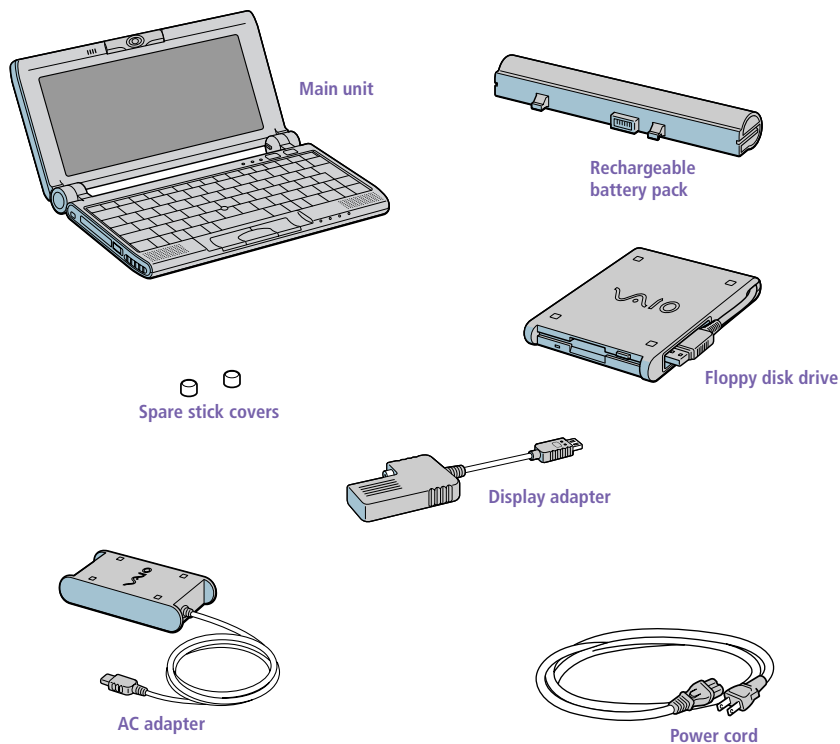

Manuals

- ❑ The *VAIO® C1 PictureBook Computer User Guide* (this manual) contains information on how to get the most from your computer, find help and solve common problems. It also includes product specifications.
- ❑ *Read Me First* contains Frequently Asked Questions, the most up-to-date information on using your computer, and software information.
- ❑ The *Consumer Information Guide* contains ergonomic considerations and your computer's limited warranty statement.
- ❑ The *Microsoft® Windows® 98 Second Edition Getting Started* manual explains how to use the basic features of the Windows operating system.

Software CDs

- ❑ Microsoft® Word 2000

Recovery CDs

- ❑ System Recovery CD(s)
- ❑ Application Recovery CD(s)



To use these recovery CDs, you need to purchase the PCGA-CD51 CD-ROM drive.

Other

- ❑ Setting up your VAIO® C1 PictureBook™ Computer (poster)
- ❑ Packet containing special product offers

Setting Up Your VAIO C1 PictureBook™ Computer

This section describes how to start using your computer and how to use your computer's internal and external devices, such as the pointing device and floppy disk drive.

Locating the Controls and Connectors

Front

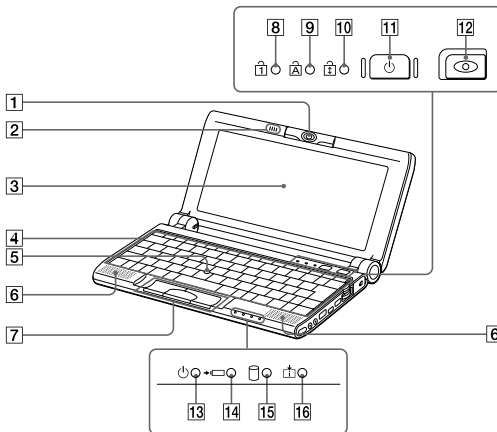

- | | | | |
|----------|--------------------------|-----------|---------------------------|
| 1 | MOTION EYE camera | 9 | Caps Lock indicator |
| 2 | Microphone | 10 | Scroll Lock indicator |
| 3 | LCD screen | 11 | Power button |
| 4 | Keyboard | 12 | CAPTURE button |
| 5 | Pointing device | 13 | Power indicator |
| 6 | Speakers | 14 | Battery indicator |
| 7 | Left/Center/Right button | 15 | Hard disk drive indicator |
| 8 | Num Lock indicator | 16 | Information indicator |

Left

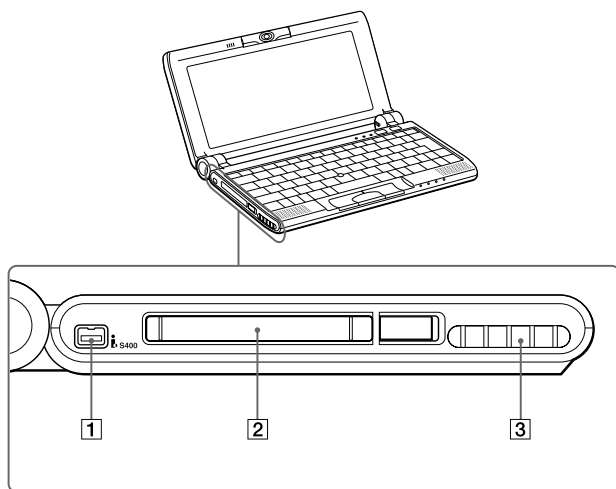

1 i.LINK port, S400 

2 PC card slot

3 Ventilation duct



There is a ventilation duct located near the PC card slot. Do not cover the ventilation duct when your computer is on.

Right

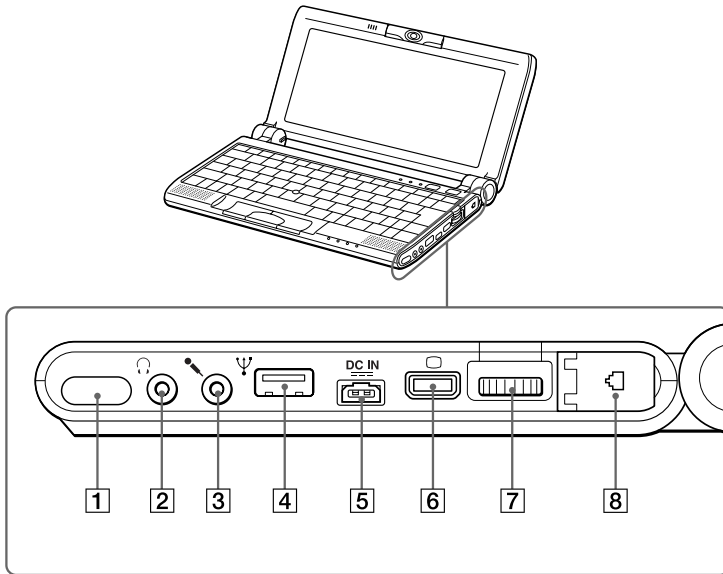

1 Infrared port

2 Headphone connector

3 Microphone connector

4 USB connector

5 DC In (page 8)

6 Mini VGA/TV Out Connector (page 47)

7 Jog Dial Control (page 26)

8 Modem Jack

Bottom

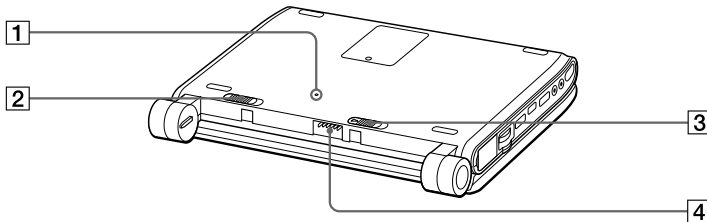

1 Reset switch

3 Battery release lever (page 12)

2 Battery lock lever (page 9)

4 Battery connector (page 10)

Connecting a Power Source

You can use either AC power or a rechargeable battery pack as a power source.

Using the AC Adapter

- 1 Plug the cable attached to the AC adapter into the DC In connector on the computer.
- 2 Plug one end of the power cord into the AC adapter.
- 3 Plug the other end of the power cord into an AC outlet.

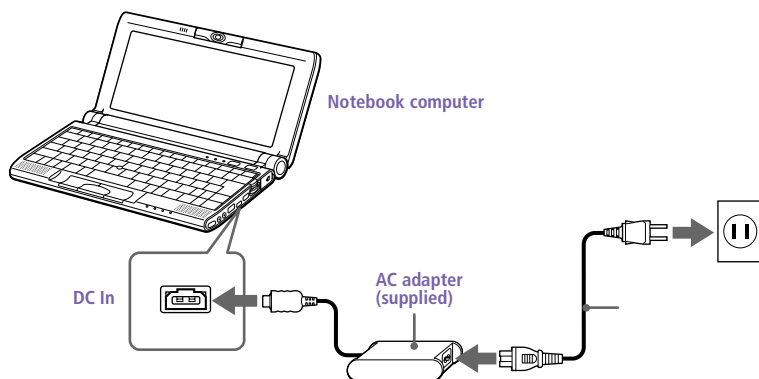

 Use your notebook only with the supplied AC adapter.

To disconnect your notebook completely from the main power source, unplug the AC adapter. Make sure that the electrical outlet is easily accessible.

Using Battery Power

You can use a battery pack as a source of power. The PCGA-BP51A battery pack that comes with your computer is not fully charged at the time of purchase. Follow the steps below to insert and charge the battery pack.

 You can also purchase the high-capacity PCGA-BP52/BP54 battery pack as a separate option.

To insert the battery pack

- 1 Make sure the Lock lever on the bottom of the computer is in the release position.

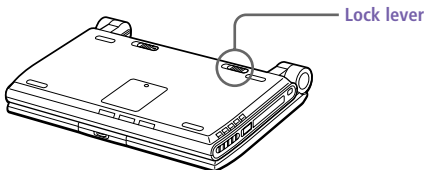

- 2 Align the grooves and tabs on the battery with the notches and tabs on the back of the computer. Slide the battery towards the computer until it clicks into place.

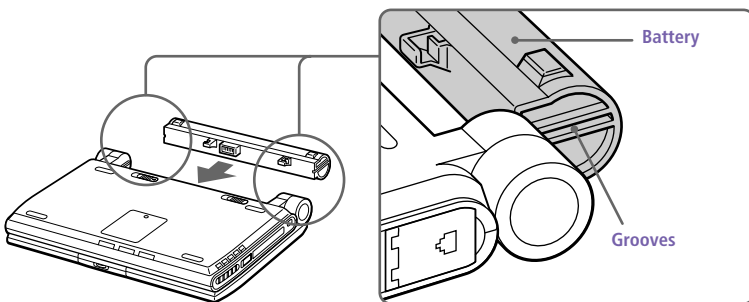

- 3 Slide the Lock lever into the lock position.

To charge the battery pack

- 1 Connect the AC adapter to the computer.
- 2 Insert the battery pack.

The computer automatically charges the battery (the battery indicator light flashes in a double blink pattern as the battery charges). When the battery is 85 percent full, the battery indicator light turns off. This process takes approximately one and one half hours. To charge the battery completely, continue charging for an additional hour.

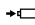
The  battery indicator indicates the status of the battery pack.



You can charge the battery pack with the optional battery charger PCGA-BC5. See the battery charger manual for more information.

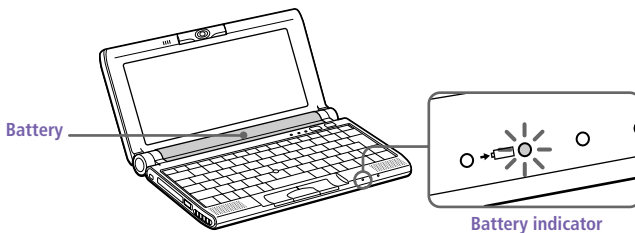

Battery Indicator Light Status

Meaning

On	The computer is using battery power.
Single blink	The battery is running out of power.
Double blink	The battery is charging.
Off	The computer is using AC power.



Both the battery and power indicators blink when the battery is running out of power.

Keep the battery pack in the computer while it is directly connected to AC power. The battery pack continues to charge while you are using the computer.

If your battery level falls to less than 10%, you should either attach the AC adapter to recharge the battery or shut down your computer and insert a fully-charged battery.

You can extend battery life by changing the power management modes in the PowerPanel utility. See "Using Power Saving Modes" on page 41.

The battery pack supplied with your computer is a lithium ion battery and can be recharged at any time. Charging a partially discharged battery does not affect battery life.

The battery indicator light is on while you use the battery pack as a power source. When battery life is nearly depleted, the battery indicator starts flashing.

For some software applications and some peripheral devices, your computer may not enter system hibernation mode when the battery life is low. To avoid loss of data when using battery power, you should save your data frequently and manually activate a power management mode, such as system suspend or system hibernation.

To remove the battery pack

- 1 Turn off the computer.
- 2 Slide the release levers to the **UNLOCK** position and slide the battery away from the computer.

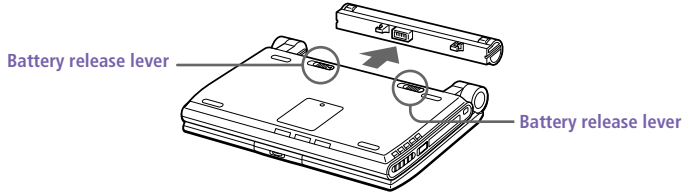

 You may lose data if you remove the battery pack while the computer is on and not connected to the AC adapter or if you remove the battery while the computer is in System Suspend mode.

To insert the optional high-capacity battery pack (PCGA-BP54)

Insert the battery pack with the VAIO logo side facing down. See the manual that came with the battery pack for more information.

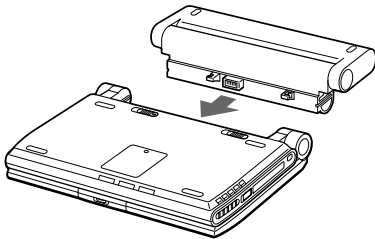

Conserving Battery Power

When using the notebook computer with a battery, the LCD display and the hard drive can be set to switch off automatically to conserve battery power (Power Management function). For details, refer to page 41.

Opening the PowerPanel

The PowerPanel software supplied with the notebook computer allows you to make power conservation settings to suit your usage requirements.

When you start the notebook, the PowerPanel  icon appears in the taskbar at the bottom of the display screen (factory default setting). It is operated with the Jog Dial control.

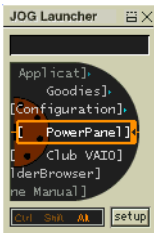

Displaying the PowerPanel Toolbar

To display the PowerPanel toolbar, right-click the taskbar and select Toolbars from the pop-up menu. Then, click PowerPanel and the PowerPanel toolbar appears in the taskbar. When you point to a button, a tool-tip appears showing the function of the button.

You can display the PowerPanel toolbar on the right of the screen by dragging it to the right.

Starting Your VAIO C1 PictureBook Computer

- 1 Lift the cover while holding the bottom of the computer firmly. Do not grasp the camera lens when opening the cover as this may damage the unit.

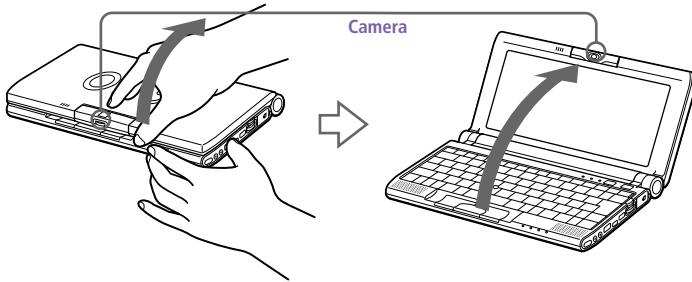

 Turn the built-in camera towards you before closing the cover. Do not turn the built-in camera while the cover is closed.

- 2 Press the power button until the green power indicator light turns on.

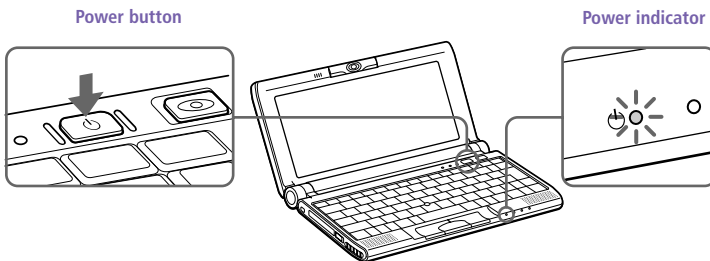

 If you push the power button for more than four seconds, the computer turns off.

- 3 If necessary, adjust the brightness controls for the LCD display. To decrease the brightness, press Fn+F5 and then the down or left arrow key. To increase the brightness, press Fn+F5 and then the up or right arrow key.

Shutting Down Your VAIO C1 PictureBook Computer

! To avoid potential loss of data, follow these steps to shut down your computer.

Using the Windows Start Button

- 1 Click the Start button on the Windows 98 taskbar.
- 2 Click Shut Down at the bottom of the Start menu to display the Shut Down Windows dialog box.

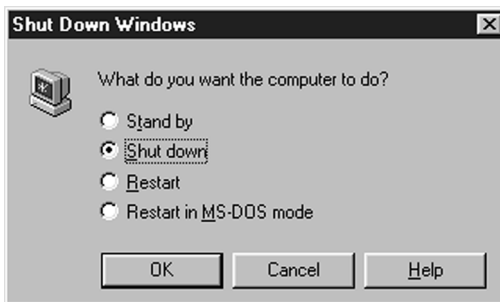

- 3 Select Shut down.
- 4 Click OK.

 Respond to any prompts warning you to save documents.

- 5 Wait for your computer to turn off automatically. The power indicator turns off.
- 6 Turn off any peripherals connected to your computer.
- 7 To close the cover, make sure the tabs on both sides of the display panel click into place in the grooves.

 If you are unable to shut down your computer using the steps described above, press the Ctrl+Alt+Delete keys at the same time and click Shut Down. If you are unable to shut down the computer in this way, you can push the power button and hold it for four seconds. This operation may result in loss of any unsaved data.

During a period of inactivity, you can conserve battery life by using System Suspend mode. See "Using Power Saving Modes" on page 41.

Registering Your Computer

You can take advantage of Sony's commitment to quality customer support and receive the following benefits by registering your computer with Sony:

- ❑ **Extended Limited Warranty** – Protect your investment. Extend your Warranty nine months for a total of 12 months from the original date of purchase when you register your computer.
- ❑ **Express service** – Provides a fast and direct return of your VAIO Notebook to Sony for service of your computer.*

If you have not already registered, follow these steps to use your computer's online registration service. You may also sign up for Internet access with a Sony-preferred Internet Service Provider.



You must connect a phone line (not supplied) before using any online services, including the online registration service. See "Connecting a Phone Line" on page 44.

- 1 Click the Registration icon on the VAIO desktop.
- 2 Enter the information requested on the first online registration form. Press the Tab key to move from box to box.
- 3 Click the Next button to advance to the next form.
- 4 Complete the remaining forms by clicking the Next button each time you complete a form.

The computer automatically transfers your registration information using your built-in modem and a toll-free telephone number.



* Certain restrictions apply.

Using the Keyboard

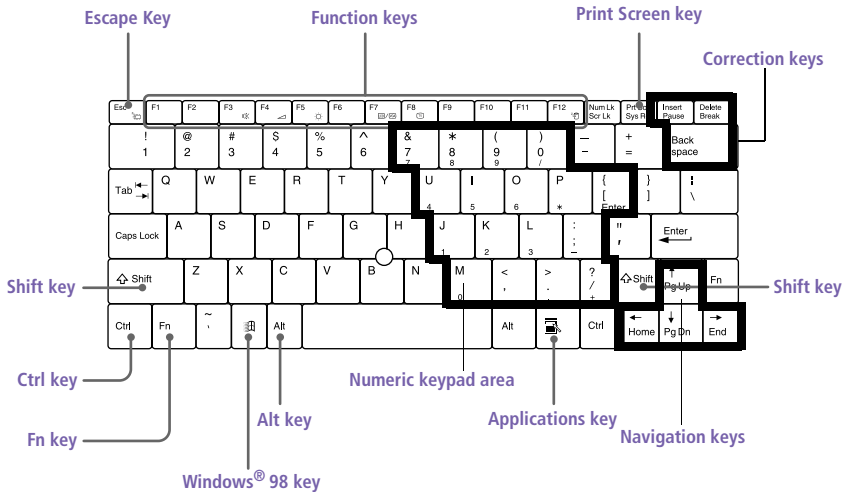
Your keyboard is very similar to a typewriter's, but the keyboard has additional keys that perform specific computer-related tasks.





Key	Description
Numeric keypad area	Contains the keys found on a typical calculator. Use the numeric keypad area to type numbers or to perform mathematical calculations such as addition and subtraction. Numbers appear on the front beveled edge of the numeric keys. Note that you must press the Num Lock key to activate the numeric keypad. (When you do so, the Num Lock light will be on.)
Navigation keys	Several keys are devoted to moving the cursor on the screen (the four arrow keys which also function as the Home, End, Page Up, and Page Down keys).
Correction keys	The Insert, Backspace, and Delete keys enable you to make corrections in your documents.
Function keys	The twelve function keys along the top of the keyboard are used to perform designated tasks. For example, in many applications, F1 is the Help key. The task associated with each function key may vary from one application to the next.



<i>Key</i>	<i>Description</i>
Escape key	The Esc (Escape) key is used to cancel commands.
Print Screen key	The Print Screen key takes an electronic snapshot of the screen and places it in the Windows Clipboard. You can then paste the screen shot into a document and print it.
Operator keys	Several keys are always used with at least one other key: Ctrl, Alt, and Shift. When held down with another key, the Ctrl (Control) and Alt (Alternate) keys offer another way to give commands. For example, in many applications, instead of choosing the Save command from a menu, you can hold down Ctrl and press S (referred to as Ctrl+S). The Shift key operates the same way as on a typewriter; it's used to produce capital letters or special symbols such as @ and \$.
Windows® 98 key 	The key with the Windows® logo displays the Windows® 98 Start menu; it's the equivalent of clicking the Start button on the task bar. See "Combinations and Functions with the Windows 98 Key" on page 19.
Fn key	The Fn key is used in combination with other keys to issue commands. The Fn keys at the left and right sides both work the same. See "Combinations and Functions with the Fn Key" on page 21.
Applications key 	The Applications key displays a shortcut menu of context-sensitive choices; pressing this key is the equivalent of clicking the right mouse button.

Combinations and Functions with the Windows 98 Key

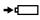





<i>Combination</i>	<i>Function</i>
⌘ + F1	Displays Windows Help.
⌘ + Tab	Switches the selected button on the taskbar.
⌘ + E	Displays Windows Explorer.
⌘ + F	Displays the Windows Find: All Files window to find a file or folder. This is the equivalent of selecting Find and then Files or Folders from the Start menu.
⌘ + Ctrl + F	Displays the Windows Find: Computer window where you can locate other computers. This is the equivalent of selecting Find and then Computer from the Start menu.
⌘ + M	Minimizes all displayed windows.
Shift + ⌘ + M	Returns all minimized windows to their previous size.
⌘ + R	Displays the Run window. This is the equivalent of selecting Run from the Start menu.
Fn + ⌘ + Insert	Displays the Properties window. This is the equivalent of double-clicking the System icon in the Control Panel.

Indicators

<i>Indicator</i>	<i>Function</i>
Power 	Power on: lights green. System Idle mode: lights amber. System Suspend mode: flashes amber.
Battery 	Indicates the status of the battery inserted in the computer.
Hard disk 	Lights when data is read from or written to the hard drive. Do not enter System Suspend mode or turn off the computer when this indicator light is on.
Information 	Turns on when the Timer is set. Turns off when the Timer is not set or the Timer setting is inactive (such as when the computer's power is off or in System Hibernation mode). Depending on the VAIO Action Setup Settings, the Information indicator lights up when you receive or retrieve e-mail. For details, see the VAIO Action Setup help files

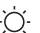
<i>Light</i>	<i>On</i>	<i>Off</i>
Num Lock 	Turns on when the number keys area in the numeric keypad are active.	Turns off when the alphanumeric character keys in the keypad area are active.
Caps Lock 	Turns on when the letters appear in uppercase as you type. The Shift key lowers the case of typed letters when Caps Lock is on.	Turns off when letters appear in lower case as you type (unless you hold down the Shift key).
Scroll Lock 	Turns on when the screen scrolls differently. (depends on the application. No effect in many applications.)	Turns off when information moves across the display normally.

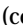
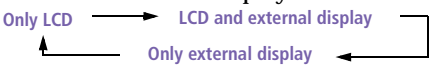
Combinations and Functions with the Fn Key

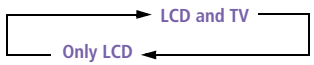
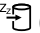
Combinations/ Feature	Functions
Fn+  (ESC) System Suspend	Puts the system into System Suspend mode, a power management state. To return the system to the active state, press any key or press the power switch on your computer.
Fn+  (F3) Speaker switch	Toggles the built-in speaker off and on.
Fn+  (F4) Speaker volume	Adjusts the built-in speaker volume. To increase volume, press Fn+F4, then ↑ or → . To decrease volume, press Fn+F4, then ↓ or ← .
Fn+  (F5) Brightness control	Adjusts the brightness of the LCD. To increase light intensity, press Fn+F5 and then ↑ or → . To decrease light intensity, press Fn+F5 and then ↓ or ← .
Fn+  (F7) Switch to the external display	Toggles through the LCD, external display (connected to the  Monitor connector), and both LCD and external display. 
Fn+  /  (F8) Switch to the TV	Toggles through LCD display and dual LCD/TV. 
Fn+  (F12) System Hibernation	Provides for the lowest level of power consumption. When you execute this command, the state of the system and state of the peripheral devices are written to the hard disk and the system power is turned off. To return the system to the original state, use the power switch to turn on the power.
Fn+D Video standby	Turns off the LCD in order to save power.
Fn+B Bass Boost	Toggles the bass-boost function off and on. This feature is available only while using the headphone.
Fn+S System Idle	Puts the system into Idle mode, a power management state. To return to the active state, press any key.

Using the Pointing Device

The pointing device on the keyboard allows you to point to, select, drag, and scroll objects on the screen.

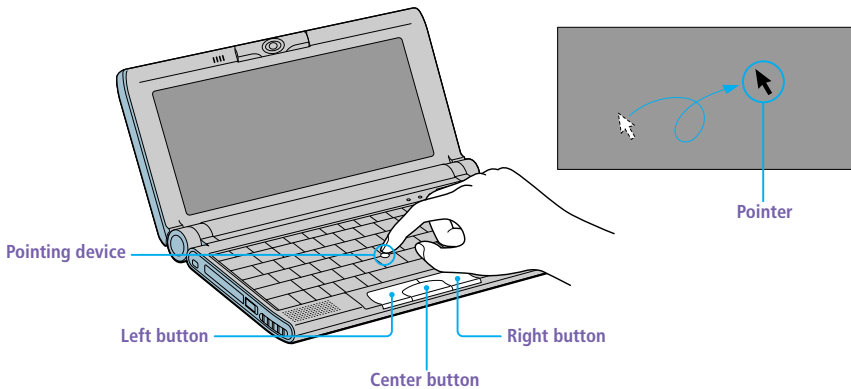

<i>Action</i>	<i>Description</i>
Point	Press the pointing device in a direction to place the pointer on an item or object.
Click	Press the left button once.
Double-click	Press the left button twice.
Right-click	Press the right button once. In many applications, this action displays a shortcut menu of context-sensitive choices.
Drag	Press the pointing device in a direction to place the pointer on an item or object. While holding the left button, press the pointing device, then release it at the desired point.
Scroll	Press the pointing device while pressing the center button.



The scroll function is available only with applications that support a scroll pointing device feature. Pushing the pointing device too hard may damage it.

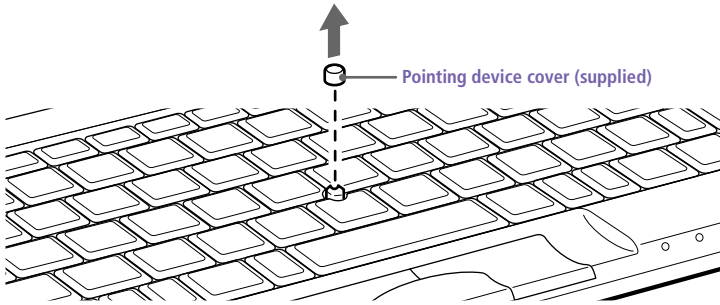

To replace the pointing device cover

You can take off the pointing device cover and replace it with the additional cover supplied with your computer.



Make sure the cover is tightly secured to prevent damage to the screen when you close the computer.

VAIO Action Setup

VAIO Action Setup manages the settings for your computer's Jog Dial control and i.LINK interface. An overview of each of these functions is provided in the next few pages. For more information on changing the settings using VAIO Action Setup, right-click the Jog Dial control icon,  or , in the task tray and click Help Topics.

Jog Dial™ Control

Your computer is equipped with a Jog Dial on the right side of the unit. The Jog Dial control enables you to open an application, folder, or document from a predefined list by rotating and pressing the Jog Dial control. In addition, when you press the Jog Dial control, you can turn on your computer automatically and start the selected application or document, and if the document you select is a script file, you can execute a complex task, such as connecting to the Internet and downloading your e-mail to your computer by simply pressing the Jog Dial control.

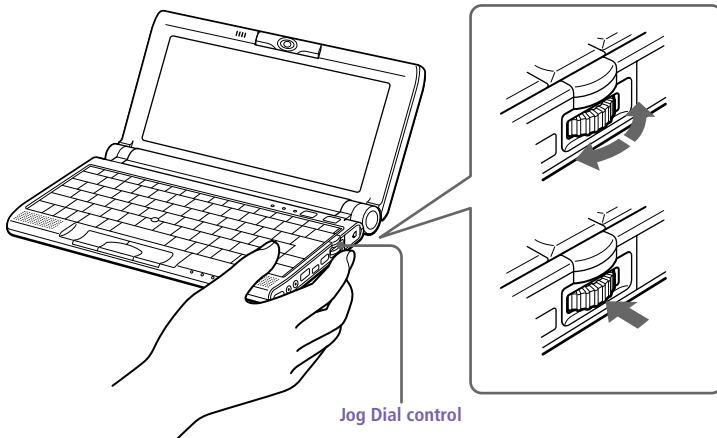

The Jog Dial control window always appears in the display. It is either in the launcher mode or in the guide mode.

Launcher mode

The Jog Dial control window is in launcher mode until a software application is launched or the Jog Dial control window becomes active. When an arrow is displayed next to an item in the Jog Dial control window, you can display a submenu of that item by selecting it and pressing the Jog Dial control button.

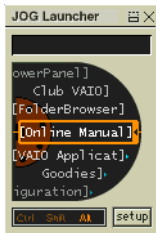

Guide mode

The Jog Dial control window is in the guide mode when software is in use and the software window is active. Depending on the software you are using, you can select items from the displayed list using the Jog Dial control. Some Sony software applications have two modes in List View, Simple Menu and Full Menu. You can switch the mode by pressing the shift key while turning the Jog Dial control.



Using the Jog Dial™ Control

This section explains how to use the Jog Dial control. For information on how to change the Jog Dial control's settings, right-click the Jog Dial control icon in the task tray and click Help Topics.

Launcher mode

To use the Jog Dial control, click the Jog Dial control window or the Jog Dial control icon in the task tray. Alternatively, you can press the Jog Dial control while pressing the Ctrl key on the keyboard to switch to the launcher mode.

- 1 Turn the Jog Dial control to select the item you want, then press the Jog Dial control. The window switches to the guide mode, and shows the Jog Dial's function.



- 2 Turn or press the Jog Dial control to use the desired function.
- 3 To select another item, switch to the launcher mode and repeat from step 1.

Guide mode

The Jog Dial control window displays the Jog Dial's function.

Software that supports the Jog Dial Control

If Sony software that supports the Jog Dial control is active, you can use the Jog Dial's functions that are allocated to that software. For more information on functions allocated to software, see the software applications online Help.

Software that does not support the Jog Dial Control

If the software you are using does not support the Jog Dial control, you can scroll the window or adjust the window size as described below:

<i>Action</i>	<i>Description</i>
Maximize Window*	Press the Jog Dial control button to maximize the size of the active window. Press again to return to normal window size.
Minimize Window*	Press the Jog Dial control button to minimize the size of the active window. Press again to return to normal window size.
Finish Window*	Press the Jog Dial control button to close the active application.
Scroll*	Press the Jog Dial control button to begin scrolling within the active window.
Jog Dial Launcher	Press the Jog Dial control button to return the Jog Dial control to Jog Launcher mode.
Menu Bar	Press the Jog Dial control button, then use the Jog Dial control to scroll through the active window's toolbar.

* Some software does not support these functions.

Dialog box

When a window such as Screen properties is active, Dialog is displayed in the Jog Dial control window. You can select an item in the window by rotating the Jog Dial control. Also, pressing the Jog Dial control is equivalent to pressing Enter.



Internal Timer

You can use the internal timer to start an application at a specific time. The timer can start applications even when the power is off.

AutoAlert E-mail Notification System

VAIO Action Setup enables you to set up your computer to notify you with an Information LED when new mail arrives in your e-mail mailbox. The Information LED turns red to indicate that new e-mail has arrived. For AutoAlert E-mail Notification to work, you must use Microsoft® Outlook® Express as your default e-mail software, and you must have an Internet Service Provider with Dial-up capabilities set up.

As an alternative you can program your VAIO Action Setup to set the Information LED to turn on when VAIO Action Setup has successfully completed the task of dialing up and connecting to receive mail. In this case, the Information LED turns on to indicate that your e-mail account has been accessed successfully, regardless of whether or not you have mail; this works with Outlook Express.

i.LINK Interface

Your computer comes equipped with an i.LINK port. The port is a digital interface (IEEE-1394) for high-speed communication. By using your computer, a Sony Digital Handycam® Camcorder or other camera that supports the i.LINK interface, you can easily create and edit your own home videos. For more information on connecting an i.LINK device, see "Connecting an i.LINK device" on page 59 of this manual.

Using the built-in MOTION EYE camera

Your computer includes a built-in MOTION EYE camera. You can use the camera to shoot still images and record video clips.



Do not touch the camera lens.

Do not point the camera towards the sun.

You cannot detach the camera.

Smart Capture is unavailable while other software that uses the built-in camera is in use. Close all software that uses the built-in camera before you use Smart Capture.

You cannot transfer still images or video clips from the built-in camera while transferring to connected i.LINK devices.

You should take an initial shot before taking a final shot to ensure sound and picture quality.

Your recording is not guaranteed.

If your recording fails due to conditions unfavorable to the camera, the contents of your recording cannot be guaranteed.

Clean the lens regularly. Picture quality is adversely affected when the lens is dirty.

Capturing a still image

- 1 Press the **CAPTURE** button to start Smart Capture.

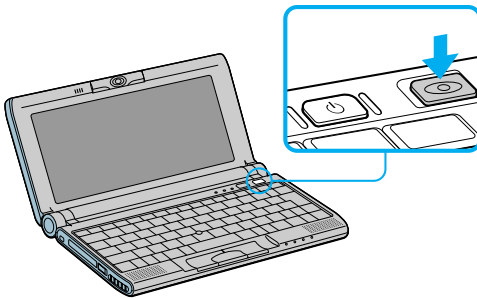

- 2 Select Still Viewer/Movie Player from the application list.
- 3 Choose Still by clicking the on-screen Capture Mode button. To switch to Motion, click the Capture Mode button again.

- 4 The Finder window appears. Turn the MOTION EYE camera lens towards the subject you want to photograph.

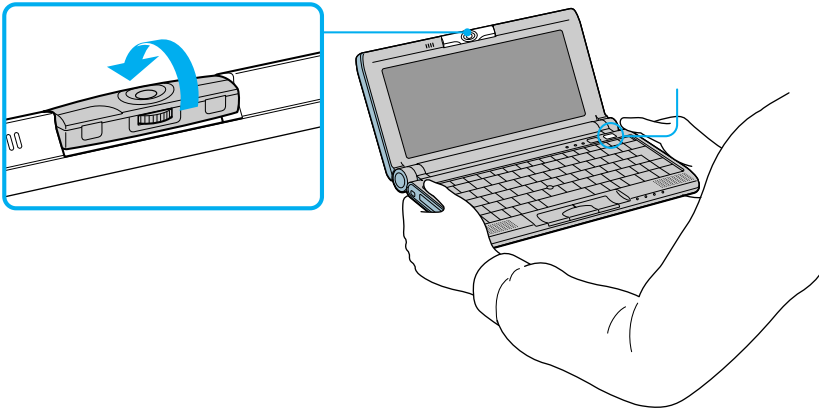

- 5 Adjust the focusing ring.

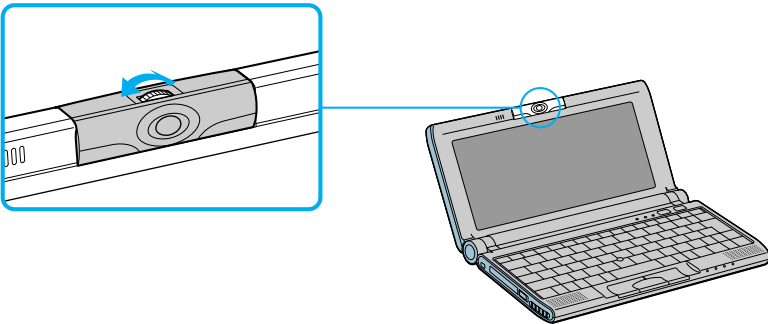

- 6 Half-press the CAPTURE button on the computer. The image remains still for a few seconds. To display another image, release the CAPTURE button and press again.
- 7 Fully press the CAPTURE button. The still viewer window opens and the captured still image appears in the still viewer window.
- 8 For more detailed information about the capture software, refer to the online Help for Smart Capture.



If you turn the lens inwards, Smart Capture goes into mirror mode. You can use the mirror mode to take a still image of yourself. A mirror-image appears in the finder window of the display while shooting; however, after capturing, a normal image appears.

You can capture the following still images sizes: 640 x 480, 320 x 240, 160 x 120, 80 x 60, and 40 x 30.



To set the sound quality, you can adjust the sound quality for differing sound environments. click Start, select Settings, then click Control Panel. Double-click Multimedia, and click the Record icon of the Audio tab. Adjust the volume level with the microphone slider.

To create a panoramic image

You can create panoramic images by connecting still images captured with the MOTION EYE camera.

- 1 Capture the still images. Using the Panoramic-assist function of Smart Capture, capture still images to be used to create your panoramic image. For details, see Smart Capture online Help.
- 2 Start the PictureGear software. For details, see the Picture Gear online Help.

To set the image quality and mode of MOTION EYE camera

You can change the settings of image quality or mode of MOTION EYE camera.

- 1 Click the Start button, point to Settings, and then click Control Panel.
- 2 Double-click the MOTION EYE camera icon. The Camera Control Utility appears.



You can also activate the Camera Control Utility using the Jog Dial control. Camera Control Utility is available even while using other software applications that use the MOTION EYE camera.

- 3 Click the Image Quality tab and drag the slider to the left or the right. The level settings increase as the slider is moved to the right and decrease as it is moved to the left.

<i>Features</i>	<i>Description</i>
Brightness	Adjust the brightness
Contrast	Adjust the contrast of the light part and the dark part
Color	Adjust the coloring
Hue	Adjust the hue of the color
Sharpness	Adjust the sharpness

4 Click Mode tab and click the item you want to set.

<i>Features</i>	<i>Description</i>
Field/Frame	Set according to the movement of subjects. <ul style="list-style-type: none"> <input type="checkbox"/> Field: Suitable for moving subjects. <input type="checkbox"/> Frame (interpolation): The middle mode between the Field mode and Frame mode. <input type="checkbox"/> Frame: Suitable for still subjects.
White balance	Adjust the colors to be more natural. <ul style="list-style-type: none"> <input type="checkbox"/> Auto: Adjust automatically to natural colors. <input type="checkbox"/> Indoor: Suitable for indoor capturing. <input type="checkbox"/> Outdoor: Suitable for outdoor capturing. <input type="checkbox"/> Hold: Suspend the proximate settings of the white balance, so that settings do not change automatically.
Shutter speed	Set the shutter speed: <ul style="list-style-type: none"> <input type="checkbox"/> Auto: Adjust the shutter speed automatically. <input type="checkbox"/> $\frac{1}{100}$ shutter: Set the shutter speed $\frac{1}{100}$ seconds. This speed is suitable for capturing images under fluorescent light. <input type="checkbox"/> Hold: Suspend the proximate settings of the shutter speed, so that settings do not change automatically.



The appropriate mode will vary depending on the situation or subject. Switching between outdoor and indoor environments while setting the White Balance to Hold may cause colors to appear incorrectly. For color correctness, set White Balance to Auto and capture something white, and then wait approximately 10 seconds. The image should now display with the correct color.

5 Click OK.



Click the Default button, and then click OK to return all settings to the default settings.

Using the Floppy Disk Drive

You can connect the floppy disk drive to the USB connector on your computer.

To connect the floppy disk drive

 You do not need to shut down the computer before connecting or disconnecting the floppy disk drive.

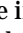
Plug the USB cable on the floppy disk drive into the  USB connector on the computer. When using the disk drive, the VAIO logo should face up.

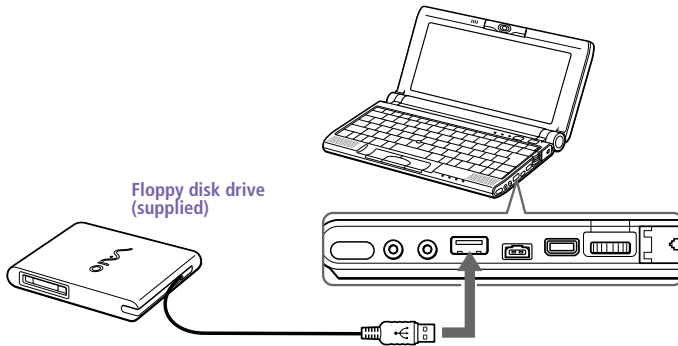

 Do not use the supplied floppy disk drive with other computers, as this may cause damage to the unit.

To insert a diskette

- 1 Hold the diskette with the label side facing up.
- 2 Gently push the diskette into the drive until it clicks into place.

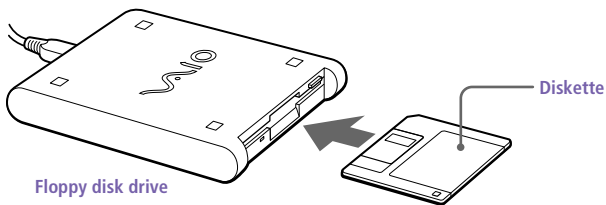

To remove a diskette

When you finish using the diskette, wait until the LED indicator turns off and then press the Eject button to remove the diskette.



Do not press the Eject button while the LED indicator is on, as this may damage the diskette.

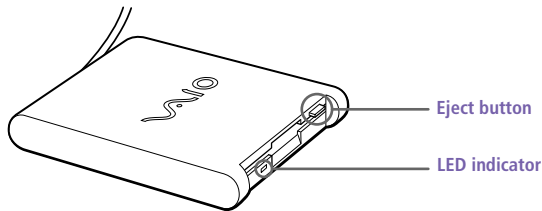

If the diskette does not come out by pressing the Eject button, disconnect the floppy disk drive from the computer.

To remove the floppy disk drive

Wait until the LED indicator turns off, and then unplug the USB cable from the computer.

To carry the floppy disk drive

Fold the floppy disk cable into the compartment on the side of the floppy disk drive.



Using PC Cards

Your computer includes a PC card slot. PC cards allow you to connect portable external devices, such as a CD-ROM drive, or to connect to a network.

 The PC card slot can accommodate one Type I or Type II PC card. This slot is compatible with a 16-bit Card and CardBus. The ZV (Zoomed Video) port is not available.

Some PC cards may require that you disable idle devices when using the PC card. You can use Sony Notebook Setup to disable devices. See "Displaying the Sony Notebook Setup Screen" in *Customizing Your VAIO® C1 PictureBook Computer*.

Be sure to use the most recent software driver provided by the PC card manufacturer.

If an "!" mark appears on the Device Manager tab in the System Properties dialog, remove the software driver and then reinstall it.

You may not be able to use some PC cards or some of the functions of a PC card with this computer.

To insert a PC card

 You do not need to shut down the computer before inserting or removing a PC card.

- 1 Insert the PC card into the PC card slot with the front label facing up. Gently push the card into the slot until it is fixed into the connector; the release button comes out.

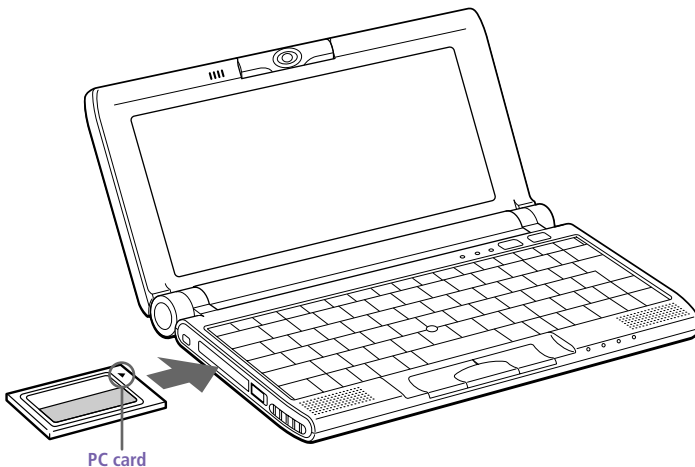

- 2 Pull the release button, then push it down toward the slot.

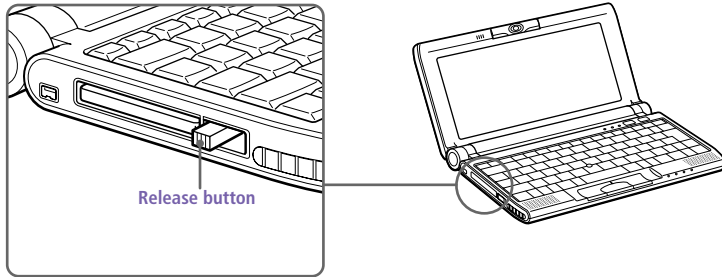

Do not force a card into the slot. It may damage the connector pins.

If you have difficulty inserting a card, check that you are inserting the card with the correct orientation.

See the manual that came with your PC card for more information on its use.

To remove a PC card



Follow the procedure below when you remove the PC card while your computer is on. Failure to follow this procedure may result in a malfunction. When removing the card while your computer is off, skip steps 1 through 4.

- 1 Click the Start button, point to Settings, and then click Control Panel.
- 2 Double-click PC card.
- 3 Click the name of your PC card from the list that displays.

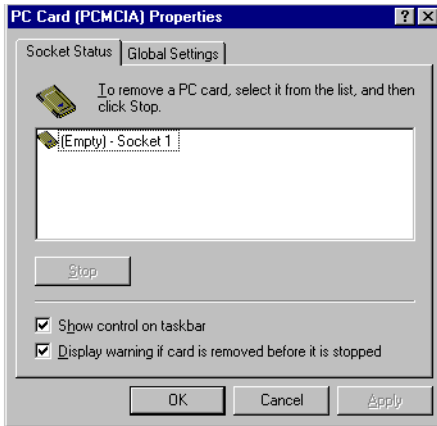

- 4 Click the Stop button, and then OK.
- 5 Push the release button.
- 6 Gently grasp the card and pull it out.

Using Smart Connect

With Smart Connect you can copy, edit, or delete files on another VAIO computer (equipped with Smart Connect) that is connected to your computer with an i.LINK® cable.

You can also print a document on a printer that is connected to another VAIO computer.

See the Smart Connect online help for more information.

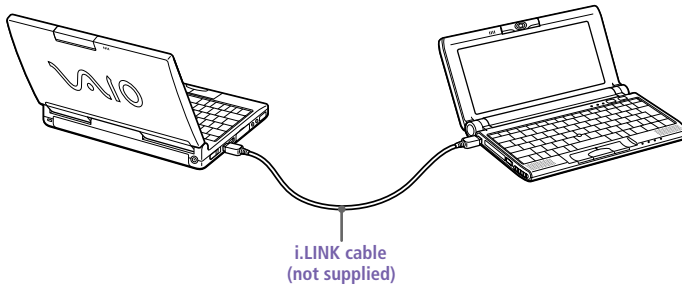

i.LINK cables that are compatible with your VAIO® C1 PictureBook Computer include cables with the following part numbers: VMC-IL4415 (a 1.5 meter cable with a 4-pin connector at each end), VMC-IL4408 (a 0.8 meter cable with a 4-pin connector at each end), VMC-IL4615 (a 1.5 meter cable with a 4-pin connector at one end and a 6-pin connector at the other).

Using Infrared Communication Devices

Your computer includes an infrared port, located on the right side of the computer. You can use this port to communicate with other infrared-equipped devices with compatible protocols, such as a digital still camera or other computers.

To use infrared communication with a digital still camera

Align the infrared ports on the computer and the digital camera so that they are in a direct line.

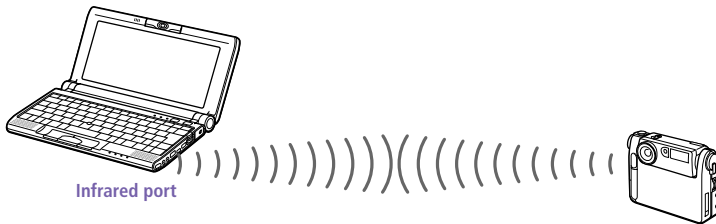

To use infrared communication with another computer

Align the infrared ports on the two computers so that they are in a direct line.

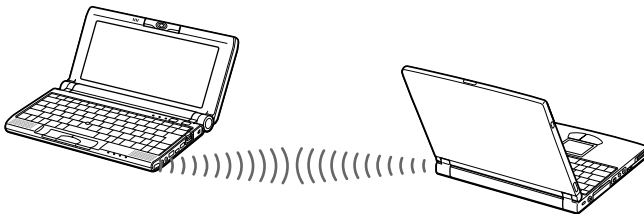

Infrared communication capability can be turned on and off. By default, it is not enabled when your system is shipped. To enable infrared use, click the Infrared icon in the Windows Control Panel, and select the Enable infrared communication checkbox on the Options tab.

You can disable infrared communication when you are not using it to conserve battery life.

Use the Infrared icon in the Windows Control Panel to enable and disable infrared communication. Do not use the icon in the taskbar.

When you transfer files directly from devices other than the internal hard disk drive (from a CD-ROM drive or hard disk drive on a network), set the System Suspend and System Hibernation timers to Off.

Check the Status tag of the Infrared Monitor in the Windows Control Panel to determine if the infrared device is detected.

If the two devices are too far apart or too close together, data transfer may be interrupted or there may be noise in the transmission.

Do not cover the infrared ports with your hand or any other objects.

Avoid direct sunlight, fluorescent light, or flashing incandescent light near the infrared ports.

See the manual that came with your digital still camera or other infrared communication device for more information on installation and use.

The active area of infrared transmission extends about $39\frac{3}{8}$ inches (1m) with a radius of approximately 15 degrees.

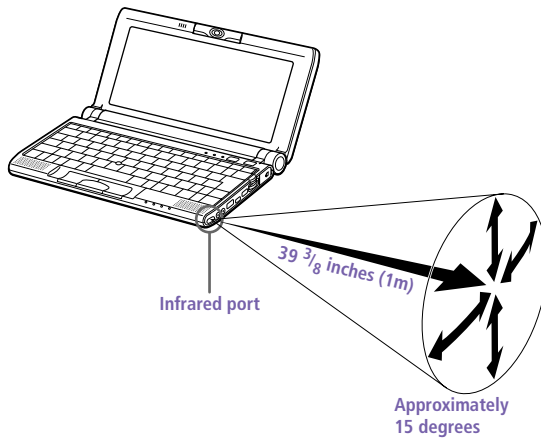

Using Power Saving Modes

When you use a battery as the source of power for your computer, you can take advantage of power management settings to conserve battery life. In addition to the normal operating mode, which allows you to turn off specific devices, your computer has two distinct power saving modes: System Suspend and System Hibernation. When using battery power, you should be aware that the computer automatically enters System Hibernation mode when the remaining battery charge drops below 7%, regardless of the power management setting you select.



If your battery level falls to less than 10%, you should either attach the AC adapter to recharge the battery or shut down your computer and insert a fully-charged battery.

Normal Mode

This is the normal state of your computer when it is in use. The green power indicator light is on in this mode. To save power, you can turn off a specific device such as the LCD or the hard disk.



For details, see "Controlling Power Management" in *Customizing Your VAIO® C1 PictureBook™ Computer*.

System Suspend Mode

The computer saves the current state of the system in RAM and switches off power to the CPU. The amber power indicator light flashes in this mode.

To activate System Suspend mode

Press Fn+Esc, or you can press the power button and release it immediately. You can also use the PowerPanel utility to enter System Suspend mode.

To return to normal mode

Press any key.

System Hibernation Mode

The state of the system is saved on the hard drive and power is turned off. The power indicator light is off in this mode.

To activate System Hibernation mode

Press Fn+F12. You can also use the PowerPanel utility to enter System Hibernation mode.

To return to normal mode

Turn on the computer by pressing the power button. The computer returns to its previous state.



When returning from System Hibernation mode, the system status stored on the hard disk is erased and the computer starts normally if you push the power button and hold it for more than four seconds.

- ❑ **Time to return to normal mode:**
System Suspend requires less time than System Hibernation.
- ❑ **Power consumption:**
System Suspend uses more power than System Hibernation.

Connecting Peripheral Devices

You can add functionality to your computer by connecting any of these peripherals:

- Phone line (page 44)
- Printer (page 46)
- External display (page 47)
- External USB mouse (page 55)
- CD-ROM drive (page 56)
- Digital video camera recorder (page 59)

Connecting a Phone Line

You need to connect a phone line (not supplied) to take advantage of online services and the Internet.



In order to register your VAIO C1 PictureBook Computer or register your software online, you must connect to a phone line. You must register your computer to receive the extended warranty.

- 1 **Open the phone line jack cover.** The cover opens only to a 45-degree angle.



Use care when opening the phone jack cover. Opening it beyond a 45-degree angle may result in damage to the unit.

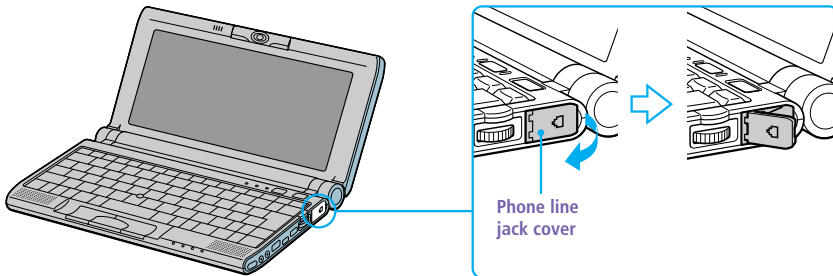

- 2 **Plug one end of the phone cable into the jack on the inside of the phone line jack cover.** Make sure you insert the phone cable from the rear of the computer and that the modular jack clicks into place.

3 Plug the other end into the wall jack.

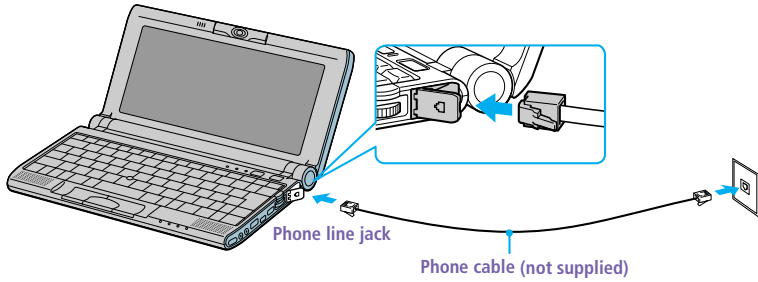

Your computer does not work with party lines, cannot be connected to a coin-operated telephone, and may not work with multiple phone lines or a private branch exchange (PBX). Some of these connections might result in excess electrical current and could cause a malfunction in the internal modem.

Connecting a Printer

You can connect a printer that is compatible with Windows 98 to your computer.

To connect a printer

Plug the optional USB printer cable into the USB connector on your computer and the parallel port on your printer.

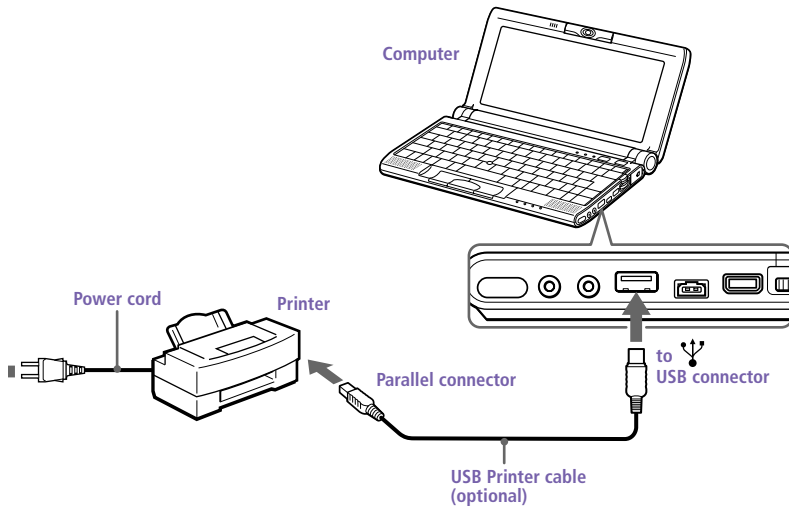

See the manual that came with your printer for more information on installation and use.

To use a printer

To use a printer, first install the driver software that came with your printer.

Connecting an External Display

You can connect an external display to your VAIO C1 PictureBook Computer. For example, you can use the computer with either of the following:

- ❑ Computer display (monitor) (page 47)
- ❑ Projector (page 48)
- ❑ TV (page 49)

To connect a computer display

- ❑ Use the  symbol to locate the mini VGA/TV Out connector. Connect the supplied adapter to the mini VGA/TV Out connector, then plug the display cable into the adapter.
- ❑ If necessary, plug one end of the display power cord into the display, and the other end into an AC outlet.

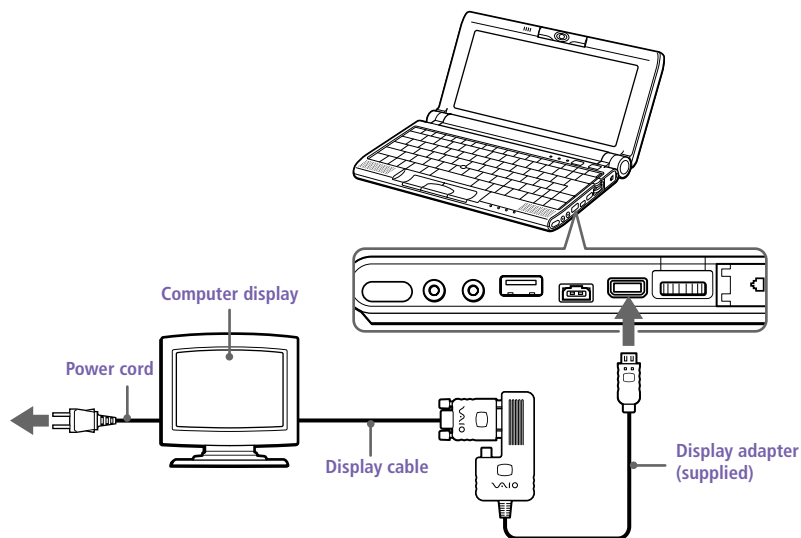

See the manual that came with your computer display for more information on installation and use.

To connect a projector

You can use a projector as an external display, such as the Sony LCD Projector.

You can connect a projector using the supplied Display adapter.

- 1 Plug the VGA adapter into the computer's mini VGA/TV Out connector and the display signal cable to the "VGA Out" connector of the Display adapter.
- 2 Use the  symbol to locate the Earphone connector. Plug the speaker cable into this connector.

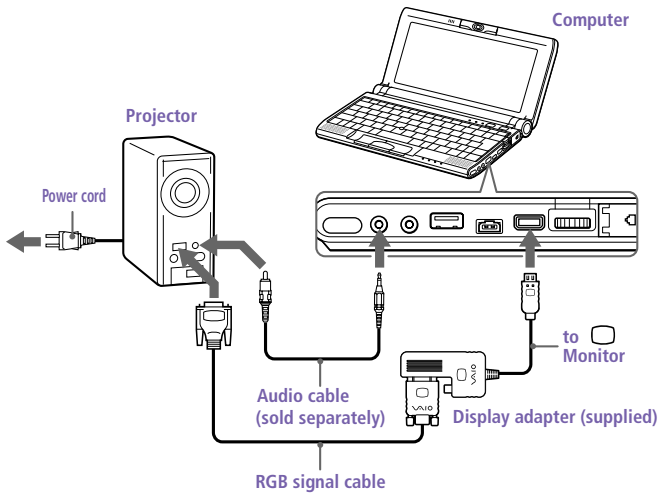

 See the manual that came with your projector for more information on installation and use.

You may not be able to display the computer's LCD and the external display together, depending on the types of computer display and projector used.

Connect the AC adapter after you finish connecting all other peripherals. Turn on all the peripherals before you turn on the computer.

To connect a TV

Use the supplied display adapter to connect your TV monitor to the computer.

- 1 Plug the supplied display adapter into the computer's mini VGA/TV Out connector and the video cable to the "TV Out" connector of the display adapter.
- 2 Plug the other end of the video cable to the Video In connector of the TV.

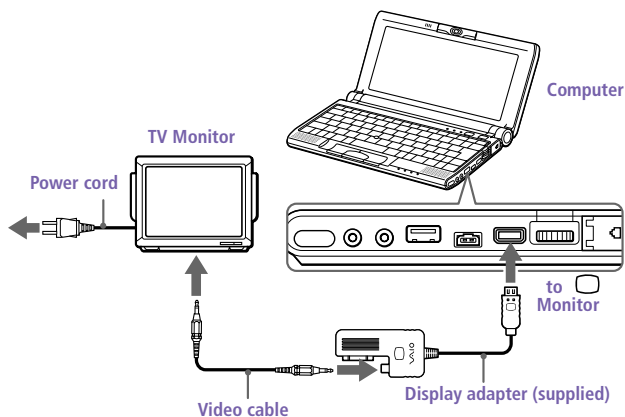

 Your computer's TV output is compatible to NTSC only.

Selecting a Display

This notebook computer uses the NeoMagic video controller. You can select which display is used when the computer is connected to an external display.

- 1 Click the Start button, select Settings, and then click Control Panel. The Control Panel appears.
- 2 Click Display. Display Properties appears.
- 3 Click the Settings tab.
- 4 Click the Advanced button. NeoMagic MagicMedia 256AV XL+ Properties appears.
- 5 Click the NeoMagic tab. The NeoMagic settings appear.

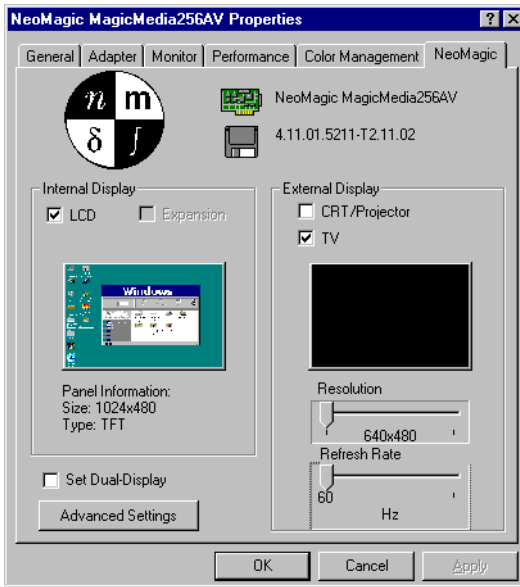

6 Select the external display type:

<i>Setting</i>	<i>Equipment displayed</i>
LCD panel	The internal LCD panel.
CRT/Projector	An external computer display connected to the Monitor connector on the notebook or the power up station, or an RGB connected projector.
TV	A video monitor or television connected to the VIDEO or S VIDEO connector on the power up station.

You can turn off the notebook's LCD display by checking the External Display box in CRT/Projector and removing the check from the LCD box in Internal Display. With this setting, you can adjust the vertical frequency of the display with the refresh rate slider, but the resolution slider will not work.

To set the width of the desktop and the vertical frequency of the display, check Independent Display/Timing in Monitor as shown in step 2 on the next page. You can then change the settings by moving the refresh rate slider and the resolution slider.

When the external display type is set to TV:

- ❑ The internal LCD display cannot be turned off. The content of both the LCD and the TV displays will be the same.
- ❑ The resolution can be set with the resolution slider to either 640×480 or 800×600 dots.

7 Click OK.

Screen Properties reappears, and the selected display is enabled.

You can switch between displays by moving the Jog Dial control or pressing Fn and the function key. For details, see page 21.

! Important: It is not possible to display screens simultaneously on both an external computer display connected to the Monitor connector and a TV connected to the VIDEO or S VIDEO connector.

! Depending on the type of computer projector being used, it may not be possible to display screens simultaneously on the internal LCD and an external projector.

! Screens cannot be displayed on a TV connected to the VIDEO or S VIDEO connector while using true color (24 bit).

CRT Display

If you selected CRT/Projector in step 6 of Selecting a Display on the previous page, you can set the resolution and other settings as appropriate for the type of external computer display (CRT, Projector) or projector you are using.

- 1 Click Details in step 6 of Selecting a Display on the previous page. Advanced Settings appears.

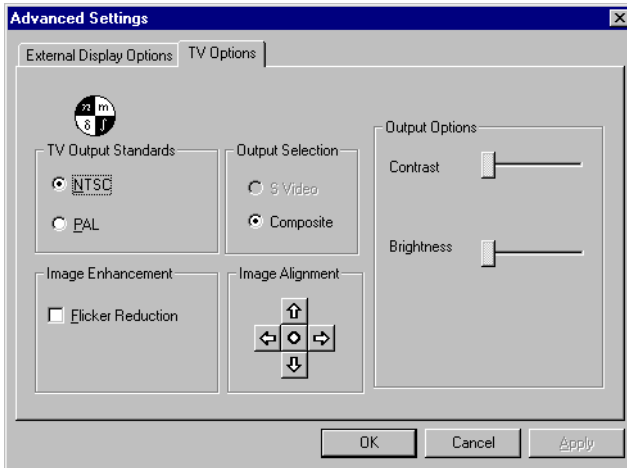

- 2 Select the display type.

External display/device:

<i>Setting</i>	<i>Function</i>
CRT	Connection to an external computer display.
Projector	Connection to a projector.

Set the refresh rate/resolution (for Independent display/Timing)

When Independent display/Timing is selected in Monitor settings, you can set separate values for the refresh rate and resolution of the internal and external displays.

- 3 Set the resolution.
Select the resolution for the projector that you are going to use.
- 4 Click OK.

! Important: It is not possible to select Independent display/Timing when true color (24 bit) is selected for the number of colors.

Television Display (When connected to the Display Adapter)

If you selected TV in step 6 of “Selecting a Display” on page 50, you can change settings such as the TV format and the display position.

- 1 Click Details in step 6 of “Selecting a Display” on page 50. Advanced Settings appears.
- 2 Click the TV Options tab.

Standard TV output:

Setting	Function
NTSC	Connection to a standard US/Japanese TV or video monitor.
PAL	Connection to PAL TV or video monitor.

Output Selection:

Setting	Function
S Video	Connection to a TV or video monitor that has an S connector.
Composite	Standard video output.

Image Enhancement:

Setting	Function
Flicker suppression	This helps prevent problems with TV flicker.

Output Option:

Setting	Function
Contrast	Adjusts the TV contrast
Brightness	Adjusts the TV brightness

- 3 Click OK.

To adjust the window position

Press the arrow to move the window in the direction of the arrow.

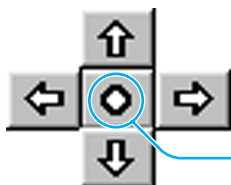

Press to position the window in the center of the screen.

Connecting an External USB Mouse

You can connect an external USB mouse PCGA-UMS1 (optional) to your computer.

To connect an external mouse

Plug the mouse cable into the USB connector. PCGA-UMS1 driver has already been installed.

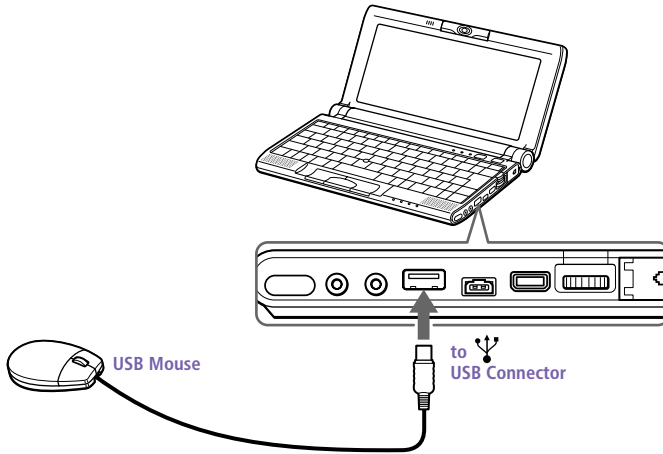

A serial mouse or PS/2 mouse is not compatible with the VAIO® C1 PictureBook Computer.

See the manual that came with your mouse for more information on installation and use.

Connecting a CD Drive

You can use the optional PCGA-CD51 CD-ROM or PCGA-CDRW51 CD-RW drive with your notebook. If you use either optional drive when your computer is running on battery power, the battery life will be shorter. The drive draws power from the computer through a PC card.

 Procedures for connecting the CD drive may vary, depending on the CD drive.

See the manual that came with your CD drive for more information on use.

To play an audio CD in the optional PCGA-CD5 CD-ROM drive with your notebook, your computer's settings must be set properly. You can check the settings as follows:

- 1) Click the Start button, select Settings, and click Control Panel.
- 2) Click the Multimedia icon.
- 3) Click the CD music tab and make sure the "Enable digital CD audio for this CD-ROM device" box is checked. When this box is checked, your notebook computer's settings are correct for playing an audio CD in the PCGA-CD5 CD-ROM drive.

To connect a CD-ROM drive

 You can connect a PCGA-CD51 CD-ROM drive or PCGA-CDRW51 CD-RW drive while the computer is on, unless you want to use the System and Application Recovery CDs. Turn off your computer before using the System and Application Recovery CDs.

- 1 Remove the PC card slot protector from the PC card slot. See "Using PC Cards" on page 35 for details.
- 2 Remove the PC card from the bottom side of the CD drive.

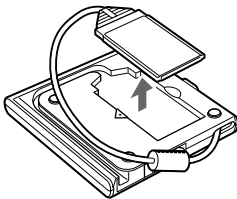

- 3 Insert the PC card into the PC card slot with the SONY logo facing up. See “Using PC Cards” on page 35 for details.

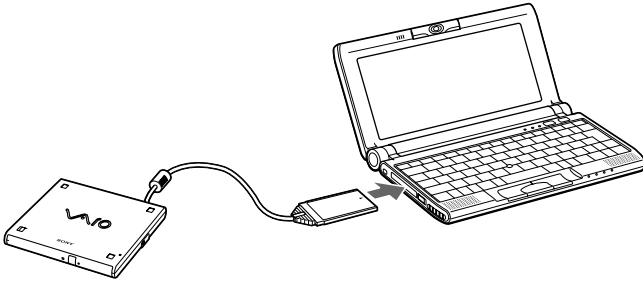

 A protective cover is attached to the lens of the CD-ROM drive at the factory. Before using the CD-ROM drive, remove the protective cover.

To insert a CD-ROM

- 1 Push the Open button in the direction of the arrow to open the CD-ROM drive lid.

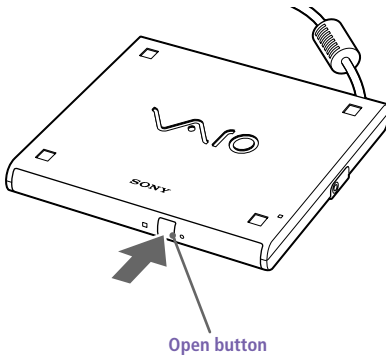

- Place the CD-ROM in the tray with the label side facing up. Push the disc onto the hub until the disc clicks into place.

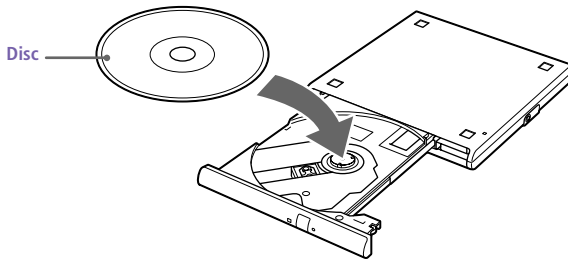

 Be sure to seat the CD-ROM firmly over the CD-ROM drive hub fingers. If you do not seat the disc firmly, you could damage your CD-ROM drive and you may not be able to open the CD-ROM drive lid.

- Gently slide the tray back into place.

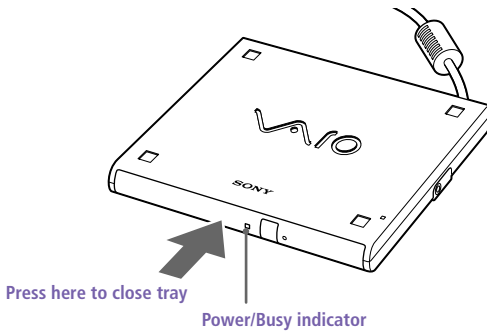



Connecting an i.LINK device

The VAIO C1 PictureBook Computer includes an i.LINK (IEEE-1394) connector, which you can use to connect to an i.LINK-enabled digital video camera recorder.

To connect a digital video camera recorder

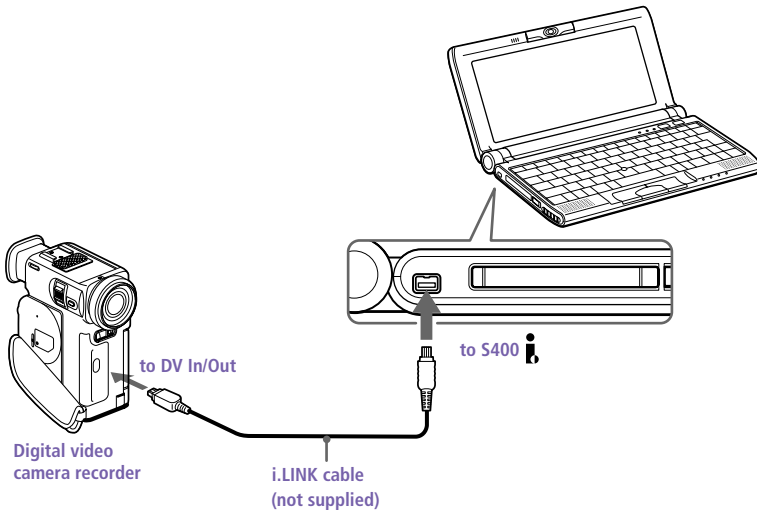
- ❑ Plug one end of an i.LINK cable into the S400  connector on the left side of the computer and the other end into the DV In/Out connector on the digital video camera recorder.



 The Sony digital video camera recorder is pictured; your digital video camera recorder may need to be connected differently.

On Sony digital video cameras, connectors labeled "DV In/Out" or "i.LINK" are compatible.

See the manual that came with your digital video camera recorder for more information on installation and use.

The i.LINK connector does not supply power to external devices. If the external device requires power from the i.LINK connector, you cannot use the device with your computer.

The C1 PictureBook Computer supports transfer rates up to 400 Mbps; however, the actual transfer rate is the lowest transfer rate of the external device.

The i.LINK features available may vary depending on the software applications you use. See the documentation that came with your software for more information.

Connecting External Speakers

You can enhance the sound quality of your computer by connecting external speakers.

To connect external speakers

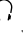
- Use the  symbol to locate the Headphone connector. Plug the speaker cable into this connector.



Make sure your speakers are designed for computer use.

Turn down the volume of the speakers before you turn them on.

Do not place diskettes on the speakers; the speaker's magnetic field may damage the data on the diskettes.



See the manual supplied with your speakers for more information on installation and use.

Connecting an External Microphone

You can enhance the quality of sound input by using an external microphone.



Make sure your microphone is designed for computer use.

To connect an external microphone

Use the  to locate the Microphone connector. Plug the microphone cable into this connector.



See the manual supplied with your microphone for more information on installation and use.

Getting Help

Sony provides several support options for your Sony computer. When you have questions about your computer and the preinstalled software, check these sources for answers, in the following sequence:

1	<i>Read Me First</i>	Contains Frequently Asked Questions, the most up-to-date information on using your computer, and software support information.
2	<i>VAIO® C1 PictureBook™ Computer User Guide</i>	The User Guide (this manual) contains information on how to get the most from your computer, find help, and solve common problems. It also contains product specifications.
3	<i>Customizing Your VAIO® C1 PictureBook™ Computer</i>	The electronic document contains additional information on customizing your computer. You can access this guide from the Windows Start menu by selecting Programs/VAIO/Documentation.
4	Manuals and online help files that may accompany your preinstalled software	Most of the manuals for preinstalled software are located on your hard disk drive as online help files. You can access the online help files from the Help menu in the specific application. A printed manual is available for some applications.
5	Knowledge Database	Provides instant access to information on commonly encountered problems. Enter a description of your problem and the Knowledge Database searches for the corresponding solutions online. You can access the Sony Knowledge Database at: http://www.sony.com/pcsupport

-
- 6 *Sony Fax-on-Demand* This service provides you with answers to commonly asked questions. You can use this automated service to request a list of available topics and then select the topics that you want to receive. To contact the Sony fax-on-demand service, call 1-888-4SONYPC (1-888-476-6972). (Requires a fax machine or your fax software.)
-
- 7 *Calling Sony Customer Support* You can call and speak with a Sony Customer Support Representative without using your computer by calling 1-888-4SONYPC (1-888-476-6972). Software support is available free of charge for 90 days after the original date of purchase.
-

Troubleshooting

This section describes how to solve common problems you may encounter when using your computer. Many problems have simple solutions, so try these suggestions before you call Sony Customer Support.



When you reconnect devices, be sure to turn off the computer as described in “Shutting Down Your VAIO C1 PictureBook Computer” on page 15. Turning off the computer using other methods may result in data loss.

My computer won't start

- ❑ Check that the computer is plugged into a power source and that it is turned on. Check that the power indicator on the front panel of the computer indicates that the power is on.
- ❑ Check that the battery is inserted properly and that it is charged.
- ❑ Make sure there is no diskette in the floppy disk drive.
- ❑ Confirm that the AC adapter and all cables are connected firmly, as described in “Connecting Peripheral Devices” on page 43.
- ❑ If you plugged the computer into a power strip or UPS, make sure the power strip or UPS is turned on and working.
- ❑ If you are using an external display, check that it is plugged into a power source and turned on. Check that the brightness control is adjusted correctly. See the manual that came with your display for details.
- ❑ Moisture condensation may have occurred. Do not use the computer for at least one hour and then turn on the computer.

When I turn on my computer, the message “Operating system not found” appears and Windows does not start

- ❑ Check the floppy disk drive to see if a non-bootable diskette is in the drive.
- ❑ If a non-bootable diskette is in the drive, turn off the computer, remove the diskette, and then turn on the computer again. Confirm that Windows starts properly. If Windows still does not start, follow the procedure below to initialize the BIOS.
- ❑ If the floppy disk drive is empty or contains a bootable diskette, use the following procedure to initialize the BIOS:

- 1 Turn off the computer.
- 2 Remove the floppy disk drive, PC card, and any other peripheral devices from the computer.
- 3 Turn the computer on again.
- 4 Press the F2 key when the Sony logo appears. The BIOS setup menu screen appears.
- 5 Press the arrow keys to select the Exit menu.
- 6 Press the arrow keys to select Get Default Values and then press the Enter key. The message “Load default configuration now?” appears.
- 7 Check that Yes is selected, and then press the Enter key.
- 8 Press the arrow keys to select Exit (Save Changes) and then press the Enter key. The message “Save configuration changes and exit now?” appears.
- 9 Check that Yes is selected, and then press the Enter key. The computer restarts.

When I turn on my computer, the message “No system disk or disk error. Replace and press any key when ready” appears and the computer does not start.

Remove the diskette from the floppy disk drive by pressing the Eject button and then press any key.

My LCD does not display anything

- ❑ Check that the computer is plugged into a power source and that it is turned on. Check that the power indicator on the front panel of the computer is on.
- ❑ Check that the battery pack is inserted properly and that it is charged.
- ❑ The computer may be in LCD (Video) Standby mode. Press any key to activate the display.
- ❑ The video output may be directed to an external display. Press Fn+F7 until video output appears on the LCD.

The screen image on my external display is not centered or sized properly

Use the controls on your external display to adjust the image. See the manual supplied with your display for more information.

The video image on my screen is too dark

If an external display is connected to the Monitor connector, disconnect the display.

The pointer moves across the screen on its own

This is called a “drift” and is not a malfunction. The pointer stabilizes if you do not touch the pointing device for a few seconds.

When I press the pointing device without pressing the left button, it clicks

Check that you have not selected the press-select function. See “Changing the Pointing Device settings” in the online document *Customizing Your VAIO® C1 PictureBook™ Computer*.

My mouse doesn't work

If you are using an external mouse, check that the mouse is plugged into the USB connector. See “Connecting an External USB Mouse” on page 55 for details.

My computer “locks up”

- ❑ Try restarting the computer. On the Windows taskbar, click the Start button, click Shut Down, and then click Restart the computer.
- ❑ If you cannot restart as described in the preceding step, you can restart the computer by pressing Ctrl+Alt+Delete.
- ❑ If the previous step does not work, slide the power switch toward the front and hold it for four seconds. This turns off the power.
- ❑ If your computer locks up while playing a CD-ROM, stop the CD-ROM, and restart the computer by pressing Ctrl+Alt+Delete.



Pressing Ctrl+Alt+Delete or turning off the computer with the power switch may result in data loss in files that are currently open.

My software program “locks up” or crashes

Contact the software publisher or designated provider for technical support.

Movements of the displayed images are awkward (not smooth)

In PowerPanel, right-click CPU Speed and select OS Controlled. See “Controlling Power Management” in the online document *Customizing Your VAIO® C1 PictureBook™ Computer* for details.

I cannot play a CD-ROM

- ❑ Make sure the label of the CD-ROM is facing up.
- ❑ If the CD-ROM requires software, make sure the software is installed according to the program's instructions.
- ❑ Moisture condensation may have occurred. Disconnect the CD-ROM drive and disconnect the power to the drive for at least one hour.
- ❑ Make sure the CD-ROM drive is properly connected. See "To connect a CD-ROM drive" on page 56.
- ❑ Clean the CD-ROM.
- ❑ Check the speaker volume.

When I press Fn+F3, nothing happens

Use the following procedure to enable sound:

- 1 Click Start, select Settings, and click Control Panel.
- 2 Click the System icon.
- 3 Click the Device Manager tab.
- 4 Click Sound, video and game controllers.
- 5 Double-click Yamaha DS-XG PCI Audio CODEC (WDM).
- 6 Uncheck the "Disable in this hardware profile" box.
- 7 Click OK. The sound is now enabled.

My microphone doesn't work

If you are using an external microphone, check that the microphone is plugged into the Microphone connector. For details, see "Connecting an External Microphone" on page 61.

When I click an application icon a message appears, such as "You must insert the application CD into your CD-ROM drive," and the software does not start

- ❑ Some titles require specific files that are located on the application's CD-ROM. Insert the disc and try starting the program again.
- ❑ Make sure you place the disc in the tray with the label side facing up.

My floppy disk drive cannot write to a diskette

- ❑ The diskette is write-protected. Disable the write-protect feature or use a diskette that is not write-protected.
- ❑ Check that the diskette is properly inserted into the floppy disk drive.

My speaker has no sound

- ❑ The built-in speaker is turned off. Press Fn+F3 to turn on the speaker.
- ❑ The speaker volume is turned to the minimum. Press Fn+F4, and then press **↑** or **→** to increase the volume.
- ❑ If your computer is powered by the battery, check that the battery is connected properly and that it is charged.
- ❑ If you are using an application that has its own volume control, check that the volume is turned up.
- ❑ Check the volume controls in Windows 98.
- ❑ If you have connected a headphone or an audio cable to the Headphone connector, disconnect the cable.

My modem does not work

- ❑ Check that the phone line is plugged into the line jack. See “Connecting a Phone Line” on page 44 for details.
- ❑ Check that the phone line is working. You can check the line by plugging in an ordinary phone and listening for a dial tone.
- ❑ Check that the phone number the program is dialing is correct.
- ❑ Check that the software you are using is compatible with the computer modem. (All preinstalled programs are compatible.) Call the software publisher.

My modem connection is slow

The computer's modem uses K56flex™ technology/V.90. Many factors influence modem connection speed, including telephone line noise or compatibility with telephone equipment (such as fax machines or other modems). If you think your modem is not connecting properly to other PC-based modems, fax machines, or your Internet Service Provider, check the following:

- ❑ Have your phone company check that your phone line is free from any line noise.
- ❑ If your problem is fax-related, check that there are no problems with the fax machine you are calling and that it is compatible with fax modems.
- ❑ If you are having a problem connecting with your Internet Service Provider, check that the ISP is not experiencing technical problems.
- ❑ If you have a second phone line available, try connecting the modem to that line.

I cannot use DV devices and messages appear on the screen

- ❑ Check that the DV device is turned on and that the cables are properly connected.
- ❑ If you are using multiple i.LINK devices, the combination of the connected devices may cause unstable operation. In this case, turn off the power to all connected devices and disconnect unused devices. Check the connection, then turn on the power again.

My computer does not shut down

It is best to shut down your computer using the Shut Down command on the Windows 98 Start menu. Using other methods, including those listed here, may result in loss of unsaved data. If the Shut Down command does not work properly, follow these steps:

- ❑ Restart the computer by pressing Ctrl+Alt+Delete. If this does not work, slide the power switch forward and hold it for four seconds.
- ❑ Unplug the computer from the AC adapter and remove the battery pack from your computer.

My PC card is not working

- ❑ Make sure the PC card is compatible with Windows 98.
- ❑ Use the Sony Notebook Setup utility to disable devices you are not currently using.

The game images or video images are not clear

Right-click the application bar of the PowerPanel software, right-click CPU Speed, and select OS Controlled. See the online help of the PowerPanel help file for details.

There is a vertical line when shooting a bright subject with a dark background using the camera

This is a phenomenon called “smear.” This is not a malfunction.

The image in the viewfinder of “Smart Capture” is grainy

- ❑ If you are shooting an image of minimum size, such as 40 x 30, the image may appear grainy.
- ❑ If you are shooting a subject that is moving rapidly, there may be a gap. This is not a malfunction.

The images imported with the MOTION EYE camera are not clear

- ❑ Shooting under fluorescent light may result in reflections.
- ❑ Red or green interference may occur if the imported images include dark parts.
- ❑ Check that the lens of the MOTION EYE camera is clean.
- ❑ Use the focus ring for focus adjustment.

I cannot record using Smart Capture, Smart Write, or Smart Label

- 1 Double-click  in the task tray.
- 2 Point to Display Select and select Recording.
- 3 Remove the check from the Mute check box in Microphone if the box is selected.

Smart Write and Smart Label do not start

Reinstall the software using the Application Recovery CD.

About the MOTION EYE Camera

There is a vertical line when shooting a bright subject with a dark background using MOTION EYE camera. This is a phenomenon called “smear,” resulting from the inherent limits of this technology. This is not a malfunction.

The image in the view finder of “Smart Capture” is rough

If you are shooting a subject in rapid movement, there may be a gap. However, this is not a malfunction.

There are picture gaps and sound gaps when importing video images

Gaps may occur based on the effect settings in the Smart Capture software. See the on-line help of the Smart Capture software for details.

The MOTION EYE camera does not show any images

- ❑ Check to see if you are using any other applications which use the MOTION EYE camera. If any of these applications are running, close them.
- ❑ Check the screen resolution and the color palette settings. These settings use video memory. Selecting lower settings releases video memory.
- ❑ Open the Camera Control utility by selecting Start, Control Panel, and then clicking MOTION EYE camera. In the window that displays, select the Default button.
- ❑ If the MOTION EYE camera still does not show any images, restart your computer.

The message "Failed to record to DV deck" appears

If this message appears while you are recording images to a digital video device using DVgate Motion, close all open applications and restart your computer. Frequent recordings of images to a digital video device while using DVgate Motion sometimes causes this to occur.

Power Management

The operating system may become unstable if a lower power state such as system hibernation is initiated and then changed before the operating system completely enters the lower power state. To restore the computer to its normal operating stability, close all open applications, and restart the computer. If the computer does not restart, press the power button and hold it there for four seconds or more to completely shut down the computer.

Using the System and Application Recovery CDs

The following sections describe how to use the System Recovery and Application Recovery utilities. You need to connect the optional PCGA-CD51 CD-ROM drive to use the System and Application Recovery CDs.

Using the System Recovery CD(s)

You can reinstall software titles that shipped with your computer if they are corrupted or accidentally erased. You may not need to recover the entire contents of your hard drive. If you experience a problem with your computer, reinstalling an individual device driver or software title may correct the problem. Use the Application Recovery CD(s) to reinstall individual applications or device drivers. See “Using the Application Recovery CD(s)” on page 74.

The System Recovery CD contains a backup copy of all the software originally installed on your hard disk drive. **It can be used only to recover the hard disk of the computer you purchased.**

The System Recovery utility gives you three options:

- ❑ **Full Restore without Format** restores all the software titles that originally came with your computer without formatting the hard disk.
- ❑ **Full Restore with Format** formats the hard disk drive and then restores all the original software.
- ❑ **Operating System Only** restores the Windows 98 operating system, the computer utility programs, and the device drivers that shipped with your computer.

! If you choose the Full Restore with Format or Operating System Only option, your hard disk will be formatted, which removes all the information on the hard disk drive. You will lose any software you have installed and any other files you have created since you started to use your computer. This means you will have to reinstall any applications that were not included with the computer when you purchased it. If you choose the Full Restore without Format option, you may need to reinstall applications that were not included with the computer when you purchased it. If you have any questions on using the System Recovery CD, contact Sony Customer Support.

To use the System Recovery CD

 The optional PCGA-CD51 CD-ROM drive must be connected to the computer to use the System Recovery CD.

- 1 Insert the Sony System Recovery CD in the CD-ROM drive.
- 2 Shut down your computer as described in “Shutting Down Your VAIO C1 PictureBook Computer” on page 15.
- 3 Wait four seconds and turn on your computer.
- 4 Click OK to signify you have read and accept the Microsoft End-User License Agreement.
- 5 When the System Recovery menu appears, follow the on-screen instructions to complete the recovery process.

 Your system may include one or two System Recovery CDs. If you have two System Recovery CDs, insert the first CD to run the System Recovery program. You are prompted to insert the second CD once the information from the first CD has been installed.

The recovery process takes between 30 to 60 minutes to complete.

If your computer does not start from the Recovery CD

- 1 Slide the power switch forward and hold it for more than four seconds to turn off the computer.
- 2 Turn on the computer and press the F2 key when the Sony logo appears. The BIOS setup menu screen appears.
- 3 Press the arrow keys to select the Exit menu.
- 4 Press the arrow keys to select Get Default Values and then press the Enter key. The message “Load default configuration now?” appears.
- 5 Check that Yes is selected, and then press the Enter key.
- 6 Press the arrow keys to select Exit (Save Changes) and then press the Enter key. The message “Save configuration changes and exit now?” appears.
- 7 Check that Yes is selected, and then press the Enter key. The computer restarts from the Recovery CD.

Using the Application Recovery CD(s)

The Application Recovery CD(s) allow you to reinstall individual applications and device drivers if they are corrupted or accidentally erased. Reinstalling an individual device driver or software title may correct a problem you are experiencing with your computer, and you may not need to recover the entire contents of your hard drive. If you do need to reinstall all the software titles that shipped with your computer, use the System Recovery CD(s). See “Using the System Recovery CD(s)” on page 72.



You must be in Windows to run the Application Recovery CDs. The application will not run from DOS. If you have any questions on using the Application Recovery CDs, contact Sony Customer Support.

Some applications on the Application Recovery CDs must be decompressed before the installation process begins. Your screen does not change while the files are decompressed. The time to decompress an application varies and may be as long as 30 minutes.

To use the Application Recovery CD(s)

- 1 Turn on your computer. If your computer is already on, close all applications.**
- 2 When the Windows desktop appears, insert the first Sony Application Recovery CD in the CD-ROM drive. The Application Recovery utility loads automatically.**
- 3 When the Application Recovery menu appears, follow the on-screen instructions to complete the recovery process.**



You may be prompted to insert the second CD, depending on the application you want to restore.

Your system may include one or two Application Recovery CDs. If you have two Application Recovery CDs, insert the first CD to run the Application Recovery program. You may be prompted to insert the second CD, depending on the application you wish to restore.

Hard Drive Partition

In order to improve the performance of your computer's DVgate™ Motion software, the hard disk drive on your computer has been formatted with two partitions. The C drive partition is approximately 8 GB, and the D drive partition is 4 GB. DVgate Motion saves files to the D partition. This prevents large video captures from consuming the available space on your C partition. To maintain optimum performance of DVgate Motion, you should defragment your D partition regularly. See the DVgate Motion online help for more information.

Specifications

<i>Model</i>	<i>PCG-C1XS</i>	
<i>Processor</i>	400 MHz* Mobile Intel® Pentium® II Processor	
<i>Hard Disk Drive</i>	12 GB†	
<i>Integrated Camera</i>	410,000 pixels (effective 380,000 pixels)	
<i>Image Device</i>	1/6 inch 410,000 pixel CCD	
<i>Lens</i>	2 elements in 2 groups f = 2.8 mm, F = 2.8	
<i>White Balance</i>	Auto/Indoor/Outdoor/Hold	
<i>Shutter Speed</i>	Auto/ 1/100 /Hold	
<i>Video Capture Format/Size</i>	YUY2/RGB 24 bit Motion JPEG	40 x 30, 80 x 60, 160 x 120, 320 x 240, 640 x 480
<i>Display Frames</i>	30 frames/second maximum (overlay)	
<i>Capture Frames</i>	30 frames/second maximum (320x240 motion JPEG) 15 frames/second maximum (640x480 motion JPEG)	
<i>Standard RAM</i>	64 MB SDRAM, expandable to 128 MB	
<i>LCD Screen</i>	8.9" XWIDE™ Active Matrix XGA TFT (1024 x 480)	
<i>L2 Cache Memory</i>	128 KB	
<i>MPEG</i>	MPEG1 Digital Video supports full-screen playback	
<i>Graphics</i>	128-bit accelerator with 2.5 MB Video RAM	
<i>Sound Capabilities</i>	16-bit CD-quality stereo sound	
<i>Diskette Drive</i>	External 3.5" 1.44 MB (USB)	
<i>Modem</i>	K56flex and V.90 compatible data/fax modem‡	
<i>Infrared</i>	Supports 4 Mbps, 1.1 Mbps, and 115 kbps IrDA standard	
<i>Expansion Capabilities</i>	One PCMCIA type II card and card bus support	
<i>Built-in Capabilities</i>	Mono microphone Stereo Speaker MOTION EYE camera Pointing device Jog Dial control	
<i>Special Buttons</i>	Jog Dial control and capture	
<i>Telecommunications Capabilities</i>	Fax send/receive	

<i>Model</i>	<i>PCG-C1XS</i>
<i>Connection Capabilities</i>	Phone line (RJ-11) USB port Stereo headphone (MEGA BASS support) Microphone in VGA monitor i.LINK
<i>Supplied Accessories</i>	USB Floppy disk drive Rechargeable battery AC adapter Display adapter Pointing device spare caps
<i>Service</i>	90-day limited express service ^{††} Extendible to one year from original date of purchase upon registration
<i>Limited Warranty</i>	90-day parts/labor standard ^{††} Extendible to one year from original date of purchase upon registration
<i>Power Requirements</i>	34 watts maximum (16V DC/AC100-240V)
<i>Power Management</i>	Energy Star Compliant Advanced power management (APM) version 1.2
<i>Battery</i>	Lithium-ion 11.1 V
<i>Dimensions</i>	9.76" (w) x 1.06" (h) x 6.02" (d) (248 mm x 27 mm x 153 mm)
<i>Weight</i>	2.2 lbs. (1.0 kg) (with supplied battery)
<i>Operating Temperature</i>	41°F to 95°F (+5°C to 35°C) (Temperature gradient less than 18°F/10°C/hour)
<i>Operating Humidity</i>	20% to 80% (not condensed) when that humidity is less than 65% at 95°F (35°C) (hygrometer reading of less than 84°F (29°C))
<i>Storage Temperature</i>	-4°F to 140°F (-20°C to 60°C) (temperature gradient less than 18°F(10°C)/hour)
<i>Storage Humidity</i>	10% to 90% (not condensed) when that humidity is less than 20% at 140°F (60°C) (hygrometer reading of less than 95°F (35°C))

*MHz denotes microprocessor internal clock speed; other factors may affect application performance.

†GB means one billion bytes when referring to hard drive capacity. Accessible capacity may vary.

‡ Due to FCC limitations, speeds of 53 kbps are the maximum-permissible transmit power levels during download transmissions. Actual data speeds vary depending on the line conditions. Maximum speed for faxing is 14.4 kbps. Your modem is capable of downloading at 56 kbps using K56flex technology or V.90. Your online service or Internet Service Provider, however, may not support this technology or operate at this speed.

†† Certain restrictions apply.

Specifications are subject to change without notice.

This product meets the standards of the International Energy Star Program for energy efficiency.

Index

A

- AC adapter **8**
- AC power **8**
- accessing online support **16**

adding

- hardware **43**
- peripherals **43**
- printers **46**

adjusting

- brightness **21**

Alt key **18**

Application Recovery CDs **74**

Applications key **18**

B

battery pack **9**

- charging **10**
- indicator light status **10**
- indicator lights **10**
- inserting **9**
- loading **9**
- power status **10**
- rechargeable **8**
- removing **12**

brightness

- adjusting **14, 21**

built-in speaker **21**

- volume **21**

buttons

- Open **57**
- Start (Windows 98) **15**

C

cameras

- digital video recorder **59**

canceling commands **18**

Caps Lock

- indicator light **20**

CD-ROM drive

closing lid **58**

- connecting **35, 56**
- opening lid **57**
- troubleshooting **67**
- using **56**

charge status indicator light **10**

charging battery pack **10**

choosing

- power source **9**

coin-operated telephones **45**

computer

- lithium ion battery **vi**
- setting up **5**
- starting **14**
- troubleshooting **64–69**

connecting

- CD-ROM drive **35, 56**
- coin-operated telephones **45**
- digital video recorder **59**
- external keyboard **55**
- external mouse **55**
- floppy disk drive **33**
- monitor **47**
- multiple phone lines **45**
- network **35**
- parallel devices **46**
- party phone lines **45**
- PBX **45**
- phone line **44**
- power source **8**
- printer **46**
- projector **48**

connectors

- DC In **8**
- external speakers **7**

- infrared **39**
- parallel **46**
- printer **46**
- correction keys **17, 18**
- Ctrl key **18**
- cursor-movement keys **17**
- customer assistance
 - support options **62**
- D**
- DC In **8**
- digital still camera **39**
- digital video camera **59**
- diskettes
 - ejecting **34**
 - inserting into drive **33**
 - troubleshooting **67**
- disposal of lithium ion battery **vi**
- drives **56**
 - CD-ROM **56**
 - floppy disk **33**
- DV In/Out **59**
- E**
- Eject button **34**
- ejecting
 - diskettes **34**
- electronic
 - documentation **62**
- Energy Star **ii**
- Escape key **18**
- Express Service technical support **16**
- external devices
 - display
 - See also monitor
 - keyboard **55**
 - mouse **55**
- F**
- faxes
 - laws governing **v**
- floppy disk drive
 - connecting **33**
 - disconnecting **34**
 - troubleshooting **67**
- Fn key **18**

- combination commands **21**
- function keys **17, 18**
- H**
- headphone
 - connector **48**
- help **62**
- I**
- i.LINK **59**
- IEEE-1394 **59**
- indicator lights
 - battery **10**
 - Caps Lock **20**
 - charge status **10**
 - Num Lock **20**
 - Scroll Lock **5, 20**
- infrared communication devices **39**
 - other computers **39**
- infrared port **39**
- infrared transmission
 - active distance **40**
 - troubleshooting **40**
- input devices **iv**
- Insert key **17, 18**
- inserting
 - battery pack **9**
 - diskettes into drive **33**
- installing
 - hardware **43**
 - memory **35**
 - peripherals **43**
- interference **iv**
- K**
- keyboard **17–19, 21**
 - connecting **55**
- L**
- LCD
 - troubleshooting **65**
- Limited Warranty **16**
- lithium ion battery
 - disposal **vi**
 - safety precautions **vi**
- loading

- battery pack **9**
- M**
- memory module
 - installing **35**
- microphone **5**
- modem
 - laws governing **v**
 - troubleshooting **68**
- monitor
 - connecting **47**
 - switching among **21**
- mouse
 - connecting **55**
- multiple phone lines **45**
- N**
- navigation keys **17**
- network
 - connecting **35**
- Num Lock
 - indicator light **20**
- numeric keypad area **17**
- O**
- online
 - help **62**
- Open button **57**
- opening
 - CD-ROM drive lid **57**
- operator keys **18**
- output devices **iv**
 - adding **46**
- P**
- parallel port **46**
- party phone lines **45**
- PBX **45**
- PC card
 - inserting **35**
 - removing **37**
 - slots **35**
 - troubleshooting **69**
 - Type II **35**
- phone
 - connecting line **44**
 - jack **44**
 - laws governing **v**
- power saving modes **41**
 - System Hibernation **21, 42**
 - System Suspend **21, 41**
 - Video Standby **21**
- power sources **9**
 - connecting **8**
- Print Screen key **18**
- printer
 - connecting **46**
 - port **46**
- projector **48**
- R**
- radio interference **iv**
- rechargeable battery pack **8, 9**
- recharging battery pack **10**
- Recovery CDs **74**
- registering
 - your computer **16**
- removing
 - battery pack **12**
 - diskettes **34**
 - floppy disk drive **34**
- restoring data **74**
- S**
- Scroll Lock **5**
 - indicator light **20**
- selecting
 - power source **9**
- Shift key **18**
- Shut Down Windows dialog box **15**
- Sony Fax-on-Demand service **63**
- speakers
 - connectors **7**
 - troubleshooting **68**
- Start button **15**
- starting
 - computer **14**
- startup problems **15**
- switching
 - display **21**
 - monitor **21**
- System Hibernation mode **21, 42**

System Suspend mode **21, 41**

T

technical support

 support options **62**

troubleshooting **64–69**

 startup **15, 64**

turning on

 computer **14**

TV

 interference **iv**

V

VAIO Action Setup **24**

video camera **59**

Video Standby mode **21**

W

warranty **16**

Windows 98

 Control Panel **40**

 Explorer **19**

 Find window **19**

 help **19**

 key **18**

 key combinations **19**

 Start button **15**

 taskbar **15, 66**