

**Panel w/ Elongated Lens Detail**

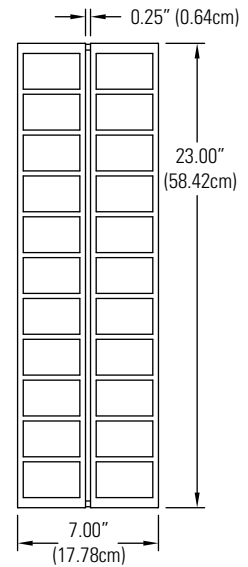
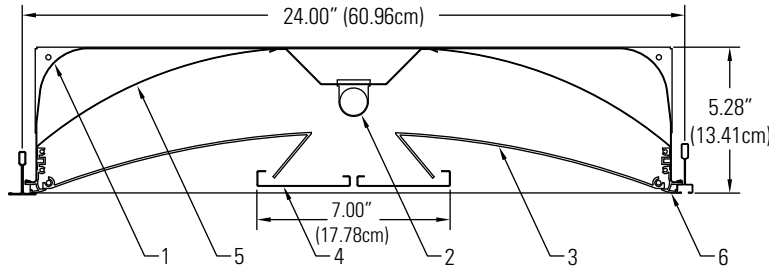

**Panel w/ Segmented Lens Detail**

### Ordering Information

Family	Shielding	Length	Lamps	Lamp Type	Ballast Factor	Voltage	Housing	Option
<b>A</b>	<input type="checkbox"/>	<input type="checkbox"/>	<b>1</b>	<b>T8</b>	<input type="checkbox"/>	<input type="checkbox"/>	<input type="checkbox"/>	<input type="checkbox"/>
<b>Aletta</b>	<b>PE</b> = Panel w/ Elongated Lens <b>PS</b> = Panel w/ Segmented Lens	<b>2</b> = 2' (60.96cm) <b>4</b> = 4' (121.92cm)	<b>1</b> = 1 Lamp	<b>T8</b> = T8 Standard Output	<b>71</b> = .71 <b>78</b> = .78 <b>88</b> = .88 <b>10</b> = *1.0 Dimming and Static <b>12</b> = *1.2 Step Dimming	<b>1</b> = 120v <b>2</b> = 277v <b>3</b> = 347v	<b>U</b> = Individual Unit <b>S</b> = Starter <b>J</b> = Joiner <b>E</b> = Ender	<b>D</b> = Dimming <b>E</b> = EM Pack <b>2</b> = 2 Circuit <b>4</b> = 4 Through Wire <b>5</b> = 5 Through Wire

\* For dimming, use "D" option. If "D" is not selected, ballast will be static.

### Features

- Housing:** 23 gauge pre-painted steel. 20 gauge available, consult factory.
- Lamp:** One T8. (by others)
- Faux Housing:** Extruded Frosty acrylic.
- Panel:** 24 gauge powder painted CRS with linear micro-prismatic lens overlays. Elongated lens openings are 22" (55.88cm) windows. Segmented lens openings are 2" (5.08cm) windows.
- Performance Kick Reflector:** .020" (0.05cm) 95%-98% reflective, UV resistant polypropylene.
- Trim:** Extruded aluminum trim, painted white, interfaces with ceiling grid or plaster frame by others.

### Electrical

Ballasts are electronic and high power factor. Dimming ballasts are available on many lamp types, please consult factory regarding specific applications. 1325 max lumen battery pack is standard. See application table on page 2 for output with specific lamp types. Continuous luminaires utilize 12 gauge through wires. Factory installed ballast disconnect allows the ballast to be disconnected from and reconnected to incoming power under load without turning the entire circuit off.

### Mounting

Housing is suspended by hanger wires and laid into standard or slot-T grid ceiling. Mounting accessory available for drywall installations (see page 2).

### Labels

UL, cUL and I.B.E.W.

### Ordering Instructions

#### Individual Fixtures:

- Order quantity of Individual Units required.

#### Continuous Runs:

- Order one Starter and one Ender fixture per run.
- Order appropriate quantity of Joiner fixtures.

Continuous runs only - Prior to installing Aletta in a grid ceiling, the installing contractor must ensure that the fixture will set into two main runners, spaced 2' (60.96cm) on center. No grid cross members are required except at the beginning and end of the run.

Job Information	Type:
<b>Job Name:</b>	
<b>Cat. No.:</b>	
<b>Lamp(s):</b>	
<b>Notes:</b>	

631 Airport Road, Fall River, MA 02720 • (508) 679-8131 • Fax (508) 674-4710  
We reserve the right to change details of design, materials and finish.  
www.lightolier.com © 2008 Philips Group • C0808

## Performance

CANDLEPOWER CURVE

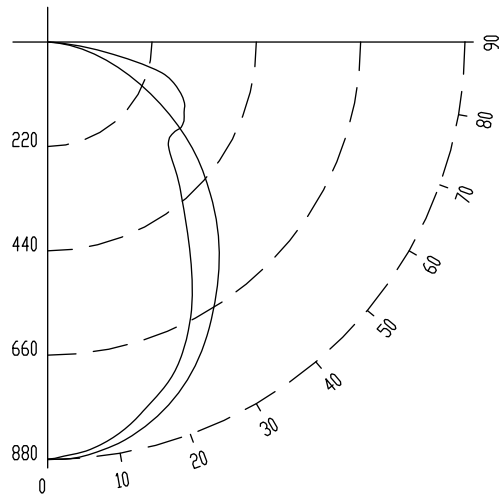

REPORT NO.: APE41T8.IES  
 LAMPS: 1 F032/835  
 LUMENS: 2950  
 EFFICIENCY: 71.3%

ZONE	CANDLEPOWER				
	0	22	45	67	90
DEG.	CANDELAS				
90	0	0	0	0	0
85	22	40	43	40	36
75	109	120	184	233	249
65	221	210	232	293	319
55	360	328	288	303	328
45	496	480	421	390	381
35	624	625	581	539	519
25	745	739	724	704	692
15	831	826	815	805	799
5	876	874	871	869	867
0	879	879	879	879	879

COEFFICIENTS OF UTILIZATION  
 % EFFECTIVE CEILING CAVITY REFLECTANCE

ROOM CAVITY RATIO	WALL REFLECTANCE								
	80			70			50		
	70	50	30	70	50	30	50	30	10
0	85	85	85	83	83	83	79	79	79
1	77	74	71	75	72	69	69	67	65
2	70	64	60	68	63	59	61	57	53
3	64	57	51	63	56	50	53	49	45
4	59	50	44	57	50	44	48	43	39
5	54	45	39	53	45	39	43	38	34
6	50	41	35	49	40	34	39	34	30
7	47	37	31	46	37	31	36	30	27
8	44	34	28	43	34	28	33	28	24
9	41	32	26	40	31	26	30	25	22
10	39	29	24	38	29	24	28	23	20

20% FLOOR CAVITY REFLECTANCE

DISTRIBUTION

Zone	Lumens	% Lamp	% Luminaire
0-90	2104	71.3	100
0-180	2104	71.3	100

## EM Pack Output Table

Lamp Length	Lamp Type	Lamp Rated Output	Lamp Wattage	Battery Lumen Output
4' (121.92cm)	T5HO	4450*	54	1250*
4' (121.92cm)	T5	2600*	28	1325*
4' (121.92cm)	T8	2950	32	1100
2' (60.96cm)	T5HO	1750*	24	725*
2' (60.96cm)	T5	1200*	14	750*
2' (60.96cm)	T8	1350	17	650

\* 25°C Rating

## Mounting Accessory

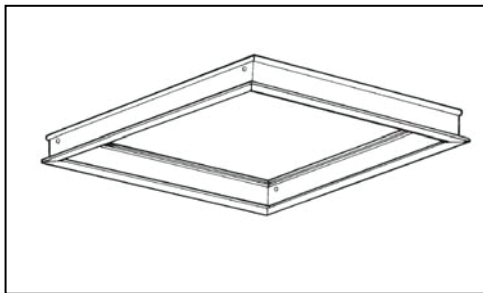

### Drywall Conversion Kit

For Individual Units only

**FK92X2** – Conversion Kit for 2' (60.96cm) Unit

**FK92X4** – Conversion Kit for 4' (121.92cm) Unit

### Job Information

### Type:

631 Airport Road, Fall River, MA 02720 • (508) 679-8131 • Fax (508) 674-4710

We reserve the right to change details of design, materials and finish.

www.lightolier.com © 2008 Philips Group • C0808