

# COOPER LIGHTING - METALUX®



## SNL SERIES SSL SERIES

2', 3', 4', 6' or 8' Strip  
1 or 2 Lamps

NARROW STAGGERED  
STRIPLITE (SNL)

STAGGERED STRIPLITE  
(SSL)

- Equipped with energy saving ballast/complies with federal energy efficiency standards
- For shadow free continuous illumination in cove lighting applications
- Pressure lock lampholders
- Die formed channel
- Can be surface or pendant mounted, individual or in rows
- Baked white enamel finish
- Easy wireway access/wireway cover removed without tools
- Numerous KO's for easy installation
- UL/CUL Listed. Suitable for damp locations.

### DESCRIPTION

The SNL Series (narrow staggered) and the SSL Series (staggered) make up a functional, multi-purpose staggered strip family that incorporates premium performance and construction durability. These energy efficient staggered strips can be surface or pendant mounted individually or in rows using various mounting methods. Both series provide 4" lamp overlap to produce shadow-free illumination when used in continuous rows. Numerous options and accessories are available for use with both series.

The SNL Series is an excellent choice for size restrictive architectural coves, showcases and displays. The SSL Series is perfect for normal sized coves, showcases and display areas.

### DIMENSIONS

#### SNL Series

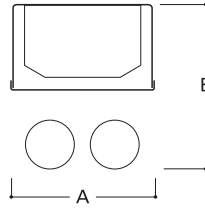

#### SSL Series

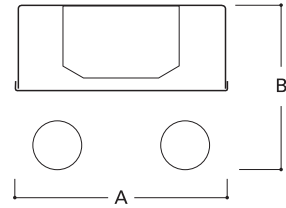

#### NOMINAL LENGTH

	A	B
(SNL) 2', 3', 4', 6' and 8'	2-3/4" (70mm)	3-5/8" (92mm)
(SSL) 2', 3', 4', 6' and 8'	4-1/4" (108mm)	3-3/8" (86mm)

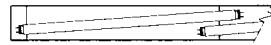

One lamp versions feature a diagonal lamp orientation for uniform illumination of the indirect surface.



Two lamp version

**ORDERING INFORMATION:** NOTE: Two SSL-1, SNL-1 or SSL-2, SNL-2 Starter Kits required per row. One Starter Kit: provided with each fixture<sup>(5)</sup>

SAMPLE NUMBER: SSL-232-120V-EB81-U

ADDITIONAL STARTER KITS<sup>(5)</sup>  
SAMPLE NUMBER: SSL-2

<b>Tandem</b> Blank=2', 3' or 4' Length 6T=6' Length 8T=8' Length	<b>Number of Lamps</b> 1 or 2 lamps (Not included)	<b>Options</b> (See Options Section)	<b>Packaging</b> U=Unit Pack	<b>Series</b> SSL=Staggered Strip SNL=Narrow Staggered Strip	<b>Number of Lamps</b> 1 or 2 lamps (not included)	<b>Type</b> (Slimline Lamps Only) Blank=Bipin rapid start lamp SL=Slimline or HO lamp
<b>Series</b> SSL=Staggered Strip SNL=Narrow Staggered Strip	<b>Wattage (Length)</b> 20=20W T12 (24") 17=17W T8 (24" T8) 30=30W T12 (36") 25=25W T8 (36" T8) 40=40W T12 (48") 32=32W T8 (48") 96=75W T12 (96") SL <sup>(3) (6)</sup> 96T8=59W T8 (96") SL <sup>(3) (6)</sup> 96T8HO=86W T8 (96") HO <sup>(3) (6)</sup>	<b>Ballast Type<sup>(1)</sup></b> Blank=Standard Magnetic Ballast LE3=T12 Magnetic Energy Saving EB8 = T8 Electronic Instant Start. Total Harmonic Distortion < 10% No. of Ballast 1, 2 or 3 EB8 / PLUS= T8 Electronic Instant Start. High Ballast Factor >1.13. Total Harmonic Distortion < 20% No. of Ballast 1, 2 or 3 ER8 = T8 Electronic Program Rapid Start. Total Harmonic Distortion < 10% No. of Ballast 1, 2 or 3 EB5 = T5 Biax Electronic Instant Start. Total Harmonic Distortion < 20% No. of Ballast 1, 2 or 3 TEB5 = T5 Biax Electronic Instant Start. Total Harmonic Distortion < 10% No. of Ballast 1, 2 or 3 EB2 = T12 Electronic Rapid Start. No. of Ballast 1 or 2 DLS=Digital Lighting System Dimming (For complete details on generic or to specify manufacturer's ballast see pg. 469)				
	<b>Starting Type</b> LTS=Low Trigger Start (20 Watt only) (120V only) HTS=High Trigger Start (20 Watt only) LRS=Low Rapid Start (3' or 4') (T12 only) (120V only) HRS=High Rapid Start (3' or 4') (T12 only)					
	<b>Voltage<sup>(1)</sup></b> 120V=120 Volt 277V=277 Volt 347V=347 Volt UNV=Universal Voltage 120-277 <sup>(2)</sup>					
	<b>Options</b> GL=Single Element Fuse GM=Double Element Fuse Emergency - for EM installed, see EM options table <sup>(4)</sup>					

NOTES: <sup>(1)</sup>Products also available in non-US voltages and frequencies for international markets. <sup>(2)</sup>Not available when specifying emergencies, voltage must be specific. <sup>(3)</sup>96" high output available in T8 only. <sup>(4)</sup>Not available for 2' versions. <sup>(5)</sup>Sufficient starter kits are provided with each fixture for multiple fixture rows. If rows consist of only one fixture, an additional row starter kit must also be ordered. <sup>(6)</sup>SSL only.

For complete product data, reference the Fluorescent Specification binder. Specifications & dimensions subject to change without notice. Consult your Cooper Lighting Representative for availability and ordering information.