

**MODEL NUMBER:**

- **2171 Single Control Lavatory**  
Pop-up drain. Porcelain Lever Handle. Polished Chrome finish.
- **2171S Single Control Lavatory**  
Pop-up drain. Porcelain Lever Handle. Satin Nickel (PVD) finish.

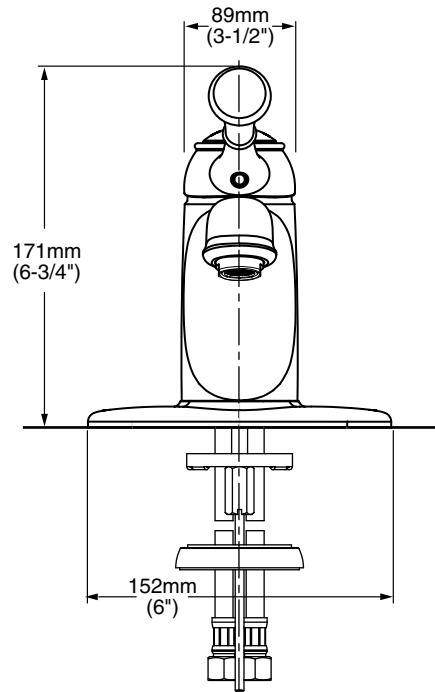
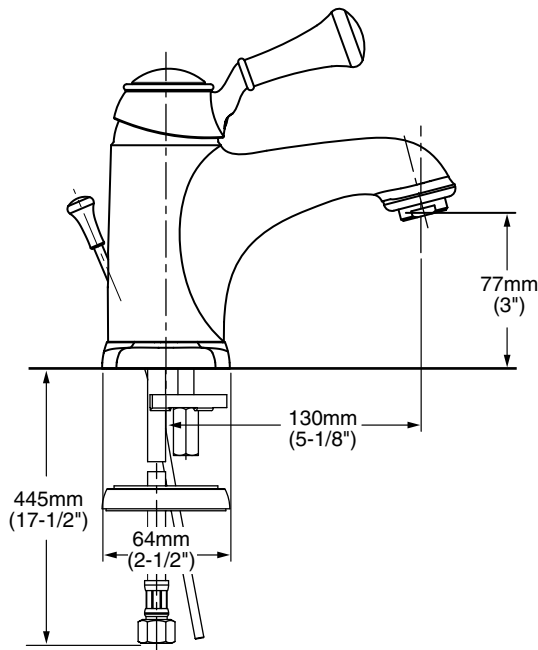

**GENERAL DESCRIPTION:**

Cast brass body. Genuine porcelain lever handle. Washerless 47mm ceramic disc valve cartridge. Equipped with a hot limit safety stop. Braided flexible supply hoses with 3/8" compression connectors. Fitting can be mounted on 4" centers using supplied brass escutcheon or by single hole mounting method using supplied decorative ring. All metal pop-up drain. 1.5 gpm/5.7L/min. maximum flow rate.

**PRODUCT FEATURES:**

**Cast Brass Construction:** Durable. Easy to clean, seamless design. Ideal for prolonged contact with water.

**Ceramic Disc Valve Cartridge:** Assures a lifetime of smooth handle operation and drip-free performance.

**Adjustable Hot Limit Safety Stop:** Limits the amount of hot water allowed to mix with cold. Reduces the risk of accidental scalding.

**Low Lead:** Meets NSF Standard 61/Section 9 & Prop 65 lead requirements.

**Genuine Porcelain Handle:** Lever handle.

**Choice of Finishes:** Available in Polished Chrome or Satin Nickel (PVD).

**SUGGESTED SPECIFICATION:**

Single control lavatory faucet shall feature a cast brass body and porcelain lever handle. Fitting shall be equipped with flexible supply hoses with 3/8" compression connectors. Shall also feature washerless ceramic disc valve cartridge. Fitting shall be equipped with a hot limit safety stop. Fitting shall be American Standard Model # 2171\_.

CODES AND STANDARDS

These products meet or exceed the following codes and standards:

- ANSI A117.1
- ASME A112.18.1
- CSA B 125
- NSF 61/Section 9

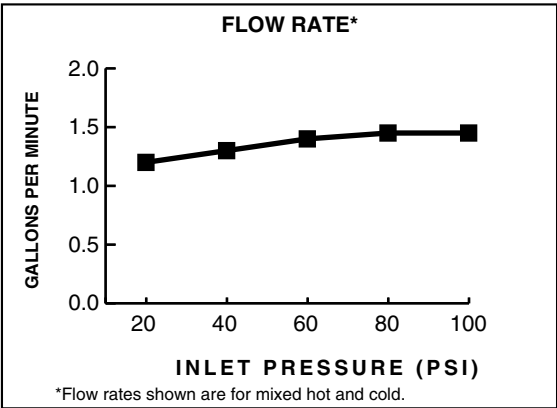

Product Number	Description
2171	Single Control Lavatory faucet with pop-up drain. Porcelain Lever handle. Polished Chrome finish.
2171S	Single Control Lavatory faucet with pop-up drain. Porcelain Lever handle. Satin Nickel (PVD) finish.

Meets the American Disabilities Act Guidelines and **ANSI A117.1** Requirements for the physically challenged.