

*American Standard*

# Reliant+™

**LAVATORY FAUCETS  
POP-UP DRAIN**

## Installation Instructions

**2385.R SERIES  
2385.W SERIES**

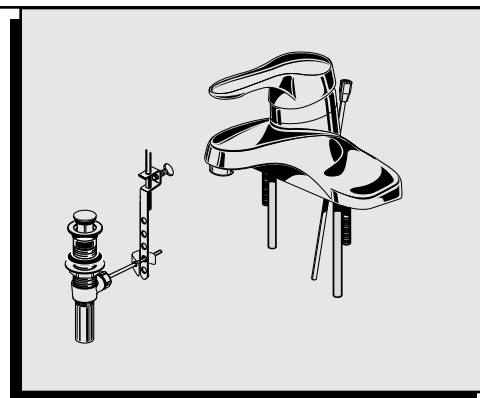

*Thank you for selecting American-Standard...the benchmark of fine quality for over 100 years.*

*To ensure that your installation proceeds smoothly-please read these instructions carefully before you begin.*

Certified to comply with ANSI A112.18.1M  
U.S. PATENT NO. 4,294,289;

78523C

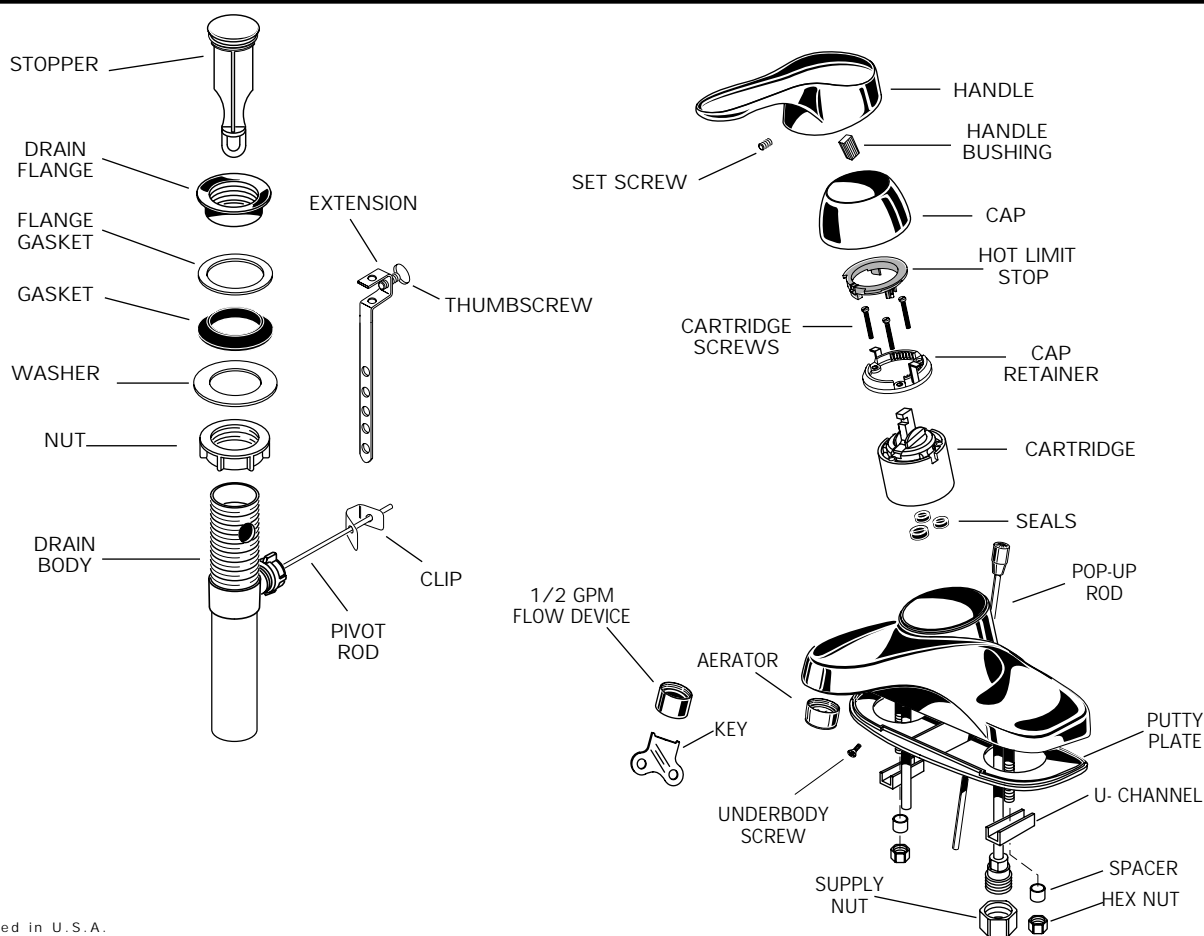

Printed in U.S.A.



**1**

### CAUTION

Turn off hot and cold water supplies before beginning.

#### FAUCET INSTALLATION

- Put U-CHANNEL, SPACERS, if necessary and NUTS onto BOLTS.
- Place PUTTY PLATE on SINK. Push faucet supplies and studs through deck holes.
- Insert POP-UP ROD to assure proper clearance when faucet is assembled to the sink.
- Position FAUCET on SINK.
- Tighten HEXNUTS.

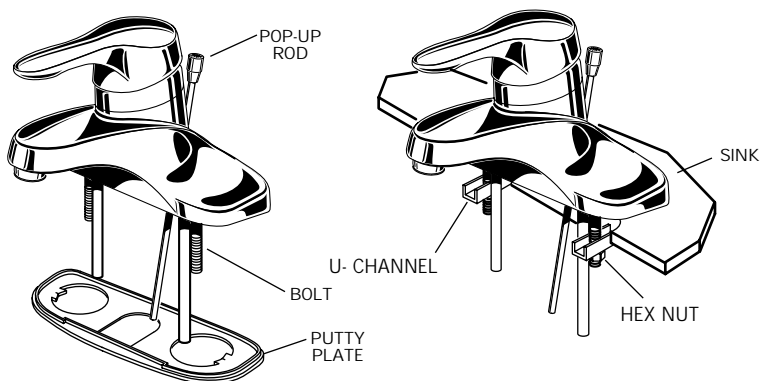

## 2

### CONNECT SUPPLIES

- Carefully bend copper supplies to meet water supply lines using the palms of the hands to avoid kinking.
- Connect HOT water supply line to LEFT tube, and COLD water supply line to RIGHT tube using appropriate connectors.



OR



## 3

### INSTALL POP-UP DRAIN

- Push DRAIN BODY down into trap.
- Thread LOCKNUT, WASHER and GASKET onto DRAIN BODY.
- Feed DRAIN BODY up through SINK. Place FLANGE GASKET over BODY and thread FLANGE **FULLY** onto BODY.
- Tighten LOCKNUT firmly, keeping the PIVOT ROD pointed towards the back of the SINK.
- Drop STOPPER into DRAIN BODY.
- Position EXTENSION ROD onto POP-UP ROD and tighten THUMBSCREW.

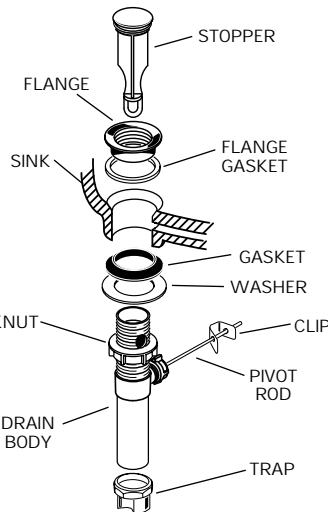

- Remove one end of CLIP from PIVOT ROD by squeezing ends together while sliding.
- Insert PIVOT ROD into second or third hole in EXTENSION and reassemble CLIP. (EXTENSION may need to be bent.)
- Adjust STOPPER height by repositioning EXTENSION and tightening THUMBSCREW.

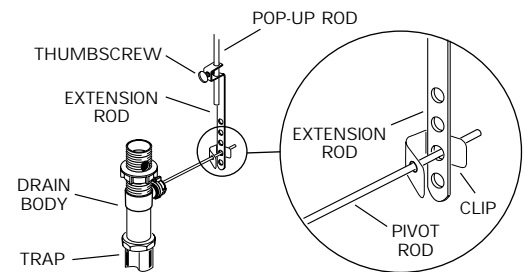

## 4

### TEST INSTALLED FAUCET

- Move handle down into "off" position and remove AERATOR.
- For vandal-resistant FLOW DEVICE, insert KEY teeth into slots near outlet and turn.

- Turn on water supplies and check connections for leaks.
- Operate handle up and down, left and right to flush water lines thoroughly.
- Move handle down to "off" position and replace AERATOR or FLOW DEVICE.

## 5

### HOT LIMIT STOP

By restricting handle rotation and limiting the amount of hot water allowed to mix with the cold, the HOT LIMIT SAFETY STOP reduces risk of accidental scalding. To set the maximum hot water temperature of your RELIANT faucets, all you need to do is adjust the setting on the HOT LIMIT SAFETY STOP.

- Remove HANDLE, CAP and HOT LIMIT STOP. Follow "A" or "B" to adjust maximum discharge temperature.

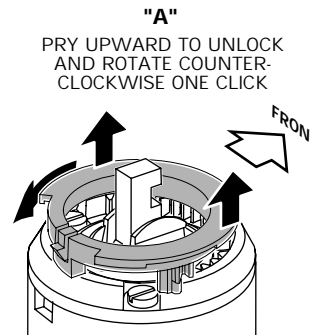

ADJUSTMENT WHEN  
WATER IS TOO HOT

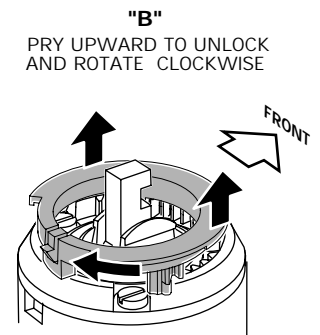

ADJUSTMENT WHEN  
WATER IS TOO COLD

## 6

### SERVICE

- AERATOR may accumulate dirt causing distorted and reduced water flow. Remove AERATOR. Clean AERATOR and FLOW RESTRICTOR. Replace AERATOR.
- If faucet drips, operate handle several times from "off" to "on". Do not apply excessive force.
- Clogged CARTRIDGE inlets may cause reduced flow in "full on" hot or cold. To clean inlets, first turn off water supply, then:
  - Remove HANDLE, CAP, HOT LIMIT STOP and CARTRIDGE. Clean inlets and MANIFOLD.
  - Reassemble CARTRIDGE, alternately tightening screws. Replace HOT LIMIT STOP, CAP and HANDLE. Check flow.

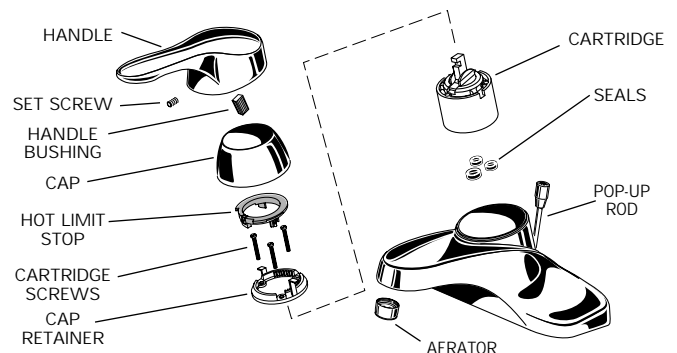

#### HOTLINE FOR HELP

For toll-free information and answers to your questions, call:

1 (800) 223-0068

Weekdays 8:00 a.m. to 4:00 p.m. Eastern Time

Product names listed herein are trademarks of American Standard Inc.  
©American Standard Inc. 1993

78523C