

## LABORATORY VALVES

Thank you for selecting American-Standard...the benchmark of fine quality for over 100 years. To ensure that your installation proceeds smoothly—please read these instructions carefully before you begin.



**7270.001**  
(Water Valve)



**7270.500**  
(Air, Gas or Vacuum Valve)



**7270.551**  
(Air, Gas or Vacuum Valve)



**7270.501**  
(Air or Gas Valve with Integral Check)

M968483

## ROUGHING-IN DIMENSIONS

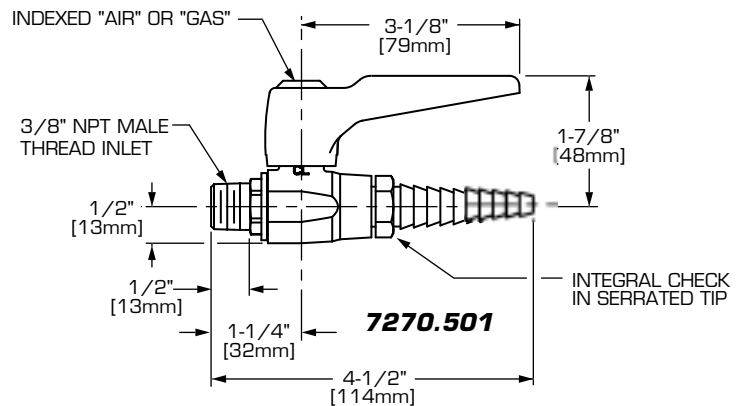
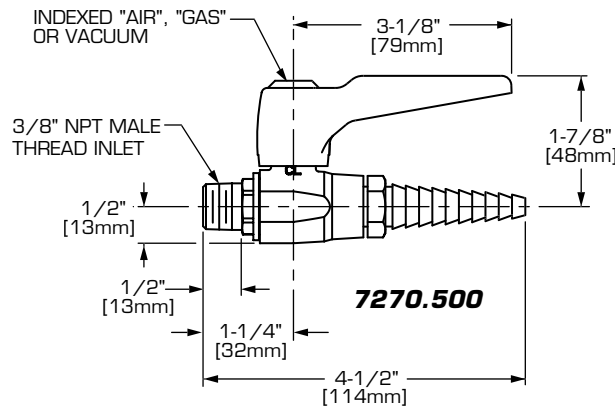
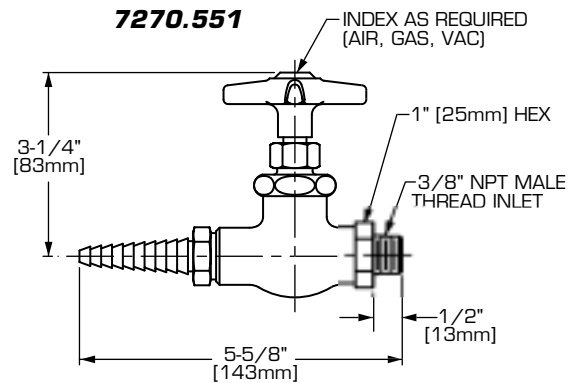
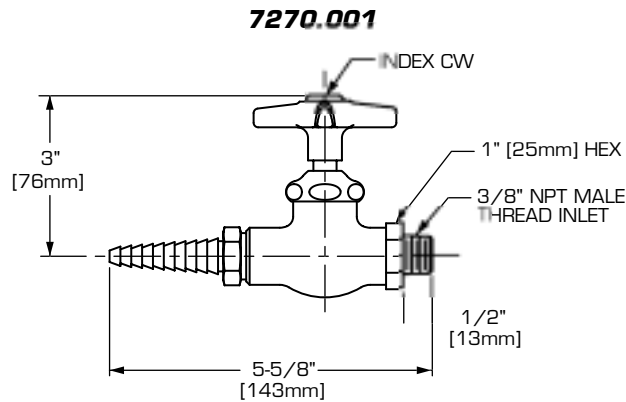

## TOOLS AND SUPPLIES REQUIRED

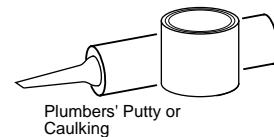
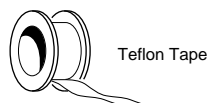
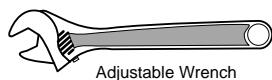

# 1 INSTALL VALVE

**IMPORTANT: FLUSH ALL SUPPLY LINES PRIOR TO FITTING INSTALLATION.**

- Use appropriate sealant on **valve** threads. Thread **valve** into turret or other piping connection.
- install the appropriate **index button** into **handle** counter bore.

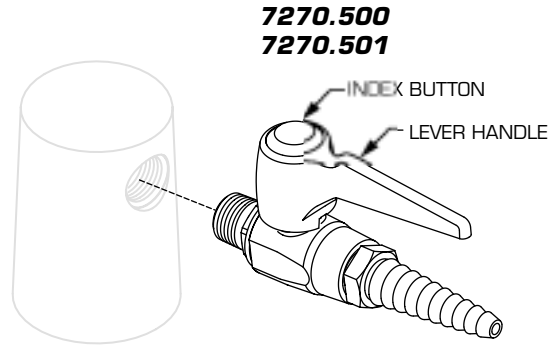
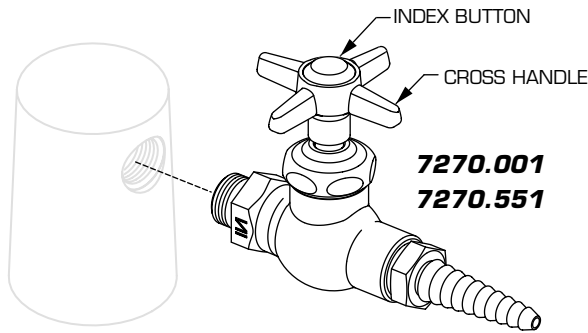

## CARE INSTRUCTIONS:

**DO: SIMPLY RINSE THE PRODUCT CLEAN WITH CLEAR WATER. DRY WITH A SOFT COTTON FLANNEL CLOTH.**

**DO NOT: CLEAN THE PRODUCT WITH SOAPS, ACID, POLISH, ABRASIVES, HARSH CLEANERS, OR A CLOTH WITH A COARSE SURFACE.**

## American Standard AVAILABLE REPAIR PARTS

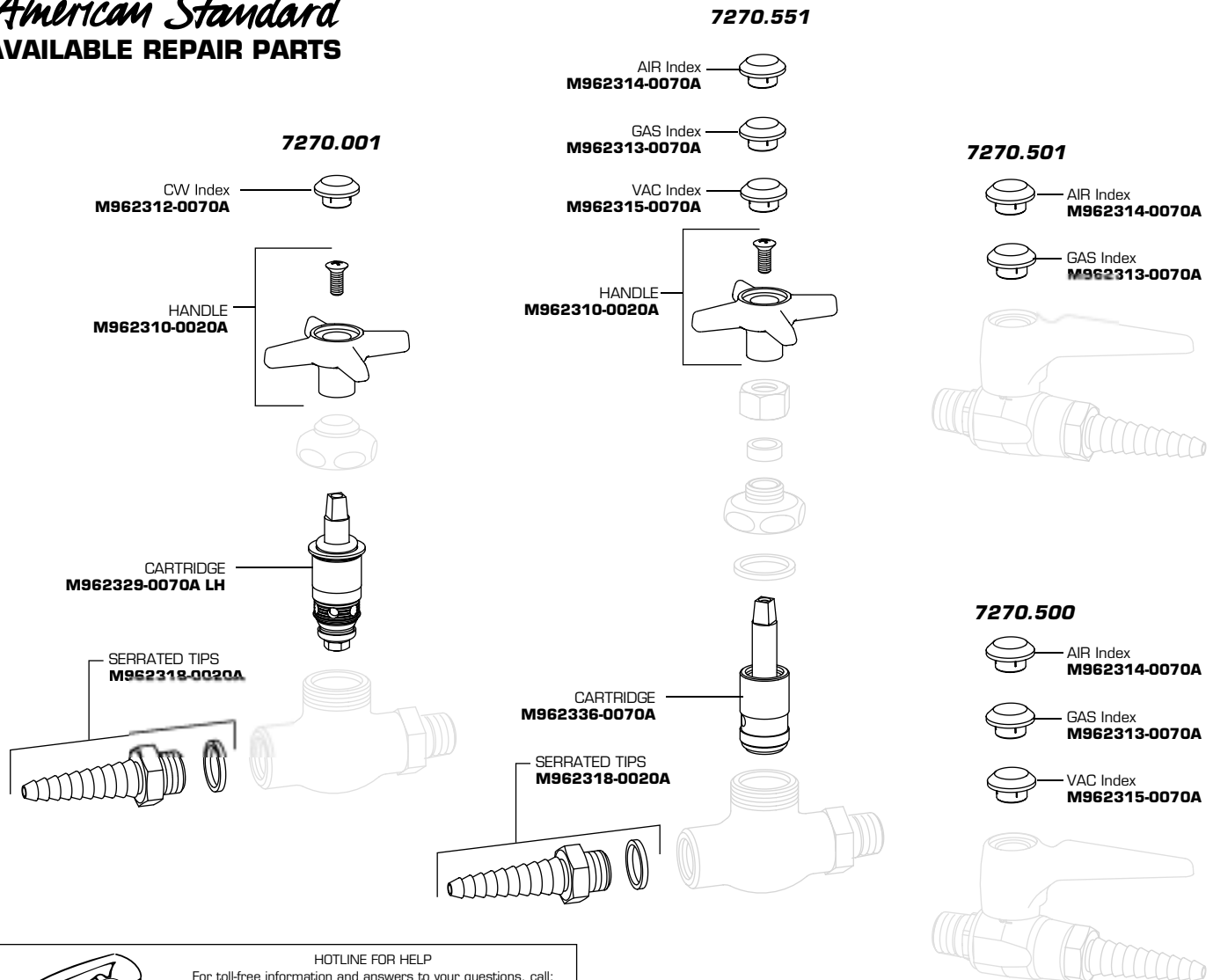

**HOTLINE FOR HELP**  
For toll-free information and answers to your questions, call:  
1 (800) 442-1902

Weekdays  
8:00 to 7:00 p.m. Eastern Time

CANADA  
1-800-387-0369 (TORONTO 1-905-306-1093)

Product names listed herein are trademarks of American Standard Inc. © American Standard Inc. 2004

M968483