

American Standard

ClearTap™

Water Filtering
System



Owner's Manual

**Models 4665.000.XXX and 4665.003.XXX
(Colors .002, .020, .021, .285 and .295);**

**4665, 4665-3, 4665X and 4665-3X
(Colors B, W, V, S)**

Foreign and Domestic Patents pending

ClearTap® Water Filtering System
ClearTap® Filters

SMARTELECTRONICS™

The Employees of American Standard would like to thank you for purchasing our product. The revolutionary ClearTap™ Water Filtering System will provide you with great tasting, clean water. To get the most enjoyment from your American Standard ClearTap™ Water Filtering System, please read all installation and operating instructions carefully. With simple care and maintenance, the ClearTap™ Water Filtering System will provide many years of reliable performance. If you should have any questions or comments, please call us toll-free in the U.S. at 1-800-223-0068.

TABLE OF CONTENTS

Water Filtration Summary.....	2
Installation Instructions.....	4
Operating Instructions.....	12
Filter Replacement.....	13
Care and Maintenance.....	14
Repair Parts	15
Warranty.....	16

ClearTap® Water Filtering System
ClearTap® Filters
SMARTELECTRONICS™

WATER FILTRATION SUMMARY

Your American Standard ClearTap™ Water Filtering System is a fast and effective appliance designed to reduce and/or remove contaminants which may be found in drinking water. This filter faucet system has been certified by NSF, an Independent Standard Setting Organization, to comply with the nationally recognized standards for Water Filtration (NSF 42 and 53) and the Safe Drinking Water Act (Faucet Drinking Water Additives/Health Effects NSF 61). The ClearTap™ Water Filtering System has been designed to the ANSI ASME A112.18.1 and CSA B125 Plumbing Standards. Installation must comply with State and Local plumbing codes and regulations.

ClearTap™ Water Filtering System includes
the Patented American Standard
ClearTap™ Filter Cartridge



System Tested and Certified by NSF International against ANSI/NSF Standard 42 for the reduction of Chlorine, Class I, Taste and Odor, Particulate, Class I, and against ANSI/NSF Standard 53 for the reduction of Turbidity, Lead and Cysts.

Do not use with water that is microbiologically unsafe or of unknown quality without adequate disinfection before or after the system.

System Certified for Cyst Reduction and may be used on disinfected waters that may contain filterable cysts.

"Important Notice; Read the Manufacture's Performance Data Sheet"

- ClearTap™ Filter Cartridges are designed for replacement after dispensing 250 gallons of filtered water or approximately 3 months of normal household usage. Water conditions may affect filter life.
- The SmartElectronic™ indicator will identify when filter replacement is necessary. The SmartElectronic™ monitors your family's filter water usage and communicates the filter replacement in "Days of Life" remaining before the filter needs to be changed. This patented feature is unique in the market place.

- Use only ClearTap™ Filter Cartridges with the ClearTap™ Water Filtering System.
- The ClearTap™ Water Filtering System flow rate is 0.60 - 0.75 gpm for supply pressures from 20 psi to 125 psi.
- Maximum water temperature in filtered mode 100° F. Minimum operating temperature 35° F.

Filter Water Temperature

Please follow the installation instructions to ensure the proper supply water line hookup. Once connected properly, the ClearTap™ Water Filtering System has a built-in patented design feature that does not allow hot water to circulate through the filter. Hot water exposure can decrease filtered water quality.

***Clear Tap™* Filter Cartridge Flushing**

Allow water to flow through a new filter to flush the system. Unlike some other point of use carbon filter systems, the ClearTap™ Filter cartridge will not shed black particles. If the ClearTap™ Water Filtering System has not been used for an extended period of time, allow fresh water to purge the system for 1 minute before utilizing the filtered water.

Questions?

If you have any questions, please call our toll-free help line:

- In the USA: 1-800-223-0068, Monday through Friday 8:00 a.m. to 7:00 p.m. EST,
- In Canada: 1-800-387-0369 (Toronto area only: 1-905-306-1093),
- In Mexico: 1-800-839-1200.

ClearTap™ Water Filtering System Installation

Recommended tools:

Adjustable wrenches (2)

5/16" or 8 mm hex socket/ratchet or nut driver

Flat blade screw driver

To install your new faucet in a simple and easy manner, read the following instructions before beginning installation.

1

CAUTION

Turn off hot and cold water supplies before beginning.

- Remove old faucet. Thoroughly clean and dry the mounting surface.
- Install the three (1") long (1) and one (1/2") long (2) Slotted Hex Head Screws into the Faucet Mounting Ring (7).

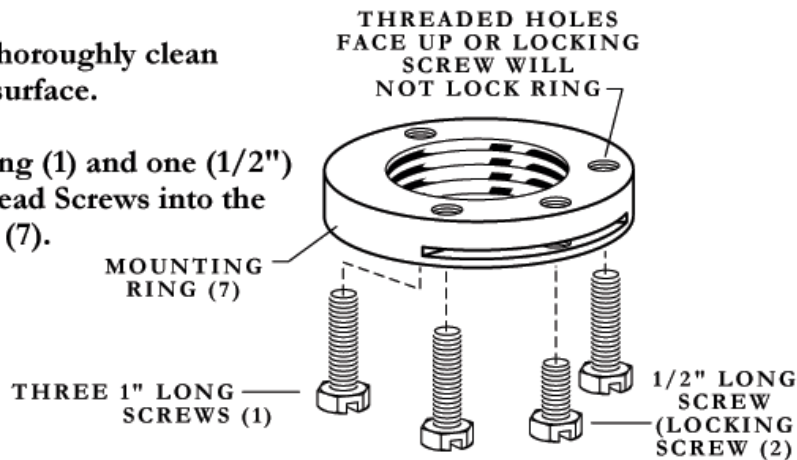

2

SPRAY HOLDER INSTALLATION

- If Side Spray is not desired, use Pipe Cap (3) to seal the faucet spray outlet.
- Place the Side Spray Holder (4) into the appropriate mounting hole. Assemble the Spray Holder Nut (5) onto the shank of the spray holder from below and tighten. Caution do not use putty.

Note: Perform the following steps before installing the faucet.

- Push Spray Hose (6) into Spray Holder. Push the end of Spray Hose through the Faucet Mounting Ring (7), Brass Washer (8) and Rubber Washer (9). Push the end of the Spray Hose up through the desired sink hole and Escutcheon (if used), see detail in step 3 for proper orientation.
- Make certain the large O-ring (10) is properly seated in the recess in the faucet body (11). Attach and tighten Spray Hose (6) to the faucet.

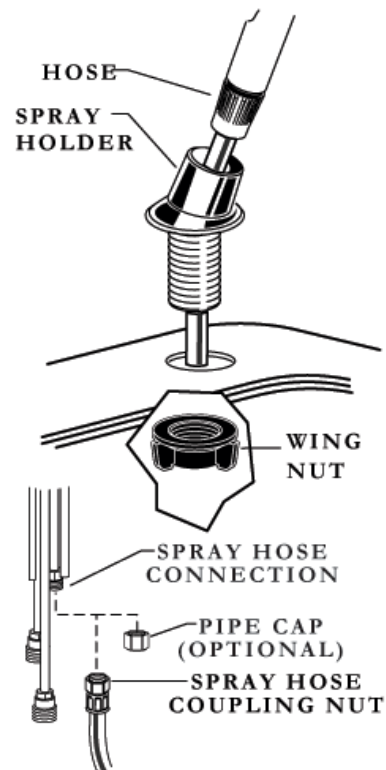

3

INSTALL ClearTap® FAUCET TO SINK

✚ Insert Supply Tubes and faucet shank through hole in sink and center hole of Escutcheon (12), if used. Use Single Hole Faucet Mounting Ring (13) for less escutcheon installations (optional installation).

✚ Assemble Rubber Washer (9), Brass Washer (8), and threaded faucet Mounting Ring (7) onto the faucet shank from the underside of the sink. Screw faucet mounting ring hand tight against sink and check that the spout rotation from left to right is centered.

✚ Using a 5/16" or 8mm socket wrench, nut driver, or flat blade screw driver work around the faucet Mounting Ring, tightening the three long Screws (1) slightly each time until tight. Insure that the Screws make even contact pressure against the brass washer on the undersurface of the sink.

✚ Securely tighten the fourth Locking Screw (2) to hold threaded Mounting Ring in position on the faucet shank.

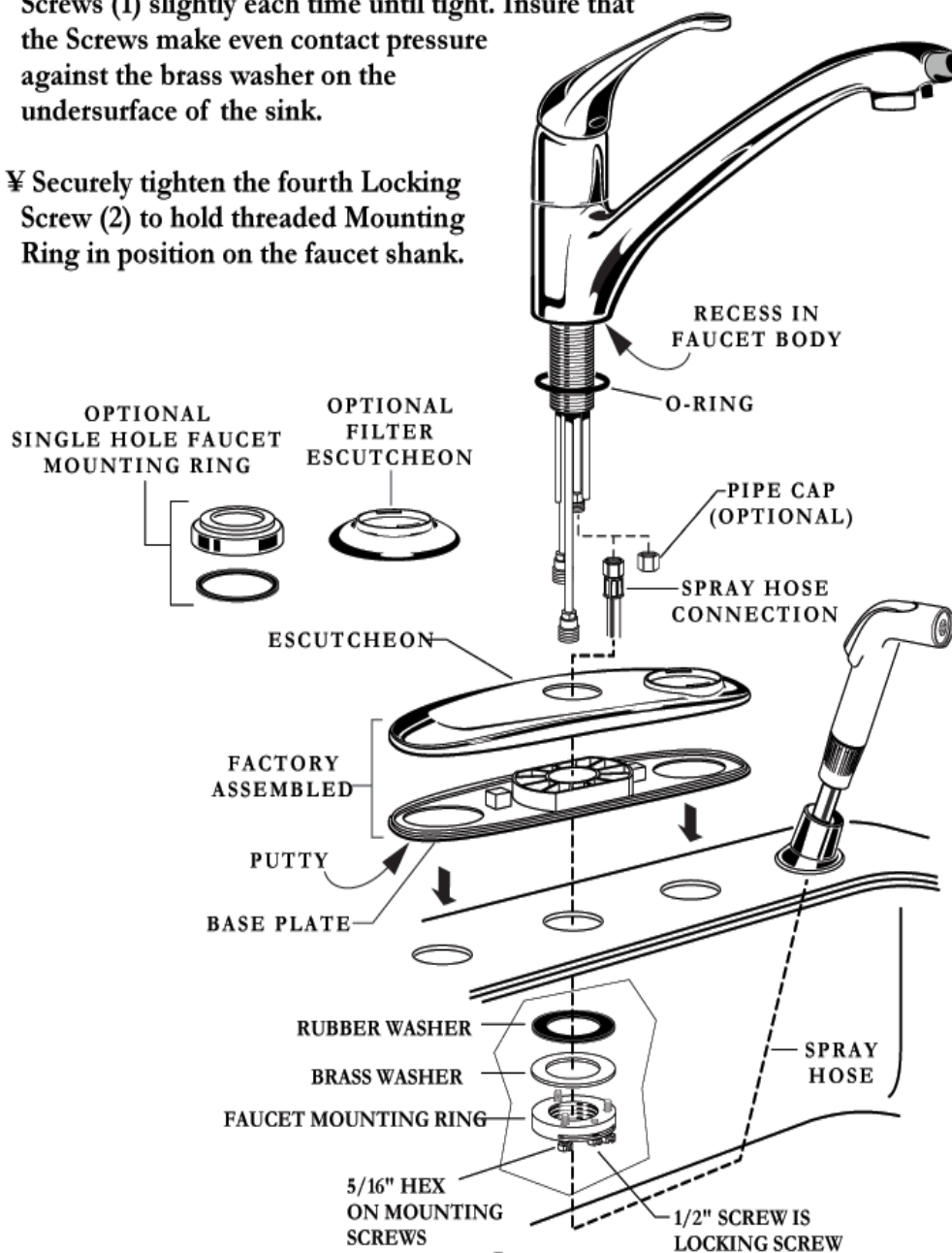

4

CONNECT INLET WATER SUPPLIES

- ¥ Carefully bend the faucet copper inlet supplies to meet the water supply lines. Use the palms of the hands to avoid kinking.
- ¥ Connect hot water to the shorter supply tube (red tape) and cold supply to the longer tube. Hold the threaded fitting with a wrench to prevent twisting and collapse of the tube while tightening with the other wrench.

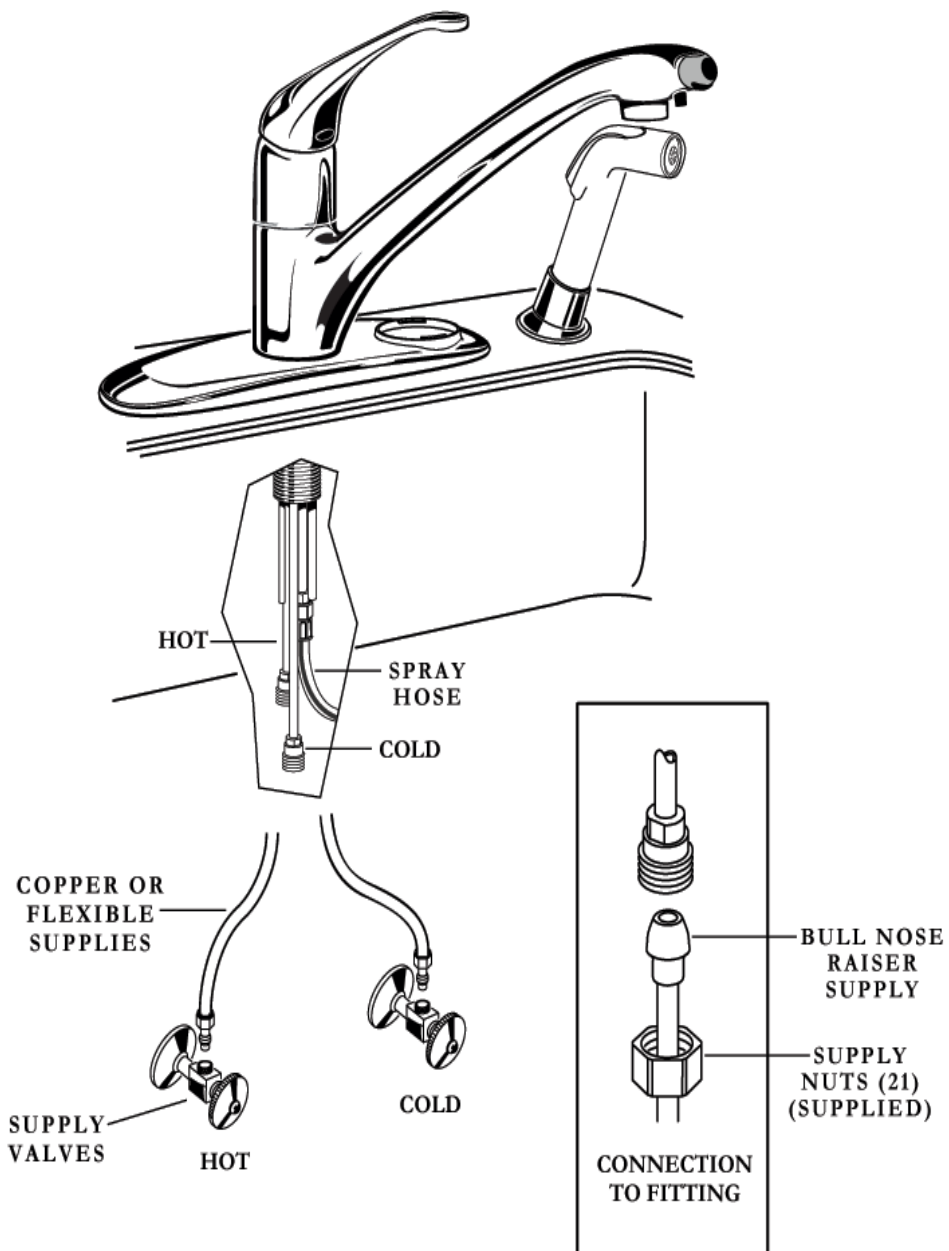

5

ClearTap® Filter HOUSING INSTALLATION

✂ Remove the Collet Assembly (14) from the Filter Housing (15) by grasping the Collet Assembly and firmly pull it down the housing.

✂ Insert the Filter Housing into the faucet Escutcheon filter hole.

Note: For faucet installations not utilizing the Escutcheon (12), use separate Filter Housing Escutcheon (16).

✂ Insert filter hoses through Collet Assembly. **Note:** make sure the Collet Assembly is correctly oriented, check for the "up" arrows on the Collet Assembly.

✂ Push the Collet assembly onto Filter Housing. Make sure the Collet Assembly is moved above the "Bump" on the Filter Housing, see picture.

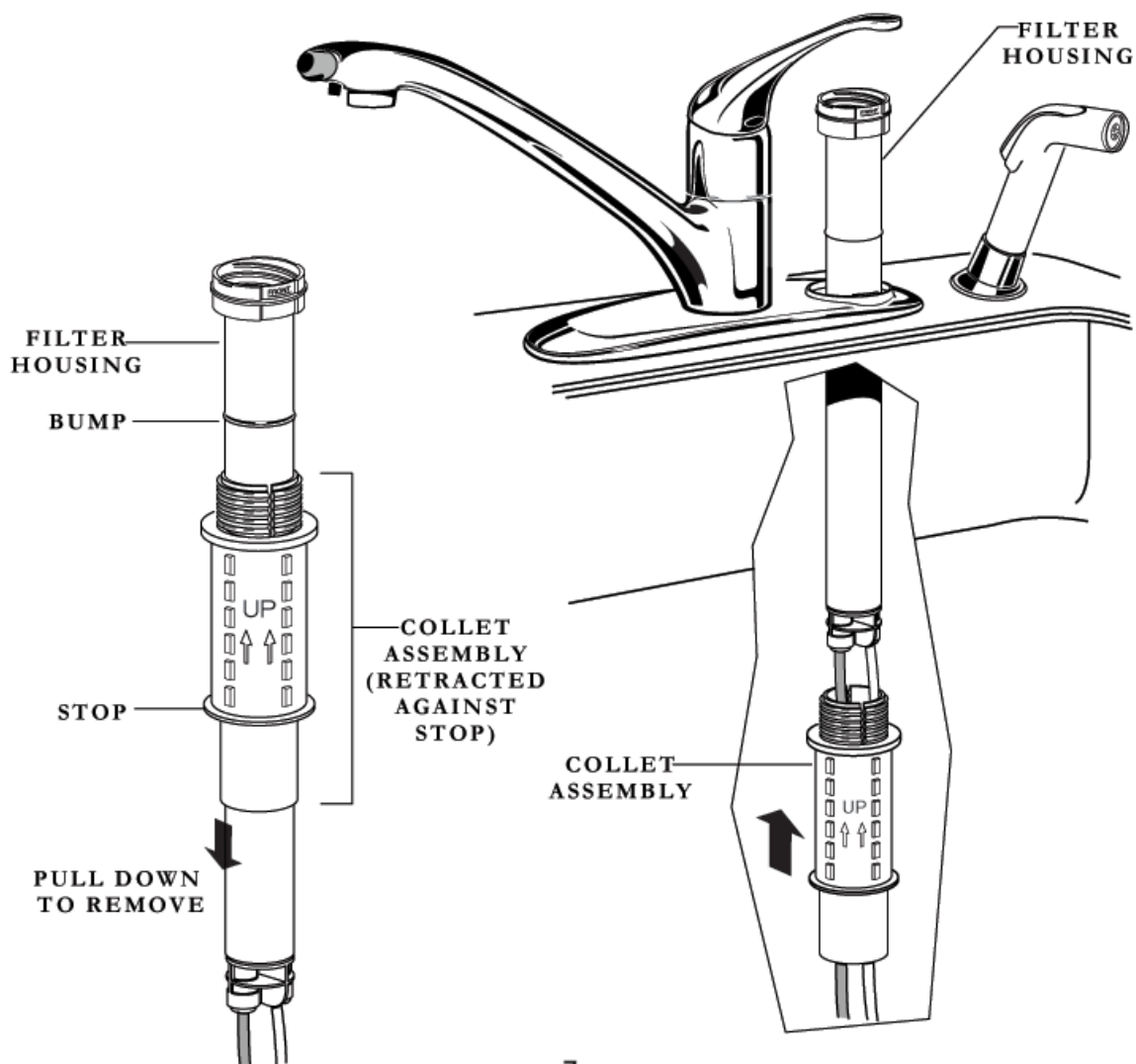

ClearTap[®] Filter HOUSING INSTALLATION (CONTINUED)

✂ Orient the Filter Housing ("front" is identified) and secure by holding the lower portion of the Collet assembly while turning the upper half of the Collet assembly with the other hand.

✂ Securely hand-tighten the Filter Housing. Tools are not required.

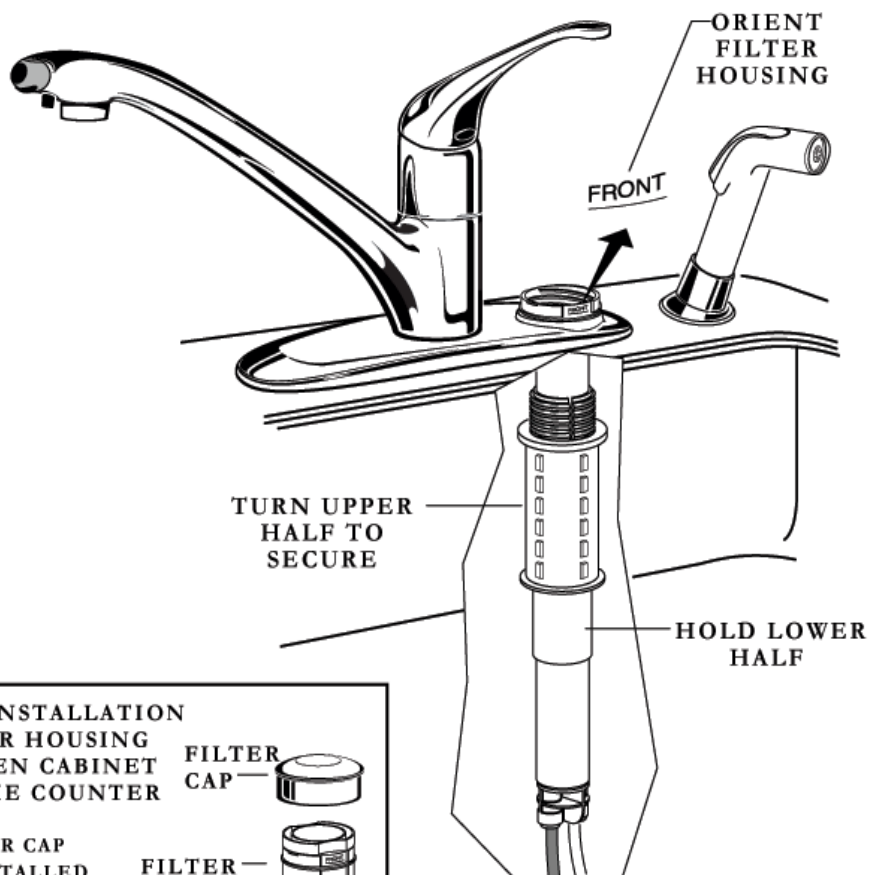

OPTIONAL INSTALLATION OF FILTER HOUSING IN KITCHEN CABINET BELOW THE COUNTER

NOTE; FILTER CAP MUST BE INSTALLED IN ALL MOUNTING APPLICATIONS.

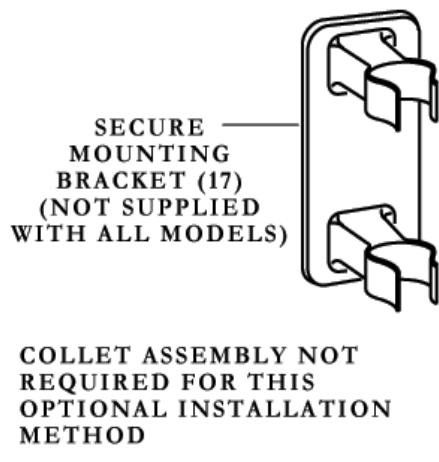

6

ATTACH FILTER LINES

¥ Attach the two Quick Connect Unions (18) to the filter water inlet and outlet copper tubes of the faucet.

¥ Note: The copper tubes are different diameters. The BLUE hose connects to the LARGER diameter copper tube and the CLEAR hose connects to the SMALLER diameter copper tube.

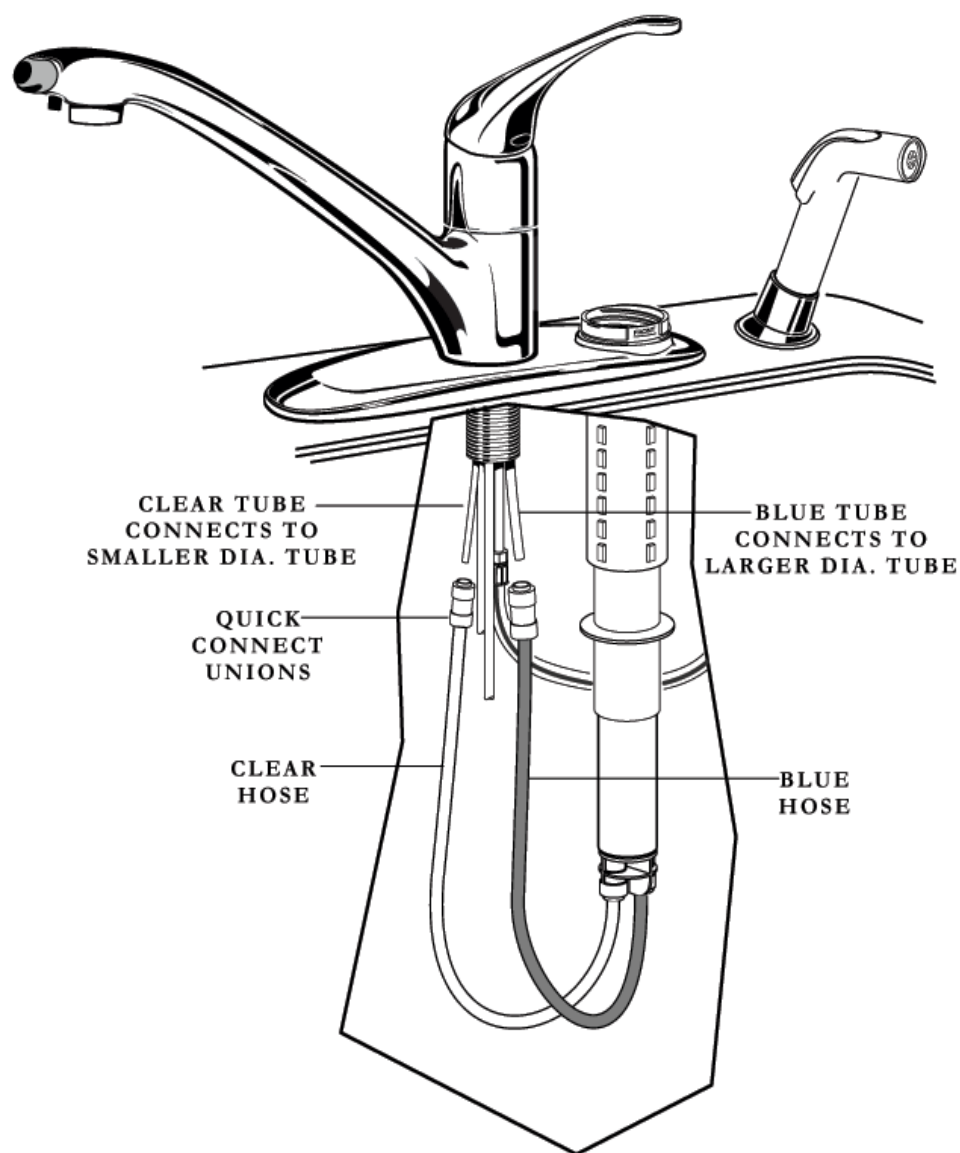

7

FILTER INSTALLATION

¥ Insert the ClearTap™ Filter (19) into the top of the Filter Housing (15).

¥ Turn the Filter clockwise to engage the threads and continue to turn until the notch on the filter faces forward and is aligned with notch in the Filter Housing thread ring.

¥ Push the Filter Cap (20) onto the Filter Housing (15) until the Filter Cap snaps onto the Filter Housing thread ring.

Caution: The filter cap will not snap into place unless the filter cartridge is installed properly.

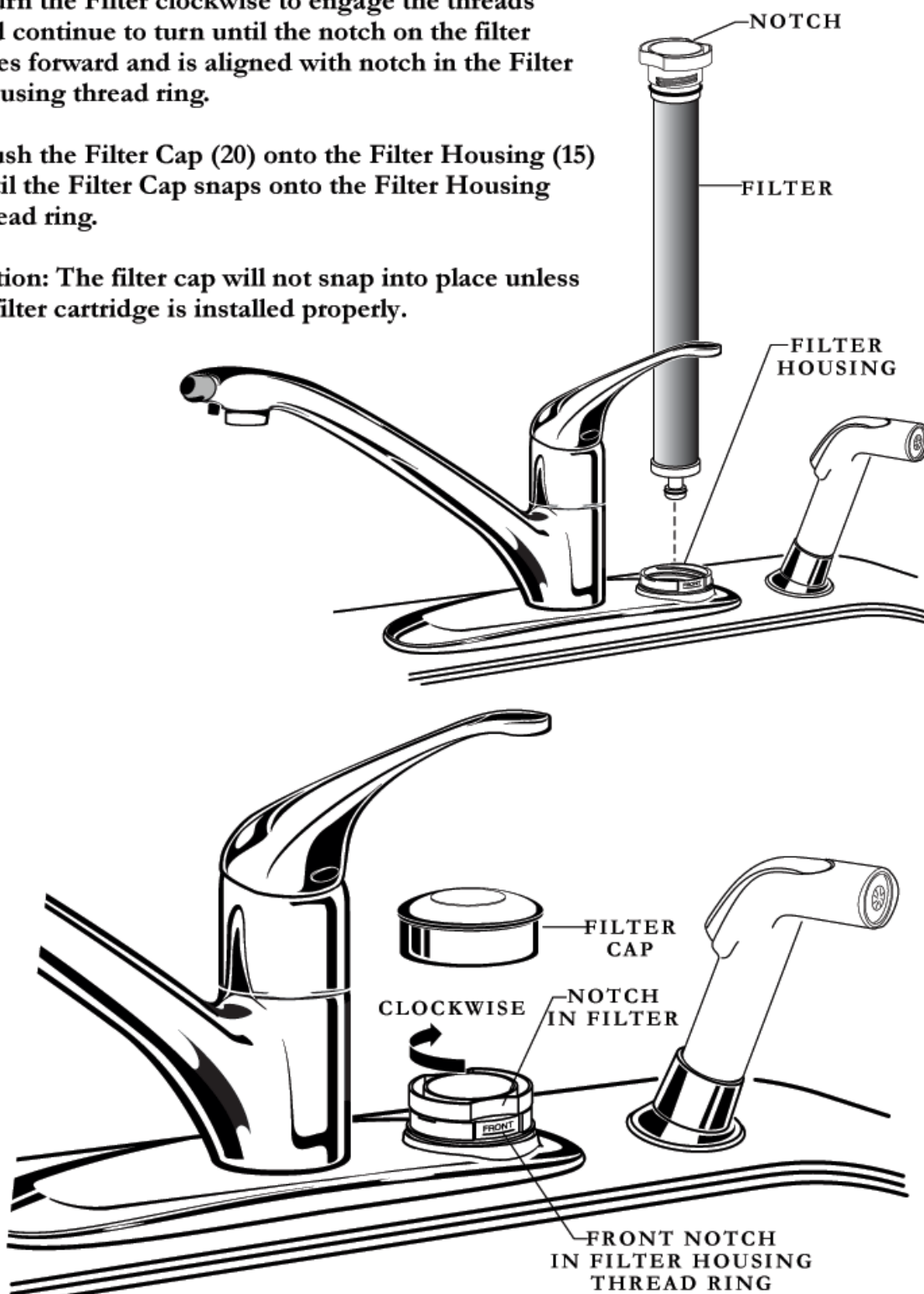

- ¥ Move handle into "OFF" position and remove Aerator (22).
- ¥ Turn on water supplies and check connections for leaks.
- ¥ Operate handle up and down, left and right to flush water lines thoroughly.
- ¥ Put the Faucet Handle in filter water position (handle in the off, far right position). There will be a small resistance as the handle is moved into the filter position.
- ¥ Flush the system.
- ¥ Continue to allow filtered water to flow. Reset the **SMARTELECTRONICS** end of Filter Life Indicator (23). Using the edge of a coin or your thumbnail, depress the battery case and reset the indicator, see the illustration (pg. 14) for details. The display will read 88 days of life and will calibrate itself, showing "90 Days of Filter Life" remaining with the next activation.
- ¥ Replace the aerator.

The ClearTap™ Water Filtering System installation is now complete. Please read carefully the operation instructions to ensure optimal performance.

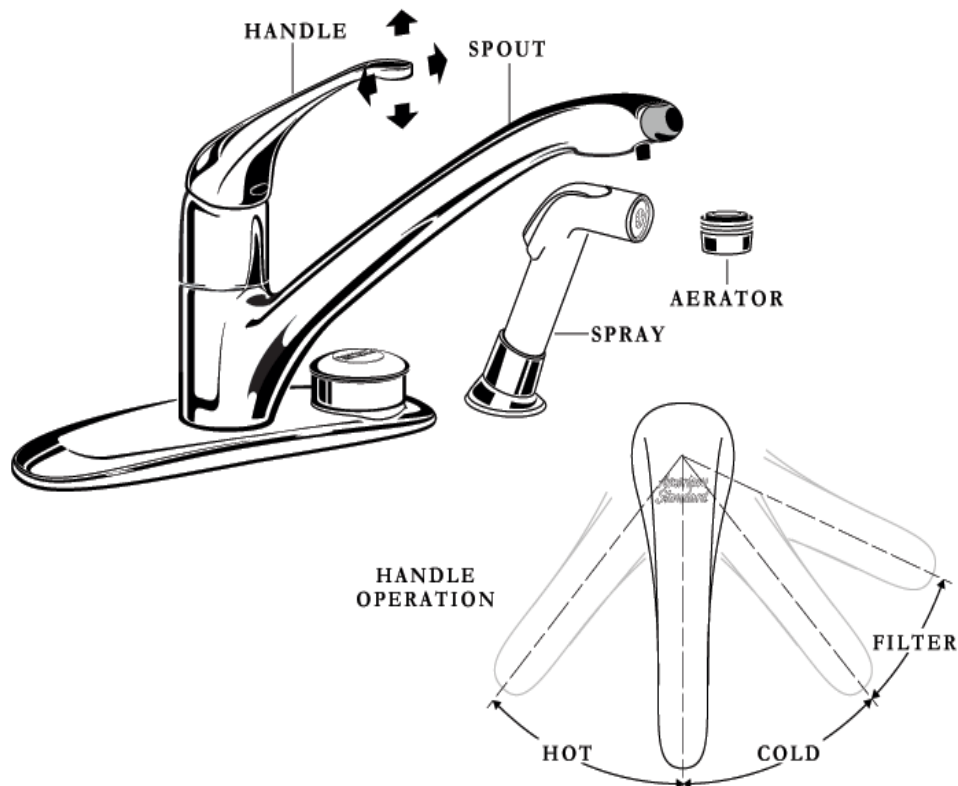

ClearTap[®] Water Filtering System

Operating Faucet Instructions

Water Delivery

The ClearTap[™] Water Filtering System provides four options for water delivery:

Unfiltered cold, mixed or hot water
and
Filtered cold water

Unfiltered water is delivered from the normal faucet Aerator (22).
Filtered water is delivered from the Filter Water Nozzle (24), which is positioned in front of Aerator (22).

Note: Water from the spray hose is not filtered.

¥ HOT, UNFILTERED MODE:

Move the handle up and to the left.

¥ MIXED, UNFILTERED WATER:

Move the handle up into the center position.

¥ COLD, UNFILTERED WATER:

Move the handle up and to the right.

¥ COLD, FILTERED WATER:

With the Faucet handle in the closed position move the faucet handle to the right. Push the Faucet Handle past the resistance and filtered water will begin to flow from the Filter Water Nozzle.

SMART ELECTRONICS Filter End of Life Indicator

- ¥ The ClearTap™ Water Filter System comes with an Electronic End of Filter Life Indicator, which is located at the end of the spout. It indicates the amount of time (in days) before the filter has to be changed.
- ¥ The display is only illuminated when filtered water is being drawn from the faucet. In all other times, the display is blank.
- ¥ When the display reads "CF", this indicates "Change Filter"; it is time to replace the filter. See filter replacement section for the "How to replace the old filter and install the new filter" details.

Note: Always reset the electronic end of filter life indicator when changing filters.

ClearTap™ Filter Cartridge Replacement

The ClearTap™ Filters F20 (19) can be purchased at your local retail or wholesale American Standard distributor or www.americanstandard-us.com.

The ClearTap™ Filter Cartridge should be left in protective film until ready for installation. The ClearTap™ Filter Cartridge is a high performance carbon based filter developed specially by American Standard for the ClearTap™ Water Filtering System. The electronic module keeps track of the amount of filter life remaining and will signal you when the filter change is necessary by displaying the letters "CF".

Note: Use only ClearTap™ Filter Cartridges with the ClearTap™ Water Filtering Systems.

How To Replace the OLD Filter with a NEW Filter

- ¥ Remove the Filter Cap (20) by lifting straight up.
- ¥ Turn the Filter (19) counter clockwise until the filter pops out of the Filter Housing (15). Discard the old filter.
- ¥ Remove the protective wrapping from the replacement filter cartridge.
- ¥ Insert the filter into the top of the filter housing.
- ¥ Turn the filter clockwise to engage the threads and continue to turn until the notch on the filter faces forward and is aligned with notch in the Filter Housing thread ring.
- ¥ Push the Filter Cap onto the Filter Housing until the Filter Cap snaps onto the Filter Housing thread ring.
Caution: The filter cap will not snap into place unless the filter cartridge is installed properly.
- ¥ Turn the faucet handle to the filtered water position and allow filtered water to flow. Using the edge of a coin or your thumbnail, depress the battery case and reset the indicator, see the illustration for details (pg. 14). The display will read 88 days of life and will calibrate itself, showing 90 Days of Filter Life remaining with the next activation.
- ¥ Allow cold water to run through the new filter to flush the system for 5 minute.

Care and Maintenance

Battery Replacement

A 3V-lithium watch battery (CR1220) powers the electronic indicator. Battery replacement is required when the **SMARTELECTRONICS™** displays the letters "CB".

To Replace the Battery

- ✧ Turn the faucet off.
- ✧ Gently pull the Battery Holder (25) from the End of Life Indicator (23) Housing (located underneath the front of the faucet spout).
- ✧ Insert a new Battery (26) into the rubber Battery Holder (25). Note the polarity of the battery and the orientation of the Battery Holder, see the detail insert.
- ✧ Push battery and Holder back into faucet securely.
- ✧ Turn on the filter water flow to check battery operation. The display will read 88 days of life and will calibrate itself, showing 90 Days of Filter Life remaining with the next activation.

Care

All that is needed to clean the ClearTap™ Water Filtering System is a soft damp cloth. American Standard does not recommend the use of scouring pads, abrasive cleaners or chemicals. The surface of the faucet and its components could be permanently damaged. A non-abrasive auto polish can be used to help restore and protect the finish.

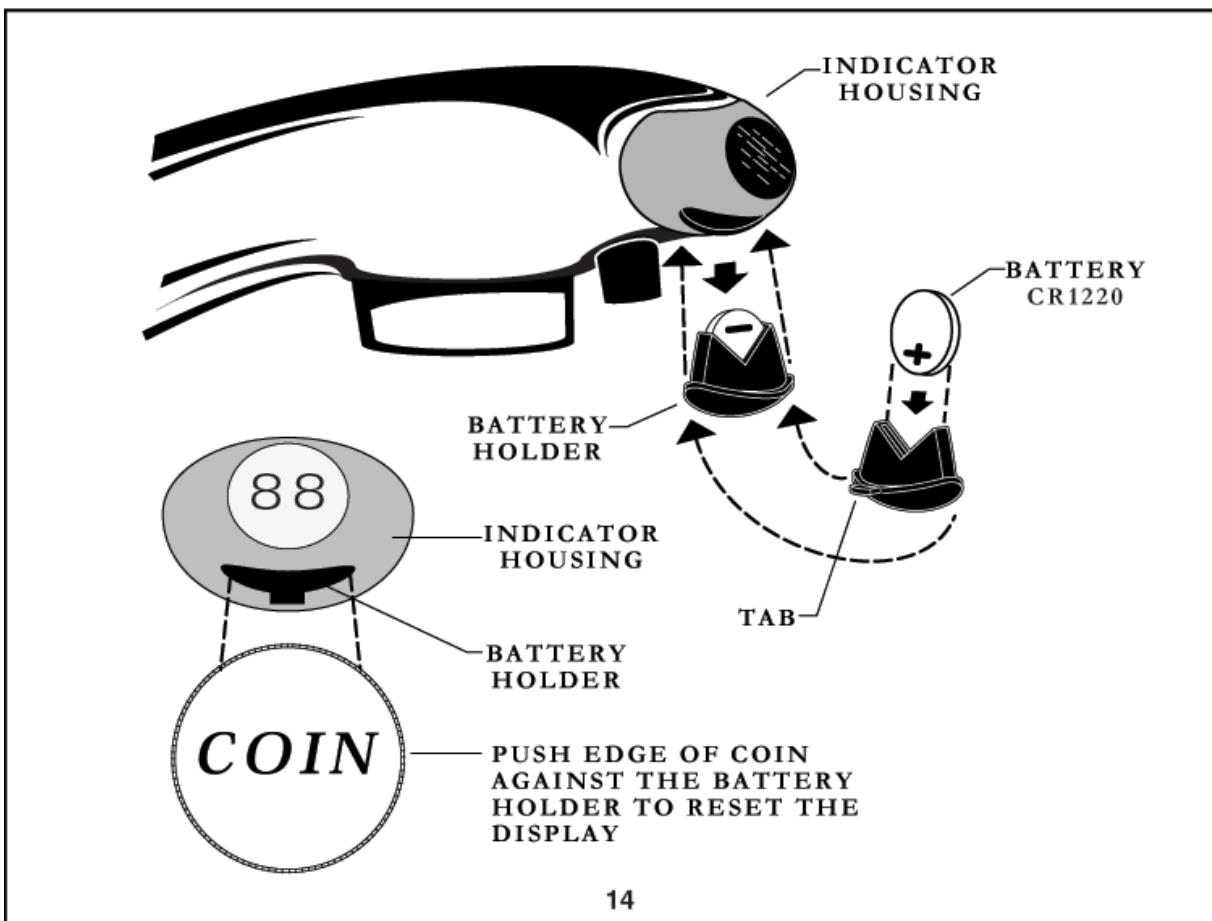

REPAIR PARTS BREAKDOWN

MODEL NUMBERS

**4665.000.XXX 4665.003.XXX
4665 4665W 4665B
4665V 4665S 4665-3**

M907760-YYY0A
Filter Cap

M953895-0070A
ClearTap Filter (F-20)

M961769-0070A
Filter Housing

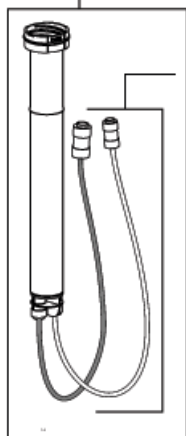

M961790-0070A
Hose Kit W/Quick Connect Unions

A954427-0070A
Collet Assembly

M961770-0070A
Mounting Bracket

A918585-0070A
Cartridge Screws

A954410-0070A
Cartridge and Seals

042850-0070A
Diverter

060366-0070A
Spout Seal Kit

A912647-0070A
Gasket

024220-0070A
Supply Nuts

M961760-YYY0A
Handle Kit

M961761-0070A
Button and Screw Kit

030243-YYY0A
Cap and Retainer

M961772-0070A
Filter Clutch

061810-YYY0A
Spray Holder (3 Hole)

M961762-0070A
Cartridge Mtg. Disk and Screws

A923583-0070A
Seal Ring

A904664-0070A
Manifold

A954589-0070A
End of Life Indicator

A923588-0070A
Nozzle

M961764-0070A
Battery with Holder

066070-YYY0AA
Aerator

M961763-YYY0A
Spout

060341-0070A
Pipe Cap

M961766-YYY0A
Escutcheon Kit



M961767-YYY0A
Escutcheon Kit W/ Spray Hole

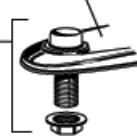

M961768-YYY0A
Single Hole Mounting Escutcheon



Replace the "YYY" with appropriate finish code

CHROME	002
WHITE	020
BONE	021
SATIN	295

M961765-0070A
Mounting Ring Kit



M907765-YYY0A
Filter Housing Escutcheon



□□□ ClearTap™ Water Filtering System

□□ Limited Lifetime Warranty

Definitions

"Faucet" □ That part of the ClearTap™ Water Filtering System that includes the handle, spout, valve cartridge, cartridge cover, waterways, filter housing, filter cap, escutcheons, spray head, hoses and mounting hardware.

"End of Life Indicator" □ That part of the ClearTap™ Water Filtering System that includes the electronic display, housing, electronic components, battery, and battery holder.

"Filter" □ That part of the ClearTap™ Filtering Faucet System that is to be replaced once 250 gallons of water has run through the system.

Warranty

American Standard warrants to the original consumer purchaser that for as long as the original consumer purchaser occupies the location of original product installation (the "Warranty Period") that the Faucet (see definition for Faucet above) will be leak-free during normal use and all parts and finishes of the Faucet will be free from defects in material and workmanship during the applicable warranty period.

Original commercial, industrial or business installations shall have a five (5) year warranty on the faucet.

All parts and finishes of the End of Life Indicator, carry a one (1) year warranty.

The Filter carries a thirty (30) day warranty.

American Standard will provide free of charge, at its sole option, replacement part(s) or product (or if no longer available, a comparable product) to replace those which have proven defective in materials or workmanship.

Proof of purchase (original sales receipt) from the original consumer or business purchaser must be made available to American Standard for all warranty claims. This warranty is non-transferable. It does not apply in the event of product damage due to the use of other than genuine American Standard replacement parts, installation error, abuse, misuse, or improper care and maintenance (whether performed by a plumber, contractor, service provider or member of the purchaser's household). The warranty excludes damage due to aggressive air or water conditions or harsh or abrasive cleaners and/or materials. This warranty does not cover labor charges incurred and/or damage sustained in installation, repair or replacement, nor incidental or consequential damages. This warranty is applicable only to American Standard faucets installed in the United States, Canada or Mexico.

THIS WARRANTY IS EXCLUSIVELY IN LIEU OF ALL OTHER WARRANTIES, INCLUDING ANY IMPLIED WARRANTIES OF MERCHANTABILITY OR FITNESS FOR A PARTICULAR PURPOSE.

This warranty gives the original consumer or business purchaser of an American Standard faucet specific legal rights which may vary from state to state or from province to province. In some states or provinces the exclusion or limitation of incidental or consequential damages is not allowed, so those exclusions may not apply to you.

In the USA: □□□ In Canada: □ □□ In Mexico:

American Standard □ American Standard □ Ideal Standard S.A. de C.V.

Worldwide Fittings Group □□

Customer Satisfaction Team □

Customer Satisfaction Team

Customer Satisfaction Team □ 2480 Stanfield Rd. □□

Planta Llaves Monterrey

1 Centennial Ave. □□ Mississauga, Ontario □□□

Carretera Mex-Loredo KM 1011

Piscataway, NJ 08855 □□

L4Y1S2 □ Canada □□

Cienega de Flores, N.L. Mexico

1-800-223-0068 □□ 1-800-387-0369 □□ 1-800-839-1200

In Toronto Area only:

1-905-306-1093