

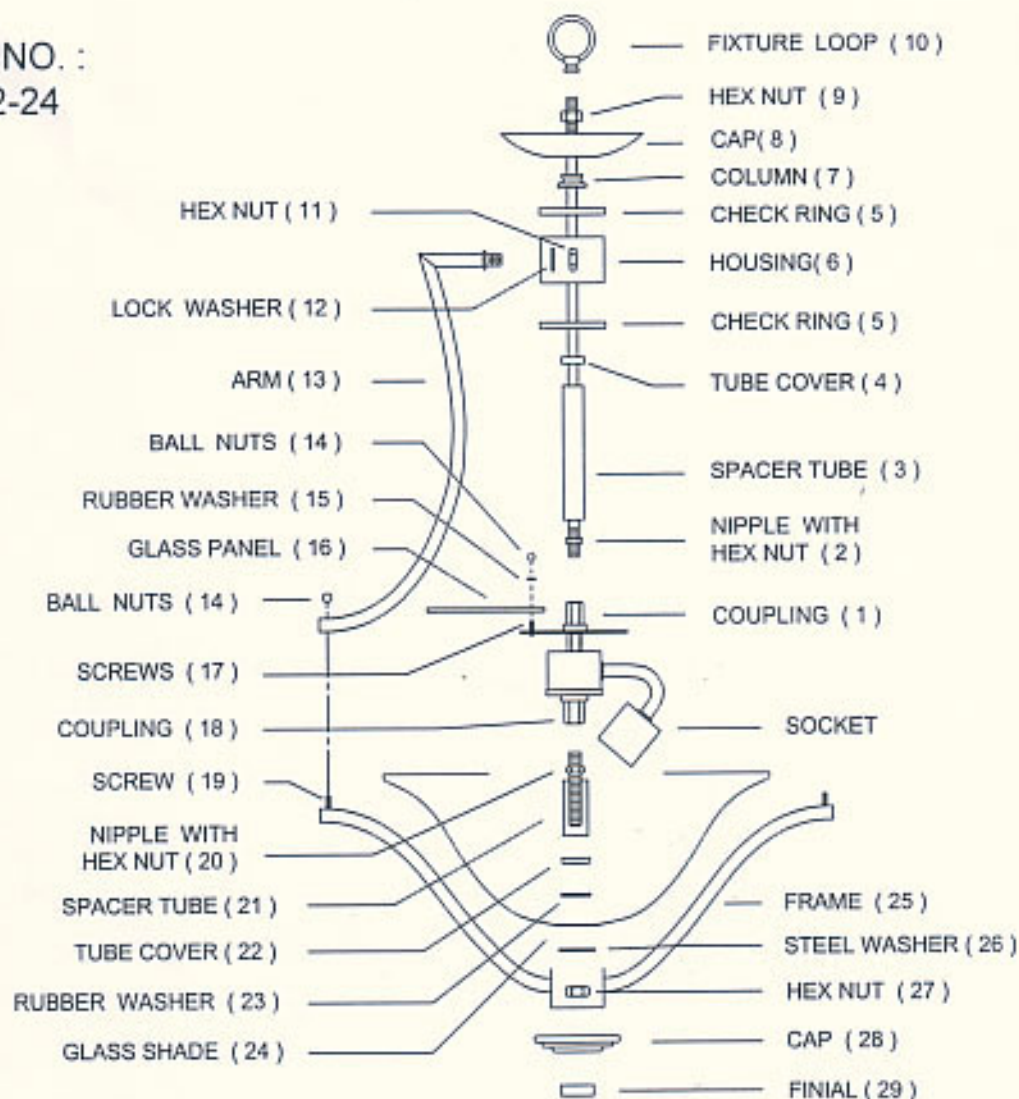

Assembly Instructions

ITEM NO. :
32782-24



1. Carefully remove the fixture out of the carton, and check that all parts are included referring to the above illustration. Make sure not to misplace any parts that are needed for the installation;
2. Thread the nipple (2) into the coupling (1) and secure it with hex nut.
3. Assemble the ARM (13) onto the housing (6) & lock washer (12), and lock it place by hex nut (11).
4. Slide the spacer tube (3), tube cover (4), check ring (5), housing (6), column (7), cap (8), onto the nipple (2), then secure them with hex nut (9).
5. Thread the fixture loop (10) onto the nipple (2) tightly.
6. Thread the nipple (20) into the coupling (18) and secure it with hex nut.
7. Slide the spacer tube (21), tube cover (22), rubber washer (23), glass shade (24), steel washer (26) onto the nipple (20), and secure them with hex nut (27).
8. Slide the frame (25) onto the nipple (20), and install the screws (19) into the hole on the ARM (13), then fix it by ball nuts (14).
9. Secure the cap (28) onto the nipple (20), then fix it by the finial (29).
10. Install proper bulb (not included).
11. Install the glass panel (16) rubber washer (15) onto the screws (17), then secure them with ball nuts (14).