

# Specification Decorative BowShield® 40828U

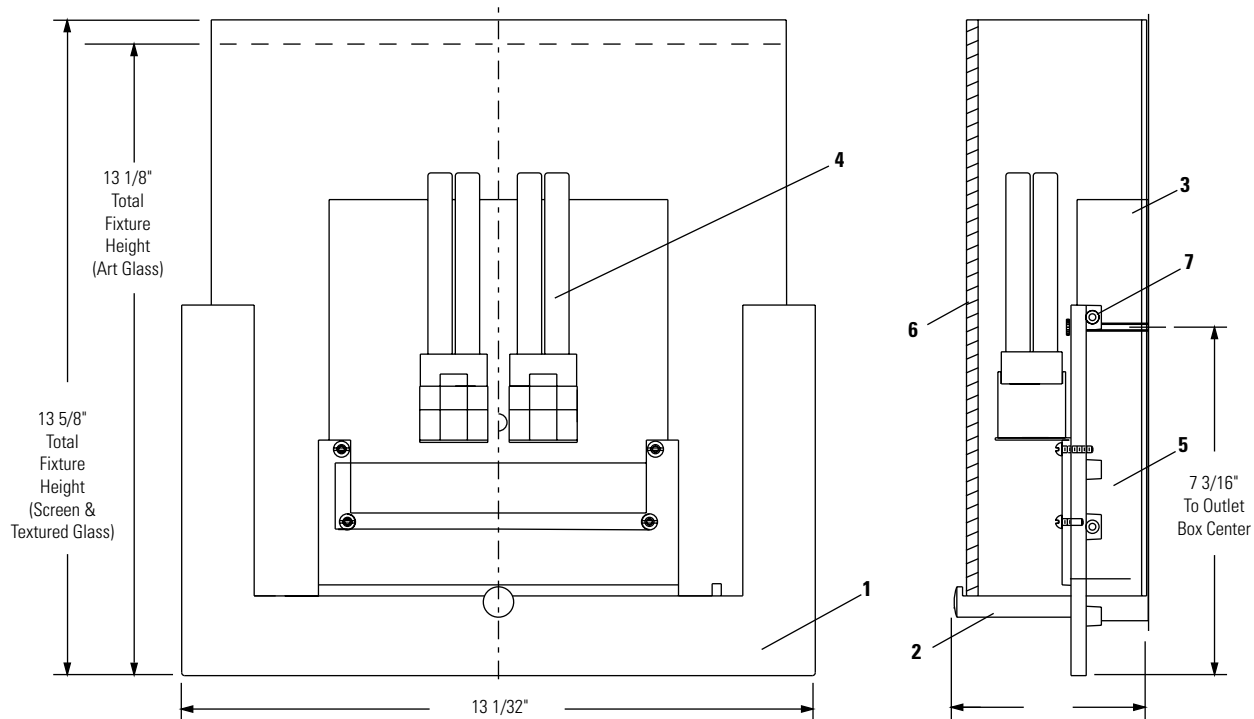

Page 1 of 2

Wall Mounted Compact Fluorescent ADA Compliant

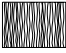

Complete Fixture consists of Lightshield and Backplate Assembly. Order each separately.

## Lightshield Ordering Information

Cat. No.	Pattern/Description/Color	Cat. No.	Pattern/Description/Color	Cat. No.	Pattern/Description/Color
40871	 Rolled "Rain" pattern texture, Silk-screened White/Clear	40865	 Three Dimensional "Squares" White/Clear Silk-screened Pattern	40862	 "Ceramic White" Silk-screened and Sandblasted

## Backplate Assembly Ordering Information

Cat. No.	Finish	Cat. No.	Finish	Lamps	Ballast Type	Input Wattage
40828H1	Satin Brass	40829H1	Satin Nickel	2x18W Quad	1-2 Lt. HPF Magnetic	120V
40828H2	Satin Brass	40829H2	Satin Nickel	2-Pin G24d-2 base	1-2 Lt. HPF Magnetic	277V
40828U	Satin Brass	40829U	Satin Nickel	2x18W Quad	1-2 Lt. HPF Electronic	120/277V
40828D1	Satin Brass	40829D1	Satin Nickel	4-Pin G24q-2 base	1-2 Lt. HPF Electronic Dimmable	120V

## Features

- 1. Diffuser Holder:** Die-cast zinc alloy. Satin brass or satin nickel finish with clear lacquer.
- 2. Diffuser Support Peg:** Turned brass. Satin brass or satin nickel finish with clear lacquer.
- 3. Backplate:** 20 ga. (.036") Die-formed steel, gloss white finish.
- 4. Lamps:** Quad tube compact fluorescent, by others. See chart above for wattage and base type.
- 5. Ballasts:** Class-P, high power factor, 120/277V, encased.
- 6. Diffuser:** 6mm thick (Max.) Glass. See chart above for options.
- 7. Screw:** Nylon. 8-32. To secure Diffuser.

## Electrical

Ballasts	Electronic	Electronic
	120v/277v Unv.	120v Dimmable

Total Input Watts:	38	34
Max. Line Current:	.32/.14	0.28
Power Factor:	>.97	High
Ballast Factor:	>.98	0.8-0.9
THD:	<10%	<10%
Starting Temp:	-18°C (0°F)	50°F

## Labels

UL listed suitable for damp locations.

Job Information	Type:
Job Name:	
Cat. No.:	
Lamp(s):	
Notes:	

Lightolier a Genlyte Thomas Company  
631 Airport Road, Fall River, MA 02720 • (508) 679-8131 • Fax (508) 674-4710  
We reserve the right to change details of design, materials and finish.  
© 2002 Genlyte Thomas Group LLC (Lightolier Division) • A0902

LIGHTOLIER®

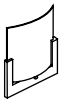

## Hallway / Footcandles

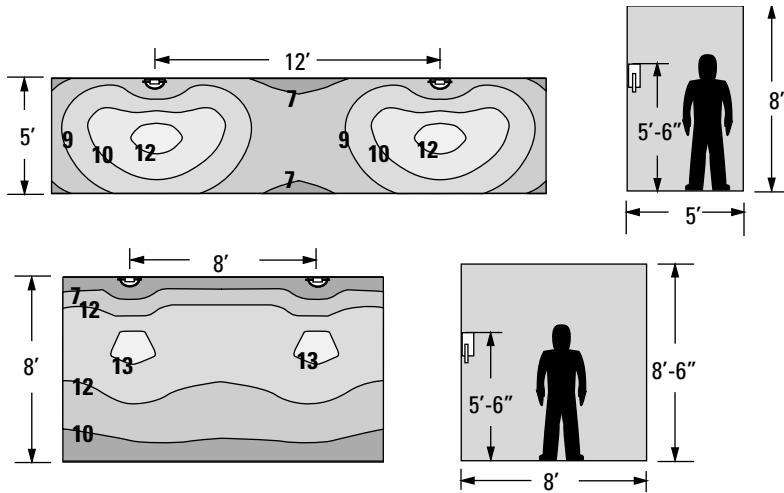

## Vestibule / Conference Room / Footcandles

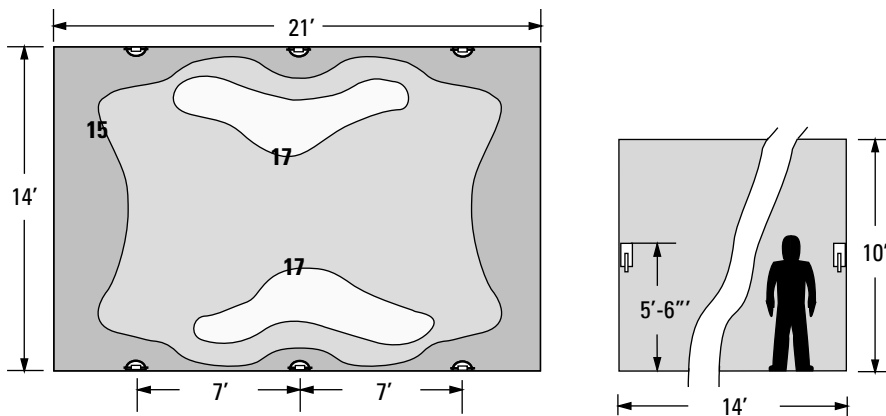

## Reflectances

80% ceiling / 50% wall / 20% floor  
Footcandles are on floor.

## Multiplier Factors

Data shown is based on an "All White" lightshield. For colors use 0.8 multiplier.

### Job Information

### Type:

Lightolier a Genlyte Thomas Company

[www.lightolier.com](http://www.lightolier.com)

631 Airport Road, Fall River, MA 02720 • (508) 679-8131 • Fax (508) 674-4710

We reserve the right to change details of design, materials and finish.

© 2002 Genlyte Thomas Group LLC (Lightolier Division) • A0902

# LIGHTOLIER®