

Narrow T5 Strip **SV T5 Strip**

Features

- Only 2" wide.
- Utilizes compact, high efficiency, T5 or T5HO lamps.
- Fully enclosed wiring.
- Optional white or specular, symmetric and assymetric reflector.
- Convenience outlet and switch K.O.s provided
- Push through lamp holders with rotor for secure lamp retention.
- Optional hangers and wires guards.

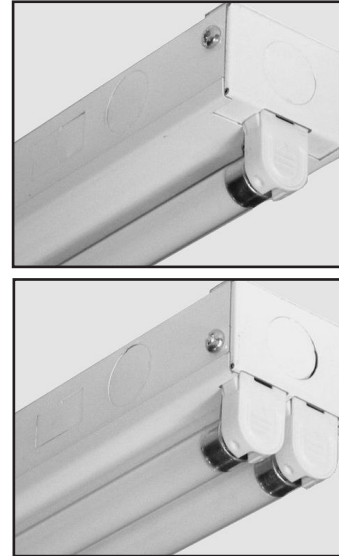

Dimensions

A: 9/16"(14mm) K.O.
 B: 7/8"(22mm) K.O.
 C: CARRIAGE SLOT

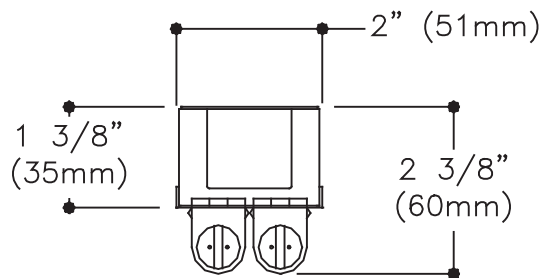
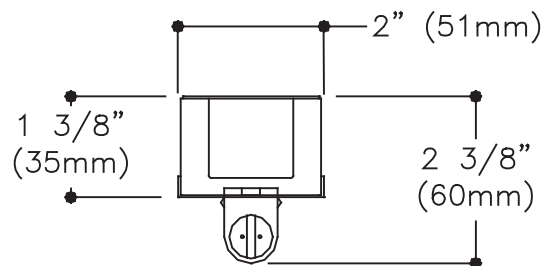
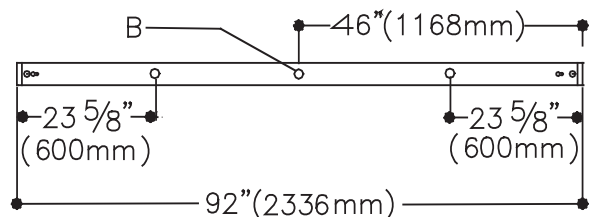
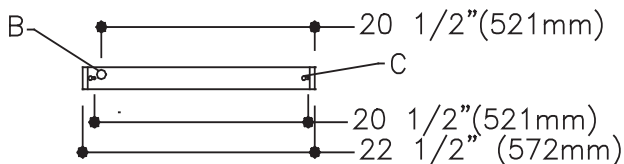
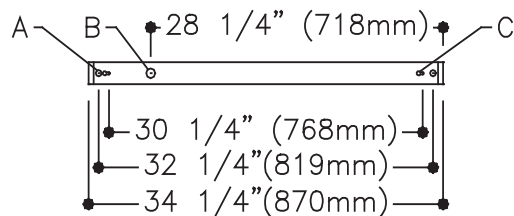
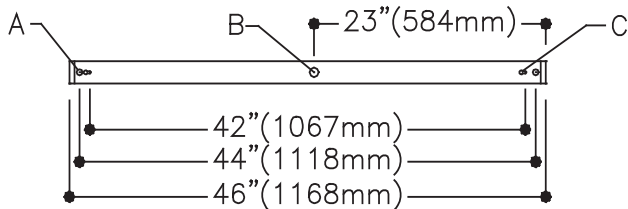

Job Information	Type:
Job Name:	
Cat. No.:	
Lamp(s):	
Volts/Ballast:	

Lightolier a Genlyte Thomas Company www.lightolier.com
 Technical Information: (978) 657-7600 • Fax (978) 658-0595
 631 Airport Road, Fall River, MA 02720 • (508) 679-8131 • Fax (508) 674-4710
 We reserve the right to change details of design, materials and finish.
 Copyright 2002 Lightolier **Section 3A/Folio H120-17**

