

### Ordering Information

Style	Lamps	Length	Type	Wattage	Voltage	Finish
SH	2					
	2 = 2-Lamp T5	4 = 4 Foot 8 = 8 Foot	J = Joiner	28 = 28 watt 54 = 54 watt	1 = 120v 2 = 277v	WH = White Enamel AL = Aluminum Enamel

Complete ordering instructions below.

### Features

- Housing:** Extruded aluminum. Die-cast end plate mechanically attached with no exposed fasteners.
- Lamping:** Two T5 (28 or 54 watt as specified) fluorescent lamps per 4-foot section. Provided by others.
- Reflector:** Die-formed specular aluminum reflector.
- Shielding:** Die-formed perforated 18 gauge CRS.
- Diffuser:** Translucent acrylic diffuser.
- Louver:** Straight blade louver finished to match housing.

### Electrical

Specify 120 volt or 277 volt. Three conductor, 18 gauge wire. Color-coded quick connectors allow ease of connection for joiner modules. For special circuiting, consult factory. Ballast is class "P" electronic, class "A" sound rating, less than 10% THD, thermally protected, end of lamp life cutoff. Factory installed ballast disconnect allows the ballast to be disconnected from and reconnected to incoming power under load without turning the entire circuit off.

### Mountings

Cable suspension - 4-1/2" (11.43cm) diameter canopy finished white enamel, 1/16" (0.16cm) diameter stainless steel aircraft cable adjustable up to 36" (91.44cm). Griplock® with cable adjustment. Draw tight connector create hairline seam between joiner modules.

### Finish

Powder coated baked white or aluminum enamel. Custom colors available, consult factory.

### Options and Accessories

L, T, X inline joiner blocks and emergency battery pack available.

### Labels Included

UL, cUL, and IBEW

### Ordering Instructions

#### Individual Fixtures:

- Order one JOINER MODULE.
- Order one POWER FEED END SET.
- Order one CABLE ASSEMBLY.

#### Continuous Rows:

- Determine run length.
- Order the appropriate number of JOINER MODULES to complete the run.
- Order one POWER FEED END SET per run.
- Order one CABLE ASSEMBLY per JOINER MODULE.
- Maximum run length for a 2-light cross section, 54watt, 120volt is 88' (26.82m).

#### Square/Rectangle Patterns:

- Order appropriate number of JOINER MODULES to complete the pattern size.
- Order number and type of JOINER BLOCKS required.
- Order one CABLE/CORD ASSEMBLY or POWER FEED END SET to power the pattern.
- For patterns that exceed amperage limits, order the appropriate number of CABLE/CORD FEEDS.

Griplock® is a registered trademark of Reutlinger GripLock Systems.

Job Information	Type:
<b>Job Name:</b>	
<b>Cat. No.:</b>	
<b>Lamp(s):</b>	
<b>Notes:</b>	

631 Airport Road, Fall River, MA 02720 • (508) 679-8131 • Fax (508) 674-4710  
 We reserve the right to change details of design, materials and finish.  
 www.lightolier.com © 2008 Philips Group • B1008

### Performance

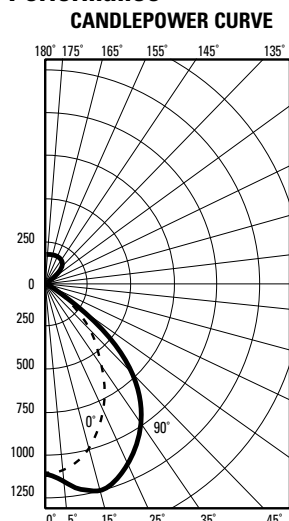

**REPORT NO:** LRL 299-1C  
**CAT NO:** SH241281WH  
**LAMPS:** 2 F28T5  
**LUMENS:** 2900  
**EFFICIENCY:** 54.3%

ZONE DEG.	CANDLEPOWER				
	22	45	67	90	
	<b>CANDELAS</b>				
180	147	147	147	147	147
175	148	147	147	143	143
165	142	135	129	124	122
155	130	117	113	114	117
145	110	97	103	116	120
135	80	76	93	109	115
125	56	61	86	99	102
115	23	35	61	81	87
105	14	26	57	80	75
95	7	26	57	77	51
90	11	34	64	83	46
85	29	48	77	96	67
75	85	98	112	136	137
65	137	185	239	201	188
55	217	315	451	486	468
45	395	511	634	749	772
35	620	758	832	963	1031
25	823	960	1051	1127	1155
15	979	1057	1166	1246	1248
5	1079	1092	1118	1132	1136
0	1099	1099	1099	1099	1099

		COEFFICIENTS OF UTILIZATION								
		% EFFECTIVE CEILING CAVITY REFLECTANCE								
		80		70			50			
		WALL REFLECTANCE								
		70	50	30	70	50	30	50	30	10
ROOM CAVITY RATIO	0	63	63	63	60	60	60	56	56	56
	1	58	56	54	56	54	52	50	48	47
	2	54	50	47	52	48	46	45	43	41
	3	50	45	42	48	44	40	41	38	36
	4	46	41	37	44	40	36	37	34	32
	5	43	37	33	41	36	32	34	31	28
	6	40	34	30	39	33	29	31	28	25
	7	37	31	27	36	30	26	28	25	23
	8	35	28	24	33	27	24	26	23	20
	9	32	26	22	31	25	21	24	21	18
	10	29	23	19	28	22	18	21	18	15

DISTRIBUTION			
Zone	Lumens	% Lamp	% Luminaire
0-90	2666	46.0	84.7
90-180	482	8.3	15.3
0-180	3148	54.3	100.0

Calculations are for 28 watt T5 lamps, for 54 watt T5 lamps multiply by 1.7

### Quick Calculator

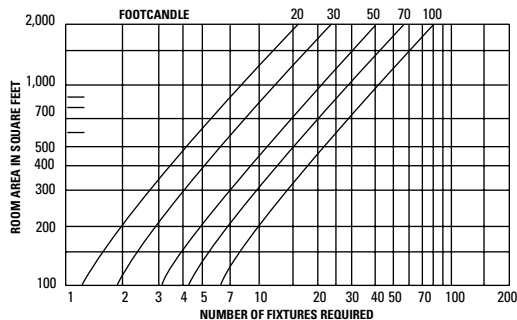

1. Find room area on vertical axis.
2. Move across chart to footcandle curve.
3. Move down to horizontal axis and read number of fixtures required.

### Fixture Lengths & Mounting Locations

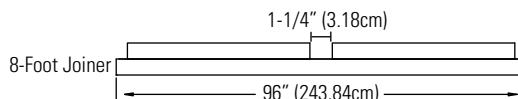
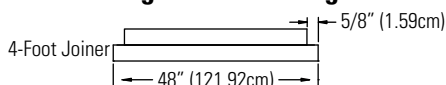

### Sample Run

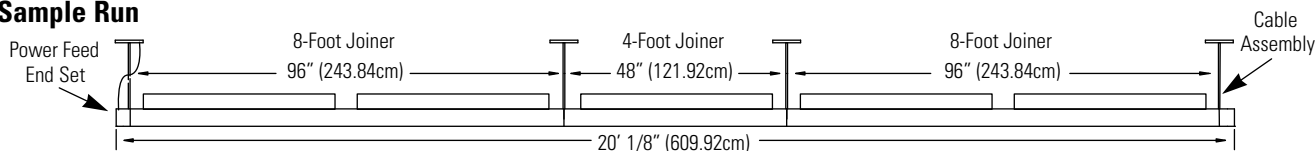

### Mounting & Joinder Block Accessories

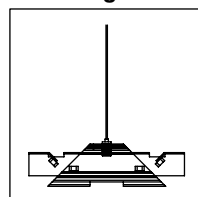

**Cable Assembly**  
SC36

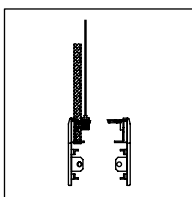

**Power Feed End Set**  
SE36WH (white)  
SE36AL (aluminum)

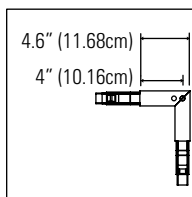

**"L" Block with Suspension**  
SL36WH (white)  
SL36AL (aluminum)

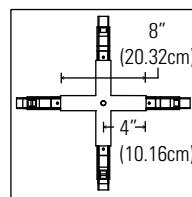

**"X" Block with Suspension**  
SX36WH (white)  
SX36AL (aluminum)

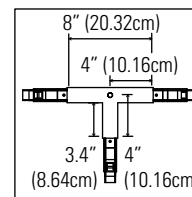

**"T" Block with Suspension**  
ST36WH (white)  
ST36AL (aluminum)

Inline block available (SI36WH or SI36AL).

### Job Information Type:

631 Airport Road, Fall River, MA 02720 • (508) 679-8131 • Fax (508) 674-4710  
 We reserve the right to change details of design, materials and finish.  
 www.lightolier.com © 2008 Philips Group • B1008