

Module Ordering Information

Family	Lamps	Shielding	Voltage	Length	Options
PTS6	1 1 = 1 Lamp	<input type="checkbox"/> O = Open L = Lens S = Straight Blade Louver	<input type="checkbox"/> 1 = 120V 2 = 277V 3 = 347V D1 = 120V Dim. D2 = 277V Dim. E1 = 120V Emerg. E2 = 277V Emerg.	<input type="checkbox"/> 2 = Two-Foot 3 = Three-Foot 4 = Four-Foot 6 = Six-Foot 8 = Eight-Foot	<input type="checkbox"/> Blank = No Options A = Adjustable* X4 = 4 thru wires X5 = 5 thru wires A4 = Adjustable 4 thru wires* A5 = Adjustable 5 thru wires*

* only available on Two-Foot, Three-Foot and Four-Foot versions. See length variations of adjustable fixtures on page 2.

Features

- Housing:** Die-formed 20 gauge pre-painted steel. Integral heavy gauge bulkheads support housing and trim, permitting modules to be bolted together in continuous runs and facilitate suspension.
- Lamping:** Cross-sectional one linear T8 fluorescent lamp. Provided by others.
- Reflector:** Precision die-formed CRS finished in a high reflective baked white powder coat.
- Louver:** Lift and shift straight blade louver constructed from die-formed aluminum and painted to match housing. Louver blades are 1" (2.54cm) high on 1-1/8" (2.86cm) centers. (Optional)

Mounting

"J" Rail is first mounted to the wall and the modules connect to the rail for 1/4" (0.64cm) wall adjustment. Modules are hung from suspension wires attached to the fixture bulkheads and the structure above.

Electrical

Electronic Ballast: Programmed start, 3 conductor, 12 gauge wire. Color-coded quick connectors allow easy connection for modular fixtures. Factory installed ballast disconnect allows the ballast to be disconnected from and reconnected to incoming power under load without turning the entire circuit off.

Dimming: Advance Mark X, use Advance compatible two-wire control (no extra control lead required).

Emergency Battery Pack: 450 Lumens @ 90 minimum.

Ordering Instructions

Individual Fixtures:

- Order number of MODULES required.
- Order one END SET per MODULE.

Continuous Rows:

- Determine run length.
- Order the appropriate number of MODULES for the complete ROW.
- Stagger rows must be completed with an adjustable module. (2-light only)
- Non-stagger rows must be completed with an adjustable module unless row lengths are in precise 1 foot (30.48cm) intervals.
- Order one END SET per ROW.

Labels

UL, cUL and IBEW

Job Information

Type:

Job Name:

Cat. No.:

Lamp(s):

Notes:

631 Airport Road, Fall River, MA 02720 • (508) 679-8131 • Fax (508) 674-4710
We reserve the right to change details of design, materials and finish.
www.lightolier.com © 2008 Philips Group • C0908

Performance & Quick Calculators

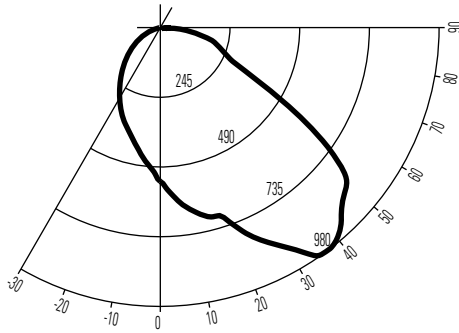

Report No: ITL53555
Cat No: PTS61S14
Lamps: 1 F32T8
Lumens: 2950
Efficiency: 48.1%

ZONE DEG.	CANDLEPOWER				
	0	45	90	135	180
180	0	0	0	0	0
175	0	0	0	0	0
165	0	0	0	0	0
155	0	0	0	0	0
145	0	0	0	0	0
135	0	0	0	0	0
125	0	0	0	0	0
115	0	0	0	0	0
105	0	0	0	0	0
95	0	0	0	0	0
90	31	28	0	0	0
85	76	49	9	9	0
75	197	153	43	41	18
65	280	228	84	77	64
55	702	284	133	126	118
45	900	498	209	184	179
35	977	585	312	253	247
25	822	591	404	329	324
15	689	621	480	409	395
5	607	589	536	501	484
0	541	541	541	541	541

COEFFICIENTS OF UTILIZATION

ROOM CAVITY RATIO	% EFFECTIVE CEILING CAVITY REFLECTANCE								
	80			70			50		
	% WALL REFLECTANCE								
	70	50	30	70	50	30	50	30	10
0	57	57	57	56	56	53	53	53	53
1	53	50	48	51	49	47	47	46	44
2	48	44	41	47	43	40	42	39	37
3	44	39	35	43	38	35	37	34	31
4	40	35	31	39	34	30	33	30	27
5	37	31	27	36	31	27	30	26	23
6	34	28	24	33	28	24	27	23	21
7	32	26	21	31	25	21	24	21	18
8	30	23	19	29	23	19	22	16	16
9	28	21	17	27	21	17	21	17	15
10	26	20	16	25	19	16	19	16	13

Floor cavity reflectance = 20%

ZONAL LUMEN SUMMARY

ZONE	LUMENS	% BARELAMP	% LUMINAIRE
0-90	1420	48.1	100.0
90-180	0.0	0.0	0.0
0-180	1420	48.1	100.0

Sample Run

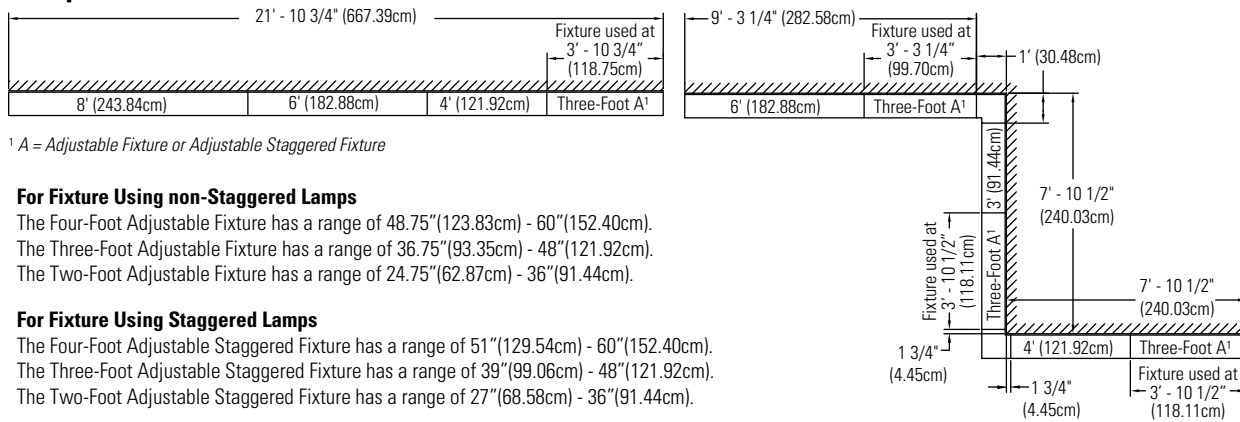

¹ A = Adjustable Fixture or Adjustable Staggered Fixture

For Fixture Using non-Staggered Lamps

The Four-Foot Adjustable Fixture has a range of 48.75"(123.83cm) - 60"(152.40cm).
 The Three-Foot Adjustable Fixture has a range of 36.75"(93.35cm) - 48"(121.92cm).
 The Two-Foot Adjustable Fixture has a range of 24.75"(62.87cm) - 36"(91.44cm).

For Fixture Using Staggered Lamps

The Four-Foot Adjustable Staggered Fixture has a range of 51"(129.54cm) - 60"(152.40cm).
 The Three-Foot Adjustable Staggered Fixture has a range of 39"(99.06cm) - 48"(121.92cm).
 The Two-Foot Adjustable Staggered Fixture has a range of 27"(68.58cm) - 36"(91.44cm).

End Plate and Corner Block Accessories

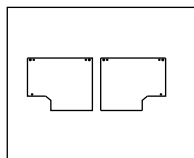

End Cap Set:
PTSEP

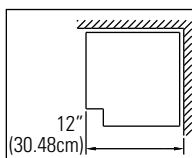

90° Inside Corner:
 PTS690INCO - Open
 PTS690INCL - Lens
 PTS690INCS - Straight Blade Louver

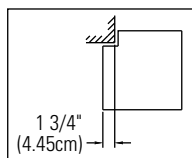

90° Outside Corner:
 PTS690OTCO - Open
 PTS690OTCL - Lens
 PTS690OTCS - Straight Blade Louver

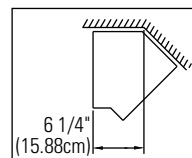

135° Inside Corner:
 PTS6135INCO - Open
 PTS6135INCL - Lens
 PTS6135INCS - Straight Blade Louver

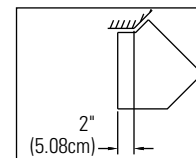

135° Outside Corner:
 PTS6135OTCO - Open
 PTS6135OTCL - Lens
 PTS6135OTCS - Straight Blade Louver

Job Information	Type:
-----------------	-------

631 Airport Road, Fall River, MA 02720 • (508) 679-8131 • Fax (508) 674-4710
 We reserve the right to change details of design, materials and finish.
 www.lightolier.com © 2008 Philips Group • C0908