

8684 Mirrored Globe

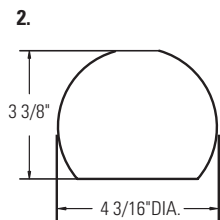

8685 Globe

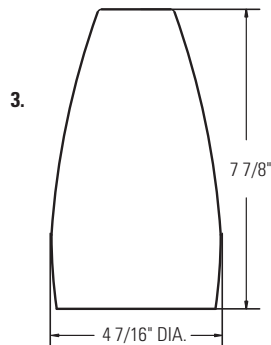

8686 Tall Bell

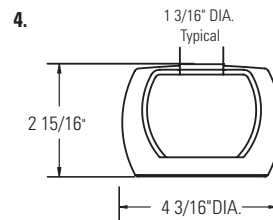

8687 Mini Barrel

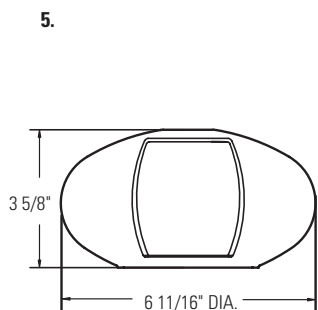

8682 Transparent with Swirl

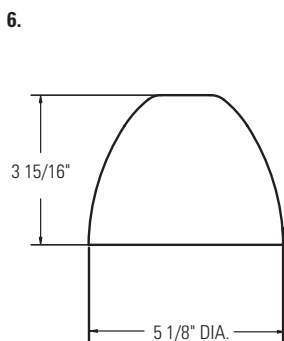

8680 Textured Bell

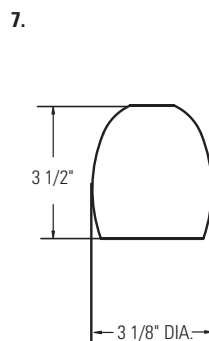

8681 Beehive

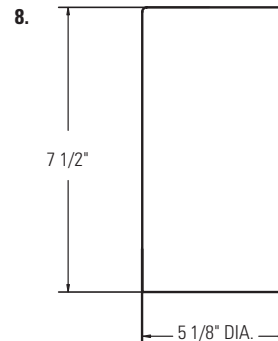

8683 Transparent Cylinder

Catalog No.	Finish	Description
8684MR	Mirror	Mirrored Globe: Semi transparent mirror elegantly fades to clear mouth blown glass providing a soft glow.
8685LC	Light Caramel	Globe: Provides a soft warm glow while promoting downward light.
8686LC	Light Caramel	Tall Bell: Creates a warm focal glow and delivers a soft downward pool of light.
8687CL	Clear	Mini Barrel: Double barrel concept creates an array of soft translucent light.
8687CB	Champagne Beige	Mini Barrel: Double barrel concept creates an array of soft translucent light.
8687BL	Blue	Mini Barrel: Double barrel concept creates an array of soft translucent light.
8682WH	Clear Swirl	Transparent with Swirl: Translucent white opal glass, glows warmly through the rich white glass thread decor.
8680WH	White	Textured Bell: Soft textured white opal glass delivers a soft glow and directs downward light.
8681WH	White	Beehive: Concentrated light gently glows through the textured mouth blown glass.
8683WH	White	Transparent Cylinder: White opal glass creates a translucent glow. Clear glass radiates beautifully.

Features

1. Mouth blown clear glass with semi transparent mirror
2. Mouth blown cased glass, matte surface
3. Mouth blown cased glass, matte surface
4. Mouth blown transparent glass, with glossy finish
 - a. Inside piece: Mouth blown translucent opal glass. Matte surface
5. Mouth blown clear glass thread decor. Glossy surface.
 - a. Inside piece: Mouth blown translucent opal glass. Matte surface
6. Mouth blown textured glass bell, with linen structure. Matte surface.
7. Mouth blown textured glass with linen structure. Matte surface.
8. Mouth blown, upper part translucent opal, lower part clear with glossy surface.

Features

Mouth blown glass.

Labels

UL

Job Information	Type:
Job Name:	
Cat. No.:	
Lamp(s):	
Notes:	

Lightolier a Genlyte company www.lightolier.com
 631 Airport Road, Fall River, MA 02720 • (508) 679-8131 • Fax (508) 674-4710
 We reserve the right to change details of design, materials and finish.
 © 2005 Genlyte Group LLC • A1205

LIGHTOLIER®