

## Ordering Information

Style	Lamps	Length	Type	Wattage	Voltage	Finish
SA	1					
	1 = 1-Lamp T5	4 = 4 Foot 8 = 8 Foot	J = Joiner	28 = 28 watt 54 = 54 watt	1 = 120v 2 = 277v	WH = White Enamel AL = Aluminum Enamel

Complete ordering instructions below.

## Features

- Housing:** Extruded aluminum. Die-cast end plate mechanically attached with no exposed fasteners.
- Lamping:** One T5 (28 or 54 watt as specified) fluorescent lamp per 4-foot section. Provided by others.
- Reflector:** Die-formed specular aluminum reflector.
- Shielding:** Die-formed perforated 18 gauge CRS.
- Diffuser:** Translucent acrylic diffuser.

## Electrical

Specify 120 volt or 277 volt. Three conductor, 18 gauge wire. Color-coded quick connectors allow ease of connection for joiner modules. For special circuiting, consult factory. Ballast is class "P" electronic, class "A" sound rating, less than 10% THD, thermally protected, end of lamp life cutoff. Factory installed ballast disconnect allows the ballast to be disconnected from and reconnected to incoming power under load without turning the entire circuit off.

## Mountings

Cable suspension - 4-1/2" (11.43cm) diameter canopy finished white enamel, 1/16" (0.16cm) diameter stainless steel aircraft cable adjustable up to 36" (91.44cm). Griplock® with cable adjustment. Draw tight connector create hairline seam between joiner modules.

## Finish

Powder coated baked white or aluminum enamel.  
Custom colors available, consult factory.

## Options and Accessories

L, T, X inline joiner blocks and emergency battery pack available.

## Labels Included

UL, cUL, and IBEW

## Ordering Instructions

### Individual Fixtures:

- Order one JOINER MODULE.
- Order one POWER FEED END SET.
- Order one CABLE ASSEMBLY.

### Continuous Rows:

- Determine run length.
- Order the appropriate number of JOINER MODULES to complete the run.
- Order one POWER FEED END SET per run.
- Order one CABLE ASSEMBLY per JOINER MODULE.
- Maximum run length for a 2-light cross section, 54watt, 120volt is 88' (26.82m).

### Square/Rectangle Patterns:

- Order appropriate number of JOINER MODULES to complete the pattern size.
- Order number and type of JOINER BLOCKS required.
- Order one CABLE/CORD ASSEMBLY or POWER FEED END SET to power the pattern.
- For patterns that exceed amperage limits, order the appropriate number of CABLE/CORD FEEDS.

Griplock® is a registered trademark of Reutlinger GripLock Systems.

Job Information	Type:
<b>Job Name:</b>	
<b>Cat. No.:</b>	
<b>Lamp(s):</b>	
<b>Notes:</b>	

631 Airport Road, Fall River, MA 02720 • (508) 679-8131 • Fax (508) 674-4710  
We reserve the right to change details of design, materials and finish.  
www.lightolier.com © 2008 Philips Group • B1008

### Performance

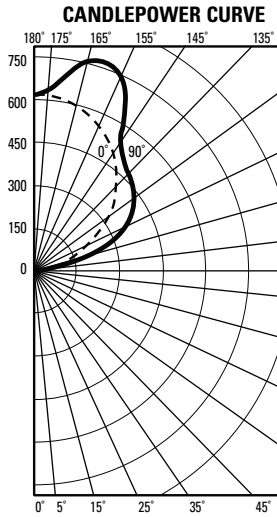

REPORT NO: LRL 299-1J  
 CAT NO: SA141281VH  
 LAMPS: 1 F28T5  
 LUMENS: 2900  
 EFFICIENCY: 81.7%

ZONE DEG.	CANDLEPOWER				
	22	45	67	90	
	CANDELAS				
180	607	607	607	607	607
175	606	613	571	629	631
165	592	629	668	710	705
155	557	626	686	689	682
145	492	595	598	537	528
135	399	496	429	448	461
125	313	363	363	437	434
115	206	236	312	339	346
105	113	171	202	216	217
95	23	47	48	54	57
90	6	9	22	38	43
85	5	10	26	43	46
75	4	16	34	51	53
65	7	20	38	52	58
55	17	32	48	63	63
45	20	33	45	58	61
35	30	34	47	57	59
25	35	33	43	50	52
15	39	36	37	40	41
5	42	41	40	39	38
0	40	40	40	40	40

		COEFFICIENTS OF UTILIZATION								
		% EFFECTIVE CEILING CAVITY REFLECTANCE								
ROOM CAVITY RATIO		80			70			50		
		WALL REFLECTANCE								
		70	50	30	70	50	30	50	30	10
0	80	80	80	69	69	69	50	50	50	
1	72	69	65	62	60	57	43	41	40	
2	66	60	55	57	52	48	37	35	33	
3	60	52	47	51	45	41	33	30	27	
4	54	46	40	47	40	35	29	25	23	
5	50	41	34	43	35	30	25	22	19	
6	45	36	30	39	31	26	23	19	16	
7	42	32	26	36	28	23	20	17	14	
8	38	29	23	33	25	20	18	15	12	
9	36	26	20	31	23	18	17	13	11	
10	33	24	18	29	21	16	15	12	9	

DISTRIBUTION			
Zone	Lumens	% Lamp	% Luminaire
0-90	236	8.1	10.0
90-180	2134	73.6	90.0
0-180	2370	81.7	100.0

Calculations are for 28 watt T5 lamps, for 54 watt T5 lamps multiply by 1.7

### Quick Calculator and Ceiling Brightness

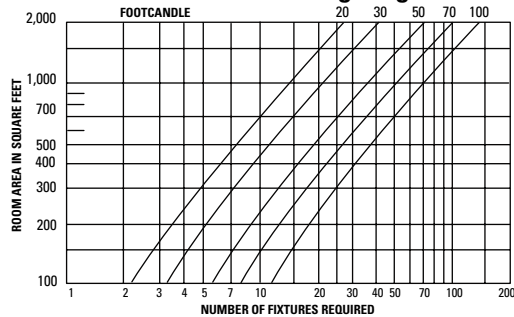

1. Find room area on vertical axis.
2. Move across chart to footcandle curve.
3. Move down to horizontal axis and read number of fixtures required.

Suspension Length	12"	18"	24"
Footlamberts Above Fixture	223	158	121
Footlamberts Between Fixtures	23.5	25.2	27.9
Ceiling Brightness Ratio	9.9	6.3	4.3

Reflectances of 80% ceiling, 50% walls and 20% floor. Light loss factor is .85, Room size is 50' x 50', Run Spacing 10'. Ceiling Height 9' to 12'. Values are taken from the center of the room.

### Fixture Lengths & Mounting Locations

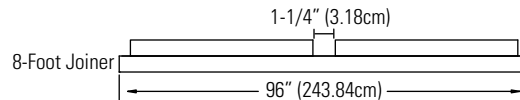
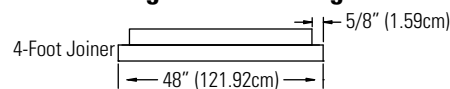

### Sample Run

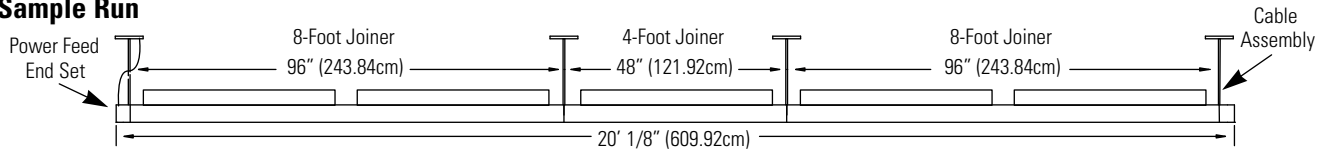

### Mounting & Joiner Block Accessories

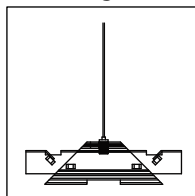

Cable Assembly  
SC36

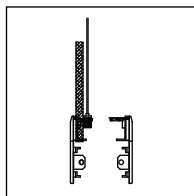

Power Feed End Set  
SE36WH (white)  
SE36AL (aluminum)

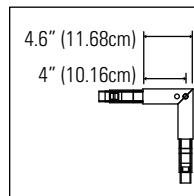

"L" Block with Suspension  
SL36WH (white)  
SL36AL (aluminum)

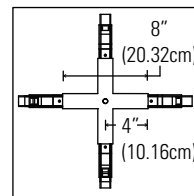

"X" Block with Suspension  
SX36WH (white)  
SX36AL (aluminum)

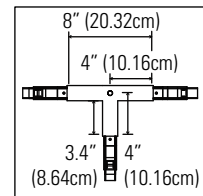

"T" Block with Suspension  
ST36WH (white)  
ST36AL (aluminum)

Inline block available (SI36WH or SI36AL).

### Job Information Type:

631 Airport Road, Fall River, MA 02720 • (508) 679-8131 • Fax (508) 674-4710  
 We reserve the right to change details of design, materials and finish.  
 www.lightolier.com © 2008 Philips Group • B1008