

Ordering Information

Family	Series	Type	Lamps	Color	Wattage	Voltage	Length	Options
F7	3 3 = Block	7 7 = Point Source	1 = 1 Lamp 2 = 2 Lamps 4 = 4 Lamps	AL = Aluminum WH = White	7 = 20W HID 8 = 39W HID 9 = 75W MR16	1 = 120v 2 = 277v	1 = 1' (30.48cm) 2 = 2' (90.96cm) 4 = 4' (121.92cm)	X4 = 4 Through Wires X5 = 5 Through Wires

Complete Ordering Instructions below.

Features

- Housing:** Unitized body of extruded high-purity aluminum, partially recycled pre-consumer, with die-cast ends welded in place; matched to fluorescent modules in the series. All modules connect and suspend like fluorescent modules.
- Housing End:** Die-cast aluminum, welded to the ends of the housing.
- End Cap:** Die-cast aluminum. Encloses the suspension cable and power feed cord for the end of the run.
- MR16:** Lamping is 75W maximum. Transformer is electronic, 12V secondary, 120V or 277V primary (as specified) Gimbal ring provided as part of the module and regressed into it. 45° aiming; accepts one standard Lytespan 2" (5.08cm) filter or louver; regressed lamp pulls out for relamping. The 12" (30.48cm) MR16 module can be cantilevered from the end of a run of fluorescent fixtures.
- Metal Halide:** Lamping is 20W or 39W. Ballast is electronic, 20W or 39W, as specified, 120V or 277V, as specified. Connector accepts selected Lytespan PowerArc Modular Track heads. Compatible Track heads include standard Lytespan PowerArc modular track heads, which connect to the module. 8300, 8303, 8304, 8313, 8314, 8316, and 83W4 with applicable reflectors. Track heads and applicable reflectors must be specified and ordered separately, including appropriate finish. Finish is powder-coated, baked enamel, white or aluminum, as specified.
- Electrical:** Pre-wired with 18 gauge wires and polarized cannon plug connectors for simultaneous mechanical/electrical connection. Factory installed ballast disconnect allows the ballast to be disconnected from and reconnected to incoming power under load without turning the entire circuit off.

- Finish:** Powder-coated, baked enamel, white or aluminum, as specified.
- Power Feeds:** Standard 18/3 power feed is rated for 10 amps. X4 power feed is 18/4 and is rated for 7 amps. Observe amperage limitations and provide additional Intermediate Power Cables, as required. When providing an additional power feed, the through wiring from the previous module must be disconnected from the cannon plug and capped.
- Mounting:** Suspended by 1/16" (0.16cm) stainless steel cable, adjustable; precisely modular 1' (30.48cm), 2' (90.96cm) or 4' (121.92cm) suspension centers; 4 1/2" (11.43cm) white canopy.

Labels

UL, cUL and I.B.E.W.

Job Information	Type:
Job Name:	
Cat. No.:	
Lamp(s):	
Notes:	

631 Airport Road, Fall River, MA 02720 • (508) 679-8131 • Fax (508) 674-4710
 We reserve the right to change details of design, materials and finish.
 www.lightolier.com © 2008 Philips Group • D0808

MR16

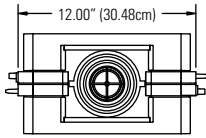

1 Light MR16

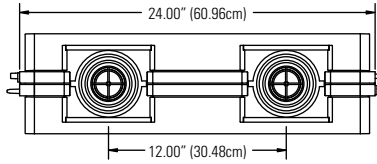

2 Light MR16

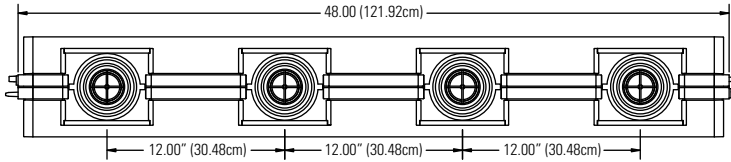

4 Light MR16

HID

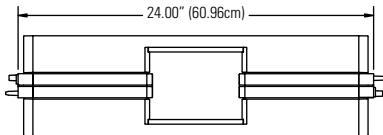

1 Light HID

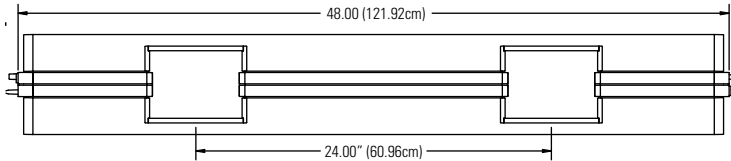

2 Light HID

Job Information

Type:

631 Airport Road, Fall River, MA 02720 • (508) 679-8131 • Fax (508) 674-4710
We reserve the right to change details of design, materials and finish.
www.lightolier.com © 2008 Philips Group • D0808